

Internal B1A				
Deerfield 2 - Phase 2				
PURCHASER: Portobello Partnership			Printed: 2-Sep-21 7:42 am	
LOT NUMBER B06		PHASE 2	HOUSE TYPE 120 THE HUNTLEY	CLOSING DATE 1-Dec-21
ITEM	QTY	EXTRA / CHANGE	PRICE	INTERNAL USE
*17 90565 35961	1 -	- BONUS - APPLIANCES - 3 BASIC STAINLESS STEEL KITCHEN APPLIANCES INCLUDING MICROWAVE COMBO HOODFAN, AND BASIC TOP LOAD WHITE WASHER AND DRYER. Note:	\$ 0.00	Each
18 88290 35962	1 -	- FLAT CEILING IN WHOLE HOUSE Note: Includes Family Room in Basement	\$ 2,245.00	Each
19 35963	1 -	- KITCHEN - DELETE ITEM #5 IN B1A'S (RE: UPGRADE KITCHEN CABINETRY TO LEVEL 1). Note:	-\$2,108.00	Each
20 35966	1 -	- DELETE ITEM # 10 IN B1A'S (RE: SUPPLY AND INSTALL OAK STAIRCASE WITH VENEERED RISERS & STRINGERS AND SOLID TREADS, PER STAIRCASE IN LIEU OF STANDARD STAIRCASE FROM MAIN FLOOR TO SECOND LEVEL). Note:	-\$6,078.00	Each
21 35969	1 -	- KITCHEN - DELETE ITEM #11 IN B1A'S (RE: UPC9-2A LEVEL 1 CABINETRY STANDARD LAYOUT. INCLUDES 42IN UPPERS WITH FILLER DETAIL ON UPPER KITCHEN CABINETRY TO STANDARD BULKHEAD). Note:	-\$647.00	Each
*22 103637 35977	1 -	- KITCHEN - CABINETRY - UPC9-2A - BUILDERS STANDARD CABINETRY - STANDARD LAYOUT. INCLUDES UPGRADE TO 42IN UPPERS WITH FILLER DETAIL ON UPPER KITCHEN CABINETRY TO STANDARD BULKHEAD Note: As per UPC Sketch and kitchen sketch dated August 25, 2021. Purchaser Acknowledges and accepts that Upper Kitchen cabinetry upgraded wood doors will have center style.	*\$ 488.00	Each
23 35972	1 -	- KITCHEN - IN REFERENCE TO ITEM # 6 IN B1A'S, KITCHEN COUNTERTOP AND FLUSH BREAKFAST BAR TO BE EASED EDGE DETAIL. Note: As per countertop edge profile sketch dated August 25, 2021.	\$ 0.00	Each
24 35973	1 -	- KITCHEN - DELETE ITEM # 12 IN B1A'S (RE: KITCHEN SINK FRANKE CUBE CUX110-30-CA SINGLE BOWL STAINLESS STEEL 9" DEEP UNDERMOUNT SINK). Note:	-\$855.00	Each
25 88544 35974	1 -	- KITCHEN - KITCHEN SINK - REGINOX ND1831UA/9 DOUBLE BOWL UNDERMOUNT SINK Note: See item # 6 for solid surface countertops. See item # 27 for faucet.	\$ 143.00	Each
26 35975	1 -	- KITCHEN - DELETE ITEM # 13 IN B1A'S (RE: KITCHEN FAUCET DELTA ESSA 9113 AR DST ARCTIC STAINLESS SINGLE HANDLE PULL DOWN). Note:	-\$456.00	Each
*27 88428 35976	1 -	- KITCHEN - KITCHEN FAUCET - DELTA MARLEY 986LF - AR ARCTIC STAINLESS Note: See item # 6 for solid surface countertops. See item # 25 for sink.	*\$ 357.00	Each
28 90835 35978	1 -	- KITCHEN - CABINETRY - EXTEND FRIDGE UPPER TO APPROX. 2FT DEEP (ALL SERIES) Note: In standard series cabinetry, as per kitchen sketch and Schedule H dated August , 2021.	\$ 187.00	Each

Internal B1A Deerfield 2 - Phase 2				
PURCHASER: Portobello Partnership			Printed: 2-Sep-21 7:42 am	
LOT NUMBER B06		PHASE 2	HOUSE TYPE 120 THE HUNTLEY	CLOSING DATE 1-Dec-21
ITEM	QTY	EXTRA / CHANGE	PRICE	INTERNAL USE
29 87999	1	KITCHEN - LOWER CABINETS - LC POTS & PANS C/W 3 DRAWER FRONTS 6/12/12	\$ 704.00	Each
35979	Note:	In standard series cabinetry. To be located between Dining Room and range, as per kitchen sketch and Schedule H dated August 25, 2021.		
30 35980	1	KITCHEN - SUPPLY AND INSTALL CABINETRY HARDWARE POI-V53-192-Z23, IN STANDARD LAYOUT KITCHEN, HORIZONTAL INSTALL, INCLUDING POTS AND PANS 3 DRWS. Note: See item 29	\$ 662.00	Each
31 35981	1	MAIN BATHROOM - SUPPLY AND INSTALL CABINETRY HARDWARE POI-V53-192-Z23, IN MAIN BATHROOM, HORIZONTAL INSTALL. Note:	\$ 63.00	Each
32 35982	1	ENSUITE BATH - SUPPLY AND INSTALL CABINETRY HARDWARE POI-V53-192-Z23, IN 4 PCE ENSUITE BATHROOM, HORIZONTAL INSTALL. Note:	\$ 126.00	Each
33 35983	1	MAIN BATHROOM - SUPPLY AND INSTALL UPGRADED LAMINATE ON COUNTERTOP IN MAIN BATHROOM. Note: As per Schedule H dated August 25, 2021.	\$ 84.00	Each
34 35984	1	ENSUITE BATH - SUPPLY AND INSTALL UPGRADED LAMINATE ON COUNTERTOP IN 4 PCE ENSUITE BATHROOM. Note: As per Schedule H dated August 25, 2021.	\$ 105.00	Each
35 130 35985	1	KITCHEN - TILE - WALL - BACKSPLASH - UPGRADE - SILVER - - KITCHEN - SILVER Note: As per wall tile installation sketch dated August 25, 2021.	\$ 150.00	Each
36 88508 35987	1	- - CERAMIC TILE - GROUT COLOR PER COLOUR Note:	\$ 75.00	Each
37 137 35988	1	MAIN BATHROOM - TILE - WALL - UPGRADE - FLOOR TILE IN LIEU OF WALL - BRONZE - MAIN BATHROOM - BRONZE Note: As per wall tile installation sketch dated August 25, 2021.	\$ 624.00	Each
38 137 35989	1	ENSUITE BATH - TILE - WALL - UPGRADE - FLOOR TILE IN LIEU OF WALL - BRONZE - - APPROXIMATELY 5 FOOT x 3 FOOT CERAMIC SHOWER - BRONZE Note: In 4 Pce Ensuite bathroom, as per wall tile installation sketch dated August 25, 2021. -See Item 4 (4PCE Ensuite Bathroom).	\$ 745.00	Each
39 137 35990	1	ENSUITE BATH - TILE - WALL - UPGRADE - FLOOR TILE IN LIEU OF WALL - BRONZE - - TUB SURROUND - ENSUITE BATHROOM - OPTIONAL (20) - BRONZE Note: In 4 Pce Ensuite bathroom, includes tub deck and tub backsplash, as per wall tile installation sketch dated August 25, 2021.	\$ 274.00	Each
40 35991	1	- - SUPPLY AND INSTALL QUOTE LEVEL CARPET BEAULIEU SILEX II BROADLOOM CARPET, CHINESE DESERT 89809, IN STAIRS TO SECOND LEVEL. Note: As per Schedule H dated August 25, 2021.	\$ 1,500.00	Each

Internal B1A Deerfield 2 - Phase 2				
PURCHASER: Portobello Partnership		Printed: 2-Sep-21 7:42 am		
LOT NUMBER B06	PHASE 2	HOUSE TYPE 120 THE HUNTLEY	CLOSING DATE 1-Dec-21	
ITEM	QTY	EXTRA / CHANGE	PRICE	INTERNAL USE
41		1 - - SUPPLY AND INSTALL QUOTE LEVEL CARPET BEAULIEU SILEX II BROADLOOM CARPET, CHINESE DESERT 89809, IN STAIRS TO BASEMENT.	\$ 1,500.00	Each
35992		Note: As per Schedule H dated August 25, 2021.		
*42		*1 - - UNDERPAD - UPGRADE - LEVEL 1 - - UPPER STAIRCASE - LEVEL 1	*\$ 100.00	Each
107				
36052		Note: To be installed in Main floor stairs to upper level, as per Schedule H dated August 25, 2021.		
*43		*1 - - UNDERPAD - UPGRADE - LEVEL 1 - - BASEMENT STAIRCASE - LEVEL 1	*\$ 94.00	Each
107				
36051		Note: To be installed in stairs to basement, as per Schedule H dated August 25, 2021.		
44		1 - <i>FOYER</i> - SUPPLY AND INSTALL TORLYS EVERTILE PREMIER ET24013 CALCATTA 11-1/2" WIDE x 23-5/8" LONG, SIDE TO SIDE AND 1/2 BRICK INSTALLATION.	\$ 371.00	Each
35995		Note: To be installed in Foyer and Powder Room, as per Schedule H and wall tile installation sketch dated August 25, 2021.		
45		1 - <i>LAUNDRY ROOM</i> - SUPPLY AND INSTALL TORLYS EVERWOOD PREMIER 23001 BEACH HOUSE 4-7/8" WIDE x 48-3/8" LONG PLANK, FRONT TO BACK INSTALLATION.	\$ 0.00	Each
35996		Note: To be installed in Laundry Room, as per Schedule H dated August 25, 2021.		
46		1 - <i>KITCHEN/DINETTE</i> - SUPPLY AND INSTALL TORLYS EVERWOOD PREMIER 23001 BEACH HOUSE 4-7/8" WIDE x 48-3/8" LONG PLANK, FRONT TO BACK INSTALLATION.	\$ 0.00	Each
35997		Note: To be installed in Kitchen, as per Schedule H dated August 25, 2021.		
47		1 - <i>MAIN BATHROOM</i> - SUPPLY AND INSTALL TORLYS EVERWOOD PREMIER 23001 BEACH HOUSE 4-7/8" WIDE x 48-3/8" LONG PLANK, FRONT TO BACK INSTALLATION.	\$ 0.00	Each
35998		Note: To be installed in Main bathroom, as per Schedule H dated Augiust 25, 2021.		
48		1 - <i>ENSUITE BATH</i> - SUPPLY AND INSTALL TORLYS EVERWOOD PREMIER 23001 BEACH HOUSE 4-7/8" WIDE x 48-3/8" LONG PLANK, FRONT TO BACK INSTALLATION.	\$ 113.00	Each
35999		Note: To be installed in 4 Pce Ensuite bathroom, as per Schedule H dated August 25, 2021.		
49		1 - <i>GREAT ROOM</i> - SUPPLY AND INSTALL TORLYS EVERWOOD PREMIER 23001 BEACH HOUSE 4-7/8" WIDE x 48-3/8" LONG PLANK, FRONT TO BACK INSTALLATION. (ALL STANDARD AREAS).	\$ 0.00	Each
36000		Note: To be installed in Great Room, Dining Room, Lower Hallway and Upper Hallway, as per Schedule H date August 25, 2021.		
50		1 - <i>BASEMENT</i> - SUPPLY AND INSTALL TORLYS EVERWOOD PREMIER 23001 BEACH HOUSE 4-7/8" WIDE x 48-3/8" LONG PLANK, FRONT TO BACK INSTALLATION.	\$ 4,755.00	Each
36001		Note: To be installed in Basement, as per Schedule H dated August 25, 2021.		
51		1 - <i>BEDROOM 2</i> - SUPPLY AND INSTALL TORLYS EVERWOOD PREMIER 23001 BEACH HOUSE 4-7/8" WIDE x 48-3/8" LONG PLANK, FRONT TO BACK INSTALLATION.	\$ 1,703.00	Each
36002		Note: To be installed in Bedroom #2, as per Schedule H dated August 25, 2021.		
52		1 - <i>BEDROOM 3</i> - SUPPLY AND INSTALL TORLYS EVERWOOD PREMIER 23001 BEACH HOUSE 4-7/8" WIDE x 48-3/8" LONG PLANK, FRONT TO BACK INSTALLATION.	\$ 1,922.00	Each
36003		Note: To be installed in Bedroom #3, as per Schedule H dated August 25, 2021.		

Internal B1A Deerfield 2 - Phase 2				
PURCHASER: Portobello Partnership		Printed: 2-Sep-21 7:42 am		
LOT NUMBER B06	PHASE 2	HOUSE TYPE 120 THE HUNTLEY	CLOSING DATE 1-Dec-21	
ITEM	QTY	EXTRA / CHANGE	PRICE	INTERNAL USE
53 36004	1 - MASTER BEDROOM - SUPPLY AND INSTALL TORLYS EVERWOOD PREMIER 23001 BEACH HOUSE 4-7/8" WIDE x 48-3/8" LONG PLANK, FRONT TO BACK INSTALLATION. Note: To be installed in Master Bedroom and WIC, as per Schedule H dated August 25, 2021.		\$ 3,088.00	Each
54 88441 36005	1 - ENSUITE BATH - BATHROOMS - ZITTA NICHE 12X12 STAINLESS STEEL Note: To be installed on small wall in shower opposite shower head in 4 Pce Ensuite bathroom. Top of niche to be installed approximately 5'-0" from floor and centered, as per Schedule H dated August 25, 2021. See item 4		\$ 447.00	Each
55 36050	1 - - CLARIFICATION TO ITEMS 7-8-9: Railing to include METAL BRACKETS where necessary Note:		\$ 0.00	Each
56 36053	1 - ENSUITE BATH - Delete item 16: Duplicate item Note: See item 4		\$ 0.00	Each
			Sub Total	\$12,481.00
			HST	\$0.00
			Total	\$12,481.00

Payment Summary	
<u>Paid By</u>	<u>Amount</u>
APS	\$12,481.00
<u>Total Payment:</u>	<u>\$12,481.00</u>

PURCHASER:

Portobello Partnership

25-Aug-21
DATE

VENDOR:

PER: Valecraft Homes Limited

DATE:

CONSTRUCTION SCHEDULING APPROVAL	
PER:	_____
DATE:	_____

OPTIONAL KITCHEN CABINET CROWN MOULDING,
FILLER & **STANDARD** BULKHEAD DETAILS

UPC9-1B Upgrade #: N/A

- Includes upgrade to 40" uppers with filler detail & valence on upper kitchen cabinetry. Raised approx. 2" to standard bulkhead.

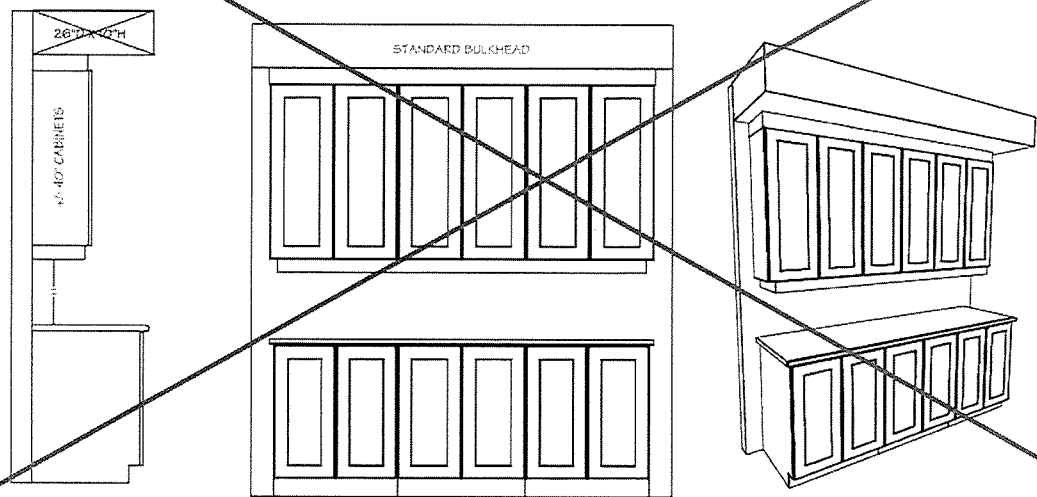

UPC9-2A Upgrade #: 22

- Includes upgrade to 42" uppers with filler detail on upper kitchen cabinetry to standard bulkhead.

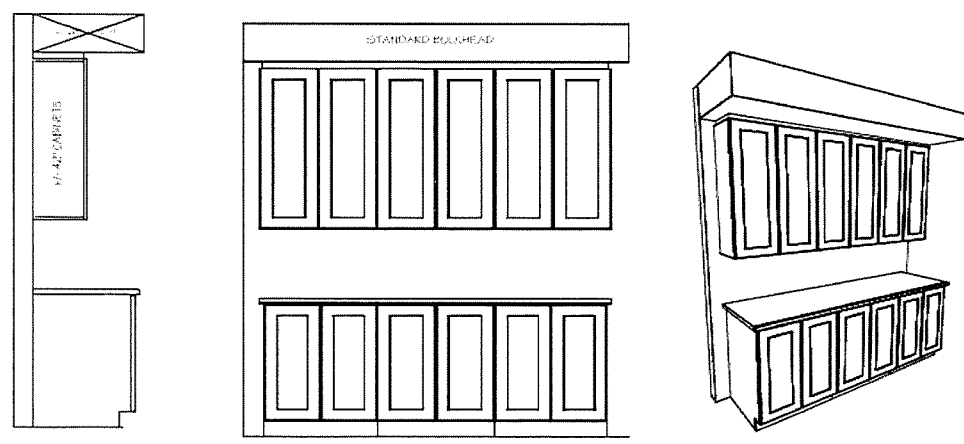

UPC9-3B Upgrade #: N/A

- Includes upgrade to 40" uppers with crown moulding & filler detail on upper kitchen cabinetry to standard bulkhead.

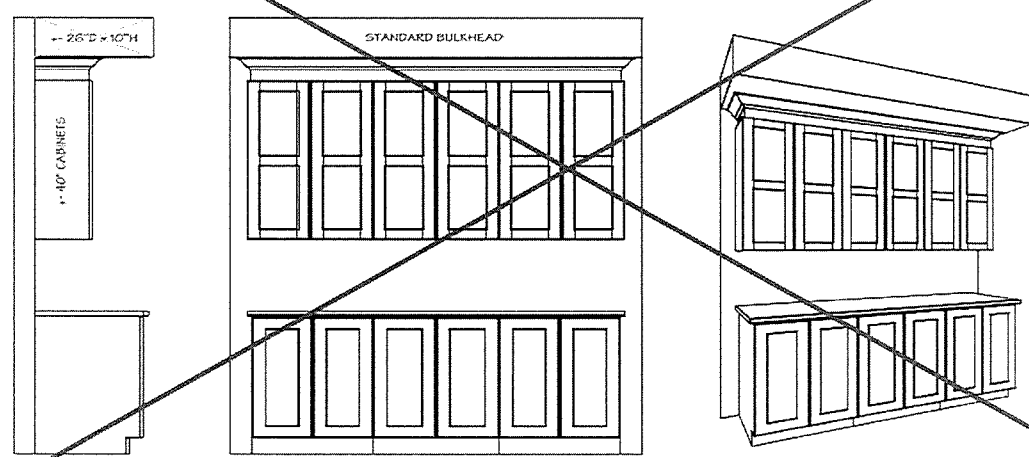

Site: DV2

Purchaser: Portobello Partnership

Plan No: 4M-1290







Lot: B06

Purchaser:

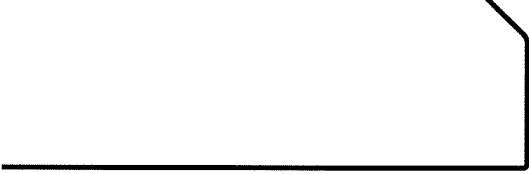
Date: August 25, 2021



Standard Edge Profiles for Granite & Quartz

	#6 & 23 Kitchen Eased Edge
	1/4 Bevel
	1/2 Bevel
	3/4 Bevel
	Pencil Top Only with Square Bottom
	Pencil Top and Bottom
	1/2 Bullnose
	Full Bullnose

Project: DV2

Purchaser: Portobello Partnership

Plan #: 4M-1290

Purchaser: _____

Lot: B06

Date: August 25, 2021

Model: 120 The Huntley Rev.

Upgrade #: 6, 23



Tile Installation Options

WALL TILE

Vertical stacked

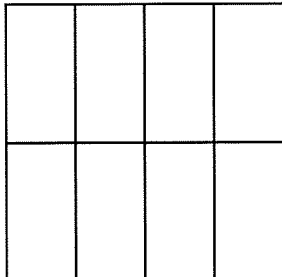

Horizontal stacked

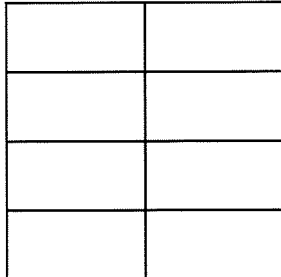

Kitchen Backsplash
Main Bathroom
Ensuite Bathroom

Vertical 1/3 offset brick

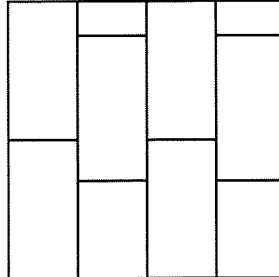

Horizontal 1/3 offset brick

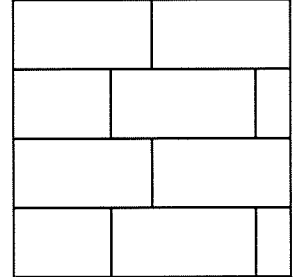

Vertical brick

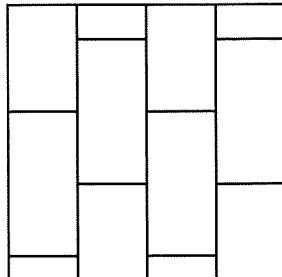

Horizontal brick

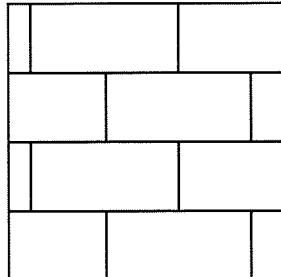

45 degree

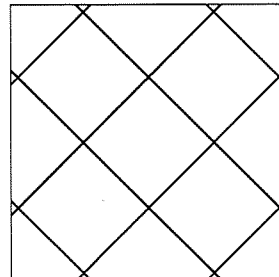

Standard square

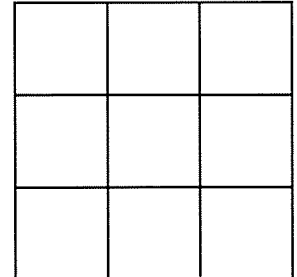

Project: DV2

Plan #: 4M-1290

Lot: B06

Model: 120 Huntley Rev W.O. End Unit

Purchaser: Portobello Parnership

Purchaser: _____

Date: August 25, 2021

Upgrade #: 4, 35, 37, 38, 39



Valecraft
Homes Ltd.

Tile Installation Options

FLOOR TILE

Standard square



Square brick

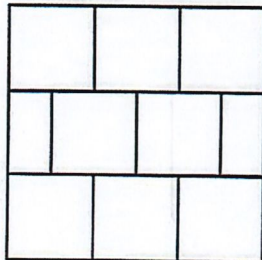

Rectangular
front to back of the house

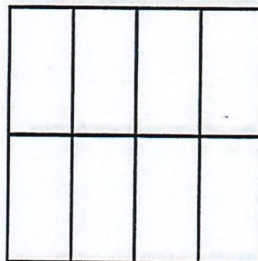

Rectangular
side to side of the house

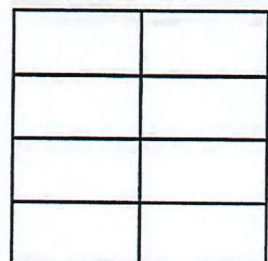

1/2 brick front to back
of the house

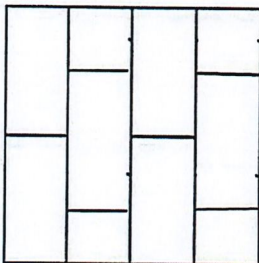

1/2 brick side to side of
house

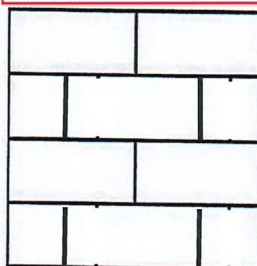

45 degree

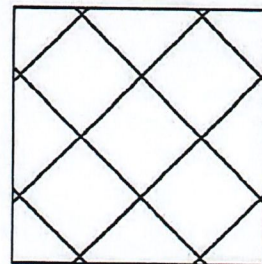

Foyer & Powder Room

Project: DV2

Plan #: 4M-1290

Lot: B06

Model: 120 The Huntley Rev.

Purchaser: Portobello Partnership

Purchaser: _____

Date: August 25, 2021

Upgrade #: 4, 44

Schedule "W4"
Granite & Variegated Quartz Colour Variation

Purchaser's name: Portobello Partnership Lot no: B06 Plan #: 4M-1290
Purchaser's name: Contact: Samar Mehri Project: DEERFIELD VILLAGE 2
Home Phone: _____ Model: 120 Huntley Rev. W/O End
Work Phone: 613-831-2754 Closing Date: _____
E-Mail (1): design@valecraft.com E-Mail (2): _____

Valecraft Homes Ltd. continues to provide the best in class sales and service. We recognize the importance of your home to you, our valued customer.

Granite & Variegated Quartz countertops are an elegant addition to your home. However, there are some things of which you should be aware.

Due to the natural composition of **Granite**, inherent variations in texture, colour and consistency are to be expected and considered as normal.

During the process of manufacturing **Variegated Quartz** to achieve a more natural stone look, variations in the appearance between the sample & the slab are to be expected.

Valecraft Homes Limited strongly suggests that you attend an appointment with our granite/quartz supplier two to three months prior to closing to view the granite/variegated quartz slabs available in the colour you have already chosen. A representative from our supplier will contact you to set up a mutual date & time for the appointment.

I/we, Portobello Partnership
have read and fully understand the aforementioned recommendation set forth by the builder and as such hereby release VALECRAFT HOMES LIMITED from future responsibility with respect to a variation in colour of granite/variegated quartz countertops.

☒ We accept this opportunity

☐ We decline this opportunity

Project: DEERFIELD VILLAGE 2 LOT NO: B06

Purchaser _____ Date: _____

Purchaser _____ Date: _____

T. Oliver August 25, 2021
Valecraft Homes Limited Date: _____

Appointment date given: _____ Spoke with/left message: _____

Time scheduled: _____ Date & Time: _____



THE HUNTLEY

MODEL 120

2221 sq.ft.
(474 sq.ft. Basement)

Site: Deerfield Village 2

Plan No.: 4M-1290

Lot: B06

Date: August 25, 2021

Purchaser: Portobello Partnership

Purchaser:

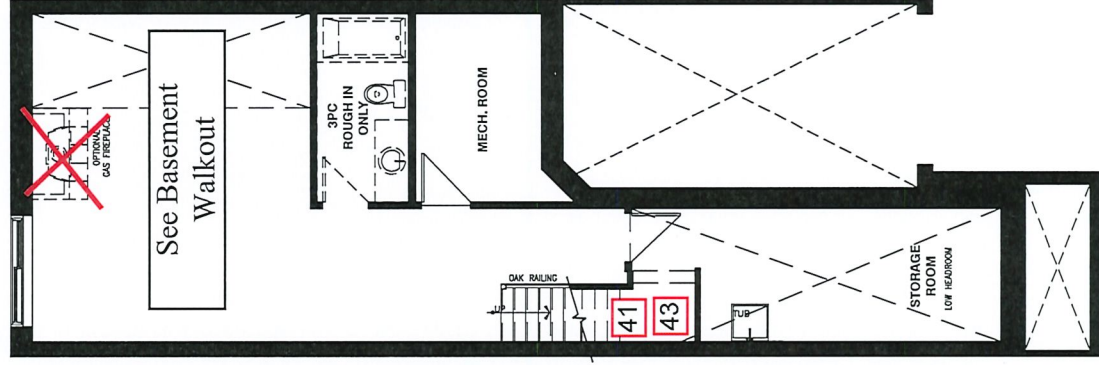

BASEMENT FLOOR

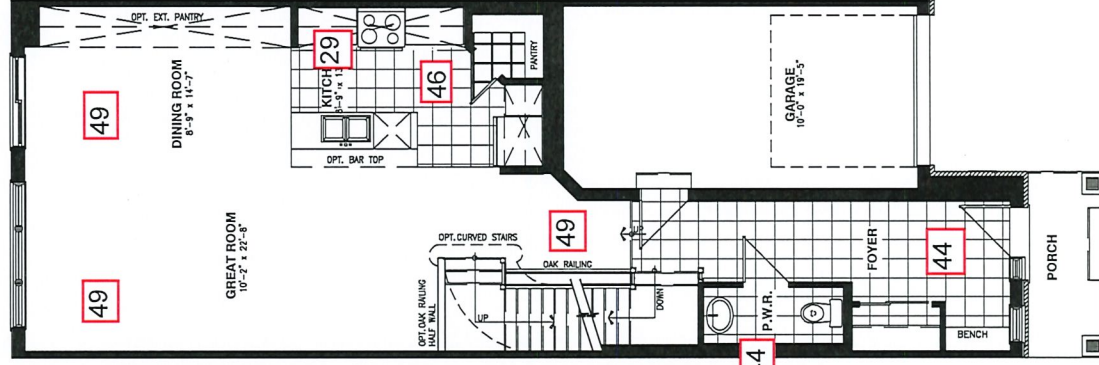

GROUND FLOOR

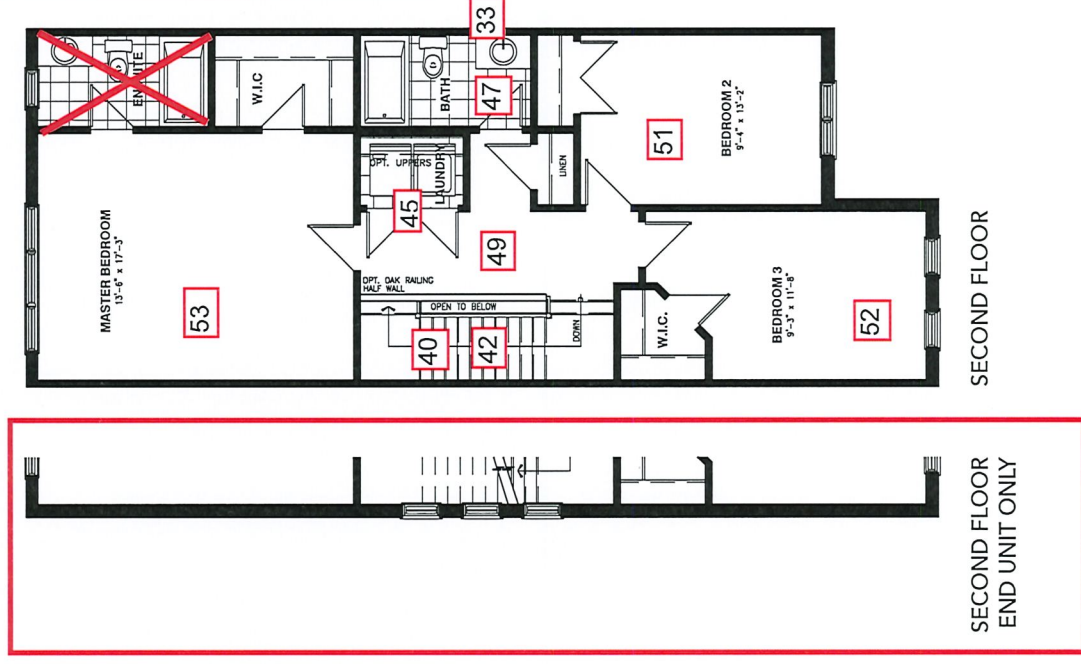

SECOND FLOOR

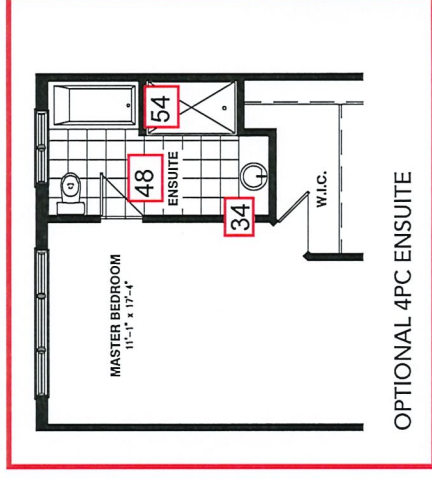

OPTIONAL 4PC ENSUITE

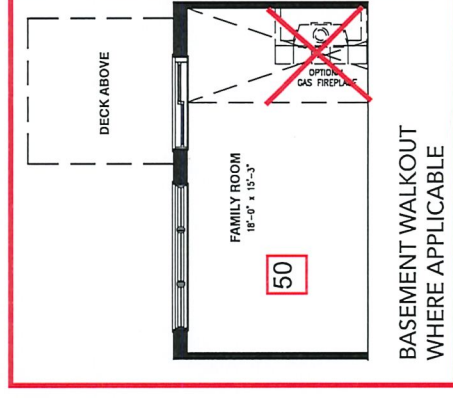

BASEMENT WALKOUT
WHERE APPLICABLE

Schedule H



Vertical and/or horizontal bulkheads (chaseways) may be required to contain mechanical piping. All dimensions are approximate. E. & O.E., plans, materials and specifications are subject to change.

 Valecraft Homes Ltd.	SINGLES AND TOWNS COLOUR CHART				
	Community:	Deerfield Village 2	Reg'd Plan #:	4M-1290	Sales Rep: N. Trudel
	Lot No:	B06	Civic Address:	512 Fawn Valley Private	
	Purchaser(s):	Portobello Partnership			Model Name/ #: 120 The Huntley Rev.
	Purchaser(s):				Closing Date: 01-Dec-21

INTERIOR FINISHES		
DESCRIPTION		STD/UPG #
TRIM STYLE	Standard Nivaga Baseboards and Casings	STD
DOOR STYLE	Standard Cambridge Style Passage Doors	STD
INTERIOR HARDWARE	Standard Satin Chrome	STD
INTERIOR LIGHTING PACKAGE	Roma Lighting Package	4, 14
BATHROOM ACCESSORIES	Standard Infinity Series in Chrome	4
FIREPLACE MANTLE	N/A	N/A

INTERIOR HANDRAILS AND SPINDLES				
	WOOD	STYLE	STAIN/COLOUR	STD/UPG #
HANDRAIL	Red Oak	Contemporary	SB 200	7, 8, 9, 49
BRACKET (if applicable)	Metal	Metal	Gunn Metal Grey	7, 8, 9, 55
SPINDLES	Metal	Square / Metal	Gunn Metal Grey	7, 8, 9
POSTS	Red Oak	0	SB 200	7, 8, 9, 49
NOSINGS	Red Oak	N/A	SB 200	7, 8, 49
HARDWOOD STAIRCASE <i>(WHERE APPLICABLE)</i>	N/A	N/A	N/A	N/A

APPLIANCES				
TYPE	SIZE	STD/UPG #	APPLIANCE UPG LEVEL	STD/UPG #
FRIDGE <i>(Standard Minimum Opening is 33" x 70.75")</i>	Standard Opening	STD	Basic Stainless Steel	17
RANGE	Standard Opening	STD	Basic Stainless Steel	17
DISHWASHER	Standard Opening	STD	Basic Stainless Steel	17
MICROWAVE / HOODFAN	Standard Opening	STD	OTR - Basic Stainless Steel	17
WASHING MACHINE/DRYER	Standard Opening	STD	Basic Top Load Package in White	17

Purchaser's Signature(s) : _____

Date: _____

Purchaser's Signature(s) : _____

Date: _____

Approved By : _____

T. OLIVER

Date: August 25, 2021



Community:	Deerfield Village 2	Reg'd Plan #:	4M-1290	Sales Rep:	N. Trudel
Lot No:	B06	Civic Address:	512 Fawn Valley Private		
Purchaser(s):	Portobello Partnership			Model Name/#:	120 The Huntley Rev.
Purchaser(s):				Closing Date:	01-Dec-21

ROOM	MAIN COLOUR	STD/UPG #	ACCENT WALL	STD/UPG #
TRIM	Semi Gloss OC-117 simply white	STD	N/A	N/A
FOYER	Low Luster OC-30 Gray Mist	STD	N/A	N/A
POWDER ROOM	Semi Gloss OC-30 Gray Mist	STD	N/A	N/A
MAIN FLOOR HALLWAY	Low Luster OC-30 Gray Mist	STD	N/A	N/A
DEN	N/A	N/A	N/A	N/A
FAMILY ROOM	Low Luster OC-30 Gray Mist	STD	N/A	N/A
GREAT ROOM	Low Luster OC-30 Gray Mist	STD	N/A	N/A
DINING ROOM	Low Luster OC-30 Gray Mist	STD	N/A	N/A
FLEX ROOM	N/A	N/A	N/A	N/A
KITCHEN/DINETTE/ BREAKFAST	Semi Gloss OC-30 Gray Mist	STD	N/A	N/A
LAUNDRY/MUDROOM	Low Luster OC-30 Gray Mist	STD	N/A	N/A
2nd FLOOR HALLWAY	Low Luster OC-30 Gray Mist	STD	N/A	N/A
MAIN BATH	Semi Gloss OC-30 Gray Mist	STD	N/A	N/A
BEDROOM #2	Low Luster OC-30 Gray Mist	STD	N/A	N/A
BEDROOM #3	Low Luster OC-30 Gray Mist	STD	N/A	N/A
BEDROOM #4	N/A	N/A	N/A	N/A
MASTER BEDROOM	Low Luster OC-30 Gray Mist	STD	N/A	N/A
MASTER BEDROOM WALK-IN CLOSET	Low Luster OC-30 Gray Mist	STD	N/A	N/A
MASTER BEDROOM ENSUITE	Semi Gloss OC-30 Gray Mist	STD	N/A	N/A
FINISHED BASEMENT RECREATION ROOM	N/A	N/A	N/A	N/A
BASEMENT BATHROOM	N/A	N/A	N/A	N/A

Date: _____

Date: _____

Date: August 25, 2021

K:\SALES\Sales Legal Docs\Site - Deerfield\Block B\B06\DV2 B06 - Interior Colours\DV2 B06 Colour

 Valecraft Homes Ltd.	SINGLES AND TOWNS COLOUR CHART					
	Community:	Deerfield Village 2	Reg'd Plan #:	4M-1290	Sales Rep:	N. Trudel
	Lot No:	B06	Civic Address:	512 Fawn Valley Private		
	Purchaser(s):	Portobello Partnership			Model Name/#:	120 The Huntley Rev.
Purchaser(s):				Closing Date:	01-Dec-21	
CERAMIC & GROUT SELECTIONS (1)						
ROOM	AREA	MANUFACTURER/SERIES/SIZE/ COLOUR/CODE	GROUT SELECTION	LEVEL	STD/UPG #	
FOYER	FLOOR	Torlys Evertile Premier ET-24013 Calcatta 11-1/2" Wide x 23-5/8" Long (Side to Side 1/2" Brick Install)	N/A	Quote	44	
POWDER ROOM	FLOOR	Torlys Evertile Premier ET-24013 Calcatta 11-1/2" Wide x 23-5/8" Long (Side to Side 1/2" Brick Install)	N/A	Quote	44	
	WALL	N/A	N/A	N/A	N/A	
	INSERT OR BORDER	N/A				
LAUNDRY ROOM	FLOOR	See Flooring Selection Sheet	N/A	N/A	45	
	WALL	N/A	N/A	N/A	N/A	
	INSERT OR BORDER	N/A				
MUDROOM	FLOOR	N/A	N/A	N/A	N/A	
	WALL	N/A	N/A	N/A	N/A	
	INSERT OR BORDER	N/A				
KITCHEN	FLOOR	See Flooring Selection Sheet	N/A	N/A	46	
	BACKSPLASH	Euro Pasha Classic 6"x12" Calacatta Glossy (Horizontal Stacked Install)	931 Standard White	Silver wall tile + STD grout	35	
	INSERT OR BORDER	N/A				
BREAKFAST AREA/DINETTE	FLOOR	N/A	N/A	N/A	N/A	
FIREPLACE	HEARTH	N/A	N/A	N/A	N/A	
	SURROUND	N/A	N/A	N/A	N/A	
ADDITIONAL FIREPLACE	HEARTH	N/A	N/A	N/A	N/A	
	SURROUND	N/A	N/A	N/A	N/A	

Purchaser's Signature(s) : _____

Date: _____

Purchaser's Signature(s) : _____

Date: _____

Approved By : T. OLIVER

Date: August 25, 2021

 Valecraft Homes Ltd.	SINGLES AND TOWNS COLOUR CHART					
	Community:	Deerfield Village 2	Reg'd Plan #:	4M-1290	Sales Rep:	N. Trudel
	Lot No:	B06	Civic Address:	512 Fawn Valley Private		
	Purchaser(s):	Portobello Partnership			Model Name/#:	120 The Huntley Rev.
	Purchaser(s):				Closing Date:	01-Dec-21
CERAMIC & GROUT SELECTIONS (2)						
ROOM	AREA	MANUFACTURER/SERIES/SIZE/ COLOUR/CODE		GROUT SELECTION	LEVEL	STD/UPG #
MAIN BATHROOM	FLOOR	See Flooring Selection Sheet		N/A	N/A	47
	WALL	Shnier Casa Roma Tika 12" x 24" Fume (Gry) TB000336 (Horizontal Stacked Install)		934 DeLorean Gray	Bronze floor tile on wall + UPG Grout	36, 37
	INSERT OR BORDER	N/A				
OTHER BATHROOM	FLOOR	N/A		N/A	N/A	N/A
	WALL	N/A		N/A	N/A	N/A
	INSERT OR BORDER	N/A				
4PC ENSUITE BATHROOM	FLOOR	See Flooring Selection Sheet		N/A	N/A	4, 48
	TUB DECK	Shnier Casa Roma Tika 12" x 24" Fume (Gry) TB000336 (Horizontal Stacked Install)		934 DeLorean Gray	Bronze floor tile on wall + UPG Grout	4, 36, 39
	TUB BACKSPLASH	Shnier Casa Roma Tika 12" x 24" Fume (Gry) TB000336 (Horizontal Stacked Install)		934 DeLorean Gray	Bronze floor tile on wall + UPG Grout	4, 36, 39
	SHOWER WALL	Shnier Casa Roma Tika 12" x 24" Fume (Gry) TB000336 (Horizontal Stacked Install)		934 DeLorean Gray	Bronze floor tile on wall + UPG Grout	4, 36, 38
	SHOWER WALL INSERT	N/A		N/A	N/A	N/A
BASEMENT/OTHER BATHROOM	FLOOR	N/A		N/A	N/A	N/A
	WALL	N/A		N/A	N/A	N/A
	INSERT OR BORDER	N/A		N/A	N/A	N/A

Purchaser's Signature(s) :

Date:

Purchaser's Signature(s) :

Date:

Approved By :

T. OLIVER

Date:

August 25, 2021



SINGLES AND TOWNS COLOUR CHART					
Community:	Deerfield Village 2	Reg'd Plan #:	4M-1290	Sales Rep:	N. Trudel
Lot No:	B06	Civic Address:	512 Fawn Valley Private		
Purchaser(s):	Portobello Partnership			Model Name/#:	120 The Huntley Rev.
Purchaser(s):				Closing Date:	01-Dec-21

FLOORING SELECTIONS

ROOM	CARPET/UNDERPAD OR HARDWOOD	LEVEL	STD/UPG #
MAIN FLOOR HALLWAY	Torlys Everwood Premier EW23001 Beach House 4-7/8" Wide x 48-3/8" Long Plank (Front to back install)	Quote	49
LAUNDRY CLOSET	Torlys Everwood Premier EW23001 Beach House 4-7/8" Wide x 48-3/8" Long Plank (Front to back install)	Quote	45
FAMILY ROOM	Torlys Everwood Premier EW23001 Beach House 4-7/8" Wide x 48-3/8" Long Plank (Front to back install)	Quote	50
DINING ROOM	Torlys Everwood Premier EW23001 Beach House 4-7/8" Wide x 48-3/8" Long Plank (Front to back install)	Quote	49
GREAT ROOM	Torlys Everwood Premier EW23001 Beach House 4-7/8" Wide x 48-3/8" Long Plank (Front to back install)	Quote	49
DEN / HOME OFFICE	N/A	N/A	N/A
MAIN BATHROOM	Torlys Everwood Premier EW23001 Beach House 4-7/8" Wide x 48-3/8" Long Plank (Front to back install)	Quote	47
KITCHEN	Torlys Everwood Premier EW23001 Beach House 4-7/8" Wide x 48-3/8" Long Plank (Front to back install)	Quote	46
BREAKFAST AREA/DINETTE	N/A	N/A	N/A
MAIN STAIRS TO BEDROOMS (Including Landings)	Beaulieu Silex II Broadloom Carpet Chinese Desert 89809 + Upgraded Underpad	Quote Carpet + L1 Underpad	40, 42
UPPER HALLWAY	Torlys Everwood Premier EW23001 Beach House 4-7/8" Wide x 48-3/8" Long Plank (Front to back install)	Quote	49
BEDROOM # 2	Torlys Everwood Premier EW23001 Beach House 4-7/8" Wide x 48-3/8" Long Plank (Front to back install)	Quote	51
BEDROOM # 3	Torlys Everwood Premier EW23001 Beach House 4-7/8" Wide x 48-3/8" Long Plank (Front to back install)	Quote	52
4PCE ENSUITE BATHROOM	Torlys Everwood Premier EW23001 Beach House 4-7/8" Wide x 48-3/8" Long Plank (Front to back install)	Quote	4, 48
MASTER BEDROOM	Torlys Everwood Premier EW23001 Beach House 4-7/8" Wide x 48-3/8" Long Plank (Front to back install)	Quote	53
MASTER BEDROOM WALK-IN CLOSET	Torlys Everwood Premier EW23001 Beach House 4-7/8" Wide x 48-3/8" Long Plank (Front to back install)	Quote	53
STAIRS TO BASEMENT	Beaulieu Silex II Broadloom Carpet Chinese Desert 89809 + Upgraded Underpad	Quote Carpet + L1 Underpad	41, 43
OTHER	N/A	N/A	N/A

Purchaser's Signature(s) : _____

Date: _____

Purchaser's Signature(s) : _____

Date: _____

Approved By : T. OLIVER

Date: August 25, 2021

Subject to change by Valecraft Homes in the event of unavailability of materials.
Prices, terms and specifications are subject to change without notice E/O.E
K:\SALES\Sales Legal Docs\Site - Deerfield\Block B\B06\DV2 B06 - Interior Colours\DV2 B06 Colour

 Valecraft Homes Ltd.	SINGLES AND TOWNS COLOUR CHART					
	Community:	Deerfield Village 2	Reg'd Plan #:	4M-1290	Sales Rep:	N. Trudel
	Lot No:	B06	Civic Address:	512 Fawn Valley Private		
	Purchaser(s):	Portobello Partnership			Model Name/#:	120 The Huntley Rev.
	Purchaser(s):				Closing Date:	01-Dec-21
PLUMBING FIXTURES						
ROOM	FIXTURE	STYLE		FINISH	STD/UPG#	
KITCHEN	SINK	Reginox Kitchen Sink Undermount Double Bowl ND1831UA/9		Stainless Steel	25	
	FAUCET	Delta Marley Kitchen Faucet Single Handle Pull-Down 986LF-AR		Arctic Stainless	27	
MAIN BATHROOM	SINK	Standard		White	STD	
	VANITY FAUCET	Standard		Chrome	STD	
	WATER CLOSET	Standard		White	STD	
	TUB/SHOWER	Standard		White	STD	
	TUB/SHOWER FAUCET	Standard		Chrome	STD	
MASTER BEDROOM 4PCE ENSUITE BATHROOM	SINK	Standard		White	4	
	VANITY FAUCET	Standard		Chrome	4	
	WATER CLOSET	Standard		White	4	
	SHOWER	Standard with Zitta Niche 12 x 12 (installed on small wall opposite of the shower head. To be centered approx. 5ft from floor)		White/Chrome/Clear Glass/ Stainless Steel	4, 54	
	SHOWER FAUCET	Standard		Chrome	4	
	BATHTUB	Standard		White	4	
	BATHTUB FAUCET	Standard		Chrome	4	
POWDER ROOM	PEDESTAL	Pedestal		White	STD	
	SINK FAUCET	Standard		Chrome	STD	
	WATER CLOSET	Standard		White	STD	
BASEMENT BATHROOM	SINK	N/A		N/A	N/A	
	VANITY FAUCET	N/A		N/A	N/A	
	WATER CLOSET	N/A		N/A	N/A	
	TUB/SHOWER	N/A		N/A	N/A	
	TUB/SHOWER FAUCET	N/A		N/A	N/A	
NOTE: All fixtures are white as standard						

Purchaser's Signature(s) : _____

Purchaser's Signature(s) : _____

Approved By : _____

Date: _____

Date: _____

Date: August 25, 2021

Subject to change by Valecraft Homes in the event of unavailability of materials.
Prices, terms and specifications are subject to change without notice E/O.E
K:\SALES\Sales Legal Docs\Site - Deerfield\Block B\B06\DV2 B06 - Interior Colours\DV2 B06 Colour