

Internal B1A

Deerfield 2 - Phase 2

PURCHASER: Portobello Partnership

Printed: 31-Aug-21 3:13 pm

LOT NUMBER N79	PHASE 2	HOUSE TYPE 140 THE GREEN	CLOSING DATE 30-Nov-21
-------------------	------------	-----------------------------	---------------------------

ITEM	QTY	EXTRA / CHANGE	PRICE	INTERNAL USE
*18 90567 35907	1 -	- BONUS - APPLIANCES - 3 BASIC STAINLESS STEEL KITCHEN APPLIANCES INCLUDING MICROWAVE COMBO HOODFAN, AND BASIC TOP LOAD WHITE WASHER AND DRYER. Note:	\$ 0.00	Each
19 88290 35908	1 -	- FLAT CEILING IN WHOLE HOUSE Note: Includes Family Room in Basement	\$ 2,245.00	Each
20 35918	1 -	<i>GREAT ROOM</i> - DELETE ITEM # 5 IN B1A'S (RE: DIRECT VENT 2 SIDED PIER FIREPLACE MAIN FLOOR WITH 2 SIDED SURROUND FROM BUILDER'S STANDARDS,AND MDF CAP PAINTED WHITE). Note:	-\$7,481.00	Each
21 35919	1 -	<i>KITCHEN</i> - DELETE ITEM # 7 IN B1A'S (RE: KITCHEN LAYOUT 1 LEVEL 1 CABINETRY BUILDER'S STANDARD COUNTERTOP AND BACKSPLASH). Note: - See Item 6 for Optional Kitchen Layout 1 in Builder's Standard finishes.	-\$2,140.00	Each
22 35920	1 -	<i>KITCHEN</i> - DELETE ITEM # 8 IN B1A'S (RE: UPC9-2A LEVEL 1 CABINETRY OPTIONAL KITCHEN 1. INCLUDES UPGRADE TO 42IN UPPERS WITH FILLER DETAIL ON UPPER KITCHEN CABINETRY TO STANDARD BULKHEAD). Note:	-\$626.00	Each
23 35921	1 -	<i>KITCHEN</i> - IN REFERENCE TO ITEM # 9 IN B1A'S, KITCHEN COUNTERTOP AND FLUSH BREAKFAST BAR TO BE EASED EDGE DETAIL. Note: As per countertop edge profile sketch dated August 20, 2021.	\$ 0.00	Each
24 35922	1 -	- CLARIFICATION - RAILING DETAILS (RE: ITEMS # 10 AND # 11 N B1A'S TO BE C/W METAL BRACKETS). Note:	\$ 0.00	Each
25 35923	1 -	- DELETE ITEM # 14 IN B1A'S (RE: SUPPLY AND INSTALL OAK STAIRCASE WITH VENEERED RISERS & STRINGERS AND SOLID TREADS, PER STAIRCASE. IN LIEU OF STANDARD STAIRCASE FROM MAIN FLOOR TO SECOND LEVEL). Note:	-\$6,078.00	Each
26 35924	1 -	<i>KITCHEN</i> - DELETE ITEM #15 IN B1A'S (RE: KITCHEN SINK FRANKE CUBE CUX110-30-CA SINGLE BOWL STAINLESS STEEL 9" DEEP UNDERMOUNT SINK). Note:	-\$855.00	Each
27 88544 35925	1 -	<i>KITCHEN</i> - KITCHEN SINK - REGINOX ND1831UA/9 DOUBLE BOWL UNDERMOUNT SINK Note: See item # 9 for solid surface countertops. See item #29 for faucet.	\$ 143.00	Each
28 35926	1 -	<i>KITCHEN</i> - DELETE ITEM # 16 IN B1A'S (RE: DELTA ESSA 9113 - AR - DST ARCTIC STAINLESS SINGLE HANDLE PULL- DOWN KITCHEN FAUCET). Note:	-\$456.00	Each
*29 88428 35927	1 -	<i>KITCHEN</i> - KITCHEN FAUCET - DELTA MARLEY 986LF - AR ARCTIC STAINLESS Note: See item # 9 for solid surface countertops. See item # 27 for sink.	*\$ 357.00	Each

Vendor Initials: _____

Purchaser Initials: _____

PREPARED BY: Nicole Trudel

LOCKED BY: Lisa Ballard

PE 1,648-1

InvoiceSQL.rpt 05may21

CONSTRUCTION SCHEDULING APPROVAL

PER: _____

DATE: _____

Internal B1A Deerfield 2 - Phase 2				
PURCHASER: Portobello Partnership			Printed: 31-Aug-21 3:13 pm	
LOT NUMBER N79		PHASE 2	HOUSE TYPE 140 THE GREEN	CLOSING DATE 30-Nov-21
ITEM	QTY	EXTRA / CHANGE	PRICE	INTERNAL USE
*30 103640 35928		1 - <i>KITCHEN</i> - CABINETRY - UPC9-2A - BUILDERS STANDARD CABINETRY - OPTIONAL KITCHEN 1. INCLUDES UPGRADE TO 42IN UPPERS WITH FILLER DETAIL ON UPPER KITCHEN CABINETRY TO STANDARD BULKHEAD Note: As per UPC Sketch dated August 20, 2021. In Kitchen layout #1. Purchaser Acknowledges and accepts that Upper Kitchen cabinetry upgraded wood doors will have center style	*\$ 471.00	Each
31 90835 35929		1 - <i>KITCHEN</i> - CABINETRY - EXTEND FRIDGE UPPER TO APPROX. 2FT DEEP (ALL SERIES) Note: In standard series cabinetry, in kitchen layout #1, as per Schedule H dated August 20, 2021.	\$ 187.00	Each
32 87999 35930		1 - <i>KITCHEN</i> - LOWER CABINETS - LC POTS & PANS C/W 3 DRAWER FRONTS 6/12/12 Note: In standard series cabinetry, to be located between dinette and range, in kitchen layout #1, as per Schedule H dated August 20, 2021.	\$ 704.00	Each
33 127 35931		1 - <i>KITCHEN</i> - TILE - WALL - BACKSPLASH - UPGRADE - BRONZE - - KITCHEN - BRONZE Note: To be installed Horizontal 1/2 brick install, in kitchen layout #1, as per wall tile installation sketch dated August 20, 2021.	\$ 133.00	Each
34 88508 35932		1 - - CERAMIC TILE - GROUT COLOR PER COLOUR Note:	\$ 75.00	Each
35 122 35933		1 - <i>MAIN BATHROOM</i> - TILE - WALL - UPGRADE - SILVER - MAIN BATHROOM - SILVER Note: To be Horizontal 1/2 brick install, in Main bathroom, as per wall tile installation sketch dated August 20, 2021.	\$ 779.00	Each
36 140 35934		1 - <i>ENSUITE BATH</i> - TILE - WALL - UPGRADE - FLOOR TILE IN LIEU OF WALL - SILVER - - TUB SURROUND - ENSUITE BATHROOM - OPTIONAL (20) - SILVER Note: To be installed on tub backsplash and tub deck in 4 Pce Ensuite bathroom, as per wall tile installation sketch dated August 20, 2021.	\$ 377.00	Each
37 140 35935		1 - <i>ENSUITE BATH</i> - TILE - WALL - UPGRADE - FLOOR TILE IN LIEU OF WALL - SILVER - - SHOWER SURROUND - ENSUITE BATHROOM - OPTIONAL (20) - SILVER Note: -To be installed in 4 PC Ensuite as per wall tile installation sketch dated August 20, 2021. - See Item #4 for 4 PC Ensuite bathroom layout	\$ 1,025.00	Each
38 88441 35936		1 - <i>ENSUITE BATH</i> - BATHROOMS - ZITTA NICHE 12X12 STAINLESS STEEL Note: To be installed on small shower wall opposite shower head in 4 Pce ensuite bathroom. Top of niche to be installed approximately 5'-0" from floor and centered, as per Schedule H dated August 20, 2021.	\$ 447.00	Each
39 35937		1 - - SUPPLY AND INSTALL QUOTE LEVEL CARPET, BEAULIEU SILEX II BROADLOOM CARPET PAMPA BEIGE 16320, INSTALLED ON STAIRS TO BASEMENT, IN LIEU OF STANDARD. Note: To be installed on stairs to basement, as per Schedule H dated August 20, 2021.	\$ 1,500.00	Each
40 35938		1 - - SUPPLY AND INSTALL QUOTE LEVEL CARPET, BEAULIEU SILEX II BROADLOOM CARPET PAMPA BEIGE 16320, INSTALLED ON STAIRS TO SECOND LEVEL, IN LIEU OF STANDARD. Note: To be installed on main stairs to second level, as per Schedule H dated August 20, 2021.	\$ 1,500.00	Each
*41 107 36154		*1 - - UNDERPAD - UPGRADE - LEVEL 1 - - BASEMENT STAIRCASE - LEVEL 1 Note: As per Schedule H dated August 20, 2021.	*\$ 100.00	Each

Internal B1A Deerfield 2 - Phase 2				
PURCHASER: Portobello Partnership		Printed: 31-Aug-21 3:13 pm		
LOT NUMBER N79	PHASE 2	HOUSE TYPE 140 THE GREEN	CLOSING DATE 30-Nov-21	
ITEM	QTY	EXTRA / CHANGE	PRICE	INTERNAL USE
*42 107 36155	*1 - - UNDERPAD - UPGRADE - LEVEL 1 -- UPPER STAIRCASE - LEVEL 1 Note: As per Schedule H dated August 20, 2021.		*\$ 107.00	Each
43 35941	1 - FOYER - SUPPLY AND INSTALL TORLYS EVERTILE PREMIER ET24001 CLIFF ISLAND, 11-1/2" WIDE x 23-5/8" LONG, FRONT TO BACK AND 1/2 BRICK INSTALLATION IN FOYER AND POWDER ROOM. Note: To be installed in Foyer and Powder Room, as per floor tile installation sketch and as per Schedule H dated August 20, 2021.		\$ 278.00	Each
44 35942	1 - LAUNDRY ROOM - SUPPLY AND INSTALL TORLYS EVERWOOD PREMIER EW-23001 BEACH HOUSE 4-7/8" WIDE x 48-3/8" LONG PLANK, FRONT TO BACK INSTALL. Note: To be installed in Laundry Room, as per Schedule H dated August 20, 2021.		\$ 54.00	Each
45 35943	1 - KITCHEN/DINETTE - SUPPLY AND INSTALL TORLYS EVERWOOD PREMIER EW-23001 BEACH HOUSE 4-7/8" WIDE x 48-3/8" LONG PLANK, FRONT TO BACK INSTALL. Note: To be installed in Kitchen Layout #1 and Dinette, as per Schedule H dated August 20, 2021.		\$ 272.00	Each
46 35944	1 - MAIN BATHROOM - SUPPLY AND INSTALL TORLYS EVERWOOD PREMIER EW-23001 BEACH HOUSE 4-7/8" WIDE x 48-3/8" LONG PLANK, FRONT TO BACK INSTALL. Note: To be installed in Main bathroom, as per Schedule H dated August 20, 2021.		\$ 11.00	Each
47 35945	1 - ENSUITE BATH - SUPPLY AND INSTALL TORLYS EVERWOOD PREMIER EW-23001 BEACH HOUSE 4-7/8" WIDE x 48-3/8" LONG PLANK, FRONT TO BACK INSTALL. Note: To be installed in 4 Pce Ensuite bathroom, as per Schedule H dated August 20, 2021.		\$ 142.00	Each
48 35946	1 - GREAT ROOM - SUPPLY AND INSTALL TORLYS EVERWOOD PREMIER EW-23001 BEACH HOUSE 4-7/8" WIDE x 48-3/8" LONG PLANK, FRONT TO BACK INSTALL. (ALL STANDARD AREAS). Note: To be installed in Great Room, Dining Room, Lower Hallway and Upper Hallway, as per Schedule H dated August 20, 2021.		\$ 0.00	Each
49 35947	1 - BASEMENT - SUPPLY AND INSTALL TORLYS EVERWOOD PREMIER EW-23001 BEACH HOUSE 4-7/8" WIDE x 48-3/8" LONG PLANK, FRONT TO BACK INSTALL. Note: To be installed in Family Room, as per Schedule H dated August 20, 2021.		\$ 5,437.00	Each
50 35948	1 - BEDROOM 2 - SUPPLY AND INSTALL TORLYS EVERWOOD PREMIER EW-23001 BEACH HOUSE 4-7/8" WIDE x 48-3/8" LONG PLANK, FRONT TO BACK INSTALL. Note: To be installed in Bedroom #2, as per Schedule H dated August 20, 2021.		\$ 1,661.00	Each
51 35949	1 - BEDROOM 3 - SUPPLY AND INSTALL TORLYS EVERWOOD PREMIER EW-23001 BEACH HOUSE 4-7/8" WIDE x 48-3/8" LONG PLANK, FRONT TO BACK INSTALL. Note: To be installed in Bedroom #3, as per Schedule H dated August 20, 2021.		\$ 1,528.00	Each
52 35950	1 - MASTER BEDROOM - SUPPLY AND INSTALL TORLYS EVERWOOD PREMIER EW-23001 BEACH HOUSE 4-7/8" WIDE x 48-3/8" LONG PLANK, FRONT TO BACK INSTALL. Note: To be installed in Master Bedroom and WIC, as per Schedule H dated August 20, 2021.		\$ 2,886.00	Each
53 36006	1 - ENSUITE BATH - DELETE ITEM 17 (Duplicate Item) Note: See item 4		\$ 0.00	Each

Internal B1A Deerfield 2 - Phase 2			
PURCHASER: Portobello Partnership		Printed: 31-Aug-21 3:13 pm	
LOT NUMBER N79	PHASE 2	HOUSE TYPE 140 THE GREEN	CLOSING DATE 30-Nov-21

ITEM	QTY	EXTRA / CHANGE	PRICE	INTERNAL USE
------	-----	----------------	-------	--------------

Sub Total	\$4,783.00
HST	\$0.00
Total	\$4,783.00

Payment Summary

<u>Paid By</u>	<u>Amount</u>
APS	\$4,783.00
<u>Total Payment:</u>	<u>\$4,783.00</u>

PURCHASER: _____
Portobello Partnership

31-Aug-21
DATE

VENDOR: _____
PER: Valecraft Homes Limited

DATE: _____

CONSTRUCTION SCHEDULING APPROVAL	
PER:	_____
DATE:	_____

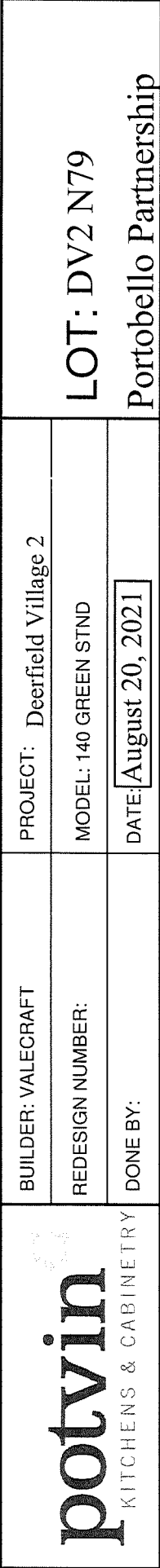

DIMENSIONS MAY VARY DEPENDING ON SITE MEASURES/CONDITIONS

Kitchen Sketch

The diagram illustrates a kitchen layout with the following dimensions and components:

- Overall Dimensions:**
 - Top: 2885
 - Left: 1431, 700, 675, 25
 - Right: 1454, 350, 325, 812, 700, 23
 - Bottom: 84, 616, 900, 525, 392, 1733, 2125
- Component Dimensions:**
 - Sink Area (31): 839 (width), 419.5 (depth), 775 (total depth), 32 (clearance)
 - Stove Area (32): 839 (width), 419.5 (depth), 775 (total depth), 32 (clearance)
 - Refrigerator Area: 839mm x 1817mm (fridge opening)
- Labels and Notes:**
 - OPT. KITCHEN #1
 - 914mm UPPERS
 - SHORTER TOP DRAWER FOR PLUG
 - FRIDGE OPENING: 839mm X 1817mm
 - ALIGN

Kitchen Sketch

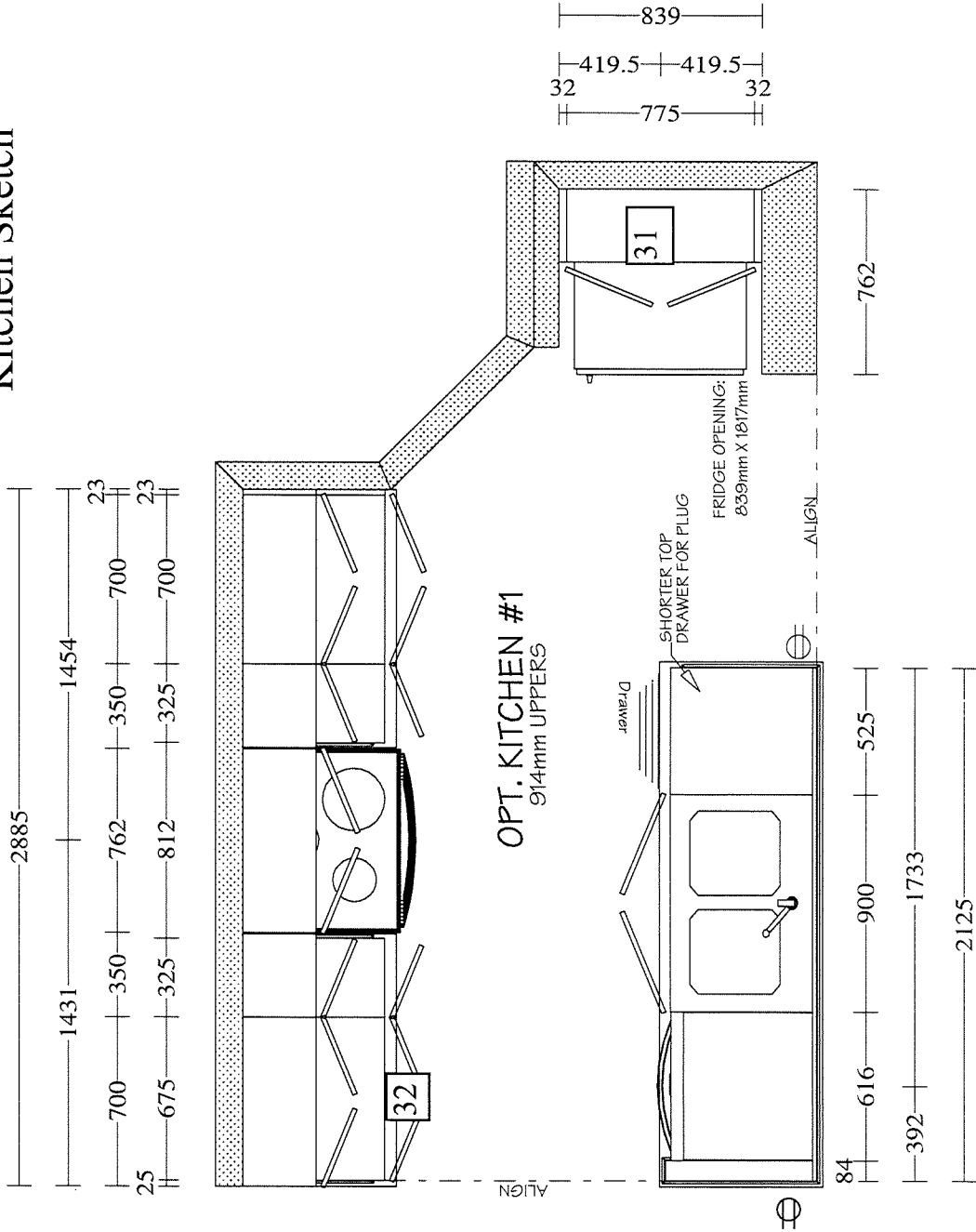

Schedule "W4"
Granite & Variegated Quartz Colour Variation

Purchaser's name:	<u>Portobello Partnership</u>	Lot no:	<u>N79</u>	Plan #:	<u>4M-1290</u>
Purchaser's name:	<u>Contact: Samar Mehri</u>	Project:	<u>DEERFIELD VILLAGE 2</u>		
Home Phone:	<u></u>	Model:	<u>140 Green Rev.</u>		
Work Phone:	<u>613-837-2754</u>	Closing Date:	<u></u>		
E-Mail (1):	<u>design@valecrafthomes.com</u>	E-Mail (2):	<u></u>		

Valecraft Homes Ltd. continues to provide the best in class sales and service. We recognize the importance of your home to you, our valued customer.

Granite & Variegated Quartz countertops are an elegant addition to your home. However, there are some things of which you should be aware.

Due to the natural composition of **Granite**, inherent variations in texture, colour and consistency are to be expected and considered as normal.

During the process of manufacturing **Variegated Quartz** to achieve a more natural stone look, variations in the appearance between the sample & the slab are to be expected.

Valecraft Homes Limited strongly suggests that you attend an appointment with our granite/quartz supplier two to three months prior to closing to view the granite/variegated quartz slabs available in the colour you have already chosen. A representative from our supplier will contact you to set up a mutual date & time for the appointment.

I/we, Portobello Partnership
have read and fully understand the aforementioned recommendation set forth by the builder and as such hereby release VALECRAFT HOMES LIMITED from future responsibility with respect to a variation in colour of granite/ variegated quartz countertops.

<input checked="" type="checkbox"/>	We <u>accept</u> this opportunity
<input type="checkbox"/>	We <u>decline</u> this opportunity

Project:	<u>DEERFIELD VILLAGE 2</u>	LOT NO:	<u>N79</u>
Purchaser	<u></u>	Date:	<u></u>
Purchaser	<u></u>	Date:	<u></u>
Valecraft Homes Limited	<u>T. Oliver</u>	Date:	<u>August 20, 2021</u>

Appointment date given:	<u></u>	Spoke with/left message:	<u></u>
Time scheduled:	<u></u>	Date & Time:	<u></u>



Standard Edge Profiles for Granite & Quartz

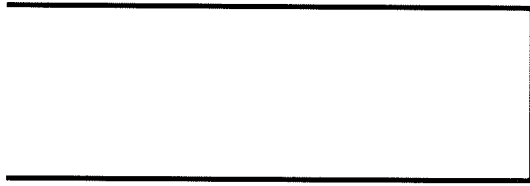

Eased Edge

#9 & 23 Kitchen

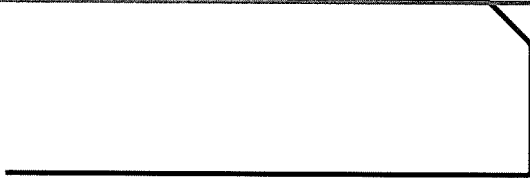

1/4 Bevel

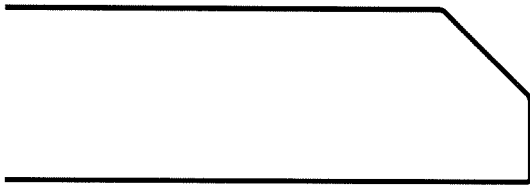

1/2 Bevel

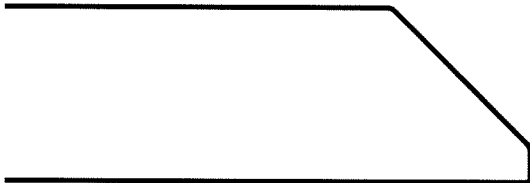

3/4 Bevel

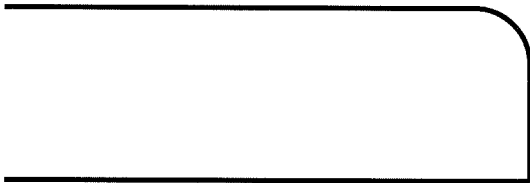

Pencil Top Only
with Square Bottom

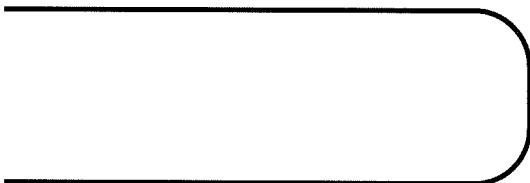

Pencil Top and Bottom

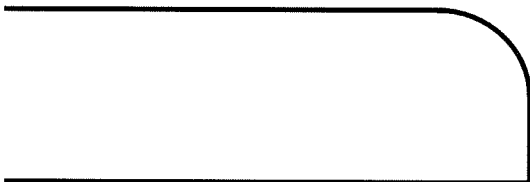

1/2 Bullnose



Full Bullnose

Project: DV2

Purchaser: Portobello Partnership

Plan #: 4M-1290

Purchaser: _____

Lot: N79

Date: August 20, 2021

Model: 140 The Green Rev.

Upgrade #: 9, 23



Valecraft
Homes Ltd.

Tile Installation Options

FLOOR TILE

Standard square

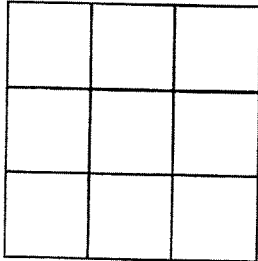

Square brick

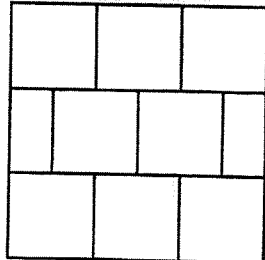

Rectangular
front to back of the house

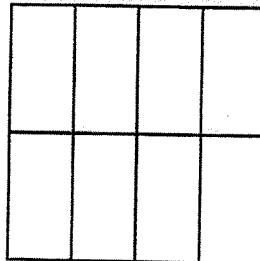

Rectangular
side to side of the house

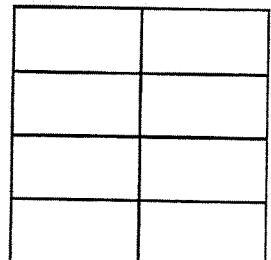

1/2 brick front to back
of the house

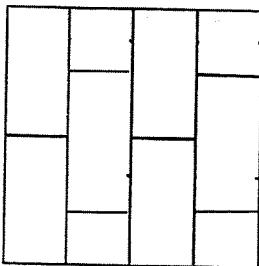

Foyer & Powder Room

Rectangular 1/3 staggered
side to side of the house

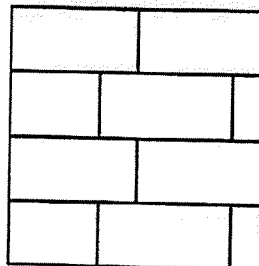

45 degree

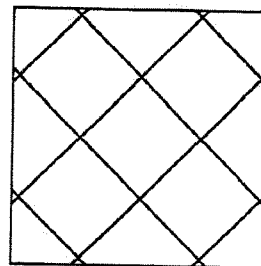

Project: DV2

Plan #: 4M-1290

Lot: N79

Model: 140 The Green Rev.

Purchaser: Portobello Partnership

Purchaser: _____

Date: August 20, 2021

Upgrade #: 43



Tile Installation Options

WALL TILE

Vertical stacked

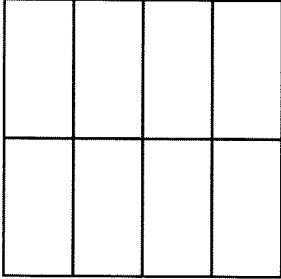

Horizontal stacked

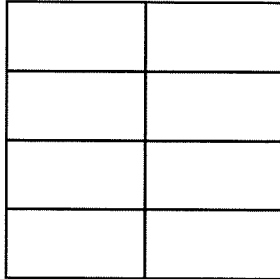

Ensuite Tub Deck &
Tub Backsplash,
Ensuite Shower Walls

Vertical 1/3 offset brick

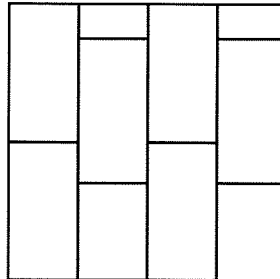

Horizontal 1/3 offset brick

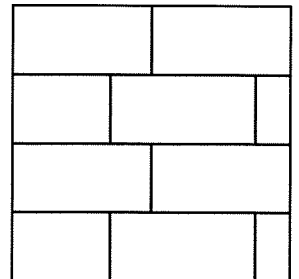

Vertical brick

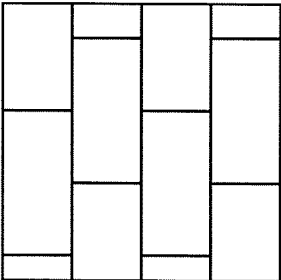

Horizontal brick

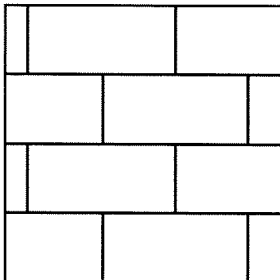

Kitchen Backsplash,
Main Bathroom
Wall/Tub Surround,

45 degree

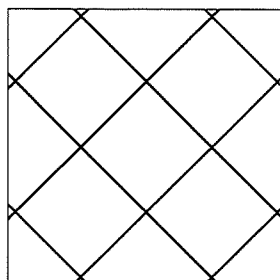

Standard square

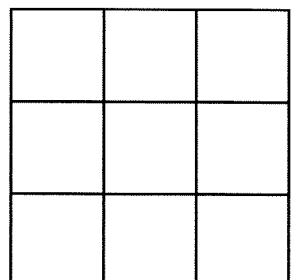

Project: DV2

Plan #: 4M-1290

Lot: N79

Model: 140 The Green Rev.

Purchaser: Portobello Partnership

Purchaser: _____

Date: August 20, 2021

Upgrade #: 4, 33, 35, 36, 37

OPTIONAL KITCHEN CABINET CROWN MOULDING,
FILLER & **STANDARD** BULKHEAD DETAILS

UPC9-1B

Upgrade #: N/A

26" D x 10" H

40" CABINETS

STANDARD BULKHEAD

UPC9-2A

Upgrade #: 30

26" D x 10" H

42" CABINETS

STANDARD BULKHEAD

UPC9-3B

Upgrade #: N/A

26" D x 10" H

40" CABINETS

STANDARD BULKHEAD

Site: DV2

Purchaser: Portobello Partnership

Plan No: 4M-1290

Lot: N79

Purchaser:

Date: August 20, 2021



THE GREEN

MODEL 140

2209 sq.ft (505 sq.ft. Basement)

Site: DV2

Plan No.: 4M-1290

Lot: N79

Date: August 20, 2021

Purchaser: Portobello Partnership

Purchaser:

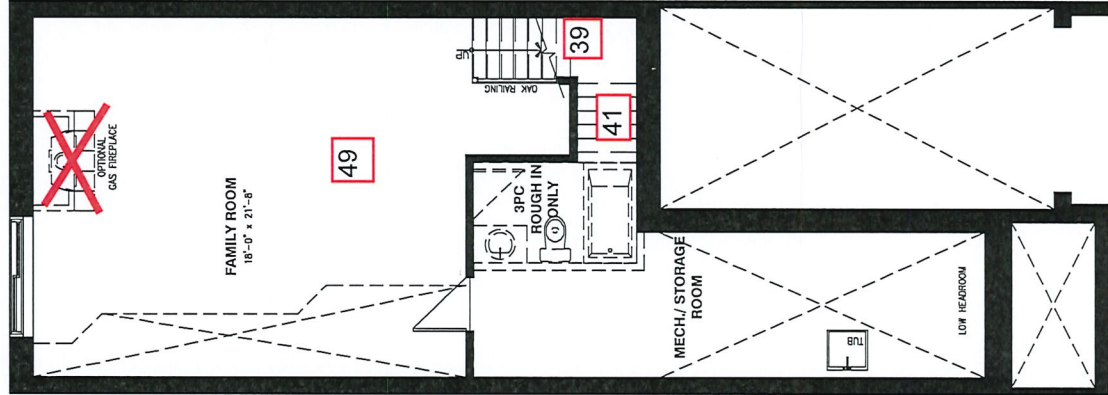

BASEMENT FLOOR

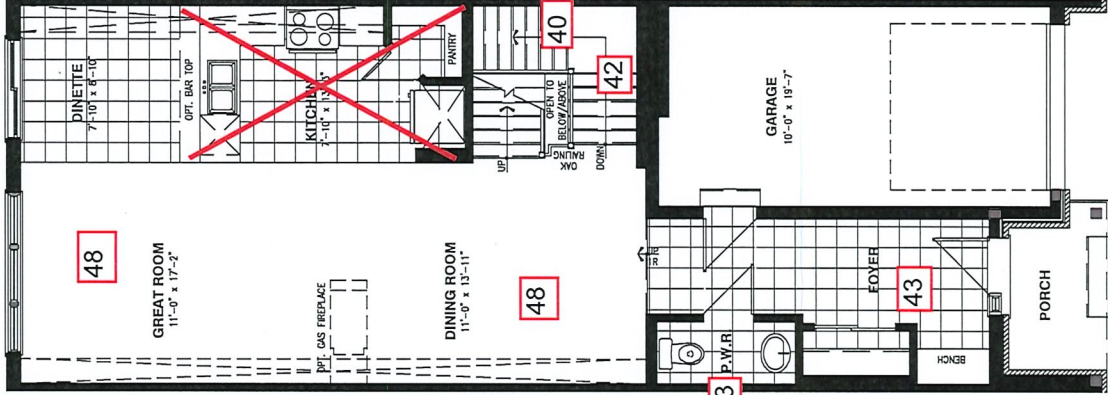

GROUND FLOOR

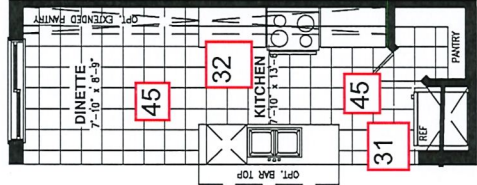

OPTIONAL KITCHEN #1

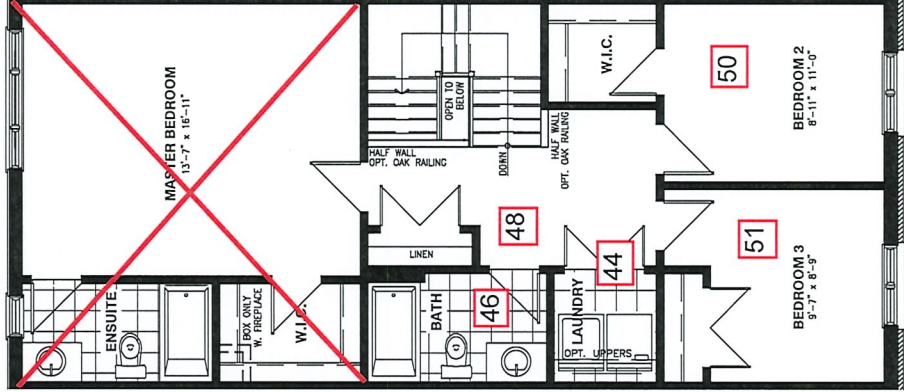

SECOND FLOOR

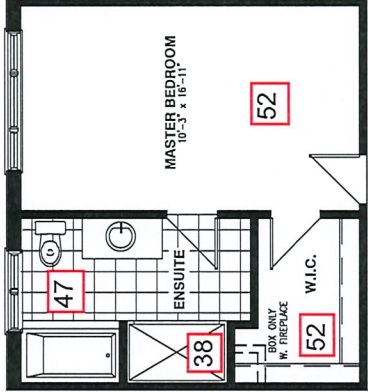

OPTIONAL 4PC ENSUITE

Schedule H

+

Vertical and/or horizontal bulkheads (chaseways) may be required to contain mechanical piping. All dimensions are approximate. E. & O.E., plans, materials and specifications are subject to change without notice. Actual useable floor space may vary from the stated floor area. *Note: Number of steps varies due to site grading.

 Valecraft Homes Ltd.	SINGLES AND TOWNS COLOUR CHART					
	Community:	Deerfield Village 2	Reg'd Plan #:	4M-1290	Sales Rep:	N. Trudel
	Lot No:	N79	Civic Address:	628 Tranquil Stream Private		
	Purchaser(s):	Portobello Partnership			Model Name/#:	140 The Green Rev.
	Purchaser(s):				Closing Date:	30-Nov-21
INTERIOR FINISHES						
DESCRIPTION					STD/UPG #	
TRIM STYLE	Standard Nivaga Baseboards and Casings					STD
DOOR STYLE	Standard Cambridge Style Passage Doors					STD
INTERIOR HARDWARE	Standard Satin Chrome					STD
INTERIOR LIGHTING PACKAGE	Standard Roma Lighting Package					STD, 12
BATHROOM ACCESSORIES	Standard Infinity Series in Chrome					4
FIREPLACE MANTLE	N/A					N/A

INTERIOR HANDRAILS AND SPINDLES				
	WOOD	STYLE	STAIN/COLOUR	STD/UPG #
HANDRAIL	Red Oak	Contemporary	SB 200	10, 11, 48
BRACKET (if applicable)	Metal	Metal	Gun Metal Grey	10, 11, 24
SPINDLES	Metal	Square	Gun Metal Grey	10, 11
POSTS	Red Oak	3-1/2" wide Modern Beveled	SB 200	10, 11, 48
NOSINGS	Red Oak	N/A	SB 200	10, 48
HARDWOOD STAIRCASE <i>(WHERE APPLICABLE)</i>	N/A	N/A	N/A	N/A

APPLIANCES				
TYPE	SIZE	STD/UPG #	APPLIANCE UPG LEVEL	STD/UPG #
FRIDGE <i>(Standard Minimum Opening is 33" x 70.75")</i>	Standard Opening	STD	Basic Stainless Steel	18
RANGE	Standard Opening	STD	Basic Stainless Steel	18
DISHWASHER	Standard Opening	STD	Basic Stainless Steel	18
MICROWAVE / HOODFAN	Standard Opening	STD	OTR - Basic Stainless Steel	18
WASHING MACHINE/DRYER	Standard Opening	STD	Basic White with Top Load Washer	18

Purchaser's Signature(s) : _____
Date: _____

Purchaser's Signature(s) : _____
Date: _____

Approved By : T. OLIVER
Date: August 20, 2021

Subject to change by Valecraft Homes in the event of unavailability of materials.
Prices, terms and specifications are subject to change without notice E/O.E
K:\Sales\Sales Legal Docs\Site - Deerfield\Block N\N79\DV2 N79 Interior Colours Aug 20-21 HO SAL

 Valecraft Homes Ltd.	SINGLES AND TOWNS COLOUR CHART						
	Community:	Deerfield Village 2	Reg'd Plan #:	4M-1290	Sales Rep:	N. Trudel	
	Lot No:	N79	Civic Address:	628 Tranquil Stream Private			
	Purchaser(s):	Portobello Partnership				Model Name/#:	140 The Green Rev.
	Purchaser(s):					Closing Date:	30-Nov-21
CABINETRY							
ROOM	SELECTION				LEVEL	STD/UPG #	
KITCHEN	STYLE AND COLOUR	B10R 2164			STD	6, 30, 31, 32	
	HARDWARE CODE	81091-142	TYPE	Knobs	STD	6, 32	
	COUNTERTOP	New Caledonia (Slab Viewing Required)	COUNTERTOP EDGE PROFILE	Eased Edge	Granite Level 1	6, 9, 23	
MAIN BATHROOM	STYLE AND COLOUR	B10R 2164			STD	STD	
	HARDWARE CODE	81091-142	TYPE	Knobs	STD	STD	
	COUNTERTOP	P394-VL	COUNTERTOP EDGE PROFILE	Standard	Standard Laminate	STD	
4PCE ENSUITE BATHROOM	STYLE AND COLOUR	B10R 2164			STD	4	
	HARDWARE CODE	81091-142	TYPE	Knobs	STD	4	
	COUNTERTOP	P394-VL	COUNTERTOP EDGE PROFILE	Standard	Standard Laminate	4	
POWDER ROOM	STYLE AND COLOUR	Pedestal			STD	STD	
	HARDWARE CODE	N/A	TYPE	N/A	N/A	N/A	
	COUNTERTOP	N/A	COUNTERTOP EDGE PROFILE	N/A	N/A	N/A	
BASEMENT/OTHER BATHROOM	STYLE AND COLOUR	N/A			N/A	N/A	
	HARDWARE CODE	N/A	TYPE	N/A	N/A	N/A	
	COUNTERTOP	N/A	COUNTERTOP EDGE PROFILE	N/A	N/A	N/A	
LAUNDRY ROOM	STYLE AND COLOUR	N/A			N/A	N/A	
	HARDWARE CODE	N/A	TYPE	N/A	N/A	N/A	
	COUNTERTOP	N/A	COUNTERTOP EDGE PROFILE	N/A	N/A	N/A	

Purchaser's Signature(s) : _____

Purchaser's Signature(s) : _____

Approved By : _____

Date: _____

Date: _____

Date: August 20, 2021

Subject to change by Valecraft Homes in the event of unavailability of materials.
Prices, terms and specifications are subject to change without notice E/O.E
K:\Sales\Sales Legal Docs\Site - Deerfield\Block N\N79\DV2 N79 Interior Colours Aug 20-21 HO SAL

 Valecraft Homes Ltd.	SINGLES AND TOWNS COLOUR CHART					
	Community:	Deerfield Village 2	Reg'd Plan #:	4M-1290	Sales Rep:	N. Trudel
	Lot No:	N79	Civic Address:	628 Tranquil Stream Private		
	Purchaser(s):	Portobello Partnership			Model Name/#:	140 The Green Rev.
	Purchaser(s):				Closing Date:	30-Nov-21
PAINT COLOUR(S)						
ROOM	MAIN COLOUR		STD/UPG #	ACCENT WALL		STD/UPG #
TRIM	Semi Gloss OC-117 simply white		STD	N/A		N/A
FOYER	Low Lustre OC-30 Gray Mist		STD	N/A		N/A
POWDER ROOM	Semi Gloss OC-30 Gray Mist		STD	N/A		N/A
MAIN FLOOR HALLWAY	Low Lustre OC-30 Gray Mist		STD	N/A		N/A
DINING ROOM	Low Lustre OC-30 Gray Mist		STD	N/A		N/A
FLEX ROOM	N/A		N/A	N/A		N/A
GREAT ROOM	Low Lustre OC-30 Gray Mist		STD	N/A		N/A
FAMILY ROOM	Low Lustre OC-30 Gray Mist		STD	N/A		N/A
DEN/STUDY/HOME OFFICE	N/A		N/A	N/A		N/A
KITCHEN/ DINETTE	Semi Gloss OC-30 Gray Mist		STD	N/A		N/A
LAUNDRY CLOSET	Low Lustre OC-30 Gray Mist		STD	N/A		N/A
2nd FLOOR HALLWAY	Low Lustre OC-30 Gray Mist		STD	N/A		N/A
MAIN BATH	Semi Gloss OC-30 Gray Mist		STD	N/A		N/A
BEDROOM #2	Low Lustre OC-30 Gray Mist		STD	N/A		N/A
BEDROOM #3	Low Lustre OC-30 Gray Mist		STD	N/A		N/A
BASEMENT BEDROOM	N/A		N/A	N/A		N/A
MASTER BEDROOM	Low Lustre OC-30 Gray Mist		STD	N/A		N/A
MASTER BEDROOM WALK-IN CLOSET	Low Lustre OC-30 Gray Mist		STD	N/A		N/A
MASTER BEDROOM 4PCE ENSUITE	Semi Gloss OC-30 Gray Mist		STD	N/A		N/A
FINISHED BASEMENT RECREATION ROOM	N/A		N/A	N/A		N/A
BASEMENT BATHROOM	N/A		N/A	N/A		N/A

Purchaser's Signature(s) : _____
Date: _____

Purchaser's Signature(s) : _____
Date: _____

Approved By : **T. OLIVER**
Date: **August 20, 2021**

Subject to change by Valecraft Homes in the event of unavailability of materials.
Prices, terms and specifications are subject to change without notice E/O.E
K:\Sales\Sales Legal Docs\Site - Deerfield\Block N\N79\DV2 N79 Interior Colours Aug 20-21 HO SAL

 Valecraft Homes Ltd.	SINGLES AND TOWNS COLOUR CHART					
	Community:	Deerfield Village 2	Reg'd Plan #:	4M-1290	Sales Rep:	N. Trudel
	Lot No:	N79	Civic Address:	628 Tranquil Stream Private		
	Purchaser(s):	Portobello Partnership			Model Name/#:	140 The Green Rev.
	Purchaser(s):				Closing Date:	30-Nov-21
CERAMIC & GROUT SELECTIONS (1)						
ROOM	AREA	MANUFACTURER/SERIES/SIZE/ COLOUR/CODE		GROUT SELECTION	LEVEL	STD/UPG #
FOYER	FLOOR	Torlys Evertile Premier ET24001 Cliff Island 11-1/2" Wide x 23-5/8" Long (Front to Back 1/2 Brick Install)		N/A	Quote	43
POWDER ROOM	FLOOR	Torlys Evertile Premier ET24001 Cliff Island 11-1/2" Wide x 23-5/8" Long (Front to Back 1/2 Brick Install)		N/A	Quote	43
	WALL	N/A		N/A	N/A	N/A
	INSERT OR BORDER	N/A				
MUDROOM	FLOOR	N/A		N/A	N/A	N/A
	WALL	N/A		N/A	N/A	N/A
	INSERT OR BORDER	N/A				
LAUNDRY CLOSET	FLOOR	See Hardwood (Vinyl) Selection		N/A	N/A	44
	WALL	N/A		N/A	N/A	N/A
	INSERT OR BORDER	N/A				
KITCHEN	FLOOR	See Hardwood (Vinyl) Selection		N/A	N/A	6, 45
	BACKSPLASH	Euro Pasha Soho 3" x 6" Matte White (Horizontal brick install)		931 Standard White	Bronze Wall Tile + UPG install + STD Grout	6, 33
	INSERT OR BORDER	N/A				
BREAKFAST AREA/DINETTE	FLOOR	See Hardwood (Vinyl) Selection		N/A	N/A	45
FIREPLACE	HEARTH	N/A		N/A	N/A	N/A
	SURROUND	N/A		N/A	N/A	N/A
ADDITIONAL FIREPLACE	HEARTH	N/A		N/A	N/A	N/A
	SURROUND	N/A		N/A	N/A	N/A

Purchaser's Signature(s) :

Purchaser's Signature(s) :

Approved By :

T. OLIVER

Date: _____

Date: _____

Date: August 20, 2021

Subject to change by Valecraft Homes in the event of unavailability of materials.
Prices, terms and specifications are subject to change without notice E/O.E
K:\Sales\Sales Legal Docs\Site - Deerfield\Block N\N79\DV2 N79 Interior Colours Aug 20-21 HO SAL

 Valecraft Homes Ltd.	SINGLES AND TOWNS COLOUR CHART					
	Community:	Deerfield Village 2	Reg'd Plan #:	4M-1290	Sales Rep:	N. Trudel
	Lot No:	N79	Civic Address:	628 Tranquil Stream Private		
	Purchaser(s):	Portobello Partnership			Model Name/#:	140 The Green Rev.
	Purchaser(s):				Closing Date:	30-Nov-21
CERAMIC & GROUT SELECTIONS (2)						
ROOM	AREA	MANUFACTURER/SERIES/SIZE/ COLOUR/CODE		GROUT SELECTION	LEVEL	STD/UPG #
MAIN BATHROOM	FLOOR	See Hardwood (Vinyl) Selection		N/A	N/A	46
	WALL/TUB SURROUND	Euro Pasha Classic 6" x 12" Calacatta Glossy (Horizontal brick Install)		909 Sterling	Silver Wall Tile + UPG Install + UPG Grout	34, 35
	INSERT OR BORDER	N/A				
4PCE ENSUITE BATHROOM	FLOOR	N/A		N/A	N/A	N/A
	WALL/TUB SURROUND	N/A		N/A	N/A	N/A
	INSERT OR BORDER	N/A				
4PC ENSUITE BATHROOM	FLOOR	See Hardwood (Vinyl) Selection		N/A	N/A	4, 47
	TUB DECK	Ceratec Stone Glamour 11.6" x 23.6" Calacatta Matt (Horizontal stacked install)		909 Sterling	Silver floor tile on wall + UPG Grout	4, 34, 36
	TUB BACKSPLASH	Ceratec Stone Glamour 11.6" x 23.6" Calacatta Matt (Horizontal stacked install)		909 Sterling	Silver floor tile on wall + UPG Grout	4, 34, 36
	INSERT OR BORDER	N/A				
	SHOWER WALLS	Ceratec Stone Glamour 11.6" x 23.6" Calacatta Matt (Horizontal stacked install)		909 Sterling	Silver floor tile on wall + UPG Grout	4, 34, 37
BASEMENT/OTHER BATHROOM	FLOOR	N/A		N/A	N/A	N/A
	WALL/TUB SURROUND	N/A		N/A	N/A	N/A
	INSERT OR BORDER	N/A				

Purchaser's Signature(s) :

Date:

Purchaser's Signature(s) :

Date:

Approved By :

T. OLIVER

Date:

August 20, 2021



SINGLES AND TOWNS COLOUR CHART					
Community:	Deerfield Village 2	Reg'd Plan #:	4M-1290	Sales Rep:	N. Trudel
Lot No:	N79	Civic Address:	628 Tranquil Stream Private		
Purchaser(s):	Portobello Partnership			Model Name/#:	140 The Green Rev.
Purchaser(s):				Closing Date:	30-Nov-21

FLOORING SELECTIONS

ROOM	CARPET/UNDERPAD OR HARDWOOD	LEVEL	STD/UPG #
MAIN FLOOR HALLWAY	Torlys Everwood Premier EW-23001 Beach House 4-7/8" Wide x 48-3/8" Long Plank (Front to Back Install)	Quote	48
DINING ROOM	Torlys Everwood Premier EW-23001 Beach House 4-7/8" Wide x 48-3/8" Long Plank (Front to Back Install)	Quote	48
LAUNDRY CLOSET	Torlys Everwood Premier EW-23001 Beach House 4-7/8" Wide x 48-3/8" Long Plank (Front to Back Install)	Quote	44
FAMILY ROOM	Torlys Everwood Premier EW-23001 Beach House 4-7/8" Wide x 48-3/8" Long Plank (Front to Back Install)	Quote	49
GREAT ROOM	Torlys Everwood Premier EW-23001 Beach House 4-7/8" Wide x 48-3/8" Long Plank (Front to Back Install)	Quote	48
DEN/HOME OFFICE	N/A	N/A	N/A
UPPER HALLWAY	Torlys Everwood Premier EW-23001 Beach House 4-7/8" Wide x 48-3/8" Long Plank (Front to Back Install)	Quote	48
KITCHEN	Torlys Everwood Premier EW-23001 Beach House 4-7/8" Wide x 48-3/8" Long Plank (Front to Back Install)	Quote	45
BREAKFAST AREA/DINETTE	Torlys Everwood Premier EW-23001 Beach House 4-7/8" Wide x 48-3/8" Long Plank (Front to Back Install)	Quote	45
MAIN STAIRS TO BEDROOMS	Beaulieu Silex II Broadloom Carpet Pampa Beige 16320 + Upgraded Underpad	Quote Carpet + L1 Underpad	40, 42
MAIN BATHROOM	Torlys Everwood Premier EW-23001 Beach House 4-7/8" Wide x 48-3/8" Long Plank (Front to Back Install)	Quote	46
BEDROOM # 2	Torlys Everwood Premier EW-23001 Beach House 4-7/8" Wide x 48-3/8" Long Plank (Front to Back Install)	Quote	50
BEDROOM # 3	Torlys Everwood Premier EW-23001 Beach House 4-7/8" Wide x 48-3/8" Long Plank (Front to Back Install)	Quote	51
4PCE ENSUITE BATHROOM	Torlys Everwood Premier EW-23001 Beach House 4-7/8" Wide x 48-3/8" Long Plank (Front to Back Install)	Quote	4, 47
MASTER BEDROOM	Torlys Everwood Premier EW-23001 Beach House 4-7/8" Wide x 48-3/8" Long Plank (Front to Back Install)	Quote	52
MASTER BEDROOM WALK-IN CLOSET	Torlys Everwood Premier EW-23001 Beach House 4-7/8" Wide x 48-3/8" Long Plank (Front to Back Install)	Quote	52
STAIRS TO BASEMENT	Beaulieu Silex II Broadloom Carpet Pampa Beige 16320 + Upgraded Underpad	Quote Carpet + L1 Underpad	39, 41
FINISHED BASEMENT BEDROOM ROOM	N/A	N/A	N/A

Date: _____

Date:

Date: August 20, 2021

Subject to change by Valecraft Homes in the event of unavailability of materials.
Prices, terms and specifications are subject to change without notice E/O.E
K:\Sales\Sales Legal Docs\Site - Deerfield\Block N\N79\DV2 N79 Interior Colours Aug 20-21 HO SAL

 Valecraft Homes Ltd.	SINGLES AND TOWNS COLOUR CHART					
	Community:	Deerfield Village 2	Reg'd Plan #:	4M-1290	Sales Rep:	N. Trudel
	Lot No:	N79	Civic Address:	628 Tranquil Stream Private		
	Purchaser(s):	Portobello Partnership			Model Name/#:	140 The Green Rev.
	Purchaser(s):				Closing Date:	30-Nov-21
PLUMBING FIXTURES						
ROOM	FIXTURE	STYLE		FINISH	STD/UPG#	
KITCHEN	SINK	Reginox Kitchen Sink Undermount Double Bowl ND1831UA/9		Stainless Steel	27	
	FAUCET	Delta Marley Kitchen Faucet Single Handle Pull-Down 986LF-AR		Arctic Stainless	29	
MAIN BATHROOM	SINK	Standard		White	STD	
	VANITY FAUCET	Standard		Chrome	STD	
	WATER CLOSET	Standard		White	STD	
	TUB/SHOWER	Standard		White	STD	
	TUB/SHOWER FAUCET	Standard		Chrome	STD	
4PCE ENSUITE BATHROOM	SINK	Standard		White	4	
	VANITY FAUCET	Standard		Chrome	4	
	WATER CLOSET	Standard		White	4	
	SHOWER	Standard with Upgraded to include Zitta Niche 12 x 12		White/Chrome /Clear Glass/ Stainless Steel	4, 38	
	SHOWER FAUCET	Standard		Chrome	4	
	BATHTUB	Standard		White	4	
	BATHTUB FAUCET	Standard		Chrome	4	
POWDER ROOM	PEDESTAL	Standard Pedestal Sink		White	STD	
	SINK FAUCET	Standard		Chrome	STD	
	WATER CLOSET	Standard		White	STD	
BASEMENT/OTHER BATHROOM	SINK	N/A		N/A	N/A	
	VANITY FAUCET	N/A		N/A	N/A	
	WATER CLOSET	N/A		N/A	N/A	
	SHOWER	N/A		N/A	N/A	
	SHOWER FAUCET	N/A		N/A	N/A	
NOTE: All fixtures are white as standard						

Purchaser's Signature(s) : _____
Date: _____

Purchaser's Signature(s) : _____
Date: _____

Approved By : T. OLIVER _____
Date: August 20, 2021

Subject to change by Valecraft Homes in the event of unavailability of materials.
 Prices, terms and specifications are subject to change without notice E/O.E
 K:\Sales\Sales Legal Docs\Site - Deerfield\Block N\N79\DV2 N79 Interior Colours Aug 20-21 HO SAL