

NON STANDARD EXTRAS (680)			
Deerfield 2 - Phase 2			
PURCHASER: Portobello Partnership		Printed: 31-Aug-21 10:35 am	
LOT NUMBER M72	PHASE 2	HOUSE TYPE 120 THE HUNTLEY	CLOSING DATE 4-Nov-21
ITEM	QTY	EXTRA / CHANGE	PRICE
*63 90565	1	- BONUS - APPLIANCES - 3 BASIC STAINLESS STEEL KITCHEN APPLIANCES INCLUDING MICROWAVE COMBO HOODFAN, AND BASIC TOP LOAD WHITE WASHER AND DRYER.	\$ 0.00
35429	Note:	See item #64.	Each
64 35430	1	- KITCHEN - DELETE ITEM #25 IN 680's (RE: KITCHEN OTR BASIC 1.7 C/F MICROWAVE WITH HOOD - STAINLESS).	-\$75.00
	Note:		Each
65 35431	1	- KITCHEN - DELETE ITEM #12 IN B1A's (RE:KITCHEN FAUCET DELTA ESSA 9113-AR-DST ARCTIC STAINLESS SINGLE HANDLE PULL- DOWN).	-\$456.00
	Note:		Each
*66 88428	1	- KITCHEN - KITCHEN FAUCET - DELTA MARLEY 986LF - AR ARCTIC STAINLESS	*\$ 361.00
35432	Note:	See item #6 for solid surface countertop and item #68 for sink.	Each
67 35434	1	- KITCHEN - DELETE ITEM # 51 IN 680's (RE:KITCHEN SINK - FRANKE CUBE CUX120-CA DOUBLE BOWL STAINLESS STEEL 9" DEEP UNDERMOUNT SINK).	-\$1,140.00
	Note:		Each
68 88544	1	- KITCHEN - KITCHEN SINK - REGINOX ND1831UA/9 DOUBLE BOWL UNDERMOUNT SINK	\$ 143.00
35435	Note:	See item #6 for solid surface countertops and item #66 for faucet.	Each
69 35436	1	- KITCHEN - DELETE ITEM # 19 IN 680's (RE: UPGRADE TO LEVEL 3 QUARTZ, EASED EDGE DETAIL, AS PER COUNTERTOP EDGE PROFILE SKETCH DATED June 1, 2021).	-\$1,569.00
	Note:	See item 6 for upgrade to Level 1 Granite	Each
70 35437	1	- KITCHEN - IN REFERENCE TO ITEM # 6 IN B1A's, KITCHEN COUNTERTOP TO BE EASED EDGE DETAIL.	\$ 0.00
	Note:	As per countertop edge profile sketch dated August 11, 2021..	Each
71 35438	1	- - DELETE ITEM # 16 IN B1A's (RE: GARAGE DOOR OPENER - BELT DRIVE 8355 WIFI - EACH - INCLUDES 1 REMOTE CONTROL AND 1 SENSOR KIT).	-\$929.00
	Note:		Each
72 35439	1	- GARAGE - DELETE ITEM # 17 IN 680's (RE: GARAGE DOOR OPENER - KEYLESS ENTRY - CONTROL PAD ON GARAGE DOOR FRAME).	-\$90.00
	Note:		Each
73 35440	1	- GARAGE - DELETE ITEM # 18 IN 680's (RE: GARAGE DOOR OPENER - SUPPLY EXTRA REMOTE CONTROL(S) TRANSMITTER).	-\$75.00
	Note:		Each
74 35441	1	- KITCHEN - DELETE ITEM # 22 IN 680's (RE: HARDWOOD OAK LAUZON 6 1/4" WIDE ESTATE NATURAL IN KITCHEN IN LIEU OF STANDARD).	-\$1,490.00
	Note:		Each

PREPARED BY: Nicole Trudel
LOCKED BY: Lisa Ballard
PE 1,660-1

InvoiceSQL.rpt 05may21

Vendor Initials: Purchaser Initials:

CONSTRUCTION SCHEDULING APPROVAL

PER:

DATE:

NON STANDARD EXTRAS (680)			
Deerfield 2 - Phase 2			
PURCHASER: Portobello Partnership		Printed: 31-Aug-21 10:35 am	
LOT NUMBER M72	PHASE 2	HOUSE TYPE 120 THE HUNTLEY	CLOSING DATE 4-Nov-21
ITEM	QTY	EXTRA / CHANGE	PRICE
75	1	KITCHEN - SUPPLY AND INSTALL TORLYS EVERWOOD PREMIER EW-23024 SIERRA 4 7/8" WIDE x 48 3/8" LONG PLANK, FRONT TO BACK INSTALL.	\$ 0.00
35442	Note:	To be installed in Kitchen, as per floor plan sketch Dated August 11, 2021.	Each
76	1	- DELETE ITEM # 23 IN 680's (RE: RHYTHM COLLECTION - UPGRADE FIXTURES THROUGHOUT).	-\$1,910.00
35443	Note:		Each
77	1	- MAIN BATHROOM - DELETE ITEM # 29 IN 680's (RE: MAIN BATHROOM COUNTERTOP QUARTZ LEVEL 1).	-\$668.00
35444	Note:		Each
78	1	- ENSUITE BATH - DELETE ITEM # 30 IN 680's (RE: 4PC ENSUITE BATHROOM COUNTERTOP QUARTZ LEVEL 1).	-\$998.00
35445	Note:		Each
79	1	- DELETE ITEM # 34 IN 680's (RE: PAINT ADDITIONAL COLOUR -NON DEEP BASE-BUILDER'S STANDARD PAINT. PER COLOUR FOR COMPLETE HOUSE).	-\$1,050.00
35446	Note:		Each
80	1	- FOYER - DELETE ITEM # 35 IN 680's (RE: UPGRADE FOYER/POWDER ROOM FLOOR TILE TO SILVER LEVEL).	-\$1,131.00
35447	Note:		Each
81	1	- FOYER - DELETE ITEM #36 IN 680's (RE: RECTANGULAR 1/3 STAGGERED SIDE TO SIDE INSTALLATION ONLY FOR SILVER LEVEL FLOOR TILES IN FOYER AND POWDER ROOM.	-\$323.00
35478	Note:		Each
82	1	- FOYER - SUPPLY AND INSTALL TORLYS EVERTILE PREMIER ET24001 CLIFF ISLAND, 11 1/2" WIDE x 23 5/8" LONG, FRONT TO BACK AND 1/2 BRICK INSTALLATION IN FOYER AND POWDER ROOM.	\$ 371.00
35448	Note:	To be installed in Foyer and Powder Room, as per floor plan sketch and as per floor tile installation sketch dated August 11, 2021.	Each
83	1	- LAUNDRY ROOM - DELETE ITEM #37 IN 680's (RE: LAUNDRY ROOM SILVER LEVEL FLOOR TILE).	-\$173.00
35483	Note:		Each
84	1	- LAUNDRY ROOM - SUPPLY AND INSTALL TORLYS EVERWOOD PREMIER EW-23024 SIERRA 4 7/8" WIDE x 48 3/8" LONG PLANK, FRONT TO BACK INSTALL.	\$ 0.00
35453	Note:	To be installed in Laundry Room, as per floor plan sketch dated August 11, 2021.	Each
85	1	- GREAT ROOM - DELETE ITEM #45 IN 680's (RE: HARDWOOD OAK 6 1/4" WIDE ESTATE SERIES NATURAL, IN STANDARD AREAS, GREATROOM, DINING ROOM, LOWER AND UPPER HALLWAYS).	-\$6,046.00
35490	Note:		Each
86	1	- GREAT ROOM - SUPPLY AND INSTALL TORLYS EVERWOOD PREMIER EW-23024 SIERRA 4 7/8" WIDE x 48 3/8" LONG PLANK, FRONT TO BACK INSTALL, IN LIEU OF STANDARD.	\$ 1,979.00
35454	Note:	To be installed in Great Room, Dining Room, Lower and Upper hallways, As per floor plan sketch dated August 11, 2021.	Each

PREPARED BY: Nicole Trudel

LOCKED BY: Lisa Ballard

PE 1,660-2

InvoiceSQL.rpt 05may21

Vendor Initials: _____ Purchaser Initials: _____

CONSTRUCTION SCHEDULING APPROVAL

PER: _____

DATE: _____

NON STANDARD EXTRAS (680)			
Deerfield 2 - Phase 2			
PURCHASER: Portobello Partnership		Printed: 31-Aug-21 10:35 am	
LOT NUMBER M72	PHASE 2	HOUSE TYPE 120 THE HUNTLEY	CLOSING DATE 4-Nov-21
ITEM	QTY	EXTRA / CHANGE	PRICE
87	1	BASEMENT - DELETE ITEM #47 IN 680's (RE: BASEMENT UNDERPAD LEVEL 1).	-\$333.00
35495	Note:		Each
88	1	BASEMENT - SUPPLY AND INSTALL TORLYS EVERWOOD PREMIER EW-23024 SIERRA 4 7/8" WIDE x 48 3/8" LONG PLANK, FRONT TO BACK INSTALL.	\$ 4,753.00
35455	Note:	To be installed in Family Room, as per floor plan sketch dated August 11, 2021.	Each
89	1	MAIN BATHROOM - DELETE ITEM #41 IN 680's (RE:MAIN BATHROOM CERAMIC FLOOR TILE BRONZE LEVEL).	-\$160.00
35496	Note:		Each
90	1	MAIN BATHROOM - SUPPLY AND INSTALL TORLYS EVERWOOD PREMIER EW-23024 SIERRA 4 7/8" WIDE x 48 3/8" LONG PLANK, FRONT TO BACK INSTALL.	\$ 0.00
35456	Note:	To be installed in Main Bathroom, as per floor plan sketch dated August 11, 2021.	Each
91	1	ENSUITE BATH - DELETE ITEM #38 IN 680's (RE: 4 PCE ENSUITE BATHROOM CERAMIC FLOOR TILE SILVER LEVEL).	-\$453.00
35501	Note:		Each
92	1	ENSUITE BATH - SUPPLY AND INSTALL TORLYS EVERWOOD PREMIER EW-23024 SIERRA 4 7/8" WIDE x 48 3/8" LONG PLANK, FRONT TO BACK INSTALL.	\$ 113.00
35457	Note:	To be installed in 4 Pce Ensuite bathroom, as per floor plan sketch dated August 11, 2021.	Each
93	1	BEDROOM 2 - DELETE ITEM #48 IN 680's (RE: UPGRADE UNDERPAD IN BEDROOM 2, LEVEL 1).	-\$140.00
35502	Note:		Each
94	1	BEDROOM 2 - SUPPLY AND INSTALL TORLYS EVERWOOD PREMIER EW-23024 SIERRA 4 7/8" WIDE x 48 3/8" LONG PLANK, FRONT TO BACK INSTALL.	\$ 2,306.00
35458	Note:	To be installed in Bedroom #2, as per floor plan sketch dated August 11, 2021.	Each
95	1	BEDROOM 3 - DELETE ITEM # 49 IN 680's (RE: UPGRADE UNDERPAD IN BEDROOM 3, LEVEL 1).	-\$153.00
35503	Note:		Each
96	1	BEDROOM 3 - SUPPLY AND INSTALL TORLYS EVERWOOD PREMIER EW-23024 SIERRA 4 7/8" WIDE x 48 3/8" LONG PLANK, FRONT TO BACK INSTALL.	\$ 2,599.00
35462	Note:	To be installed in Bedroom #3, as per floor plan sketch dated August 11, 2021.	Each
97	1	MASTER BEDROOM - DELETE ITEM #50 IN 680's (RE: UPGRADE UNDERPAD IN MASTER BEDROOM AND WIC, LEVEL 1).	-\$213.00
35504	Note:		Each
98	1	MASTER BEDROOM - SUPPLY AND INSTALL TORLYS EVERWOOD PREMIER EW-23024 SIERRA 4 7/8" WIDE x 48 3/8" LONG PLANK, FRONT TO BACK INSTALL.	\$ 4,165.00
35464	Note:	To be installed in Master Bedroom and WIC, as per floor plan sketch dated August 11, 2021.	Each

PREPARED BY: Nicole Trudel
LOCKED BY: Lisa Ballard
PE 1,660-3
InvoiceSQL.rpt 05may21

Vendor Initials: _____ Purchaser Initials: _____

CONSTRUCTION SCHEDULING APPROVAL

PER: _____

DATE: _____



NON STANDARD EXTRAS (680)			
Deerfield 2 - Phase 2			
PURCHASER: Portobello Partnership		Printed: 31-Aug-21 10:35 am	
LOT NUMBER M72	PHASE 2	HOUSE TYPE 120 THE HUNTLEY	CLOSING DATE 4-Nov-21
ITEM	QTY	EXTRA / CHANGE	PRICE
99		1 - - SUPPLY AND INSTALL QUOTE LEVEL CARPET, BEAULIEU SILEX II BROADLOOM CARPET PAMPA BEIGE 16320. INSTALLED ON STAIRS TO BASEMENT, IN LIEU OF STANDARD.	\$ 1,500.00
35471		Note: To be installed on stairs to basement, as per floor plan sketch dated August 11, 2021.	Each
100		2 - - DELETE ITEM #44 IN 680's (RE: GROUT COLOUR PER COLOUR).	-\$150.00
35505		Note:	
101		1 - - CERAMIC TILE - GROUT COLOR PER COLOUR	\$ 75.00
88508			Each
35507		Note:	
102		1 - MAIN BATHROOM - DELETE ITEM # 52 IN 680's (RE: MAIN BATHROOM SINK - AMERICAN STANDARD BOXE UNDERMOUNT SINK 0315-000).	-\$285.00
35508		Note:	Each
103		1 - ENSUITE BATH - DELETE ITEM # 53 IN 680's (RE: 4 PCE ENSUITE BATHROOM SINK - AMERICAN STANDARD BOXE UNDERMOUNT SINK 0315-000).	-\$285.00
35509		Note:	Each
104		1 - MAIN BATHROOM - DELETE ITEM # 54 IN 680's (RE: MAIN BATHROOM DELTA TRINSIC SINGLE HANDLE HIGH - ARC LAVATORY FAUCET 559HA-DST).	-\$304.00
35510		Note:	Each
105		1 - ENSUITE BATH - DELETE ITEM # 55 IN 680's (RE: 4 PCE ENSUITE BATHROOM DELTA TRINSIC SINGLE HANDLE HIGH - ARC LAVATORY FAUCET 559HA-DST).	-\$304.00
35511		Note:	Each
106		1 - POWDER ROOM - DELETE ITEM # 56 IN 680's (RE: POWDER ROOM DELTA TRINSIC SINGLE HANDLE HIGH - ARC LAVATORY FAUCET 559HA-DST).	-\$304.00
35512		Note:	Each
107		1 - ENSUITE BATH - DELETE ITEM # 57 IN 680's (RE: 4 PCE ENSUITE BATHROOM DELTA TRINSIC SHOWER FAUCET T14259-R10000-UNBX WITH H20 KINETIC RAINCAN SHOWER HEAD CHROME).	-\$160.00
35513		Note:	Each
108		1 - ENSUITE BATH - DELETE ITEM # 58 IN 680's (RE: 4 PCE ENSUITE BATHROOM DELTA TRINSIC ROMAN TUB FAUCET T2759 CHROME).	-\$346.00
35514		Note:	Each
109		1 - ENSUITE BATH - BATHROOMS - ZITTA NICHE 12X12 STAINLESS STEEL	\$ 447.00
88441			Each
35706		Note: To be installed on small shower wall opposite shower head in 4 pce ensuite bathroom. Top of niche to be installed approximately 5'-0" from floor and centered, as per floor plan sketch dated August 11, 2021.	
110		1 - - REVISION #1 TO COLOUR SHEETS. NEW COLOUR SHEETS DATED AUGUST 11, 2021.	\$ 0.00
35707		Note:	Each

PREPARED BY: Nicole Trudel

LOCKED BY: Lisa Ballard

PE 1,660-4

InvoiceSQL.rpt 05may21

Vendor Initials: _____ Purchaser Initials: _____

CONSTRUCTION SCHEDULING APPROVAL

PER: _____

DATE: _____

NON STANDARD EXTRAS (680)			
Deerfield 2 - Phase 2			
PURCHASER: Portobello Partnership		Printed: 31-Aug-21 10:35 am	
LOT NUMBER	PHASE	HOUSE TYPE	CLOSING DATE
M72	2	120 THE HUNTLEY	4-Nov-21

ITEM	QTY	EXTRA / CHANGE	PRICE	INTERNAL USE
Sub Total			\$-2,901.00	
HST			\$0.00	
Total			\$-2,901.00	

Payment Summary	
<u>Paid By</u>	<u>Amount</u>
APS	-\$2,901.00
<u>Total Payment:</u>	<u>-\$2,901.00</u>

PURCHASER:

Portobello Partnership

31-Aug-21

DATE

VENDOR:

PER: Valecraft Homes Limited

DATE:

CONSTRUCTION SCHEDULING APPROVAL

PER: _____

DATE: _____



Valecraft
Homes Ltd.

Roma Collection

All Models
STANDARD

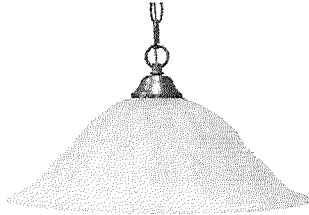

BREAKFAST / DINETTE
A3016P-11
Bulb: 1 x A19 LED Bulb

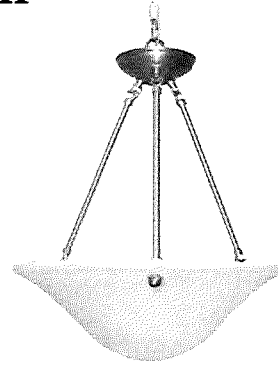

DINING ROOM / STAIRWELL / HIGH CEILINGS
(Plan Permitting)
A3016ch-11
Bulbs: 3 x A19 LED Bulb

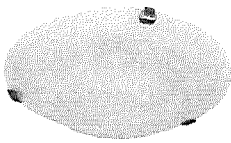

**ENTRY / HALL / LAUNDRY / BEDROOMS /
DEN / STUDY / BATH CEILING / KITCHEN SINK /
FINISHED BASEMENT AREAS**
(Plan Permitting)
A3012-11
12" dia.
Bulbs: 2 x A19 LED Bulb

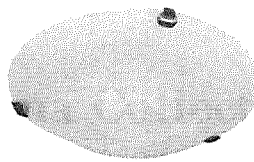

KITCHEN / MASTER BEDROOM
(Plan Permitting)
A3016-11
16" dia.
Bulbs: 3 x A19 LED Bulb

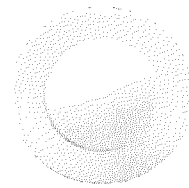

BASEMENT STAIRS / SOFFIT
AFR4-0930-WH
LED Recessed Light
5" dia.

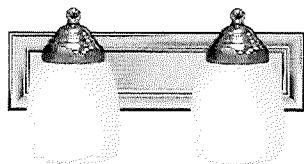

POWDER ROOM VANITY
(Plan Permitting)
A16012-7
14" Wide
Bulbs: 2 x A19 LED Bulb

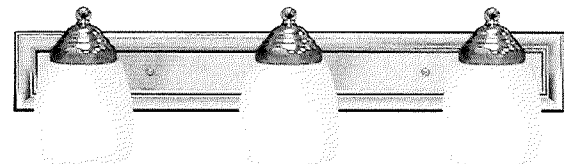

BATHROOM VANITY
A16013-7
24" Wide
Bulbs: 3 x A19 LED Bulb

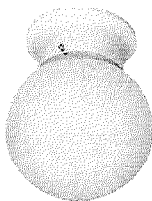

CLOSET / PANTRY
A121-11
Bulb: 1 x A19 LED Bulb



FRONT EXTERIOR
(Plan Permitting)
SAN-A1010-6
Bulb: 1 x A19 LED Bulb

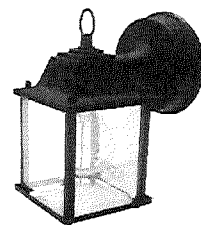

BACK EXTERIOR
SAN-A40455-6
Bulb: 1 x A19 LED Bulb

* All dimensions are approximate.

*** Keyless LIGHT OUTLETS IN GARAGE, UNFINISHED BASEMENT AREAS***

Project: DV2

Purchaser: Portobello Partnership

Plan #: 4M-1290

Purchaser: _____

Lot: M72

Date: August 11, 2021

Model: 130 The Lewis Rev. End

Upgrade #: Standard, 14



THE HUNTLEY

MODEL 120

2221 sq.ft.
(474 sq.ft. Basement)

Site: Deerfield Village 2 Purchaser: Portobello Partnership

Plan No.: 4M-1290

Lot: M72 Purchaser:

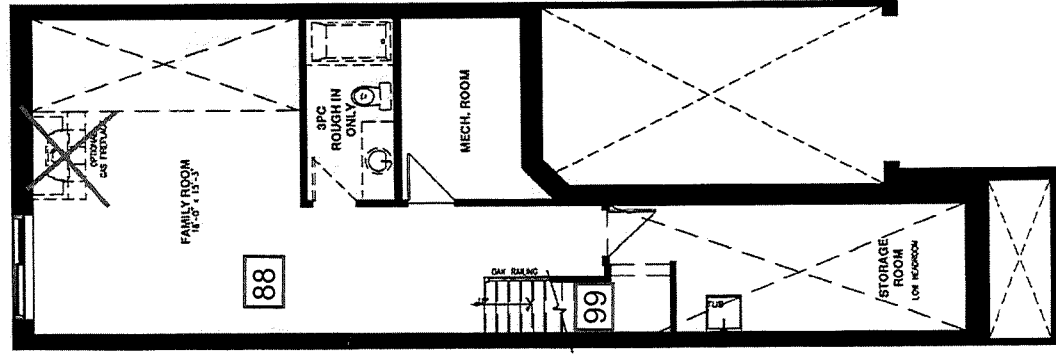
Date: August 11, 2021

BASEMENT FLOOR

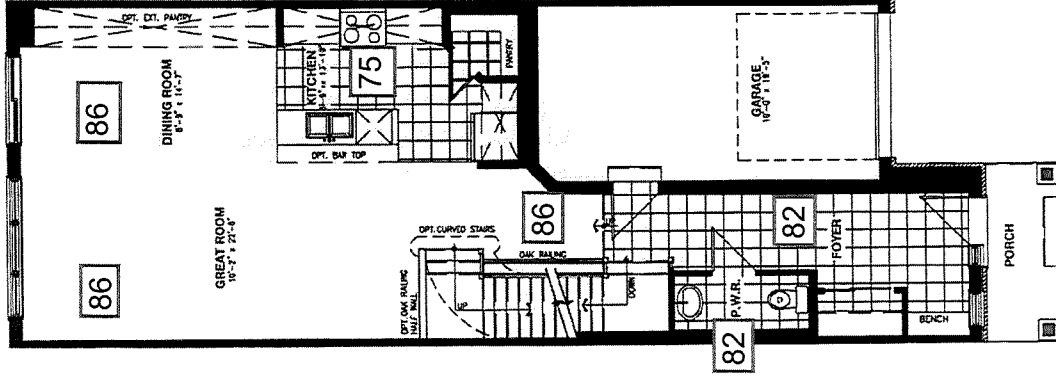

GROUND FLOOR

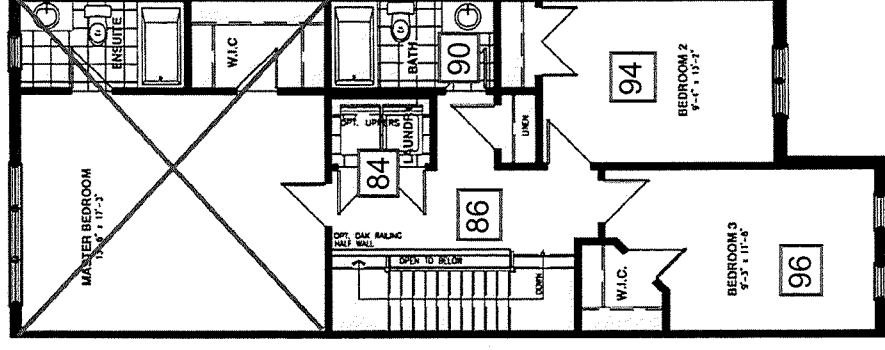

SECOND FLOOR

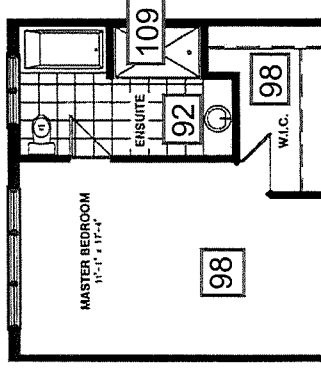

OPTIONAL 4PC ENSUITE

Floor Plan Sketch



Valecraft
Homes Ltd.

Tile Installation Options

FLOOR TILE

Standard square

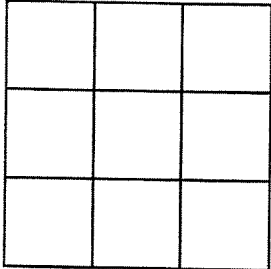

Square brick

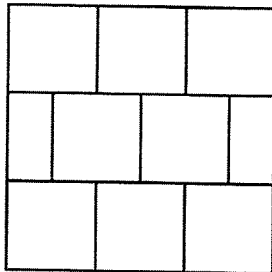

Rectangular
front to back of the house

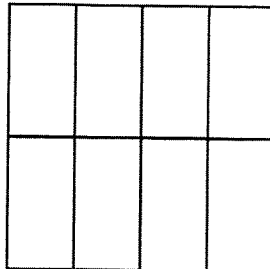

Rectangular
side to side of the house

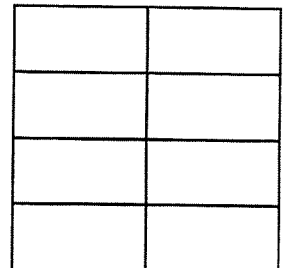

1/2 Brick
front to back of the house

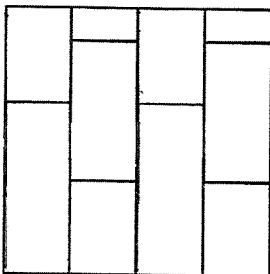

Foyer/Powder Room

Rectangular 1/3 staggered
side to side of the house

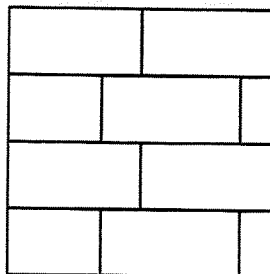

45 degree

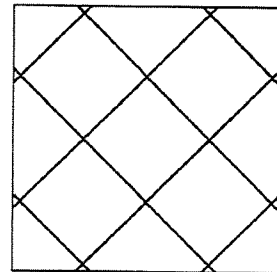

Project: DV2

Purchaser: Portobello Partnership

Plan #: 4M-1290

Purchaser: _____

Lot: M72

Date: August 11, 2021

Model: 120 The Huntley Std.

Upgrade #: 82



Standard Edge Profiles for Granite & Quartz

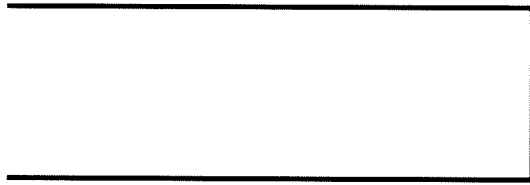

Eased Edge

Kitchen Granite

#6, #70

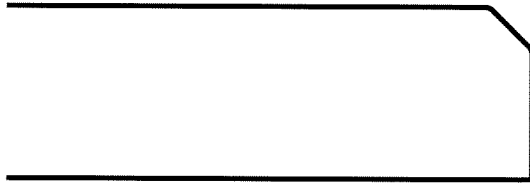

1/4 Bevel

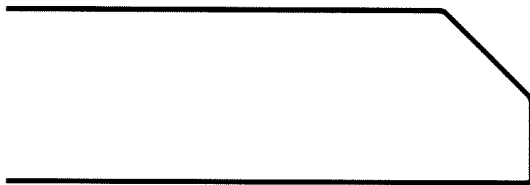

1/2 Bevel

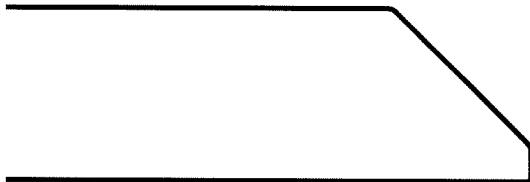

3/4 Bevel

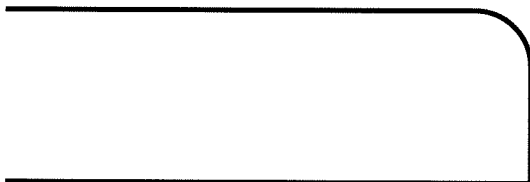

Pencil Top Only
with Square Bottom



Pencil Top and Bottom

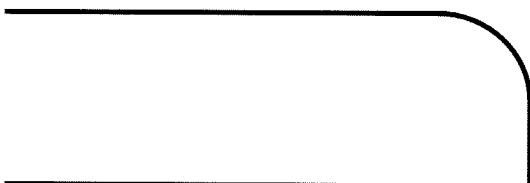

1/2 Bullnose

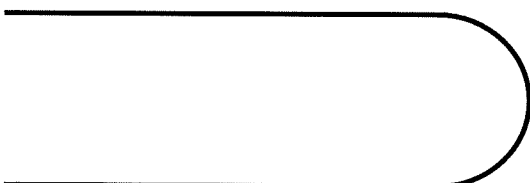

Full Bullnose

Project: DV2

Purchaser: Portobelo Partnership

Plan #: 4M-1290

Purchaser: _____

Lot: M72

Date: August 11, 2021

Model: 120 The Huntley Std.

Upgrade #: 6, 70

Schedule "W4"
Granite & Variegated Quartz Colour Variation

Purchaser's name: Portobello Partnership Lot no: M72 Plan #: 4M-1290
Purchaser's name: Samar Mehri Project: DEERFIELD VILLAGE 2
Home Phone: design@valecraft.com Model: 120 Huntley Std.
Work Phone: 613-837-2754 Closing Date: _____
E-Mail (1): _____ E-Mail (2): _____

Valecraft Homes Ltd. continues to provide the best in class sales and service. We recognize the importance of your home to you, our valued customer.

Granite & Variegated Quartz countertops are an elegant addition to your home. However, there are some things of which you should be aware.

Due to the natural composition of **Granite**, inherent variations in texture, colour and consistency are to be expected and considered as normal.

During the process of manufacturing **Variegated Quartz** to achieve a more natural stone look, variations in the appearance between the sample & the slab are to be expected.

Valecraft Homes Limited strongly suggests that you attend an appointment with our granite/quartz supplier two to three months prior to closing to view the granite/variegated quartz slabs available in the colour you have already chosen. A representative from our supplier will contact you to set up a mutual date & time for the appointment.

I/we, Portobello Partnership

have read and fully understand the aforementioned recommendation set forth by the builder and as such hereby release VALECRAFT HOMES LIMITED from future responsibility with respect to a variation in colour of granite/variegated quartz countertops.

☒ We accept this opportunity

☐ We decline this opportunity

Project: DEERFIELD VILLAGE 2 LOT NO: M72

Purchaser _____ Date: _____

Purchaser _____ Date: _____

D. Brunet August 11, 2021
Valecraft Homes Limited Date: _____

Appointment date given: _____ Spoke with/left message: _____

Time scheduled: _____ Date & Time: _____

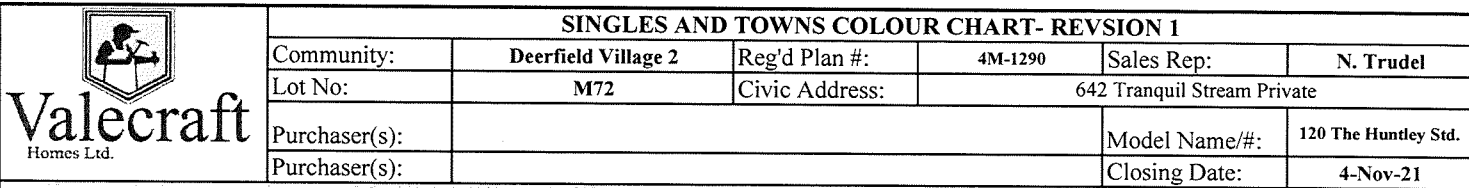

INTERIOR FINISHES		
	DESCRIPTION	STD/UPG #
TRIM STYLE	Standard Nivaga Baseboards and Casings	STD
DOOR STYLE	Standard Cambridge Style Passage Doors	STD
INTERIOR HARDWARE	Standard Satin Chrome	STD
INTERIOR LIGHTING PACKAGE	Roma Light Package + False Bottom with Under-Cabinet LED Puck Lights on Upper Kitchen Cabinets	14, 24
BATHROOM ACCESSORIES	Standard Infinity Series In Chrome	4
FIREPLACE MANTLE	N/A	N/A

INTERIOR HANDRAILS AND SPINDLES				
	WOOD	STYLE	STAIN/COLOUR	STD/UPG #
HANDRAIL	Red Oak	Contemporary	SB 208	7, 8, 9, 86
BRACKET	Metal	Wrinkled Black Metal	Black	7, 8, 9
SPINDLES	Metal	Square Wrinkled Black Metal	Black	7, 8, 9
POSTS	Red Oak	3-1/2" wide Modern with Cap	SB 208	7, 8, 9, 61, 86
NOSINGS	Red Oak	N/A	SB 208	7, 8, 86
HARDWOOD STAIRCASE (WHERE APPLICABLE)	Red Oak	N/A	SB 208	10, 62, 86

APPLIANCES				
TYPE	SIZE	STD/UPG #	APPLIANCE UPG LEVEL	STD/UPG #
FRIDGE <i>(Standard Minimum Opening is 33" x 70.75")</i>	Standard Opening	STD	Basic Stainless Steel	63
RANGE	Standard Opening	STD	Basic Stainless Steel	63
DISHWASHER	Standard Opening	STD	Basic Stainless Steel	63
MICROWAVE/HOODFAN <i>(Specify if convection)</i>	Standard Opening	STD	Basic Stainless Steel	63
WASHING MACHINE/DRYER	Standard Opening	STD	Basic White	63

Purchaser's Signature(s) : _____ Date: _____

Purchaser's Signature(s) : _____ Date: _____

Approved By : **D. Brunet** _____ Date: **August 11, 2021**

Subject to change by Valecraft Homes in the event of unavailability of materials.
Prices, terms and specifications are subject to change without notice E/O.E
\\Sales\Sales Legal\Docs\Site - Deerfield\Block MM72\DV2 M72 Colour sheet Consolidated Aug 18-



SINGLES AND TOWNS COLOUR CHART- REVISION 1					
Community:	Deerfield Village 2	Reg'd Plan #:	4M-1290	Sales Rep:	N. Trudel
Lot No:	M72	Civic Address:	642 Tranquil Stream Private		
Purchaser(s):				Model Name/#:	120 The Huntley Std.
Purchaser(s):				Closing Date:	4-Nov-21

CABINETS

ROOM	SELECTION				LEVEL	STD/UPG #
KITCHEN	STYLE AND COLOUR	Shaker 5PCS TF-180			Level 1	5, 6, 11, 24, 27, 28
	HARDWARE CODE	POI-R7040-128-BSAE	TYPE	Pulls	UPG	26, 28
	COUNTERTOP	Black Pearl (Slab Viewing Required)	COUNTERTOP EDGE PROFILE	Eased Edge	Level 1 Granite	6, 70
MAIN BATHROOM	STYLE AND COLOUR	Shaker 5PCS TF-178			Level 1	31
	HARDWARE CODE	POI-R7040-128-BSAE	TYPE	Pulls	UPG	26
	COUNTERTOP	P394-VL	COUNTERTOP EDGE PROFILE	Standard	STD Laminate	STD
4pce ENSUITE BATHROOM	STYLE AND COLOUR	Shaker 5PCS TF-178			Level 1	4, 32, 33
	HARDWARE CODE	POI-R7040-128-BSAE	TYPE	Pulls	UPG	4, 26, 33
	COUNTERTOP	P394-VL	COUNTERTOP EDGE PROFILE	Standard	STD Laminate	4
POWDER ROOM	STYLE AND COLOUR	Pedestal			STD	STD
	HARDWARE CODE	N/A	TYPE	N/A	N/A	N/A
	COUNTERTOP	N/A	COUNTERTOP EDGE PROFILE	N/A	N/A	N/A
BASEMENT/OTHER BATHROOM	STYLE AND COLOUR	N/A			N/A	N/A
	HARDWARE CODE	N/A	TYPE	N/A	N/A	N/A
	COUNTERTOP	N/A	COUNTERTOP EDGE PROFILE	N/A	N/A	N/A
LAUNDRY ROOM	STYLE AND COLOUR	N/A			N/A	N/A
	HARDWARE CODE	N/A	TYPE	N/A	N/A	N/A
	COUNTERTOP	N/A	COUNTERTOP EDGE PROFILE	N/A	N/A	N/A

Purchaser's Signature(s) :

Date:

Purchaser's Signature(s) :

Date: _____

Approved By: **D. Brunet**

Date: August 11, 2021

 Valecraft Homes Ltd.	SINGLES AND TOWNS COLOUR CHART- REVISION 1					
	Community:	Deerfield Village 2	Reg'd Plan #:	4M-1290	Sales Rep:	N. Trudel
	Lot No:	M72	Civic Address:	642 Tranquil Stream Private		
	Purchaser(s):				Model Name/#:	120 The Huntley Std.
	Purchaser(s):				Closing Date:	4-Nov-21

PAINT COLOUR(S)				
ROOM	MAIN COLOUR	STD/UPG #	ACCENT WALL	STD/UPG #
TRIM	Semi Gloss OC-117 simply white	STD	N/A	N/A
FOYER	Low Lustre OC-30 Gray Mist	STD	N/A	N/A
POWDER ROOM	Semi Gloss OC-30 Gray Mist	STD	N/A	N/A
MAIN FLOOR HALLWAY	Low Lustre OC-30 Gray Mist	STD	N/A	N/A
DINING ROOM	Low Lustre OC-30 Gray Mist	STD	N/A	N/A
FLEX ROOM	N/A	N/A	N/A	N/A
GREAT ROOM	Low Lustre OC-30 Gray Mist	STD	N/A	N/A
FAMILY ROOM	Low Lustre OC-30 Gray Mist	STD	N/A	N/A
DEN/STUDY/HOME OFFICE	N/A	N/A	N/A	N/A
KITCHEN	Semi Gloss OC-30 Gray Mist	STD	N/A	N/A
LAUNDRY CLOSET	Low Lustre OC-30 Gray Mist	STD	N/A	N/A
2nd FLOOR HALLWAY	Low Lustre OC-30 Gray Mist	STD	N/A	N/A
MAIN BATH	Semi Gloss OC-30 Gray Mist	STD	N/A	N/A
BEDROOM #2	Low Lustre OC-30 Gray Mist	STD	N/A	N/A
BEDROOM #3	Low Lustre OC-30 Gray Mist	STD	N/A	N/A
BASEMENT BEDROOM	N/A	N/A	N/A	N/A
MASTER BEDROOM	Low Lustre OC-30 Gray Mist	STD	N/A	N/A
MASTER BEDROOM WALK-IN CLOSET	Low Lustre OC-30 Gray Mist	STD	N/A	N/A
MASTER BEDROOM ENSUITE	Semi Gloss OC-30 Gray Mist	STD	N/A	N/A
FINISHED BASEMENT RECREATION ROOM	N/A	N/A	N/A	N/A
BASEMENT BATHROOM	N/A	N/A	N/A	N/A

Purchaser's Signature(s) : _____

Date: _____

Purchaser's Signature(s) : _____

Date: _____

Approved By : _____

Date: August 11, 2021

Subject to change by Valecraft Homes in the event of unavailability of materials.
Prices, terms and specifications are subject to change without notice E/O.E
K:\Sales\Sales Legal Docs\Site - Deerfield\Block M\M72\DV2 M72 Colour sheet Consolodated Aug 18-

 Valecraft Homes Ltd.	SINGLES AND TOWNS COLOUR CHART- REVISION 1								
	Community:	Deerfield Village 2	Reg'd Plan #:	4M-1290	Sales Rep:	N. Trudel			
	Lot No:	M72	Civic Address:	642 Tranquil Stream Private					
	Purchaser(s):				Model Name/#:	120 The Huntley Std.			
	Purchaser(s):				Closing Date:	4-Nov-21			
CERAMIC & GROUT SELECTIONS (1)									
ROOM	AREA	MANUFACTURER/SERIES/SIZE/ COLOUR/CODE		GROUT SELECTION	LEVEL	STD/UPG #			
FOYER	FLOOR	Torlys Evertile Premier ET24001 Cliff Island 11-1/2" Wide x 23-5/8" Long (Front to Back 1/2 Brick Install)		N/A	Quote	82			
POWDER ROOM	FLOOR	Torlys Evertile Premier ET24001 Cliff Island 11-1/2" Wide x 23-5/8" Long (Front to Back 1/2 Brick Install)		N/A	Quote	82			
	WALL	N/A		N/A	N/A	N/A			
	INSERT OR BORDER	N/A							
MUDROOM	FLOOR	N/A		N/A	N/A	N/A			
	WALL	N/A							
	INSERT OR BORDER	N/A							
LAUNDRY CLOSET	FLOOR	See Hardwood (Vinyl) Selection		N/A	N/A	84			
	WALL	N/A							
	INSERT OR BORDER	N/A							
KITCHEN	FLOOR	See Hardwood (Vinyl) Selection		N/A	N/A	75			
	BACKSPLASH	Euro Pasha Classic 3"x6" Calacatta (Horizontal 1/3 Offset Brick install)					931 Standard White	Bronze Wall Tile + UPG install + STD Grout	59, 60
	INSERT OR BORDER	N/A							
BREAKFAST AREA/DINETTE	FLOOR	N/A		N/A	N/A	N/A			
FIREPLACE	HEARTH	N/A		N/A	N/A	N/A			
	SURROUND	N/A		N/A	N/A	N/A			
ADDITIONAL FIREPLACE	HEARTH	N/A		N/A	N/A	N/A			
	SURROUND	N/A		N/A	N/A	N/A			

Purchaser's Signature(s) : _____
Date: _____

Purchaser's Signature(s) : _____
Date: _____

Approved By : _____
D. Brunet
Date: August 11, 2021

Subject to change by Valecraft Homes in the event of unavailability of materials.
Prices, terms and specifications are subject to change without notice E/O.E
K:\Sales\Sales Legal Docs\Site - Deerfield\Block MM72\DV2 M72 Colour sheet Consolodated Aug 18-

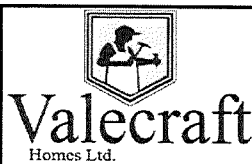

SINGLES AND TOWNS COLOUR CHART- REVSION 1					
Community:	Deerfield Village 2	Reg'd Plan #:	4M-1290	Sales Rep:	N. Trudel
Lot No:	M72	Civic Address:	642 Tranquil Stream Private		
Purchaser(s):				Model Name/#:	120 The Huntley Std.
Purchaser(s):				Closing Date:	4-Nov-21

CERAMIC & GROUT SELECTIONS (2)

ROOM	AREA	MANUFACTURER/SERIES/SIZE/ COLOUR/CODE	GROUT SELECTION	LEVEL	STD/UPG #
MAIN BATHROOM	FLOOR	See Hardwood (Vinyl) Selection	N/A	N/A	90
	WALL/TUB SURROUND	Euro Pasha Classic 6"x12" Calacatta Glossy (Horizontal 1/3 Offset Brick Install)	909 Sterling	Silver Wall Tile +UPG install + UPG Grout	42, 43, 44
	INSERT OR BORDER	N/A			
3PC ENSUITE BATHROOM	FLOOR	N/A	N/A	N/A	N/A
	WALL/TUB SURROUND	N/A	N/A	N/A	N/A
	INSERT OR BORDER	N/A			
4PC ENSUITE BATHROOM	FLOOR	See Hardwood (Vinyl) Selection	N/A	N/A	92
	TUB DECK	Ceratec Stone Glamour 11.6"x23.6" Calacatta Matt (Horizontal Stacked Install)	909 Sterling	Silver Floor Tile on Wall + UPG Grout	4, 40, 44
	TUB BACKSPLASH	Ceratec Stone Glamour 11.6"x23.6" Calacatta Matt (Horizontal Stacked Install)	909 Sterling	Silver Floor Tile on Wall + UPG Grout	4, 40, 44
	INSERT OR BORDER	N/A			
	SHOWER WALL	Ceratec Glamour Stone 11.6"x23.6" Calacatta Matt (Horizontal Stacked Install)	909 Sterling	Silver Floor Tile on Wall + UPG Grout	4, 39, 44
BASEMENT/OTHER BATHROOM	FLOOR	N/A	N/A	N/A	N/A
	WALL/TUB SURROUND	N/A	N/A	N/A	N/A
	INSERT OR BORDER	N/A			

Purchaser's Signature(s) :

Date: _____

Purchaser's Signature(s) : _____

Date: _____

Approved By: **D. Brunet**

Date: August 11, 2021

Subject to change by Valecraft Homes in the event of unavailability of materials.
Prices, terms and specifications are subject to change without notice E/O.E

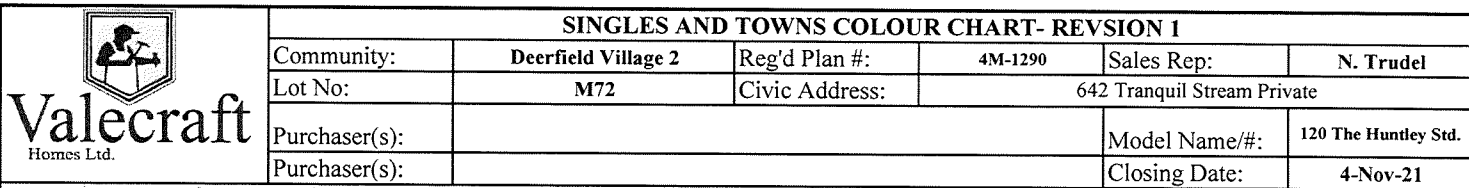

Flooring Selections			
Room	Carpet/Underpad or Hardwood	Level	Std/UpG #
Main Floor Hallway	Torlys Everwood Premier EW-23024 Sierra 4-7/8" Wide x 48-3/8" Long plank (Front to Back Install)	UPG	86
Dining Room	Torlys Everwood Premier EW-23024 Sierra 4-7/8" Wide x 48-3/8" Long plank (Front to Back Install)	UPG	86
Laundry Room	Torlys Everwood Premier EW-23024 Sierra 4-7/8" Wide x 48-3/8" Long plank (Front to Back Install)	UPG	84
Family Room	Torlys Everwood Premier EW-23024 Sierra 4-7/8" Wide x 48-3/8" Long plank (Front to Back Install)	UPG	88
Great Room	Torlys Everwood Premier EW-23024 Sierra 4-7/8" Wide x 48-3/8" Long plank (Front to Back Install)	UPG	86
Den/Home Office	N/A	N/A	N/A
Upper Hallway	Torlys Everwood Premier EW-23024 Sierra 4-7/8" Wide x 48-3/8" Long plank (Front to Back Install)	UPG	86
Kitchen	Torlys Everwood Premier EW-23024 Sierra 4-7/8" Wide x 48-3/8" Long plank (Front to Back Install)	UPG	75
Breakfast Area/Dinette	N/A	N/A	N/A
Main Stairs to Bedrooms	Red oak Stained SB 208 with Designer Collection White Oak Wyndham 6-1/4" on landings	UPG	10, 62
Bedroom # 2	Torlys Everwood Premier EW-23024 Sierra 4-7/8" Wide x 48-3/8" Long plank (Front to Back Install)	UPG	94
Bedroom # 3	Torlys Everwood Premier EW-23024 Sierra 4-7/8" Wide x 48-3/8" Long plank (Front to Back Install)	UPG	96
Main Bathroom	Torlys Everwood Premier EW-23024 Sierra 4-7/8" Wide x 48-3/8" Long plank (Front to Back Install)	UPG	90
Ensuite Bathroom	Torlys Everwood Premier EW-23024 Sierra 4-7/8" Wide x 48-3/8" Long plank (Front to Back Install)	UPG	4, 92
Master Bedroom	Torlys Everwood Premier EW-23024 Sierra 4-7/8" Wide x 48-3/8" Long plank (Front to Back Install)	UPG	98
Master Bedroom Walk-in Closet	Torlys Everwood Premier EW-23024 Sierra 4-7/8" Wide x 48-3/8" Long plank (Front to Back Install)	UPG	98
Stairs to Basement	Beaulieu Silex II Broadloom Carpet Pampa Beige 16320 + Upgraded Underpad	Quote Carpet + L1 Underpad	46, 99
Finished Basement Bedroom Room	N/A	N/A	N/A

Purchaser's Signature(s) : _____ Date: _____

Purchaser's Signature(s) : _____ Date: _____

Approved By : **D. Brunet** _____ Date: **August 11, 2021**



SINGLES AND TOWNS COLOUR CHART- REVSION 1					
Community:	Deerfield Village 2	Reg'd Plan #:	4M-1290	Sales Rep:	N. Trudel
Lot No:	M72	Civic Address:	642 Tranquil Stream Private		
Purchaser(s):				Model Name/#:	120 The Huntley Std.
Purchaser(s):				Closing Date:	4-Nov-21

PLUMBING FIXTURES

ROOM	FIXTURE	STYLE	FINISH	STD/UPG#
KITCHEN	SINK	Reginox Kitchen Sink Undermount Double Bowl ND1831UA/9	Stainless Steel	68
	FAUCET	Delta Marley Kitchen Faucet Single Handle Pull-Down 986LF-AR	Arctic Stainless	66
MAIN BATHROOM	SINK	Standard	White	STD
	VANITY FAUCET	Standard	Chrome	STD
	WATER CLOSET	Standard	White	STD
	TUB/SHOWER	Standard	White	STD
	TUB/SHOWER FAUCET	Standard	Chrome	STD
4PCE ENSUITE BATHROOM	SINK	Standard	White	4
	VANITY FAUCET	Standard	Chrome	4
	WATER CLOSET	Standard	White	4
	SHOWER	Standard with Zitta Niche 12 x 12	Chrome / Clear Glass / White / Stainless Steel	4, 109
	SHOWER FAUCET	Standard	Chrome	4
	BATHTUB	Standard	White	4
	BATHTUB FAUCET	Standard	Chrome	4
POWDER ROOM	PEDESTAL	Standard	White	STD
	SINK FAUCET	Standard	Chrome	STD
	WATER CLOSET	Standard	White	STD
BASEMENT/OTHER BATHROOM	SINK	N/A	N/A	N/A
	VANITY FAUCET	N/A	N/A	N/A
	WATER CLOSET	N/A	N/A	N/A
	SHOWER	N/A	N/A	N/A
	SHOWER FAUCET	N/A	N/A	N/A

NOTE: All fixtures are white as standard

Purchaser's Signature(s) :

Date: _____

Purchaser's Signature(s) : _____

Date: _____

Approved By : D. Brunet

Date: August 11, 2021

Subject to change by Valecraft Homes in the event of unavailability of materials.
Prices, terms and specifications are subject to change without notice E/O.E
K:\Sales\Sales Legal Docs\Site - Deerfield\Block MM72\DV2 M72 Colour sheet Consolidated Aug 18-