

| NON STANDARD EXTRAS (680)         |       |  |              |
|-----------------------------------|-------|--|--------------|
| Deerfield 2 - Phase 2             |       |  |              |
| PURCHASER: Portobello Partnership |       | Printed: 31-Aug-21 10:06 am  |              |
| LOT NUMBER                        | PHASE | HOUSE TYPE   | CLOSING DATE |
| M70                               | 2     | 110 THE THOMAS   | 10-Nov-21    |
| ITEM                              | QTY   | EXTRA / CHANGE   | PRICE        |
| *67<br>90564                      | 1     | - BONUS - APPLIANCES - 3 BASIC STAINLESS STEEL KITCHEN APPLIANCES INCLUDING MICROWAVE COMBO HOODFAN, AND BASIC TOP LOAD WHITE WASHER AND DRYER.  | \$ 0.00      |
| 35538                             | Note: | Refer to item #24 in 680's re: hood fan - chimney style hood fan may not be deleted as cabinets are already in production. Chimney style hood fan is to remain. Microwave/hood fan combo not to be included. | Each         |
| 68<br>35539                       | 1     | - KITCHEN - DELETE ITEM # 12 IN B1A's (RE: KITCHEN SINK FRANKE CUBE CUX110-30-CA SINGLE BOWL STAINLESS STEEL 9" DEEP UNDERMOUNT SINK).   | -\$855.00    |
|                                   | Note: |  | Each         |
| 69<br>88544                       | 1     | - KITCHEN - KITCHEN SINK - REGINOX ND1831UA/9 DOUBLE BOWL UNDERMOUNT SINK  | \$ 143.00    |
| 35540                             | Note: | See item # 6 for solid surface countertops. See item # 71 for faucet.  | Each         |
| 70<br>35541                       | 1     | - KITCHEN - DELETE ITEM # 13 IN B1A's (RE: KITCHEN FAUCET - DELTA ESSA 9113 - AR-DST ARCTIC STAINLESS SINGLE HANDLE PULL DOWN).  | -\$456.00    |
|                                   | Note: |  | Each         |
| *71<br>88428                      | 1     | - KITCHEN - KITCHEN FAUCET - DELTA MARLEY 986LF - AR ARCTIC STAINLESS  | *\$ 361.00   |
| 35542                             | Note: | See item # 6 for solid surface countertops. See item # 69 for sink.  | Each         |
| 72<br>35543                       | 1     | - KITCHEN - DELETE ITEM # 16 IN 680's (RE: UPGRADE TO QUARTZ LEVEL 2, EASED EDGE DETAIL.AS PER COUNTERTOP EDGE PROFILE SKETCH DATED MAY 21ST, 2021).   | -\$1,411.00  |
|                                   | Note: | See item 6 for Granite Level 1   | Each         |
| 73<br>35544                       | 1     | - KITCHEN - IN REFERENCE TO ITEM #6 IN B1A'S, KITCHEN COUNTERTOP C/W B-BAR TO BE EASED EDGE DETAIL.  | \$ 0.00      |
|                                   | Note: | As per countertop edge profile sketch dated August 10, 2021.   | Each         |
| 74<br>35545                       | 1     | - - DELETE ITEM # 22 IN 680's (RE: UPGRADE FIXTURES THROUGHOUT TO RHYTHM COLLECTION).  | -\$1,756.00  |
|                                   | Note: |  | Each         |
| 75<br>35546                       | 1     | - MAIN BATHROOM - DELETE ITEM # 30 IN 680's (RE: UPGRADE COUNTERTOP IN MAIN BATHROOM TO QUARTZ LEVEL 2).   | -\$815.00    |
|                                   | Note: |  | Each         |
| 76<br>35547                       | 1     | - ENSUITE BATH - DELETE ITEM # 31 IN 680's (RE: UPGRADE COUNTERTOP IN 4 PCE ENSUITE BATHROOM TO QUARTZ LEVEL 2).   | -\$1,151.00  |
|                                   | Note: |  | Each         |
| 77<br>35548                       | 1     | - - DELETE ITEM # 35 IN 680's (RE: PAINT ADDITIONAL COLOUR, NON DEEP BASE, BUILDERS STANDARD PAINT. PER COLOUR FOR COMPLETE HOUSE).  | -\$1,050.00  |
|                                   | Note: |  | Each         |
| 78<br>35549                       | 1     | - FOYER - DELETE ITEM # 36 IN 680's (RE: UPGRADE CERAMIC FLOOR TILE IN FOYER/POWDER ROOM, SILVER LEVEL).   | -\$812.00    |
|                                   | Note: |  | Each         |

PREPARED BY: Nicole Trudel  
LOCKED BY: Lisa Ballard  
PE 1,661-1

InvoiceSQL.rpt 05may21

Vendor Initials: Purchaser Initials:

CONSTRUCTION SCHEDULING APPROVAL

PER:

DATE:

| NON STANDARD EXTRAS (680)         |       |  |              |
|-----------------------------------|-------|--|--------------|
| Deerfield 2 - Phase 2             |       |  |              |
| PURCHASER: Portobello Partnership |       | Printed: 31-Aug-21 10:06 am  |              |
| LOT NUMBER                        | PHASE | HOUSE TYPE   | CLOSING DATE |
| M70                               | 2     | 110 THE THOMAS   | 10-Nov-21    |
| ITEM                              | QTY   | EXTRA / CHANGE   | PRICE        |
|                                   |       |  | INTERNAL USE |
| 79                                |       | 1 - FOYER - SUPPLY AND INSTALL TORLYS EVERTILE PREMIER ET24001 CLIFF ISLAND 11 1/2" WIDE x 23 5/8" LONG, FRONT TO BACK                                   | \$ 190.00    |
| 35590                             | Note: | To be installed in Foyer and Powder Room, as per floor plan sketch #2 and floor tile installation sketch, dated August 10, 2021.                         | Each         |
| 80                                |       | 1 - KITCHEN/DINETTE - DELETE ITEM # 37 IN 680's (RE: UPGRADE CERAMIC FLOOR TILE IN KITCHEN/DINETTE STD LAYOUT, SILVER LEVEL).                            | -\$1,237.00  |
| 35550                             | Note: |  | Each         |
| 81                                |       | 1 - KITCHEN/DINETTE - SUPPLY AND INSTALL TORLYS EVERWOOD PREMIER EW23001 BEACH HOUSE 4 7/8" WIDE x 48 3/8" LONG PLANK, FRONT TO BACK INSTALL.            | \$ 278.00    |
| 35583                             | Note: | To be installed in Kitchen and Dinette, as per floor plan sketch #2 dated August 10, 2021.   | Each         |
| 82                                |       | 1 - LAUNDRY ROOM - DELETE ITEM # 38 IN 680's (RE: UPGRADE CERAMIC FLOOR TILE IN LAUNDRY ROOM, SILVER LEVEL).   | -\$186.00    |
| 35551                             | Note: |  | Each         |
| 83                                |       | 1 - LAUNDRY ROOM - SUPPLY AND INSTALL TORLYS EVERWOOD PREMIER EW23001 BEACH HOUSE 4 7/8" WIDE x 48 3/8" LONG PLANK, FRONT TO BACK INSTALL.               | \$ 0.00      |
| 35584                             | Note: | To be installed in laundry room, as per floor plan sketch #2 dated August 10, 2021.  | Each         |
| 84                                |       | 1 - ENSUITE BATH - DELETE ITEM # 39 IN 680's (RE: UPGRADE FLOOR TILE IN LIEU OF WALL TILE, PLATINUM LEVEL ON SHOWER SURROUND IN 4 PCE ENSUITE BATHROOM). | -\$1,583.00  |
| 35552                             | Note: |  | Each         |
| 85                                |       | 1 - ENSUITE BATH - TILE - WALL - UPGRADE - FLOOR TILE IN LIEU OF WALL - SILVER -- SHOWER SURROUND - ENSUITE BATHROOM - OPTIONAL (20) - SILVER            | \$ 1,024.00  |
| 140                               |       |  | Each         |
| 35594                             | Note: | To be installed in 4 Pce Ensuite shower, as per wall tile sketch and as per floor plan sketch #2 dated August 10, 2021.                                  |              |
| 86                                |       | 1 - ENSUITE BATH - DELETE ITEM # 40 IN 680's (RE: UPGRADE FLOOR TILE IN LIEU OF WALL TILE, PLATINUM LEVEL ON TUB SURROUND IN 4 PCE ENSUITE BATHROOM).    | -\$582.00    |
| 35553                             | Note: |  | Each         |
| 87                                |       | 1 - ENSUITE BATH - TILE - WALL - UPGRADE - FLOOR TILE IN LIEU OF WALL - SILVER -- TUB SURROUND - ENSUITE BATHROOM - OPTIONAL (20) - SILVER               | \$ 376.00    |
| 140                               |       |  | Each         |
| 35595                             | Note: | Including tub backsplash. To be installed in 4 Pce Ensuite, as per wall tile installation sketch and as per floor plan sketch #2 dated August 10, 2021.  |              |
| 88                                |       | 1 - MAIN BATHROOM - DELETE ITEM # 41 IN 680's (RE: UPGRADE FLOOR TILE, PLATINUM LEVEL, IN MAIN BATHROOM).  | -\$519.00    |
| 35554                             | Note: |  | Each         |
| 89                                |       | 1 - MAIN BATHROOM - SUPPLY AND INSTALL TORLYS EVERTILE PREMIER ET24013 CALCATTA 11 1/2" WIDE x 23 5/8" LONG, FRONT TO BACK.                              | \$ 0.00      |
| 35591                             | Note: | To be installed in main bathroom, as per floor plan sketch #2 and floor tile installation sketch, dated August 10, 2021.                                 | Each         |
| 90                                |       | 1 - ENSUITE BATH - DELETE ITEM # 42 IN 680's (RE: UPGRADE FLOOR TILE, PLATINUM LEVEL, IN 4 PCE ENSUITE BATHROOM).  | -\$791.00    |
| 35555                             | Note: |  | Each         |

| NON STANDARD EXTRAS (680)         |            |  |                           |
|-----------------------------------|------------|--|---------------------------|
| Deerfield 2 - Phase 2             |            |  |                           |
| PURCHASER: Portobello Partnership |            | Printed: 31-Aug-21 10:06 am  |                           |
| LOT NUMBER<br>M70                 | PHASE<br>2 | HOUSE TYPE<br>110 THE THOMAS   | CLOSING DATE<br>10-Nov-21 |
| ITEM                              | QTY        | EXTRA / CHANGE   | PRICE                     |
| 91                                |            | 1 - <i>ENSUITE BATH</i> - SUPPLY AND INSTALL TORLYS EVERTILE PREMIER ET24013 CALCATTA 11 1/2" WIDE x 23 5/8" LONG, FRONT TO BACK.  | \$ 47.00                  |
| 35592                             |            | Note: To be installed in 4 pce Ensuite bathroom, as per floor plan sketch #2 and floor tile installation sketch, dated August 10, 2021.  | Each                      |
| 92                                |            | 1 - <i>MAIN BATHROOM</i> - DELETE ITEM # 43 IN 680's (RE: UPGRADE WALL TILE, BRONZE LEVEL IN MAIN BATHROOM).   | -\$312.00                 |
| 35556                             |            | Note:  | Each                      |
| 93                                |            | 1 - <i>MAIN BATHROOM</i> - TILE - WALL - UPGRADE - FLOOR TILE IN LIEU OF WALL - SILVER - MAIN BATHROOM - SILVER  | \$ 857.00                 |
| 140                               |            |  | Each                      |
| 35593                             |            | Note: To be installed in Main bathroom, as per wall tile installation sketch and as per floor plan sketch #2 dated August 10, 2021.  |                           |
| 94                                |            | 1 - <i>KITCHEN</i> - DELETE ITEM # 44 IN 680's (RE: UPGRADE KITCHEN BACKSPLASH TO BRONZE LEVEL).   | -\$137.00                 |
| 35557                             |            | Note:  | Each                      |
| 95                                |            | 1 - <i>KITCHEN</i> - TILE - WALL - BACKSPLASH - UPGRADE - GOLD - - KITCHEN - GOLD  | \$ 342.00                 |
| 128                               |            |  | Each                      |
| 35580                             |            | Note: Installed in standard kitchen layout in standard area and behind chimney style hood fan all the way to the ceiling (see item # 24). As per wall tile sketch dated August 10, 2021.         |                           |
| 96                                |            | 1 - <i>GREAT ROOM</i> - DELETE ITEM # 46 IN 680's (RE: SUPPLY AND INSTALL LAUZON ENGINEERED HARDWOOD FLOORING, 4 1/8" WIDE, STAINED, WIRE-BRUSHED, IN GREATROOM, DINING ROOM AND UPPER HALLWAY). | -\$3,818.00               |
| 35558                             |            | Note:  | Each                      |
| 97                                |            | 1 - <i>GREAT ROOM</i> - SUPPLY AND INSTALL TORLYS EVERWOOD PREMIER EW23001 BEACH HOUSE 4 7/8" WIDE x 48 3/8" LONG PLANK, FRONT TO BACK INSTALL.  | \$ 1,618.00               |
| 35585                             |            | Note: To be installed in Great Room, Dining Room, Lower and Upper hallways, as per floor plan sketch #2 dated August 10, 2021.   | Each                      |
| 98                                |            | 1 - <i>BASEMENT</i> - DELETE ITEM # 48 IN 680's (RE: UPGRADE UNDERPAD IN FAMILY ROOM, LEVEL 1).  | -\$240.00                 |
| 35560                             |            | Note:  | Each                      |
| 99                                |            | 1 - <i>BEDROOM 2</i> - DELETE ITEM # 49 IN 680's (RE: UPGRADE UNDERPAD IN BEDROOM 2, LEVEL 1).   | -\$166.00                 |
| 35561                             |            | Note:  | Each                      |
| 100                               |            | 1 - <i>BEDROOM 3</i> - DELETE ITEM # 50 IN 680's (RE: UPGRADE UNDERPAD IN BEDROOM 3, LEVEL 1).   | -\$120.00                 |
| 35562                             |            | Note:  | Each                      |
| 101                               |            | 1 - <i>MASTER BEDROOM</i> - DELETE ITEM # 51 IN 680's (RE: UPGRADE UNDERPAD IN MASTER BEDROOM AND WIC, LEVEL 1).   | -\$200.00                 |
| 35563                             |            | Note:  | Each                      |
| 102                               |            | 1 - - DELETE ITEM # 52 IN 680's (RE: UPGRADE CARPET TO LEVEL 1 IN BASEMENT STAIRCASE).   | -\$147.00                 |
| 35564                             |            | Note:  | Each                      |

PREPARED BY: Nicole Trudel

LOCKED BY: Lisa Ballard

PE 1,661-3

InvoiceSQL.rpt 05may21

Vendor Initials: \_\_\_\_\_ Purchaser Initials: \_\_\_\_\_

CONSTRUCTION SCHEDULING APPROVAL

PER: \_\_\_\_\_

DATE: \_\_\_\_\_

| NON STANDARD EXTRAS (680)         |            |  |                           |
|-----------------------------------|------------|--|---------------------------|
| Deerfield 2 - Phase 2             |            |  |                           |
| PURCHASER: Portobello Partnership |            | Printed: 31-Aug-21 10:06 am  |                           |
| LOT NUMBER<br>M70                 | PHASE<br>2 | HOUSE TYPE<br>110 THE THOMAS   | CLOSING DATE<br>10-Nov-21 |
| ITEM                              | QTY        | EXTRA / CHANGE   | PRICE                     |
| 103                               |            | 1 - BASEMENT - DELETE ITEM # 53 IN 680's (RE: UPGRADE CARPET LEVEL 1 IN FAMILY ROOM).  | - \$377.00                |
| 35565                             |            | Note:  | Each                      |
| 104                               |            | 1 - BASEMENT - SUPPLY AND INSTALL TORLYS EVERWOOD PREMIER EW23001 BEACH HOUSE 4 7/8" WIDE x 48 3/8" LONG PLANK, FRONT TO BACK INSTALL.                           | \$ 3,458.00               |
| 35589                             |            | Note: To be installed in Family Room, as per floor plan sketch #2 dated August 10, 2021.   | Each                      |
| 105                               |            | 1 - BEDROOM 2 - DELETE ITEM # 54 IN 680's (RE: UPGRADE CARPET IN BEDROOM 2, LEVEL 1).  | - \$262.00                |
| 35566                             |            | Note:  | Each                      |
| 106                               |            | 1 - BEDROOM 2 - SUPPLY AND INSTALL TORLYS EVERWOOD PREMIER EW23001 BEACH HOUSE 4 7/8" WIDE x 48 3/8" LONG PLANK, FRONT TO BACK INSTALL.                          | \$ 2,922.00               |
| 35586                             |            | Note: To be installed in Bedroom 2, as per floor plan sketch # 2 dated August 10, 2021.  | Each                      |
| 107                               |            | 1 - BEDROOM 3 - DELETE ITEM # 55 IN 680's (RE: UPGRADE CARPET IN BEDROOM 3, LEVEL 1).  | - \$188.00                |
| 35567                             |            | Note:  | Each                      |
| 108                               |            | 1 - BEDROOM 3 - SUPPLY AND INSTALL TORLYS EVERWOOD PREMIER EW23001 BEACH HOUSE 4 7/8" WIDE x 48 3/8" LONG PLANK, FRONT TO BACK INSTALL.                          | \$ 2,223.00               |
| 35587                             |            | Note: To be installed in Bedroom 3, as per floor plan sketch #2 dated August 10, 2021.   | Each                      |
| 109                               |            | 1 - MASTER BEDROOM - DELETE ITEM # 56 IN 680's (RE: UPGRADE CARPET IN MASTER BEDROOM AND WIC, LEVEL 1).  | - \$314.00                |
| 35568                             |            | Note:  | Each                      |
| 110                               |            | 1 - MASTER BEDROOM - SUPPLY AND INSTALL TORLYS EVERWOOD PREMIER EW23001 BEACH HOUSE 4 7/8" WIDE x 48 3/8" LONG PLANK, FRONT TO BACK INSTALL (OPT ENSUITE LAYOUT) | \$ 4,142.00               |
| 35588                             |            | Note: To be installed in Master Bedroom and WIC, as per floor plan sketch #2 dated August 10, 2021.  | Each                      |
| 111                               |            | 1 - MAIN BATHROOM - DELETE ITEM # 57 IN 680's (RE: AMERICAN STANDARD BOXE UNDERMOUNT SINK 0315-000 IN MAIN BATHROOM).  | - \$285.00                |
| 35569                             |            | Note:  | Each                      |
| 112                               |            | 1 - ENSUITE BATH - DELETE ITEM # 58 IN 680's (RE: AMERICAN STANDARD BOXE UNDERMOUNT SINK 0315-000 IN 4 PCE ENSUITE BATHROOM).                                    | - \$285.00                |
| 35570                             |            | Note:  | Each                      |
| 113                               |            | 1 - MAIN BATHROOM - DELETE ITEM # 59 IN 680's (RE: DELTA TRINSIC SINGLE HANDLE HIGH- ARC LAVATORY FAUCET 559HA-DST).   | - \$304.00                |
| 35571                             |            | Note:  | Each                      |
| 114                               |            | 1 - ENSUITE BATH - DELETE ITEM # 60 IN 680's (RE: DELTA TRINSIC SINGLE HANDLE HIGH- ARC LAVATORY FAUCET 559HA-DST).  | - \$304.00                |
| 35572                             |            | Note:  | Each                      |

PREPARED BY: Nicole Trudel

LOCKED BY: Lisa Ballard

PE 1,661-4

InvoiceSQL.rpt 05may21

Vendor Initials: \_\_\_\_\_ Purchaser Initials: \_\_\_\_\_

CONSTRUCTION SCHEDULING APPROVAL

PER: \_\_\_\_\_

DATE: \_\_\_\_\_

| NON STANDARD EXTRAS (680)         |       |   |              |
|-----------------------------------|-------|---|--------------|
| Deerfield 2 - Phase 2             |       |   |              |
| PURCHASER: Portobello Partnership |       | Printed: 31-Aug-21 10:06 am   |              |
| LOT NUMBER                        | PHASE | HOUSE TYPE  | CLOSING DATE |
| M70                               | 2     | 110 THE THOMAS  | 10-Nov-21    |
| ITEM                              | QTY   | EXTRA / CHANGE  | PRICE        |
| INTERNAL USE                      |       |   |              |
| 115                               |       | 1 - <i>ENSUITE BATH</i> - DELETE ITEM # 61 IN 680's (RE: DELTA TRINSIC ROMAN TUB FAUCET T2759 CHROME).  | -\$346.00    |
| 35573                             |       | Note:   | Each         |
| 116                               |       | 1 - <i>ENSUITE BATH</i> - DELETE ITEM # 62 IN 680's (RE: DELTA TRINSIC SHOWER FAUCET T14259-R10000-UNBX WITH H2O KINETIC RAINCAN SHOWER HEAD CHROME).   | -\$160.00    |
| 35574                             |       | Note:   | Each         |
| 117                               |       | 1 - <i>GARAGE</i> - DELETE ITEM # 63 IN 680's (RE: GARAGE DOOR OPENER BELT DRIVE 8355 WIFI - EACH - INCLUDES 1 REMORE CONTROL AND 1 SENSOR KIT.).   | -\$929.00    |
| 35575                             |       | Note:   | Each         |
| 118                               |       | 1 - <i>GARAGE</i> - DELETE ITEM # 64 IN 680's (RE: GARAGE DOOR OPENER KEYLESS ENTRY CONTROL PAD ON GARAGE DOOR FRAME).  | -\$90.00     |
| 35576                             |       | Note:   | Each         |
| 119                               |       | 1 - <i>GARAGE</i> - DELETE ITEM # 65 IN 680's (RE: GARAGE DOOR OPENER SUPPLY EXTRA REMOTE CONTROLS TRANSMITTER).  | -\$75.00     |
| 35577                             |       | Note:   | Each         |
| 120                               |       | 1 - <i>POWDER ROOM</i> - DELETE ITEM # 66 IN 680's (RE: DELTA TRINSIC SINGLE HANDLE HIGH- ARC LAVATORY FAUCET 559HA-DST).   | -\$304.00    |
| 35578                             |       | Note:   | Each         |
| 121                               |       | 1 - - SUPPLY AND INSTALL QUOTE LEVEL CARPET, BEAULIEU SILEX II BROADLOOM CARPET, PAMPA BEIGE 16320, IN STAIRS TO BASEMENT.  | \$ 1,500.00  |
| 35579                             |       | Note: As per floor plan sketch #2 dated August 10, 2021.  | Each         |
| 122                               |       | 1 - - DELETE ITEM # 18 IN 680's (RE: MODERN TRIM PACKAGE - 239 BASEBOARD AND 1113 CASING).  | -\$4,387.00  |
| 35581                             |       | Note:   | Each         |
| 123                               |       | 1 - - DELETE ITEM # 21 IN 680's (RE: INTERIOR DOOR STYLE MADISON SMOOTH SQUARE SINGLE PANEL - ALL AREAS).   | -\$672.00    |
| 35582                             |       | Note:   | Each         |
| 124<br>88441                      |       | 1 - <i>ENSUITE BATH</i> - BATHROOMS - ZITTA NICHE 12X12 STAINLESS STEEL   | \$ 447.00    |
| 35701                             |       | Note: To be installed on small shower wall opposite shower head in 4 pce ensuite bathroom. Top of niche to be installed approximately 5'-0" from floor and centered, as per floor plan sketch #2 dated August 10, 2021. | Each         |
| 125                               |       | 1 - - REVISION #1 TO COLOUR SHEETS for new colour selections  | \$ 0.00      |
| 35702                             |       | Note:   | Each         |

|           |             |
|-----------|-------------|
| Sub Total | \$-7,698.00 |
| HST       | \$0.00      |
| Total     | \$-7,698.00 |

PREPARED BY: Nicole Trudel  
LOCKED BY: Lisa Ballard  
PE 1,661-5

InvoiceSQL.rpt 05may21

Vendor Initials: \_\_\_\_\_ Purchaser Initials: \_\_\_\_\_

|                                  |       |
|----------------------------------|-------|
| CONSTRUCTION SCHEDULING APPROVAL |       |
| PER:                             | _____ |
| DATE:                            | _____ |



NON STANDARD EXTRAS (680)

Deerfield 2 - Phase 2

PURCHASER: Portobello Partnership

Printed: 31-Aug-21 10:06 am

|            |       |                |              |
|------------|-------|----------------|--------------|
| LOT NUMBER | PHASE | HOUSE TYPE     | CLOSING DATE |
| M70        | 2     | 110 THE THOMAS | 10-Nov-21    |

|      |     |                |       |              |
|------|-----|----------------|-------|--------------|
| ITEM | QTY | EXTRA / CHANGE | PRICE | INTERNAL USE |
|------|-----|----------------|-------|--------------|

|                       |                    |
|-----------------------|--------------------|
| Payment Summary       |                    |
| <u>Paid By</u>        | <u>Amount</u>      |
| APS                   | -\$7,698.00        |
| <u>Total Payment:</u> | <u>-\$7,698.00</u> |

PURCHASER:

Portobello Partnership

31-Aug-21

DATE

VENDOR:

PER: Valecraft Homes Limited

DATE:

CONSTRUCTION SCHEDULING APPROVAL

PER: \_\_\_\_\_

DATE: \_\_\_\_\_



**Valecraft**  
Homes Ltd.

# THE THOMAS

# MODEL 110

2098 sq.ft  
(365 sq.ft. Basement)

Site: DV2

Plan No.: 4M-1290

Lot: M70

Date: Aug 10, 2021

Purchaser: Portobelo Partnership.

Purchaser:

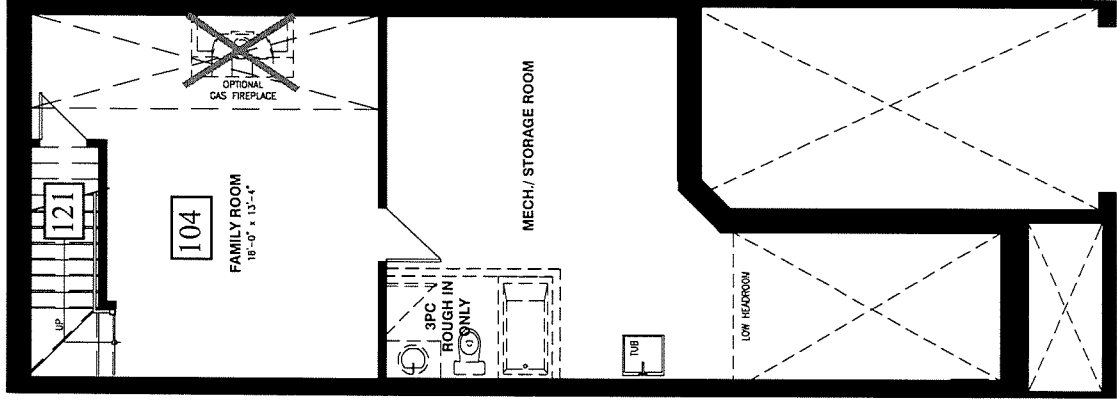

BASEMENT FLOOR

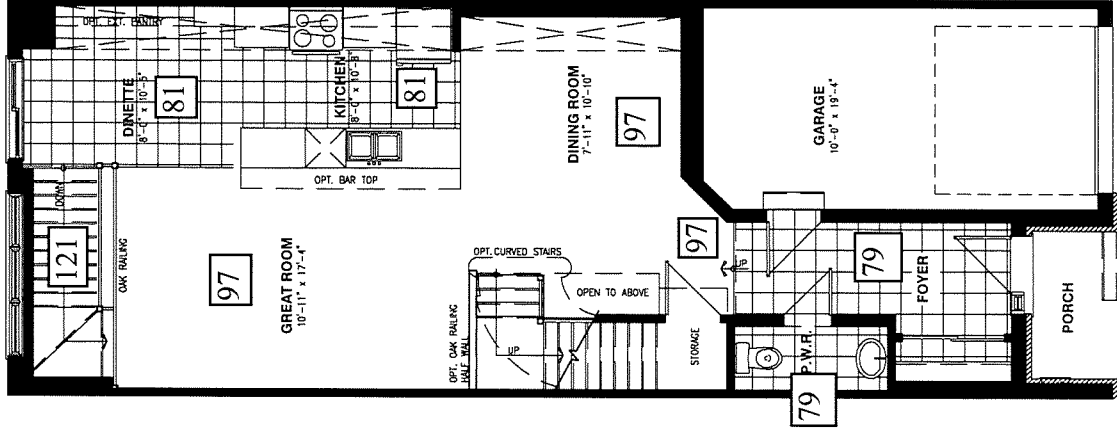

## GROUND FLOOR

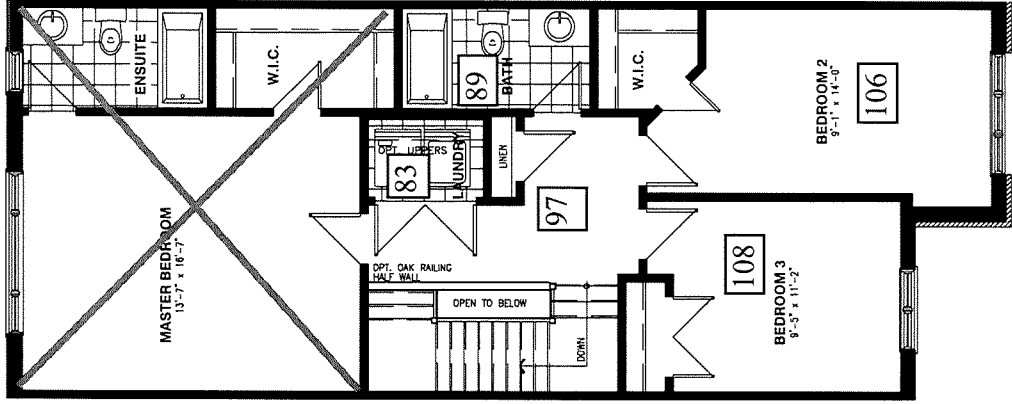

## SECOND FLOOR

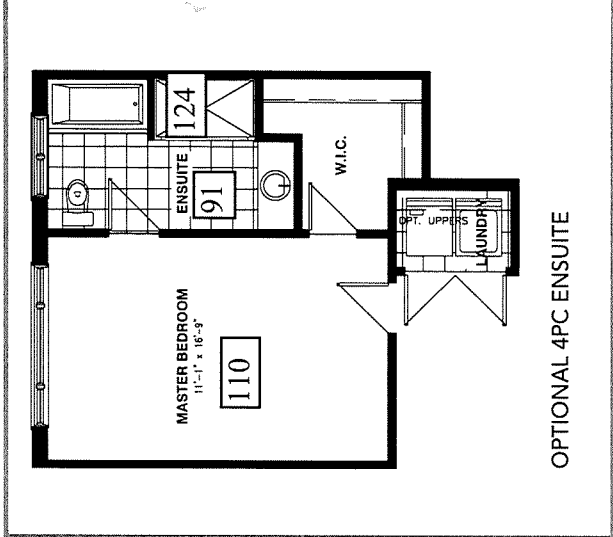

OPTIONAL 4PC ENSUITE



## Floor plan sketch 2

Vertical and/or horizontal bulkheads (chaseways) may be required to contain mechanical piping. All dimensions are approximate. E. & O.E., plans, materials and specifications are subject to change.



**Valecraft**  
Homes Ltd.

## Roma Collection

All Models  
STANDARD

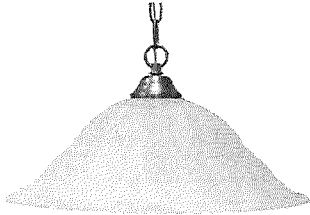

**BREAKFAST / DINETTE**  
A3016P-11  
Bulb: 1 x A19 LED Bulb

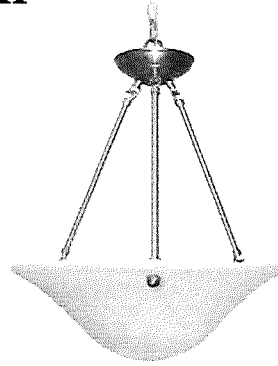

**DINING ROOM / STAIRWELL / HIGH CEILINGS**  
(Plan Permitting)  
A3016ch-11  
Bulbs: 3 x A19 LED Bulb

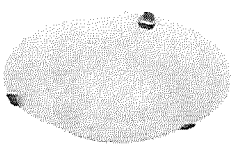

**ENTRY / HALL / LAUNDRY / BEDROOMS /  
DEN / STUDY / BATH CEILING / KITCHEN SINK /  
FINISHED BASEMENT AREAS**  
(Plan Permitting)  
A3012-11  
12" dia.  
Bulbs: 2 x A19 LED Bulb

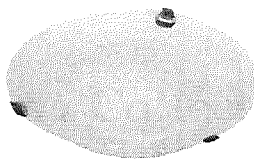

**KITCHEN / MASTER BEDROOM**  
(Plan Permitting)  
A3016-11  
16" dia.  
Bulbs: 3 x A19 LED Bulb

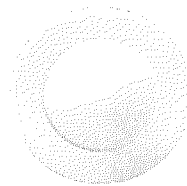

**BASEMENT STAIRS / SOFFIT**  
AFR4-0930-WH  
LED Recessed Light  
5" dia.

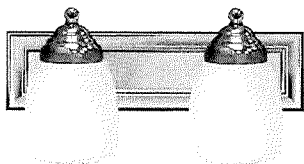

**POWDER ROOM VANITY**  
(Plan Permitting)  
A16012-7  
14" Wide  
Bulbs: 2 x A19 LED Bulb

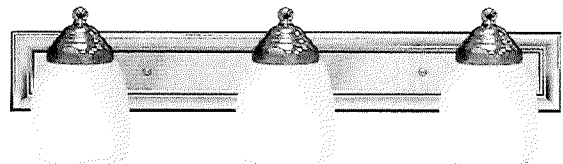

**BATHROOM VANITY**  
A16013-7  
24" Wide  
Bulbs: 3 x A19 LED Bulb

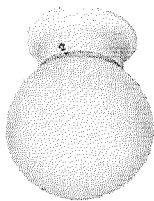

**CLOSET / PANTRY**  
A121-11  
Bulb: 1 x A19 LED Bulb



**FRONT EXTERIOR**  
(Plan Permitting)  
SAN-A1010-6  
Bulb: 1 x A19 LED Bulb

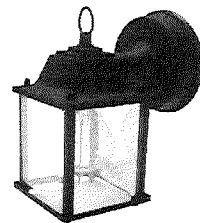

**BACK EXTERIOR**  
SAN-A40455-6  
Bulb: 1 x A19 LED Bulb

\* All dimensions are approximate.

\*\*\* Keyless LIGHT OUTLETS IN GARAGE, UNFINISHED BASEMENT AREAS\*\*\*

Project: DV2

Purchaser: \_\_\_\_\_

Plan #: 4M-1290

Purchaser: \_\_\_\_\_

Lot: M70

Date: August 10, 2021

Model: 110 The Thomas Std.

Upgrade #: Standard, 14, 23





## Standard Edge Profiles for Granite & Quartz

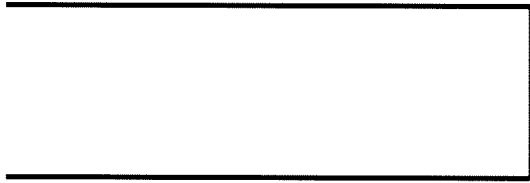

Eased Edge

Kitchen Granite

#6 & #73



1/4 Bevel

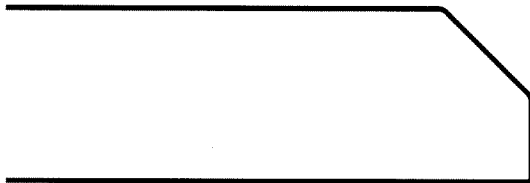

1/2 Bevel



3/4 Bevel

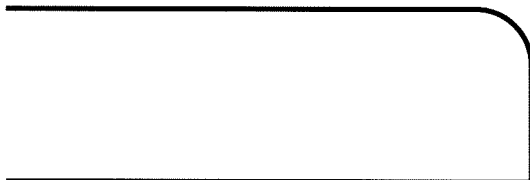

Pencil Top Only  
with Square Bottom

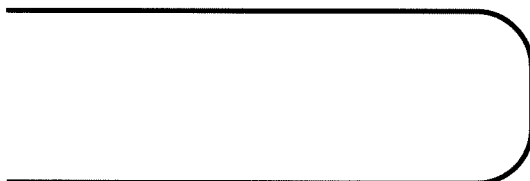

Pencil Top and Bottom



1/2 Bullnose



Full Bullnose

Project: DV2

Purchaser: \_\_\_\_\_

Plan #: 4M-1290

Purchaser: \_\_\_\_\_

Lot: M70

Date: August 10, 2021

Model: 110 The Thomas

Upgrade #: 6, 73



Valecraft  
Homes Ltd.

## Tile Installation Options

### FLOOR TILE

Standard square

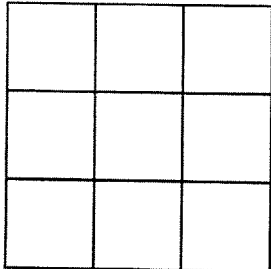

Square brick

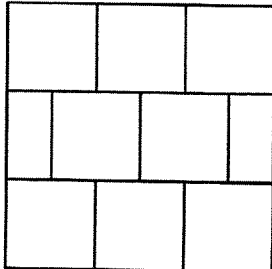

Rectangular  
front to back of the house

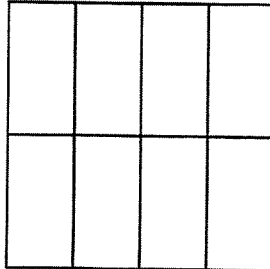

Rectangular  
side to side of the house

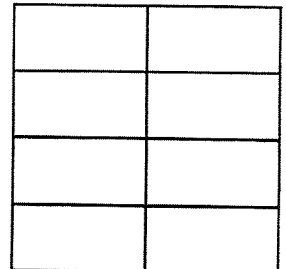

*1/2 BRICK*  
front to back of the house

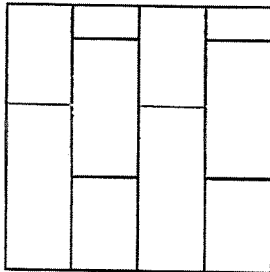

Foyer/Powder Room

Rectangular 1/3 staggered  
side to side of the house

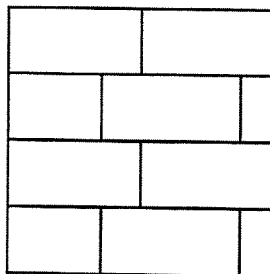

45 degree

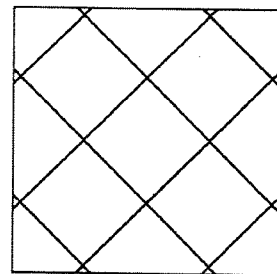

Project: DV2

Purchaser: \_\_\_\_\_

Plan #: 4M-1290

Purchaser: \_\_\_\_\_

Lot: M70

Date: August 10, 2021

Model: 110 The Thomas Std.

Upgrade #: 79



## Tile Installation Options

### WALL TILE

Vertical stacked

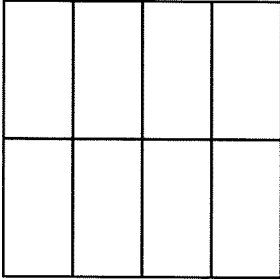

\_\_\_\_\_

\_\_\_\_\_

\_\_\_\_\_

Horizontal stacked

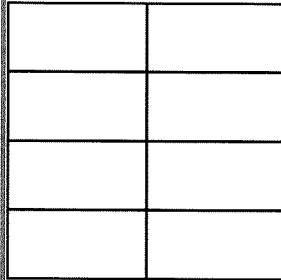

- Kitchen Backsplash,  
Main bathroom Tub  
surround, Ensuite  
Bathroom Tub  
Backsplash, Ensuite  
Shower wall

Vertical 1/3 offset brick

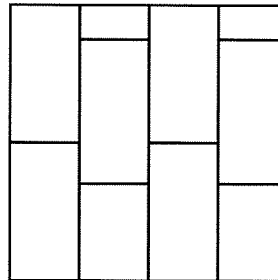

\_\_\_\_\_

\_\_\_\_\_

\_\_\_\_\_

Horizontal 1/3 offset brick

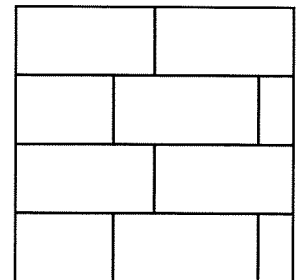

\_\_\_\_\_

\_\_\_\_\_

\_\_\_\_\_

Vertical brick

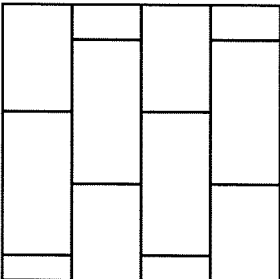

\_\_\_\_\_

\_\_\_\_\_

\_\_\_\_\_

Horizontal brick

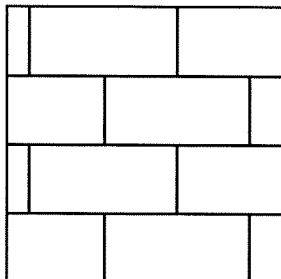

\_\_\_\_\_

\_\_\_\_\_

\_\_\_\_\_

45 degree

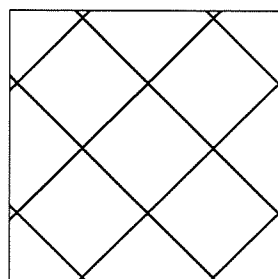

\_\_\_\_\_

\_\_\_\_\_

\_\_\_\_\_

Standard square

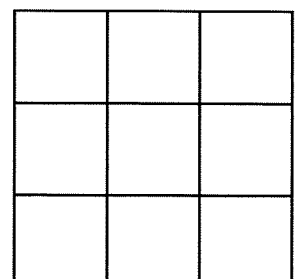

\_\_\_\_\_

\_\_\_\_\_

\_\_\_\_\_

Project: Deerfield Village

Plan #: 4M-1290

Lot: M70

Model: 110 The Thomas

Purchaser: Portobello Partnership

Purchaser: \_\_\_\_\_

Date: August 10, 2021

Upgrade #: 85, 87, 93, 95,

## Schedule "W4" Granite & Variegated Quartz Colour Variation

Purchaser's name: Portobello Partnership Lot no: M70 Plan #: 4M-1290  
Purchaser's name: Contact: Samar Mehri Project: DEERFIELD VILLAGE 2  
Home Phone: \_\_\_\_\_ Model: 110 Thomas Std.  
Work Phone: 613-837-2754 Closing Date: \_\_\_\_\_  
E-Mail (1): design@valecraft.com E-Mail (2): \_\_\_\_\_

Valecraft Homes Ltd. continues to provide the best in class sales and service. We recognize the importance of your home to you, our valued customer.

Granite & Variegated Quartz countertops are an elegant addition to your home. However, there are some things of which you should be aware.

Due to the natural composition of **Granite**, inherent variations in texture, colour and consistency are to be expected and considered as normal.

During the process of manufacturing **Variegated Quartz** to achieve a more natural stone look, variations in the appearance between the sample & the slab are to be expected.

Valecraft Homes Limited strongly suggests that you attend an appointment with our granite/quartz supplier two to three months prior to closing to view the granite/variegated quartz slabs available in the colour you have already chosen. A representative from our supplier will contact you to set up a mutual date & time for the appointment.

I/we, Portobello Partnership

have read and fully understand the aforementioned recommendation set forth by the builder and as such hereby release VALECRAFT HOMES LIMITED from future responsibility with respect to a variation in colour of granite/variegated quartz countertops.

☒ We accept this opportunity

☐ We decline this opportunity

**Project:** DEERFIELD VILLAGE 2 **LOT NO:** M70

**Purchaser** \_\_\_\_\_ **Date:** \_\_\_\_\_

**Purchaser** \_\_\_\_\_ **Date:** \_\_\_\_\_

D. Brunet August 10, 2021  
**Valecraft Homes Limited** **Date:** \_\_\_\_\_

Appointment date given: \_\_\_\_\_ Spoke with/left message: \_\_\_\_\_

Time scheduled: \_\_\_\_\_ Date & Time: \_\_\_\_\_



| SINGLES AND TOWNS COLOUR CHART- REVISION 1 |                     |                |                             |               |                 |
|--|---------------------|----------------|-----------------------------|---------------|-----------------|
| Community:                                 | Deerfield Village 2 | Reg'd Plan #:  | 4M-1290                     | Sales Rep:    | N. Trudel       |
| Lot No:                                    | M70                 | Civic Address: | 646 Tranquil Stream Private |               |                 |
| Purchaser(s):                              |                     |                |                             | Model Name/#: | 110 Thomas Std. |
| Purchaser(s):                              |                     |                |                             | Closing Date: | 10-Nov-21       |

## INTERIOR FINISHES

| DESCRIPTION               |  | STD/UPG # |
|---------------------------|--|-----------|
| TRIM STYLE                | Standard Nivaga Baseboards and Casings   | STD       |
| DOOR STYLE                | Standard Cambridge Style Passage Doors   | STD       |
| INTERIOR HARDWARE         | Standard Satin Chrome  | STD       |
| INTERIOR LIGHTING PACKAGE | Standard Roma Light Package + False bottom with under cabinet LED puck lights on upper kitchen cabinets. | 14, 23    |
| BATHROOM ACCESSORIES      | Standard Infinity Series in Chrome   | 4         |
| FIREPLACE MANTLE          | N/A  | N/A       |

## INTERIOR HANDRAILS AND SPINDLES

|  | WOOD    | STYLE                         | STAIN/COLOUR    | STD/UPG #   |
|--|---------|-------------------------------|-----------------|-------------|
| HANDRAIL                                 | Red Oak | Contemporary                  | SB 200          | 7, 8, 9     |
| BRACKET (if applicable)                  | Metal   | Square                        | Stainless Steel | 7, 8, 9     |
| SPINDLES                                 | Metal   | Square                        | Stainless Steel | 7, 8, 9     |
| POSTS                                    | Red Oak | 3-1/2" wide Modern Routed Top | SB 200          | 7, 8, 9, 20 |
| NOSINGS                                  | Red Oak | N/A                           | SB 200          | 7           |
| HARDWOOD STAIRCASE<br>(WHERE APPLICABLE) | Red Oak | N/A                           | SB 200          | 7, 11, 19   |

## APPLIANCES

| TYPE  | SIZE             | STD/UPG # | APPLIANCE UPG LEVEL                                       | STD/UPG # |
|---|------------------|-----------|---|-----------|
| <b>FRIDGE</b><br>(Standard Minimum Opening is 33" x 70.75") | Standard Opening | STD       | Basic Stainless Steel                                     | 67        |
| <b>RANGE</b>  | Standard Opening | STD       | Basic Stainless Steel                                     | 67        |
| <b>DISHWASHER</b>   | Standard Opening | STD       | Basic Stainless Steel                                     | 67        |
| <b>CHIMNEY HOODFAN</b><br>(Specify if convection)           | Standard Opening | STD       | Whirlpool Stainless Steel Chimney Hoodfan 30" wide 300CFM | 24        |
| <b>WASHING MACHINE/DRYER</b>                                | Standard Opening | STD       | Basic White   | 67        |

**Purchaser's Signature(s) :** \_\_\_\_\_

Date: \_\_\_\_\_

**Purchaser's Signature(s) :** \_\_\_\_\_

Date:

Approved By : D. Brunet

**Date: August 10, 2021**

Subject to change by Valecraft Homes in the event of unavailability of materials.  
Prices, terms and specifications are subject to change without notice E/O.E  
C:\Users\ballard\AppData\Local\Microsoft\Windows\NetCache\Content.Outlook\W4QSMWEQ\DV2 M70 Col

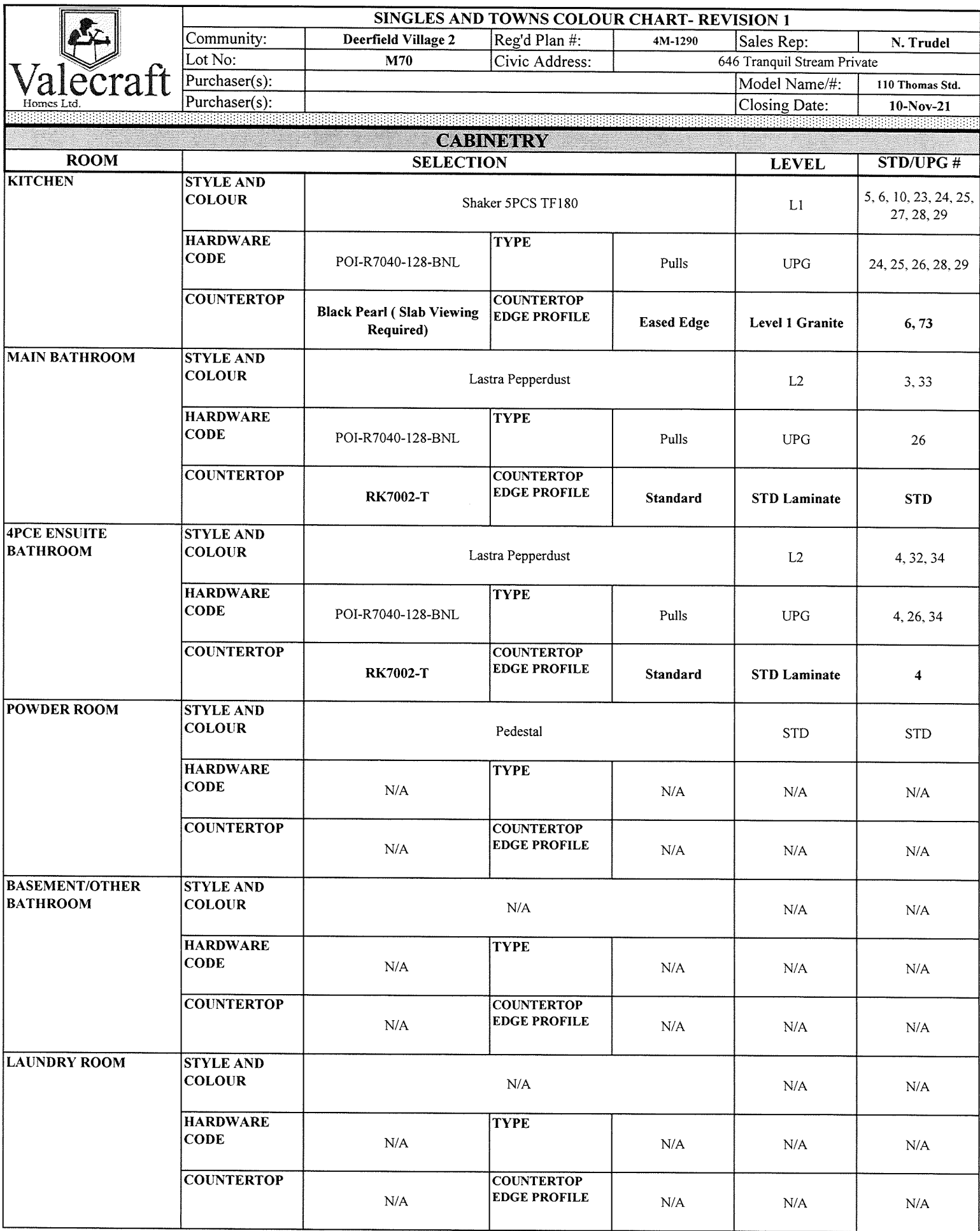

Subject to change by Valecraft Homes in the event of unavailability of materials.  
Prices, terms and specifications are subject to change without notice E/O.E  
C:\Users\lbaldard\AppData\Local\Microsoft\Windows\NetCache\Content.Outlook\W4QSMWEQ\DV2 M70 Col



| SINGLES AND TOWNS COLOUR CHART- REVISION 1 |                     |                |                             |               |                 |
|--|---------------------|----------------|-----------------------------|---------------|-----------------|
| Community:                                 | Deerfield Village 2 | Reg'd Plan #:  | 4M-1290                     | Sales Rep:    | N. Trudel       |
| Lot No:                                    | M70                 | Civic Address: | 646 Tranquil Stream Private |               |                 |
| Purchaser(s):                              |                     |                |                             | Model Name/#: | 110 Thomas Std. |
| Purchaser(s):                              |                     |                |                             | Closing Date: | 10-Nov-21       |

| PAINT COLOUR(S)                   |                                |           |             |           |
|-----------------------------------|--------------------------------|-----------|-------------|-----------|
| ROOM                              | MAIN COLOUR                    | STD/UPG # | ACCENT WALL | STD/UPG # |
| TRIM                              | Semi Gloss OC-117 simply white | STD       | N/A         | N/A       |
| FOYER                             | Low Lustre OC-30 Gray Mist     | STD       | N/A         | N/A       |
| POWDER ROOM                       | Semi Gloss OC-30 Gray Mist     | STD       | N/A         | N/A       |
| MAIN FLOOR HALLWAY                | Low Lustre OC-30 Gray Mist     | STD       | N/A         | N/A       |
| DINING ROOM                       | Low Lustre OC-30 Gray Mist     | STD       | N/A         | N/A       |
| FLEX ROOM                         | N/A                            | N/A       | N/A         | N/A       |
| GREAT ROOM                        | Low Lustre OC-30 Gray Mist     | STD       | N/A         | N/A       |
| FAMILY ROOM                       | Low Lustre OC-30 Gray Mist     | STD       | N/A         | N/A       |
| DEN/STUDY/HOME OFFICE             | N/A                            | N/A       | N/A         | N/A       |
| KITCHEN / DINETTE                 | Semi Gloss OC-30 Gray Mist     | STD       | N/A         | N/A       |
| LAUNDRY CLOSET                    | Low Lustre OC-30 Gray Mist     | STD       | N/A         | N/A       |
| 2nd FLOOR HALLWAY                 | Low Lustre OC-30 Gray Mist     | STD       | N/A         | N/A       |
| MAIN BATH                         | Semi Gloss OC-30 Gray Mist     | STD       | N/A         | N/A       |
| BEDROOM #2                        | Low Lustre OC-30 Gray Mist     | STD       | N/A         | N/A       |
| BEDROOM #3                        | Low Lustre OC-30 Gray Mist     | STD       | N/A         | N/A       |
| BASEMENT BEDROOM                  | N/A                            | N/A       | N/A         | N/A       |
| MASTER BEDROOM                    | Low Lustre OC-30 Gray Mist     | STD       | N/A         | N/A       |
| MASTER BEDROOM WALK-IN CLOSET     | Low Lustre OC-30 Gray Mist     | STD       | N/A         | N/A       |
| MASTER BEDROOM ENSUITE            | Semi Gloss OC-30 Gray Mist     | STD       | N/A         | N/A       |
| FINISHED BASEMENT RECREATION ROOM | N/A                            | N/A       | N/A         | N/A       |
| BASEMENT BATHROOM                 | N/A                            | N/A       | N/A         | N/A       |

**Purchaser's Signature(s) :** \_\_\_\_\_

Date: \_\_\_\_\_

**Purchaser's Signature(s) :** \_\_\_\_\_

Date: \_\_\_\_\_

Approved By : D. Brunet

**Date:** August 10, 2021

Subject to change by Valecraft Homes in the event of unavailability of materials.  
Prices, terms and specifications are subject to change without notice E/O.E  
C:\Users\lballard\AppData\Local\Microsoft\Windows\NetCache\Content.Outlook\W4QSMWEQ\DV2 M70 Col

|   |  |  |                |                             |                            |                 |
|---|--|--|----------------|-----------------------------|----------------------------|-----------------|
| <br><b>Valecraft</b><br>Homes Ltd. | SINGLES AND TOWNS COLOUR CHART- REVISION 1 |  |                |                             |                            |                 |
|   | Community:                                 | Deerfield Village 2  | Reg'd Plan #:  | 4M-1290                     | Sales Rep:                 | N. Trudel       |
|   | Lot No:                                    | M70  | Civic Address: | 646 Tranquil Stream Private |                            |                 |
|   | Purchaser(s):                              |  |                |                             | Model Name/#:              | 110 Thomas Std. |
|   | Purchaser(s):                              |  |                |                             | Closing Date:              | 10-Nov-21       |
| CERAMIC & GROUT SELECTIONS (1)  |  |  |                |                             |                            |                 |
| ROOM  | AREA                                       | MANUFACTURER/SERIES/SIZE/<br>COLOUR/CODE   |                | GROUT<br>SELECTION          | LEVEL                      | STD/UPG #       |
| FOYER   | FLOOR                                      | Torlys Evertile Premier ET24001 Cliff Island 11-1/2" Wide x 23-5/8" Long (Front to Back 1/2 Brick Install) |                | N/A                         | Quote                      | 79              |
| POWDER ROOM   | FLOOR                                      | Torlys Evertile Premier ET24001 Cliff Island 11-1/2" Wide x 23-5/8" Long (Front to Back 1/2 Brick Install) |                | N/A                         | Quote                      | 79              |
|   | WALL                                       | N/A  |                | N/A                         | N/A                        | N/A             |
|   | INSERT OR BORDER                           | N/A  |                |                             |                            |                 |
| MUDROOM   | FLOOR                                      | N/A  |                | N/A                         | N/A                        | N/A             |
|   | WALL                                       | N/A  |                | N/A                         | N/A                        | N/A             |
|   | INSERT OR BORDER                           | N/A  |                |                             |                            |                 |
| LAUNDRY CLOSET  | FLOOR                                      | See Hardwood (Vinyl) Selection   |                | /                           | /                          | 83              |
|   | WALL                                       | N/A  |                | N/A                         | N/A                        | N/A             |
|   | INSERT OR BORDER                           | N/A  |                |                             |                            |                 |
| KITCHEN   | FLOOR                                      | See Hardwood (Vinyl) Selection   |                | /                           | /                          | 81              |
|   | BACKSPLASH                                 | Euro Pasha Soho 4"x16" Matte White (Horizontal stacked install)  |                | 910 Bright White            | Gold Wall Tile + UPG Grout | 45, 95          |
|   | INSERT OR BORDER                           | N/A  |                |                             |                            |                 |
| BREAKFAST AREA/DINETTE  | FLOOR                                      | See Hardwood (Vinyl) Selection   |                | /                           | /                          | 81              |
| FIREPLACE   | HEARTH                                     | N/A  |                | N/A                         | N/A                        | N/A             |
|   | SURROUND                                   | N/A  |                | N/A                         | N/A                        | N/A             |
| ADDITIONAL FIREPLACE  | HEARTH                                     | N/A  |                | N/A                         | N/A                        | N/A             |
|   | SURROUND                                   | N/A  |                | N/A                         | N/A                        | N/A             |

Purchaser's Signature(s) : \_\_\_\_\_
Date: \_\_\_\_\_

Purchaser's Signature(s) : \_\_\_\_\_
Date: \_\_\_\_\_

Approved By : \_\_\_\_\_
D. Brunet
Date: August 10, 2021





| SINGLES AND TOWNS COLOUR CHART- REVISION 1 |                     |                |                             |               |                 |
|--|---------------------|----------------|-----------------------------|---------------|-----------------|
| Community:                                 | Deerfield Village 2 | Reg'd Plan #:  | 4M-1290                     | Sales Rep:    | N. Trudel       |
| Lot No:                                    | M70                 | Civic Address: | 646 Tranquil Stream Private |               |                 |
| Purchaser(s):                              |                     |                |                             | Model Name/#: | 110 Thomas Std. |
| Purchaser(s):                              |                     |                |                             | Closing Date: | 10-Nov-21       |

**CERAMIC & GROUT SELECTIONS (2)**

| ROOM                       | AREA                 | MANUFACTURER/SERIES/SIZE/<br>COLOUR/CODE   | GROUT<br>SELECTION | LEVEL                                    | STD/UPG # |
|----------------------------|----------------------|--|--------------------|--|-----------|
| MAIN BATHROOM              | FLOOR                | Torlys Everlite Premier ET-24013 Calcatta 11-1/2" Wide x 23-5/8" Long (Front to Back 1/2" Brick Install) | N/A                | Quote                                    | 89        |
|                            | WALL/TUB<br>SURROUND | Ceratec Gaia Visuals 11.6" x 23.4" Grey<br>(Horizontal stacked install)                                  | 908 Dove Gray      | Silver Floor Tile on<br>Wall + UPG Grout | 45, 93    |
|                            | INSERT OR<br>BORDER  | N/A  |                    |  |           |
| 3PC ENSUITE<br>BATHROOM    | FLOOR                | N/A  | N/A                | N/A                                      | N/A       |
|                            | WALL/TUB<br>SURROUND | N/A  | N/A                | N/A                                      | N/A       |
|                            | INSERT OR<br>BORDER  | N/A  |                    |  |           |
| 4PC ENSUITE<br>BATHROOM    | FLOOR                | Torlys Everlite Premier ET-24013 Calcatta 11-1/2" Wide x 23-5/8" Long (Front to Back 1/2" Brick Install) | N/A                | Quote                                    | 4, 91     |
|                            | TUB DECK             | Ceratec Gaia Visuals 11.6"x23.4" Grey<br>(Horizontal stacked install)                                    | 908 Dove Gray      | Silver Floor Tile on<br>Wall + UPG Grout | 4, 45, 87 |
|                            | TUB BACKSPLASH       | Ceratec Gaia Visuals 11.6"x23.4" Grey<br>(Horizontal stacked install)                                    | 908 Dove Gray      | Silver Floor Tile on<br>Wall + UPG Grout | 4, 45, 87 |
|                            | INSERT OR<br>BORDER  | N/A  |                    |  |           |
|                            | SHOWER WALL          | Ceratec Gaia Visuals 11.6"x23.4" Grey<br>(Horizontal stacked install)                                    | 908 Dove Gray      | Silver Floor Tile on<br>Wall + UPG Grout | 4, 45, 85 |
| BASEMENT/OTHER<br>BATHROOM | FLOOR                | N/A  | N/A                | N/A                                      | N/A       |
|                            | WALL/TUB<br>SURROUND | N/A  | N/A                | N/A                                      | N/A       |
|                            | INSERT OR<br>BORDER  | N/A  |                    |  |           |

**Purchaser's Signature(s) :** \_\_\_\_\_

Date:

**Purchaser's Signature(s) :** \_\_\_\_\_

Date:

Approved By : D. Brunet

**Date: August 10, 2021**

|   |  |                     |                |                             |                            |                 |
|---|--|---------------------|----------------|-----------------------------|----------------------------|-----------------|
| <br><b>Valecraft</b><br>Homes Ltd. | SINGLES AND TOWNS COLOUR CHART- REVISION 1   |                     |                |                             |                            |                 |
|   | Community:   | Deerfield Village 2 | Reg'd Plan #:  | 4M-1290                     | Sales Rep:                 | N. Trudel       |
|   | Lot No:  | M70                 | Civic Address: | 646 Tranquil Stream Private |                            |                 |
|   | Purchaser(s):  |                     |                |                             | Model Name/#:              | 110 Thomas Std. |
|   | Purchaser(s):  |                     |                |                             | Closing Date:              | 10-Nov-21       |
| FLOORING SELECTIONS   |  |                     |                |                             |                            |                 |
| ROOM  | CARPET/UNDERPAD OR HARDWOOD  |                     |                |                             | LEVEL                      | STD/UPG #       |
| MAIN FLOOR HALLWAY  | Torlys Everwood Premier EW23001 Beach House 4-7/8" Wide x 48-3/8" Long Plank (Front to back install) |                     |                |                             | Quote                      | 97              |
| DINING ROOM   | Torlys Everwood Premier EW23001 Beach House 4-7/8" Wide x 48-3/8" Long Plank (Front to back install) |                     |                |                             | Quote                      | 97              |
| LAUNDRY CLOSET  | Torlys Everwood Premier EW23001 Beach House 4-7/8" Wide x 48-3/8" Long Plank (Front to back install) |                     |                |                             | Quote                      | 83              |
| FAMILY ROOM   | Torlys Everwood Premier EW23001 Beach House 4-7/8" Wide x 48-3/8" Long Plank (Front to back install) |                     |                |                             | Quote                      | 104             |
| GREAT ROOM  | Torlys Everwood Premier EW23001 Beach House 4-7/8" Wide x 48-3/8" Long Plank (Front to back install) |                     |                |                             | Quote                      | 97              |
| DEN/HOME OFFICE   | N/A  |                     |                |                             | N/A                        | N/A             |
| UPPER HALLWAY   | Torlys Everwood Premier EW23001 Beach House 4-7/8" Wide x 48-3/8" Long Plank (Front to back install) |                     |                |                             | Quote                      | 97              |
| KITCHEN   | Torlys Everwood Premier EW23001 Beach House 4-7/8" Wide x 48-3/8" Long Plank (Front to back install) |                     |                |                             | Quote                      | 81              |
| BREAKFAST AREA/DINETTE  | Torlys Everwood Premier EW23001 Beach House 4-7/8" Wide x 48-3/8" Long Plank (Front to back install) |                     |                |                             | Quote                      | 81              |
| MAIN STAIRS TO BEDROOMS   | Red Oak SB200 with Lauzon Essential Tradition Matte 4-1/8" Red Oak Smoky Grey on landings            |                     |                |                             | UPG                        | 11, 19          |
| MAIN FLOOR HALLWAY  | N/A  |                     |                |                             | N/A                        | N/A             |
| BEDROOM # 2   | Torlys Everwood Premier EW23001 Beach House 4-7/8" Wide x 48-3/8" Long Plank (Front to back install) |                     |                |                             | Quote                      | 106             |
| BEDROOM # 3   | Torlys Everwood Premier EW23001 Beach House 4-7/8" Wide x 48-3/8" Long Plank (Front to back install) |                     |                |                             | Quote                      | 108             |
| BEDROOM # 4   | N/A  |                     |                |                             | N/A                        | N/A             |
| MASTER BEDROOM  | Torlys Everwood Premier EW23001 Beach House 4-7/8" Wide x 48-3/8" Long Plank (Front to back install) |                     |                |                             | Quote                      | 110             |
| MASTER BEDROOM WALK-IN CLOSET   | Torlys Everwood Premier EW23001 Beach House 4-7/8" Wide x 48-3/8" Long Plank (Front to back install) |                     |                |                             | Quote                      | 110             |
| STAIRS TO BASEMENT  | Beaulieu Silex II Broadloom Carpet Pampa Beige 16320 + Upgraded Underpad                             |                     |                |                             | Quote Carpet + L1 Underpad | 47, 121         |
| FINISHED BASEMENT BEDROOM ROOM  | N/A  |                     |                |                             | N/A                        | N/A             |

Purchaser's Signature(s) :
Date:

Purchaser's Signature(s) :
Date:

Approved By :
D. Brunet
Date: August 10, 2021



| SINGLES AND TOWNS COLOUR CHART- REVISION 1 |                     |                |                             |               |                 |
|--|---------------------|----------------|-----------------------------|---------------|-----------------|
| Community:                                 | Deerfield Village 2 | Reg'd Plan #:  | 4M-1290                     | Sales Rep:    | N. Trudel       |
| Lot No:                                    | M70                 | Civic Address: | 646 Tranquil Stream Private |               |                 |
| Purchaser(s):                              |                     |                |                             | Model Name/#: | 110 Thomas Std. |
| Purchaser(s):                              |                     |                |                             | Closing Date: | 10-Nov-21       |

## PLUMBING FIXTURES

| ROOM                    | FIXTURE           | STYLE  | FINISH   | STD/UPG# |
|-------------------------|-------------------|--|--|----------|
| KITCHEN                 | SINK              | Reginox Kitchen Sink Undermount Double Bowl ND1831UA/9       | Stainless Steel                                | 69       |
|                         | FAUCET            | Delta Marley Kitchen Faucet Single Handle Pull-Down 986LF-AR | Arctic Stainless                               | 71       |
| MAIN BATHROOM           | SINK              | Standard   | White  | STD      |
|                         | VANITY FAUCET     | Standard   | Chrome   | STD      |
|                         | WATER CLOSET      | Standard   | White  | STD      |
|                         | TUB/SHOWER        | Standard   | White  | STD      |
|                         | TUB/SHOWER FAUCET | Standard   | Chrome   | STD      |
| 4PCE ENSUITE BATHROOM   | SINK              | Standard   | White  | 4        |
|                         | VANITY FAUCET     | Standard   | Chrome   | 4        |
|                         | WATER CLOSET      | Standard   | White  | 4        |
|                         | SHOWER            | Standard with Zitta Niche 12 x 12                            | Chrome / Clear Glass / White / Stainless Steel | 4, 124   |
|                         | SHOWER FAUCET     | Standard   | Chrome   | 4        |
|                         | BATHTUB           | Standard   | White  | 4        |
|                         | BATHTUB FAUCET    | Standard   | Chrome   | 4        |
| POWDER ROOM             | PEDESTAL          | Standard   | White  | STD      |
|                         | SINK FAUCET       | Standard   | Chrome   | STD      |
|                         | WATER CLOSET      | Standard   | White  | STD      |
| BASEMENT/OTHER BATHROOM | SINK              | N/A  | N/A  | N/A      |
|                         | VANITY FAUCET     | N/A  | N/A  | N/A      |
|                         | WATER CLOSET      | N/A  | N/A  | N/A      |
|                         | SHOWER            | N/A  | N/A  | N/A      |
|                         | SHOWER FAUCET     | N/A  | N/A  | N/A      |

**NOTE:** All fixtures are white as standard

**Purchaser's Signature(s) :** \_\_\_\_\_

Date: \_\_\_\_\_

**Purchaser's Signature(s) :**

Date: \_\_\_\_\_

Approved By : D. Brunet

**Date: August 10, 2021**

Subject to change by Valecraft Homes in the event of unavailability of materials.  
Prices, terms and specifications are subject to change without notice E/O.E  
C:\Users\ballard\AppData\Local\Microsoft\Windows\NetCache\Content.Outlook\W4QSMWEQ\DV2 M70 Col