

NON STANDARD EXTRAS (680)

Deerfield 2 - Phase 2

PURCHASER: Portobello Partnership

Printed: 11-Aug-21 2:23 pm

LOT NUMBER M72		PHASE 2	HOUSE TYPE 120 THE HUNTLEY	CLOSING DATE 4-Nov-21
ITEM	QTY	EXTRA / CHANGE	PRICE	INTERNAL USE
*63 90565  35429	1	- BONUS - APPLIANCES - 3 BASIC STAINLESS STEEL KITCHEN APPLIANCES INCLUDING MICROWAVE COMBO HOODFAN, AND BASIC TOP LOAD WHITE WASHER AND DRYER.  Note: See item #64.	\$ 0.00	Each
64  35430	1	- KITCHEN - DELETE ITEM #25 IN 680's (RE: KITCHEN OTR BASIC 1.7 C/F MICROWAVE WITH HOOD - STAINLESS).  Note:	-\$75.00	Each
65  35431	1	- KITCHEN - DELETE ITEM #12 IN B1A's (RE:KITCHEN FAUCET DELTA ESSA 9113-AR-DST ARCTIC STAINLESS SINGLE HANDLE PULL- DOWN).  Note:	-\$456.00	Each
*66 88428  35432	1	- KITCHEN - KITCHEN FAUCET - DELTA MARLEY 986LF - AR ARCTIC STAINLESS  Note: See item #6 for solid surface countertop and item #68 for sink.	*\$ 361.00	Each
67  35434	1	- KITCHEN - DELETE ITEM # 51 IN 680's (RE:KITCHEN SINK - FRANKE CUBE CUX120-CA DOUBLE BOWL STAINLESS STEEL 9" DEEP UNDERMOUNT SINK).  Note:	-\$1,140.00	Each
68 88544  35435	1	- KITCHEN - KITCHEN SINK - REGINOX ND1831UA/9 DOUBLE BOWL UNDERMOUNT SINK  Note: See item #6 for solid surface countertops and item #66 for faucet.	\$ 143.00	Each
69  35436	1	- KITCHEN - DELETE ITEM # 19 IN 680's (RE: UPGRADE TO LEVEL 3 QUARTZ, EASED EDGE DETAIL, AS PER COUNTERTOP EDGE PROFILE SKETCH DATED June 1, 2021).  Note: See item 6 for upgrade to Level 1 Granite	-\$1,569.00	Each
70  35437	1	- KITCHEN - IN REFERENCE TO ITEM # 6 IN B1A's, KITCHEN COUNTERTOP TO BE EASED EDGE DETAIL.  Note: As per countertop edge profile sketch dated August 11, 2021..	\$ 0.00	Each
71  35438	1	- - DELETE ITEM # 16 IN B1A's (RE: GARAGE DOOR OPENER - BELT DRIVE 8355 WIFI - EACH - INCLUDES 1 REMOTE CONTROL AND 1 SENSOR KIT).  Note:	-\$929.00	Each
72  35439	1	- GARAGE - DELETE ITEM # 17 IN 680's (RE: GARAGE DOOR OPENER - KEYLESS ENTRY - CONTROL PAD ON GARAGE DOOR FRAME).  Note:	-\$90.00	Each
73  35440	1	- GARAGE - DELETE ITEM # 18 IN 680's (RE: GARAGE DOOR OPENER - SUPPLY EXTRA REMOTE CONTROL(S) TRANSMITTER).  Note:	-\$75.00	Each
74  35441	1	- KITCHEN - DELETE ITEM # 22 IN 680's (RE: HARDWOOD OAK LAUZON 6 1/4" WIDE ESTATE NATURAL IN KITCHEN IN LIEU OF STANDARD).  Note:	-\$1,490.00	Each

Vendor Initials: Purchaser Initials:

PREPARED BY: Nicole Trudel  
LOCKED BY: Lisa Ballard  
PE 1,660-1  
InvoiceSQL.rpt 05may21

CONSTRUCTION SCHEDULING APPROVAL

PER:

DATE:

NON STANDARD EXTRAS (680)			
Deerfield 2 - Phase 2			
PURCHASER: Portobello Partnership		Printed: 11-Aug-21 2:23 pm	
LOT NUMBER M72	PHASE 2	HOUSE TYPE 120 THE HUNTLEY	CLOSING DATE 4-Nov-21
ITEM	QTY	EXTRA / CHANGE	PRICE
75		1 - <i>KITCHEN</i> - SUPPLY AND INSTALL TORLYS EVERWOOD PREMIER EW-23024 SIERRA 4 7/8" WIDE x 48 3/8" LONG PLANK, FRONT TO BACK INSTALL.	\$ 323.00
35442		Note: Includes cost for underlay and installation. To be installed in Kitchen, as per floor plan sketch Dated August 11, 2021.	Each
76		1 - - DELETE ITEM # 23 IN 680's (RE: RHYTHM COLLECTION - UPGRADE FIXTURES THROUGHOUT).	-\$1,910.00
35443		Note:	Each
77		1 - <i>MAIN BATHROOM</i> - DELETE ITEM # 29 IN 680's (RE: MAIN BATHROOM COUNTERTOP QUARTZ LEVEL 1).	-\$668.00
35444		Note:	Each
78		1 - <i>ENSUITE BATH</i> - DELETE ITEM # 30 IN 680's (RE: 4PC ENSUITE BATHROOM COUNTERTOP QUARTZ LEVEL 1).	-\$998.00
35445		Note:	Each
79		1 - - DELETE ITEM # 34 IN 680's (RE: PAINT ADDITIONAL COLOUR -NON DEEP BASE-BUILDER'S STANDARD PAINT. PER COLOUR FOR COMPLETE HOUSE).	-\$1,050.00
35446		Note:	Each
80		1 - <i>FOYER</i> - DELETE ITEM # 35 IN 680's (RE: UPGRADE FOYER/POWDER ROOM FLOOR TILE TO SILVER LEVEL).	-\$1,131.00
35447		Note:	Each
81		1 - <i>FOYER</i> - DELETE ITEM #36 IN 680's (RE: RECTANGULAR 1/3 STAGGERED SIDE TO SIDE INSTALLATION ONLY FOR SILVER LEVEL FLOOR TILES IN FOYER AND POWDER ROOM.	-\$323.00
35478		Note:	Each
82		1 - <i>FOYER</i> - SUPPLY AND INSTALL TORLYS EVERTILE PREMIER ET24001 CLIFF ISLAND, 11 1/2" WIDE x 23 5/8" LONG, FRONT TO BACK AND 1/2 BRICK INSTALLATION IN FOYER AND POWDER ROOM.	\$ 405.00
35448		Note: Includes cost for underlay and installation. To be installed in Foyer and Powder Room, as per floor plan sketch and as per floor tile installation sketch dated August 11, 2021.	Each
83		1 - <i>LAUNDRY ROOM</i> - DELETE ITEM #37 IN 680's (RE: LAUNDRY ROOM SILVER LEVEL FLOOR TILE).	-\$173.00
35483		Note:	Each
84		1 - <i>LAUNDRY ROOM</i> - SUPPLY AND INSTALL TORLYS EVERWOOD PREMIER EW-23024 SIERRA 4 7/8" WIDE x 48 3/8" LONG PLANK, FRONT TO BACK INSTALL.	\$ 63.00
35453		Note: Includes the cost of underlay and installation. To be installed in Laundry Room, as per floor plan sketch dated August 11, 2021.	Each
85		1 - <i>GREAT ROOM</i> - DELETE ITEM #45 IN 680's (RE: HARDWOOD OAK 6 1/4" WIDE ESTATE SERIES NATURAL, IN STANDARD AREAS, GREATROOM, DINING ROOM, LOWER AND UPPER HALLWAYS).	-\$6,046.00
35490		Note:	Each
86		1 - <i>GREAT ROOM</i> - SUPPLY AND INSTALL TORLYS EVERWOOD PREMIER EW-23024 SIERRA 4 7/8" WIDE x 48 3/8" LONG PLANK, FRONT TO BACK INSTALL, IN LIEU OF STANDARD.	\$ 2,951.00
35454		Note: Includes cost for underlay and installation.To be installed in Great Room, Dining Room, Lower and Upper hallways, As per floor plan sketch dated August 11, 2021.	Each

NON STANDARD EXTRAS (680)			
Deerfield 2 - Phase 2			
PURCHASER: Portobello Partnership		Printed: 11-Aug-21 2:23 pm	
LOT NUMBER	PHASE	HOUSE TYPE	CLOSING DATE
M72	2	120 THE HUNTLEY	4-Nov-21
ITEM	QTY	EXTRA / CHANGE	PRICE INTERNAL USE
87	1	BASEMENT - DELETE ITEM #47 IN 680's (RE: BASEMENT UNDERPAD LEVEL 1).	-\$333.00 Each
35495	Note:		
88	1	BASEMENT - SUPPLY AND INSTALL TORLYS EVERWOOD PREMIER EW-23024 SIERRA 4 7/8" WIDE x 48 3/8" LONG PLANK, FRONT TO BACK INSTALL.	\$ 5,073.00 Each
35455	Note:	Includes cost for underlay and installation. To be installed in Family Room, as per floor plan sketch dated August 11, 2021.	
89	1	MAIN BATHROOM - DELETE ITEM #41 IN 680's (RE:MAIN BATHROOM CERAMIC FLOOR TILE BRONZE LEVEL).	-\$160.00 Each
35496	Note:		
90	1	MAIN BATHROOM - SUPPLY AND INSTALL TORLYS EVERWOOD PREMIER EW-23024 SIERRA 4 7/8" WIDE x 48 3/8" LONG PLANK, FRONT TO BACK INSTALL.	\$ 100.00 Each
35456	Note:	Includes cost for underlay and installation. To be installed in Main Bathroom, as per floor plan sketch dated August 11, 2021.	
91	1	ENSUITE BATH - DELETE ITEM #38 IN 680's (RE: 4 PCE ENSUITE BATHROOM CERAMIC FLOOR TILE SILVER LEVEL).	-\$453.00 Each
35501	Note:		
92	1	ENSUITE BATH - SUPPLY AND INSTALL TORLYS EVERWOOD PREMIER EW-23024 SIERRA 4 7/8" WIDE x 48 3/8" LONG PLANK, FRONT TO BACK INSTALL.	\$ 152.00 Each
35457	Note:	Includes cost for underlay and installation. To be installed in 4 Pce Ensuite bathroom, as per floor plan sketch dated August 11, 2021.	
93	1	BEDROOM 2 - DELETE ITEM #48 IN 680's (RE: UPGRADE UNDERPAD IN BEDROOM 2, LEVEL 1).	-\$140.00 Each
35502	Note:		
94	1	BEDROOM 2 - SUPPLY AND INSTALL TORLYS EVERWOOD PREMIER EW-23024 SIERRA 4 7/8" WIDE x 48 3/8" LONG PLANK, FRONT TO BACK INSTALL.	\$ 2,206.00 Each
35458	Note:	Includes cost for underlay and installation. To be installed in Bedroom #2, as per floor plan sketch dated August 11, 2021.	
95	1	BEDROOM 3 - DELETE ITEM # 49 IN 680's (RE: UPGRADE UNDERPAD IN BEDROOM 3, LEVEL 1).	-\$153.00 Each
35503	Note:		
96	1	BEDROOM 3 - SUPPLY AND INSTALL TORLYS EVERWOOD PREMIER EW-23024 SIERRA 4 7/8" WIDE x 48 3/8" LONG PLANK, FRONT TO BACK INSTALL.	\$ 2,942.00 Each
35462	Note:	Includes cost for underlay and installation. To be installed in Bedroom #3, as per floor plan sketch dated August 11, 2021.	
97	1	MASTER BEDROOM - DELETE ITEM #50 IN 680's (RE: UPGRADE UNDERPAD IN MASTER BEDROOM AND WIC, LEVEL 1).	-\$213.00 Each
35504	Note:		
98	1	MASTER BEDROOM - SUPPLY AND INSTALL TORLYS EVERWOOD PREMIER EW-23024 SIERRA 4 7/8" WIDE x 48 3/8" LONG PLANK, FRONT TO BACK INSTALL.	\$ 4,207.00 Each
35464	Note:	Includes cost for underlay and installation. To be installed in Master Bedroom and WIC, as per floor plan sketch dated August 11, 2021.	

NON STANDARD EXTRAS (680)			
Deerfield 2 - Phase 2			
PURCHASER: Portobello Partnership		Printed: 11-Aug-21 2:23 pm	
LOT NUMBER	PHASE	HOUSE TYPE	CLOSING DATE
M72	2	120 THE HUNTLEY	4-Nov-21
ITEM	QTY	EXTRA / CHANGE	PRICE
99		1 - - SUPPLY AND INSTALL QUOTE LEVEL CARPET, BEAULIEU SILEX II BROADLOOM CARPET PAMPA BEIGE 16320, INSTALLED ON STAIRS TO BASEMENT, IN LIEU OF STANDARD.	\$ 1,500.00
35471		Note: To be installed on stairs to basement, as per floor plan sketch dated August 11, 2021.	Each
100		2 - - DELETE ITEM #44 IN 680's (RE: GROUT COLOUR PER COLOUR).	-\$150.00
35505		Note:	
101		1 - - CERAMIC TILE - GROUT COLOR PER COLOUR	\$ 75.00
88508			Each
35507		Note:	
102		1 - <i>MAIN BATHROOM</i> - DELETE ITEM # 52 IN 680's (RE: MAIN BATHROOM SINK - AMERICAN STANDARD BOXE UNDERMOUNT SINK 0315-000).	-\$285.00
35508		Note:	Each
103		1 - <i>ENSUITE BATH</i> - DELETE ITEM # 53 IN 680's (RE: 4 PCE ENSUITE BATHROOM SINK - AMERICAN STANDARD BOXE UNDERMOUNT SINK 0315-000).	-\$285.00
35509		Note:	Each
104		1 - <i>MAIN BATHROOM</i> - DELETE ITEM # 54 IN 680's (RE: MAIN BATHROOM DELTA TRINSIC SINGLE HANDLE HIGH - ARC LAVATORY FAUCET 559HA-DST).	-\$304.00
35510		Note:	Each
105		1 - <i>ENSUITE BATH</i> - DELETE ITEM # 55 IN 680's (RE: 4 PCE ENSUITE BATHROOM DELTA TRINSIC SINGLE HANDLE HIGH - ARC LAVATORY FAUCET 559HA-DST).	-\$304.00
35511		Note:	Each
106		1 - <i>POWDER ROOM</i> - DELETE ITEM # 56 IN 680's (RE: POWDER ROOM DELTA TRINSIC SINGLE HANDLE HIGH - ARC LAVATORY FAUCET 559HA-DST).	-\$304.00
35512		Note:	Each
107		1 - <i>ENSUITE BATH</i> - DELETE ITEM # 57 IN 680's (RE: 4 PCE ENSUITE BATHROOM DELTA TRINSIC SHOWER FAUCET T14259-R10000-UNBX WITH H20 KINETIC RAINCAN SHOWER HEAD CHROME).	-\$160.00
35513		Note:	Each
108		1 - <i>ENSUITE BATH</i> - DELETE ITEM # 58 IN 680's (RE: 4 PCE ENSUITE BATHROOM DELTA TRINSIC ROMAN TUB FAUCET T2759 CHROME).	-\$346.00
35514		Note:	Each
109		1 - <i>ENSUITE BATH</i> - BATHROOMS - ZITTA NICHE 12X12 STAINLESS STEEL	\$ 447.00
88441			Each
35706		Note: To be installed on small shower wall opposite shower head in 4 pce ensuite bathroom. Top of niche to be installed approximately 5'-0" from floor and centered, as per floor plan sketch dated August 11, 2021.	
110		1 - - REVISION #1 TO COLOUR SHEETS. NEW COLOUR SHEETS DATED AUGUST 11, 2021.	\$ 0.00
35707		Note:	Each



# Valecraft

Homes Ltd.

### NON STANDARD EXTRAS (680)

## Deerfield 2 - Phase 2

**PURCHASER:** Portobello Partnership

Printed: 11-Aug-21 2:23 pm

LOT NUMBER	PHASE	HOUSE TYPE	CLOSING DATE
M72	2	120 THE HUNTLEY	4-Nov-21

ITEM	QTY	EXTRA / CHANGE	PRICE	INTERNAL USE
------	-----	----------------	-------	--------------

Sub Total	\$-765.00
HST	\$0.00
Total	\$-765.00

### Payment Summary

<u>Paid By</u>	<u>Amount</u>
----------------	---------------

**Total Payment:**

PURCHASER: Portobello Partnership 11-Aug-21  
DATE

**VENDOR:** \_\_\_\_\_  
**PER:** Valecraft Homes Limited

**DATE:** \_\_\_\_\_

**PREPARED BY:** Nicole Trudel

**LOCKED BY:** Lisa Ballard

**PE 1,660-5**

InvoiceSQL.rpt 05may21

### CONSTRUCTION SCHEDULING APPROVAL

PER: \_\_\_\_\_

DATE: \_\_\_\_\_



Valecraft  
Homes Ltd.

## Roma Collection

All Models  
STANDARD



**BREAKFAST / DINETTE**  
A3016P-11  
Bulb: 1 x A19 LED Bulb

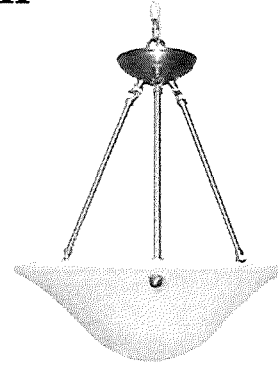

**DINING ROOM / STAIRWELL / HIGH CEILINGS**  
(Plan Permitting)  
A3016ch-11  
Bulbs: 3 x A19 LED Bulb

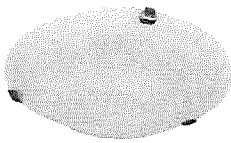

**ENTRY / HALL / LAUNDRY / BEDROOMS /  
DEN / STUDY / BATH CEILING / KITCHEN SINK /  
FINISHED BASEMENT AREAS**  
(Plan Permitting)  
A3012-11  
12" dia.  
Bulbs: 2 x A19 LED Bulb

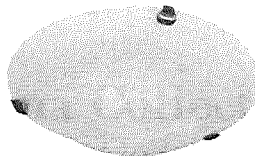

**KITCHEN / MASTER BEDROOM**  
(Plan Permitting)  
A3016-11  
16" dia.  
Bulbs: 3 x A19 LED Bulb

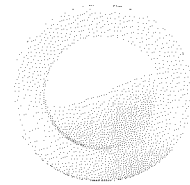

**BASEMENT STAIRS / SOFFIT**  
AFR4-0930-WH  
LED Recessed Light  
5" dia.

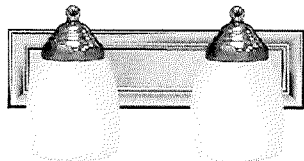

**POWDER ROOM VANITY**  
(Plan Permitting)  
A16012-7  
14" Wide  
Bulbs: 2 x A19 LED Bulb

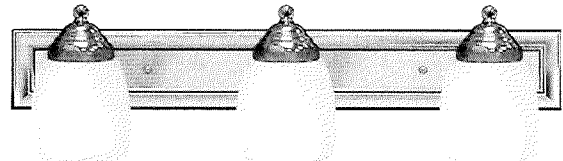

**BATHROOM VANITY**  
A16013-7  
24" Wide  
Bulbs: 3 x A19 LED Bulb

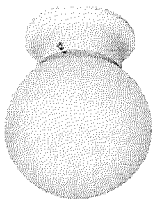

**CLOSET / PANTRY**  
A121-11  
Bulb: 1 x A19 LED Bulb

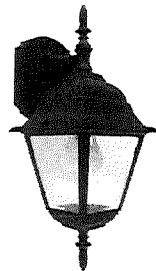

**FRONT EXTERIOR**  
(Plan Permitting)  
SAN-A1010-6  
Bulb: 1 x A19 LED Bulb

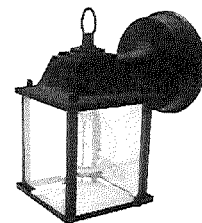

**BACK EXTERIOR**  
SAN-A40455-6  
Bulb: 1 x A19 LED Bulb

\* All dimensions are approximate.

\*\*\* Keyless LIGHT OUTLETS IN GARAGE, UNFINISHED BASEMENT AREAS\*\*\*

Project: DV2

Purchaser: Portobello Partnership

Plan #: 4M-1290

Purchaser: \_\_\_\_\_

Lot: M72

Date: August 11, 2021

Model: 130 The Lewis Rev. End

Upgrade #: Standard, 14

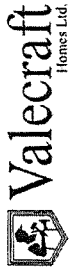

THE HUNTLEY

MODEL 120

2221 sq.ft.  
(474 sq.ft. Basement)

Site: Deerfield Village 2 Purchaser: Portobello Partnership

Plan No.: 4M-1290

Lot: M72 Purchaser: \_\_\_\_\_

Date: August 11, 2021

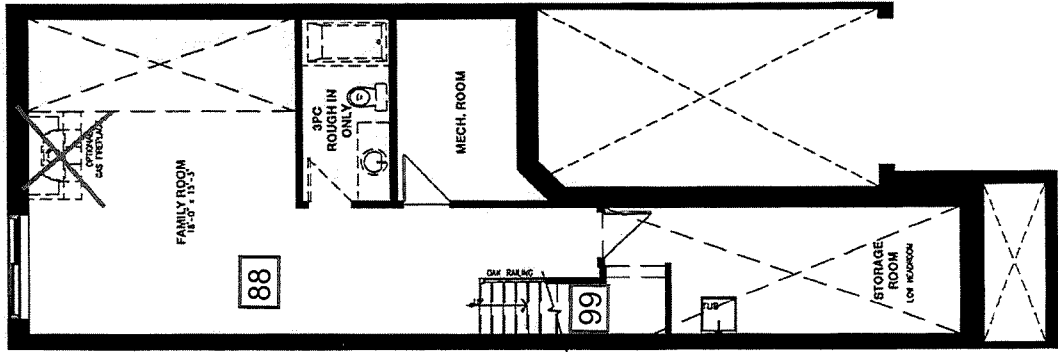

BASEMENT FLOOR

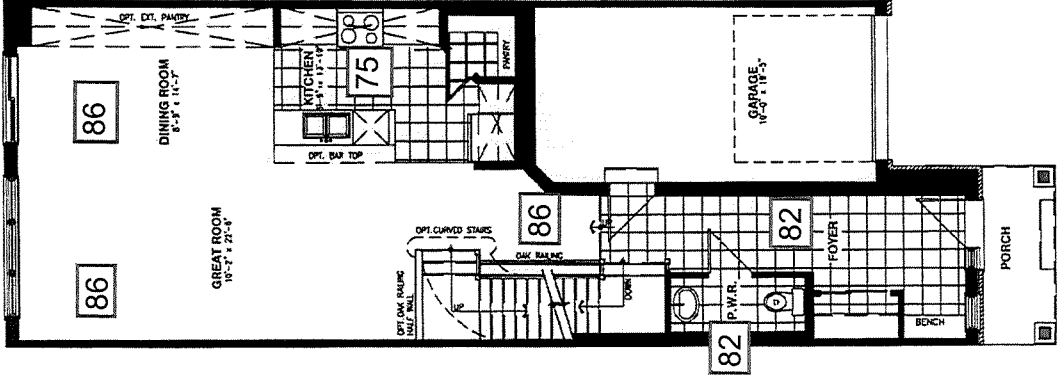

GROUND FLOOR

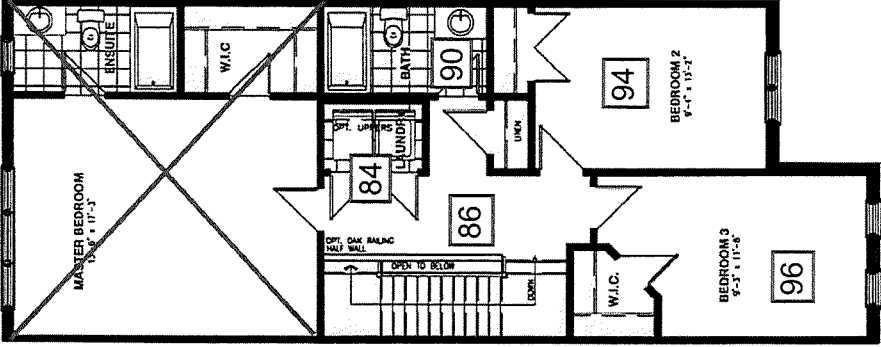

SECOND FLOOR

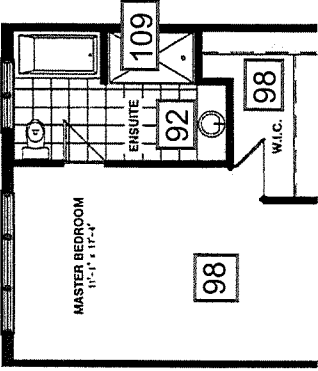

OPTIONAL 4PC ENSUITE

Floor Plan Sketch

Vertical and/or horizontal bulkheads (chaseways) may be required to contain mechanical piping. All dimensions are approximate. E. & O.E., plans, materials and specifications are subject to change without notice. Actual useable floor space may vary from the stated floor area. \*Note: Number of steps varies due to site grading.



Valecraft  
Homes Ltd.

## Tile Installation Options

### FLOOR TILE

Standard square

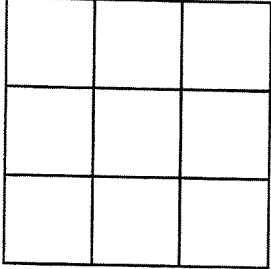

Square brick

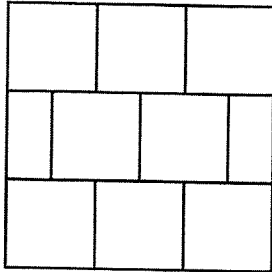

Rectangular  
front to back of the house

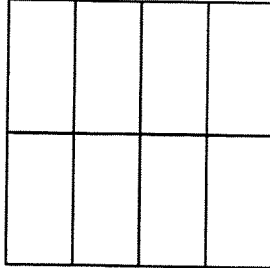

Rectangular  
side to side of the house

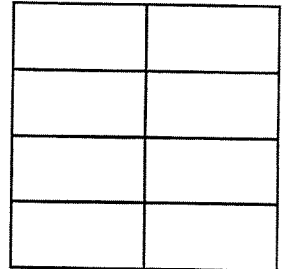

*1/2 Brick*  
front to back of the house

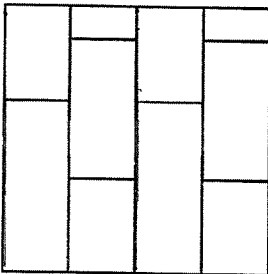

Foyer/Powder Room

Rectangular 1/3 staggered  
side to side of the house

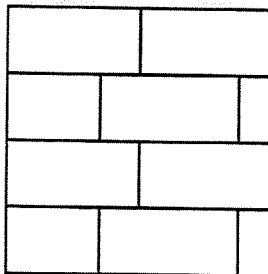

45 degree

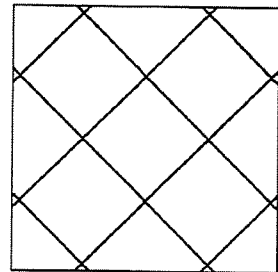

Project: DV2

Purchaser: Portobello Partnership

Plan #: 4M-1290

Purchaser: \_\_\_\_\_

Lot: M72

Date: August 11, 2021

Model: 120 The Huntley Std.

Upgrade #: 82





## Standard Edge Profiles for Granite & Quartz

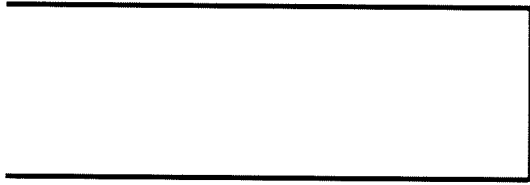

Eased Edge

Kitchen Granite

#6, #70

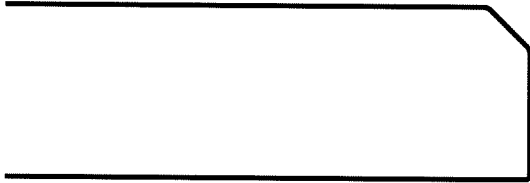

1/4 Bevel

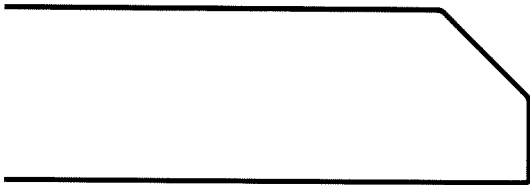

1/2 Bevel

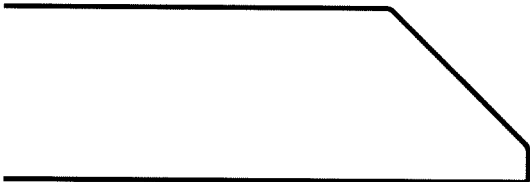

3/4 Bevel

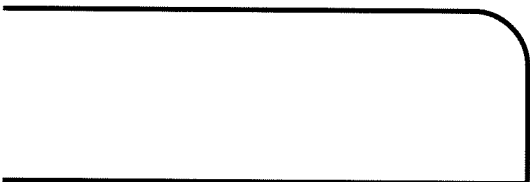

Pencil Top Only  
with Square Bottom

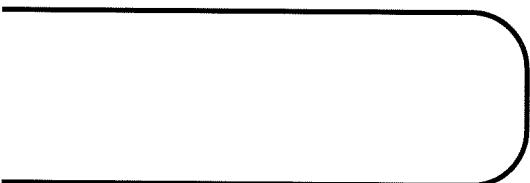

Pencil Top and Bottom

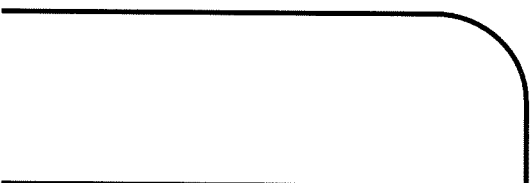

1/2 Bullnose

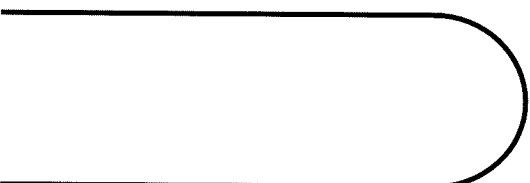

Full Bullnose

Project: DV2

Purchaser: Portobelo Partnership

Plan #: 4M-1290

Purchaser: \_\_\_\_\_

Lot: M72

Date: August 11, 2021

Model: 120 The Huntley Std.

Upgrade #: 6, 70

Schedule "W4"  
Granite & Variegated Quartz Colour Variation

Purchaser's name:	<u>Portobello Partnership</u>	Lot no:	<u>M72</u>	Plan #:	<u>4M-1290</u>
Purchaser's name:	<u>Samar Mehri</u>	Project:	<u>DEERFIELD VILLAGE 2</u>		
Home Phone:	<u>design@valecraft.com</u>	Model:	<u>120 Huntley Std.</u>		
Work Phone:	<u>613-837-2754</u>	Closing Date:			
E-Mail (1):		E-Mail (2):			

Valecraft Homes Ltd. continues to provide the best in class sales and service. We recognize the importance of your home to you, our valued customer.

Granite & Variegated Quartz countertops are an elegant addition to your home. However, there are some things of which you should be aware.

Due to the natural composition of **Granite**, inherent variations in texture, colour and consistency are to be expected and considered as normal.

During the process of manufacturing **Variegated Quartz** to achieve a more natural stone look, variations in the appearance between the sample & the slab are to be expected.

Valecraft Homes Limited strongly suggests that you attend an appointment with our granite/quartz supplier two to three months prior to closing to view the granite/variegated quartz slabs available in the colour you have already chosen. A representative from our supplier will contact you to set up a mutual date & time for the appointment.

I/we, Portobello Partnership  
have read and fully understand the aforementioned recommendation set forth by the builder and as such hereby release VALECRAFT HOMES LIMITED from future responsibility with respect to a variation in colour of granite/ variegated quartz countertops.

<input checked="" type="checkbox"/>	We <u>accept</u> this opportunity
<input type="checkbox"/>	We <u>decline</u> this opportunity

Project:	<u>DEERFIELD VILLAGE 2</u>	LOT NO:	<u>M72</u>
Purchaser		Date:	
Purchaser		Date:	
<u>D. Brunet</u>		<u>August 11, 2021</u>	
Valecraft Homes Limited		Date:	

Appointment date given:		Spoke with/left message:	
Time scheduled:		Date & Time:	

 <b>Valecraft</b> Homes Ltd.	SINGLES AND TOWNS COLOUR CHART- REVISION 1					
	Community:	Deerfield Village 2	Reg'd Plan #:	4M-1290	Sales Rep:	N. Trudel
	Lot No:	M72	Civic Address:	642 Tranquil Stream Private		
	Purchaser(s):	Portobello Partnership			Model Name/#:	120 The Huntley Std.
	Purchaser(s):				Closing Date:	4-Nov-21

INTERIOR FINISHES		
DESCRIPTION		STD/UPG #
TRIM STYLE		
DOOR STYLE		
INTERIOR HARDWARE		
INTERIOR LIGHTING PACKAGE	Roma Light Package + False Bottom with Under-Cabinet LED Puck Lights on Upper Kitchen Cabinets	14, 24
BATHROOM ACCESSORIES		
FIREPLACE MANTLE		

INTERIOR HANDRAILS AND SPINDLES				
	WOOD	STYLE	STAIN/COLOUR	STD/UPG #
HANDRAIL	Red Oak	Contemporary	SB 208	7, 8, 9, 86
BRACKET				
SPINDLES				
POSTS	Red Oak	3-1/2" wide Modern with Cap	SB 208	7, 8, 9, 61, 86
NOSINGS	Red Oak	N/A	SB 208	7, 8, 86
HARDWOOD STAIRCASE <i>(WHERE APPLICABLE)</i>	Red Oak	N/A	SB 208	10, 62, 86

APPLIANCES				
TYPE	SIZE	STD/UPG #	APPLIANCE UPG LEVEL	STD/UPG #
FRIDGE <i>(Standard Minimum Opening is 33" x 70.75")</i>	Standard Opening	STD	Basic Stainless Steel	63
RANGE	Standard Opening	STD	Basic Stainless Steel	63
DISHWASHER	Standard Opening	STD	Basic Stainless Steel	63
MICROWAVE/HOODFAN <i>(Specify if convection)</i>	Standard Opening	STD	Basic Stainless Steel	63
WASHING MACHINE/DRYER	Standard Opening	STD	Basic White	63

Purchaser's Signature(s) :
Date:

Purchaser's Signature(s) :
Date:

Approved By :
Date:



SINGLES AND TOWNS COLOUR CHART- REVISION 1					
Community:	Deerfield Village 2	Reg'd Plan #:	4M-1290	Sales Rep:	N. Trudel
Lot No:	M72	Civic Address:	642 Tranquil Stream Private		
Purchaser(s):	Portobello Partnership			Model Name/#:	120 The Huntley Std.
Purchaser(s):				Closing Date:	4-Nov-21

CABINETRY						
ROOM	SELECTION			LEVEL	STD/UPG #	
KITCHEN	STYLE AND COLOUR					
	HARDWARE CODE		TYPE			
	COUNTERTOP	Black Pearl	COUNTERTOP EDGE PROFILE	Eased Edge	Level 1 Granite	6, 70
MAIN BATHROOM	STYLE AND COLOUR					
	HARDWARE CODE		TYPE			
	COUNTERTOP	P394-VL	COUNTERTOP EDGE PROFILE	Standard	STD Laminate	STD
4pce ENSUITE BATHROOM	STYLE AND COLOUR					
	HARDWARE CODE		TYPE			
	COUNTERTOP	P394-VL	COUNTERTOP EDGE PROFILE	Standard	STD Laminate	4
POWDER ROOM	STYLE AND COLOUR					
	HARDWARE CODE		TYPE			
	COUNTERTOP		COUNTERTOP EDGE PROFILE			
BASEMENT/OTHER BATHROOM	STYLE AND COLOUR					
	HARDWARE CODE		TYPE			
	COUNTERTOP		COUNTERTOP EDGE PROFILE			
LAUNDRY ROOM	STYLE AND COLOUR					
	HARDWARE CODE		TYPE			
	COUNTERTOP		COUNTERTOP EDGE PROFILE			

Purchaser's Signature(s) : \_\_\_\_\_

Date: \_\_\_\_\_

Purchaser's Signature(s) : \_\_\_\_\_

Date: \_\_\_\_\_

Approved By : \_\_\_\_\_

Date: \_\_\_\_\_

 <b>Valecraft</b> Homes Ltd.	SINGLES AND TOWNS COLOUR CHART- REVSION 1					
	Community:	Deerfield Village 2	Reg'd Plan #:	4M-1290	Sales Rep:	N. Trudel
	Lot No:	M72	Civic Address:	642 Tranquil Stream Private		
	Purchaser(s):	Portobello Partnership			Model Name/#:	120 The Huntley Std.
	Purchaser(s):				Closing Date:	4-Nov-21
PAINT COLOUR(S)						
ROOM	MAIN COLOUR		STD/UPG #	ACCENT WALL		STD/UPG #
TRIM						
FOYER	Low Lustre OC-30 Gray Mist		STD			
POWDER ROOM	Semi Gloss OC-30 Gray Mist		STD			
MAIN FLOOR HALLWAY	Low Lustre OC-30 Gray Mist		STD			
DINING ROOM	Low Lustre OC-30 Gray Mist		STD			
FLEX ROOM						
GREAT ROOM	Low Lustre OC-30 Gray Mist		STD			
FAMILY ROOM	Low Lustre OC-30 Gray Mist		STD			
DEN/STUDY/HOME OFFICE						
KITCHEN	Semi Gloss OC-30 Gray Mist		STD			
LAUNDRY CLOSET	Low Lustre OC-30 Gray Mist		STD			
2nd FLOOR HALLWAY	Low Lustre OC-30 Gray Mist		STD			
MAIN BATH	Semi Gloss OC-30 Gray Mist		STD			
BEDROOM #2	Low Lustre OC-30 Gray Mist		STD			
BEDROOM #3	Low Lustre OC-30 Gray Mist		STD			
BASEMENT BEDROOM						
MASTER BEDROOM	Low Lustre OC-30 Gray Mist		STD			
MASTER BEDROOM WALK-IN CLOSET	Low Lustre OC-30 Gray Mist		STD			
MASTER BEDROOM ENSUITE	Semi Gloss OC-30 Gray Mist		STD			
FINISHED BASEMENT RECREATION ROOM						
BASEMENT BATHROOM						

Purchaser's Signature(s) : \_\_\_\_\_
Date: \_\_\_\_\_

Purchaser's Signature(s) : \_\_\_\_\_
Date: \_\_\_\_\_

Approved By : \_\_\_\_\_
Date: \_\_\_\_\_



SINGLES AND TOWNS COLOUR CHART- REVISION 1					
Community:	Deerfield Village 2	Reg'd Plan #:	4M-1290	Sales Rep:	N. Trudel
Lot No:	M72	Civic Address:	642 Tranquil Stream Private		
Purchaser(s):	Portobello Partnership			Model Name/#:	120 The Huntley Std.
Purchaser(s):				Closing Date:	4-Nov-21

CERAMIC & GROUT SELECTIONS (1)					
ROOM	AREA	MANUFACTURER/SERIES/SIZE/ COLOUR/CODE	GROUT SELECTION	LEVEL	STD/UPG #
FOYER	FLOOR	Torlys Evertile Premier ET24001 Cliff Island 11-1/2" Wide x 23-5/8" Long (Front to Back 1/2 Brick Install)	N/A	Quote	82
POWDER ROOM	FLOOR	Torlys Evertile Premier ET24001 Cliff Island 11-1/2" Wide x 23-5/8" Long (Front to Back 1/2 Brick Install)	N/A	Quote	82
	WALL				
	INSERT OR BORDER				
MUDROOM	FLOOR				
	WALL				
	INSERT OR BORDER				
LAUNDRY CLOSET	FLOOR	Torlys Everwood Premier EW-23024 Sierra 4-7/8" Wide x 48-3/8" Long plank (Front to Back Install)	N/A	Quote	84
	WALL				
	INSERT OR BORDER				
KITCHEN	FLOOR	Torlys Everwood Premier EW-23024 Sierra 4-7/8" Wide x 48-3/8" Long plank (Front to Back Install)	N/A	Quote	75
	BACKSPLASH				
	INSERT OR BORDER				
BREAKFAST AREA/DINETTE	FLOOR				
FIREPLACE	HEARTH				
	SURROUND				
ADDITIONAL FIREPLACE	HEARTH				
	SURROUND				

Purchaser's Signature(s) : \_\_\_\_\_

Date: \_\_\_\_\_

Purchaser's Signature(s) : \_\_\_\_\_

Date: \_\_\_\_\_

Approved By : \_\_\_\_\_

Date: \_\_\_\_\_

	SINGLES AND TOWNS COLOUR CHART- REVSION 1					
	Community:	Deerfield Village 2	Reg'd Plan #:	4M-1290	Sales Rep:	N. Trudel
	Lot No:	M72	Civic Address:	642 Tranquil Stream Private		
	Purchaser(s):	Portobello Partnership			Model Name/#:	120 The Huntley Std.
	Purchaser(s):				Closing Date:	4-Nov-21
CERAMIC & GROUT SELECTIONS (2)						
ROOM	AREA	MANUFACTURER/SERIES/SIZE/ COLOUR/CODE		GROUT SELECTION	LEVEL	STD/UPG #
MAIN BATHROOM	FLOOR	Torlys Everwood Premier EW-23024 Sierra 4-7/8" Wide x 48-3/8" Long plank (Front to Back Install)		N/A	Quote	90
	WALL/TUB SURROUND					
	INSERT OR BORDER					
3PC ENSUITE BATHROOM	FLOOR					
	WALL/TUB SURROUND					
	INSERT OR BORDER					
4PC ENSUITE BATHROOM	FLOOR	Torlys Everwood Premier EW-23024 Sierra 4-7/8" Wide x 48-3/8" Long plank (Front to Back Install)		N/A	Quote	4, 92
	TUB DECK					
	TUB BACKSPLASH					
	INSERT OR BORDER					
		SHOWER WALL				
BASEMENT/OTHER BATHROOM	FLOOR					
	WALL/TUB SURROUND					
	INSERT OR BORDER					

Purchaser's Signature(s) :

Purchaser's Signature(s) :

Approved By :

Date:

Date:

Date:



SINGLES AND TOWNS COLOUR CHART- REVSION 1					
Community:	Deerfield Village 2	Reg'd Plan #:	4M-1290	Sales Rep:	N. Trudel
Lot No:	M72	Civic Address:	642 Tranquil Stream Private		
Purchaser(s):	Portobello Partnership			Model Name/#:	120 The Huntley Std.
Purchaser(s):				Closing Date:	4-Nov-21

FLOORING SELECTIONS			
ROOM	CARPET/UNDERPAD OR HARDWOOD	LEVEL	STD/UPG #
MAIN FLOOR HALLWAY	Torlys Everwood Premier EW-23024 Sierra 4-7/8" Wide x 48-3/8" Long plank (Front to Back Install)	UPG	86
DINING ROOM	Torlys Everwood Premier EW-23024 Sierra 4-7/8" Wide x 48-3/8" Long plank (Front to Back Install)	UPG	86
FLEX ROOM			
FAMILY ROOM	Torlys Everwood Premier EW-23024 Sierra 4-7/8" Wide x 48-3/8" Long plank (Front to Back Install)	UPG	88
GREAT ROOM	Torlys Everwood Premier EW-23024 Sierra 4-7/8" Wide x 48-3/8" Long plank (Front to Back Install)	UPG	86
DEN/HOME OFFICE			
UPPER HALLWAY	Torlys Everwood Premier EW-23024 Sierra 4-7/8" Wide x 48-3/8" Long plank (Front to Back Install)	UPG	86
KITCHEN	See Ceramic & Grout Sheet	N/A	N/A
BREAKFAST AREA/DINETTE	See Ceramic & Grout Sheet	N/A	N/A
MAIN STAIRS TO BEDROOMS	Red oak Stained SB 208 with Designer Collection White Oak Wyndham 6-1/4" on landings	UPG	10, 62
MAIN FLOOR HALLWAY			
BEDROOM # 2	Torlys Everwood Premier EW-23024 Sierra 4-7/8" Wide x 48-3/8" Long plank (Front to Back Install)	UPG	94
BEDROOM # 3	Torlys Everwood Premier EW-23024 Sierra 4-7/8" Wide x 48-3/8" Long plank (Front to Back Install)	UPG	96
BEDROOM # 4			
MASTER BEDROOM	Torlys Everwood Premier EW-23024 Sierra 4-7/8" Wide x 48-3/8" Long plank (Front to Back Install)	UPG	98
MASTER BEDROOM WALK-IN CLOSET	Torlys Everwood Premier EW-23024 Sierra 4-7/8" Wide x 48-3/8" Long plank (Front to Back Install)	UPG	98
STAIRS TO BASEMENT	Beaulieu Silex II Broadloom Carpet Pampa Beige 16320 + Upgraded Underpad	Quote Carpet + L1 Underpad	46, 99
FINISHED BASEMENT BEDROOM ROOM			

Purchaser's Signature(s) : \_\_\_\_\_

Date: \_\_\_\_\_

Purchaser's Signature(s) : \_\_\_\_\_

Date: \_\_\_\_\_

Approved By : \_\_\_\_\_

Date: \_\_\_\_\_



 <b>Valecraft</b> Homes Ltd.	SINGLES AND TOWNS COLOUR CHART- REVSION 1					
	Community:	Deerfield Village 2	Reg'd Plan #:	4M-1290	Sales Rep:	N. Trudel
	Lot No:	M72	Civic Address:	642 Tranquil Stream Private		
	Purchaser(s):	Portobello Partnership			Model Name/#:	120 The Huntley Std.
	Purchaser(s):				Closing Date:	4-Nov-21
PLUMBING FIXTURES						
ROOM	FIXTURE	STYLE		FINISH	STD/UPG#	
KITCHEN	SINK	Reginox Kitchen Sink Undermount Double Bowl ND1831UA/9		Stainless Steel	68	
	FAUCET	Delta Marley Kitchen Faucet Single Handle Pull-Down 986LF-AR		Arctic Stainless	66	
MAIN BATHROOM	SINK	Standard		White	STD	
	VANITY FAUCET	Standard		Chrome	STD	
	WATER CLOSET					
	TUB/SHOWER					
	TUB/SHOWER FAUCET					
4PCE ENSUITE BATHROOM	SINK	Standard		White	4	
	VANITY FAUCET	Standard		Chrome	4	
	WATER CLOSET					
	SHOWER	Standard with Zitta Niche 12 x 12		Chrome / Clear Glass / White / Stainless Steel	4, 109	
	SHOWER FAUCET	Standard		Chrome	4	
	BATHTUB					
	BATHTUB FAUCET	Standard		Chrome	4	
POWDER ROOM	PEDESTAL	Standard		White	STD	
	SINK FAUCET	Standard		Chrome	STD	
	WATER CLOSET					
BASEMENT/OTHER BATHROOM	SINK					
	VANITY FAUCET					
	WATER CLOSET					
	SHOWER					
	SHOWER FAUCET					
NOTE: All fixtures are white as standard						

Purchaser's Signature(s) : \_\_\_\_\_

Date: \_\_\_\_\_

Purchaser's Signature(s) : \_\_\_\_\_

Date: \_\_\_\_\_

Approved By : \_\_\_\_\_

Date: \_\_\_\_\_