

NON STANDARD EXTRAS (680)			
Deerfield 2 - Phase 2			
PURCHASER: Portobello Partnership		Printed: 10-Aug-21 3:14 pm	
LOT NUMBER	PHASE	HOUSE TYPE	CLOSING DATE
M69	2	130 THE LEWIS	16-Nov-21
ITEM	QTY	EXTRA / CHANGE	PRICE
*60 90566	1	- BONUS - APPLIANCES - 3 BASIC STAINLESS STEEL KITCHEN APPLIANCES INCLUDING MICROWAVE COMBO HOODFAN, AND BASIC TOP LOAD WHITE WASHER AND DRYER.	\$ 0.00
35596	Note:	Refer to item #27 in 680's re: hood fan - chimney style hood fan may not be deleted as cabinets are already in production. Chimney style hood fan is to remain. Microwave/hood fan combo not to be included.	Each
61 35597	1	- KITCHEN - DELETE ITEM #13 IN B1A'S (RE: KITCHEN SINK FRANKE CUBE CUX110-30-CA SINGLE BOWL STAINLESS STEEL 9" DEEP UNDERMOUNT SINK).	-\$855.00
	Note:		Each
62 88544	1	- KITCHEN - KITCHEN SINK - REGINOX ND1831UA/9 DOUBLE BOWL UNDERMOUNT SINK	\$ 143.00
35599	Note:	See item #8 for solid surface countertops and see item #64 for faucet.	Each
63 35600	1	- KITCHEN - DELETE ITEM #14 IN B1A'S (RE: KITCHEN FAUCET DELTA ESSA 9113- AR-DST- ARCTIC STAINLESS SINGLE HANDLE PULL DOWN).	-\$456.00
	Note:		Each
*64 88428	1	- KITCHEN - KITCHEN FAUCET - DELTA MARLEY 986LF - AR ARCTIC STAINLESS	*\$ 361.00
35598	Note:	See item #8 for solid surface countertops. See item # 62 for sink.	Each
65 35601	1	- GARAGE - DELETE ITEM #19 IN 680'S (RE: GARAGE DOOR OPENER BELT DRIVE 8355 WIFI EACH INCLUDES 1 REMOTE CONTROL AND 1 SENSOR KIT).	-\$929.00
	Note:		Each
66 35602	1	- GARAGE - DELETE ITEM #20 IN 680'S (RE: GARAGE DOOR OPENER KEYLESS ENTRY CONTROL PAD ON GARAGE DOOR FRAME).	-\$90.00
	Note:		Each
67 35603	1	- GARAGE - DELETE ITEM #21 IN 680'S (RE: GARAGE DOOR OPENER SUPPLY EXTRA REMOTE CONTROLS TRANSMITTER).	-\$75.00
	Note:		Each
68 35604	1	- KITCHEN - DELETE ITEM #22 IN 680'S (RE: UPGRADE FOR LEVEL 1 GRANITE TO LEVEL 3 QUARTZ, EASED EDGE DETAIL, AS PER COUNTERTOP EDGE PROFILE SKETCH DATED MAY 12TH, 2021), -Reference Item # 8 in B1A	-\$1,942.00
	Note:		Each
69 35636	1	- KITCHEN - REFERENCE ITEM # 8 IN B1A'S, KITCHEN COUNTERTOPS C/W B- BAR IN OPTIONAL KITCHEN #2 LAYOUT COUNTERTOP PROFILE TO BE EASED EDGE.	\$ 0.00
	Note:	As per countertop edge profile sketch dated August 10, 2021.	Each
70 35605	1	- - DELETE ITEM #24 IN 680'S (RE: RHYTHM COLLECTION UPGRADE FIXTURES THROUGHOUT).	-\$1,829.00
	Note:		Each
71 35606	1	- - DELETE ITEM #36 IN 680'S (RE: PAINT ADDITIONAL COLOUR, NON DEEP BASE, BUILDERS STANDARD PAINT. PER COLOUR FOR COMPLETE HOUSE).	-\$1,050.00
	Note:		Each

PREPARED BY: Nicole Trudel  
LOCKED BY: Lisa Ballard  
PE 1,662-1  
InvoiceSQL.rpt 05may21

Vendor Initials: \_\_\_\_\_ Purchaser Initials: \_\_\_\_\_

CONSTRUCTION SCHEDULING APPROVAL

PER: \_\_\_\_\_

DATE: \_\_\_\_\_

NON STANDARD EXTRAS (680)

Deerfield 2 - Phase 2

PURCHASER: Portobello Partnership

Printed: 10-Aug-21 3:14 pm

LOT NUMBER M69	PHASE 2	HOUSE TYPE 130 THE LEWIS	CLOSING DATE 16-Nov-21
-------------------	------------	-----------------------------	---------------------------

ITEM	QTY	EXTRA / CHANGE	PRICE	INTERNAL USE
------	-----	----------------	-------	--------------

72  35607	1 - <i>FOYER</i> - DELETE ITEM #37 IN 680'S (RE: UPGRADE FLOOR TILES TO SILVER LEVEL IN FOYER/POWDER ROOM).  Note:		-\$1,237.00	Each
73  35608	1 - <i>FOYER</i> - SUPPLY AND INSTALL TORLYS EVERTILE PREMIER ET24001 CLIFF ISLAND 11 1/2" WIDE x 23 5/8" LONG, FRONT TO BACK AND 1/2 BRICK INSTALL).  Note: Includes cost for the underlay and installation. To be installed in Foyer and Powder Room, as per Floor Plan Sketch #2 and floor tile installation sketch dated August 10, 2021.		\$ 442.00	Each
74  35609	1 - <i>KITCHEN</i> - DELETE ITEM #38 IN 680'S (RE:KITCHEN OPT #2 FLOOR TILE UPGRADE TO SILVER LEVEL).  Note:		-\$905.00	Each
75  35610	1 - <i>KITCHEN</i> - SUPPLY AND INSTALL TORLYS EVERWOOD PREMIER EW23001 BEACH HOUSE 4 7/8" WIDE x 48 3/8" LONG PLANK, FRONT TO BACK INSTALL).  Note: Includes cost for the underlay and installation. To be installed in Kitchen Opt #2 layout, as per Floor Plan Sketch #2 dated August 10, 2021. -See Item #8 for Optional Kitchen Layout 2		\$ 323.00	Each
76  35611	1 - <i>LAUNDRY ROOM</i> - DELETE ITEM #39 IN 680'S (RE:LAUNDRY ROOM FLOOR UPGRADE TO SILVER LEVEL).  Note:		-\$173.00	Each
77  35612	1 - <i>LAUNDRY ROOM</i> - SUPPLY AND INSTALL TORLYS EVERWOOD PREMIER EW23001 BEACH HOUSE 4 7/8" WIDE x 48 3/8" LONG PLANK, FRONT TO BACK INSTALL).  Note: Includes cost for the underlay and installation. To be installed in Laundry Room, as per Floor Plan Sketch #2 dated August 10, 2021.		\$ 63.00	Each
78  35613	1 - <i>ENSUITE BATH</i> - DELETE ITEM #40 IN 680'S (RE: 4 PCE ENSUITE (2 SINKS) BATHROOM FLOOR TILE UPGRADE TO SILVER SERIES).  Note:		-\$346.00	Each
79  35614	1 - <i>ENSUITE BATH</i> - SUPPLY AND INSTALL TORLYS EVERWOOD PREMIER EW23001 BEACH HOUSE 4 7/8" WIDE x 48 3/8" LONG PLANK, FRONT TO BACK INSTALL).  Note: Includes cost for the underlay and installation. To be installed in 4 Pce Ensuite bathroom with 2 sinks, as per Floor Plan Sketch #2 dated August 10, 2021. -See Item #4 for 4PC Ensuite Layout.		\$ 114.00	Each
80  35615	1 - <i>MAIN BATHROOM</i> - DELETE ITEM #44 IN 680'S (RE: MAIN BATHROOM FLOOR TILE UPGRADE TO BRONZE LEVEL).  Note:		-\$137.00	Each
81  35616	1 - <i>MAIN BATHROOM</i> - SUPPLY AND INSTALL TORLYS EVERWOOD PREMIER EW23001 BEACH HOUSE 4 7/8" WIDE x 48 3/8" LONG PLANK, FRONT TO BACK INSTALL).  Note: Includes cost for the underlay and installation. To be installed in Main Bathroom, as per Floor Plan Sketch #2 dated August 10, 2021.		\$ 86.00	Each
82  35617	2 - - DELETE ITEM #47 IN 680'S (RE: CERAMIC TILE GROUT COLOUR PER COLOUR).  Note:		-\$150.00	
83 88508  35618	1 - - CERAMIC TILE - GROUT COLOR PER COLOUR  Note:		\$ 75.00	Each

Vendor Initials: \_\_\_\_\_

Purchaser Initials: \_\_\_\_\_

PREPARED BY: Nicole Trudel

LOCKED BY: Lisa Ballard

PE 1,662-2

InvoiceSQL.rpt 05may21

CONSTRUCTION SCHEDULING APPROVAL

PER: \_\_\_\_\_

DATE: \_\_\_\_\_

NON STANDARD EXTRAS (680)			
Deerfield 2 - Phase 2			
PURCHASER: Portobello Partnership		Printed: 10-Aug-21 3:14 pm	
LOT NUMBER	PHASE	HOUSE TYPE	CLOSING DATE
M69	2	130 THE LEWIS	16-Nov-21
ITEM	QTY	EXTRA / CHANGE	PRICE INTERNAL USE
84	1	- DELETE ITEM #48 IN 680'S (RE: HARDWOOD OAK LAUZON 6 1/4" WIDE ESTATE STAINED IN STANDARD AREAS). GREAT ROOM, DINING ROOM AND UPPER HALLWAY.	-\$5,650.00 Each
35619	Note:		
85	1	- GREAT ROOM - SUPPLY AND INSTALL TORLYS EVERWOOD PREMIER EW23001 BEACH HOUSE 4 7/8" WIDE x 48 3/8" LONG PLANK, FRONT TO BACK INSTALL, IN STANDARD AREAS).	\$ 2,766.00 Each
35620	Note:	Includes cost for the underlay and installation. To be installed in Great Room, Dining Room, Lower and Upper Hallway, as per Floor Plan Sketch #2 dated August 10, 2021.	
86	1	- BASEMENT - DELETE ITEM # 50 IN 680'S (RE: UPGRADE UNDERPAD LEVEL 1 IN FAMILY ROOM).	-\$333.00 Each
35621	Note:		
87	1	- BASEMENT - SUPPLY AND INSTALL TORLYS EVERWOOD PREMIER EW23001 BEACH HOUSE 4 7/8" WIDE x 48 3/8" LONG PLANK, FRONT TO BACK INSTALL).	\$ 4,823.00 Each
35622	Note:	Includes cost for the underlay and installation. To be installed if Family Room, as per Floor Plan Sketch #2 dated August 10, 2021.	
88	1	- BEDROOM 2 - DELETE ITEM # 51 IN 680'S (RE: UPGRADE UNDERPAD LEVEL 1 IN BEDROOM #2).	-\$133.00 Each
35623	Note:		
89	1	- BEDROOM 2 - SUPPLY AND INSTALL TORLYS EVERWOOD PREMIER EW23001 BEACH HOUSE 4 7/8" WIDE x 48 3/8" LONG PLANK, FRONT TO BACK INSTALL).	\$ 2,643.00 Each
35624	Note:	Includes cost for the underlay and installation. To be installed in Bedroom #2, as per Floor Plan Sketch #2 dated August 10, 2021.	
90	1	- BEDROOM 3 - DELETE ITEM #52 IN 680'S (RE: UPGRADE UNDERPAD LEVEL 1 IN BEDROOM #3).	-\$160.00 Each
35625	Note:		
91	1	- BEDROOM 3 - SUPPLY AND INSTALL TORLYS EVERWOOD PREMIER EW23001 BEACH HOUSE 4 7/8" WIDE x 48 3/8" LONG PLANK, FRONT TO BACK INSTALL).	\$ 2,899.00 Each
35626	Note:	Includes cost for the underlay and insatallation. To be installed in Bedroom #3, as per Floor Plan Sketch #2 dated August 10, 2021.	
92	1	- MASTER BEDROOM - DELETE ITEM #53 IN 680'S (RE: UPGRADE UNDERPAD LEVEL 1 IN MASTER BEDROOM AND WIC OPT. ENSUITE).	-\$213.00 Each
35627	Note:		
93	1	- MASTER BEDROOM - SUPPLY AND INSTALL TORLYS EVERWOOD PREMIER EW23001 BEACH HOUSE 4 7/8" WIDE x 48 3/8" LONG PLANK, FRONT TO BACK INSTALL).	\$ 4,604.00 Each
35628	Note:	Includes cost for the underlay and installation. To be installed in Master Bedroom and MBD WIC, as per Floor Plan Sketch #2 dated August 10, 2021.	
94	1	- - SUPPLY AND INSTALL QUOTE LEVEL CARPET, BEAULIEU SILEX II BROADLOOM PAMPA BEIGE 16320.	\$ 1,500.00 Each
35629	Note:	To be installed in stairs to basement, as per Floor Plan Sketch #2 dated August 10, 2021.	
95	1	- MAIN BATHROOM - DELETE ITEM #54 IN 680'S (RE: MAIN BATHROOM SINK AMERICAN STANDARD BOXE UNDERMOUNT SINK 0315-000).	-\$285.00 Each
35630	Note:		

PREPARED BY: Nicole Trudel

LOCKED BY: Lisa Ballard

PE 1.662-3

InvoiceSQL.rpt 05may21

Vendor Initials: \_\_\_\_\_ Purchaser Initials: \_\_\_\_\_

CONSTRUCTION SCHEDULING APPROVAL

PER: \_\_\_\_\_

DATE: \_\_\_\_\_

NON STANDARD EXTRAS (680)			
Deerfield 2 - Phase 2			
PURCHASER: Portobello Partnership		Printed: 10-Aug-21 3:14 pm	
LOT NUMBER	PHASE	HOUSE TYPE	CLOSING DATE
M69	2	130 THE LEWIS	16-Nov-21
ITEM	QTY	EXTRA / CHANGE	PRICE
			INTERNAL USE
96		2 - <i>ENSUITE BATH</i> - DELETE ITEM #55 IN 680'S (RE: 4 PCE ENSUITE WITH 2 SINKS, BATHROOM SINKS AMERICAN STANDARD BOXE UNDERMOUNT SINK 0315-000).	-\$570.00
35631		Note:	
97		1 - <i>MAIN BATHROOM</i> - DELETE ITEM #56 IN 680'S (RE: DELTA TRINSIC SINGLE HANDLE HIGH ARC LAVATORY FAUCET 559HA- DST IN MAIN BATHROOM).	-\$304.00
35632		Note:	Each
98		2 - <i>ENSUITE BATH</i> - DELETE ITEM # 57 IN 680'S (RE: DELTA TRINSIC SINGLE HANDLE HIGH ARC LAVATORY FAUCET 559HA- DST IN 4 PCE ENSUITE BATHROOM C/W 2 SINKS).	-\$608.00
35633		Note:	
99		1 - <i>POWDER ROOM</i> - DELETE ITEM # 58 IN 680'S (RE: DELTA TRINSIC SINGLE HANDLE HIGH ARC LAVATORY FAUCET 559HA- DST IN POWDER ROOM).	-\$304.00
35634		Note:	Each
100		1 - <i>ENSUITE BATH</i> - DELETE ITEM # 59 IN 680'S (RE: DELTA TRINSIC SHOWER FAUCET T14259-R10000-UNBX WITH H2O KINETIC RAINCAN SHOWER HEAD CHROME IN 4 PCE ENSUITE C/W 2 SINKS).	-\$160.00
35635		Note:	Each
101		1 - <i>ENSUITE BATH</i> - BATHROOMS - ZITTA NICHE 12X12 STAINLESS STEEL	\$ 447.00
88441			Each
35703		Note: To be installed on small shower wall opposite shower head in 4 pce ensuite bathroom. Top of niche to be installed approximately 5'-0" from floor and centered, as per Floor Plan Sketch #2 dated August 10, 2021.	
102		1 - - DELETE ITEM #26 IN B1A'S (RE: ITEM #12 OAK STAIRCASE TO BE COMPLETED WITH UPGRADED 6 1/4" WIDE ENGINEERED HARDWOOD LANDINGS 'STAINED CELTIK' IN LIEU OF STANDARD 3 1/8" WIDE ENGINEERED HARDWOOD LANDINGS)	-\$462.00
35764		Note:	Each
103		1 - - AT MAIN STAIRCASE LANDING - OAK STAIRCASE TO BE COMPLETED WITH UPGRADED LAUZON ESSENTIAL COLLECTION TRADITION GRADE MATTE 4 1/8" WIDE ENGINEERED HARDWOOD RED OAK SMOKEY GREY.	\$ 262.00
35765		Note: -See Item 12 (Oak Main Staircase Upgrade) On main floor staicase to second level, as per floor plan sketch dated August 10th, 2021.	Each
105		1 - <i>MAIN BATHROOM</i> - DELETE ITEM #34 IN B1A'S (RE: COUNTERTOP QUARTZ LEVEL 1 IN MAIN BATHROOM)	-\$668.00
35766		Note:	Each
104		1 - - ACNOWLEDGEMENT REGARDING THE STAIN FOR HANDRAIL, POSTS, NOSING AND HARDWOOD STAIRCASE HAS CHANGED FROM ORIGINAL SELECTION OF LAUZON RED OAK CELTIK TO SB 200 STAIN AS PER REVISION #1 COLOUR SHEETS DATED AUGUST 10, 2021.	\$ 0.00
35768		Note:	Each
106		1 - <i>ENSUITE BATH</i> - DELETE ITEM # 35 IN B1A'S (RE: COUNTERTOP QUARTZ LEVEL 1 IN 4 PCE ENSUITE BATHROOM WITH 2 SINKS)	-\$1,388.00
35767		Note:	Each
107		1 - - REVISION #1 TO COLOUR SHEET. NEW COLOUR SHEET DATED AUGUST 10, 2021	\$ 0.00
35704		Note:	Each

PREPARED BY: Nicole Trudel

LOCKED BY: Lisa Ballard

PE 1,662-4

InvoiceSQL.rpt 05may21

Vendor Initials: \_\_\_\_\_ Purchaser Initials: \_\_\_\_\_

CONSTRUCTION SCHEDULING APPROVAL

PER: \_\_\_\_\_

DATE: \_\_\_\_\_

NON STANDARD EXTRAS (680)			
Deerfield 2 - Phase 2			
PURCHASER: Portobello Partnership		Printed: 10-Aug-21 3:14 pm	
LOT NUMBER M69	PHASE 2	HOUSE TYPE 130 THE LEWIS	CLOSING DATE 16-Nov-21

ITEM	QTY	EXTRA / CHANGE	PRICE	INTERNAL USE
------	-----	----------------	-------	--------------

Sub Total	\$139.00
HST	\$0.00
Total	\$139.00

Payment Summary

<u>Paid By</u>	<u>Amount</u>
----------------	---------------

<u>Total Payment:</u>
-----------------------

PURCHASER: \_\_\_\_\_ 10-Aug-21  
Portobello Partnership DATE

VENDOR: \_\_\_\_\_  
PER: Valecraft Homes Limited

DATE: \_\_\_\_\_

CONSTRUCTION SCHEDULING APPROVAL	
PER:	_____
DATE:	_____

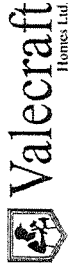

THE LEWIS

MODEL 130

2171 sq.ft. (452 sq.ft. Basement)

Site: DV2

Plan No.: 4M-1290

Lot: M69

Date: August 10, 2021

Purchaser: Portobello Partnership

Purchaser:

# Floor Plan Sketch

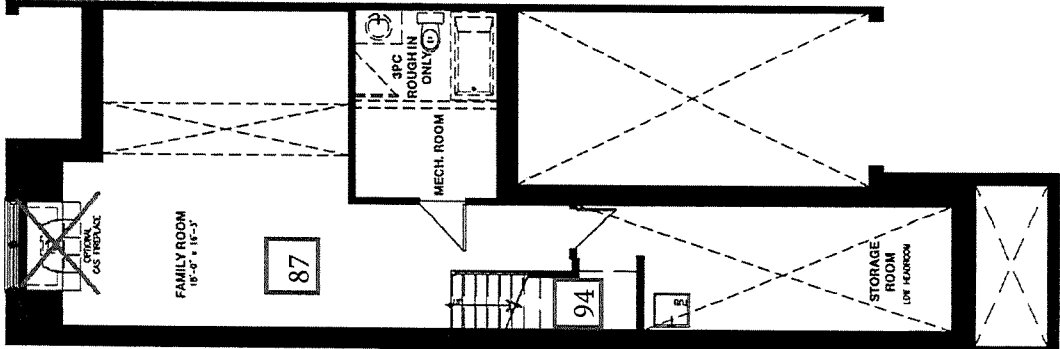

BASEMENT FLOOR

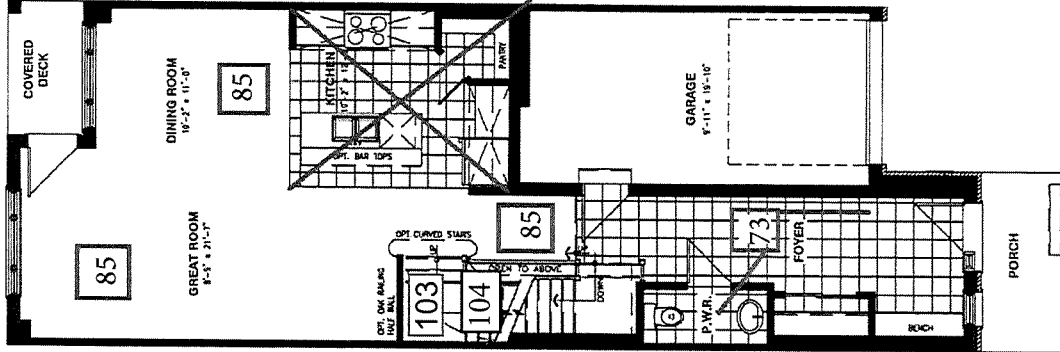

GROUND FLOOR

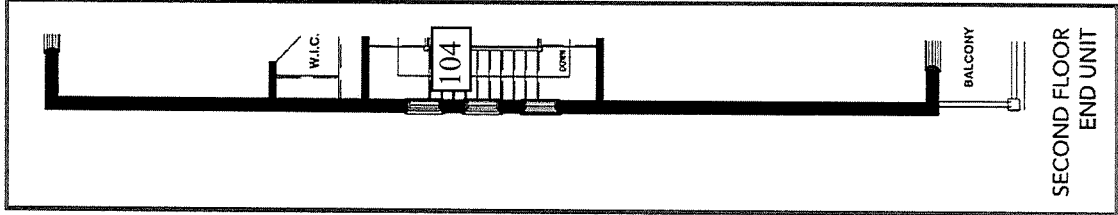

SECOND FLOOR  
END UNIT

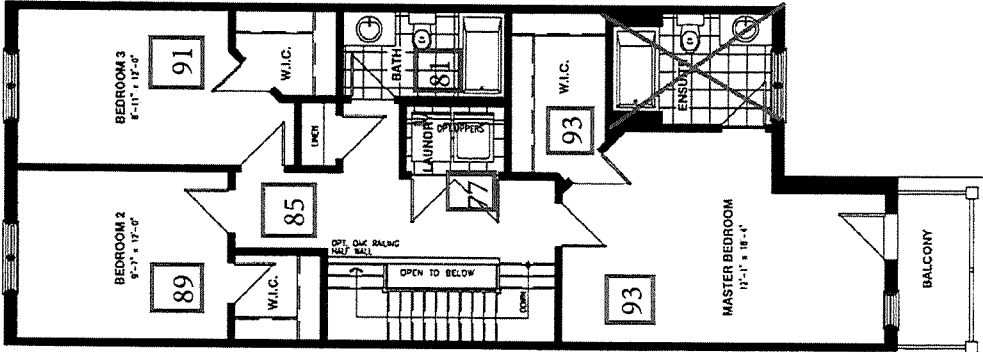

SECOND FLOOR

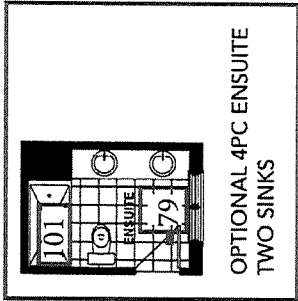

OPTIONAL 4PC ENSUITE  
TWO SINKS

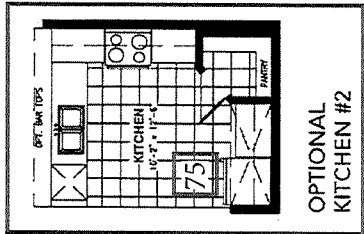

OPTIONAL  
KITCHEN #2

Vertical and/or horizontal bulkheads (chaseways) may be required to contain mechanical piping. All dimensions are approximate. E. & O.E., plans, materials and specifications are subject to change without notice. Actual useable floor space may vary from the stated floor area. \*Note: Number of steps varies due to site grading.

Schedule "W4"  
Granite & Variegated Quartz Colour Variation

Purchaser's name:	<u>Portobello Partnership</u>	Lot no:	<u>M69</u>	Plan #:	<u>4M-1290</u>
Purchaser's name:	<u>Contact: Samar Mehri</u>	Project:	<u>DEERFIELD VILLAGE 2</u>		
Home Phone:	<u></u>	Model:	<u>130 Lewis Rev. End Unit</u>		
Work Phone:	<u>613-837-2754</u>	Closing Date:	<u>November 16, 2021</u>		
E-Mail (1):	<u>design@valecraft.com</u>	E-Mail (2):	<u></u>		

Valecraft Homes Ltd. continues to provide the best in class sales and service. We recognize the importance of your home to you, our valued customer.

Granite & Variegated Quartz countertops are an elegant addition to your home. However, there are some things of which you should be aware.

Due to the natural composition of **Granite**, inherent variations in texture, colour and consistency are to be expected and considered as normal.

During the process of manufacturing **Variegated Quartz** to achieve a more natural stone look, variations in the appearance between the sample & the slab are to be expected.

Valecraft Homes Limited strongly suggests that you attend an appointment with our granite/quartz supplier two to three months prior to closing to view the granite/variegated quartz slabs available in the colour you have already chosen. A representative from our supplier will contact you to set up a mutual date & time for the appointment.

I/we, Portobello Partnership  
have read and fully understand the aforementioned recommendation set forth by the builder and as such hereby release VALECRAFT HOMES LIMITED from future responsibility with respect to a variation in colour of granite/ variegated quartz countertops.

<input checked="" type="checkbox"/>	We <u>accept</u> this opportunity
<input type="checkbox"/>	We <u>decline</u> this opportunity

Project:	<u>DEERFIELD VILLAGE 2</u>	LOT NO:	<u>M69</u>
Purchaser	<u></u>	Date:	<u></u>
Purchaser	<u></u>	Date:	<u></u>
<u>D. Brunet</u>	<u></u>	<u>August 10,2021</u>	<u></u>
Valecraft Homes Limited	<u></u>	Date:	<u></u>

Appointment date given:	<u></u>	Spoke with/left message:	<u></u>
Time scheduled:	<u></u>	Date & Time:	<u></u>



## Tile Installation Options

### FLOOR TILE

Standard square

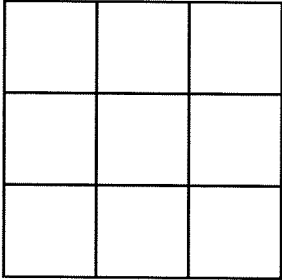

Square brick

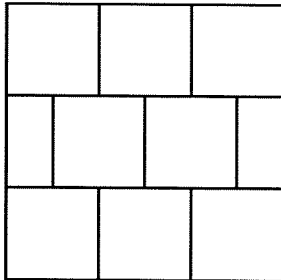

Rectangular  
front to back of the house

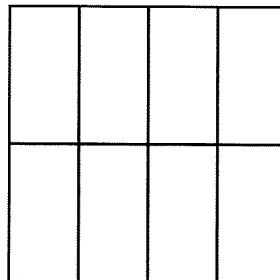

Rectangular  
side to side of the house

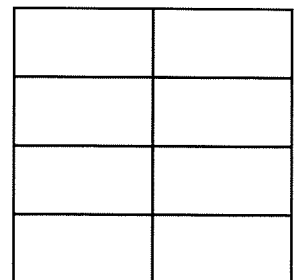

1/2 Brick  
front to back of the house

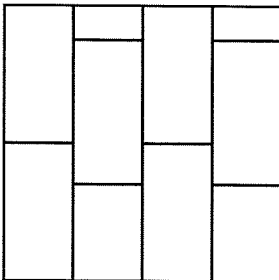

Foyer & Powder Room

Rectangular 1/3 staggered  
side to side of the house

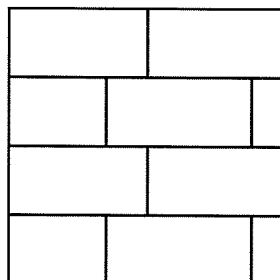

45 degree

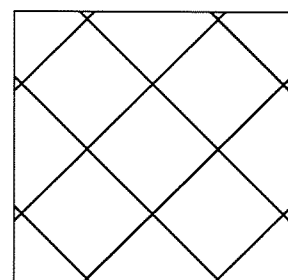

Project: Deerfield Village 2

Purchaser: Portobello Partnership

Plan #: 4M-1290

Purchaser: \_\_\_\_\_

Lot: M69

Date: August 10, 2021

Model: 130 Lewis Rev. End

Upgrade #: 73





Valecraft  
Homes Ltd.

## Roma Collection

All Models  
STANDARD

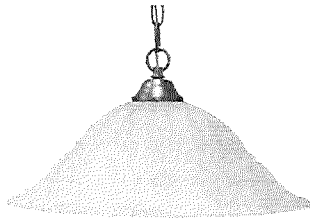

**BREAKFAST / DINETTE**  
A3016P-11  
Bulb: 1 x A19 LED Bulb

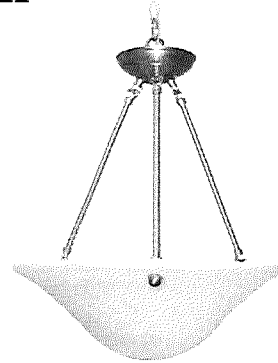

**DINING ROOM / STAIRWELL / HIGH CEILINGS**  
(Plan Permitting)  
A3016ch-11  
Bulbs: 3 x A19 LED Bulb

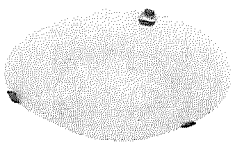

**ENTRY / HALL / LAUNDRY / BEDROOMS /  
DEN / STUDY / BATH CEILING / KITCHEN SINK /  
FINISHED BASEMENT AREAS**  
(Plan Permitting)  
A3012-11  
12" dia.  
Bulbs: 2 x A19 LED Bulb

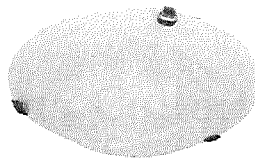

**KITCHEN / MASTER BEDROOM**  
(Plan Permitting)  
A3016-11  
16" dia.  
Bulbs: 3 x A19 LED Bulb

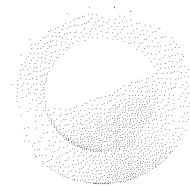

**BASEMENT STAIRS / SOFFIT**  
AFR4-0930-WH  
LED Recessed Light  
5" dia.

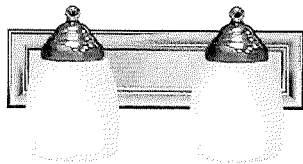

**POWDER ROOM VANITY**  
(Plan Permitting)  
A16012-7  
14" Wide  
Bulbs: 2 x A19 LED Bulb

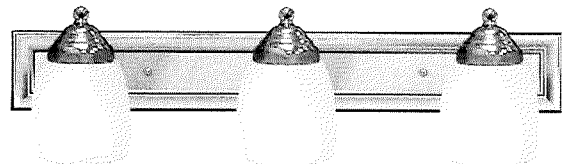

**BATHROOM VANITY**  
A16013-7  
24" Wide  
Bulbs: 3 x A19 LED Bulb

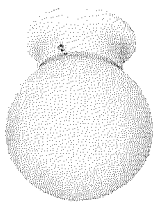

**CLOSET / PANTRY**  
A121-11  
Bulb: 1 x A19 LED Bulb



**FRONT EXTERIOR**  
(Plan Permitting)  
SAN-A1010-6  
Bulb: 1 x A19 LED Bulb

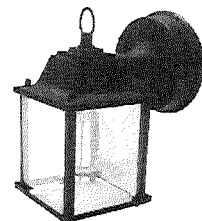

**BACK EXTERIOR**  
SAN-A40455-6  
Bulb: 1 x A19 LED Bulb

\* All dimensions are approximate.

\*\*\* Keyless LIGHT OUTLETS IN GARAGE, UNFINISHED BASEMENT AREAS\*\*\*

Project: DV2

Purchaser: Portobello Partnership

Plan #: 4M-1290

Purchaser: \_\_\_\_\_

Lot: M69

Date: August 10, 2021

Model: 130 The Lewis Rev. End

Upgrade #: Standard



## Standard Edge Profiles for Granite & Quartz

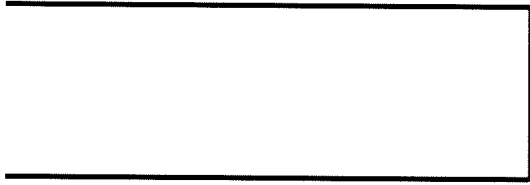

Eased Edge

Kitchen Granite #5, #8, #69

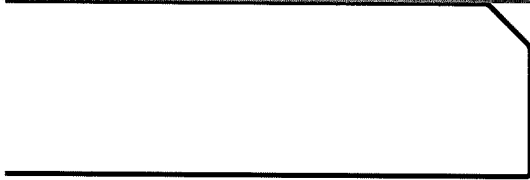

1/4 Bevel

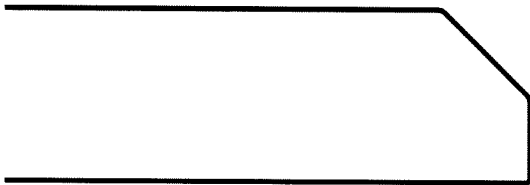

1/2 Bevel

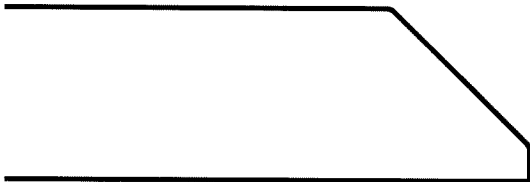

3/4 Bevel

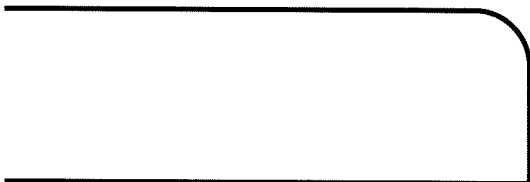

Pencil Top Only  
with Square Bottom

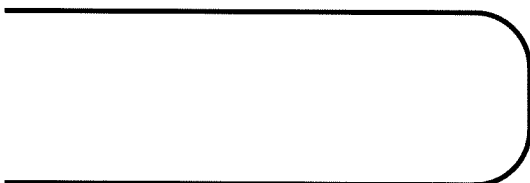

Pencil Top and Bottom

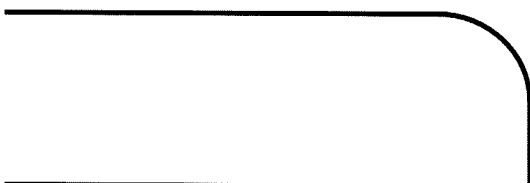

1/2 Bullnose



Full Bullnose

Project: DV2

Purchaser: Portobello Partnership

Plan #: 4M-1290

Purchaser: \_\_\_\_\_

Lot: M69

Date: Aug 10, 2021

Model: 130 The Lewis Rev. End

Upgrade #: 8, 68, 69

 <b>Valecraft</b> Homes Ltd.	<b>SINGLES AND TOWNS COLOUR CHART- REVISION 1</b>					
	Community:	Deerfield Village 2	Reg'd Plan #:	4M-1290	Sales Rep:	N. Trudel
	Lot No:	M69	Civic Address:	648 Tranquil Stream Private		
	Purchaser(s):	Portobello Partnership			Model Name/#:	130 Lewis Rev. End.
	Purchaser(s):				Closing Date:	16 November, 2021

INTERIOR FINISHES		
DESCRIPTION		STD/UPG #
TRIM STYLE		
DOOR STYLE		
INTERIOR HARDWARE		
INTERIOR LIGHTING PACKAGE	Standard Roma Light Package + False Bottom with Under Cabinet LED Puck Lights on Upper Kitchen Cabinets	STD, 15, 25
BATHROOM ACCESSORIES		
FIREPLACE MANTLE		

INTERIOR HANDRAILS AND SPINDLES				
	WOOD	STYLE	STAIN/COLOUR	STD/UPG #
HANDRAIL	Red Oak	Contemporary	SB 200	9, 10, 11, 85, 104
BRACKET (if applicable)				
SPINDLES				
POSTS	Red Oak	3-1/2" wide Modern Beveled	SB 200	9, 10, 11, 85, 104
NOSINGS	Red Oak	N/A	SB 200	10, 11, 85, 104
HARDWOOD STAIRCASE <i>(WHERE APPLICABLE)</i>	Red Oak	N/A	SB 200	12, 26, 85, 103, 104

APPLIANCES				
TYPE	SIZE	STD/UPG #	APPLIANCE UPG LEVEL	STD/UPG #
FRIDGE <i>(Standard Minimum Opening is 33" x 70.75")</i>	Standard Opening	STD	Basic Stainless Steel	60
RANGE	Standard Opening	STD	Basic Stainless Steel	60
DISHWASHER	Standard Opening	STD	Basic Stainless Steel	60
CHIMNEY HOODFAN				
WASHING MACHINE/DRYER	Standard Opening	STD	Basic White	60

Purchaser's Signature(s) :

Date:

Purchaser's Signature(s) :

Date:

Approved By :

Date:

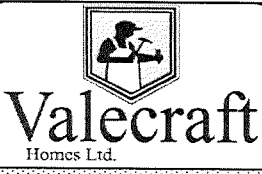
	SINGLES AND TOWNS COLOUR CHART- REVISION 1					
	Community:	Deerfield Village 2	Reg'd Plan #:	4M-1290	Sales Rep:	N. Trudel
	Lot No:	M69	Civic Address:	648 Tranquil Stream Private		
	Purchaser(s):	Portobello Partnership			Model Name/#:	130 Lewis Rev. End.
	Purchaser(s):				Closing Date:	16 November, 2021

CABINETRY						
ROOM	SELECTION			LEVEL	STD/UPG #	
KITCHEN	STYLE AND COLOUR					
	HARDWARE CODE		TYPE			
	COUNTERTOP	New Caledonia (Slab Viewing Required)	COUNTERTOP EDGE PROFILE	Eased Edge	Level 1 Granite	5, 8, 69
MAIN BATHROOM	STYLE AND COLOUR					
	HARDWARE CODE		TYPE			
	COUNTERTOP	P394-VL	COUNTERTOP EDGE PROFILE	Standard	STD Laminate	STD
4PC ENSUITE BATHROOM C/W 2 Sinks	STYLE AND COLOUR					
	HARDWARE CODE		TYPE			
	COUNTERTOP	P394-VL	COUNTERTOP EDGE PROFILE	Standard	STD Laminate	STD
POWDER ROOM	STYLE AND COLOUR					
	HARDWARE CODE		TYPE			
	COUNTERTOP		COUNTERTOP EDGE PROFILE			
BASEMENT/OTHER BATHROOM	STYLE AND COLOUR					
	HARDWARE CODE		TYPE			
	COUNTERTOP		COUNTERTOP EDGE PROFILE			
LAUNDRY ROOM	STYLE AND COLOUR					
	HARDWARE CODE		TYPE			
	COUNTERTOP		COUNTERTOP EDGE PROFILE			

Purchaser's Signature(s) :	_____	Date: _____
Purchaser's Signature(s) :	_____	Date: _____
Approved By :	_____	Date: _____

	SINGLES AND TOWNS COLOUR CHART- REVISION 1					
	Community:	Deerfield Village 2	Reg'd Plan #:	4M-1290	Sales Rep:	N. Trudel
	Lot No:	M69	Civic Address:	648 Tranquil Stream Private		
	Purchaser(s):	Portobello Partnership			Model Name/#:	130 Lewis Rev. End.
	Purchaser(s):				Closing Date:	16 November, 2021
PAINT COLOUR(S)						
ROOM	MAIN COLOUR		STD/UPG #	ACCENT WALL		STD/UPG #
TRIM						
FOYER	Low Lustre OC-30 Gray Mist		STD			
POWDER ROOM	Semi Gloss OC-30 Gray Mist		STD			
MAIN FLOOR HALLWAY	Low Lustre OC-30 Gray Mist		STD			
DINING ROOM	Low Lustre OC-30 Gray Mist		STD			
FLEX ROOM						
GREAT ROOM	Low Lustre OC-30 Gray Mist		STD			
FAMILY ROOM	Low Lustre OC-30 Gray Mist		STD			
DEN/STUDY/HOME OFFICE						
KITCHEN	Semi Gloss OC-30 Gray Mist		STD			
LAUNDRY CLOSET	Low Lustre OC-30 Gray Mist		STD			
2nd FLOOR HALLWAY	Low Lustre OC-30 Gray Mist		STD			
MAIN BATH	Semi Gloss OC-30 Gray Mist		STD			
BEDROOM #2	Low Lustre OC-30 Gray Mist		STD			
BEDROOM #3	Low Lustre OC-30 Gray Mist		STD			
BASEMENT BEDROOM						
MASTER BEDROOM	Low Lustre OC-30 Gray Mist		STD			
MASTER BEDROOM WALK-IN CLOSET	Low Lustre OC-30 Gray Mist		STD			
MASTER BEDROOM ENSUITE	Semi Gloss OC-30 Gray Mist		STD			
FINISHED BASEMENT RECREATION ROOM						
BASEMENT BATHROOM						

Purchaser's Signature(s) : \_\_\_\_\_

Date: \_\_\_\_\_

Purchaser's Signature(s) : \_\_\_\_\_

Date: \_\_\_\_\_

Approved By : \_\_\_\_\_

Date: \_\_\_\_\_

	SINGLES AND TOWNS COLOUR CHART- REVISION 1					
	Community:	Deerfield Village 2	Reg'd Plan #:	4M-1290	Sales Rep:	N. Trudel
	Lot No:	M69	Civic Address:	648 Tranquil Stream Private		
	Purchaser(s):	Portobello Partnership			Model Name/#:	130 Lewis Rev. End.
	Purchaser(s):				Closing Date:	16 November, 2021
CERAMIC & GROUT SELECTIONS (1)						
ROOM	AREA	MANUFACTURER/SERIES/SIZE/ COLOUR/CODE		GROUT SELECTION	LEVEL	STD/UPG #
FOYER	FLOOR	Torlys Evertile Premier ET24001 Cliff Island 11-1/2" Wide x 23-5/8" Long (Front to Back 1/2 Brick Install)		N/A	Quote	73
POWDER ROOM	FLOOR	Torlys Evertile Premier ET24001 Cliff Island 11-1/2" Wide x 23-5/8" Long (Front to Back 1/2 Brick Install)		N/A	Quote	73
	WALL					
	INSERT OR BORDER					
MUDROOM	FLOOR					
	WALL					
	INSERT OR BORDER					
LAUNDRY CLOSET	FLOOR	Torlys Everwood Premier EW-23001 Beach House 4-7/8" Wide x 48-3/8" Long plank (Front to Back Install)		N/A	Quote	77
	WALL					
	INSERT OR BORDER					
KITCHEN	FLOOR	Torlys Everwood Premier EW-23001 Beach House 4-7/8" Wide x 48-3/8" Long plank (Front to Back Install)		N/A	Quote	75
	BACKSPLASH					
	INSERT OR BORDER					
BREAKFAST AREA/DINETTE	FLOOR					
FIREPLACE	HEARTH					
	SURROUND					
ADDITIONAL FIREPLACE	HEARTH					
	SURROUND					

Purchaser's Signature(s) :

Purchaser's Signature(s) :

Approved By :

	SINGLES AND TOWNS COLOUR CHART- REVISION 1					
	Community:	Deerfield Village 2	Reg'd Plan #:	4M-1290	Sales Rep:	N. Trudel
	Lot No:	M69	Civic Address:	648 Tranquil Stream Private		
	Purchaser(s):	Portobello Partnership			Model Name/#:	130 Lewis Rev. End.
	Purchaser(s):				Closing Date:	16 November, 2021
CERAMIC & GROUT SELECTIONS (2)						
ROOM	AREA	MANUFACTURER/SERIES/SIZE/ COLOUR/CODE		GROUT SELECTION	LEVEL	STD/UPG #
MAIN BATHROOM	FLOOR	Torlys Everwood Premier EW-23001 Beach House 4-7/8" Wide x 48-3/8" Long plank (Front to Back Install)		N/A	Quote	81
	WALL/TUB SURROUND					
	INSERT OR BORDER					
3PC ENSUITE BATHROOM	FLOOR					
	WALL/TUB SURROUND					
	INSERT OR BORDER					
4PC ENSUITE BATHROOM C/W 2 Sinks	FLOOR	Torlys Everwood Premier EW-23001 Beach House 4-7/8" Wide x 48-3/8" Long plank (Front to Back Install)		N/A	Quote	4, 79
	TUB DECK					
	TUB BACKSPLASH					
	INSERT OR BORDER					
	SHOWER WALL					
BASEMENT/OTHER BATHROOM	FLOOR					
	WALL/TUB SURROUND					
	INSERT OR BORDER					

Purchaser's Signature(s) :

Purchaser's Signature(s) :

Approved By :

 <div>Valecraft</div> <div>Homes Ltd.</div>	SINGLES AND TOWNS COLOUR CHART- REVISION 1					
	Community:	Deerfield Village 2	Reg'd Plan #:	4M-1290	Sales Rep:	N. Trudel
	Lot No:	M69	Civic Address:	648 Tranquil Stream Private		
	Purchaser(s):	Portobello Partnership			Model Name/#:	130 Lewis Rev. End.
	Purchaser(s):				Closing Date:	16 November, 2021
FLOORING SELECTIONS						
ROOM	CARPET/UNDERPAD OR HARDWOOD			LEVEL	STD/UPG #	
MAIN FLOOR HALLWAY	Torlys Everwood Premier EW-23001 Beach House 4-7/8" Wide x 48-3/8" Long plank (Front to Back Install)			Quote	85	
DINING ROOM	Torlys Everwood Premier EW-23001 Beach House 4-7/8" Wide x 48-3/8" Long plank (Front to Back Install)			Quote	85	
FLEX ROOM						
FAMILY ROOM	Torlys Everwood Premier EW-23001 Beach House 4-7/8" Wide x 48-3/8" Long plank (Front to Back Install)			Quote	87	
GREAT ROOM	Torlys Everwood Premier EW-23001 Beach House 4-7/8" Wide x 48-3/8" Long plank (Front to Back Install)			Quote	85	
DEN/HOME OFFICE						
UPPER HALLWAY	Torlys Everwood Premier EW-23001 Beach House 4-7/8" Wide x 48-3/8" Long plank (Front to Back Install)			Quote	85	
KITCHEN	See Ceramic & Grout Sheet			N/A	N/A	
BREAKFAST AREA/DINETTE						
MAIN STAIRS TO BEDROOMS	Red Oak SB 200 with Lauzon Essential Tradition Matte 4-1/8" Red Oak Smoky Grey on Landings			UPG	12, 26	
MAIN FLOOR HALLWAY						
BEDROOM # 2	Torlys Everwood Premier EW-23001 Beach House 4-7/8" Wide x 48-3/8" Long plank (Front to Back Install)			Quote	89	
BEDROOM # 3	Torlys Everwood Premier EW-23001 Beach House 4-7/8" Wide x 48-3/8" Long plank (Front to Back Install)			Quote	91	
BEDROOM # 4						
MASTER BEDROOM	Torlys Everwood Premier EW-23001 Beach House 4-7/8" Wide x 48-3/8" Long plank (Front to Back Install)			Quote	93	
MASTER BEDROOM WALK-IN CLOSET	Torlys Everwood Premier EW-23001 Beach House 4-7/8" Wide x 48-3/8" Long plank (Front to Back Install)			Quote	93	
STAIRS TO BASEMENT	Beaulieu Silex II Broadloom Carpet Pampa Beige 16320 + Upgraded Underpad			Quote Carpet + L1 Underpad	49, 94	
FINISHED BASEMENT BEDROOM ROOM						

Purchaser's Signature(s) : \_\_\_\_\_

Purchaser's Signature(s) : \_\_\_\_\_

Approved By : \_\_\_\_\_

Date: \_\_\_\_\_

Date: \_\_\_\_\_

Date: \_\_\_\_\_



 <b>Valecraft</b> Homes Ltd.	SINGLES AND TOWNS COLOUR CHART- REVISION 1					
	Community:	Deerfield Village 2	Reg'd Plan #:	4M-1290	Sales Rep:	N. Trudel
	Lot No:	M69	Civic Address:	648 Tranquil Stream Private		
	Purchaser(s):	Portobello Partnership			Model Name/#:	130 Lewis Rev. End.
	Purchaser(s):				Closing Date:	16 November, 2021
PLUMBING FIXTURES						
ROOM	FIXTURE	STYLE		FINISH	STD/UPG#	
KITCHEN	SINK	Reginox Kitchen Sink Undermount Double Bowl ND1831UA/9		Stainless Steel	62	
	FAUCET	Delta Marley Kitchen Faucet Single Handle Pull-Down 986LF-AR		Arctic Stainless	64	
MAIN BATHROOM	SINK	Standard		White	STD	
	VANITY FAUCET	Standard		Chrome	STD	
	WATER CLOSET					
	TUB/SHOWER					
	TUB/SHOWER FAUCET					
4PCE ENSUITE BATHROOM C/W 2 Sinks	SINKS	Standard		White	4	
	VANITY FAUCETS	Standard		Chrome	4	
	WATER CLOSET					
	SHOWER	Standard w/ Upgraded Zitta Niche 12 x 12		Stainless Steel	4, 101	
	SHOWER FAUCET	Standard		Chrome	4	
	BATHTUB					
	BATHTUB FAUCET					
POWDER ROOM	PEDESTAL	Standard		White	STD	
	SINK FAUCET	Standard		Chrome	STD	
	WATER CLOSET					
BASEMENT/OTHER BATHROOM	SINK					
	VANITY FAUCET					
	WATER CLOSET					
	SHOWER					
	SHOWER FAUCET					
NOTE: All fixtures are white as standard						

Purchaser's Signature(s) : \_\_\_\_\_

Purchaser's Signature(s) : \_\_\_\_\_

Approved By : \_\_\_\_\_

Date: \_\_\_\_\_

Date: \_\_\_\_\_

Date: \_\_\_\_\_