

**AMENDMENT TO AGREEMENT OF PURCHASE AND SALE
BETWEEN THE UNDERSIGNED PARTIES HERETO SIGNED
ON THE 18th DAY OF April, 2021.**

REGARDING PROPERTY KNOWN AS: BUILDER'S LOT : N75
LOT: N75 BLOCK :
4M-1290 DEERFIELD VILLAGE 2
CIVIC ADDRESS: 636 Tranquil Stream Private

PURCHASERS: Kristina Desiree Malt & Kiana Maria Malt

VENDORS: VALECRAFT HOMES LIMITED

DATE OF ACCEPTANCE: April 22nd, 2021

It is hereby understood and agreed between the undersigned parties hereto that the following changes shall be made to the above mentioned Agreement of Purchase and Sale and except for such changes noted below all other terms and conditions in the Agreement shall remain as stated therein and time shall remain of the essence.

DELETE: PURCHASE PRICE: \$484,846.61
BALANCE AT CLOSING: \$469,846.61
LESS H.S.T. AMOUNT: \$450,306.73
SCHEDULE "G" DATED: April 18th, 2021
TARION SCHEDULE "B" DATED: April 18th, 2021
SCHEDULE "W-4" DATED: April 18th, 2021

INSERT: 680 dated: May 30th, 2021 in the amount of: \$8,599.00
NEW PURCHASE PRICE: \$493,445.61
NEW BALANCE AT CLOSING: \$478,445.61
NEW LESS H.S.T. AMOUNT: \$457,916.47
SCHEDULE "G" DATED: May 30th, 2021
TARION SCHEDULE "B" DATED: May 30th, 2021
SCHEDULE "W-4" DATED: May 30th, 2021

Dated at Ottawa this 30th day of May, 2021

In the presence of:

WITNESS

PURCHASER

WITNESS

PURCHASER

Dated at Ottawa this 3rd day of June, 2021

VALECRAFT HOMES LIMITED (VENDOR)

PER: 

NON STANDARD EXTRAS (680)			
Deerfield 2 - Phase 2			
PURCHASERS: Kristina Desiree Malt and Kiana Maria Malt			Printed: 30-May-21 2:25 pm
LOT NUMBER N75	PHASE 2	HOUSE TYPE 130 THE LEWIS	CLOSING DATE 12-Jan-22

ITEM	QTY	EXTRA / CHANGE	PRICE	INTERNAL USE
32		1 - BEDROOM 2 - DELETE ITEM #16 IN B1A'S RE: UPGRADE UNDERPAD LEVEL 1 IN BEDROOM 2.	-\$133.00	Each
33795		Note:		
33		1 - BEDROOM 3 - DELETE ITEM #17 IN B1A'S RE: UPGRADE UNDERPAD LEVEL 1 IN BEDROOM 3.	-\$160.00	Each
33796		Note:		
34		1 - MASTER BEDROOM - DELETE ITEM #18 IN B1A'S RE: UPGRADE UNDERPAD LEVEL 1 IN MASTER BEDROOM WITH W.I.C..	-\$213.00	Each
33797		Note:		
35		1 - KITCHEN - DELETE ITEM #21 IN B1A'S RE: UPGRADE TILE WALL BACKSPLASH TO SILVER SERIES.	-\$147.00	Each
33798		Note:		
36	127	1 - KITCHEN - TILE - WALL - BACKSPLASH - UPGRADE - BRONZE - - KITCHEN - BRONZE	\$ 84.00	Each
33804		Note: See item #37.		
37		1 - KITCHEN - HORIZONTAL 1/3 OFFSET BRICK INSTALLATION ONLY FOR KITCHEN BACKSPLASH IN STANDARD KITCHEN LAYOUT AND STANDARD AREA.	\$ 63.00	Each
33806		Note: As per wall tile installation sketch dated May 30th, 2021. See item #36.		
38		1 - ENSUITE BATH - DELETE ITEM #22 IN B1A'S RE: COUNTERTOP - GRANITE - LEVEL 1 - ENSUITE BATHROOM - OPT 4PC WITH 2 SINKS.	-\$1,428.00	Each
33799		Note:		
*39	89290	1 - ENSUITE BATH - COUNTERTOP - QUARTZ - LEVEL 1 - ENSUITE BATHROOM - OPT 4PC - 2 SINKS	*\$ 1,460.00	Each
33808		Note: Eased edge detail, as per countertop edge profile sketch dated May 30th, 2021. See items #54 & #55 for sink and faucet.		
40		1 - MAIN BATHROOM - DELETE ITEM #31 IN B1A'S RE: UPGRADE SILVER FLOOR TILE IN MAIN BATHROOM.	-\$250.00	Each
33800		Note:		
41	87972	1 - KITCHEN - OTR - BASIC - 1.7 C/F MICROWAVE WITH HOOD - STAINLESS	\$ 75.00	Each
33809		Note:		
*42	89116	1 - KITCHEN - CABINETRY - UPGRADE KITCHEN CABINETRY TO LEVEL 1	*\$ 2,483.00	Each
33810		Note: Standard kitchen layout, including extended pantry towards dining room, approximately 24" in length.		
43		1 - KITCHEN - SUPPLY AND INSTALL UPGRADED CABINETRY HARDWARE POI-R20004-160-NM IN KITCHEN.	\$ 580.00	Each
33811		Note: Standard kitchen layout, including extended pantry <i>Cabinetry</i> towards dining room, approximately 24" in length. <i>See items 7 & 245.</i>	<i>\$600.00</i>	<i>Each</i>

NON STANDARD EXTRAS (680)			
Deerfield 2 - Phase 2			
PURCHASERS: Kristina Desiree Malt and Kiana Maria Malt			Printed: 30-May-21 2:25 pm
LOT NUMBER	PHASE	HOUSE TYPE	CLOSING DATE
N75	2	130 THE LEWIS	12-Jan-22
ITEM	QTY	EXTRA / CHANGE	PRICE
44		1 - ENSUITE BATH - SUPPLY AND INSTALL UPGRADED CABINETRY HARDWARE POI-R20004-160-NM IN 4 PCE ENSUITE WITH 2 SINKS. <i>incl Bank of Drawers - \$160.00</i>	\$ 80.00
33812	Note:	<i>See Items 5 and 15</i>	Each
*45		1 - KITCHEN - LOWER CABINETS - LC POTS & PANS C/W 3 DRAWER FRONTS 6/12/12	* \$ 704.00
87999			Each
33813	Note:	To be located beside refrigerator, in standard kitchen layout, as per floor plan sketch dated May 30th, 2021.	
46		1 - ENSUITE BATH - TILE - WALL - UPGRADE - FLOOR TILE IN LIEU OF WALL - BRONZE -- APPROXIMATELY 5 FOOT x 3 FOOT CERAMIC SHOWER - BRONZE	\$ 745.00
137			Each
33814	Note:	In 4 pce ensuite with 2 sinks shower.	
47		1 - BEDROOM 2 - CARPET - UPGRADE - LEVEL 3 -- BEDROOM 2 - LEVEL 3	\$ 361.00
104			Each
33815	Note:	As per floor plan sketch dated May 30th, 2021.	
48		1 - BEDROOM 3 - CARPET - UPGRADE - LEVEL 3 -- BEDROOM 3 - LEVEL 3	\$ 434.00
104			Each
33816	Note:	As per floor plan sketch dated May 30th, 2021.	
49		1 - MASTER BEDROOM - CARPET - UPGRADE - LEVEL 3 -- MASTER BEDROOM / WIC OPT ENSUITE - LEVEL 3	\$ 578.00
104			Each
33817	Note:	As per floor plan sketch dated May 30th, 2021.	
50		1 - BASEMENT - CARPET - UPGRADE - LEVEL 3 -- FAMILY ROOM - LEVEL 3	\$ 903.00
104			Each
33818	Note:	As per floor plan sketch dated May 30th, 2021.	
51		1 - BASEMENT - CARPET - UPGRADE - LEVEL 3 -- BASEMENT STAIRCASE - LEVEL 3	\$ 217.00
104			Each
33819	Note:	As per floor plan sketch dated May 30th, 2021.	
52		1 - KITCHEN - KITCHEN SINK - REGINOX ND1831UA/9 DOUBLE BOWL UNDERMOUNT SINK	\$ 143.00
88544			Each
34276	Note:	Only available with Solid Surface Countertops. See item #29.	
53		1 - KITCHEN - KITCHEN FAUCET - DELTA ESSA 9113 - BL - DST MATTE BLACK SINGLE HANDLE PULL-DOWN	\$ 494.00
88472			Each
34278	Note:	See item #29.	
54		2 - ENSUITE BATH - BATHROOM SINK - AMERICAN STANDARD OVALYN UNDERMOUNT 0495 - 221	\$ 362.00
88462			
34280	Note:	Only available with Solid Surface Countertops. See item #39.	
*55		2 - ENSUITE BATH - BATHROOMS - DELTA TRINSIC SINGLE HANDLE HIGH - ARC LAVATORY FAUCET 559HA - DST	* \$ 592.00
88217			
34282	Note:	See item #39.	

NON STANDARD EXTRAS (680)
Deerfield 2 - Phase 2

PURCHASERS: Kristina Desiree Malt and Kiana Maria Malt

Printed: 30-May-21 3:57 pm

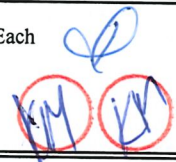
LOT NUMBER	PHASE	HOUSE TYPE	CLOSING DATE	
N75	2	130 THE LEWIS	12-Jan-22	
ITEM QTY EXTRA / CHANGE			PRICE	INTERNAL USE
*56 88217	1 - POWDER ROOM - BATHROOMS - DELTA TRINSIC SINGLE HANDLE HIGH - ARC LAVATORY FAUCET 559HA - DST		*\$ 296.00	Each
34284	Note:			
57 34381	1 - FOYER - DELETE ITEM #57 - CLARIFICATION TO ITEM 58: Standard Hardwood Areas include the Great Room, w/c Dining Room, and Upper Hallway only.			Each 
58 33826	1 - KITCHEN - DELETE ITEM #14 IN B1A'S RE: UPC9-2B INCLUDES UPGRADE TO 42" UPPERS W/FILLER DETAIL ON UPPER KITCHEN CABINETRY TO UPGRADED BULKHEAD IN BUILDER'S STD CABINETRY & EXTEND APPROX. 2'-0" TOWARDS DINING ROOM ABOVE ADDITIONAL CABINETS.			
59 33827	1 - KITCHEN - UPC9-2B INCLUDES UPGRADE TO 42" UPPERS W/FILLER DETAIL ON UPPER KITCHEN CABINETRY TO UPGRADED BULKHEAD IN LEVEL 1 CABINETRY AND EXTEND APPROX. 2'-0" TOWARDS DINING ROOM ABOVE ADDITIONAL CABINETS. Note: As per UPC Sketch dated May 30th, 2021.		\$ 731.00	Each

Sub Total	\$8,499.00
HST	\$0.00
Total	\$8,499.00

Payment Summary

Paid By	Amount
Total Payment:	

PURCHASER:

X Kristina Malt
Kristina Desiree Malt

30-May-21
DATE

VENDOR:

T. Det
PER: Valecraft Homes Limited

PURCHASER:

X Kiana Malt
Kiana Maria Malt

30-May-21
DATE

DATE:

June 3, 2021

PREPARED BY: Nicole Trudel
LOCKED BY:
PE 1,564-3
InvoiceSQL.rpt 16May20

CONSTRUCTION SCHEDULING APPROVAL
PER: _____
DATE: _____

SCHEDULE "G"**HARMONIZED SALES TAX AND NEW HOUSING REBATE**

1. The parties acknowledge that as at the date of this Agreement, Harmonized Sales Tax ("HST") is applicable to this transaction pursuant to the Excise Tax Act (Canada) (the "**Legislation**") and that, the Purchaser may qualify for the GST/HST new housing rebate (as is authorized by the Legislation from time to time) (the "**New Housing Rebate**") in respect of this transaction.
2. The Purchaser is hereby advised that the Purchase Price listed in "Purchase Price" Section of this Agreement includes all HST and the New Housing Rebate applicable to this transaction (refer to maximum rebate allowance in Clause 8) as at the date this Agreement is signed by the parties. All sales taxes applicable to the transaction (including any applicable New Housing Rebate) will be calculated as of the closing of the subject transaction and will be applied in accordance with the Legislation. In the event that there is a change to the Legislation after the execution of this Agreement but prior to the closing of this transaction, the Vendor shall make all applicable adjustments to the sales taxes payable in this transaction in accordance with all applicable Legislation.
3. The Purchaser hereby irrevocably assigns to the Vendor the benefit of the New Housing Rebate, if applicable to this transaction.
4. The Purchaser hereby warrants and agrees that:
 - (a) The Real Property is being purchased as the Purchaser's primary place of residence and that the Purchaser will take possession and occupy the Dwelling forthwith upon closing and will not allow occupancy of the Dwelling by any other individual (other than the Purchaser's immediate family) as a place of residence prior to occupancy by the Purchaser;
 - (b) Purchaser will execute and deliver on closing such documents as the Vendor may require to confirm the warranties and agreements contained in this Schedule; and
 - (c) Purchaser will submit to the Vendor on closing, prior to or after closing at the Vendor's request, an application or applications in the manner and in the form prescribed containing prescribed information required by the Legislation for the New Housing Rebate
5. The Purchaser acknowledges that the Vendor has calculated the Purchase Price on the assumption that the New Housing Rebate will be applicable to this transaction. If for any reason the Purchaser does not qualify for the New Housing Rebate, then the Purchaser shall be fully responsible for paying to the Vendor the amount of such New Housing Rebate plus interest at the Bank of Montreal prime rate from the date the statement of adjustments is calculated plus any fees, penalties or damages imposed on the Vendor under the Legislation. For greater certainty, the Purchaser acknowledges that the New Housing Rebate described above is for individuals buying a new house or residential condominium as a primary place of residence for themselves or a relation. It does not include the rebate for HST which may be available to investors buying a new house or residential condominium as a rental property (the GST/HST "**New Residential Rental Property Rebate**"). If the Property is being purchased for investment purposes, the Purchaser will not qualify for the New Housing Rebate and the Purchaser shall be responsible for paying to the Vendor an amount equal to the New Housing Rebate which has been included in the Purchase Price hereunder. All Purchasers buying a new house or residential condominium as a rental property are responsible for applying for the New Residential Rental Property Rebate after the closing of the subject transaction.

 Purchaser

 Purchaser

 Vendor

6. The Purchaser acknowledges and agrees that the Purchase Price set forth in this Agreement has been arrived at on the basis that the Purchase Price includes all Extras, premiums and bonuses and excludes any Extras ordered pursuant to a Change Order following the date of execution of this Agreement. The Purchaser acknowledges that the purchase of additional Extras following the date of execution of this Agreement may push the Purchase Price of the Real Property into a different sales tax category for the purposes of determining the amount of the New Housing Rebate, and that this may lower the amount of said New Housing Rebate applicable to the transaction. If a reduced New Housing Rebate is applicable under the Legislation due to the purchase of Extras following the date of execution of this Agreement, the Purchaser agrees to compensate the Vendor for the, amount by which the New Housing Rebate used to calculate the Purchase Price listed in the "Purchase Price" section herein exceeds the actual applicable New Housing Rebate, such amount to be credited to the Vendor as an adjustment on closing.
7. The Parties acknowledge that for purposes of Land Transfer Tax, the total consideration to be inserted in the Transfer/Deed of Land for this transaction shall be the total Purchase Price including Extras excluding HST and the New Housing Rebate, namely the amount of ~~\$457,916.47~~ \$457,827.97. The Purchaser is responsible for payment in full of the Land Transfer Tax and the cost of registration of the transfer.
8. The Purchaser agrees to execute all further documents required by the Vendor after closing to give effect to this Schedule.

Signed at Ottawa this 30th day of May, 2021

X Kunal
PURCHASER

VALECRAFT HOMES LIMITED

X Kunal
PURCHASER

PER: [Signature]

DATE: June 3, 2021

PROJECT: DEERFIELD VILLAGE 2 LOT: N75

Schedule "W4"
Granite & Variegated Quartz Colour Variation

Purchaser's name: Kristina Desiree Malt Lot no: N75 Plan #: 4M-1290
Purchaser's name: Kiana Maria Malt Project: DEERFIELD VILLAGE 2
Home Phone: N/A Model: 130 Lewis Rev. End Unit
Work Phone: 613-996-3071 Closing Date: January 12th, 2022
E-Mail (1): kristinamalt@hotmail.com E-Mail (2): kianamalt@hotmail.com

Valecraft Homes Limited continues to provide the best in class sales and service. We recognize the importance of your home to you, our valued customer.

Granite & Variegated Quartz countertops are an elegant addition to your home. However, there are some things of which you should be aware.

Due to the natural composition of **Granite**, inherent variations in texture, colour and consistency are to be expected and considered as normal.

During the process of manufacturing **Variegated Quartz** to achieve a more natural stone look, variations in the appearance between the sample & the slab are to be expected.

Valecraft Homes Limited strongly suggests that you attend an appointment with our granite/quartz supplier two to three months prior to closing to view the granite/variegated quartz slabs available in the colour you have already chosen. A representative from our supplier will contact you to set up a mutual date & time for the appointment.

I/we, Kristina Desiree Malt & Kiana Maria Malt
have read and fully understand the aforementioned recommendation set forth by the builder and as such hereby release VALECRAFT HOMES LIMITED from future responsibility with respect to a variation in colour of granite/ variegated quartz countertops.

☒ We accept this opportunity

☐ We decline this opportunity

Project: DEERFIELD VILLAGE 2 LOT NO: N75

X Kristina Malt
Purchaser

X Kiana Malt
Purchaser

[Signature]
Valecraft Homes Limited

May 30th, 2021

Date:

May 30th, 2021

Date:

June 3, 2021
Date:

Appointment date given: _____ Spoke with/left message: _____

Time scheduled: _____ Date & Time: _____

SCHEDULE B

Adjustments to Purchase Price or Balance Due on Closing

PART I Stipulated Amounts/Adjustments

These are additional charges, fees or other anticipated adjustments to the final purchase price or balance due on Closing, the dollar value of which is stipulated in the Purchase Agreement and set out below.

1. Preparation of transfer fee by Builder's solicitor as stated in Clause #17 of the Agreement of Purchase & Sale. **\$225.00 + HST= \$254.25**

Part II All Other Adjustments – to be determined in accordance with the terms of the Purchase Agreement

These are additional charges, fees or other anticipated adjustments to the final purchase price or balance due on Closing, which will be determined after signing the Purchase Agreement, all in accordance with the terms of the Purchase Agreement.

1. Land Transfer Tax based on final purchase price less HST as stated in Clause #17 of the Agreement of Purchase & Sale.
2. Property Taxes as per final statement of adjustments as stated in Clause #7 of the Agreement of Purchase & Sale.
3. Maximum GST/HST rebate based on final purchase price less HST as stated in Schedule "G" Clause # 8 of the Agreement of Purchase & Sale.
4. Tarion Enrolment Fee based on final purchase price less HST as stated in Clause #7 of the Agreement of Purchase & Sale. Tarion Enrolment Calculation Table can be viewed on-line at tarion.com. See chart on page 12 as a guide.
5. Additional upgrades/deletions contained in the attached Amendment to the Agreement of Purchase and Sale dated May 30th, 2021.
6. Any increase in existing or newly imposed levies, development charges, education development any impost or other charges imposed by an approving authority or public utility corporation as stated in Clause # 33 of the Agreement of Purchase & Sale.

Signed at Ottawa, this 30th day of May, 2021.

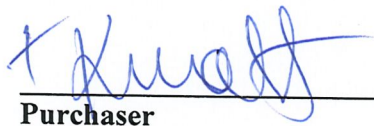
Purchaser

Valecraft Homes Limited

Purchaser

Per: 

Date: June 3, 2021

Lot #: N75

Project: Deerfield Village II



THE LEWIS

MODEL 130

2171 sq.ft. (452 sq.ft. Basement)

Site: DV2

Plan No.: 4M-1290

Lot: N75

Date: May 30, 2021

Purchaser: Kristina Desiree Malt

Purchaser: Kiana Maria Malt

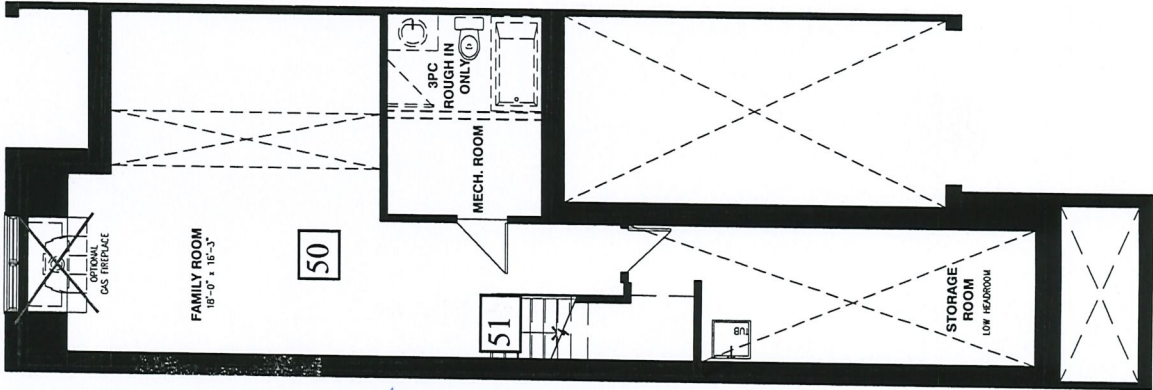

BASEMENT FLOOR

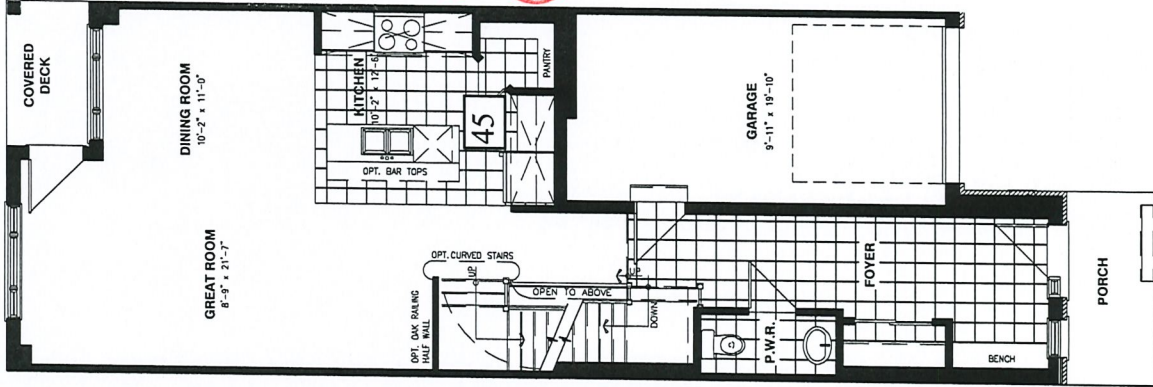

GROUND FLOOR

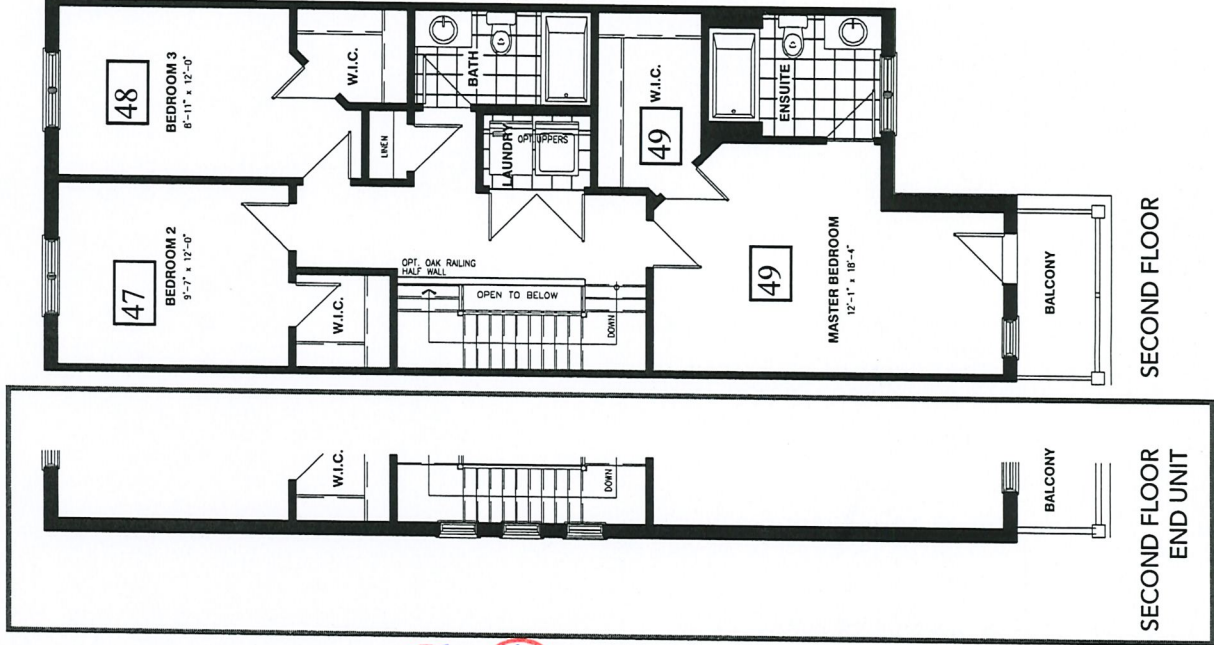

SECOND FLOOR
END UNIT

SECOND FLOOR

Floor Plan sketch

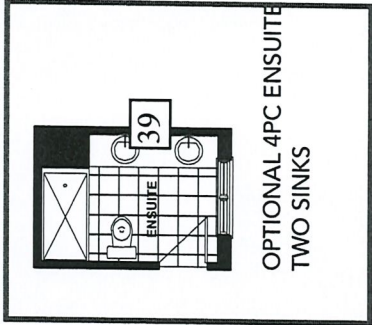

OPTIONAL 4PC ENSUITE
TWO SINKS

Vertical and/or horizontal bulkheads (chaseways) may be required to contain mechanical piping.
All dimensions are approximate. F & O F plans materials and specifications are subject to change without notice. Actual useable floor space may vary from the stated floor area.



Tile Installation Options

WALL TILE

Vertical stacked

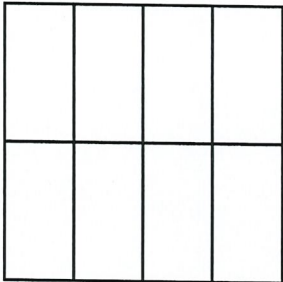

Horizontal stacked

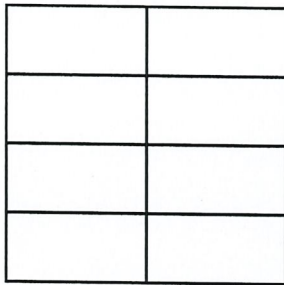

Main Bathroom

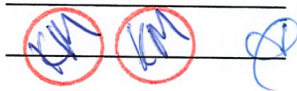

Vertical 1/3 offset brick

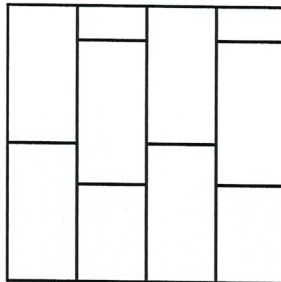

Horizontal 1/3 offset brick

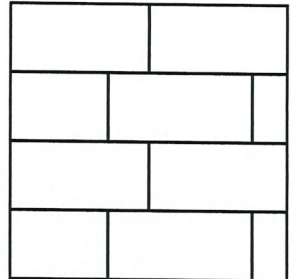

Kitchen Backsplash



Vertical brick

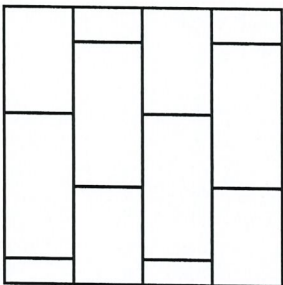

Horizontal brick

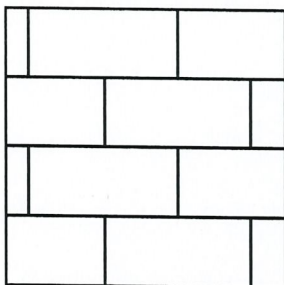

45 degree

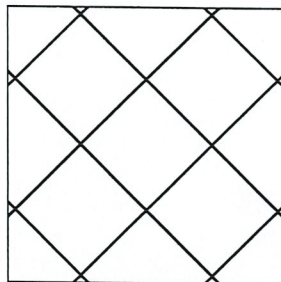

Standard square

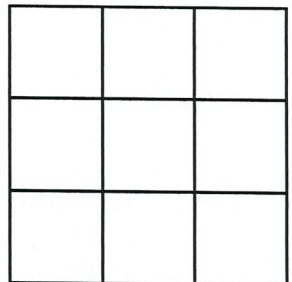

4pc Ensuite Shower
Walls



Project: DV2

Plan #: 4M-1290

Lot: N75

Model: 130 The Lewis Rev. End

Purchaser: Kristina Desiree Malt

Purchaser: Kiana Maria Malt

Date: May 30th, 2021

Upgrade #: 36, 37, 46, 4, 5



Tile Installation Options

FLOOR TILE

Standard square

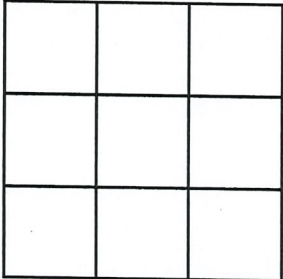

Square brick

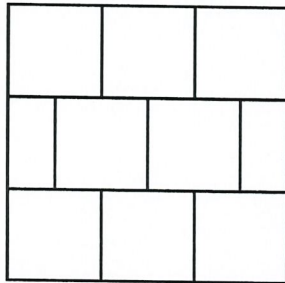

Rectangular
front to back of the house

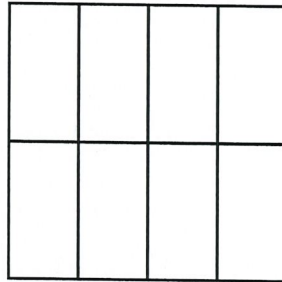

Rectangular
side to side of the house

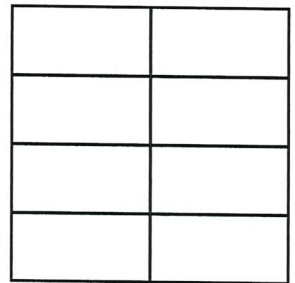

Laundry Area
Main Bathroom
4pc Ensuite w/ 2 Sinks

Foyer & Powder Room



Rectangular 1/3 staggered
front to back of the house

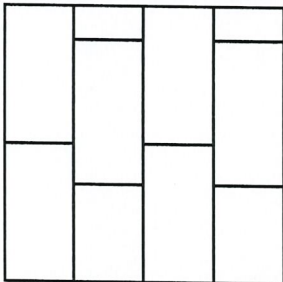

Rectangular 1/3 staggered
side to side of the house

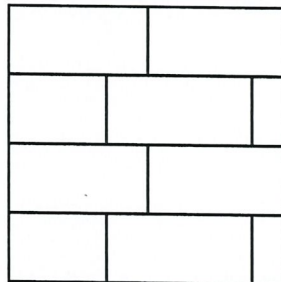

45 degree

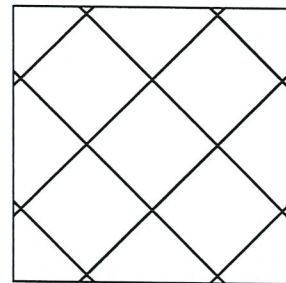

Project: DV2

Plan #: 4M-1290

Lot: N75

Model: 130 The Lewis Rev. End

Purchaser: Kristina Desiree Malt

Purchaser: Kiana Maria Malt

Date: May 30th, 2021

Upgrade #: 5, 20, 30, 4



Valecraft
Homes Ltd.

Standard Edge Profiles for Granite & Quartz

KM
KM

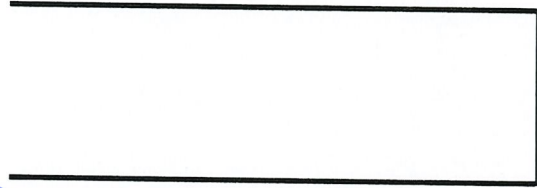

Eased Edge

Kitchen Quartz #29
4 pce Ensuite complete with
two sinks Quartz #39

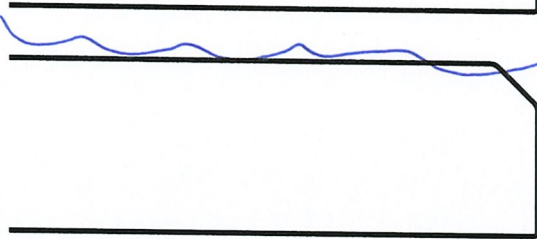

1/4 Bevel

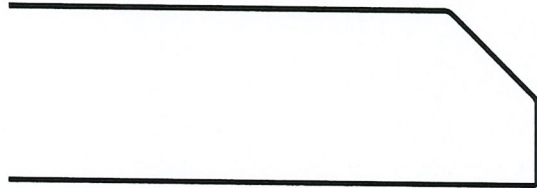

1/2 Bevel

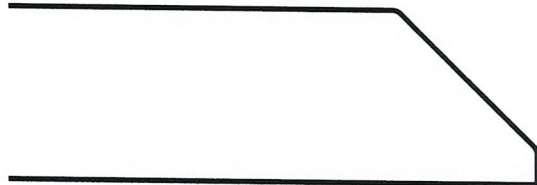

3/4 Bevel

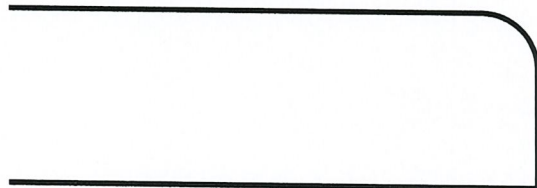

Pencil Top Only
with Square Bottom

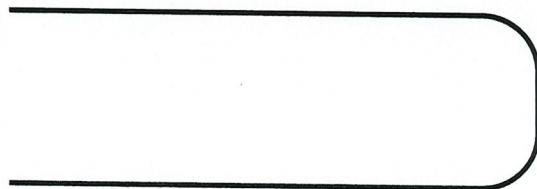

Pencil Top and Bottom

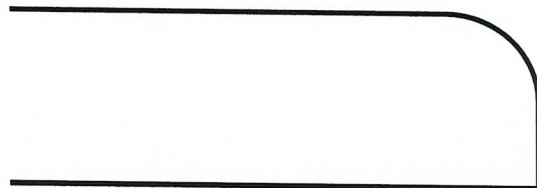

1/2 Bullnose

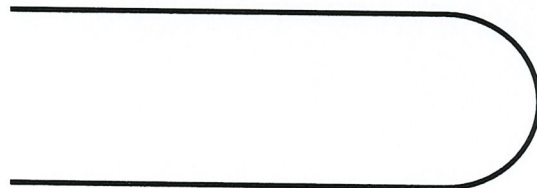

Full Bullnose

Project: DV2

Purchaser: Kristina Desiree Malt

Plan #: 4M-1290

Purchaser: Kiana Maria Malt

Lot: N75

Date: May 30th, 2021

Model: 130 The Lewis Rev. End Unit

Upgrade #: 29, 39

OPTIONAL KITCHEN CABINET CROWN MOULDING, FILLER & **UPGRADE** BULKHEAD DETAILS

UPC9-1C Upgrade #: N/A

- Includes upgrade to 40" uppers with filler detail & valence on upper kitchen cabinetry. Raised approx. 2" to upgraded bulkhead.

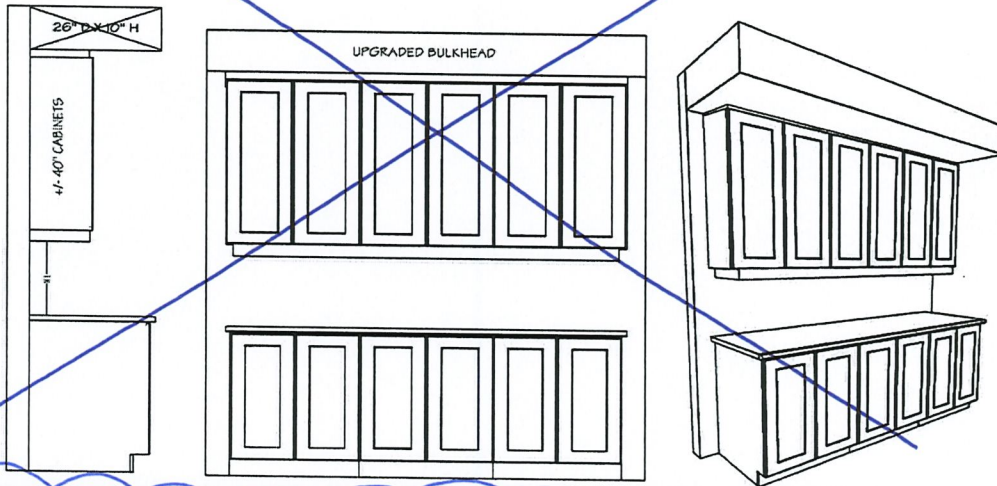

UPC9-2B Upgrade #: 59

- Includes upgrade to 42" uppers with filler detail on upper kitchen cabinetry to upgraded bulkhead.

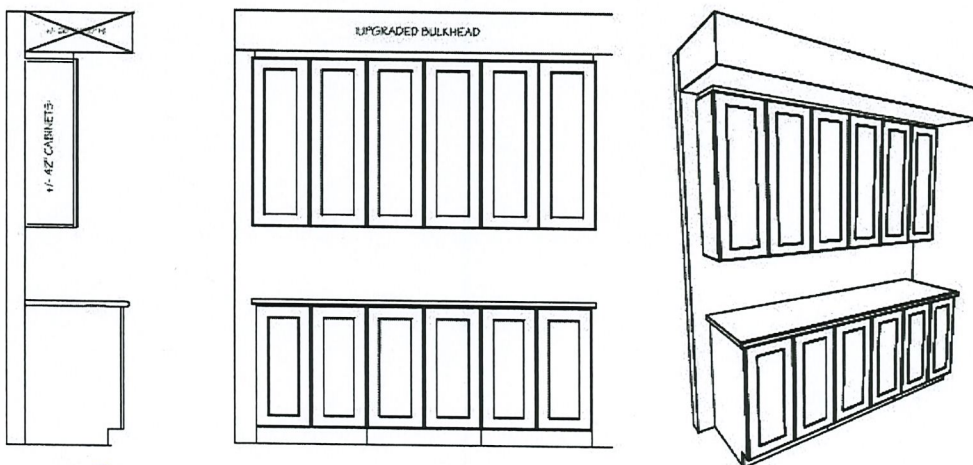

UPC9-3A Upgrade #: N/A

- Includes upgrade to 40" uppers with crown moulding & filler detail on upper kitchen cabinetry to upgraded bulkhead.

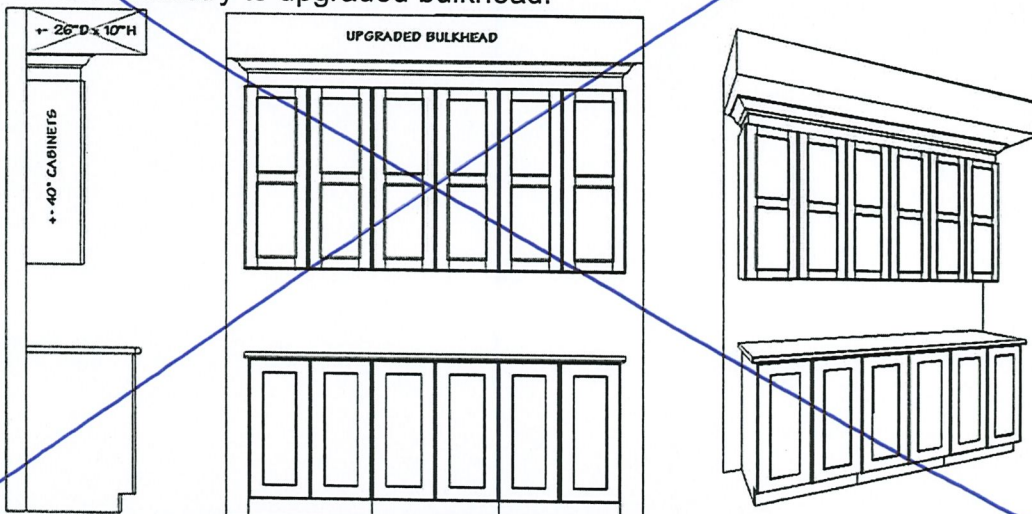

Site: DV2

Purchaser: Kristina Desiree Malt

Plan No: 4M-1290

Lot: N75

Purchaser: Kiana Maria Malt

Date: May 30th, 2021

Model: 130 The Lewis Rev. End Unit

	SINGLES AND TOWNS COLOUR CHART					
	Community:	Deerfield Village 2	Reg'd Plan #:	4M-1290	Sales Rep:	N. Trudel
	Lot No:	N75	Civic Address:	636 Tranquil Stream Private		
	Purchaser(s):	Kristina Desiree Malt			Model Name/#:	130 Lewis Rev. End
	Purchaser(s):	Kiana Maria Malt			Closing Date:	January 12th, 2022

INTERIOR FINISHES		
	DESCRIPTION	STD/UPG #
TRIM STYLE	Standard Nivaga Baseboards and Casings	STD
DOOR STYLE	Standard Cambridge Style Passage Doors	STD
INTERIOR HARDWARE	Standard Satin Chrome	STD
INTERIOR LIGHTING PACKAGE	Roma Lighting Package	STD
BATHROOM ACCESSORIES	Standard Infinity Series In Chrome	STD 4,5
FIREPLACE MANTLE	N/A	N/A

INTERIOR HANDRAILS AND SPINDLES				
	WOOD	STYLE	STAIN/COLOUR	STD/UPG #
HANDRAIL	Red Oak	Standard Colonial	SB 200	8, 28
BRACKET (if applicable)	Red Oak	Standard Colonial	SB 200	8, 28
SPINDLES	Red Oak	Standard Colonial	SB 200	8, 28
POSTS	Red Oak	Standard Colonial	SB 200	8, 28
NOSINGS	Red Oak	N/A	SB 200	8, 28
HARDWOOD STAIRCASE (WHERE APPLICABLE)	Red Oak	N/A	SB 200	10, 28

APPLIANCES				
TYPE	SIZE	STD/UPG #	APPLIANCE UPG LEVEL	STD/UPG #
FRIDGE <i>(Standard Minimum Opening is 33" x 70.75")</i>	Standard Opening	STD	Sleeve for future waterline + Water Line	24
RANGE	Standard Opening	STD	N/A	N/A
DISHWASHER	Standard Opening	STD	N/A	N/A
MICROWAVE/HOODFAN	Standard Opening	STD	Basic Stainless Steel	41
WASHING MACHINE/DRYER	Standard Opening	STD	N/A	N/A

Purchaser's Signature(s) :

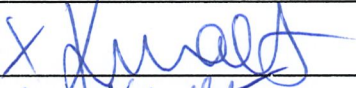

Purchaser's Signature(s) :



Approved By :



Date:

May 30th, 2021

Date:

May 30th, 2021

Date:

June 3, 2021

	SINGLES AND TOWNS COLOUR CHART					
	Community:	Deerfield Village 2	Reg'd Plan #:	4M-1290	Sales Rep:	N. Trudel
	Lot No:	N75	Civic Address:	636 Tranquil Stream Private		
	Purchaser(s):	Kristina Desiree Malt			Model Name/#:	130 Lewis Rev. End
	Purchaser(s):	Kiana Maria Malt			Closing Date:	January 12th, 2022
CABINETRY						
ROOM	SELECTION				LEVEL	STD/UPG #
KITCHEN	STYLE AND COLOUR	Shaker 5PCS TF-180			Level 1	3, 6, 7, 13, 42, 45, 59 29
	HARDWARE CODE	POI-R20004-160-NM	TYPE	Pulls	UPG	6, 7, 43, 45
	COUNTERTOP	Tebas Black	COUNTERTOP EDGE PROFILE	Eased Edge	Quartz Level 1	6, 29 7
MAIN BATHROOM	STYLE AND COLOUR	100i Thermoplastic B10R			STD	3
	HARDWARE CODE	81092-142	TYPE	Pulls	STD	STD
	COUNTERTOP	7213-58	COUNTERTOP EDGE PROFILE	Standard	STD	STD
4PC ENSUITE BATHROOM W/ 2 Sinks	STYLE AND COLOUR	100i Thermoplastic B10R			STD	3, 5, 15 4
	HARDWARE CODE	POI-R20004-160-NM	TYPE	Pulls	UPG	4, 5, 15, 44
	COUNTERTOP	Marengo	COUNTERTOP EDGE PROFILE	Eased Edge	Quartz Level 1	4, 5, 39
POWDER ROOM	STYLE AND COLOUR	Pedestal			STD	STD
	HARDWARE CODE	N/A	TYPE	N/A	N/A	N/A
	COUNTERTOP	N/A	COUNTERTOP EDGE PROFILE	N/A	N/A	N/A
BASEMENT BATHROOM	STYLE AND COLOUR	N/A			N/A	N/A
	HARDWARE CODE	N/A	TYPE	N/A	N/A	N/A
	COUNTERTOP	N/A	COUNTERTOP EDGE PROFILE	N/A	N/A	N/A
LAUNDRY ROOM	STYLE AND COLOUR	N/A			N/A	N/A
	HARDWARE CODE	N/A	TYPE	N/A	N/A	N/A
	COUNTERTOP	N/A	COUNTERTOP EDGE PROFILE	N/A	N/A	N/A

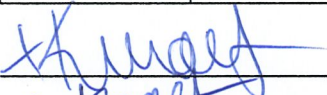
Purchaser's Signature(s) :

Purchaser's Signature(s) :

Approved By :

Date:
May 30th 2021

Date:
May 30th 2021

Date:
June 3, 2021

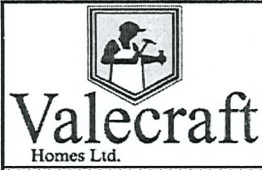
	SINGLES AND TOWNS COLOUR CHART				
	Community:	Deerfield Village 2	Reg'd Plan #:	4M-1290	Sales Rep: N. Trudel
	Lot No:	N75	Civic Address:	636 Tranquil Stream Private	
	Purchaser(s):	Kristina Desiree Malt			Model Name/ #: 130 Lewis Rev. End
	Purchaser(s):	Kiana Maria Malt			Closing Date: January 12th, 2022

PAINT COLOUR(S)				
ROOM	MAIN COLOUR	STD/UPG #	ACCENT WALL	STD/UPG #
TRIM	Semi Gloss OC-117 simply white	STD	N/A	N/A
FOYER	Low Luster OC-30 Gray Mist	STD	N/A	N/A
POWDER ROOM	Semi Gloss OC-30 Gray Mist	STD	N/A	N/A
MAIN FLOOR HALLWAY	Low Luster OC-30 Gray Mist	STD	N/A	N/A
DEN	N/A	N/A	N/A	N/A
FAMILY ROOM	Low Luster OC-30 Gray Mist	STD	N/A	N/A
GREAT ROOM	Low Luster OC-30 Gray Mist	STD	N/A	N/A
DINING ROOM	Low Luster OC-30 Gray Mist	STD	N/A	N/A
FLEX ROOM	N/A	N/A	N/A	N/A
KITCHEN/DINETTE/ BREAKFAST	Semi Gloss OC-30 Gray Mist	STD	N/A	N/A
LAUNDRY/MUDROOM	Low Luster OC-30 Gray Mist	STD	N/A	N/A
2nd FLOOR HALLWAY	Low Luster OC-30 Gray Mist	STD	N/A	N/A
MAIN BATH	Semi Gloss OC-30 Gray Mist	STD	N/A	N/A
BEDROOM #2	Low Luster OC-30 Gray Mist	STD	N/A	N/A
BEDROOM #3	Low Luster OC-30 Gray Mist	STD	N/A	N/A
BEDROOM #4	N/A	N/A	N/A	N/A
MASTER BEDROOM	Low Luster OC-30 Gray Mist	STD	N/A	N/A
MASTER BEDROOM WALK-IN CLOSET	Low Luster OC-30 Gray Mist	STD	N/A	N/A
MASTER BEDROOM ENSUITE	Semi Gloss OC-30 Gray Mist	STD	N/A	N/A
FINISHED BASEMENT RECREATION ROOM	N/A	N/A	N/A	N/A
BASEMENT BATHROOM	N/A	N/A	N/A	N/A

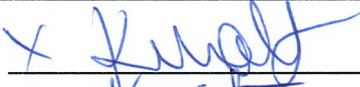
Purchaser's Signature(s) :

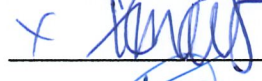

Purchaser's Signature(s) :

Approved By :

Date:
May 30th 2021

Date:
May 30th 2021

Date:
June 3, 2021

	SINGLES AND TOWNS COLOUR CHART					
	Community:	Deerfield Village 2	Reg'd Plan #:	4M-1290	Sales Rep:	N. Trudel
	Lot No:	N75	Civic Address:	636 Tranquil Stream Private		
	Purchaser(s):	Kristina Desiree Malt			Model Name/#:	130 Lewis Rev. End
	Purchaser(s):	Kiana Maria Malt			Closing Date:	January 12th, 2022

CERAMIC & GROUT SELECTIONS (1)					
ROOM	AREA	MANUFACTURER/SERIES/SIZE/ COLOUR/CODE	GROUT SELECTION	LEVEL	STD/UPG #
FOYER	FLOOR	Ceratec Stone Glamour 11.6"x23.6" Calacatta Matt (Rectangular Front to Back Install)	909 Sterling	Silver Floor tile + UPG Grout	19, 30
POWDER ROOM	FLOOR	Ceratec Stone Glamour 11.6"x23.6" Calacatta Matt (Rectangular Front to Back Install)	909 Sterling	Silver Floor Tile+ UPG Grout	19, 30
	WALL	N/A	N/A	N/A	N/A
	INSERT OR BORDER	N/A			
LAUNDRY ROOM	FLOOR	Ceratec Graniser Kafka 13"x13" Grey (Standard Square Install)	909 Sterling	STD Floor Tile + UPG Grout	19
	WALL	N/A	N/A	N/A	N/A
	INSERT OR BORDER	N/A			
MUDROOM	FLOOR	N/A	N/A	N/A	N/A
	WALL	N/A	N/A	N/A	N/A
	INSERT OR BORDER	N/A			
KITCHEN	FLOOR	See Hardwood Flooring Sheet	N/A	N/A	N/A 27
	BACKSPLASH	Euro Pasha Classic 3"x6" Calacatta (Horizontal 1/3 Offset Brick install)	909 Sterling	Bronze Wall Tile + UPG Install + UPG Grout	19, 36, 37
	INSERT OR BORDER	N/A			
BREAKFAST AREA/DINETTE	FLOOR	N/A	N/A	N/A	N/A
FIREPLACE	HEARTH	N/A	N/A	N/A	N/A
	SURROUND	N/A	N/A	N/A	N/A
ADDITIONAL FIREPLACE	HEARTH	N/A	N/A	N/A	N/A
	SURROUND	N/A	N/A	N/A	N/A

Purchaser's Signature(s) :

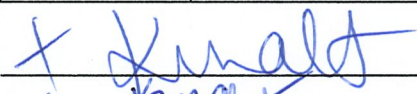

Purchaser's Signature(s) :

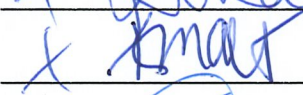

Approved By :

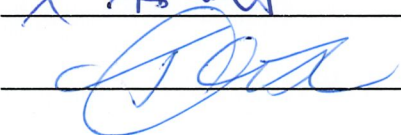

Date:

May 30th, 2021

Date:

May 30th, 2021

Date:

June 3, 2021

	SINGLES AND TOWNS COLOUR CHART					
	Community:	Deerfield Village 2	Reg'd Plan #:	4M-1290	Sales Rep:	N. Trudel
	Lot No:	N75	Civic Address:	636 Tranquil Stream Private		
	Purchaser(s):	Kristina Desiree Malt			Model Name/#:	130 Lewis Rev. End
	Purchaser(s):	Kiana Maria Malt			Closing Date:	January 12th, 2022

CERAMIC & GROUT SELECTIONS (2)					
ROOM	AREA	MANUFACTURER/SERIES/SIZE/ COLOUR/CODE	GROUT SELECTION	LEVEL	STD/UPG #
MAIN BATHROOM	FLOOR	Ceratec Graniser Kafka 13"x13" Grey (Standard Square Install)	909 Sterling	STD Floor Tile+ UPG Grout	19
	WALL	Ceratec Kafka 7.9"x9.8" Grey (Horizontal Stacked Install)	909 Sterling	STD Wall Tile+ UPG Grout	19
	INSERT OR BORDER	N/A			
OTHER BATHROOM	FLOOR	N/A	N/A	N/A	N/A
	WALL	N/A	N/A	N/A	N/A
	INSERT OR BORDER	N/A			
4PC ENSUITE BATHROOM W/ 2 Sinks	FLOOR	Euro Pasha Classic 12"x12" Calacatta (Standard Square Install)	909 Sterling	Bronze Floor Tile + UPG Grout	4, 5, 19, 20
	TUB DECK	N/A	N/A	N/A	N/A
	TUB BACKSPLASH	N/A	N/A	N/A	N/A
	SHOWER WALLS	Euro Pasha Classic 12"x12" Calacatta (Standard Square Install)	909 Sterling	Bronze Floor Tile on Wall + UPG Grout	4, 5, 19, 46
	SHOWER WALL INSERT	N/A	N/A	N/A	N/A
BASEMENT/OTHER BATHROOM	FLOOR	N/A	N/A	N/A	N/A
	WALL	N/A	N/A	N/A	N/A
	INSERT OR BORDER	N/A	N/A	N/A	N/A

Purchaser's Signature(s) :

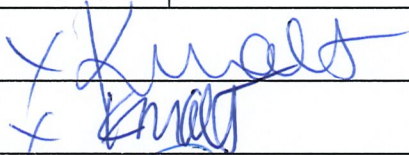

Purchaser's Signature(s) :

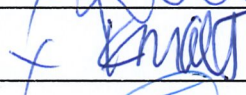

Approved By :



Date:

May 30th, 2021

Date:

May 30th, 2021

Date:

June 3, 2021

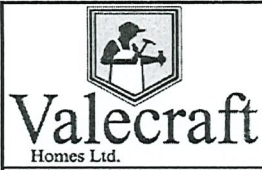
	SINGLES AND TOWNS COLOUR CHART					
	Community:	Deerfield Village 2	Reg'd Plan #:	4M-1290	Sales Rep:	N. Trudel
	Lot No:	N75	Civic Address:	636 Tranquil Stream Private		
	Purchaser(s):	Kristina Desiree Malt			Model Name/#:	130 Lewis Rev. End
	Purchaser(s):	Kiana Maria Malt			Closing Date:	January 12th, 2022

FLOORING SELECTIONS			
ROOM	CARPET/UNDERPAD OR HARDWOOD	LEVEL	STD/UPG #
MAIN FLOOR HALLWAY	Lauzon Essential Collection Tradition Grade Matte Engineered Expert Red Oak Smoky Grey 3-1/8" wide	UPG	28, <i>57</i>
FLEX ROOM	N/A	N/A	N/A
FAMILY ROOM	Beaulieu Silky Sparkle A4780 Velvety Clay 18923 + Standard Underpad	Level 3 carpet + STD Underpad	50
DINING ROOM	Lauzon Essential Collection Tradition Grade Matte Engineered Expert Red Oak Smoky Grey 3-1/8" wide	UPG	28, <i>57</i>
GREAT ROOM	Lauzon Essential Collection Tradition Grade Matte Engineered Expert Red Oak Smoky Grey 3-1/8" wide	UPG	28, <i>57</i>
DEN	N/A	N/A	N/A
REAR HALLWAY	N/A	N/A	N/A
KITCHEN	Lauzon Essential Collection Tradition Grade Matte Engineered Expert Red Oak Smoky Grey 3-1/8" wide	UPG	27
BREAKFAST AREA/DINETTE	N/A	N/A	N/A
MAIN STAIRS TO BEDROOMS (Including Landings)	Red Oak SB 200	UPG	10, <i>28</i>
UPPER HALLWAY	Lauzon Essential Collection Tradition Grade Matte Engineered Expert Red Oak Smoky Grey 3-1/8" wide	UPG	28, <i>57</i>
BEDROOM # 2	Beaulieu Silky Sparkle A4780 Velvety Clay 18923 + Standard Underpad	Level 3 carpet + STD Underpad	47
BEDROOM # 3	Beaulieu Silky Sparkle A4780 Velvety Clay 18923 + Standard Underpad	Level 3 carpet + STD Underpad	48
BEDROOM # 4	N/A	N/A	N/A
MASTER BEDROOM	Beaulieu Silky Sparkle A4780 Velvety Clay 18923 + Standard Underpad	Level 3 carpet + STD Underpad	49
MASTER BEDROOM WALK-IN CLOSET	Beaulieu Silky Sparkle A4780 Velvety Clay 18923 + Standard Underpad	Level 3 carpet + STD Underpad	49
STAIRS TO BASEMENT	Beaulieu Silky Sparkle A4780 Velvety Clay 18923 + Standard Underpad	Level 3 carpet + STD Underpad	51
OTHER	N/A	N/A	N/A

Purchaser's Signature(s) : *x K Malt*

Purchaser's Signature(s) : *x K Malt*

Approved By : *[Signature]*

Date: *May 30th, 2021*

Date: *May 30th, 2021*

Date: *June 3, 2021*

	SINGLES AND TOWNS COLOUR CHART					
	Community:	Deerfield Village 2	Reg'd Plan #:	4M-1290	Sales Rep:	N. Trudel
	Lot No:	N75	Civic Address:	636 Tranquil Stream Private		
	Purchaser(s):	Kristina Desiree Malt			Model Name/#:	130 Lewis Rev. End
	Purchaser(s):	Kiana Maria Malt			Closing Date:	January 12th, 2022

PLUMBING FIXTURES				
ROOM	FIXTURE	STYLE	FINISH	STD/UPG#
KITCHEN	SINK	Reginox Undermount Double Bowl ND1831UA/9	Stainless Steel	52
	FAUCET	Delta Essa Single Handle Pull-Down Kitchen Faucet 9113-BL-DST	Matte Black	53
MAIN BATHROOM	SINK	Standard	White	STD
	VANITY FAUCET	Standard	Chrome	STD
	WATER CLOSET	Standard	White	STD
	TUB/SHOWER	Standard	White	STD
	TUB/SHOWER FAUCET	Standard	Chrome	STD
4PC ENSUITE BATHROOM W/ 2 Sinks	SINKS	American Standard Ovalyn 0495.221 Undermount Lavatory Sink	White	4, 5, 54
	VANITY FAUCETS	Delta Trinsic Single Handle High-Arc 559HA-DST Lavatory Faucet	Chrome	4, 5, 55
	WATER CLOSET	Standard	White	4, 5
	SHOWER	Standard	Chrome/ Clear Glass/ White	4, 5
	SHOWER FAUCET	Standard	Chrome	4, 5
	BATHTUB	N/A	N/A	N/A
	BATHTUB FAUCET	N/A	N/A	N/A
POWDER ROOM	PEDESTAL	Standard	White	STD 56
	SINK FAUCET	Delta Trinsic Single Handle High-Arc 559HA-DST Lavatory Faucet	Chrome	56
	WATER CLOSET	Standard	White	STD
BASEMENT BATHROOM	SINK	N/A	N/A	N/A
	VANITY FAUCET	N/A	N/A	N/A
	WATER CLOSET	N/A	N/A	N/A
	TUB/SHOWER	N/A	N/A	N/A
	TUB/SHOWER FAUCET	N/A	N/A	N/A

NOTE: All fixtures are white as standard

Purchaser's Signature(s) :

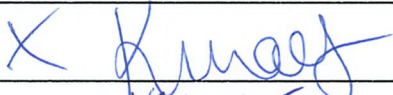

Purchaser's Signature(s) :



Approved By :

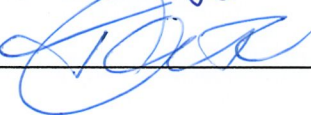

Date:

May 30th, 2021

Date:

May 30th, 2021

Date:

June 3, 2021