



NON STANDARD EXTRAS (680)

Rathwell Landing - Phase 1

PURCHASERS: Kristina Alessandra Musca and Sebastian Dawid Pawlak

Printed: 3-May-21 9:15 am

LOT NUMBER	PHASE	HOUSE TYPE	CLOSING DATE
237	1	810 THE KEMP 3 BED ELEV B	15-Dec-2021

ITEM	QTY	EXTRA / CHANGE	PRICE	INTERNAL USE
60		1 - KITCHEN - PURCHASER(S) ACCEPT AND ACKNOWLEDGE KITCHEN AND BATHROOM LAYOUT AS PER KITCHEN AND BATHROOM SKETCH DATED MAY 3, 2021.	\$0.00	Each
32784		Note:		

Sub Total	\$0.00
HST	\$0.00
Total	\$0.00

Payment Summary	
<u>Paid By</u>	<u>Amount</u>
<u>Total Payment:</u>	

PURCHASER:

DocuSigned by:

Kristina Alessandra Musca

Kristina Alessandra Musca

03-May-21

DATE

PURCHASER:

DocuSigned by:

Sebastian Dawid Pawlak

Sebastian Dawid Pawlak

03-May-21

DATE

VENDOR:

DocuSigned by:

Vicinia Oliver

B66AFC94F0B9401...

PER: Valecraft Homes Limited

May 5, 2021 | 5:02 AM PDT

DATE:

PREPARED BY: Lisa Ballard

LOCKED BY: Lisa Ballard

PE 1,523-1

InvoiceSQL.rpt 28mar21

CONSTRUCTION SCHEDULING APPROVAL

PER: \_\_\_\_\_

DATE: \_\_\_\_\_

\* These plans are intended for production of cabinets ONLY. Potvin is not liable if they are used for other purposes.  
\* Construction lines on plans are subjective and are drawn for representation only. Their dimensions are approximate and may vary due to site conditions.  
\* Appliances in elevations and plans are generic templates and may not reflect actual selections.

**potvin**   
KITCHENS & CABINETRY

Four number lines are shown, each representing a different way to partition the number 1000. The first line is marked with 0, 500, and 1000. The second line is marked with 0, 250, 500, 750, and 1000. The third line is marked with 0, 125, 250, 375, 500, 625, 750, 875, and 1000. The fourth line is marked with 0, 100, 200, 300, 400, 500, 600, 700, 800, 900, and 1000. A red checkmark is placed next to the first line.

All Cabinets				
No	Name	Width	Height	Depth
0	Electric range	762	1118	716
0	WINE FRIDGE	635	875.5	673
0	Refrigerator LH	711	1695.5	800
1	450x450 Filler	450	16.5	450
2	P Filler	45	2445	587
3	P525/2445/587	525	2445	587
4	Lc Filler	25	883	587
5	LC 1025	1025	883	587
6	LC 850 PP 6-12-12	850	883	587
7	LC 850 PP 6-12-12	850	883	587
8	Lc Filler	38	883	587
9	UC850 Puck Light MLW	850	1067	302
10	UC850 Puck Light MLW	850	1067	302
11	UC800 Puck Light MLW	800	1067	302
12	Canopy Range Hood	762	539	690
13	UC800 Puck Light MLW	800	1067	302
14	UC Filler	38	1067	302
15	FGABLE	16.5	2445	609
16	LC 900	900	883	587
17	LC 650 MWD	650	883	587
18	Lc Filler	25	883	587
19	UC Filler	38.5	625	587
20	UC920/625/587 fridge	920	625	587
21	UC775 Puck Light MLW	775	1067	302
22	UC775 Puck Light MLW	775	1067	302
23	UC Filler	25	1067	302

2 COLOUR KITCHEN  
SUPER WHITE

# Transformer

## Transformes

Room Name		
STANDARD - PERIMETER		
COUNRTERTOPS		
COUNRTERTOP BY OTHERS		
FINISH		
MDF Super White (0)		
HANDLES		
POL-R7640-12B-BNL		
DOOR STYLE		
baseboardFD-7731V Red Deer	MDF Super White	
UpperDoorFD-7731V Red Deer	MDF Super White	
DrawerFD-7000V Drawer	MDF Super White	
DRAWER GUIDE		
ATR1A Full Extension		
DOOR HINGE STYLE		
SOFTCLOSE HINGES		
Construction		
(A)Petrvin 32mm		
CROWN MLDG		
Finished BulkHead 102	MDF Super White	
LIGHT VALANCE		
NO VALANCE	MDF Super White	

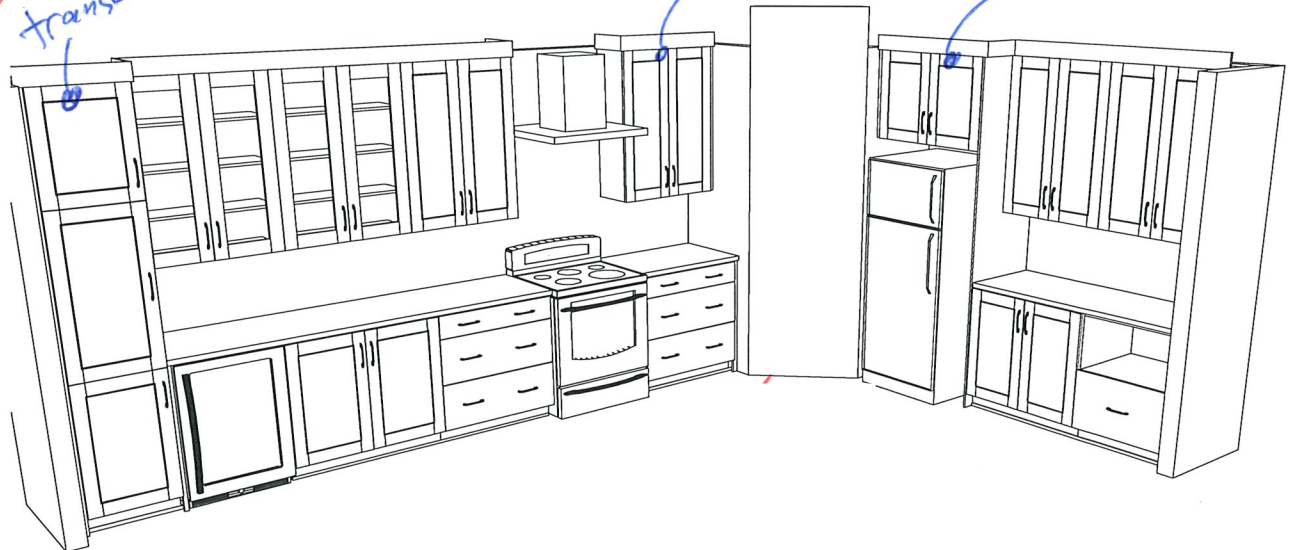

DS  
Km

DS  
SDP

DS  
VJ

CLIENT: VALECRAFT

ADDR.: 810 KEMP STND, ,

SL #: Job

Phone:                      Mobile:

Email :

LOT:RL01-237

OUT BY: ABBY LOOV                      DATE: 23/04/21

RL01-237

\* These plans are intended for production of cabinets ONLY. Potvin is not liable if they are used for other purposes.  
\* Construction lines on plans are subjective and are drawn for representation only. Their dimensions are approximate and may vary due to site conditions.  
\* Appliances in elevations and plans are generic templates and may not reflect actual selections.

PG#  
2 of 3  
Sheet 2

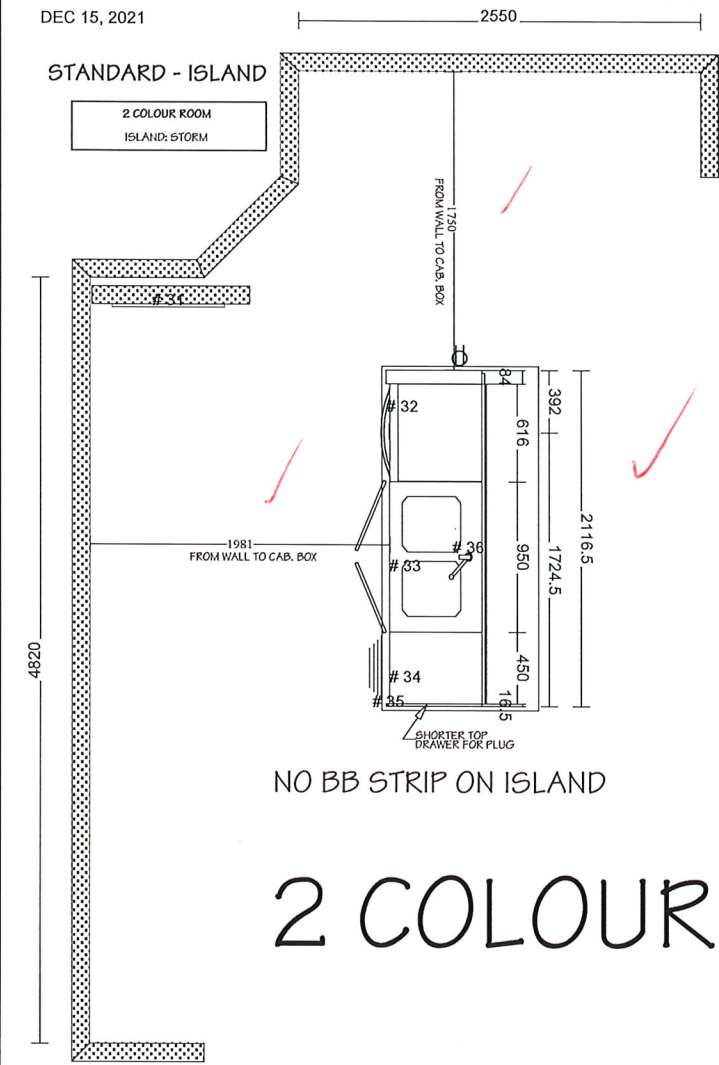

Room Name
STANDARD - ISLAND
COUNTERTOPS
COUNTERTOP BY OTHERS
FINISH
MDF STORM (O)
HANDLES
POL-R7040-128-BNL
DOOR STYLE
base door:FD-7731-V Red Deer
Upper Door:FD-7731-V Red Deer
Drawer:FD-7000V Drawer
DRAWER GUIDE
ATIRA Full Extension
DOOR HINGE STYLE
SOFTCLOSE HINGES
Construction
(A)Potvin 32mm
CROWN MLDG
NO CROWN
MDF STORM
LIGHT VALANCE
NO VALANCE
MDF STORM

All Cabinets				
No	Name	Width	Height	Depth
0	DISHWASHER	616	883	587
0	Double W/Faucet/gray	762	101.5	457
31	DW FILLER T1S	711	102	19
32	DW PLUG Left Sid	84	883	864
33	LC 950 SK USB	950	883	587
34	LC450D	450	883	587
35	DW GABLE	16.5	883	864
36	ISLPANEL Horizontal	2083.5	883	16.5

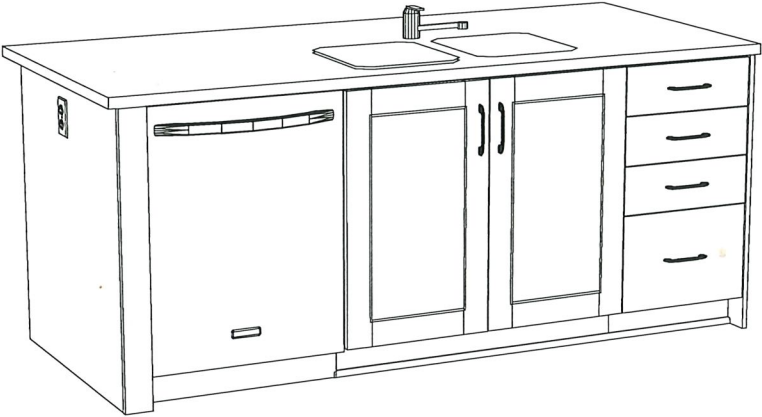

2 COLOUR KITCHEN - STORM

\\Potvin\potvin-portal\AAA\CABINETS\J005\ Build\Final Valecraft - Production\BATHWELL LANDINO\RL02-237, KEMP\RL01-237, 810 KEMP STND.cad

CLIENT: VALECRAFT		LOT:RL01-237	
ADDR.: 810 KEMP STND, ,			
SL #: Job			
Phone:	Mobile:		
OUT BY: ABBY LOOV		DATE: 23/04/21	
Email :		RL01-237	

\* These plans are intended for production of cabinets ONLY. Potvin is not liable if they are used for other purposes.  
\* Construction lines on plans are subjective and are drawn for representation only. Their dimensions are approximate and may vary due to site conditions.  
\* Appliances in elevations and plans are generic templates and may not reflect actual selections.

PG#	3 of 3	
Sheet 3		

DEC 15, 2021

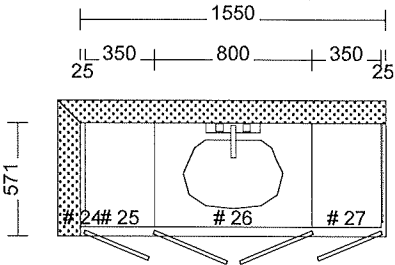

MAIN 2ND FLOOR

All Cabinets				
No	Name	Width	Height	Depth
0	Single W/Faucet	508	51	432
24	V Filler	25	819	524
25	V350	350	819	524
26	V 800 SK	800	819	524
27	V350	350	819	524

Room Name	
MAIN BATH 2ND FLOOR	
COUNTERTOPS	
COUNTERTOP BY OTHERS	
FINISH	
PM-V392WT	
HANDLES	
POI-R7040-128-BNL	
DOOR STYLE	
basedoor:100I	PM-V392WT
UpperDoor:100I	PM-V392WT
Drawer:100I DRAWER	PM-V392WT
DRAWER GUIDE	
ATIRA Full Extension	
DOOR HINGE STYLE	
SOFTCLOSE HINGES	
Construction	
(A)Potvin 32mm	

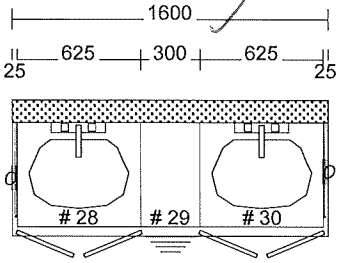
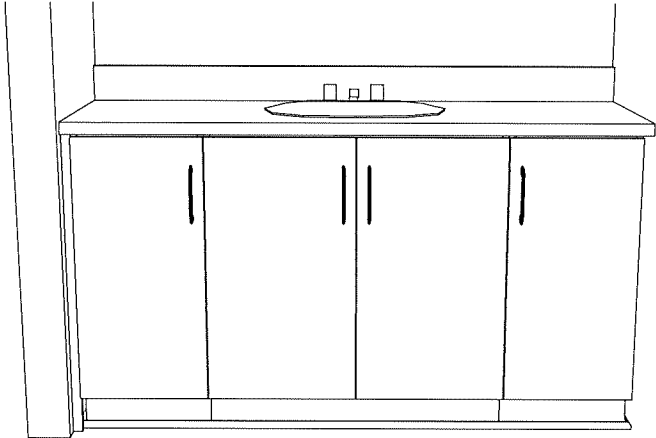

ENSUITE 2ND FLOOR

All Cabinets				
No	Name	Width	Height	Depth
0	Single W/Faucet	508	51	432
0	Single W/Faucet	508	51	432
28	V 625 SK	625	819	524
29	V300 4D	300	819	524
30	V 625 SK	625	819	524

Room Name	
ENSUITE 2ND FLOOR	
COUNTERTOPS	
COUNTERTOP BY OTHERS	
FINISH	
PM-V392WT	
HANDLES	
POI-R7040-128-BNL	
DOOR STYLE	
basedoor:100I	PM-V392WT
UpperDoor:100I	PM-V392WT
Drawer:100I DRAWER	PM-V392WT
DRAWER GUIDE	
ATIRA Full Extension	
DOOR HINGE STYLE	
SOFTCLOSE HINGES	
Construction	
(A)Potvin 32mm	

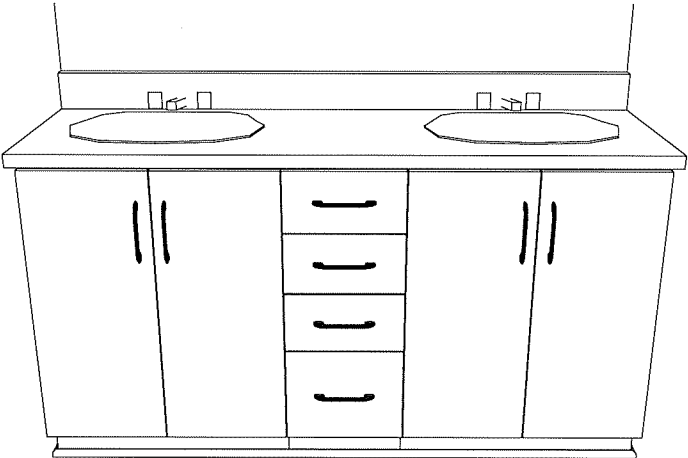

\\Potvin\potvin\potvin\AAACABINETS\J055\_ Builder\A Valecraft\_Production\BATHWELL LAND\NOI\LO2-237, KEMP\RL01-237, 810 KEMP STND.dwg