



Additional Structural

PURCHASER'S EXTRAS QUOTATION

Oak Ridge Meadows - Phase 2 - Grovetrail Dev. Inc.

PURCHASER: ZHUOTIAN LAO

TEL:

LOT NUMBER	PHASE	HOUSE TYPE
138	2	BELVEDERE Elev A

ITEM	EXTRA / CHANGE	QTY	UNIT PRICE	EXTENDED
1	CLOSET- UPPER LANDING- Install extended height double doors for the Linen Closet on the Upper Stair Landing (See Sketch)	2		
229495				
2	PURCHASER AWARE AND ACCEPTS THAT ANY CHANGES MADE TO UPGRADES AFTER SIGNING THIS PURCHASERS EXTRA FORM ARE SUBJECT TO A MINIMUM ADMINISTRATION FEE OF \$1,000	1		
229496				



Sub Total

HST

Total

1. In the event the work on the house has progressed beyond the point where the items covered by this extra cannot be installed without entailing any unusual expense, then this order is to be cancelled and any deposit paid in connection with the same is to be refunded to the Purchaser.
2. The Vendor will undertake to incorporate the work covered by the sales extra in the construction of the house but will not be liable to the purchaser in any way, if for any reason the work covered by the extra is not carried out. In that event, any monies paid in connection with the same shall be returned to the Purchaser.
3. It is understood and agreed that if for any reason whatsoever the transaction of Purchase and Sale is not completed, the total cost of extras ordered are not refundable to the Purchaser(s).
4. Extras or changes will not be processed unless signed by the Vendor.
5. These extras may not be amended without the written consent of Grovetrail Developments Inc..
6. The Purchaser(s) and the Vendor acknowledge and agree that this form shall not be deemed to be part of the Agreement of Purchase and Sale entered into between them, nor an addendum thereto.
7. No Estimates or orders will be accepted once construction has commenced.
8. Prices are estimates only and guaranteed for a period of 5 days only.
9. Any cancellations to this order, providing they can be cancelled, are subject to a \$500 minimum administration charge and a 10% cancellation charge for the total amount being cancelled.
10. For Visa, Mastercard and Debit paments, transactions are identified on you statement as "SHERWAY CONSTRUCTION LTD", an Authorized Visa /Mastercard/Debit Merchant and authorized Royal Pine Homes company.

Payment Summary

Paid By	Amount
Amendment	
Total Payment:	

Bonus Summary

Bonus Package offering (includes taxes) from Royal Pine Homes Décor Centre is being applied to this order.

Any remaining balance(s) will be applied accordingly to extras purchased.

Bonus Package Offering

Invoice Number	Date	Amount
8672	19-Nov-24	
Total Bonus Used:		
Remaining Balance:		

PURCHASER:

Signed by:

0B3EEE6416EA49C...

ZHUOTIAN LAO

07-Jan-25

DATE

VENDOR:

PER: Grovetrail Developments Inc.

TAX#:1

PREPARED BY: Laura Di Pede

PRINTED: 7-Jan-25 at 12:27 pm

RoyInvoiceSQL.rpt 07aug20

CONSTRUCTION SCHEDULING APPROVAL

PER: _____

DATE: _____



PE 8679-1

Additional Sheet

PURCHASER'S EXTRAS QUOTATION
Oak Ridge Meadows - Phase 2

PURCHASER: ZHUOTIAN LAO

TEL:

TEL:

LOT NUMBER	PHASE	HOUSE TYPE
138	2	BELVEDERE Elev A

ITEM	EXTRA / CHANGE	QTY	UNIT PRICE	EXTENDED
1 228297	SECOND FLOOR- Install SIX (X6) extended height interior doors on the second floor. To include the bedroom entrance doors and laundry room. (See Sketch) -MASTER BEDROOM -X2 DOOR -LAUNDRY ROOM- X1 DOOR -BEDROOM #2- X1 -BEDROOM #3- X1 DOOR -BEDROOM #4- X1 DOOR	6		
2 228355	MASTER ENSUITE- Delete the full wall next to the free standing tub and install additional full frameless glass and additional curb with white quartz top (See Sketch)	1		
3 228356	KITCHEN ISLAND- Install a bar sink and faucet plumbing rough in ONLY for future bar sink. (See Sketch) **Purchaser accepts & acknowledges that the above price does not include the sink and faucet for the island**To be chosen at time of colour chart appt. **Price above does not include the counter top cut and polish fee**to be charged at time of colour chart	1		
4 228357	KITCHEN ISLAND- Increase the island to accommodate the bar sink (See Sketch) **Priced as per QTK **Purchaser is aware that the price above does NOT include additional counter top and will be charged accordingly at time of colour chart**	1		
5 228317	PURCHASER AWARE AND ACCEPTS THAT ANY CHANGES MADE TO UPGRADES AFTER SIGNING THIS PURCHASERS EXTRA FORM ARE SUBJECT TO A MINIMUM ADMINISTRATION FEE OF \$1,000	1		
6 228318	PURCHASER HAS ATTENDED A STRUCTURAL APPOINTMENT AT THE DESIGN STUDIO AND HAS DECLINED ANY ADDITIONAL UPGRADES	1		



Sub Total
HST
Total

- In the event the work on the house has progressed beyond the point where the items covered by this extra cannot be installed without entailing any unusual expense, then this order is to be cancelled and any deposit paid in connection with the same is to be refunded to the Purchaser.
- The Vendor will undertake to incorporate the work covered by the sales extra in the construction of the house but will not be liable to the purchaser in any way, if for any reason the work covered by the extra is not carried out. In that event, any monies paid in connection with the same shall be returned to the Purchaser.
- It is understood and agreed that if for any reason whatsoever the transaction of Purchase and Sale is not completed, the total cost of extras ordered are not refundable to the Purchaser(s).
- Extras or changes will not be processed unless signed by the Vendor.
- These extras may not be amended without the written consent of Grovetrail Developments Inc..
- The Purchaser(s) and the Vendor acknowledge and agree that this form shall not be deemed to be part of the Agreement of Purchase and Sale entered into between them, nor an addendum thereto.
- No Estimates or orders will be accepted once construction has commenced.
- Prices are estimates only and guaranteed for a period of 5 days only.
- Any cancellations to this order, providing they can be cancelled, are subject to a \$500 minimum administration charge and a 10% cancellation charge for the total amount being cancelled.
- For Visa, Mastercard and Debit payments, transactions are identified on you statement as "SHERWAY CONSTRUCTION LTD", an Authorized Visa /Mastercard/Debit Merchant and authorized Royal Pine Homes company.

TAX#:1

PREPARED BY: Laura Di Pede
PRINTED: 12-Dec-24 at 9:56 am
RoyInvoiceSQL.rpt 07aug20

Initials
C.L.

CONSTRUCTION SCHEDULING APPROVAL
PER: _____
DATE: _____

Lot 138

Grovetrail

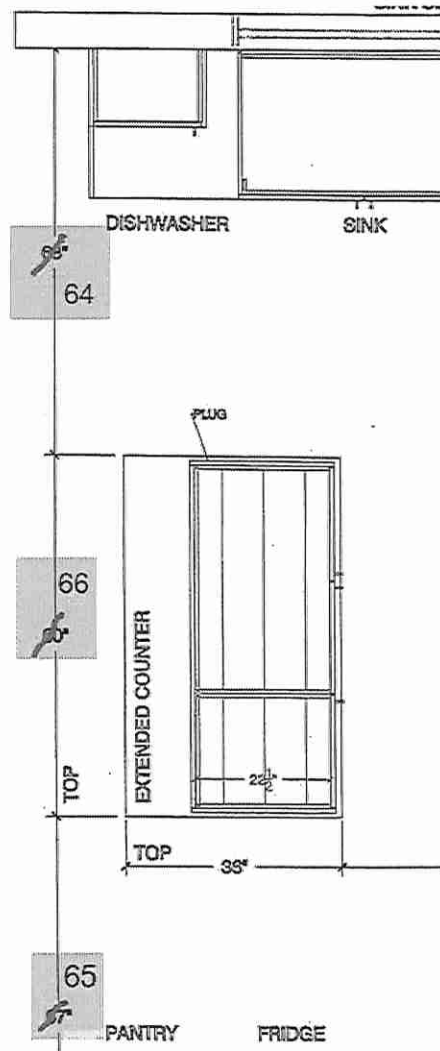

*Extended Island To Accommodate Bar Sink *
in Island



STRUCTURAL

CONSTRUCTION SUMMARY

Grovetrail Developments Inc. R-2

PURCHASER: ZHUOTIAN LAO

TEL:

LOT NUMBER	PHASE	HOUSE TYPE	CLOSING DATE
138	2	BELVEDERE Elev A	27-Nov-25

Offer	Purchaser accepts and acknowledges that the Elevation may be altered slightly in order to satisfy and bring into compliance any requirements stipulated by Architectural Controls.
Worksheet	Note:

Offer	BONUS PACKAGE FOR 38? DETACHED: PURCHASER TO RECEIVE \$15,000.00 (INCLUSIVE OF TAXES) WORTH OF UPGRADES AT DECOR CENTRE AT TIME OF COLOUR CHART
Worksheet	Note:

Date Added: 19-Nov-24 Invoice Number: 8672

1 - MAIN FLOOR-Install extended height main floor ceilings to 10'-0", in lieu of the standard. Includes taller Archways (where applicable/where possible) and taller interior doors (where applicable/where possible) on Main floor. Note: Above Approved as per Steve C Price approved as per Steve C
3 - BASEMENT- Install THREE (X3) larger basement windows 36"x24" in lieu of the builders standard basement size windows (With Possible window wells) (See Sketch) Note: Approved as per Fonzie
1 - EXTERIOR FRONT DOOR- Install extended height double front door with glass in existing design, in lieu of the builders standard height. Delete the transom above to accommodate the extended height Note:
1 - PURCHASER AWARE AND ACCEPTS THAT ANY CHANGES MADE TO UPGRADES AFTER SIGNING THIS PURCHASERS EXTRA FORM ARE SUBJECT TO A MINIMUM ADMINISTRATION FEE OF \$1,000 Note:
1 - PURCHASER HAS REVIEWED STRUCTURAL CHANGES THROUGH THE DESIGN STUDIO AND HAS DECLINED ANY ADDITIONAL UPGRADES Note:
1 - BONUS PACKAGE-PURCHASER TO RECEIVE \$15,000 (INCLUSIVE OF TAXES) WORTH OF UPGRADES AT THE DESIGN STUDIO AT TIME OF COLOUR CHART Note:

This Document is Extremely Time Sensitive - Printed 19 Nov 24 at 16:10