

LG REFRIGERATION

LFXS26973\_

3-Door French Door Refrigerator

- Slim SpacePlus® Ice System
- Dual Ice Maker
- Smudge Resistant Stainless Steel
- SmartThinQ® WiFi Connectivity
- Smart Cooling System with Door Cooling + SmartDiagnosis®
- LoDecibel™ Quiet Operation
- ENERGY STAR® Qualified

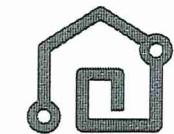

SmartThinQ®

Enjoy new ways to control your home with LG smart appliances

- Get an alert when kids forget to close the door
- Make more ice while you're at work
- Works with the LG SmartThinQ® app



works with the Google Assistant



WORKS WITH alexa

CAPACITY

Refrigerator (cu.ft.)	17.4
Freezer (cu.ft.)	8.8
Total Capacity (cu.ft.)	26.2

ENERGY

Energy Consumption (kWh/Year)	685
ENERGY STAR® Qualified	Yes

WATER & ICE SYSTEM

Ice & Water Dispenser	Yes
Dispenser Type	Integrated Tall
Daily Ice Production (lbs)	6.0 lbs.
IcePlus™ Production (lbs)	6.5 lbs.
Ice Storage Capacity (lbs)	2.5 + 4.0 lbs
Ice System	Slim SpacePlus®
Dual Ice	Yes
Dispenser Light	Yes
Water Filter	LT1000P

COOLING

Inverter Linear Compressor	Yes
Smart Cooling® System	Yes
Multi-Air Flow Cooling	Yes
Temperature Sensors	6
Fresh Air Filter	Yes

CONVENIENCE

Display Type	Membrane / White LED
Temperature Controls	Electronic/Digital
Door Alarm	Yes
Child Lock	Yes
Auto Closing Door Hinge	Yes
Sabbath Mode	Yes
LoDecibel™ Quiet Operation	Yes

REFRIGERATOR

No. of Shelves	4 split
Cantilevered Shelves	Hybrid Cantilevered
Shelf Construction	Spill Protector™ Tempered Glass
Crisper Bins	2 Humidity Crispers
Glide N' Serve® Pantry Drawer	Yes
Refrigerator Light	Ceiling LED

REFRIGERATOR DOOR

No. of Bins	6 Total (2 Adjustable Gallon Sized)
Door Bin Construction	1 Piece (Clear)

FREEZER

Door Type	Pull Drawer
Drawers	2-Tier Organization
DuraBase™ Solid Drawer Base	Yes
Drawer Divider	Yes

SmartThinQ® SMART FEATURES

Wi-Fi Enabled	Yes
Voice Activation	Yes
Works with SmartDiagnosis™	Google Assistant and Amazon Alexa
	Yes

MATERIALS AND FINISHES

Contour Door	Yes
Hidden Hinges	Yes
Surface	Smooth
Available Colour	Smudge Resistant Stainless Steel

DIMENSIONS/CLEARANCES/WEIGHTS

Depth with Handles	34 7/8"
Depth without Handles	32 3/8"
Depth without Door	27 3/4"
Depth (Total with Door Open)	36 7/8"
Height to Top of Case	68 3/8"
Height to Top of Door Hinge	69 3/4"
Width	35 3/4"
Width (Door Open 90° with Handle)	44 1/4"
Width (Door Open 90° without Handle)	39 1/4"
Door Edge Clearance with Handle	4 1/2"
Door Edge Clearance without Handle	1 1/3"
Installation Clearance	Sides 1/8", Top 1", Back 2"
Weight (Unit/Carton)	284 lbs. / 316lbs.
Carton Dimensions (WxHxD)	38" x 73" x 36"

LIMITED WARRANTY

Parts & Labor	1 Year
Sealed System	7 Years
Inverter Linear Compressor	10 Years

UPC CODES

LFXS26973S.ASTCNA0	048231797122
--------------------	--------------

Lot 35

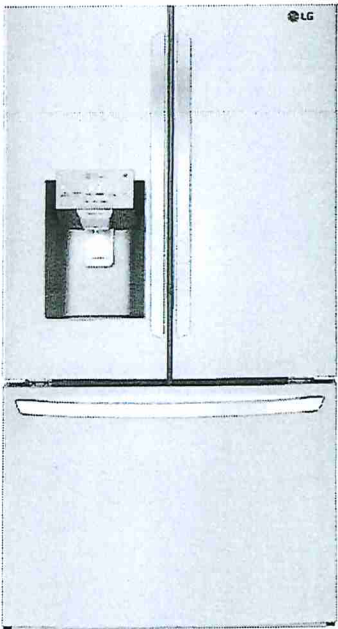

LG COOKING

LWC3063ST

Combi Wall Oven

1.7 cu.ft. Microwave (Speed Oven)

Infrared Heating™

4.7 cu.ft. Oven

Crisp Convection

Self+EasyClean

SmartThinQ® WiFi Technology

LOT 35

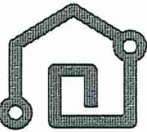
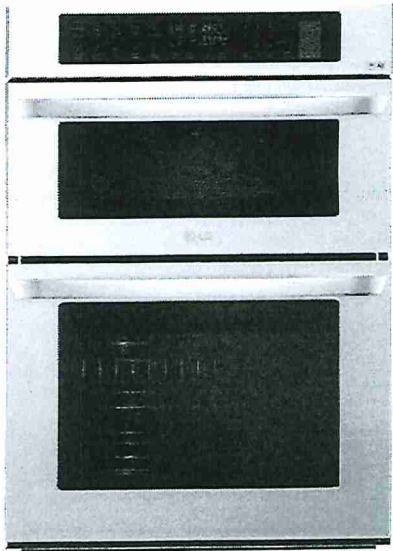

Enjoy new ways to control your home with LG smart appliances

- Start or stop your Oven remotely
- Set your Monitor Status from your smartphone
- Works with the LG SmartThinQ® app

SmartThinQ®



SUMMARY

Total Oven Capacity (cu. ft.)	6.4 (Upper & Lower)
Colors	Stainless Steel
UPPER OVEN FEATURES	
Capacity (cu.ft)	1.7
Interior(Cavity) - Upper MWO / Lower Oven	Stainless / Enamel Coating
Microwave Power output	950W
Microwave mode power consumption	1650W
Convection Bake mode power consumption	1550W
Broil mode power consumption	1650W
Convection Element (W)	1500W (Sheath heater)
Broil Upper Element (W)	1200W = 700W (Miracron heater) + 500W (Infrared Heating™)
Broil Lower Element (W)	375W (Miracron heater)
Microwave	Yes
Convection Bake	Yes
Broil	Yes
Speed cook	Yes (TurboCook™)
- # of Defrost (4 Menu)	Meat / Poultry / Fish / Bread
- # of Sensor cook (9 Menu)	Beverage / Casserole / Chicken / Pasta / Pizza / Plate of food / Rice / Soup / Vegetable Bacon (regular sliced) / Bagels (frozen) / Baked Corn dog (frozen) / Fresh vegetable / Frozen chicken wings / Frozen fries / Frozen chicken nuggets / Frozen pizza (regular crust) / Frozen soft pretzels / Frozen vegetable / Garlic bread (sliced, frozen) / Hamburger (1/2" thick) / Lamb chops (1/2" chick, 6-7oz) / Meat loaf (9" X 5") / Nachos / Oatmeal / Pork chops (1/2" thick, 6-7oz) / Quinoa / Rib eye steak (1" thick 14-15oz) / Rice / Salmon steak (1" thick) / Sausage / Sirloin steak (1" thick 18-21 oz) / Tenderloin / Vegetable-canned
- # of Auto cook (28 Menu)	
- # of Soften (4 Menu)	Butter & Margarine / Cream Cheese / Ice Cream / Frozen Juice
- # of Melt (5 Menu)	Butter / Caramel / Cheese / Chocolate / Marshmallow
LOWER OVEN FEATURES	
Capacity (cu.ft)	4.7
EasyClean®	Yes
Self Clean	Yes (3,4,5 hours)
Variable cleaning time	Yes (3,4,5 hours)
Variable broil	Yes (Full,Center / High,Med,Low)
Broil element	2,500 watts inner / 1,500 watts outer
Bake element	2,500 watts
Bake element type	Hidden (8 pass)
# of rack position	5
12 hrs. shut-off	Yes
- # of light	3 (Halogen Lamp - 3 dimension lighting)
Convection conversion	Yes
-Convection element	Yes (2,000 watts Sheath heater)
Convection System/Mode/Cooking System	Conventional
Convection Fan	Dual Speed (High/Low)
Oven Cooking mode	Conv.Bake / Conv.Roast / Bake / Broil / Steam Bake / Steam Roast / Probe / more mode (Favorite/Warm/Proof)
Oven Control Features	Glass Touch (SmoothTouch™)
Door Lock	Yes

CONTROL

Oven Control Type	Glass Touch (SmoothTouch™)
Display	White VFD
Language	English / French
Smart Function	Wi-Fi / Smart Buzzer
Clock	12 hr or 24 hr (option)
Kitchen Timer	Yes
Timed Cook	Yes
Temperature Unit of Measure	Fahrenheit / Celsius
Cooking Complete Reminder Volume	Beeper (1. Loud, 2. Low, 3. Mute)
APPEARANCE	
Available Colors	Stainless Steel
Handle/Knobs	Stainless Steel Finish (Aluminum)
Oven Door Feature	WideView™ Window
Scratch-Resistant	Yes
Smudge Resistant Finish	No

SmartThinQ™ SMART FEATURES

SmartDiagnosis™	Yes
Wi-Fi Connectivity	Yes
Works with SmartThinQ®	Google Assistant and Amazon Alexa
SmartThinQ®	
Yes	
DIMENSIONS/CLEARANCES/WEIGHT	
Shipping Weight (lbs)	244 lbs
Product Weight (lbs)	194 lbs
Product (W x H x D)	29 3/4" x 43 13/16" x 24 1/2"
Cut-out (W x H x D)	28 1/2" x 43 8/19" x 23 1/2"
Overall Depth (in) - including handle	26 7/8"
Actual Depth with Door Open (Upper) (in):	37.1"
Actual Depth with Door Open (Lower) (in):	45.7"
Oven Interior Dimensions (Upper) (in) (W x H x D)	20 8/11" x 8 9/25" x 17 5/13"
Oven Interior Dimensions (Lower) (in) (W x H x D)	24 1/2" x 17 5/8" x 18 7/8"
Carton Dimensions (in) (W x H x D)	33" x 30" x 50"
POWER/RATINGS	
Amp at 240V	32.5A
kW at 240V	7.8kW
Requirements	120 / 240 VAC, 120 / 208 VAC
ACCESSORIES	
Glass Tray(Upper)	Yes
Metal Tray(Upper)	Yes
Rack(Upper)	Yes
Broiler pan & Grid	Yes
Gliding Rack	1
Heavy Duty Rack	2
Meat probe	Yes
Scouring Pad	Yes
WARRANTY	
Parts & Labor	1 Year
UPC CODES	
LWC3063ST (Stainless Steel)	048231339810



LG COOKING

LWC3063ST

Combi Wall Oven

QUICK INSTALL & CLEARANCES

For full installation directions/clearances please refer to the corresponding User Manual and Installation Guide.

DIMENSIONS / CLEARANCES / WEIGHT	
Product Dimensions (in) (W x H x D)	29 3/4" x 43 13/16" x 24 1/2"
Cut-out (W x H x D)	28 1/2" x 43 8/19" x 23 1/2"
Overall Depth (in) - including handle	26 7/8"
Actual Depth with Door Open (Upper) (in):	37.1"
Actual Depth with Door Open (Lower) (in):	45.7"
Oven Interior Dimensions (Upper) (in) (W x H x D)	20 8/11" x 8 9/25" x 17 5/13"
Oven Interior Dimensions (Lower) (in) (W x H x D)	24 1/2" x 17 5/8" x 18 7/8"
Carton Dimensions (in) (W x H x D)	33" x 30" x 50"
POWER RATINGS	
Amp at 240V	32.5A
kW at 240V	7.8kW
Requirements	120 / 240 VAC, 120 / 208 VAC

INSTALLATION REQUIREMENTS

- The cabinet base platform must be able to support 202 lbs (91.65 kg) for a Microwave Combination Wall Oven. If the cabinet does not have a solid bottom, two braces or runners must be installed level with the bottom of the cutout to support the weight of the oven. Make sure the base is level and the front of the cabinet is square. If the cabinet base is not level, the oven racks will tend to slide out when opening the door.
- If marks, blemishes or the cutout opening are visible above the installed oven, it may be necessary to add wood shims under the runners and front trim until the marks or opening are covered.
- If the cabinet does not have a front frame and the sides are less than 3/4" (1.9 cm) thick, shim both sides equally to establish the cutout width.
- The junction box must be flush with the rear wall of the cabinet as shown below.
- Allow at least a 23" clearance for the door depth when it is open.
- Kitchen cabinets in contact with the oven must be heat resistant up to 194°F (90°C), and fronts of nearby units up to at least 158°F (70°C).

CUTOUT DIMENSIONS

- Cabinet Width: 30" (762 mm)
- Recommended Minimum Cutout Location from Floor:
  - Cutout Depth: 23 1/2" Min. (596.9 mm)
  - Cutout Width: 28 1/2" Min. (723.9 mm)  
28 5/8" Max. (727 mm)
  - Cutout Height: 43 7/16" Min. (1103 mm)  
43 1/2" Max. (1106 mm)

PRODUCT DIMENSIONS

LOT35



ELECTRICAL CONNECTIONS

- Be sure the wall oven is installed and grounded properly by a qualified installer or service technician.
- This wall oven must be electrically grounded in accordance with local codes or, in their absence, with the National Electrical Code ANSI/NFPA No.70- latest edition in United States, or with CSA Standard C22.1-1982 and C22.2 No.01982 (or latest edition), Canadian Electrical Code, Part 1, and all local codes and ordinances.
- This wall oven must be supplied with the proper voltage and frequency, and connected to an individual, properly grounded branch circuit, protected by a circuit breaker or fuse. For the circuit breaker or fuse required by this model, see the rating plate to find the wattage consumption and refer to the table below to get the circuit breaker or fuse amperage.
- A Microwave Combination Wall Oven can consume up to 7,800 W at 240 VAC. A 50 Amp circuit breaker with wire gauge #8 AWG must be used.
- Do Not ground to a gas pipe.
- Do Not have a fuse in the neutral or grounding circuit.
- A U.L.-listed conduit connector must be provided at the junction box.
- Prepare the electrical connection as follows:
  - Turn off the circuit breaker or remove fuses to the oven branch circuit.
  - With the oven positioned directly in front of the cabinet opening, connect the flexible conduit to the electrical junction box as shown below. Position the conduit in such a manner that it will lie on top of the oven in a natural loop when the oven is installed.
  - If local codes permit connection of the frame grounding conductor to the neutral(white) wire, follow the instructions for a 3-wire circuit connection.
  - If used in mobile homes or new construction, or a recreational vehicle, or local codes do not permit connection of the frame grounding conductor to the neutral(white) wire, follow the instructions for a 4-wire circuit connection.

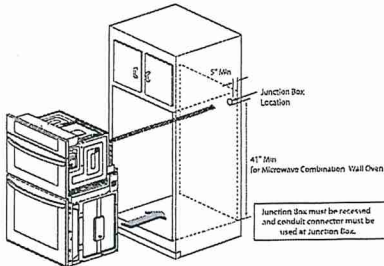

INSTALL THE OVEN

- Install the oven into the cabinet as follows:
  - Slide the oven into the opening.
    - Loop (do not tie) a 36" (91 cm) string around the conduit before the oven is slid into place. Lay the string over the top of the oven and use it to keep the conduit from falling behind the oven.
    - Lift oven into cabinet cutout using the oven opening as a grip. Carefully push against the oven front frame. Do not push against outside edges.
    - While sliding the oven back, pull the string so that the conduit lies on the top of the oven in a natural loop.
    - When you are sure the conduit is out of the way, slide the oven 3/4 way back into the opening. Remove the string by pulling on one end of the loop.
  - Secure the oven.
    - Using the mounting holes on the oven side trim as a guide, drill pilot holes for screws provided. (For securing the Combi Oven, use a minimum of 4 screws, one on each side in both the upper and lower ovens.)
    - Secure the oven to the cabinet with screws provided. If the cabinet is particle board, you must use 3/4" particle board screws. These may be purchased at any hardware store.
  - Install the metal bottom trim.
    - Place the metal bottom trim centered over the pre-drilled mounting holes on the lower base.
    - Using 3 screws provided, secure the bottom trim to the bottom edge of the cabinet.
  - Reinstall the oven door.

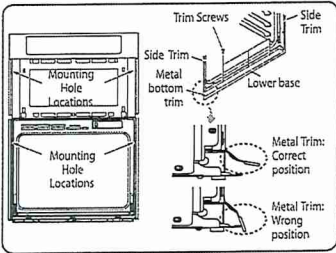

- To reduce the possibility of gas leaks, apply Teflon tape or a thread compound approved for use with LP or natural gases to all threaded connections.
- Flexible metal appliance connector (5/8" I.D.) A 3-foot length is recommended for ease of installation but other lengths are acceptable.
- Never use an old connector when installing a new cooktop.
- Flare union adapter for connection to gas supply line (3/4" or 1/2" NPT x 5/8" I.D.)
- Flare union adapter for connection to pressure regulator on cooktop. (1/4" NPT x 1/2" I.D.)
- Liquid leak detector or soapy water

LOT 35

Dimensions and Clearances

Provide enough clearance between the cooktop and adjacent combustible surfaces. These dimensions must be met for safe use of your cooktop. The location of the electrical outlet and pipe opening may be adjusted to meet specific requirements.

The cooktop must be placed with at least 2 3/4" of clearance to the back wall.

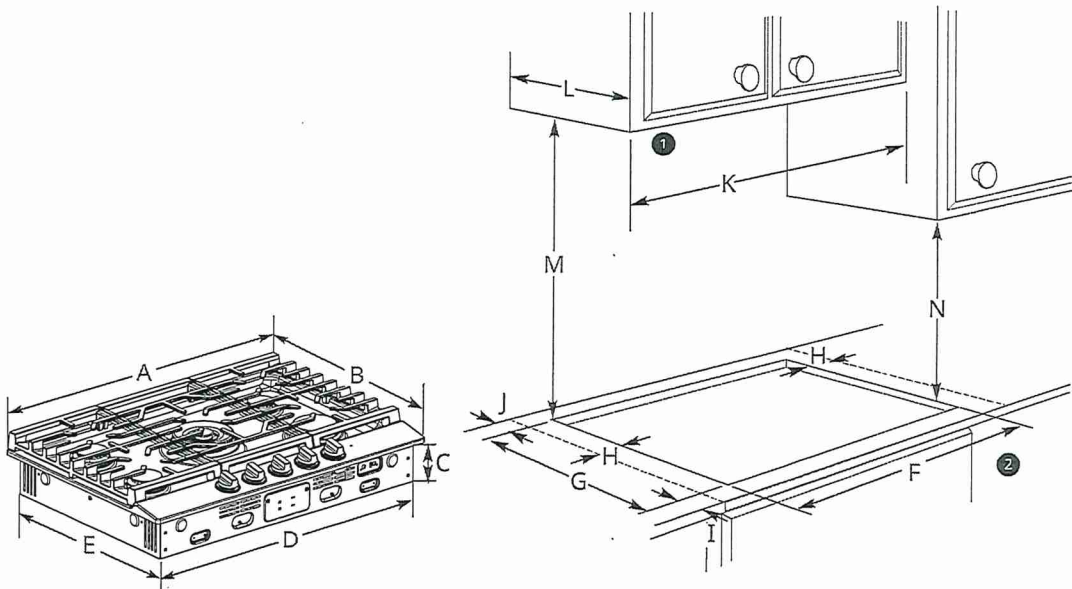

- ❶ Make sure wall coverings, countertop and cabinets around cooktop can withstand the heat (up to 200 °F) generated by the cooktop
- ❷ To ensure accuracy, it is best to make a template when cutting the opening in the counter

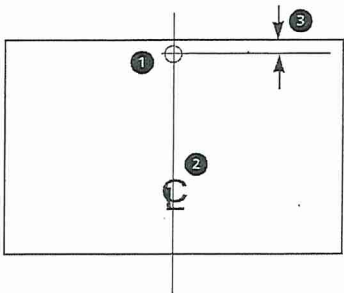

- ❶ Recommended gas supply location
- ❷ From cutout center line
- ❸ 1" min. from back wall



Lot 35

-	Dimension/Clearance	30" Cooktop	36" Cooktop
A	Width of upper plate	30" (760 mm)	36" (915 mm)
B	Depth of upper plate	21" (533 mm)	
C	Height of cooktop base	3 3/4" (95 mm)	
D	Width of cooktop base	28 1/4" (717 mm)	33 5/8" (854 mm)
E	Depth of cooktop base	19 3/8" (492 mm)	
F	Width of cutout	28 1/2" (724 mm)	33 7/8" (860 mm)
G	Depth of cutout	19 5/8" (498 mm)	
H	Distance from cutout to side wall on the left of unit. / Distance from cutout to side wall on the right of the unit.	≥11 13/16" (300 mm)	
I	Distance from front edge of cutout to front edge of countertop	≥1 5/8" (41 mm)	
J	Distance between cutout and the wall behind the cooktop	≥2 3/4" (69 mm)	
K	Width of unprotected overhead cabinets	≥30" (760 mm)	≥36" (915 mm)
L	Depth of unprotected overhead cabinets	≤13" (330 mm)	
M	Clearance from countertop to unprotected overhead surface	≥30" (760 mm)	
N	Clearance from countertop to nearest cabinet on either side of unit	≥18" (457 mm)	

Installing the Cooktop

Installing the Cooktop Unit

1    Locate the electrical outlet and gas shut-off valve in the cabinet beneath the cooktop. The access cap on the gas regulator must face the front of the cabinet and be easily accessible. Never reuse old flexible connectors. Install a manual shut-off valve 2 in the gas line in an easily accessible location outside the cooktop. Be sure you know how and where to shut off the gas supply to the cooktop. Install the electrical outlet 12" 1 below the countertop.

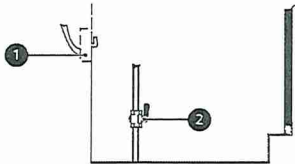

2    Carefully lower the cooktop into the countertop cutout, making sure not to trap any wires.

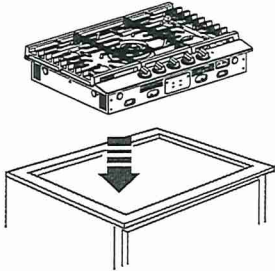

3    Remove the retainer brackets from the literature package.

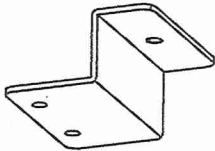

- 4** Install the retainer brackets **1** to the bottom of the cooktop unit **3**, then snug the screws **2** against the bottom of the countertop **4** as shown.

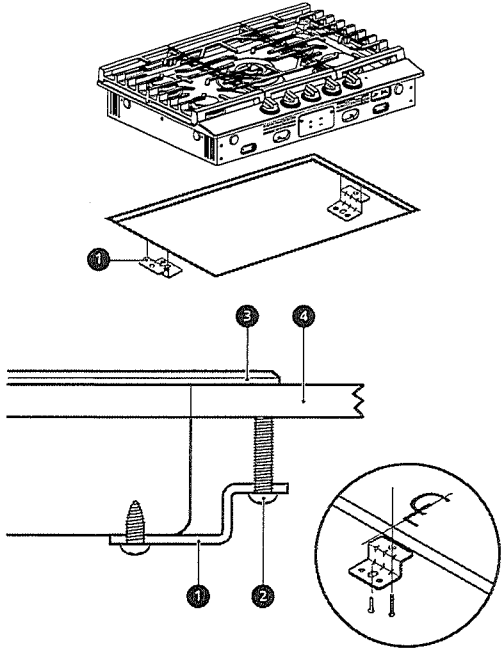

#### NOTE

- The retainer brackets **MUST** be installed to meet local codes or, in their absence, the National Electrical Code ANSI/NFPA No. 70, latest edition.

### 1. Providing Adequate Gas Supply

This cooktop is designed to operate at a pressure of 5" of water column with natural gas or 10" of water column with LP, propane or butane gas.

Make sure you are supplying your cooktop with the type of gas for which it is designed.

This cooktop is convertible for use with natural or propane gas. When using this cooktop with LP gas, the conversion must be made by a qualified LP installer before attempting to operate the cooktop using that gas.

For correct operation, the pressure of natural gas supplied to the regulator should be between 5" and 13" of water column.

For LP gas, the pressure supplied must be between 10" and 13" of water column.

When checking for correct operation of the regulator, the inlet pressure must be at least 1" more than the operating (manifold) pressure as given above.

The pressure regulator located at the inlet of the cooktop manifold must remain in the supply line regardless of whether natural or LP gas is being used.

A flexible metal appliance connector used to connect the cooktop to the gas supply line must have an I.D. of 5/8" and must be a maximum of 3 feet in length for easy installation. In Canada, flexible connectors should be single wall metal connectors less than 6 feet in length.

### 2. Connecting the Cooktop to Gas

Shut off the main gas supply valve before removing the old cooktop and leave it off until the new hook-up has been completed. Don't forget to relight the pilot on other gas appliances when you turn the gas back on.

Because hard piping restricts movement of the cooktop, the use of a CSA International-certified flexible metal appliance connector is recommended unless local codes require a hard-piped connection.

Never reuse an old connector when installing a new cooktop. If the hard piping method is used, you must carefully align the pipe; the cooktop cannot be moved after the connection is made.

To prevent gas leaks, put pipe joint compound on all male (external) pipe threads.

- 1 Install a manual gas line shut-off valve in the gas line in an easily accessed location outside of the cooktop. Be sure everyone operating the cooktop knows where and how to shut off the gas supply to the cooktop.
- 2 Install a male 1/2" flare union adapter to the 1/2" NPT internal thread at the inlet of the pressure regulator. Use a backup wrench on the pressure regulator fitting to prevent damage. Make sure that the access cap on the gas regulator is facing the front of the cabinet and is easily accessible through the cabinet doors.
- 3 Install a male 1/2" or 3/4" flare union adapter to the NPT internal thread of the manual shut-off valve, taking care to back-up the shut-off valve to keep it from turning.
- 4 Connect a flexible metal connector to the adapter on the cooktop. Position the cooktop to permit connection at the shut-off valve.

- 5 When all connections have been made, be sure all cooktop controls are in the off position and turn on the main gas supply valve. Check for gas leaks using a manometer. If a manometer is not available, turn the gas supply to the cooktop on and use a liquid leak detector at all joints and connections to check for leaks. Tighten all connections, if necessary, to prevent gas leakage in the cooktop or supply line.

**⚠ WARNING**

- DO NOT USE A FLAME TO CHECK FOR GAS LEAKS.
- The appliance and its individual shutoff valve must be disconnected from the gas supply piping system during any pressure testing of that system at test pressures in excess of 1/2 psi (3.5 kPa).
- The appliance must be isolated from the gas supply piping system by closing its individual manual shutoff valve during any pressure testing of the gas supply piping system at test pressures equal to or less than 1/2 psi (3.5 kPa).

**Flexible Connector Hookup**

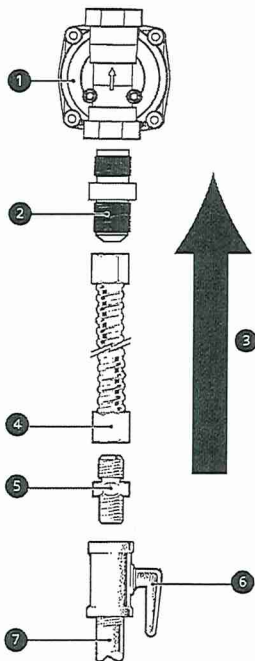

- 1 Pressure Regulator
- 2 Adapter
- 3 Gas Flow into Cooktop
- 4 Flex Connector (3 ft. max. in US, 6 ft. max. in Canada)

- 5 Adapter
- 6 Gas Shut-off Valve
- 7 1/2" or 3/4" Gas Pipe

LOT 35

**NOTE**

- Installer: Inform the consumer of the location of the gas shut-off valve.

**3. Electrical Connections**

**Electrical Requirements**

This cooktop requires a 120 Volt, 60 Hertz, properly grounded dedicated circuit protected by a 15 A or 20 A circuit breaker or time-delay fuse.

The appliance, when installed, must be electrically grounded in accordance with local codes or, in the absence of local codes, with the National Electrical Code, NFPA70 or the Canadian Electric Code, CSA C22.1-02.

**Grounding**

IMPORTANT: FOR PERSONAL SAFETY, THIS APPLIANCE MUST BE PROPERLY GROUNDED.

Preferred Method

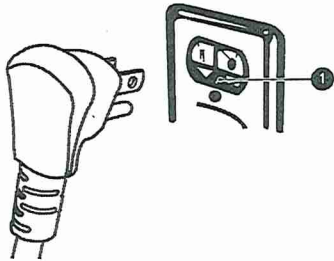

- 1 Ensure proper ground exists before use.

The power cord of this appliance should be equipped with a three-prong (grounding) plug which mates with a standard three-prong grounding wall receptacle to reduce the possibility of electric shock hazard from this appliance.

The customer should have the wall receptacle and circuit checked by a qualified technician to be sure the receptacle is properly grounded.

When connecting this cooktop, it is the personal responsibility and obligation of the customer to have a standard two-prong wall receptacle replaced with a properly grounded three-prong wall receptacle.





Clarification

PURCHASER'S EXTRAS QUOTATION

Castlemore Crossing - Phase 8 FORESTSIDE

PURCHASERS: NIMESH TAMRAKAR and SIRJANA,DEVI SHRESTHA

TEL:

LOT NUMBER	PHASE	HOUSE TYPE
35	8	BLUE ELDER (38-03C) - ELEV C

ITEM	EXTRA / CHANGE	QTY	UNIT PRICE	EXTENDED
1 225892	KITCHEN- Accommodate the cabinetry for Built in Oven/Micro, To be installed next to the Fridge	1		
2 225893	PURCHASER AWARE AND ACCEPTS THAT ANY CHANGES MADE TO UPGRADES AFTER SIGNING THIS PURCHASERS EXTRA FORM ARE SUBJECT TO A MINIMUM ADMINISTRATION FEE OF \$1,000	1		



Sub Total  
HST  
Total

- In the event the work on the house has progressed beyond the point where the items covered by this extra cannot be installed without entailing any unusual expense, then this order is to be cancelled and any deposit paid in connection with the same is to be refunded to the Purchaser.
- The Vendor will undertake to incorporate the work covered by the sales extra in the construction of the house but will not be liable to the purchaser in any way, if for any reason the work covered by the extra is not carried out. In that event, any monies paid in connection with the same shall be returned to the Purchaser.
- It is understood and agreed that if for any reason whatsoever the transaction of Purchase and Sale is not completed, the total cost of extras ordered are not refundable to the Purchaser(s).
- Extras or changes will not be processed unless signed by the Vendor.
- These extras may not be amended without the written consent of FORESTSIDE ESTATES INC..
- The Purchaser(s) and the Vendor acknowledge and agree that this form shall not be deemed to be part of the Agreement of Purchase and Sale entered into between them, nor an addendum thereto.
- No Estimates or orders will be accepted once construction has commenced.
- Prices are estimates only and guaranteed for a period of 5 days only.
- Any cancellations to this order, providing they can be cancelled, are subject to a \$500 minimum administration charge and a 10% cancellation charge for the total amount being cancelled.
- For Visa, Mastercard and Debit payments, transactions are identified on you statement as "SHERWAY CONSTRUCTION LTD", an Authorized Visa /Mastercard/Debit Merchant and authorized Royal Pine Homes company.

Payment Summary

Paid By	Amount
Amendment	
Total Payment:	

Bonus Summary

Bonus Package offering (includes taxes) from Royal Pine Homes Décor Centre is being applied to this order.  
Any remaining balance(s) will be applied accordingly to extras purchased.

Bonus Package Offering

Invoice Number	Date	Amount
8495	27-Jun-23	
Total Bonus Used:		
8537	12-Sep-23	
Total Bonus Used:		
Remaining Balance:		

PURCHASER:

DocuSigned by:  
NIMESH TAMRAKAR  
DocuSigned by:

05-Feb-24  
DATE

VENDOR:

PER: Forestside Estates Inc.

PURCHASER:

DocuSigned by:  
SIRJANA,DEVI SHRESTHA  
DocuSigned by:

05-Feb-24  
DATE

TAX#:86425 2416 RT0001

PREPARED BY: Laura Di Pede  
PRINTED: 5-Feb-24 at 12:54 pm  
RoyInvoiceSQL.rpt 07aug20

CONSTRUCTION SCHEDULING APPROVAL

PER: \_\_\_\_\_  
DATE: \_\_\_\_\_





CONSTRUCTION SUMMARY

Forestside Estates Inc.

PURCHASERS: NIMESH TAMRAKAR and SIRJANA,DEVI SHRESTHA

TEL:

LOT NUMBER	PHASE	HOUSE TYPE	CLOSING DATE
35	8	BLUE ELDER (38-03C) - ELEV C	30-Jul-24

Date Added: 20-Dec-23

Invoice Number: 8586

<p>1 - Install standard Cable Rough-ins (x2) and install Standard Telephone rough-ins (x2) (See Sketch)</p> <p>Note:</p>
<p>1 - GARAGE DOOR- Install the builders standard garage door handle with lock</p> <p>Note:</p>
<p>1 - THERMOFOIL CABINET - The purchaser was advised and therefore accepts and acknowledges that by installing thermofoil cabinets in the kitchen, they may result in the cabinet peeling due to the vapor and moisture of the stove and dishwasher.</p> <p>Note:</p>
<p>1 - KITCHEN- Standard Stainless Steel Exhaust Fan</p> <p>Note:</p>
<p>1 - KITCHEN - COUNTER - Install UPGRADED "L" EDGE throughout the kitchen where applicable. (see sketch)</p> <p>Note: ** PRICING FOR REVISED KITCHEN LAYOUT</p>
<p>1 - KITCHEN - CABINetry HARDWARE- Install UPGRADE 1 HANDLES (9351 128 BSN) throughout the kitchen where applicable.</p> <p>Note: *pricing for revised kitchen layout</p>
<p>1 - KITCHEN- DEEPER FRIDGE UPPERS in leiu of the standard To include applicable gables</p> <p>Note:</p>
<p>1 - KITCHEN - Install ROUGH-IN 220 VOLT to Accommodate Built-In Microwave (See Sketch)</p> <p>Note: **PLEASE NOTE - Above Price is subject to change once appliance specifications have been submitted and reviewed</p>
<p>1 - KITCHEN - Install ROUGH-IN Electrical for Built-In Wall Oven (See Sketch)</p> <p>Note: **PLEASE NOTE - Above Price is subject to change once appliance specifications have been submitted and reviewed</p>
<p>1 - KITCHEN - COUNTERTOP - Accomodate Stone Countertop for 30" Cook-Top Cut Out (See Sketch)</p> <p>Note: specifications required</p>
<p>1 - STAIRCASE - RAILING - Install UPGRADE 4 RAILING throughout from main to second.</p> <p>HANDRAIL-Mod Rectangle</p> <p>PICKETS-Steel 1/2" sq.,plain/ PTM-1S/Plain, w/ modern shoes</p> <p>POSTS-3 1/2" Sq. IRP-13 No Cap</p> <p>Note:</p>
<p>1 - STAIRCASE - Stain Oak Staircase from Main Floor to Second Floor, where applicable. To be Stained - Vintage Red Oak TITANIUM- To Include; Steps,Risers, Handrail and Post, and applicable Stringers (See Sketch)</p> <p>Note:</p>
<p>1 - MAIN FLOOR - HARDWOOD- Install UPGRADE HARDWOOD (5" Red Oak Titianium-UVF finish) throughout the main floor where applicable in lieu of the builder's standard natural hardwood.</p> <p>Note: To include; main hall, Den, Living/dining room, family room, upper hall and applicable landings</p>
<p>1 - KITCHEN - Install COMPLETE LED UNDER CABINET VALANCE LIGHTING with ONE (1) Seperate Switch - To be installed below upper cabinetry, where applicable (See Sketch)</p> <p>Note:</p>
<p>1 - KITCHEN - Install OPEN VALANCE MOULDING throughout the kitchen where applicable. To be installed underneath the upper cabinets.</p> <p>Note: Confirmed as per kitchen company</p>



CONSTRUCTION SUMMARY

Forestside Estates Inc.

PURCHASERS: NIMESH TAMRAKAR and SIRJANA,DEVI SHRESTHA

TEL:

LOT NUMBER	PHASE	HOUSE TYPE	CLOSING DATE	
35	8	BLUE ELDER (38-03C) - ELEV C	30-Jul-24	

Date Added: 20-Dec-23      Invoice Number: 8586

1 - KITCHEN - CABINETRY - Install DUAL RECYCLING BIN with soft close Note:
1 - KITCHEN - Install SOFT CLOSE throughout the kitcen where applicable. Note:
1 - KITCHEN- CABINETY- Install 30" COOKTOP WITH 2 POT DRAWERS Note:
1 - KITCHEN - CABINETRY- EXPAND EXISTING PANTRY by Approx 1'-0" Note:
1 - KITCHEN - CABINETRY- Install extra upper cabinets (Door way closure) Note:
1 - KITCHEN - CABINETRY- Install extra base cabinets (Door way closure) Note:
1 - KITCHEN - Install OPTIONAL 42" UPPER CABINETS IN LIEU OF 39" Note:
1 - KITCHEN - CABINETRY- Install CROWN MOULDING throughout the kitchen where applicable Note:
1 - KITCHEN - Install PAN throughout the kitchen where applicable Note:
1 - KITCHEN - Install FASCIA throughout the kitchen where applicable Note:
1 - PRIMARY ENSUITE - Install UPGRADED STONE COUNTERTOP (Emmerstone Calacatta Gold) Throughout the primary ensuite where applicable. Note: To be installed with builder's standard facucet
1 - PRIMARY ENSUITE - PLUMBING - Install upgraded Contract undermount sink CATENA Model #4210CIY (X2) SINKS **To include cut and polish Note: To be installed with standard faucet
1 - POWER ROOM - COUNTERTOP-Install EMMERSTONE STONE COUNTERTOP (Pure grey) Throughout the powder room where applicable. Note:
1 - POWDER ROOM - PLUMBING - Install upgraded Contract undermount sink CATENA Model #4210CIY (X1) SINK **To include cut and polish Note: To be installed with standard faucet
1 - KITCHEN - BACKSPLASH - Install FULL HEIGHT UPGRADE 1 Emmerstone CALACATTA GOLD throughout the kitchen backsplash where applicable. Does not include behind stove/fridge Note:
1 - KITCHEN - PLUMBING- Install UPGRADED UNDERMOUNT SINK (BLANCO QUATRUS U2 Model #401247) In lieu of the builder's standard sink. To include cut and polish (see sketch) Note: To be installed with builder's standard faucet





CONSTRUCTION SUMMARY

Forestside Estates Inc.

PURCHASERS: NIMESH TAMRAKAR and SIRJANA,DEVI SHRESTHA

TEL:

LOT NUMBER	PHASE	HOUSE TYPE	CLOSING DATE	
35	8	BLUE ELDER (38-03C) - ELEV C	30-Jul-24	

Date Added: 20-Dec-23

Invoice Number: 8586

1 - KITCHEN -Install builders standard counter top in the kitchen- Emmerstone MAPLE WHITE

Note: COUNTER TOPS

Purchaser accepts & acknowledges that the Stone slabs vary in size & all seams are visible & the fabricator reserves the right to position the seams as necessary.

1 - PURCHASER AWARE AND ACCEPTS THAT ANY CHANGES MADE TO UPGRADES AFTER SIGNING THIS PURCHASERS EXTRA FORM ARE SUBJECT TO A MINIMUM ADMINISTRATION FEE OF \$1,000

Note:

1 - PURCHASER HAS ATTENDED A STRUCTURAL AND COLOUR CHART APPOINTMENT AT THE DESIGN STUDIO AND HAS DECLINED ANY ADDITIONAL UPGRADES

Note:

Date Added: 12-Sep-23

Invoice Number: 8537

4 - BASEMENT - Increase FOUR (x4) Basement Windows from Standard 30 IN (W) x 16 IN (H) TO LARGER 30 IN (W) x 24 IN (H) (with Possible Window Wells) (See Sketch)

Note:

1 - BASEMENT - Install ONE (x1) ADDITIONAL BASEMENT WINDOW 30 IN (W) x 24 IN (H) (with Possible Window Well) (See Sketch)

Note: Location Approved by Tony

1 - SIDE EXTERIOR - Install OPTIONAL SIDE DOOR ENTRANCE (Includes Applicable Exterior Coach Light) \*\*If Grade Permits\*\* (See Sketch)

Note:

1 - FRONT EXTERIOR - Delete builders standard height single door with applicable side lites. Install DOUBLE DOOR EXTENDED HEIGHT (Delete Transom Window Above) (See Sketch)

Note:

1 - BASEMENT - Install Upgrade 200 AMP in lieu of builders standard 100 Amp (See Sketch)

Note:

1 - GARAGE - Re-Locate Central Vac Trunk Rough-In to Garage in lieu of Basement. (See Sketch)

Location Determined by Vendor

Note:

1 - KITCHEN - Install UPGRADE 8 INCH EXHAUST DUCT To Stove Area at kitchen, in lieu of builders standard 6 inch duct (See Sketch)

Note:

1 - KITCHEN - Install GAS LINE ROUGH-IN To Stove at Kitchen \*\*Includes Additional Applicable Electrical\*\* (See Sketch)

Note: PLEASE NOTE - Purchaser Accepts and Acknowledges that additional electrical requirements may be required once appliance specifications have been submitted and reviewed

1 - KITCHEN - Install WATER LINE ROUGH-IN To Fridge area at kitchen (See Sketch)

Note:

1 - KITCHEN - Close Opening between kitchen and living room/dining room (See Sketch)

Note: PLEASE NOTE - Purchaser accepts and acknowledges that additional cabinetry and/or countertop required will be discussed during decor appointment

1 - FRONT EXTERIOR - Install ONE (x1) FESTIVE SOFIT PLUG on a Single Pole Separate Switch (See Sketch)

Location of Switch to be determined by Vendor

Note:

1 - SECOND FLOOR - Install Upgrade SMOOTH CEILINGS Throughout Second Floor, where applicable. To Include; Upper Hall, Primary Bedroom, Bedroom #2, Bedroom #3, Bedroom #4 and Bedroom #5 (See Sketch)

Note:



**CONSTRUCTION SUMMARY**  
**Forestside Estates Inc.**

**PURCHASERS:** NIMESH TAMRAKAR and SIRJANA,DEVI SHRESTHA

**TEL:**

LOT NUMBER	PHASE	HOUSE TYPE	CLOSING DATE	
35	8	BLUE ELDER (38-03C) - ELEV C	30-Jul-24	

**Date Added:** 12-Sep-23

**Invoice Number:** 8537

1 - BONUS PACKAGE - PURCHASER HAS APPLIED \$20,000.00 (Incudes Taxes) WORTH OF UPGRADE PROMOTIONAL PACKAGE TOWARDS THE PURCHASE OF STRUCTURAL UPGRADES COMPLETED AT THE DECOR CENTRE

Note:

1 - PURCHASER HAS ATTENDED A STRUCTURAL APPOINTMENT AT THE DESIGN STUDIO & HAS DECLINED ANY ADDITIONAL UPGRADES.Purchaser accepts & acknowledges that there will be no further structural changes/additions/deletions to be made upon signing on SEPTEMBER 12,2023

Note:

1 - PURCHASER AWARE AND ACCEPTS THAT ANY CHANGES MADE TO UPGRADES AFTER SIGNING THIS PURCHASERS EXTRA FORM ARE SUBJECT TO A MINIMUM ADMINISTRATION FEE OF \$1,000

Note:

**Date Added:** 27-Jun-23

**Invoice Number:** 8495

1 - BASEMENT - Purchaser has declined the extended 9'-0" basement ceiling height

Note:

1 - PURCHASER AWARE AND ACCEPTS THAT ANY CHANGES MADE TO UPGRADES AFTER SIGNING THIS PURCHASERS EXTRA FORM ARE SUBJECT TO A MINIMUM ADMINISTRATION FEE OF \$1,000

Note:

**This Document is Extremely Time Sensitive - Printed 21 Dec 23 at 9:52**





\* INTERIOR COLOUR SCHEME \*

Purchasers	Decor Consultant	Model and Elevation	Telephone Res. / Bus	Project	Closing Date	Property
NIMESH TAMRAKAR & SIRJANA,DEVI SHRESTHA	Denise Sue	BLUE ELDER (38-03C) - ELEV C	/	Forestside Estates Inc.	30/07/2024	35

Page 1 of 3

	Flooring	Wall Title	Main	Accent/Insert	Border / Listello	Pattern	Plumbing
Primary Ensuite	13x13 Keaton Ice (STD)		8x10 Keaton Ice (STD)	N/A	N/A	N/A	White
Shared Bath #1	13x13 Cinq White (STD)		8x10 Cinq White (STD)	N/A	N/A	N/A	White
Shared Bath #2	13x13 New Reeds Silver		8x10 New Reeds Silver	N/A	N/A	N/A	White
Powder Room	12x24 Enduring White Matte (STD)		N/A	N/A	N/A	N/A	See Notes
Kitchen	12x24 Enduring White Matte (STD)		Emerskne Calacatta Gold Full Height Upgrade	N/A	N/A	N/A	See Notes
Laundry	12x24 Enduring White Matte (STD)		N/A	N/A	N/A	N/A	Std.
Mudroom	12x24 Enduring White Matte (STD)		N/A	N/A	N/A	N/A	
Foyer	12x24 Enduring White Matte (STD)						
Main Hall	5" x 3/4" Red Oak Titanium(Sculpted) (UPG)						
Family Room	5" x 3/4" Red Oak Titanium(Sculpted) (UPG)						
Living Room	5" x 3/4" Red Oak Titanium(Sculpted) (UPG)						
Dining Room	5" x 3/4" Red Oak Titanium(Sculpted) (UPG)						
Den	5" x 3/4" Red Oak Titanium(Sculpted) (UPG)						
Upper Hall	5" x 3/4" Red Oak Titanium(Sculpted) (UPG)						
Primary Bedroom	Mohawk Opening Night 4002 04						
Bedroom 2	Mohawk Opening Night 4002 04						
Bedroom 3	Mohawk Opening Night 4002 04						
Bedroom 4	Mohawk Opening Night 4002 04						
Bedroom 5	Mohawk Opening Night 4002 04						

Railings and Stairs				Cornice Moulding / Medallion			
Railings	Vintage Red Oak Titanium (UPG)	Landing - Upper	5" x 3/4" Vintage Red Oak Titanium	Foyer	N/A		
Pickets	12" Square Plain 17-19 Plain (UPG)	Landing - Lower	12x24 Enduring White Matte (STD)	Living Room	N/A		
Posts	Vintage Red Oak 3 1/2" Sq. IP-13 (UPG)	Ledge - Upper	N/A	Dining Room	N/A		
Stringers	Vintage Red Oak Titanium	Ledge - Lower	N/A	Family Room	N/A		
Treads	Vintage Red Oak Titanium			Main Hall	N/A		
Risers	Vintage Red Oak Titanium			Kitchen	N/A		
Runner	N/A			2nd Floor Hall	N/A		
Trim							
Baseboard & Casing	Standard Colonial	Knobs	STANDARD				
Front Door Glass	STANDARD	Hinges	STANDARD				
Interior Doors	STANDARD-CARRARA SMOOTH	Grip Set	STANDARD				

Notes  
PRIMARY ENSUITE - Install 2x2 WHITE MOSAIC Shower Floor tiles and 6" Curb with White Quartz  
\*\*KITCHEN-INSTALL UPGRADED UNDERMOUNT KITCHEN SINK- INSTALL THE BLANCO QUATRUS U2 MODEL#401247 \*\*POWDER ROOM-INSTALL UPGRADE UNDERMOUNT SINK CONTRAC CATENA 4210C1(X1)\*\*PRIMARY ENSUITE- INSTALL UPGRADE UNDERMOUNT SINK CONTRAC CATENA 4210C1(X2)\*\*

Page 1 of 3

Consultant: Denise Sue

Purchaser: Nimesh Tamrakar

Purchaser: Sirjana,Devi Shrestha

Vendor: Forestside Estates Inc.



\* INTERIOR COLOUR SCHEME \*

Purchasers	Decor Consultant	Model and Elevation	Telephone Res. / Bus	Project	Closing Date	Property
NIMESH TAMRAKAR & SIRJANA, DEVI SHRESTHA	Denise Sue	BLUE ELDER (38-03C) - ELEV C	/	Forestside Estates Inc.	30/07/2024	35

Page 2 of 3

	Interior Paint	Cabinet
	Description	Style
Primary Ensuite	Silver Birch (STANDARD)	Euro Melamine-White W100 White
Shared Bath #1	Silver Birch (STANDARD)	Euro Melamine-White W100 White
Shared Bath #2	Silver Birch (STANDARD)	Euro Melamine-White W100 White
Powder Room		
Kitchen/Breakfast	Silver Birch (STANDARD)	Euro Melamine-White W100 White
Laundry	Silver Birch (STANDARD)	Euro Melamine-Free Spirit L580 (Karisma)
Mudroom	Silver Birch (STANDARD)	Euro Melamine-White W100 White
Foyer		
Main Hall	Silver Birch (STANDARD)	
Family Room	Silver Birch (STANDARD)	
Living Room	Silver Birch (STANDARD)	
Dining Room	Silver Birch (STANDARD)	
Den	Silver Birch (STANDARD)	
Upper Hall	Silver Birch (STANDARD)	
Primary Bedroom		
Bedroom 2	Silver Birch (STANDARD)	
Bedroom 3	Silver Birch (STANDARD)	
Bedroom 4	Silver Birch (STANDARD)	
Bedroom 5	Silver Birch (STANDARD)	

Appliance Opening/Dimension			
Fridge Size	W 36in x H 70in	Range	Sid 31in Opening
Built-Ins	None	Microwave	None
Hood Fan	Sid 30in	Exhaust Opening	○ 6" ● 8"
Dishwasher Cabinet	Sid 24in Opening		

Fireplace			
Fireplace	Family Room	Fireplace	N/A
Location Flooring	5" HWD	Location Flooring	N/A
Style	Villa Nova	Style	N/A
Finish	Stone	Finish	N/A
Marble	NO	Marble	N/A
Hearth	NONE	Hearth	N/A

Decor Consultant: Denise Sue

Purchaser: Nimesh Tamrakar

Purchaser: Sirjana, Devi Shrestha

Vendor: Forestside Estates Inc.

Notes: KITCHEN- Standard Stainless Steel Exhaust Fan







# BLANCO

## Sink Specifications

Colour                      SKU  
brushed finish            401247

### Design and planning tips

- Min cabinet size: 36 in ( 915 mm )

#### Specifications:

3 ½" (90 mm) stainless steel strainer(s)

Installation instructions

Cut-out template

Mounting clips

Limited lifetime warranty

Depending on cabinet construction, a different cabinet size may be required.

### Codes & Standards

ASME A112.19.3-2017/CSA B45.4-17

### Optional Accessories

CapFlow Strainer Cover    517666  
Ash Cutting Board        406345  
Sink Grid                    406349

## QUATRUS U 2

Stainless steel brushed finish

Kitchen Sink

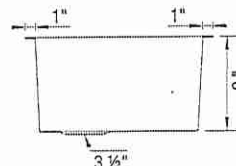
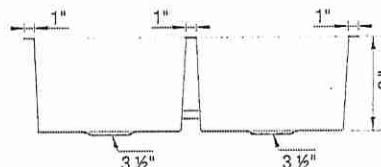
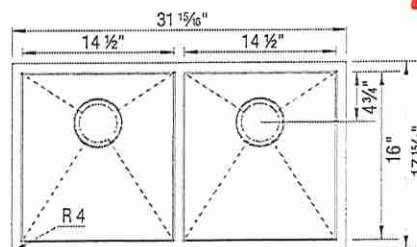

### Warranty

Limited lifetime warranty on all sinks and faucets. One-year warranty on all accessories and soap dispensers.

### Code/Standards Compliance

BLANCO sinks and faucets are third-party tested and certified to CSA, cUPC, ANSI/ASME, IAPMO and NSF standards and listed by applicable certification bodies. For more information on individual product listings, contact our office or listing organization.



Need support? Learn more by watching our sink & faucet How-to videos:

<https://www.blanco.com/ca-en/support/how-to-videos/how-to-videos-for-sinks/>



BLANCO Canada Inc  
100 Corporation Drive  
Brampton ON L6S 6B5

#### Tel & Fax

Tel: 905-494-2400 Toll free: 1-877-425-2626

Fax: 905-494-2425 Toll free: 1-877-825-2626

While BLANCO strives to provide accurate information, all images and dimensions in this document are intended for reference only and are subject to change at any time without notice. This document is not intended for use as an installation guide. For technical installation details, refer to installation instructions provided with the product. BLANCO assumes no responsibility for the use of superseded or voided specifications.

LOT 35 Forestside (Ph8)

LOT 35

**CONTRAC CATENA**

(x1)  
Powder Room & Primary Ensuite (x2)

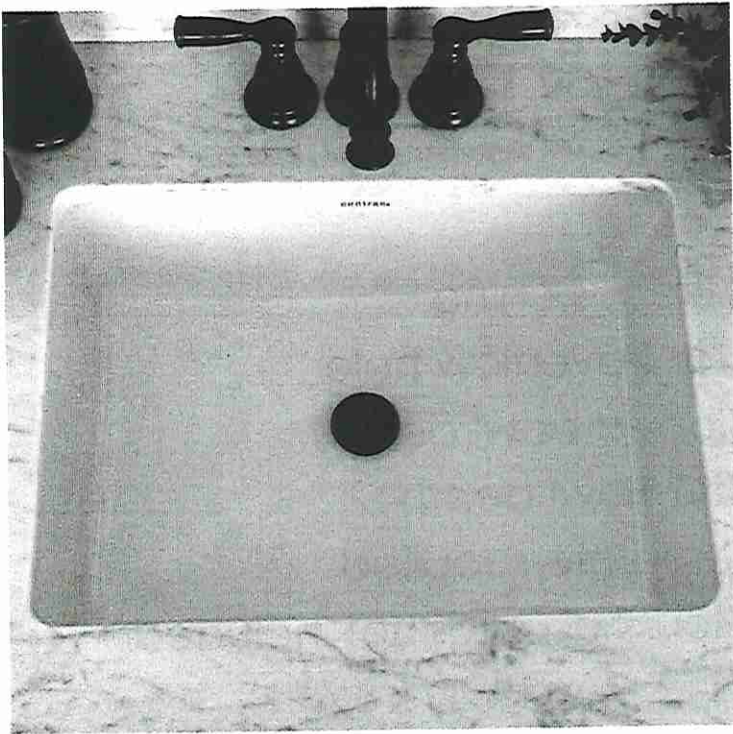

**Rectangular Undermount Sink**  
4210CIY

Vitreous china  
Front overflow hole  
Template supplied  
Faucet not included  
Mounting clips not included  
20" W x 15<sup>3</sup>/<sub>8</sub>" D x 7<sup>1</sup>/<sub>2</sub>" H

**\* Install Standard Faucet \***



LOT 35

# CONNOLLY

Marble & Granite Ltd.

## EDGE DETAILS

004

A.

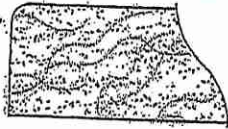

STRAIGHT EDGE  
(STANDARD - 3/4")

\* PRIMARY ENSUITE \*

\* POWDER ROOM

\*\* L.

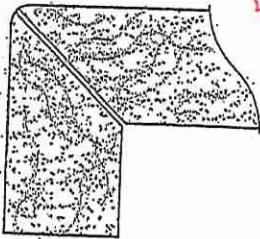

MITER WITH SKIRT EDGE  
(MEDIUM - 1 1/2")

\* KITCHEN \*

M.



OGEE - SQUARE EDGE  
(MED./HIGH - 1 1/2")

EDGING UP-GRADE OPTIONS

RECEIVED  
10/15/17

*Elisa*

KITCHENS & FINE CABINETRY LTD

8111 Jane St, Unit 10  
Courtland, Ontario L4K 4L7  
Tel: (905) 889-7028  
Fax: (905) 889-7503  
email: designstudio@villakitchens.ca  
www.villakitchens.ca

CLIENT: ROYAL PINE

PROJECT: FORESTSIDE PH 8

ADDRESS: RP-FS(Ø)-LOT 35

MODEL: 3B-03-ELEV A B C

KITCHEN

DOOR STYLE: EURO  
DOOR THICKNESS: 3/4"  
DOOR MATERIAL: MELAMINE  
(KARISMA)  
FINISH: FREE SPIRIT L580  
INTERIOR: WHITE  
CROWN MOLD: REG EURO CM  
PAN MOLD: SQUARE  
VALANCE: SQUARE OPEN  
INT HW: STANDARD  
INSTALL HEIGHT 98 5/8" H  
HW:  
COUNTERTOP: STONE BY OTHERS

LG 35

DS DS  
SOS V7

DRAWN BY: ELISA

DATE: JULY 6, 2023

REVISION: NOVEMBER 30, 2023

SCALE:

PAGE: 1 OF 5

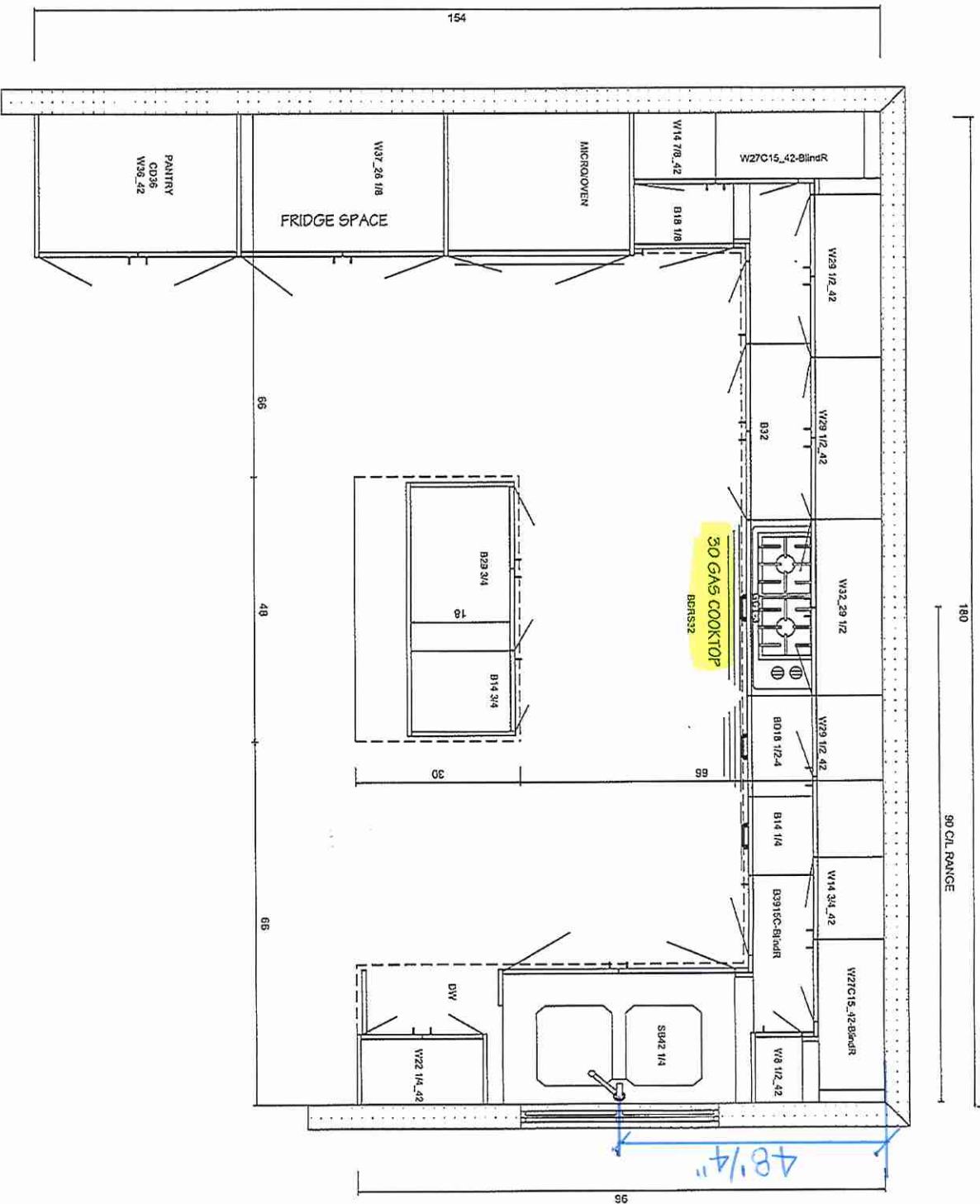



KITCHENS & FINE CABINETRY LTD

8111 Jane St, Unit 10  
Concord, Ontario L4K 4L7  
Tel: (905) 669-7028  
Fax: (905) 669-7503  
email: designstudio@vikklkitchens.ca  
www.vikklkitchens.ca

CLIENT: ROYAL PINE

PROJECT: FORESTSIDE PH B

ADDRESS: RP-FS(8)-LOT 35

MODEL: 38-03--ELEV A B C

FRIDGE WALL

DOOR STYLE: EURO  
DOOR THICKNESS: 3/4"  
DOOR MATERIAL: MELAMINE  
(KARISMA)  
FINISH: FREE SPIRIT L580  
INTERIOR: WHITE  
CROWN MOLD: REG EURO CM  
PAN MOLD: SQUARE  
VALANCE: SQUARE OPEN  
INT HW: STANDARD  
INSTALL HEIGHT 98 5/8"H  
HW:  
COUNTERTOP: STONE BY OTHERS

Len 35

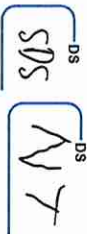

DRAWN BY: ELISA

DATE: JULY 6, 2023

REVISION: NOVEMBER 30, 2023

SCALE:

PAGE: 2 OF 5

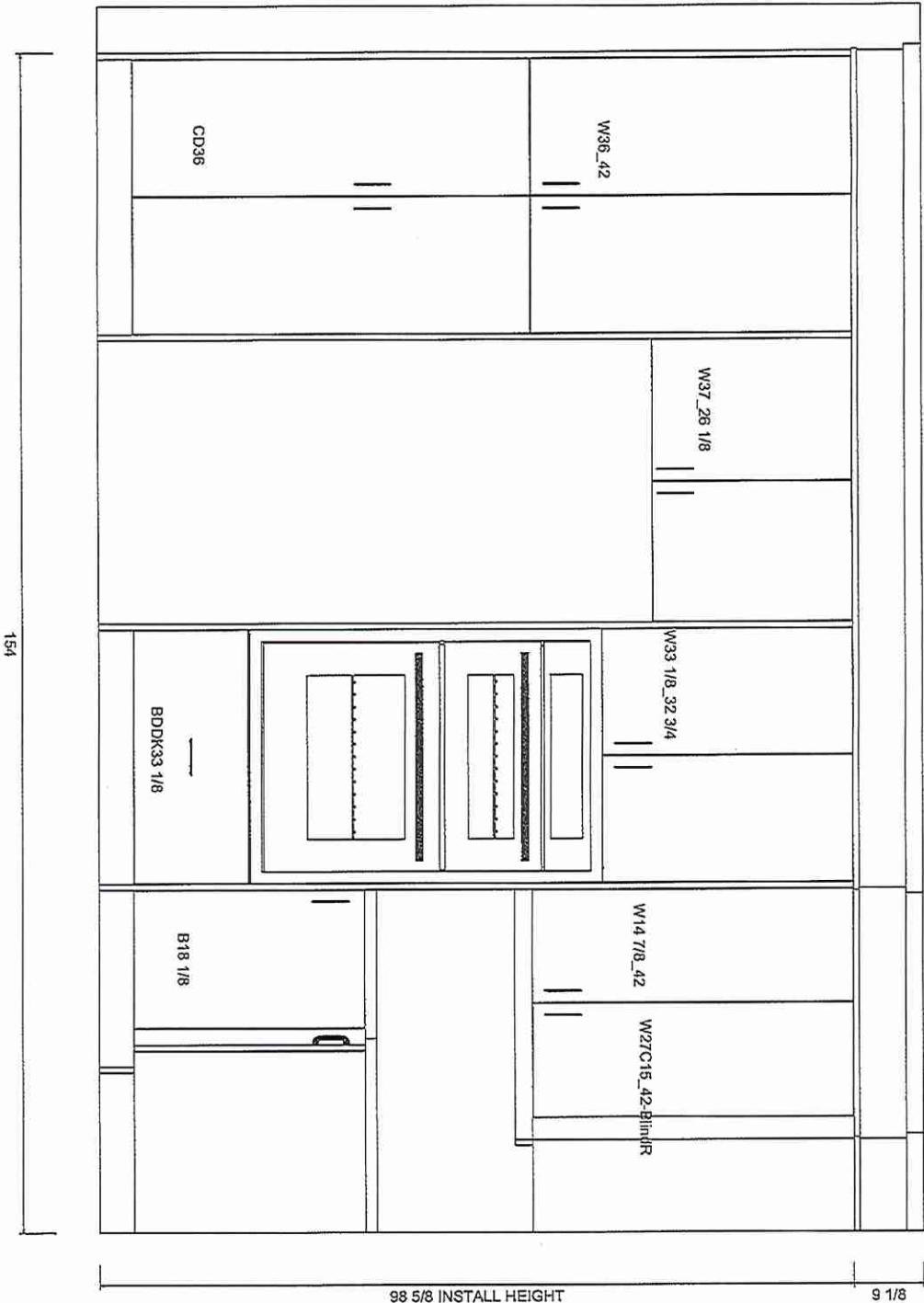





KITCHENS & FINE CABINETRY LTD

8111 Jane St, Unit 10  
Corcoran, Ontario L4K 4L7  
Tel: (905) 689-7028  
Fax: (905) 689-7303  
email: designstudio@vilakitchens.ca  
www.vilakitchens.ca

CLIENT: ROYAL PINE

PROJECT: FORESTSIDE PH 8

ADDRESS: RP-FS(8)-LOT 35

MODEL: 38-03-ELEV A B C

COOKTOP WALL

DOOR STYLE: EURO  
DOOR THICKNESS: 3/4"  
DOOR MATERIAL: MELAMINE  
(KARISMA)  
FINISH: FREE SPIRIT L580  
INTERIOR: WHITE  
CROWN MOLD: REG EURO CM  
PAN MOLD: SQUARE  
VALANCE: SQUARE OPEN  
INT HW: STANDARD  
INSTALL HEIGHT 98 5/8"H  
HW:  
COUNTERTOP: STONE BY OTHERS

Let 35

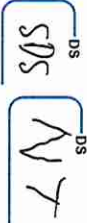

DRAWN BY: ELISA

DATE: JULY 6, 2023

REVISION: NOVEMBER 30, 2023

SCALE:

PAGE: 3 OF 5

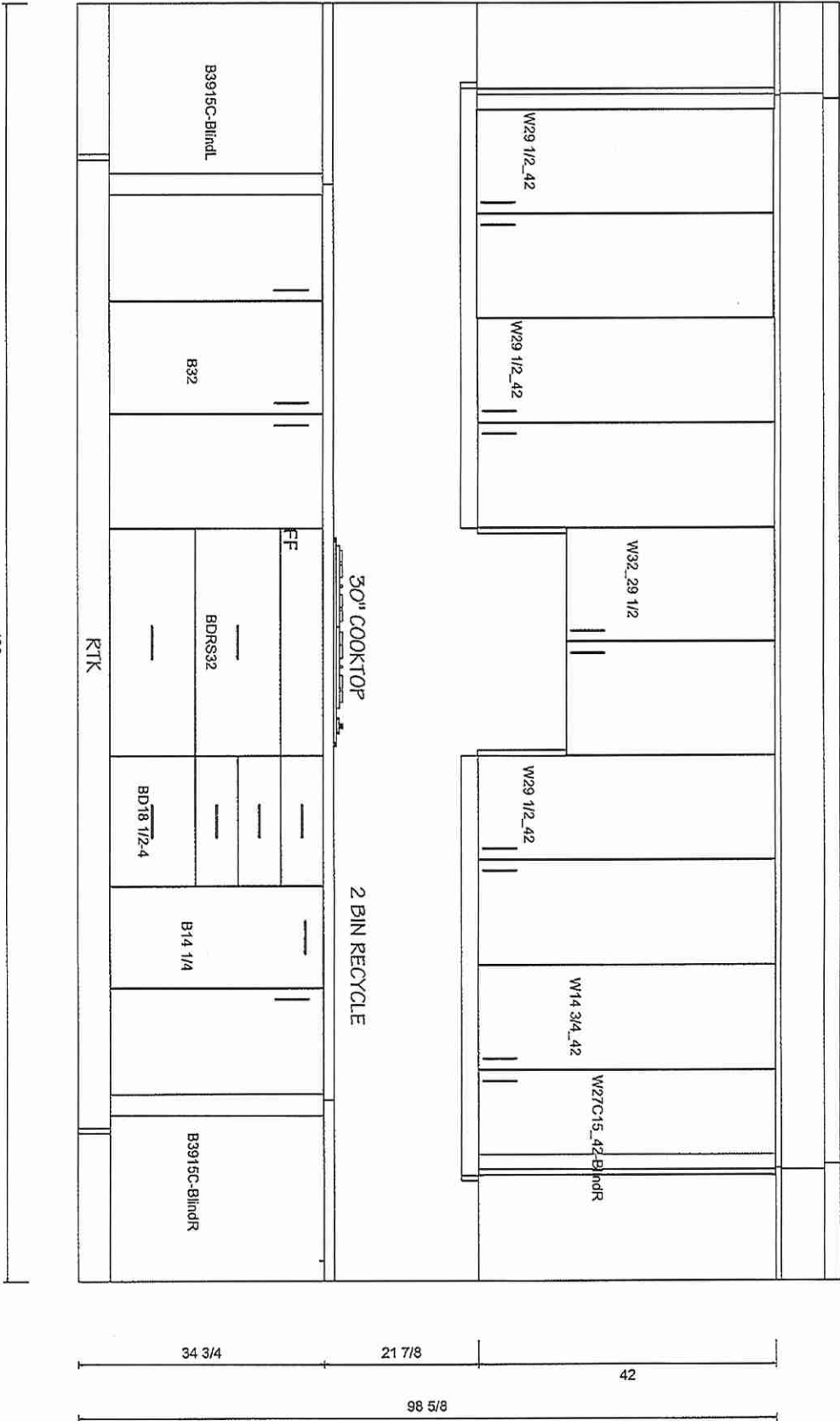



8111 Jane St. Unit 10  
Concord, Ontario L4K 4L7  
Tel: (905) 669-7028  
Fax: (905) 669-7903  
email: designstudio@vilakitchens.ca  
www.vilakitchens.ca

KITCHENS & FINE CABINETRY LTD

CLIENT: ROYAL PINE

PROJECT: FORESTSIDE PH 8

ADDRESS: RP-FS(8)-LOT 35

MODEL: 38-03-ELEV A B C

SINK WALL

DOOR STYLE: EURO

DOOR THICKNESS: 3/4"

DOOR MATERIAL: MELAMINE

(KARISMA)

FINISH: FREE SPIRIT L580

INTERIOR: WHITE

CROWN MOLD: REG EURO CM

PAN MOLD: SQUARE

PAN HW: STANDARD

INSTALL HEIGHT 98 5/8"H

HW: COUNTERTOP: STONE BY OTHERS

LOT 35

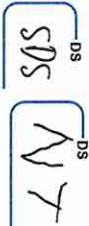

DRAWN BY: ELISA

DATE: JULY 6, 2023

REVISION: NOVEMBER 30, 2023

SCALE:

PAGE: 4 OF 5

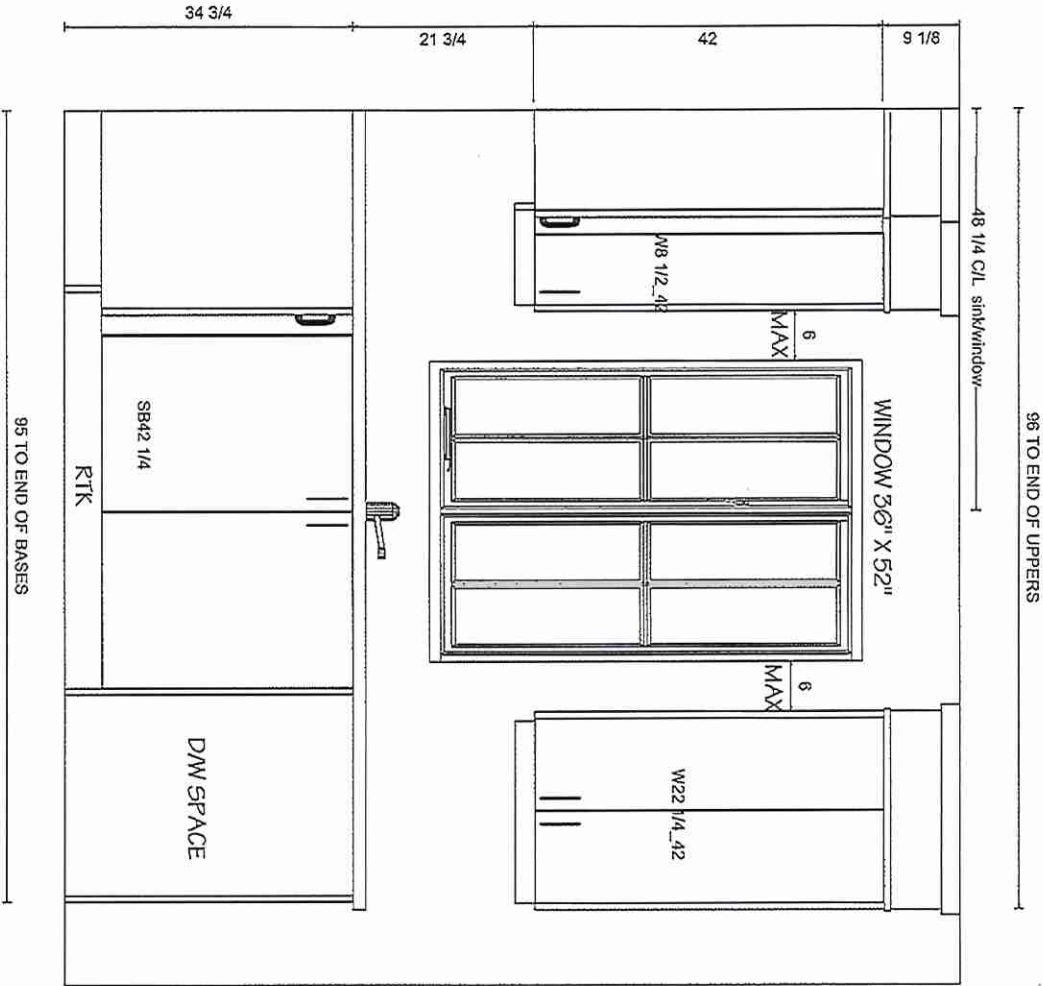

*Villa*  
KITCHENS & FINE CABINETRY LTD  
8111 Jane St. Unit 10  
Concord, Ontario L4K 4L7  
Tel. (905) 569-7028  
Fax. (905) 669-7903  
email: designstudio@villakitchens.ca  
www.villakitchens.ca

CLIENT: ROYAL PINE  
PROJECT: FORESTSIDE PH 8  
ADDRESS: RP-FS(8)-LOT 35  
MODEL: 38-03-ELEV A B C

ISLAND  
DOOR STYLE: EURO  
DOOR THICKNESS: 3/4"  
DOOR MATERIAL: MELAMINE (KARISMA)  
FINISH: FREE SPIRIT L580  
INTERIOR: WHITE  
CROWN MOLD: REG EURO CM  
PAN MOLD: SQUARE  
VALANCE: SQUARE OPEN  
INT HW: STANDARD  
INSTALL HEIGHT 98 5/8"H  
HW:  
COUNTERTOP: STONE BY OTHERS

lot 35

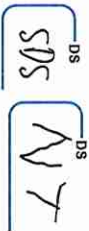

DRAWN BY: ELISA  
DATE: JULY 6, 2023  
REVISION: NOVEMBER 30, 2023  
SCALE:  
PAGE: 5 OF 5

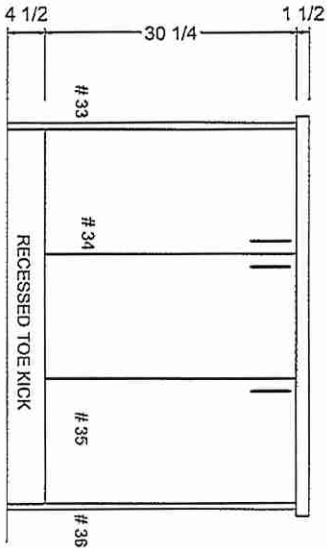

OUTLET LOCATION ON ISLAND TBD  
FOR THE CLIENT PRIOR PRODUCTION

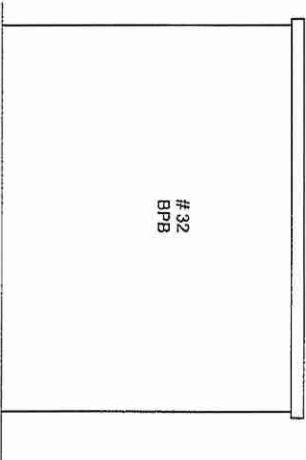
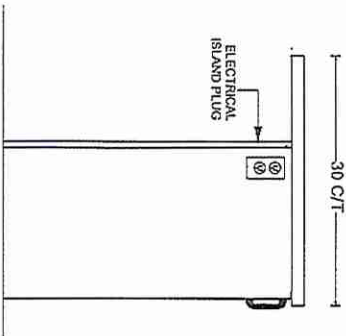
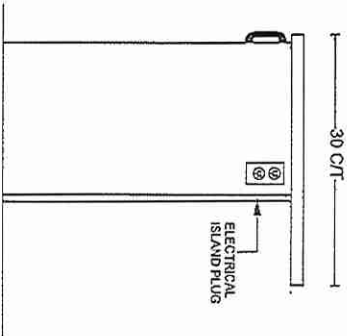



*Vika*  
KITCHENS & FINE CABINETRY LTD  
8111 Jane St. Unit 10  
Concord, Ontario L4K 4L7  
Tel. (905) 669-7028  
Fax. (905) 669-7903  
email: designstudio@vikakitchens.ca  
www.vikakitchens.ca

CLIENT: ROYAL PINE  
PROJECT: FORESTSIDE PH 8  
ADDRESS:  
MODEL: 38-03-ELEV A B C  
VANITIES

Lot 35  
Forestside (Pns)

DRAWN BY: LAI YEE  
DATE: JULY 6, 2023  
REVISION: NOVEMBER 8, 2023  
SCALE:  
PAGE: 5 OF 7

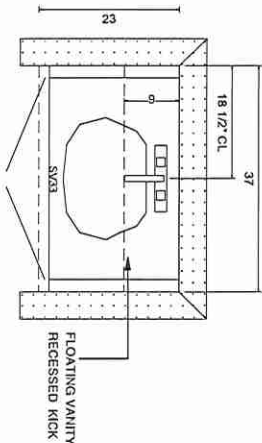

POWDER ROOM

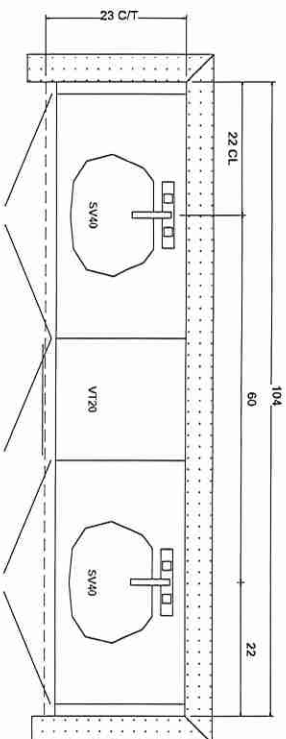

PRIMARY ENSUITE

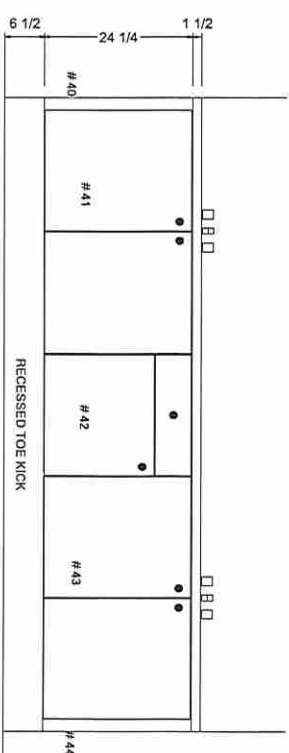
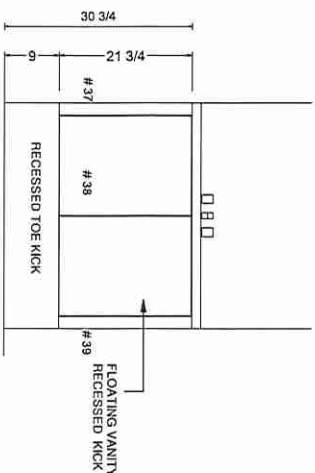

*Willa*  
KITCHENS & FINE CABINETRY LTD  
8111 Jane St, Unit 10  
Concord, Ontario L4K 4L7  
Tel: (905) 659-7028  
Fax: (905) 659-7303  
email: designstudio@willakitchens.ca  
www.willakitchens.ca

CLIENT: ROYAL PINE  
PROJECT: FORESTSIDE PH 8  
ADDRESS:  
MODEL: 38-03--ELEV A B C  
VANITIES

Lot 35  
Forestside (PH8)

DRAWN BY: LAI YEE  
DATE: JULY 6, 2023  
REVISION: NOVEMBER 8, 2023  
SCALE:  
PAGE: 6 OF 7

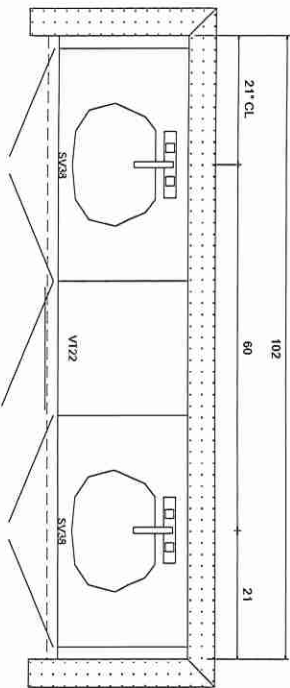

SHARED BATH 1 ( BEDROOM 2 & 3)

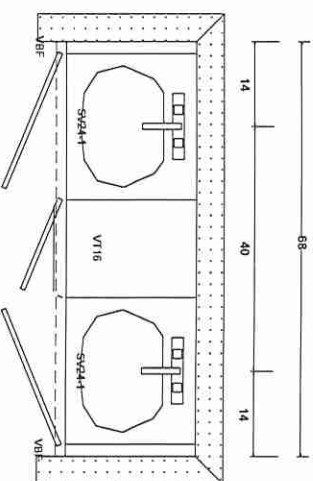

SHARED BATH 2 ( BEDROOM 4 & 5)

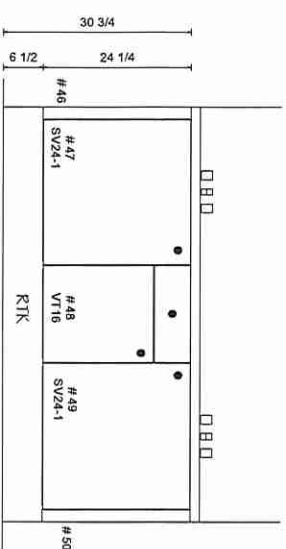
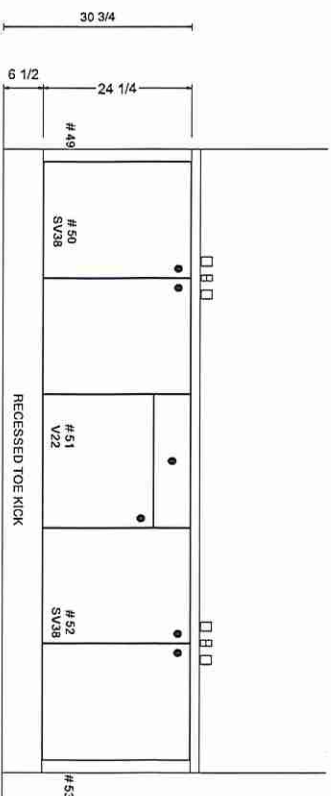

*Willa*  
KITCHENS & FINE CABINETRY LTD  
8111 Jane St, Unit 10  
Concord, Ontario L4K 4L7  
Tel. (905) 669- 7028  
Fax. (905) 669- 7903  
email: designstudio@willakitchens.ca  
www.willakitchens.ca

CLIENT: ROYAL PINE  
PROJECT: FORESTSIDE PH 8  
ADDRESS:  
MODEL: 38-03-ELEV A B C

LAUNDRY

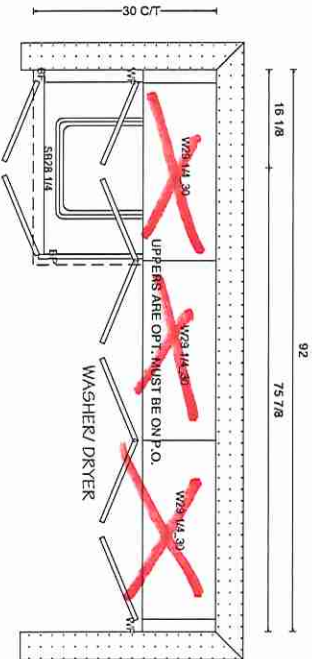

Lot 35  
Forestside (PH8)

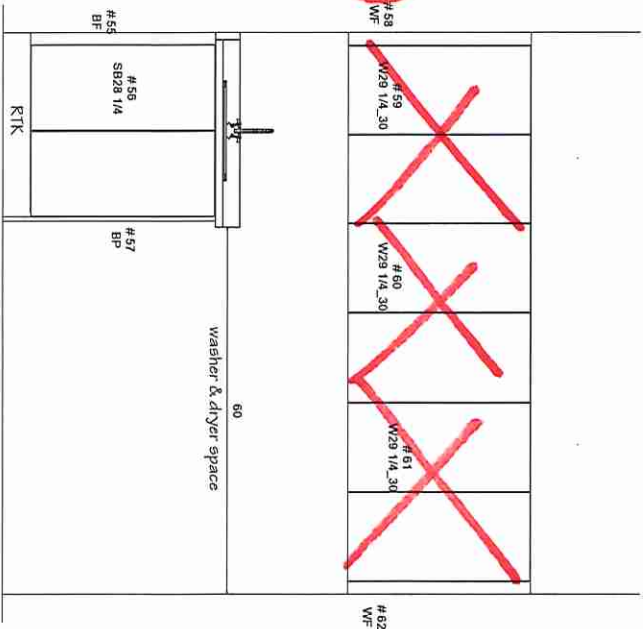

DRAWN BY: LAI-YEE  
DATE: JULY 6, 2023  
REVISION: NOVEMBER 8, 2023  
SCALE:  
PAGE: 7 OF 7