

## \* INTERIOR COLOUR SCHEME \*

Purchasers	Decor Consultant	Model and Elevation	Telephone Res. / Bus	Project	Closing Date	Property
RAMANDEEP, SINGH RAIKHI & GURPREET KAUR WALIA	Denise Sue	SABELLA-STD MAIN-5 BEDROOM-ELEVATION B	(416) 564-7270 / (416) 564-7272	2185715 Ontario Inc.		035

Page 1 of 3

Master Ensuite

Twin Bath 2/3

Ensuite #5

Ensuite #4

Powder Room

Kitchen/Dinette

Laundry

Foyer

Main Hall

Family Room

Living/Dining Room

Den

Upper Hall

Primary Bedroom

Bedroom 2

Bedroom 3

Bedroom 4

Bedroom 5

## Flooring

## Description

24x24 Eterna Imperial Grey Polished (Upgd)

13X13 MALENA ICE (STD)

13X13 GOSTA WHITE (STD)

13X13 Serpentine White

24X24 GEOLOGY STONE IVORY (UPGD)

24X24 GEOLOGY STONE IVORY (UPGD)

24X24 GEOLOGY STONE IVORY (UPGD)

24X24 GEOLOGY STONE IVORY (UPGD)

Vintage Red Oak 31/4"x3/4" BAJA Pearl (Upgd)

Vintage Red Oak 31/4"x3/4" BAJA Pearl (Upgd)

Vintage Red Oak 31/4"x3/4" BAJA Pearl (Upgd)

Vintage Red Oak 31/4"x3/4" BAJA Pearl (Upgd)

Vintage Red Oak 31/4"x3/4" BAJA Pearl (Upgd)

400Z OPENING NIGHT #04 (STD)

400Z OPENING NIGHT #04 (STD)

400Z OPENING NIGHT #04 (STD)

400Z OPENING NIGHT #04 (STD)

400Z OPENING NIGHT #04 (STD)

## Wall Tile

## Main

12x24 Eterna Imperial Grey Pol (Stack) (Upgd)

8X10 MALENA ICE (STD)

8X10 UNIWAL TENDER GREY (STD)

8X10 Serpentine White

N/A

4x16 Tender Grey (Stacked) (Upgd)

N/A

N/A

## Railings and Stairs

## Railings

Vintage Red Oak Baja Tudor (Upgd)

## Pickets

Single Collar/Plain Alt w/shoes Black (Upgd)

## Posts

Vintage Red Oak IRP-1 PC1 Cap (Upgd)

## Stringers

(STD) Vintage Red Oak Baja

## Treads

(STD) Vintage Red Oak Baja

## Risers

(STD) Vintage Red Oak Baja

## Runner

N/A

## Trim

## Baseboard &amp; Casing

COLONIAL (Traditional)-STD

## Front Door Glass

STANDARD

## Interior Doors

STANDARD- Carrara Smooth

## Accent/Insert

N/A

N/A

N/A

N/A/N/A

N/A

N/A

N/A

N/A

Landing - Upper

Landing - Lower

Ledge - Upper

Ledge - Lower

## Knobs

STANDARD

## Hinges

STANDARD

## Grip Set

STANDARD

## Border / Listello

N/A

N/A

N/A

N/A

N/A

N/A

N/A

N/A

## Pattern

N/A

N/A

N/A

N/A

N/A

N/A

N/A

N/A

## Plumbing

WHITE

WHITE

WHITE

WHITE

WHITE

STD

N/A

N/A

## Cornice Moulding / Medallion

## Foyer

N/A

## Living Room

N/A

## Dining Room

N/A

## Family Room

N/A

## Main Hall

N/A

## Kitchen

N/A

## 2nd Floor Hall

N/A

Page 1 of 3

Consultant:

Denise Sue

Purchaser:

RAMANDEEP, SINGH RAIKHI

RAMANDEEP, SINGH RAIKHI

Purchaser:

GURPREET KAUR WALIA

GURPREET KAUR WALIA

Vendor:

2185715 Ontario Inc.

Printed Nov 21, 2022 12:46 pm



PE 8439-1

Revision / Addition

PURCHASER'S EXTRAS QUOTATION

The Estates of West River - Phase 1 2185715 Ontario Inc.

PURCHASERS: RAMANDEEP, SINGH RAIKHI and GURPREET KAUR WALIA

TEL: RES.: 416-564-7270 BUS.: 416-564-7272

LOT NUMBER	PHASE	HOUSE TYPE
035	1	ISABELLA-STD MAIN-5 BEDROOM-ELEVATION B

ITEM	EXTRA / CHANGE	QTY	UNIT PRICE	EXTENDED
1	FAMILY ROOM- Delete the 24"x30" (X2) (approx) windows on either side of the Fireplace and install TWO (x2) 24"x69" Fixed windows on either side of the fireplace. (See Sketch)	1		
220220	Approved As Per Fonzie			
*2	PURCHASER AWARE AND ACCEPTS THAT ANY CHANGES MADE TO UPGRADES AFTER SIGNING THIS PURCHASERS EXTRA FORM ARE SUBJECT TO A MINIMUM ADMINISTRATION FEE OF \$1,000 PLUS A 10% HOLDBACK FEE.	1		
20080				
220221				



Sub Total  
HST  
Total

- In the event the work on the house has progressed beyond the point where the items covered by this extra cannot be installed without entailing any unusual expense, then this order is to be cancelled and any deposit paid in connection with the same is to be refunded to the Purchaser.
- The Vendor will undertake to incorporate the work covered by the sales extra in the construction of the house but will not be liable to the purchaser in any way, if for any reason the work covered by the extra is not carried out. In that event, any monies paid in connection with the same shall be returned to the Purchaser.
- It is understood and agreed that if for any reason whatsoever the transaction of Purchase and Sale is not completed, the total cost of extras ordered are not refundable to the Purchaser(s).
- Extras or changes will not be processed unless signed by the Vendor.
- These extras may not be amended without the written consent of 2185715 Ontario Inc..
- The Purchaser(s) and the Vendor acknowledge and agree that this form shall not be deemed to be part of the Agreement of Purchase and Sale entered into between them, nor an addendum thereto.
- No Estimates or orders will be accepted once construction has commenced.
- Prices are estimates only and guaranteed for a period of 5 days only.
- Any cancellations to this order, providing they can be cancelled, are subject to a \$500 minimum administration charge and a 10% cancellation charge for the total amount being cancelled.
- For Visa, Mastercard and Debit payments, transactions are identified on you statement as "SHERWAY CONSTRUCTION LTD", an Authorized Visa /Mastercard/Debit Merchant and authorized Royal Pine Homes company.

Payment Summary	
Paid By	Amount
Amendment	
Total Payment:	

Bonus Summary		
Bonus Package offering (includes taxes) from Royal Pine Homes Décor Centre is being applied to this order.		
Any remaining balance(s) will be applied accordingly to extras purchased.		
Bonus Package Offering		
Invoice Number	Date	Amount
8401	1-Dec-22	
Total Bonus Used:		
7890	14-Jul-22	
Total Bonus Used:		
Remaining Balance:		

PURCHASER: DocuSigned by: Ramandeep Singh Raikhi 05-Jan-23  
RAMANDEEP, SINGH RAIKHI DATE  
PURCHASER: Gurpreet Kaur Walia 05-Jan-23  
GURPREET KAUR WALIA DATE

VENDOR: PER: 2185715 Ontario Inc.

CAX#:1

PREPARED BY: Laura Di Pede  
PRINTED: 5-Jan-23 at 12:05 pm  
toyInvoiceSQL.rpt 07aug20

CONSTRUCTION SCHEDULING APPROVAL	
PER:	
DATE:	



(C) cable (includes steel attic w/ cable as per features list)  
 (T) Telephone  
 (E) Electric  
 Am. Room → surround Sound (S)  
 (ATL) (X3) \* CONDUIT ATTIC TO BSMT  
 \* Relocate

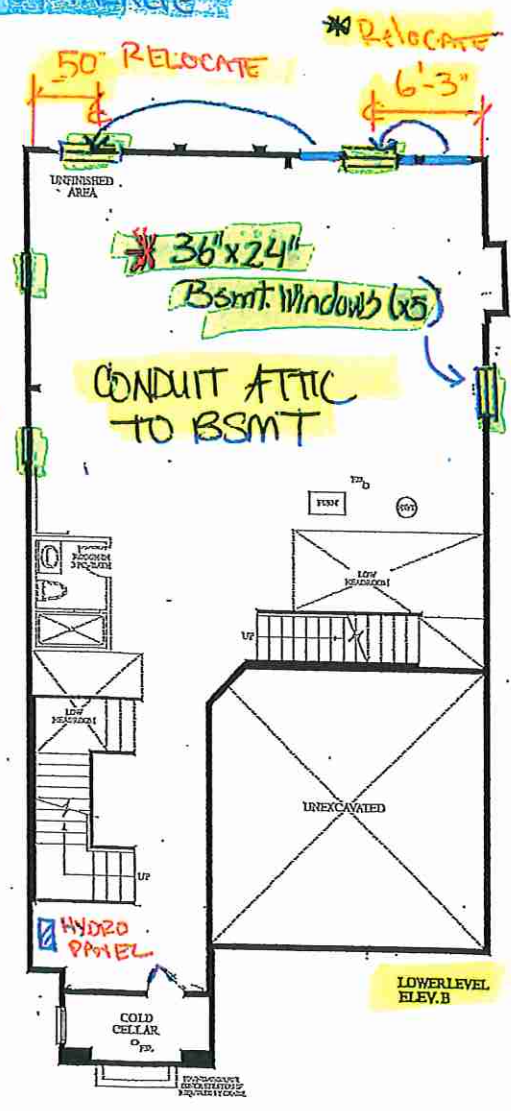

\* CHIMNEY HOOD FAN  
 204"

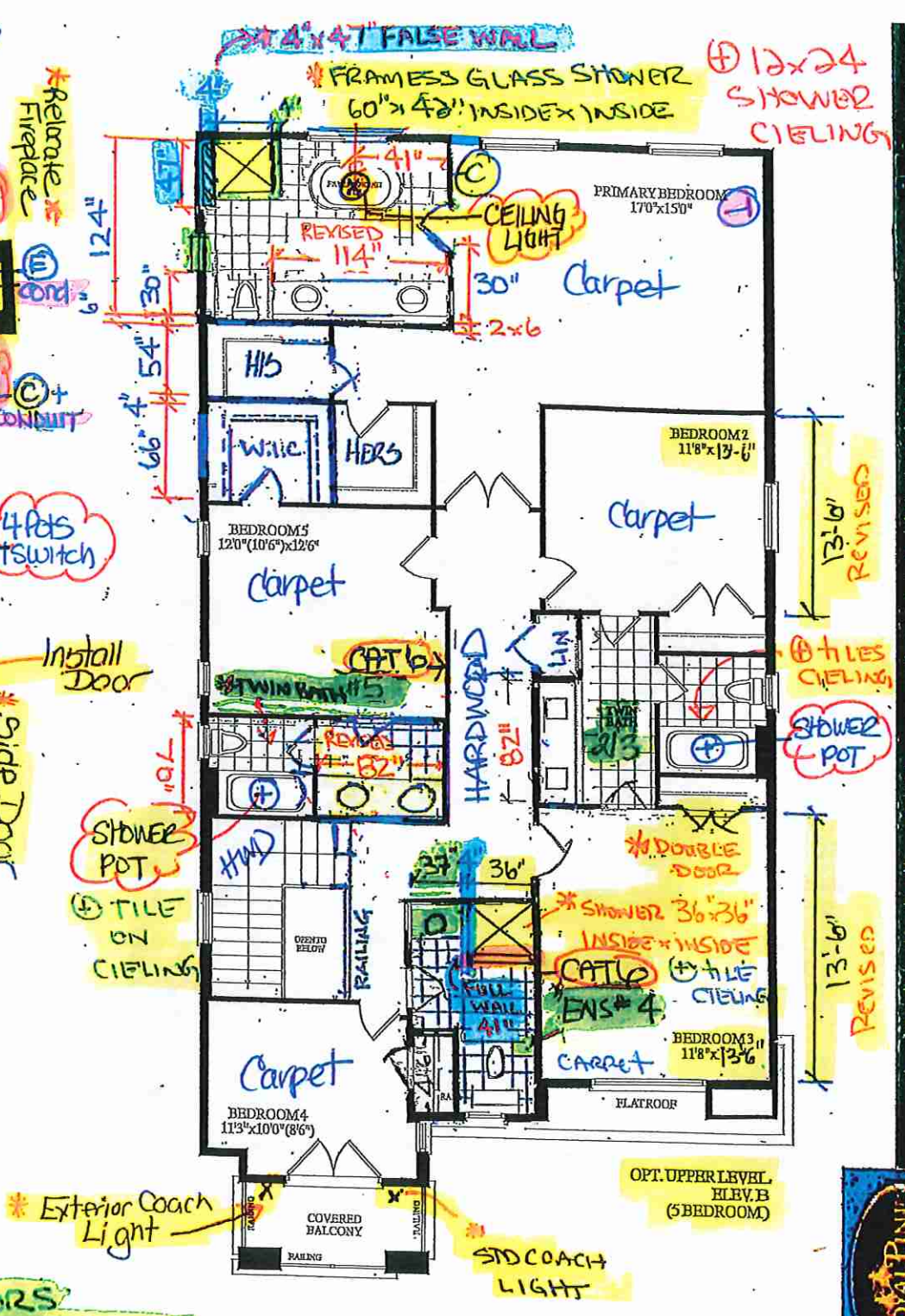

DOUBLE EXTENDED  
 HEIGHT FRONT DOORS  
 (3/4 GLASS w/ mullions)





KCGS956ESS

LOT 35 . WRV

KitchenAid®

36" 5-Burner Gas Cooktop with Griddle

<http://www.kitchenaid.com>

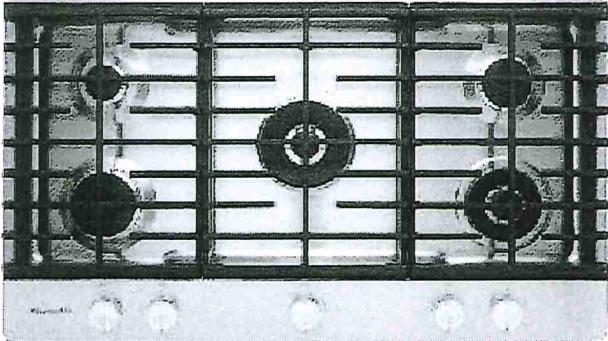

Key Features:

- Even-Heat™ 10K BTU Torch Burner
- 20K BTU Professional Dual Ring Burner
- CookShield Finish
- Lighted Knobs
- Even-Heat™ 6K BTU Simmer Burner
- Removable Griddle
- Electronic Ignition and Automatic Reignition
- Full-Width Cast-Iron Grates
- LP Conversion Kit Included

Product Dimensions:

Height: 3 11/16  
Width: 36 1/4  
Depth: 21

Electrical Requirements:

15.

Additional Information:

- [Use And Care Guide](#)
- [Dimension Guide](#)
- [Installation Guide](#)
- [Warranty Certificate](#)

Available in:

☒ Stainless Steel

INVESTED  
IN  
AMERICA



©Registered trademark/TM Trademark of Whirlpool, U.S.A. © 2016 Whirlpool Corporation. All Rights Reserved.  
All other trademarks are owned by their respective companies.  
Because Whirlpool Corporation policy includes a continuous commitment to improve our products, we reserve the right to change materials and specifications without notice. We also reserve the right to discontinue or transition products without notice.  
Manufacturer's Suggested Retail Price (MSRP) and Minimum Advertised Price (MAP) provided for reference purposes only. Dealer alone determines advertised and retail prices.  
Created On: Friday, March 03, 2017 08:08:55



30" (76.2 CM) AND 36" (91.4 CM) GAS BUILT-IN COOKTOP

LOT 35

PRODUCT MODEL NUMBERS

KCGS350E	KCGS955E	MGC9530D	WCG75US0D
KCGS356E	KCGS956E	MGC9536D	WCG97US0D
KCGS550E	MGC7430D	WCG51US0D	WCG97US6D
KCGS556E	MGC7536D	WCG51US6D	

GAS SUPPLY REQUIREMENTS

Type of Gas

Natural Gas:

- This cooktop is factory set for use with Natural gas. If converting to LP gas, see the "LP Gas Conversion" instructions provided in the package containing literature. The model/serial rating plate located on the underside of the cooktop base has information on the types of gas that can be used. If the types of gas listed do not include the type of gas available, check with the local gas supplier.

LP Gas Conversion:

Conversion must be done by a qualified service technician.

No attempt shall be made to convert the cooktop from the gas specified on the model/serial rating plate for use with a different gas without consulting the serving gas supplier. See the Gas Conversion instructions provided in the package containing literature.

Gas Supply Line

- Provide a gas supply line of 3/4" (1.9 cm) rigid pipe to the cooktop location. A smaller size pipe on longer runs may result in insufficient gas supply. Pipe-joint compounds that resist the action of LP gas must be used. Do not use TEFLON<sup>®</sup> tape. With LP gas, piping or tubing size should be 1/2" minimum. Usually, LP gas suppliers determine the size and materials used in the system.

Flexible metal appliance connector:

- If local codes permit, use a 1/2" or 3/4" I.D. flexible stainless steel tubing gas connector, designed by CSA to connect the cooktop to the rigid gas supply line.

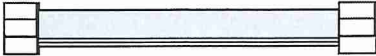

- A 1/2" male pipe thread is needed for connection to the female pipe threads of the inlet to the cooktop pressure regulator.
- Do not kink or damage the flexible metal tubing when moving the cooktop.

- Must include a shutoff valve:  
The supply line must be equipped with a manual shutoff valve. This valve should be located in the same room but external to the cooktop opening, such as an adjacent cabinet. It must be accessible without removing the cooktop, and it should be in a location that allows ease of opening and closing. Do not block access to shutoff valve. The valve is for turning on or shutting off gas to the cooktop.

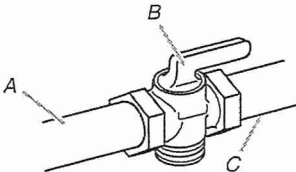

A. Gas supply line  
B. Shutoff valve "open" position  
C. To cooktop

<sup>†</sup>TEFLON is a registered trademark of E.I. Du Pont De Nemours and Company.

ELECTRICAL REQUIREMENTS

- A 120 volt, 60 Hz, AC only, 15-amp, fused electrical circuit is required. A time-delay fuse or circuit breaker is also recommended. It is recommended that a separate circuit serving only this cooktop be provided.
- Electronic ignition systems operate within wide voltage limits, but proper grounding and polarity are necessary. Check that the outlet provides 120-volt power and is correctly grounded.



KCGS550ESS and KCGS950ESS Models

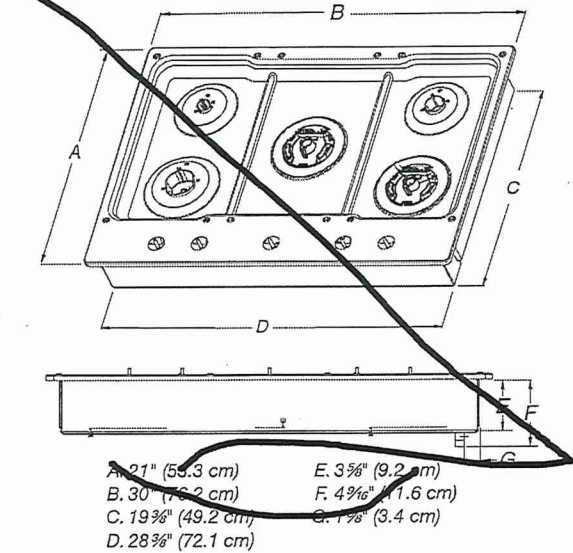

KCGS556ESS and KCGS956ESS Models

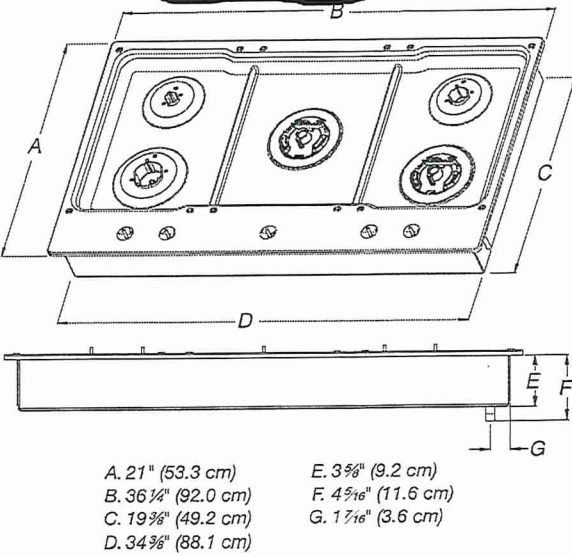

All Other 30" (76.2 cm) Models

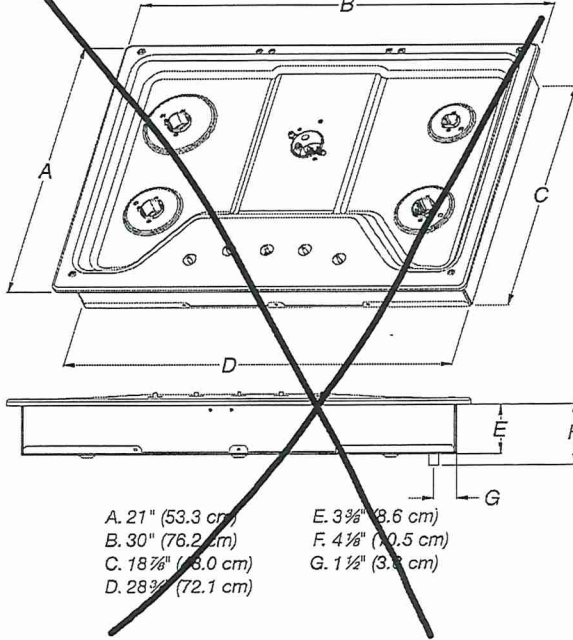

All Other 36" (91.4 cm) Models

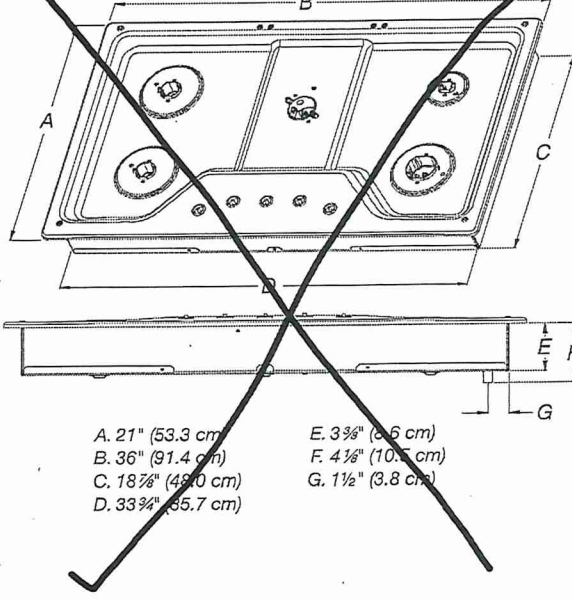



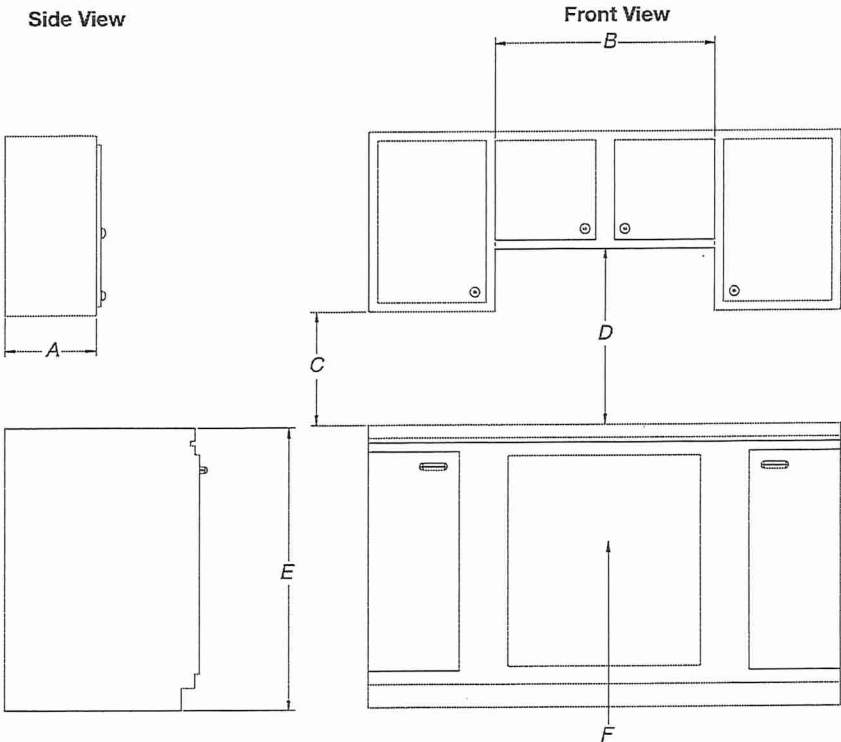

- A. 13" (33.0 cm) recommended upper cabinet depth.
- B. 30" (76.2 cm) for 30" models; 36" (91.4 cm) for 36" models.
- C. 18" (45.7 cm) minimum clearance from upper cabinet to countertop within minimum horizontal clearances to cooktop.
- D. 30" (76.2 cm) minimum clearance between top of cooktop platform and bottom of uncovered wood or metal cabinet. 24" [61 cm] minimum clearance if bottom of wood or metal cabinet is covered by not less than 1/4" [0.6 cm] flame retardant millboard covered with not less than No. 28 MSG sheet steel, 0.015" [0.04 cm] stainless steel, or 0.024" [0.06 cm] aluminum or 0.020" [0.05 cm] copper
- E. 36" (91.4 cm) top of countertop to floor.
- F. Gas line opening - Wall: anywhere 5" (12.7 cm) below underside of countertop. Cabinet floor: anywhere within 6" (15.2 cm) of rear wall is recommended.



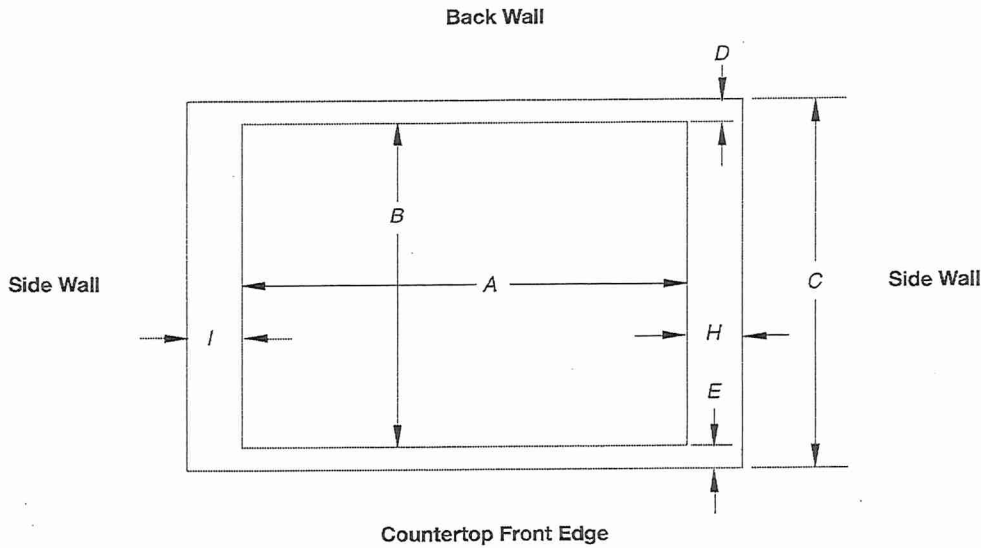

Cutout (Product Opening) Dimensions						
<del>30" (76.2 cm) Models</del>						
Models	A			B		
	Min	Recommended	Max	Min	Recommended	Max
KCGS550 and KCGS950	28 1/2" (72.4 cm)	28 7/8" (73.4 cm)	29 5/16" (74.3 cm)	19 1/2" (49.5 cm)	19 13/16" (50.2 cm)	20" (50.8 cm)
All Other 30" (76.2 cm) Models	28 1/2" (72.4 cm)	28 7/8" (73.4 cm)	29 5/16" (74.3 cm)	19" (48.3 cm)	19 1/2" (49.5 cm)	20" (50.8 cm)
36" (91.4 cm) Models						
KCGS556 and KCGS956	34 7/8" (88.4 cm)	35 3/16" (89.4 cm)	35 5/8" (90.3 cm)	19 1/2" (49.5 cm)	19 13/16" (50.2 cm)	20" (50.8 cm)
All Other 36" (91.4 cm) Models	<del>34 7/8" (88.4 cm)</del>	<del>35 3/16" (89.4 cm)</del>	<del>35 5/8" (90.3 cm)</del>	<del>19 1/2" (49.5 cm)</del>	<del>19 13/16" (50.2 cm)</del>	<del>20" (50.8 cm)</del>

Side Walls (Combustible Surfaces)	
Models	H and I
KCGS5 and KCGS9	H and I added together must be at least 48" (122.0 cm), with each side individually being at least 8" (20.3 cm).
KCGS350, KCGS356, MGC3536, WCG97US0, WCG97US6	H and I added together must be at least 48" (122.0 cm), with each side individually being at least 12" (30.5 cm).
All Other Models	Both have to be 8" (20.3 cm) or more.

Back Wall and Countertop Front Dimensions			
Models	C	D	E
KCGS550 and KCGS950	25" (63.5 cm)	2 7/8" (7.3 cm)	2 3/4" (6.9 cm)
All Other Models			3 1/8" (7.9 cm)

**NOTES:** After making the countertop cutout, some installations may require notching down the base cabinet side walls to clear the cooktop base. To avoid this modification, use a base cabinet with sidewalls wider than the cutout.

If cabinet has a drawer, a 4" (10.2 cm) depth clearance from the countertop to the top of the drawer (or other obstruction) in base cabinet is required. The drawer depth may need to be shortened to avoid interfering with the regulator.

**IMPORTANT:** If a built-in wall oven is to be installed below this cooktop, the grounded outlet and gas supply piping must be located in an adjacent cabinet.

This cooktop and its gas and electrical supply sources must be installed before the undercounter built-in wall oven is installed.



KOCE500ESS

LOT 35

KitchenAid®

30" Combination Wall Oven with Even-Heat™ True Convection (Lower Oven)

<http://www.kitchenaid.com>



Key Features:

- Even-Heat™ True Convection Oven (lower oven)
- Microwave Convection Cooking (upper oven)
- Professionally-Inspired Design
- Temperature Probe
- EasyConvect™ Conversion System
- 5.0 Cu. Ft. Total Capacity (lower oven)
- 1.4 Cu. Ft. Capacity (upper oven)
- Crispwave™ Microwave Technology and Crisper Pan (upper oven)
- SatinGlide™ Roll-Out Extension Rack (lower oven)

Product Dimensions:

Height: 42 1/2

Width: 30

Depth: 27 1/8

Electrical Requirements:

40 Amps.

Additional Information:

[Use And Care Guide](#)

[Dimension Guide](#)

[Installation Guide](#)

[Warranty Certificate](#)

Available in:

- Black
- Stainless Steel
- White

INVESTED  
IN  
AMERICA

©Registered trademark/TM Trademark of Whirlpool, U.S.A. © 2016 Whirlpool Corporation. All Rights Reserved.  
All other trademarks are owned by their respective companies.  
Because Whirlpool Corporation policy includes a continuous commitment to improve our products, we reserve the right to change materials and specifications without notice. We also reserve the right to discontinue or transition products without notice.  
Manufacturer's Suggested Retail Price (MSRP) and Minimum Advertised Price (MAP) provided for reference purposes only. Dealer alone determines advertised and retail prices.  
Created On: Monday, March 06, 2017 18:50:58

Lot 35

KitchenAid®

27" (68.6 cm) and 30" (76.2 cm) Electric Built-In Microwave/Oven Combination

PRODUCT MODEL NUMBERS

KEMS309E KOCE500E KOCE507E

ELECTRICAL CONNECTION

If codes permit and a separate ground wire is used, it is recommended that a qualified electrical installer determine that the ground path and the wire gauge are in accordance with local codes. Check with a qualified electrical installer if you are not sure the oven is properly grounded.

This oven must be connected to a grounded metal, permanent wiring system.

Be sure that the electrical connection and wire size are adequate and in conformance with the National Electrical Code, ANSI/NFPA 70-latest edition or CSA Standards C22.1-94, Canadian Electrical Code, Part 1 and C22.2 No. O-M91-latest edition, and all local codes and ordinances.

To properly install your oven, you must determine the type of electrical connection you will be using and follow the instructions provided for it here.

- Oven must be connected to the proper electrical voltage and frequency as specified on the model/serial/rating plate. See the following illustration.

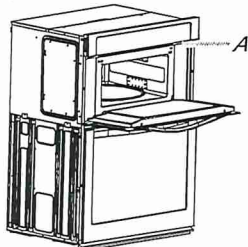

A. Model/serial/rating plate

- Models rated from 7.3 to 9.6 kW at 240 volts (5.4 to 7.4 kW at 208 volts) require a separate 40-amp circuit. Models rated at 4.8 kW and below at 240 volts (3.6 kW and below at 208 volts) require a separate 30-amp circuit.
- A circuit breaker is recommended.
- Connect directly to the fused disconnect (or circuit breaker box) through flexible, armored or nonmetallic sheathed, copper cable (with grounding wire). See "Make Electrical Connection" section.
- Flexible conduit from the oven should be connected directly to the junction box.
- Do not cut the conduit. The length of conduit provided is for serviceability of the oven.
- A UL listed or CSA approved conduit connector must be provided.
- If the house has aluminum wiring, follow the procedure below:
  - Connect a section of solid copper wire to the pigtail leads.
  - Connect the aluminum wiring to the added section of copper wire using special connectors and/or tools designed and UL listed for joining copper to aluminum.

Follow the electrical connector manufacturer's recommended procedure. Aluminum/copper connection must conform with local codes and industry accepted wiring practices.

For power requirements, refer to the following table.

Model	Voltage	Amperage (L1)*	Amperage (L2)*	Rating (W)
KOCE507E/KOCE500E	120/240	32	30	8000
KOCE507E/KOCE500E	120/208	33	33	6600

\*Amperage values noted above are for information purposes only: the units are rated in watts.

Because Whirlpool Corporation includes a continues commitment to improve our products, we reserve the right to change materials and specifications without notice.

PRODUCT DIMENSIONS

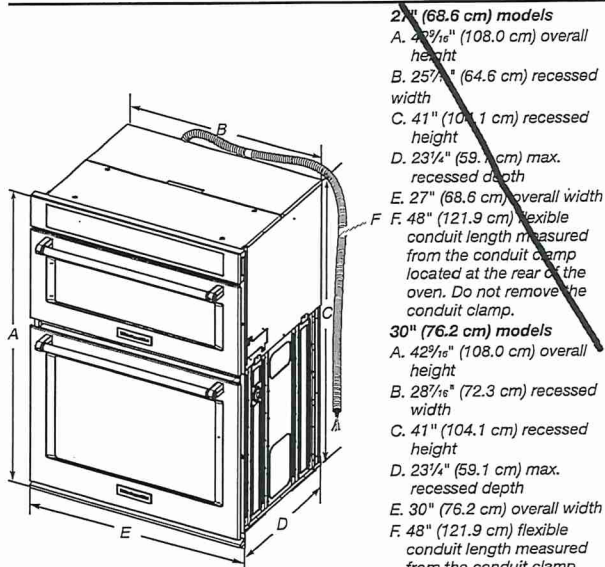

- 27" (68.6 cm) models
- A. 27 1/16" (108.0 cm) overall height
  - B. 25 7/16" (64.6 cm) recessed width
  - C. 41" (104.1 cm) recessed height
  - D. 23 1/4" (59.1 cm) max. recessed depth
  - E. 27" (68.6 cm) overall width
  - F. 48" (121.9 cm) flexible conduit length measured from the conduit clamp located at the rear of the oven. Do not remove the conduit clamp.
- 30" (76.2 cm) models
- A. 42 7/16" (108.0 cm) overall height
  - B. 28 7/16" (72.3 cm) recessed width
  - C. 41" (104.1 cm) recessed height
  - D. 23 1/4" (59.1 cm) max. recessed depth
  - E. 30" (76.2 cm) overall width
  - F. 48" (121.9 cm) flexible conduit length measured from the conduit clamp located at the rear of the oven. Do not remove the conduit clamp.

Cabinet Dimensions

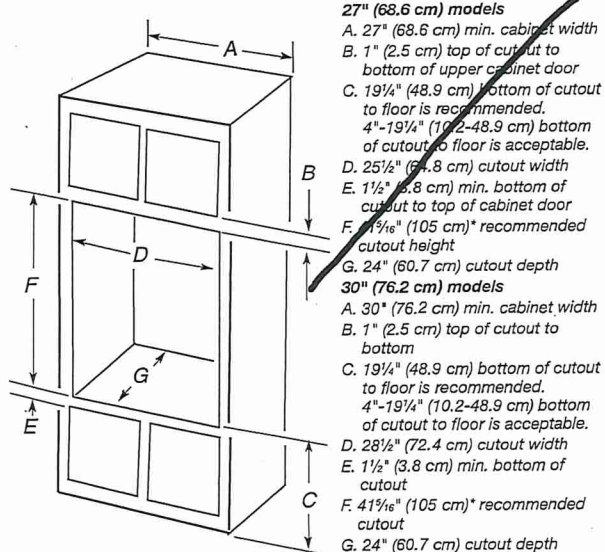

- 27" (68.6 cm) models
- A. 27" (68.6 cm) min. cabinet width
  - B. 1" (2.5 cm) top of cutout to bottom of upper cabinet door
  - C. 19 1/4" (48.9 cm) bottom of cutout to floor is recommended. 4"-19 1/4" (10.2-48.9 cm) bottom of cutout to floor is acceptable.
  - D. 25 1/2" (64.8 cm) cutout width
  - E. 1 1/2" (3.8 cm) min. bottom of cutout to top of cabinet door
  - F. 41 1/16" (105 cm)\* recommended cutout height
  - G. 24" (60.7 cm) cutout depth
- 30" (76.2 cm) models
- A. 30" (76.2 cm) min. cabinet width
  - B. 1" (2.5 cm) top of cutout to bottom
  - C. 19 1/4" (48.9 cm) bottom of cutout to floor is recommended. 4"-19 1/4" (10.2-48.9 cm) bottom of cutout to floor is acceptable.
  - D. 28 1/2" (72.4 cm) cutout width
  - E. 1 1/2" (3.8 cm) min. bottom of cutout
  - F. 41 1/16" (105 cm)\* recommended cutout
  - G. 24" (60.7 cm) cutout depth

\* NOTE: The cabinet height can be between 41" (104.1 cm) and 41 1/2" (105.6 cm) for microwave/oven combination.

Dimensions are for planning purposes only. For complete details, see Installation Instructions packed with product. Specifications subject to change without notice.

Ref. W10725683B  
2/10/15



36" Wall-Mount, 3-Speed Canopy Hood

<http://www.kitchenaid.com>



Key Features:

- 600 CFM/65K BTU Threshold
- Perimeter Ventilation
- Auto Speed Setting
- LED Task Lights
- Halogen Night Lights
- 3-Speed Electronic Touch Control with Boost Function (10 Min.)
- Whisper Quiet® System @ 49 dBA (1.5 sones) at Low Speed
- Dishwasher Safe Commercial-Style Baffle Filters
- Easy In-line Conversion

Product Dimensions:

Height: 24 5/8

Width: 36

Depth: 19 11/16

Electrical Requirements:

15.

Additional Information:

[Use And Care Guide](#)

[Dimension Guide](#)

[Installation Guide](#)

[Warranty Certificate](#)

Available in:

☒ Stainless Steel

©Registered trademark/TM Trademark of Whirlpool, U.S.A. © 2016 Whirlpool Corporation. All Rights Reserved.  
All other trademarks are owned by their respective companies.  
Because Whirlpool Corporation policy includes a continuous commitment to improve our products, we reserve the right to change materials and specifications without notice. We also reserve the right to discontinue or transition products without notice.  
Manufacturer's Suggested Retail Price (MSRP) and Minimum Advertised Price (MAP) provided for reference purposes only. Dealer alone determines advertised and retail prices.  
Created On: Monday, March 06, 2017 20:00:03

**KitchenAid**  
FOR THE WAY IT'S MADE.® ~~30" (76.2 cm)~~ and 36" (91.4 cm) Wall-Mount Canopy Range Hood

## PRODUCT MODEL NUMBERS

KVWB600D

KVWB606D

**Electrical:** A 120 volt, 60 Hz., AC only, 15-amp, fused electrical circuit is required.

## VENTING METHODS

This canopy range hood is factory set for venting through the roof or through the wall.

A 6" (15.2 cm) round vent system is needed for installation (not included). The hood exhaust opening is 6" (15.2 cm) round.

**NOTE:** Flexible vent is not recommended. Flexible vent creates back pressure and air turbulence that greatly reduce performance.

Vent system can terminate either through the roof or wall. To vent through a wall, a 90° elbow is needed.

### Rear Discharge

A 90° elbow may be installed immediately above the hood.

### For Non-Vented (Recirculating) Installations

If it is not possible to vent cooking fumes and vapors to the outside, the hood can be used in the non-vented (recirculating) version, using a Recirculation Kit (which includes charcoal filters and a deflector). To order, see the "Assistance or Service" section.

## Roof Venting

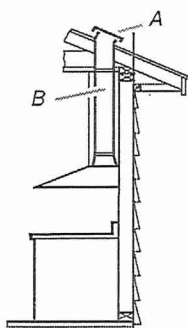

A. Roof cap  
B. 6" (15.2 cm)  
round vent

## Wall Venting

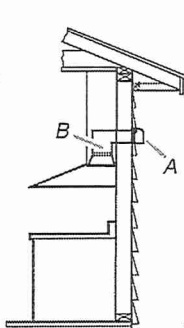

A. Wall cap  
B. 6" (15.2 cm)  
round vent

### Non-Vented (Recirculating)

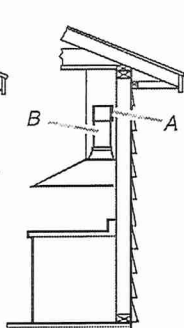

A. Diverter  
B. 6" (15.2 cm)  
round vent

### Calculating Vent System Length

To calculate the length of the system you need, add the equivalent feet (meters) for each vent piece used in the system.

### Vent System

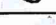
Vent Piece		6" (15.2 cm) Round
45° elbow	2.5 ft (0.8 m)	
90° elbow	5.0 ft (1.5 m)	

Maximum equivalent vent length is 35 ft (10.7 m).

### Example Vent System

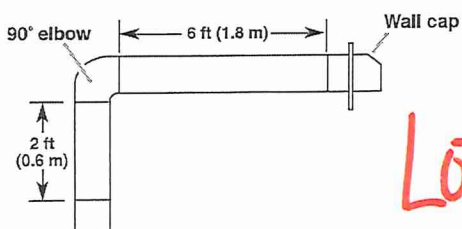

The following example falls within the maximum recommended vent length of 35 ft (10.7 m).

1 - 90° elbow	= 5.0 ft (1.5 m)
1 - wall cap	= 0.0 ft (0.0 m)
8 ft (2.4 m) straight	= 8.0 ft (2.4 m)
<b>Length of system</b>	<b>= 13.0 ft (3.9 m)</b>

## PRODUCT DIMENSIONS

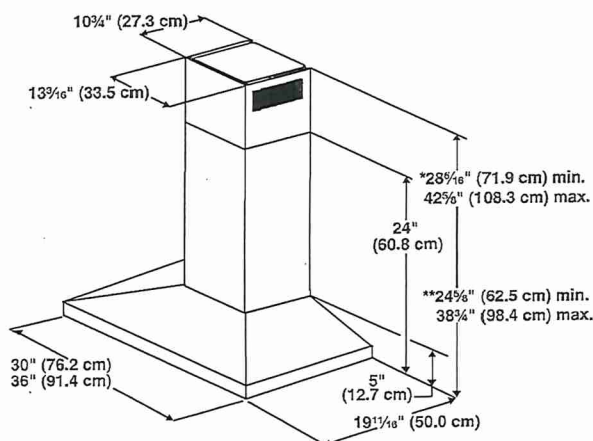

\*For non-vented (recirculating) installations

\*\*For vented installations



CABINET DIMENSIONS

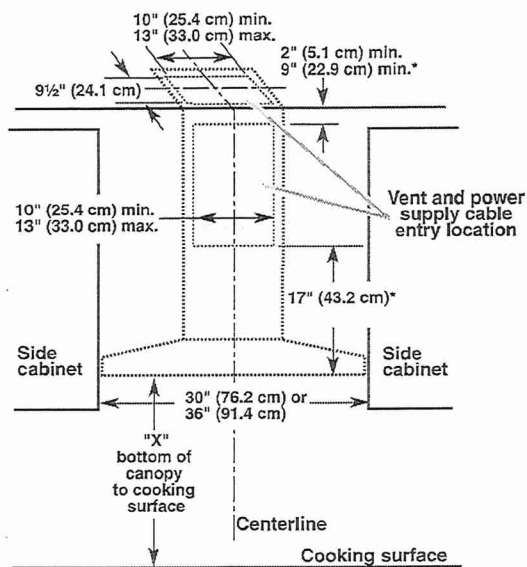

\*For non-vented (recirculating) installations

IMPORTANT:

- Minimum distance "X": 24" (61.0 cm) from electric cooking surface.
- Minimum distance "X": 27" (68.6 cm) from gas cooking surfaces.
- Suggested maximum distance "X": 36" (91.4 cm)

The chimneys can be adjusted for different ceiling heights. See the following chart.

Vented Installations		
	Min. ceiling height	Max. ceiling height
Electric cooking surface	7' 1" (2.16 m)	9' 2" (2.79 m)
Gas cooking surface	7' 4" (2.23 m)	9' 2" (2.79 m)
Non-vented (recirculating) Installations		
	Min. ceiling height	Max. ceiling height
Electric cooking surface	7' 1" (2.16 m)	9' 6" (2.9 m)
Gas cooking surface	7' 4" (2.23 m)	9' 6" (2.9 m)

\*NOTE: The range hood chimneys are adjustable and designed to meet varying ceiling or soffit heights depending on the distance "X" between the bottom of the range hood and the cooking surface. For higher ceilings, a Chimney Extension Kit is available from your dealer or an authorized parts distributor. The chimney extension replaces the chimney shipped with the range hood. To order, see the "Assistance or Service" section.

LOT35

KDTE204KPS

Lot 35

KitchenAid®

39 dBA Dishwasher in PrintShield™ Finish with  
Third Level Utensil Rack

<http://www.kitchenaid.com>



Key Features:

- 39 dBA
- ProWash™ Cycle
- Heat Dry Option
- Third Level Utensil Rack
- Extended Heat Dry Option
- Durable Stainless Steel Interior
- SatinGlide® Rails in Third and Middle Racks
- Express Wash Cycle
- Top Controls
- Adjustable Middle Rack

Product Dimensions:

Height: 34 1/2

Width: 23 7/8

Depth: 26 3/4

Additional Information:

[Dimension Guide](#)

[Energy Guide](#)

[Warranty Certificate](#)

Available in:

- Black
- Black Stainless Steel with PrintShield™ Finish
- Stainless Steel with PrintShield™ Finish
- White

INVESTED  
IN  
AMERICA



©Registered trademark/TM Trademark of Whirlpool, U.S.A. © 2016 Whirlpool Corporation. All Rights Reserved.  
All other trademarks are owned by their respective companies.  
Because Whirlpool Corporation policy includes a continuous commitment to improve our products, we reserve the right to change materials and specifications without notice. We also reserve the right to discontinue or transition products without notice.  
Manufacturer's Suggested Retail Price (MSRP) and Minimum Advertised Price (MAP) provided for reference purposes only. Dealer alone determines advertised and retail prices.  
Created On: Tuesday, July 26, 2020 08:39:51





# 24" Dishwasher

## DETAILED PLANNING DIMENSIONS GUIDE

Applies to all model numbers starting with;  
KDFE104K, KDFE204K, KDTE204K, KDTE204LPA, KDFM404K,  
KDTM404K, KDPM604K, KDTM604K, KDPM704K, KDTM704K,  
KDTM704LPA, KDPM804K, KDTM804K

### PRODUCT DIMENSIONS

LOT 35

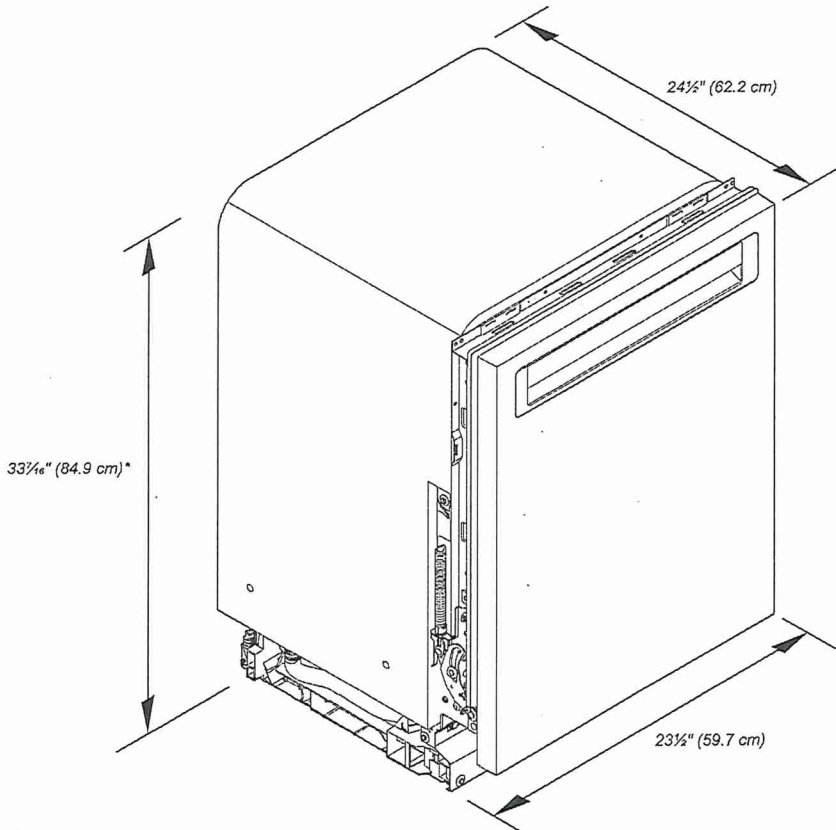

\*Dishwasher can be raised 1 7/16" (3.7 cm) with feet fully extended.

Because Whirlpool Corporation policy includes a continuous commitment to improve our products, we reserve the right to change materials and specifications without notice.

Dimensions are for planning purposes only. For complete details, see Installation Instructions packed with product. Specifications subject to change without notice.

LOT 35

PRODUCT DIMENSIONS (CONTD.)

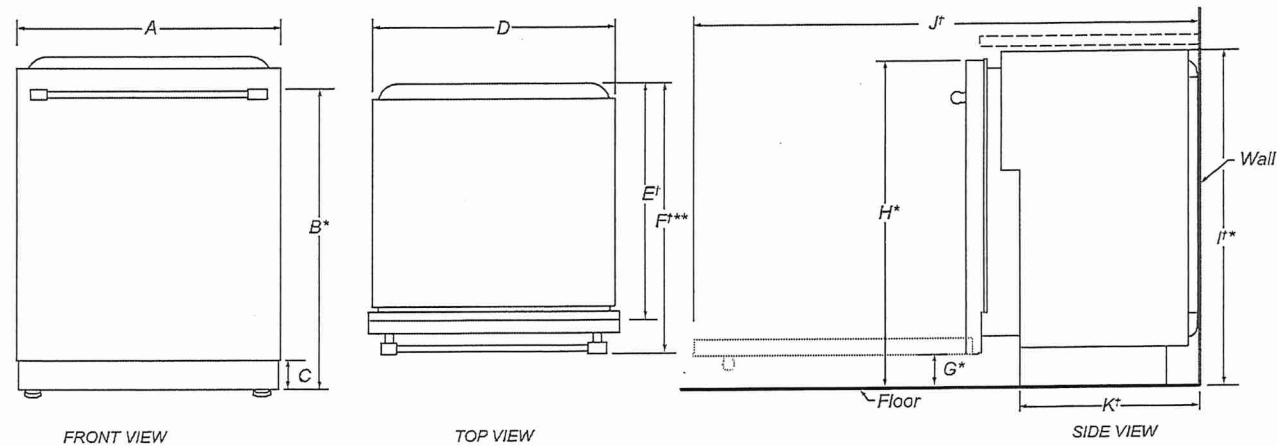

	DESCRIPTION	DIMENSIONS
A	Width of door	23½" (59.7 cm)
B*	Height to top of handle	30⅜" (78.3 cm)
C	Height of adjustable toe kick	3⅝" (8.4 cm) - min. 4⅞" (11.8 cm) - max.
D	Width of recessed dishwasher	22⅝" (57.4 cm)
E†	Depth without door	22⅝" ( 57.5 cm)
F**	Depth with Towel Bar Handle	26⅞" (68.3 cm)
	Depth with Pocket Handle	24½" (62.6 cm)
	Depth of Panel-Ready Models	24" (61.0 cm)
G*	Height to bottom of door (min.)	3⅝" (8.4 cm)
H*	Height to top of door (min.)	33⅞" (84.9 cm)
I*	Height of recessed dishwasher (min.)	33⅞" (85.4 cm)
J†	Depth with door fully open (min.)	50⅞" (127.4 cm)
K*	Depth with toe kick (min.)	20⅜" (52.9 cm)

†Insulation blanket thickness adds up to 11/16" (1.8 cm) but can crush up to 1/8" (0.3 cm).  
\*Dishwasher can be raised 1⅞" (3.7 cm) with feet fully extended.  
\*\*For panel-ready models, dishwasher depth is 24" (61.0 cm), not including the 3/4" (1.9 cm) custom door panel.

Because Whirlpool Corporation policy includes a continuous commitment to improve our products, we reserve the right to change materials and specifications without notice.  
Dimensions are for planning purposes only. For complete details, see Installation Instructions packed with product. Specifications subject to change without notice.



LOT 35

**IMPORTANT:** Check that all surfaces have no protrusions that would prohibit dishwasher installation.

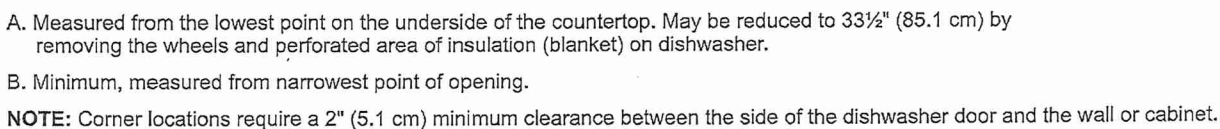

Dimensions are for planning purposes only. For complete details, see Installation Instructions packed with product. Specifications subject to change without notice.

DRAIN REQUIREMENTS

- A new drain hose is supplied with your dishwasher. If drain hose is not long enough, use a new drain hose with a maximum length of 12 ft (3.7 m) that meets all current AHAM/ IAPMO test standards, is resistant to heat and detergent, and fits the 1" (2.5 cm) drain connector of the dishwasher.
- NOTE:** Do not connect multiple drain hoses together.
- Make sure to connect drain hose to waste tee or disposer inlet above drain trap in house plumbing and 20" (50.8 cm) minimum above the floor. It is recommended that the drain hose either be looped up and securely fastened to the underside of the counter or be connected to an air gap.
- Make sure to use an air gap if the drain hose is connected to house plumbing lower than 20" (50.8 cm) above subfloor or floor.

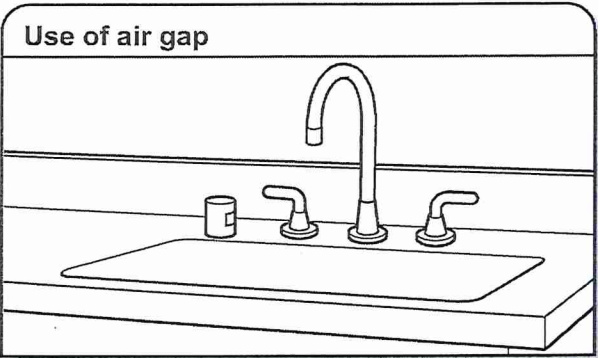

- If required, the air gap should be installed in accordance with the air gap installation instructions. When you are connecting the air gap, a rubber hose (not provided) will be needed to connect to the waste tee or disposer inlet.
- Use 1/2" (1.3 cm) minimum I.D. drain line fittings.

WATER SUPPLY REQUIREMENTS

- This dishwasher has a water heating feature and also requires a connection to a hot water supply line.
- A hot water line with 20 psi to 120 psi (138 kPa to 862 kPa) water pressure can be verified by a licensed plumber.
- 120°F (49°C) water at dishwasher.
- 3/8" (0.95 cm) O.D. copper tubing with compression fitting or flexible braided water supply line.
- NOTE:** 1/2" (1.3 cm) minimum plastic tubing is not recommended.
- A 90° elbow with 3/4" (0.95 cm) hose connection with rubber washer.
- Do not solder within 6" (15.2 cm) of the water inlet valve.
- If installed in new construction, make sure the house water supply lines have been flushed prior to connecting the dishwasher to remove any debris that may exist in the supply line.
- NOTE:** If replacing an existing dishwasher, it is recommended to install a new water line and drain hose (supplied) with the new dishwasher.

ELECTRICAL REQUIREMENTS



LOT35

⚠ **WARNING**

Electrical Shock Hazard

Plug into a grounded 3 prong outlet.

Do not remove ground prong.

Do not use an adapter.

Do not use an extension cord.

Failure to follow these instructions can result in death, fire, or electrical shock.

Be sure that the electrical connection and wire size are adequate and in conformance with the National Electrical Code, ANSI/NFPA 70 - latest edition, and all local codes and ordinances.

A copy of the above code standards can be obtained from:

National Fire Protection Association  
1 Batterymarch Park  
Quincy, MA 02169-7471

You Must Have:

- 120 V, 60 Hz, AC only, 15 A or 20 A, fused electrical supply
- Copper wire only
- A maximum of 2 field wiring supply conductors (12 AWG largest size) plus 1 grounding conductor are permitted in the terminal box.

We Recommend:

- A time-delay fuse or circuit breaker.

Circuit Requirements:

- The dishwasher may be installed on the same circuit as a garbage disposal providing that the branch circuit cannot exceed rated circuit load and must comply with all governing codes and regulations such as but not limited to National Electrical Code, ANSI/NFPA 70 - latest edition.
- No electrical connections other than the dishwasher power and ground connections can be made inside of the dishwasher terminal box.

If connecting dishwasher with a power supply cord:

- Use UL Listed power cord kit marked for use with dishwasher.
- Plug into a grounded 3 prong outlet. Outlet must meet all local codes and ordinances.



If connecting dishwasher with direct wiring:

- Use flexible, armored, or nonmetallic sheathed copper wire with grounding wire that meets the wiring requirements for your home and local codes and ordinances.
- Use a UL Listed/CSA Approved metallic strain relief.





# WF45R6100AP

SAMSUNG

Samsung Front Load Washer with Steam

5.2 cu. ft. Capacity IEC

LOT35

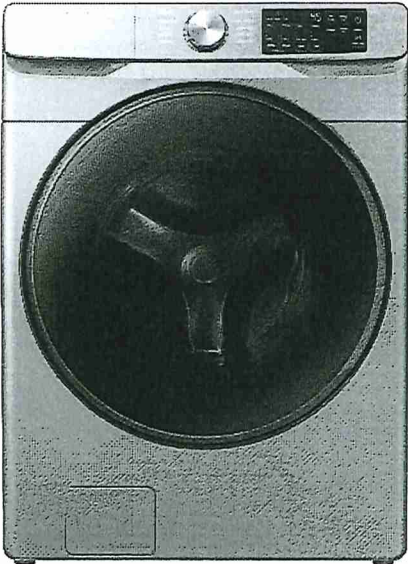

### Signature Features

#### Steam

- Powerful stain removal without pretreatment while still gentle on your clothing.

#### Self Clean+

- Keeps your washer drum fresh and clean by eliminating 99% of bacteria<sup>1</sup>. Will also send a reminder to clean the drum every forty wash cycles.

#### Closet-Depth

- This washer fits within your existing laundry space without sacrificing any capacity thanks to our new, wider drum.
- A new control panel design provides better visibility so it is easy to use even when stacked.

### Available Colors



Platinum (shown)

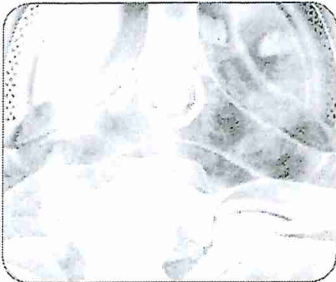

Steam

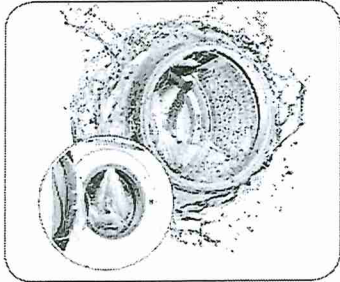

Self Clean+

### Features

- Steam.
- Self Clean+
- Smart Care
- VRT Plus™ Technology
- Swirl+ Drum Design
- Closet-Depth Fit<sup>2</sup>
- Stackability
- Internal Water Heater
- 1200 RPM Maximum Spin Speed
- Direct Drive Motor
- 10 Preset Washing Cycles
- 7 Additional Washing Options
- 5 Temperature Levels
- LED Display: Ice Blue
- 24-Hour Delay End

### Convenience

- Child Lock
- Delay End
- Dispenser Trays: Main Wash, Softener, Bleach

### Rating



ENERGY STAR®-rated  
CEE Tier 2  
IMEF = 2.92  
IWF = 2.9

<sup>1</sup>Based on testing by Intertek of the Self Clean+ cycle on the WF6000R.  
<sup>2</sup>Designed to fit a 40" installation depth.

# WF45R6100AP

SAMSUNG

## Samsung Front Load Washer with Steam

5.2 cu. ft. Capacity IEC

LOT35

### Installation Specifications

If the washer and dryer are installed together or the dryer alone, the closet front must have two unobstructed air openings for a combined minimum total area of 72-inch<sup>2</sup> (see stacked build below). Your washer alone does not require a specific air opening.

\*Required spacing (External exhaust elbow may require additional space.)

#### 1. Alcove or closet installation

Minimum Clearance for Closet and Alcove Installations:

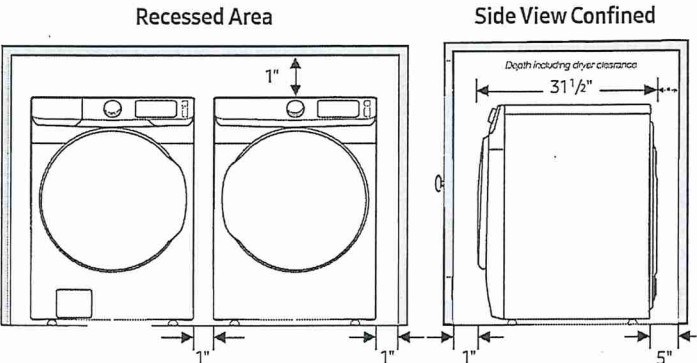

#### 2. With stacked washer and dryer

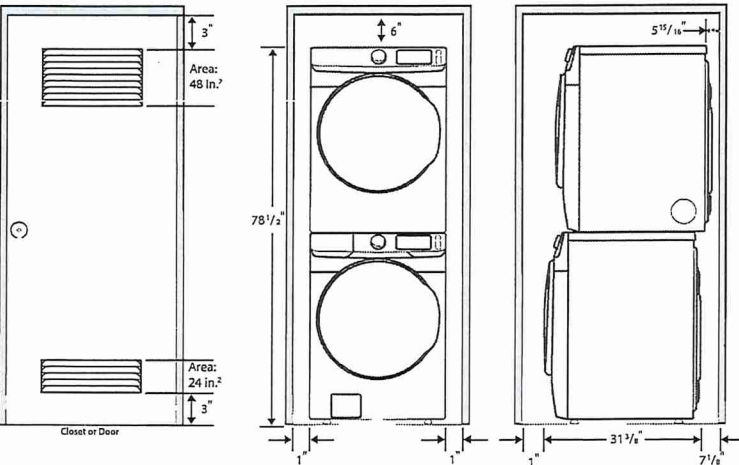

### Dimensions

Required Dimensions for Installation with Pedestal:

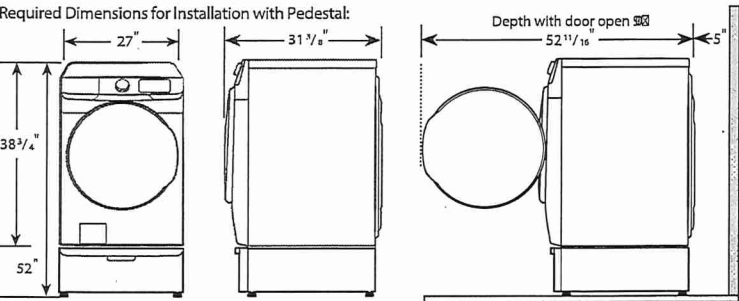

Actual color may vary. Design, specifications, and color availability are subject to change without notice. Non-metric weights and measurements are approximate.  
© 2019 Samsung Electronics Canada Inc. All rights reserved. Samsung is a registered trademark of Samsung Electronics Co., Ltd., used with permission.

#### 10 Preset Washing Cycles:

Normal, Heavy Duty, Bedding, Quick Wash, Permanent Press, Delicates, Whites, Sanitize, Rinse and Spin, Self Clean+

#### 7 Additional Washing Options:

Presoak, Steam, Delay End, Alarm Off, Child Lock, Smart Care, Spin Only

#### 5 Temperature Levels:

Hot, Warmer, Warm, Cool, Cold

#### 5 Spin Speeds:

High, Medium High, Medium, Low, No Spin

#### 5 Soil Levels:

Heavy, Medium Heavy, Normal, Medium Low, Light

#### Dispenser Trays:

Main Wash, Softener, Bleach

#### Warranty

One (1) Year Parts and Labor

Ten (10) Years Direct Drive Motor (Part Only)

#### Product Dimensions & Weight (WxHxD)

Dimensions: 27" x 38 3/4" x 31 3/8"

Weight: 201 lbs

#### Shipping Dimensions & Weight (WxHxD)

Dimensions: 29 3/8" x 42 3/8" x 34 1/8"

Weight: 205 lbs

Color	Model #	UPC Code
Platinum	WF45R6100AP	887276299464

#### Matching Dryer (Electric/Gas)

Champagne	DVE45T6100C	887276390352
Platinum	DVE45T6100P	887276390369
Platinum	DVG45T6100P	887276390390

#### Pedestal

Champagne	WE402NC	887276310121
Platinum	WE402NP	887276310145

#### Accessories

Stacking Kit	SKK-8K	887276344034
--------------	--------	--------------



DVE/

45T6100P

SAMSUNG

Samsung Front Load Electric ~~Gas~~ Dryer with Steam Sanitize+

7.5 cu. ft. Capacity DOE

LOT35

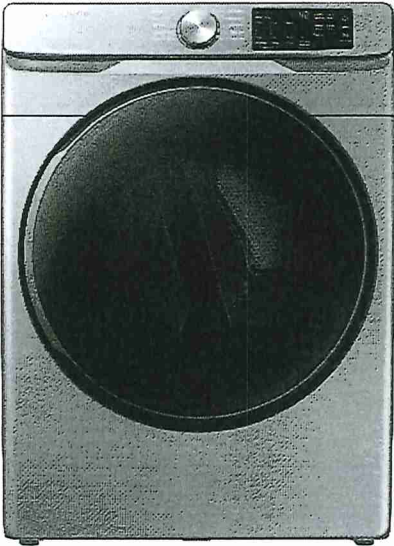

Signature Features

Steam Sanitize+

- The Steam Sanitize+ cycle removes 99.9% of germs and bacteria, over 95% of pollen, and kills 100% of dust mites<sup>1</sup>. Multi-Steam Technology steams away wrinkles, odors, and static.

Sensor Dry

- Automatically optimizes the time and temperature of your drying cycle to protect your clothes from heat damage, while avoiding excess energy use.

Smart Care

- Easy troubleshooting from the convenience of your smartphone<sup>2</sup>. Smart Care interacts with your washer and dryer to perform an immediate diagnosis and offer quick solutions.

Available Colors



Platinum (shown)

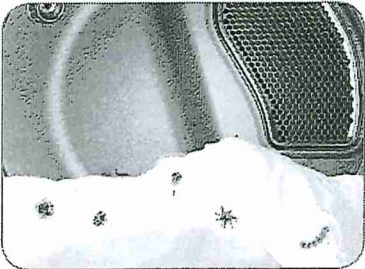

Steam Sanitize+



Sensor Dry

Features

- Steam Sanitize+
- Sensor Dry
- Smart Care
- Interior Drum Light
- 10 Preset Drying Cycles
- 9 Additional Drying Options
- 5 Temperature Levels
- 4-Way Venting (Electric)
- 3-Way Venting (Gas)
- Reversible Tinted Door
- LED Display: Ice Blue

Convenience

- Child Lock
- Lint Filter Indicator

Rating



ENERGY STAR®-rated  
608 kwh/yr

<sup>1</sup>Based on internal testing and independently verified by Intertek. Individual results may vary.  
<sup>2</sup>Requires Samsung Smart Washer/Dryer App. The Samsung Smart Washer/Dryer app supports Android OS 2.3.6 or later and iOS 3 or later for iPhone models. Smart Washer/Dryer app available in App Store and Play Store.

# DVE/G45T6100P

SAMSUNG

Samsung Front Load Electric/~~Gas~~ Dryer with Steam Sanitize+

7.5 cu. ft. Capacity DOE

LOT35

## Installation Specifications

If the washer and dryer are installed together or the dryer alone, the closet front must have two unobstructed air openings for a combined minimum total area of 72-inch<sup>2</sup> (see stacked build below). Your washer alone does not require a specific air opening.

\*Required spacing (External exhaust elbow may require additional space.)

### 1. Alcove or closet installation

Minimum Clearance for Closet and Alcove Installations:

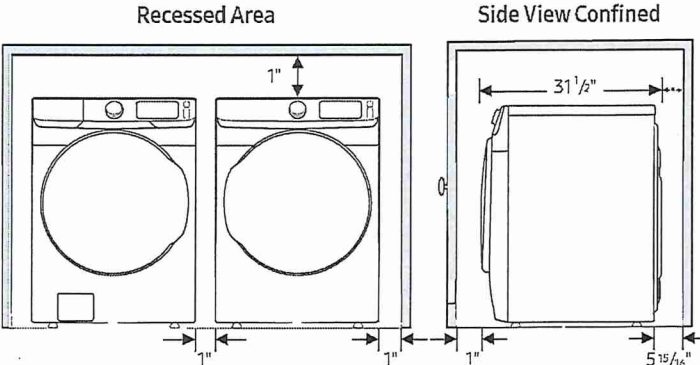

### 2. With stacked washer and dryer

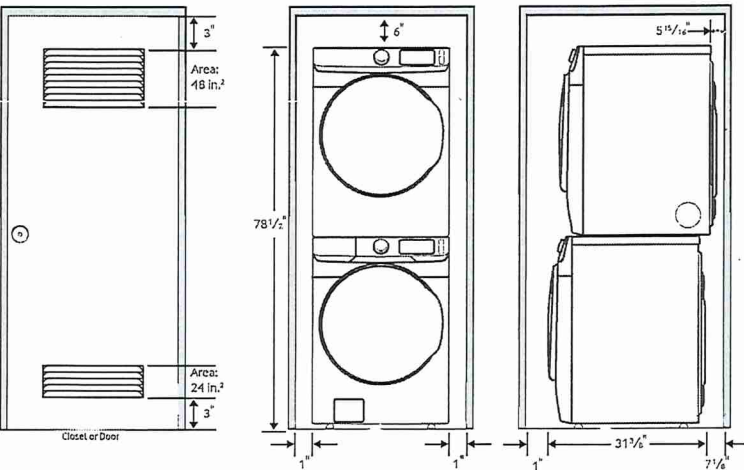

## Dimensions

Required Dimensions for Installation with Pedestal:

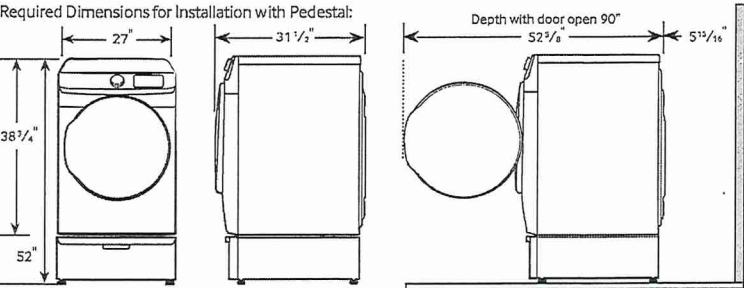

Actual color may vary. Design, specifications, and color availability are subject to change without notice. Non-metric weights and measurements are approximate.  
© 2020 Samsung Electronics Canada Inc. All rights reserved. Samsung is a registered trademark of Samsung Electronics Co., Ltd., used with permission.

### 4-Way Venting (Electric)

### 3-Way Venting (Gas)

### 10 Preset Drying Cycles:

Refresh, Steam Sanitize+, Normal, Heavy Duty, Permanent Press, Bedding, Delicates, Time Dry, Air Fluff, Quick Dry

### 9 Additional Drying Options:

Damp Alert, Wrinkle Prevent, Adjust Time (Up), Adjust Time (Down), Eco Dry, Child Lock, Smart Care, Alarm Off, Drum Light

### 5 Temperature Levels:

High, Medium High, Medium, Medium Low, Low

### 5 Dry Levels:

More Dry, Normal-More Dry, Normal Dry, Normal-Less Dry, Less Dry

### Warranty

One (1) Year Parts and Labor

### Product Dimensions & Weight (WxHxD)

Dimensions: 27" x 38 3/4" x 31 1/2"

Weight: 123 lbs

### Shipping Dimensions & Weight (WxHxD)

Dimensions: 29 3/8" x 42 9/16" x 33 1/2"

Weight: 130 lbs

Colour	Model #	UPC Code
Platinum	DVE45T6100P	887276390369
Platinum	DVG45T6100P	887276390390

### Matching Washer

Platinum	WF45R6100AP	887276299464
----------	-------------	--------------

### Pedestal

Platinum	WE402NP	887276310138
----------	---------	--------------

### Accessories

Stacking Kit	SKK-8K	887276344034
--------------	--------	--------------



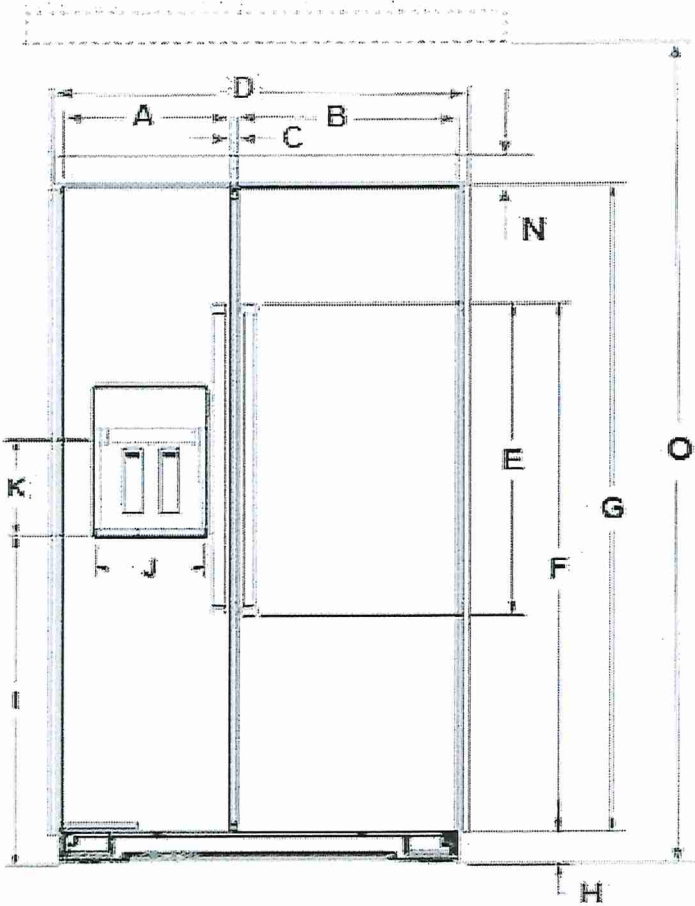

Description		Inches (mm)
A	Width of FC door	
	<del>36"</del>	<del>15" (381)</del>
	42"	17½" (444.5)
	<del>40"</del>	<del>20" (508)</del>
B	Width of RC door	
	<del>36"</del>	<del>20" (508)</del>
	42"	23½" (596.9)
	<del>40"</del>	<del>27" (685.8)</del>
C	Space between doors	1/4" (6.4)
D	Overall width with band	
	<del>36"</del>	<del>36¾" (919.2)</del>
	42"	42¾" (1071.6)
	<del>40"</del>	<del>40¾" (1024)</del>
E	Height of door handles	39⅛" (992.2)
F	Height to top of door handles	60⅞" (1538.3)
G	Height of doors	70⅛" (1801.8)
H	Height of grille	3⅞" (90.5)
I	Height to bottom of the Dispenser	38⅞" (973.1)
J	Width of Dispenser	9⅜" (233.4)
K	Height of Dispenser	7⅛" (195.3)
L	Water line location distance from side	17¾" (450.9)
M	Water line location distance from front	3¼" (82.6)
N	Height of grille (top)	8⅞" (225.4)
O	To bottom of solid soffit (minimum/maximum)	83½" (2120.9)
		84⅞" (2149.5)

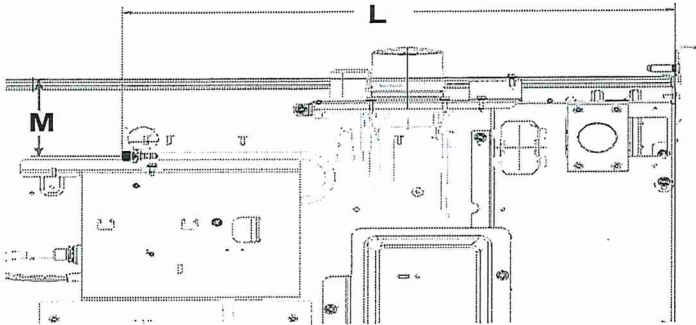

Because Whirlpool Corporation policy includes a continuous commitment to improve our products, we reserve the right to change materials and specifications without notice. Dimensions are for planning purposes only. For complete details, see Installation Instructions packed with product. Specifications subject to change without notice.

W11613020C

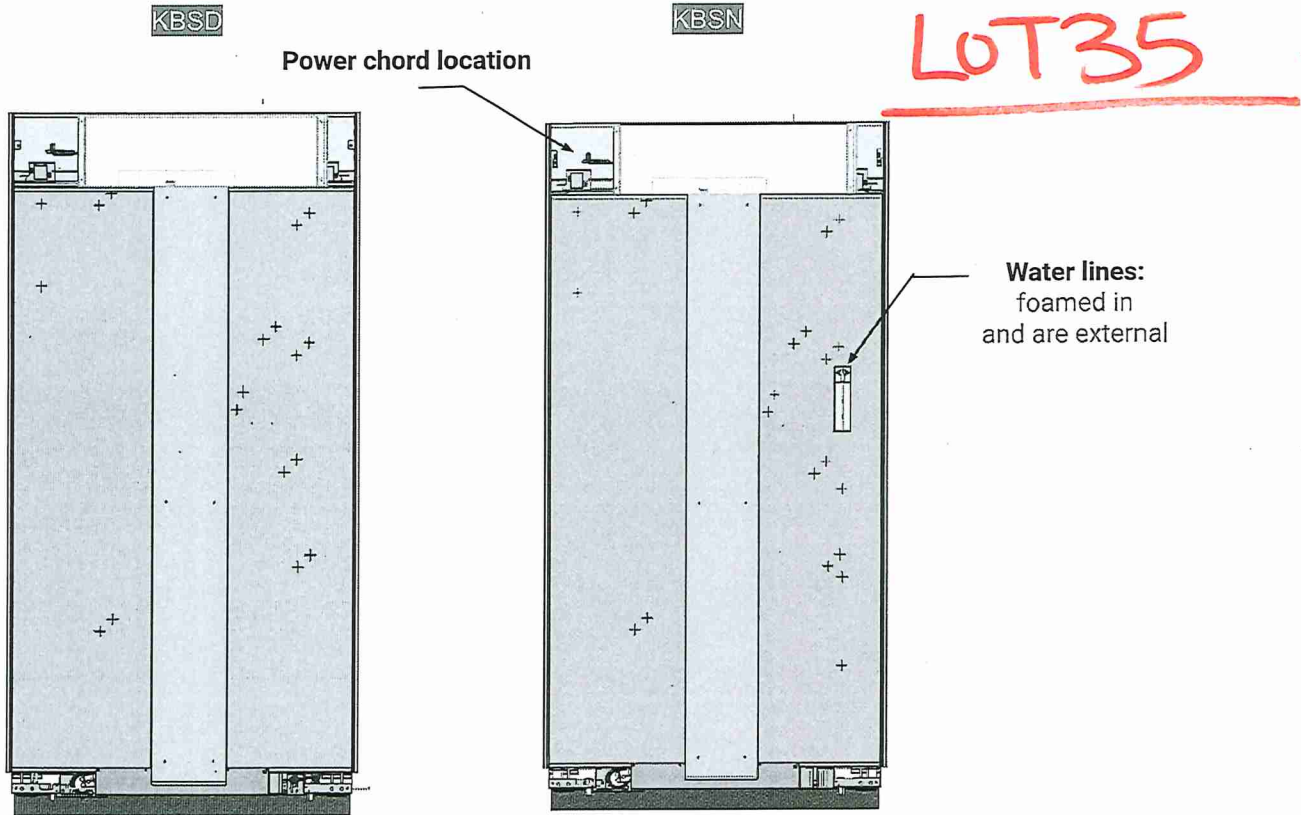

Electrical Requirements

⚠ WARNING

Electrical Shock Hazard

Plug into a grounded 3 prong outlet.

Do not remove ground prong.

Do not use an adapter.

Do not use an extension cord.

Failure to follow these instructions can result in death, fire, or electrical shock.

	Power chord	
	Type	Length Inches (mm)
	Standard	60" (1524)

**Electrical:** A 115V, 60 Hz, AC only, 15A or 20A fused, grounded electrical supply is required. It is recommended that a separate circuit serving only your refrigerator be provided. Use an outlet that cannot be turned off by a switch. Do not use an extension cord.

Because Whirlpool Corporation policy includes a continuous commitment to improve our products, we reserve the right to change materials and specifications without notice. Dimensions are for planning purposes only. For complete details, see Installation Instructions packed with product. Specifications subject to change without notice.

**Water:** A cold water supply with water pressure of between 30 psi and 120 psi (270 kPa and 827 kPa) is required to operate the water dispenser and ice maker. If you have questions about your water pressure, call a licensed, qualified plumber.

2

LOT35

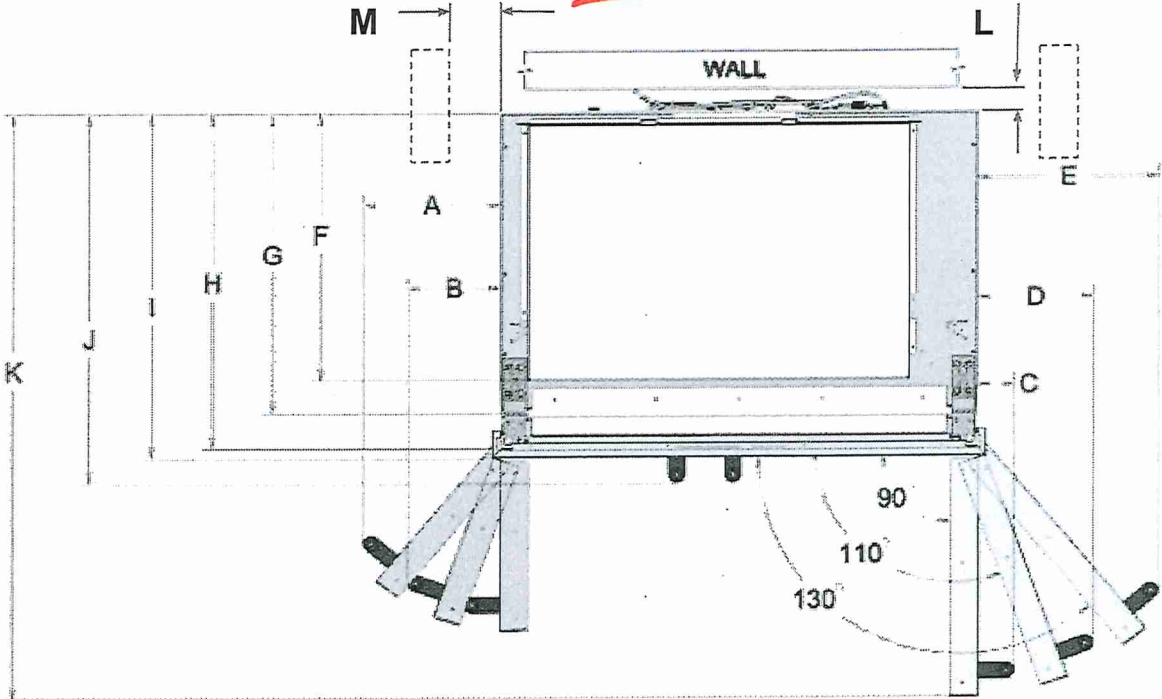

Description		Inches (mm)
A	Width from FC side of refrigerator to handle - door fully open 130°	10" (254)
		11 <sup>5</sup> / <sub>8</sub> " (295.3)
		13 <sup>1</sup> / <sub>2</sub> " (336.5)
B	Width from FC side of refrigerator to handle - door fully open 110°	6 <sup>3</sup> / <sub>4</sub> " (171.5)
		7 <sup>5</sup> / <sub>8</sub> " (193.7)
		8 <sup>7</sup> / <sub>16</sub> " (214.3)
C	Width from FC side of refrigerator to handle - door open 90°	2 <sup>11</sup> / <sub>16</sub> " (68.3)
D	Width from RC side of refrigerator to handle - door fully open 110°	8 <sup>7</sup> / <sub>16</sub> " (214.3)
		9 <sup>5</sup> / <sub>8</sub> " (244.5)
		10 <sup>7</sup> / <sub>8</sub> " (276.2)
E	Width from RC side of refrigerator to handle - door fully open 130°	13 <sup>1</sup> / <sub>2</sub> " (336.5)
		15 <sup>1</sup> / <sub>2</sub> " (393.7)
		17 <sup>3</sup> / <sub>4</sub> " (450.9)
F	Depth to machine compartment cover	19 <sup>15</sup> / <sub>16</sub> " (506.4)
G	Depth without doors	22 <sup>3</sup> / <sub>8</sub> " (568.3)
H	Depth with doors	25" (635)
I	Depth with top grill	25 <sup>13</sup> / <sub>16</sub> " (655.6)
J	Depth with handles	27 <sup>11</sup> / <sub>16</sub> " (703.3)
K	Depth with RC door open 90°	10" (254)
		11 <sup>5</sup> / <sub>8</sub> " (295.3)
		13 <sup>1</sup> / <sub>2</sub> " (336.5)
L	Space required for water lines and power chord	1" (25.4)
M	Space required for side cabinet	6" (152.4)



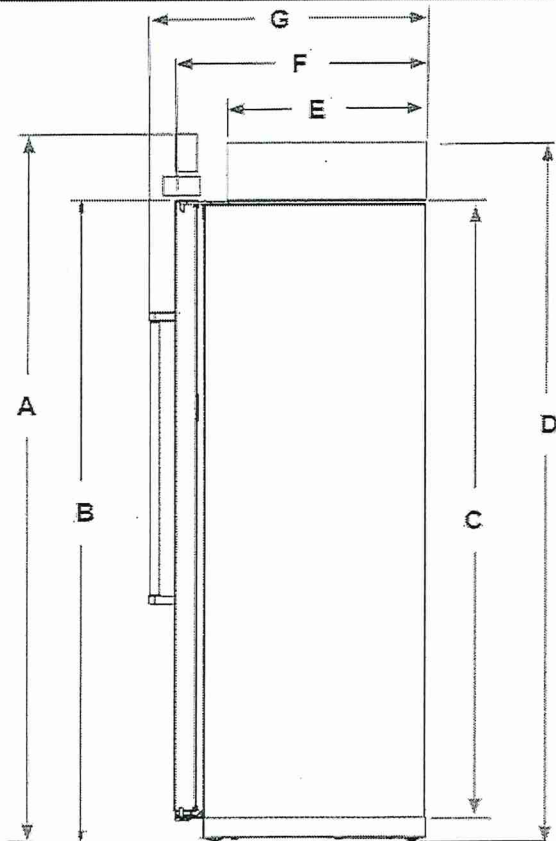

Description		Inches (mm)
A	Total height	83 <sup>3</sup> / <sub>8</sub> " (2117.7)
B	Height to top of doors	74 <sup>1</sup> / <sub>2</sub> " (1892.3)
C	Height of Cabinet	71" (1803.4)
D	Height to top of machine compartment cover	83 <sup>3</sup> / <sub>16</sub> " (2113)
E	Depth to machine compartment cover	19 <sup>15</sup> / <sub>16</sub> " (506.4)
F	Depth with doors	25" (635)
G	Depth with handles	27 <sup>11</sup> / <sub>16</sub> " (703.3)

Interior dimensions	Width Inches (mm)	Height Inches (mm)
Refrigerator Compartment	36" (914.4) 42" (1066.8) 46" (1168.3)	67 <sup>1</sup> / <sub>16</sub> " (1703.4)
Freezer Compartment	36" (914.4) 42" (1066.8) 46" (1168.3)	66 <sup>3</sup> / <sub>4</sub> " (1695.5)

LOT 35

Location Requirements

**⚠ WARNING**

**Explosion Hazard**  
Keep flammable materials and vapors, such as gasoline, away from refrigerator.  
Failure to do so can result in death, explosion, or fire.

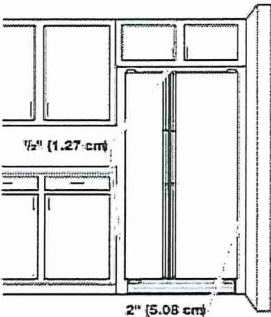

To ensure proper ventilation for your refrigerator, allow for 1/2" (12.7 mm) of space on each side and at the top. Allow for 1" (25.4 mm) of space behind the refrigerator. If your refrigerator has an ice maker, allow extra space at the back for the water line connections. When installing your refrigerator next to a fixed wall, leave a 2" (50.8 mm) minimum space on each side (depending on your model) to allow the doors to swing open.

- NOTES:**
- This refrigerator is intended for use in a location where the temperature ranges from a minimum of 55°F (13°C) to a maximum of 110°F (43°C). The preferred room temperature range for optimum performance, which reduces electricity usage and provides superior cooling, is between 60°F (15°C) and 90°F (32°C). It is recommended that you do not install the refrigerator near a heat source, such as an oven or radiator.
  - Normal minimum cabinet cut-out width required for product installation is 36" (914.4 mm). However, if the product is placed against an extended wall and the ability to remove the crisper pans is desired, an additional 18" (457.2 mm) of cabinet width is required, so a total cabinet opening width of 54" (1371.6 mm) is recommended.

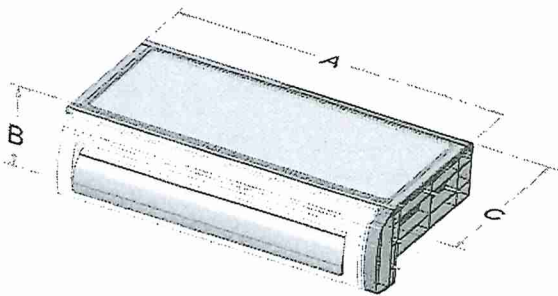

Meat Pan

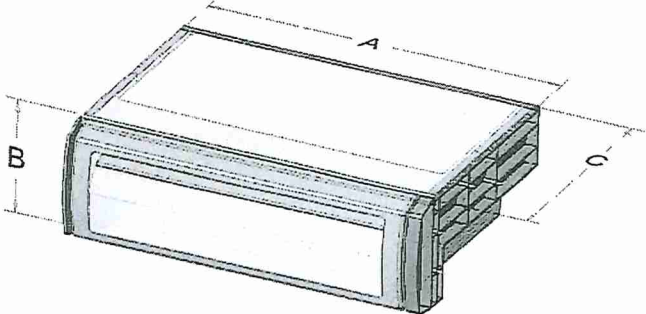

Crisper Pan

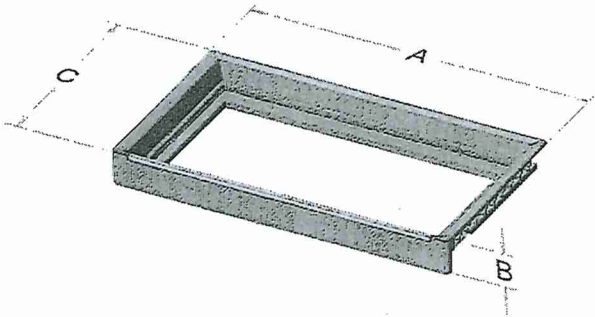

Pull Out Tray

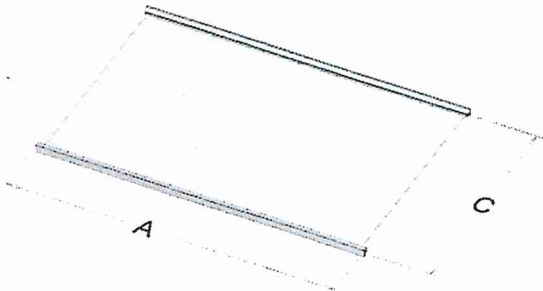

Shelf

Refrigerator Compartment Features			
Description	A Width Inches (mm)	B Height Inches (mm)	C Depth Inches (mm)
Meat pan 36" 42" 48"	17 <sup>1</sup> / <sub>8</sub> " (435) 20 <sup>11</sup> / <sub>16</sub> " (525.5) 24 <sup>3</sup> / <sub>16</sub> " (614.4)	6 <sup>1</sup> / <sub>16</sub> " (154)	12 <sup>7</sup> / <sub>8</sub> " (327)
Crisper pan 36" 42" 48"	17 <sup>3</sup> / <sub>16</sub> " (436.6) 20 <sup>11</sup> / <sub>16</sub> " (525.5) 24 <sup>3</sup> / <sub>16</sub> " (614.4)	7 <sup>15</sup> / <sub>16</sub> " (201.6)	16 <sup>9</sup> / <sub>16</sub> " (420.7)
Pull out tray 36" 42" 48"	17" (431.8) 20 <sup>7</sup> / <sub>16</sub> " (519.1) 23 <sup>15</sup> / <sub>16</sub> " (608)	2 <sup>3</sup> / <sub>8</sub> " (60.3)	12 <sup>9</sup> / <sub>16</sub> " (319.1)
Shelf 36" 42" 48"	16 <sup>11</sup> / <sub>16</sub> " (423.9) 20 <sup>9</sup> / <sub>16</sub> " (512.8) 23 <sup>11</sup> / <sub>16</sub> " (601.7)	N/A	14" (355.6)

LOT35

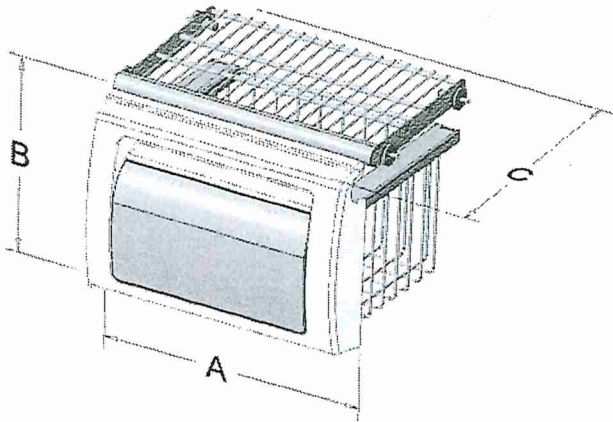

Basket Freezer

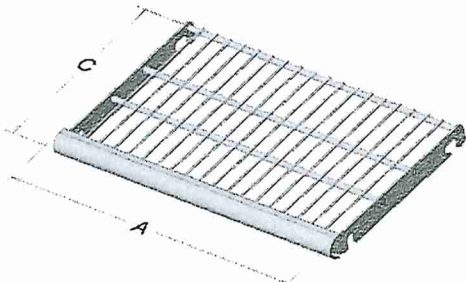

Bottom Wire Shelf

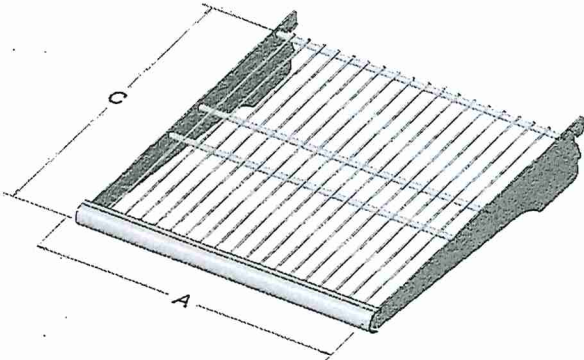

Top Wire Shelf

Freezer Compartment Features			
Description	A Width Inches (mm)	B Height Inches (mm)	C Depth Inches (mm)
Basket Freezer			
36"	11 <sup>5</sup> / <sub>16</sub> " (287.3)	8 <sup>7</sup> / <sub>16</sub> " (214.3)	10 <sup>3</sup> / <sub>16</sub> " (258.8)
42"	13 <sup>3</sup> / <sub>4</sub> " (349.3)		
48"	16 <sup>1</sup> / <sub>4</sub> " (412.8)		
Bottom Wire Shelf		N/A	7 <sup>1</sup> / <sub>8</sub> " (181)
36"	11 <sup>7</sup> / <sub>16</sub> " (290.5)		
42"	13 <sup>7</sup> / <sub>8</sub> " (352.4)		
48"	16 <sup>7</sup> / <sub>16</sub> " (417.5)		
Top Wire Shelf		N/A	11 <sup>9</sup> / <sub>16</sub> " (293.7)
36"	11 <sup>7</sup> / <sub>16</sub> " (290.5)		
42"	13 <sup>7</sup> / <sub>8</sub> " (352.4)		
48"	16 <sup>7</sup> / <sub>16</sub> " (417.5)		



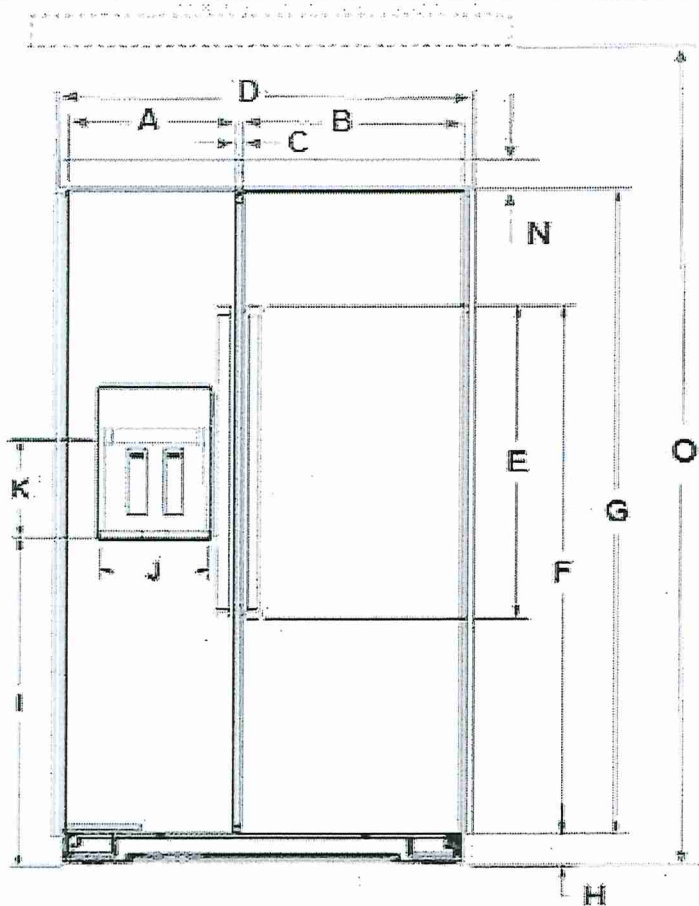

Description		Po (mm)
A	Largeur de la porte du CG	
	36 po	15 po (381)
	42 po	17 1/2 po (444,5)
B	Largeur de la porte du RF	
	36 po	20 po (508)
	42 po	23 1/2 po (596,9)
C	Espace entre les portes	
	48 po	27 po (685,8)
D	Largeur totale avec bande	
	36 po	1/4 po (6,4)
	42 po	36 3/16 po (919,2)
E	Hauteur des poignées de la porte	
	48 po	42 3/16 po (1071,6)
		48 3/16 po (1224)
F	Hauteur des poignées de la porte	39 1/16 po (992,2)
G	Hauteur jusqu'au haut des poignées de la porte	60 9/16 po (1538,3)
H	Hauteur des portes	70 15/16 po (1801,8)
I	Hauteur de la grille	3 9/16 po (90,5)
J	Hauteur jusqu'au bas du distributeur	38 5/16 po (973,1)
K	Largeur du distributeur	9 3/16 po (233,4)
L	Hauteur du distributeur	7 11/16 po (195,3)
M	Distance entre l'emplacement de la canalisation d'eau et le côté	17 3/4 po (450,9)
N	Distance entre l'emplacement de la canalisation d'eau et l'avant	3 1/4 po (82,6)
O	Hauteur de la grille (haut)	8 7/8 po (225,4)
O	Jusqu'au bas du soffite massif (minimum et maximum)	
		83 1/2 po (2120,9)
		84 5/8 po (2149,5)

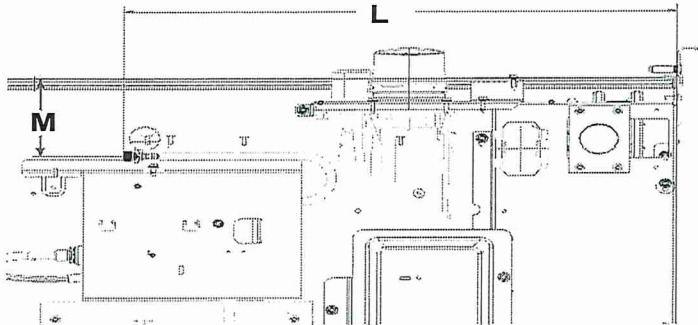

La politique de Whirlpool Corporation, c'est aussi notre engagement à travailler sans relâche à l'amélioration de nos produits; aussi nous nous réservons le droit de modifier les matériaux et spécifications sans préavis. Les dimensions sont indiquées à des fins de planification uniquement. Pour des détails complets, voir les Instructions d'installation fournies avec le produit. Spécifications indiquées sous réserve de modifications.

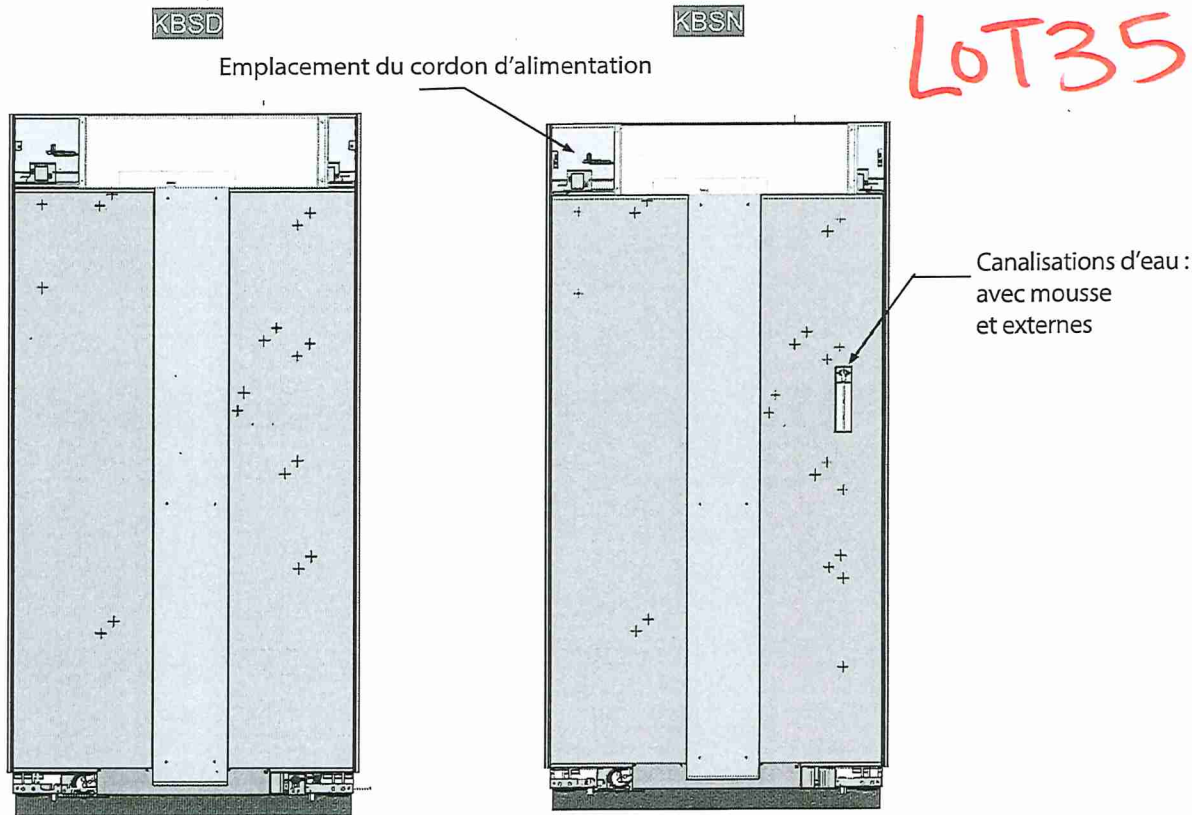

Spécifications électriques



**AVERTISSEMENT**



Risque de choc électrique

Brancher sur une prise à 3 alvéoles reliée à la terre.

Ne pas enlever la broche de liaison à la terre.

Ne pas utiliser un adaptateur.

Ne pas utiliser un câble de rallonge.

Le non-respect de ces instructions peut causer un décès, un incendie ou un choc électrique.

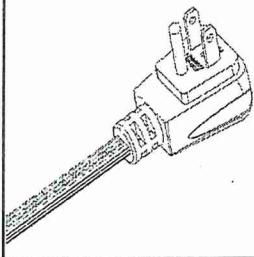
	Cordon d'alimentation	
	Type	Longueur Po (mm)
	Standard	60 po (1524)

**Circuit électrique :** Un circuit de 115 V CA à 60 Hz relié à la terre et protégé par un fusible de 15 A ou 20 A est requis. Il est recommandé d'utiliser un circuit distinct pour alimenter le réfrigérateur uniquement. Utiliser une prise de courant dont l'alimentation ne peut pas être interrompue par un interrupteur. Ne pas utiliser de rallonge.

**Eau :** Une alimentation en eau froide avec une pression entre 30 lb/po² et 120 lb/po² (270 kPa et 827 kPa) est nécessaire pour faire fonctionner le distributeur d'eau et la machine à glaçons. Pour toute question au sujet de la pression de l'eau, faire appel à un plombier qualifié agréé.

La politique de Whirlpool Corporation, c'est aussi notre engagement à travailler sans relâche à l'amélioration de nos produits; aussi nous nous réservons le droit de modifier les matériaux et spécifications sans préavis. Les dimensions sont indiquées à des fins de planification uniquement. Pour des détails complets, voir les Instructions d'installation fournies avec le produit. Spécifications indiquées sous réserve de modifications.

LOT35

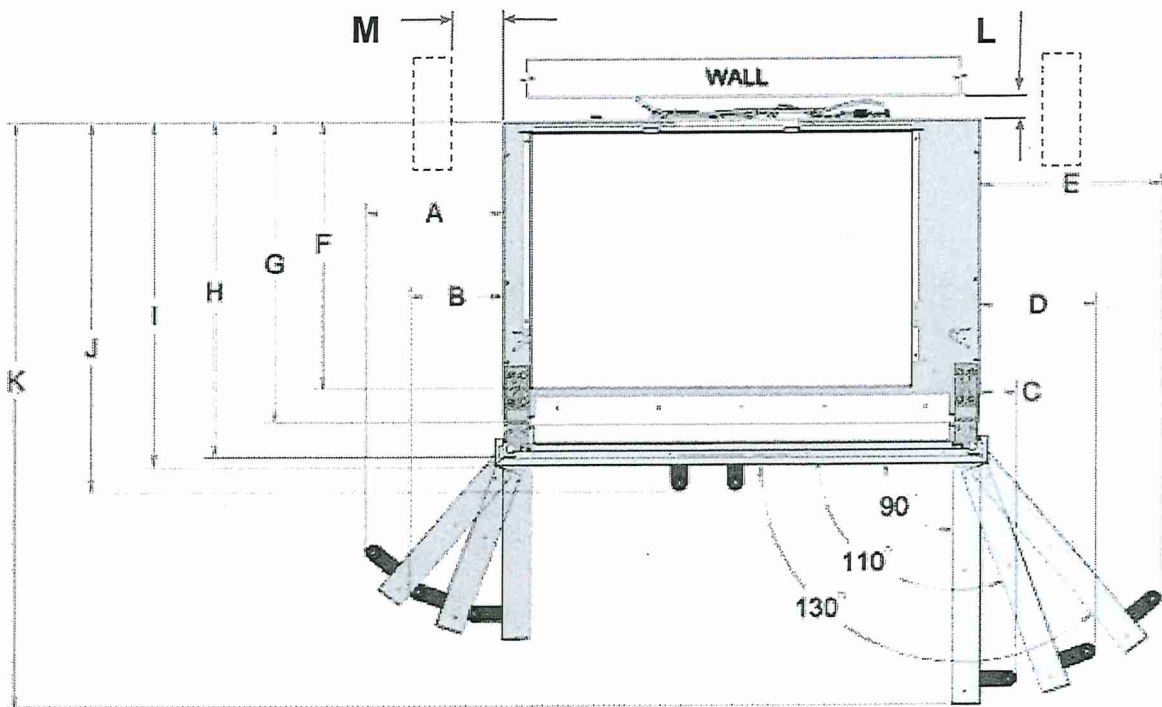

Description		Po (mm)
A	Largeur du côté CG du réfrigérateur à la poignée – porte complètement ouverte à 130°	10 po (254) 11 5/8 po (295,3) 13 1/4 po (336,5)
B	Largeur du côté CG du réfrigérateur à la poignée – porte complètement ouverte à 110°	6 3/4 po (171,5) 7 5/8 po (193,7) 8 7/16 po (214,3)
C	Largeur du côté CG du réfrigérateur à la poignée – porte ouverte à 90°	2 11/16 po (68,3)
D	Largeur du côté RF du réfrigérateur à la poignée – porte complètement ouverte à 110°	8 7/16 po (214,3) 9 5/8 po (244,5) 10 7/8 po (276,2)
E	Largeur du côté RF du réfrigérateur à la poignée – porte complètement ouverte à 130°	13 1/4 po (336,5) 15 1/2 po (393,7) 17 3/4 po (450,9)
F	Profondeur jusqu’au couvercle du compartiment de la machine	19 15/16 po (506,4)
G	Profondeur sans porte	22 3/8 po (568,3)
H	Profondeur avec les portes	25 po (635)
I	Profondeur avec la grille supérieure	25 13/16 po (655,6)
J	Profondeur avec les poignées	27 11/16 po (703,3)
K	Profondeur avec les portes du RF ouvertes à 90°	10 po (254) 11 5/8 po (295,3) 13 1/4 po (336,5)
L	Espace requis pour les canalisations d’eau et le cordon d’alimentation	1 po (25,4)
M	Espace requis pour l’armoire latérale	6 po (152,4)



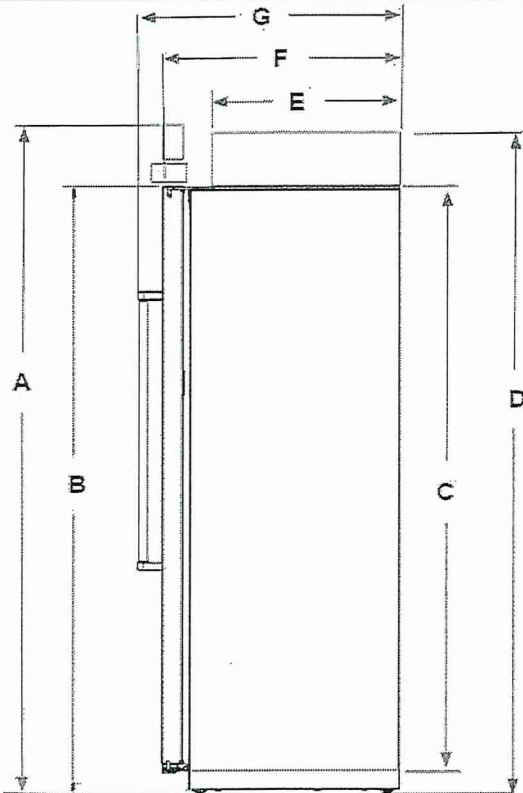

Description		Po (mm)
A	Hauteur totale	83 3⁄8 po (2117,7)
B	Hauteur jusqu'au sommet des portes	74 1⁄2 po (1892,3)
C	Hauteur de l'armoire	71 po (1803,4)
D	Hauteur jusqu'au haut du couvercle du compartiment de la machine	83 3⁄16 po (2113)
E	Profondeur jusqu'au couvercle du compartiment de la machine	19 15⁄16 po (506,4)
F	Profondeur avec les portes	25 po (635)
G	Profondeur avec les poignées	27 11⁄16 po (703,3)

Dimensions de l'intérieur	Largeur Po (mm)	Hauteur Po (mm)
Compartiment de réfrigération		
36 po	17 5⁄16 po (439,7)	67 1⁄16 po (1703,4)
42 po	20 13⁄16 po (528,6)	
48 po	24 5⁄16 po (617,5)	
Compartiment de congélation		
36 po	11 13⁄16 po (300)	66 3⁄4 po (1695,5)
42 po	14 5⁄16 po (363,5)	
48 po	16 13⁄16 po (427)	

Exigences d'emplacement

⚠ Avertissement

Risque d'explosion

Garder les matériaux et les vapeurs inflammables, telle que l'essence, loin du réfrigérateur.

Le non-respect de cette instruction peut causer un décès, une explosion ou un incendie.

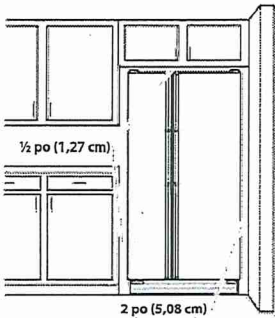

Pour obtenir une aération appropriée pour le réfrigérateur, laissez un espace de 1/2 po (12,7 mm) de chaque côté et au sommet. Laissez un espace de 1 po (25,4 mm) derrière le réfrigérateur. Si le réfrigérateur comporte une machine à glaçons, s'assurer qu'un espace additionnel est prévu à l'arrière pour permettre les raccordements des conduits d'eau. En cas d'installation du réfrigérateur près d'un mur fixe, laissez un minimum de 2 po (50,8 mm) de chaque côté (selon le modèle) pour permettre à la porte de s'ouvrir sans obstruction.

REMARQUES :

■ Ce réfrigérateur est conçu pour être utilisé dans un endroit où la température est comprise entre un minimum de 55 °F (13 °C) et un maximum de 110 °F (43 °C). La plage de température ambiante idéale pour un rendement optimal est comprise entre 60 °F (15 °C) et 90 °F (32 °C). Respecter cette plage de température permet aussi de réduire la consommation d'électricité et d'optimiser l'efficacité du refroidissement. Il est recommandé de ne pas installer le réfrigérateur près d'une source de chaleur comme un four ou un radiateur.

■ La largeur de la cavité d'encastrement doit être d'au moins 36 po (914,4 mm) pour l'installation du produit. Cependant, si le produit est placé contre une paroi avec prolongement et si on veut pouvoir retirer les poêles à croustiller, il convient d'élargir la cavité de 18 po (457,2 mm). On recommande donc une cavité d'encastrement d'une largeur totale de 54 po (1371,6 mm).

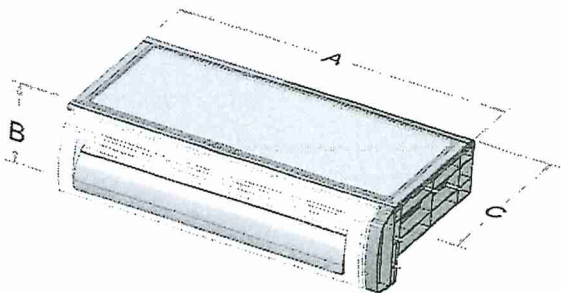

Bac à viande

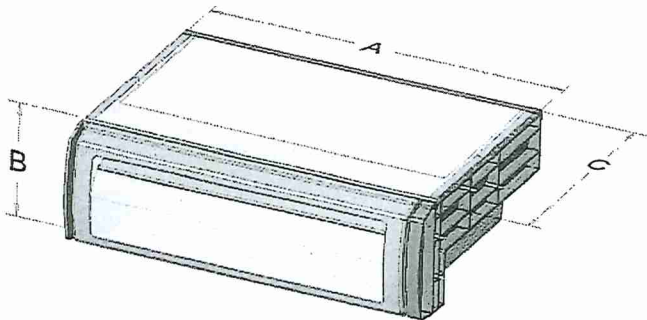

Bac à légumes

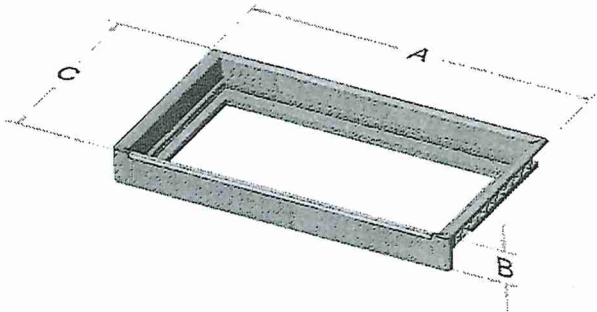

Tablette de rangement à plateau

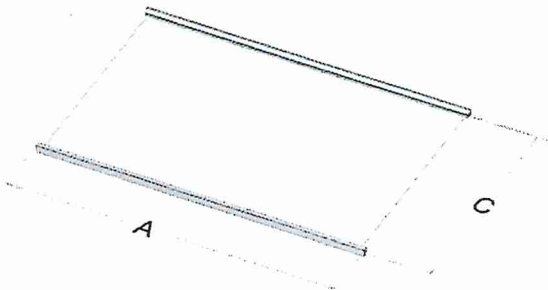

Tablette

Caractéristiques du réfrigérateur			
Description	A Largeur po (mm)	B Hauteur po (mm)	C Profondeur po (mm)
Bac à viande 36 po 42 po 48 po	17 1/8 po (435) 20 11/16 po (525,5) 24 3/16 po (614,4)	6 1/16 po (154)	12 7/8 po (327)
Bac à légumes 36 po 42 po 48 po	17 3/16 po (436,6) 20 11/16 po (525,5) 24 3/16 po (614,4)	7 15/16 po (201,6)	16 9/16 po (420,7)
Tablette de rangement à plateau 36 po 42 po 48 po	17 po (431,8) 20 7/16 po (519,1) 23 15/16 po (608)	2 3/8 po (60,3)	12 9/16 po (319,1)
Tablette 36 po 42 po 48 po	16 11/16 po (423,9) 20 3/16 po (512,8) 23 11/16 po (601,7)	S.O.	14 po (355,6)

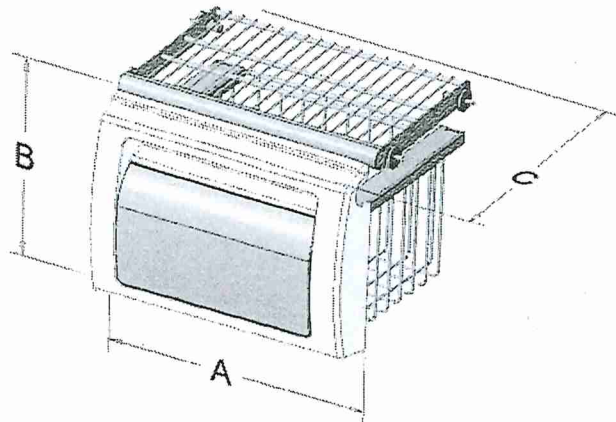

Panier du congélateur

LOT 35.

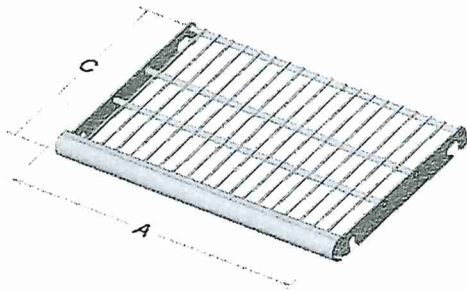

Tablette en broche du bas

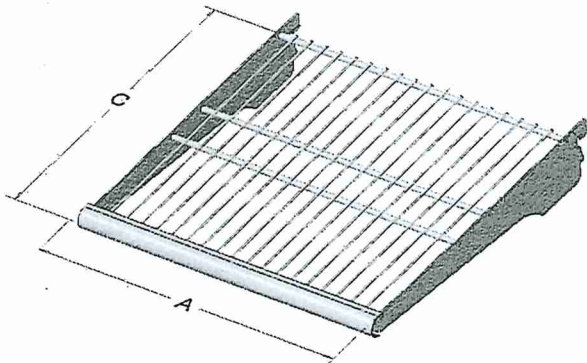

Tablette en broche du haut

Caractéristiques du congélateur			
Description	A Largeur po (mm)	B Hauteur po (mm)	C Profondeur po (mm)
Panier du congélateur 36 po 42 po 48 po	11 5/16 po (287,3) 13 3/4 po (349,3) 16 1/4 po (412,8)	8 7/16 po (214,3)	10 3/16 po (258,8)
Tablette en broche du bas 36 po 42 po 48 po	11 7/16 po (290,5) 13 7/8 po (352,4) 16 7/16 po (417,5)	S.O.	7 1/8 po (181)
Tablette en broche du haut 36 po 42 po 48 po	11 7/16 po (290,5) 13 7/8 po (352,4) 16 7/16 po (417,5)	S.O.	11 9/16 po (293,7)





SITE COPY

CONSTRUCTION SUMMARY

2185715 Ontario Inc.

PURCHASERS: RAMANDEEP,SINGH RAIKHI and GURPREET KAUR WALIA

TEL: RES.: 416-564-7270 BUS.: 416-564-7272

LOT NUMBER	PHASE	HOUSE TYPE	CLOSING DATE
035	1	ISABELLA-STD MAIN-5 BEDROOM-ELEVATION B	

Date Added: 01-Dec-22

Invoice Number: 8401

1 - Install Standard Cable Rough-ins (x2) and Install Standard Telephone Rough-Ins (x2) (See Sketch) Note: **As per the features and finishes list- all Master Bedroom and Family are prewired for TV rough in with Cat 6 Cable**
1 - GARAGE DOOR- Install the builders standard garage door handle with lock Note:
1 - KITCHEN & BATHROOM- SEE ATTACHED QUALITY TOPS & KITCHENS FOR ALL KITCHEN & BATHROOMS UPGRADES/LAYOUTS (See attached Upgrade Package) Note:
1 - KITCHEN- Install an upgarded kitchen undermount sink, in lieu of the builders standard. Install the Blanco QUATRUS U2 undermount kitchen sink Model # 401247 Note:
1 - KITCHEN -Install an upgrade kitchen faucet, Install the Moen Belifield Single Handle Pulldown Kitchen Faucet Chrome Model #7260 Note:
1 - KITCHEN- Install a Soap Dispenser Raditional or lotion dispenser Model #S3945 Chrome To be isnaltded on the right side of the sink (See Sketch) Note:
1 - KITCHEN - COUNTERTOP - Install a 1st Upgrade counter top in the kitchen – Emmerstone CALACATTA GOLD with To be installed throughout kitchen, where applicable (does not include stone backsplash) (See Sketch) Note:
1 - KITCHEN- Install an Upgrade "L" Edge throughout the kitchen, where applicable Note:
1 - KITCHEN- Accommodate the counter top for a drop in cook top Note: **Price is subject to change once all appliance specifications are received and reviewed**
1 - KITCHEN- Accommodate the electrical in the kitchen for a built in Oven and Micro Note: **Price is subject to change once all appliance specifications are received and reviewed**
1 - KITCHEN- As per QTK- Delete the upper cabinets baove the stove- Accommodate teh electrical for a future chimney style exhaust fan Note: **Price is subject to change once all appliance specifications are received and reviewed**
1 - KITCHEN BACKSPLASH- Install an Upgrade #2 kitchen backsplash- Install the 4x16 C&D TENDER GREY BRIGHT tile for the kitchen backsplash, throughout where applicable. Note:
1 - KITCHEN/ POWDER ROOM- COUNTERTOP - Purchaser accepts & acknowledges that the Stone slabs vary in size & all seams are visible & the fabricator reserves the right to position the seams as necessary. Note:
1 - POWDER ROOM - COUNTERTOP - Install Builders Standard Stone Countertop - Emmerstone MAPLE WHITE with STANDARD " A " EDGE PROFILE - To be installed throughout the Powder Room where applicable. To include 3" Splash(See Sketch) Note:
615 - MAIN FLOOR- Install an Upgrade floor tile on the main floor- Install the 24X24 GEOLOGY STONE , throughout the Foyer, Powder Room, Laundry room, Garage landing, Kitchen/Dinette Note:



SITE COPY

CONSTRUCTION SUMMARY

2185715 Ontario Inc.

PURCHASERS: RAMANDEEP,SINGH RAIKHI and GURPREET KAUR WALIA

TEL: RES.: 416-564-7270 BUS.: 416-564-7272

LOT NUMBER	PHASE	HOUSE TYPE	CLOSING DATE
035	1	ISABELLA-STD MAIN-5 BEDROOM-ELEVATION B	

Date Added: 01-Dec-22

Invoice Number: 8401

<p>1 - MAIN FLOOR- Install a Colour Change Upgrade hardwood flooring on the main floor, to include Main Hall, Living/Dining Room, Den, Family Room, lower landing, and all applicable stair landings. Install the Vintage Red Oak 3 1/4"x3/4" "Baja"</p> <p>Note:</p>
<p>1 - STAIRCASE VS FLOORING</p> <p>STAINING DIFFERENCE:</p> <p>STAIRCASE - The purchaser was advised and therefore accepts and acknowledges that the stain of the staircase and flooring chosen do not match. This difference might result in an undesirable colour variance.</p> <p>Note: The purchaser agrees that the vendor is to be exempt from any and all claims by the purchaser regarding this colour variance.</p>
<p>1 - UPPER HALL- Install an Upgrade 1 hardwood flooring on the Upper Hall, in lieu of the carpet. Install the Vintage Red Oak 3 1/4"x3/4" "Baja"</p> <p>Note:</p>
<p>1 - STAIRCASE- Install an upgrade #3 staircase package, throughout, where applicable; Install</p> <p>Handrail- TUDOR</p> <p>Pickets- Single Collar/ Plain Alt. with shoes</p> <p>Post- IRP-1 PC1 Cap</p> <p>Note:</p>
<p>1 - MASTER ENSUITE - COUNTERTOP - Install Builders Standard Stone Countertop - Emmerstone MAPLE WHITE with STANDARD " A " EDGE PROFILE - To be installed throughout the Master Ensuite where applicable. To include 3" Splash(See Sketch)</p> <p>Note:</p>
<p>122 - MASTER ENSUITE- Install an Upgrade #5 floor tile on teh master Ensuite floor- Install teh 24x24 ETERNA IMPERIAL GREY POLISHED Floor Tile</p> <p>Note:</p>
<p>110 - MASTER ENSUITE SHOWER STALL WALLS- Install an Upgrade #4 floor tile on the master Ensuite shower stall walls, in lieu of the builders standard- Install the 12x24 ETERNA IMPERIAL GREY POLISHED</p> <p>Note:</p>
<p>1 - MASTER ENSUITE SHOWER STALL CEILING- Install an Upgrade #4 floor tile on the master Ensuite shower stall ceiling, in lieu of the builders standard- Install the 12x24 ETERNA IMPERIAL GREY POLISHED</p> <p>Note:</p>
<p>1 - MASTER ENSUITE SHOWER STALL- Delete teh builders standard shower stall faucet, and Install the Moen CHATEAU Posi-Temp Tub/Shower Faucet with 3 Function Trasnfer Valve /Trim and Slide Bar with Hand Shower Model # TL183EP/U361CI/UT2721/3669EP/A725/62320</p> <p>Note: **Inlcudes Toe Tester**</p>
<p>2 - MASTER ENSUITE- Install upgrade undermount sinks in the master Ensuite- Install the Contrac "CATENA" Model # 4210CIY (X2 SINKS)</p> <p>Note: **Install builders standard faucet**</p>
<p>1 - TWIN BATH 2/3 - COUNTERTOP - Install Builders Standard Stone Countertop - Emmerstone PURE GRAY with STANDARD " A " EDGE PROFILE - To be installed throughout the Twin Bath where applicable. To include 3" Splash(See Sketch)</p> <p>Note:</p>
<p>1 - TWIN BATH 2/3 TUB/SHOWER CEILING- Install the 8x10 MALENA ICE wall tile on the Tub/Shower ceiling</p> <p>Note:</p>
<p>1 - TWIN BATH 2/3- Install a shower pot light for Twin Bath 2/3 Tub/Shower</p> <p>Note:</p>
<p>1 - ENSUITE #5- COUNTERTOP - Install Builders Standard Stone Countertop - Emmerstone GRAY GALAXY with STANDARD " A " EDGE PROFILE - To be installed throughout the Twin Bath 2 where applicable. To include 3" Splash(See Sketch)</p> <p>Note:</p>



SITE COPY

CONSTRUCTION SUMMARY  
2185715 Ontario Inc.

PURCHASERS: RAMANDEEP,SINGH RAIKHI and GURPREET KAUR WALIA

TEL: RES.: 416-564-7270 BUS.: 416-564-7272

LOT NUMBER	PHASE	HOUSE TYPE	CLOSING DATE
035	1	ISABELLA-STD MAIN-5 BEDROOM-ELEVATION B	

Date Added: 01-Dec-22 Invoice Number: 8401

<p>1 - ENSUITE #5 TUB/SHOWER CEILING- Install the 8x10 UNIWAL TENDER GREY wall tile on the Tub/Shower ceiling</p> <p>Note:</p>
<p>1 - ENSUITE #5- Install a shower pot light for Ensuite #5 Tub/Shower</p> <p>Note:</p>
<p>1 - ENSUITE #4- COUNTERTOP - Install Builders Standard Stone Countertop - Emmerstone MAPLE WHITE with STANDARD " A " EDGE PROFILE - To be installed throughout the Ensuite #4 where applicable. To include 3" Splash(See Sketch)</p> <p>Note:</p>
<p>1 - ENSUITE #4 SHOWER STALL CEILING- Install the 8x10 CINQE WHITE wall tile on the shower stall ceiling</p> <p>Note:</p>
<p>1 - ENSUITE #4- Delete teh builders standard tub/shower faucet and Install the Moen Chateau Posi Temp Tub/Shower Faucet with 4 Function Hand Shower Model # TL2359EP/62320 Chrome</p> <p>Note: **Includes Toe Tester**</p>
<p>1 - LAUNDRY ROOM- Install an upgrade Top Mount sink for the Laundry room- install the Blanco ESSENTIAL Laundry Topmount Sink Model # 401202 (4" Centre)</p> <p>Note: **Install the builders standard Faucet**</p>
<p>1 - PRIMARY ENSUITE / TWIN BATH / TWIN BATH 2/ ENSUITE #4 - COUNTERTOP - Purchaser accepts &amp; acknowledges that the Stone slabs vary in size &amp; all seams are visible &amp; the fabricator reserves the right to position the seams as necessary.</p> <p>Note:</p>
<p>1 - Purchaser to receive TEN (X10) Potlights on Main floor as per their Standard Features and Finishes List</p> <p>**SEE BELOW**</p> <p>Note:</p>
<p>10 - MAIN FLOOR POT LIGHTS- Upgrade the TEN (x10) builders standard main floor pot lights included in the Features &amp; Finishes List to Day Light 5000K bulb</p> <p>Note: Purchaser is paying for the difference between the standard pot light bulb to the Day Light 5000K pot light bulb</p> <p>Priced as per Campoli</p>
<p>1 - KITCHEN/DINETTE- In addition to the builders standard ceilings lights, Install SIX (X6) Day Light pot lights (5000k) in the kitchen/dinette area. All SIX (X6) pot lights to be on one switch (See Sketch)</p> <p>Note: **Keep standard ceiling light in the Dinette area**</p>
<p>1 - DEN- In addition to the builders standard ceilings light, Install FOUR (X4) Day Light pot lights (5000k) in the Den. All FOUR (X4) pot lights to be on one switch (See Sketch)</p> <p>Note: **Purchaser has been charged for a seperate switch only</p>
<p>1 - LIVING ROOM- In addiion to teh builders standard switch operated plugs, Install a ceiling lights centred with in the Living Room (See Sketch)</p> <p>Note:</p>
<p>1 - KITCHEN- In addition to the builders standard ceiling light , Install a ceiling light above the island , centred (See Sketch)</p> <p>Note: To be on its own switch</p>
<p>1 - MASTER ENSUITE- In addition to the builders standard vanity strip lighting- Install a ceiling light above the free standing tub, centred To be on its own switch (See Sketch)</p> <p>Note:</p>
<p>1 - ATTIC- BASEMENT- Install a Conduit pipe from Attic to Basement- to be dropped next to electrical panel</p> <p>Note:</p>





SITE COPY

CONSTRUCTION SUMMARY

2185715 Ontario Inc.

PURCHASERS: RAMANDEEP.SINGH RAIKHI and GURPREET KAUR WALIA

TEL: RES.: 416-564-7270 BUS.: 416-564-7272

LOT NUMBER	PHASE	HOUSE TYPE	CLOSING DATE
035	1	ISABELLA-STD MAIN-5 BEDROOM-ELEVATION B	

Date Added: 01-Dec-22

Invoice Number: 8401

1 - DEN- Install a CAT 6 R/I in the Den (See Sketch) Note:
1 - BEDROOM #3 - Install a CAT 6 R/I in the Bedroom #3(See Sketch) Note:
1 - BEDROOM #5 - Install a CAT 6 R/I in the Bedroom #5(See Sketch) Note:
1 - FAMILY ROOM- Install and Raise the conduit in the Family Room above teh fireplace mantle for future TV, To be installed 70" AFF (See Sketch) Note:
1 - FAMILY ROOM- Install an electrical plug in the Family Room above the fireplace mantle for future TV, To be installed 70" AFF (See Sketch) Note:
1 - FANILY ROOM- Install 5.1 Surround Sound Prewire,4 speakers and 1 Sub (Coax). (See Sketch for Approx. Locations) Note: Syltech to advise if a better location of Prewire,4 speakers and 1 Sub (Coax) is recomended
1 - Purchaser has been given a further discount of \$2,000 (Before taxes) Note: **As per Steve C
1 - PURCHASER AWARE AND ACCEPTS THAT ANY CHANGES MADE TO UPGRADES AFTER SIGNING THIS PURCHASERS EXTRA FORM ARE SUBJECT TO A MINIMUM ADMINISTRATION FEE OF \$1,000 PLUS A 10% HOLDBACK FEE. Note:
1 - PURCHASER HAS ATTENDED A STRUCTURAL AND COLOR APPOINTMENT AT THE DECOR CENTRE AND HAS DECLINED ANY ADDITIONAL UPGRADES. Note:

Date Added: 14-Jul-22

Invoice Number: 7890

3 - BASEMENT WINDOWS - Install Larger Basement Windows, in lieu of the builders standard 30"x16". Install THREE(x3) 36"x 24" Basement Windows (with possible window wells) (See Sketch) Note:
1 - BASEMENT WINDOWS - Shift and Enlarge ONE (1) Basement Window, from standard 30" x 16" to Larger 36"x24" at rear elevation. To be installed below at original fireplace bum out. (with possible window wells) (See Sketch) Note: **Price Includes Relocation of Basement Window**
1 - BASEMENT WINDOWS - Shift and Enlarge ONE (1) Basement Window, from standard 30" x 16" to Larger 36"x24" at rear elevation. To be installed below at original fireplace bum out. (with possible window wells) (See Sketch) Note: **Price Includes Relocation of Basement Window**
1 - FRONT EXTERIOR - Delete the builders standard Single Front Door, Sidelights & Transom. Install DOUBLE EXTENDED HEIGHT Front Doors with 3/4 Glass Inserts with Mullions (See Sketch) Note: As per Fonzie
1 - SIDE EXTERIOR- Install Optional SIDE EXTERIOR DOOR with applicable coach light (See Sketch) Note:
1 - FAMILY ROOM - Relocate Standard Gas Fireplace from back exterior elevation to side elevation between standard windows (Fireplace to be vented outside) (Includes Relocation of Side Basement Window) (See Sketch) Note: **DELETE Fireplace Bump Out at Rear Elevation Basement & Main Floor, Wall to be Straight** As per Tony



SITE COPY

CONSTRUCTION SUMMARY  
2185715 Ontario Inc.

PURCHASERS: RAMANDEEP,SINGH RAIKHI and GURPREET KAUR WALIA

TEL: RES.: 416-564-7270 BUS.: 416-564-7272

LOT NUMBER	PHASE	HOUSE TYPE	CLOSING DATE
035	1	ISABELLA-STD MAIN-5 BEDROOM-ELEVATION B	

Date Added: 14-Jul-22

Invoice Number: 7890

1 - FAMILY ROOM - Install ONE (1) WINDOW (3 Panel Approx 72" x 68") at Rear Elevation in lieu of standard windows at rear elevation (See Sketch) Note: Priced as per NewMar
1 - GARAGE - Relocate Central Vac Trunk Rough-In to Garage (in lieu of basement) Location Determined by Vendor Note:
1 - KITCHEN - Install GAS LINE ROUGH-IN (Includes Additional Applicable Electrical) to stove area of kitchen (See Sketch) Note:
1 - KITCHEN - Delete and Close Opening between kitchen and dining room (See Sketch) Note: **Purchaser is aware that the price above is ONLY to close the entrance from the kitchen to the dining room. Purchaser is aware that additional cabinetry will be chosen at some of colour chart and will be additional charge**
1 - LIVING ROOM / DINING ROOM - Enlarge Opening to living room / dining room with applicable nib walls on either side (See Sketch) Note:
1 - LIVING ROOM / DINING ROOM - Install OPTIONAL COFFERED CEILING Throughout perimeter of living room / dining room (See Sketch) Note: **COFFERED CEILING IS REQUIRED IF REMOVE WALL (SEE ABOVE ITEM)**
1 - LAUNDRY ROOM - Relocate Standard Door leading to Service Staircase at laundry room. (See Sketch) Note: Purchaser Accepts & Acknowledges the Service Staircase will be visible from the lower landing area
1 - MINIMUM CHARGE FOR ANY CHANGE TO STRUCTURE/FLOOR PLAN Note: As per Steve C.
1 - PRIMARY BEDROOM - Divide primary bedroom dressing room into 2 Walk-In Closets (HIS & HERS) and Primary Bedroom (See Sketch) Note: As per Steve C.
1 - BEDROOM #5 - Delete standard closet at bedroom #5. Install Walk-In Closet at Bedroom #5, using remainder of primary bedroom dressing room area. (See Sketch) Note: Window From Dressing Room Area to be Deleted, install additional wire shelving on exterior wall. As per Steve C.
1 - MASTER ENSUITE - reconfigure master ensuite. Close opening to master ensuite from dressing room. Door to master ensuite to be relocated. Relocate tub & shower to be against rear exterior wall. Note: Tub to be located under rear window and shifted if required. Toilet to be relocated against HIS Walk-In Closet wall. Side window to be shifted down beside toilet. Vanity to be relocated against closet wall. (Vanity Size to Remain as per Standard) (See Sketch)
1 - MASTER ENSUITE - Install ADDITIONAL FRAMELESS GLASS SHOWER at Master Ensuite shower stall. Shower Stall to be Enlarged to Approx. 60" x 42" (includes additional standard wall tile, 2x2 mosaics, 6" curb w/ with stone and additional frameless glass(See Sketch) Note: *Dummy Wall as Required to Accommodate Plumbing* **Color of Mosaics to be Determined During Decor Appointment**  As per Fonzie
1 - TWIN BATH #1 - Delete Linen Closet at Upper Hall, shift vanity of twin bath #1 towards bedroom #3. Linen closet at twin bath #1 to increase & have access from upper hall. Note: Increase Size of Bedroom #3 & Bedroom #2 by decreasing bedroom #3 W.I.C & twin bath #1. New closet at bedroom #3 to be double door, relocate linen closet door to accommodate double door closet. (See Sketch)
1 - BEDROOM #4 ENSUITE -Convert original seasonal closet & bedroom #4 walk-in closet to a Completed 3 Piece Bathroom at bedroom #4. To Include; Vanity, Builders Standard Toilet, Shower Stall (2x2 mosaics & Front of Shower Left Open) Note: and standard plumbing, applicable bathroom fan. (See Sketch) Closet at Bedroom #4 to be a standard single door closet (See Sketch)
1 - BEDROOM #4 ENSUITE - Install FRAMELESS GLASS PANEL and FRAMELESS GLASS SHOWER DOOR to Front of shower stall at bedroom #4 ensuite (See Sketch) Note:



SITE COPY

CONSTRUCTION SUMMARY

2185715 Ontario Inc.

PURCHASERS: RAMANDEEP,SINGH RAIKHI and GURPREET KAUR WALIA

TEL: RES.: 416-564-7270 BUS.: 416-564-7272

LOT NUMBER	PHASE	HOUSE TYPE	CLOSING DATE
035	1	ISABELLA-STD MAIN-5 BEDROOM-ELEVATION B	

Date Added: 14-Jul-22

Invoice Number: 7890

1 - TWIN BATH #2 - Delete Door to Twin Bath #2 from Upper Hall (See Sketch) Note:
1 - TWIN BATH #2 - Relocate and Enlarge Vanity by Approx 1'-0" in length (See Sketch)  *Price Does Not Include Additional Stone Countertop - Additional Countertop to be priced during decor appointment* Note: **Above Price is Based on STANDARD Cabinetry ONLY**, any upgrade cabinetry will be charged accordingly during QTK appointment**  As per Fonzie
1 - FRONT EXTERIOR - BALCONY - Install ONE (1) EXTERIOR COACH LIGHT with ONE (1) Seperate Switch at balcony door area. (See Sketch) Note:
1 - BONUS PACKAGE - PURCHASER HAS APPLIED \$20,000.00 (Includes Taxes) WORTH OF UPGRADE PROMOTIONAL PACKAGE TOWARDS THE PURCHASE OF STRUCTURAL UPGRADES COMPLETED AT THE DECOR CENTRE Note:
1 - Purchaser to Receive a Further Discount of \$2,000.00 (Before Taxes) - As per Fonzie C. Note:
1 - PURCHASER HAS ATTENDED A STRUCTURAL APPOINTMENT AT THE DECOR CENTRE AND HAS DECLINED ANY ADDITIONAL UPGRADES.Purchaser accepts and acknowledges that there will be no further structural changes/additions/deletions to be made upon signing on JULY 14,2022 Note:
1 - PURCHASER AWARE AND ACCEPTS THAT ANY CHANGES MADE TO UPGRADES AFTER SIGNING THIS PURCHASERS EXTRA FORM ARE SUBJECT TO A MINIMUM ADMINISTRATION FEE OF \$1,000 PLUS A 10% HOLDBACK FEE. Note:

Date Added:

Invoice Number: 8218

This Document is Extremely Time Sensitive - Printed 1 Dec 22 at 13:35







Quality Tops & Kitchens Ltd.  
80 Sante Drive, Vaughan, ON L4K 3C4  
T 416.746.1811 F 905.761.5901  
www.QTK.ca info@qtk.ca

**PURCHASE AGREEMENT FORM**

PURCHASER:		CONTRACTOR:	2185715 ONTARIO INC.	
ADDRESS:		SITE:	WEST RIVER VALLEY PH1, BRAMPTON	
EMAIL:		MODEL TYPE:	40-06 B	
PHONE #:		LOT #:	35 WRV	
PHONE #:		DATE:	Nov 23, 2022	Q10264

The purchaser agrees to buy and Quality Tops & Kitchens Ltd. (QTK) agrees to sell and provide for the purchaser the following articles listed herein and with attached drawing in accordance to the terms and conditions described on the reverse of this agreement form.

ROOM	DESCRIPTION	CATEGORY
KITCHEN	DOOR STYLE: QT 2101 FLAT VENEER PANEL FINISH: PISTACHIO SPECIES: FLAT CUT MAPLE DOOR HARDWARE: DRW HARDWARE: COUNTER TOP: Counter Top by Others	Category 2

ITEM #	QTY	DESCRIPTION	PRICE
CK-3PD	1	DROP IN COOK-TOP w/ POT DRWS w/ BLUM ANTARO WHITE - P/D 3 (1 SMALL, 2 BIG DRW) ✓	
DUAS	1	DELETE UPPER ABOVE STOVE	
TCS2696	*	STRAIGHT PANTRY CABINET - 26"D x 95-1/2"H (STANDALONE) - (OPTION PAID FOR BY BUILDER)	
BGB2-17	1	DOUBLE BIN PULL-OUT RECYCLE 17" WIDE CAB	
PF2696	1	BUILT-IN FOR PROFESSIONAL SERIES FRIDGES 26" DEEP x 95-1/2"H	
CUST-1	1	BUILT-IN MICRO & WALL OVEN w/ WOOD DRAWER(S) BELOW - 26" D x 95-1/2"H (INCL. FILLED IN VOID SPACE) ✓	
CUST-5	1	4" HIGH Z-42 CROWN MOULDING (DOESN'T GO TO CELING/BULKHEAD) OPTION PAID FOR BY BUILDER	
CUST-6	1	4BD BANK OF DRAWER (4 EQ. DRAWERS) OPTION PAID FOR BY BUILDER	
CUST-12	1	CATEGORY 2 DOOR STYLE & FINISH: QTC 2101 PISTACHIO (FLAT CUT MAPLE)	
CUST-13	1	CATEGORY 1 HARDWARE: DH00010	
ROOM SUMMARY:			

ROOM	DESCRIPTION	CATEGORY
MASTER ENSUITE VANITY	DOOR STYLE: QT 3801 NONE FINISH: WROUGHT IRON SPECIES: FIBERBOARD DOOR HARDWARE: DRW HARDWARE: COUNTER TOP: Counter Top by Others	Category 5

ITEM #	QTY	DESCRIPTION	PRICE
CUST-3	1	1 CONVERT TOP DRAWER INTO 1 SET OF VANITY DRAWER VBD/3 ( 1 SMALL, 2 BIG DRAWERS)	
CUST-4	1	CATEGORY 5 DOOR STYLE AND FINISH: QTF 3801 WROUGHT IRON (FIBERBOARD)	
CUST-5	1	CATEGORY 1 HARDWARE: DH00010	
ROOM SUMMARY:			

ROOM	DESCRIPTION	CATEGORY
TWIN BATH # 2/3 VANITY	DOOR STYLE: QT 1622 NONE FINISH: WILLOW GREY SUPERMATTE SPECIES: LP LAMINATE DOOR HARDWARE: DRW HARDWARE: COUNTER TOP: Counter Top by Others	Category 1

ITEM #	QTY	DESCRIPTION	PRICE
BCAB-P	1	BASE CABINETS AS PER DRAWINGS PROVIDED - (OPTION PAID FOR BY BUILDER)	
CUST-3	1	CATEGORY 1 DOOR STYLE AND FINISH: QTC 1622 WILLOW GREY (SM) LP LAMINATE	
CUST-4	1	CATEGORY 1 HARDWARE: DH00010	





your kitchen. your taste.

Quality Tops & Kitchens Ltd.  
80 Sante Drive, Vaughan, ON L4K 3C4  
T 416.746.1811 F 905.761.5901  
www.QTK.ca info@qtk.ca

**PURCHASE AGREEMENT FORM**

PURCHASER:		CONTRACTOR:	2185715 ONTARIO INC.
ADDRESS:		SITE:	WEST RIVER VALLEY PH1, BRAMPTON
EMAIL:		MODEL TYPE:	40-06 B
PHONE #:		LOT #:	35 WRV
PHONE #:		DATE:	Nov 23, 2022 Q10264

		ROOM SUMMARY:	
--	--	---------------	--

ROOM	DESCRIPTION	CATEGORY
ENSUITE # 5 VANITY	DOOR STYLE: QT 1622 NONE FINISH: WILLOW GREY SUPERMATTE SPECIES: LP LAMINATE DOOR HARDWARE: DRW HARDWARE: COUNTER TOP: Counter Top by Others	Category 1

ITEM #	QTY	DESCRIPTION	PRICE
BCAB-P	1	BASE CABINETS AS PER DRAWINGS PROVIDED - (OPTION PAID FOR BY BUILDER)	
CUST-3	1	CATEGORY 1 DOOR STYLE AND FINISH: QTC 1622 WILLOW GREY (SM) LP LAMINATE	
CUST-4	1	CATEGORY 1 HARDWARE: DH00010	
		ROOM SUMMARY:	

ROOM	DESCRIPTION	CATEGORY
ENSUITE 4 VANITY	DOOR STYLE: QT 1022 NONE FINISH: BLACKWOOD SPECIES: LP LAMINATE DOOR HARDWARE: DRW HARDWARE: COUNTER TOP: Counter Top by Others	Category 1

ITEM #	QTY	DESCRIPTION	PRICE
BCAB-P	1	BASE CABINETS AS PER DRAWINGS PROVIDED - (OPTION PAID FOR BY BUILDER)	
CUST-3	1	CATEGORY 1 DOOR STYLE AND FINISH: QTC 1022 BLACKWOOD (TX) LP LAMINATE	
CUST-4	1	CATEGORY 1 HARDWARE: DH00010	
		ROOM SUMMARY:	

ROOM	DESCRIPTION	CATEGORY
POWDER ROOM VANITY	DOOR STYLE: QT 2101 NONE FINISH: WILLOW SPECIES: FIBERBOARD DOOR HARDWARE: DRW HARDWARE: COUNTER TOP: Counter Top by Others	Category 5

ITEM #	QTY	DESCRIPTION	PRICE
CUST-2	1	FLOATING VANITY w/ 1 DRAWER & FALSE PANEL ABOVE - 10-1/2" FFL(WALL TO WALL) - OPTION PAID FOR BY BUILDER	
CUST-3	1	CATEGORY 5 DOOR STYLE AND FINISH: QTF 2101 WILLOW (FIBERBOARD)	
CUST-4	1	CATEGORY 1 HARDWARE: DH00010	
		ROOM SUMMARY:	





Quality Tops & Kitchens Ltd.  
80 Sante Drive, Vaughan, ON L4K 3C4  
T 416.746.1811 F 905.761.5901  
www.QTK.ca info@qtk.ca

PURCHASE AGREEMENT FORM

PURCHASER:		CONTRACTOR:		2185715 ONTARIO INC.	
ADDRESS:		SITE:		WEST RIVER VALLEY PH1, BRAMPTON	
EMAIL:		MODEL TYPE:		40-06 B	
PHONE #:		LOT #:		35 WRV	
PHONE #:		DATE:		Nov 23, 2022 Q10264	

ROOM	DESCRIPTION	CATEGORY
LAUNDRY ROOM	DOOR STYLE: QT 1022 NONE FINISH: WILLOW GREY SUPERMATTE SPECIES: LP LAMINATE DOOR HARDWARE: DRW HARDWARE: COUNTER TOP: Counter Top by Others	Category 1

ITEM #	QTY	DESCRIPTION	PRICE
CUST-4	1	QTC 1622 WILLOW GREY (SM) LAMINATE - (CATEGORY 1 UPGRADE)	
CUST-5	1	CATEGORY 1 HARDWARE: DH00010	
ROOM SUMMARY:			

EXPECTED DELIVERY DATE	TBD	SUB-TOTAL:	
Customers please note all garbage bins, spice baskets, magic corner baskets and other accessories will only be delivered AFTER you move in the house. Please call us to request delivery of these items after you move in. Thank you. ALL CHANGES FINAL UPON SIGNING PLEASE READ ALL THE TERMS AND CONDITIONS ON THE ACCOMPANYING QTK TERMS & CONDITIONS DOCUMENT. BY SIGNING BELOW YOU AGREE TO RECEIVE THE ITEMS LISTED HEREIN AND PAY (ACCORDING TO QTK'S PAYMENT POLICY), AND HAVE READ AND UNDERSTOOD THE TERMS & CONDITIONS AS OUTLINED IN THE QTK TERMS & CONDITIONS DOCUMENT.		TOTAL:	
		HST	
		GRAND TOTAL:	
		DEPOSIT 1 DATE:	DEPOSIT 1:
DEPOSIT 2 DATE:	DEPOSIT 2:		
BALANCE TO BE PAID IN FULL BY DUE DATE:		CUSTOMER INITIAL(S):	

CUSTOMER SIGNATURE:	DATE:
CUSTOMER SIGNATURE:	DATE:
SALES REP NAME: - apD QTK AUTHORIZED SIGNATURE:	

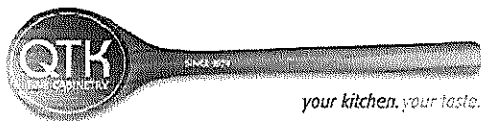

80 Sante Drive, Vaughan, ON L4K 3C4  
T 416.746.1811 F 905.761.5901  
www.QTK.ca info@qtk.ca

CLIENT: ROYAL PINE HOMES	JOB NAME: LOT 35 WRV (40-06)	ROOM: KITCHEN	DRAWN BY: RP
SITE: WEST RIVER VALLEY	DOOR STYLE: __	DOOR HANDLE: __	SCALE: 1/2" = 1'-0"
PHONE: __	FINISH: __	DRW HANDLE: __	DATE: Sept 16, 2022
EMAIL: __	SPECIES: __	TOP: __	PAGE:
COMMENTS:			

Customer Agrees and Accepts the following conditions: 1. The Drawing is a representation only and the installed cabinetry may vary slightly in product size, measurements, handle appearance and location and other details. Although Quality Tops & Kitchens Ltd. (QTK) does it's best to manufacture exactly what is shown here outside factors may prevent that and some variance is to be expected and accepted by the customer. 2. These drawings represent the intellectual property of QTK and as such the customer understands and accepts that all deposits given by the customer to QTK are non-refundable after QTK has supplied drawings (either physically or electronically) to the customer. If the customer decides to cancel the order after QTK has submitted drawings to the customer, the deposit will then be considered a design fee and no money will be returned to the customer.

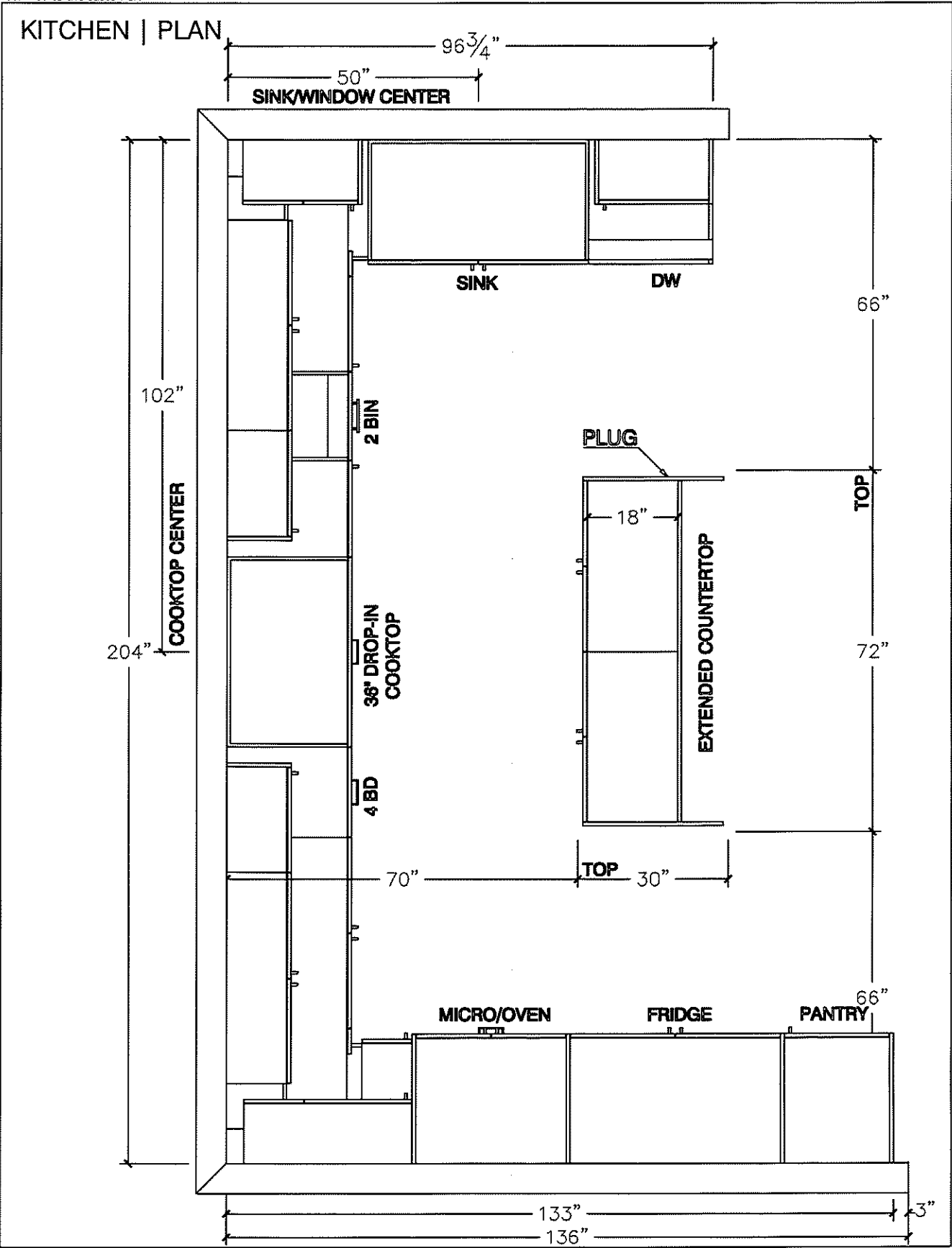

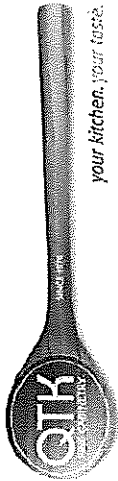

80 Sante Drive, Vaughan, ON L4K 3C4  
T 416.746.1811 F 905.761.5901  
www.QTK.ca info@qtk.ca

CLIENT: ROYAL PINE HOMES	JOB NAME: LOT 35 WRV (40-6)	ROOM: KITCHEN	DRAWN BY: RP
SITE: WEST RIVER VALLEY	DOOR STYLE: —	DOOR HANDLE: —	SCALE: 1/2" = 1'-0"
PHONE: —	FINISH: —	DRW HANDLE: —	DATE: Sept 16, 2022
EMAIL: —	SPECIES: —	TOP: —	PAGE:

COMMENTS:

Customer Agrees and Accepts the following conditions: 1. The Drawing is a representation only and the installed cabinetry may vary slightly in product size, measurements, handle appearance and location and other details. Although Quality Tops & Kitchens Ltd. (QTK) does it's best to manufacture exactly what is shown here outside factors may prevent that and some variance is to be expected and accepted by the customer. 2. These drawings represent the intellectual property of QTK and as such the customer understands and accepts that all deposits given by the customer to QTK are non-refundable after QTK has supplied drawings (either physically or electronically) to the customer. If the customer decides to cancel the order after QTK has submitted drawings to the customer, the deposit will then be considered a design fee and no money will be returned to the customer.

STOVE WALL | ELEVATION

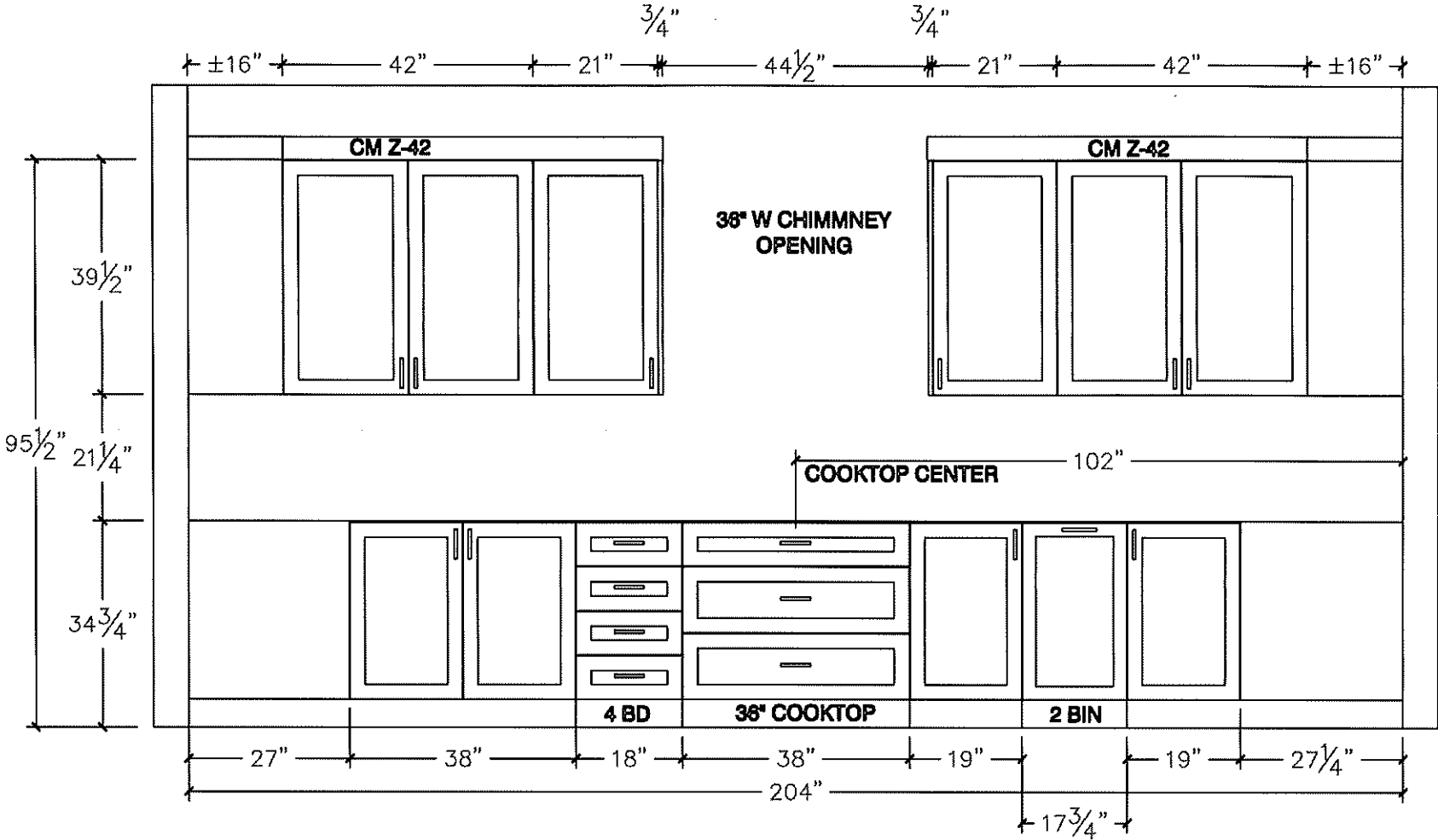



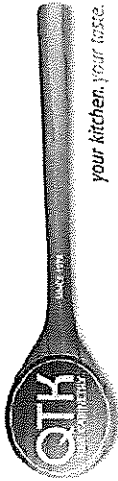

80 Sante Drive, Vaughan, ON L4K 3C4  
T 416.746.1811 F 905.761.5901  
www.QTK.ca info@qtk.ca

CLIENT: ROYAL PINE HOMES	JOB NAME: LOT 35 WRV (40-6)	ROOM: KITCHEN	DRAWN BY: RP
SITE: WEST RIVER VALLEY	DOOR STYLE: —	DOOR HANDLE: —	SCALE: 1/2" = 1'-0"
PHONE: —	FINISH: —	DRW HANDLE: —	DATE: Sept 16, 2022
EMAIL: —	SPECIES: —	TOP: —	PAGE:

COMMENTS:

Customer Agrees and Accepts the following conditions: 1. The Drawing is a representation only and the installed cabinetry may vary slightly in product size, measurements, handle appearance and location and other details. Although Quality Tops & Kitchens Ltd. (QTK) does it's best to manufacture exactly what is shown here outside factors may prevent that and some variance is to be expected and accepted by the customer. 2. These drawings represent the intellectual property of QTK and as such the customer understands and accepts that all deposits given by the customer to QTK are non-refundable after QTK has supplied drawings (either physically or electronically) to the customer. If the customer decides to cancel the order after QTK has submitted drawings to the customer, the deposit will then be considered a design fee and no money will be returned to the customer.

FRIDGE WALL | ELEVATION

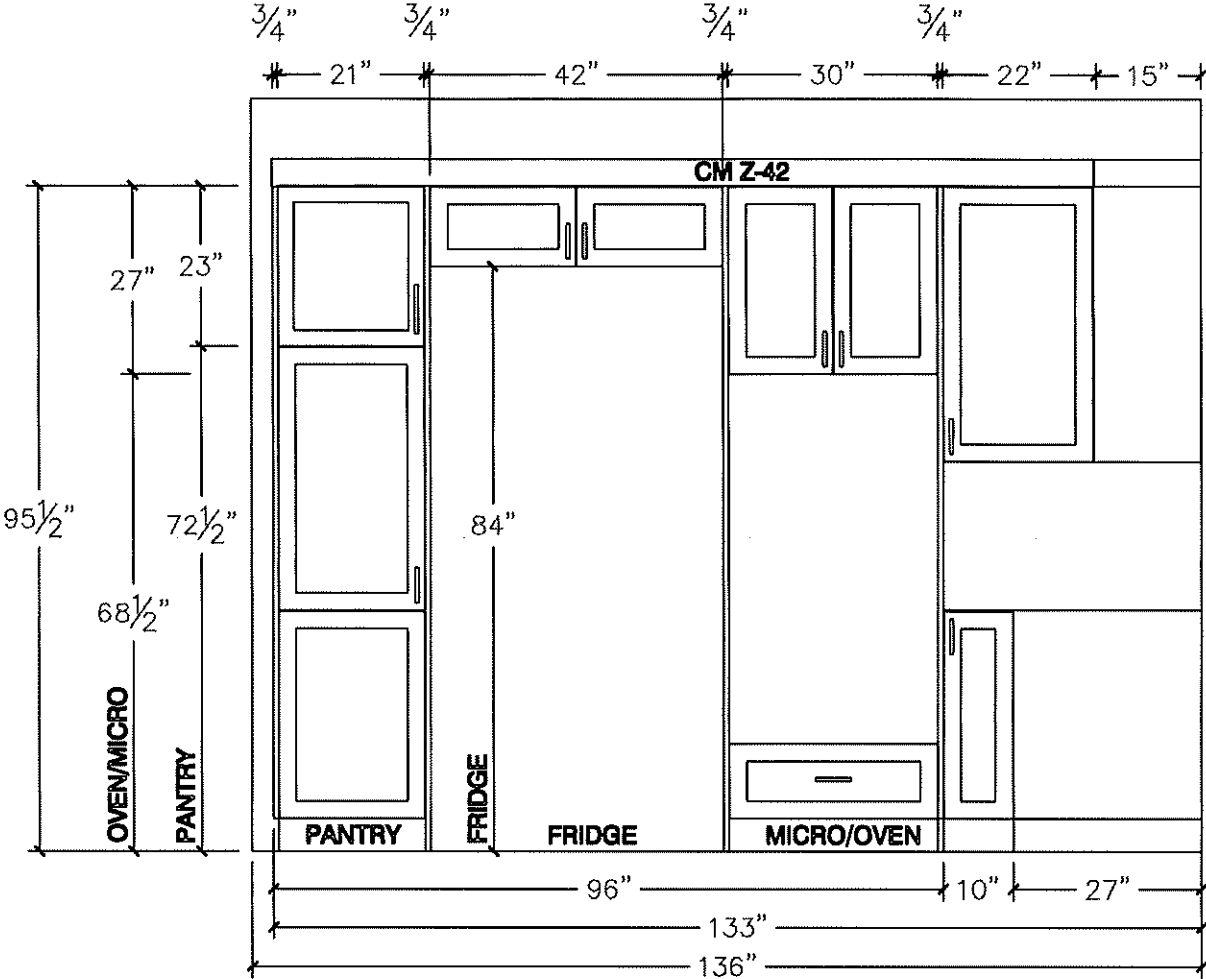

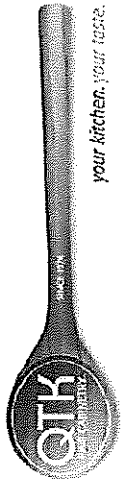

80 Sante Drive, Vaughan, ON L4K 3C4  
T 416.746.1811 F 905.761.5901  
www.QTK.ca info@qtk.ca

CLIENT: ROYAL PINE HOMES	JOB NAME: LOT 35 WRV (40-6)	ROOM: KITCHEN	DRAWN BRP
SITE: WEST RIVER VALLEY	DOOR STYLE: —	DOOR HANDLE: —	SCALE: 1/2" = 1'-0"
PHONE: —	FINISH: —	DRW HANDLE: —	DATE: Sept 16, 2022
EMAIL: —	SPECIES: —	TOP: —	PAGE:
COMMENTS:			

Customer Agrees and Accepts the following conditions: 1. The Drawing is a representation only and the installed cabinetry may vary slightly in product size, measurements, handle appearance and location and other details. Although Quality Tops & Kitchens Ltd. (QTK) does it's best to manufacture exactly what is shown here outside factors may prevent that and some variance is to be expected and accepted by the customer. 2. These drawings represent the intellectual property of QTK and as such the customer understands and accepts that all deposits given by the customer to QTK are non-refundable after QTK has supplied drawings (either physically or electronically) to the customer. If the customer decides to cancel the order after QTK has submitted drawings to the customer, the deposit will then be considered a design fee and no money will be returned to the customer.

SINK WALL | ELEVATION

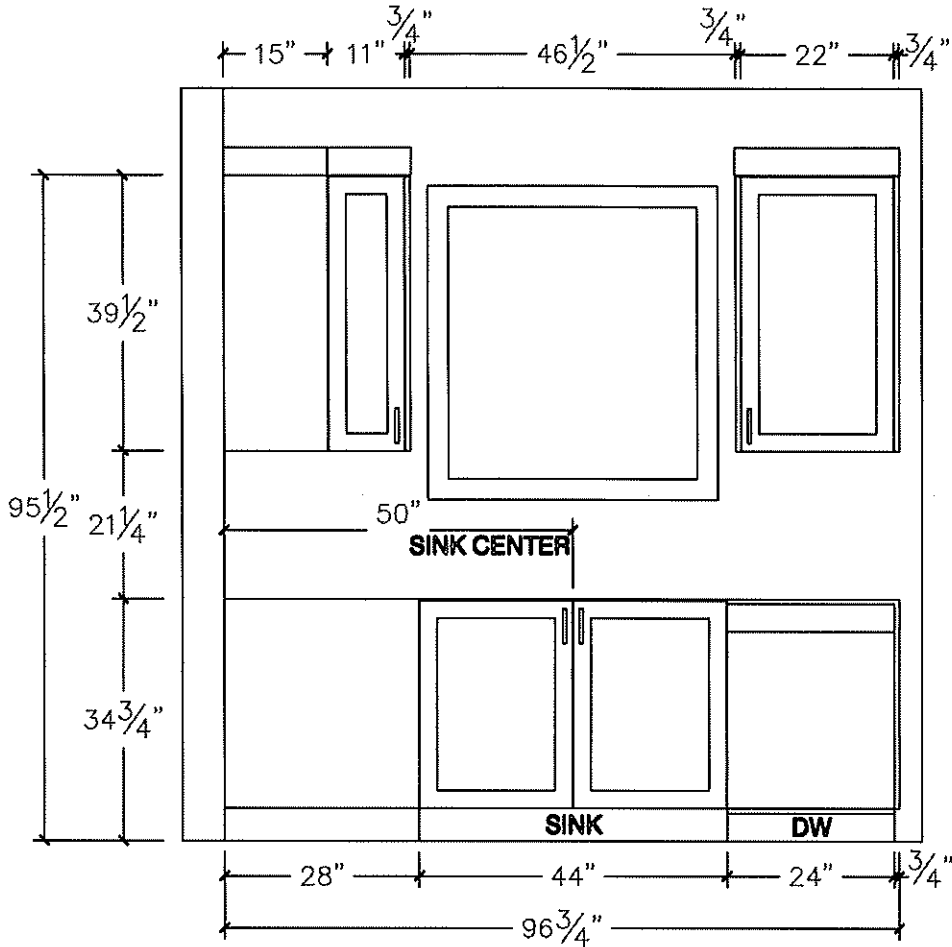

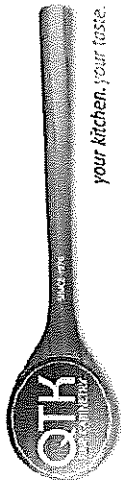

80 Sante Drive, Vaughan, ON L4K 3C4  
T 416.746.1811 F 905.761.5901  
www.QTK.ca info@qtk.ca

CLIENT: ROYAL PINE HOMES	JOB NAME: LOT 35 WRV (40-6)	ROOM: KITCHEN	DRAWN BRP
SITE: WEST RIVER VALLEY	DOOR STYLE: —	DOOR HANDLE: —	SCALE: 1/2" = 1'-0"
PHONE: —	FINISH: —	DRW HANDLE: —	DATE: Sept 16, 2022
EMAIL: —	SPECIES: —	TOP: —	PAGE:
COMMENTS:			

Customer Agrees and Accepts the following conditions: 1. The Drawing is a representation only and the installed cabinetry may vary slightly in product size, measurements, handle appearance and location and other details. Although Quality Tops & Kitchens Ltd. (QTK) does it's best to manufacture exactly what is shown here outside factors may prevent that and some variance is to be expected and accepted by the customer. 2. These drawings represent the intellectual property of QTK and as such the customer understands and accepts that all deposits given by the customer to QTK are non-refundable after QTK has supplied drawings (either physically or electronically) to the customer. If the customer decides to cancel the order after QTK has submitted drawings to the customer, the deposit will then be considered a design fee and no money will be returned to the customer.

ISLAND FRONT | ELEVATION

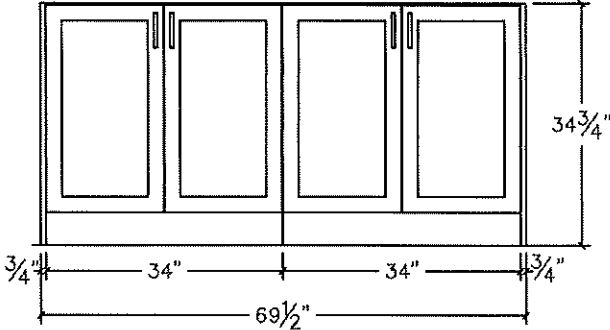

ISLAND REAR | ELEVATION

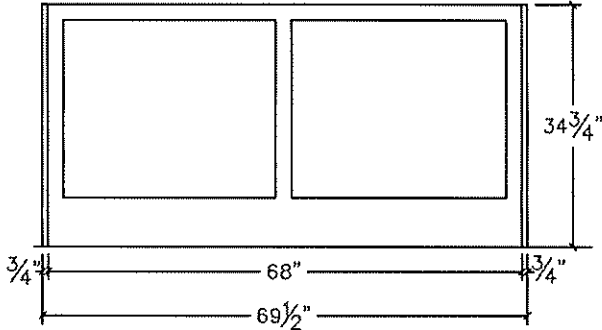

ISLAND SIDE | ELEVATION

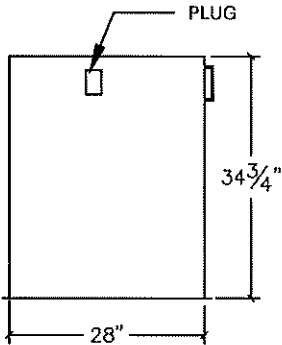





80 Sante Drive, Vaughan, ON L4K 3C4  
T 416.746.1811 F 905.761.5901  
www.QTK.ca info@qtk.ca

CLIENT: ROYAL PINE HOMES	JOB NAME: LOT 35 WRV (40-06)	ROOM: KITCHEN	DRAWN BY: RP
SITE: WEST RIVER VALLEY	DOOR STYLE: __	DOOR HANDLE: __	SCALE: 1/2" = 1'-0"
PHONE: __	FINISH: __	DRW HANDLE: __	DATE: Sept 16, 2022
EMAIL: __	SPECIES: __	TOP: __	PAGE:

COMMENTS:

Customer Agrees and Accepts the following conditions: 1. The Drawing is a representation only and the installed cabinetry may vary slightly in product size, measurements, handle appearance and location and other details. Although Quality Tops & Kitchens Ltd. (QTK) does it's best to manufacture exactly what is shown here outside factors may prevent that and some variance is to be expected and accepted by the customer. 2. These drawings represent the intellectual property of QTK and as such the customer understands and accepts that all deposits given by the customer to QTK are non-refundable after QTK has supplied drawings (either physically or electronically) to the customer. If the customer decides to cancel the order after QTK has submitted drawings to the customer, the deposit will then be considered a design fee and no money will be returned to the customer.

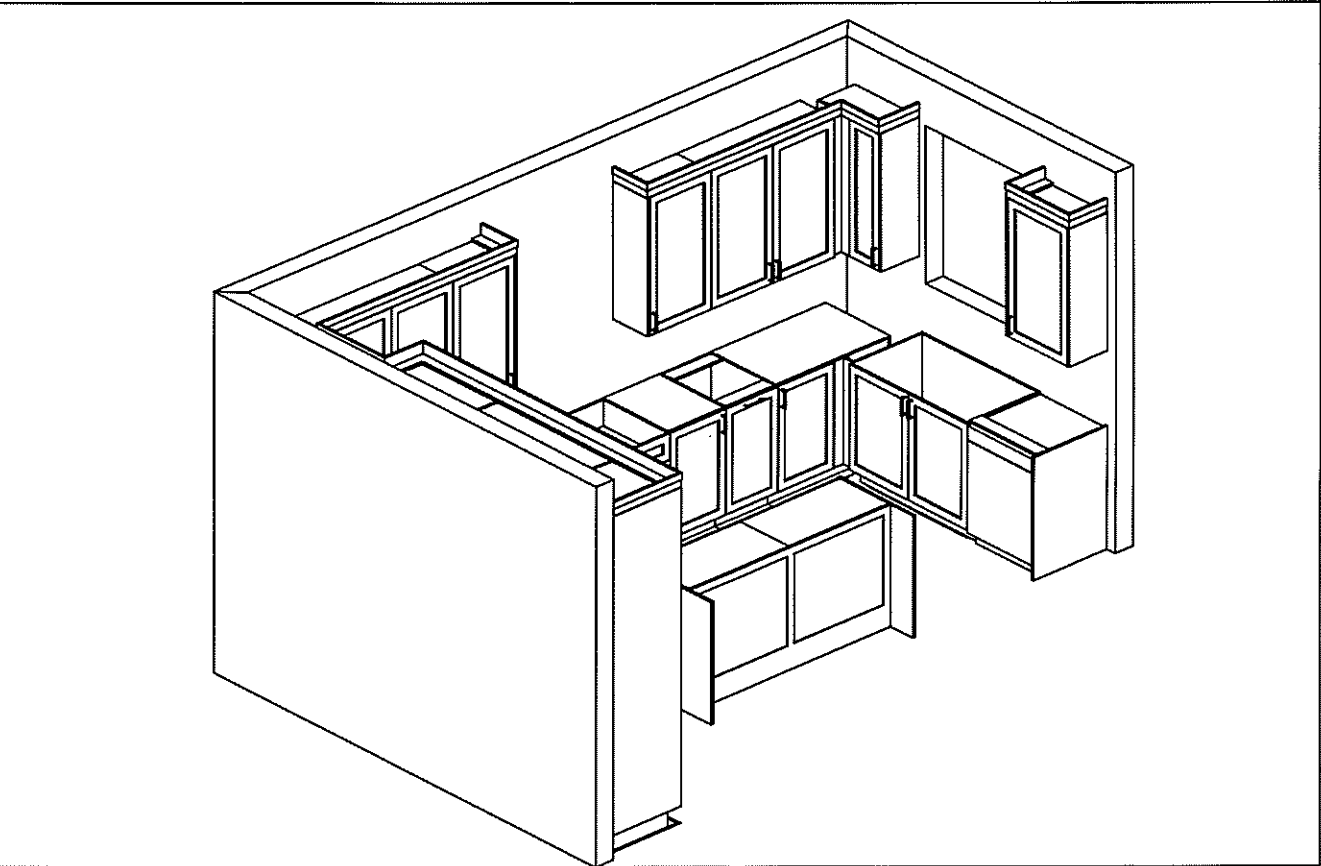
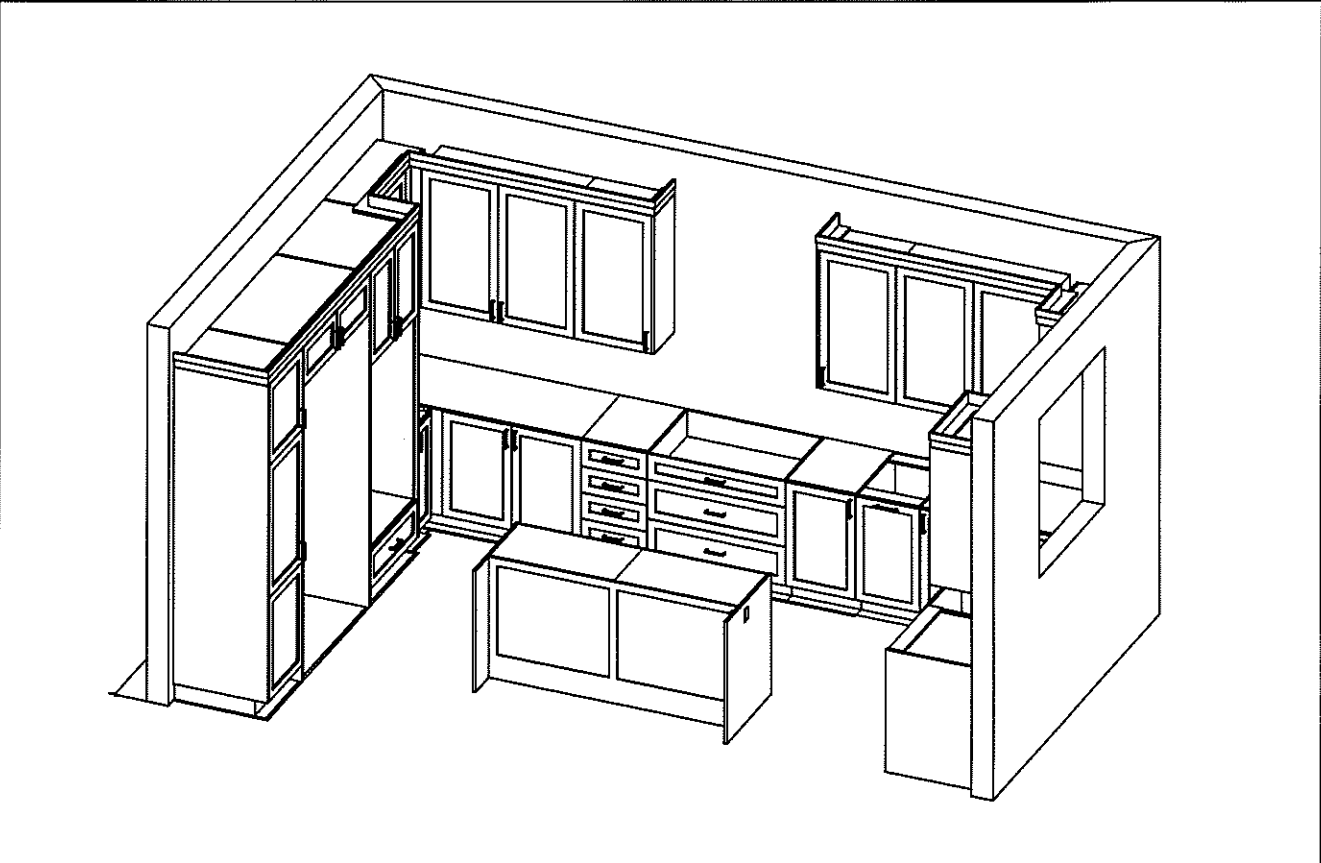

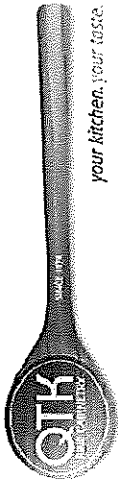

80 Sante Drive, Vaughan, ON L4K 3C4  
T 416.746.1811 F 905.761.5901  
www.QTK.ca info@qtk.ca

CLIENT: ROYAL PINE HOMES	JOB NAME: LOT 35 WRV (40-6)	ROOM:	VANITY	DRAWN BY: RP
SITE: WEST RIVER VALLEY	DOOR STYLE: —	DOOR HANDLE:	—	SCALE: 1/2" = 1'-0"
PHONE: —	FINISH: —	DRW HANDLE:	—	DATE: Sept 16, 2022
EMAIL: —	SPECIES: —	TOP:	—	PAGE:
COMMENTS:				

Customer Agrees and Accepts the following conditions: 1. The Drawing is a representation only and the installed cabinetry may vary slightly in product size, measurements, handle appearance and location and other details. Although Quality Tops & Kitchens Ltd. (QTK) does it's best to manufacture exactly what is shown here outside factors may prevent that and some variance is to be expected and accepted by the customer. 2. These drawings represent the intellectual property of QTK and as such the customer understands and accepts that all deposits given by the customer to QTK are non-refundable after QTK has supplied drawings (either physically or electronically) to the customer. If the customer decides to cancel the order after QTK has submitted drawings to the customer, the deposit will then be considered a design fee and no money will be returned to the customer.

MASTER ENSUITE (4 BED) | PLAN

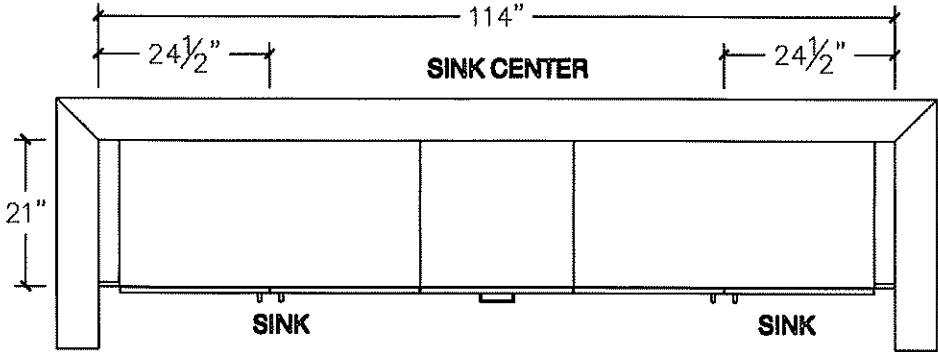

MASTER ENSUITE (4 BED) | ELEVATION

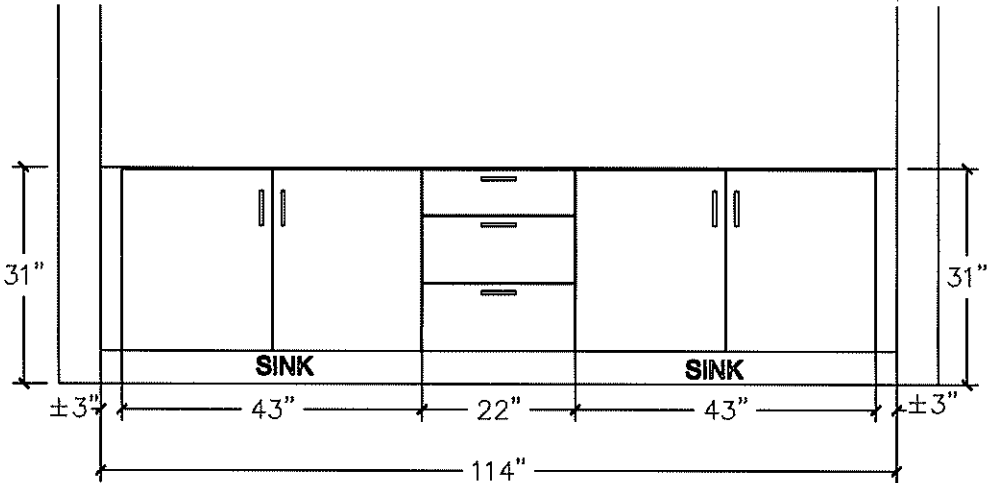

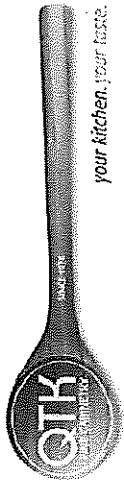

80 Sante Drive, Vaughan, ON L4K 3C4  
T 416.746.1811 F 905.761.5901  
www.QTK.ca info@qtk.ca

CLIENT: ROYAL PINE HOMES	JOB NAME: LOT 35 WRV (40-6)	ROOM: VANITY	DRAWN BY: RP
SITE: WEST RIVER VALLEY	DOOR STYLE: —	DOOR HANDLE: —	SCALE: 1/2" = 1'-0"
PHONE: —	FINISH: —	DRW HANDLE: —	DATE: Sept 16, 2022
EMAIL: —	SPECIES: —	TOP: —	PAGE:
COMMENTS:			

Customer Agrees and Accepts the following conditions: 1. The Drawing is a representation only and the installed cabinetry may vary slightly in product size, measurements, handle appearance and location and other details. Although Quality Tops & Kitchens Ltd. (QTK) does it's best to manufacture exactly what is shown here outside factors may prevent that and some variance is to be expected and accepted by the customer. 2. These drawings represent the intellectual property of QTK and as such the customer understands and accepts that all deposits given by the customer to QTK are non-refundable after QTK has supplied drawings (either physically or electronically) to the customer. If the customer decides to cancel the order after QTK has submitted drawings to the customer, the deposit will then be considered a design fee and no money will be returned to the customer.

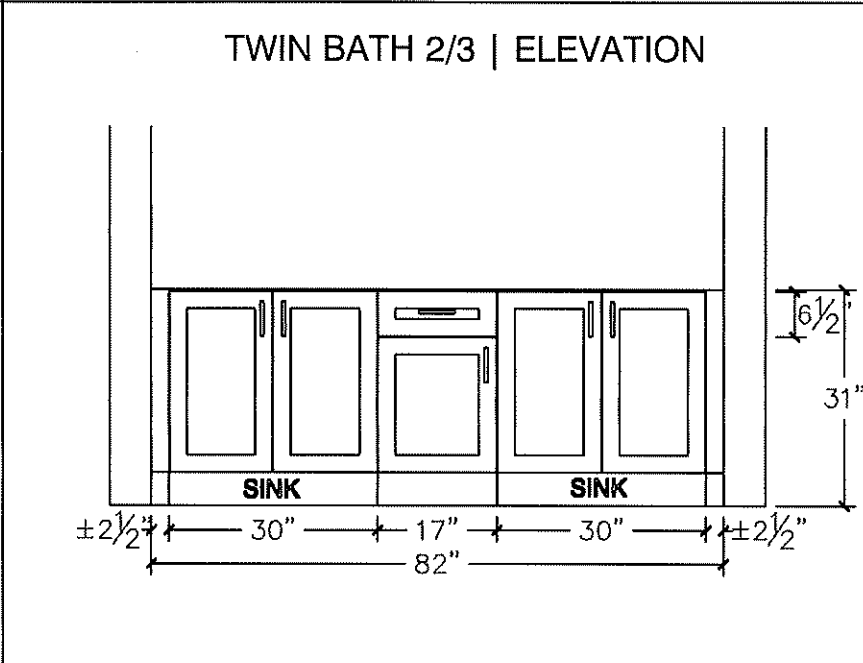
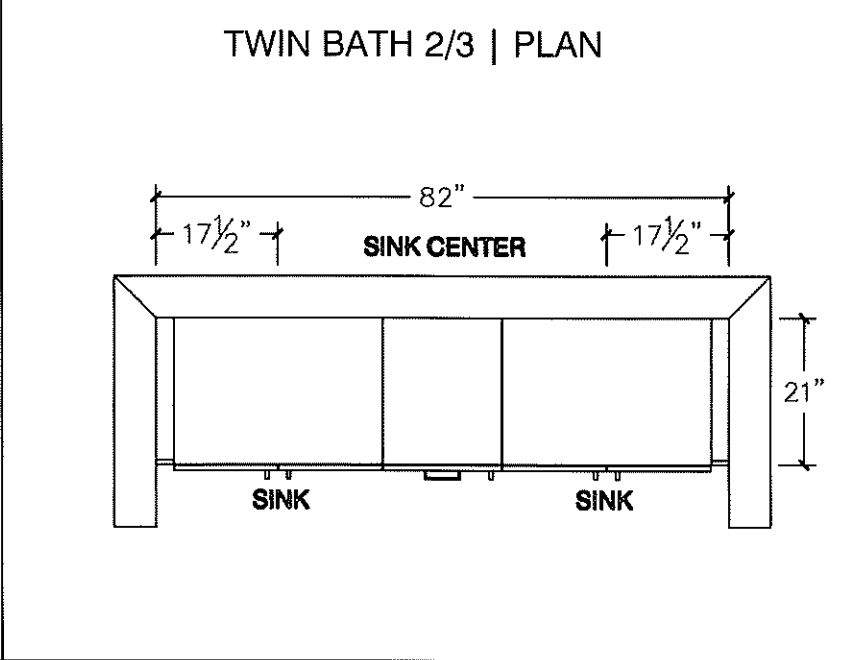
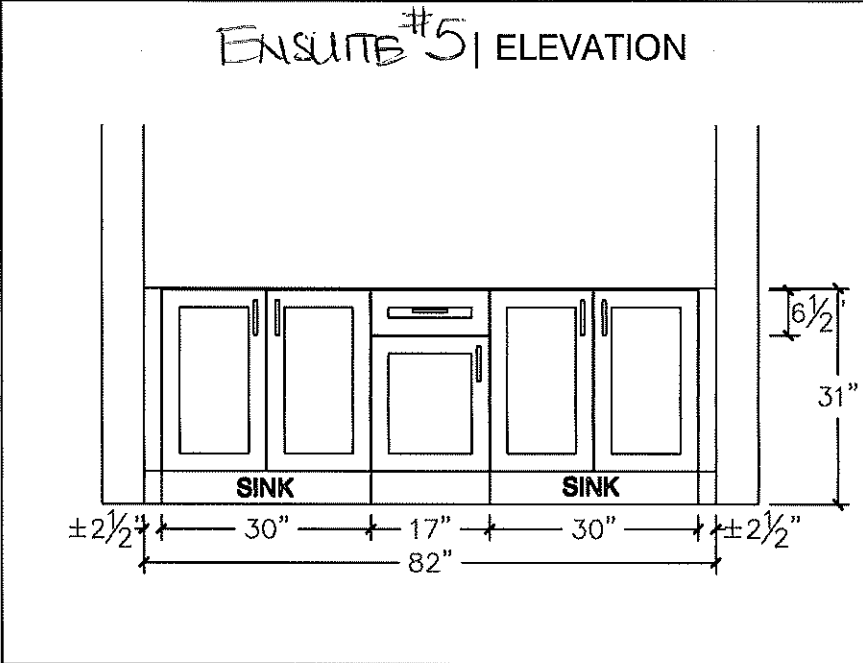
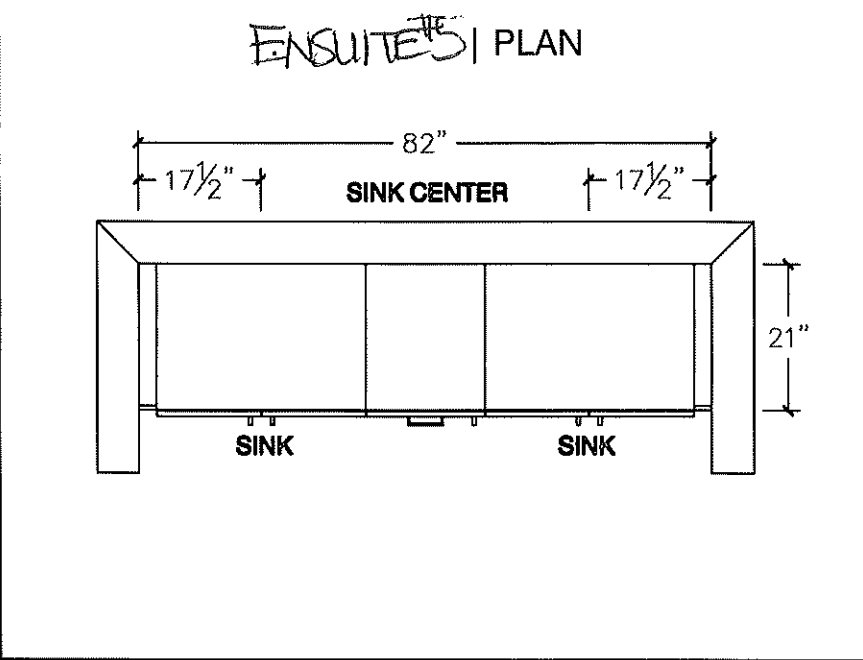



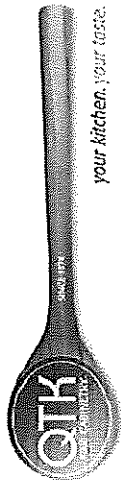

80 Sante Drive, Vaughan, ON L4K 3C4  
T 416.746.1811 F 905.761.5901  
www.QTK.ca info@qtk.ca

CLIENT: ROYAL PINE HOMES	JOB NAME: LOT 35 WRV (40-6)	ROOM: VANITY	DRAWN BY: RP
SITE: WEST RIVER VALLEY	DOOR STYLE: —	DOOR HANDLE: —	SCALE: 1/2" = 1'-0"
PHONE: —	FINISH: —	DRW HANDLE: —	DATE: Sept 16, 2022
EMAIL: —	SPECIES: —	TOP: —	PAGE:
COMMENTS:			

Customer Agrees and Accepts the following conditions: 1. The Drawing is a representation only and the installed cabinetry may vary slightly in product size, measurements, handle appearance and location and other details. Although Quality Tops & Kitchens Ltd. (QTK) does it's best to manufacture exactly what is shown here outside factors may prevent that and some variance is to be expected and accepted by the customer. 2. These drawings represent the intellectual property of QTK and as such the customer understands and accepts that all deposits given by the customer to QTK are non-refundable after QTK has supplied drawings (either physically or electronically) to the customer. If the customer decides to cancel the order after QTK has submitted drawings to the customer, the deposit will then be considered a design fee and no money will be returned to the customer.

POWDER RM. | PLAN

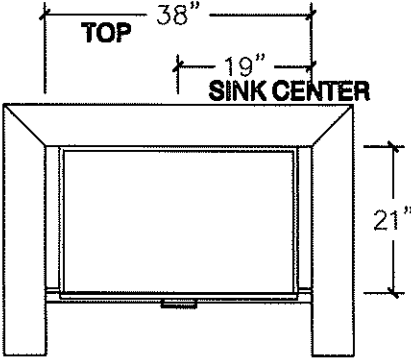

ENSUITE 4 | PLAN

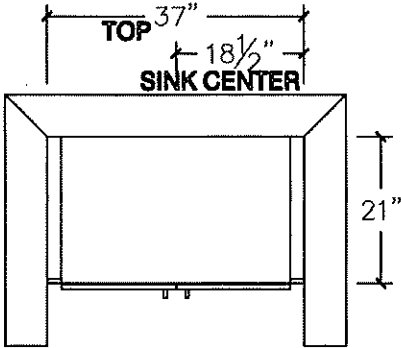

POWDER RM. | ELEVATION

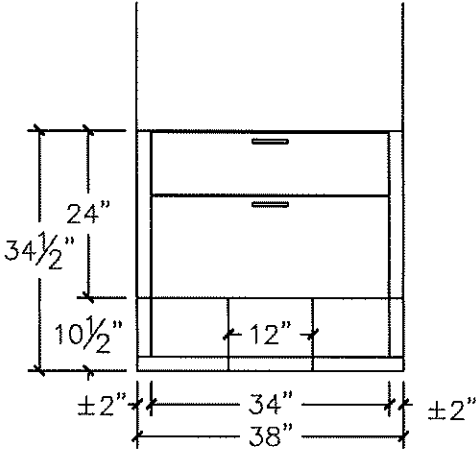

ENSUITE 4 | ELEVATION

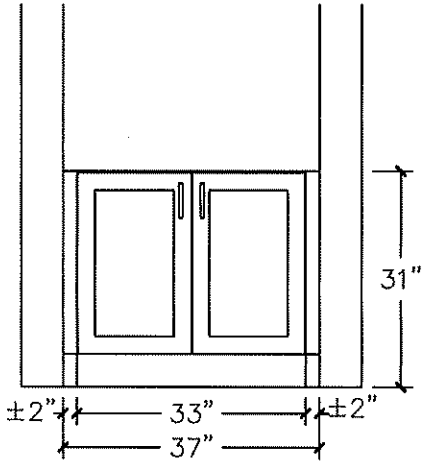

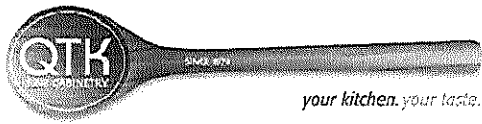

80 Sante Drive, Vaughan, ON L4K 3C4  
T 416.746.1811 F 905.761.5901  
www.QTK.ca info@qtk.ca

CLIENT: ROYAL PINE HOMES	JOB NAME: LOT 35 WRV (40-06)	ROOM: LAUNDRY	DRAWN BY: RP
SITE: WEST RIVER VALLEY	DOOR STYLE: __	DOOR HANDLE: __	SCALE: 1/2" = 1'-0"
PHONE: __	FINISH: __	DRW HANDLE: __	DATE: Sept 16, 2022
EMAIL: __	SPECIES: __	TOP: __	PAGE:

COMMENTS:

Customer Agrees and Accepts the following conditions: 1. The Drawing is a representation only and the installed cabinetry may vary slightly in product size, measurements, handle appearance and location and other details. Although Quality Tops & Kitchens Ltd. (QTK) does it's best to manufacture exactly what is shown here outside factors may prevent that and some variance is to be expected and accepted by the customer. 2. These drawings represent the intellectual property of QTK and as such the customer understands and accepts that all deposits given by the customer to QTK are non-refundable after QTK has supplied drawings (either physically or electronically) to the customer. If the customer decides to cancel the order after QTK has submitted drawings to the customer, the deposit will then be considered a design fee and no money will be returned to the customer.

LAUNDRY| PLAN

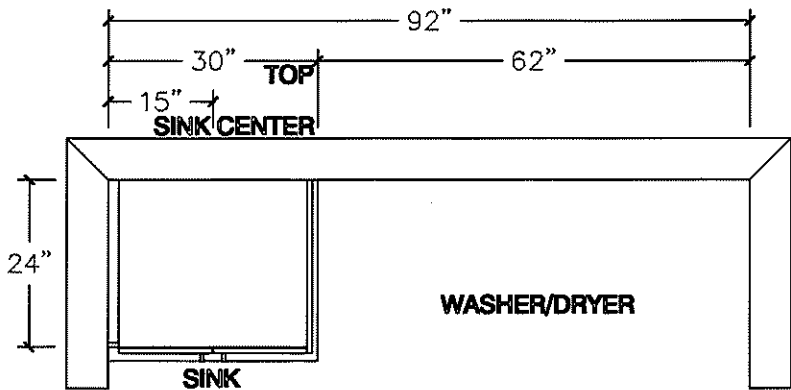

LAUNDRY| ELEVATION

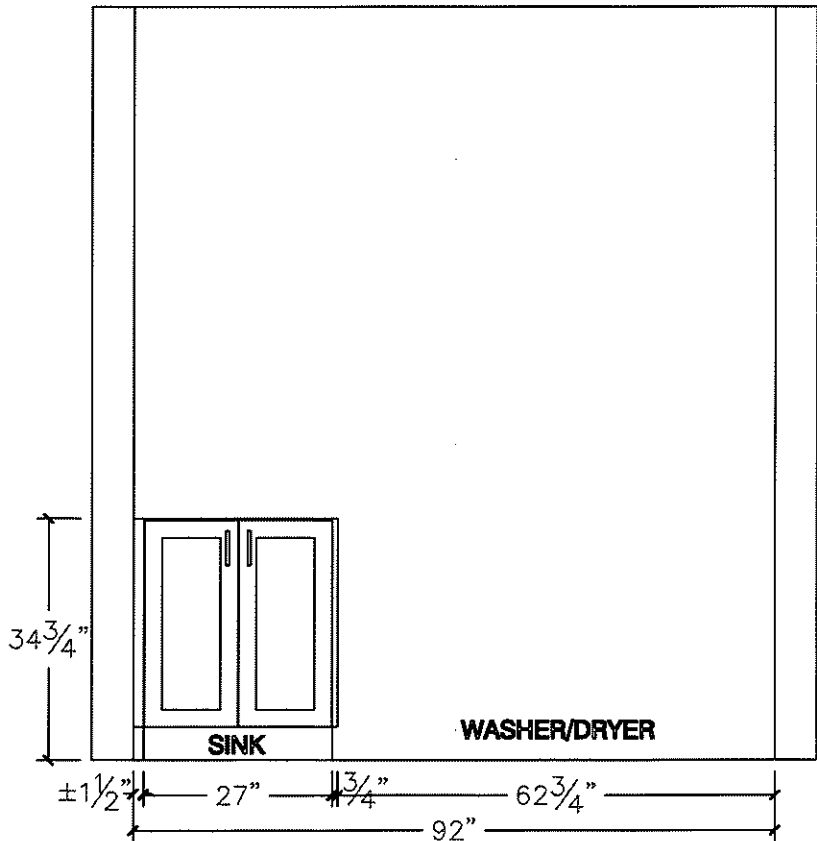

Sink Specifications

QUATRUS U 2  
Stainless steel brushed finish

Colour                      SKU  
brushed finish              401247

Design and planning tips

- Min cabinet size: 36 in ( 915 mm )
- Bowl Depth: 9 in ( 230.0 mm )

Specifications:  
3 ½" (90 mm) stainless steel strainer(s)  
Installation instructions  
Cut-out template  
Mounting clips  
Limited lifetime warranty

Depending on cabinet construction, a different cabinet size may be required. Consult the cabinet manufacturer.  
Cubed weight: 72 lbs.

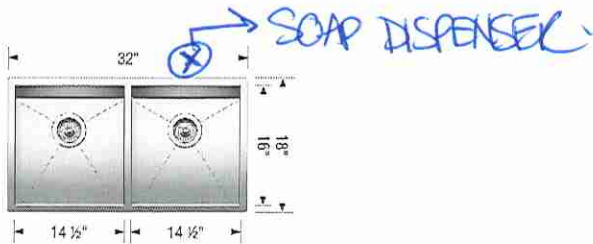

~~Optional Accessories~~

~~CapFlow Strainer Cover    517666~~  
~~Ash Cutting Board        406345~~  
~~Sink Grid                  406349~~

**\* UPGRADED FAUCET \***

Warranty  
Limited lifetime warranty on all sinks and faucets. One-year warranty on all accessories and soap dispensers.

Code/Standards Compliance  
BLANCO sinks and faucets are third-party tested and certified to CSA, cUPC, ANSI/ASME, IAPMO and NSF standards and listed by applicable certification bodies. For more information on individual product listings, contact our office or listing organization.

 Need support? Learn more by watching our sink & faucet How-to videos:  
<https://www.blanco.com/ca-en/support/how-to-videos/how-to-videos-for-sinks/>

	BLANCO Canada Inc 100 Corporation Drive Brampton ON L6S 6B5	Tel & Fax Tel: 905-494-2400 Toll free: 1-877-425-2626 Fax: 905-494-2425 Toll free: 1-877-825-2626
---	---	---

While BLANCO strives to provide accurate information, all images and dimensions in this document are intended for reference only and are subject to change at any time without notice. This document is not intended for use as an installation guide. For technical installation details, refer to installation instructions provided with the product. BLANCO assumes no responsibility for the use of superseded or voided specifications.



Lot 35

Kitchen

Belfield™

KITCHEN



FAUCETS

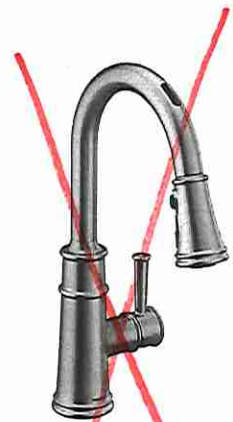

**MotionSense Wave™  
Hands-Free Single Handle  
Pulldown Kitchen Faucet**

7260EW  
Chrome \$925.44  
Other \$1,054.99



**Single Handle Pulldown  
Kitchen Faucet**

7260  
Chrome \$736.18  
~~Other \$953.99~~

Use model number only for C



**Single Handle  
Kitchen Faucet**

7240  
Chrome \$484.18  
Other \$662.09



**Two Handle  
Kitchen Faucet**

7250  
Chrome \$457.73  
Other \$626.06

FINISH OPTIONS



Chrome (C), Spot Resist™ Stainless (SRS),  
Oil Rubbed Bronze (ORB) Matte Black (BL)

To order, combine the model number with one of these  
finish letter(s): Chrome (C), Spot Resist™ Stainless  
(SRS), Oil Rubbed Bronze (ORB) & Matte Black (BL).

Lot 35

# Soap Dispensers

KITCHEN

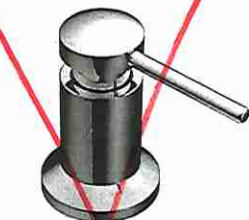

Transitional Soap or Lotion Dispenser

3942  
Chrome \$166.82  
Other \$200.81

Not available in BLS, BG, NL & ORB  
Use model number only for C



Transitional Soap or Lotion Dispenser

3944  
Chrome \$166.82  
Other \$200.81

Not available in BLS, BG & NL  
Use model number only for C

## SOAP DISPENSER



Traditional Soap or Lotion Dispenser

S3945  
Chrome \$246.82  
Other \$311.46

Not available in BLS



Paterson Soap or Lotion Dispenser

S3955  
Chrome \$246.82  
Other \$311.46

Not available in BLS, BG, NL & ORB



Transitional Soap or Lotion Dispenser

S3948  
Chrome \$246.82  
Other \$311.46

Not available in BLS, BG & NL



Transitional Soap or Lotion Dispenser

S3946  
Chrome \$246.82  
Other \$311.46  
Black Stainless \$342.63

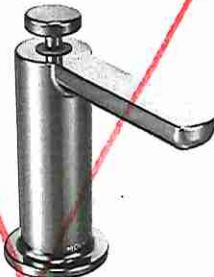

Modern Soap or Lotion Dispenser

S3947  
Chrome \$246.82  
Other \$311.46  
Black Stainless \$342.63

Not available in NL & ORB

## FINISH OPTIONS

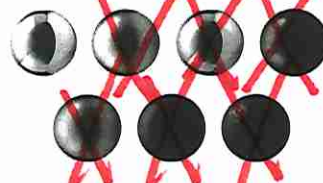

Chrome (C), Spot Resist™ Stainless (SRS), LifeShine® Polished Nickel (NL), Black Stainless (BLS), Brushed Gold (BG), Matte Black (BL), Oil Rubbed Bronze (ORB)

To order, combine the model number with one of these finish letter(s):  
Chrome (C), Spot Resist™ Stainless (SRS), LifeShine® Polished Nickel (NL), Black Stainless (BLS), Brushed Gold (BG), Matte Black (BL) & Oil Rubbed Bronze (ORB)



Chateau®

LOT 35

POSI-TEMP®

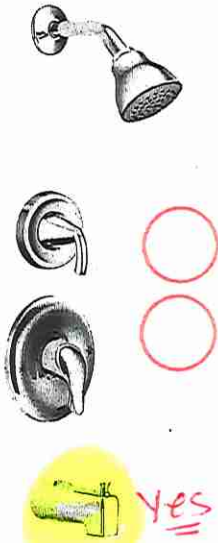
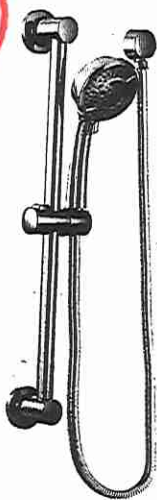

Posi-Temp® Tub/Shower Faucet with  
3 Function Transfer Valve/Trim and  
Slide Bar with Hand Shower\*

TL183EP / U361CI / UT2721 / 3669EP /  
A725 / 62320

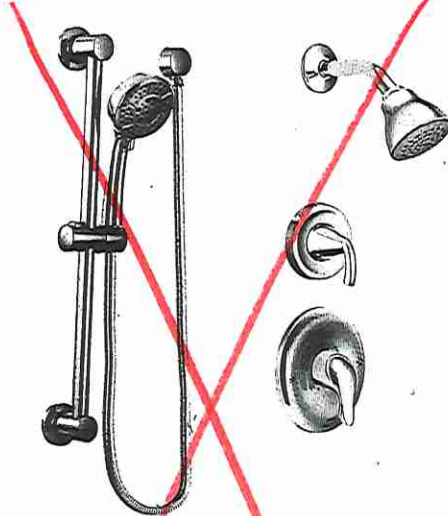

Posi-Temp® Shower Only with 3  
Function Transfer Valve/Trim and  
Slide Bar with Hand Shower\*

TL182EP / U361CI / UT2721 /  
3669EP / A725 / 62320

Master Ensuite

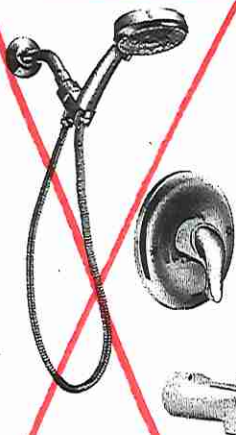

Posi-Temp® Tub/Shower Faucet  
with 4 Function Hand Shower\*

TL2359EP / 62320

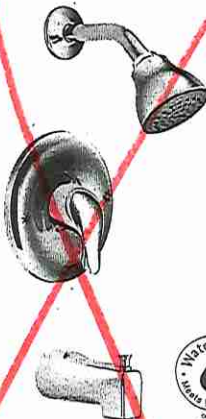

Eco-Performance Posi-Temp®  
Tub/Shower Faucet\*

TL183EP / 62320

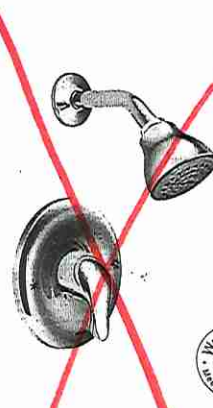

Eco-Performance Posi-Temp®  
Shower Only\*

TL182EP / 62320

CHATEAU  
FINISH OPTION



Chrome

To order Chrome (C) model, use  
model number only.  
\* Refer to the Shower Design Guide  
for Installation Instructions

LOT 35

## CATENA

## ITEM DETAILS

OUTER DIMENSIONS 20" W x 15 3/8" D x 7 1/2" H

INNER DIMENSIONS 18" W x 13 3/8" D x 5 1/2" H

MATERIAL Vitreous china COLOUR Soft white

Rectangular undermount sink | Front overflow hole | Template and mounting hardware supplied | Faucet not included

## CERTIFICATIONS

| IAPMO cUPC

| ASME A112.19.2 / CSA B45.1

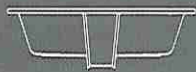
20" SINK  
4210CIY\*Install Std Faucet\*

ISSUED JULY 2019

Master Ensuite (x2)LOT 35



Chateau®

LOT 35

POSI-TEMP®

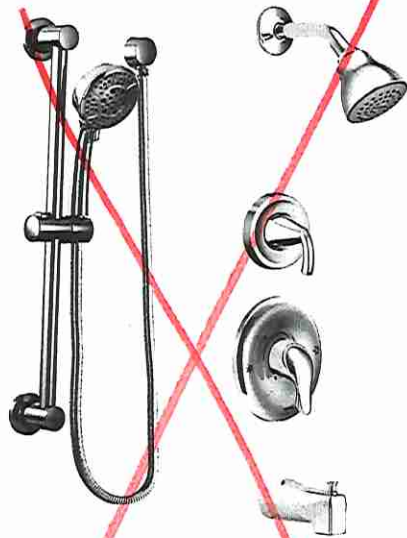

**Posi-Temp® Tub/Shower Faucet with 3 Function Transfer Valve/Trim and Slide Bar with Hand Shower\***

TL183EP / U361CI / UT2721 / 3669EP / A725 / 62320

Chrome \$1,357.65



**Posi-Temp® Shower Only with 3 Function Transfer Valve/Trim and Slide Bar with Hand Shower\***

TL182EP / U361CI / UT2721 / 3669EP / A725 / 62320

Chrome \$1,318.08



**Posi-Temp® Tub/Shower Faucet with 4 Function Hand Shower\***

TL2359EP / 62320

Chrome \$548.17



**Eco-Performance Posi-Temp® Tub/Shower Faucet\***

TL183EP / 62320

Chrome \$318.02



**Eco-Performance Posi-Temp® Shower Only\***

TL182EP / 62320

Chrome \$278.45

CHATEAU  
FINISH OPTION



Chrome

To order Chrome (C) model, use model number only.

\* Refer to the Shower Design Guide for installation instructions

Ensuite #4

# BLANCO

LOT 35

## Sink Specifications

ESSENTIAL LAUNDRY  
Stainless steel brushed finish

Colour                      SKU  
brushed finish              401202

### Design and planning tips

- Min cabinet size: 27 in ( 685 mm )
- Bowl Depth: 12 in ( 305.0 mm )

### Specifications:

Drop-in clips, Sink template, Installation instructions, 3 ½" (90 mm) stainless steel strainer, Limited Lifetime Warranty



4" distance between the outer holes.  
Depending on cabinet construction, a different cabinet size may be required. Consult the cabinet manufacturer.

Codes/Standards: ASME A112.19.3-2017/ CSA B45.4-17

*\* Top Mount \**

### ~~Optional Accessories~~

~~CapFlow Strainer Cover 517666~~

*\* Install Std Faucet \**

### Warranty

Limited lifetime warranty on all sinks and faucets. One-year warranty on all accessories and soap dispensers.

### Code/Standards Compliance

BLANCO sinks and faucets are third-party tested and certified to CSA, cUPC, ANSI/ASME, IAPMO and NSF standards and listed by applicable certification bodies. For more information on individual product listings, contact our office or listing organization.



Need support? Learn more by watching our sink & faucet How-to videos:

<https://www.blanco.com/ca-en/support/how-to-videos/how-to-videos-for-sinks/>



BLANCO Canada Inc  
100 Corporation Drive  
Brampton ON L6S 6B5

Tel & Fax  
Tel: 905-494-2400 Toll free: 1-877-425-2626  
Fax: 905-494-2425 Toll free: 1-877-825-2626

While BLANCO strives to provide accurate information, all images and dimensions in this document are intended for reference only and are subject to change at any time without notice. This document is not intended for use as an installation guide. For technical installation details, refer to installation instructions provided with the product. BLANCO assumes no responsibility for the use of superseded or voided specifications.

LOT 35

EDGE  
DETAILS

004

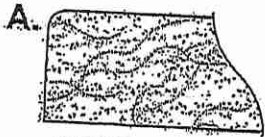

STRAIGHT EDGE  
(STANDARD - 3/4")

\* Powder Room  
\* Master Ensuite  
\* Twin Bath 2/3  
\* Ensuite #5  
\* Ensuite #4

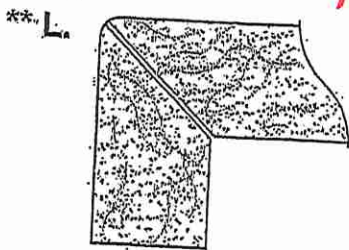

MITER WITH SKIRT EDGE  
(MEDIUM - 1 1/2")

\* Kitchen



OGEE - SQUARE EDGE  
(MED./HIGH - 1 1/2")

EDGING UP-GRADE OPTIONS

RECEIVED  
RCS 5/17