

BENCHMARK INFORMATION:
BENCHMARK No. 03-149
ELEVATION = 189.884
EBENEZER COMMUNITY HALL AT THE NORTH-
WEST CORNER OF EBENEZER ROAD AND THE
GORE ROAD. TABLET IS SET 1.22m EAST OF
SOUTHWEST CORNER OF FOUNDATION AND
0.31m ABOVE GROUND.

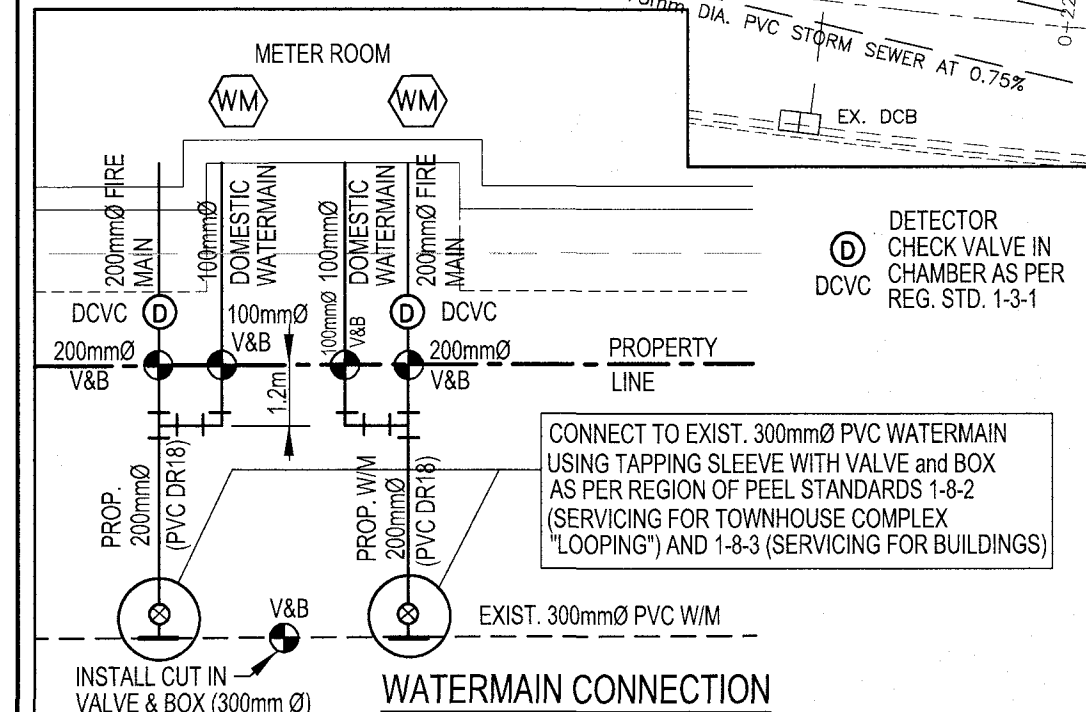
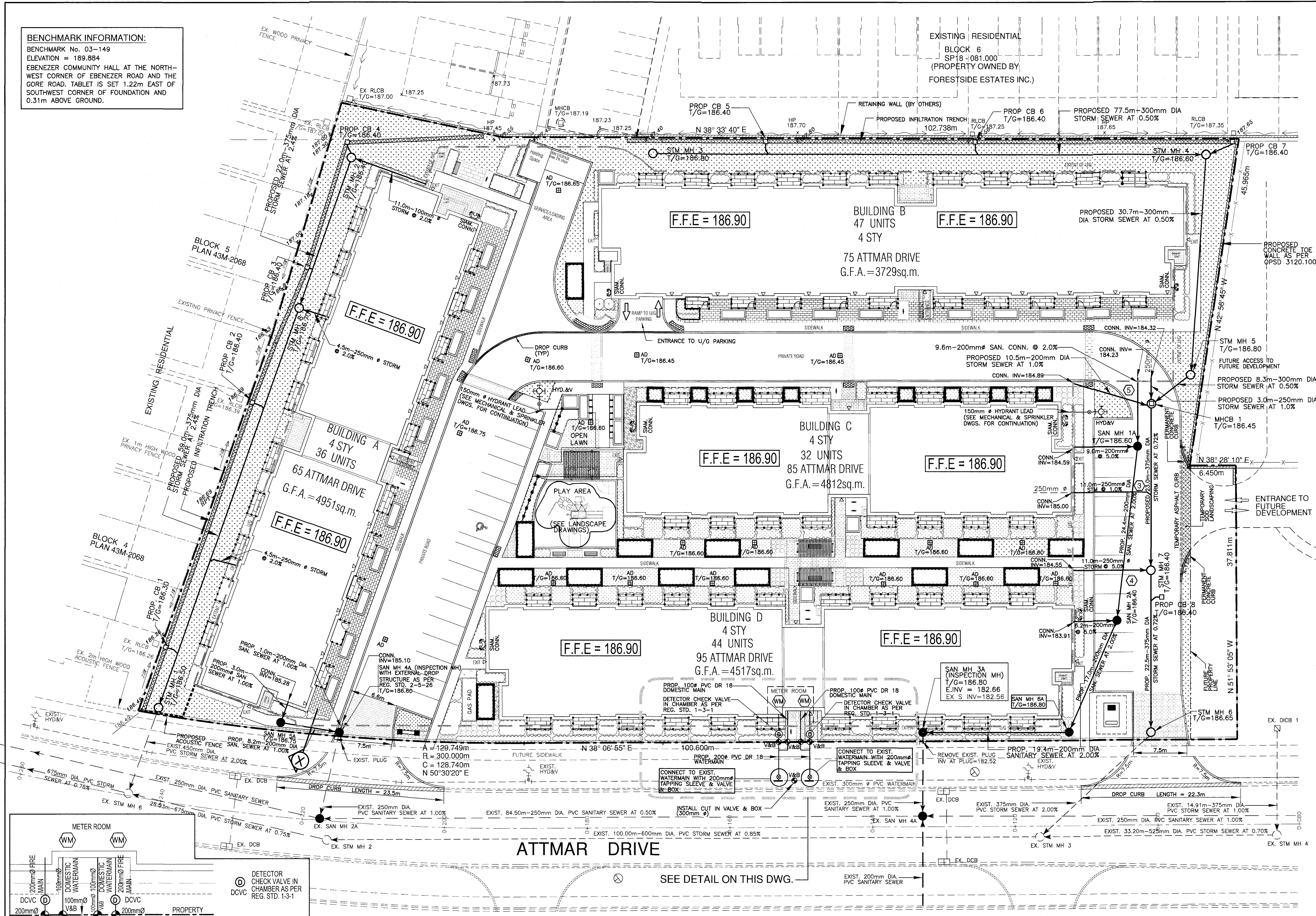

STORM SEWER INFORMATION

DESCRIPTION	TOP OF GRATE ELEVATION	INVERT ELEVATION
MH 1	186.50	S.W. = 182.41(EX) N.E. = 182.46
MH 2	186.40	S.W. = 184.46 N.W. = 184.51 S.E. = 184.51
MH 3	186.80	E. = 184.82 N.E. = 184.42 S.W. = 184.37 W. = 184.42
MH 4	186.60	S. = 183.72(EX) N. = 183.75
MH 5	186.80	N. = 183.94 S. = 183.91 W. = 184.00
MH 6	186.63	N. = 183.72(EX) N. = 183.75
MH 7	186.40	N. = 183.94 S. = 183.91 W. = 184.00
MH 8	186.70	N. = 183.94 S. = 183.91 W. = 184.00
MH CB 1	186.45	S. = 184.11 N. = 184.20 N.E. = 184.20 W. = 184.79

CATCHBASIN INFORMATION

DESCRIPTION	TOP OF GRATE ELEVATION	INVERT ELEVATION
CB 1	186.30	184.90
CB 2	186.40	185.00
CB 3	186.40	185.00
CB 4	186.40	185.00
CB 5	186.40	185.00
CB 6	186.40	185.00
CB 7	186.40	185.00
CB 8	186.40	185.00

PIPE CROSSING INFORMATION

NUMBER	DESCRIPTION
③	200mm Ø STM INV=184.12 200mm Ø SAN INV=183.78
④	250mm Ø STM INV=184.86 200mm Ø SAN INV=183.84
⑤	200mm Ø STM INV=184.80 200mm Ø SAN INV=184.29

SANITARY SEWER INFORMATION

DESCRIPTION	TOP OF GRATE ELEVATION	INVERT ELEVATION
MH 1A	186.60	N. = 184.04 S. = 183.99 W. = 184.14
MH 2A	186.40	S.W. = 183.45 N. = 183.50 W. = 183.50
MH 3A	186.80	E. = 182.66 EX S INV=182.56
MH 4A	186.60	N. = 185.10 N. DROP=182.20 W. = 185.13 W. DROP=182.20 EX S INV=182.10
MH 5A	186.75	E. = 185.20 N. = 185.25
MH 6A	186.80	W. = 183.05 N.E. = 183.10

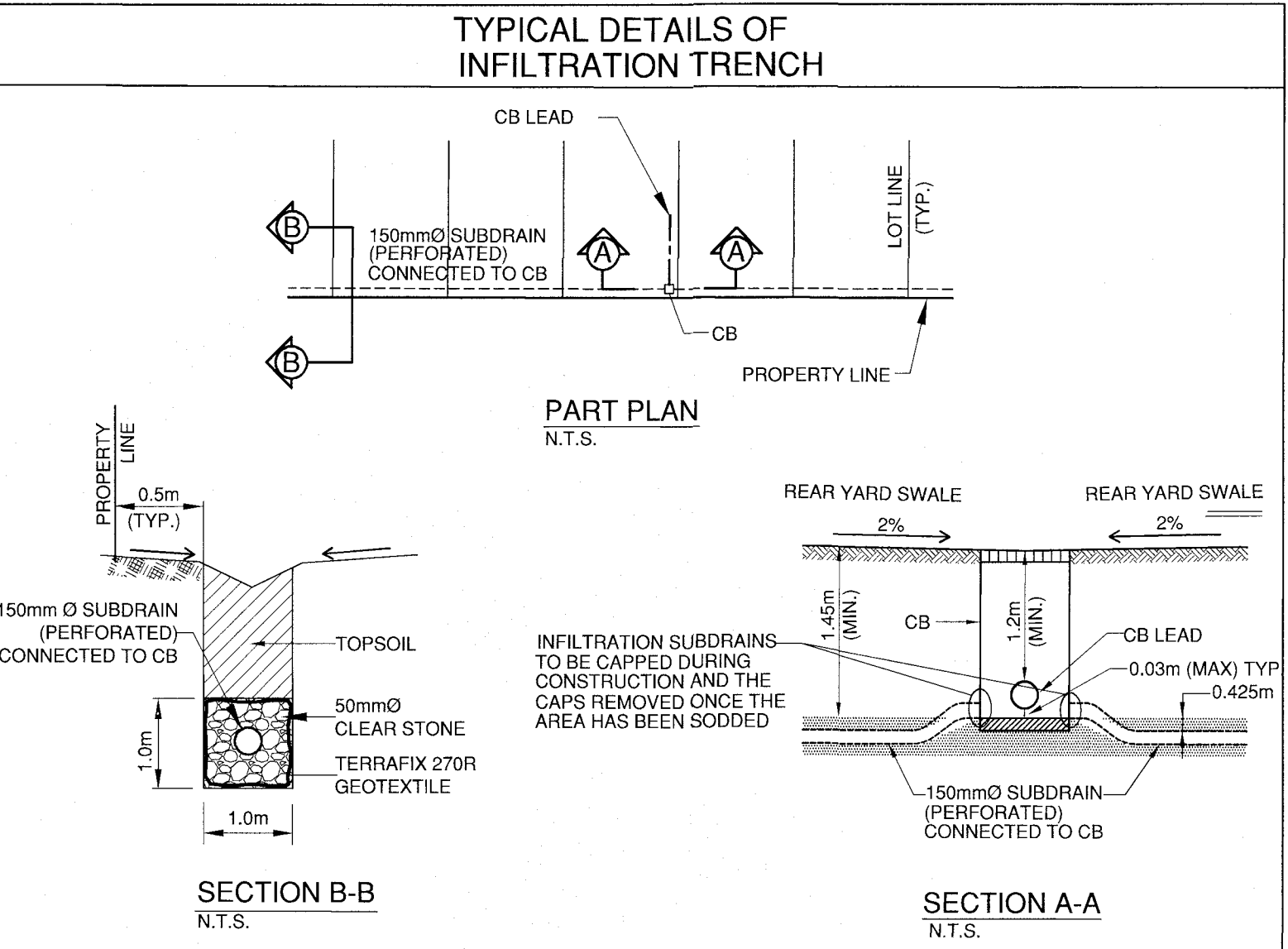
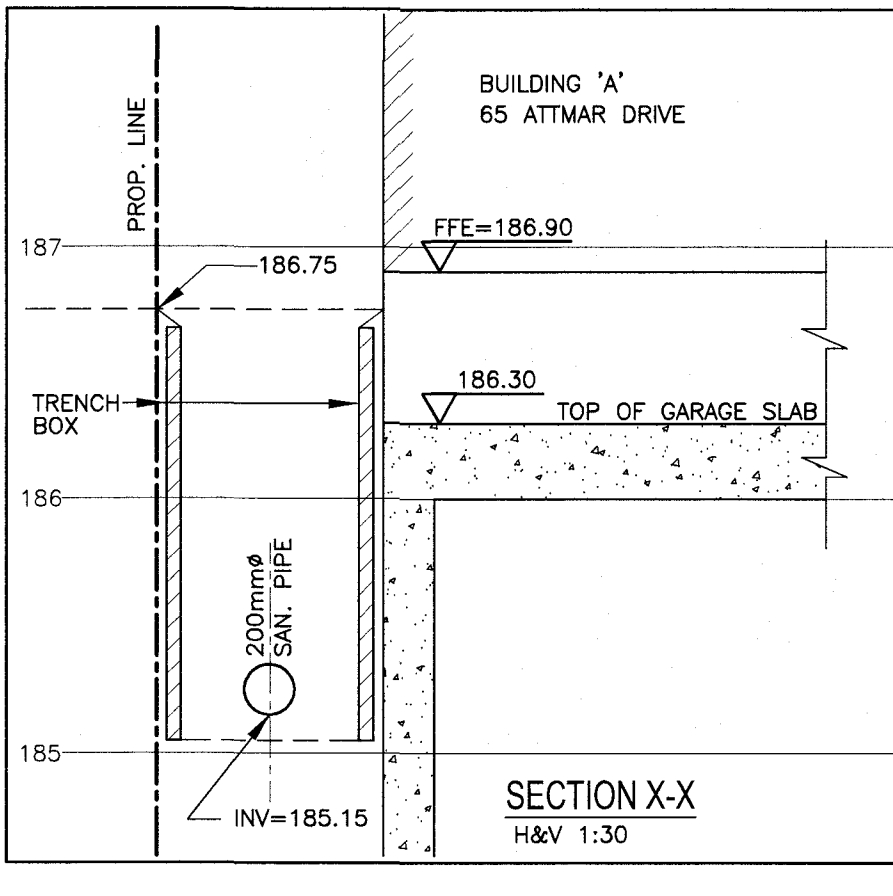

A. GENERAL NOTES:

- ALL THE CONSTRUCTION WORK FOR THIS PROJECT SHALL COMPLY WITH THE STANDARD DRAWINGS AND SPECIFICATIONS OF THE CITY OF BRAMPTON, THE REGION OF PEEL AND THE ONTARIO PROVINCIAL STANDARDS AND SPECIFICATIONS.
- ALL SURFACE DRAINAGE SHALL BE SELF-CONTAINED, COLLECTED AND DISCHARGED AT A LOCATION TO BE APPROVED PRIOR TO ISSUANCE OF A BUILDING PERMIT. DRAINAGE OF ADJUTING PROPERTIES SHALL NOT BE ADVERSELY AFFECTED.
- PROPOSED ELEVATIONS ALONG SITE PROPERTY LINES MUST MATCH EXISTING ELEVATION.
- A SILT FENCE TO THE CITY OF BRAMPTON STD. 406 MUST BE PLACED AROUND THE PERIMETER OF THE SITE OR AS SHOWN ON DRAWING.
- AT ALL ENTRANCES TO THE SITE, THE ROAD CURB AND SIDEWALK WILL BE CONTINUOUS, THROUGH THE DRIVEWAY. THE DRIVEWAY GRADE WILL BE COMPATIBLE WITH THE EXISTING SIDEWALK AND CURB DEPRESSION WILL BE PROVIDED FOR EACH ENTRANCE. ACCESS CONSTRUCTION AS PER CITY OF BRAMPTON STD. 237.
- SIDEWALKS TO BE REMOVED AND REPLACED SHALL BE CONSTRUCTED AS PER O.P.S.D. 310.010.
- THE PORTION OF THE DRIVEWAY WITHIN THE MUNICIPAL BOULEVARD MUST BE PAVED WITH 40mm H13 AND 50mm H13 SUBBASE TO BE 150mm GRANULAR "A" (OR 130mm OF 20mm CRUSHER RUN LIMESTONE) AND 300mm GRANULAR "B" (OR 225mm OF 50mm CRUSHER RUN LIMESTONE) COMPACTED TO 100% STANDARD PROCTOR DENSITY.
- A UTILITY CLEARANCE RADIUS OF 1.5m WITHIN THE PROPOSED DRIVEWAY ENTRANCE CURB. RETURN AND ALL ABOVE GROUND UTILITIES MUST BE MAINTAINED.
- A ROAD OCCUPANCY PERMIT MUST BE OBTAINED 48 HOURS PRIOR TO COMMENCING ANY WORKS WITHIN THE MUNICIPAL ROAD ALLOWANCE.
- THE SERVICE CONNECTION TRENCH WITHIN THE TRAVELLED PORTION OF THE ROAD ALLOWANCE SHALL BE BACKFILLED IN ACCORDANCE WITH THE REQUIREMENTS OF THE ROAD OCCUPANCY ACCESS PERMIT APPLICATION.
- IT IS THE RESPONSIBILITY OF THE DESIGN ENGINEERING CONSULTING FIRM TO ENSURE THAT AN ELEVATION DETAIL OF EXISTING AERIAL PLANT IS SUBMITTED WHEN OVERHEAD CABLES ARE PRESENT. CABLES SHALL NOT BE LESS THAN 4.7 METRES FROM THE HIGHEST POINT OF THE FINISHED PAVEMENT TO THE LOWEST POINT OF THE AERIAL CABLE DIRECTLY ABOVE THE AVENUE AREA TO ENSURE CLEARANCES ARE MET.

B. REGION OF PEEL - WATERMAINS AND SANITARY SEWERS:

- ALL MATERIALS AND CONSTRUCTION METHODS MUST CORRESPOND TO THE CURRENT PEEL PUBLIC WORKS STANDARDS AND SPECIFICATIONS.
- WATERMAIN AND / OR WATER SERVICE MATERIALS 100mm (4") AND LARGER MUST BE DR 18 P.V.C. PIPE MANUFACTURED TO A.W.W.A. SPEC. C900-16 SPEC COMPLETE WITH TRACER WIRE. SIZE 80mm (3") AND SMALLER MUST BE TYPE "K" SOFT COPPER PIPE AS PER A.S.T.M. B88-49 SPECIFICATION.
- WATERMAINS AND / OR WATER SERVICES ARE TO HAVE A MINIMUM COVER OF 1.7m (5'-6") WITH A MINIMUM HORIZONTAL SPACING OF 1.2m (4'-0") FROM THEMSELVES AND ALL OTHER UTILITIES.
- PROVISIONS FOR FLUSHING WATER LINE PRIOR TO TESTING ETC. MUST BE PROVIDED WITH AT LEAST A 50mm (2") OUTLET ON 100mm (4") AND LARGER LINES. COPPER LINES ARE TO HAVE FLUSHING POINTS AT THE END, THE SAME SIZE AS THE LINE. THEY MUST ALSO BE HOSED OR PIPED TO ALLOW THE WATER TO DRAIN ON TO A PARKING LOT OR TO A DRAIN. ON FIRE LINES FLUSHING OUTLET TO BE 100mm (4") DIAMETER MINIMUM ON A HYDRANT.
- ALL CURB STOPS TO BE 300mm (12") OFF THE FACE OF BUILDING UNLESS OTHERWISE NOTED.
- HYDRANT AND VALVE SET TO REGION STANDARD 1-6.1, DIMENSION A AND B, 0.7m (2') AND 0.9m (3') AND TO HAVE PUMPER NOZZLE.
- WATERMAINS TO BE INSTALLED TO GRADES AS SHOWN ON APPROVED SITE PLAN. COPY OF GRADE SHEET SHALL BE SUPPLIED TO INSPECTOR PRIOR TO COMMENCEMENT OF WORK, WHERE REQUESTED BY INSPECTOR.
- WATERMAINS MUST HAVE A MINIMUM VERTICAL CLEARANCE OF 0.5m (20") OVER / 0.5m (20") UNDER SEWERS AND ALL OTHER UTILITIES WHEN CROSSING.
- ALL PROPOSED WATER PIPING MUST BE ISOLATED FROM EXISTING LINES IN ORDER TO ALLOW INDEPENDENT PRESSURE TESTING AND CHLORINATING FROM EXISTING SYSTEMS.
- ALL LIVE TAPPING AND OPERATION OF REGION WATER VALVES SHALL BE ARRANGED THROUGH THE REGIONAL INSPECTOR ASSIGNED OR BY CONTACTING THE OPERATIONS AND MAINTENANCE DIVISION.
- LOCATION OF ALL UTILITIES IN THE FIELD TO BE ESTABLISHED BY THE CONTRACTOR.
- THE CONTRACTOR(S) SHALL BE SOLELY RESPONSIBLE FOR LOCATES, EXPOSING, SUPPORTING AND PROTECTING OF ALL UNDERGROUND AND OVERHEAD UTILITIES AND STRUCTURES EXISTING AT THE TIME OF CONSTRUCTION IN THE AREA OF THEIR WORK. WHETHER SHOWN ON THE PLANS OR NOT AND FOR ALL REPAIRS AND CONSEQUENCES RESULTING FROM DAMAGE TO SAME.
- THE CONTRACTOR(S) SHALL BE SOLELY RESPONSIBLE TO GIVE 72 HOURS WRITTEN NOTICE TO THE UTILITIES PRIOR TO CROSSING SUCH UTILITIES, FOR THE PURPOSE OF INSPECTION BY THE CONCERNED UTILITY. THIS INSPECTION WILL BE FOR THE DURATION OF THE CONSTRUCTION, WITH THE CONTRACTOR RESPONSIBLE FOR ALL COSTS ARISING FROM SUCH INSPECTION.
- ALL PROPOSED WATER PIPING MUST BE ISOLATED THROUGH A TEMPORARY CONNECTION THAT SHALL INCLUDE AN APPROPRIATE CROSS-SECTION CONTROL DEVICE, CONSISTENT WITH THE DEGREE OF HAZARD, FOR BACKFLOW PREVENTION OF THE ACTIVE DISTRIBUTION SYSTEM, CONFORMING TO REGION OF PEEL STANDARDS 1-7 OR 1-7-8.
- BEDDING FOR WATERMAINS SHALL BE AS PER STD. 1-5.1 - THRUST BLOCKS AND SUPPORTS SHALL COMPLY WITH STANDARDS 1-5.4 TO 1-5.7 INCLUSIVE.
- WATER SERVICE TO BE LAID COMMENCING AT POINT OF METERING TOWARDS THE STREET LINE TO PREVENT JOINTS UNDER THE BUILDING FLOOR.
- SANITARY SEWERS SHALL BE PVC SDR 35 AS PER CSA SPEC. B 182.1.
- BEDDING FOR SANITARY SEWERS SHALL BE CLASS "B" AS PER STANDARD 2-3-1.
- MANHOLES SHALL BE 2-5-3 WITH STANDARD 2-5-3 MANHOLE STEPS SHALL BE AS PER STANDARD 2-6-1.
- FRAME AND COVER SHALL BE AS PER STANDARD 2-5-13. MANHOLE STEPS SHALL BE AS PER STANDARD 2-6-1.
- PROVIDE A MINIMUM OF 150mm GRANULAR "A" OR SAND COVER OVER PIPES. BACKFILL SHALL BE APPROVED NATIVE MATERIAL COMPACTED TO 98% STD. PROCTOR DENSITY WITH 98% STANDARD PROCTOR DENSITY FOR THE TOP 100mm.

C. STORM WATER MANAGEMENT:

- DURING CONSTRUCTION AND UNTIL SUCH TIME AS THE SITE HAS BEEN PAVED AND SODDED, THE CONTRACTOR SHALL PREVENT STORM WATER RUNOFF FROM DIRECTLY ENTERING THE MUNICIPAL STORM SEWER SYSTEM AND THE ADJOINING PROPERTIES BY INSTALLING AND MAINTAINING SILT CONTROLS AND FACILITIES TO ALL CATCHBASINS (SLOTTED OR APPROVED EQUAL) AND BY INSTALLING AND MAINTAINING SILT FENCE AS PER CITY OF BRAMPTON STANDARD 406.
- STORM WATER MANAGEMENT CONTROLS SHALL BE IN ACCORDANCE WITH THE STORM WATER MANAGEMENT REPORT PREPARED BY CANDEVCON LIMITED FOR THE PROJECT.
- FOUNDATION DRAINS SHALL NOT BE CONNECTED TO THE STORM SEWER ON SITES WITH STORMWATER MANAGEMENT CONTROL.

D. STORM SEWER NOTES:

- ALL STORM SEWER WORKS SHALL BE CONSTRUCTED IN ACCORDANCE WITH CURRENT CITY OF BRAMPTON AND ONTARIO PROVINCIAL STANDARD DRAWINGS (OPSD) AND SPECIFICATIONS (OPSS).
- SEWERS SHALL BE CONSTRUCTED OF CONCRETE OR PVC PIPE WITH CLASS 'B' BEDDING IN ACCORDANCE WITH OPSD 802.03.
- SEWER PIPE SMALLER THAN 450mm DIA. SHALL BE PVC CLASS SDR 35 AS PER CSA B182-1 SEWER PIPE LARGER THAN 450mm DIA. SHALL BE CONCRETE CLASS 65-D.
- THE MAXIMUM ALLOWABLE TRENCH WIDTH AT THE TOP OF THE PIPE SHALL NOT EXCEED THE FOLLOWING:
200mm - 300mm PIPE: 900mm
375mm - 750mm PIPE: OUTSIDE DIAMETER PLUS 600mm
- MANHOLES SHALL BE AS PER OPSD 701.010. FRAMES AND COVERS SHALL BE AS PER OPSD 401.010. STEPS SHALL BE AS PER STANDARD 316.
- SINGLE CATCHBASINS SHALL BE AS PER OPSD 705.010, WITH FRAMES AND COVERS AS PER OPSD 400.02. DOUBLE CATCHBASINS SHALL BE AS PER OPSD 705.020.
- MANHOLE CATCHBASINS SHALL BE AS PER OPSD 701.010.
- UNLESS NOTED OTHERWISE, CATCHBASIN LEADS SHALL BE 200mm DIA. AT MINIMUM 1% GRADE.
- DROP STRUCTURES SHALL BE AS PER OPSD 1003.01.
- PROVIDE A MINIMUM OF 150mm GRANULAR "A" OR SAND COVER OVER PIPES. BACKFILL SHALL BE IN ACCORDANCE WITH THE SPECIFICATIONS SECTION 33.10.00.
- PROVIDE TWO SUBDRAINS, MINIMUM LENGTH OF 5.0m EACH EXTENDING FROM OPPOSITE SIDES OF ALL CATCHBASINS AND MANHOLE CATCHBASINS TO DRAIN THE GRANULAR SUB BASE.
- STORM SEWER PIPES CONNECTING TO THE CITY'S STORM SEWER SHALL NOT BE SMALLER THAN 200mm.
- WITHIN THE CITY'S RIGHT-OF-WAY, STORM SEWERS AND STORM SEWER CONNECTIONS MUST BE CONSTRUCTED TO APPROVED EQUAL, WITH TYPE 'B' BEDDING THROUGHOUT. THE STRENGTH OF THE CONCRETE PIPE MUST BE AS PER CITY STANDARD 341 AND AS FOLLOWS: MINIMUM 65-D FOR REINFORCED PIPE AND MINIMUM ES FOR NON REINFORCED PIPE.
- ALL CATCHBASIN MANHOLES AND MANHOLES WITH INLET CONTROL DEVICES MUST HAVE A MINIMUM 0.3m SUMP AND TOP AS PER MUNICIPAL STANDARDS.

E. SPECIFICATIONS FOR RESTORATION WORK WITHIN RIGHT OF WAY:

- ALL WORK SHALL BE SUBJECT TO THE CONDITIONS AND REQUIREMENTS OF THE CITY OF BRAMPTON STANDARD SPECIFICATIONS AND ROAD OCCUPANCY PERMIT.
- ALL DISTURBED GRASS AREAS SHALL BE RESTORED WITH TOPSOIL AND SOD TO ORIGINAL CONDITION OR BETTER.
- ALL ASPHALT PAVEMENT AND ALL CONCRETE SIDEWALK AND CURB AND GUTTER SHALL BE SAWCUT PRIOR TO REMOVAL.
- ALL DISTURBED ASPHALT PAVEMENT SHALL BE RESTORED WITH HOT LAID ASPHALT MATCHING THE EXISTING LAYERS AND ROAD OCCUPANCY PERMIT.
- THE CONTRACTOR SHALL OBTAIN A ROAD OCCUPANCY PERMIT 48 HOURS PRIOR TO COMMENCING WORK WITHIN THE R.O.W.

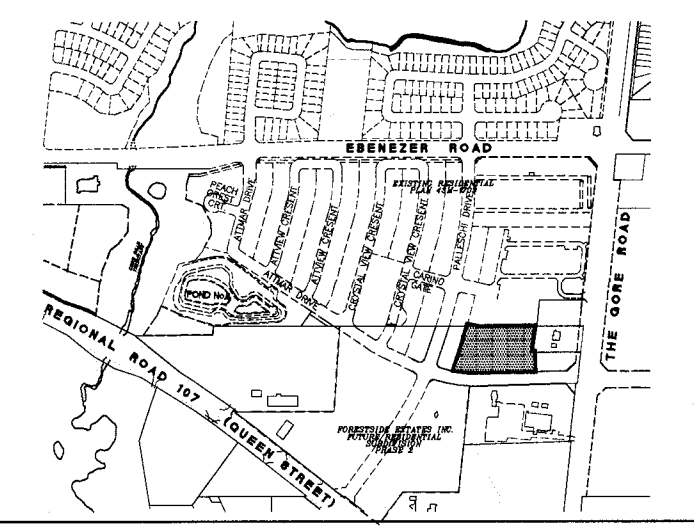

KEY PLAN

LEGEND

- SAN MH 1A ○ PROPOSED SANITARY MANHOLE
- STM MH 1 ○ PROPOSED STORM MANHOLE
- CB □ PROPOSED CATCHBASIN
- AD □ PROPOSED AREA DRAIN (WATTS FD 330 OR APPROVED EQUIVALENT)
- PROPOSED HYDRANT & VALVE
- PROPOSED INFILTRATION TRENCH
- PROPOSED LIMIT OF UNDERGROUND GARAGE
- PROPERTY LINE
- PERVIOUS AREA (LANDSCAPE)
- 75mm WATERMETER REG. STD. 1-4-1 MIN. FLOW = 100gpm
- DETECTOR CHECK VALVE IN CHAMBER AS PER REG. STD. 1-3-1
- CHECK VALVE IN CHAMBER AS PER REG. STD. 1-3-1 WITHOUT THE BY-PASS AND METER

REFERENCE DRAWINGS:

- FOR SITE PLAN INFORMATION REFER TO DRAWING A101 PREPARED BY GRAZIANI + CORAZZA ARCHITECTS
- FOR LANDSCAPE INFORMATION REFER TO DRAWINGS PREPARED BY STRYBOS BARRON KING, LANDSCAPE ARCHITECTURE
- FOR MECHANICAL/PLUMBING INFORMATION WITHIN THE BUILDING AND UNDERGROUND GARAGE, REFER TO DRAWING M-2 PREPARED BY UNITED ENGINEERING INC.
- FOR SITE GRADING INFORMATION REFER TO DRAWING G-2 PREPARED BY CANDEVCON LIMITED
- FOR SEDIMENT AND EROSION CONTROL PLAN REFER TO DRAWING ESC-1 PREPARED BY CANDEVCON LIMITED

NO.	REVISIONS	DATE	BY
1	REVISED TO ADDRESS REGION'S COMMENTS DATED AUGUST 31st, 2021	SEPT. 07 2021	D.K.H.
2	REVISIONS AS NOTED	JULY 19 2021	D.K.H.
3	REVISED TO ADDRESS CITY'S COMMENTS DATED APRIL 15th, 2021	APR. 19 2021	D.K.H.
4	REVISED TO ADDRESS CITY'S COMMENTS DATED MARCH 8th, 2021	MAR. 15 2021	D.K.H.
5	SANITARY MH 2A MOVED NORTH; SANITARY MH 6A ADDED	JAN. 27 2021	D.K.H.
6	REVISED TO INCORPORATE LANDSCAPE REVISIONS	FEB. 27 2020	D.K.H.
7	REVISED AS PER OWNER'S REQUEST	FEB. 04 2020	D.K.H.
8	REVISED TO ADDRESS REGION'S COMMENTS DATED JAN. 9th, 2020	JAN. 27 2020	D.K.H.
9	REVISED TO ADDRESS CITY'S COMMENTS DATED NOV. 21 2019	NOV. 25 2019	D.K.H.
10	UPDATED AS PER REVISED SITE PLAN	SEPT. 20 2019	D.K.H.
11	ISSUED FOR TENDER	AUG. 02 2019	D.K.H.
12	REVISED TO ADDRESS CITY'S AND REGION'S COMMENTS	JULY 22 2019	D.K.H.

CANDEVCON LIMITED
CONSULTING ENGINEERS AND PLANNERS
9358 GOREWAY DRIVE
TEL. (905) 794-0600 FAX (905) 794-0611

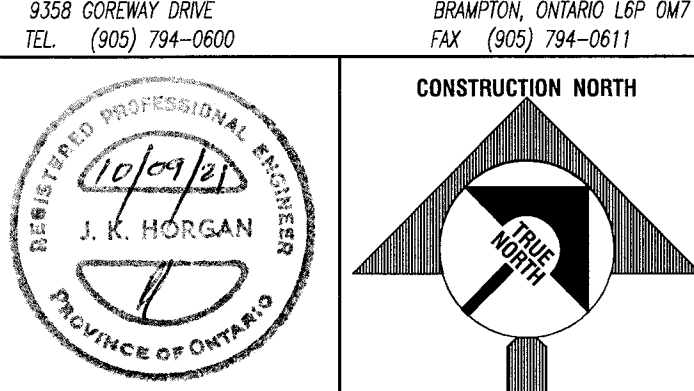

FORESTSIDE ESTATES INC.
PROPOSED CONDOMINIUM
APARTMENT DEVELOPMENT
BLOCK 7, PLAN 43M-2068

65, 75, 85 AND 95
ATTMAR DRIVE
CITY OF BRAMPTON

SHEET FILE No. SP18-118.000 REGION FILE No. C-601295

SITE SERVICING PLAN

DRAWN BY: D.R.	PROJECT No. W19044
DESIGN/CHECK BY: D.K.H.	DRAWING No.
SCALE: 1:300	G-1
DATE: APRIL 18th, 2019	