

DECIDUOUS TREE PLANTING (ON SLAB)

FOR TREES LESS THAN 80 mm CALIPER

1 200 PLANTING DETAILS

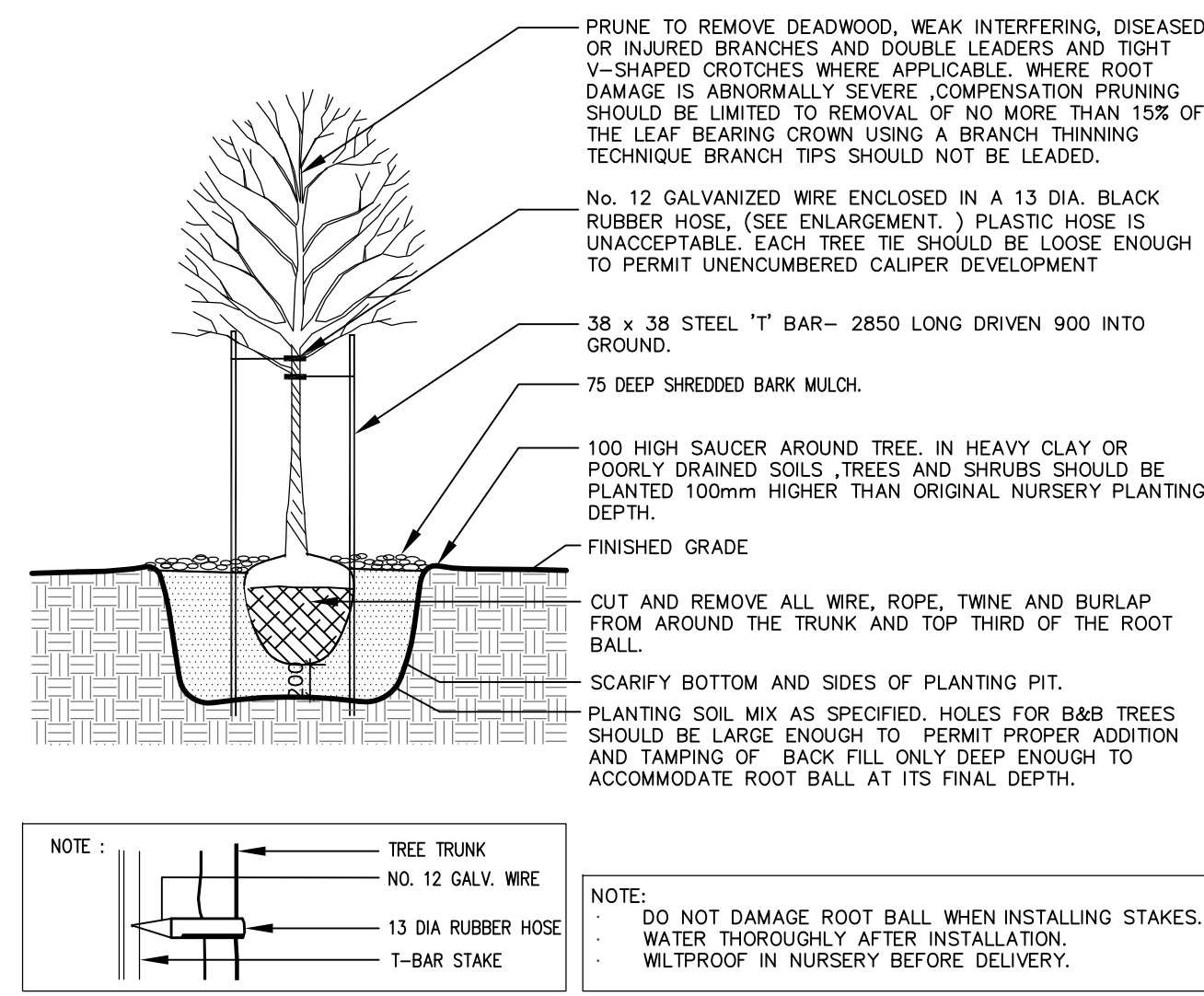

DECIDUOUS TREE PLANTING DETAIL

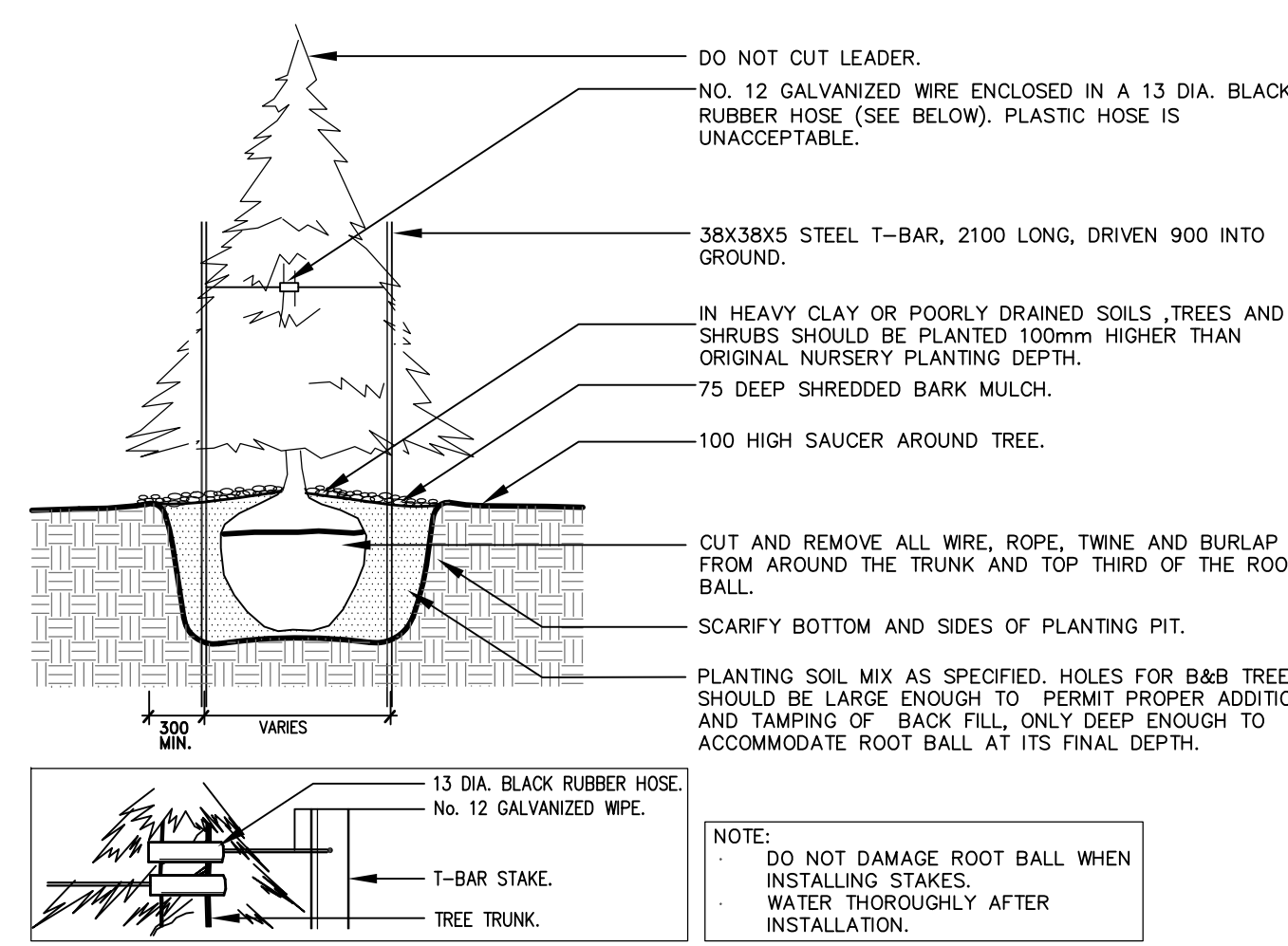

CONIFEROUS TREE PLANTING DETAIL

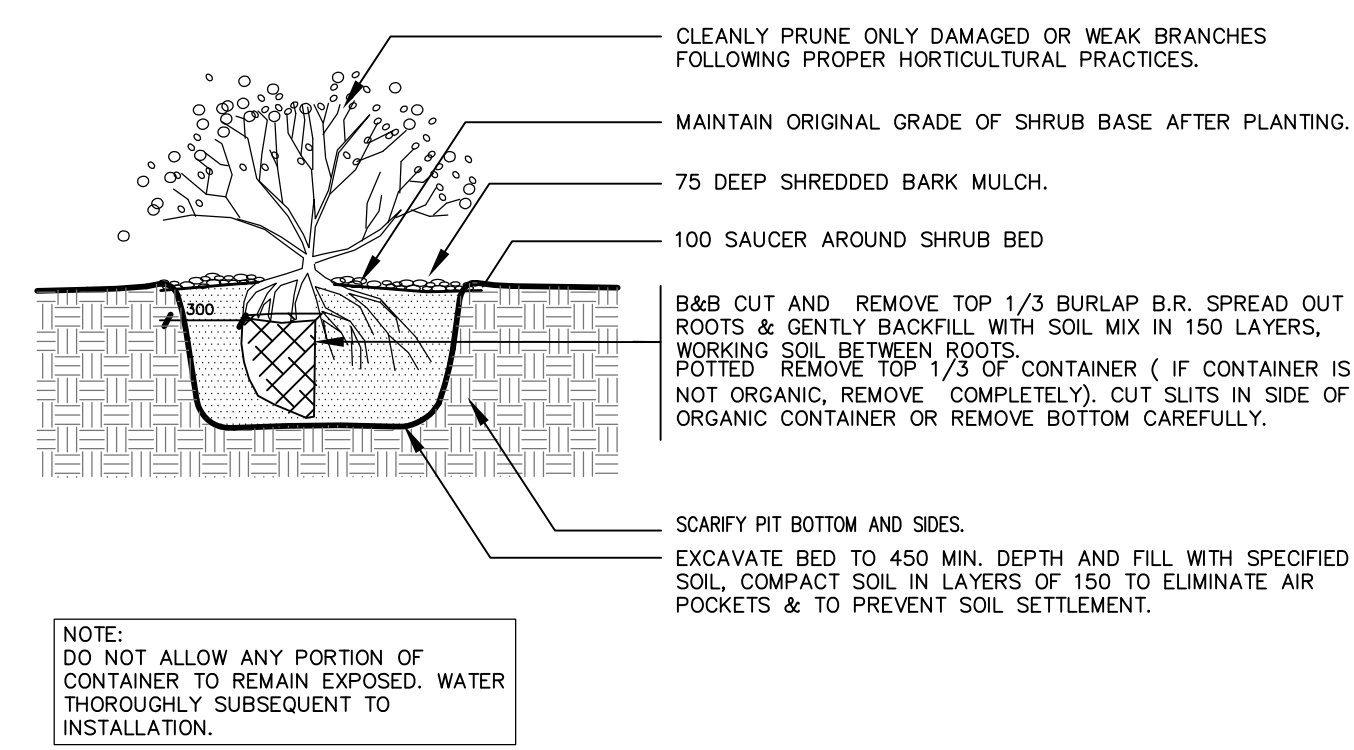

SHRUB PLANTING DETAIL

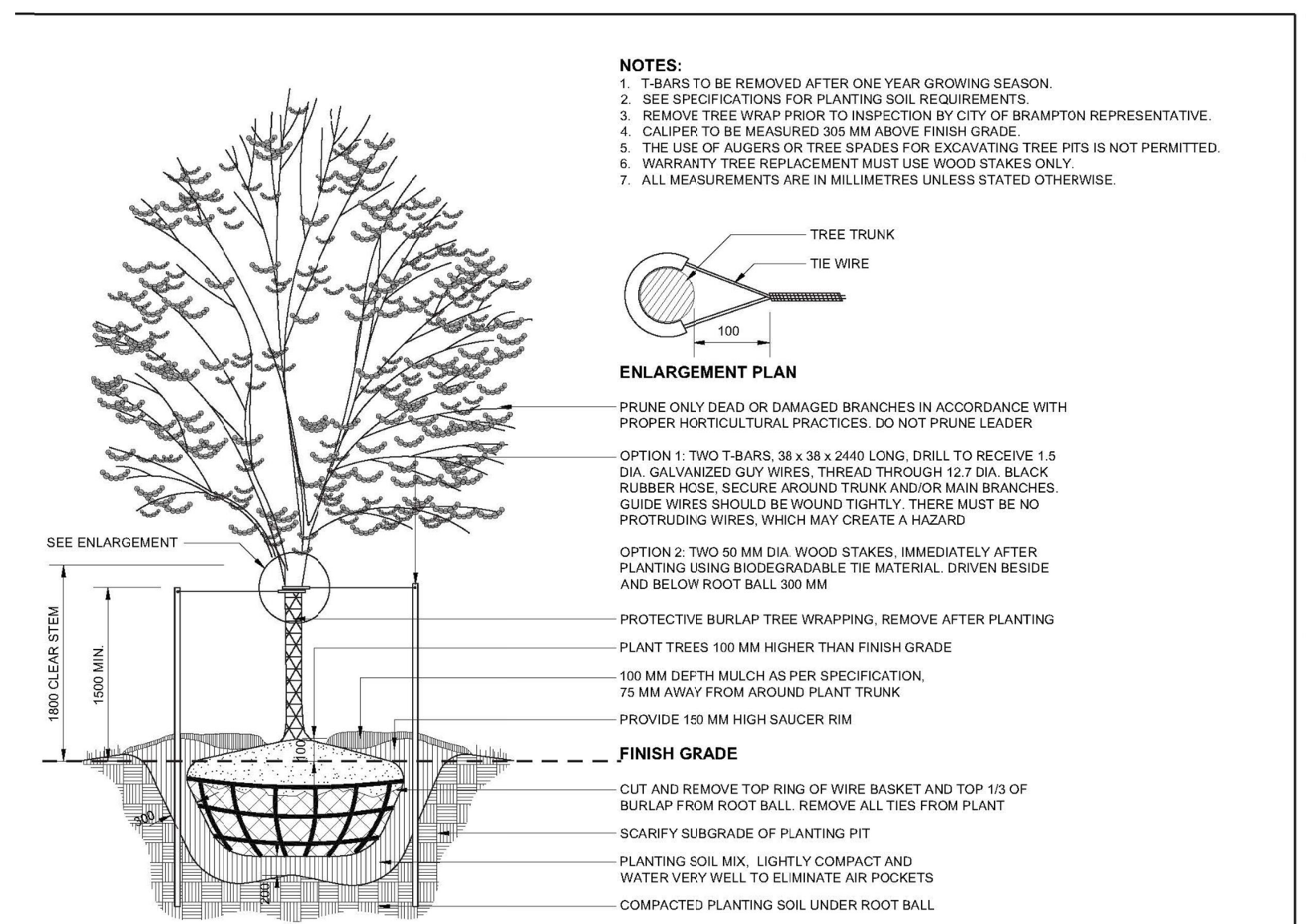

2 200 BOULEVARD TREE PLANTING DETAIL (CITY OF BRAMPTON)

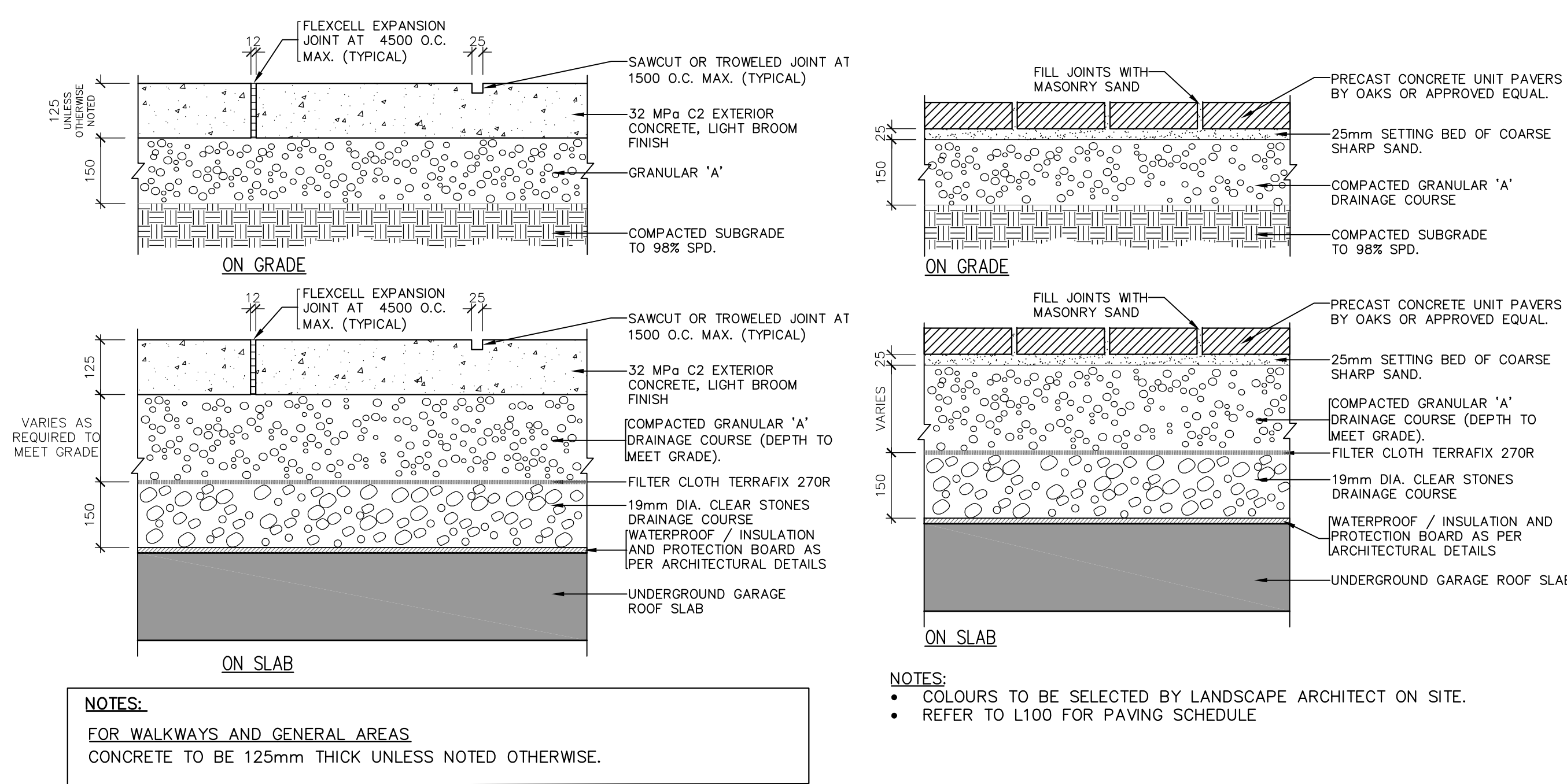

3 200 CONCRETE PAVING

4 200 PRECAST CONCRETE UNIT PAVERS

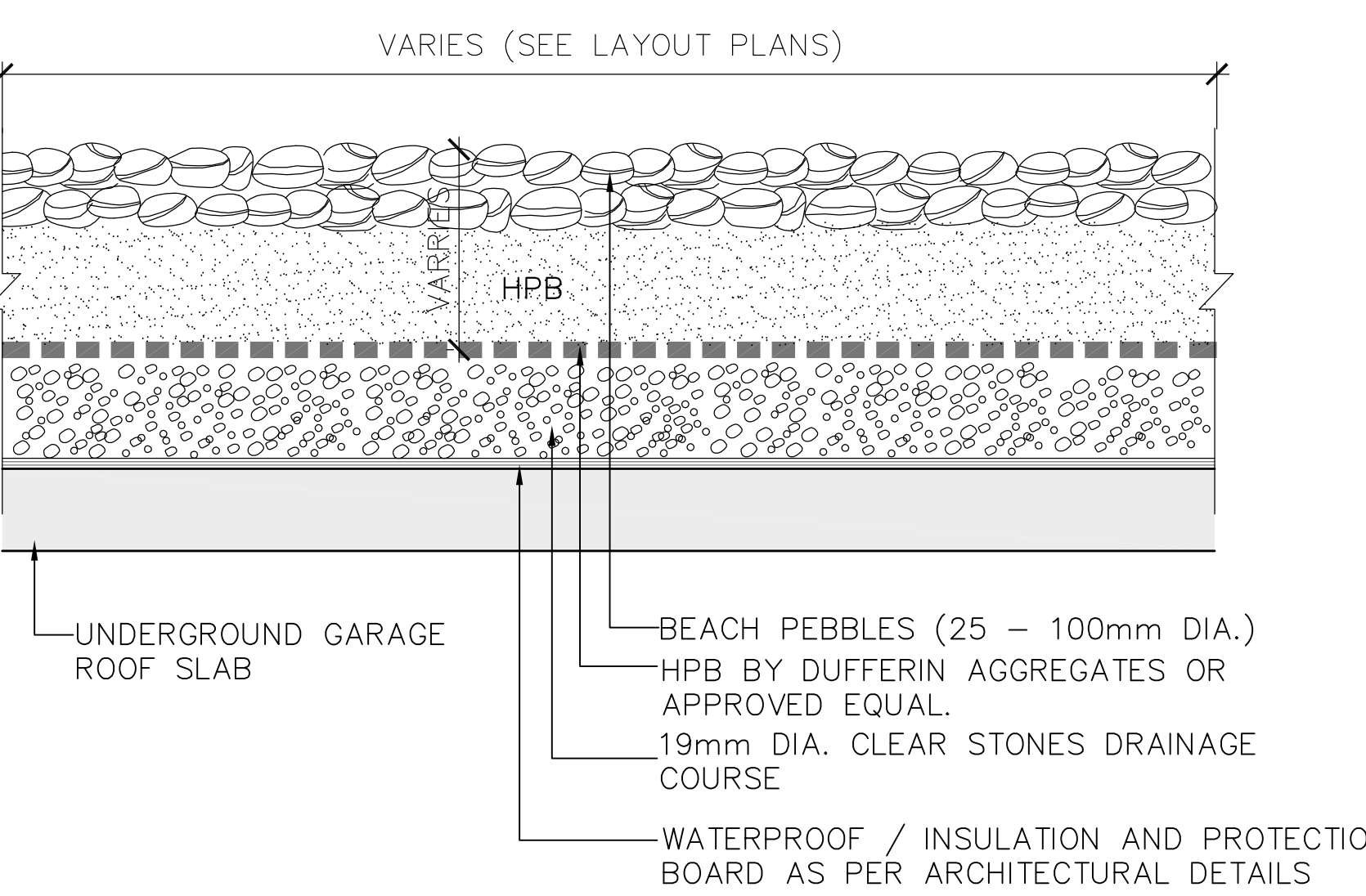

7 200 BEACHSTONE MAINTENANCE STRIP

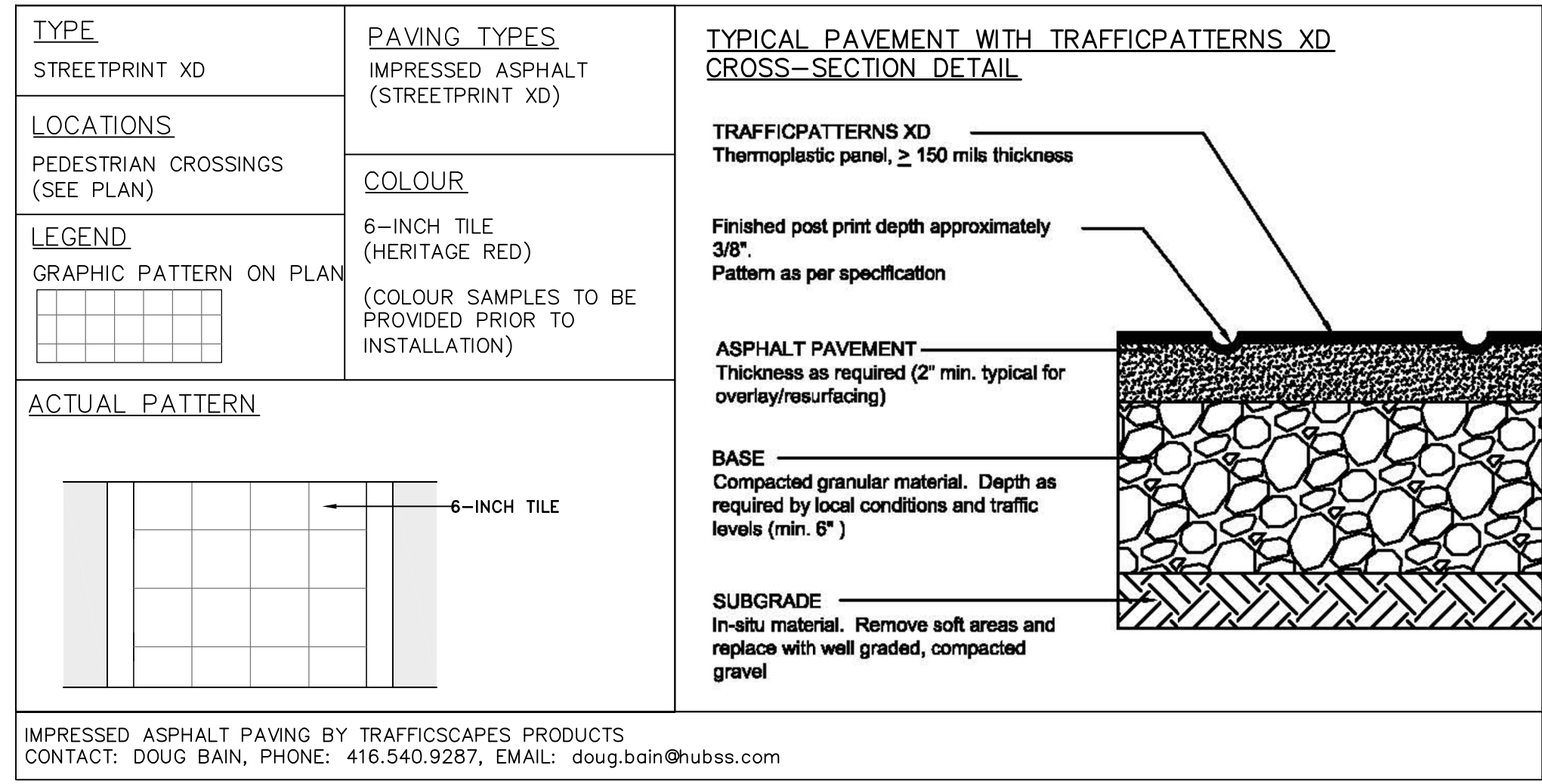

5 200 IMPRESSED XD ASPHALT

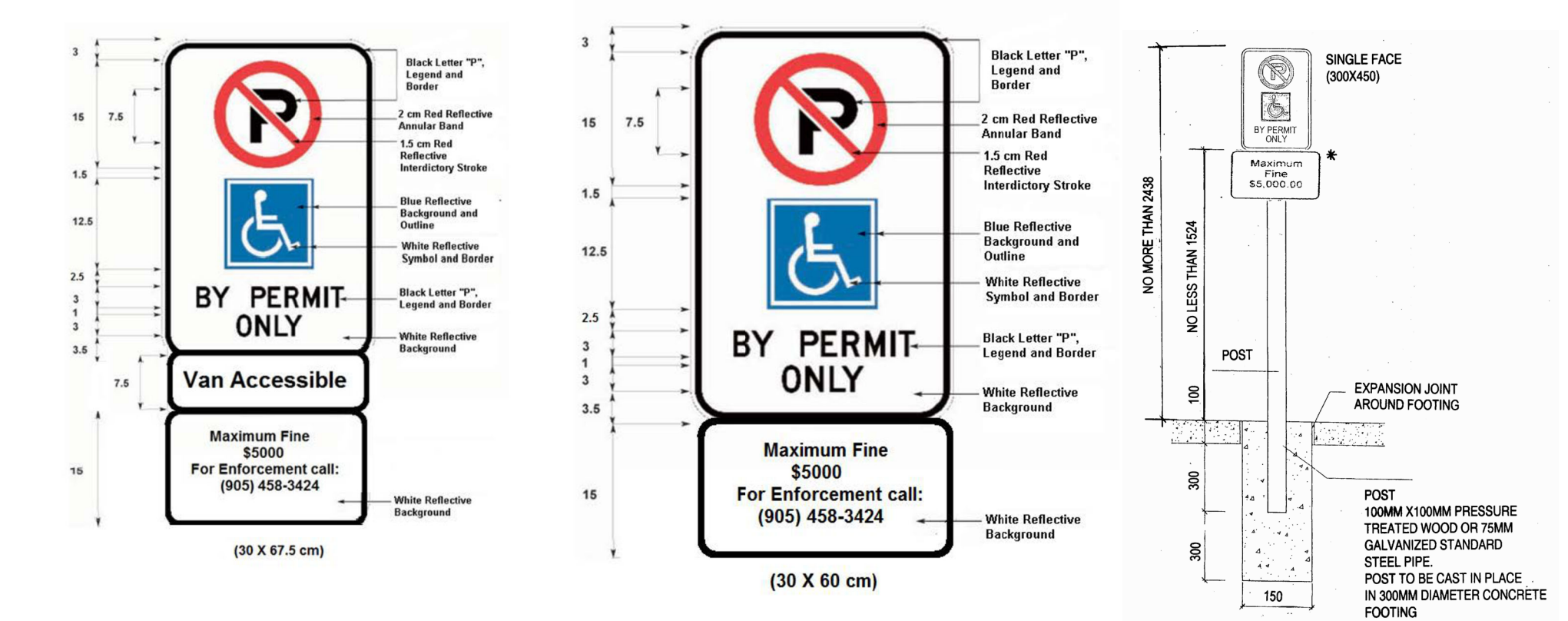

6 200 ACCESSIBLE PARKING SIGNAGE

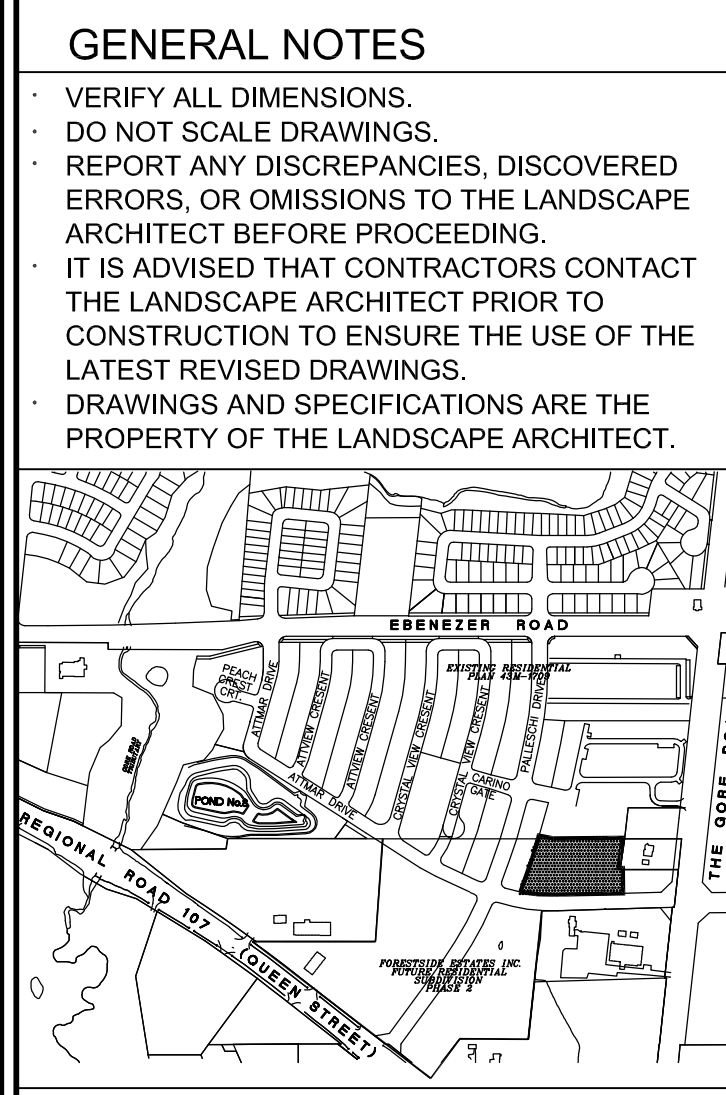

SHEET LIST	LANDSCAPE PLAN
L100	LANDSCAPE PLAN
L200	LANDSCAPE DETAILS
L201	LANDSCAPE DETAILS
L202	LANDSCAPE DETAILS
L203	LANDSCAPE DETAILS

**APPROVED**

Planning and Development Services Department

Manager, Development Services

Date

No.	DATE.	REVISION.	BY.
5	08-05-2022	Issued For TENDER	BB
4	04-21-2020	Issued For SPA SUBMISSION	BB
3	10-01-2019	Issued For SPA SUBMISSION	BB
2	08-02-2019	Issued For Tender	BB
1	04-22-2019	For Submission	BB

It is the responsibility of the Contractor and/or Owner to ensure that the drawings with the latest revisions are used for construction.

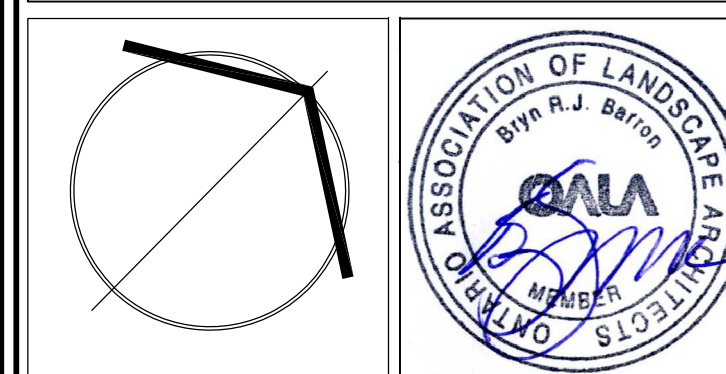

**SBK** 5770 HURONTARIO STREET, SUITE 320 MISSISSAUGA, ONTARIO, L5R 3G5  
T: 416.605.4245 F: 905.712.3101 WWW.STRYBOS.COM

**STRYBOS BARRON KING**  
LANDSCAPE ARCHITECTURE

PROJECT:  
**PROPOSED STACKED TOWNHOMES DEVELOPMENT**  
FORESTSIDE ESTATES INC  
65-95 ATTMAR DRIVE

DRAWING TITLE: LANDSCAPE DETAILS	
SCALE: AS SHOWN	PROJECT No. 18-5261
DATE: MARCH 2019	
DRAWN BY: KG	DRAWING No.
CHECKED BY: SM/BB	L200







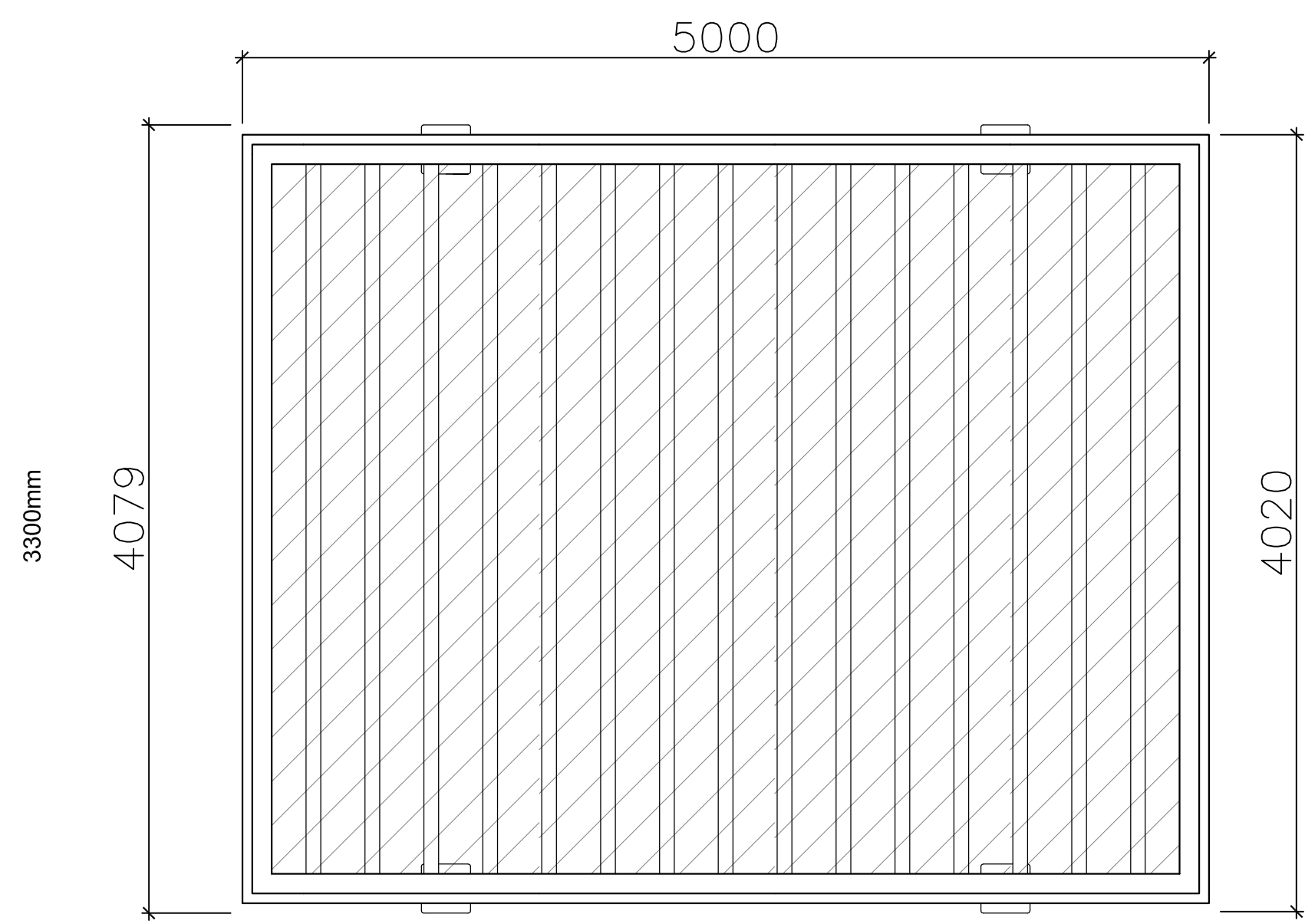

A-PLAN VIEW  
(TWIN WALL 10mm POLYCARBONATE ROOF PANELS W/ 76mm X 76mm RAFTERS)

NOTE  
THIS DETAIL IS SCHEMATIC CONNECTION  
DETAILS TO BE PROVIDED ALONG WITH  
SHOP DRAWINGS CERTIFIED BY A  
STRUCTURAL ENGINEER.

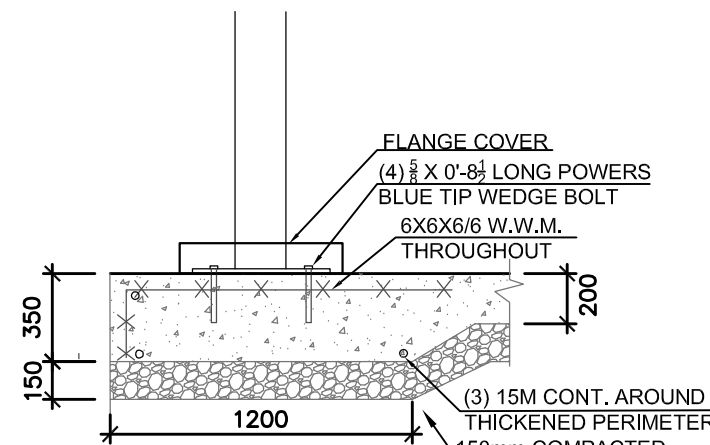

C-SECTION  
(TYPICAL SHADE STRUCTURE POST CONNECTION TO CONCRETE PAD)

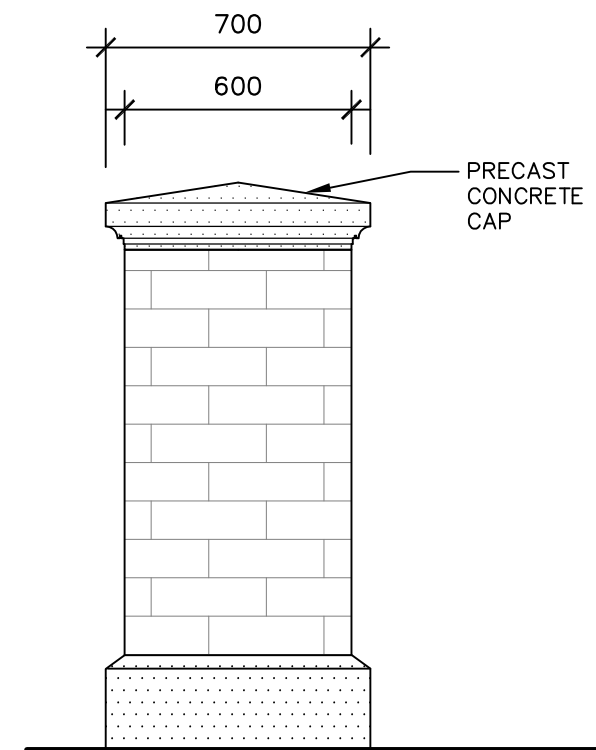

B-ELEVATION  
(PILLAR)

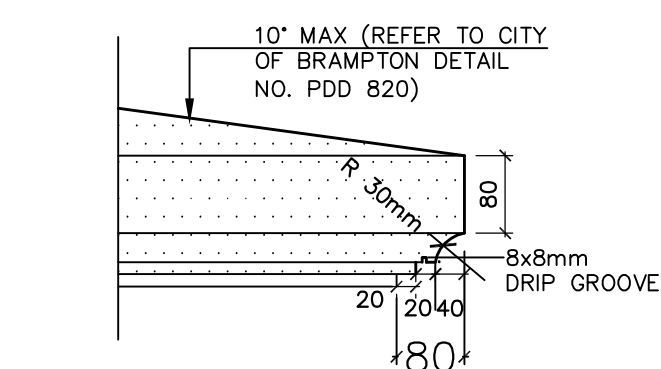

C-ELEVATION  
(PILLAR CAP)

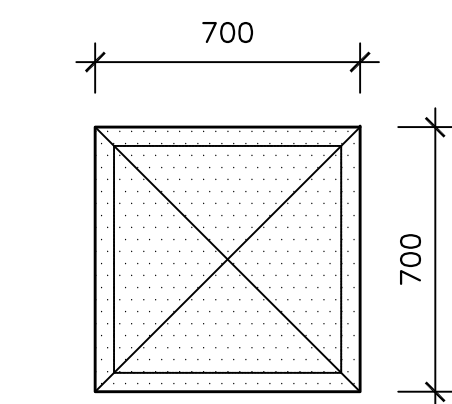

D-PLAN VIEW  
(PILLAR CAP)

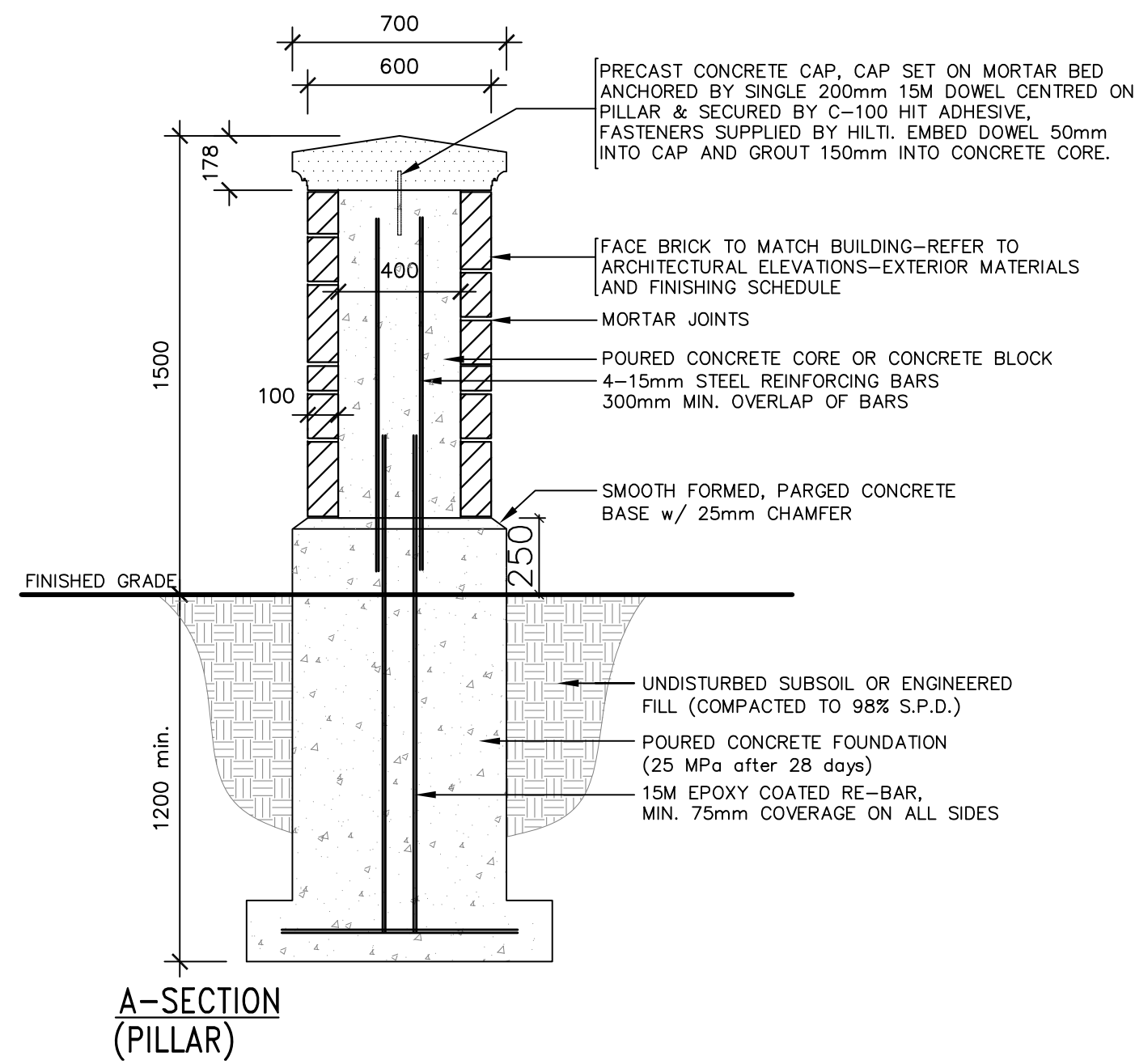

A-SECTION  
(PILLAR)

1500mm HT MASONRY PILLAR

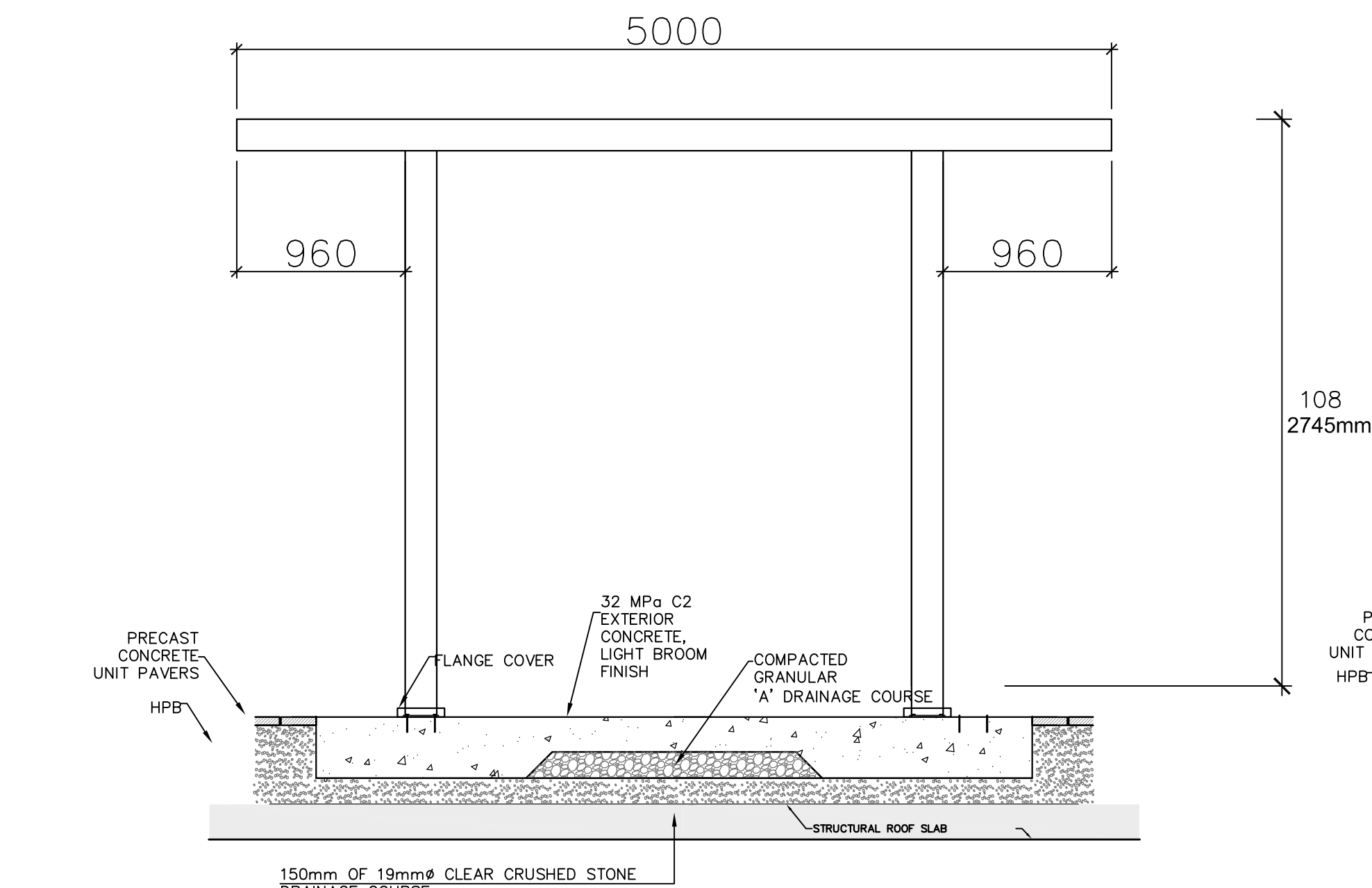

B-SIDE ELEVATION

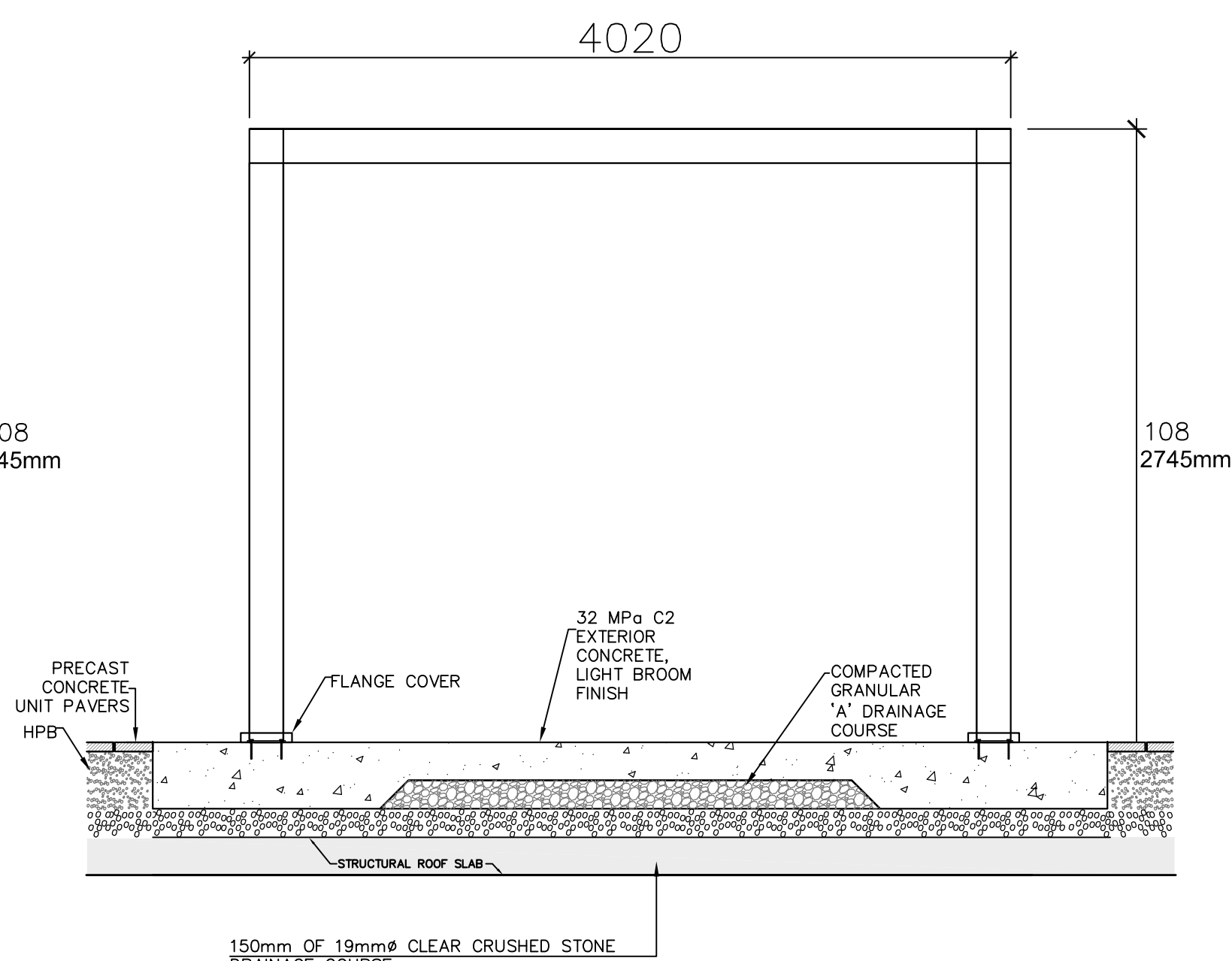

D-FRONT ELEVATION

1 SHADE STRUCTURE (STUR DESIGN INC. MODEL CODE: CP-TB-5500-5PC, CUSTOM TOSA BOLD, 2019-07-31)

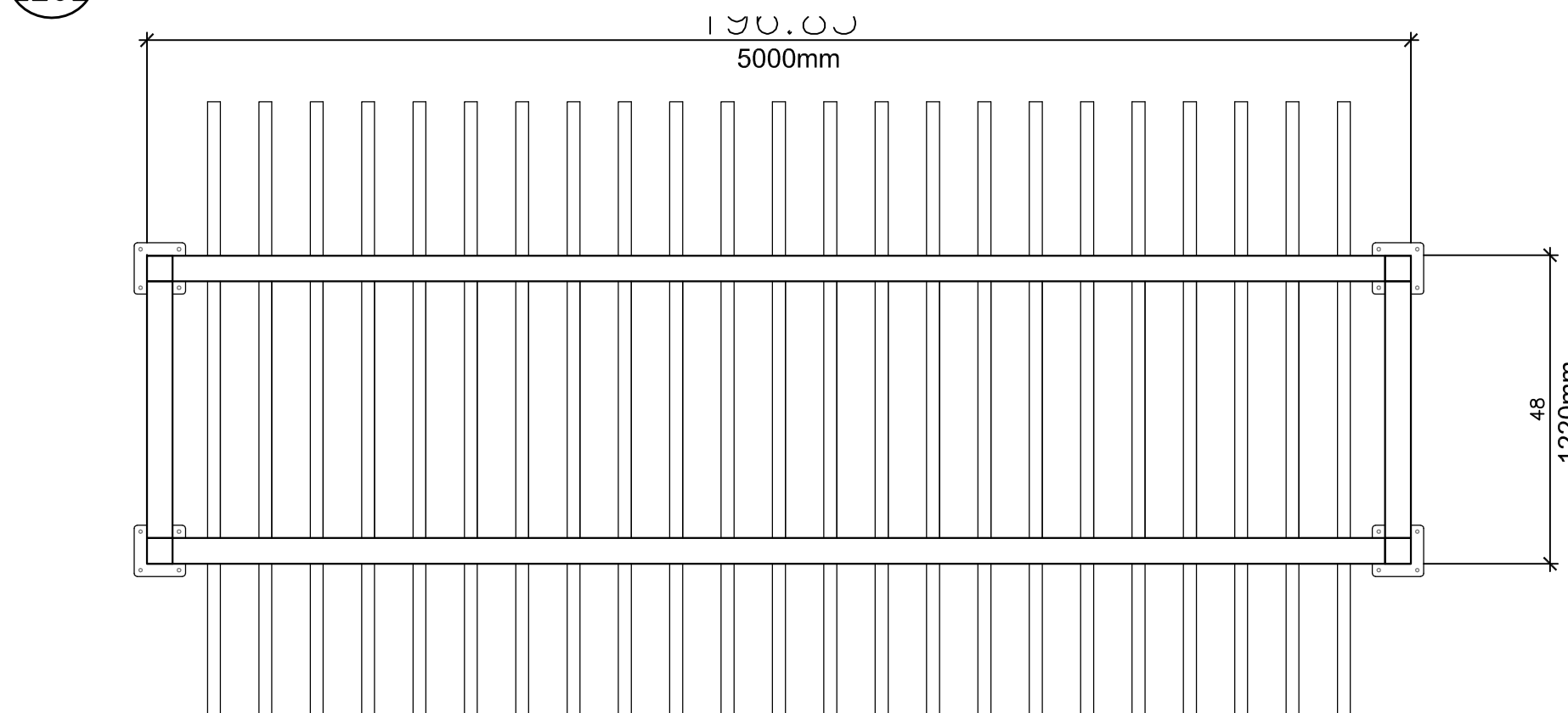

A-PLAN VIEW  
(VERTICALLY ORIENTED 51mm X 152mm ALUMINUM PURLINS SPACED AT ~203mm O/C.)

NOTE  
THIS DETAIL IS SCHEMATIC CONNECTION  
DETAILS TO BE PROVIDED ALONG WITH  
SHOP DRAWINGS CERTIFIED BY A  
STRUCTURAL ENGINEER.

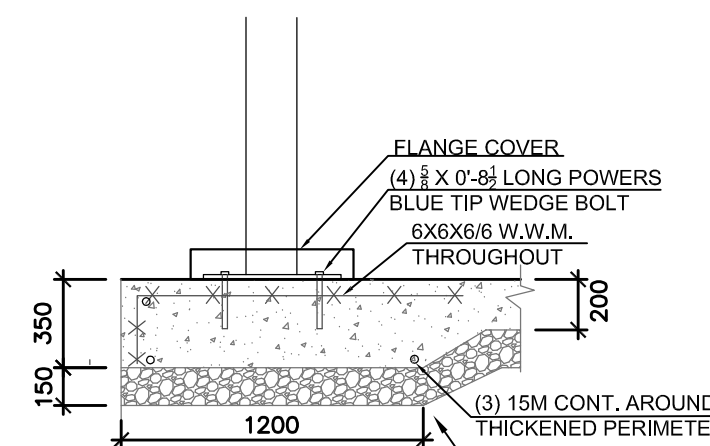

C-SECTION  
(TYPICAL SHADE STRUCTURE POST CONNECTION TO CONCRETE PAD)

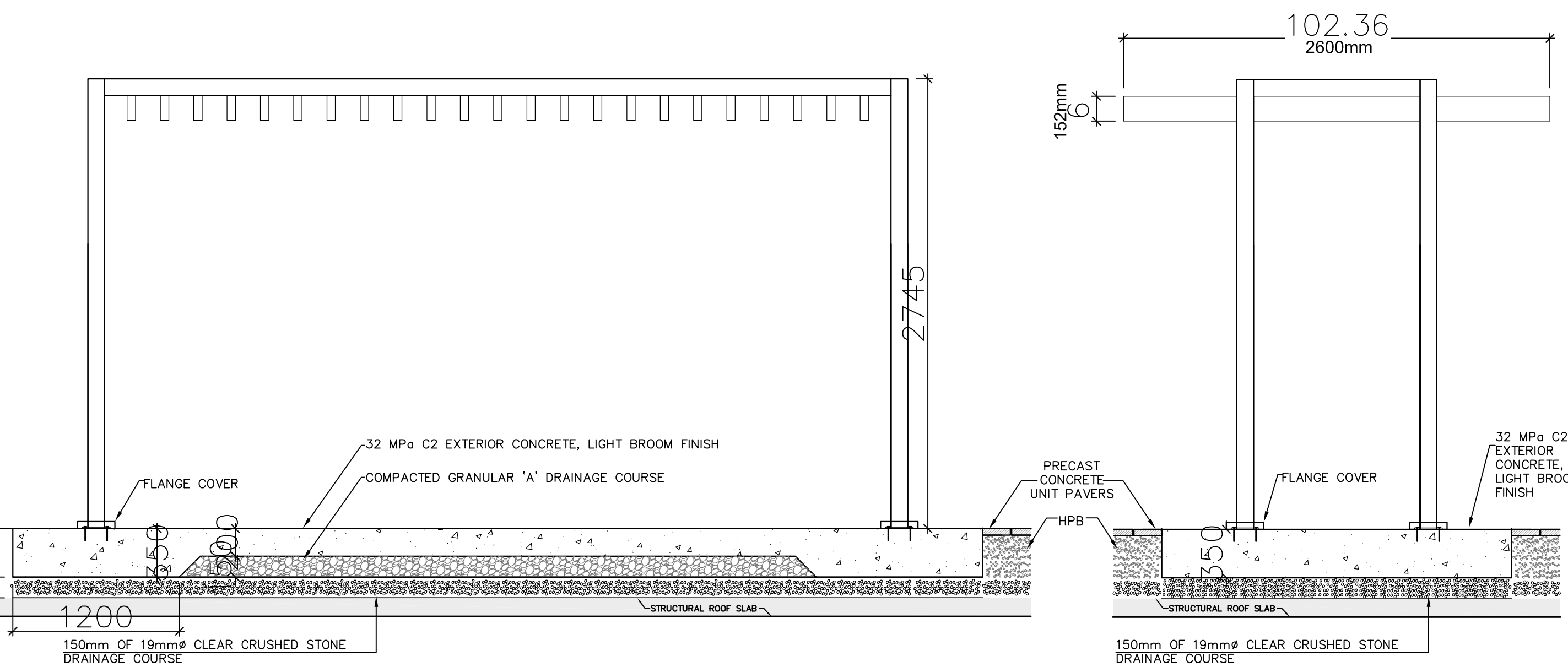

B-SIDE ELEVATION  
(102mm x 102mm COLUMNS AND BEAMS, WITH 203mm x 203mm BASE PLATES)

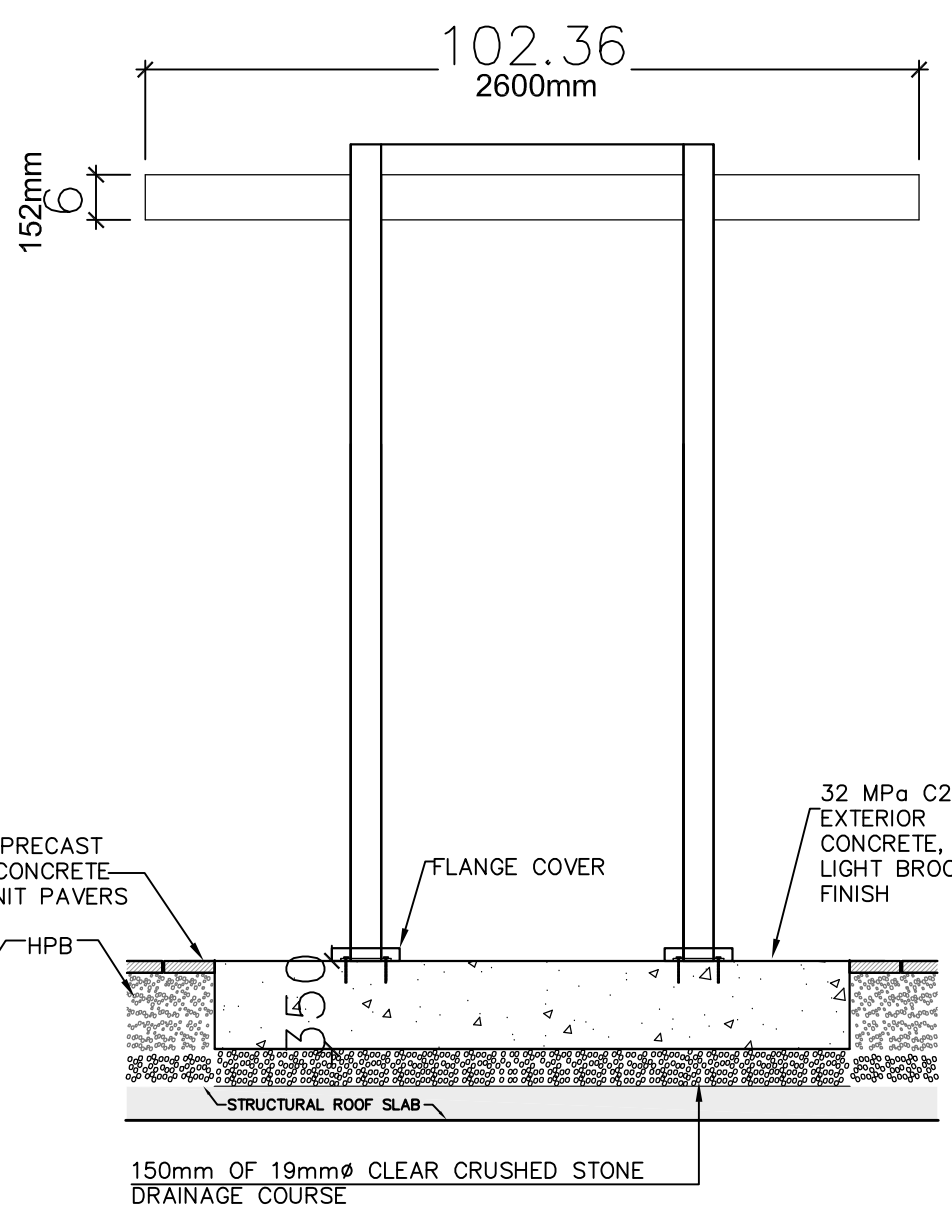

D-FRONT ELEVATION

3 TRELLIS (STUR DESIGN INC. MODEL CODE: CP-A-5000-UVA26, CUSTOM ARCO, 2019-07-31)

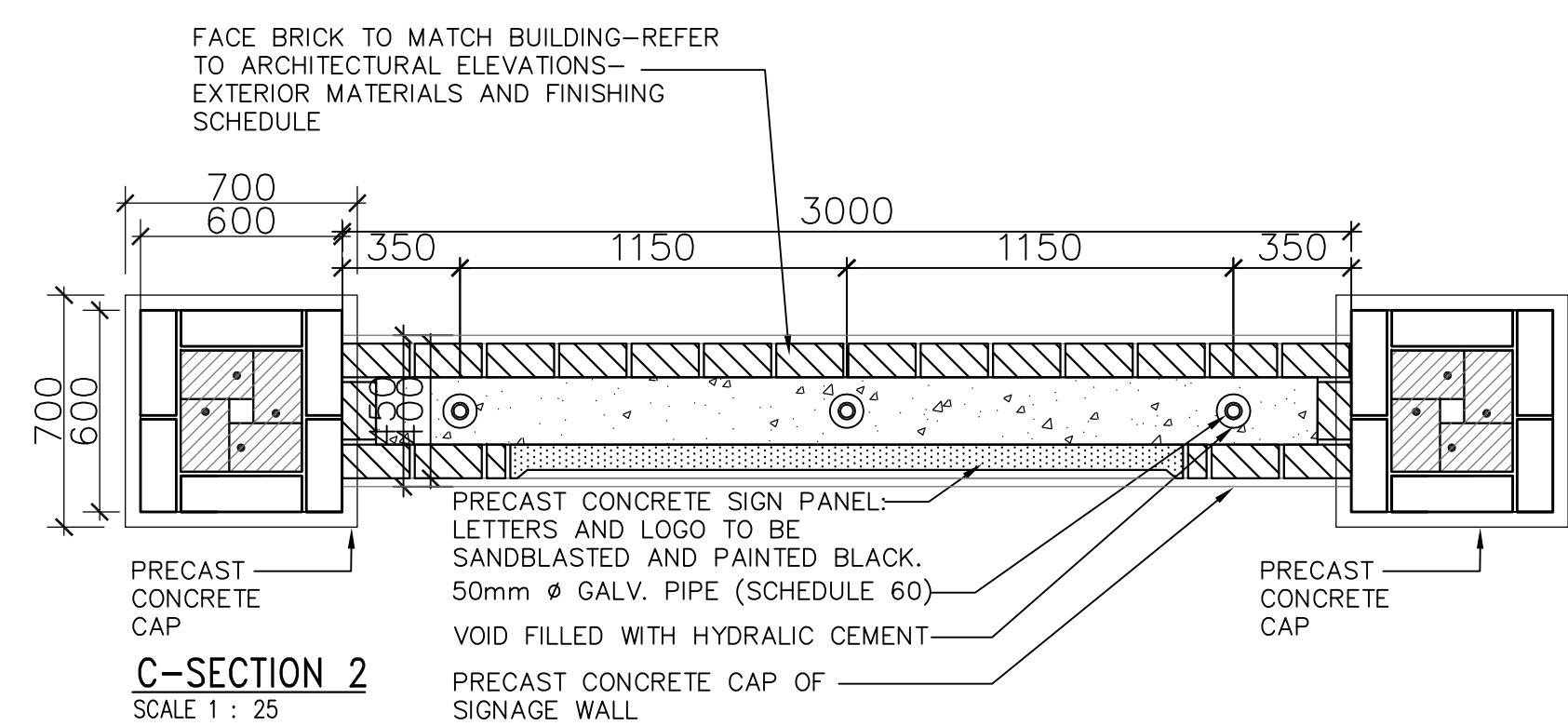

C-SECTION 2  
SCALE 1 : 25

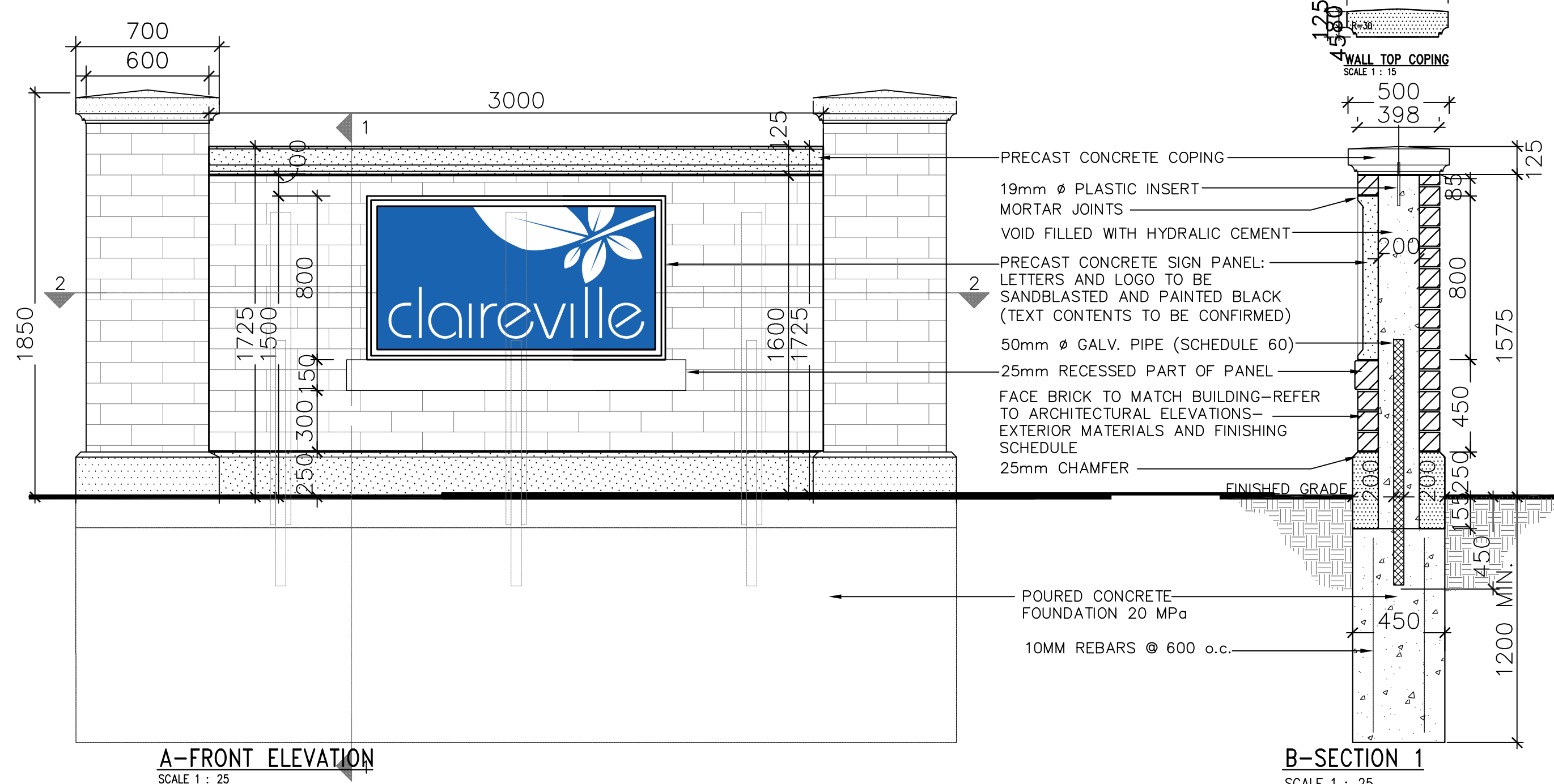

A-FRONT ELEVATION  
SCALE 1 : 25

B-SECTION 1  
SCALE 1 : 25

4 ENTRY FEATURE MASONRY WALL

## GENERAL NOTES

- VERIFY ALL DIMENSIONS.
- DO NOT SCALE DRAWINGS.
- REPORT ANY DISCREPANCIES, DISCOVERED ERRORS, OR OMISSIONS TO THE LANDSCAPE ARCHITECT BEFORE PROCEEDING.
- IT IS ADVISED THAT CONTRACTORS CONTACT THE LANDSCAPE ARCHITECT PRIOR TO CONSTRUCTION TO ENSURE THE USE OF THE LATEST REVISED DRAWINGS.
- DRAWINGS AND SPECIFICATIONS ARE THE PROPERTY OF THE LANDSCAPE ARCHITECT.

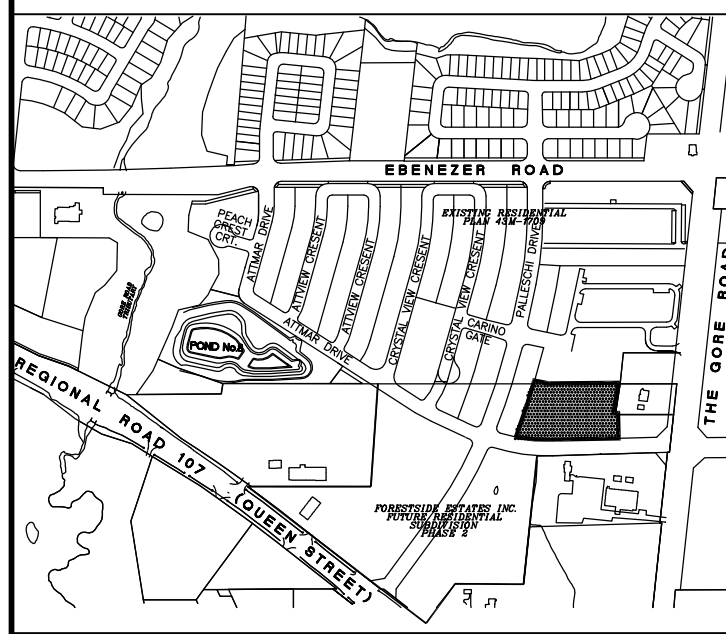

SHEET LIST	LANDSCAPE PLAN
L100	LANDSCAPE PLAN
L200	LANDSCAPE DETAILS
L201	LANDSCAPE DETAILS
L202	LANDSCAPE DETAILS
L203	LANDSCAPE DETAILS

## APPROVED

Planning and Development  
Services Department

Manager, Development Services

Date

No.	DATE	REVISION	BY
5	08-05-2022	Issued For TENDER	BB
4	04-21-2020	Issued For SPA SUBMISSION	BB
3	10-01-2019	Issued For SPA SUBMISSION	BB
2	08-02-2019	Issued For Tender	BB
1	04-22-2019	For Submission	BB

It is the responsibility of the Contractor and/or Owner to ensure that the drawings with the latest revisions are used for construction.

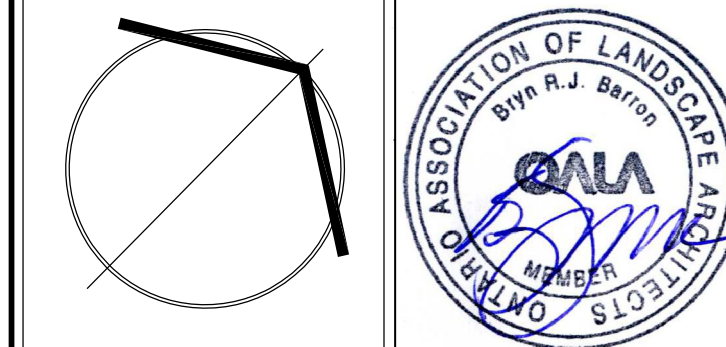

**SBK**  
STRYBOS BARRON KING  
LANDSCAPE ARCHITECTURE

PROJECT:  
**PROPOSED STACKED TOWNHOMES DEVELOPMENT**  
FORESTSIDE ESTATES INC  
65-05 ATTARM DRIVE

DRAWING TITLE:  
**LANDSCAPE DETAILS**

SCALE	PROJECT No.
AS SHOWN	18-5261
DATE	DRAWING No.
MARCH 2019	L202
DRAWN BY:	
SM/BB	
CHECKED BY:	



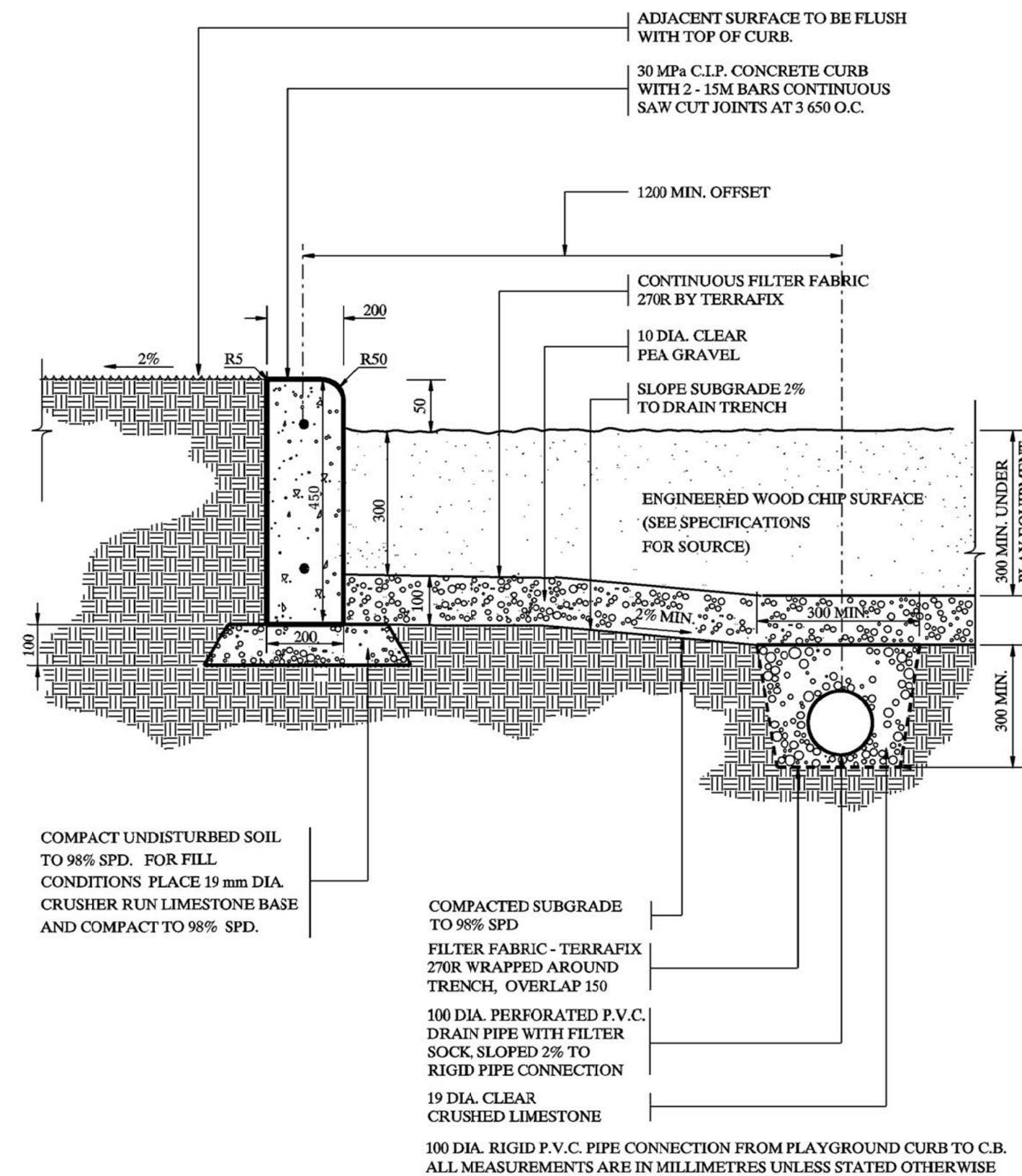
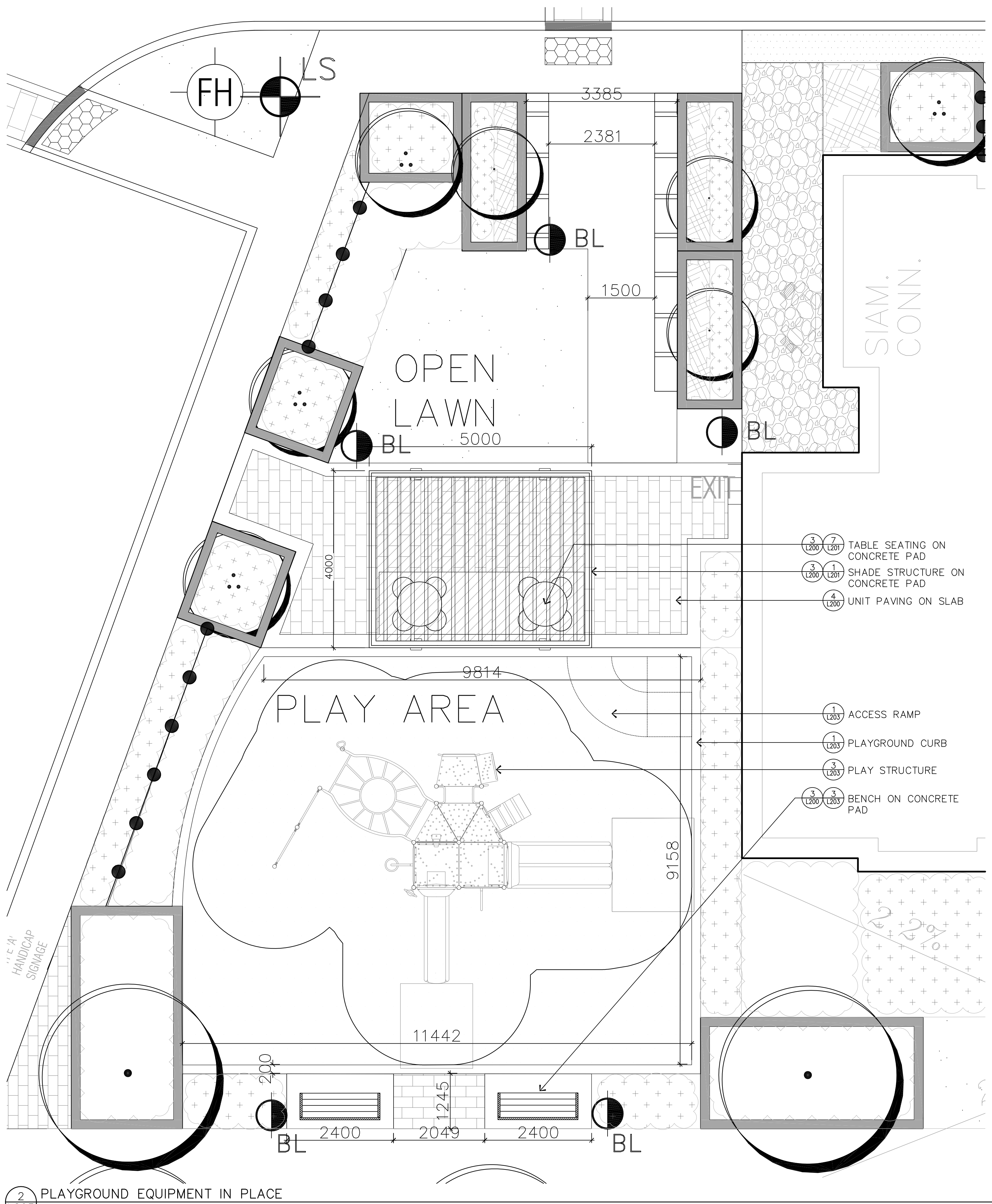

A-STANDARD CONCRETE CURB

1 203 PLAYGROUND CURB & WOOD FIBAR SURFACE

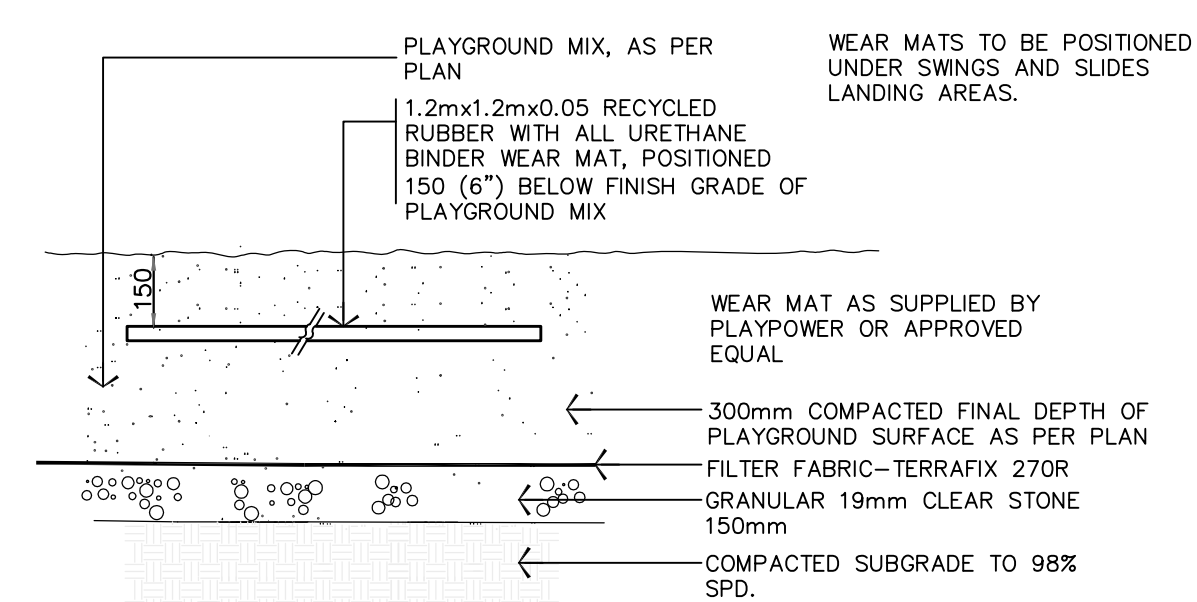

C-RUBBER WEAR MAT

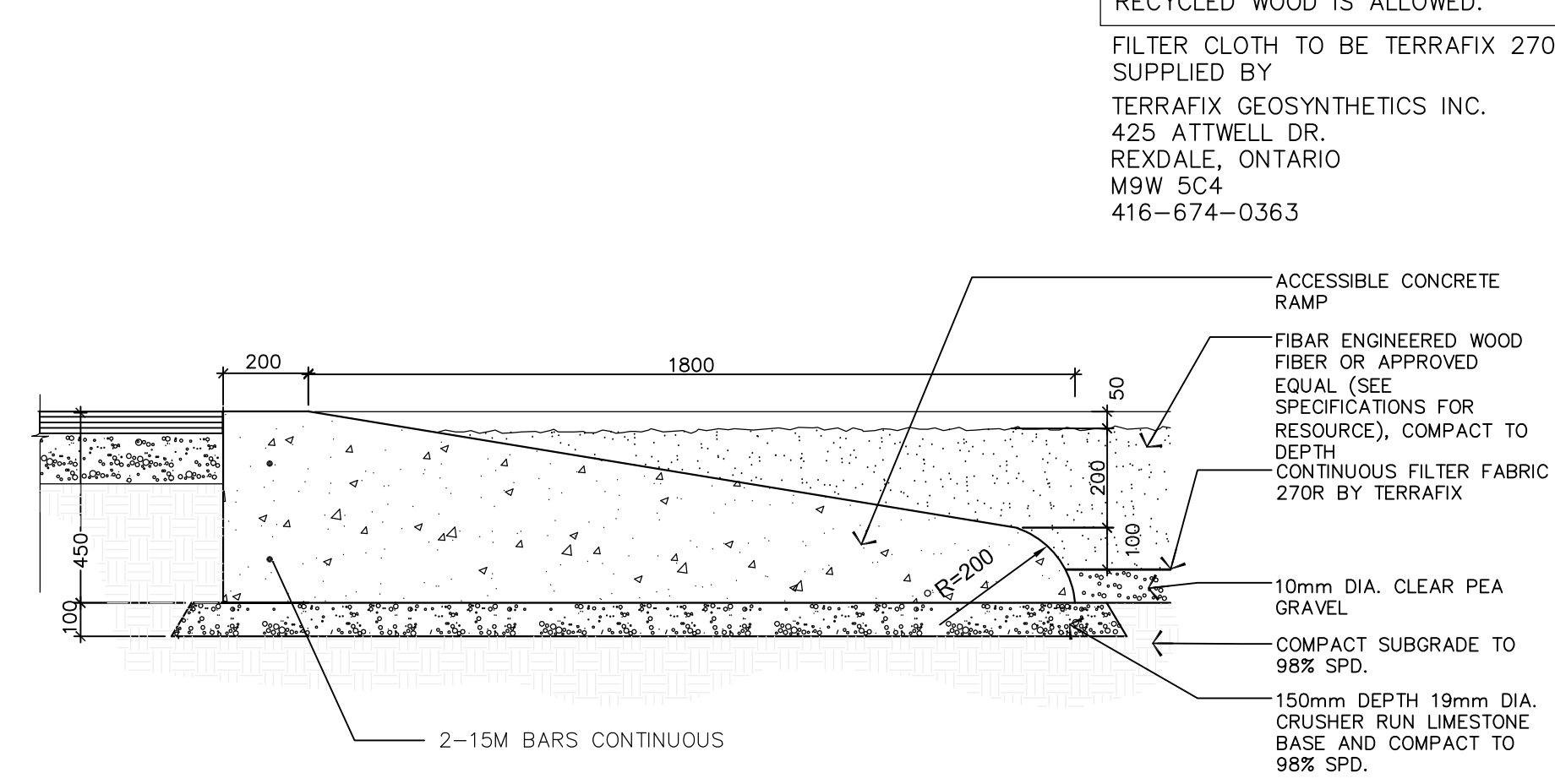

B-RAMPED CONCRETE CURB

CLEAR WOOD FIBRE TO BE FIBAR 3000 SYSTEM AS SUPPLIED BY WOODCARPET RECREATIONAL SURFACING OR APPROVED EQUAL.

WOOD FIBRE TO BE RECENTLY HARVESTED NORTH AMERICAN HARDWOODS FREE OF BARK, SOIL, LEAVES, TWIGGS AND OTHER CONTAMINANTS WITH NO CHEMICAL TREATMENTS OR ADDITIVES. NO WOOD FROM PALLETS OR WASTE OR RECYCLED WOOD IS ALLOWED.

FILTER CLOTH TO BE TERRAFIX 270R AS SUPPLIED BY TERRAFIX GEOSYNTHETICS INC. 425 ATTWELL DR. REXDALE, ONTARIO M9W 5C4 416-674-0363

General Notes:

- Age Group  
☐ 2-5yrs ☒ 5-12 yrs ☐ 12-17yrs ☐ 18+yrs
- The Americans with Disabilities Act (ADA) may require that you make your park and/or playground accessible when viewed in its entirety. Please consult your local council to determine if the ADA applies to you.
  - For playground equipment to be considered accessible, accessible surfacing must be utilized in applicable areas.
  - Although a particular playground design may not meet the proposed Access Board Regulations in regards to the appropriate number of ground level events, the actual existing play components.
  - All deck heights are measured from top of ground cover.
  - Full absorbing ground cover is required under and around all play equipment.
  - The minimum recommended fall zone around the entire play structure is shown. This zone is to be free of all tripping or collision hazards (i.e. roots, rocks, border materials, etc.).
  - Post heights are identified by feet showing the post height, i.e. 9'6" represents a 9'6" high post.
  - Not all equipment may be appropriate for all children. Supervision is required.

AGE GROUP: 5-12  
ELEVATED PLAY ACTIVITIES: TOTAL: 7  
ELEVATED PLAY ACTIVITIES ACCESSIBLE BY TRANSFER: 7  
ELEVATED PLAY ACTIVITIES ACCESSIBLE BY RAMP: 3  
GROUND LEVEL ACTIVITY TYPE: 3  
GROUND LEVEL ACTIVITY TYPE: 4

Playground Layout Compliance:

- ☒ ASTM F1487 - Playground Equipment for Public Use.  
☒ CPSC Handbook for Public Playground Safety
- ☒ This playground design meets the final Access Board Regulations.

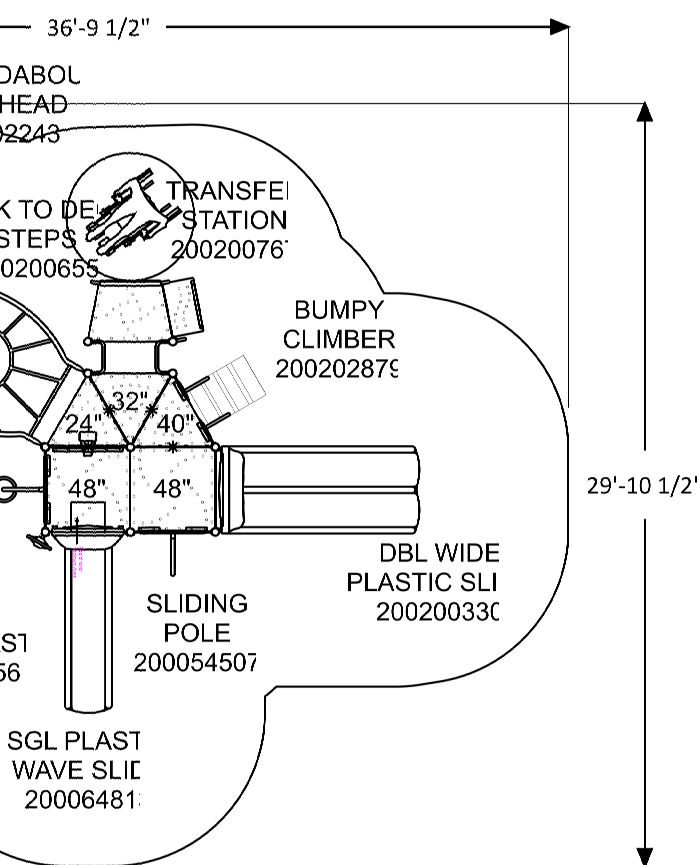

Project: PB19-071309 2019 1ST HALF PROMO MONETT, MO  
LTCPS rep: Donna Friedman  
PLAYPOWER 573-915-7740  
Ground Space: 25'-6" x 18'-6"  
Protective Area: 37'-0" x 30'-0"  
Drawn by: Donna Friedman  
Date: 9/23/2016  
DWG Name: 0000\_42639415093  
LTCPS - Farmington 878 East Highway 60  
Monett, Missouri 65708  
Voice: 1-800-325-8828  
Fax: 417-354-2273

LEED points for this structure  
2

3 203 PLAYGROUND EQUIPMENT ENLARGEMENT

GENERAL NOTES

- VERIFY ALL DIMENSIONS.
- DO NOT SCALE DRAWINGS.
- REPORT ANY DISCREPANCIES, DISCOVERED ERRORS, OR OMISSIONS TO THE LANDSCAPE ARCHITECT BEFORE PROCEEDING.
- IT IS ADVISED THAT CONTRACTORS CONTACT THE LANDSCAPE ARCHITECT PRIOR TO CONSTRUCTION TO ENSURE THE USE OF THE LATEST REVISED DRAWINGS.
- DRAWINGS AND SPECIFICATIONS ARE THE PROPERTY OF THE LANDSCAPE ARCHITECT.

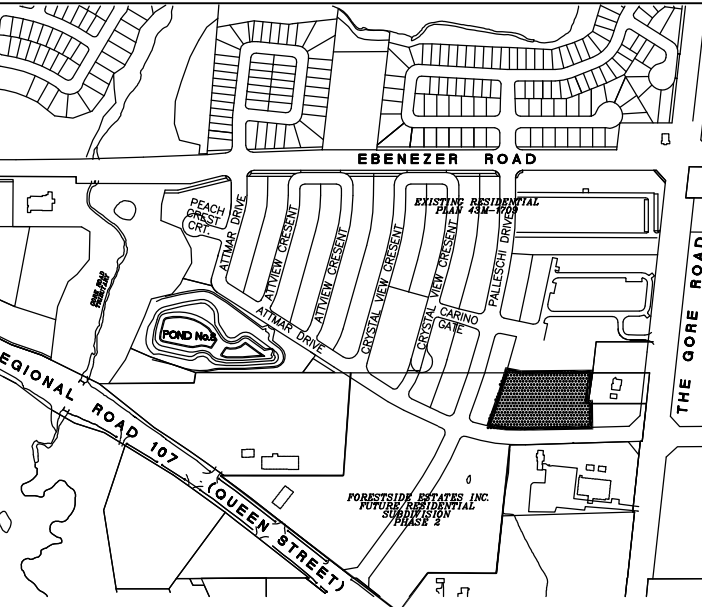

SHEET LIST	LANDSCAPE PLAN	LANDSCAPE DETAILS	LANDSCAPE DETAILS	LANDSCAPE DETAILS	LANDSCAPE DETAILS
L100	LANDSCAPE PLAN	L200	LANDSCAPE DETAILS	L201	LANDSCAPE DETAILS
L202	LANDSCAPE DETAILS	L203	LANDSCAPE DETAILS	L203	LANDSCAPE DETAILS

APPROVED  
Planning and Development  
Services Department

Manager, Development Services

Date

No.	DATE	REVISION	BY
5	08-05-2022	Issued For TENDER	BB
4	04-21-2020	Issued For SPA SUBMISSION	BB
3	10-01-2019	Issued For SPA SUBMISSION	BB
2	08-02-2019	Issued For Tender	BB
1	04-22-2019	For Submission	BB

It is the responsibility of the Contractor and/or Owner to ensure that the drawings with the latest revisions are used for construction.

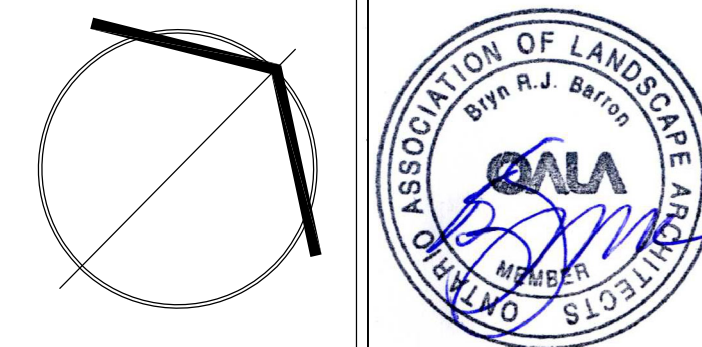

**SBK** 5770 HURONTARIO STREET, SUITE 320 MISSISSAUGA, ONTARIO, L5R 3G5  
T: 416-605-4040 F: 905-712-3101  
WWW.STRYBOS.COM

PROJECT: PROPOSED STACKED TOWNHOMES DEVELOPMENT  
FORESIDE ESTATES INC  
65-95 ATTARM DRIVE

DRAWING TITLE: LANDSCAPE DETAILS

SCALE: MARCH 2019	PROJECT No. 18-5261
DATE: AS PER L100	
DRAWN BY: KG	DRAWING No. L203
CHECKED BY: SM/BB	