

## GENERAL NOTES:

### MAINTENANCE and ACCEPTANCE:

- ALL PLANT MATERIAL SHALL BE MAINTAINED BY THE CONTRACTOR IMMEDIATELY AFTER ANY PLANTING HAS BEEN INSTALLED AND SHALL CONTINUE UNTIL THE DATE OF FINAL ACCEPTANCE.
- SUCH MAINTENANCE SHALL INCLUDE ALL MEASURES NECESSARY TO ESTABLISH AND MAINTAIN ALL PLANTS IN AN ACCEPTABLE, VIGOROUS AND HEALTHY GROWING CONDITION INCLUDING CULTIVATING AND WEEDING, WATERING WHEN REQUIRED, PRUNING AND MAINTENANCE OF ALL ACCESSORIES.
- AT TIME OF INSPECTION FOR INITIAL & FINAL ACCEPTANCE, ALL PLANTING BEDS AND TREE PITS SHALL BE FRESHLY CULTIVATED, FREE OF WEEDS, LEAVES, BROKEN BRANCHES AND RUBBISH AND SHALL BE IN A NEAT AND TIDY CONDITION.
- ALL PLANT MATERIAL TO BE GUARANTEED FOR A PERIOD OF 2 (TWO) YEARS FROM THE DATE OF ACCEPTANCE BY THE LANDSCAPE ARCHITECT AND LOCAL AUTHORITY UNLESS OTHERWISE NOTED.
- MAINTAIN PLANTING BEDS AND TREE PITS FREE OF WEEDS THROUGHOUT THE GUARANTEE PERIOD.
- THE DEVELOPER SHALL REGULARLY REMOVE DEBRIS FROM THE WEELAND UNTIL THE COMPLETION OF ALL BUILDING CONSTRUCTION WITHIN THE DEVELOPMENT.

### UTILITIES:

- APPLICANT IS RESPONSIBLE FOR OBTAINING NECESSARY APPROVALS FROM THE UTILITY COMPANIES FOR WORKS WITHIN THE MUNICIPAL BOULEVARD.
- ALL UTILITIES WITHIN THE BOULEVARDS MUST BE LOCATED PRIOR TO COMMENCING CONSTRUCTION WITHIN THE BOULEVARD.

### RODENT PROTECTION:

- THE CONTRACTOR SHALL BE RESPONSIBLE FOR THE PROTECTION OF ALL TREES AND SHRUBS FROM RODENT INJURY FOR THE DURATION OF THE GUARANTEE PERIOD. PROTECTIVE WIRE MESH GUARDS SHALL BE EMPLOYED AROUND ALL DECIDUOUS TREES. GUARDS SHALL BE INSTALLED PRIOR TO THE APPLICATION OF MULCH AND SHOULD BE PLACED A MINIMUM OF 50mm CUT FROM THE TREE TRUNK ON ALL SIDES. SUFFICIENT MESH SHOULD BE CUT TO COMPLETE THIS CONFORMANCE AS WELL AS TO PROVIDE A MINIMUM OF 25mm OVERLAP.
- THE WIRE MESH GUARDS MUST BE OF GALVANIZED STEEL 12mm SQUARE MESH, 19 GAUGE AND SUPPLIED IN 600mm ROLLS. THE WIRE MESH CAN BE FASTENED WITH ANY ACCEPTABLE GALVANIZED WIRE TIE. ALL SHRUBS AND CONIFEROUS TREES SHALL HAVE AN APPLICATION OF "SKOOT" OR APPROVED EQUIVALENT RODENT FORMULA, TO BE APPLIED AT THE END OF OCTOBER. FOLLOW MANUFACTURER'S DIRECTIONS FOR APPLICATION.

### TOPSOIL:

- USE EVENLY MIXED TOPSOIL OF FERTILE, FRABLE NATURAL LOAM CONTAINING NOT LESS THAN 4% ORGANIC MATTER FOR CLAY LOAMS AND 2% MINIMUM ORGANIC MATTER FOR SAND LOAMS WITH AN ACIDITY RANGE OF 5.5 TO 7.5 pH.
- ALL TOPSOIL SHOULD BE FREE OF SUBSOILS, CLAY, STONES, ROOTS, EXCESS WATER, FROST AND OTHER EXTRANEOUS MATTER.

### CARPENTRY

- (UNLESS OTHERWISE SPECIFIED)
- ALL LUMBER SHALL BE NO. 1 GRADE WESTERN CEDAR UNLESS OTHERWISE STATED, AND SHALL BE STAMPED IN ACCORDANCE WITH THE CURRENT REQUIREMENTS OF THE LATEST NLGA STANDARD GRADING RULES.
- PRESSURE TREATED WOOD SHALL BE EITHER PINE, SPRUCE OR FIR. THIS WOOD SHALL BE PRESSURE TREATED WITH A.C.Q.-B (ALKALINE COPPER QUAT TYPE B) OR OTHER APPROVED WATERBORNE CHEMICAL IN ACCORDANCE WITH THE LATEST REQUIREMENTS OF C.S.A.-080.
- ALL CEDAR LUMBER IS TO BE STAINED WITH ONE COAT OF A LATEX STAIN AS APPROVED BY THE LANDSCAPE ARCHITECT BEFORE APPLICATION.
- ALL WOOD SHALL BE SELECTED FOR UNIFORM APPEARANCE AND SIZE SHALL BE STRUCTURALLY SOUND AND SHALL BE FREE OF SPLITS, CRACKS AND LOOSE AND OPEN KNOTS.
- ALL WOOD SHALL BE DRESSED FOUR SIDES.
- ALL SPIKES AND NAILS SHALL BE "ARDOX" SPIRAL SHANK.
- ALL SPIKES, NAILS, BOLTS, NUTS AND ANY OTHER METAL FASTENERS AND CONNECTORS SHALL BE NOT DIPPED, GALVANIZED IN ACCORDANCE WITH C.S.A.-084.
- CONCRETE FOR FOOTINGS SHALL HAVE A COMPRESSIVE STRENGTH OF 20.7 M.P.A. IN 28 DAYS (MIN).
- MAKE ALL TIMBER CUTS STRAIGHT AND PLUMB TO INSURE A TIGHTLY BUTTED FLUSH JOINT. PAINT ALL CUTS TO PRESSURE TREATED WOOD, WITH ONE COAT OF APPROVED PRESERVATIVE PRIOR TO ASSEMBLY.
- COUNTERSINK ALL BOLTS, NUTS, PLATES, ANCHORS, ETC. IN ORDER TO BE FLUSH WITH WOOD SURFACE AND AS DETAIL.

### PLANTING:

- (UNLESS OTHERWISE SPECIFIED)
- PREPARE PLANTING BED BY EVENLY MIXING FOUR PARTS SANDY TOPSOIL, ONE PART ORGANIC SOIL ADDITIVE WITH 500g BONE MEAL AND 750g COMMERCIAL FERTILIZER PER CUBIC METER. THE FOREGOING RATES ARE SUBJECT TO ADJUSTMENT ON RECEIPT OF TOPSOIL ANALYSIS REPORT.
- EXCAVATE AND PROVIDE PLANTING SOLS AS PER PLANTING DETAILS.
- PROVIDE ALL SHRUBS AND TREES ACCORDING TO THE GUIDE SPECIFICATIONS FOR NURSERY STOCK OF THE CANADIAN NURSERY TRADE ASSOCIATION WITH REGARD TO QUALITY AND GRADING AND SIZED AS PER PLANT LIST.
- SPRAY ALL PLANTINGS IN LEAF WITH ANTIDESICCANT.
- PROVIDE TREES WITH STAKES.
- PLANTS ARE TO BE NO. 1 NURSERY GROWN, UNDER PROPER CULTURAL PRACTICES, IN PARTICULAR WITH RESPECT TO AMPLIFIED SPACING, PEST AND DISEASE CONTROL, AND BRANCH AND ROOT PRUNING.
- TREES ARE TO HAVE STURDY, STRAIGHT TRUNKS.
- TREES SHALL BE WELL BRANCHED AND BALANCED WITH A STRONG CENTRAL LEADER.
- DECIDUOUS SHADE TREES SHALL BE FREE OF BRANCHES NOT LESS THAN 1.8m FROM THE GROUND.
- ALL SHRUBS ARE TO BE PLANTED IN CONTINUOUS BEDS.
- DO NOT SOO BETWEEN THE EXISTING EXTERIOR AREA OF SHRUB BED UNIFORMITY TO SPECIFIED DEPTH AND FILL WITH SPECIFIED PLANTING SOIL.

### TREE LOCATION:

- NO TREES SHALL BE PLANTED UNDER OVERHEAD WIRES OR UNDERGROUND SERVICES.
- TREES ARE NOT TO BE PLANTED LESS THAN 1M FROM CURBS, UNDERGROUND UTILITIES, SIDEWALKS AND DRIVEWAYS, 2m FROM FIRE HYDRANTS AND TRANSFORMERS, AND 4m FROM LIGHT STANDARDS.
- THE CONTRACTOR IS TO STAKE OUT LOCATIONS OF TREE PITS. THIS STAKE OUT IS TO BE INSPECTED BEFORE THE EXCAVATION OF ANY TREE PITS.
- BEFORE THIS STAKE OUT, THE CONTRACTOR IS TO REQUEST A STAKE OUT ALL UNDERGROUND SERVICES.
- THE LANDSCAPE ARCHITECT AND THE MUNICIPALITY MAY, AT THEIR DISCRETION REDISTRIBUTE TREE LOCATIONS PRIOR TO PLANTING, IN ORDER TO MINIMIZE CONFLICTS WITH UTILITIES, DRIVEWAYS AND INTERSECTION VISIBILITY.

### SODDING:

- PREPARE A MINIMUM 100mm DEPTH OF TOPSOIL WITH A 10-6-4 COMMERCIAL FERTILIZER AT 7.3kg/100sq.m. AND SUPER PHOSPHATE AT 5kg/100sq.m. THE PROPORTIONS SPECIFIED ARE SUBJECT TO ADJUSTMENT DEPENDING ON TOPSOIL ANALYSIS REPORT.
- LAY NO. 1 NURSERY SOO ON ALL AREAS OF THE PROJECT NOT COVERED BY BUILDINGS OR PAVING.
- IMMEDIATELY AFTER INSTALLATION, SOO MUST BE WATERED AND ROLLED.

### UNIT PAVING:

- PAVERS SHALL BE PRECAST CONCRETE UNIT PAVERS WITH MIN. 58.85 M.P.A. (8500 P.S.I.) COMPRESSIVE STRENGTH, AND A WATER ABSORPTION NOT EXCEEDING 5% AND A FREEZE-THAW RESISTANCE EQUAL TO C.S.A.-A2-2 (1987).
- SETTING BED SHALL CONSIST OF SHARP, CLEAN, COARSE CONCRETE SAND OR APPROVED LIMESTONE SCREENINGS.
- SAND FOR JOINTS SHALL BE A CLEAN, NATURAL GRAVEL, CRUSHED STONE OR ROCK.
- INSTALL GRANULAR BASE AND COMPACT TO A MINIMUM STANDARD PROCTOR DENSITY UNTIL THE MIN. SPECIFIED DEPTH AS DETAILED, HAS BEEN ESTABLISHED.
- LOOSELY PLACED CONCRETE SAND OR SCREENINGS TO A UNIFORM DEPTH OF 50mm. (2"), MIN.
- MAINTAIN JOINTS UNIFORM AND CLOSELY BUTTED THROUGHOUT.
- WHERE NECESSARY, SAW OUT PAVERS TO PRODUCE A SHARP, VERTICAL CUT WITHOUT DAMAGED EDGES, AND TO FIT ACCURATELY.
- AFTER COMPLETION OF INSTALLATION, COMPACT PAVING BY MEANS OF A VIBRATING PLATE TAMPER.
- FILL THE JOINTS WITH FINE SAND, BY BRUSHING AND SWEEPING, HOSE PAVING WITH FINE WATER SPRAY.

## BRAMPTON STANDARD NOTES

- The Contractor must notify the Planning, Design & Development Department of the City of Brampton prior to commencement of any planting.
- The locations of all trees on street frontages must be approved by the Planning, Design & Development Department prior to their installation.
- The Owner is required, upon completion, of all landscape works to submit an Acceptance Certificate prepared by a Landscape Architect to the Planning, Design & Development Department and to request an inspection by the Department.
- All landscape works shall be guaranteed for one year following inspection. Plant material which is not in a healthy growing condition one year after inspection shall be replaced to the satisfaction of the City with an additional one year maintenance guarantee period. Supply and plant all replacements in strict accordance with plans and specifications.
- Sod that is damaged or missing on the public boulevard is to be repaired/installed at the Owner's expense.
- Any chain link fencing and components that are installed subsequent to Site Plan approval shall have a shop applied block glass enamel finish by powder coat application. Prior to application of finish, treat with Parker Bonderite and chlorothane solvent. Powder coat finish to be applied in a thickness of 4-5 mils by electrostatic coat and oven cured for smooth and even surface. Chain link fabric to be black vinyl coated.
- The Contractor is responsible for location of all underground services prior to excavation of tree pits and shrub beds.
- All T-bars to be removed at the conclusion of the warranty period.
- Any transformer installed subsequent to site plan approval shall be screened with plant material to the satisfaction of the City of Brampton.
- All signage is subject to the provisions of the sign by-law.

## LANDSCAPE STANDARD NOTES FOR SITE PLAN PROJECTS

THE OWNER OR CONTRACTOR SHALL REQUEST AN INSPECTION BY THE PLANNING, DESIGN & DEVELOPMENT DEPARTMENT UPON COMPLETION OF ALL LANDSCAPE WORKS.

ALL LANDSCAPE WORK SHALL BE GUARANTEED FOR ONE YEAR FOLLOWING INSPECTION. PLANT MATERIAL WHICH IS NOT IN A HEALTHY GROWING CONDITION ONE YEAR AFTER INSPECTION SHALL BE REPLACED, SUPPLY AND PLANT ALL REPLACEMENTS IN STRICT ACCORDANCE WITH PLANS AND SPECIFICATIONS.

THE CONTRACTOR IS RESPONSIBLE FOR LOCATION OF ALL UNDERGROUND SERVICES PRIOR TO EXCAVATING TREE PITS AND SHRUB BEDS AND GRADING.

THE OWNER IS REQUIRED TO FORWARD ON COMPLETION OF THE LANDSCAPE WORK, A COPY OF THE ACCEPTANCE CERTIFICATE PREPARED BY THE LANDSCAPE ARCHITECT TO THE PLANNING, DESIGN & DEVELOPMENT DEPARTMENT.

**NOTE:**  
ANY EXISTING PLANT MATERIAL THAT DIES DUE TO CONSTRUCTION SHALL BE REPLACED TO SATISFACTION OF THE CITY OF BRAMPTON.

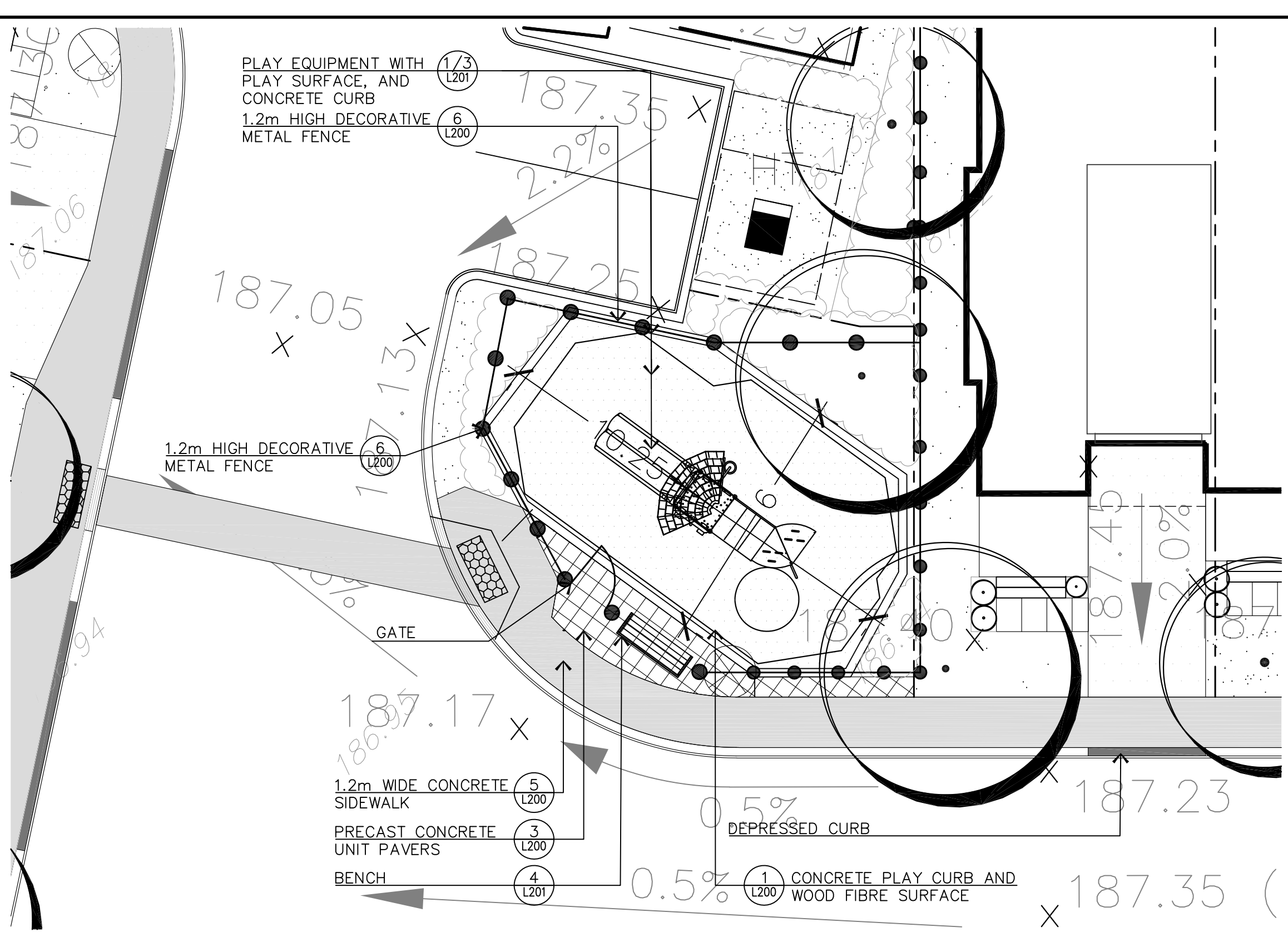

PARKETTE ENLARGEMENT

KEY	QTY.	BOTANICAL NAME	COMMON NAME	HEIGHT	SPREAD	CAL.	SPACING	COND.	REMARKS
<b>DECIDUOUS TREES + LARGE SHRUBS</b>									
AF	07	Acer freemontii 'Celebration'	Celebration Maple	4000	2000	70	as shown	SB	FULL FORM
AG	06	Acer ginnala 'Flame'	Flame Amure Maple (Tree Form)	4000	2000	70	as shown	SB	FULL FORM
AR	09	Acer rubrum 'Bowhall'	Bowhall Red Maple	4000	2000	70	as shown	SB	FULL FORM
GB	07	Ginkgo biloba	Ginkgo Biloba	4000	2000	70	as shown	SB	FULL FORM
QM	02	Quercus macrocarpa	Burr Oak	4000	2000	70	as shown	SB	FULL FORM
SR	12	Syringa reticulata	Japanese Tree Lilac	4000	2000	70	as shown	SB	FULL FORM
ZS	05	Zelkova serrata 'Miyashino'	Miyashino Zelkova	4000	2000	70	as shown	SB	FULL FORM
<b>DECIDUOUS SHRUBS</b>									
AC	14	Amelanchier canadensis	Serviceberry	1500	1000	-	as shown	CG	FULL FORM
AI	12	Amelanchier laevis 'Spring Flurry'	Spring Flurry Serviceberry	1500	1000	-	as shown	CG	FULL FORM
Eol	20	Eoumyrus alatus 'Little Mosses'	Little Mosses Burning-Bush	700	-	750	CG	FULL FORM	
Hp	70	Hydrangea paniculata 'Bobo'	Bobo Hardy Hydrangea	700	-	750	CG	FULL FORM	
PI	40	Potentilla fruticosa 'Pink Beauty'	Pink Beauty Potentilla	500	-	600	CG	FULL FORM	
Rr	6	Ribes alpinum	Alpine Currant	600	-	900	CG	FULL FORM	
Rr	62	Rosa rugosa	Rugosa Rose	600	-	750	CG	FULL FORM	
Sp	52	Spiraea prunifolia	Bridalweath Spirea	600	-	900	CG	FULL FORM	
Tmd	32	Tous x media 'Densiformis'	Dense Yew	-	600	-	750	CG	FULL FORM
<b>PERENNIALS AND GRASSES</b>									
cbs	57	Coreopsis L'I Bang 'Starstruck'	L'I Bang Coreopsis	1GAL	-	-	500	CG2	FULL FORM
had	114	Hemerocallis 'Stella D'Oro'	Stella D'Oro Daylily	1GAL	-	-	500	CG2	FULL FORM

SCALE 1:100

**GENERAL NOTES:**  
VERIFY ALL DIMENSIONS.  
DO NOT SCALE DRAWINGS.  
REPORT ANY DISCREPANCIES, DISCOVERED ERRORS, OR OMISSIONS TO THE LANDSCAPE ARCHITECT BEFORE PROCEEDING.  
IT IS ADVISED THAT CONTRACTORS CONTACT THE LANDSCAPE ARCHITECT PRIOR TO CONSTRUCTION TO ENSURE THE USE OF THE LATEST REVISED DRAWINGS.  
DRAWINGS AND SPECIFICATIONS ARE THE PROPERTY OF THE LANDSCAPE ARCHITECT.

## KEY MAP

### LEGEND

- PROPOSED DECIDUOUS TREE
- PROPOSED LARGE SHRUBS
- PROPOSED SHRUB
- PROPOSED SHRUB GROUPING
- SODDING
- PRECAST CONCRETE PATIO SLABS
- DECORATIVE UNIT PAVING
- PATIO SLAB AND WOOD PRIVACY SCREEN
- WOOD PRIVACY FENCE
- EXISTING WOOD PRIVACY FENCE
- EXISTING ACUSTIC FENCE
- DECORATIVE METAL FENCE
- GATE
- EXISTING CHAIN LINK FENCE
- TRANSFORMER
- STREETLIGHT
- FIRE HYDRANT AND VALVE

## LIST OF DRAWINGS

NO.	DATE	REVISION	BY
1	2019-04-15	FINAL SUBMISSION	B.B.
2	2019-03-11	ISSUED FOR SPA SUBMISSION	B.B.
3	2018-10-24	ISSUED FOR SPA SUBMISSION	B.B.
4	2018-08-21	REVISION PER CITY COMMENTS	B.B.

4.	2019-04-15	FINAL SUBMISSION	B.B.
3.	2019-03-11	ISSUED FOR SPA SUBMISSION	B.B.
2.	2018-10-24	ISSUED FOR SPA SUBMISSION	B.B.
1.	2018-08-21	REVISION PER CITY COMMENTS	B.B.
No.	DATE	REVISION	BY

It is the responsibility of the Contractor and/or Owner to ensure that the drawings with the latest revisions are used for construction.

## APPROVED

Planning and Development Services Department

Manager, Development Services

Date

DATE

DATE

DATE

DATE

DATE

DATE

DATE

DATE

DATE

DATE

DATE

DATE

DATE

DATE

DATE

DATE

DATE

DATE

DATE

DATE

DATE

DATE

DATE

DATE

DATE

DATE

DATE

DATE

DATE

DATE

DATE

DATE

DATE

DATE

DATE

DATE

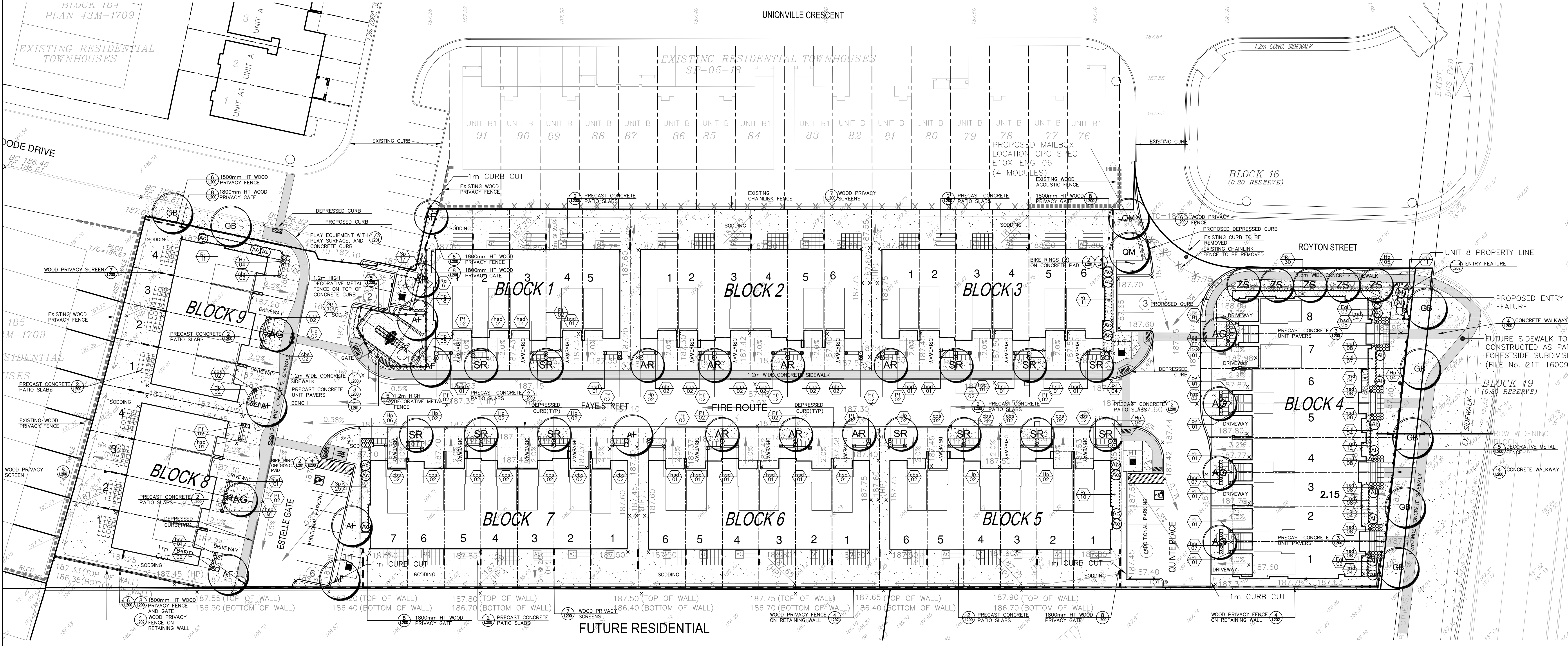

**SBK**  
STRYBOS BARRON KING  
LANDSCAPE ARCHITECTURE

5770 HURONTARIO STREET, SUITE 320  
MISSISSAUGA, ONTARIO, L5R 3G5  
T: 416.895.4949 F: 905.712.3101  
WWW.STRYBOS.COM

PROJECT: TOWNHOUSE DEVELOPMENT

S/W OF ROYTON STREET & THE GORE ROAD  
BRAMPTON, ONTARIO  
SPI8-081.000

FORETSIDE ESTATES INC.

DRAWING TITLE: LANDSCAPE PLAN

SCALE: 1 : 250 PROJECT No. 17-5017

DATE: APRIL 24, 2017

DRAWN BY: S.M. DRAWING No. L100

CHECKED BY: B.B.



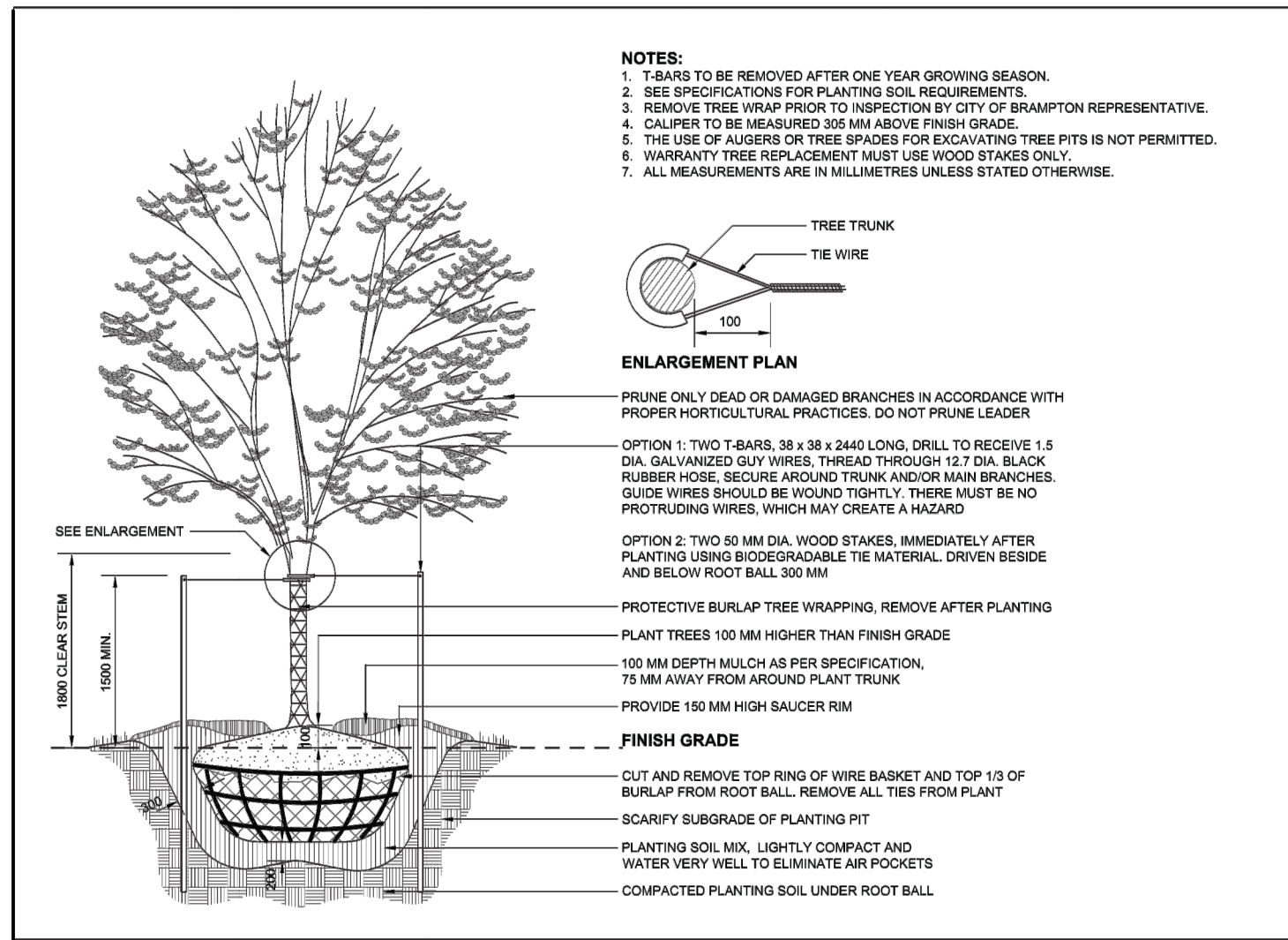

**L910**  
N.T.S.  
SEPTEMBER 2014  
PLANTING - SERIES 900  
**BRAMPTON**  
Flower City  
Landscape Architecture

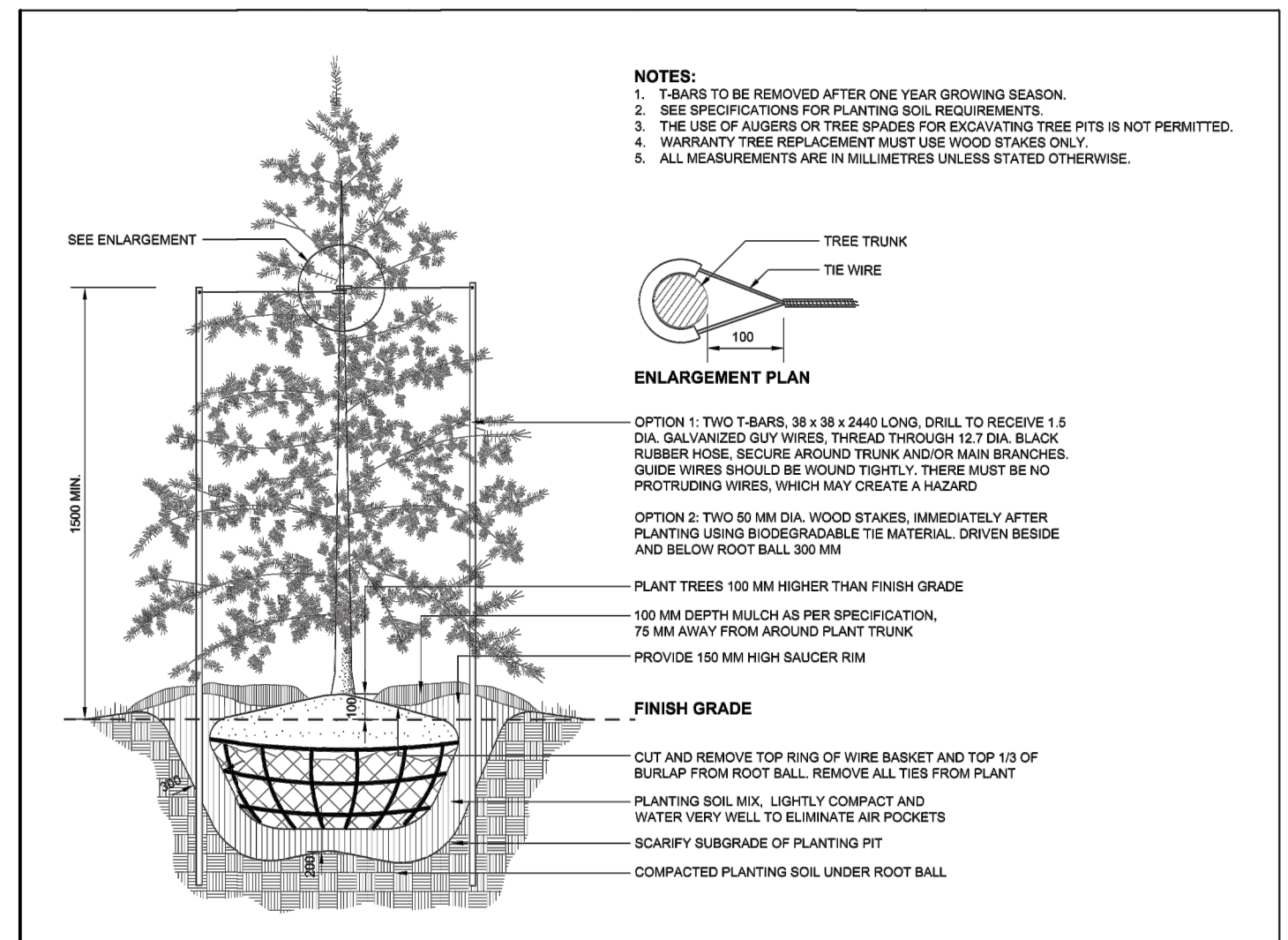

**L911**  
N.T.S.  
SEPTEMBER 2014  
PLANTING - SERIES 900  
**BRAMPTON**  
Flower City  
Landscape Architecture

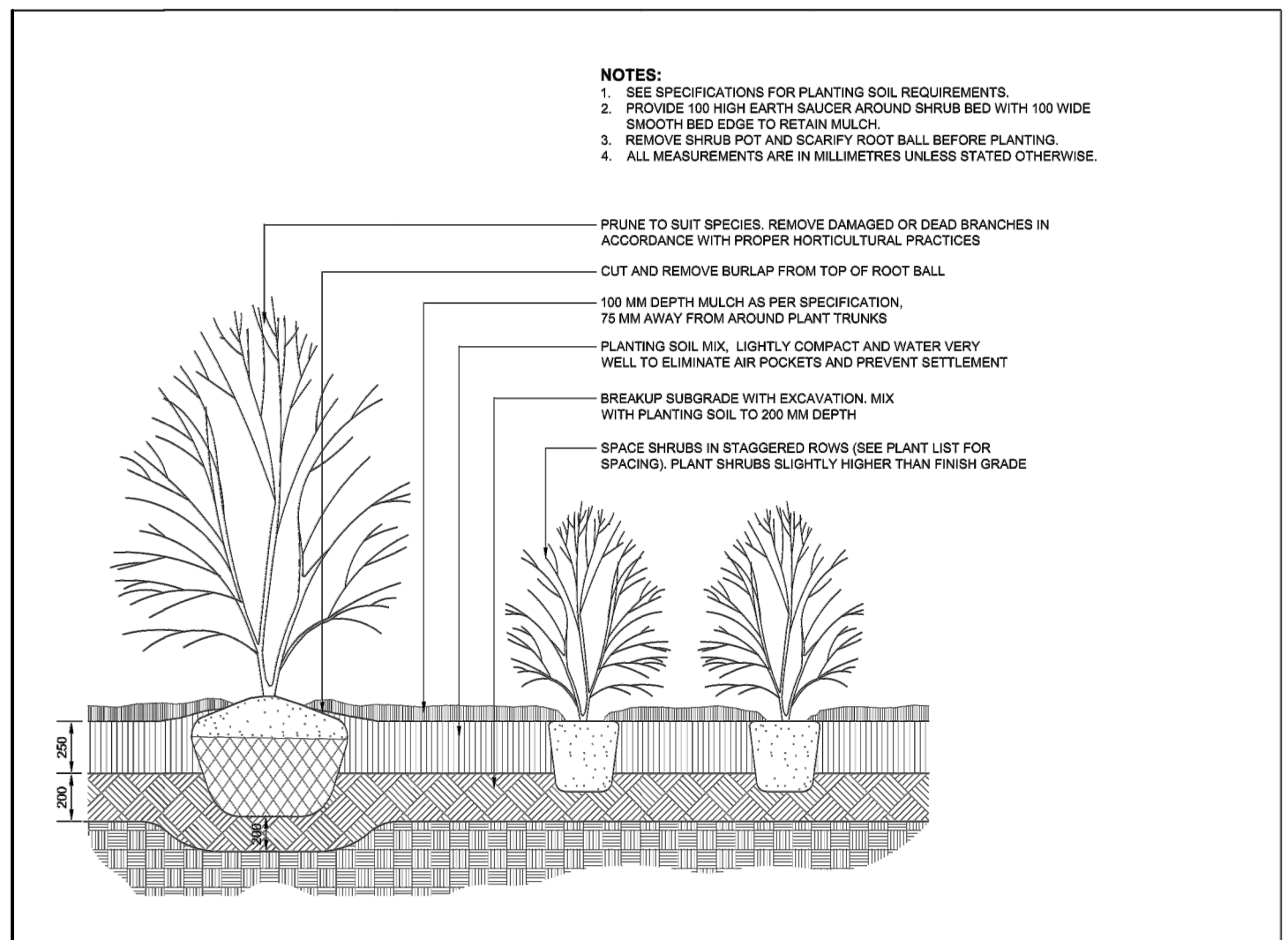

**L912**  
N.T.S.  
SEPTEMBER 2014  
PLANTING - SERIES 900  
**BRAMPTON**  
Flower City  
Landscape Architecture

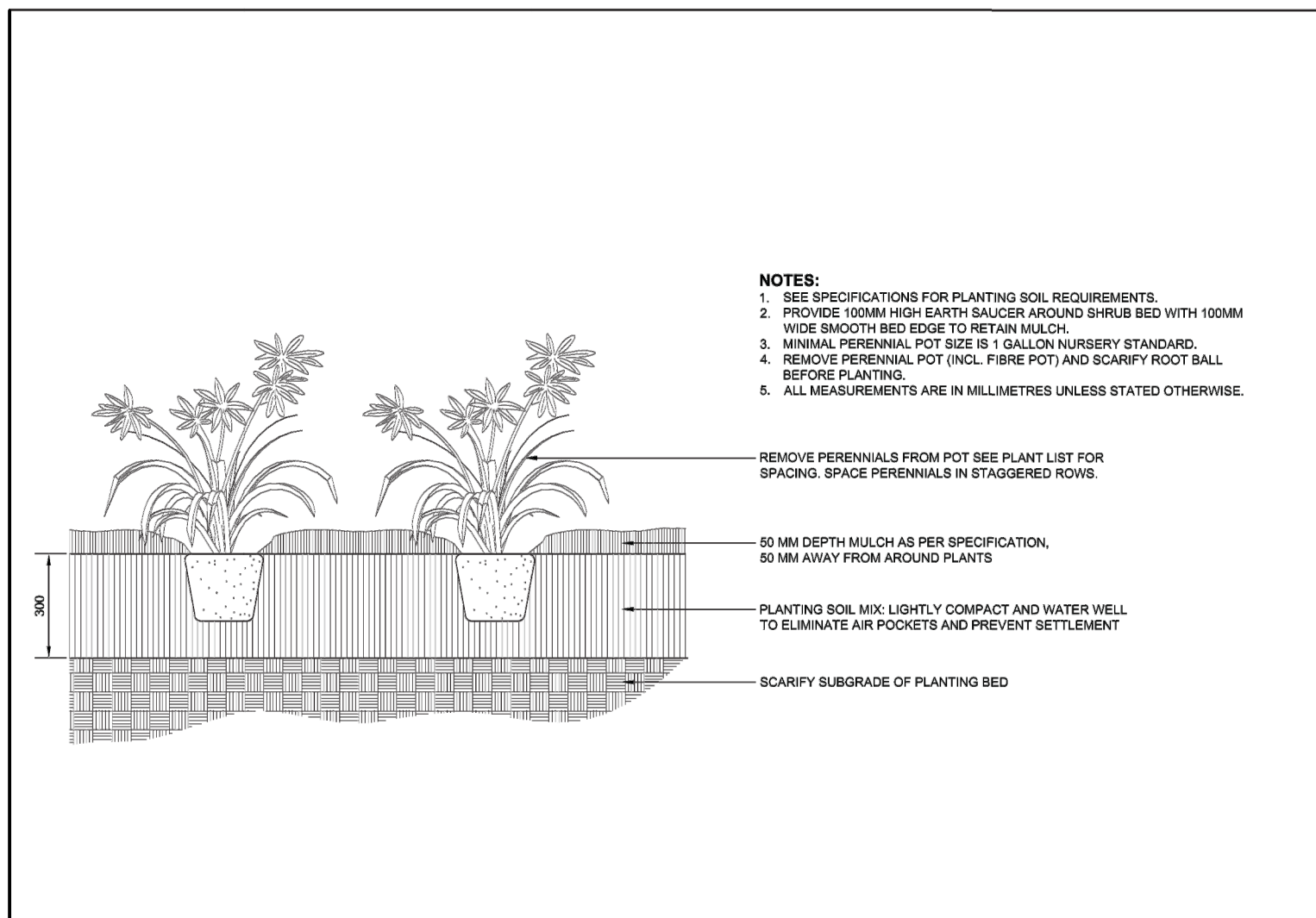

**L914**  
N.T.S.  
SEPTEMBER 2014  
PLANTING - SERIES 900  
**BRAMPTON**  
Flower City  
Landscape Architecture

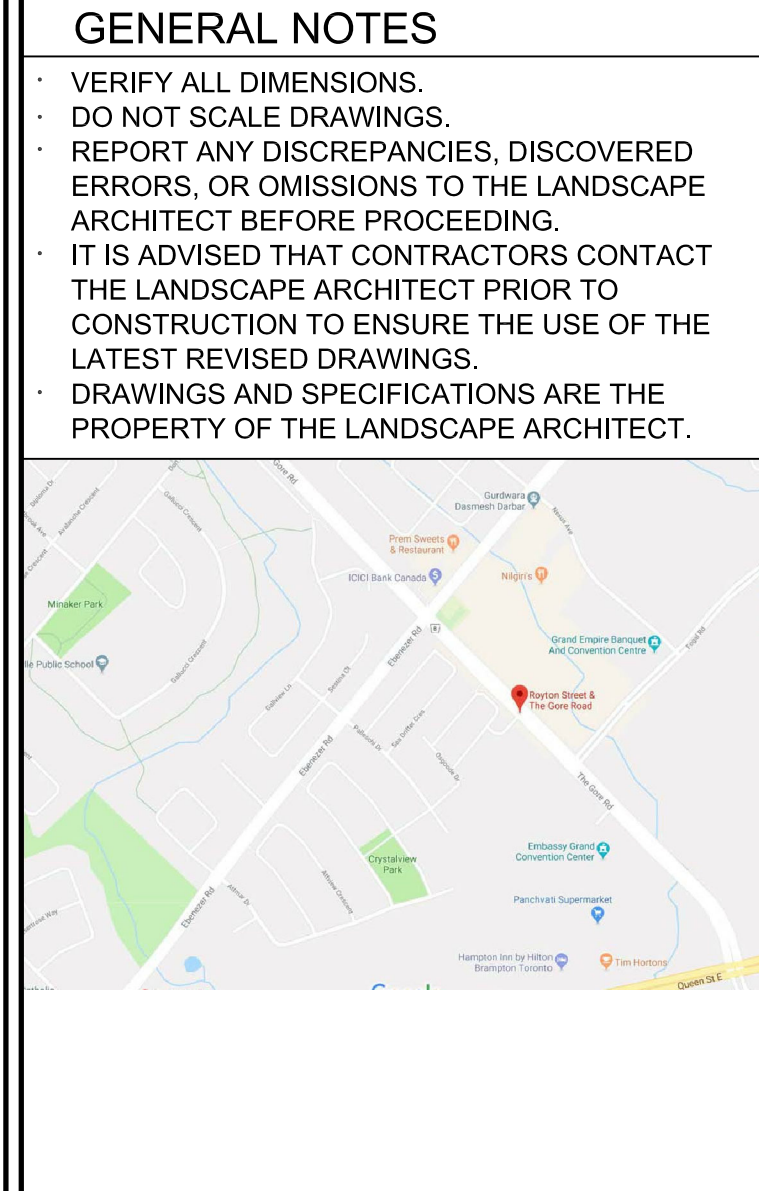

## 1 LANDSCAPE PLANTING DETAILS

1/200

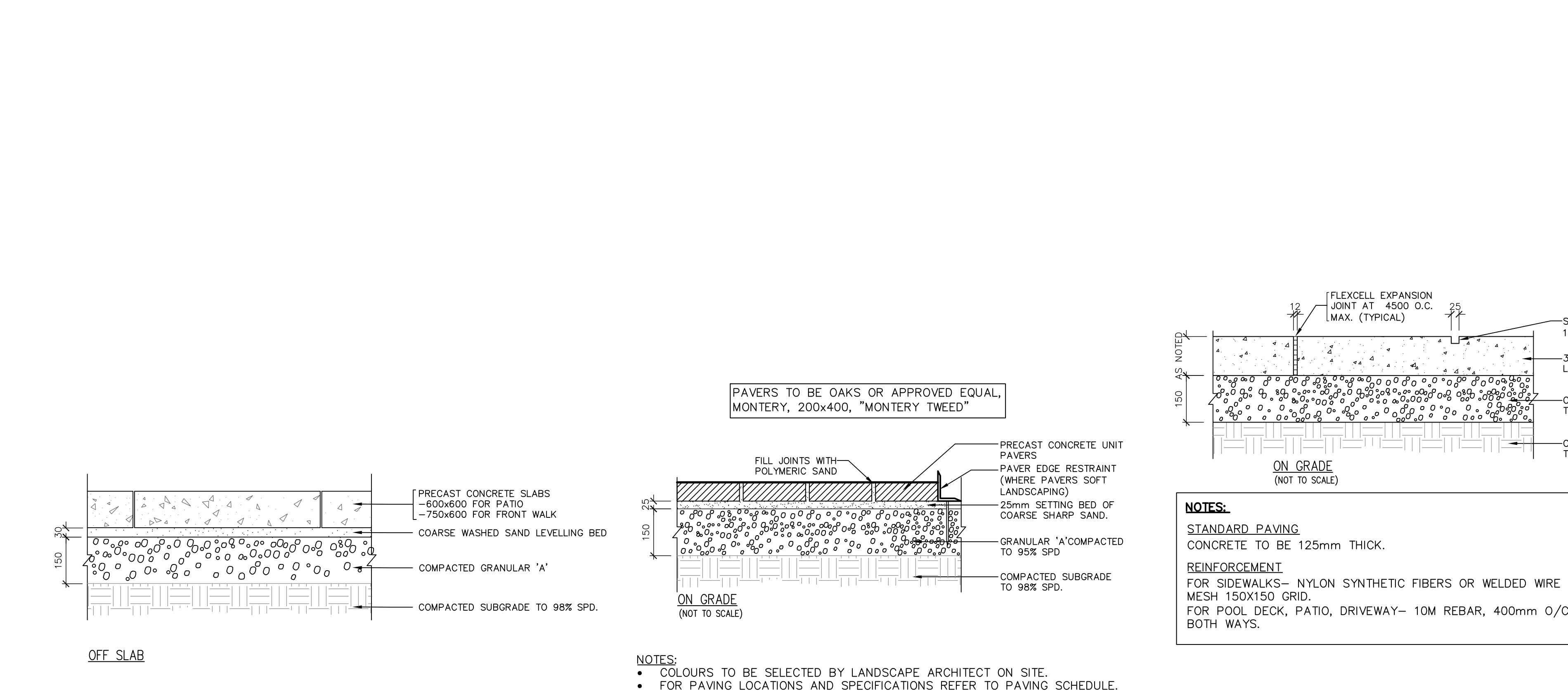

## 2 PRECAST CONCRETE PATIO SLABS

2/200

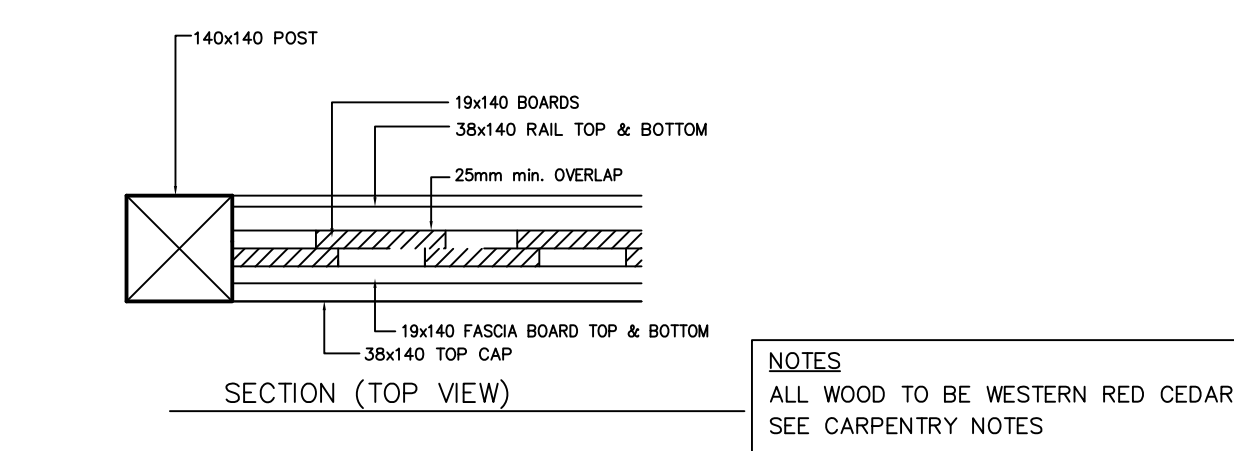

## 3 PRECAST CONCRETE UNIT PAVERS

3/200

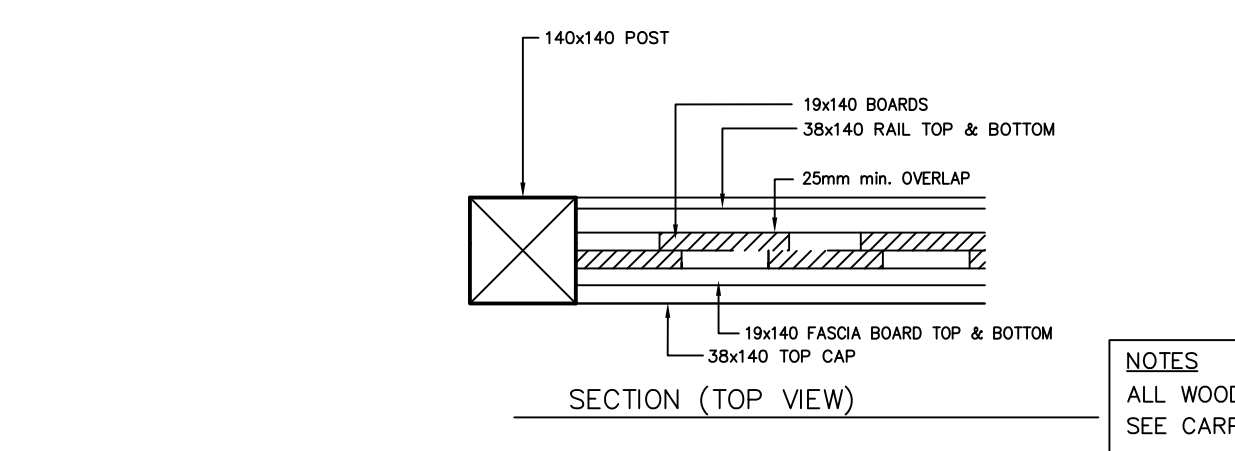

## 4 CONCRETE PAVING

4/200



## 5 1200mm HT DECORATIVE METAL FENCE

5/200

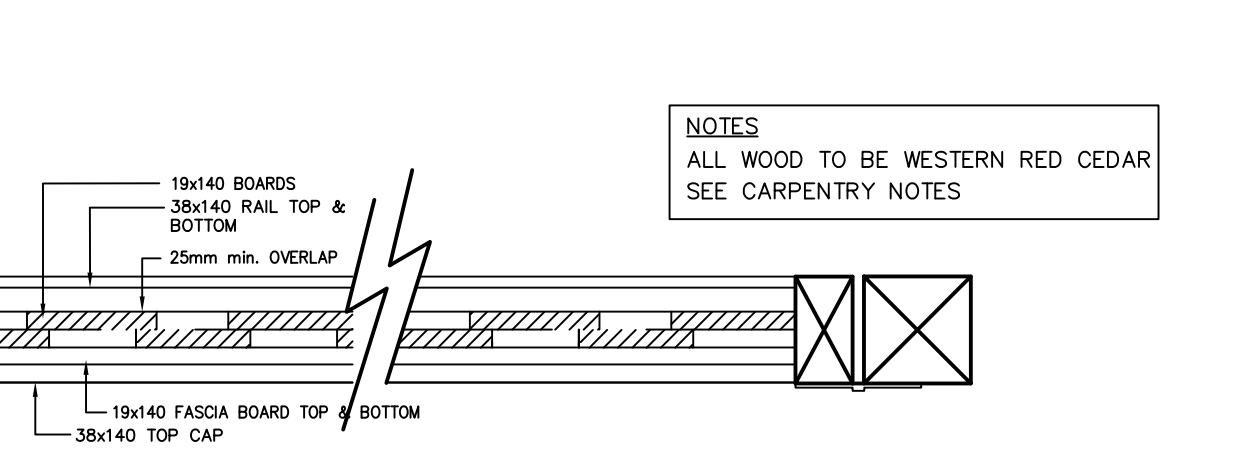

## 6 1800mm HT. WOOD PRIVACY FENCE

6/200



## 7 1800mm HT. WOOD PRIVACY SCREEN

7/200



## 8 1800mm HT. WOOD PRIVACY GATE

8/200



It is the responsibility of the Contractor and/or Owner to ensure that the drawings with the latest revisions are used for construction.

**APPROVED**  
Planning and Development Services Department

Manager, Development Services

Date

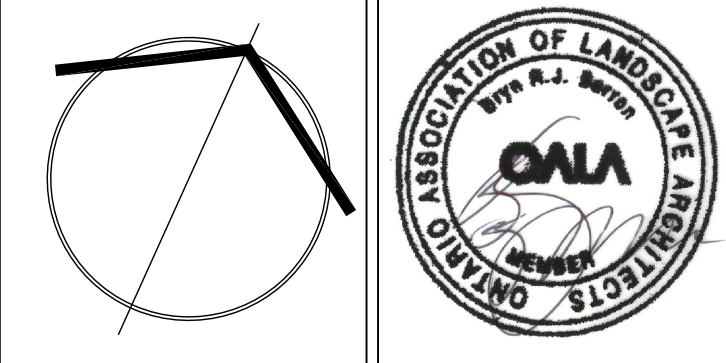

**SBK** 5770 HURONTARIO STREET, SUITE 320  
MISSISSAUGA, ONTARIO, L5R 3G5  
T: 416.695.4949 F: 905.712.3101  
WWW.STRYBOS.COM

**STRYBOS BARRON KING**  
LANDSCAPE ARCHITECTURE

PROJECT:  
**TOWNHOUSE DEVELOPMENT**  
S/W OF ROYTON STREET & THE GORE ROAD  
BRAMPTON, ONTARIO  
SP18-081.000

**FORETSIDE ESTATES INC.**

DRAWING TITLE:  
**LANDSCAPE DETAILS**

SCALE: 1 : 250  
DATE: APRIL 24, 2017  
DRAWN BY: S.M.  
CHECKED BY: B.B.

PROJECT No.  
**17-5017**  
DRAWING No.  
**L200**



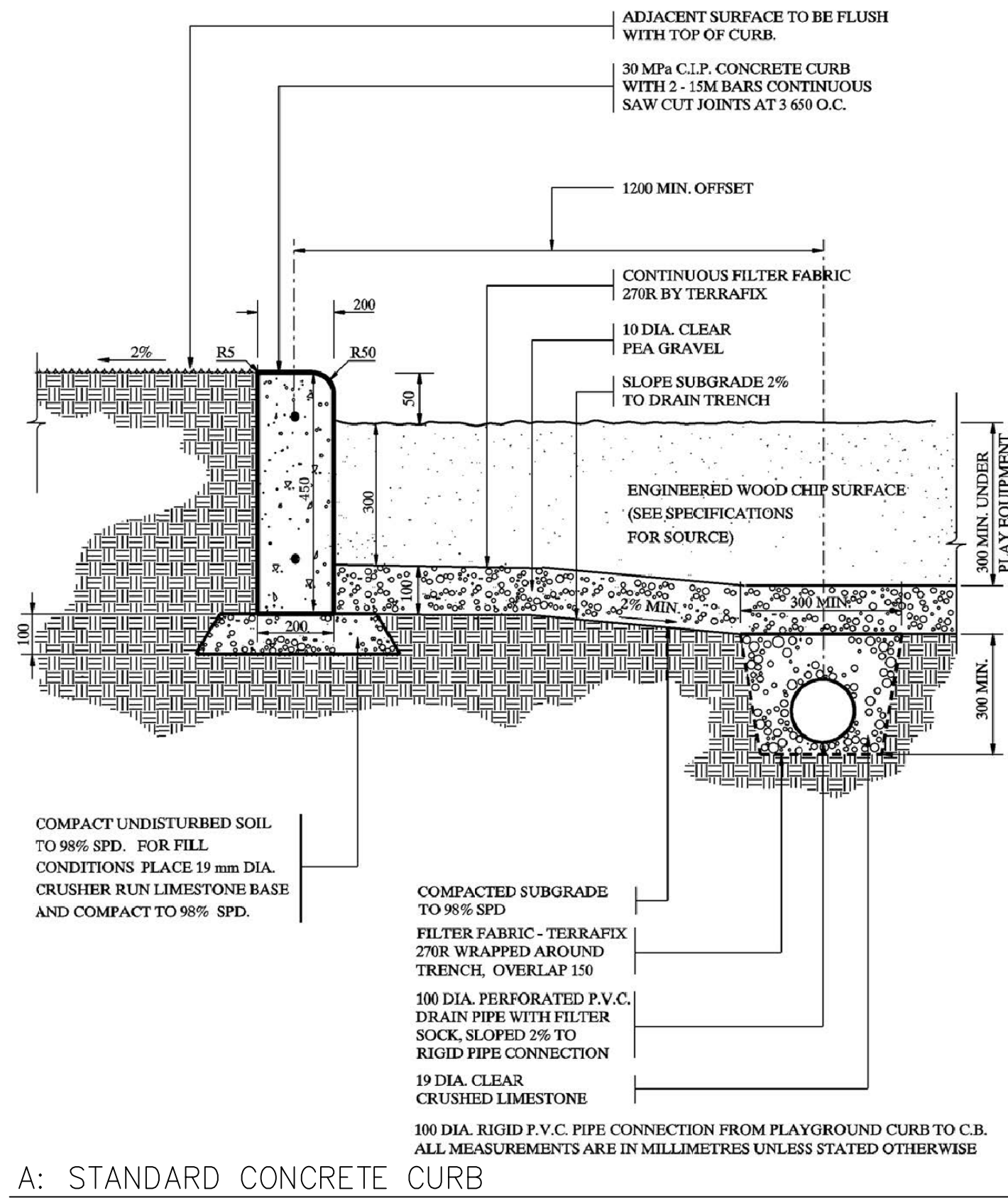

1 L201 PLAYGROUND CURB & WOOD FIBRE SURFACE

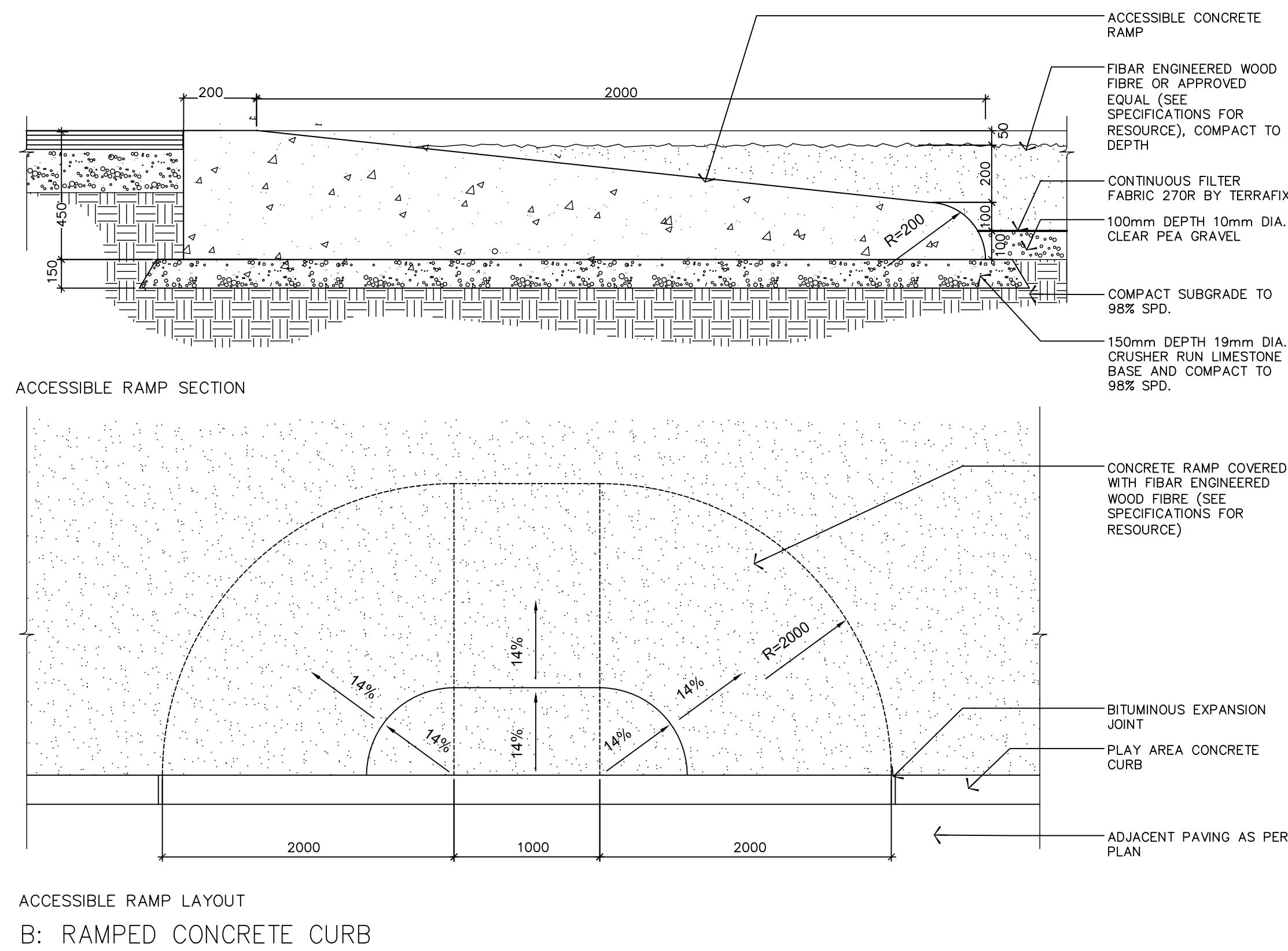

2 L201 RAMPED CONCRETE CURB

CLEAR WOOD FIBRE TO BE FIBAR 3000 SYSTEM AS SUPPLIED BY WOODCARPET RECREATIONAL SURFACING OR APPROVED EQUAL.

WOOD FIBRE TO BE RECENTLY HARVESTED NORTH AMERICAN HARDWOODS FREE OF BARK, SOIL, LEAVES, TWIGS AND OTHER CONTAMINANTS WITH NO CHEMICAL TREATMENTS OR ADDITIVES. NO WOOD FROM PALLETS OR WASTE OR RECYCLED WOOD IS ALLOWED.

FILTER CLOTH TO BE TERRAFIX 270R AS SUPPLIED BY TERRAFIX GEOSYNTHETICS INC. 425 ATTWELL DR. REXDALE, ONTARIO M9W 5C4 416-674-0363

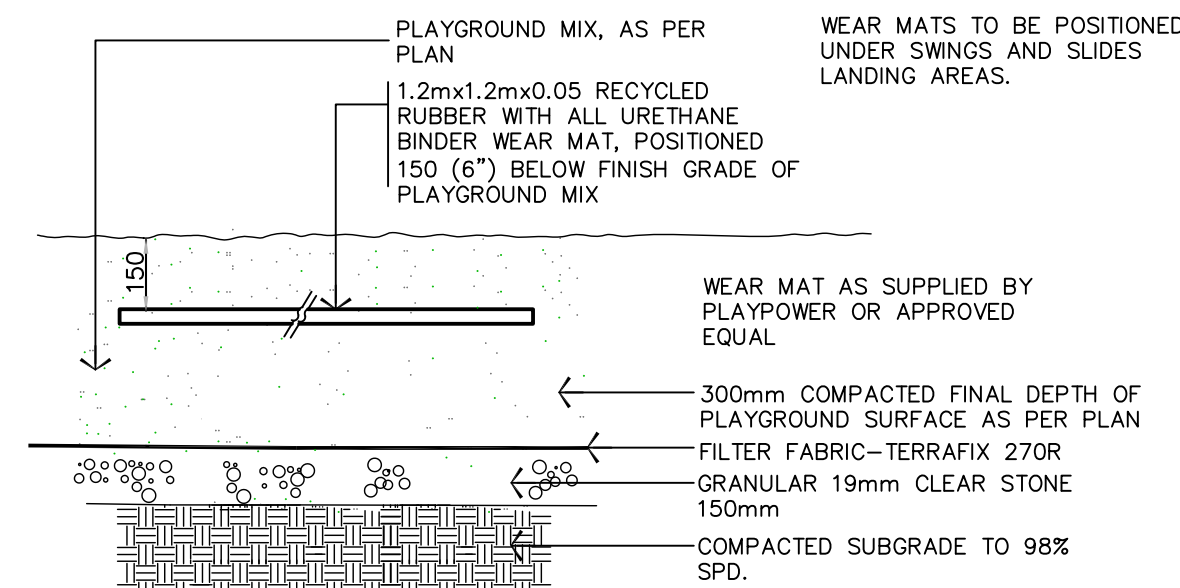

3 L201 RUBBER WEAR MAT

## Halo Stainless Steel Bicycle Rack

PS-79-SS-101-BD - Halo Stainless Steel Bike Rack

Our Halo Stainless Steel Bicycle Rack features a 316 stainless tubular steel construction, and is available in Surface or In-Ground mounting options. Stainless steel anchor bolts provided.

Width: 35.5" (90.2 cm)  
Depth: 2.25" (5.7 cm)  
Height: 32" (81.3 cm)



**HAUSER**  
SITE FURNITURE

sales@hausersite.com  
800-268-7328  
hausersite.com

4 L201 BIKE RING

**General Notes:**

Age Group  
18 m-5 yrs 5-12 years 12 yrs-12 yrs

1. No-encroachment zone - that additional area adjacent to the protective surfacing zone intended to allow pedestrian traffic over the play equipment to use while maintaining the risk of trips to pedestrians. CSA-2614
2. Although a particular playground design may not meet the proposed Access Board Regulations in regard to the appropriate number of ground level events, the actual playground may be in compliance when considering existing play components.
3. All steel heights are measured from top of ground cover.
4. All steel heights are measured from top of ground cover.
5. The minimum recommended fall zone around the entire playground is shown. This zone is to be free of all tripping or collision hazards (i.e. rocks, roots, border material, etc.).
6. All steel heights are identified by feet showing the post height. (i.e. 96 represents a 96 inch post).
7. Not all equipment may be appropriate for all children. Supervision is required.

**8mo-12yrs** LIST OF ANNEX H COMPONENTS

48" DOUBLE WIDE PLASTIC SLIDE  
SEVEN STATION PLAY FACTORY  
SEVEN STATION

**8mo-12yrs** ANNEX H REQUIREMENTS FOR NUMBER OF PLAY COMPONENTS SHOWN TO NUMBER REQUIRED

COMPONENT	REQUIRED	PROVIDED
TOTAL ELEVATED PLAY COMPONENTS	3	3
TOTAL ELEVATED COMPONENTS ACCESSIBLE BY RAMP	1	1
TOTAL ACCESSIBLE COMPONENTS ACCESSIBLE BY RAMP	1	1
TOTAL DIFFERENT TYPES OF GROUND LEVEL COMPONENTS	1	1

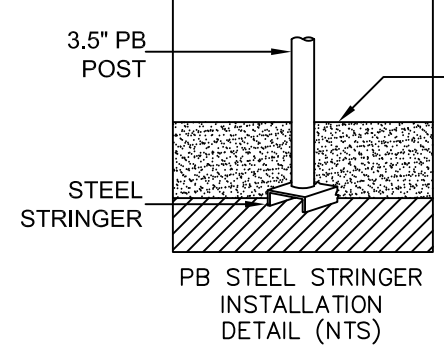
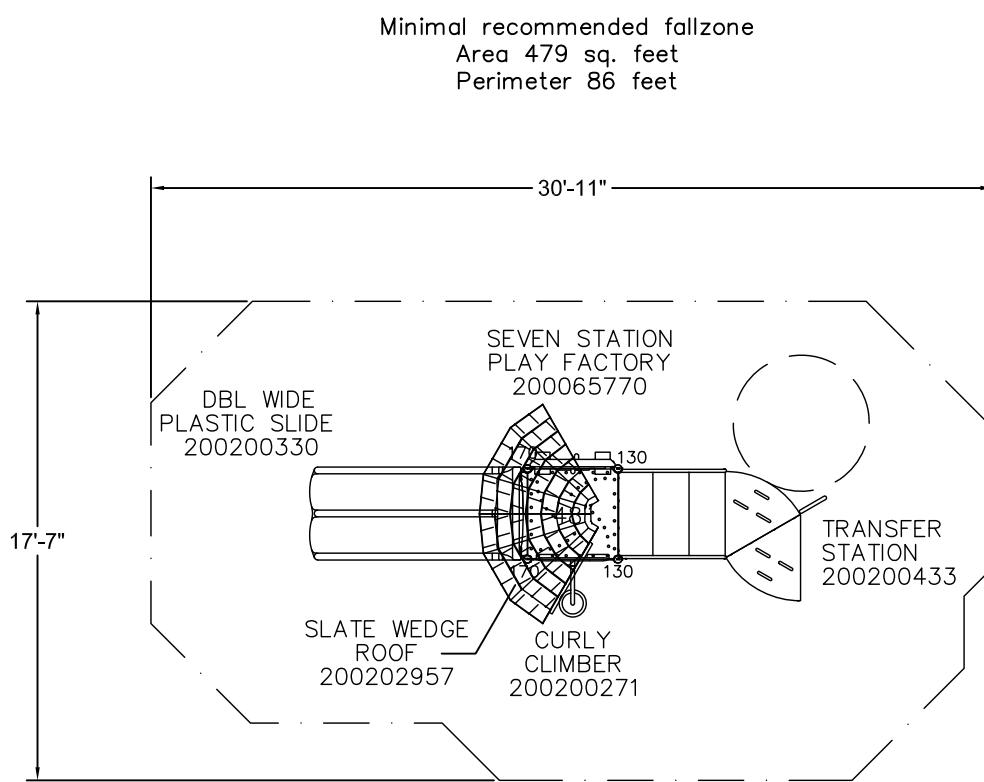

Playground Layout Compliance:

CSA Z-614 Children's Playspaces and Equipment



The play components identified in this plan are PEPA certified. The use and layout of these components conform to the requirements of CAN/CSA 2614.

PROTECTIVE SURFACING ZONE  
NO-ENCROACHMENT ZONE

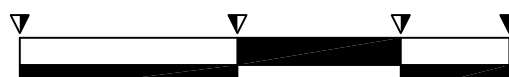
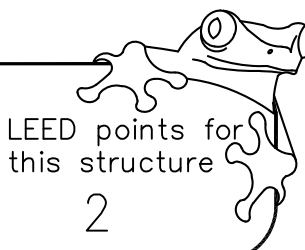

5 L201 PLAYGROUND EQUIPMENT

**PlayPower**  
Serving Canada Since 1947 Canada

Project: 6BK Tot Lot

LTCPS rep:  
Steve Howes  
LTCPS Canada  
800-265-9953

Kid Builders:  
Post Material: galvanized  
Post Color: Red  
Accent Color: Blue  
Panel Color: Tan  
Slide Color: Tan  
Roof Color: Blue  
Hex Wedge: None  
Hex Rib: None  
Mounting: Stringers

Drawn by: Michael Foreback  
Date: 9/27/2016  
DWG Name: QU068138  
Scale: 1/8"=1'

Approved by:  
PlayPower Canada  
P.O. Box 125  
Paris, Ontario Canada N3T 3E7  
Voice: 1-800-265-9953  
Fax: 519-442-8200



NOTE: ALL SITE FURNITURE TO BE SECURELY FASTENED TO CONCRETE FOOTINGS. NOT TO BE SECURED TO UNIT PAVING.

MODEL: MLB300W

MATERIALS: BENCH ENDS SOLID CAST ALUMINUM, IPE WOOD SLAT SEAT.

FINISH: E-COAT RUST PROOFING AND MAGLIN POWDERCOAT. WOOD SLATS FINISHED WITH PENETRATING SEALERS.

INSTALLATION: SURFACE MOUNT

COLOR: BENCH ENDS TO BE "GRAPHITE"

AS SUPPLIED BY:  
MAGLIN SITE FURNITURE INC.  
275 TECUMSEH STREET  
WOODSTOCK, ON  
N4S 7W1  
P: 1-800-716-5506  
www.maglin.com

OR APPROVED EQUAL

6 L201 BENCH

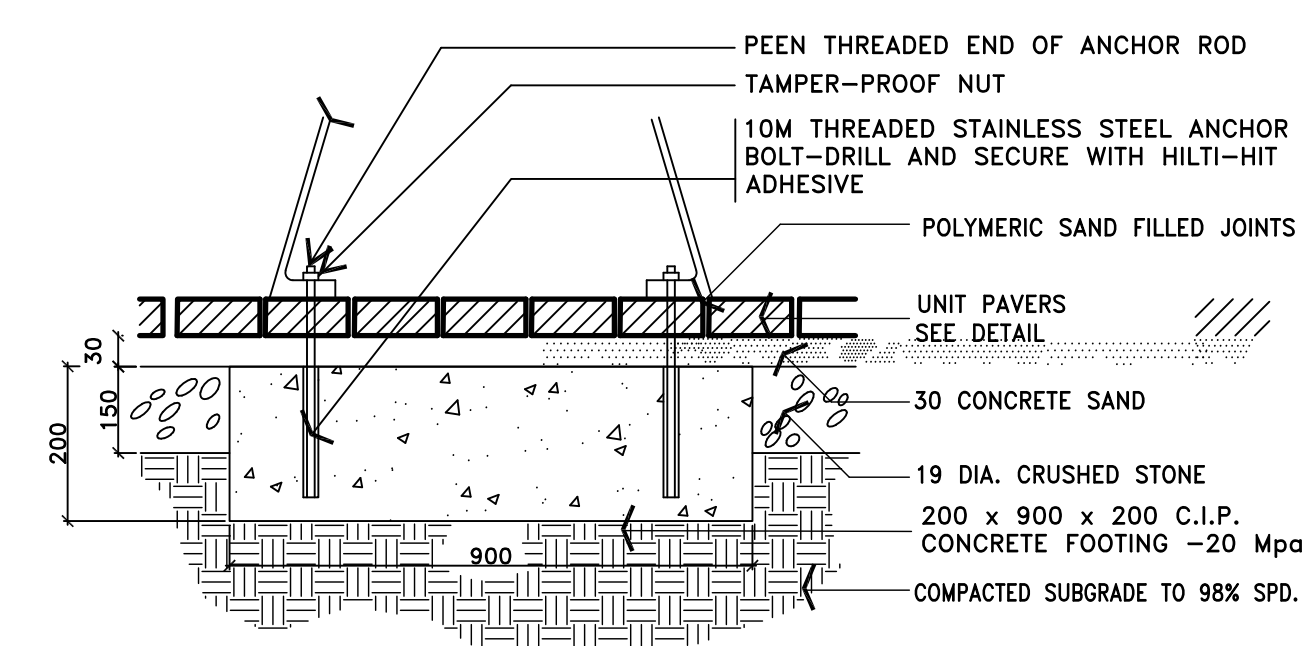
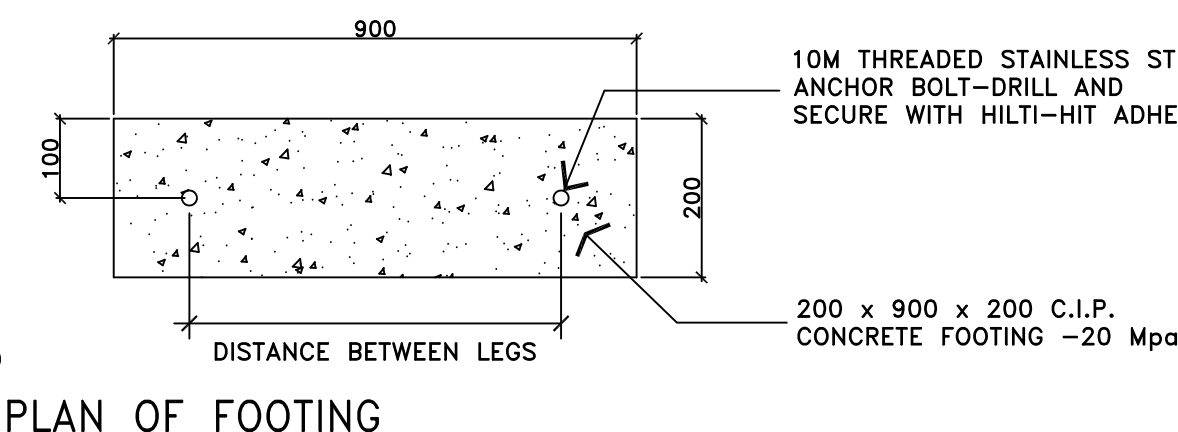

7 L201 SECTION A: MOUNTING DETAIL FOR SITE FURNITURE IN UNIT PAVERS

**GENERAL NOTES**

- VERIFY ALL DIMENSIONS.
- DO NOT SCALE DRAWINGS.
- REPORT ANY DISCREPANCIES, DISCOVERED ERRORS, OR OMISSIONS TO THE LANDSCAPE ARCHITECT BEFORE PROCEEDING.
- IT IS ADVISED THAT CONTRACTORS CONTACT THE LANDSCAPE ARCHITECT PRIOR TO CONSTRUCTION TO ENSURE THE USE OF THE LATEST REVISED DRAWINGS.
- DRAWINGS AND SPECIFICATIONS ARE THE PROPERTY OF THE LANDSCAPE ARCHITECT.

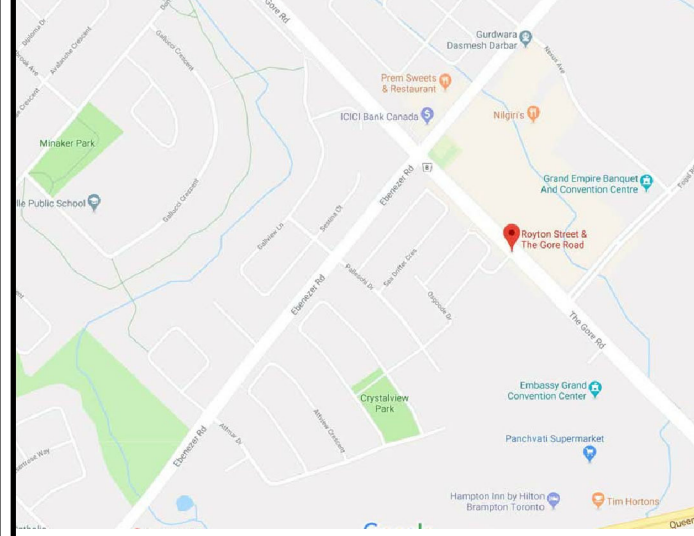

## LIST OF DRAWINGS

L100	LANDSCAPE PLAN
L200	LANDSCAPE DETAILS
L201	LANDSCAPE PLAY AREA DETAILS
L202	LANDSCAPE ENTRY FEATURE DETAILS

No.	DATE	REVISION	BY
1.	2018-08-21	REVISED PER CITY COMMENTS.	B.B.
2.	2018-10-24	ISSUED FOR SPA SUBMISSION	B.B.
3.	2019-03-11	ISSUED FOR SPA SUBMISSION	B.B.
4.	2019-04-15	FINAL SUBMISSION	B.B.

It is the responsibility of the Contractor and/or Owner to ensure that the drawings with the latest revisions are used for construction.

**APPROVED**  
Planning and Development Services Department

Manager, Development Services

Date

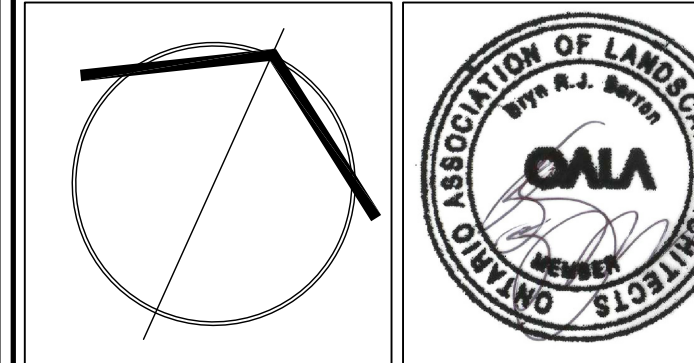

**SBK** 5770 HURONTARIO STREET, SUITE 320  
MISSISSAUGA, ONTARIO, L5R 3G5  
T: 416.695.4949 F: 905.712.3101  
WWW.STRYBOS.COM

STRYBOS BARRON KING LANDSCAPE ARCHITECTURE

PROJECT: TOWNHOUSE DEVELOPMENT

S/W OF ROYTON STREET & THE GORE ROAD  
BRAMPTON, ONTARIO  
SP18-081.000

FORESTSIDE ESTATES INC.

DRAWING TITLE:

LANDSCAPE DETAILS

SCALE:	PROJECT No.
DATE: APRIL 24, 2017	17-5017
DRAWN BY: S.M.	DRAWING No.
CHECKED BY: B.B.	L201



