

---

## SITE INSTRUCTION #3

Project Name: Hampton Manor (25 Baker Hill Boulevard) - Stouffville

Project Number: 20140490

Vince Staffieri

July 26, 2017

Royal Pine Homes

3550 Langstaff Road, Suite 200

Woodbridge, Ontario L4L 9G3

via email: vince@royalpinehomes.com

Distribution: Owner [ ]; Contractor [ ]; Consultant A [ ]; M [ ]; E [ ]; L [ ]; Other

---

1. Site instructions are issued only for the purpose of recording any clarification or interpretation of the contract documents or giving direction on problems resulting from field conditions.
  2. These instructions are subject to the provisions of the contract documents and unless stated herein and specifically co-authorized by the Client, will not affect the contract.
  3. Should the Contractor require a change in the contract price or project schedule, he shall submit an itemized proposal to the Architect within 14 calendar days of the date hereof.
  4. If the proposal is accepted by the Client, this site instruction will be superseded by a Change Order.
- 

### A. REFERENCE:

- .1 Drawing S1-01 (not included).

### B. INSTRUCTION:

- .1 Footings for columns and walls may be constructed on top of 10 MPa concrete fill, as shown on the attached Sketches SK-SI-03.01 and SK-SI-03.02.

### C. REASON:

- .1 Client's request.

Yours very truly,  
STEPHENSON ENGINEERING LIMITED

per Mauricio Nieto

Mauricio Nieto, MASC., P.Eng.  
Senior Engineer, Project Manager  
mnieto@stephenson-eng.com

per Sandra Cullen

Sandra Cullen, P.Eng.  
Principal  
scullen@stephenson-eng.com

Distribution cc:

Lenny Simonelli	rexcon.construxion@gmail.com
Gino Colangelo	gcolangelo@gc-architects.com
Carmen Taranu	CTaranu@gc-architects.com
Shari Grant	SGrant@gc-architects.com
Hrvoje Vukic	hvukic@stephenson-eng.com

Project: HAMPTON MANOR (20140490)	Date: JULY 26-2017
Part:	Sheet #: SK-SI-03.01
Notes:	By: MN

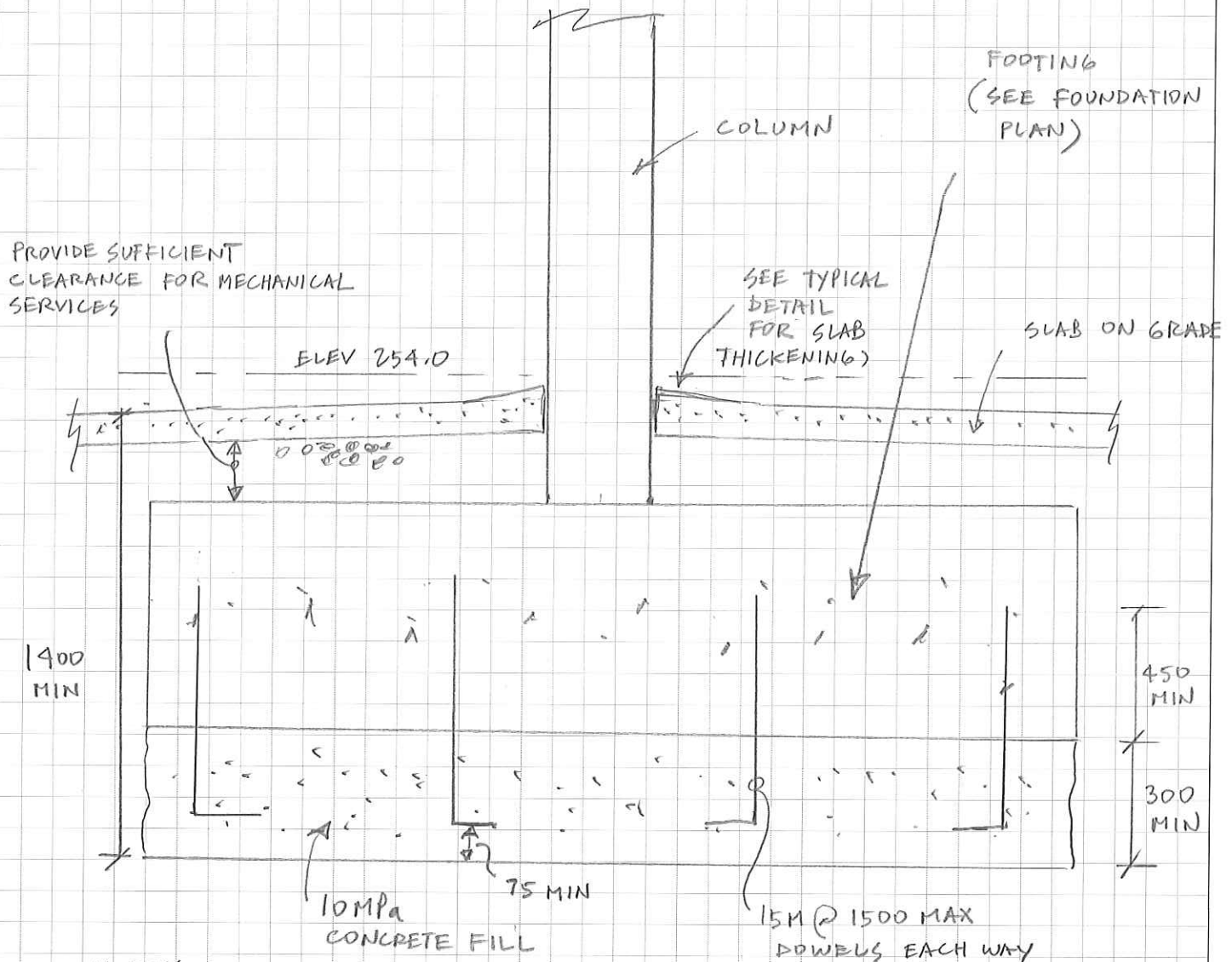

NOTES:

1. GEOTECHNICAL CONSULTANT TO VERIFY THAT SOIL BELOW 10MPa CONCRETE FILL HAS ADEQUATE BEARING CAPACITY.
2. LOCATE UNDERSIDE OF CONCRETE FILL AT SAME ELEVATION AS UNDERSIDE OF FOOTING ELEVATIONS PER FOUNDATION PLAN.

TYPICAL ALTERNATE DETAIL FOR INTERIOR FOOTING

Project: HAMPTON MANDR (2014 D490)	Date: JULY 26 - 2017
Part:	Sheet #: SK-SI-03,02
Notes:	By: MN

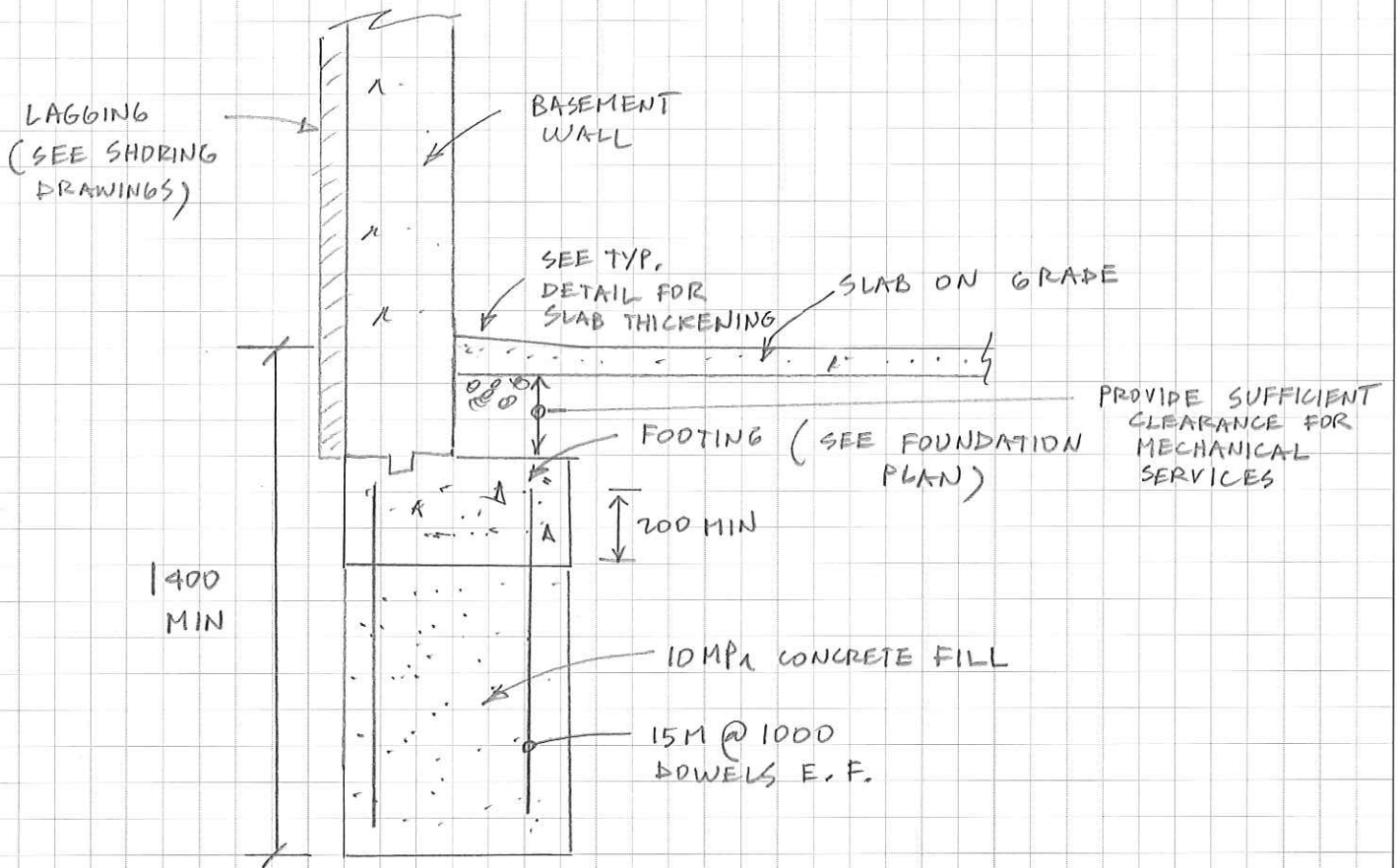

NOTES:

REFER TO SKETCH SK-SI-03.01

TYPICAL ALTERNATE DETAIL FOR  
EXTERIOR WALL FOOTING