

WPI-5001

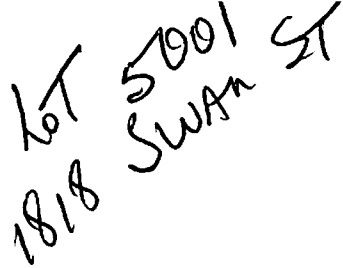

Please list below any damaged, incomplete, or missing items and anything that is not in good operating condition. Also note any "substitutions" of items referred to in, or to be selected under, the Agreement of Purchase and Sale (APS). Please initial all changes and deletions. As a minimum check the following:

Comments DOUBLAS TRIMBLE. (unmarked)

**ONHW-PDIF-01.01**

SEP. 10 / 2008

lot # 5001

1600332

1818 Swan ST