

SCHEDULE "C"

CONDOMINIUMS

UNIT #: 6

MODEL: Maple

BUILDING #: 2

PURCHASER: Charman

PAINT & CLEAN: No

OCCUPANCY DATE: _____

CLOSE DATE: April 29th, 2010

FEATURES INCLUDED AT NO EXTRA COST:

Yes 2X6 EXTERIOR CONSTRUCTION

Yes FORCED AIR GAS FURNACE (HIGH EFFICIENCY)

Yes 800 SERIES DOORS WITH BRASS HARDWARE

Yes 40 OZ. CARPET WITH 1/2" CHIPFOAM UNDERPAD

No FULL CLAY BRICK

No OAK SPINDLES AND HAND RAILS (NATURAL COLOUR)

Yes 2 TELEPHONE JACKS & 2 CABLE TV JACKS

EXTRAS INCLUDED IN PURCHASE PRICE:

ceramic flooring: foyer, baths, kitchen

Incentive option off price

Lot premium

11
26

THE Maple 1,104 sq. ft.

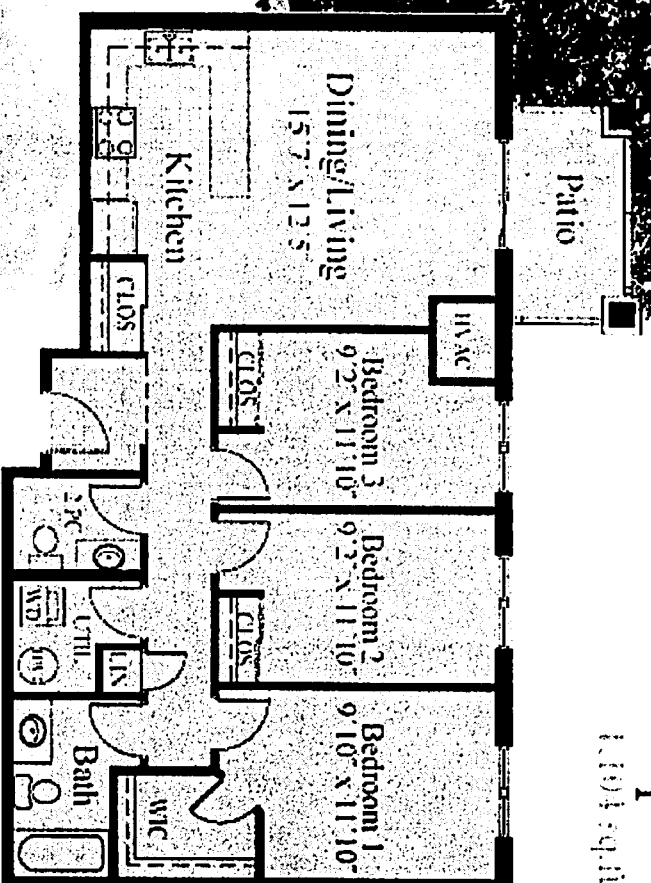

One closet on each floor



Seaside Vista's #0
Bldg #2, Unit #6.
Greta Cherman.