

SCHEDULE "C"

Sun-1016

CONDOMINIUMS

UNIT #: 16

MODEL: Maple

BUILDING #: 1

PURCHASER: Liddiard

PAINT & CLEAN: No

OCCUPANCY DATE: _____

CLOSE DATE: April 20th, 2010

FEATURES INCLUDED AT NO EXTRA COST:

Yes 2X6 EXTERIOR CONSTRUCTION

Yes H VAC HEATING AND COOLING SYSTEM

Yes 800 SERIES DOORS WITH NICKEL HARDWARE

Yes 40 OZ. CARPET WITH 1/2" CHIPFOAM UNDERPAD

Yes CLAY BRICK WITH STUCCO FAÇADE

Yes 2 TELEPHONE JACKS & 2 CABLE TV JACKS

EXTRAS INCLUDED IN PURCHASE PRICE:

5 appliance pkg

fff

23 D2

Schedule "A"

-1016 Sunn
39-16 Coulter St.

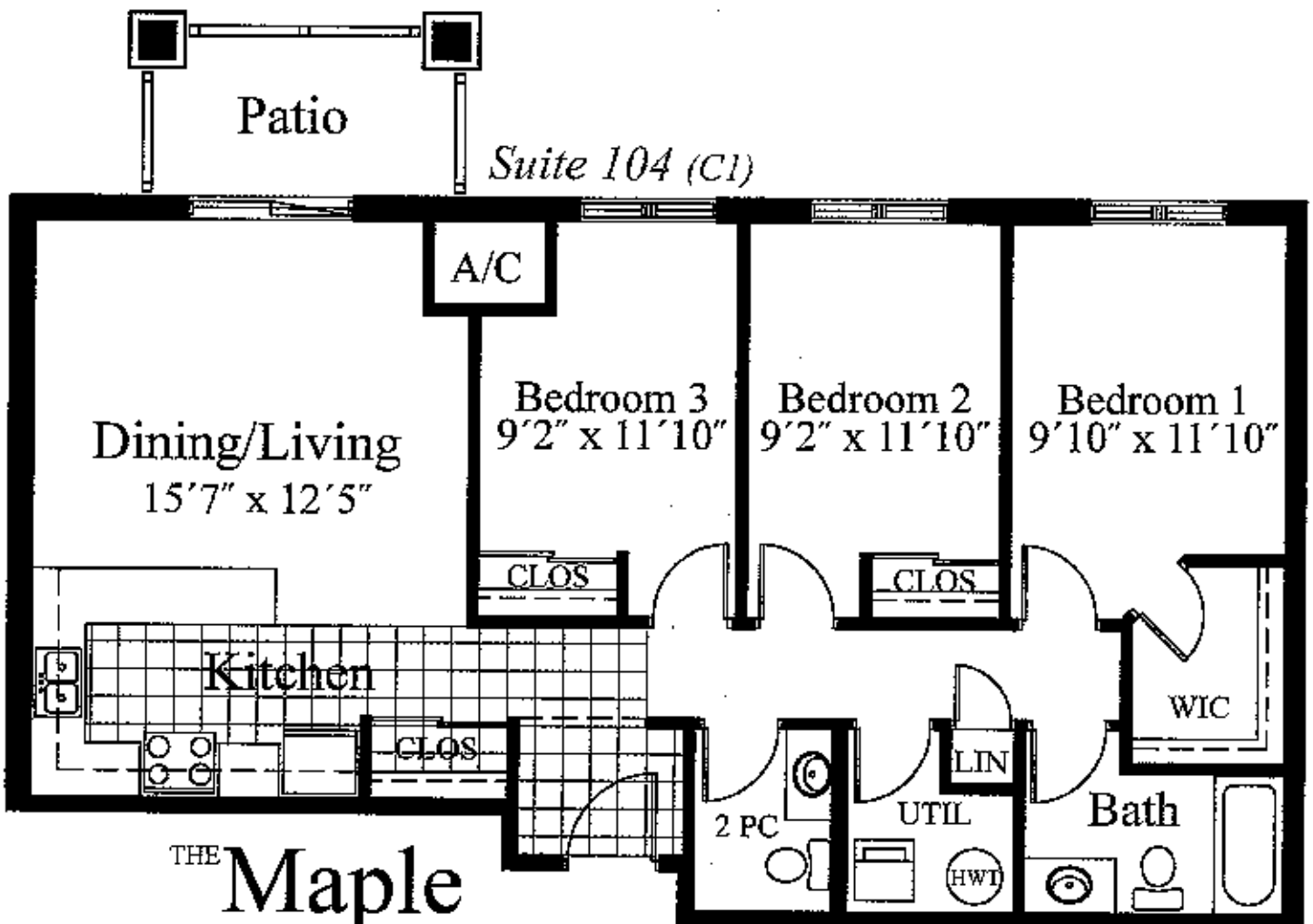

THE **Maple**
1,104 sq.ft.

FLOOR PLANS, PRICES AND STANDARD FEATURES SUBJECT
TO CHANGE A.E.& O.E.

111
m2 D2