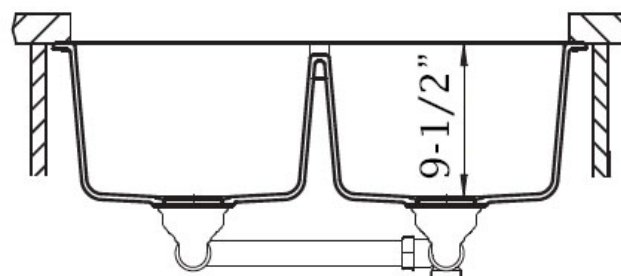
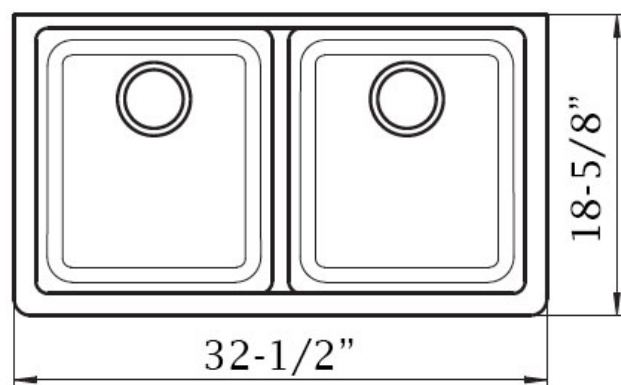

Product Specification Sheet

Virtuo Granite Double Bowl Undermount
B300 - B301 - B302 - B327 - B334 - B341
**Colour Finish**

Slate Grey

Pearl Back

Coffee Brown

Asphalt

Stone Taupe

White

Model No.

B300

B301

B302

B327

B334

B341

Description

- Undermount granite double bowl sink
- Outside Dimensions – 32 1/2" x 18 5/8" x 9 1/2" Deep
- 80% Quartz Content & 20% Resin
- 3 1/2" drain opening
- Supplied with installation clips, template & strainers
- Made in Germany
- Scratch and heat resistant
- cUPC certified
- Minimum Cabinet Size: 34"

Available accessories

- Matching Strainer
- Drying Rack
- BG300/301/302/327/334/341 - Stainless Steel Grid

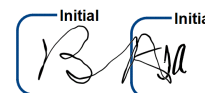
**MAIN LOCATION**

BRISTOL SINKS
 56 Firestone Blvd
 London, Ontario
 N5W 6E6

WESTERN LOCATION

BRISTOL SINKS
 964 72nd Avenue NE
 Calgary, Alberta
 T2E 8V9

CONTACT

Tel: 1(800) 930-0214
 Fax: 1(866) 310-7580
 Email: sales@bristolsinks.com



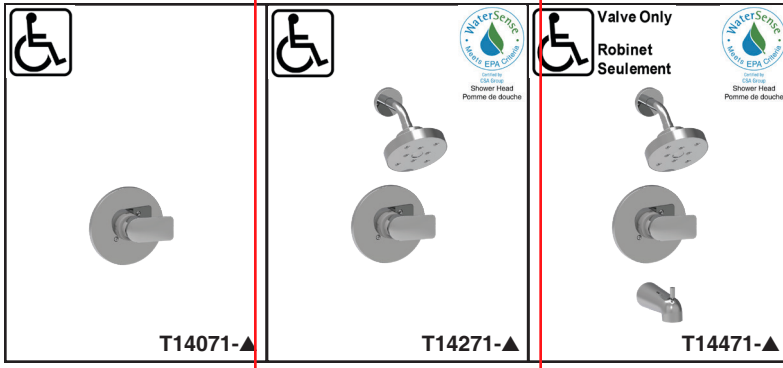

see what Delta can do™

BATHROOM FAUCETS

- Portage™ Bath Collection
- Valve Only (T14071)
- Shower Only (T14271)
- Tub/Shower (T14471)

Submitted Model No.: _____

Specific Features: _____

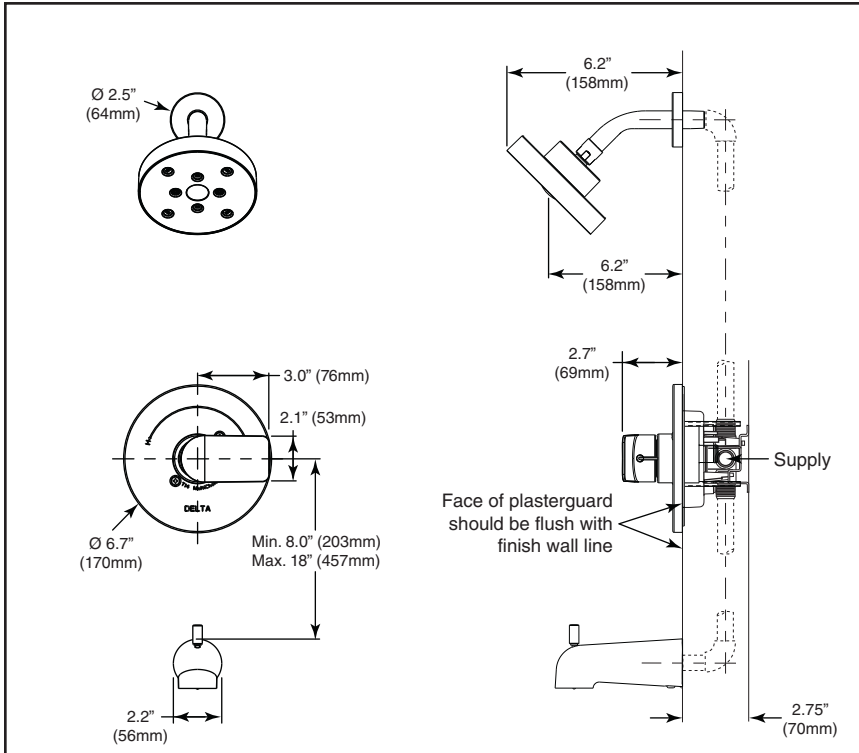

STANDARD SPECIFICATIONS:

- Monitor® 14 Series pressure balanced bath single handle mixing valve trim
- Maintains a balanced pressure of hot and cold water even when a valve is turned on or off elsewhere in the system
- For use with MultiChoice® Universal rough valve body (R10000 Series)
- Back-to-back installation capability.
- Temperature only controlled with handle
- Red/blue temperature indicators
- Field adjustable to limit Stop
- 120° maximum handle rotation.
- All parts replaceable from the front of the valve.
- Maximum 1.75gpm @80psi (6.6L/min@ 550kpa)
- Tub port maximum flow rate 6.0gpm @ 60psi with R10000-UNBX
- ½" C.W.T slip-on spout

WARRANTY

- Parts and Finish - Lifetime limited warranty; or for commercial purchasers, 10 years for multi-family residential (apartments and condominiums) and 5 years for all other commercial uses, in each case from the date of purchase.
- Electronic Parts and Batteries (if applicable) - 5 years from the date of purchase; or for commercial purchasers, 1 year from the date of purchase. No warranty is provided on batteries.

RP70175▲



H₂Okinetic®
Spray

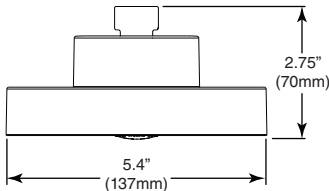

RP79226 (Chrome, SS Finishes)

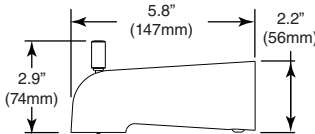

RP73371 (BL Finish)

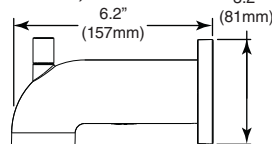

COMPLIES WITH:

- ASME A112.18.1 / CSA B125.1
- ASSE 1016
- EPA WaterSense®
- ♿ Indicates compliance to ICC/ANSI A117.1

Initial
Initial

▲ Designate Proper Finish Suffix

Delta Faucet Company reserves the right (1) to make changes in specifications and materials, and (2) to change or discontinue models, both without notice or obligation. Dimensions are for reference only. See current full-line price book or www.deltafaucet.com for finish options and product availability.

DSP-B-T14071, Rev. A

Delta Faucet Company

55 E. 111th Street, Indianapolis, IN 46280
350 South Edgeware Road, St. Thomas, ON N5P 4L1
© 2020 Delta Faucet Company