

Product Specification Sheet

WTR4 LOT 139 - LAUNDRY ROOM SINK

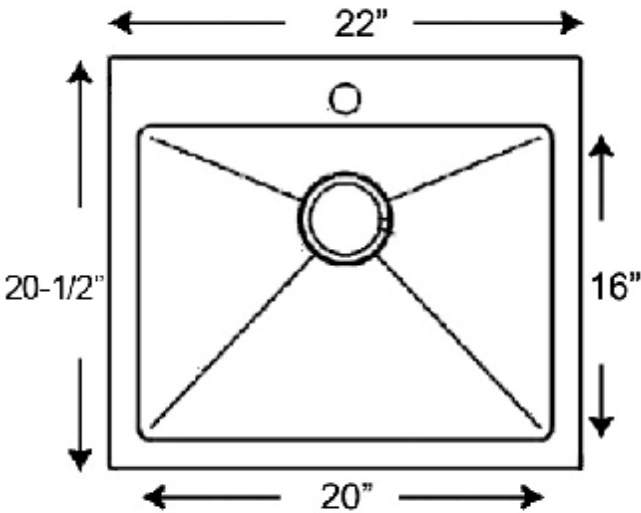

B1205 Top-mount Stainless Steel Single Bowl Laundry Sink



Colour Finish  
Stainless Steel

Model No.  
B1205

- Description
- Dimensions: 22" x 20-1/2" & 12" Deep
  - Minimum Cabinet Size: 24"
  - 18 Gauge Type 304 Stainless Steel Top Mount Sink
  - Brushed Satin Finish
  - Stone Guard undercoating over a rubber pad
  - 3 1/2" drain opening
  - Supplied with installation clip, template, and strainer
  - Stainless Steel Grid Available
  - cUPC certified
  - Limited Lifetime Warranty



Available accessories

- BG1205 Grid
- Colander Strainer - Stainless Steel
- Drying Rack



MAIN LOCATION

**BRISTOL SINKS**  
56 Firestone Blvd  
London, Ontario  
N5W 6E6

WESTERN LOCATION

**BRISTOL SINKS**  
964 72nd Avenue NE  
Calgary, Alberta  
T2E 8V9

CONTACT

Tel: 1(800) 930-0214  
Fax: 1(866) 310-7580  
Email: sales@bristolsinks.com



I F&>AF #%- Ž43E7? 7@F 43F: DAA? 83G57F %)) (Ž4>? BGŽ6EF

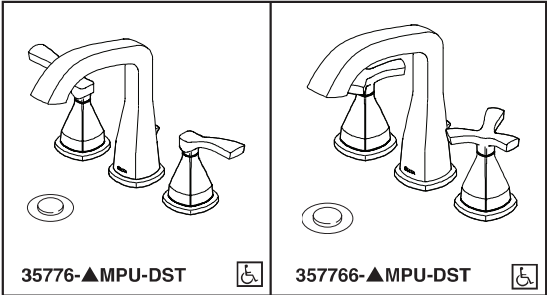

Submitted Model No.: \_\_\_\_\_

Specific Features: \_\_\_\_\_

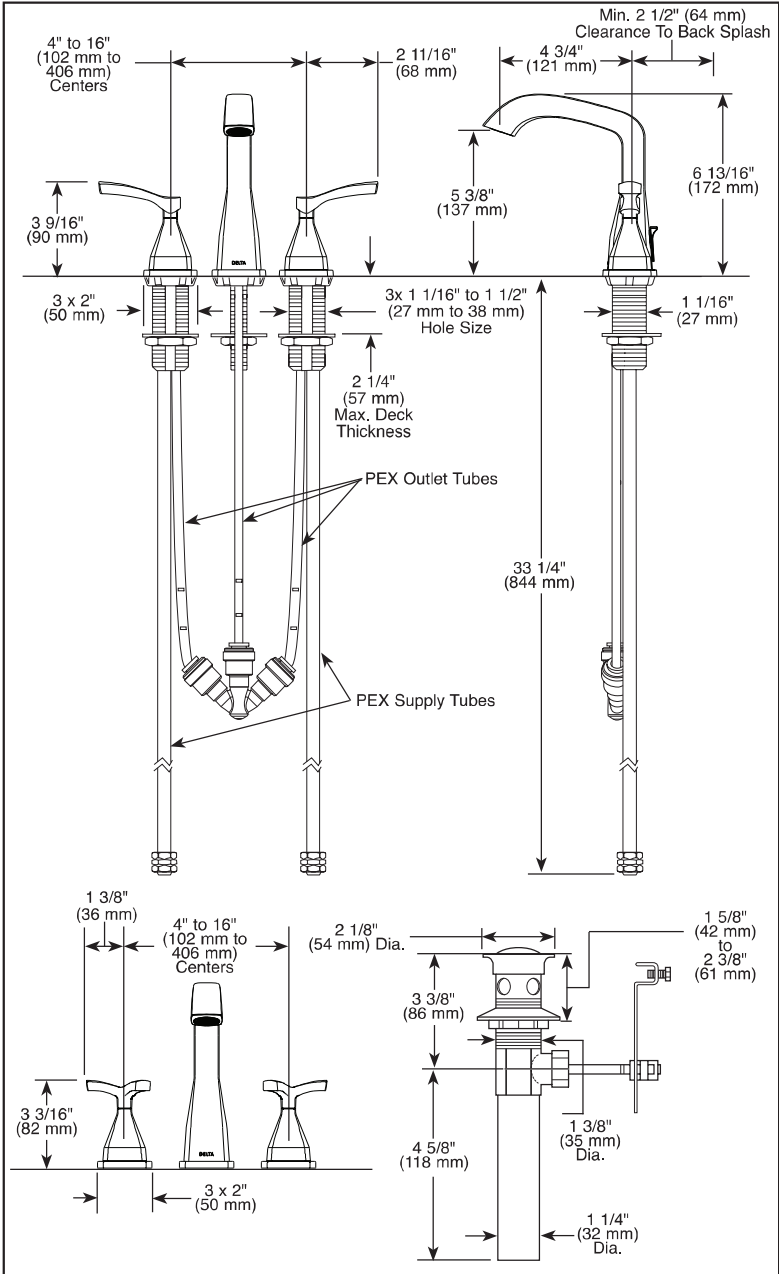

▲ Designate proper finish suffix

Delta reserves the right (1) to make changes in specifications and materials, and (2) to change or discontinue models, both without notice or obligation. Dimensions are for reference only. See current full-line price book or [www.deltafaucet.com](http://www.deltafaucet.com) for finish options and product availability.

DSP-L-35776-MPU-DST Rev. A



see what Delta can do™

LAVATORY FAUCETS

- Stryke™ Collection
- Two Handle Widespread Deck Mount

FEATURES:

- DIAMOND Seal® Technology

STANDARD SPECIFICATIONS:

- Max. 1.20 gpm @ 60 psi, 4.54 L/min @ 414 kPa
- Three hole mount
- Solid brass fabricated end valve
- 1/4 turn stops
- Hot and cold stems are interchangeable
- Diamond coated ceramic cartridge
- 3/8" O.D. straight PEX supply tubes
- Models have metal drain with pop-up type fitting with plated flange and stopper

WARRANTY

- Lifetime limited warranty on parts (other than electronic parts and batteries) and finishes: or, for commercial users, for 5 years from date of purchase.
- 5 year limited warranty on electronic parts (other than batteries); or, for commercial users, for 1 year from the date of purchase. No warranty is provided on batteries.



COMPLETE VALVE COMPLIES WITH:

- ASME A112.18.1 / CSA B125.1
- ASME A112.18.2 / CSA B125.2
- Indicates compliance to ICC/ANSI A117.1
- EPA WaterSense

Delta Faucet Company  
55 E. 111th Street, Indianapolis, IN 46280  
350 South Edgeware Road, St. Thomas, ON N5P 4L1  
© 2018 Delta Faucet Company





I F&>AF #%-Ž43E7? 7@F 43F: DAA? E AI 7D&JFGD7F#&S) (Ž4>

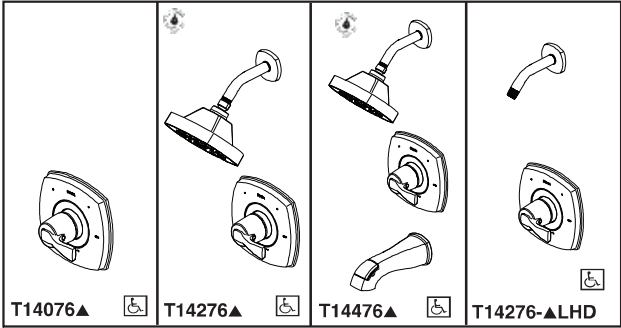

Submitted Model No.: \_\_\_\_\_

Specific Features: \_\_\_\_\_

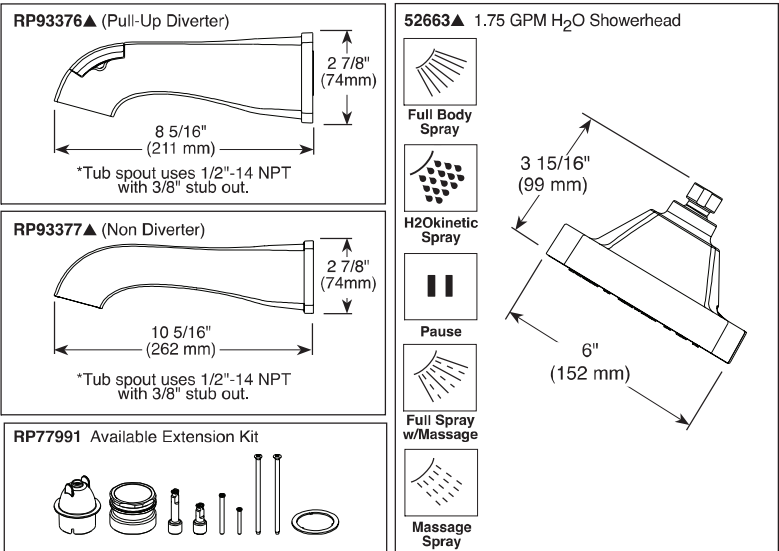
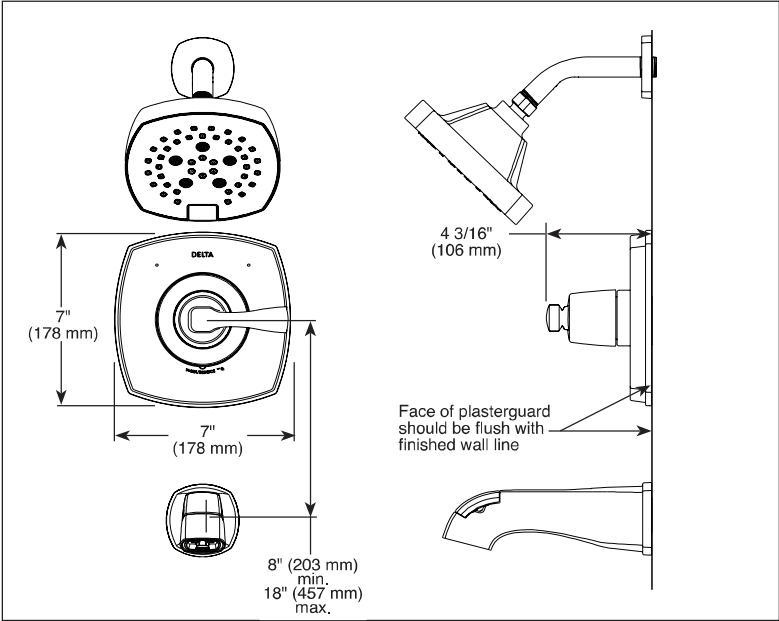

▲ Designate Proper Finish Suffix

Delta reserves the right (1) to make changes in specifications and materials, and (2) to change or discontinue models, both without notice or obligation. Dimensions are for reference only. See current full-line price book or [www.deltafaucet.com](http://www.deltafaucet.com) for finish options and product availability.

DSP-B-T14076 Rev. A



see what Delta can do™

## TUB AND SHOWER FAUCET TRIM

- Stryke™ Bath Collection
- Valve Only (T14076)
- Shower Only (T14276 & T14276-LHD)
- Tub/Shower (T14476)

### FEATURES:

- Monitor® 14 Series pressure balanced bath single handle mixing valve trim
- Five-setting H<sub>2</sub>Okinetic® Technology showerhead

### STANDARD SPECIFICATIONS:

- Maintains a balanced pressure of hot and cold water even when a valve is turned on or off elsewhere in the system.
- For use with MultiChoice® Universal rough valve body. (R10000 Series)
- Back-to-back installation capability.
- Temperature only controlled with handle.
- Field adjustable to limit handle rotation into hot water zone.
- 120° maximum handle rotation.
- All parts replaceable from the front of the valve.
- Max. 1.75 gpm @ 80 psi, 7.60 L/min @ 550 kPa.
- Red/blue pad print temperature indicator on the shower escutcheon.
- "LHD" models indicate less showerhead.
- Stem extension kit RP77991 can be ordered to allow for an additional 1 3/4" wall thickness. RP77991 ships with chrome escutcheon screws. For special finishes also order RP12630 escutcheon screws in desired finish.

### WARRANTY

- Lifetime limited warranty on parts (other than electronic parts and batteries) and finishes; or, for commercial users, for 5 years from date of purchase.
- 5 year limited warranty on electronic parts (other than batteries); or, for commercial users, for 1 year from the date of purchase. No warranty is provided on batteries.



### COMPLIES WITH:

- ASME A112.18.1 / CSA B125.1
- Indicates compliance to ICC/ANSI A117.1-Valve control only.
- EPA WaterSense®

**Delta Faucet Company**  
55 E. 111th Street, Indianapolis, Indiana 46280  
350 South Edgeware Road, St. Thomas, ON N5P 4L1  
© 2018 Delta Faucet Company





I F&>AF #%+ Ž43E7? 7@F 43F: DAA? E AI 7D6AAD/4>35=f

Halo 56 1/2-59 x 78 3/4 in. 8mm Sliding Shower Door for Alcove Installation

Model number:	138997-900-340-000
---------------	--------------------

Dimensions:	59" x 78.75"	Installation:	Alcove	Material:
-------------	--------------	---------------	--------	-----------





Standard Features:
<ul style="list-style-type: none"><li>• 8 mm tempered glass panels</li></ul>
<ul style="list-style-type: none"><li>• Available in 4 finishes: Chrome, Brushed Nickel, Dark Bronze, Matte Black</li></ul>
<ul style="list-style-type: none"><li>• Sliding door configuration features one sliding glass panel and one stationary panel</li></ul>
<ul style="list-style-type: none"><li>• Compatible with a wide range of MAAX's shower bases and walls, making it a versatile addition to any bathroom</li></ul>
<ul style="list-style-type: none"><li>• Ball bearing roller technology along a friction-free stainless steel rail system for a smooth and quiet opening</li></ul>
<ul style="list-style-type: none"><li>• The frameless design brings a sense of spaciousness to the room and creates a sleek, minimalist look</li></ul>
Product characteristics:
<ul style="list-style-type: none"><li>• Ball Bearing Roller System</li></ul>
<ul style="list-style-type: none"><li>• Bestseller</li></ul>
<ul style="list-style-type: none"><li>• Utile Compatible</li></ul>

Frame Finish(es):

  
Brushed Nickel

  
Chrome

  
Dark Bronze

  
Matte Black

Glass Pattern(s):

  
Clear

Certifications

MAAX products adhere to one or more of the following certifications:



MAAX





Halo 56 1/2-59 x 78 3/4 in. 8mm Sliding Shower Door for Alcove Installation

Model number:	138997-900-340-000
---------------	--------------------

Dimensions: 59" x 78.75"

Installation: Alcove

Material:

STANDARD

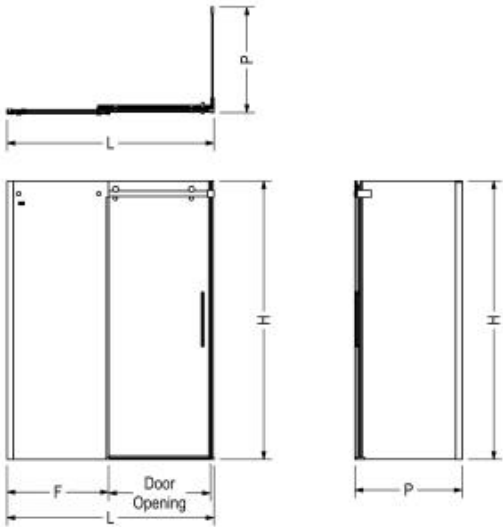

Code	Description	H	L Adjustable	F	P Adjustable	Door Opening	Wall Adjustment
138996	Halo 78 3/4" x 47"	78 3/4"	44 1/2" - 47"	22 1/2"	-	16 1/4" - 18 3/4"	1"
138997	Halo 78 3/4" x 59"	78 3/4"	56 1/2" - 59"	28 5/8"	-	22 1/8" - 24 5/8"	1"
139393	Return Panel 30"	78 3/4"	-	-	27 7/8"	-	1"
138998	Return Panel 32"	78 3/4"	-	-	29 7/8"	-	1"
139395	Return Panel 34"	78 3/4"	-	-	31 7/8"	-	1"
139396	Return Panel 36"	78 3/4"	-	-	33 7/8"	-	1"
139394	Return Panel 42"	78 3/4"	-	-	39 7/8"	-	1"

All dimensions are approximate. Structure measurements must be verified against the unit to ensure proper fit.

Project: \_\_\_\_\_

Contractor: \_\_\_\_\_

Representative: \_\_\_\_\_

Date: \_\_\_\_\_

Tel: \_\_\_\_\_

Notes: \_\_\_\_\_

\_\_\_\_\_

\_\_\_\_\_

MAAX





I F&>AF #%+ ŽBD;? 3DK 7@EG;F7E AI 7D6AAD/4DGE 76 @;5= 7>fi

Halo 56 1⁄2-59 x 78 3⁄4 in. 8mm Sliding Shower Door for Alcove Installation

Model number:	138997-900-305-000		
---------------	--------------------	--	--

Dimensions: 59" x 59" x 83" Installation: Alcove

Material:



Standard Features:
<ul style="list-style-type: none"><li>• 8 mm tempered glass panels</li><li>• Available in 4 finishes: Chrome, Brushed Nickel, Dark Bronze, Matte Black</li><li>• Sliding door configuration features one sliding glass panel and one stationary panel</li><li>• Compatible with a wide range of MAAX's shower bases and walls, making it a versatile addition to any bathroom</li><li>• Ball bearing roller technology along a friction-free stainless steel rail system for a smooth and quiet opening</li><li>• The frameless design brings a sense of spaciousness to the room and creates a sleek, minimalist look</li></ul>
Product characteristics:
<ul style="list-style-type: none"><li>• Ball Bearing Roller System</li><li>• Bestseller</li><li>• Utile Compatible</li></ul>

Frame Finish(es):

  
Brushed Nickel

  
Chrome

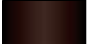
  
Dark Bronze

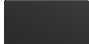
  
Matte Black

Glass Pattern(s):

  
Clear

Certifications

MAAX products adhere to one or more of the following certifications:



MAAX





Halo 56 1/2-59 x 78 3/4 in. 8mm Sliding Shower Door for Alcove Installation

Model number:

138997-900-305-000

Dimensions:

59" x 59" x 83"

Installation:

Alcove

Material:

STANDARD

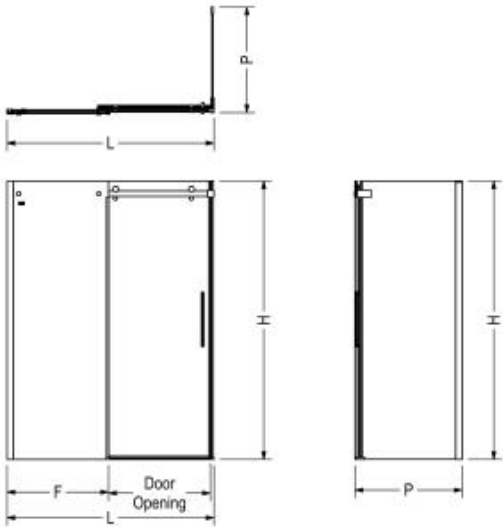

Code	Description	H	L Adjustable	F	P Adjustable	Door Opening	Wall Adjustment
138996	Halo 78 3/4" x 47"	78 3/4"	44 1/2" - 47"	22 1/2"	-	16 1/4" - 18 3/4"	1"
138997	Halo 78 3/4" x 59"	78 3/4"	56 1/2" - 59"	28 5/8"	-	22 1/8" - 24 5/8"	1"
139393	Return Panel 30"	78 3/4"	-	-	27 7/8"	-	1"
138998	Return Panel 32"	78 3/4"	-	-	29 7/8"	-	1"
139395	Return Panel 34"	78 3/4"	-	-	31 7/8"	-	1"
139396	Return Panel 36"	78 3/4"	-	-	33 7/8"	-	1"
139394	Return Panel 42"	78 3/4"	-	-	39 7/8"	-	1"

All dimensions are approximate. Structure measurements must be verified against the unit to ensure proper fit.

Project:

Contractor:

Representative:

Date:

Tel:

Notes:

MAAX



I F&>AF #%+ Ž=;F5: 7@ 83G57F +# +ŽDŽ6EF

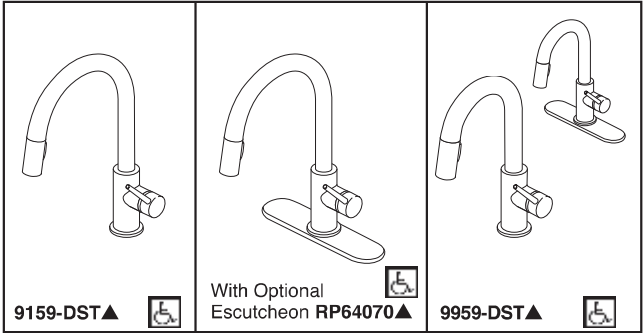

Submitted Model No.: \_\_\_\_\_

Specific Features: \_\_\_\_\_

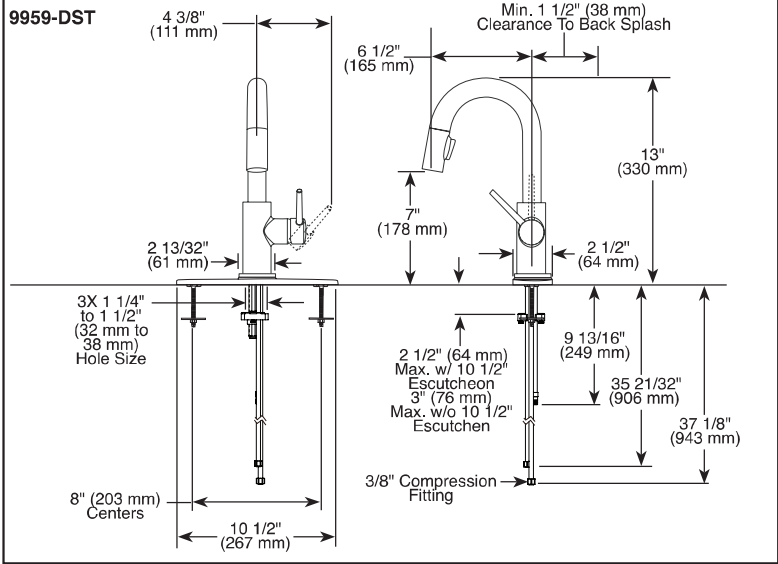
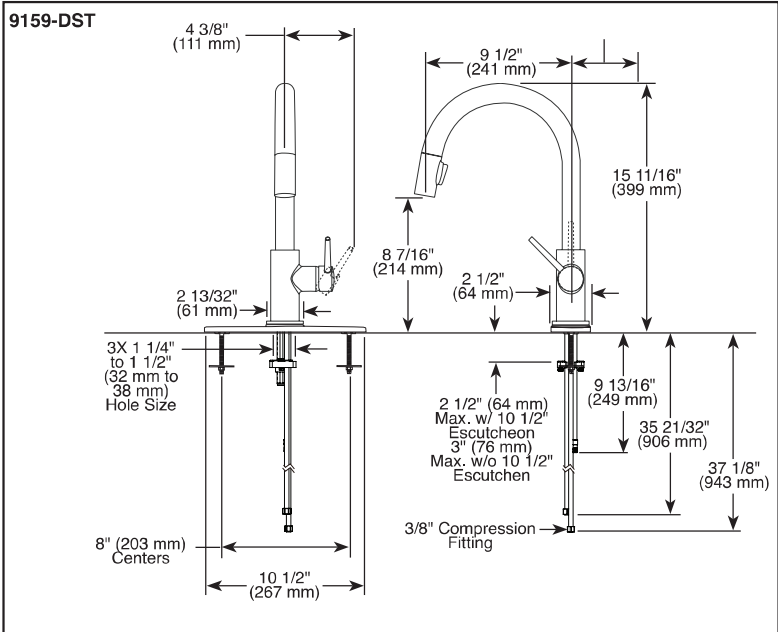

▲ Designate proper finish suffix

Delta reserves the right (1) to make changes in specifications and materials, and (2) to change or discontinue models, both without notice or obligation. Dimensions are for reference only. See current full-line price book or [www.deltafaucet.com](http://www.deltafaucet.com) for finish options and product availability.

DSP-K-9159-DST Rev. F



see what Delta can do™

## KITCHEN FAUCETS

- Trinsic® Collection
- Single Handle Deck Mount
- 2-Function Pull-Down Sprayer

### FEATURES:

- MagnaTite® Magnetic System
- DIAMOND Seal® Technology
- Touch-Clean® Sprayhead

### STANDARD SPECIFICATIONS:

- Maximum 1.8 gpm @ 60 psi, 6.8 L/min @ 414 kPa
- One or three hole mount (escutcheon optional, not included)
- Spout rotates 360°
- Control mechanism shall be full-motion valve cartridge
- Two-function wand; Aerated stream or spray
- Red/blue indicator markings
- Dual integral check valves in sprayer
- Quick connect hoses

### WARRANTY

- Parts and Finish - Lifetime limited warranty; or for commercial purchasers, 10 years for multi-family residential (apartments and condominiums) and 5 years for all other commercial uses, in each case from the date of purchase.
- Electronic Parts and Batteries (if applicable) - 5 years from the date of purchase; or for commercial purchasers, 1 year from the date of purchase. No warranty is provided on batteries.

### COMPLIES WITH:

- ASME A112.18.1 / CSA B125.1
- ASME A112.18.6
-  Indicates compliance to ICC/ANSI A117.1
- Verified compliant with .25% weighted average Pb content regulations.

### Delta Faucet Company

55 E. 111th Street, Indianapolis, IN 46280  
350 South Edgeware Road, St. Thomas, ON N5P 4L1  
© 2019 Delta Faucet Company





I F&>AF #%+ Ž>3G@6DKDAA? 83G57F ++' +ŽDŽ6EF

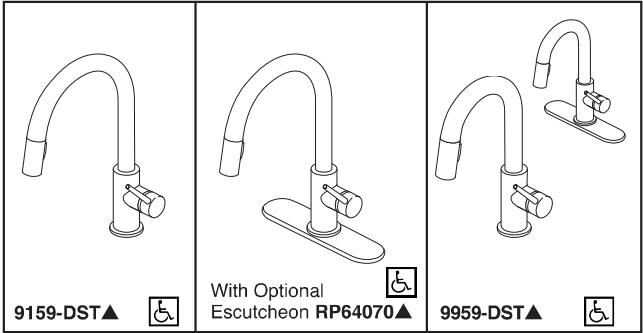

Submitted Model No.: \_\_\_\_\_  
Specific Features: \_\_\_\_\_

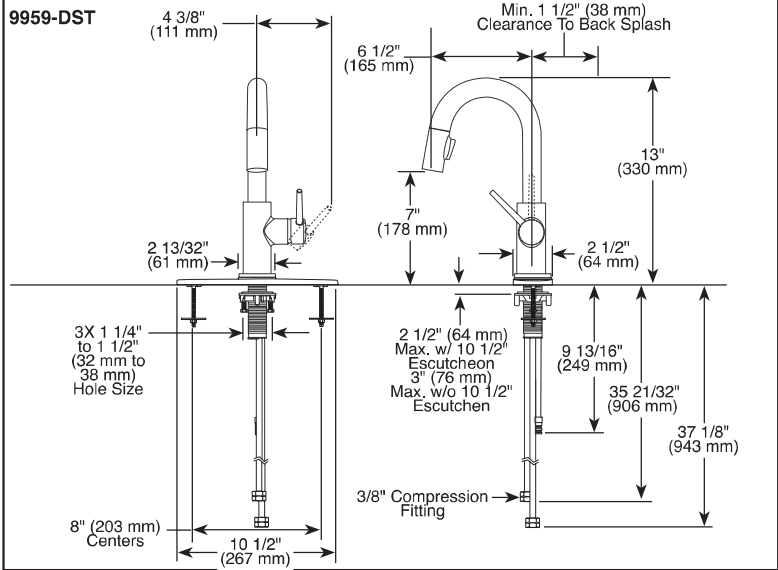
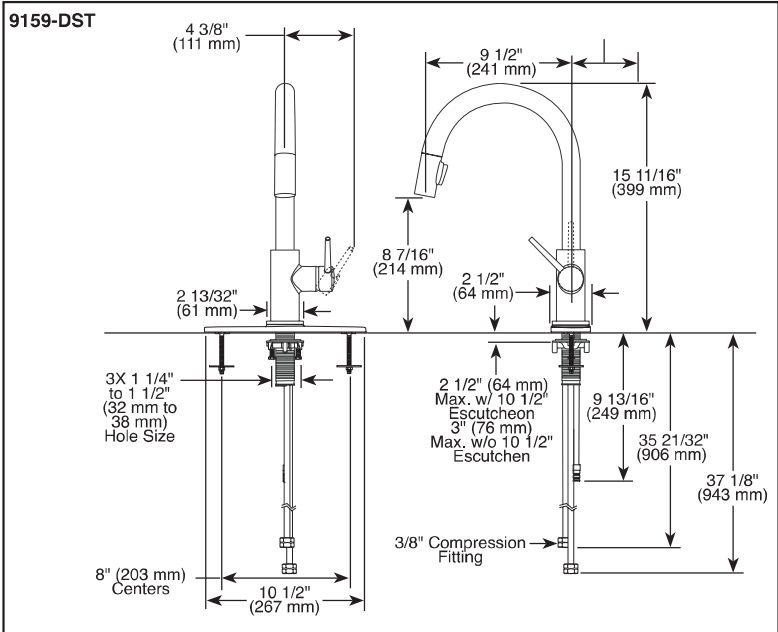

▲ Designate proper finish suffix  
Delta reserves the right (1) to make changes in specifications and materials, and (2) to change or discontinue models, both without notice or obligation. Dimensions are for reference only. See current full-line price book or [www.deltafaucet.com](http://www.deltafaucet.com) for finish options and product availability.  
DSP-K-9159-DST Rev. E



- Trinsic® Collection
- Single Handle Deck Mount
- 2-Function Pull-Down Sprayer
- Single or 3 Hole Sink Applications
- Centermount or 8" (203 mm) Centers w/ Optional 10 1/2" (267 mm) Escutcheon
- MagnaTite® Magnetic Docking

STANDARD SPECIFICATIONS:

- Single handle, 2-function pull-down kitchen faucets for exposed mounting on single or three hole sinks.
- Solid brass fabricated body.
- 15 11/16" (399 mm) high, 9 1/2" (241 mm) long, spout swings 360°.
- Lever handle. Control mechanism shall be full-motion valve cartridge.
- Touch-Clean® sprayhead.
- Quick connect hoses.
- Pull-down wand operates in an aerated or spray mode via ergonomic buttons.
- Red/blue indicator on handle button to indicate hot/cold temperature.
- MagnaTite® magnetic docking.
- Dual integral check valves in sprayer.
- Mounting wrench to assist in tightening mounting nut securely.
- Hose travels inside mounting shank so it will not interfere with deck edges.
- Keyed 10 1/2" (267 mm) escutcheon to help alignment and aid installation.
- Maximum 1.80 gpm @ 60 psi, 6.8 L/min @ 414 kPa

WARRANTY

- Lifetime limited warranty on parts (other than electronic parts and batteries) and finishes: or, for commercial users, for 5 years from date of purchase.
- 5 year limited warranty on electronic parts (other than batteries); or, for commercial users, for 1 year from the date of purchase. No warranty is provided on batteries.

COMPLIES WITH:

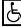
- ASME A112.18.1 / CSA B125.1
- ASME A112.18.6
-  Indicates compliance to ICC/ANSI A117.1
- Verified compliant with .25% weighted average Pb content regulations.



55 E 111th Street, Indianapolis, Indiana 46280  
350 South Edgeware Road, St. Thomas, ON N5P 4L1  
© 2015 Masco Corporation of Indiana





I F&>AF #%+ ŽBD;? 3DK 7@EG;F7 83G57FE%)) (ŽL? BGŽEF

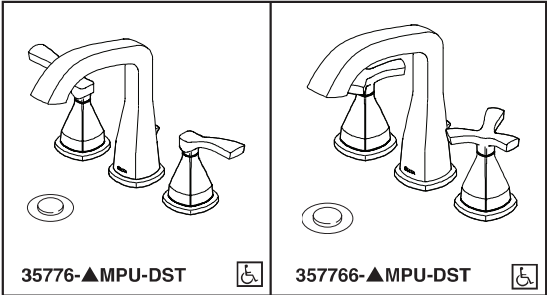

Submitted Model No.: \_\_\_\_\_

Specific Features: \_\_\_\_\_

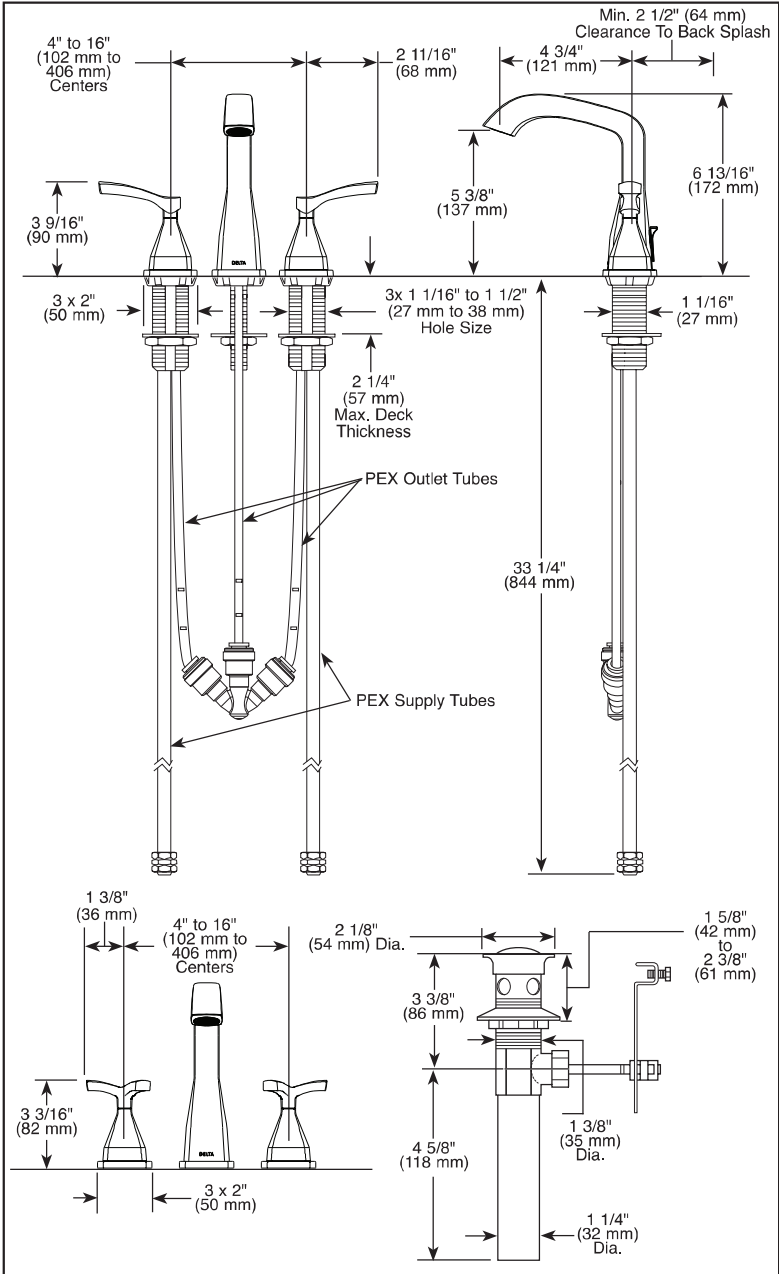

▲ Designate proper finish suffix

Delta reserves the right (1) to make changes in specifications and materials, and (2) to change or discontinue models, both without notice or obligation. Dimensions are for reference only. See current full-line price book or [www.deltafaucet.com](http://www.deltafaucet.com) for finish options and product availability.

DSP-L-35776-MPU-DST Rev. A



see what Delta can do™

LAVATORY FAUCETS

- Stryke™ Collection
- Two Handle Widespread Deck Mount

FEATURES:

- DIAMOND Seal® Technology

STANDARD SPECIFICATIONS:

- Max. 1.20 gpm @ 60 psi, 4.54 L/min @ 414 kPa
- Three hole mount
- Solid brass fabricated end valve
- 1/4 turn stops
- Hot and cold stems are interchangeable
- Diamond coated ceramic cartridge
- 3/8" O.D. straight PEX supply tubes
- Models have metal drain with pop-up type fitting with plated flange and stopper

WARRANTY

- Lifetime limited warranty on parts (other than electronic parts and batteries) and finishes: or, for commercial users, for 5 years from date of purchase.
- 5 year limited warranty on electronic parts (other than batteries); or, for commercial users, for 1 year from the date of purchase. No warranty is provided on batteries.



COMPLETE VALVE COMPLIES WITH:

- ASME A112.18.1 / CSA B125.1
- ASME A112.18.2 / CSA B125.2
- Indicates compliance to ICC/ANSI A117.1
- EPA WaterSense

**Delta Faucet Company**  
55 E. 111th Street, Indianapolis, IN 46280  
350 South Edgeware Road, St. Thomas, ON N5P 4L1  
© 2018 Delta Faucet Company





WT4 LOT 139 - PRIMARY ENSUITE SHOWER FIXTURE T14276-SS

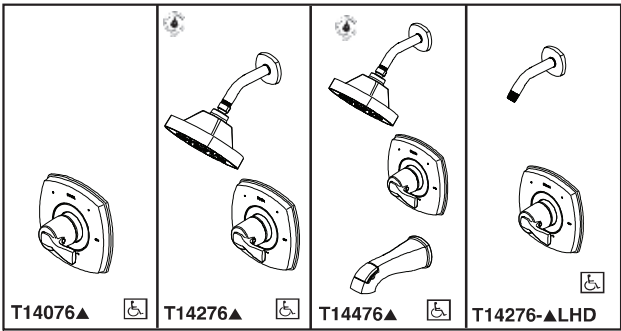

Submitted Model No.: \_\_\_\_\_  
Specific Features: \_\_\_\_\_

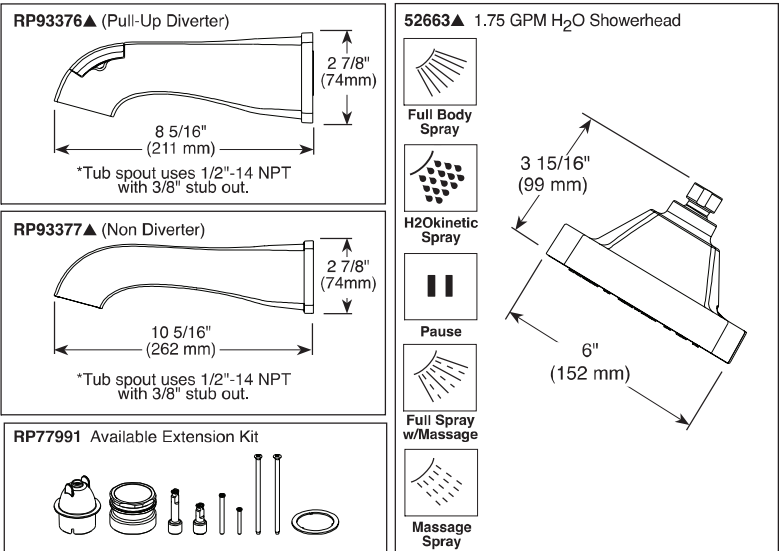
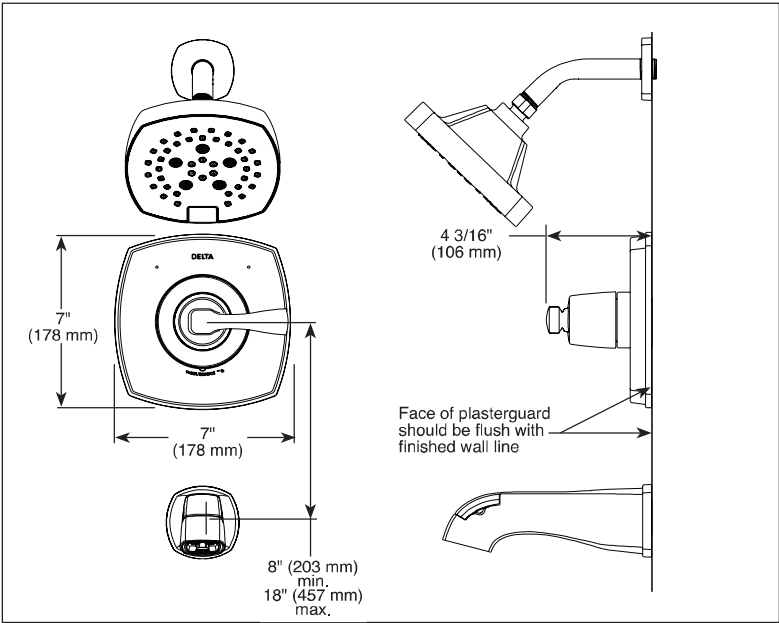

▲ Designate Proper Finish Suffix

Delta reserves the right (1) to make changes in specifications and materials, and (2) to change or discontinue models, both without notice or obligation. Dimensions are for reference only. See current full-line price book or [www.deltafaucet.com](http://www.deltafaucet.com) for finish options and product availability.  
DSP-B-T14076 Rev. A



TUB AND SHOWER FAUCET TRIM

- Stryke™ Bath Collection
- Valve Only (T14076)
- Shower Only (T14276 & T14276-LHD)
- Tub/Shower (T14476)

- FEATURES:**
- Monitor® 14 Series pressure balanced bath single handle mixing valve trim
  - Five-setting H<sub>2</sub>Okinetic® Technology showerhead
- STANDARD SPECIFICATIONS:**
- Maintains a balanced pressure of hot and cold water even when a valve is turned on or off elsewhere in the system.
  - For use with MultiChoice® Universal rough valve body. (R10000 Series)
  - Back-to-back installation capability.
  - Temperature only controlled with handle.
  - Field adjustable to limit handle rotation into hot water zone.
  - 120° maximum handle rotation.
  - All parts replaceable from the front of the valve.
  - Max. 1.75 gpm @ 80 psi, 7.60 L/min @ 550 kPa.
  - Red/blue pad print temperature indicator on the shower escutcheon.
  - "LHD" models indicate less showerhead.
  - Stem extension kit RP77991 can be ordered to allow for an additional 1 3/4" wall thickness. RP77991 ships with chrome escutcheon screws. For special finishes also order RP12630 escutcheon screws in desired finish.

- WARRANTY**
- Lifetime limited warranty on parts (other than electronic parts and batteries) and finishes; or, for commercial users, for 5 years from date of purchase.
  - 5 year limited warranty on electronic parts (other than batteries); or, for commercial users, for 1 year from the date of purchase. No warranty is provided on batteries.



- COMPLIES WITH:**
- ASME A112.18.1 / CSA B125.1
  - Indicates compliance to ICC/ANSI A117.1-Valve control only.
  - EPA WaterSense®

**Delta Faucet Company**  
55 E. 111th Street, Indianapolis, Indiana 46280  
350 South Edgeware Road, St. Thomas, ON N5P 4L1  
© 2018 Delta Faucet Company





I F&>AF #%+ ŽBD;? 3DK 7@EG;F7 DA? 3@ FG4FD;? F\$) (ŽÆ

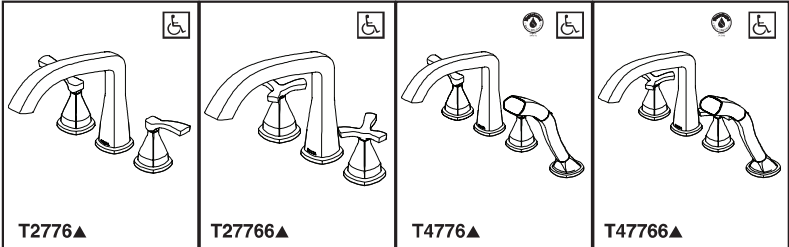

Submitted Model No.: \_\_\_\_\_

Specific Features: \_\_\_\_\_

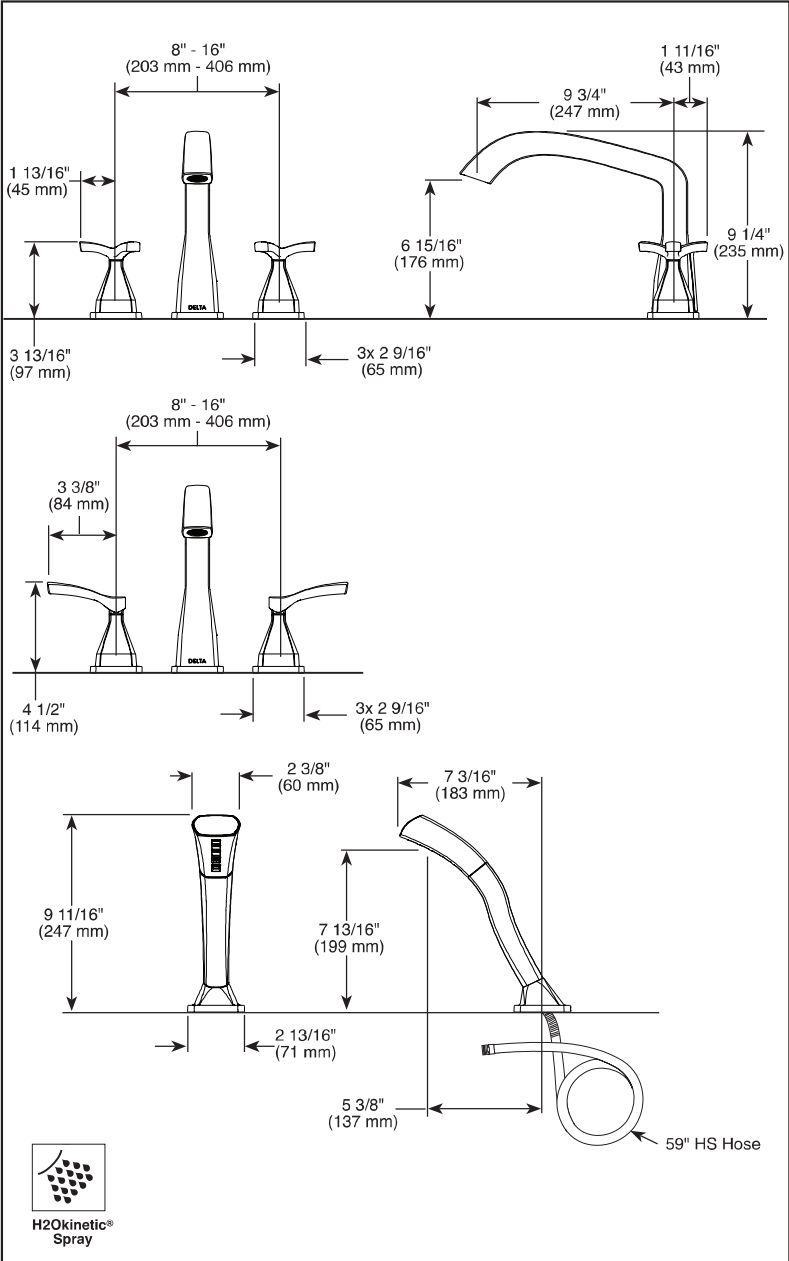

▲ Designate proper finish suffix

Delta reserves the right (1) to make changes in specifications and materials, and (2) to change or discontinue models, both without notice or obligation. Dimensions are for reference only. See current full-line price book or [www.deltafaucet.com](http://www.deltafaucet.com) for finish options and product availability.

DSP-B-T2776 Rev. A



see what Delta can do™

## ROMAN TUB/WHIRLPOOL FAUCET TRIM

- Stryke™ Bath Collection
- Three Hole Installation (T2776 & T27766 Series)
- Four Hole Installation (T4776 & T47766 Series)

### FEATURES:

- Single setting H<sub>2</sub>Okinetic® hand shower (T4776 & T47766)

### STANDARD SPECIFICATIONS:

- Temperature and volume controlled with handles
- Rough-In kit must also be ordered to complete installation (R4707 for four hole and R2707 for three hole). There are separate specification sheets on each rough-in kit if more details are required.
- Hand shower includes certified double check valves for backflow prevention (T4776 & T47766)
- Hand shower maximum 1.75 gpm @ 80 psi, 7.6 L/min @ 550 kPa
- Red/blue indicators

### WARRANTY

- Lifetime limited warranty on parts (other than electronic parts and batteries) and finishes; or, for commercial users, for 5 years from date of purchase.
- 5 year limited warranty on electronic parts (other than batteries); or, for commercial users, for 1 year from the date of purchase. No warranty is provided on batteries.



### COMPLETE VALVE COMPLIES WITH:

- ASME A112.18.1 / CSA B125.1
- Indicates compliance to - Valve control only
- ICC/ANSI A117.1
- EPA WaterSense® - Applies to hand shower only - RP100396▲

### Delta Faucet Company

55 E. 111th Street, Indianapolis, Indiana 46280  
350 South Edgeware Road, St. Thomas, ON N5P 4L1  
© 2018 Delta Faucet Company

