

MARKETING - BUILDING #10 - UNIT 257
CIVIC & CONSTRUCTION ADDRESS - 1013

DocuSign Envelope ID: 4F95C493-99D9-4A3E-B75C-4C5D472734D9

DCR - NUVO - BACK TO BACK STACKED TERRACE HOMES

UPPER UNIT

REVISED: JANUARY 17, 2023

JUNCTION BUILDING 10 UNIT 257

CABINETS - CARTIER LINE 1

HARDWARE - STD & 1ST UPGRADE

STD HINGES

STD METAL DRWRS

5 PCS - 5/8" KICK

6 PCS - FLAT SHOE MOULDING

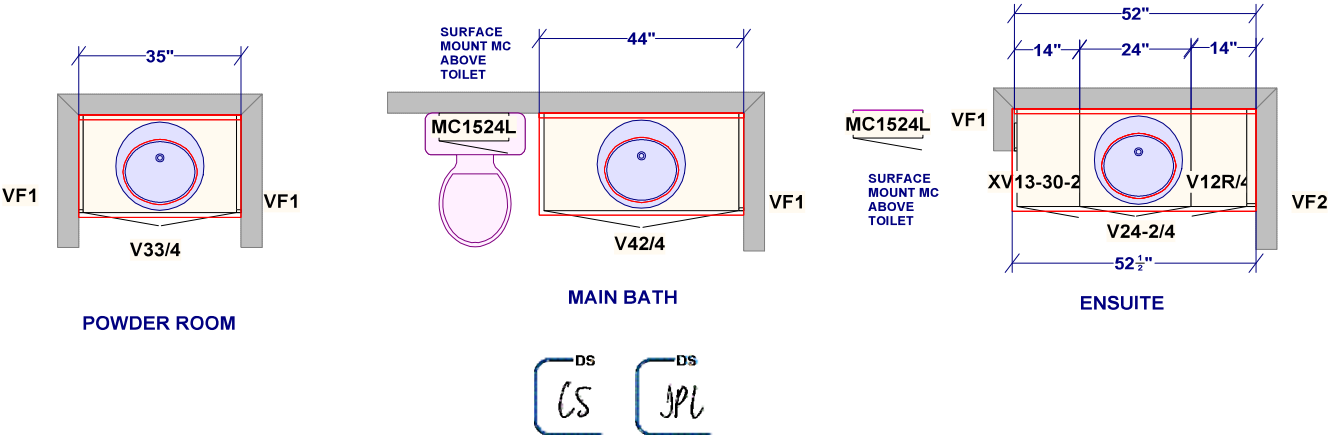
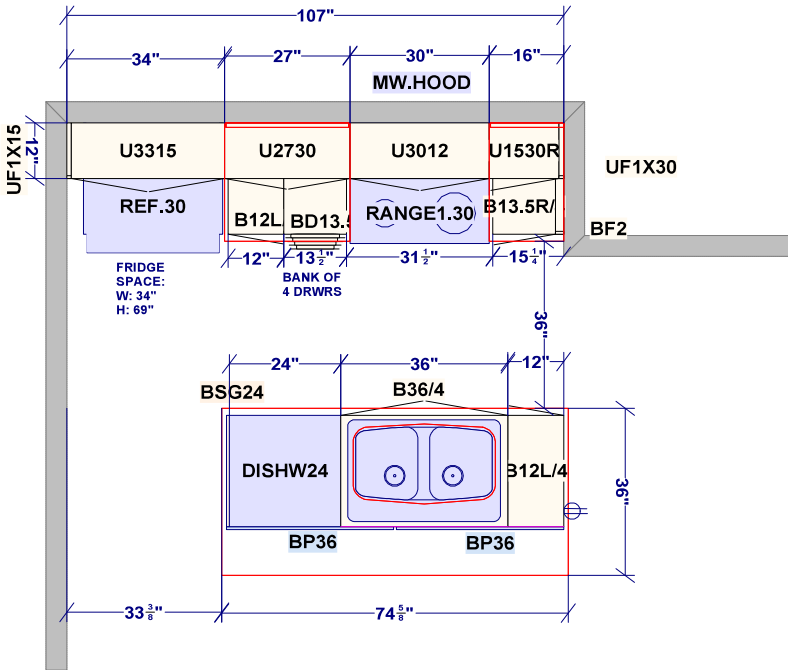

<div>CUSTOMER APPROVAL</div> <div>I have reviewed these drawings and understand the details of the design and the Cartier Kitchens specifications</div> <div>Signature _____</div> <div>Date _____</div>	<div>All dimensions _size designations given are subject to verification on job site and adjustment to fit job conditions.</div> <div></div>	<div>This is an original design and must not be released or copied unless applicable fee has been paid or job order placed.</div>	Designed: 1/17/2023 Printed: 1/17/2023	
			Drawing #: 1	No Scale.

MARKETING - BUILDING #10 - UNIT 257
CIVIC & CONSTRUCTION ADDRESS - 1013

DocuSign Envelope ID: 4F95C493-99D9-4A3E-B75C-4C5D472734D9

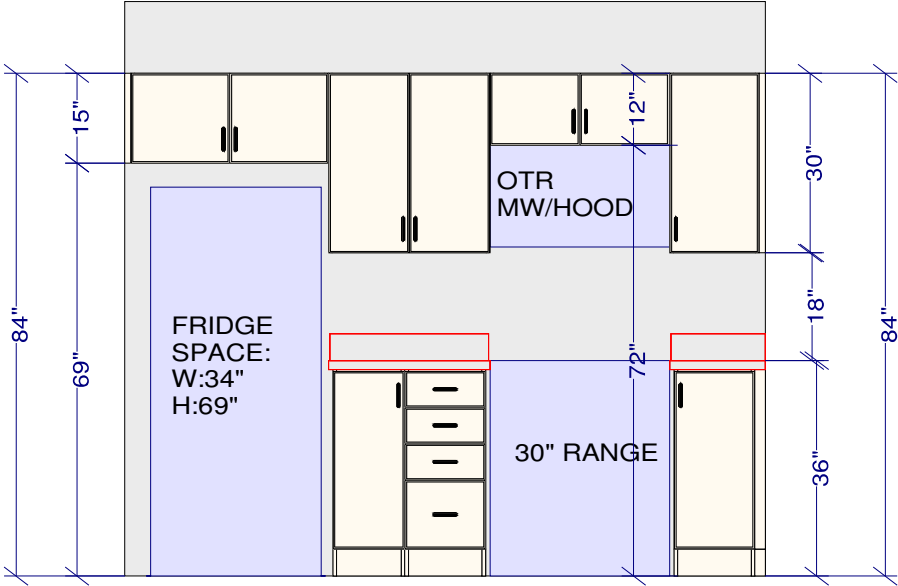

UPPER UNIT

FRIDGE/ RANGE WALL ELEVATION

CS SPL

CUSTOMER APPROVAL

I have reviewed these drawings and understand the details of the design and the Cartier Kitchens specifications

Signature _____

Date _____

All dimensions ,size designations given are subject to verification on job site and adjustment to fit job conditions.



This is an original design and must not be released or copied unless applicable fee has been paid or job order placed.

Designed: 2022-06-23
Printed: 2022-06-23