

MARKETING - BUILDING #10 - UNIT 161

CIVIC & CONSTRUCTION ADDRESS - 1031

DocuSign Envelope ID: 01DC13FD-C4EF-43B0-8CCA-C95CDA13AC69

DOOR PHENIX HOMES

NUVO - BACK TO BACK  
STACKED TERRACE HOMES

LOWER UNIT

REVISION: JANUARY 17, 2023

- CABINETS - CARTIER LINE 1
- HARDWARE - STD & 1ST UPGRADE
- STD HINGES
- STD METAL DRWRS
- 5 PCS - 5/8" KICK
- 6 PCS - FLAT SHOE MOULDING

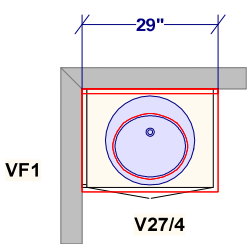
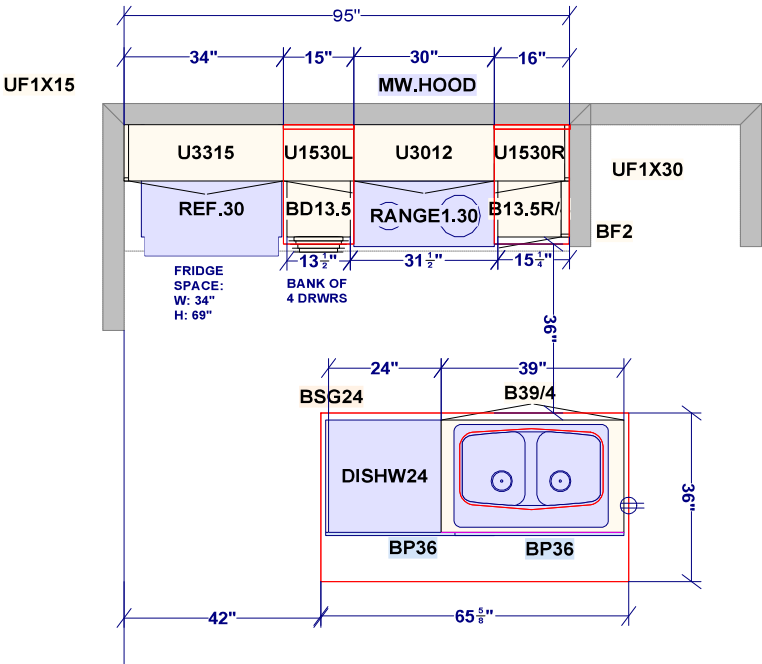

POWDER ROOM

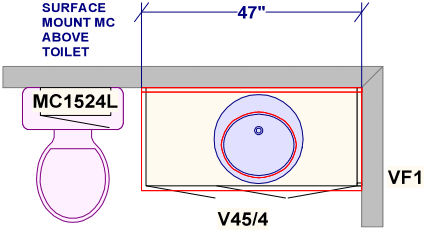

MAIN BATH

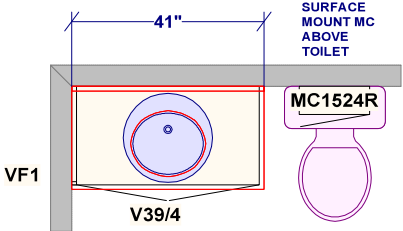

ENSUITE

CUSTOMER APPROVAL

I have reviewed these drawings and understand the details of the design and the Cartier Kitchens specifications

Signature \_\_\_\_\_

Date \_\_\_\_\_

All dimensions \_size designations given are subject to verification on job site and adjustment to fit job conditions.



This is an original design and must not be released or copied unless applicable fee has been paid or job order placed.

Designed: 1/17/2023  
Printed: 1/17/2023

DS  
M. ISO

MARKETING - BUILDING #10 - UNIT 161  
CIVIC & CONSTRUCTION ADDRESS - 1031

