



NOIR™ 30" BUILT-IN MICROWAVE OVEN WITH SPEED-COOK

Signature Features

JMC2430IM

4.3-INCH FULL COLOR LCD DISPLAY

A highly interactive, full-color LCD touchscreen is packed with dynamic features that allow you to navigate effortlessly through settings and cooking options including temperature and cooking mode.

1.4 CU. FT. MICROWAVE CAPACITY

Explore your options. There's room for whatever you're craving.

900-WATT MICROWAVE ELEMENT

Harness 900 watts of microwave energy to rapidly cook and reheat a variety of foods.

SEAMLESS TOUCHES

Seamlessly designed. Concealed details melt into their stainless steel surround, as shiny interiors and glass expanses pull you in.

CONVECTION & MICROWAVE COMBINATION COOKING

Let your appetite run wild—broil, bake or warm with convection and microwave energy.

SPEED-COOK

Renounce accepted limitations of the microwave. Three potent methods converge to deliver convection's steady heat, microwave speed and broiled caramelization in each oven-caliber bite.

STAINLESS STEEL MICROWAVE INTERIOR

Wrapped in luminous steel, intrinsic beauty is reflected in every corner.

1,200-WATT CONVECTION ELEMENT

This 1,200-watt element surrounds your cravings with circulating, consistent heat until baked to your satisfaction.

SENSOR COOKING

This intuitive sensor detects humidity released by food as it cooks, determining the precise cooking time and power level for optimal doneness of each dish.



Technical Specifications

Configuration and Overview

Size: 30 in

Microwave Type: Built-In

Microwave Details

Sensor Cooking: Yes

Cooking Power: 900 w

Cavity Finish: Stainless

Convection: Yes

Convection Power: 1200 w

Grill: Yes

Grill Power: 1600.0 w

Interior Light: No

Number or Racks: 1

Turntable: Stoppable

Microwave Details

Turntable Diameter Size: 14-1/8 in

Scrolling Electronic Display: No

Details

Number of Power Levels: 10

Clock: Yes

Night Light: No

Certifications

Kosher Consumer Friendly: Kosher Consumer Friendly

Prop 65: Standard

UL: Yes

Compatibility

Connectivity: No

Configuration

Microwave Configuration: Built-In

Dimensions

Capacity: 1-2/5

Net Weight: 90 lbs

Controls

Number of Quick Touch/One-Touch Selections: 1

Convenience Cooking Controls: Yes

Location of Controls: Top

Design Type

Design Expression: NOIR™

Electrical

Watts: 3300

30" INDUCTION COOKTOP

JIC4430X – 30³/₈" x 4¹/₈" x 21³/₈"

PRODUCT DIMENSIONS

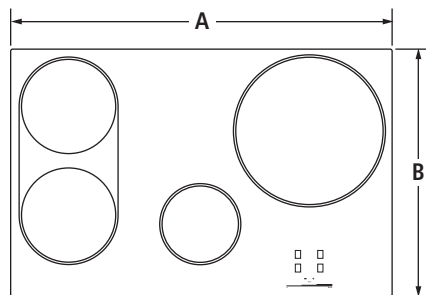

TOP VIEW

MODEL #		JIC4430X	
		in	cm
A	Overall width	30 ³ / ₈	77.0
B	Overall depth	21 ³ / ₈	54.1
C	Width of recessed cooktop	29	73.4
D	Height of recessed cooktop	3 ¹ / ₈	8.0
E	Recessed height including front flange	3 ⁷ / ₈	9.8
F	Height of cooking surface		
	Euro-Style Stainless (including trim)	1/4	0.6
	Floating Glass	1/8	0.4
G	Depth of recessed cooktop	18 ⁷ / ₈	47.9
H	Recessed height including electrical conduit	4 ¹ / ₈	10.5

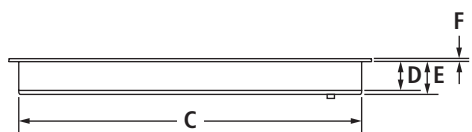

FRONT VIEW

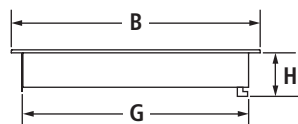

SIDE VIEW

30" INDUCTION COOKTOP

JIC4430X – 30³/₈" x 4¹/₈" x 21³/₈"

OPENING/CLEARANCE DIMENSIONS

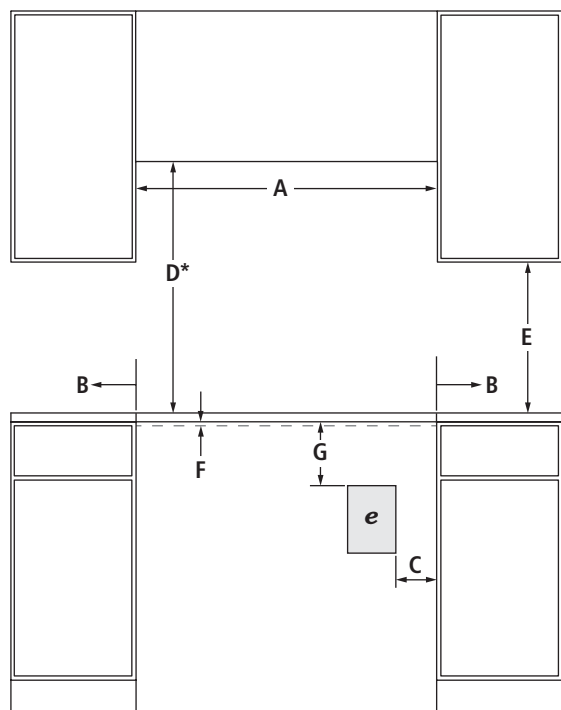

FRONT VIEW

MODEL #		JIC4430X	
		in	cm
A	Width of combustable area above cooking surface (min.)	29½	75.0
B	Width from cooktop to fixed wall or other combustable material (min.)	1	2.5
C	Width to outer edge of outlet (min.)	10	25.4
D*	Height to bottom of uncovered wood or metal cabinet above cooking surface (min.)	30	76.2
E	Height to bottom of uncovered wood or metal cabinet (min.)	18	45.7
F	Required height of ventilation opening in front cabinet under countertop for proper ventilation – full width of cooktop	¾	0.5
G	Height to top edge of outlet (min.)	12	30.5
H	Depth of upper cabinet (recommended)	13	33.0
I	Depth from cutout to wall (min.)	1	2.5
J	Width of cutout	29½	75.0
K	Depth of cutout	19¼	49.0
L	Depth from cutout to front of countertop	2	5.1
e	Recommended electrical access location		

*Dimension can be reduced by 6" (15.2 cm) when bottom of wood or metal cabinet is covered by not less than ¼" (0.6 cm) flame retardant millboard covered with not less than No. 28 MSG sheet metal, 0.015" (0.4 mm) stainless steel, 0.024" (0.6 mm) aluminum or 0.020" (0.5 mm) copper.

If installing a hood or microwave hood combination above the cooktop, follow the hood or microwave hood combination instructions for dimensional clearances above the cooking surface.

ELECTRICAL REQUIREMENTS

240 volt, 60 Hz, AC only, 40-amp fused, grounded circuit is required. A dedicated circuit is recommended. The length of conduit provided is for serviceability to the cooktop.

LOCATION REQUIREMENTS

- To ensure cooktop base clearance, cabinet side walls need to be wider than the cutout.
- If cabinet has a drawer, allow a 5¹/₈" (13.0 cm) minimum clearance between countertop and top of drawer.

COOKTOP OVER SINGLE WALL OVEN INSTALLATION REQUIREMENTS

- For approved model number combinations, refer to the under counter label on the bottom of the cooktop burner box.
- To install a cooktop over a single wall oven, refer to page 3.

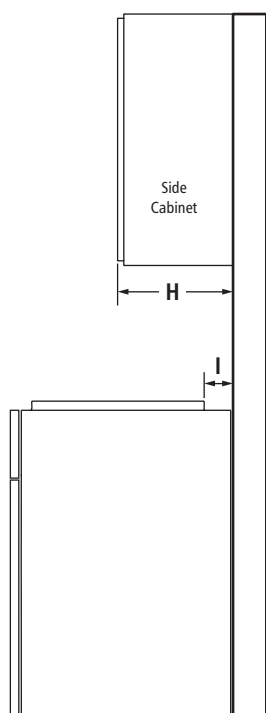

SIDE VIEW

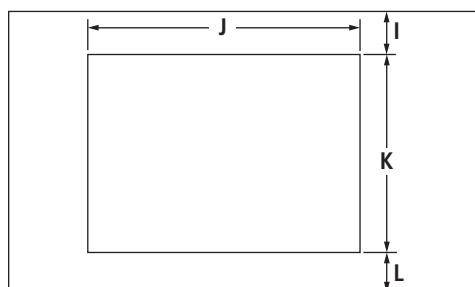

TOP VIEW – CUTOUT

SINGLE WALL OVEN AND COOKTOP COMBINATIONS

For the approved model number combinations, refer to the under counter label located on top of the oven chassis and on the bottom of the cooktop burner box.

APPROVED MODEL NUMBER COMBINATIONS

SINGLE WALL OVENS

30-Inch: JJW3430W, JJW2430W, JJW2330W

27-Inch: JJW2427W, JJW2327W

INDUCTION COOKTOPS

36-Inch: JIC4536X

30-Inch: JIC4430X

GAS COOKTOPS

36-Inch: JGC9536BD, JGC1536AD, JGC8536BD

30-Inch: JGC9430BD, JGC1430AD, JGC8430CD

ELECTRIC COOKTOPS

36-Inch: JEC4536Y, JEC9536BD, JEC8536BD

30-Inch: JEC4530Y, JEC9530BD, JEC8430BD

OPENING/CLEARANCE DIMENSIONS

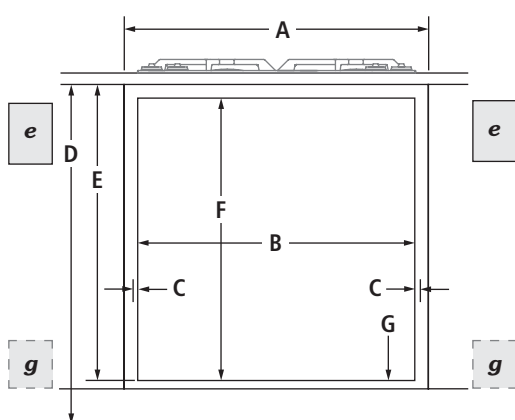

**FRONT VIEW –
UNDER COUNTER INSTALLATION**
(with cooktop installed above)

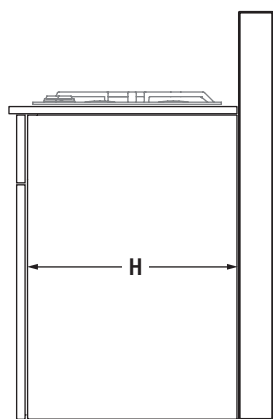

**SIDE VIEW –
UNDER COUNTER INSTALLATION**
(with cooktop installed above)

MODEL #		JJW3430W JJW2430W JJW2330W		JJW2427W JJW2327W	
		in	cm	in	cm
A	Width of cabinet (min.)	30	76.2	27	68.6
B	Width of cutout (recommended)	28½	72.4	25½	64.8
C	Oven trim overlap	⅝	1.6	⅝	1.6
D	Bottom of countertop to floor	34½	87.6	34½	87.6
E	Bottom of countertop to bottom of cutout				
	Induction cooktop combination	30⅞	78.4	30⅞	78.4
	Gas cooktop combination	29⅞	75.9	29⅞	75.9
	Electric cooktop combination	29⅞	75.9	29⅞	75.9
F	Height of cutout (recommended)	27¾	70.5	27¾	70.5
G	Bottom of cutout to floor				
	Induction cooktop combination	3⅝	9.2	3⅝	9.2
	Gas cooktop combination	4⅝	11.7	4⅝	11.7
	Electric cooktop combination	4⅝	11.7	4⅝	11.7
H	Depth of cabinet (min.)	24	61.0	24	61.0
e	Recommended junction box location				
g	Recommended gas supply line location for gas cooktop				

NOTE: For under counter installation, the junction box should be located in the adjacent right or left cabinet. Drill a 1" (2.5 cm) minimum diameter hole in an upper corner of the side wall for access to the junction box.

CABINET REQUIREMENTS

NOTE: When using under counter installation, check cabinet manufacturer's specifications to verify fit.

JENN-AIR® DETAILED PLANNING DIMENSIONS

4 of 4

VENTILATION SELECTION CHART – COOKTOPS

MODEL #	PRO-STYLE™ HOODS			EURO-STYLE ISLAND-MOUNT HOODS		EURO-STYLE WALL-MOUNT HOODS		GLASS COLLECTION ISLAND-MOUNT HOOD	GLASS COLLECTION WALL-MOUNT HOODS		PERIMETRIC HOOD	OILED BRONZE WALL-MOUNT HOODS		EURO-STYLE TELESCOPING DOWNDRAFT SYSTEMS		CUSTOM HOOD LINERS	OVER-THE-RANGE MICROWAVE OVENS
	JXW9048WP	JXW9036WP JXU9136WP	JXW9030WP JXU9130WP	JXI8042WS	JXI8036WS	JXW8036WS JXW8836WS	JXW8030WS	JXI5036WS	JXW5036WS	JXW5030WS	JXP5032WS	JXW6036WR	JXW6030WR	JXD7036YS	JXD7030YS	UXL6048YSSA UXL6036YSSA	JMV9186W JMV8208W
INDUCTION COOKTOPS																	
36-INCH																	
JIC4536X – 5 Elements	■	■	—	★	★	★	—	★	★	—	★	■	—	★	—	★	■
30-INCH																	
JIC4430X – 4 Elements	■	■	■	■	★	★	★	★	★	★	★	■	■	★	★	★	■
CONVENTIONAL GAS COOKTOPS																	
36-INCH (less than 60,000 BTU total)																	
JGC9536BD – 5 Burners	■	■	—	★	★	★	—	★	★	—	★	★	—	★	—	★	■
JGC1536AD – 5 Burners	■	■	—	★	★	★	—	★	★	—	★	■	—	★	—	★	■
JGC8536BD – 5 Burners	■	■	—	★	★	★	—	★	★	—	★	■	—	★	—	★	■
30-INCH (less than 60,000 BTU total)																	
JGC9430BD – 4 Burners	■	■	■	■	★	★	★	★	★	★	★	★	★	★	★	★	■
JGC1430AD – 4 Burners	■	■	■	■	★	★	★	★	★	★	★	■	■	★	★	★	■
JGC8430CD – 4 Burners	■	■	■	■	★	★	★	★	★	★	★	■	■	★	★	★	■
CONVENTIONAL ELECTRIC COOKTOPS																	
36-INCH																	
JEC4536Y – 5 Elements	■	■	—	★	★	★	—	★	★	—	★	■	—	★	—	★	■
JEC9536BD – 5 Elements	■	■	—	★	★	★	—	★	★	—	★	★	—	★	—	★	■
JEC8536BD – 5 Elements	■	■	—	★	★	★	—	★	★	—	★	■	—	★	—	★	■
30-INCH																	
JEC4530Y – 5 Elements	■	■	■	■	★	★	★	★	★	★	★	■	■	★	★	★	■
JEC9530BD – 5 Elements	■	■	■	■	★	★	★	★	★	★	★	★	★	★	★	★	■
JEC8430BD – 4 Elements	■	■	■	■	★	★	★	★	★	★	★	■	■	★	★	★	■

A. Custom hood liners can be used with any of the following blower motors: UXB1200DYS, UXB0600DYS, UXI1200DYS or UXI0600DYS.

KEY	
★	Style and Performance Pair
■	Performance Pair
—	Not Recommended

Product dimension, cutout and installation specifications are provided for planning purposes only. Before installing any product, be sure to verify cutout dimensions and electrical/gas connections as actual product dimensions may vary.



JRC120029A 07/2012



RISE 24" BUILT-IN DISHWASHER, 38 DBA

Signature Features

JDPSS246LL

QUIETEST LUXURY DISHWASHER BRAND²

Based on normal cycle
² Based on normal cycle</sup>

ENHANCED CINEMATIC LIGHTING

Shine a spotlight on clean. Packed with 18 LED lights that ramp up to full intensity, JennAir brand’s best lighting coverage chases away shadows to illuminate daring Obsidian racks.

DARING OBSIDIAN RACKS

A JennAir® signature, this dramatic, industry-exclusive black finish is inspired by the beauty of volcanic glass—showcasing clean dishes in striking contrast.

HIGH-CAPACITY 3RD RACK WITH WASH³

The largest 3rd Level Rack in the luxury industry¹* glides with quiet and ease, even when fully loaded with tapas bowls, large rocks glasses and cocktail shakers.
¹ Based on usable volume. Models JDPSS245LX, JDPSS246L and JDPSS245L.</sup>
³ The largest 3rd Level Rack in the luxury industry glides with quiet and ease, even when fully loaded with tapas bowls, large rocks glasses and cocktail shakers.</sup>

87% MORE METAL IN THE THIRD LEVEL RACK*

*Based on usable volume. Models JDPSS246L and JDPSS245L.

1 TO 24-HOUR DELAY START OPTION

Postpone the start of your wash cycle in one-hour increments for up to 24 hours. Start your wash cycle on your terms.
⁴
⁴ Appliance must be set to remote enable. WiFi & App required. Features subject to change. For details and privacy info, visit jennair.com/connect.</sup>

11% MORE LOADING HEIGHT⁵ (COMPARED TO JENNAIR® DISHWASHER MODELS: JDTSS246GM, JDTSS246GL, JDTSS245GX.)

⁵ Compared to JennAir® dishwasher models: JDTSS246GM, JDTSS246GL, JDTSS245GX.</sup>

RAPID WASH CYCLE

This wash cycle cleans dishes in about an hour and is ideal for any get-together, diversion or intimate night in.

38 DBA TRANQUILITY⁶ SYSTEM

Listen to the hush. At 38 dBA, JennAir is the quietest luxury dishwasher brand⁷*, all without sacrificing performance.
⁷ Based on Normal Cycle.
⁶ Based on normal cycle.</sup>



Dimensions

Net Weight: 89 lbs
Number of Place Settings: 15
Gross Weight: 100 lbs
Controls

Control Type: Tap Touch with Display
Automatic Temperature Controls: Yes
End of Cycle Signal: Yes
Status Light: Multi-Color

Electrical

Power Cord Included: No
Hz: 60

Technical Specifications

Description

Dishwasher Type: Built-In

Exterior

Handle Color: Stainless Steel

Control Panel Color: Black

Handle Type: Towel Bar

Magnetic Door: No

Handle Material: Metal

Toe Panel Color: Black

True Hold Door: Yes

2nd Level Rack

Cushion-Tip Tines: Yes

Extras:

- Stainless Steel Wash Arm
- 6 Stemware Holders

Fold-Down Tines: 1 Row 6 Position

Glides: Smooth Glide

Lower Rack

Extras: Stainless Steel Wash Arm

Glides: Ball Bearings

Details

Number of Racks: 3

Built-In Water Softener: No

Drying System Type: Fan Dry with Heating Element

Interior Light: Yes

Tub Material: Stainless Steel

Tub Style: Built-in Tall Tub 24"

Wash System: Filter

Water Filtration: Yes

Rack Material: Nylon

Hoses Included: Both Fill Hose and Drain

Features

Sound Package: Yes

Rinse Aid Dispenser Level Indicator: Yes

Cycles and Options

- Dishwasher Cycle Selections:
- Sensor
 - Cookware
 - Normal
 - Crystal
 - 1-Hour Wash
 - Refresh

Cycles

Number of Wash Cycles: 6

2nd Level Rack

Adjustable: 2 Position

Utility Basket: No

Silverware Basket

Type: Full Length Non Splitable

Location: Bottom Rack

Culinary Basket: Yes

Covers: Yes

Third Level Rack

Adjustable: No

Glides: Satin Glides

Removable: Yes

Type: Third rack with dual rotating wash tubes

Certifications

ADA Compliant: No

Energy Star® Qualified: ENERGY STAR® Certified

CEE Tier: Tier I

Energy Rating: 270

UL: Yes

CUL: Yes

Kosher Consumer Friendly: Yes

Prop 65: Standard

Options

- Dishwasher Option Selections:
- Hi Temp Wash
 - Sani Rinse®
 - Top Rack Wash
 - Bottom Rack Wash
 - 1-24 Hour Delay

48" FULLY INTEGRATED SIDE-BY-SIDE REFRIGERATOR

(BASE UNIT REQUIRES SUITE-COORDINATING PANEL KIT OR CUSTOM PANELS AND HANDLES)

JS48NXFXDE – 47³/₄" x 83¹/₈" x 24" (without door/handles)

PRODUCT DIMENSIONS (including stainless steel door panel kit dimensions)

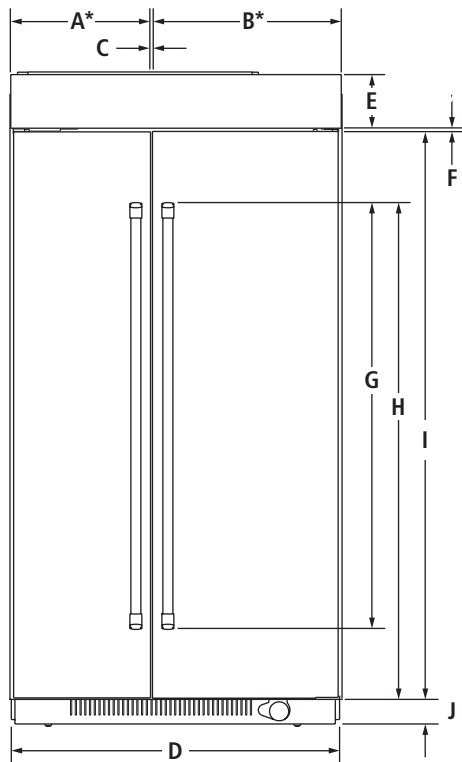

FRONT VIEW

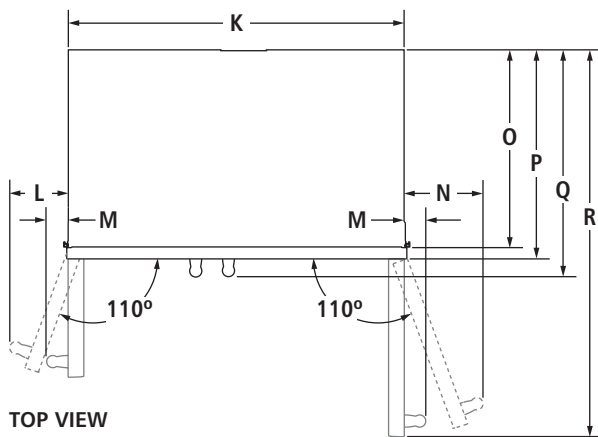

TOP VIEW

MODEL #		JS48NXFXDE	
		in	cm
A*	Width of freezer door	20 ¹ / ₈	51.2
B*	Width of refrigerator door	27 ¹ / ₈	68.9
C	Space between doors	¹ / ₈	0.3
D	Overall width (including vinyl side trim)	47 ³ / ₄	121.3
E	Height of top grille (including top grille filler)	6 ¹ / ₂	16.5
F	Space between doors and top grille	¹ / ₈	0.3
G	Height of door handles Pro-Style® Stainless	63	160
	Euro-Style Stainless	50	127.1
H	Height to top of door handles Pro-Style® Stainless	67	170.3
	Euro-Style Stainless	66 ⁵ / ₈	169.1
I	Height of doors	74 ¹ / ₄	188.6
J	Height of bottom grille	3	7.6
K	Width of recessed refrigerator	47 ⁷ / ₈	121.6
L	Width from side of refrigerator to freezer door handle – door fully open 110° Pro-Style® Stainless	8 ³ / ₈	21.3
	Euro-Style Stainless	8	20.3
M	Width from side of refrigerator to handle – doors open 90° Pro-Style® Stainless	2	5.1
	Euro-Style Stainless	1 ¹ / ₂	3.9
N	Width from side of refrigerator to refrigerator door handle – door fully open 110° Pro-Style® Stainless	9 ⁵ / ₈	24.4
	Euro-Style Stainless	9 ¹ / ₈	23.1
O	Depth without door panel kit	24	61.0
P	Depth with doors Pro-Style® Stainless panel kit	24 ³ / ₄	62.9
	Euro-Style Stainless panel kit	24 ³ / ₄	62.9
	Custom panel (¾"/1.9 cm)	24 ³ / ₄	62.9
Q	Depth with handles Pro-Style® Stainless	27 ³ / ₈	69.5
	Euro-Style Stainless	26 ⁷ / ₈	68.3
R	Depth with refrigerator door open 90°	50 ¹ / ₄	127.6

* Door width dimensions are for stainless steel panel kit only.

IMPORTANT: Dimensional specifications are provided for planning purposes only.

Do not make any cutouts based on this information. Refer to the Installation or Use & Care Guide before selecting cabinetry, verifying electrical/gas connections, making cutouts or beginning installation.

All Jenn-Air® appliances are appropriately UL, CUL or CSA approved.

48" FULLY INTEGRATED SIDE-BY-SIDE REFRIGERATOR

(BASE UNIT REQUIRES SUITE-COORDINATING PANEL KIT OR CUSTOM PANELS AND HANDLES)

JS48NFXDE – 47³/₄" x 83¹/₈" x 24" (without door/handles)

DIMENSIONS AS INSTALLED

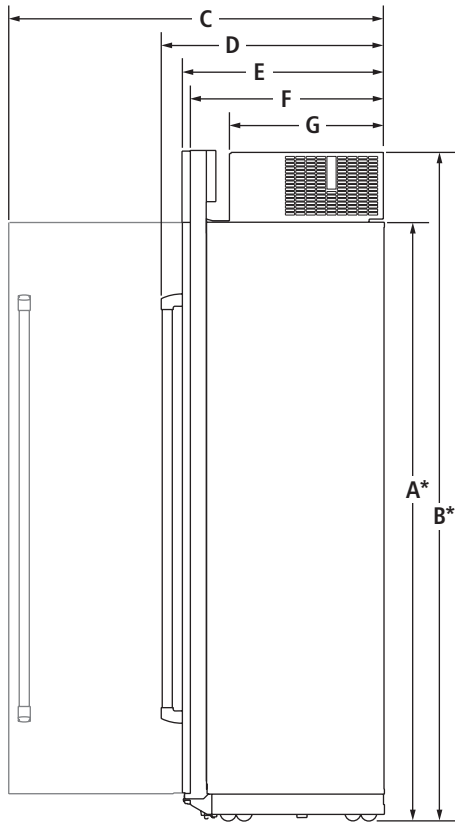

SIDE VIEW

MODEL #		JS48NFXDE	
		in	cm
A*	Height without compressor (min.)	74 ³ / ₈	188.9
B*	Height of recessed refrigerator (min.)	83 ¹ / ₈	211.1
C	Depth with refrigerator door open 90° (min.)	50 ³ / ₄	128.8
D	Depth with handles (min.)		
	Pro-Style® Stainless	27 ³ / ₈	69.5
	Euro-Style Stainless	26 ⁷ / ₈	68.3
E	Depth with doors (min.)		
	Pro-Style® Stainless panel kit	24 ³ / ₄	62.9
	Euro-Style Stainless panel kit	24 ³ / ₄	62.9
	Custom panel (3/4"/1.9 cm)	24 ³ / ₄	62.9
F	Depth without door panel kit (min.)	24	61.0
G	Depth of compressor (min.)	19 ⁷ / ₈	50.5

*Add 1¹/₄" (3.2 cm) to the height dimension when leveling legs are fully extended.**IMPORTANT:** Dimensional specifications are provided for planning purposes only.**Do not make any cutouts based on this information.** Refer to the Installation or Use & Care Guide before selecting cabinetry, verifying electrical/gas connections, making cutouts or beginning installation.

All Jenn-Air® appliances are appropriately UL, CUL or CSA approved.

48" FULLY INTEGRATED SIDE-BY-SIDE REFRIGERATOR

(BASE UNIT REQUIRES SUITE-COORDINATING PANEL KIT OR CUSTOM PANELS AND HANDLES)

JS48NXFXDE – 47³/₄" x 83¹/₈" x 24" (without door/handles)

3 STYLES FOR DOOR PANEL INSTALLATION

STANDARD INTEGRATED GRILLE INSTALLATION

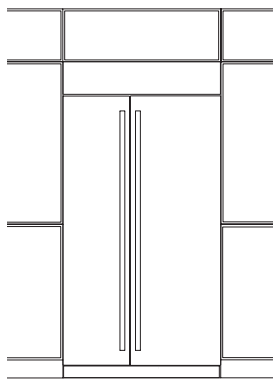

FRONT VIEW

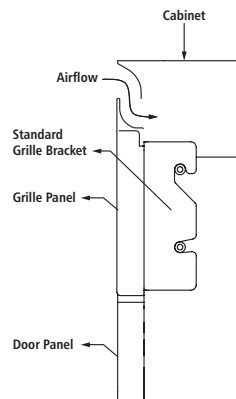

SIDE VIEW – STAINLESS STEEL
PANEL KIT

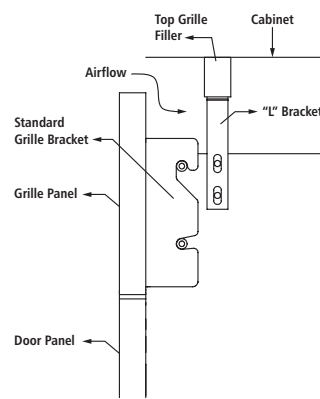

SIDE VIEW – CUSTOM PANEL
PANEL KIT

- Attach the standard custom grille with the standard grille bracket provided with the refrigerator.
- The standard grille panel height allows for an air gap critical to refrigerator performance.

FULLY INTEGRATED GRILLE INSTALLATION

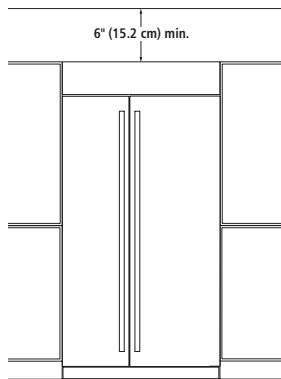

FRONT VIEW – OPEN TO CEILING
(OPTION 1)

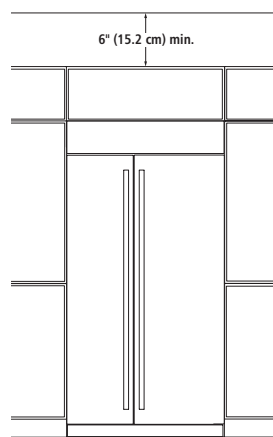

FRONT VIEW – FALSE FRONT
(OPTION 2)

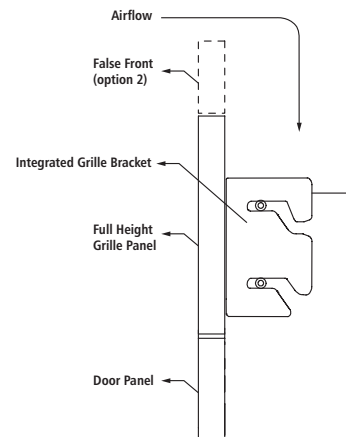

SIDE VIEW – CUSTOM PANEL

- Attach the full-height grille with the integrated grille bracket provided with the refrigerator.
- Requires a minimum of 6" (15.2 cm) of open space above the refrigerator, which must not be blocked in any way, including soffits.

ARMOIRE-STYLE INSTALLATION*

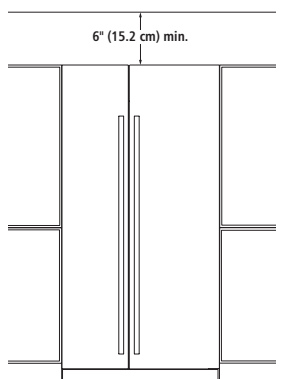

FRONT VIEW – OPEN TO CEILING
(OPTION 1)

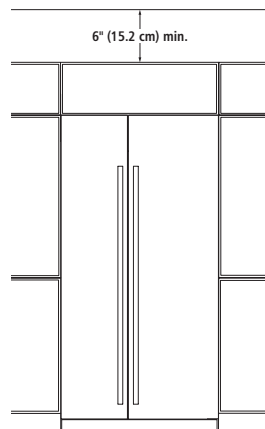

FRONT VIEW – FALSE FRONT
(OPTION 2)

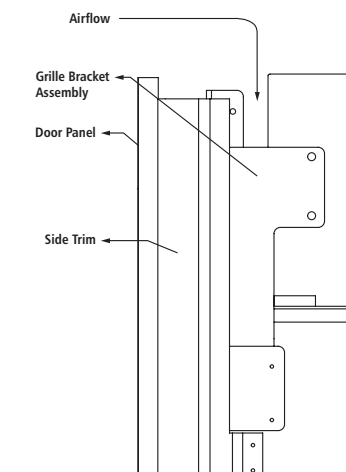

SIDE VIEW – CUSTOM PANEL

- Attach the grille bracket assembly and grille panel provided in the armoire-style panel kit.
- Requires a minimum of 6" (15.2 cm) of open space above the refrigerator, which must not be blocked in any way, including soffits.

* Refer to the Armoire Kit installation instructions for additional dimensions and installation details.

IMPORTANT: Dimensional specifications are provided for planning purposes only.

Do not make any cutouts based on this information. Refer to the Installation or Use & Care Guide before selecting cabinetry, verifying electrical/gas connections, making cutouts or beginning installation. All Jenn-Air® appliances are appropriately UL, CUL or CSA approved.

48" FULLY INTEGRATED SIDE-BY-SIDE REFRIGERATOR

(BASE UNIT REQUIRES SUITE-COORDINATING PANEL KIT OR CUSTOM PANELS AND HANDLES)

JS48NXFXDE – 47³/₄" x 83¹/₈" x 24" (without door/handles)

OPENING/CLEARANCE DIMENSIONS

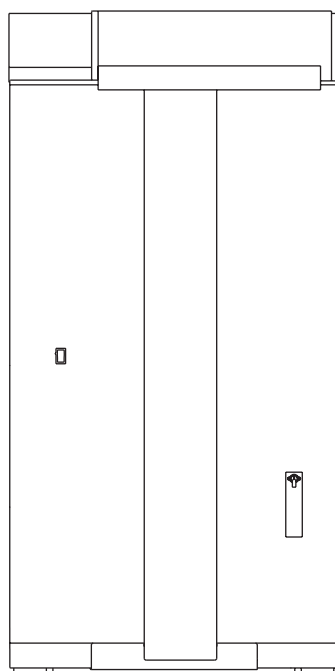
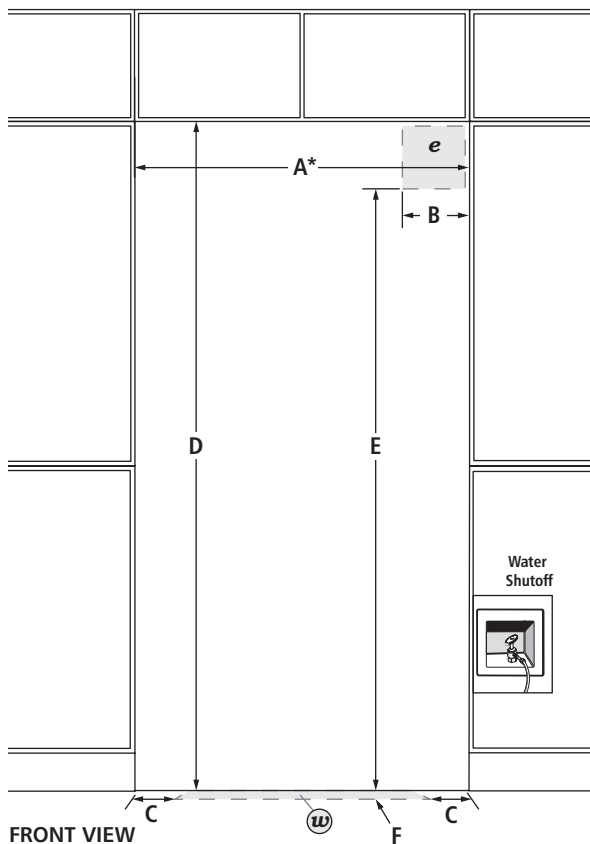

MODEL #		JS48NXFXDE	
		in	cm
A*	Width (min.)	48	121.9
B	Width of recommended electrical location	13½	34.3
C	Distance from side of cabinet to recommended water connection location	6	15.2
D	Height (min.)	84	213.4
E	Height to recommended electrical location	77	195.6
F	Depth of recommended water connection location (max.)	1	2.5
e	Recommended electrical connection location		
w	Recommended water connection location		

*Minimum width must extend behind the face of the cabinet for at least 2" (5.1 cm).

ELECTRICAL REQUIREMENTS

115 volt, 60 Hz, AC only, 15- or 20-amp fused, grounded circuit is required. A dedicated circuit is recommended. Use an outlet that cannot be turned off by a switch. Do not use an extension cord.

WATER PRESSURE REQUIREMENTS

A cold water supply with water pressure between 30 and 120 psi (207 and 827 kPa) is required to operate the ice maker. Call a licensed, qualified plumber with any questions about the water pressure.

Reverse Osmosis Water Supply

IMPORTANT: The pressure of the water coming out of a reverse osmosis system going to the water inlet valve of the refrigerator needs to be between 30 and 120 psi (207 and 827 kPa).

If a reverse osmosis water filtration system is connected to the cold water supply, the water pressure to the reverse osmosis system needs to be a minimum of 40 to 60 psi (276 to 414 kPa).

LOCATION REQUIREMENTS

Floor must be able to support refrigerator (more than 600 lb [272 kg]), door panels and contents of the refrigerator and must be at the same level as flooring in the room.

IMPORTANT: Dimensional specifications are provided for planning purposes only.

Do not make any cutouts based on this information. Refer to the Installation or Use & Care Guide before selecting cabinetry, verifying electrical/gas connections, making cutouts or beginning installation.

All Jenn-Air® appliances are appropriately UL, CUL or CSA approved.

SINGLE WALL OVENS

JJW2427I – 27" x 29-7/8" x 25-5/16"

JJW2430I, JJW3430I – 30" x 29-7/8" x 25-5/16"

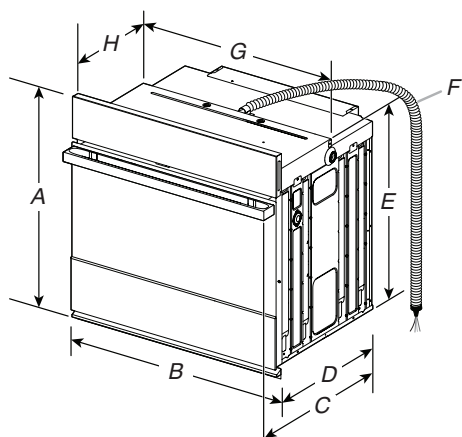

PRODUCT DIMENSIONS – SINGLE OVENS

27" (68.6 CM) MODELS

- A. 29-7/8" (75.8 cm) max. overall height
- B. 27" (68.6 cm) overall width
- C. JJW2427IM – 26-3/8" (67 cm)
JJW2427IL – 27-3/16" (69 cm)
- D. 23-1/4" (59.1 cm) max. recessed depth
- E. 27-3/16" (69 cm) recessed height
- F. 48" (121.9 cm) flexible conduit length
- G. 25-7/16" (64.6 cm) max. recessed width
- H. 12" (30.5 cm) from back of control panel to start of strain relief

30" (76.2 CM) MODELS

- A. 29-7/8" (75.8 cm) max. overall height
- B. 30" (76.2 cm) overall width
- C. JJW2430IM – 26-3/8" (67 cm)
JJW2430IL – 27-3/16" (69 cm)
JJW3430IM – 26-3/8" (67 cm)
JJW3430IL – 27-3/16" (69 cm)
- D. 23-1/4" (59.1 cm) max. recessed depth
- E. 27-3/16" (69 cm)
- F. 48" (121.9 cm) flexible conduit length
- G. 28-7/16" (72.2 cm) max. recessed width
- H. 12" (30.5 cm) from back of control panel to start of strain relief

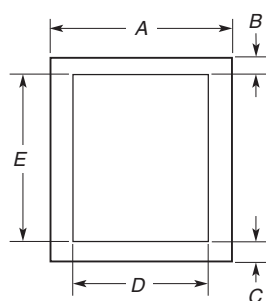

UNDERCOUNTER CABINET DIMENSIONS – SINGLE OVENS

27" (68.6 CM) MODELS

- A. 27" (68.6 cm) min. cabinet width
- B. 1-1/2" (3.8 cm) min. top of cutout to underside of countertop
- C. 5-1/4" (13.3 cm) bottom of cutout to floor
- D. 25-1/2" (64.8 cm) cutout width
- E. 28" (71.2 cm) min. cutout height

30" (76.2 CM) MODELS

- A. 30" (76.2 cm) min. cabinet width
- B. 1-1/2" (3.8 cm) min. top of cutout to underside of countertop
- C. 5-1/4" (13.3 cm) bottom of cutout to floor
- D. 28-1/2" (72.4 cm) cutout width
- E. 28" (71.2 cm) min. cutout height

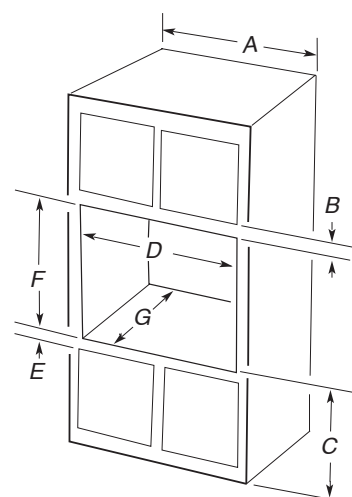

SINGLE OVENS INSTALLED IN CABINET

27" (68.6 CM) MODELS

- A. 27" (68.6 cm) min. cabinet width
- B. 2-3/16" (5.5 cm) top of cutout to bottom of upper cabinet door
- C. 32" (81.3 cm) bottom of cutout to floor
- D. 25-1/2" (64.8 cm) cutout width
- E. 1-1/2" (3.8 cm) min. bottom of cutout to top of cabinet door
- F. 28" (71.2 cm)* recommended cutout height
- G. 24" (60.7 cm) cutout depth

***NOTE:** The cutout height can be between 27-1/4" (69.2cm) and 29-7/16" (74.8 cm) for 27" single ovens.

30" (76.2 CM) MODELS

- A. 30" (76.2 cm) min. cabinet width
- B. 2-3/16" (5.5 cm) top of cutout to bottom of upper cabinet door
- C. 32" (81.3 cm) bottom of cutout to floor
- D. 28-1/2" (72.4 cm) cutout width
- E. 1-1/2" (3.8 cm) min. bottom of cutout to top of cabinet door
- F. 28" (71.2 cm)* recommended cutout height
- G. 24" (60.7 cm) cutout depth

***NOTE:** The cutout height can be between 27-1/4" (69.2 cm) and 29-7/16" (74.8 cm) for 30" single ovens.

IMPORTANT: Dimensional specifications are provided for planning purposes only.

Do not make any cutouts based on this information. Refer to the Installation or Use & Care Guide before selecting cabinetry, verifying electrical/gas connections, making cutouts or beginning installation.

All JennAir® appliances are appropriately UL, CUL or CSA approved.



SINGLE WALL OVENS

JJW2427I – 27" x 29-7/8" x 25-5/16"

JJW2430I, JJW3430I – 30" x 29-7/8" x 25-5/16"

ELECTRICAL REQUIREMENTS

If codes permit and a separate ground wire is used, it is recommended that a qualified electrical installer determine that the ground path and the wire gauge are in accordance with local codes.

Check with a qualified electrical installer if you are not sure the oven is properly grounded.

This oven must be connected to a grounded metal, permanent wiring system.

Be sure that the electrical connection and wire size are adequate and in conformance with the National Electrical Code, ANSI/NFPA 70-latest edition or CSA Standards C22.1-94, Canadian Electrical Code, Part 1 and C22.2 No. 0-M91-latest edition, and all local codes and ordinances.

A copy of the above code standards can be obtained from:

National Fire Protection Association
1 Batterymarch Park
Quincy, MA 02169-7471

CSA International
8501 East Pleasant Valley Road
Cleveland, OH 44131-5575

- Models rated from 7.3 to 9.6 kW at 240 V (5.4 to 7.4 kW at 208 V) require a separate 40 A circuit. Models rated at 4.8 kW and below at 240 V (3.6 kW and below at 208 V) require a separate 20 A circuit.
- A circuit breaker is recommended.
- Connect directly to the circuit breaker box (or fused disconnect) through flexible, armored, or nonmetallic sheathed, copper cable (with grounding wire).
- Flexible conduit from the oven should be connected directly to the junction box.
- Fuse both sides of the line.
- Do not cut the conduit. The length of conduit provided is for serviceability of the oven.
- A UL listed or CSA approved conduit connector must be provided.
- If the house has aluminum wiring, follow the procedure below: Connect the aluminum wiring using special connectors and/or tools designed and UL listed for joining copper to aluminum. Follow the electrical connector manufacturer's recommended procedure. Aluminum/copper connection must conform with local codes and industry accepted wiring practices.

For power requirements for models JJW2427I, JJW2430I and JJW3430I, refer to the following table.

	240 VAC	208 VAC
Model	kW	kW
JJW2427I	4.1	3.1
JJW2430I	4.1	3.1
JJW3430I	4.5	3.4

ELECTRICAL CONNECTION

To properly install your oven, you must determine the type of electrical connection you will be using and follow the instructions provided for it here.

- Oven must be connected to the proper electrical voltage and frequency as specified on the model/serial/rating plate. The model/serial/rating plate is located under the control panel on single ovens. See the following illustration

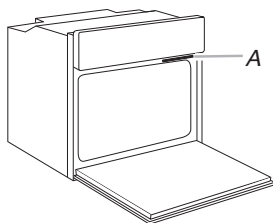

A. Model/Serial/Rating Plate

IMPORTANT: Dimensional specifications are provided for planning purposes only.

Do not make any cutouts based on this information. Refer to the Installation or Use & Care Guide before selecting cabinetry, verifying electrical/gas connections, making cutouts or beginning installation.

All JennAir® appliances are appropriately UL, CUL or CSA approved.

