

DCR PHOENIX HOMES

NEWINGTON  
OPTIONAL CHEF'S KITCHEN  
MOUNTING HEIGHT: 84

REVISED: FEB 13-19

- CABINETS - CARTIER LINE 1 & 2
- HARDWARE - STD & 1ST UPGRADE
- STANDARD WHITE INTERIOR
- METAL DRAWER BOX
- 3 PCS - 5/8" KICK - FIN. BOTH ENDS
- 3 PCS - LOOSE FILLER - 3 x 96
- 2 PCS - 90 DEG. CORNER MOULD
- 1 PCS - T-MOULD
- 1 PCS - FLAT MOULDING

42" H UPPERS @  
18" ABOVE COUNTER

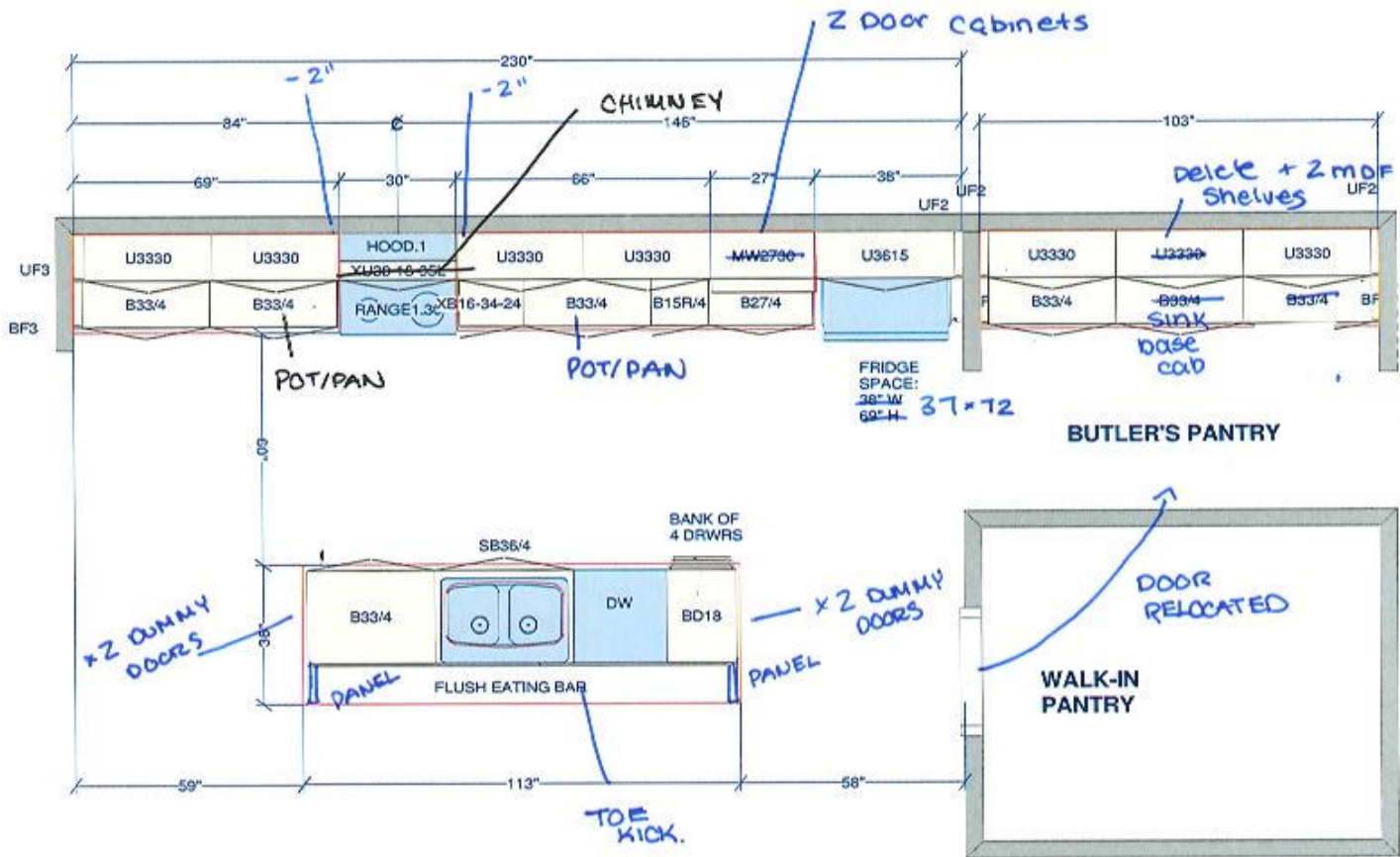

All dimensions, size designations given are subject to verification on job site and adjustment to fit job conditions.	This is an original design and must not be released or copied unless applicable fee has been paid or job order placed.	Designed: 2019-02-13 Printed: 2019-02-14	
		DRAWN BY: LORI DISAVERIO, B.I.D	
SPECTRUM KITCHEN and BATH DESIGN			
NEWINGTON - OPT. CHEF'S KITCHEN - rev Feb 13-19.kit	All	Drawing #: 1	No Scale.

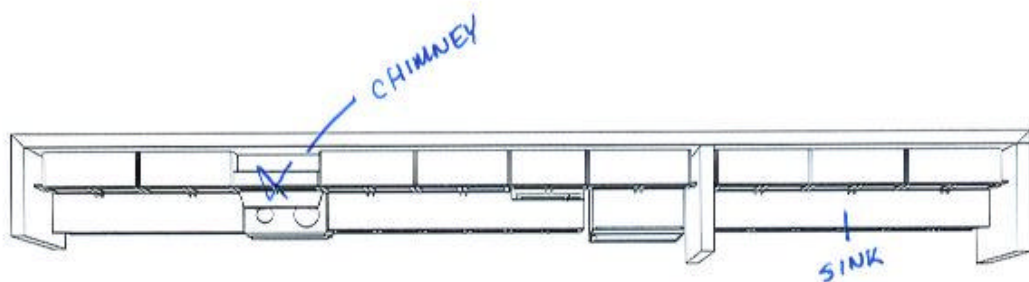

KITCHEN - TOP VIEW  
NEWINGTON - CHEF'S KITCHEN

REVISED: FEB 13-19

Note: This drawing is an artistic interpretation of the general appearance of the design. It is not meant to be an exact rendition.	Designed: 2019-02-13 Printed: 2019-02-14	
	SPECTRUM KITCHEN and BATH DESIGN	
NEWINGTON - OPT. CHEF'S	All	Drawing #: 1

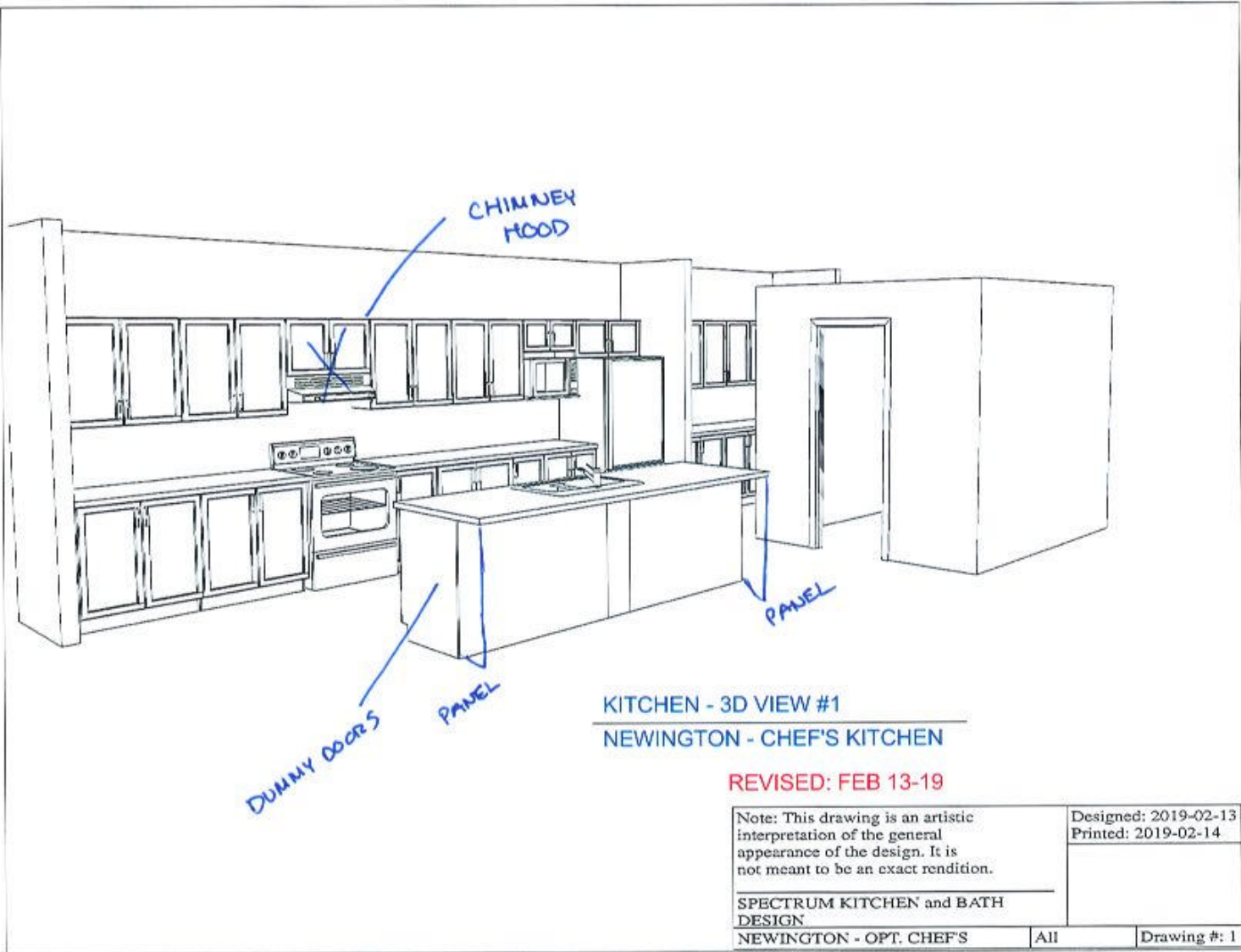

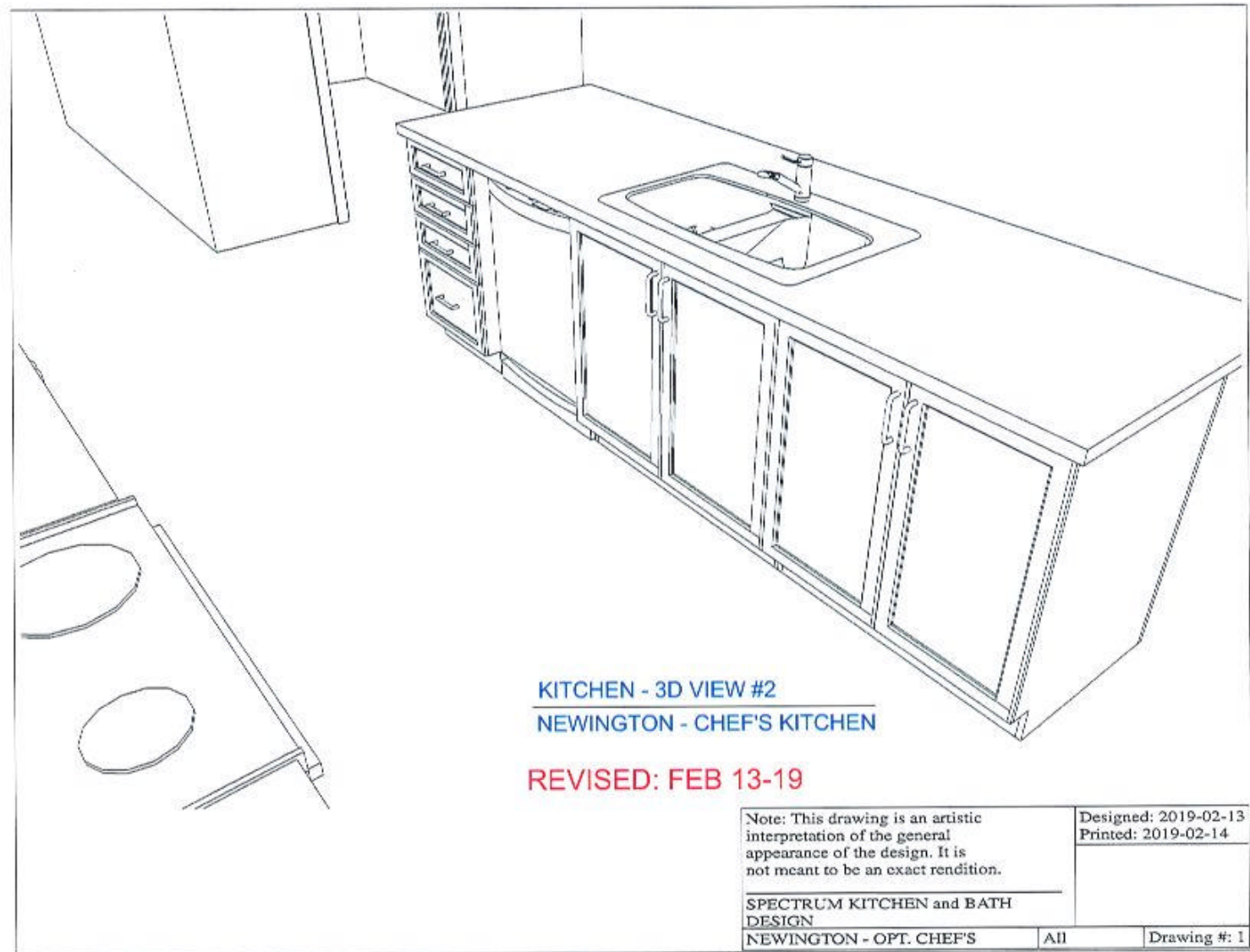

KITCHEN - 3D VIEW #2  
NEWINGTON - CHEF'S KITCHEN

REVISED: FEB 13-19

Note: This drawing is an artistic interpretation of the general appearance of the design. It is not meant to be an exact rendition.	Designed: 2019-02-13	
	Printed: 2019-02-14	
SPECTRUM KITCHEN and BATH DESIGN		
NEWINGTON - OPT. CHEF'S	All	Drawing #: 1



