



# 24" Dishwasher

## DETAILED PLANNING DIMENSIONS GUIDE

Applies to all model numbers starting with;  
MDB4949SK, MDB7959SK, MDB8959SK, MDB9959SK, MDB9979SK

### PRODUCT DIMENSIONS

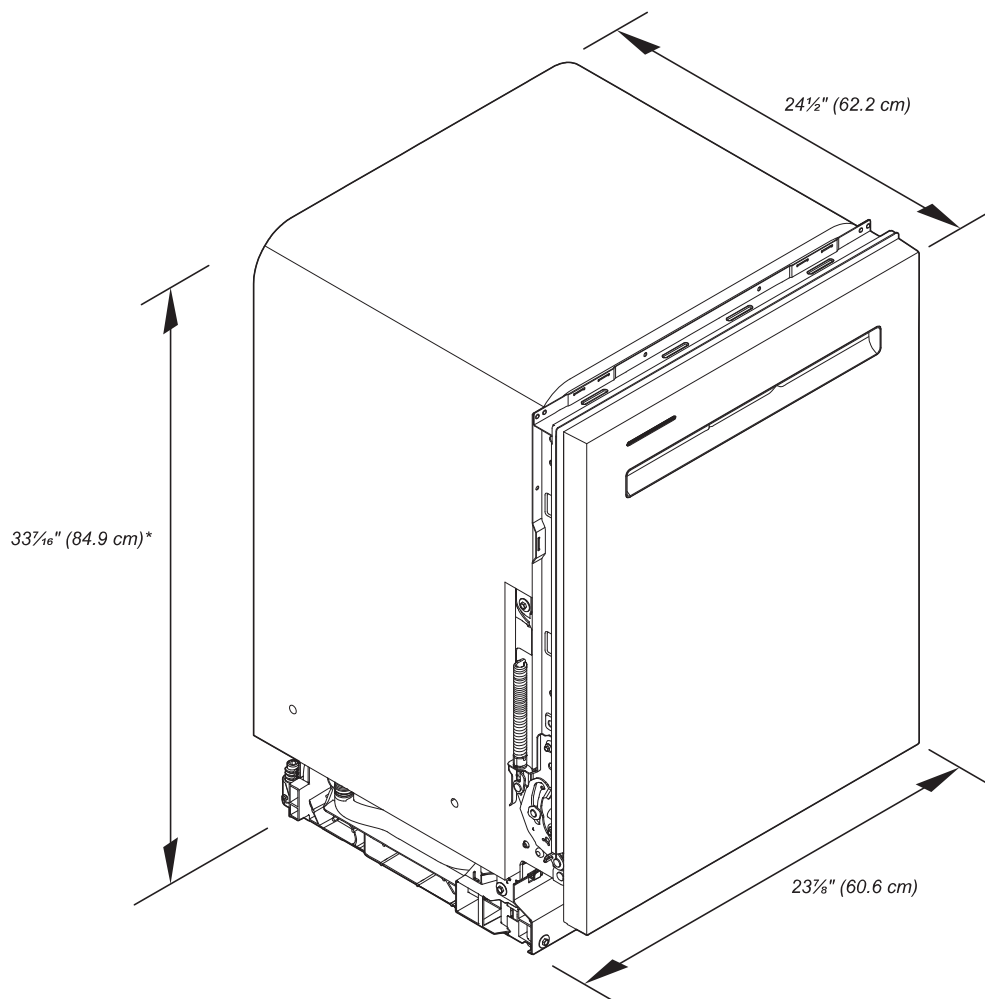

\*Dishwasher can be raised 1 1/16" (3.7 cm) with feet fully extended.

Because Whirlpool Corporation policy includes a continuous commitment to improve our products, we reserve the right to change materials and specifications without notice.

Dimensions are for planning purposes only. For complete details, see Installation Instructions packed with product. Specifications subject to change without notice.



# 24" Dishwasher

## DETAILED PLANNING DIMENSIONS GUIDE

### PRODUCT DIMENSIONS (CONTD.)

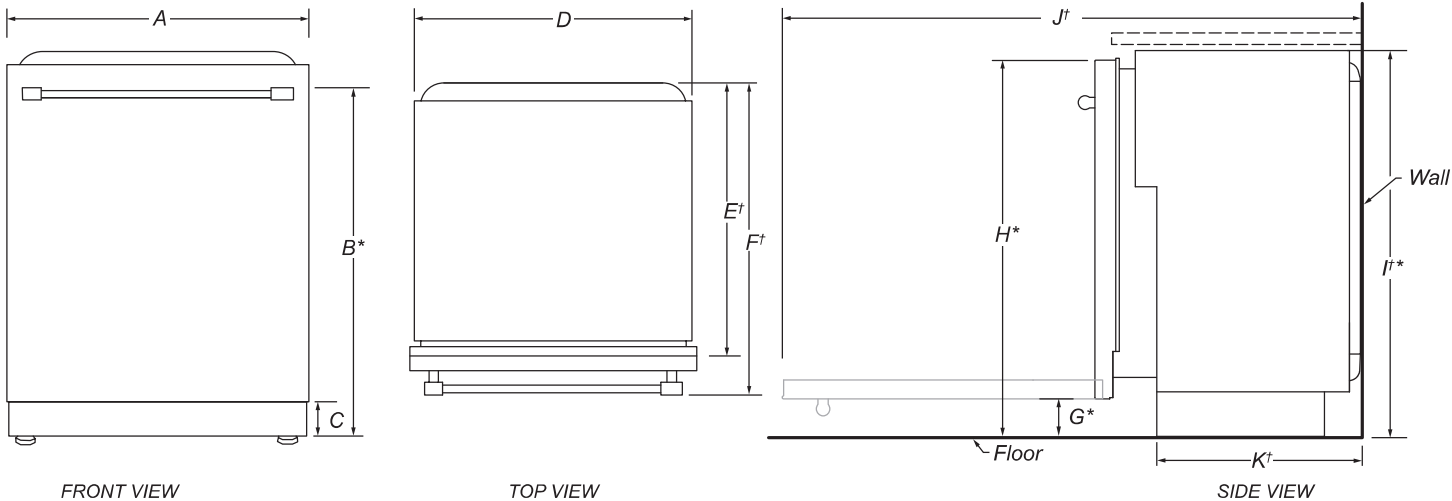

	DESCRIPTION	DIMENSIONS
A	Width of door	23 <sup>7</sup> / <sub>8</sub> " (60.6 cm)
B*	Height to top of handle	31 <sup>9</sup> / <sub>16</sub> " (80.1 cm)
C	Height of adjustable toe kick	3 <sup>1</sup> / <sub>2</sub> " (8.8 cm) - min. 4 <sup>1</sup> / <sub>4</sub> " (10.8 cm) - max.
D	Width of recessed dishwasher	23 <sup>7</sup> / <sub>8</sub> " (60.6 cm)
E†	Depth without door	22 <sup>5</sup> / <sub>8</sub> " ( 57.5 cm)
F†	Depth with Towel Bar Handle	26 <sup>15</sup> / <sub>16</sub> " (68.5 cm)
	Depth with Pocket Handle	24 <sup>1</sup> / <sub>2</sub> " (62.2 cm)
G*	Height to bottom of door (min.)	3 <sup>5</sup> / <sub>16</sub> " (8.4 cm)
H*	Height to top of door (min.)	33 <sup>7</sup> / <sub>16</sub> " (84.9 cm)
I*	Height of recessed dishwasher (min.)	33 <sup>5</sup> / <sub>8</sub> " (85.4 cm)
J†	Depth with door fully open (min.)	50 <sup>3</sup> / <sub>16</sub> " (127.4 cm)
K†	Depth with toe kick (min.)	20 <sup>13</sup> / <sub>16</sub> " (52.9 cm)

†Insulation blanket thickness adds up to 11/16" (1.8 cm) but can crush up to 1/8" (0.3 cm).

\*Dishwasher can be raised 1/16" (3.7 cm) with feet fully extended.





## 24" Dishwasher

### DETAILED PLANNING DIMENSIONS GUIDE

#### OPENING/CLEARANCE DIMENSIONS

**IMPORTANT:** Check that all surfaces have no protrusions that would prohibit dishwasher installation.

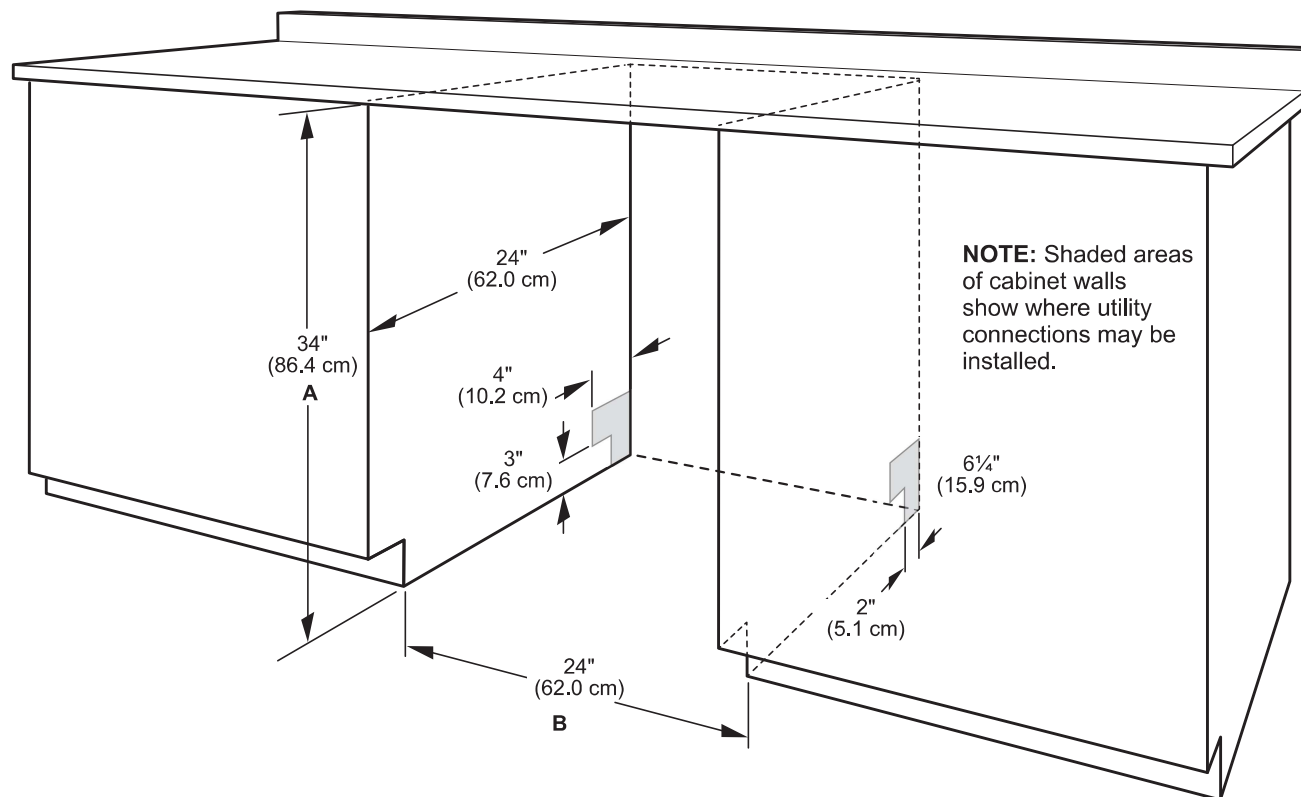

A. Measured from the lowest point on the underside of the countertop. May be reduced to 33½" (85.1 cm) by removing the wheels and perforated area of insulation (blanket) on dishwasher.

B. Minimum, measured from narrowest point of opening.

**NOTE:** Corner locations require a 2" (5.1 cm) minimum clearance between the side of the dishwasher door and the wall or cabinet.

# DVE/G45T6100P

**SAMSUNG**

## Samsung Front Load Electric/Gas Dryer with Steam Sanitize+

7.5 cu. ft. Capacity DOE



### Signature Features

#### Steam Sanitize+

- The Steam Sanitize+ cycle removes 99.9% of germs and bacteria, over 95% of pollen, and kills 100% of dust mites<sup>1</sup>. Multi-Steam Technology steams away wrinkles, odors, and static.

#### Sensor Dry

- Automatically optimizes the time and temperature of your drying cycle to protect your clothes from heat damage, while avoiding excess energy use.

#### Smart Care

- Easy troubleshooting from the convenience of your smartphone<sup>2</sup>. Smart Care interacts with your washer and dryer to perform an immediate diagnosis and offer quick solutions.

### Available Colors



Platinum (shown)



Steam Sanitize+



Sensor Dry

### Features

- Steam Sanitize+
- Sensor Dry
- Smart Care
- Interior Drum Light
- 10 Preset Drying Cycles
- 9 Additional Drying Options
- 5 Temperature Levels
- 4-Way Venting (Electric)
- 3-Way Venting (Gas)
- Reversible Tinted Door
- LED Display: Ice Blue

### Convenience

- Child Lock
- Lint Filter Indicator

### Rating



ENERGY STAR®-rated  
608 kwh/yr

<sup>1</sup>Based on internal testing and independently verified by Intertek. Individual results may vary.

<sup>2</sup>Requires Samsung Smart Washer/Dryer App. The Samsung Smart Washer/Dryer app supports Android OS 2.3.6 or later and iOS 3 or later for iPhone models. Smart Washer/Dryer app available in App Store and Play Store.

# DVE/G45T6100P

**SAMSUNG**

## Samsung Front Load Electric/Gas Dryer with Steam Sanitize+

**7.5 cu. ft. Capacity DOE**

### Installation Specifications

If the washer and dryer are installed together or the dryer alone, the closet front must have two unobstructed air openings for a combined minimum total area of 72-inch<sup>2</sup> (see stacked build below). Your washer alone does not require a specific air opening.

\*Required spacing (External exhaust elbow may require additional space.)

#### 1. Alcove or closet installation

Minimum Clearance for Closet and Alcove Installations:

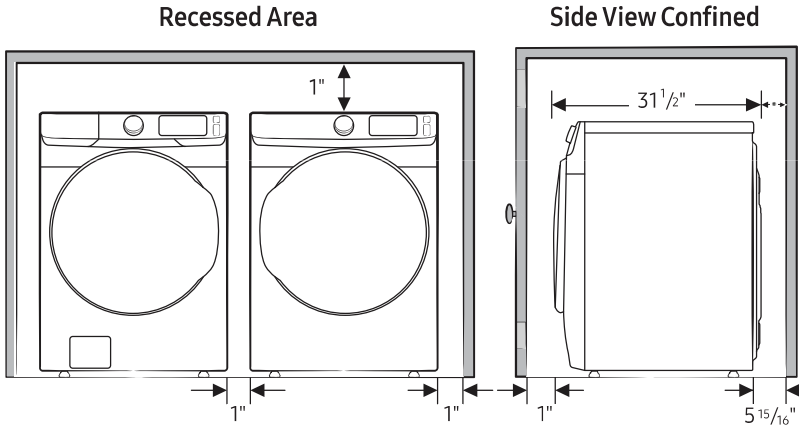

#### 2. With stacked washer and dryer

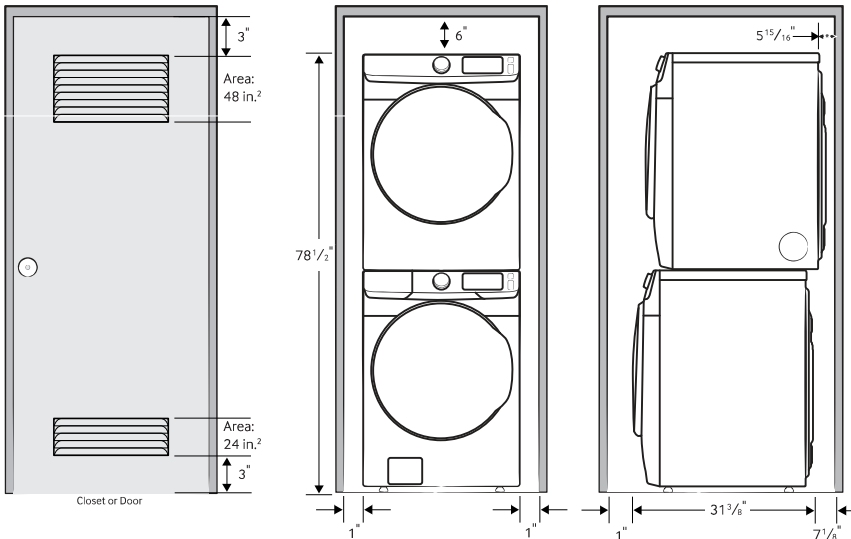

### Dimensions

Required Dimensions for Installation with Pedestal:

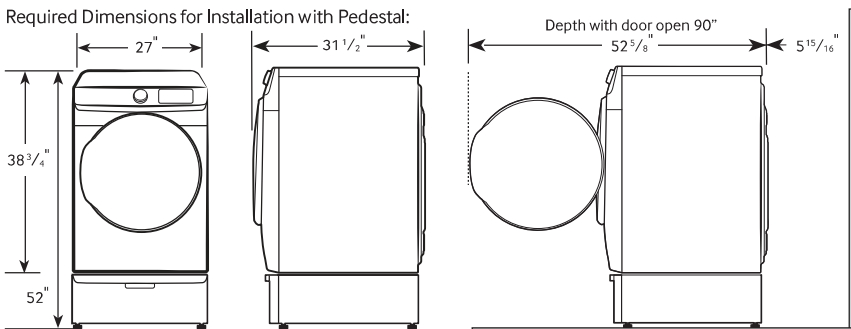

Actual color may vary. Design, specifications, and color availability are subject to change without notice. Non-metric weights and measurements are approximate.

© 2020 Samsung Electronics Canada Inc. All rights reserved. Samsung is a registered trademark of Samsung Electronics Co., Ltd., used with permission.

#### 4-Way Venting (Electric)

#### 3-Way Venting (Gas)

#### 10 Preset Drying Cycles:

Refresh, Steam Sanitize+, Normal, Heavy Duty, Permanent Press, Bedding, Delicates, Time Dry, Air Fluff, Quick Dry

#### 9 Additional Drying Options:

Damp Alert, Wrinkle Prevent, Adjust Time (Up), Adjust Time (Down), Eco Dry, Child Lock, Smart Care, Alarm Off, Drum Light

#### 5 Temperature Levels:

High, Medium High, Medium, Medium Low, Low

#### 5 Dry Levels:

More Dry, Normal-More Dry, Normal Dry, Normal-Less Dry, Less Dry

#### Warranty

One (1) Year Parts and Labor

#### Product Dimensions & Weight (WxHxD)

Dimensions: 27" x 38 3/4" x 31 1/2"

Weight: 123 lbs

#### Shipping Dimensions & Weight (WxHxD)

Dimensions: 29 3/8" x 42 9/16" x 33 1/2"

Weight: 130 lbs

#### Colour

Platinum

#### Model #

DVE45T6100P

#### UPC Code

887276390369

Platinum

DVG45T6100P

887276390390

#### Matching Washer

Platinum

WF45R6100AP

887276299464

#### Pedestal

Platinum

WE402NP

887276310138

#### Accessories

Stacking Kit

SKK-8K

887276344034

# RF23M8070SR

**SAMSUNG**

## 23 cu. ft. Counter-Depth, 4-Door French Door Refrigerator



### Signature Features

#### AutoFill Water Pitcher

- A built-in pitcher that refills with filtered water and the option to infuse with a flavor of your choice.

#### FlexZone™ Drawer

- A flexible storage drawer with four different temperature settings and an adjustable Smart Divider to stay organized.

#### Fingerprint Resistant Finish

- A special finish to reduce smudges and minimize cleaning.

### Available Colors



Fingerprint Resistant  
Stainless Steel (shown)



Fingerprint Resistant  
Black Stainless Steel



Fingerprint Resistant  
Tuscan Stainless Steel



FlexZone™ Drawer



AutoFill Water Pitcher

### Convenience

- AutoFill Water Pitcher
- FlexZone™ Drawer with 4 Temperature Settings and Smart Divider
- Wi-Fi Ready
- Adjustable Shelves for Tall Oversized Items
- Auto Pull-Out Upper Freezer Drawer
- Sabbath Mode
- Water Filter Indicator

### Design

- Counter Depth
- Fingerprint Resistant Finish
- Modern External Filtered Water and Ice Dispenser
- High Efficiency LED Lighting
- EZ-Open Handle™ on Freezer Door and FlexZone™ Drawer
- Tempered Glass Spill-Proof Shelves
- Gallon Door Bins
- Dispenser Light

### Performance

- Twin Cooling Plus®
- Ice Max - Stores up to 2.7 lbs of ice
- ENERGY STAR® Compliant
- Power Freeze and Power Cool Options
- Two Humidity-Controlled Crispers
- CoolTight Door
- Door Alarm

### Rating



ENERGY STAR® rated:  
CEE Tier 1  
633 kWh/yr

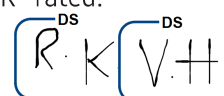

# RF23M8070SR

SAMSUNG

## 23 cu. ft. Counter-Depth, 4-Door French Door Refrigerator

### Installation Specifications

1. Measure the height, width and depth of the opening, making sure to include baseboards, molding tile, countertop overhang, etc. Check to be sure there is enough room to open the door (consider walls, islands or other obstacles when measuring).
2. Refer to illustration below to determine dimensions.
3. Allow 2.5" of clearance on hinge side of refrigerator when installing next to a wall where handle may make contact.
4. Allow 1" minimum clearance at rear for proper air circulation and water/electrical connections. Allow a 3/8" minimum clearance at sides and top for ease of installation.
5. Ensure each door and entryway in the home is wide enough for the refrigerator to be moved through easily.

For optimal usage and to be able to open refrigerator doors completely, do not install next to a wall.

Please note: The following dimension and cutout information is for planning purposes only. For complete installation details, consult manual packed with product, or download manual online at [samsung.com](http://samsung.com).

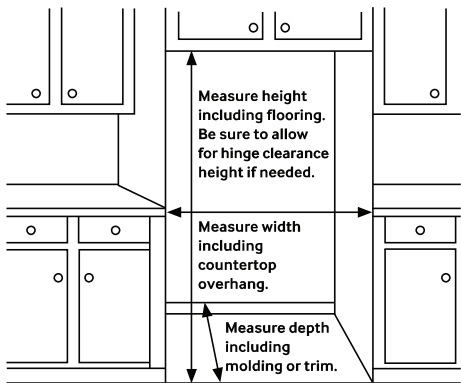

### Dimensions

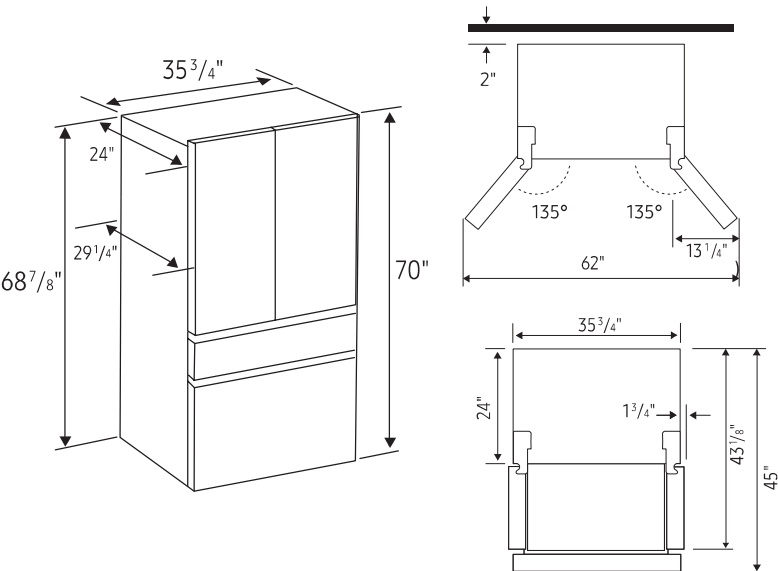

**Total Capacity: 22.6 cu. ft.**

**Refrigerator: 12.9 cu. ft.**

- 2 Humidity-Controlled Crispers
  - 1 Slide-In
  - 1 Foldable Half
  - 2 Fixed
  - 1 Full-Width Glass Shelf on Crisper
- 7 Door Bins
  - Right Door: 3 Gallon Bins
  - Left Door: 4 Regular Bins
- High Efficiency LED Lighting

**FlexZone™ Drawer: 3.1 cu. ft.**

- 4 Temperature Zones with Smart Divider
  - Meat/Fish (29°F)
  - Cold Drinks (33°F)
  - Deli/Snacks (37°F)
  - Wine/Party Dishes (42°F)

**Freezer: 6.6 cu. ft.**

- 1 Drawer Divider
- High Efficiency LED Lighting

### Warranty

One (1) Year Parts and Labor on Refrigerator  
Five (5) Years Parts and Labor on Sealed Refrigeration System Only\*  
Ten (10) Years Parts and Five (5) Years Labor on Digital Inverter Compressor

\*Compressor, evaporator, condenser, drier and connecting tubing.

### Product Dimensions & Weight

Dimensions (WxHxD with hinges, handles and doors):  
35 3/4" x 70" x 29 1/4"

Dimensions (WxHxD without hinges and door):  
35 3/4" x 68 7/8" x 24"

Dimensions (WxHxD with hinge and door, no handle):  
35 3/4" x 70" x 29 1/4"

Weight: 342 lbs

### Shipping Dimensions & Weight (WxHxD)

Dimensions: 38 1/4" x 75 3/4" x 31 1/4"

Weight: 366 lbs

Color	Model #	UPC Code
Fingerprint Resistant Stainless Steel	RF23M8070SR/AA	887276192604
Fingerprint Resistant Black Stainless Steel	RF23M8070SG/AA	887276192598
Fingerprint Resistant Tuscan Stainless Steel	RF23M8070DT/AA	887276355139

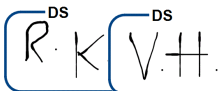



(https://www.canadianappliance.ca/air-

miles)

Showrooms

Find a product...

▼ Categories

**Boxing Day Sales Start NOW! Shop In Store, For Lower Prices Than On Website:\*** [Info >>](#)

**BOXING DAY: BUNDLE & SAVE UP TO 25% OFF\* -** Save **HUGE** on Microwave Combinations!\*

**Chat + In Store Only**

[Info >>](#)

Home (https://www.canadianappliance.ca/) > Microwaves (https://www.canadianappliance.ca/Microwave-Ovens-20/) > Countertop Microwaves (https://www.canadianappliance.ca/Microwave-Ovens-20/Countertop-Microwaves-102/) > Panasonic (https://www.canadianappliance.ca/Panasonic/Microwave-Ovens-20/Countertop-Microwaves-102/)

**Panasonic**

Availability: Ontario ▼ - ① \*7-20 Business Days

(https://www.canadianappliance.ca/Panasonic-Appliances-Canada-B615/)

Panasonic NNSD765S

Authorized Dealer

Panasonic NNSD765S Countertop Microwave, 1.6 cu. ft. Capacity, 1200W Watts, 20 inch Exterior Width, Stainless Steel colour

Up to 3 years  
FREE extended  
warranty!

i



Description & Features

Specs

Manuals

Video

Reviews

Rebates

Warranty

Financing

Install

FAQ



Install ([https://www.canadianappliance.ca/product/Panasonic\\_NNSD765S\\_Countertop\\_Microwaves\\_Panasonic\\_NNSD765S.html#tab-inst...](https://www.canadianappliance.ca/product/Panasonic_NNSD765S_Countertop_Microwaves_Panasonic_NNSD765S.html#tab-inst...))

FAQ ([https://www.canadianappliance.ca/product/Panasonic\\_NNSD765S\\_Countertop\\_Microwaves\\_Panasonic\\_NNSD765S.html#tab-faq](https://www.canadianappliance.ca/product/Panasonic_NNSD765S_Countertop_Microwaves_Panasonic_NNSD765S.html#tab-faq))

Panasonic NNSD765S Countertop Microwave, 1.6 cu. ft. Capacity, 1200W Watts, 20 inch Exterior Width, Stainless Steel colour

Family Size Genius® Cyclonic Inverter® Microwave Oven  
NN-SD765S

New Cyclonic Inverter Technology

Microwaves in 3D Cyclonic Wave Technology evenly distributes energy throughout the entire cavity and heats any size or shape of food evenly.

Defrosting

Reheating Beverages

Cyclonic Inverter® technology uses 3D waves for more efficient cooking

New 6 digit LCD / Green

Dial and button control panel

1.6 cu. ft.

1200 Watts

Auto cook / reheat

Genius® Sensor Reheat

Genius® Sensor Cook with 19 categories

Inverter® Turbo Defrost

Popcorn Key

Keep Warm (up to 30 minutes)

Child Safety Lock

Optional Trim Kit Available

Exterior Dimensions (W x D x H): 555 x 506 x 304 mm / 21.9 x 19.9 x 12 inch

Compatible with trimkit(s): NNTK714SS, NNTK722S, NNTK732S

~~\$200~~



UPC: 885170233560

Description & Features

Specs

Manuals

Video

Reviews

Rebates

Panasonic  
NN-SD765S

Warranty

Financing

Install

FAQ



## 30" (76.2 cm) Freestanding Gas Range

### PRODUCT MODEL NUMBERS

MGT8655X	MGT8775X	MGT8820D
MGT8720D	MGT8800F	MGT8885X

### GAS SUPPLY REQUIREMENTS

#### Gas supply line:

- Provide a gas supply line of  $\frac{3}{4}$ " (1.9 cm) rigid pipe to the range location. A smaller size pipe on longer runs may result in insufficient gas supply. With LP gas, piping or tubing size can be  $\frac{1}{2}$ " (1.3 cm) minimum. Usually, LP gas suppliers determine the size and materials used in the system.

**NOTE:** Pipe-joint compounds that resist the action of LP gas must be used. Do not use TEFLON<sup>†</sup> tape.

#### Flexible metal appliance connector:

- If local codes permit, a new CSA design-certified, 4 to 5 ft (122 to 152.4 cm) long,  $\frac{1}{2}$ " (1.3 cm) or  $\frac{3}{4}$ " (1.9 cm) I.D., flexible metal appliance connector may be used for connecting range to the gas supply line.



- A  $\frac{1}{2}$ " (1.3 cm) male pipe thread is needed for connection to the female pipe threads of the inlet to the appliance pressure regulator.
- Do not kink or damage the flexible metal tubing when moving the range.
- Must include a shut-off valve:  
The supply line must be equipped with a manual shut-off valve. This valve should be located in the same room but external to the range opening, such as an adjacent cabinet. It should be in a location that allows ease of opening and closing. Do not block access to shut-off valve. The valve is for turning on or shutting off gas to the range.

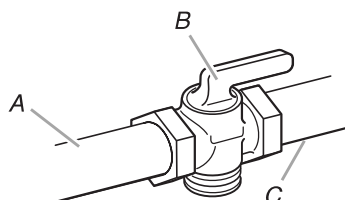

A. Gas supply line  
B. Shut-off valve "open" position  
C. To range

### Gas Pressure Regulator

The gas pressure regulator supplied with this range must be used. The inlet pressure to the regulator should be as follows for proper operation:  
Natural gas:

Minimum pressure: 5" WCP

Maximum pressure: 14" WCP

LP gas:

Minimum pressure: 11" WCP

Maximum pressure: 14" WCP

Contact local gas supplier if you are not sure about the inlet pressure.

### PRODUCT DIMENSIONS

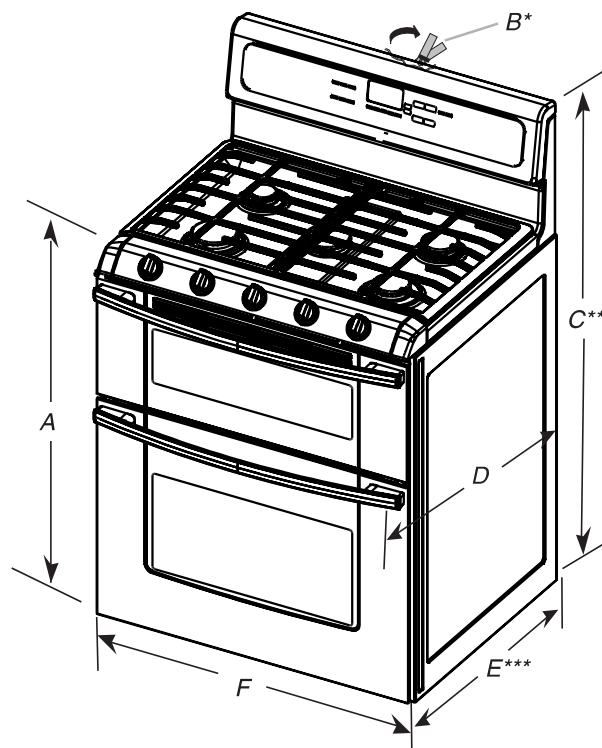

- A.  $35\frac{3}{4}" \pm \frac{1}{8}"$  (90.8  $\pm$  0.3 cm) cooktop height (minimum) with leveling legs screwed all the way in
- B. Model/serial/rating plates (located behind the control panel)\*
- C.  $47\frac{1}{8}" \pm \frac{1}{8}"$  (119.7  $\pm$  0.3 cm) overall height (minimum) with leveling legs screwed all the way in\*\*
- D.  $28\frac{1}{2}" \pm \frac{1}{4}"$  (72.4  $\pm$  0.6 cm) depth with handle
- E.  $26\frac{1}{8}"$  to  $27\frac{1}{4}" \pm \frac{1}{8}"$  (66.4  $\pm$  0.3 cm)\*\*\*
- F.  $29\frac{15}{16}" \pm \frac{1}{16}"$  (76.0  $\pm$  0.2 cm) width

\* Model/serial/rating plates may be rotated up from behind the control panel for viewing from the front of the range.

\*\* Range can be raised approximately 1" (2.5 cm) by adjusting the leveling legs.

\*\*\*Excludes handle. Dimension given is from wall to front of oven door and will vary based on electrical outlet receptacle installation.

### Type of Gas

#### Natural gas:

This range is factory set for use with Natural gas. See "Gas Conversions" section. The model/serial rating plate located behind the control panel has information on the types of gas that can be used. If the types of gas listed do not include the type of gas available, check with the local gas supplier.

#### LP gas conversion:

Conversion must be done by a qualified service technician. No attempt shall be made to convert the appliance from the gas specified on the model/serial rating plate for use with a different gas without consulting the serving gas supplier. See "Gas Conversions" section.

<sup>†</sup>TEFLON is a registered trademark of Chemours



## ELECTRICAL REQUIREMENTS

**IMPORTANT:** The range must be electrically grounded in accordance with local codes and ordinances, or in the absence of local codes, with the National Electrical Code, ANSI/NFPA 70 or Canadian Electrical Code, CSA C22.1.

If codes permit and a separate ground wire is used, it is recommended that a qualified electrical installer determine that the ground path is adequate.

- A 120 volt, 60 Hz., AC only, 15-amp fused, electrical circuit is required. A time-delay fuse or circuit breaker is also recommended. It is recommended that a separate circuit serving only this range be provided.
- Electronic ignition systems operate within wide voltage limits, but proper grounding and polarity are necessary. Check that the outlet provides 120-volt power and is correctly grounded.

## CABINET OPENING DIMENSIONS

Cabinet opening dimensions shown are for 25" (64.0 cm) countertop depth, 24" (61.0 cm) base cabinet depth and 36" (91.4 cm) countertop height.

**IMPORTANT:** If installing a range hood or microwave hood combination above the range, follow the range hood or microwave hood combination installation instructions for dimensional clearances above the cooktop surface.

Range may be installed with zero clearance to combustible construction at the rear and on the sides below the cooktop.

- A. 18" (45.7 cm) upper cabinet to countertop
- B. 13" (33.0 cm) upper cabinet depth
- C. 30" (76.2 cm) min. opening width
- D. For minimum clearance to the top of the cooktop, see NOTE.
- E. 30" (76.2 cm) min. opening width
- F. 3" (7.6 cm) min. clearance from both sides of the range to the side wall or other combustible material.
- G. Cabinet door or hinges should not extend into the cutout.
- H. 3" (7.6 cm) distance from wall
- I. 1½" (3.8 cm) min. from right side cabinet
- J. 8" (20.3 cm) width
- K. 7" (17.8 cm) min. from floor
- L. 2" (5.1 cm) min. from floor

\* Drill on centerline 1¼" (3.1 cm) from rear wall for gas supply line.

\*\* Gas lines must be installed within the shaded area to ensure proper alignment of this oven with cabinets.

\*\*\*Electrical plugs must be installed within the shaded area to ensure proper alignment of this oven with cabinets.

**NOTE:** 24" (61.0 cm) minimum when bottom of wood or metal cabinet is covered by not less than ¼" (0.64 cm) flame retardant millboard covered with not less than No. 28 MSG sheet steel, 0.015" (0.4 mm) stainless steel, 0.024" (0.6 mm) aluminum or 0.020" (0.5 mm) copper.

30" (76.2 cm) minimum clearance between the top of the cooking platform and the bottom of an uncovered wood or metal cabinet.

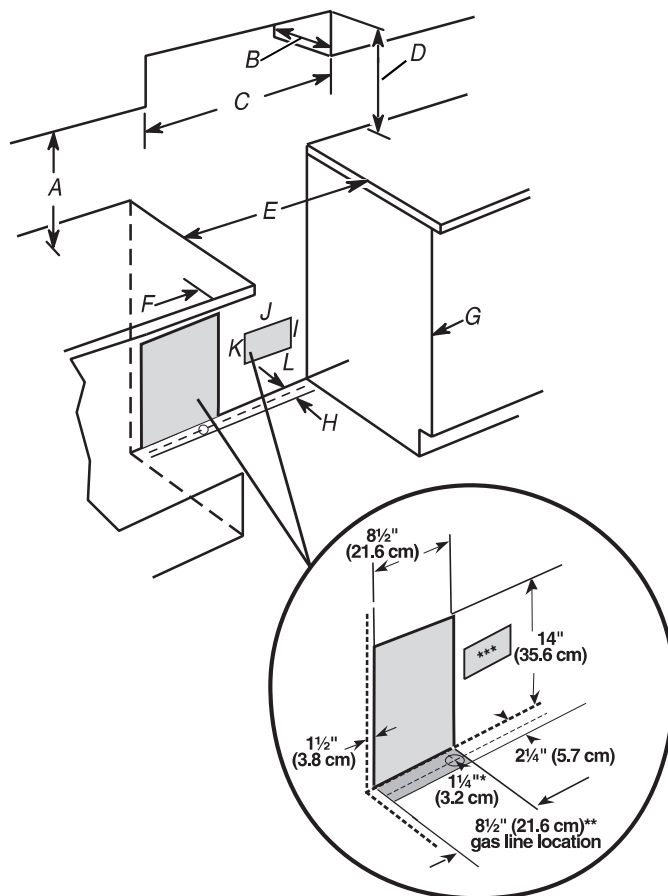

# WF45R6100AP

**SAMSUNG**

## Samsung Front Load Washer with Steam

**4.5 cu. ft. Capacity DOE**

### Signature Features

#### Steam

- Powerful stain removal without pretreatment, while still gentle on your clothing.

#### Self Clean+

- Keeps your washer drum fresh and clean by eliminating 99% of bacteria<sup>1</sup>. Will also send a reminder to clean the drum every forty wash cycles.

#### Smart Care

- Easy troubleshooting from the convenience of your smartphone<sup>2</sup>. Smart Care interacts with your washer and dryer to perform an immediate diagnosis and offer quick solutions.

### Available Colors

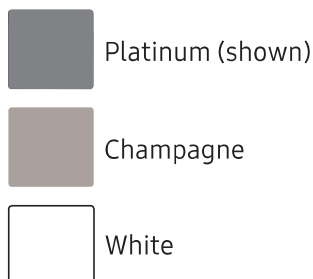

Steam



Self Clean+

### Features

- Steam
- Self Clean+
- Smart Care
- VRT Plus™ Technology
- Swirl+ Drum Design
- Closet-Depth Fit<sup>3</sup>
- Stackability
- Internal Water Heater
- 1200 RPM Maximum Spin Speed
- Direct Drive Motor
- 10 Preset Washing Cycles
- 7 Additional Washing Options
- 5 Temperature Levels
- LED Display: Ice Blue
- 24-Hour Delay End

### Convenience

- Child Lock
- Delay End
- Dispenser Trays: Main Wash, Softener, Bleach

**ADA Compliant<sup>4</sup>**

### Rating



ENERGY STAR®-rated  
CEE Tier 2  
IMEF = 2.92  
IWF = 2.9



<sup>1</sup>Based on testing by Intertek of the Self Clean+ cycle on the WF6000R.

<sup>2</sup>Requires Samsung Smart Washer/Dryer App. The Samsung Smart Washer/Dryer app supports Android OS 2.3.6 or later and iOS 3 or later for iPhone models. Smart Washer/Dryer app available in App Store and Play Store.

<sup>3</sup>Designed to fit a 40" installation depth.

<sup>4</sup>ADA Compliant when using a Samsung 27" wide riser (WE272NV or WE272NW).

# WF45R6100AP

**SAMSUNG**

## Samsung Front Load Washer with Steam

4.5 cu. ft. Capacity DOE

### Installation Specifications

If the washer and dryer are installed together or the dryer alone, the closet front must have two unobstructed air openings for a combined minimum total area of 72-inch<sup>2</sup> (see stacked build below). Your washer alone does not require a specific air opening.

\*Required spacing (External exhaust elbow may require additional space.)

#### 1. Alcove or closet installation

Minimum Clearance for Closet and Alcove Installations:

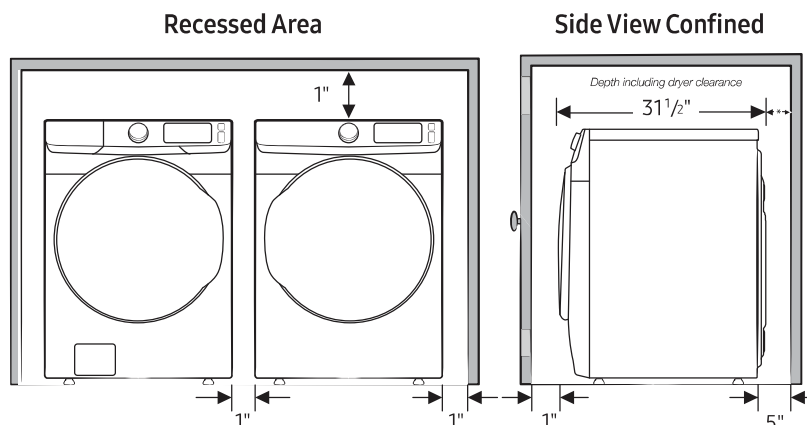

#### 2. With stacked washer and dryer

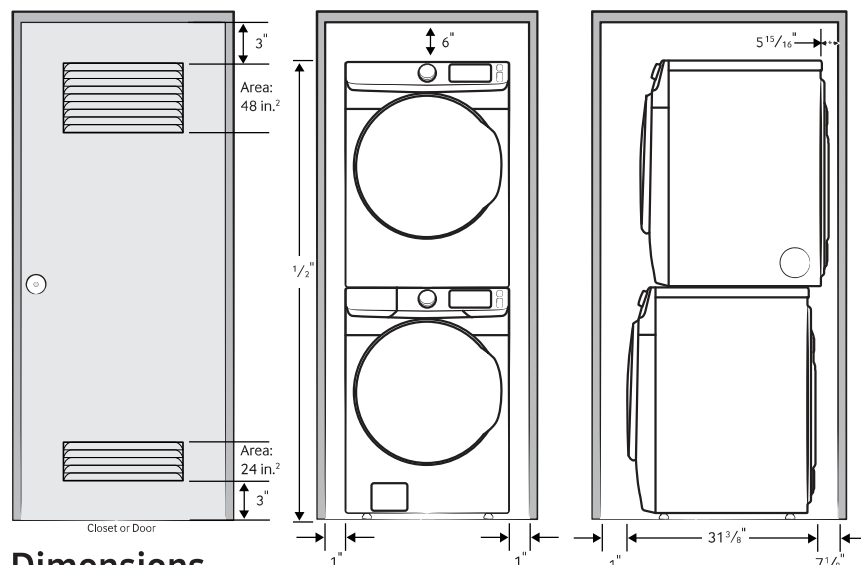

### Dimensions

Required Dimensions for Installation with Pedestal:

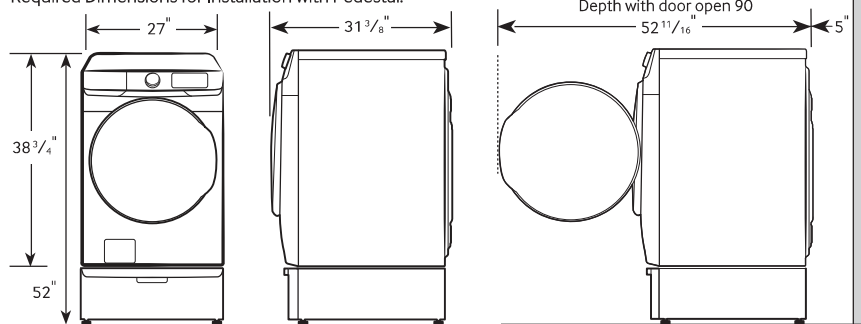

Actual color may vary. Design, specifications, and color availability are subject to change without notice. Non-metric weights and measurements are approximate.

©2019 Samsung Electronics America, Inc., 85 Challenger Road, Ridgefield Park, NJ 07660. Tel: 800-SAMSUNG. samsung.com. Samsung is a registered trademark of Samsung Electronics Co., Ltd.

#### 10 Preset Washing Cycles:

Normal, Heavy Duty, Bedding, Quick Wash, Permanent Press, Delicates, Whites, Sanitize, Rinse and Spin, Self Clean+

#### 7 Additional Washing Options:

Presoak, Steam, Delay End, Alarm Off, Child Lock, Smart Care, Spin Only

#### 5 Temperature Levels:

Hot, Warmer, Warm, Cool, Cold

#### 5 Spin Speeds:

High, Medium High, Medium, Low, No Spin

#### 5 Soil Levels:

Heavy, Medium Heavy, Normal, Medium Low, Light

#### Dispenser Trays:

Main Wash, Softener, Bleach

#### Warranty

One (1) Year Parts and Labor  
Three (3) Years Stainless Steel Drum (Part Only)  
Ten (10) Years Direct Drive Motor (Part Only)

#### Product Dimensions & Weight (WxHxD)

Dimensions: 27" x 38 3/4" x 31 3/8"  
Weight: 201 lbs

#### Shipping Dimensions & Weight (WxHxD)

Dimensions: 29 3/8" x 42 3/8" x 34 1/8"  
Weight: 205 lbs

Color	Model #	UPC Code
Platinum	WF45R6100AP	887276299464
Champagne	WF45R6100AC	887276305295
White	WF45R6100AW	887276299471

#### Matching Dryer (Electric/Gas)

Platinum	DVE45R6100P	887276300443
Champagne	DVE45R6100C	887276305943
White	DVE45R6100W	887276300450

Platinum	DVG45R6100P	887276300481
Champagne	DVG45R6100C	887276305271
White	DVG45R6100W	887276300498

#### Pedestal

Platinum	WE402NP	887276310138
Champagne	WE402NC	887276310121
White	WE402NW	887276310152

#### Accessories

Stacking Kit	SKK-7A	887276146423
--------------	--------	--------------



# SC(B)322 | PRO Collection



## Features

- Wall mount range hood
- 6" round duct adapter
- Non-stick aluminum fan blades
- 3 speed push button control
- 2 LED lights (2 x 1.4W, 4000K)
- Quick release aluminum mesh filters
- Standard chimney fits up to 9 ft. ceiling
- Up to 9 minutes time-delay OFF feature
- Plug-in connection

SC(B)32230  
SC(B)32236

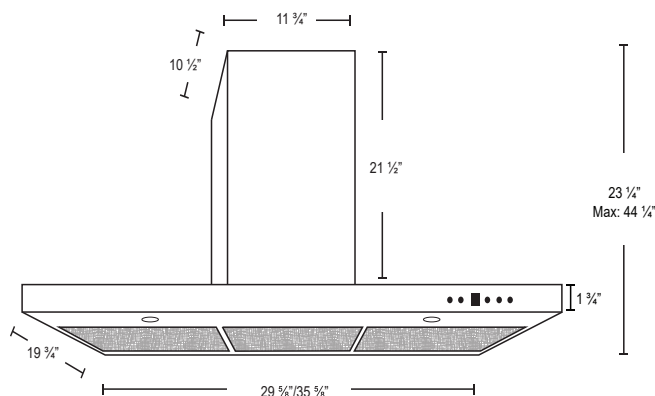

FRONT

SC(B)32224

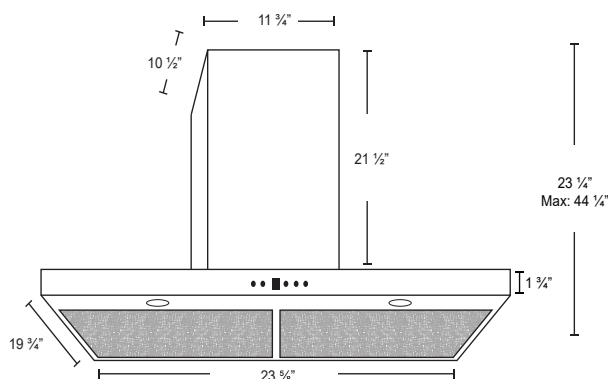

FRONT

## Options

- Filters:
  - SC322 - Quick Release Aluminum Mesh Filters
  - SCB322 - Quick Release Stainless Steel Baffle Filters
- Chimney Flues:
  - B2.CH16 - short (7'-8' ceilings)
  - B2.CH22 - standard (8'-9' ceilings)
  - B2.CH32 - extended (9'-11' ceilings)
- Widths: 24", 30", 36"

## Specifications

- |  |  |  |
|--|--|--|
| <ul style="list-style-type: none"> <li>▪ Air Flow Volume: 300 CFM</li> <li>▪ Electrical Connection: 120 V/60 Hz</li> <li>▪ Power Consumption: 300 Watts</li> </ul> | <ul style="list-style-type: none"> <li>▪ Current: 2.5 Amps</li> <li>▪ Fan Speed: 1350 RPM</li> <li>▪ Fan Type: Centrifugal Blower</li> </ul> | <ul style="list-style-type: none"> <li>▪ Finishes: Stainless Steel</li> <li>▪ Ducting: 6" Round</li> <li>▪ Noise Level: Min. 2 Sones<br/>Max. 4 Sones</li> </ul> |
|--|--|--|

