

PW 155

Exhibit 6032 IFS

Model number: 105520

Dimensions: 60" x 32" x 18"      Installation: Alcove      Material: Acrylic

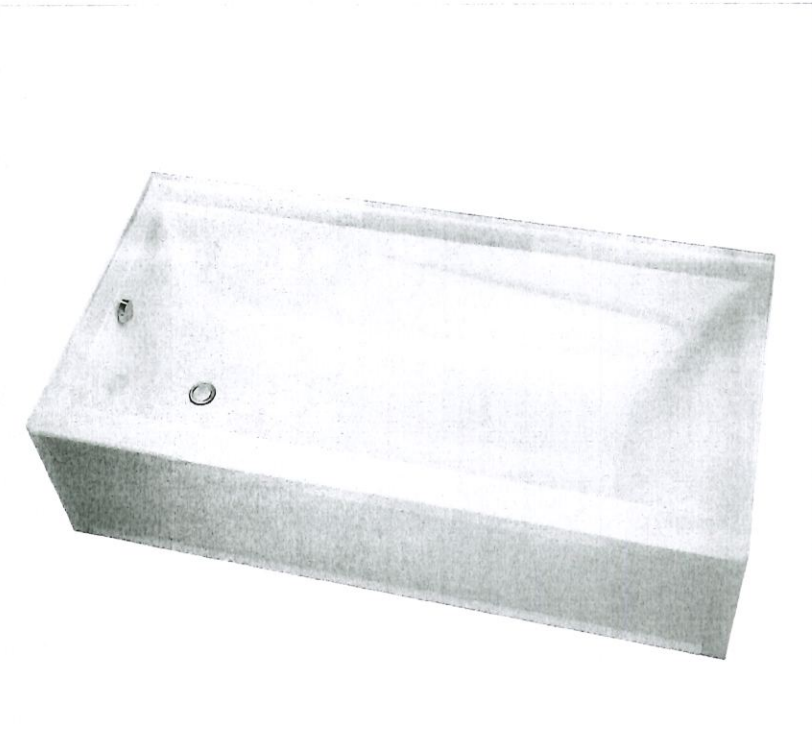

Standard Features:

- Rectangular shape bathtub in alcove installation
- Available in Above-the-Floor Rough (AFR) or not
- Minimalist look with discreet armrests and textured floor
- Integrated tiling flange
- Integrated skirt with access panel when equipped with a system

Product characteristics:

- Made in North America
- Elegant design
- Integrated Tiling Flange and Skirt

Systems:

- Whirlpool
- Combined Whirlpool/Aeroeffect
- Aeroeffect

Warranty:

25 Years

Standard colors:

White (001)

Bone (004)

Biscuit (007)

Certifications

MAAX products adhere to one or more of the following certifications:

UL

ICC

ES

PMG

Recommended products (Visit our website for a complete list of our recommended doors)

No	Description
139398	Halo Sliding Tub Door 56 1/2-59 x 59 in. 8 mm
135330	Incognito 57 Shaker Sliding Tub Door 56-59 x 56 3/4 in. 8 mm
139351	Incognito 57 Sliding Tub Door 56-59 x 56 3/4 in. 6 mm

Options (Visit our website for a complete list of our options)

No	Description
<input type="checkbox"/> OPT 10019	Removable access panel
<input type="checkbox"/> OPT 10053	Chromatherapy
<input type="checkbox"/> OPT 10095	Water heater assembly
<input type="checkbox"/> OPT 10106	Metal trim kit for whirlpool and combined systems
<input type="checkbox"/> OPT 20029	Metal trim kit for Air Push Control



PW 155

Exhibit 6032 IFS

Model number: 105520

Dimensions: 60" x 32" x 18"

Installation: Alcove

Material: Acrylic

Dimensions:

59 3/4 x 32 x 17 3/4 in.  
(1518 x 813 x 451 mm)

Water capacity:

46 gallons - 173 liters

Weight:

78 lbs - 35.37 kg

Bathing well:

53 1/4 X 25 7/8 in.  
(1353 X 657 mm)

Deep sump height:

16 1/4 in. - 413 mm

Deck width:

4 1/8 in. - 105 mm

Drain location:

Left

Right

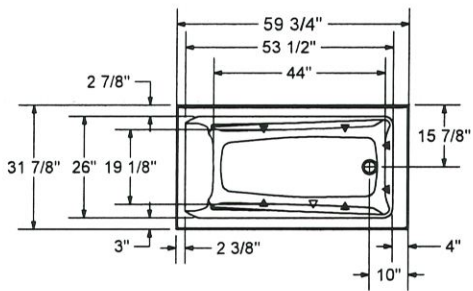

1" Single Integrated tiling  
flange (shown)  
2" Double Integrated tiling  
flange (not shown)  
Drop-in model (Shown)

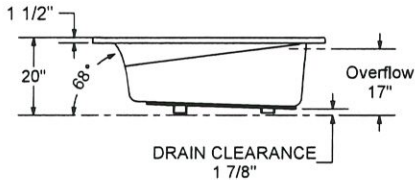

Wood support design may vary.  
Single Integrated tiling flange: 1" height x 1/4" thickness (shown)  
Double Integrated tiling flange: 2" height (not shown)  
All dimensions are approximate.  
Structure measurement must be verified against the unit to ensure proper fit.

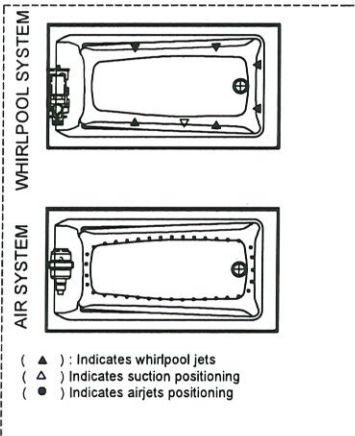

Project: \_\_\_\_\_

Contractor: \_\_\_\_\_

Representative: \_\_\_\_\_

Date: \_\_\_\_\_

Tel: \_\_\_\_\_

Notes: \_\_\_\_\_

\_\_\_\_\_

\_\_\_\_\_

PW 155-MAIN HOUSE

falmec

MERCURIO

**Version**  
FPMER30W3SS / Mercurio Wall  
30" (76 cm) 280 CFM  
**Collection**  
Potenza

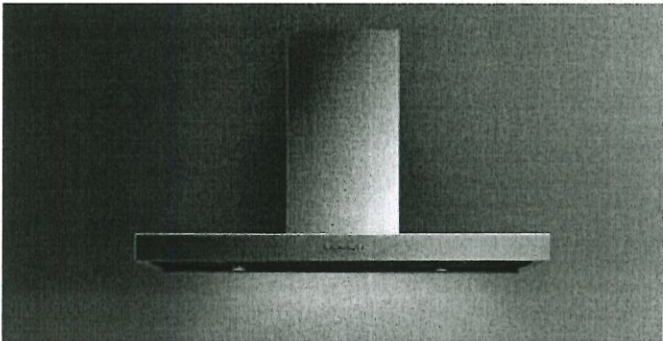

Photograph is for information purposes only  
May not correspond to the selected version

FEATURES

Scotch brite stainless steel (AISI 304)  
Electronic control  
LED lighting  
Metallic grease filter, removable and washable  
Optional charcoal filter

OPTIONAL ACCESSORIES

**KACL.815**  
Protective cleaning cloths for stainless steel (box 10 pcs)  
**103050107**  
Square charcoal filter - Type 3

TECHNICALFEATURES

**Installation type**  
Wall  
**Dimensions**  
30 " / 76 cm  
**Finish**  
Scotch brite stainless steel (AISI 304)  
**Motor**  
280 CFM  
**Type of control**  
Electronic control  
**Speed settings**  
3  
**Lighting**  
Led 2x1,2 W - 3200 K  
**Charcoal filter**  
Square charcoal filter - Type 3  
**Minimum distance**  
Gas hob: 63 cm  
Electric hob: 52 cm

PACKAGING:WEIGHTS AND VOLUMES

**Gross weight**  
19 kg  
**Net weight**  
14 kg  
**Volume**  
0,27 m³  
**Packaging size**  
Length  
995 mm  
Height  
595 mm  
Depth  
450 mm

CONSUMPTION AND CONNECTION FEATURES

**Maximum consumption**  
150 W  
**Current**  
120V 60Hz  
**Frequency**  
  
**Plug type**  
standard

