

MAAX SUBMITTAL SPECIFICATIONS

Carlton I

MODEL NUMBER 100961

DIMENSIONS: 48" x 35" x 75" Fiberglass



Project :

Contractor :

MAAX Representative :

Date :

Tel :

www.maax.com

Vivez l'expérience
MAAX
Enjoy the experience

STANDARD FEATURES

- 1-piece shower without roof cap
- Integrated shelf and seat
- Center drain

OPTIONS

- ABS shower drain with Chrome stainless steel grid
- PVC shower drain with Chrome stainless steel grid
- ABS shower drain with ABS grid, white or bone

UNIQUE FEATURES

- None

SYSTEMS

- None

DOOR SELECTION

Combine with MAAX's complete shower door offering visit www.maax.com

CERTIFICATIONS

Maax products adhere to one or more of the following certifications:



2013-02-26

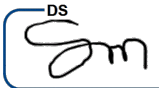

MAAX SUBMITTAL SPECIFICATIONS

Carlton I

MODEL NUMBER 100961

TECHNICAL DRAWINGS

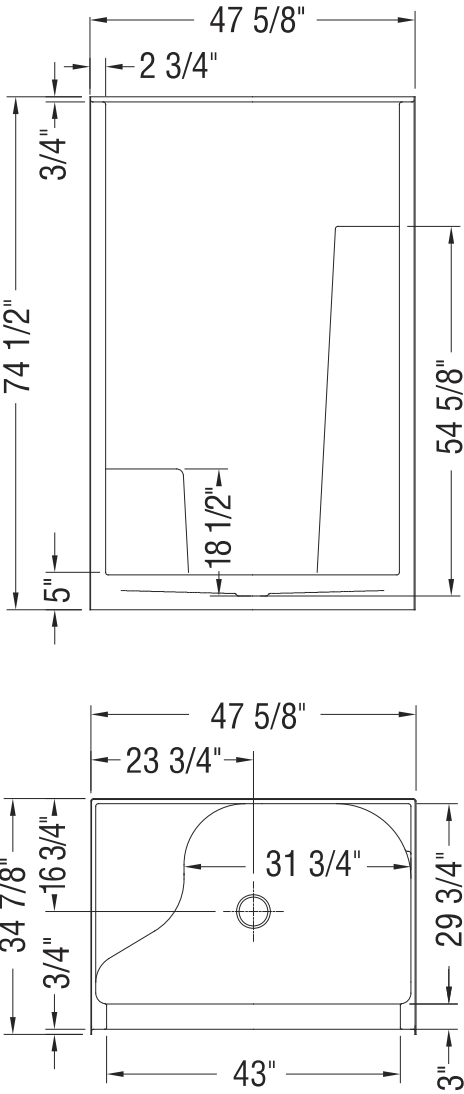

All dimensions are approximate. Structure measurements must be verified against the unit to ensure proper fit.

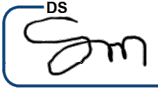

MAAX SUBMITTAL SPECIFICATIONS

Exhibit 6030 IFS AFR

MODEL NUMBER 105511

DIMENSIONS: 60" x 30" x 18" Acrylic



Project :
Contractor :
MAAX Representative : Tel :
Date :

www.maax.com

Vivez l'expérience
MAAX
Enjoy the experience

STANDARD FEATURES

- Rectangular shape bathtub in alcove installation
- Above-the-Floor Rough (AFR) or not
- Minimalist look with discreet armrests and textured floor
- Deck for faucet available
- Integrated skirt with access panel when equipped with a system

OPTIONS

- Removable access panel
- One chromatherapy light
- Water heater assembly (factory installed)
- Metal trim kit for whirlpool and combined systems
- Metal trim kit for Air Push Control
- Cable-operated waste and overflow

UNIQUE FEATURES

- Tiling Flange

SYSTEMS

 MAAX Professional Whirlpool

 Aeroeffect**DOOR**

 Combined Whirlpool/Aeroeffect

 Chromatherapy**SELECTION**

Combine with MAAX's complete shower door offering visit www.maax.com

CERTIFICATIONS

Maax products adhere to one or more of the following certifications:



2017-08-23

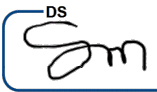

MAAX SUBMITTAL SPECIFICATIONS

Exhibit 6030 IFS AFR

MODEL NUMBER 105511

TECHNICAL DRAWINGS

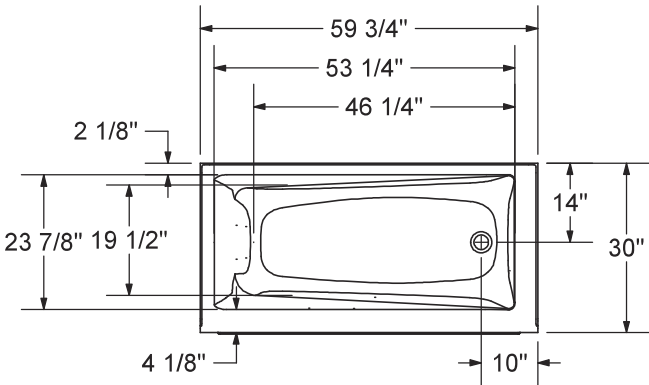

WITHOUT SYSTEM



WITH SYSTEM

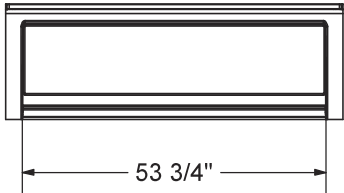

1" Single Integrated tiling
flange (shown)

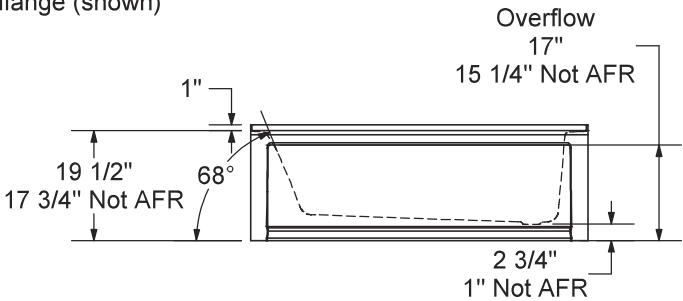

Wood support design may vary.
Single Integrated tiling flange: 1" height x 1/4" thickness (shown)

All dimensions are approximate. Structure measurements
must be verified against the unit to ensure proper fit.

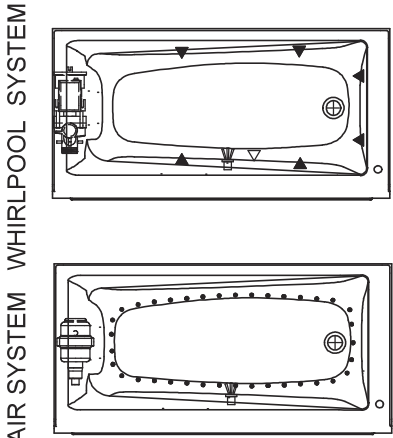

- (▲) : Indicates whirlpool jets positioning
- (△) : Indicates suction positioning
- (●) : Indicates airjets positioning
- (■) : Indicates chromatherapy light positioning

2017-08-23

