

WT2-108

Reveal Sleek 71 Pivot Shower Door 41 1/2-44 1/2 x 71 1/2 in. 8 mm

Model number: 139577

Dimensions: 41 1/2-44 1/2" x 71 1/2" Installation: Alcove Door type: Pivot



Standard Features:

- Wide opening to ease the access in and out of the shower
- Strongly built sill, permanently fixed on the base, better water barrier
- Hinge with patent mechanism that offers 3 in. of lateral adjustment
- Additional 3/4 in. of out-of-plumb adjustment
- Header-less door, no height restriction
- New design, 1 7/8 in. deep, makes it compatible with many bases and tile

Product characteristics:

- 8mm Tempered Glass
- Award Winner
- Wide Opening

Warranty:

10 Years

Certifications

MAAX products adhere to one or more of the following certifications:



Frame Finish(es):

 Chrome (084)

 Dark Bronze (173)

 Brushed Nickel (305)

 Matte Black (340)

Glass Pattern(s):

 Clear (900)

Recommended products (Visit our website for a complete list of our recommended products)

No	Description
102001	Rectangular Base 4234 - 3 in.
105714	Square Base 42 - 3 in.
105718	Rectangular Base 4236 - 3 in.

WT2-108

Reveal Sleek 71 Pivot Shower Door 41 1/2-44 1/2 x 71 1/2 in. 8 mm

Model number: 139577

Dimensions: 41 1/2-44 1/2" x 71 1/2" Installation: Alcove Door type: Pivot

STANDARD

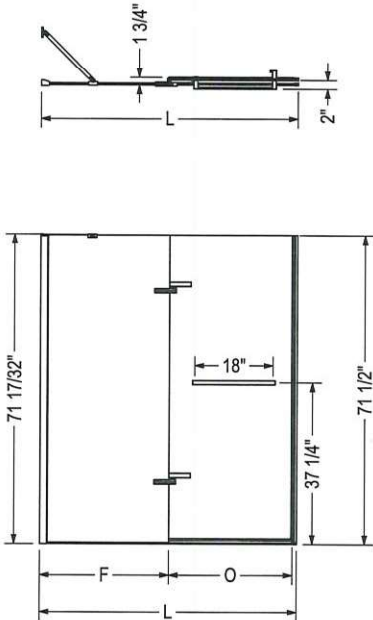

Code	Description	L	F	O
139575	Reveal Sleek 71 1/2" x 32 1/2" - 35 1/2"	32 1/2" - 35 1/2"	5 3/8"	23 3/4" - 26 3/4"
139576	Reveal Sleek 71 1/2" x 38" - 41"	38" - 41"	10 7/8"	23 3/4" - 26 3/4"
139577	Reveal Sleek 71 1/2" x 41 1/2" - 44 1/2"	41 1/2" - 44 1/2"	14 3/8"	23 3/4" - 26 3/4"
139578	Reveal Sleek 71 1/2" x 44" - 47"	44" - 47"	16 7/8"	23 3/4" - 26 3/4"
139579	Reveal Sleek 71 1/2" x 51 1/2" - 54 1/2"	51 1/2" - 54 1/2"	24 3/8"	23 3/4" - 26 3/4"
139580	Reveal Sleek 71 1/2" x 56" - 59"	56" - 59"	28 7/8"	23 3/4" - 26 3/4"

- Wall adjustment = 3/4"

All dimensions are approximate. Structure measurements must be verified against the unit to ensure proper fit.

Dimensions:

41 1/2-44 1/2 x 71 1/2 in.  
(1054-1156 x 1816 mm)

Glass Thickness:

5/16 in. (8 mm)

Weight:

116 lbs (52.7 kg)

Frame type:

Frameless

Opening:

Reversible

Door adjustment:

3 in.

Minimum access:

23 3/4 (603 mm)

Maximum access:

26 3/4 (603 mm)

Project:

Contractor:

Representative:

Date:

Tel:

Notes:

WT LOT 108

Halo Sliding Shower Door 56 1/2-59 x 78 3/4 in. 8 mm

Model number: 138997

Dimensions: 56 1/2-59" x 78 3/4" Installation: Alcove Door type: Slider



Standard Features:

- Glass panels 5/16 in. (8 mm) with a height of 78 3/4 in.
- Lotus easy clean protection for effortless maintenance
- Ball bearing roller technology for smooth and quiet opening
- 48 in. and 60 in. reversible showers door allowing left or right opening
- Also available in a corner configuration
- Available in 4 finishes: Chrome, Brushed

Product characteristics:

- Ball Bearing Roller System
- Bestseller
- Utile Compatible

Warranty:

10 Years

Certifications

MAAX products adhere to one or more of the following certifications:



Frame Finish(es):

 Chrome (084)

 Dark Bronze (173)

 Brushed Nickel (305)

 Matte Black (340)

Glass Pattern(s):

 Clear (900)

Recommended products (Visit our website for a complete list of our recommended products)

No	Description
410011	ModulR 6032 Corner left (without armrests)
102003	Rectangular Base 6034 - 3 in.
105055	Rectangular Base 6030 - 5 in.

DS

SM

DS





WT LOT 108

Halo Sliding Shower Door 56 1/2-59 x 78 3/4 in. 8 mm

Model number: 138997

Dimensions: 56 1/2-59" x 78 3/4" Installation: Alcove Door type: Slider

STANDARD

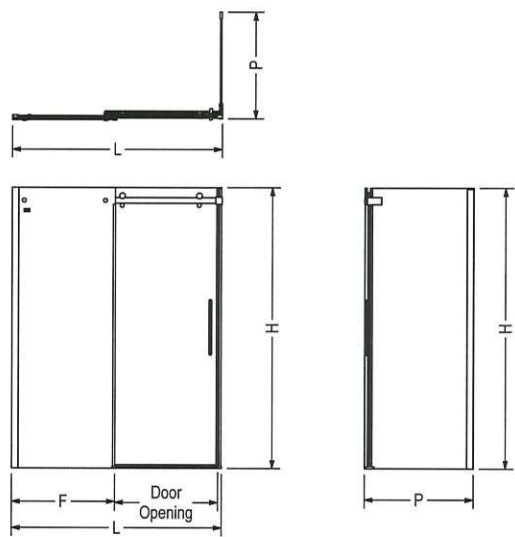

Code	Description	H	L Adjustable	F	P Adjustable	Door Opening	Wall Adjustment
138996	Halo 78 3/4" x 47"	78 3/4"	44 1/2" - 47"	22 1/2"	-	16 1/4" - 18 3/4"	1"
138997	Halo 78 3/4" x 59"	78 3/4"	56 1/2" - 59"	28 5/8"	-	22 1/8" - 24 5/8"	1"
139393	Return Panel 30"	78 3/4"	-	-	27 7/8"	-	1"
138998	Return Panel 32"	78 3/4"	-	-	29 7/8"	-	1"
139395	Return Panel 34"	78 3/4"	-	-	31 7/8"	-	1"
139396	Return Panel 36"	78 3/4"	-	-	33 7/8"	-	1"
139394	Return Panel 42"	78 3/4"	-	-	39 7/8"	-	1"

All dimensions are approximate. Structure measurements must be verified against the unit to ensure proper fit.

Dimensions:

56 1/2-59 x 78 3/4 in.  
(1435-1499 x 2000 mm)

Glass Thickness:

5/16 in. (8 mm)

Weight:

162 lbs (73.47 kg)

Frame type:

Frameless

Opening:

Reversible

Door adjustment:

For out of plumb walls

Minimum access:

22 1/2 (572 mm)

Maximum access:

24 1/2 (572 mm)

Project: \_\_\_\_\_

Contractor: \_\_\_\_\_

Representative: \_\_\_\_\_

Date: \_\_\_\_\_

Tel: \_\_\_\_\_

Notes: \_\_\_\_\_

\_\_\_\_\_

\_\_\_\_\_

DS SM DS

Oberto 6731

Model number:	106386
---------------	--------

Dimensions: 67" x 31" x 23"      Installation: Freestanding      Material: Acrylic



**Standard Features:**

- Seamless 1-piece bathtub with a symmetrical look
- Ample deck space for faucet installation and off-center drain
- Maximized bathing well with comfortable backrests
- Linear waste and overflow in chrome (pre-installed)
- Offered only in white with optional trim

**Product characteristics:**

- Deck Space for Faucet
- Maximized Bathing Well
- 1-Piece Tub

**Warranty:**

25 Years

Standard colors:

White (001)

**Certifications**

MAAX products adhere to one or more of the following certifications:

UL

ICC

ES

PMG

Options (Visit our website for a complete list of our options)

No	Description
<input type="checkbox"/> OPT 20260	Linear-rounded overflow & waste metal trim kit

DS

SM

DS



Oberto 6731

Model number:

106386

Dimensions: 67" x 31" x 23"

Installation: Freestanding

Material: Acrylic

Dimensions:

67 x 31 x 23 in.  
(1702 x 787 x 584 mm)

Water capacity:

91 gallons - 345 liters

Weight:

132 lbs - 59.86 kg

Bathing well:

62 X 28 in.  
(1575 X 711 mm)

Deep sump height:

19 in. - 483 mm

Deck width:

3 in. - 76 mm

Drain location:

Center

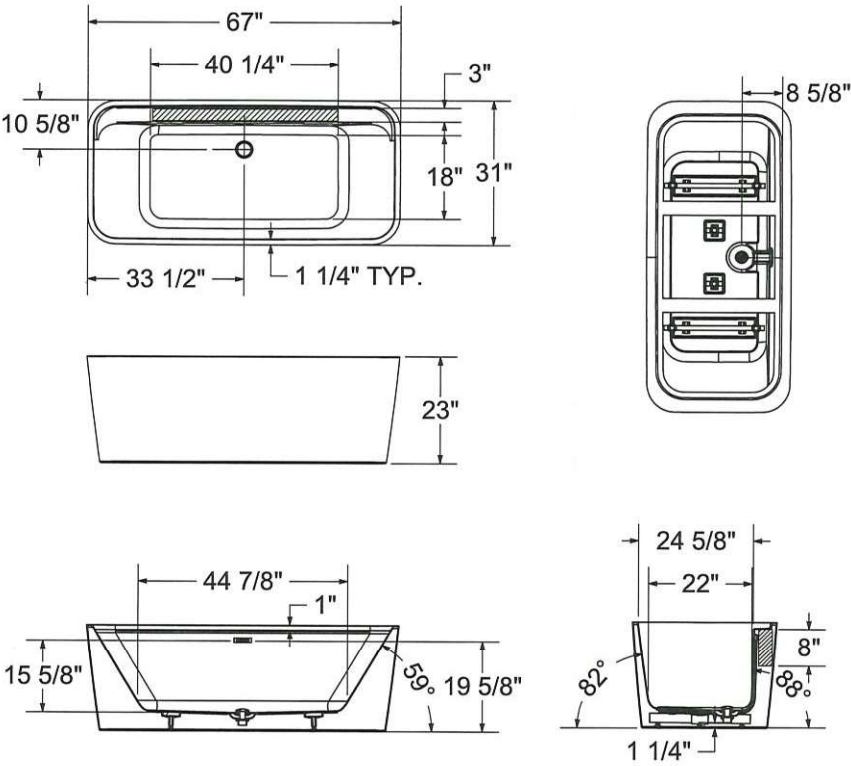

( ) Recommended faucet area of 40" (L) x 4" (W).  
Depth recommended for straight pipes 8".

All dimensions are approximate. Structure measurements must be verified against the unit to ensure proper fit.

Project:

Contractor:

Representative:

Date:

Tel:

Notes:

DS SM

DS



WT 108

Axial Duo Tub Shield 42 x 58 in. 8 mm

Model number: 137512

Dimensions: 41-42" x 58" Installation: Tub Door Door type: Shield



Standard Features:

- 8 mm tempered glass with Lotus glass protection
- Double glass; one fix 24 in. and one pivot 18 in. This gives you a wide access to get in and out while making the corner watertight
- Easy access to faucets
- The moving panel can tilt slightly inside the tub to prevent water spill
- Fixed panel clears most toilets or vanities

Product characteristics:

- Lotus Easy Clean Glass Protection
- Easy Installation
- Wide Opening

Warranty:

10 Years

Certifications

MAAX products adhere to one or more of the following certifications:



Frame Finish(es):



Glass Pattern(s):



Recommended products (Visit our website for a complete list of our recommended products)

No	Description
102722	Cocoon 6032
148015	Essence TO-6032 AFR
105684	Corinthia II

DS SM DS J M

WT 108

Axial Duo Tub Shield 42 x 58 in. 8 mm

Model number: 137512

Dimensions: 41-42" x 58"      Installation: Tub Door      Door type: Shield

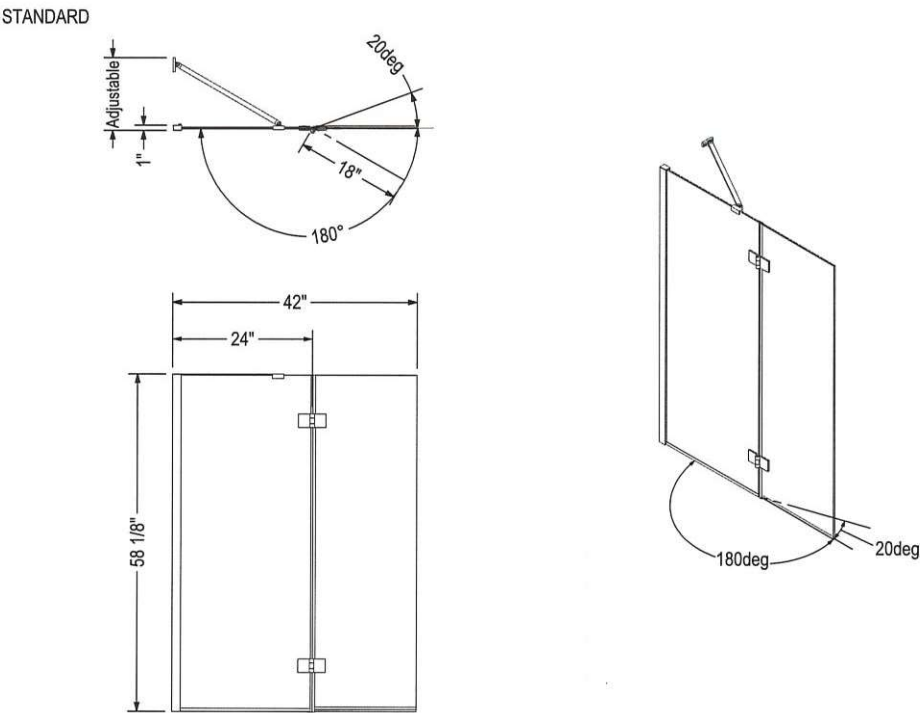

Dimensions:

41-42 x 58 in.  
(1067-1067 x 1473 mm)

Glass Thickness:

5/16 in. (8 mm)

Weight:

48 lbs (21.77 kg)

Frame type:

Frameless

Opening:

Reversible

Door adjustment:

For out of plumb walls

Minimum access:

( mm)

Maximum access:

( mm)

Code	Description	Wall Adjustment
137512	AXIAL Duo Tub 42" X 58"	3/8"

All dimensions are approximate. Structure measurements must be verified against the unit to ensure proper fit.

Project: \_\_\_\_\_

Contractor: \_\_\_\_\_

Representative: \_\_\_\_\_

Date: \_\_\_\_\_

Tel: \_\_\_\_\_

Notes: \_\_\_\_\_

\_\_\_\_\_

\_\_\_\_\_

DS SM DS *[Signature]*