



Bristol Sinks
<http://bristolsinks.com/>

DV 25

PRODUCT NAME : B926 Undermount Sink w/ 15mm Radius Corners
MODEL : B926
PRICE : \$980.00
SKU : B926
WEIGHT : 35lbs.

DESCRIPTION

Single Bowl Undermount Sink with 15mm radius corners
Outside dimensions: 32 x 19 x 10"
Minimum Cabinet Size: 33"
Stainless Steel Single Bowl Sink
16 Gauge Type 304 Stainless Steel
Stone Guard undercoating over rubber pad
3 1/2" drain opening
Supplied with installation clip, template and strainer
cUPC certified

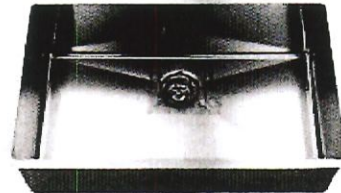

ADDITIONAL IMAGES

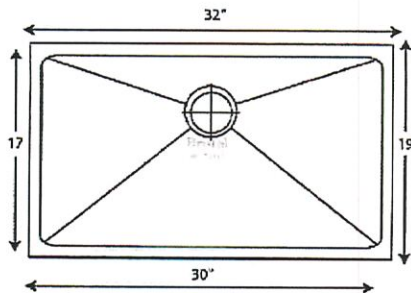

Sax

Model number: 105797

Dimensions: 60" x 32" x 25"

Installation: Freestanding

Material: AcrylX™ Ap-



Standard Features:

- 2-piece bathtub – Transports and installs easily
- Above-the-Floor Rough (AFR) and F² Drain compatible
- End drain and 4 adjustable leveling legs
- Faucet installation can be deck-mounted or floor-mounted
- Unique feature: maximized bathing well with comfortable backrest

Product characteristics:

- Transitional design
- Comfortable backrest
- Deck Space for Faucet

Warranty:

Lifetime limited

Standard colors:

 White (002)

Certifications

MAAX products adhere to one or more of the following certifications:



Options (Visit our website for a complete list of our options)

No	Description
<input type="checkbox"/> OPT 20137	Cable-operated waste and overflow
<input type="checkbox"/> OPT 20210	Waste and overflow



DV 25

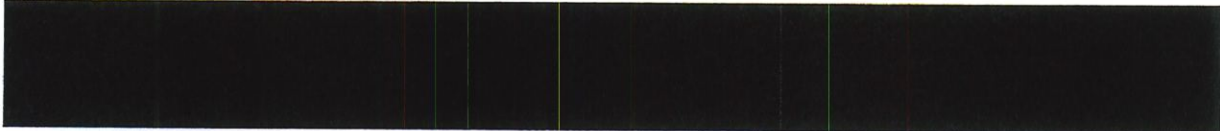

Sax

Model number: 105797

Dimensions: 60" x 32" x 25" Installation: Freestanding

Material: AcrylX™ Ap-

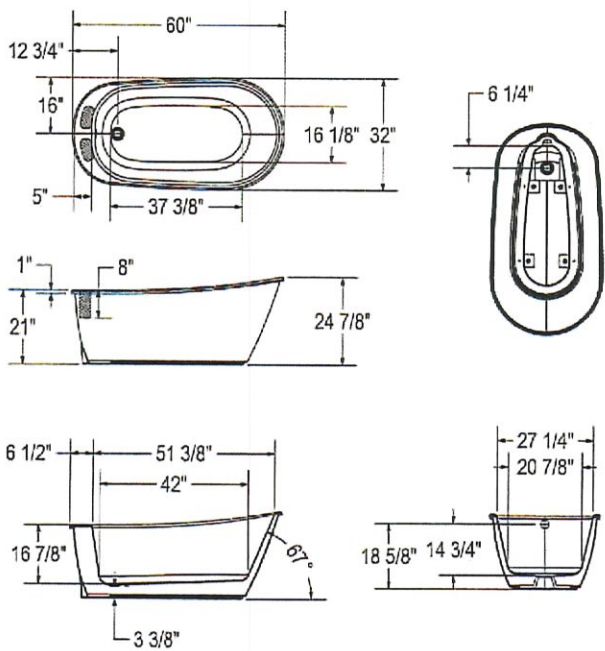

Dimensions:

60 x 32 x 24 7/8 in.
(1524 x 813 x 632 mm)

Water capacity:

44 gallons - 168 liters

Weight:

130 lbs - 58.96 kg

Bathing well:

51 3/8 X 27 1/4 in.
(1305 X 692 mm)

Deep sump height:

16 7/8 in. - 429 mm

Deck width:

5 in. - 127 mm

Drain location:

End

(NOTES): Recommended faucet area 2 sections of 7" (L) x 3" (W).
Depth recommended for straight pipes 6".

All dimensions are approximate. Structure measurements
must be verified against the unit to ensure proper fit.

BB PBF

Project: DV 25

Contractor:

Representative:

Date:

Tel:

Notes:

Exhibit 6032 IFS

DV 25

Model number:

105520

Dimensions: 60" x 32" x 18"

Installation: Alcove

Material: Acrylic



Standard Features:

- Rectangular shape bathtub in alcove installation
- Available in Above-the-Floor Rough (AFR) or not
- Minimalist look with discreet armrests and textured floor
- Integrated tiling flange
- Integrated skirt with access panel when equipped with a system

Product characteristics:

- Made In North America
- Elegant design
- Integrated Tiling Flange and Skirt

Systems:

- Whirlpool
- Combined Whirlpool/Aeroeffect
- Aeroeffect

Warranty:

25 Years

Standard colors:

White (001)

Bone (004)

Biscuit (007)

Certifications

MAAX products adhere to one or more of the following certifications:

UL

ICC

ES

FM

Recommended products (Visit our website for a complete list of our recommended doors)

No	Description
139396	Halo Sliding Tub Door 56 1/2-59 x 59 in. 6 mm
135330	Incognito 57 Shaker Sliding Tub Door 56-59 x 56 3/4 in. 6 mm
139351	Incognito 57 Sliding Tub Door 56-59 x 56 3/4 in. 6 mm

Options (Visit our website for a complete list of our options)

No	Description
<input type="checkbox"/> OPT 10019	Removable access panel
<input type="checkbox"/> OPT 10053	Chromatherapy
<input type="checkbox"/> OPT 10095	Water heater assembly
<input type="checkbox"/> OPT 10106	Metal trim kit for whirlpool and combined systems
<input type="checkbox"/> OPT 20029	Metal trim kit for Air Push Control



BB BF

Exhibit 6032 IFS

Model number: 105520

Dimensions: 60" x 32" x 18" Installation: Alcove

Material: Acrylic

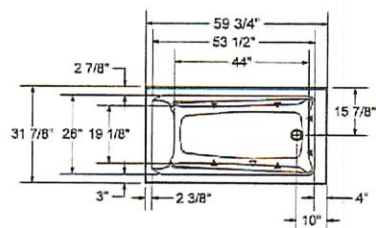

1" Single Integrated tiling flange (shown)
2" Double Integrated tiling flange (not shown)
Drop-in model (Shown)

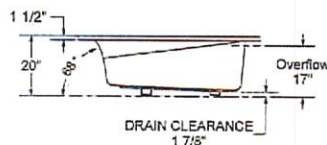

Wood support design may vary.
Single integrated tiling flange: 1" height x 1/4" thickness (shown)
Double integrated tiling flange: 2" height (not shown)
All dimensions are approximate.
Structure measurement must be verified against the unit to ensure proper fit.

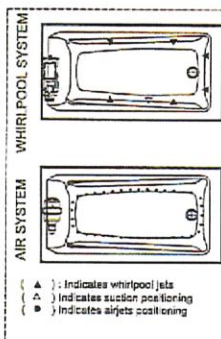

Dimensions:

59 3/4 x 32 x 17 3/4 in.
(1518 x 813 x 451 mm)

Water capacity:

46 gallons - 173 liters

Weight:

78 lbs - 35.37 kg

Bathing well:

53 1/4 X 25 7/8 in.
(1353 X 657 mm)

Deep sump height:

16 1/4 in. - 413 mm

Deck width:

4 1/8 in. - 105 mm

Drain location:

Left

Right

Project: DV 25

Contractor: _____

Representative: _____

Date: _____

Tel: _____

Notes: _____

BP BPF

DV 25

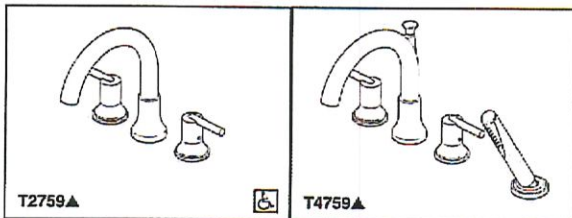

Submitted Model No.:

Specific Features:

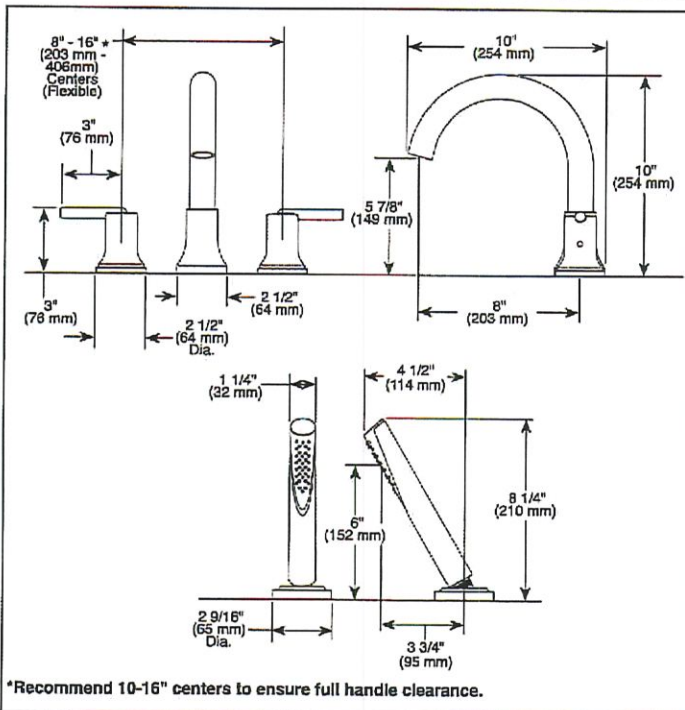

*Recommend 10-16\"/>

▲ Designate Proper Finish Suffix



Delta reserves the right (1) to make changes in specifications and materials, and (2) to change or discontinue models, both without notice or obligation. Dimensions are for reference only. See current full-line price book or www.deltafaucet.com for finish options and product availability.
DSP-B-T2759 Rev. F



see what Delta can do™

ROMAN TUB/WHIRLPOOL FAUCET TRIM

- Trinsic® Collection
- Three Hole Installation (T2759 Series)
- Four Hole Installation (T4759 Series)

STANDARD SPECIFICATIONS:

- Hand shower max flow rate of 1.75 gpm @ 80 psi, 6.6 L/min @ 550 kPa
- Trim only for two handle Roman Tub faucet for concealed mounting
- Temperature and volume controlled with handles
- Red/blue indicator markings
- Rough-in kit must also be ordered to complete installation
 - R4707 for four hole
 - R2700 or R2707 for three hole
 - RP23601 for three hole 10\"/>
- Hand shower includes double check valves for backflow prevention (T4759)

WARRANTY

- Parts and Finish - Lifetime limited warranty; or for commercial purchasers, 10 years for multi-family residential (apartments and condominiums) and 5 years for all other commercial uses, in each case from the date of purchase.
- Electronic Parts and Batteries (if applicable) - 5 years from the date of purchase; or for commercial purchasers, 1 year from the date of purchase. No warranty is provided on batteries.



COMPLIES WITH:

- ASME A112.18.1 / CSA B125.1
- Indicates compliance to ICC/ANSI A117.1 - Valve control only
- EPA WaterSense® - Applies to T4759▲ only

Delta Faucet Company
55 E. 111th Street, Indianapolis, IN 46280
350 South Edgeware Road, St. Thomas, ON N5P 4L1
© 2019 Delta Faucet Company

DV 25

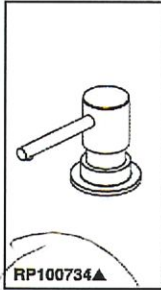

RP100734▲

CAROME

Submitted Model No.:

Specific Features:

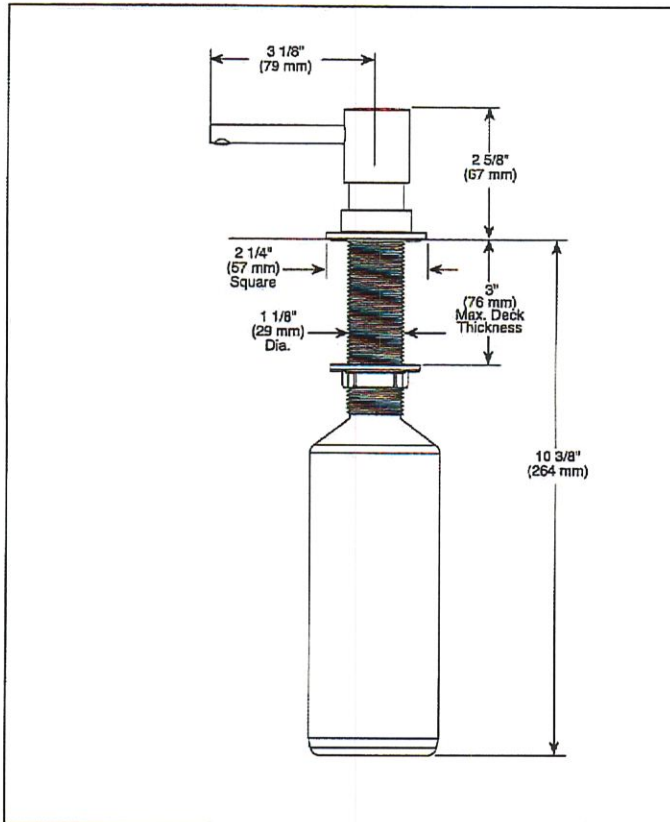

▲ Designate Proper Finish Suffix



see what Delta can do™

SOAP DISPENSER

STANDARD SPECIFICATIONS:

- 13 ounce bottle
- Refillable from above the deck
- Fits hole size 1 3/8" +/- 1/8"

WARRANTY

- Parts and Finish - Lifetime limited warranty; or for commercial purchasers, 10 years for multi-family residential (apartments and condominiums) and 5 years for all other commercial uses, in each case from the date of purchase.
- Electronic Parts and Batteries (if applicable) - 5 years from the date of purchase; or for commercial purchasers, 1 year from the date of purchase. No warranty is provided on batteries.



Delta reserves the right (1) to make changes in specifications and materials, and (2) to change or discontinue models, both without notice or obligation. Dimensions are for reference only. See current full-line price book or www.deltafaucet.com for finish options and product availability.

DSP-K-RP100734 Rev. A

Delta Faucet Company
55 E. 111th Street, Indianapolis, IN 46280
350 South Edgewood Road, St. Thomas, ON N5P 4L1
© 2018 Delta Faucet Company

Sax

Model number: 105797

Dimensions: 60" x 32" x 25" Installation: Freestanding

Material: AcrylX™ Ap-

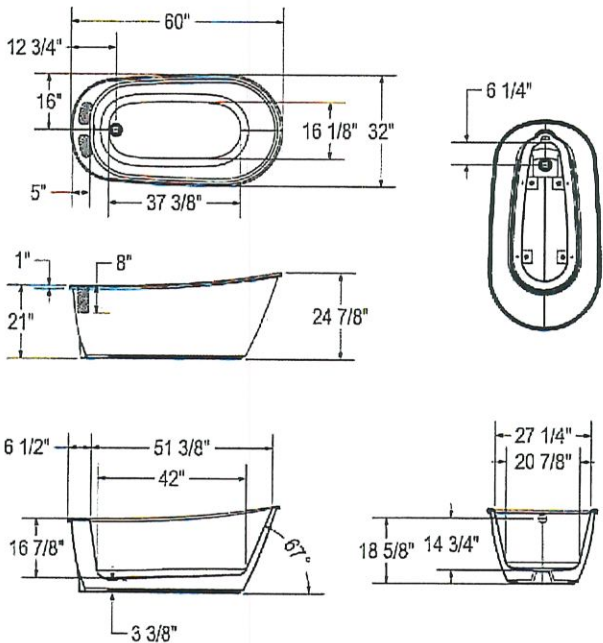

Dimensions:

60 x 32 x 24 7/8 in.
(1524 x 813 x 632 mm)

Water capacity:

44 gallons - 168 liters

Weight:

130 lbs - 58.96 kg

Bathing well:

51 3/8 X 27 1/4 in.
(1335 X 692 mm)

Deep sump height:

16 7/8 in. - 429 mm

Deck width:

5 in. - 127 mm

Drain location:

End

(Faucet): Recommended faucet area 2 sections of 7" (L) x 3" (W).
Depth recommended for straight pipes 0".

All dimensions are approximate. Structure measurements
must be verified against the unit to ensure proper fit.

BB PBF

Project: DV 25

Contractor:

Representative:

Date:

Tel:

Notes:

Exhibit 6032 IFS

DV 25

Model number:

105520

Dimensions: 60" x 32" x 18"

Installation: Alcove

Material: Acrylic

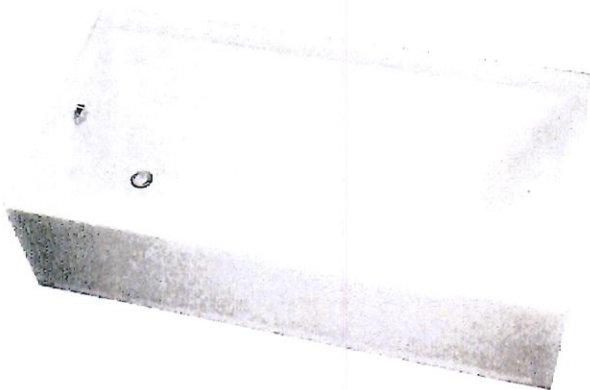

Standard Features:

- Rectangular shape bathtub in alcove installation
- Available in Above-the-Floor Rough (AFR) or not
- Minimalist look with discreet armrests and textured floor
- Integrated tiling flange
- Integrated skirt with access panel when equipped with a system

Product characteristics:

- Made in North America
- Elegant design
- Integrated Tiling Flange and Skirt

Systems:

- Whirlpool
- Combined Whirlpool/Aeroeffect
- Aeroeffect

Warranty:

25 Years

Standard colors:



White (001)



Bone (004)



Biscuit (007)

Certifications

MAAX products adhere to one or more of the following certifications:



Recommended products (Visit our website for a complete list of our recommended doors)

No	Description
139398	Halo Sliding Tub Door 56 1/2-59 x 59 in. 8 mm
135330	Incognito 57 Shaker Sliding Tub Door 56-59 x 56 3/4 in. 8 mm
139351	Incognito 57 Sliding Tub Door 56-59 x 56 3/4 in. 8 mm

Options (Visit our website for a complete list of our options)

No	Description
<input type="checkbox"/> OPT 10019	Removable access panel
<input type="checkbox"/> OPT 10053	Chromatherapy
<input type="checkbox"/> OPT 10095	Water heater assembly
<input type="checkbox"/> OPT 10106	Metal trim kit for whirlpool and combined systems
<input type="checkbox"/> OPT 20029	Metal trim kit for Air Push Control

BB BPF

Exhibit 6032 IFS

Model number: 105520

Dimensions: 60" x 32" x 18" Installation: Alcove

Material: Acrylic

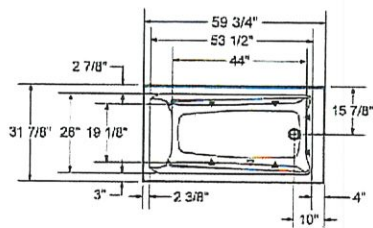

1" Single Integrated tiling flange (shown)
2" Double Integrated tiling flange (not shown)
Drop-in model (Shown)

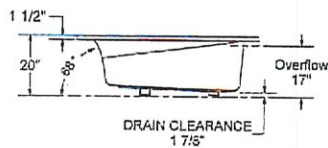

Wood support design may vary.
Single Integrated tiling flange: 1" height x 1/4" thickness (shown)
Double Integrated tiling flange: 2" height (not shown)
All dimensions are approximate.
Structure measurement must be verified against the unit to ensure proper fit.

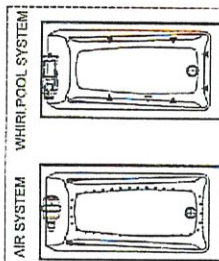

(▲) : Indicates whirlpool jets
(▲) : Indicates suction positioning
(●) : Indicates airjets positioning

Dimensions:

59 3/4 x 32 x 17 3/4 in.
(1518 x 813 x 451 mm)

Water capacity:

46 gallons - 173 liters

Weight:

78 lbs - 35.37 kg

Bathing well:

53 1/4 X 25 7/8 in.
(1353 X 657 mm)

Deep sump height:

16 1/4 in. - 413 mm

Deck width:

4 1/8 in. - 105 mm

Drain location:

Left

Right

Project: DV 25

Contractor:

Representative:

Date:

Tel:

Notes:

BPS BPF

DV 25

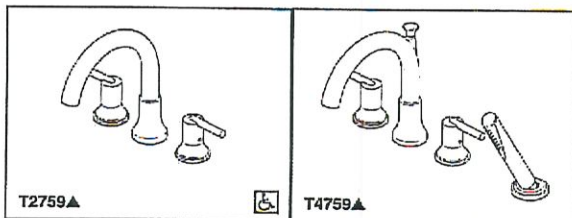

Submitted Model No.:

Specific Features:

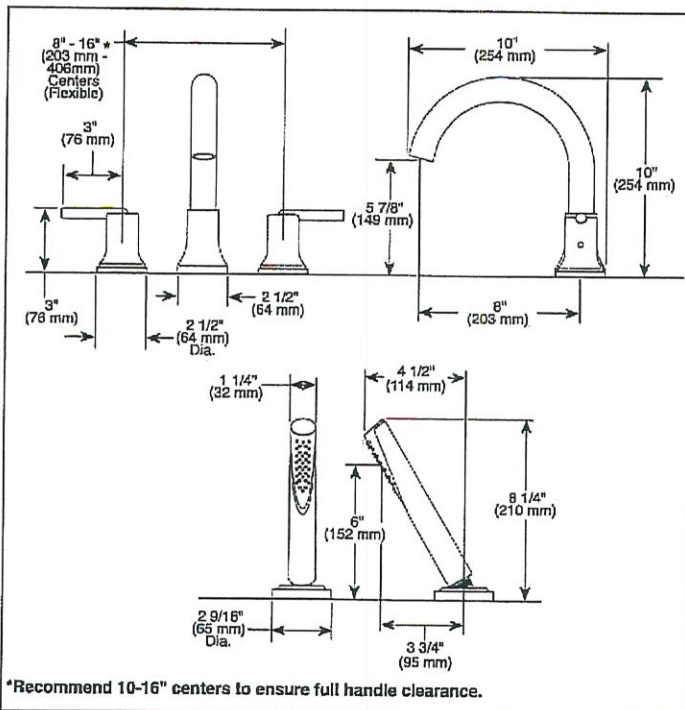

▲ Designate Proper Finish Suffix



Delta reserves the right (1) to make changes in specifications and materials, and (2) to change or discontinue models, both without notice or obligation. Dimensions are for reference only. See current full-line price book or www.deltafaucet.com for finish options and product availability.
DSP-B-T2759 Rev. F



see what Delta can do*

ROMAN TUB/WHIRLPOOL FAUCET TRIM

- Trinsic® Collection
- Three Hole Installation (T2759 Series)
- Four Hole Installation (T4759 Series)

STANDARD SPECIFICATIONS:

- Hand shower max flow rate of 1.75 gpm @ 80 psi, 6.6 L/min @ 550 kPa
- Trim: only for two handle Roman Tub faucet for concealed mounting
- Temperature and volume controlled with handles
- Red/blue indicator markings
- Rough-in kit must also be ordered to complete installation
 - R4707 for four hole
 - R2700 or R2707 for three hole
 - RF23601 for three hole 10" fixed installation
- There are separate specification sheets on each rough-in kit. If more details are required.
- Hand shower includes double check valves for backflow prevention (T4759)

WARRANTY

- Parts and Finish - Lifetime limited warranty; or for commercial purchasers, 10 years for multi-family residential (apartments and condominiums) and 5 years for all other commercial uses, in each case from the date of purchase.
- Electronic Parts and Batteries (if applicable) - 5 years from the date of purchase; or for commercial purchasers, 1 year from the date of purchase. No warranty is provided on batteries.



COMPLIES WITH:

- ASME A112.18.1 / CSA B125.1
- ICC/ANSI A117.1 - Valve control only
- EPA WaterSense® - Applies to T4759▲ only

Delta Faucet Company
55 E. 111th Street, Indianapolis, IN 46280
350 South Edgeware Road, St. Thomas, ON N5P 4L1
© 2019 Delta Faucet Company

DV 25

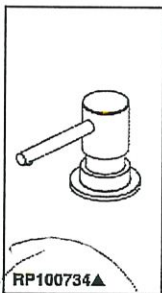

RP100734▲

CHROME

Submitted Model No.:

Specific Features:

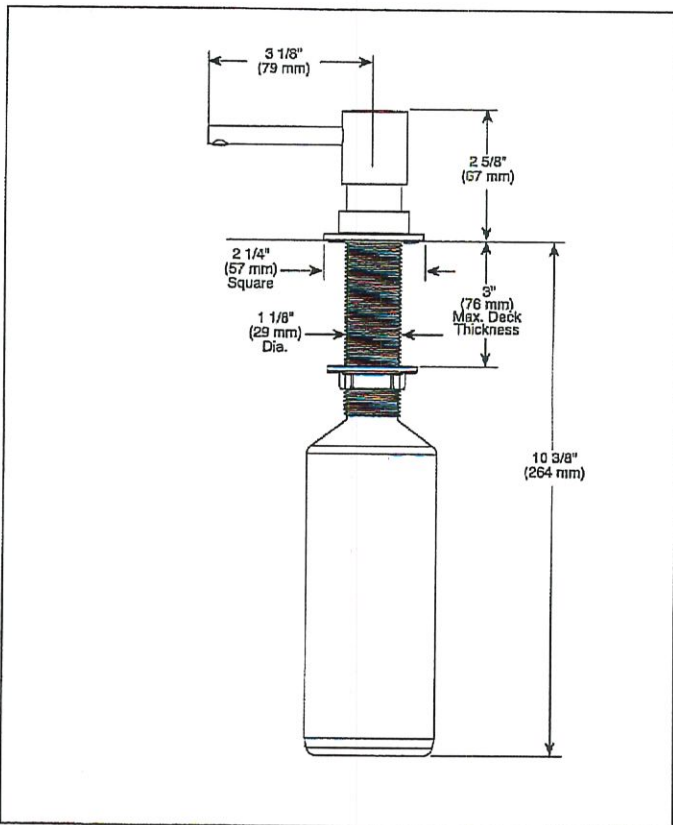

▲ Designate Proper Finish Suffix

Delta reserves the right (1) to make changes in specifications and materials, and (2) to change or discontinue models, both without notice or obligation. Dimensions are for reference only. See current full-line price book or www.deltafaucet.com for finish options and product availability.

DSP-K-RP100734 Rev. A



see what Delta can do™

SOAP DISPENSER

STANDARD SPECIFICATIONS:

- 13 ounce bottle
- Refillable from above the deck
- Fits hole size 1 3/8" +/- 1/8"

WARRANTY

- Parts and Finish - Lifetime limited warranty; or for commercial purchasers, 10 years for multi-family residential (apartments and condominiums) and 5 years for all other commercial uses, in each case from the date of purchase.
- Electronic Parts and Batteries (if applicable) - 5 years from the date of purchase; or for commercial purchasers, 1 year from the date of purchase. No warranty is provided on batteries.



Delta Faucet Company
55 E. 111th Street, Indianapolis, IN 46280
350 South Edgeware Road, St. Thomas, ON N5P 4L1
© 2018 Delta Faucet Company