

LOT 21 PW





## GAS RANGE



**INSTALLATION GUIDE**  
**SPECIFICATIONS, INSTALLATION, AND MORE**

### MODEL NUMBERS:

		
FFSGS6239-30	FFSGS6239-36	FFSGS6239-48

	
Disassemble	Lift the rack up and pull out slowly until free of the side rails.

## Electrical

Your range must be electrically grounded in accordance with local codes or, in the absence of local codes, in accordance with the National Electrical Code (ANSI/NFPA 70, latest edition). In Canada, electrical grounding must be in accordance with the current CSA C22.1 Canadian Electrical Code Part 1 and/or local codes.

The power supply must be the correct polarity. Reverse polarity will result in continuous sparking of the electrodes, even after flame ignition. If there is any doubt as to whether the power supply has the correct polarity or grounded, have it checked by a qualified electrician.

### ELECTRICAL REQUIREMENTS

Electrical Supply	Grounded, 110/120 VAC, 60 Hz
Service	15 amp or 20 amp dedicated circuit
Receptacle	3-prong grounding-type
Power Cord	6' (1.8 m)

#### ⚠ WARNING

**Electrical Grounding Instructions:** this cooking range is equipped with a three-prong (grounding) plug for your protection against shock hazard and should be plugged directly into a properly grounded three-pronged receptacle.

**Do Not** cut or removes the grounding prong from the plug.

**⚠ CAUTION** Label all wires prior to disconnection when servicing controls. Wiring errors can cause improper and dangerous operation. Verify proper operation after servicing.

## Grounding

The power cord is equipped with a three-prong (grounding) plug which mates with a standard three-prong grounding wall receptacle to minimize the possibility of electrical shock hazard from the range.

All cord connected appliance shall include instructions relative to location of the wall receptacle and a warning to the user to disconnect the electrical supply before serving the appliance.

Where a standard two-prong wall receptacle is encountered, it is the responsibility and obligation of the customer to have it replaced with a properly grounded three-prong wall receptacle. Do not cut or remove the grounding prong from the power cord.

## Gas Supply

Installation must comply with local codes or, in the absence of local codes, with the National Fuel Gas Code, ANSI Z223.1 / NFPA 54. In Canada, installation must conform to the current natural Gas Installation /code, CAN 1-1.1-M81 and with local codes where applicable.

This range has been design-certified according to ANSI Z21.1b-2012 latest edition.

### GAS REQUIREMENTS

NATURAL GAS	WC
Supply Pressure	5" (12.5 mb)
Minimum Supply Pressure	6"
Max Regulator Pressure	14" (34.9 mb), 0.5 psi (3.5 kPa)
LP GAS	WC
Supply Pressure	10" (25 mb)
Minimum Supply Pressure	11"
Max Regulator Pressure	14" (34.9 mb), 0.5 psi (3.5 kPa)

**⚠ WARNING** Do not obstruct the flow of combustion air into the range and ventilation air away from the range.

Ventilation: it is recommended that the unit be operated with an oven head, vented exhaust hood of sufficient size and capacity.

### Electric Power Supply Requirements

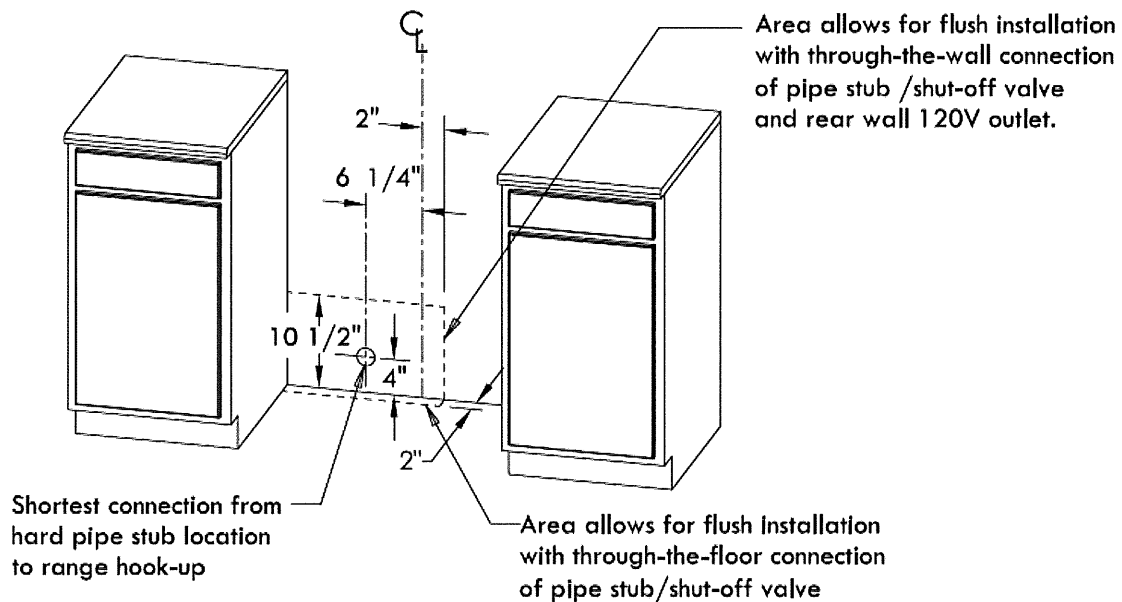

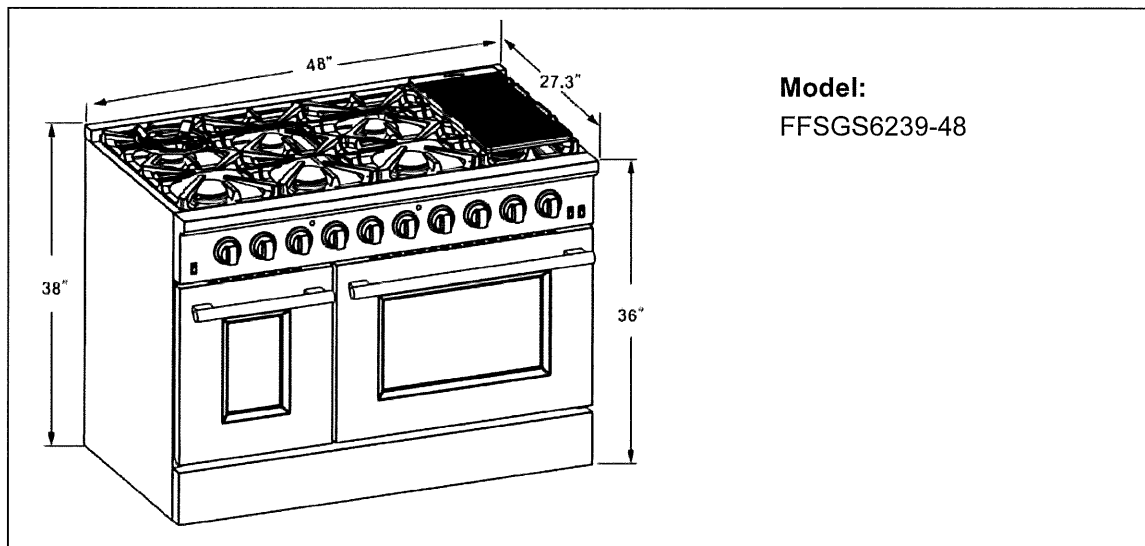

This range may be installed directly adjacent to existing countertop-height cabinets (36" or 91.5 cm from the floor). To achieve the best look, the cooktop should be level with the cabinet countertop. This can be accomplished by raising the unit using the adjustment spindles on the legs.

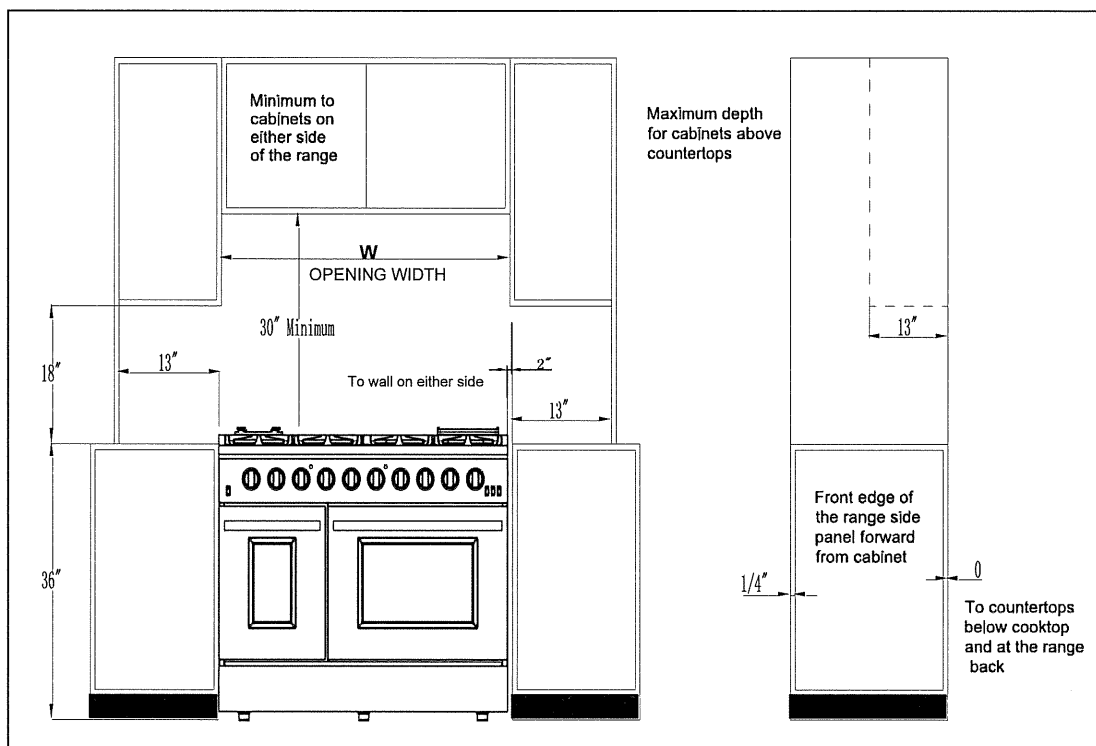

OPENING WIDTH	W
30" Model	30" (762)
36" Model	36" (914)
48" Model	48" (1219)

## Exhaust Hood Installation

The bottom of the hood should be 30" min. to 36" above the countertop. This would typically result in the bottom of the hood being 66" to 72" above the floor. These dimensions provide safe and efficient operation of the hood.

After Installation:

1. Check ignition of cooktop burners.
2. Check the air shutter adjustment – sharp blue flame, with no yellow tipping or lifting flames.
3. Check ignition of oven burner.
4. Visually check tubular burner (oven burner) re-ignition to be sure both rows of burner ports are relighting each time.
5. Check for gas leaks at all gas connections (using a gas detector, never a flame).
6. Check oven bake and convection bake function.

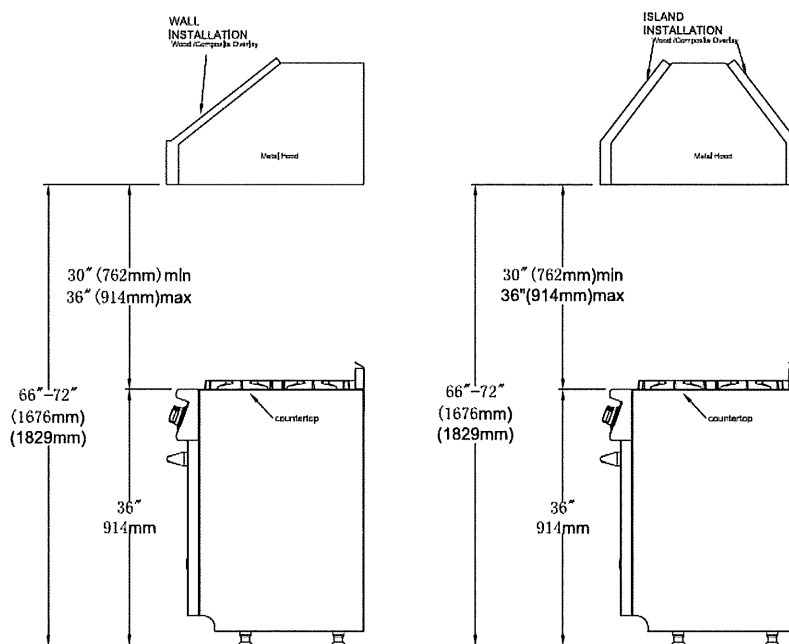

## Gas Conversion Operation

This cooking range can be used with LP gas and NG gas. It is shipped from the factory adjusted for use with NG(Nature Gas). Conversion nozzles are included. Follow the instruction shown below for gas conversion.

**⚠ WARNING** Gas conversion shall be conducted by a factory- trained professional. Call the customer service hotline to identify a factory-trained professional near your home.

**⚠ WARNING** Before carrying out this operation, disconnect the range from gas and electricity.

**The gas conversion procedure for this range includes 8 steps:**

1. Pressure regulator
2. Cooktop burners
3. Oven burner
4. Broil burner
5. Gas valves
6. Reconnect Gas and Electrical Supply
7. Air shutter oven burner
8. Installation of new rating label



# **Range Hood Instruction Manual**

## **FRHWM5029-36/48**

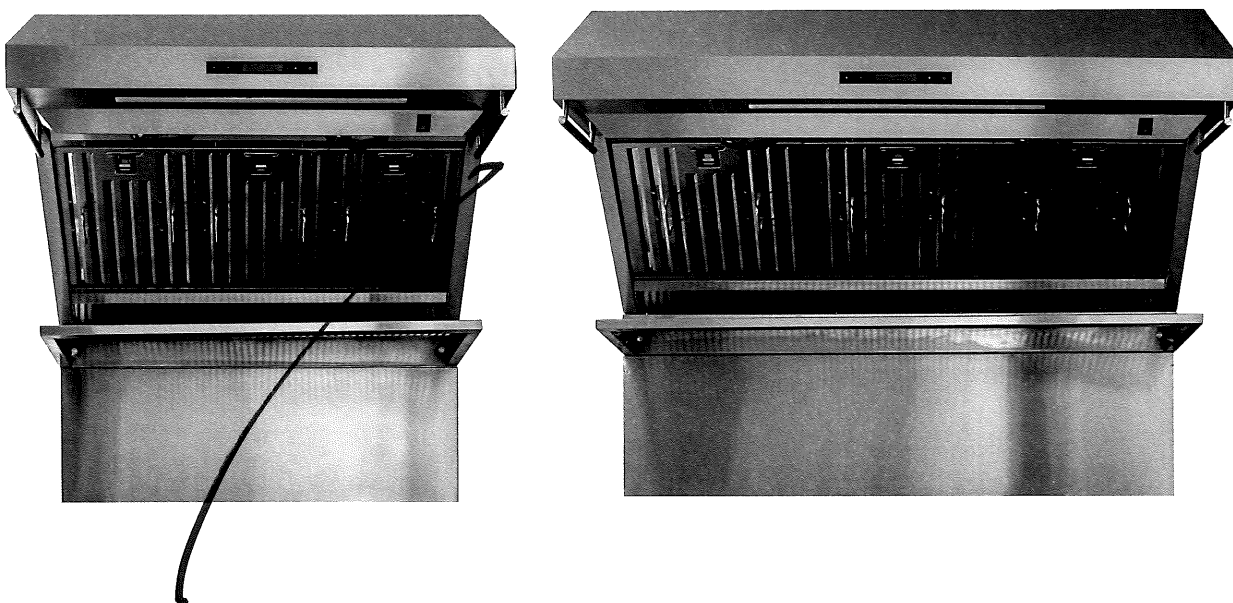

**IMPORTANT:**

**READ AND SAVE THESE INSTRUCTIONS**

**NOTICE:**

Installer: Leave this guide with the homeowner

Homeowner: Keep this guide for future reference

**STAINLESS STEEL PROFESSIONAL RANGE HOOD**

- Duct runs should be as short as possible.
- Avoid the use of elbows.
- Use duct tape on all joints.
- Do not use a duct smaller than the exhaust on the hood.

### **LOCATION PREPARATION**

The installation in this manual is intended for qualified installers, service technicians or persons with a similar qualified background. DO NOT attempt to install this appliance yourself. Injury could result from installing the unit due to lack of appropriate electrical and technical background.

All electrical wiring must be properly installed, insulated and grounded. Excessive accumulated grease in old duct work should be cleaned out or duct work should be replaced if necessary, to avoid the possibility of a grease fire. Check all joints on duct work to ensure proper connection, and all joints should be properly taped.

Note 1: On stainless steel hoods, carefully remove the plastic protective film from all exterior surfaces of the hood and chimney prior to final installation.

Note 2: At least two people will be required to mount the hood.

### **MOUNTING HEIGHTS & CLEARANCE**

The minimum mounting height between range top to hood bottom should be no less than 25"

The maximum mounting height should be no higher than 30"

It is important to install the hood at the proper mounting height. Hoods mounted too low could result in heat damage and fire hazard; while hoods mounted too high will be hard to reach and would lose their performance and efficiency.

If available, also refer to the range manufacturer's height clearance requirements and the recommended hood mounting height above the range.

\* Maximum ceiling clearance of 106.5" at 27.5" hood mounting height from stove (may vary for different models)

\*\* For a higher ceiling, a chimney extension and a decorative cover is available to purchase, if required.

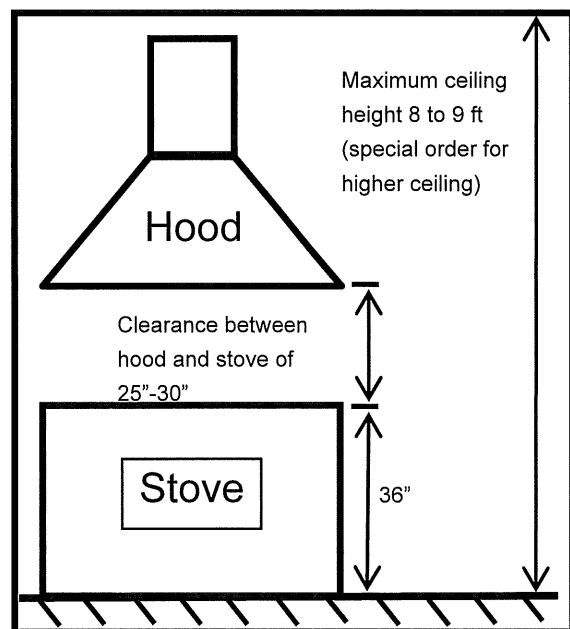

## Ductwork

NEVER exhaust air or terminate duct work into spaces between walls, crawl spaces, ceiling, attics or garages.

All exhaust must be ducted to the outside.

Use metal ductwork only.

Fasten all connections with sheet metal screws and tape all joints with certified Silver Tape or Duct Tape.

Duct Run Calculation:

Maximum run 6" or 3-1/4 x 10" duct	100FT
Deduct:	
each 90 Elbow used	15FT
each 45 Elbow used	9FT
each 6" to 3/4 x 10"	1FT
transition used	
each 3/4 x 10" to 6"	5FT
transition used	
Side Wall Cap w/ damper	30FT
Roof Cap	30FT

e.g. – 1 roof cap, 2x90 elbows, 1x45 elbow

= 30' + 30' + 9'=69' used,

31' available for straight duct runs

### DUCT SIZE

A minimum 6" round duct must be used to maintain maximum airflow efficiency.

Flexible ducts are provided for convenience, always use rigid type metal ducts if available to maximizing airflow.

Also use calculation (on left) to determine total available duct run when using elbows, transitions and caps.

ALWAYS, when possible, reduce the number of transitions and turns. If a long duct is required, increase duct size from 6" to 7 or 8".

If a reducer is used, install a long reducer instead of pancake reducer. Reduce duct size as far away from the opening as possible.

If turns or transitions are required: Install as far away from opening and as far apart, between 2, as possible.





# All Refrigerator

FPRU19F8RF

18.6 Cu. Ft.



*Shown with companion, All-Freezer model FPFU19F8RF and optional coordinated Dual 75" Louvered Trim Kit (TRIMKITEZ2).*

## Signature Features

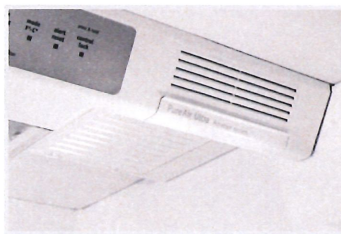

### PureAir Ultra® Filtration System

Fresh air offers great taste. PureAir Ultra® Filtration removes up to 7 times more odor than baking soda to keep ingredients tasting fresh.<sup>1</sup>



### SpacePro™ Shelving System

Offers quick access to fresh ingredients with organizational solutions designed for space optimization including SpacePro™ Door Bins, SpacePro™ Crisper Bins and SpacePro™ Full-Width Drawer.



### Smudge-Proof™

Resists fingerprints and cleans easily.

## Product Dimensions

Height (Cabinet Incl. Hinge)	70-5/8"
Width	32"
Depth (Including Door)	26-1/2"

## More Easy-To-Use Features

### Automatic Alerts

Alerts you if the door is left open, if the temperature rises or if the power goes out so your food stays at its optimal temperature.

### SpacePro™ Crisper Bins

Keep a variety of foods fresh and easily accessible with our SpacePro™ Crisper Bins.

### SpacePro™ Full-Width Drawer

Fits a variety of fresh foods for quick access.

### SpacePro™ Shelving

Optimize your refrigerator space with adjustable shelving.

### SpacePro™ Door Bins

Access fresh food from our adjustable gallon-size door bins quickly.

### PowerBright™ LED Lighting

Find fresh foods quickly with PowerBright™ LED Lighting.

### PrecisionPro Controls™

Adjust settings at the touch of a button.

Sabbath Mode (Star-K® Certified)

Available in:



Stainless  
(F)

## Optional Trim Kits

### Single 79" Louvered or 75" Collar Trim Kit (TRIMKITEZ1)

Optional trim kit that is designed to provide a built-in look for the All Refrigerator. Install with louver for 79" fit or easy-to-remove louver for a 75" fitted collar look.

### Dual 79" Louvered or 75" Collar Trim Kit (TRIMKITEZ2)

Optional trim kit that is designed to provide a built-in look for the All Refrigerator and All Freezer when the units are installed next to each other. Install with louver for 79" fit or easy-to-remove louver for a 75" fitted collar look.

<sup>1</sup>Based on a six-hour closed door test of certain common odors in the fresh food compartment of a 21 Cu. Ft. refrigerator.

frigidaire.com

Features	
Door Design	Flat
Door Finish	Smudge-Proof™ Stainless Steel
Door Handle Design	Stainless Steel
Cabinet Finish	Grey
Door Hinge Covers	Hidden
Automatic Door Closer	Yes
Leveling System/Leveling Legs	Yes/4
Controls	
Controls	PrecisionPro™
Location of Controls	Inside Cabinet, on Top
Temperature Display C°/F°	Yes
Control Lock/Light	Yes / No
Temp Failure Alerts (Audible & Duration)	Yes
Door Ajar Alert (Audible)	Yes
Power Failure Alert (Duration)	Yes
Air Filter/Air Filter Change Indicator Light	PureAir Ultra™/Yes
Refrigerator Features	
Refrigerator Shelves	2 SpacePro™ Adjustable Glass
Full-Width Deli Drawer	1 SpacePro™
Full-Width Bottom Crisper	1 SpacePro™
Crisper Divider Quantity	2 (Per Crisper)
Full-Width Gallon Door Bin	2 Clear SpacePro™
Half-Width Liter Bin	4 Clear SpacePro™
Dairy Bin	1 Clear
Lighting	8-Point PowerBright™ LED
Optional Accessories	
Single Louvered Trim Kit	PN# TRIMKITEZ1
Dual Louvered Trim Kit	PN# TRIMKITEZ2
Certifications	
Sabbath Mode (Star-K® Certified)	Yes
Specifications	
Total Capacity (Cu. Ft.)	18.6
Shelf Area (Sq. Ft.)	20.6
Annual Energy (kWh)	331
Annual Energy Cost (.12/kWh)	\$40
Power Supply Connection Location	Right Bottom Rear
Voltage Rating	115V/60Hz/20A
Connected Load (kW rating) @ 115 Volts¹	0.55
Amps @ 115 Volts	15
Minimum Circuit Required (Amps)	20
Shipping Weight (Approx.)	245 Lbs.

<sup>1</sup>An electrical supply with grounded three-prong receptacle is required. The power supply circuit must be installed in accordance with current edition of National Electrical Code (NFPA 70) and local codes & ordinances.

## Optional Trim Kits

Kits include top and side trim pieces, louvered grille, reversible kickplate and leveling system to fit 75" or 79" opening height.

### Single 79" Louvered or 75" Collar Trim Kit PN# TRIMKITEZ1

### Dual 79" Louvered or 75" Collar Trim Kit PN# TRIMKITEZ2

(Includes hardware to secure side-by-side units together.)

Note: Both kits attach directly to cabinetry through top trim piece or louvered grille to stabilize unit(s).

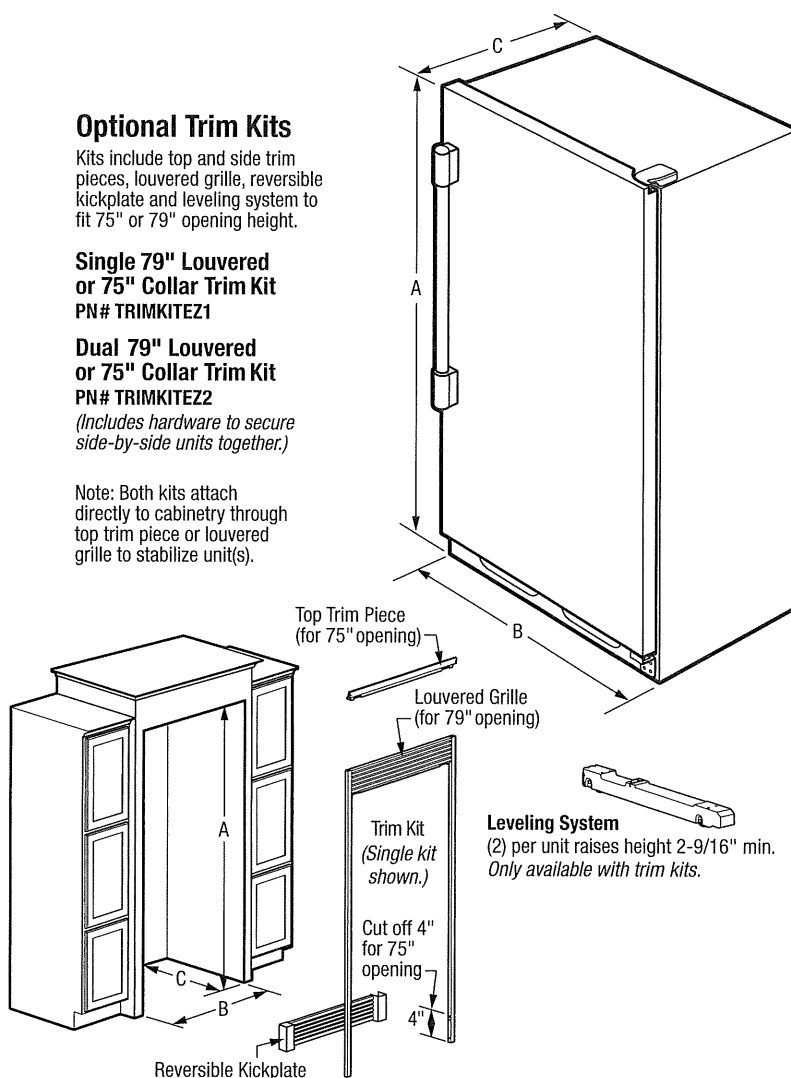

NOTE: For planning purposes only. Always consult local and national electric and plumbing codes. Refer to Product Installation Guide for detailed installation instructions on the web at [frigidaire.com](http://frigidaire.com).



Overall Exterior Dimensions	
A - Height (Incl. Door)/(Cabinet Incl. Hinge)	71-3/8" / 70-5/8"
B - Width	32"
C - Depth (Incl. Door)	26-1/2"
Depth with Door Open 90°	57-3/8"

Built-In Cutout Dimensions	
Single Unit without Trim Kit -	
A - Height	72"
B - Width	33"
C - Depth	25-1/4" min. <sup>1</sup>
Single Unit with Trim Kit & Leveling System -	
A - Height	75" or 79"
B - Width	33"
C - Depth	25-1/4" min. <sup>1</sup>

Built-In Cutout Dimensions	
Dual Unit <sup>2</sup> without Trim Kit -	
A - Height	72"
B - Width	66"
C - Depth	25-1/4" min. <sup>1</sup>
Dual Unit <sup>2</sup> with Trim Kit & Leveling System -	
A - Height	75" or 79"
B - Width	66"
C - Depth	25-1/4" min. <sup>1</sup>

<sup>1</sup>Minimum depth from face of cabinet side panels and requires recessed electrical outlet.

<sup>2</sup>Side-by-Side

Accessories information available on the web at [frigidaire.com](http://frigidaire.com)



- Product Shipping Weight – 245 Lbs.
- An electrical supply with grounded three-prong receptacle is required. The power supply circuit must be installed in accordance with current edition of *National Electrical Code (NFPA 70)* and local codes & ordinances.
- Voltage Rating – 115V/60 Hz/20 Amps
- Connected Load (kW Rating) @ 115 Volts = 0.55 kW
- Amps @ 115 Volts = 15 Amps
- Always consult local and national electric codes.
- Minimum 25-1/4" depth requires recessed electrical outlet.
- To allow for ease of installation, tape excess power cord to back of unit.
- When installing refrigerator adjacent to wall, cabinet or other appliance that extends beyond front edge of unit, 20" minimum clearance recommended to allow for optimum 140° door swing, providing complete drawer / crisper access and removal. *(Absolute 4" minimum clearance will ONLY allow for 90° door swing which will provide limited drawer / crisper access with restricted removal.)*
- Minimum 3/8" clearance required for sides and top of refrigerator or freezer with 1" clearance at rear to allow for ease of installation, proper air circulation, and plumbing/electrical connections.
- To ensure optimum performance, *(do not install in areas where temperature drops below 55°F or rises above 110°F)* and avoid installing in direct sunlight or close proximity to range, dishwasher or other heat source.

- Single Louvered Trim Kit - (PN # TRIMKITEZ1).
- Double Louvered Trim Kit - (PN # TRIMKITEZ2).
- PureAdvantage® Air Filter Replacement Cartridge - (PN # 241754001).





# Danby Fresh 5.8 cu. ft. Home Herb Grower

## DFG58D1BSS



### FEATURES

---

- ▶ The most advanced and energy efficient BloomBoss (r) 32W LED grow light
- ▶ Under shelf lighting, for coverage on both shelves
- ▶ Advanced airflow circulating fan
- ▶ Stainless steel door, toe kick and handle
- ▶ Free standing or built-in under counter
- ▶ Includes two adjustable and removable shelves
- ▶ Includes two planting trays with humidity domes
- ▶ Set and forget timer control for the light cycles
- ▶ See through glass door
- ▶ Reversible door hinge

### SPECIFICATIONS

#### Dimensions

Product Width	60.48 cm	23 13/16"
Product Depth	64.93 cm	25 9/16"
Product Height	87.95 cm	34 10/16"

#### Shipping Details

Weight	49.00kg	108.03lb
--------	---------	----------

#### Capacity

Loading Capacity	• 5.8 cu. ft.
------------------	---------------

UPC: 012218

#### WARRANTY

12 months parts and labour. Installation and/or yearly maintenance (cleaning) are not covered under warranty.



please use two expansion screws to fix feet on the floor.

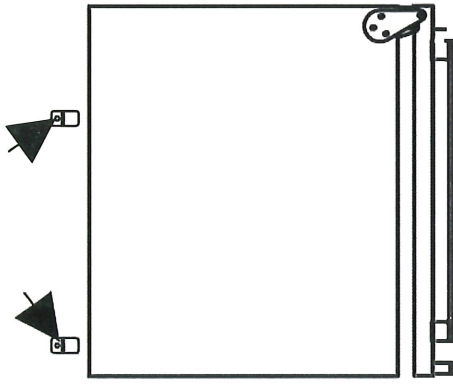

c. Push the appliance into its place of installation.

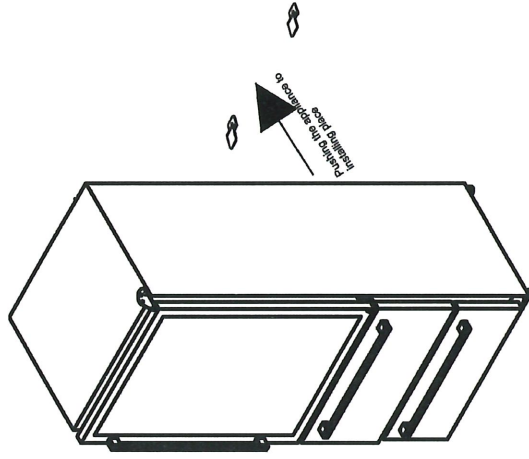

d. If the unit is not stable, pull out the appliance and repeat the previous step until the unit is stable.



## Instruction Manual Combi wine cooler & drawer FWCDR6661-30S

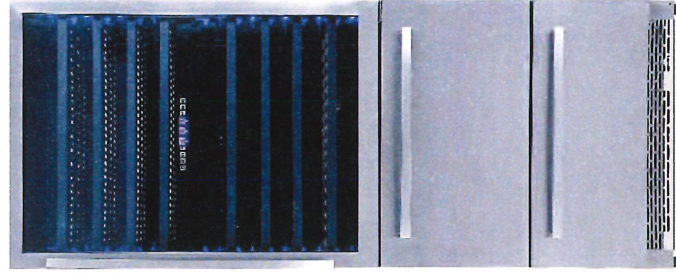

**BEFORE USE, PLEASE READ AND FOLLOW ALL  
SAFETY RULES AND OPERATING INSTRUCTIONS**



## The controls of your appliance

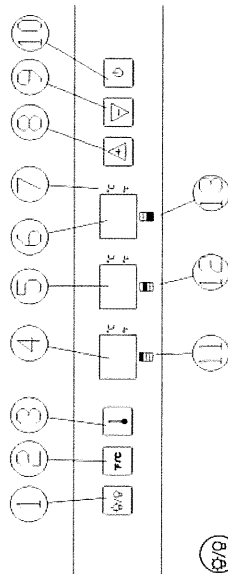

- 1- Light To control the inner light turn on/off.
- 2- °F/°C Selector Select the temperature display setting in Fahrenheit or Celsius degree.
- 3- Set temperature press this bottom, press temperature at any time, touch the UP or DOWN mark, the "set" temperature will temporarily "flash" in the LED display for 5 seconds.  
 4- Temperature Display for upper chamber of wine cooler.  
 The LED display will show the setting temperature when "flash"; Display will show the temperature for the lower chamber when normal.
- 5- Temperature Display for lower chamber of wine cooler.  
 The LED display will show the setting temperature when "flash"; Display will show the temperature for the lower chamber when normal.
- 6- Temperature Display for upper chamber of drawer fridge.  
 The LED display will show the setting temperature when "flash"; Display will show the temperature for the lower chamber when normal.
- 7- °C/°F Display
- 8- Up Used to raise (warm) the set temperature by 1°C or 1°F.
- 9- Down Used to lower (cool) the set temperature by 1°C or 1°F.
- 10- Power To control the appliance turn on/off. To turn off the appliance, touch the mark and hold for at least 5 seconds. Press again, turn on the appliance. The LED readout will show the original temperature set previously when restart the appliance or reconnect after power cuts.



## ● INSTALLATION

Before installing, carefully read the instruction in the end in order to avoid a certain number of problems.

### Cutout Dimensions

Your product has been designed built-in or free standing installation.

### Dimensions of the recess

Height of housing	mm	1960
Depth of housing	mm	700
Width of housing	mm	850

