

TWT BLK 12 LOT 119

DCR PHOENIX HOMES

TOWNHOUSE 20-14 - COLBY

KITCHEN / VANITIES

MOUNTING HEIGHT: 96"

42" H UPERS

LINE 1

HARDWARE - STD & 1st UPGRADE

STANDARD WHITE INTERIOR

METAL DRAWER BOX

6 PCS - 5/8" KICK - FIN. BOTH ENDS

3 PCS - LOOSE FILLER - 3 x 98

2 PCS - 90 DEG. CORNER MOULD

1 PCS - T-MOULD

6 PCS - FLAT MOULDING

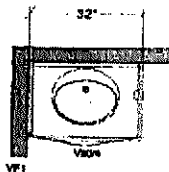
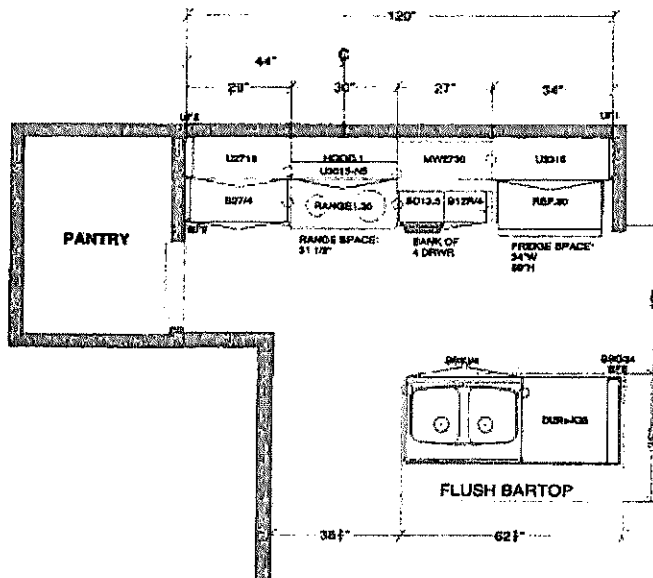

POWDER

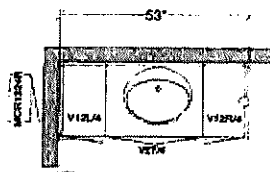

MAIN

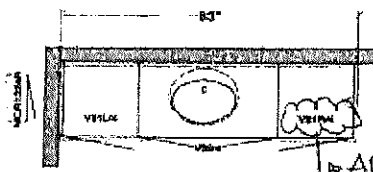

ENSUITE BANK OF DWS

All dimensions, sizes, designations given are subject to verification on job site and adjustment to fit job conditions.

SPECTRUM KITCHEN and BATH DESIGN

TH 20 - 14 - Colby - KIT - VAN kit

This is an original design and must not be released or copied unless applicable fee has been paid or job order placed.

DRAWN BY: LORI DISAVERIO, B.I.D

Designed: 2018-02-28
Printed: 2018-03-01

All

Drawing #: 1: No Scale.

600 VS AS