

CORE

OMBRA

WALL

Ombra is the perfect combination of form and function with its capacitive touch controls and optional hybrid baffle filters. Ombra features a powerful 600 CFM blower with our exclusive Airflow Control Tech-

nology™ (ACT™) to meet local code requirements. Available in sleek black stainless steel and stainless steel.

ZEPHYR
ZEPHYRONLINE.COM

ACT™

	INTERNAL BLOWER STANDARD	INTERNAL BLOWER with ACT™ AIRFLOW CONTROL TECHNOLOGY™*	
Min. - Max. CFM	200 - 600	200 - 390	200 - 290
Min. - Max. Sones	1 - 6	1 - 4	1 - 3

*AIRFLOW CONTROL TECHNOLOGY™ (ACT™) is an exclusive feature built into specific Zephyr hoods which can limit the maximum blower CFM to meet local code requirements.

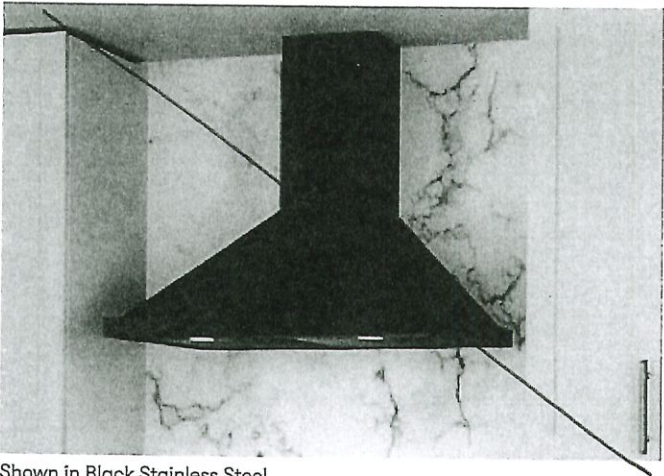

Shown in Black Stainless Steel

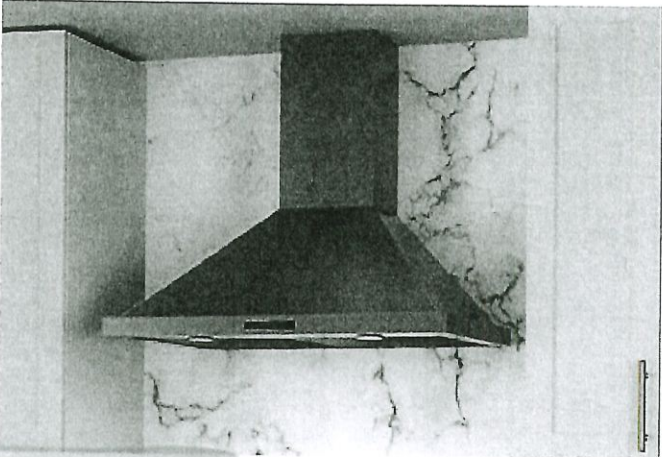

Shown in Stainless Steel

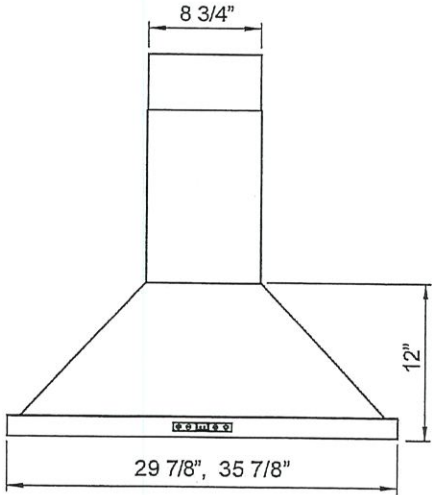

FRONT

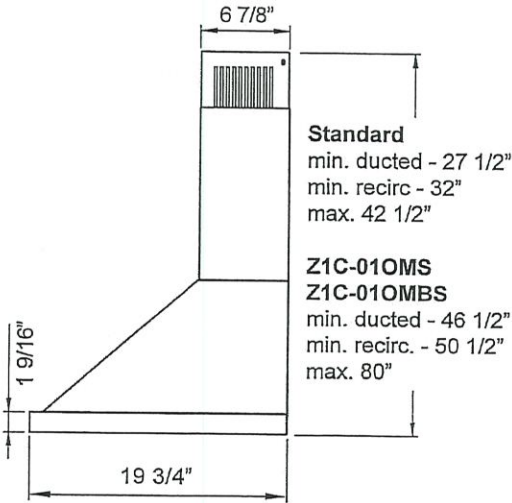

SIDE

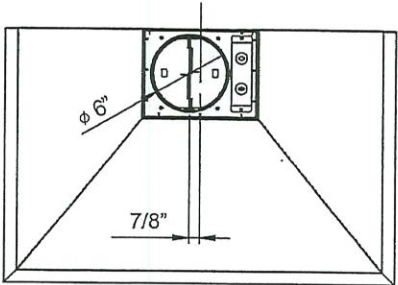

TOP



CORE

OMBRA

WALL

MODEL		
Stainless Steel	ZOM-E30AS	ZOM-E36AS
Black Stainless Steel	ZOM-E30ABS	ZOM-E36ABS
Size	30"	36"
Blower CFM (Min. - Max.)	200 - 600	200 - 600
Sones (Min. - Max.)	1 - 6	1 - 6
ACT 390 CFM (Min. - Max.)	200 - 390	200 - 390
ACT 390 Sones (Min. - Max.)	1 - 4	1 - 4
ACT 290 CFM (Min. - Max.)	200 - 290	200 - 290
ACT 290 Sones (Min. - Max.)	1 - 3	1 - 3
FEATURES		
ACT™ Technology	Yes	Yes
Controls	Capacitive Touch	Capacitive Touch
Speed Levels	4*	4*
Auto Delay-Off	Yes	Yes
Lighting	Halogen, 35W x2	Halogen, 35W x2
Dual-Level Lighting	Yes	Yes
Filters	Aluminum Mesh x2	Aluminum Mesh x2
Recirculating Option	Yes	Yes
Duct Cover Extension Option	Yes, Up to 12' Ceiling	Yes, Up to 12' Ceiling
DUCT SPECIFICATIONS		
Vertical Internal Blower	6" Round	6" Round
Horizontal Internal Blower	NA	NA
AC POWER	120V, 60Hz at Max. 3.5A	120V, 60Hz at Max. 3.5A
OPTIONAL ACCESSORIES		
Recirculating Kit	ZRC-01OM	ZRC-01OM
Duct Cover Extension	Z1C-01OMS (ss) Z1C-01OMBS (black ss)	Z1C-01OMS (ss) Z1C-01OMBS (black ss)
Bloom™ GU10 LED	Z0B0040	Z0B0040
Hybrid Baffle Filter Kit	Z0F-B002	Z0F-B002
Make-Up Air Kit	MUA006A	MUA006A
MOUNTING HEIGHT RANGE**	26" - 34"	26" - 34"
WARRANTY	3 years parts, 1 year labor	3 years parts, 1 year labor

CEILING HEIGHT		8'	8.5'	9'	9.5'	10'	10.5'	11'	12'
STANDARD DUCT COVER	Ducted Mounting Height**	26" - 33.5"	26" - 34"	29.5" - 34"	NA	NA	NA	NA	NA
	Recirc Mounting Height**	26" - 28.5"	26" - 34"	29.5" - 34"	NA	NA	NA	NA	NA
DUCT COVER EXTENSION	Ducted Mounting Height**	NA	NA	26" - 30.5"	26" - 34"	26" - 34"	26" - 34"	26" - 34"	28" - 34"
	Recirc Mounting Height**	NA	NA	26" - 26"	26" - 32"	26" - 34"	26" - 34"	26" - 34"	28" - 34"

*When ACT™ is enabled the maximum speed levels will change. ACT 390 CFM = 3 speeds and ACT 290 CFM = 2 speeds.
**Mounting height refers to distance between top of a 36" tall cooking surface and bottom of hood.

ACT™ AIRFLOW CONTROL TECHNOLOGY™ (ACT™)
is an exclusive feature built into specific Zephyr hoods which can
limit the maximum blower CFM to meet local code requirements.

Specifications subject to change, check zephyronline.com for up-to-date information.
Zephyr Ventilation | 2277 Harbor Bay Parkway, Alameda, CA 94502 | 888.880.VENT

SEP18.0101



Jazz (Drop-In)

Model number: 105509

Dimensions: 66" x 36" x 24" Installation: Drop-in Material: Acrylic



Standard Features:

- Deep soak bathing for ultimate relaxation
- Comfortable, ergonomic design with relaxing armrests
- Drop-in installation with center drain
- 4 adjustable leveling legs

Product characteristics:

- Comfortable backrest
- Maximized Bathing Well
- Therapy System Available

Systems:

ψ Aerofeel

Warranty:

25 Years

Standard colors:

☐ White (001) ☐ Bone (004) ☐ Biscuit (007)

Certifications

MAAX products adhere to one or more of the following certifications:



Options (Visit our website for a complete list of our options)

PW 149

No	Description
<input type="checkbox"/> OPT 10054	Two chromatherapy lights
<input type="checkbox"/> OPT 10119	Metal trim kit for Aerofeel

AS

Jazz (Drop-In)

Model number: 105509

Dimensions: 66" x 36" x 24" Installation: Drop-in

Material: Acrylic

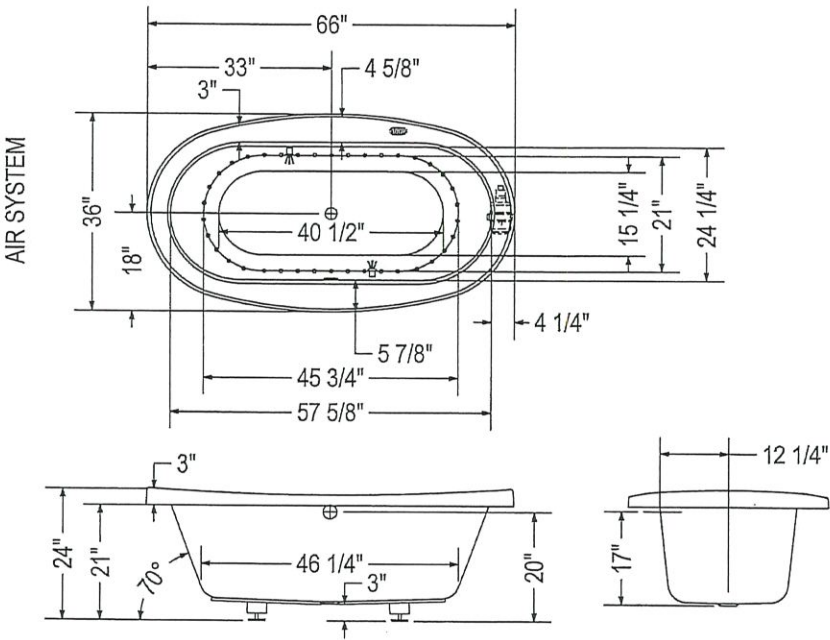

(●) : Indicates airjets positioning
(☼) : Indicates chromatherapy light positioning
All dimensions are approximate. Structure measurements must be verified against the unit to ensure proper fit.

Dimensions:

66 x 36 x 24 in.
(1676 x 914 x 610 mm)

Water capacity:

76 gallons - 286 liters

Weight:

100 lbs - 45.35 kg

Bathing well:

46 1/4 X 24 1/4 in.
(1175 X 616 mm)

Deep sump height:

19 1/4 in. - 489 mm

Deck width:

5 7/8 in. - 149 mm

Drain location:

Center

Project: PW 149

Contractor:

Representative:

Date:

Tel:

Notes:

A-S

A

Exhibit 6030 IFS

PW 149

Model number: 105519

Dimensions: 60" x 30" x 18" Installation: Alcove Material: Acrylic

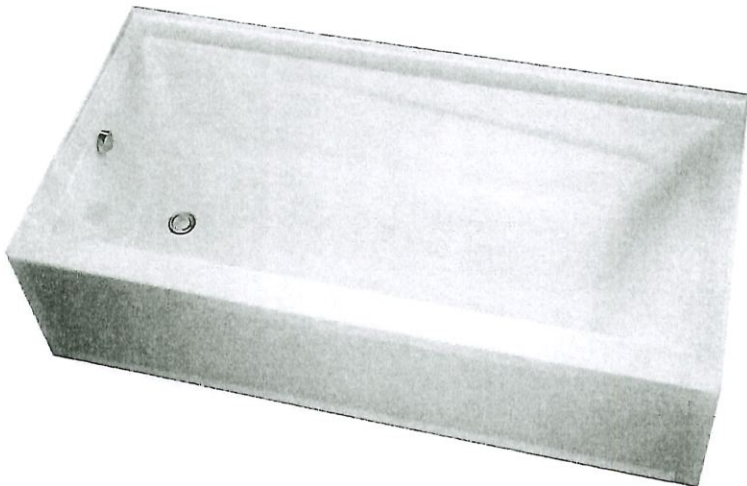

Standard Features:

- Rectangular shape bathtub in alcove installation
- Available in Above-the-Floor Rough (AFR) or not
- Minimalist look with discreet armrests and textured floor
- Integrated tiling flange
- Integrated skirt with access panel when equipped with a system

Product characteristics:

- Made in North America
- Elegant design
- Integrated Tiling Flange and Skirt

Systems:

- ☞ Whirlpool
- ☞ Combined Whirlpool/Aeroeffect
- ☞ Aeroeffect

Warranty:

25 Years

Standard colors:

White (001)

Bone (004)

Biscuit (007)

Certifications

MAAX products adhere to one or more of the following certifications:

UL

ICG

ES

PMG

AS

~~4~~

Recommended products (Visit our website for a complete list of our recommended doors)

No	Description
139398	Halo Sliding Tub Door 56 1/2-59 x 59 in. 8 mm
135330	Inoognito 57 Shaker Sliding Tub Door 56-59 x 56 3/4 in. 8 mm
139351	Inoognito 57 Sliding Tub Door 56-59 x 56 3/4 in. 6 mm

Options (Visit our website for a complete list of our options)

No	Description
<input type="checkbox"/> OPT 10019	Removable access panel
<input type="checkbox"/> OPT 10053	Chromatherapy
<input type="checkbox"/> OPT 10095	Water heater assembly
<input type="checkbox"/> OPT 10106	Metal trim kit for whirlpool and combined systems
<input type="checkbox"/> OPT 20029	Metal trim kit for Air Push Control

Exhibit 6030 IFS

PW 149

Model number: 105519

Dimensions: 60" x 30" x 18" Installation: Alcove Material: Acrylic

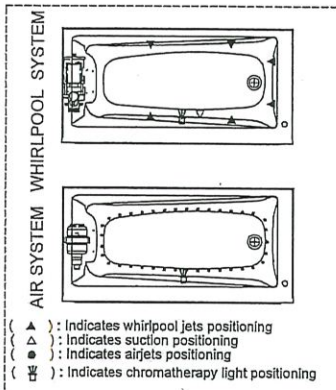
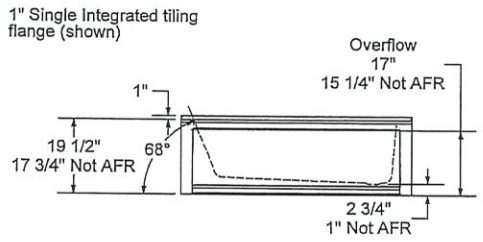
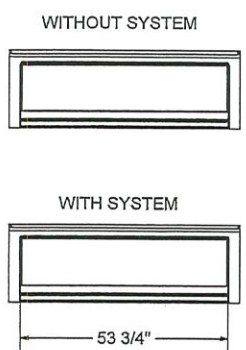
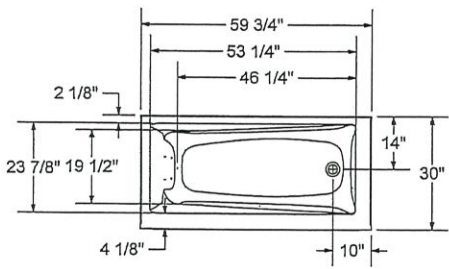

Wood support design may vary.
Single Integrated tiling flange: 1" height x 1/4" thickness (shown)
All dimensions are approximate. Structure measurements must be verified against the unit to ensure proper fit.

Dimensions:
59 3/4 x 30 x 17 3/4 in.
(1518 x 762 x 451 mm)

Water capacity:
44 gallons - 168 liters

Weight:
77 lbs - 34.92 kg

Bathing well:
59 3/4 X 23 7/8 in.
(1518 X 606 mm)

Deep sump height:
16 1/2 in. - 419 mm

Deck width:
4 1/8 in. - 105 mm

Drain location:
Left

Right

Project: _____

Contractor: _____

Representative: _____

Date: _____





Tel: _____

Notes: _____

AS

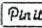
PW 149

DELTA
Monitor 14 Series Contemporary Square Shower Kit



Model #: DF-TKIT2-PBS
[What does this model number mean?](#)

Where to Buy ▶

Own this product?
Registering it helps us provide the best service. [Register Product](#)

Want to save this product so you can quickly find it later? [Save as a Product I Own](#)

Need help with your product?
[Troubleshoot Your Issue](#) ▶

[More Photos](#)

[View Larger](#) [Change Background](#)

[Share](#) [Email](#)

Product Features and Benefits	Product Support, Repair Parts & Tech Specs
<ul style="list-style-type: none">✓ Monitor 14 Series valve-only trim with integrated diverter✓ Single function Touch-Clean shower head✓ Single setting H2Okinetic hand shower with slide bar and hose	<ul style="list-style-type: none">✓ Shower arm and flange included✓ Order MultiChoice Universal rough separately✓ <u>Lifetime Faucet and Finish Warranty.</u>

AS