

<b>Trade Name:</b> Lormel Homes	<b>Site location:</b>	<b>Model:</b> 3530 Crown
<b>Address:</b>	<b>Project:</b> Balmoral Estates	<b>Phase:</b>

This layout has been explained to the purchaser by Cortina Kitchens Inc. and is understood by the purchaser.

**STD:**

GB0

LIGHT VALANCE  
SOFT CLOSE KITCHEN ONLY  
STRAIGHT CANOPY NO MOTOR  
WASTE BIN  
36" STOVE OPENING  
130 cm HIGH UPPER  
1 SET OF POTS PANS DRS  
BUILTIN FRIDGE (SPEC R. TYPICAL)

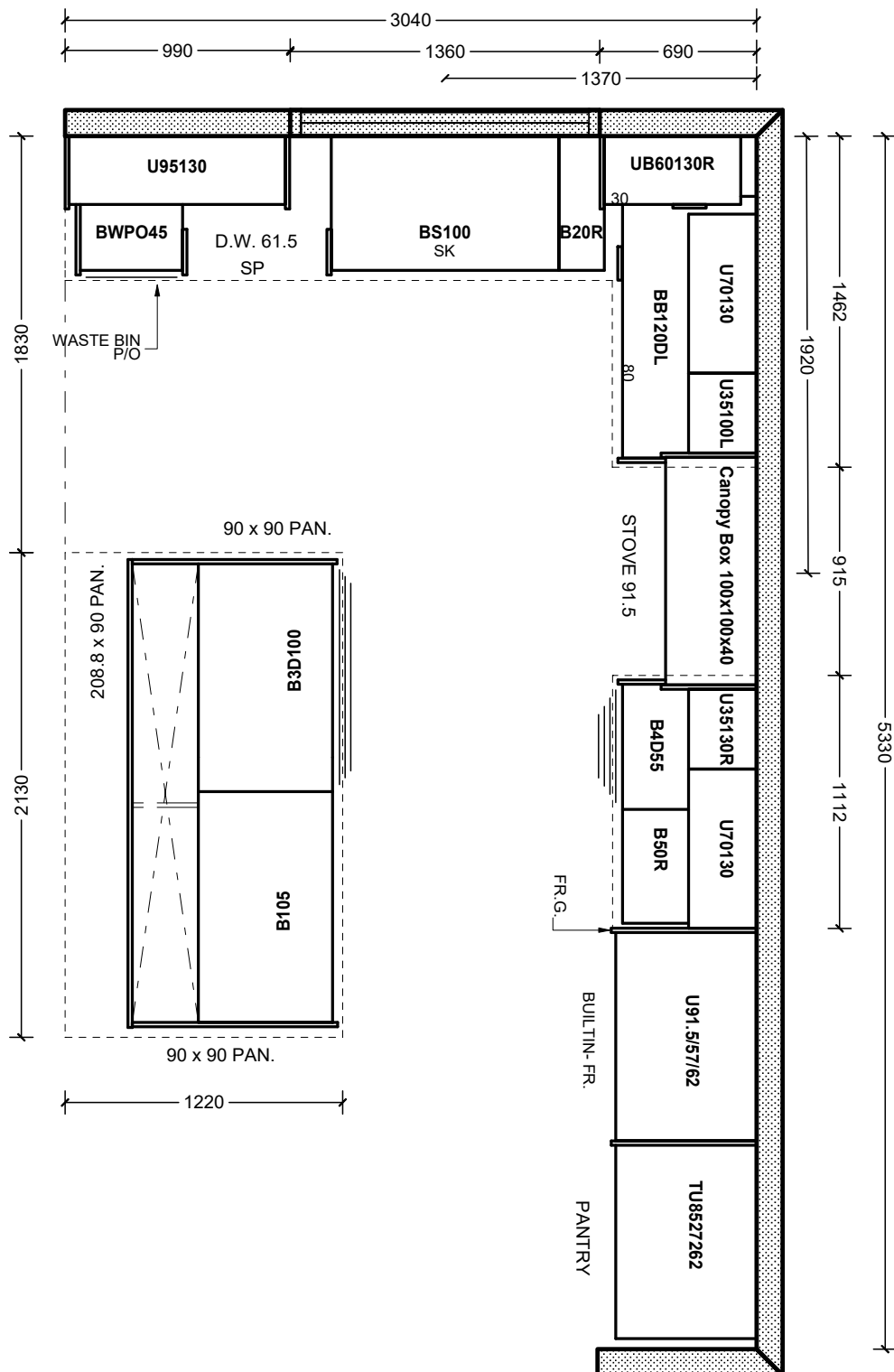

## POWDER

A horizontal line segment with tick marks at both ends, labeled 1200.

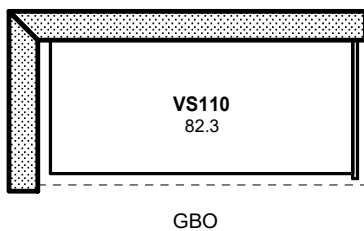

— 2590 —

- 1040 —————

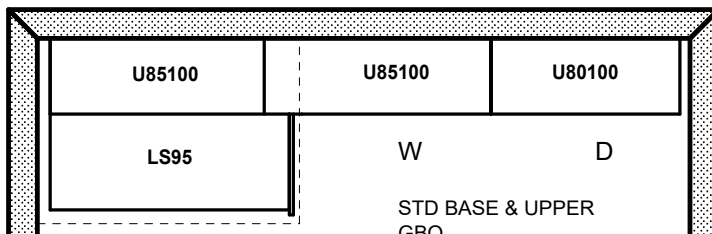

All prices subject to confirmation from head office.  
This quotation is subject to the terms & conditions set out  
in Cortina's Agreement of Purchase and Sale.

All agreements are contingent upon strikes, accidents, and delays beyond our control. Please provide our installer with template for sinkholes or \$150.00 will be charged for callback.

ACCEPTED DATE:

Customer Signature

Salesperson Signature

Cortina Head Office Approval

Item A. Wood grain and colour are characteristics of the product. We cannot guarantee that such grain and colour will always match.  
Item B. Cortina Kitchens Inc. reserves the right to alter dimensions and make technical changes without notice.

Trade Name: Lormel Homes	Site location:	Model: 3530 Crown
Address:	Project: Balmoral Estates	Phase:

This layout has been explained to the purchaser by Cortina Kitchens Inc. and is understood by the purchaser.

SECOND FLOOR

BATH BED 2/3

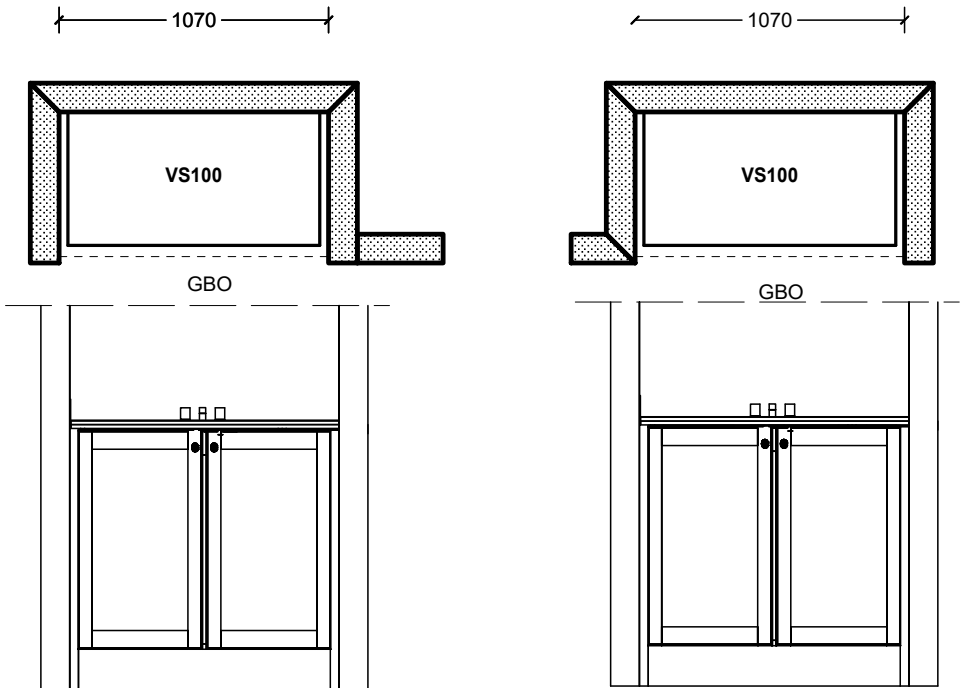

BATH BED 4

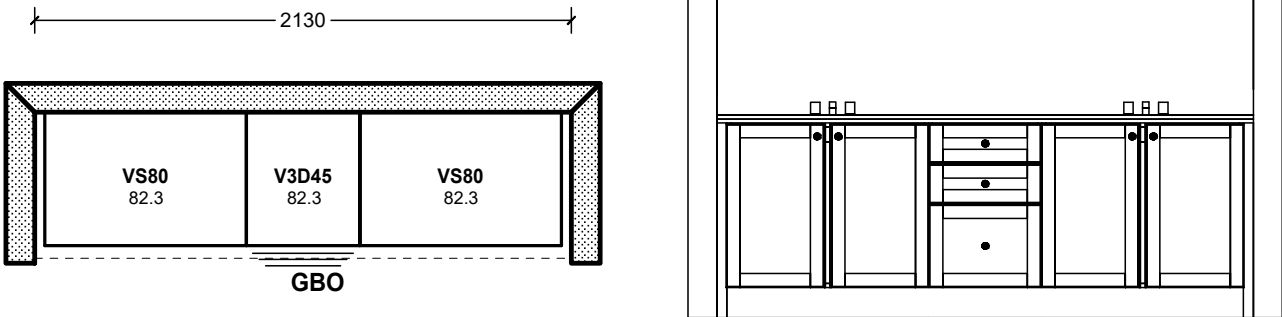

ENSUITE

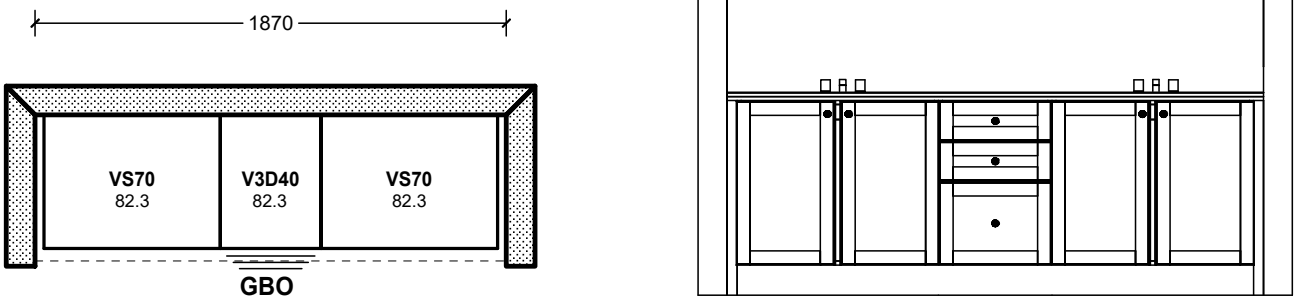

All prices subject to confirmation from head office.  
This quotation is subject to the terms & conditions set out  
in Cortina's Agreement of Purchase and Sale.

ACCEPTED DATE: \_\_\_\_\_

All agreements are contingent upon strikes, accidents, and delays beyond our control.  
Please provide our installer with template for sinkholes or \$150.00 will be charged for callback.

Customer Signature

Salesperson Signature

Cortina Head Office Approval

Item A. Wood grain and colour are characteristics of the product. We cannot guarantee that such grain and colour will always match.  
Item B. Cortina Kitchens Inc. reserves the right to alter dimensions and make technical changes without notice.

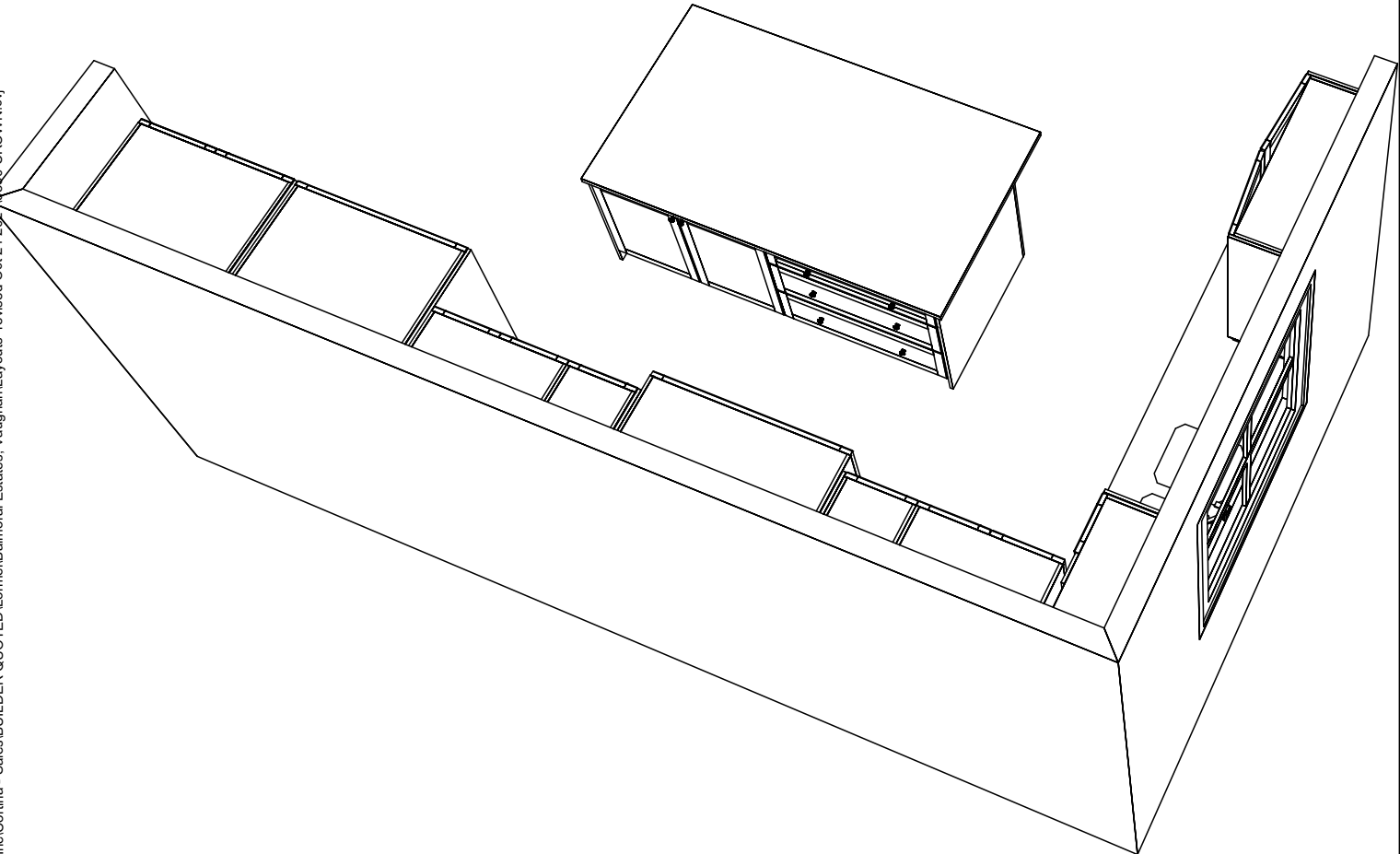
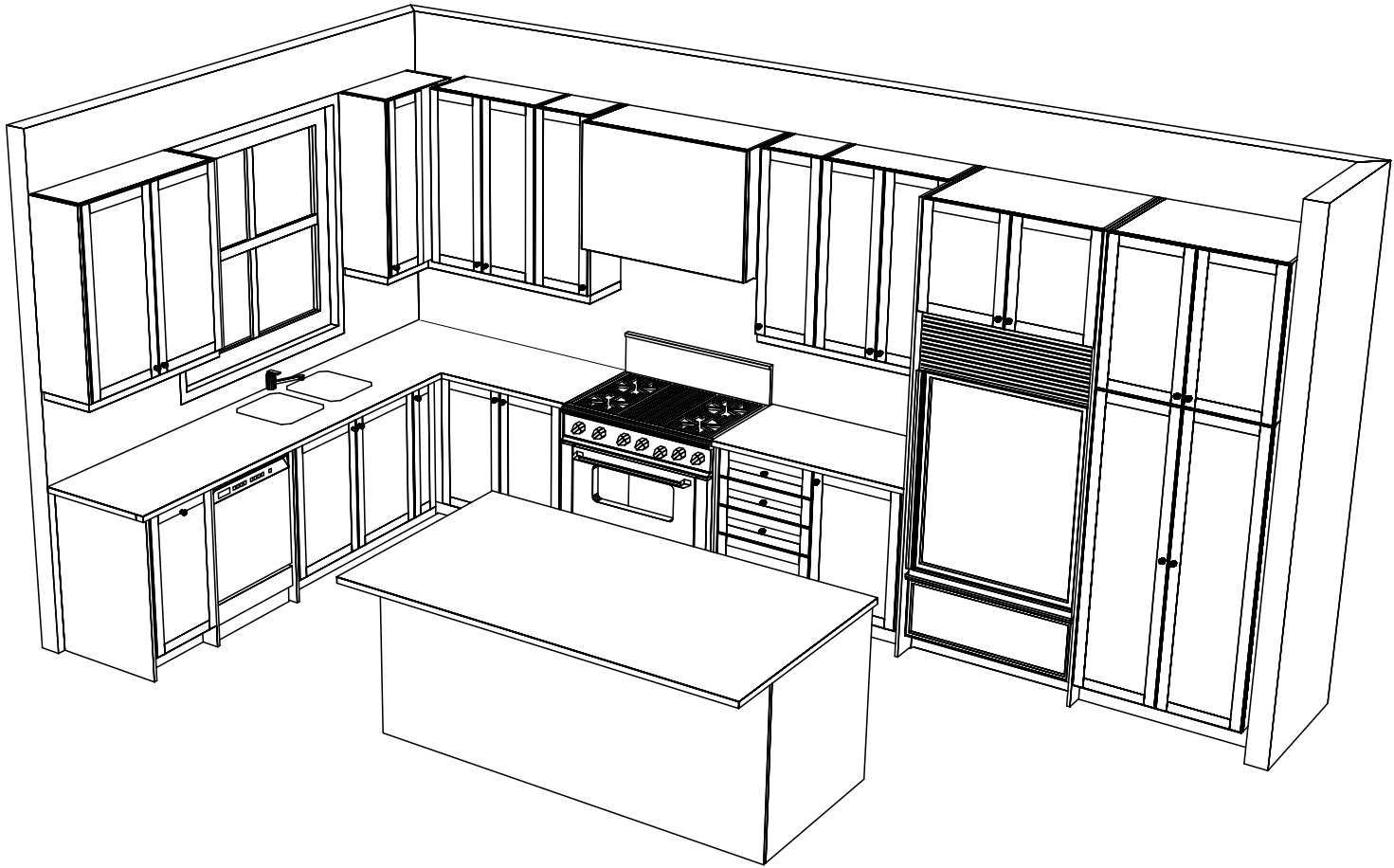

Note: This drawing is an artistic interpretation of the general appearance of the design. It is not meant to be an exact rendition. Generic doors are shown which may affect such things as hardware drilling and specific profiles.designs. .

Trade Name: Lormel Homes	Site location:	Model: 3530 Crown
Address:	Project: Balmoral Estates	Phase:

This layout has been explained to the purchaser by Cortina Kitchens Inc. and is understood by the purchaser.

ENSUITE CLOSET

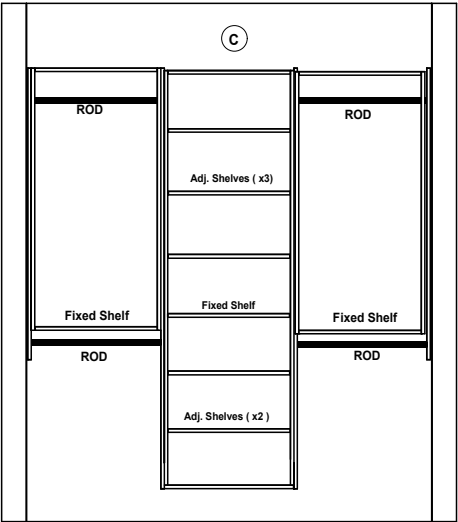
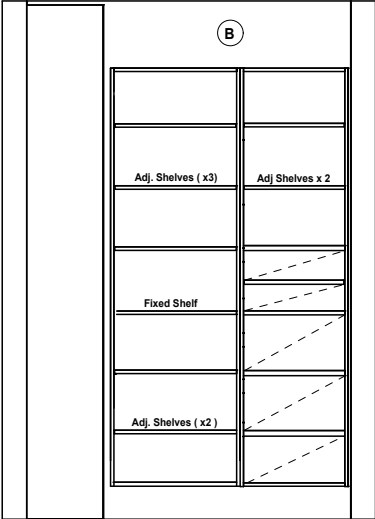
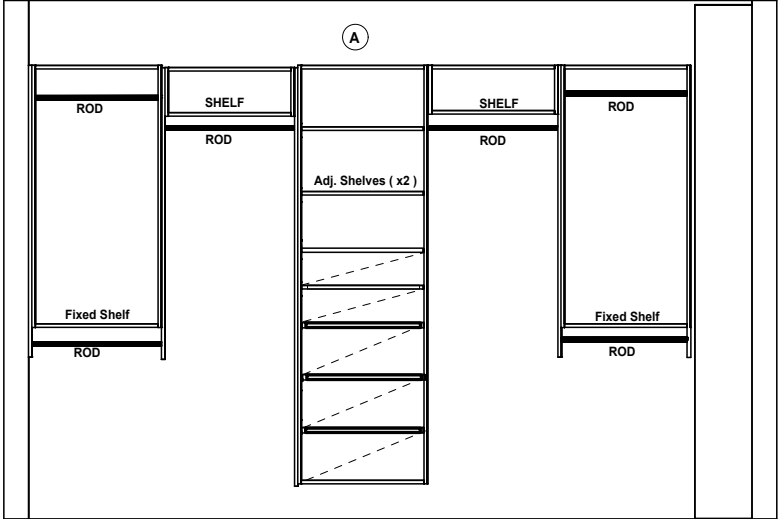
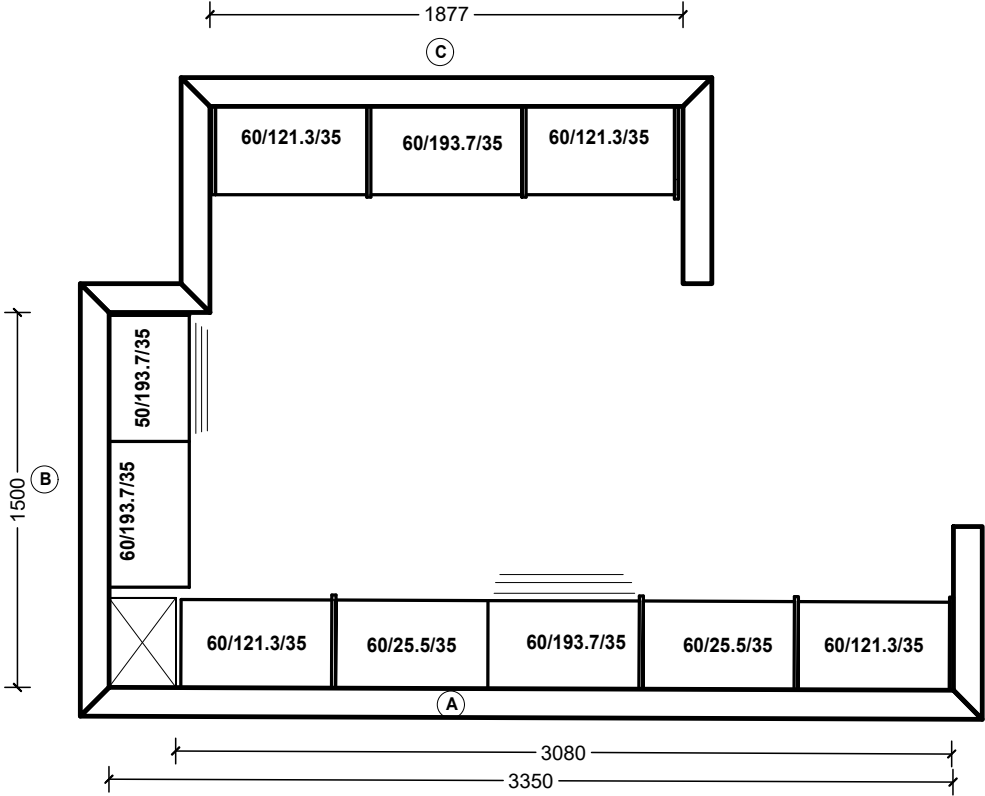

All prices subject to confirmation from head office.  
This quotation is subject to the terms & conditions set out  
in Cortina's Agreement of Purchase and Sale.

All agreements are contingent upon strikes, accidents, and delays beyond our control.  
Please provide our installer with template for sinkholes or \$150.00 will be charged for callback.

ACCEPTED DATE: \_\_\_\_\_

Customer Signature

Salesperson Signature

Cortina Head Office Approval

Item A. Wood grain and colour are characteristics of the product. We cannot guarantee that such grain and colour will always match.  
Item B. Cortina Kitchens Inc. reserves the right to alter dimensions and make technical changes without notice.