

MR00014125

KHO DESIGN & CONSTRUCTION, KITTY HO  
1402 STOVELL CRES

Contents	Page no.
<b>RF28T5A01SR</b> Samsung Refrigeration  28 cu.ft. 36" French Door Refrigerator with All-Around Cooling	3-4
<b>NE63T8111SS/AC</b> Samsung Range  6.3 cu.ft. Slide-in Electric Range with Wi-Fi	5-8
<b>DW80K5050USAC</b> Samsung Dishwasher	9-10
<b>WF45T6000AW</b> Samsung Washer  4.5 cu. ft. Front Load Washer with Vibration Reduction Technology+ in White	11-12
<b>DVE45T6005W/AC</b> Samsung Dryer  7.5 Cu.Ft. Electric Dryer with Energy Star Certification	13-14



Goemans Appliances  
goemans.com

Richard Ku  
905-513 0004

Document **MR00014125**  
Version 1.1

Sun, Nov 27, 2022  
12:21 PM EST



[enterprise.steelcod.com/sp/goem/F0CEX5YR](https://enterprise.steelcod.com/sp/goem/F0CEX5YR)

**Note about page numbers:**  
Because the original manufacturer's documents are not altered in any way, the page numbers displayed on the page may not correspond to the page number within this package.

**All specifications are intended for initial planning purposes only.**  
Manufacturers reserve the right to change specifications at any time without notice. Always consult the installation instructions found on the manufacturer's website or included with the appliances before installation.

LOT 5-19, PH5, APPLIANCES

# RF28T5A01SR



28.2 cu. Ft. French Door with All-Around Cooling

[www.samsung.com/ca](http://www.samsung.com/ca)



- Net for Freezer - 8.6 cu.ft
- Net for Fridge - 19.6 cu.ft
- Humidity Control (Vegetable&Fruit Drawer)
- Number of Shelf - 5 EA
- Gallon Door Storage - 6 EA
- Tempered Glass
- Number of Vegetable & Fruit Drawer - 2 EA
- Power Cool Function
- Interior LED Light
- Automatic Ice Maker
- Power Freeze Function
- Door Alarm
- Energy Star Certification

**Color**    Stainless Steel

### Dimensions

Width	35-6/8"
Height	70"
Depth	35-3/8"

Product dimension, cutout and installation specifications are provided for planning purposes only. Before installing any product, be sure to verify cutout dimensions and electrical/gas connections with the installation guide.

®Registered trademark/TM Trademark of Samsung Electronics Canada Inc. © Samsung Electronics Canada Inc. All Rights Reserved.  
All other trademarks are owned by their respective companies.  
Because Samsung Electronics Canada Inc. policy includes a continuous commitment to improve our products, we reserve the right to change materials and specifications without notice. We also reserve the right to discontinue or transition products without notice.

# Installation

## Clearance

See the following figures and tables for space requirements for installation.

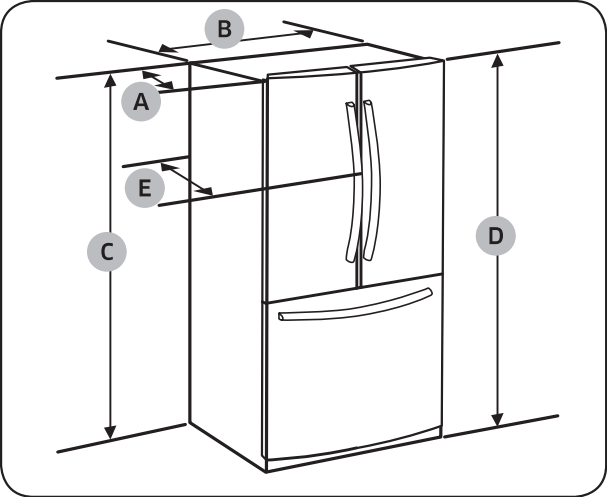

Model	RF28*
Depth "A"	32 7/8" (836 mm)
Width "B"	35 3/4" (908 mm)
Height "C"	68 7/8" (1749 mm)
Overall Height "D"	70" (1777 mm)
Depth "E"	35 3/8" (898 mm)

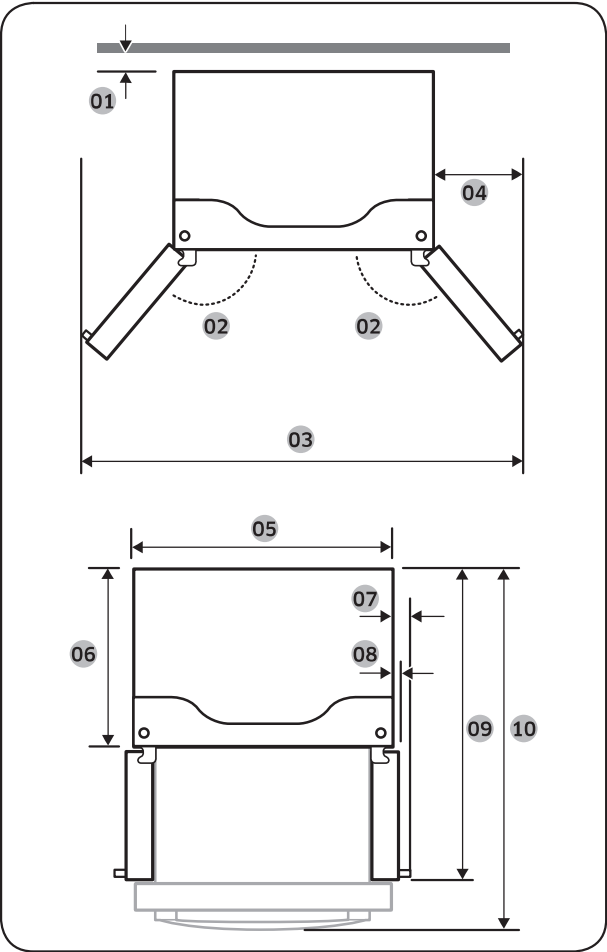

Model	RF28*
01	2" (50 mm)
02	130°
03	62 2/8" (1581 mm)
04	13 2/8" (337 mm)
05	35 3/4" (908 mm)
06	28 7/8" (735 mm)
07	3 5/8" (93 mm)
08	1 7/8" (47 mm)
09	47 2/8" (1201 mm)
10	51 7/8" (1318 mm)

**NOTE**  
The measurements in the table above may differ slightly from the actual measurements, depending on the measuring and rounding method.

LOT 5-19, PH5, APPLIANCES

# NE63T8111SS/AC



6.3 cu. ft. Electric Range with Slide-in Design

[www.samsung.com/ca](http://www.samsung.com/ca)



**Color**    Stainless Steel

## Dimensions

Width	29-15/16"
Height	36" to 36-3/4"
Depth	28-11/16"

- Oven Capacity 6.3 cu. ft.
- Drawer Capacity 1.0 cu. ft.
- Self Clean
- Steam Clean
- Wi-Fi Connection
- Bread Proof 100°F (40°C)
- Keep Warm
- Clock
- Timer
- Child Safety Lock
- Hidden Bake Element
- Interior Light 1 Incandescent 40W / Back
- Light (Lamp) On/Off
- Sound on/off
- Delay Start
- Sabbath Mode
- Heating Element 1 - 6"/9" - 3000W
- Heating Element 2 - 6" - 1200W
- Heating Element 3 - 6"/9" - 3000W
- Heating Element 4 - 6" - 1200W
- Heating Element 5 - Warm Zone (100W)
- Hot Surface Indicator
- Bake (Single) - 175°F (80°C) - 550°F (285°C)
- Variable Broil (Low-High) (Single)
- Bake Element - 3000W
- Broil Element - 4200W
- Storage Drawer
- 7 Oven Rack Positions
- 2 Wire Racks
- Anti-Tip Device
- WiFi Embedded
- SmartThings App Support

**Product dimension, cutout and installation specifications are provided for planning purposes only. Before installing any product, be sure to verify cutout dimensions and electrical/gas connections with the installation**

®Registered trademark/TM Trademark of Samsung Electronics Canada Inc. © Samsung Electronics Canada Inc. All Rights Reserved.  
All other trademarks are owned by their respective companies.  
Because Samsung Electronics Canada Inc. policy includes a continuous commitment to improve our products, we reserve the right to change materials and specifications without notice. We also reserve the right to discontinue or transition products without notice.

## Preparing to install the range

Preparing to install the range

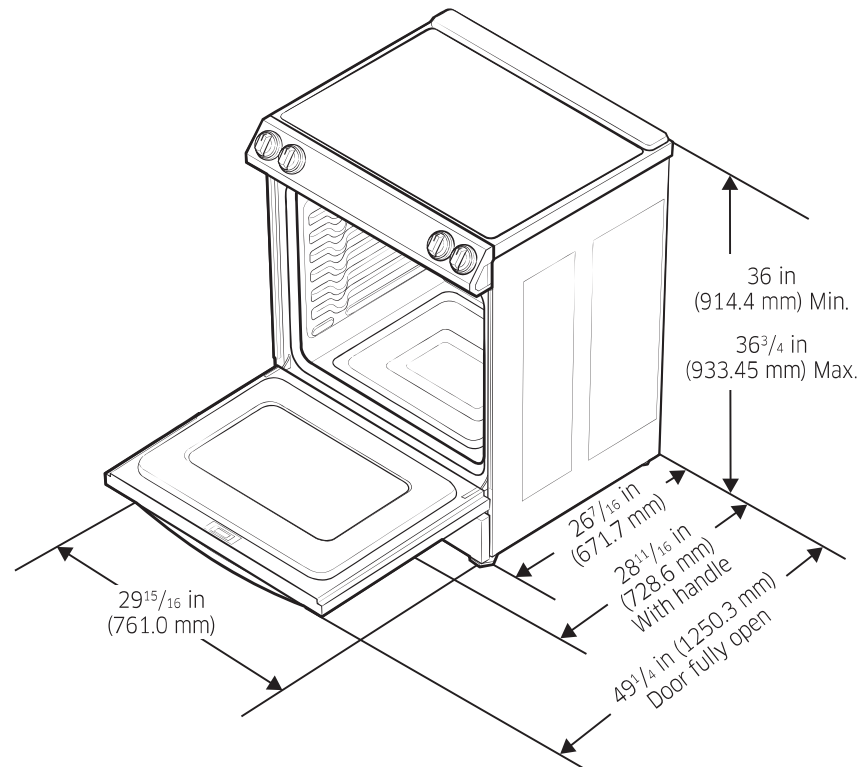

## Checking the installation site

### Clearances and dimensions

To install the range, refer to the following figure.

#### ⚠ CAUTION

This range has been designed to comply with the maximum allowable wood cabinet temperatures of 194 °F. Make sure the wall covering, countertops, and cabinets around the range can withstand the heat (up to 194 °F) generated by the range. If not, discoloration, delamination, or melting may occur.

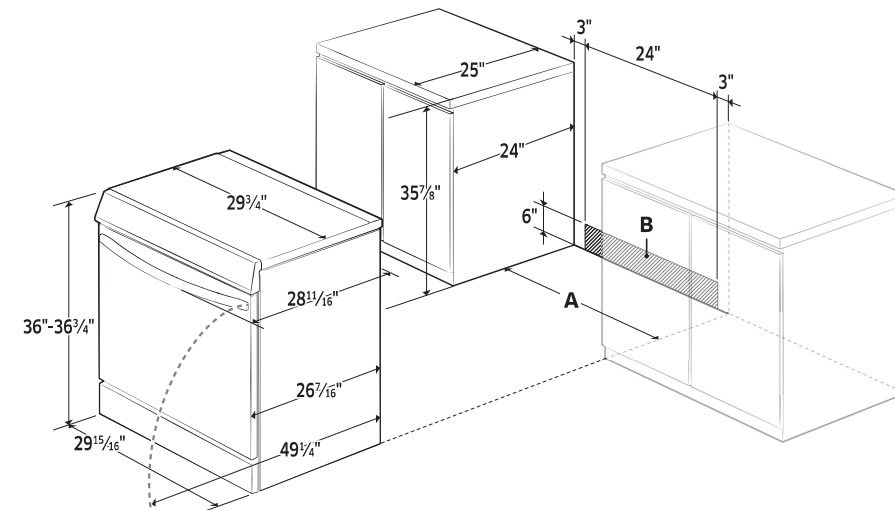

**A : Cabinet opening** min 30" (76.2 cm)

**B : Acceptable electrical outlet area**

**IMPORTANT:** If your cabinets are over  $36\frac{3}{4}$  in high, you must install this range on a hard, heat resistant support that raises the surface of the range so that it is about even with the countertop.

# Preparing to install the range

## Minimum dimensions

**IMPORTANT:** To eliminate the risk of burns or fire caused by reaching over heated surface units, avoid having cabinet storage space located above the surface units. If you have cabinet storage space over the heating elements, you can reduce the risk by installing a range hood that projects horizontally a minimum of 5 inches beyond the bottom of the cabinets.

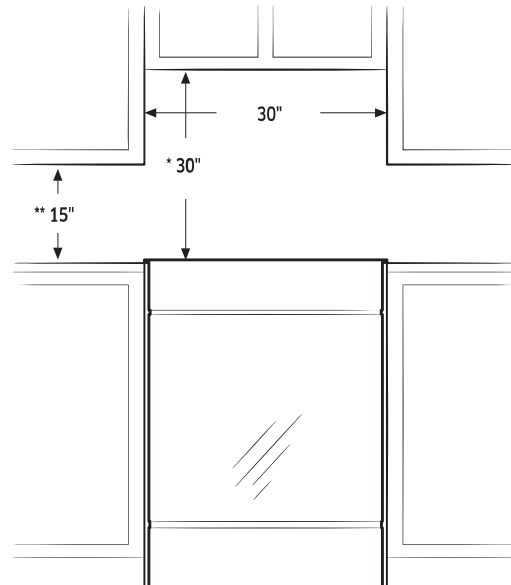

\* A minimum of 30" is required between the top of the cooking surface and the bottom of an unprotected wood or metal cabinet; a minimum of 24" is required if the bottom of the wood or metal cabinet is protected by not less than 1/4" of flame retardant millboard covered with not less than no.28 MSG of sheet steel, 0.015" of stainless steel, 0.024" of aluminum, or 0.020" of copper.

\*\* A minimum of 15" is required between the countertop and the adjacent cabinet bottom.

## CAUTION

Vapors may come out from the vent. It is normal, but be careful as it may be hot. Depending on the material of your wall, hot vapors may leave stains on it.

## To avoid breakage

### CAUTION

Do NOT lift or handle the unit by the cooktop glass or door handle.

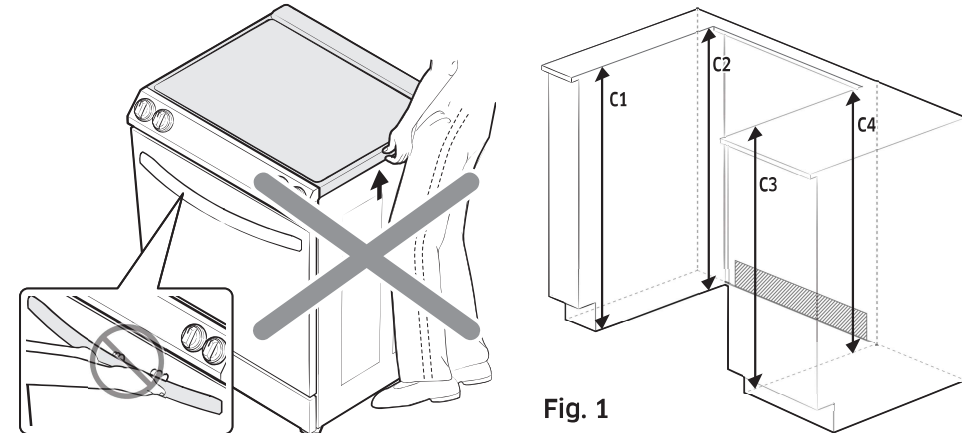

Fig. 1

1. The counter top around the cut-out should be flat and leveled.
2. Before installing the unit, measure the heights of the two cabinet sides (C1-C4), front and back (See Fig. 1) from the floor to the top of the counter.
3. Level the range using the four leveling legs so that the height from the floor to the underside of the cooktop glass frame is greater than the tallest cabinet measurement by at least 1/16".
4. Slide the unit into the cabinet (**DO NOT PUSH THE UNIT HARD**). Make sure the center of the unit aligns with the center of the cabinet cut-out.

# Connecting the power

## Step 2. Accessing the power cord connection

Loosen and then remove the rear access cover screw with a screwdriver. Remove the rear access cover by pull right and then out. The terminal block will then be accessible.

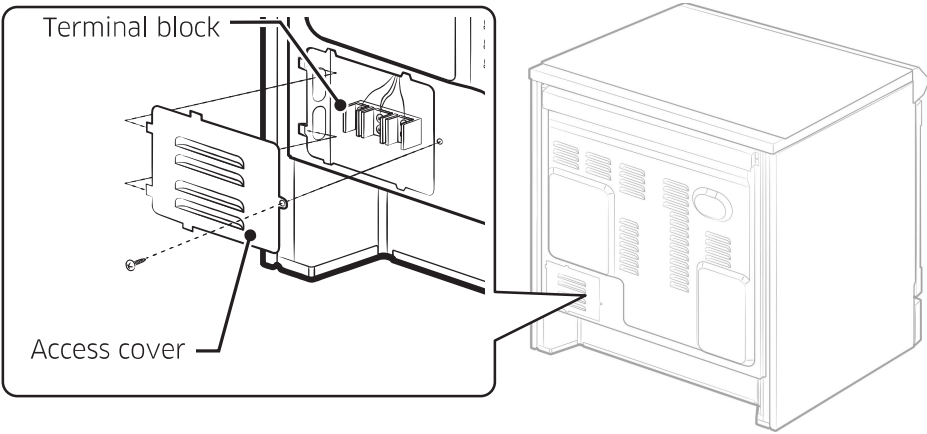

## Specified rating of power-supply-cord kit and circuit protection

Range rating, watts		Specified rating of power-supply-cord kit and circuit protection, Amps	Diameter (inches) of range connection opening	
120/240 volts 3-wire	120/208 volts 3-wire		Power cord	Conduit
8750-16500	7801-12500	40 or 50 A	1 3⁄8"	1 1⁄8"

This appliance must be supplied with the proper voltage at the proper frequency and must be connected to a dedicated, properly grounded branch circuit protected by a 40 amp or larger circuit breaker.

**NOTE**

For power cord installations, go to **Step 3**. For conduit installations, go to **Step 4** on page 11.

LOT 5-19, PH5, APPLIANCES

# DW80K5050US/AC



Dishwasher with StormWash

[www.samsung.com/ca](http://www.samsung.com/ca)

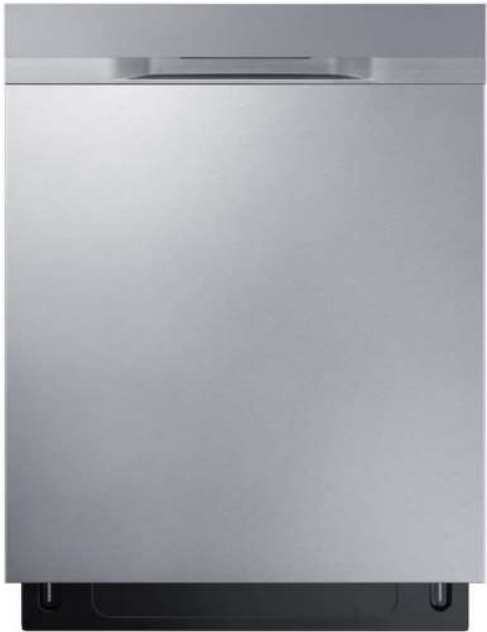

**Color**    Stainless Steel

## Dimensions

Width	23.9"
Height	33.9"
Depth	24.8"

- Control Type Hidden touch
- Display Light Color Ice blue
- Washing Type Rotary
- Capacity (Place Setting) 15 P/S
- Energy Star
- Dry System Auto Door Open Dry
- Water Consumption Per Cycle (gallons) 3.5
- Noise level (dBA) 48
- Cycle time (min) 170 - 103
- Normal | Auto | Delicate
- Rinse Only | Heavy | Express 60'
- Storm Wash | Delay Start | Half Load
- Sanitize | Hi-Temp Wash | Control Lock
- Auto Door Open
- Adjustable Height
- Adjustable Tines
- Max Dish loading 13.5"
- Cutlery Basket
- Tub Material Stainless
- Leakage Sensor
- Number of Wash Arm Upper / Mid / Low
- Food Disposer

Product dimension, cutout and installation specifications are provided for planning purposes only. Before installing any product, be sure to verify cutout dimensions and electrical/gas connections with the installation

®Registered trademark/TM Trademark of Samsung Electronics Canada Inc. © Samsung Electronics Canada Inc. All Rights Reserved.  
All other trademarks are owned by their respective companies.  
Because Samsung Electronics Canada Inc. policy includes a continuous commitment to improve our products, we reserve the right to change materials and specifications without notice. We also reserve the right to discontinue or transition products without notice.



# preparing the dishwasher enclosure

## PRODUCT DIMENSIONS

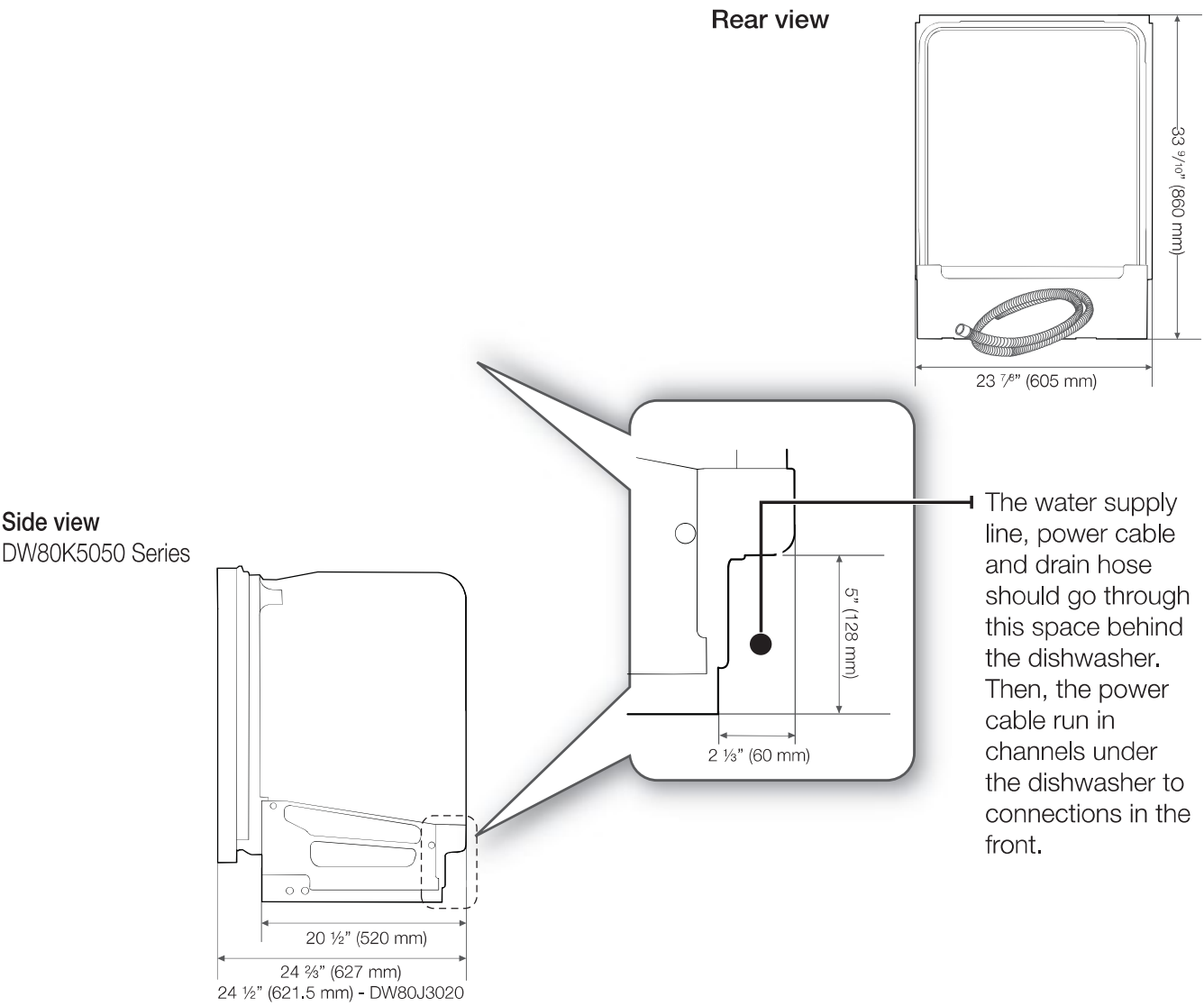

## ENCLOSURE DIMENSIONS

-  This dishwasher is designed to be enclosed on the top and on both sides by a standard residential kitchen cabinet unit.
- The installation enclosure must be clean and free of any obstructions.
- The enclosure must be at least 24 inches wide, 24 inches deep, and 34 1/8 inches high.
- For the front door of the dishwasher to be flush with the leading edge of the counter top, the counter top must be at least 25 inches deep.

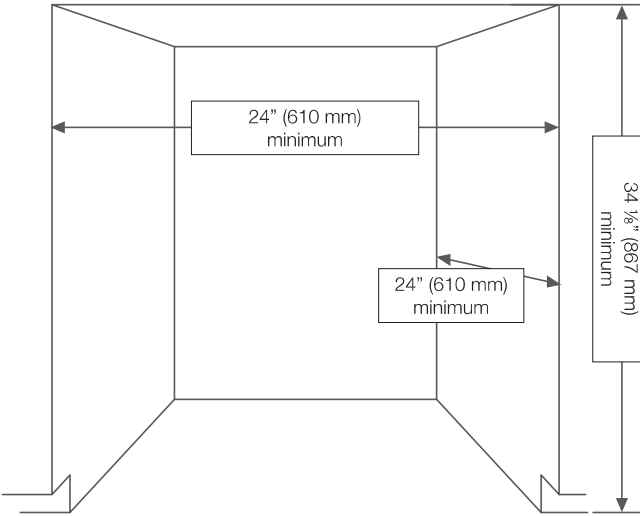

WF45T6000AW

LOT 5-19, PH5, APPLIANCES

SAMSUNG

Samsung Front Load Washer with Closet - Depth Design  
5.2 cu.ft. capacity IEC.



Signature Features

**Self Clean+**  
Keeps your washer drum fresh and clean by eliminating 99% of bacteria<sup>1</sup>. Will also send a reminder to clean the drum every forty wash cycles.

**Closet-Depth**  
This washer fits within your existing laundry space without sacrificing any capacity thanks to our new, wider drum. A new control panel design provides better visibility so it's easy to use even when stacked.<sup>2</sup>

**VRT Plus™**  
Innovative VRT Plus™ technology reduces noise and vibration for quiet washing.

Available Colors



White



Self Clean+



Closet-Depth

Features

- Self Clean+
- Smart Care
- VRT Plus™ technology
- Swirl+ Drum Design
- Closet-Depth Fit<sup>2</sup>
- Stackability
- Direct Drive Motor
- LED Display: Ice Blue
- 24-Hour Delay End

Convenience

- Child Lock
- Delay End
- Dispenser Trays: Main Wash, Softener, Bleach

Rating



ENERGY STAR® - Rated  
CEE Tier 2  
IMEF = 2.92  
IWF = 2.9

<sup>1</sup>Based on testing by Intertek of the Self Clean+ cycle on the WF6000R.  
<sup>2</sup>Designed to fit a 40" installation depth.

WF45T6000AW

LOT 5-19, PH5, APPLIANCES

SAMSUNG

Samsung Front Load Washer with Closet - Depth Design

5.2 cu.ft. capacity IEC.

Installation Specifications

If the washer and dryer are installed together or the dryer alone, the closet front must have two unobstructed air openings for a combined minimum total area of 72-inch<sup>2</sup> (see stacked build below). Your washer alone does not require a specific air opening.

\* Required spacing (External exhaust elbow may require additional space.)

1. Alcove or closet installation

Minimum Clearance for Closet and Alcove Installations:

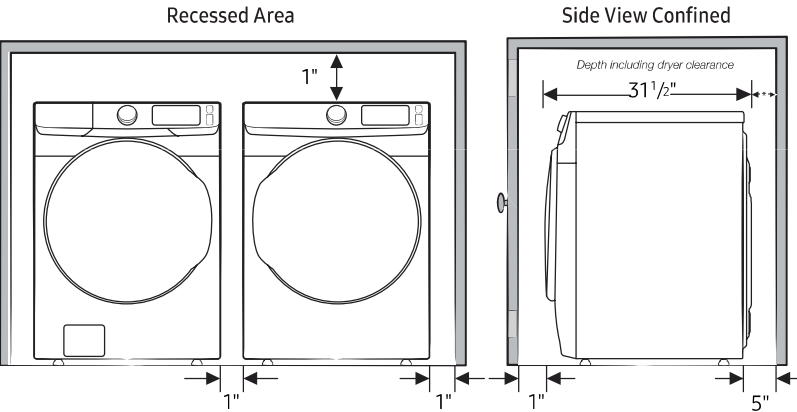

2. With stacked washer and dryer

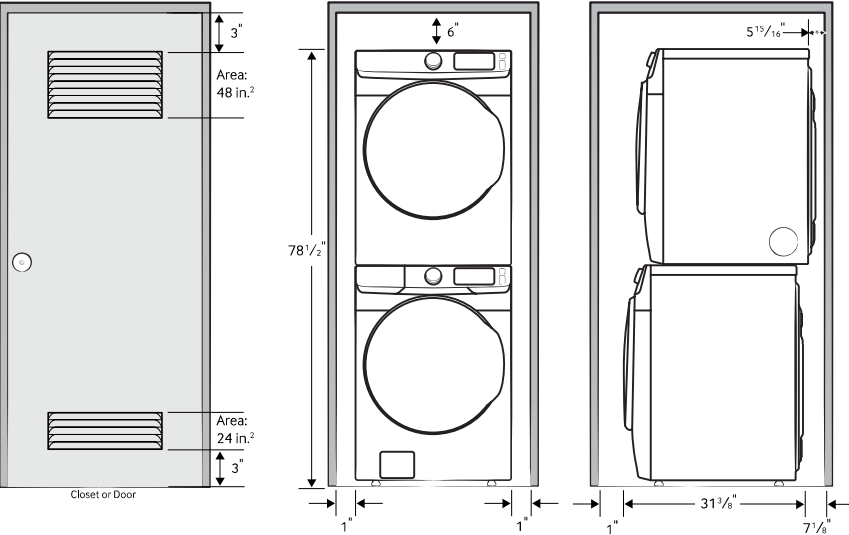

Dimensions

Required Dimensions for Installation with Pedestal:

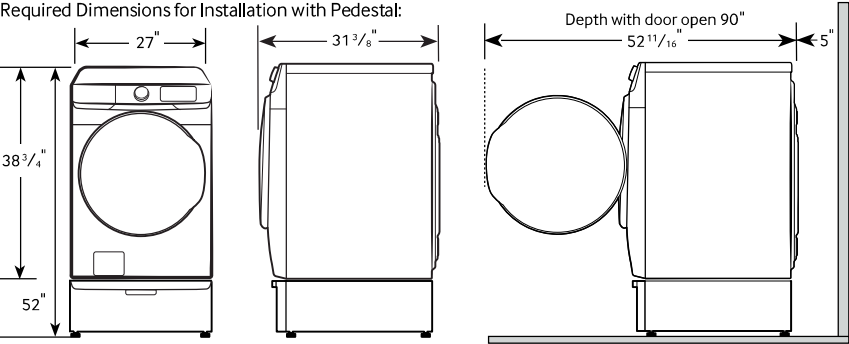

10 Preset Washing Cycles:

Normal, Heavy Duty, Bedding, Quick Wash, Permanent Press, Delicates, Whites, Rinse and Spin, Self Clean+, Active Wear.

7 Additional Washing Options:

Presoak, Delay End, Alarm Off, Child Lock, Smart Care, Spin Only

5 Temperature Levels:

Hot, Warmer, Warm, Cool, Cold

5 Spin Speeds:

High, Medium High, Medium, Low, No Spin

5 Soil Levels:

Heavy, Medium Heavy, Normal, Medium Low, Light

Dispenser Trays:

Main Wash, Softener, Bleach

Warranty

One (1) Year Parts and Labor  
Ten (10) Years Direct Drive Motor (Part Only)

Product Dimensions & Weight (WxHxD)

Dimensions: 27 x 38<sup>3</sup>/<sub>4</sub> x 31<sup>3</sup>/<sub>8</sub> inch  
Weight: 200 lb

Shipping Dimensions & Weight (WxHxD)

Dimensions: 29<sup>3</sup>/<sub>8</sub> x 42<sup>3</sup>/<sub>8</sub> x 34<sup>1</sup>/<sub>8</sub> inch  
Weight: 205 lbs

Color	Model #	UPC Code
White	WF45T6000AW	887276394794

Matching Dryer		
White	DVE45T6005W	887276387802

Pedestal		
White	WE402NW	887276310152

Accessories		
Stacking Kit	SKK-8K	887276344034

Actual color may vary. Design, specifications, and color availability are subject to change without notice. Non-metric weights and measurements are approximate.  
© 2020 Samsung Electronics Canada Inc. All rights reserved. Samsung is a registered trademark of Samsung Electronics Co., Ltd., used with permission.

DVE45T6005W

LOT 5-19, PH5, APPLIANCES

SAMSUNG

Samsung Front Load Electric Dryer with Sensor Dry  
7.5 cu.ft. Capacity DOE



Signature Features

**Sensor Dry**  
Automatically optimizes the time and temperature of your drying cycle to protect your clothes from heat damage, while avoiding excess energy use.

**Smart Care**  
Easy troubleshooting from the convenience of your smartphone<sup>1</sup>. SmartCare interacts with your washer and dryer to perform an immediate diagnosis and offer quick solutions.

**Energy Star®**  
Save money by using less energy without sacrificing performance or functionality.

Available Colors



White



Sensor Dry



Smart Care

Features

- Sensor Dry
- Smart Care
- Interior Drum Light
- Reversible Door
- LED Display: Ice Blue

Convenience

- Child Lock
- Lint Filter Indicator<sup>2</sup>

Rating



ENERGY STAR® - Rated  
608 kwh/yr

<sup>1</sup>The Samsung Smart Washer/Dryer App is required and is available on Android and iOS devices. The Samsung Smart Washer/Dryer app supports Android OS 2.3.6 or later and iOS 3 or later for iPhone models. A Wi-Fi connection is required. Service callouts will occasionally be required and may incur extra repair costs.

<sup>2</sup>User will be solely responsible for any consequence(s) that may result, including but not limited to any damage or harm caused by incorrect information provided by the user.

DVE45T6005W

LOT 5-19, PH5, APPLIANCES

SAMSUNG

Samsung Front Load Electric Dryer with Sensor Dry

7.5 cu.ft. Capacity DOE

Installation Specifications

If the washer and dryer are installed together or the dryer alone, the closet front must have two unobstructed air openings for a combined minimum total area of 72-inch<sup>2</sup> (see stacked build below). Your washer alone does not require a specific air opening.

\* Required spacing (External exhaust elbow may require additional space.)

DIMENSIONS

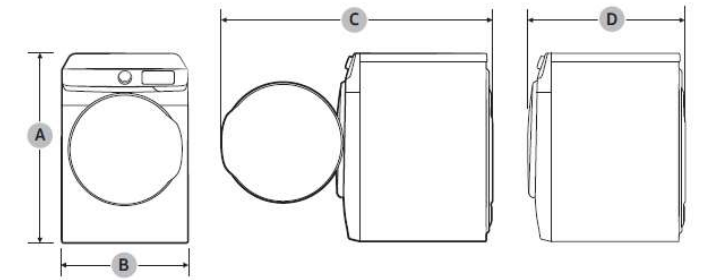

Type		Front loading dryer
Dimensions (in. (mm))	A. Overall height	38.7 (984)
	B. Width	27.0 (686)
	C. Depth with door open	52.6 (1335)
	D. Depth	31.5 (800)

UNDER COUNTER INSTALLATION

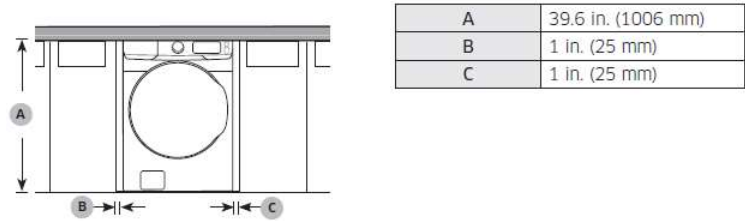

A	39.6 in. (1006 mm)
B	1 in. (25 mm)
C	1 in. (25 mm)

PEDESTAL INSTALLATION

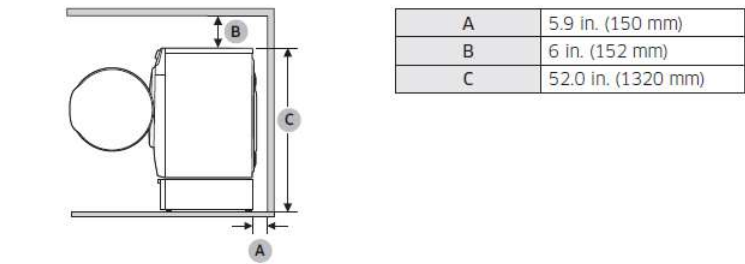

A	5.9 in. (150 mm)
B	6 in. (152 mm)
C	52.0 in. (1320 mm)

SIDE BY SIDE INSTALLATION

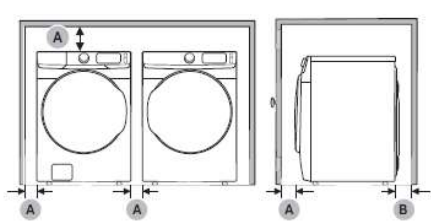

STACKED INSTALLATION

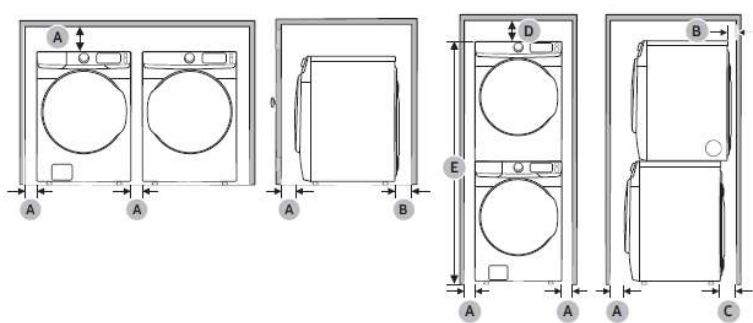

A	1 in. (25 mm)
B	5.9 in. (150 mm)
C	7.1 in. (180 mm)
D	6 in. (152 mm)
E	78.5 in. (1994 mm)

4-Way Venting

10 Preset Drying Cycles:

Normal, Heavy Duty, Permanent Press, Bedding, Delicates, Time Dry, Air Fluff, Quick Dry, Sanitize, Wrinkle Release.

9 Additional Drying Options:

Damp Alert, Wrinkle Prevent, Adjust Time (Up), Adjust Time (Down), Eco Dry, Child Lock, Smart Care, Alarm Off, Drum Light

5 Temperature Levels:

High, Medium High, Medium, Medium Low, Low

5 Dry Levels:

More Dry, Normal-More Dry, Normal Dry, Normal-Less Dry, Less Dry

Warranty

One (1) Year Parts and Labor

Product Dimensions & Weight (WxHxD)

Dimensions: 27 x 38<sup>3</sup>/<sub>4</sub> x 31<sup>1</sup>/<sub>2</sub> inch

Weight: 123 lb

Shipping Dimensions & Weight (WxHxD)

Dimensions: 29<sup>3</sup>/<sub>8</sub>" x 42<sup>9</sup>/<sub>16</sub>" x 33<sup>1</sup>/<sub>2</sub>"

Weight: 130 lbs

Color	Model #	UPC Code
White	DVE45T6005W	887276387802

Matching Washer		
White	WF45T6000AW	887276394794

Pedestal		
White	WE402NW	887276310152

Accessories		
Stacking Kit	SKK-8K	887276344034

Actual color may vary. Design, specifications, and color availability are subject to change without notice. Non-metric weights and measurements are approximate.  
© 2020 Samsung Electronics Canada Inc. All rights reserved. Samsung is a registered trademark of Samsung Electronics Co., Ltd., used with permission.