

## SINGLE WALL OVENS

JJW2427I – 27" x 29-7/8" x 25-5/16"

JJW2430I, JJW3430I – 30" x 29-7/8" x 25-5/16"

LOT 5-68, INNISFIL, APPLIANCES

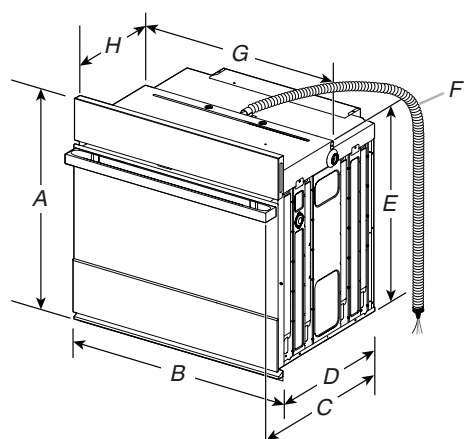

## PRODUCT DIMENSIONS – SINGLE OVENS

~~27" (68.6 CM) MODELS~~

- ~~A. 29-7/8" (75.8 cm) max. overall height~~
- ~~B. 27" (68.6 cm) overall width~~
- ~~C. JJW2427I – 26-3/8" (67 cm)  
JJW2427IL – 27-3/16" (69 cm)~~
- ~~D. 23-1/4" (59.1 cm) max. recessed depth  
27-3/16" (69 cm) recessed height~~
- ~~F. 48" (121.9 cm) flexible conduit length~~
- ~~G. 25-7/16" (64.6 cm) max. recessed width~~
- ~~H. 12" (30.5 cm) from back of control panel to start of strain relief~~

## 30" (76.2 CM) MODELS

- A. 29-7/8" (75.8 cm) max. overall height
- B. 30" (76.2 cm) overall width
- C. JJW2430IM – 26-3/8" (67 cm)  
JJW2430IL – 27-3/16" (69 cm)  
JJW3430IM – 26-3/8" (67 cm)  
JJW3430IL – 27-3/16" (69 cm)
- D. 23-1/4" (59.1 cm) max. recessed depth  
27-3/16" (69 cm)
- F. 48" (121.9 cm) flexible conduit length
- G. 28-7/16" (72.2 cm) max. recessed width
- H. 12" (30.5 cm) from back of control panel to start of strain relief

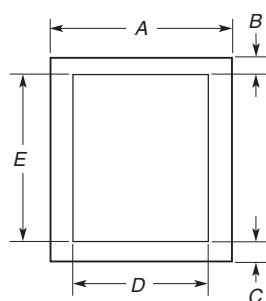

## UNDERCOUNTER CABINET DIMENSIONS – SINGLE OVENS

~~27" (68.6 CM) MODELS~~

- ~~A. 27" (68.6 cm) min. cabinet width~~
- ~~B. 1-1/2" (3.8 cm) min. top of cutout to underside of countertop~~
- ~~C. 5-1/4" (13.3 cm) bottom of cutout to floor~~
- ~~D. 28-1/2" (72.4 cm) cutout width~~
- ~~E. 28" (71.2 cm) min. cutout height~~

## 30" (76.2 CM) MODELS

- A. 30" (76.2 cm) min. cabinet width
- B. 1-1/2" (3.8 cm) min. top of cutout to underside of countertop
- C. 5-1/4" (13.3 cm) bottom of cutout to floor
- D. 28-1/2" (72.4 cm) cutout width
- E. 28" (71.2 cm) min. cutout height

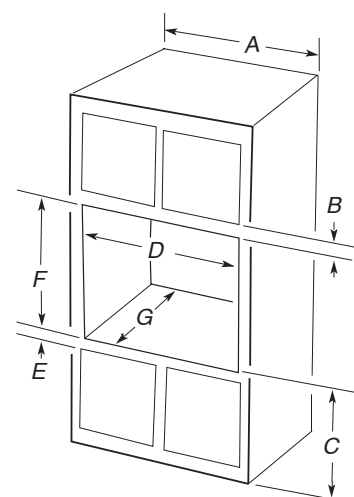

## SINGLE OVENS INSTALLED IN CABINET

~~27" (68.6 CM) MODELS~~

- ~~A. 27" (68.6 cm) min. cabinet width~~
- ~~B. 2-3/16" (5.5 cm) top of cutout to bottom of upper cabinet door~~
- ~~C. 32" (81.3 cm) bottom of cutout to floor~~
- ~~D. 28-1/2" (72.4 cm) cutout width~~
- ~~E. 1-1/2" (3.8 cm) min. bottom of cutout to top of cabinet door~~
- ~~F. 28" (71.2 cm)\* recommended cutout height~~
- ~~G. 24" (60.7 cm) cutout depth~~

**\*NOTE:** The cutout height can be between 27-1/4" (69.2cm) and 29-7/16" (74.8 cm) for 27" single ovens.

## 30" (76.2 CM) MODELS

- A. 30" (76.2 cm) min. cabinet width
- B. 2-3/16" (5.5 cm) top of cutout to bottom of upper cabinet door
- C. 32" (81.3 cm) bottom of cutout to floor
- D. 28-1/2" (72.4 cm) cutout width
- E. 1-1/2" (3.8 cm) min. bottom of cutout to top of cabinet door
- F. 28" (71.2 cm)\* recommended cutout height
- G. 24" (60.7 cm) cutout depth

**\*NOTE:** The cutout height can be between 27-1/4" (69.2 cm) and 29-7/16" (74.8 cm) for 30" single ovens.

**IMPORTANT:** Dimensional specifications are provided for planning purposes only.

**Do not make any cutouts based on this information.** Refer to the Installation or Use & Care Guide before selecting cabinetry, verifying electrical/gas connections, making cutouts or beginning installation. All JennAir® appliances are appropriately UL, CUL or CSA approved.



**SINGLE WALL OVENS****JJW2427I** – ~~27~~" x 29-7/8" x 25-5/16"**JJW2430I, JJW3430I** – 30" x 29-7/8" x 25-5/16"

LOT 5-68, INNISFIL, APPLIANCES

**ELECTRICAL REQUIREMENTS**

If codes permit and a separate ground wire is used, it is recommended that a qualified electrical installer determine that the ground path and the wire gauge are in accordance with local codes.

Check with a qualified electrical installer if you are not sure the oven is properly grounded.

This oven must be connected to a grounded metal, permanent wiring system.

Be sure that the electrical connection and wire size are adequate and in conformance with the National Electrical Code, ANSI/NFPA 70-latest edition or CSA Standards C22.1-94, Canadian Electrical Code, Part 1 and C22.2 No. 0-M91-latest edition, and all local codes and ordinances.

A copy of the above code standards can be obtained from:

National Fire Protection Association  
1 Batterymarch Park  
Quincy, MA 02169-7471

CSA International  
8501 East Pleasant Valley Road  
Cleveland, OH 44131-5575

- Models rated from 7.3 to 9.6 kW at 240 V (5.4 to 7.4 kW at 208 V) require a separate 40 A circuit. Models rated at 4.8 kW and below at 240 V (3.6 kW and below at 208 V) require a separate 20 A circuit.
- A circuit breaker is recommended.
- Connect directly to the circuit breaker box (or fused disconnect) through flexible, armored, or nonmetallic sheathed, copper cable (with grounding wire).
- Flexible conduit from the oven should be connected directly to the junction box.
- Fuse both sides of the line.
- Do not cut the conduit. The length of conduit provided is for serviceability of the oven.
- A UL listed or CSA approved conduit connector must be provided.
- If the house has aluminum wiring, follow the procedure below: Connect the aluminum wiring using special connectors and/or tools designed and UL listed for joining copper to aluminum. Follow the electrical connector manufacturer's recommended procedure. Aluminum/copper connection must conform with local codes and industry accepted wiring practices.

For power requirements for models JJW2427I, JJW2430I and JJW3430I, refer to the following table.

	240 VAC	208 VAC
Model	kW	kW
<b>JJW2427I</b>	4.1	3.1
<b>JJW2430I</b>	4.1	3.1
<b>JJW3430I</b>	4.5	3.4

**ELECTRICAL CONNECTION**

To properly install your oven, you must determine the type of electrical connection you will be using and follow the instructions provided for it here.

- Oven must be connected to the proper electrical voltage and frequency as specified on the model/serial/rating plate. The model/serial/rating plate is located under the control panel on single ovens. See the following illustration

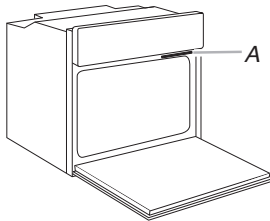

A. Model/Serial/Rating Plate

**IMPORTANT:** Dimensional specifications are provided for planning purposes only.

**Do not make any cutouts based on this information.** Refer to the Installation or Use & Care Guide before selecting cabinetry, verifying electrical/gas connections, making cutouts or beginning installation.

All JennAir® appliances are appropriately UL, CUL or CSA approved.



# INSTALLATION REQUIREMENTS LOT 5-68, INNISFIL, APPLIANCES

## Tools and Parts

Gather the required tools and parts before starting installation. Read and follow the instructions provided with any tools listed here.

### Tools Needed

- Phillips screwdriver
- Flat-blade screwdriver
- Measuring tape
- Level
- Drill (for wall cabinet installations)
- 1/8" (3 mm) drill bit (for wall cabinet installations)
- 1" (2.5 cm) drill bit (for wall cabinet installations)

### Parts Needed

- UL listed or CSA approved conduit connector
- UL listed wire connectors

### Parts Needed – Flush Installation

- W10801485 Stainless steel flush installation kit for 27" (68.6 cm) models
- W10801486 Stainless steel flush installation kit for 30" (76.2 cm) models
- W10801487 Black flush installation kit for 30" (76.2 cm) models

To order, see the "Assistance or Service" section of the Use and Care Guide.

### Parts Supplied

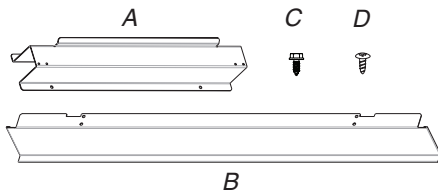

- A. Spacer bars (2)
- B. Bottom vent (1)
- C. 3/8" (9.5 mm) hex-head washer screws (4)
- D. 3/4" (1.9 cm) pan-head screws (4)

Check local codes. Check existing electrical supply. See "Electrical Requirements."

It is recommended that all electrical connections be made by a licensed, qualified electrical installer.

## Location Requirements

**IMPORTANT:** Observe all governing codes and ordinances.

- Cabinet opening dimensions that are shown must be used. Given dimensions provide minimum clearance with microwave oven.
- Recessed installation area must provide complete enclosure around the recessed portion of the microwave oven.
- Grounded electrical supply is required. See "Electrical Requirements" section.
- Electrical supply junction box should be located 3" (7.6 cm) maximum below the support surface when the microwave oven is installed in a wall cabinet. A 1" (2.5 cm) minimum diameter hole should have been drilled in the left rear corner of the support surface to pass the appliance cable through to the junction box.

- For installation above single built-in oven, the junction box must located inside upper cabinet.
- If you are installing the junction box on rear wall behind the microwave oven, the junction box must be recessed and located in the upper or lower right or left corner of the cabinet; otherwise, the microwave oven will not fit into the cabinet opening.
- Microwave oven support surface must be solid, level, and flush with bottom of cabinet cutout. Floor must be able to support a weight of 108 lbs (49.0 kg).

**IMPORTANT:** To avoid damage to your cabinets, check with your builder or cabinet supplier to make sure that the materials used will not discolor, delaminate, or sustain other damage. This oven has been designed in accordance with the requirements of UL and CSA International and complies with the maximum allowable wood cabinet temperatures of 194°F (90°C).

### Product Dimensions

#### ~~27"~~ (68.6 cm) and 30" (76.2 cm) Microwave Ovens

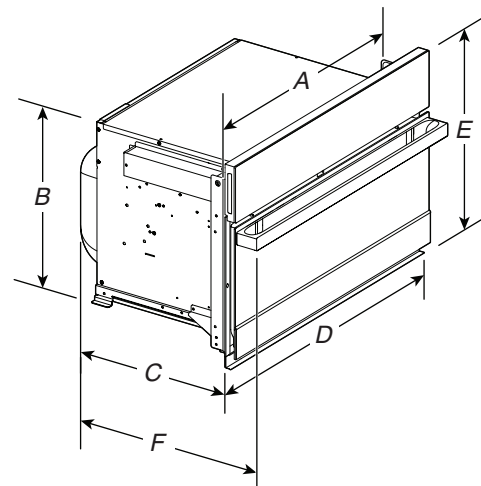

#### ~~27"~~ (68.6 cm) models

- A. 25<sup>3</sup>/<sub>8</sub>" (64.5 cm)
- B. 17<sup>3</sup>/<sub>8</sub>" (44.1 cm)
- C. 22<sup>11</sup>/<sub>16</sub>" (57.7 cm)
- D. 26<sup>3</sup>/<sub>4</sub>" (68.0 cm) overall width
- E. 19<sup>7</sup>/<sub>8</sub>" (50.3 cm) overall height
- F. JMC2427IM: 25<sup>9</sup>/<sub>16</sub>" (64.9 cm)  
JMC2427IL: 24<sup>3</sup>/<sub>4</sub>" (62.9 cm)

#### 30" (76.2 cm) models

- A. 28<sup>3</sup>/<sub>8</sub>" (72.1 cm)
- B. 17<sup>3</sup>/<sub>8</sub>" (44.1 cm)
- C. 22<sup>11</sup>/<sub>16</sub>" (57.7 cm)
- D. 29<sup>3</sup>/<sub>4</sub>" (75.6 cm) overall width
- E. 19<sup>7</sup>/<sub>8</sub>" (50.3 cm) overall height
- F. JMC2430IM: 25<sup>9</sup>/<sub>16</sub>" (64.9 cm)  
JMC2430IL: 24<sup>3</sup>/<sub>4</sub>" (62.9 cm)

#### ~~27"~~ (68.6 cm) and 30" (76.2 cm) Microwave Oven Spacer Kit

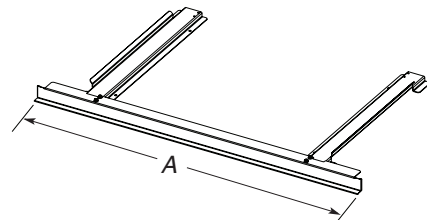

#### ~~27"~~ (68.6 cm) models

- A. 26<sup>3</sup>/<sub>4</sub>" (67.9 cm) overall width

#### 30" (76.2 cm) models

- A. 29<sup>3</sup>/<sub>4</sub>" (75.6 cm) overall width

**NOTE:** The microwave oven spacer kit will allow the microwave oven to be installed in a 17<sup>3</sup>/<sub>8</sub>" to 17<sup>3</sup>/<sub>4</sub>" (44.1 to 45.1 cm) maximum cutout height.

A microwave oven spacer kit is available from your dealer that will allow the microwave oven to be installed in a 19" to 19<sup>13/16</sup>" (48.3 to 50.2 cm) maximum cutout height. Match the oven size to the following kits:

- ~~27"~~ (68.6 cm) Stainless Steel – Model W10469901
- 30" (76.2 cm) Stainless Steel – Model W10469903

To order, see the "Assistance or Service" section of the Use and Care Guide.

### Cabinet Dimensions

#### ~~27"~~ (68.6 cm) and 30" (76.2 cm) Microwave Ovens

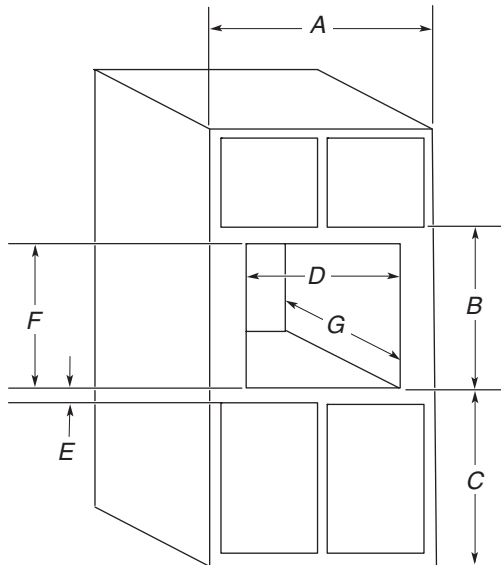

#### ~~27"~~ (68.6 cm) models

- A. ~~27"~~ (68.6 cm) min. cabinet width
- B. 19<sup>7/8</sup>" (50.3 cm) from bottom of cutout to bottom of upper cabinet door
- C. 40" (101.6 cm) bottom of cutout to floor (recommended)
- D. 25<sup>1/2</sup>" (64.8 cm) cutout width
- E. 1<sup>1/2</sup>" (3.8 cm) min. bottom of cutout to top of cabinet door
- F. 17<sup>5/8</sup>" (44.7 cm) recommended cutout height (will fit cutout height from 17<sup>3/8</sup>" [44.1 cm] to 17<sup>3/4</sup>" [45.1 cm])
- G. 21<sup>7/8</sup>" (55.5 cm) min. cutout depth

#### 30" (76.2 cm) models

- A. 30" (76.2 cm) min. cabinet width
- B. 19<sup>7/8</sup>" (50.3 cm) from bottom of cutout to bottom of upper cabinet door
- C. 40" (101.6 cm) bottom of cutout to floor (recommended)
- D. 28<sup>1/2</sup>" (72.4 cm) cutout width
- E. 1<sup>1/2</sup>" (3.8 cm) min. bottom of cutout to top of cabinet door
- F. 17<sup>5/8</sup>" (44.7 cm) recommended cutout height (will fit cutout height from 17<sup>3/8</sup>" [44.1 cm] to 17<sup>3/4</sup>" [45.1 cm])
- G. 21<sup>7/8</sup>" (55.5 cm) min. cutout depth

### Minimum Installation Clearances

For proper installation, the following minimum clearances must exist above and below the cabinet opening.

### Installation Above Single Built-In Oven

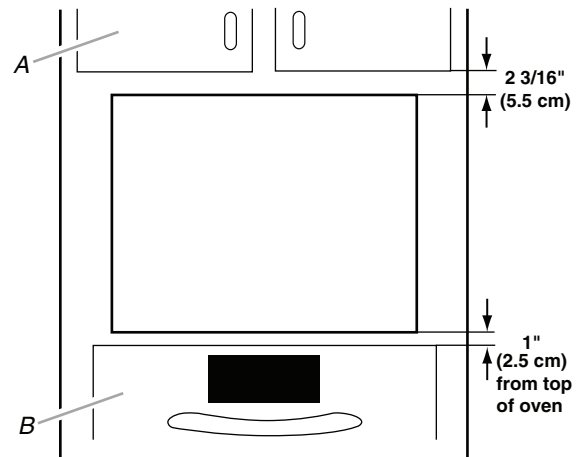

A. Upper cabinet  
B. Lower single oven

## Electrical Requirements

### GROUNDING INSTRUCTIONS

#### For a permanently connected microwave oven:

The microwave oven must be connected to a grounded, metallic, permanent wiring system, or an equipment grounding conductor should be run with the circuit conductors and connected to the equipment grounding terminal or lead on the microwave oven.

### SAVE THESE INSTRUCTIONS

If codes permit and a separate ground wire is used, it is recommended that a qualified electrical installer determine that the ground path and wire gauge are in accordance with local codes.

Check with a qualified electrical installer if you are not sure the oven is properly grounded.

This oven must be connected to a grounded metal, permanent wiring system.

Be sure that the electrical connection and wire size are adequate and in conformance with the National Electrical Code, ANSI/NFPA 70 – latest edition or CSA Standards C22.1-94, Canadian Electrical Code, Part 1 and C22.2 No. O-M91 – latest edition, and all local codes and ordinances.

A copy of the above code standards can be obtained from:

National Fire Protection Association  
1 Batterymarch Park  
Quincy, MA 02169-7471  
CSA International  
8501 East Pleasant Valley Road  
Cleveland, OH 44131-5575

### Electrical Connection

To properly install your microwave oven, you must determine the type of electrical connection you will be using and follow the instructions provided for it here.

- Microwave oven must be connected to the proper electrical voltage and frequency as specified on the model/serial/rating plate. The model/serial/rating plate is located underneath the control panel along the oven vent.

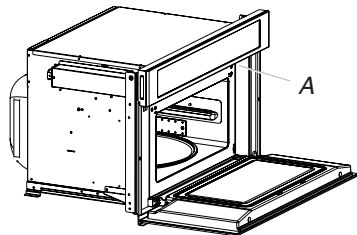

A. Model/serial/rating plate

- The microwave oven rated 120/240 V, 20 A, has 4 wires (L1, L2, N, and G) in the flex conduit, and should be connected to a 20 A maximum-rated circuit, overcurrent protected on both the L1 and L2 circuits.
- A time-delay fuse or circuit breaker is recommended.
- Flexible cable from the microwave oven should be connected directly to the junction box.

- Do not cut the conduit. The length of conduit provided is for serviceability of the microwave oven.
- A UL listed or CSA approved conduit connector must be provided.
- If the house has aluminum wiring, follow the procedure below:  
Connect the aluminum wiring using special connectors and/or tools designed and UL listed for joining copper to aluminum.  
Follow the electrical connector manufacturer's recommended procedure. Aluminum/copper connection must conform with local codes and industry accepted wiring practices.

For power requirements, refer to the following table:

Voltage	Microwave With Convection Oven
120/240 VAC	15 A
120/208 VAC	15 A

## INSTALLATION INSTRUCTIONS

### Spacer Kit Installation

#### NOTES:

- The microwave oven spacer kit allows the microwave oven to be installed in an  $17\frac{7}{16}$ " to  $17\frac{7}{8}$ " (44.1 cm to 45.3 cm) maximum cutout height.
- If your cabinet cutout height is more than  $17\frac{7}{16}$ " (44.1 cm), you must install the spacer kit. Proceed to "Assemble Spacer Kit."
- If your cabinet cutout height is less than  $17\frac{7}{16}$ " (44.1 cm), you do not have to install the spacer kit. Proceed to "Prepare Built-In Microwave Oven."

#### Assemble Spacer Kit

1. Attach the bottom vent to spacer bars using four  $\frac{3}{8}$ " (9.5 mm) hex-head washer screws.

**NOTE:** Spacer bar flanges should be facing out.

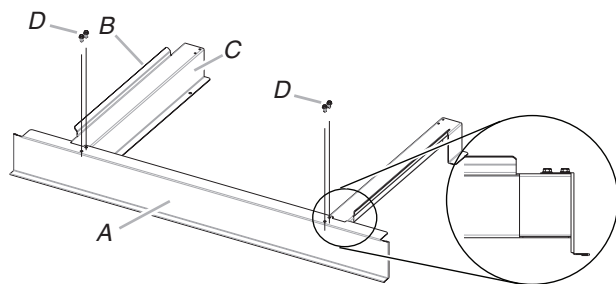

A. Bottom vent  
B. Spacer bar flange  
C. Spacer bars  
D.  $\frac{3}{8}$ " (9.5 mm) hex-head washer screws

#### Install Spacer Kit

1. Center assembled microwave oven spacer kit against lower front edge of the cabinet cutout.
2. Using an  $\frac{1}{8}$ " (3.2 mm) drill bit, drill through the mounting holes in the spacer bars to create pilot holes.

3. Attach the assembled spacer kit to the cabinet using four  $\frac{3}{4}$ " (1.9 cm) ( flat-head screws. Do not overtighten screws.

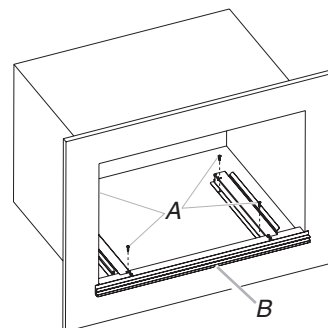

A.  $\frac{3}{4}$ " (1.9 cm) flat-head screws  
B. Spacer kit assembly

### Prepare Built-In Microwave Oven

1. Locate existing wiring to avoid drilling into or severing wiring during installation.

## ⚠ WARNING

#### Excessive Weight Hazard

**Use two or more people to move and install microwave oven.**

**Failure to do so can result in back or other injury.**

2. To avoid floor damage, set the microwave oven onto cardboard prior to installation. Do not use handle or any portion of the front frame for lifting.
3. Remove the shipping materials and tape from the microwave oven.
4. Remove and set aside racks and other items from inside the microwave oven.
5. Remove the hardware package from inside the bag containing literature.
6. Move the microwave oven and cardboard close to the microwave oven's final location.

## Make Electrical Connection

### **⚠ WARNING**



#### **Electrical Shock Hazard**

**Disconnect power before servicing.**

**Use 12 gauge copper wire.**

**Electrically ground oven.**

**Failure to follow these instructions can result in death, fire, or electrical shock.**

The microwave oven is manufactured with a neutral (white) power supply wire and a cabinet-connected green (or bare) ground wire.

1. Disconnect power.
2. Feed the flexible conduit from the microwave oven through the opening in the cabinet.
3. Remove junction box cover if it is present.
4. Install a UL listed or CSA approved conduit connector to the junction box.

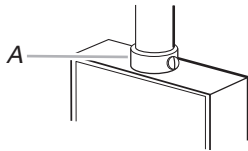

A. UL listed or CSA approved conduit connector

5. Route the flexible conduit from the microwave oven to the junction box through a UL listed or CSA approved conduit connector.
6. Tighten screws on conduit connector.
7. Complete electrical connection.

## 3-Wire Cable with Ground from Home Power Supply to Microwave Oven Cable with 4 Wires

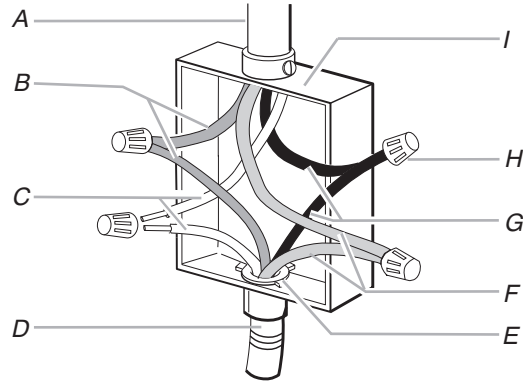

- |                                     |  |
|-------------------------------------|--|
| A. Cable from home power supply     | E. UL listed or CSA approved conduit connector |
| B. Green (or bare) wires            | F. Red wires                                   |
| C. White wires                      | G. Black wires                                 |
| D. 4-wire cable from microwave oven | H. UL listed wire connector                    |
|                                     | I. Junction box                                |

1. Connect the 2 black wires (G) together using a UL listed wire connector.
2. Connect the 2 white wires (C) using a UL listed wire connector.
3. Connect the 2 red wires (F) together using a UL listed wire connector.
4. Connect the 2 green (or bare) wires (B) together using a UL listed wire connector.
5. Install junction box cover.

## Install Microwave Oven

1. Using 2 or more people, lift the microwave oven partially into the cabinet cutout. If a spacer kit has been installed, lift the microwave oven over it and position the microwave oven between the guide strips.

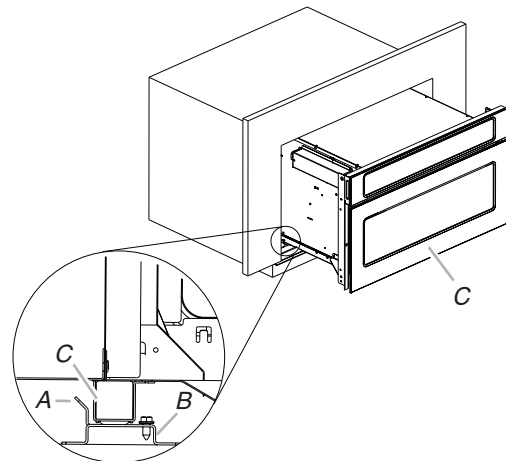

- A. Spacer bar flange  
B. Spacer bar  
C. Microwave oven



2. Push against the front frame of the microwave oven to insert oven into cabinet. Push microwave oven completely into cabinet and center in cabinet cutout.

**NOTE:** Open microwave oven door and push against seal area of microwave oven front frame when pushing microwave oven into cabinet. Do not push against outside edges.

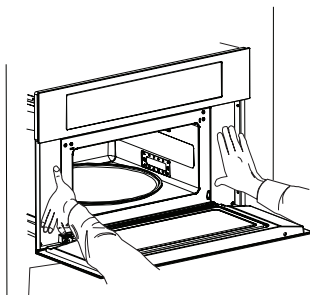

3. Using an 1/8" (3.2 mm) drill bit, predrill pilot holes through the mounting rails on each side of the microwave oven.
4. Securely fasten microwave oven to cabinet using two 3/4" (1.9 cm) flat-head screws provided. Insert the screws through holes in mounting rails. Do not overtighten screws.

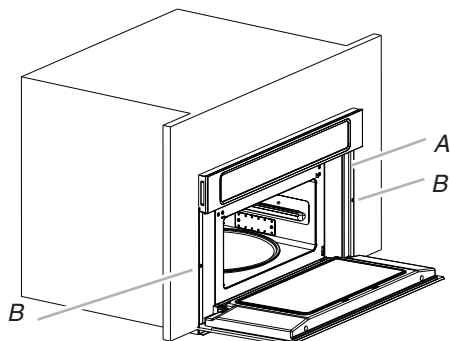

A. Mounting rail  
B. Flat-head screws

5. Replace convection grid, turntable, and support hub.
6. Reconnect power.
7. Display panel will light briefly and the clock should appear in the display.
8. If display panel does not light, please reference the "Assistance or Service" section of the Use and Care Guide or contact the dealer from whom you purchased your microwave oven.

## Complete Installation

1. Check that all parts are now installed. If there is an extra part, go back through the steps to see which step was skipped.
2. Check that you have all of your tools.
3. Dispose of/recycle all packaging materials.
4. For microwave oven use and cleaning, read the Use and Care Guide.

### Check Operation of Microwave Oven

1. Fill a microwave-safe container with 1 cup (250 mL) of water and place container on the turntable inside the microwave oven. Close door firmly.
2. Touch COOK.
3. Set power level, temperature, and cook time to "2:00" minutes.
4. Press START.

#### If microwave oven does not operate, check the following:

- Household fuse is intact and tight or circuit breaker has not tripped.
- Electrical supply is connected.
- See "Troubleshooting" section in the Use and Care Guide.

When the display reads "1:00" minute, open the microwave oven door. The microwave oven should stop cooking. Close door firmly. The interior microwave oven light should turn off.

5. Touch START to resume a preset cycle. The microwave oven should begin cooking and the microwave oven interior light should be ON.

Let microwave oven complete cooking time. Tones will sound at the end of the cooking time and the microwave oven will shut off.

6. Open microwave oven door and slowly remove container. Water in container should be hot.
7. To set the clock and other microwave oven functions, refer to the Use and Care Guide.

#### If you need Assistance or Service:

Please reference the "Assistance or Service" section of the Use and Care Guide or contact the dealer from whom you purchased your built-in microwave oven.

## 42" FULLY INTEGRATED SIDE-BY-SIDE REFRIGERATOR

(BASE UNIT REQUIRES SUITE-COORDINATING PANEL KIT OR CUSTOM PANELS AND HANDLES)

JS42NXFXDE – 41¾" x 83⅛" x 24" (without door/handles)

LOT 5-68, INNISFIL, APPLIANCES

PRODUCT DIMENSIONS (including stainless steel door panel kit dimensions)

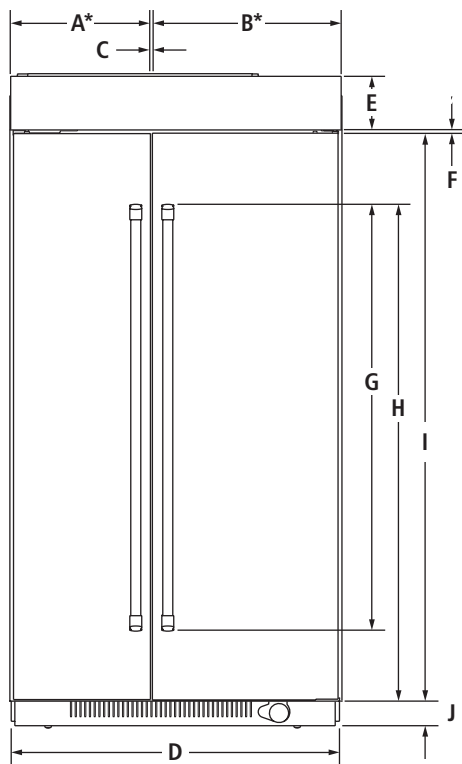

FRONT VIEW

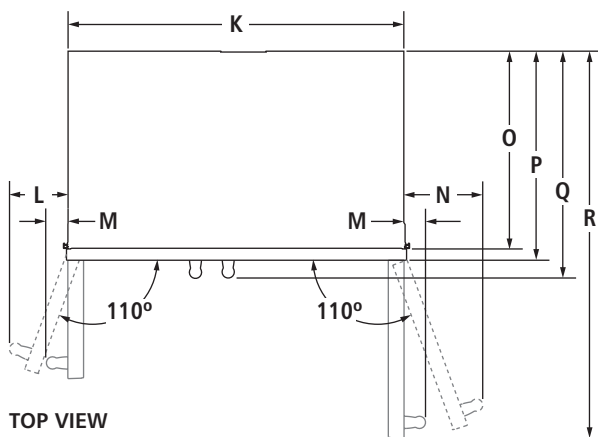

TOP VIEW

MODEL #		JS42NXFXDE	
		in	cm
A*	Width of freezer door	17⅞	44.8
B*	Width of refrigerator door	23⅝	60.0
C	Space between doors	⅛	0.3
D	Overall width (including vinyl side trim)	41¾	106.0
E	Height of top grille (including top grille filler)	6½	16.5
F	Space between doors and top grille	⅛	0.3
G	Height of door handles Pro-Style® Stainless	63	160.0
	Euro-Style Stainless	50	127.1
H	Height to top of door handles Pro-Style® Stainless	67	170.3
	Euro-Style Stainless	66⅝	169.1
I	Height of doors	74¼	188.6
J	Height of bottom grille	3	7.6
K	Width of recessed refrigerator	41	104.1
L	Width from side of refrigerator to freezer door handle – door fully open 110° Pro-Style® Stainless	7⅞	18.1
	Euro-Style Stainless	6¾	17.1
M	Width from side of refrigerator to handle – doors open 90° Pro-Style® Stainless	2	5.1
	Euro-Style Stainless	1½	3.9
N	Width from side of refrigerator to refrigerator door handle – door fully open 110° Pro-Style® Stainless	9⅝	24.4
	Euro-Style Stainless	9⅞	23.1
O	Depth without door panel kit	24	61.0
P	Depth with doors Pro-Style® Stainless panel kit	24¾	62.9
	Euro-Style Stainless panel kit	24¾	62.9
	Custom panel (¾"/1.9 cm)	24¾	62.9
Q	Depth with handles Pro-Style® Stainless	27⅝	69.5
	Euro-Style Stainless	26⅞	68.3
R	Depth with refrigerator door open 90°	46¾	118.7

\* Door width dimensions are for stainless steel panel kit only.

**IMPORTANT:** Dimensional specifications are provided for planning purposes only.

Do not make any cutouts based on this information. Refer to the Installation or Use &amp; Care Guide before selecting cabinetry, verifying electrical/gas connections, making cutouts or beginning installation.

All Jenn-Air® appliances are appropriately UL, CUL or CSA approved.



## 42" FULLY INTEGRATED SIDE-BY-SIDE REFRIGERATOR

(BASE UNIT REQUIRES SUITE-COORDINATING PANEL KIT OR CUSTOM PANELS AND HANDLES)

JS42NXFXDE – 41<sup>3</sup>/<sub>4</sub>" x 83<sup>1</sup>/<sub>8</sub>" x 24" (without door/handles)

LOT 5-68, INNISFIL, APPLIANCES

## DIMENSIONS AS INSTALLED

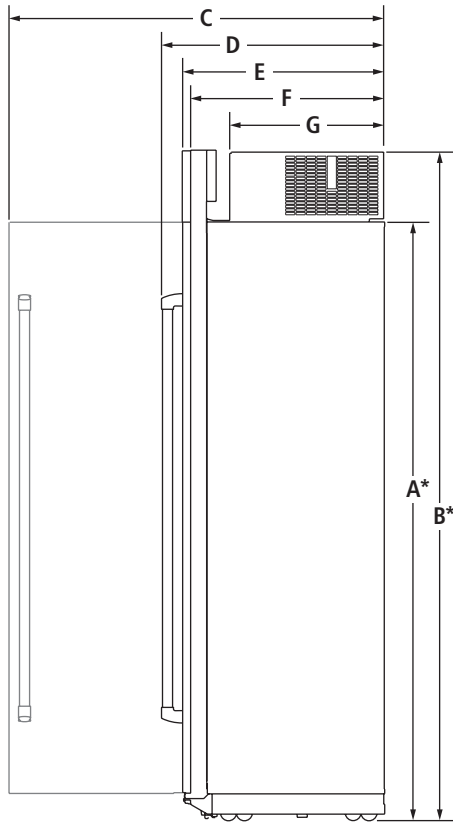

SIDE VIEW

MODEL #		JS42NXFXDE	
		in	cm
A*	Height without compressor (min.)	74 <sup>3</sup> / <sub>8</sub>	188.9
B*	Height of recessed refrigerator (min.)	83 <sup>1</sup> / <sub>8</sub>	211.1
C	Depth with refrigerator door open 90° (min.)	47 <sup>1</sup> / <sub>4</sub>	120.0
D	Depth with handles (min.)		
	Pro-Style® Stainless	27 <sup>3</sup> / <sub>8</sub>	69.5
	Euro-Style Stainless	26 <sup>7</sup> / <sub>8</sub>	68.3
E	Depth with doors (min.)		
	Pro-Style® Stainless panel kit	24 <sup>3</sup> / <sub>4</sub>	62.9
	Euro-Style Stainless panel kit	24 <sup>3</sup> / <sub>4</sub>	62.9
	Custom panel (¾"/1.9 cm)	24 <sup>3</sup> / <sub>4</sub>	62.9
F	Depth without door panel kit (min.)	24	61.0
G	Depth of compressor (min.)	19 <sup>7</sup> / <sub>8</sub>	50.5

\*Add 1<sup>1</sup>/<sub>4</sub>" (3.2 cm) to the height dimension when leveling legs are fully extended**IMPORTANT:** Dimensional specifications are provided for planning purposes only.**Do not make any cutouts based on this information.** Refer to the Installation or Use & Care Guide before selecting cabinetry, verifying electrical/gas connections, making cutouts or beginning installation.

All Jenn-Air® appliances are appropriately UL, CUL or CSA approved.

## 42" FULLY INTEGRATED SIDE-BY-SIDE REFRIGERATOR

(BASE UNIT REQUIRES SUITE-COORDINATING PANEL KIT OR CUSTOM PANELS AND HANDLES)

JS42NXFXDE – 41¾" x 83⅞" x 24" (without door/handles)

LOT 5-68, INNISFIL, APPLIANCES

## 3 STYLES FOR DOOR PANEL INSTALLATION

## STANDARD INTEGRATED GRILLE INSTALLATION

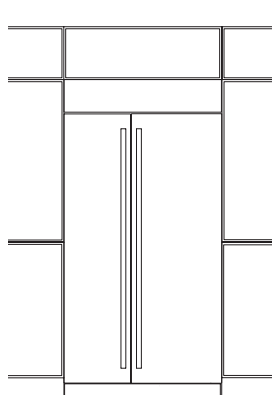

FRONT VIEW

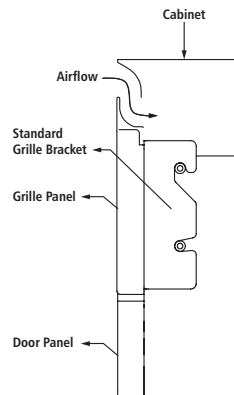
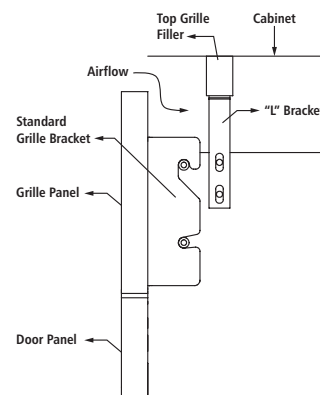
SIDE VIEW – STAINLESS STEEL  
PANEL KIT

SIDE VIEW – CUSTOM PANEL

- Attach the standard custom grille with the standard grille bracket provided with the refrigerator.
- The standard grille panel height allows for an air gap critical to refrigerator performance.

## FULLY INTEGRATED GRILLE INSTALLATION

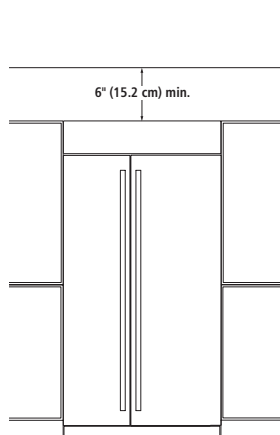
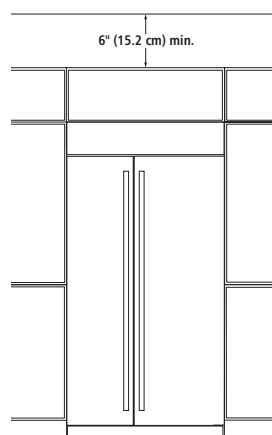
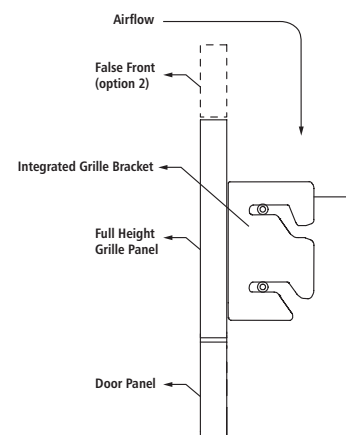
FRONT VIEW – OPEN TO CEILING  
(OPTION 1)FRONT VIEW – FALSE FRONT  
(OPTION 2)

SIDE VIEW – CUSTOM PANEL

- Attach the full-height grille with the integrated grille bracket provided with the refrigerator.
- Requires a minimum of 6" (15.2 cm) of open space above the refrigerator, which must not be blocked in any way, including soffits.

## ARMOIRE-STYLE INSTALLATION\*

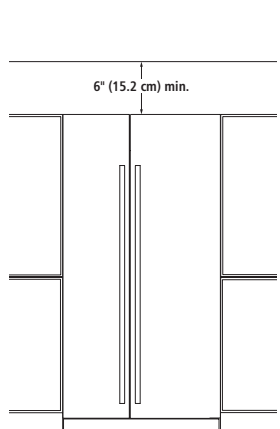
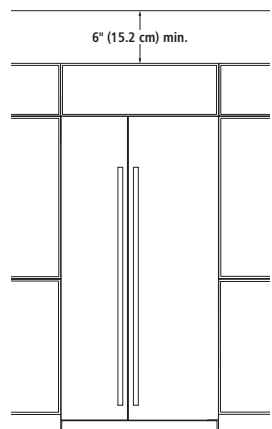
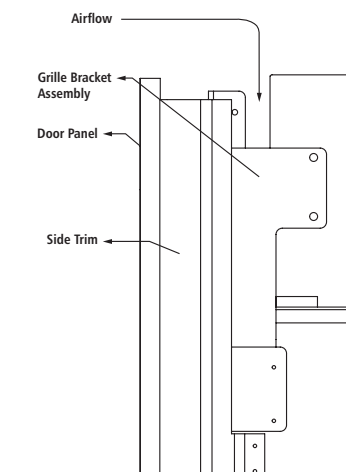
FRONT VIEW – OPEN TO CEILING  
(OPTION 1)FRONT VIEW – FALSE FRONT  
(OPTION 2)

SIDE VIEW – CUSTOM PANEL

- Attach the grille bracket assembly and grille panel provided in the armoire-style panel kit.
- Requires a minimum of 6" (15.2 cm) of open space above the refrigerator, which must not be blocked in any way, including soffits.

\* Refer to the Armoire Kit installation instructions for additional dimensions and installation details.

**IMPORTANT:** Dimensional specifications are provided for planning purposes only.

**Do not make any cutouts based on this information.** Refer to the Installation or Use & Care Guide before selecting cabinetry, verifying electrical/gas connections, making cutouts or beginning installation. All Jenn-Air® appliances are appropriately UL, CUL or CSA approved.

## 42" FULLY INTEGRATED SIDE-BY-SIDE REFRIGERATOR

(BASE UNIT REQUIRES SUITE-COORDINATING PANEL KIT OR CUSTOM PANELS AND HANDLES)

JS42NXFXDE – 41¾" x 83⅛" x 24" (without door/handles)

LOT 5-68, INNISFIL, APPLIANCES

## OPENING/CLEARANCE DIMENSIONS

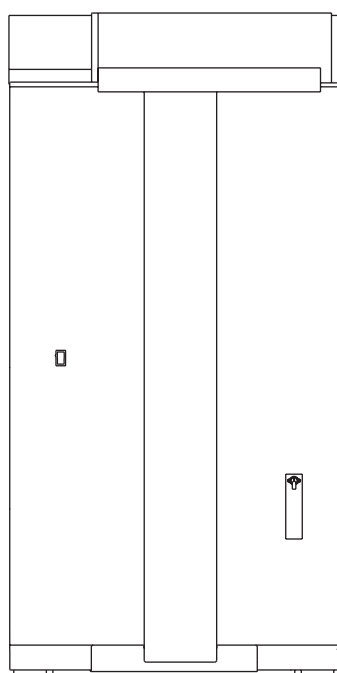
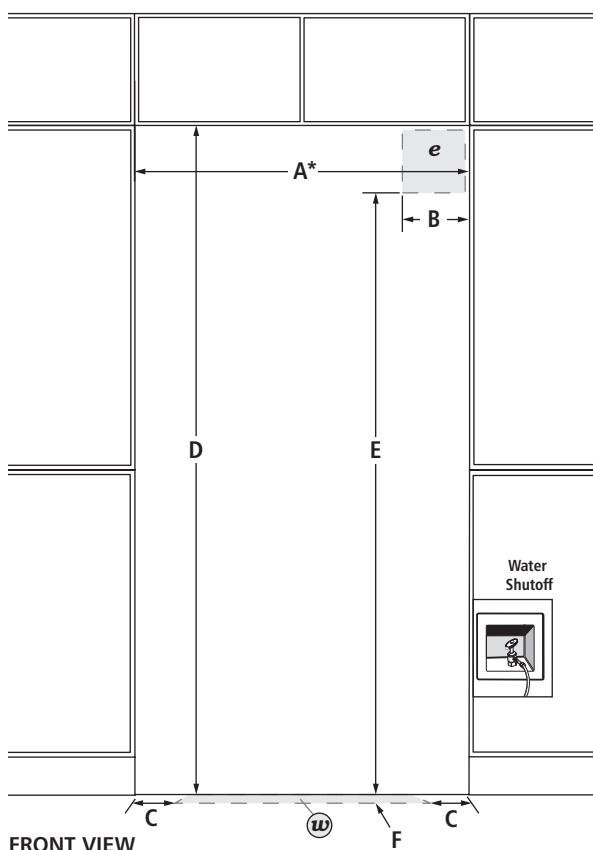

MODEL #		JS42NXFXDE	
		in	cm
<b>A*</b>	Width (min.)	42	106.7
<b>B</b>	Width of recommended electrical location	7½	19.1
<b>C</b>	Distance from side of cabinet to recommended water connection location	6	15.2
<b>D</b>	Height (min.)	84	213.4
<b>E</b>	Height to recommended electrical location	77	195.6
<b>F</b>	Depth of recommended water connection location (max.)	1	2.5
<b>e</b>	Recommended electrical connection location		
<b>w</b>	Recommended water connection location		

\*Minimum width must extend behind the face of the cabinet for at least 2" (5.1 cm).

## ELECTRICAL REQUIREMENTS

115 volt, 60 Hz, AC only, 15- or 20-amp fused, grounded circuit is required. A dedicated circuit is recommended. Use an outlet that cannot be turned off by a switch. Do not use an extension cord.

## WATER PRESSURE REQUIREMENTS

A cold water supply with water pressure between 30 and 120 psi (207 and 827 kPa) is required to operate the ice maker. Call a licensed, qualified plumber with any questions about the water pressure.

## Reverse Osmosis Water Supply

**IMPORTANT:** The pressure of the water coming out of a reverse osmosis system going to the water inlet valve of the refrigerator needs to be between 30 and 120 psi (207 and 827 kPa).

If a reverse osmosis water filtration system is connected to the cold water supply, the water pressure to the reverse osmosis system needs to be a minimum of 40 to 60 psi (276 to 414 kPa).

## LOCATION REQUIREMENTS

Floor must be able to support refrigerator (more than 600 lb [272 kg]), door panels and contents of the refrigerator and must be at the same level as flooring in the room.

**IMPORTANT:** Dimensional specifications are provided for planning purposes only.

**Do not make any cutouts based on this information.** Refer to the Installation or Use & Care Guide before selecting cabinetry, verifying electrical/gas connections, making cutouts or beginning installation. All Jenn-Air® appliances are appropriately UL, CUL or CSA approved.

# DIMENSIONS

LOT 5-68, INNISFIL, APPLIANCES

## JENNAIR® RANGETOPS PRODUCT

	<del>30" RANGETOP</del> <del>JGCP430H</del>	36" RANGETOP JGCP436H	<del>48" RANGETOP</del> <del>JGCP548H</del>
Overall Width (A)	29-3/4" (75.6 cm)	35-3/4" (90.8 cm)	47-7/8" (121.6 cm)
Grate Depth (B)	22" (55.9 cm)	22" (55.9 cm)	22" (55.9 cm)
Depth without Control Panel (C)	23-1/4" (59.1 cm)	23-1/4" (59.1 cm)	23-1/4" (59.1 cm)
Depth with Control Panel Overhang (D)	27-1/2" (69.9 cm)	27-1/2" (69.9 cm)	27-1/2" (69.9 cm)
Depth with Knobs: RISE™ (E)	29-1/8" (74 cm)	29-1/8" (74 cm)	29-1/8" (74 cm)
Depth with Knobs: NOIR™ (E)	29" (73.7 cm)	29" (73.7 cm)	29" (73.7 cm)

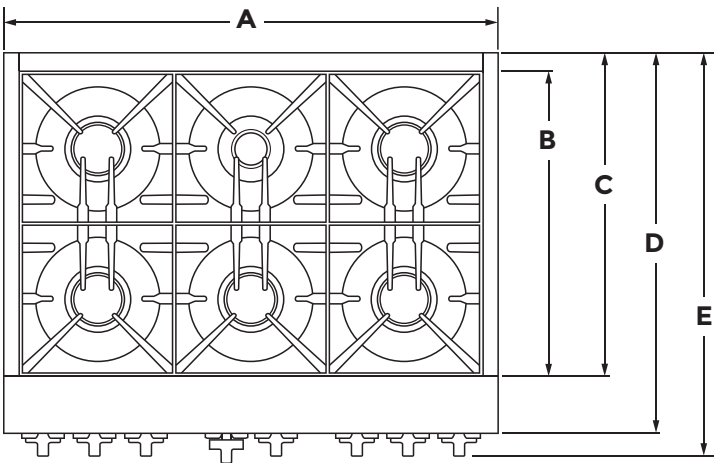

TOP VIEW



**IMPORTANT:** Dimensional specifications are provided for planning purposes only. Do not make any cutouts based on this information. Refer to the Installation Guide before selecting cabinetry, verifying electrical/gas connections, making cutouts or beginning installation. All JennAir® appliances are appropriately UL, CUL or CSA approved.

DIMENSIONS

JENNAIR® RANGETOPS

PRODUCT

LOT 5-68, INNISFIL, APPLIANCES

	<del>30" RANGETOP</del> <del>JGCP430H</del>	36" RANGETOP JGCP436H	<del>48" RANGETOP</del> <del>JGCP548H</del>
Grate Width (F)*	<del>27-7/16" (69.7 cm)</del>	33" (83.8 cm)	<del>44-3/8"* (112.7 cm)</del>
Gas Inlet to Surface (G)	10-3/4" (27.3 cm)	10-3/4" (27.3 cm)	10-3/4" (27.3 cm)
Center to Gas Inlet (H)	11" (27.9 cm)	14-1/8" (35.9 cm)	19-5/8" (49.8 cm)
Recessed Rangetop Width (I)	29-1/8" (74 cm)	35" (88.9 cm)	47-1/4" (120 cm)

\*Includes width of grates and griddle.

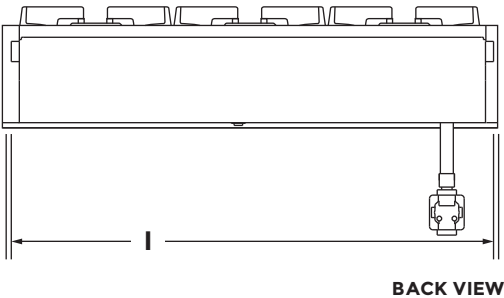
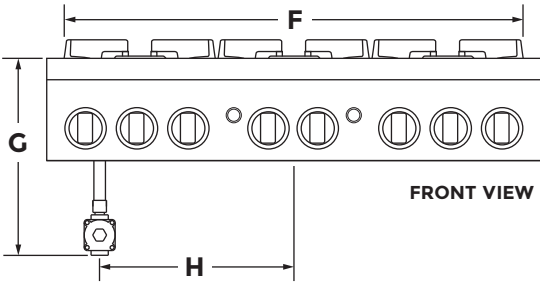

DIMENSIONS

LOT 5-68, INNISFIL, APPLIANCES

JENNAIR® RANGETOPS

PRODUCT

	<del>30" RANGETOP</del> JGCP430H	36" RANGETOP JGCP436H	<del>42" RANGETOP</del> JGCP548H
Height with Grates (J)	<del>9" (22.9 cm)</del>	9" (22.9 cm)	<del>9" (22.9 cm)</del>
Control Panel Height (K)	7-13/16" (19.8 cm)	7-13/16" (19.8 cm)	7-13/16" (19.8 cm)
Recessed Rangetop Height (L)	7" (17.8 cm)	7" (17.8 cm)	7" (17.8 cm)
Cooking Surface Height (M)	7-7/16" (18.9 cm)	7-7/16" (18.9 cm)	7-7/16" (18.9 cm)
Recessed Rangetop Depth (N)	21-7/8" (55.6 cm)	21-7/8" (55.6 cm)	21-7/8" (55.6 cm)
Depth with Control Panel (O)	25-1/2" (64.8 cm)	25-1/2" (64.8 cm)	25-1/2" (64.8 cm)

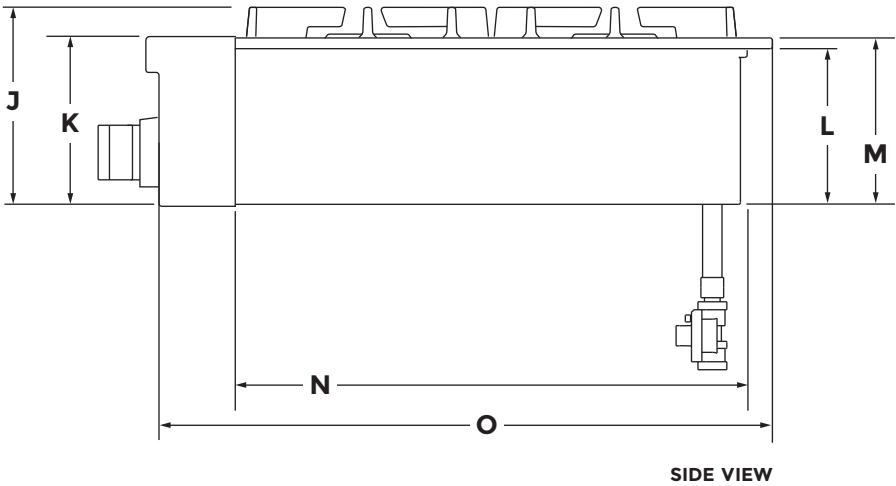



# DIMENSIONS

LOT 5-68, INNISFIL, APPLIANCES

## JENNAIR® RANGETOPS

### OPENING AND CLEARANCE

	<del>30" RANGETOP</del> <del>JGCP430H</del>	36" RANGETOP JGCP436H	<del>48" RANGETOP</del> <del>JGCP548H</del>
Combustible Area Above Cooking Surface Width (A)	<del>30" (76.2 cm) min.</del>	36" (91.4 cm) min.	<del>48" (121.9 cm) min.</del>
Bottom of Cabinet Height Above Cooking Surface (B)*	42" (106.7 cm) min.	58" (147.3 cm) min.	58" (147.3 cm) min.
Bottom of Cabinet Height Above Countertop (C)	18" (45.7 cm) min.	18" (45.7 cm) min.	18" (45.7 cm) min.
Distance to Fixed Wall or Combustible Material (D)	12" (30.5 cm) min.	12" (30.5 cm) min.	12" (30.5 cm) min.

\*Dimension reduced by 6" (15.2 cm) when bottom of wood or metal cabinet is covered by at least 1/4" (0.6 cm) flame retardant millboard, which is in turn covered with at least No. 28 MSG sheet metal, 0.015" (0.4 mm) stainless steel, 0.024" (0.6 mm) aluminum or 0.020" (0.5 mm) copper. If installing a hood above the rangetop, follow the hood instructions for dimensional clearances above the cooking surface.

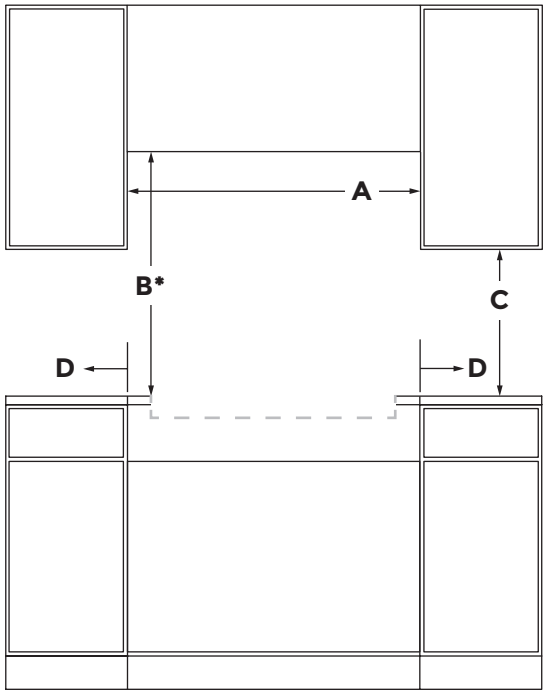

FRONT VIEW

DIMENSIONS

JENNAIR® RANGETOPS

OPENING AND CLEARANCE

LOT 5-68, INNISFIL, APPLIANCES

	<del>30" RANGETOP</del> <del>JGCP430H</del>	36" RANGETOP JGCP436H	<del>48" RANGETOP</del> <del>JGCP448H</del>
Recommended Upper Cabinet Depth (E)	<del>13" (33 cm)</del>	13" (33 cm)	<del>13" (33 cm)</del>
Cutout to Wall Depth (F)*	1-1/2" (3.8 cm) min.	1-1/2" (3.8 cm) min.	1-1/2" (3.8 cm) min.
Cabinet to Countertop Height (G)	7-1/4" (18.4 cm)	7-1/4" (18.4 cm)	7-1/4" (18.4 cm)
Cabinet Depth (H)	24" (61 cm)	24" (61 cm)	24" (61 cm)

\*If the back wall is constructed of a combustible material and a backsplash is not installed, a 7-1/2" (19.1 cm) minimum clearance is required from the cutout or 6" (15.2 cm) minimum clearance from the back edge of the rangetop.

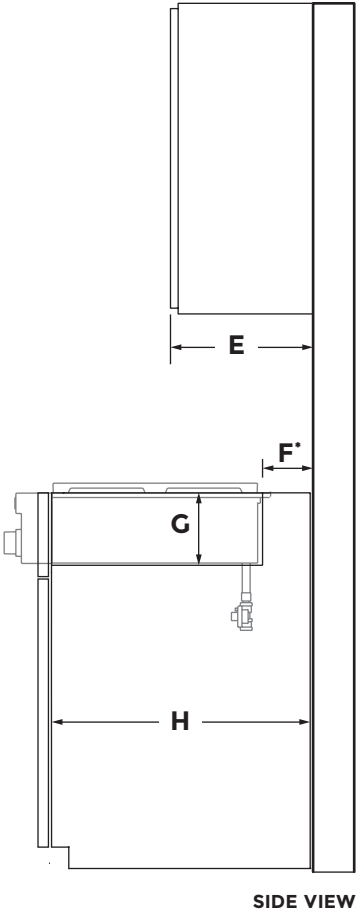

DIMENSIONS

JENNAIR® RANGETOPS

LOT 5-68, INNISFIL, APPLIANCES

OPENING AND CLEARANCE

	<del>30" RANGETOP</del> JGCP430H	36" RANGETOP JGCP436H	<del>48" RANGETOP</del> JGCP448H
Countertop and Cabinet Cutout Width (I)	<del>29-1/4" (74.3 cm)</del>	35-1/4" (89.5 cm)	<del>47-3/8" (120.3 cm)</del>
Countertop and Cutout Depth (J)	22-1/4" (56.5 cm)	22-1/4" (56.5 cm)	22-1/4" (56.5 cm)
Notch Width (K)	5/16" (0.8 cm)	5/16" (0.8 cm)	5/16" (0.8 cm)
Cutout Width (L)	29-7/8" (75.9 cm)	35-3/4" (90.8 cm)	47-7/8" (121.6 cm)

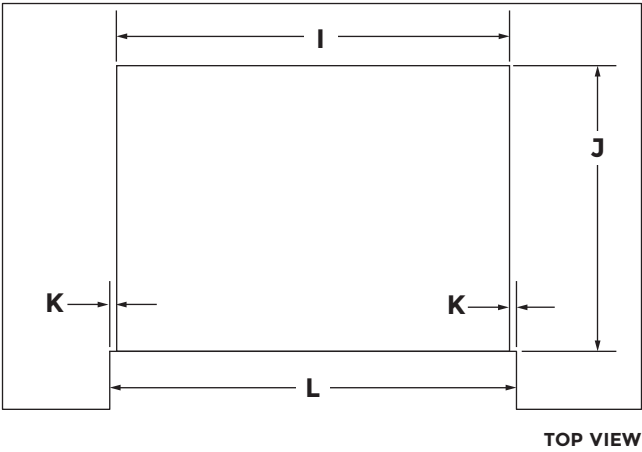

# DIMENSIONS

## JENNAIR® RANGETOPS

### ELECTRICAL REQUIREMENTS

LOT 5-68, INNISFIL, APPLIANCES

#### ELECTRIC REQUIREMENTS CHECKLIST

- ☐ A 120 volt, 60 Hz, AC only, 15-amp fused, electrical circuit is required.
- ☐ A dedicated circuit is recommended.

#### RECOMMENDED ELECTRICAL OUTLET ZONE

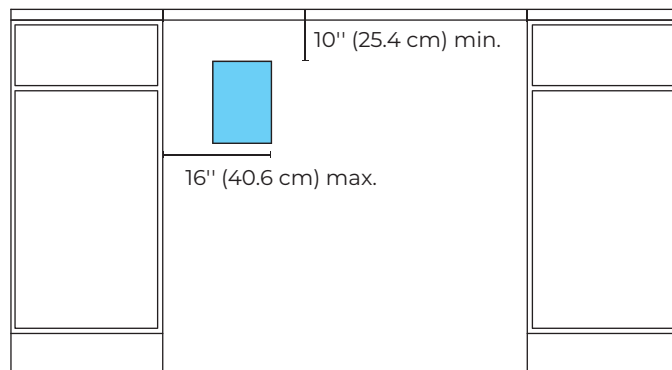

FRONT VIEW



IF YOU HAVE QUESTIONS ABOUT YOUR ELECTRICAL SUPPLY, CALL A LICENSED, QUALIFIED ELECTRICIAN.

**DIMENSIONS**  
**JENNAIR® RANGETOPS**  
GAS REQUIREMENTS

LOT 5-68, INNISFIL, APPLIANCES

**RECOMMENDED GAS SUPPLY LOCATION**

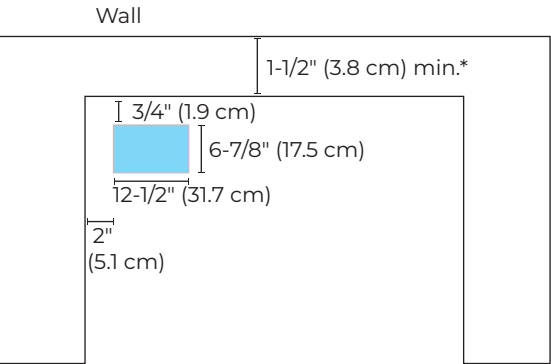

**TOP VIEW**

\*If the back wall is constructed of a combustible material and a backsplash is not installed, a 7-1/2" (19.1 cm) minimum clearance is required from the cutout or 6" (15.2 cm) minimum clearance from the back edge of the rangetop.

**GAS SUPPLY ZONE**

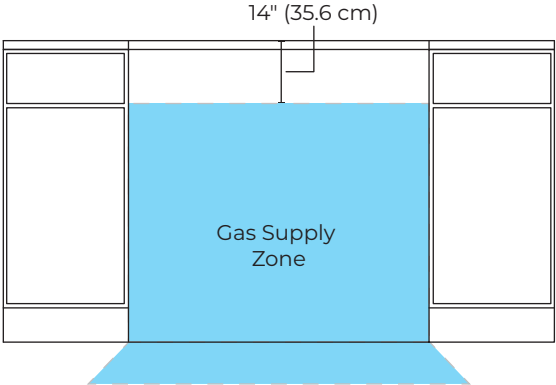

**FRONT VIEW**

**?** IF YOU HAVE QUESTIONS ABOUT YOUR GAS SUPPLY,  
CALL A LICENSED, QUALIFIED SERVICE TECHNICIAN.

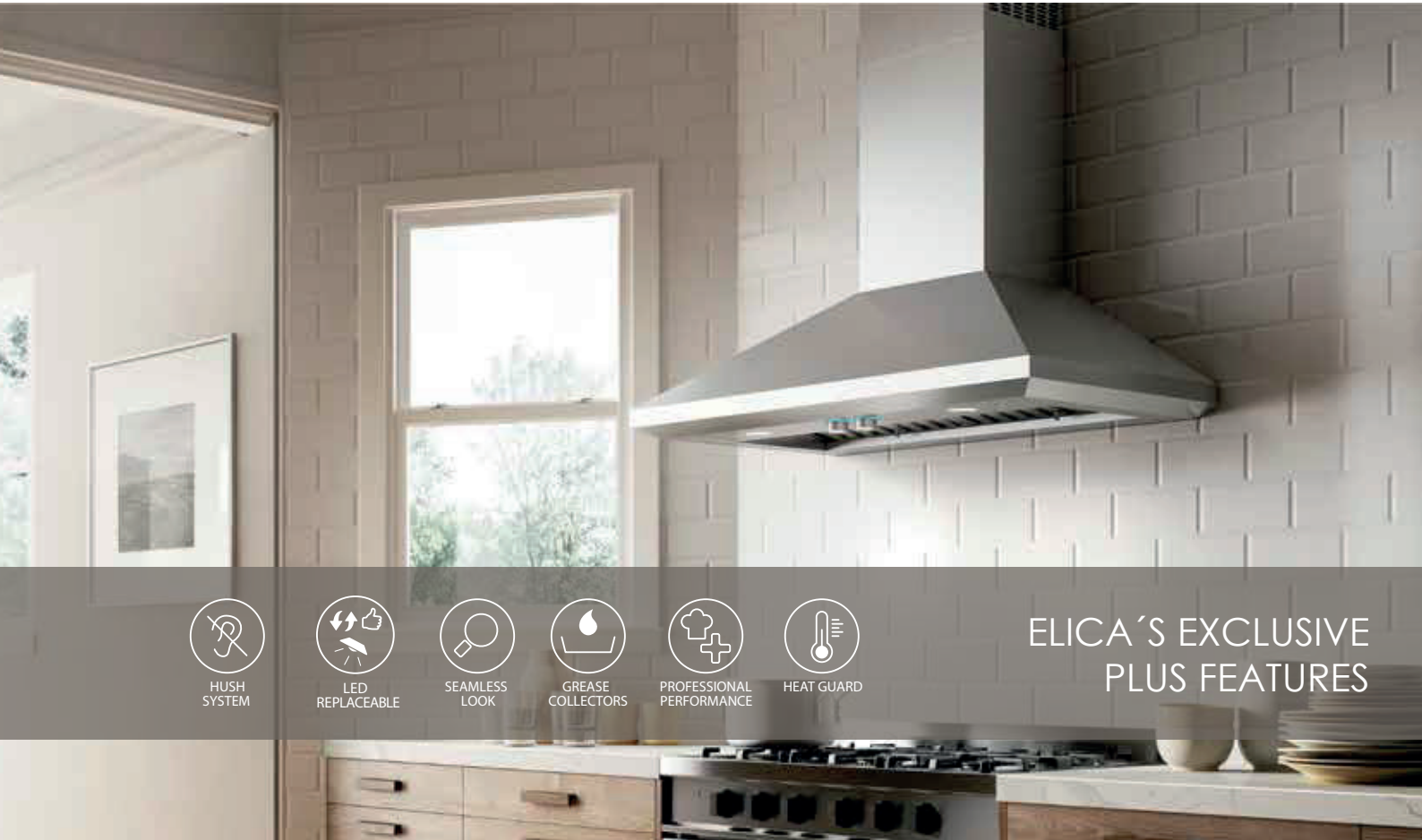

HUSH  
SYSTEM



LED  
REPLACEABLE



SEAMLESS  
LOOK



GREASE  
COLLECTORS



PROFESSIONAL  
PERFORMANCE



HEAT GUARD

ELICA'S EXCLUSIVE  
PLUS FEATURES

Give a splash of Italian design to your professional kitchen with Leone's crisp lines, seamless welded corner craftsmanship, beveled rim and gleaming stainless steel.

Leone has the extra depth (24") and power (1200 CFM on 36", 42" & 48" widths) needed to support professional ranges and cooktops. No ear plugs required with Leone's HUSH sound suppression system, which enables you to comfortably talk and entertain, even when cooking up a storm. Available in 30", 36" and 42" widths, Leone features backlit hidden knob controls, which operate the 4-speed blower and LED lighting. Designed for standard ducted ventilation only.

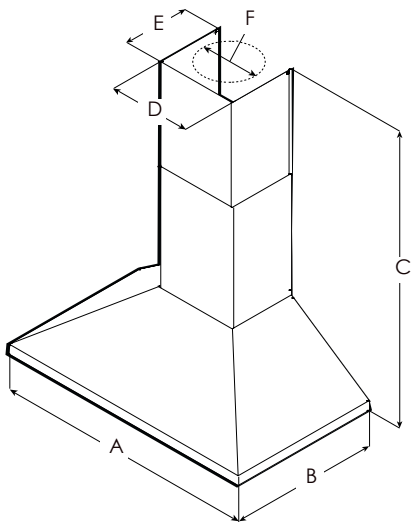

≥ 24"  
≥ 27"

MOUNTING  
HEIGHT  
RANGE

	ELN630S1 ELN630S2	ELN136S1 ELN136S2	ELN142S1 ELN142S2	ELN148SS
A	30" (76.2 cm)	36" (91.4 cm)	42" (106.7 cm)	48" (121.9 cm)
B		24" (61 cm)		
C		Max: 47 5/8" (120.9 cm) Min: 30" (76.2 cm)		
D		13 2/16" (33.2 cm)		
E		10 5/8" (27 cm)		
F		8" (20.3 cm)		



# ELICA PRO SERIES LEONE

LOT 5-68, INNISFIL, APPLIANCES



## SPECIFICATIONS

	<del>30"</del> Unit	36" Unit	<del>42"</del> Unit	<del>48"</del> Unit
Model:	ELN630S1 ELN630S2	ELN136S1 ELN136S2	ELN142S1 ELN142S2	ELN148SS
Dimensions:	30"W x 24"D x 12 1/8"H	36"W x 24"D x 12 1/8"H	42"W x 24"D x 12 1/8 "H	48"W x 24"D x 12 1/8 "H
Blower Type(internal):	600 CFM(4-speed)	1200 CFM(4-speed)	1200 CFM(4-speed)	1200 CFM(4-speed)
Blower Performance:				
Speed 1	205 CFM	375 CFM	375 CFM	375 CFM
Speed 2	350 CFM	640 CFM	640 CFM	640 CFM
Speed 3	510 CFM	940 CFM	940 CFM	940 CFM
Speed 4	600 CFM	1200 CFM	1200 CFM	1200 CFM
Noise (sones): Woking Speed	Min:2.01, Max:6	Min:3.21, Max:7.7	Min:3.21, Max:7.7	Min:3.21, Max:7.7
Finish:	Stainless Steel			
Controls:	Fully retractable rotating knobs with blue backlighting			
Illumination:	2 LED, 7.5 Watts LED light			
(replaceable lamps 1 intensity)				
Filter Type:	Dishwasher-Safe, Professional Stainless Steel, Angles baffled filters			
Angled Baffle Filters:	1	2	2	3
Duct Transition:	8" Round with BackDraft Damper (top only)			
Installation Type:	Ducted Installation Only			
Electrical:	120V - 60 Hz			
KITS:				
Long Chimney Extension Kit:	KIT02785			
CONSUMABLE PARTS:				
Replacement Grease Filter (1):	GF09FA	GF09EA	GF09FA	
Replacement Light Bulb (1):	LMP0131098			
	*Consumable parts are sold in units of one (1). Order accordingly			
INSTALL HEIGHTS:				
Ranger Hood:	Min: 8", Max 10"			
Ranger Hood with extension duct covers:	Min: 9.9", Max 13"			

## PLUS FEATURES



**HUSH SYSTEM** - An exclusive sound deadening technology that effectively reduces sound levels by over 35%



**LED CONSUMER REPLACEABLE BULB** - High quality LED lighting usually requires a skilled technician to replace lamps. Avoid this expense with Elica's new LED lamps that enable homeowners to replace in seconds



**SEAMLESS CRAFTSMANSHIP** - Heavy gauge stainless steel "Seamless" construction that delivers refined elegance.



**STAINLESS STEEL BAFFLE FILTERS WITH GREASE COLLECTORS** - Designed for high airflow cooking, the "S" shape design traps high volumes of grease



**PROFESSIONAL PERFORMANCE** - Special features and high performances for models with aspiration capacity between 600 and 1200 CFM's



**HEAT GUARD** - Senses extreme temperatures (>158 degrees) and automatically adjusts the blower speed to HIGH