



BELLAIRE PROPERTIES INC. (CARSON'S CREEK)
PURCHASER EXTRAS

LOT # 021 P.E #005 – Model MANITOU - 2480 - PHASE 2

Attention Trades...

The following items below are Purchaser Extras, please make sure that they are done on time and properly complete. Any outstanding items will be Back Charged. If you have any questions please call Roberto Ruiz. Make sure that you review ALL of the items on the Purchaser Extras.

Please be advised that Purchase Orders will come at a later date.

******Also, it is very important to speak to Roberto Ruiz before starting on site *****

TRADE:

ITEMS TO BE COMPLETED

Weston Flooring	#1, #2
North York Tile	#2, #7, #8, #9, #10
Miranda Painting	#3
Advance Marble	#4, #5
Pipecon	#5
National Fireplace	#6

Date: Sep.-01-2022
From: Lormel Homes
Site Clerk: Jai Fitzgerald
Site Tel: 905-775-3633
Site Fax: 905-775-9083

NOTE: If more information is needed please call Roberto Ruiz cell-416-688-9324
If more information needed on quotes or changes, please call Zachary 905-832-2023 ext. 224



Schedule B-3 – Purchaser’s Extras
forming part of the Agreement of Purchase and Sale



VENDOR: BELLAIRE PROPERTIES INC.

PURCHASER(S): Ivan M Kwong & Donna Lee Kwong
LOT NUMBER: 021 PHASE: 2
MODEL: 2480 Manitou
P.E.#: 005

It is understood and agreed that no requests for changes, additions or deletions will be accepted by the Vendor for the above extras after the date of acceptance of this order

No.	DESCRIPTION	PRICE
1.	Provide and install option 21 hardwood floors throughout the mian floor in lieu of standard.	
2.	Provide and install option 21 hardwood floors in the kitchen/breakfast area in lieu of level 1 floor tiles.	
3.	Provide stain to stairs, handrail and posts etc. (to complement color of harwood floors) from main to second floor. Price is based on metal/iron pickets.	
4.	Provide and install level 4 kitchen counter top in lieu of level 1	
5.	Provide and install upgrade kitchen sink (Bosco, 208038) in lieu of standard	
6.	Provide and install upgrade fireplace mantle in lieu of standard.	
7.	Provide and install level 7 floor tiles in the foyer in lieu of level 1	
8.	Provide and install level 6 floor tiles in the powder room in lieu of level 1. *Note: Tiles to be installed stacked	
9.	Provide and install level 2 wall tiles in the primary ensuite shower walls, shared bath tub walls, and 2 nd ensuite (bdrm 4) tub walls in lieu of level 1.	
10.	Provide and install upgrade grout in the foyer and powder room.	
Extra's Subtotal:		
H.S.T.		
New Total:		
Less Bonus Package (if Applicable)		
TOTAL:		
Amount to be Added to the Purchase Price as an Adjustment on Closing		
	TOTAL	

The above extras and upgrades are to be included during the construction of the above house for the above named purchaser subject to the follow conditions:

- The Vendor will undertake to install the above extras but will not be liable to the purchaser if for any reason the work covered by the extra is not carried out. In that event, the price of the extra shall be refunded to the purchaser without any interest.
- It is understood and agreed that if the transaction of Purchase and Sale is not completed for any reason whatsoever, the total cost of this extra is not refundable.

PAID: _____

PURCHASER: [Signature]

PURCHASER: [Signature]

TERMS: CASH OR CHEQUE IN ADVANCE

BELLAIRE PROPERTIES INC.

File Copy for
Construction
Office

(Original verified at Head Office)

Vendor: Lorimer Homes (Mar 8, 2022 13:56 EST)

The Manitou / Elev. A & B
2480 sq.ft.

Stove &
Hoodfan
opening to
be
36" inches
wide from
P003,
Dated
Aug.13,
2021

2 capped Lights
for future Pendants

LOT 2-21, INNISFIL, PE005



FIRST FLOOR
ELEVATION A & B

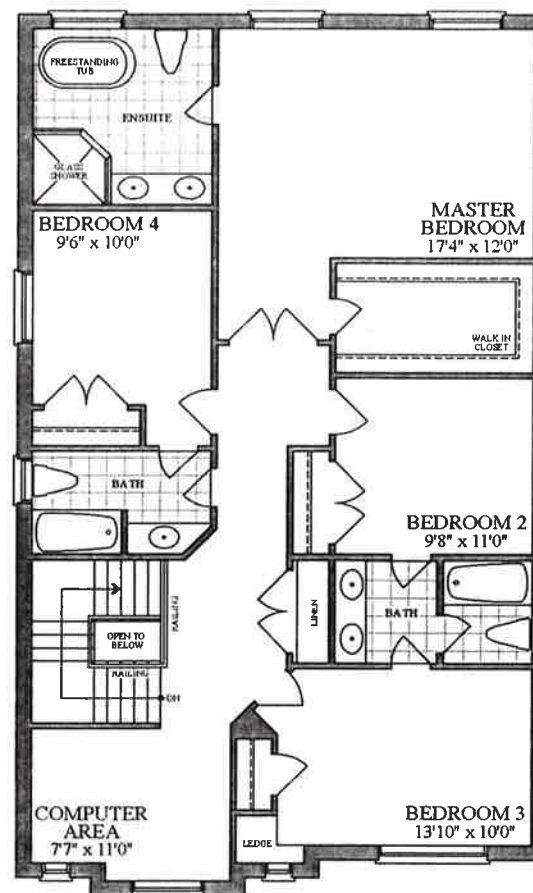

SECOND FLOOR
ELEVATION A



SECOND FLOOR
ELEVATION B

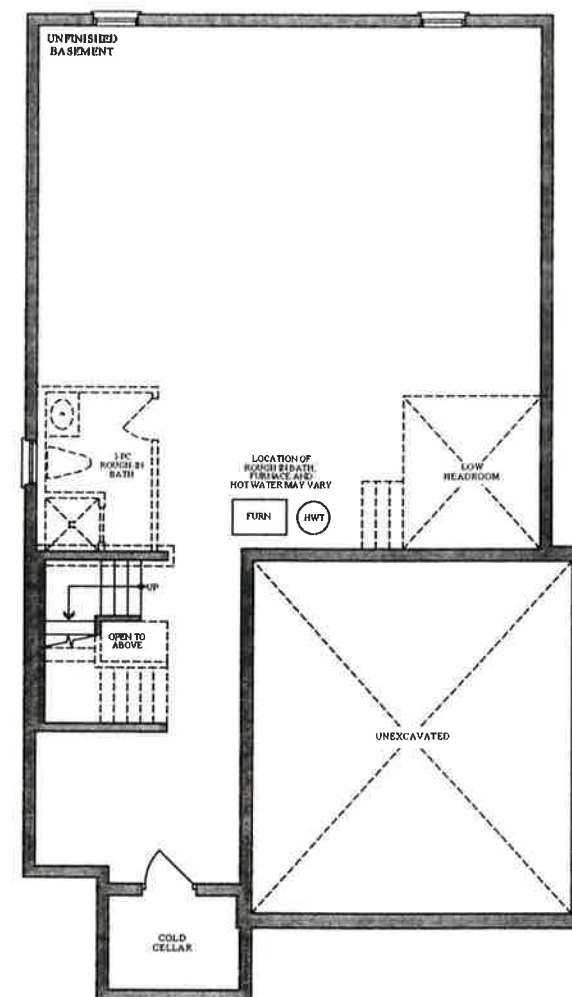

**BASEMENT
ELEVATION A & B**



Plans and specifications are subject to change without notice. E. & O. E. Actual usable floor space may vary from the stated floor area. All renderings are artist's concept.

