



VENDOR:

LORMEL DEVELOPMENTS (BRADFORD) LTD.

PURCHASER(S): Oluwatosin Ajayi & Oluwatobi Dipo Ajayi

LOT NUMBER: PART 002 PHASE: 3

MODEL: Rosemount 2800

P.E.#: 004

It is understood and agreed that no requests for changes, additions or deletions will be accepted by the Vendor for the above extras after the date of acceptance of this order.

[illegible]

The above extras and upgrades are to be included during the construction of the above house for the above named purchaser subject to the following terms and conditions:

- * The Vendor will undertake to install the above extras but will not be liable to the purchaser if for any reason the work covered by the extra is not carried out. In that event, the price of the extra shall be refunded to the purchaser without any interest.
- * It is understood and agreed that if the transaction of Purchase and Sale is not completed for any reason whatsoever, the total cost of this extra is not refundable.

PAID: _____ TERMS: CASH OR CHEQUE IN ADVANCE

Oluwatosin Ajayi

PURCHASER

Oluwatobi Dipo-Ajayi

PURCHASER

LORMEL DEVELOPMENTS (BRADFORD) LTD.

Per:

VENDOR

Signature: [Signature]

Email: tosino.tobes@gmail.com



131B CARLAUREN RD., WOODBRIDGE, ONTARIO L4L 8A0
TEL: (905) 856-7678 • FAX: (905) 856-7379
www.libertycustomcabinetry.com

QUOTATION

TO: LORELE SHIP TO: BRANDFORD

TYPE OF CABINETS:	FINISH OF CABINETS:	HARDWARE:	COUNTERTOP:	INSTALLATION:
HOUSE TYPE	REMARKS			<input type="checkbox"/> WITH <input type="checkbox"/> WITHOUT

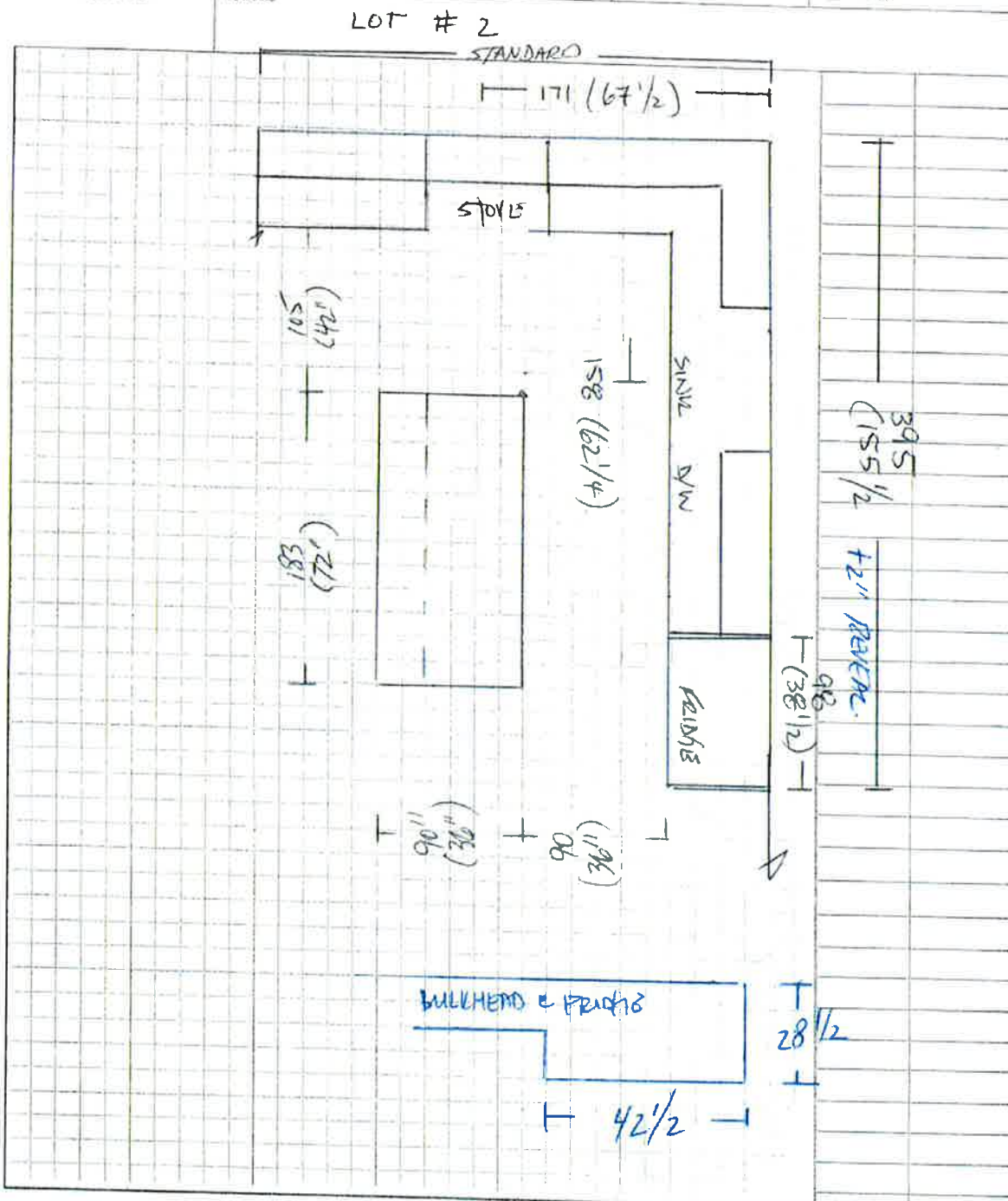

All prices subject to confirmation from head office.
Goods delivered shall be checked and inspected on
delivery. We shall not be responsible for any claims or
complaints after this inspection.

All agreements are contingent upon strikes, accidents, and
delays beyond our control.
Please provide our installer with template for sinkholes or
\$100.00 will be charged for callback.

ACCEPTED DATE: _____ TERMS: _____
LAYOUT THOROUGHLY EXPLAINED AND FULLY UNDERSTOOD

TOTAL \$

CUSTOMER SIGNATURE

SALESMAN'S SIGNATURE