

Lindsay 2017 Developments Inc. / Sugarwood

Lot/Unit: 62    Phase/Building: 1    Model/Floor Plan: Catchacoma Lake (4205) Elev B 4Bed  
2.5Bath

CABINETRY

Inv.6602	1 - TO ACCOMODATE FOR 30" CHIMNEY HOODFAN	
Line 82396	Note:	
9Jun25 / 13Jun25		

CABINETRY APPLIANCE - FRIDGE

Inv.6602	1 - 66CM DEEP FRIDGE ENCLOSURE - COUNTER DEPTH WITH - 1 WALL - 1 66CM DEEP GABLE AND 1 66CM DEEP CABINET - THIS IS NOT A ZERO CLEARANCE ENCLOSURE. STANDARD HEIGHTS AND WIDTHS WILL BE USED. - CLASSIC SERIES	
Line 82277	Note:	
9Jun25 / 13Jun25		

CABINETRY BASE CABINETS

Inv.6602	2 - POTS & PANS DRAWER - MINIMUM 60 CM - MAXIMUM 90 CM - SIZE SUBJECT TO FLOOR PLAN - CLASSIC SERIES	
Line 82278	Note:	
9Jun25 / 13Jun25		
Inv.6602	1 - BASE PIE CUT CORNER - CLASSIC SERIES	
Line 82279	Note:	
9Jun25 / 13Jun25		

CABINETRY HOOD FANS

Inv.6602	1 - HOOD FAN - PRO COLLECTION (SCB519) WALL MOUNT RANGE HOOD WITH 650 CFM FAN - 30 INCH -	
Line 82276	Note:	
9Jun25 / 13Jun25		

CABINETRY VANITY

Inv.6602	2 - INCREASE VANITY TO KITCHEN HEIGHT - 90CM HIGH - MAINTAINS VANITY DEPTH - CLASSIC SERIES IN THE MAIN AND MASTER ENSUITE	
Line 82282	Note:	
9Jun25 / 13Jun25		
Inv.6602	1 - VANITY BANK OF DRAWERS - 60CM TO 90CM WIDE - CLASSIC SERIES IN MAIN AND MASTER ENSUITE	
Line 82284	Note:	
9Jun25 / 13Jun25		

CABINETRY WALL AND HUTCH

Inv.6602	1 - UPPER ANGLE CORNER PER UNIT - CLASSIC SERIES	
Line 82280	Note:	
9Jun25 / 13Jun25		

DOORS AND WINDOWS

Inv.6602	3 - To upgrade Basement Windows (36x24:), See sketch #1	
Line 82262	Note:	
9Jun25 / 13Jun25		



CONSTRUCTION SUMMARY

Lindsay 2017 Developments Inc. / Sugarwood

Lot/Unit: 62    Phase/Building: 1    Model/Floor Plan: Catchacoma Lake (4205) Elev B 4Bed 2.5Bath

ELECTRICAL

Inv.6602	4 - TO SUPPLY & INSTALL FOUR IC 4 in POT LIGHT C/W PAR 20 BULB AND WHTIE TRIM CONNECTED TO A SEP. SWITCH IN THE GREAT ROOM, SEE SKETCH #2	
Line 82397	Note:	
9Jun25 / 13Jun25		
Inv.6602	3 - DO NOT SUPPLY STD LIGHT IN LOWER HALLWAY, SUPPLY & INSTALL THREE IC 4 in POT LIGHT C/W PAR 20 BULB AND WHTIE TRIM CONNECTED TO STD SWITCH, SEE SKETCH #2	
Line 82398	Note:	
9Jun25 / 13Jun25		
Inv.6602	5 - TO SUPPLY & INSTALL FIVE IC 4 in POT LIGHT C/W PAR 20 BULB AND WHTIE TRIM CONNECTED TO A SEP SWITCH, SEE SKETCH #2	
Line 82399	Note:	
9Jun25 / 13Jun25		
Inv.6602	1 - TO RELOCATE THE STD KITCHEN LIGHT, SEE SKETCH #2	
Line 82400	Note:	
9Jun25 / 13Jun25		
Inv.6602	1 - SEE SKETCH #2 FOR STD TV & PH LOCATIONS	
Line 82401	Note:	
9Jun25 / 13Jun25		
Inv.6602	1 - SUPPLY AND INSTALL AN ADDITIONAL BASIC RECEPTACLE (NOT DEDICATED) AT 66" UP FROM THE FLOOR OVER THE F/P, NEXT TO THE STD TV & PH ROUGH-INS	
Line 82402	Note:	
9Jun25 / 13Jun25		

PLUMBING

Inv.6602	1 - To supply and install the optional 3-piece rough-in, see sketch #1	
Line 82263	Note:	
9Jun25 / 13Jun25		

EXTRAS AS PER OFFER

Note:	
-------	--

# Catchacoma Lake

KINGSILJEN GROUP INC.

A: 2340 / B: 2310 sq. ft. / 4 Bedrooms / 2 1/2 Bathrooms

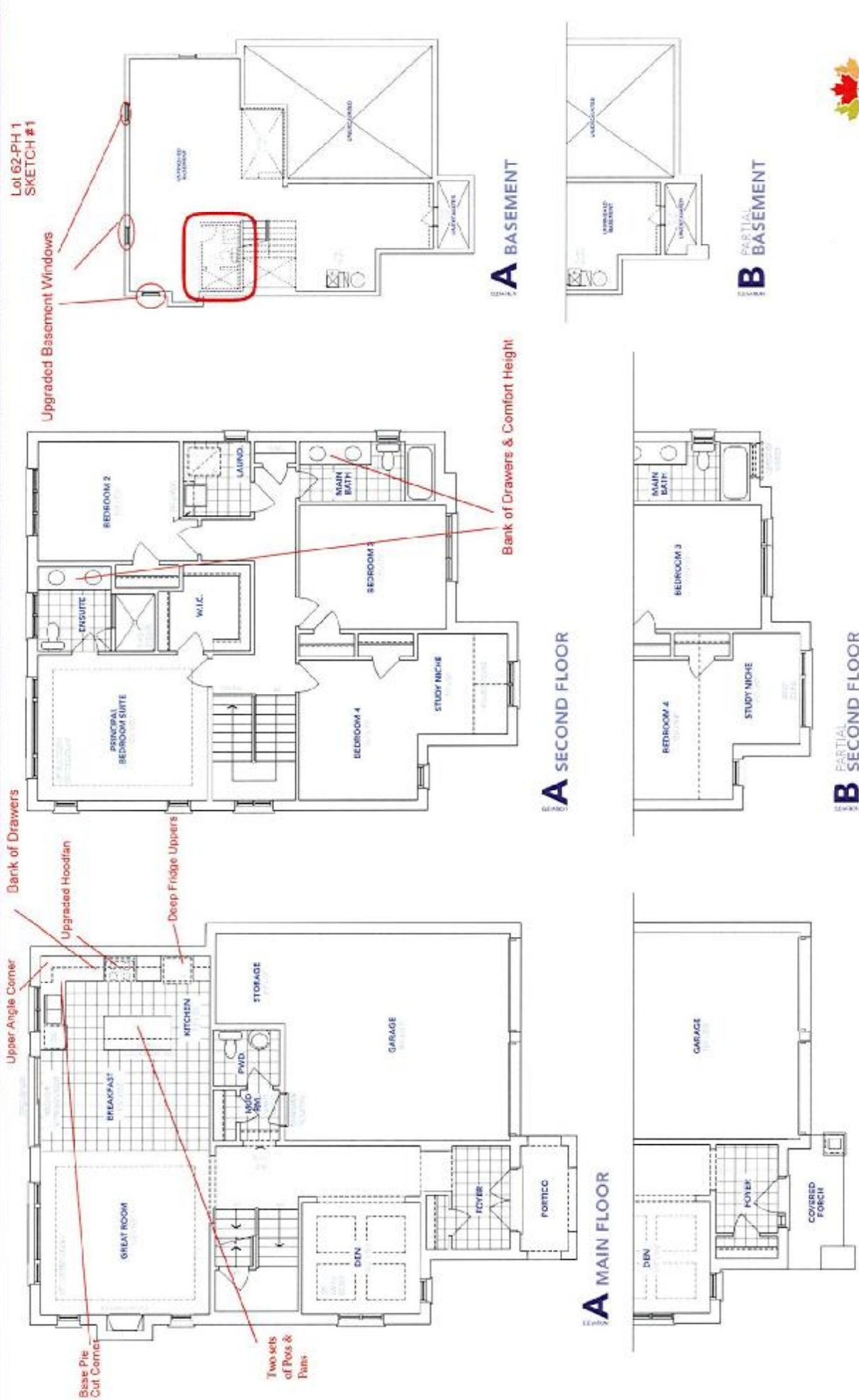

# Catchacoma Lake

4205

**KINGSLIEN**  
DESIGN INC.

A: 2340 / B: 2310 sq. ft. / 4 Bedrooms / 2 1/2 Bathrooms

LOT 66 67  
PHASE 1  
SKETCH #2

