



CONSTRUCTION SUMMARY

KINGSMEN (THAMES) INC. / Havelock Corners (Kingsmen)

Lot/Unit: 98 Phase/Building: 5B Model/Floor Plan: Andrew (3603) Elev B 4 Bed - 2+1 Bath

CABINETRY HOOD FANS

CABINETRY VANITY

CARPET

ELECTRICAL

HARDWOOD

HEATING AND AIR CONDITIONING

MISCELLANEOUS

Inv.6574	1 - Do not supply or install the optional side door if grade permints... see sketch # 4	
Line 82131	Note: This upgrade was origianlly purhcased on April 25, 2023. This upgrade cannot be accomodated due to the grade.	
14Jun24 / 14Jun24	A full refund will be issued by amendment to the purchasers.	

PAINT AND DRYWALL

PLUMBING

RAILING

TILE - FLOOR

EXTRAS AS PER OFFER

*Cannot accommodate
Due to grade.
See front H/24.
OPT. SIDE
DOOR IF PERMITS.
DOOR DOOR GRADE
PERMITTING*

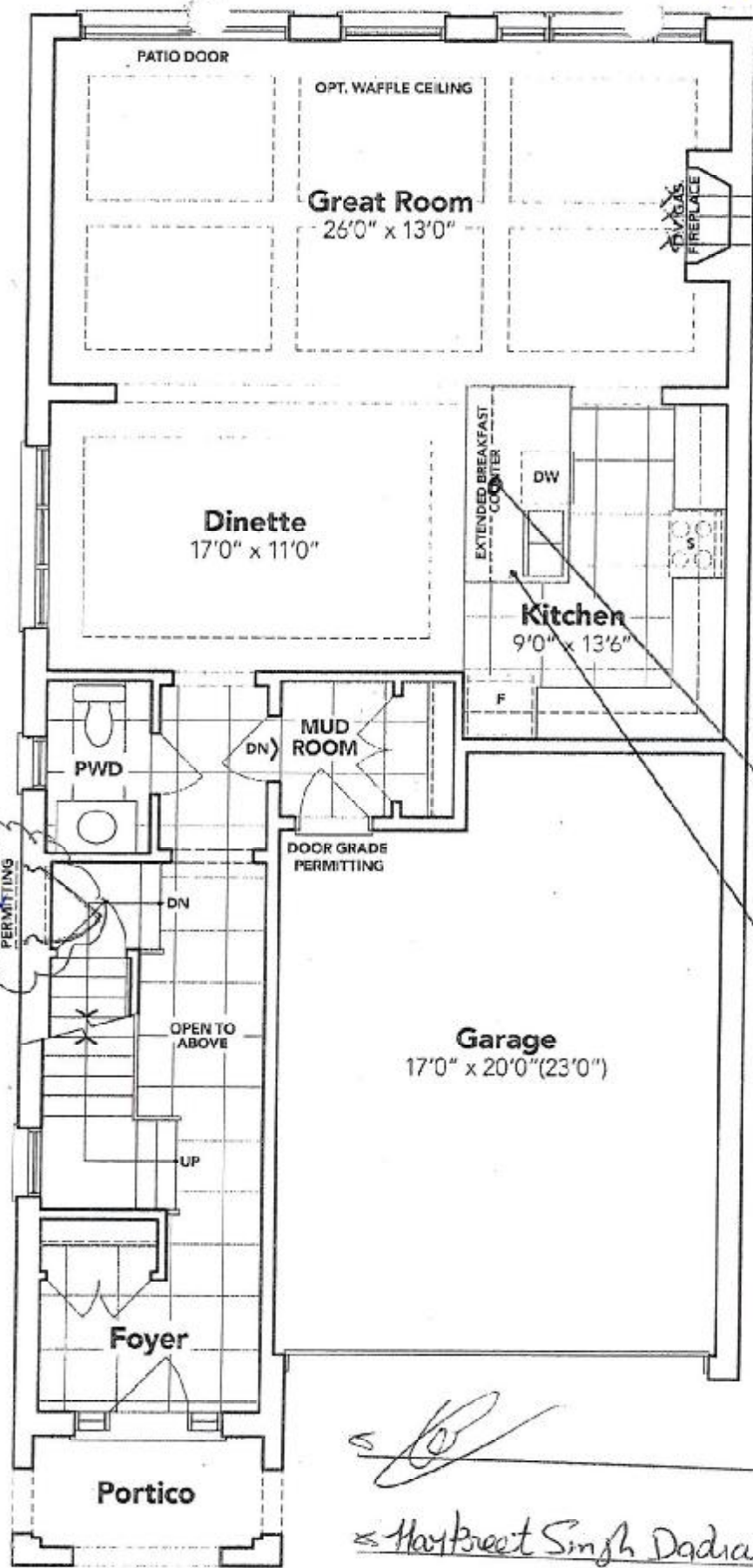

*TV
PH
all 3 items
@ 66" top
main floor*

*mapped
elec. ma
dep. Santa*

*door
responder*

Haybreed Singh Dadiale

GROUND FLOOR EL. B

The floor plans and elevations shown are pre-construction plans and may be revised or improved as necessitated by architectural controls and the construction process. The measurements adhere to the rules and regulations of the TARIION Warranty Corporation's official method for the calculation of floor area. Materials, specifications and floor plans are subject to change without notice. All house renderings are artist's concept only. Actual usable floor space may vary from the stated floor area. All options shown are upgrades. E. & O. E.