

KINGSMEN (THAMES) INC. / Havelock Corners (Kingsmen)

Lot/Unit: 142    Phase/Building: 5B    Model/Floor Plan: Louis (4203) Elev C 4 Bed - 4+1 Bath

CABINETRY

Inv.6553	1 - To accomodate a 36" stove opening in the kitchen in lieu of the standard 30" opening.	
Line 82006	Note:	
26Jan24 / 1Feb24		

CABINETRY APPLIANCE - FRIDGE

Inv.6553	1 - To supply & install a 66CM DEEP FRIDGE ENCLOSURE - COUNTER DEPTH WITH - 1 WALL - 1 66CM DEEP GABLE AND 1 66CM DEEP CABINET - THIS IS NOT A ZERO CLEARANCE ENCLOSURE. STANDARD HEIGHTS AND WIDTHS WILL BE USED. -in the kitchen... see sketch # 1	
Line 82013	Note:	
26Jan24 / 1Feb24		

CABINETRY BASE CABINETS

Inv.6553	1 - To supply & install a different colour island... see colour chart for details.	
Line 82026	Note:	
26Jan24 / 1Feb24		
Inv.6553	1 - To supply & install the 45CM WIDE PULL-OUT DOOR BASE CABINET WASTE - RECYCLE CENTRE - 2 35L BINS - AVAILABLE ONLY WITH 45CM WIDE CABINET in the kitchen... see sketch # 1	
Line 81932	Note:	
26Jan24 / 1Feb24		
Inv.6553	1 - To supply & install the POTS & PANS DRAWER in the kitchen... see sketch # 1	
Line 81933	Note:	
26Jan24 / 1Feb24		

CABINETRY MICROWAVE OVEN STOVE COOKTOP

Inv.6553	1 - To supply & install a COOKTOP CABINET WITH FALSE TOP DRAWER AND POTS AND PANS DRAWERS BELOW - SUPPLY SPECS in the kitchen...see sketch # 1	
Line 82010	Note:	
26Jan24 / 1Feb24		
Inv.6553	1 - To supply & install a BUILT-IN TALL APPLIANCE CABINET WITH DRAWER - S BELOW FOR PANEL-MOUNT - PROUD - OR TRIM KIT INSTALLATIONS - TRIM KIT REQUIRED - SUPPLY ALL SPECS AND INSTALLATION GUIDES in the kitchen... see sketch # 1	
Line 82011	Note: NO FLUSH MOUNT INSTALLATION	
26Jan24 / 1Feb24		

CABINETRY WALL AND HUTCH

Inv.6553	1 - To supply & install an UPPER ANGLE CORNER PER UNITin the kitchen.... see sketch # 1	
Line 81928	Note:	
26Jan24 / 1Feb24		
Inv.6553	1 - To supply & install a GLASS DOOR - SPECIFY CLEAR -GLASS - UNFINISHED CABINET INTERIOR - to the upper corner cabinet in the kitchen... see sketch #1	
Line 81929	Note:	
26Jan24 / 1Feb24		

KINGSMEN (THAMES) INC. / Havelock Corners (Kingsmen)

Lot/Unit: 142    Phase/Building: 5B    Model/Floor Plan: Louis (4203) Elev C 4 Bed - 4+1 Bath

COUNTER TOP

Inv.6553	1 - To accomodate the quartz countertop for a future 36" cook top.	
Line 82009	Note:	
26Jan24 / 1Feb24		

ELECTRICAL

Inv.6553	1 - To SUPPLY AND INSTALL EXTRA 240 STOVE PLUG for the future built in micorwave/oven tower in the kitchen... see spec's... see sketch # 1	
Line 82012	Note:	
26Jan24 / 1Feb24		
Inv.6553	1 - To supply & install a 36" standard style stainless steel hood fan in the kitchen in lieu of the standard 30" stainless steel hood fan.	
Line 82007	Note:	
26Jan24 / 1Feb24		
Inv.6553	1 - To supply & install the standard T.V. rough in in the great room and master bedroom... see sketch # 1 & # 2	
Line 81861	Note: Install the standard T.V. rough in at approx. 66" + - up from the floor centered + - to the F/P mantle	
26Jan24 / 1Feb24		
Inv.6553	1 - To supply & install the standard Phone ( CAT5 ) rough in in the great room, master bedroom and Bedroom # 4 ... see sketch # 1 & # 2	
Line 81862	Note: Install the standard T.V. rough in at approx. 66" + - up from the floor centered + - to the F/P mantle	
26Jan24 / 1Feb24		
Inv.6553	1 - To SUPPLY AND INSTALL AN ADDITIONAL BASIC RECEPTACLE (NOT DEDICATED) at approx. 66" + - up from the floor centered + - to the F/P mantle	
Line 81911	Note: in the great room... see sketch # 1	
26Jan24 / 1Feb24		This is for a future wall mount T.V. NO CONDUIT PIPE HAS BEEN PURCHASED.
Inv.6553	1 - To SUPPLY AND INSTALL EXTRA CEILING BOX ROUGH IN CAPPED (DOES NOT INCLUDE SWITCH) over the island in the kitchen... see sketch # 1	
Line 81912	Note: This capped elec. will be connected to a sep. switch. Switch sold sep.	
26Jan24 / 1Feb24		
Inv.6553	1 - To supply & install AN ADDITIONAL SINGLE POLE SWITCH connected to the upgraded capped elec. over the island in the kitchen.	
Line 81913	Note:	
26Jan24 / 1Feb24		
Inv.6553	1 - Relocate the standard ceiling light from the upper stair landing to the O.T.B. area on the second floor... see sketch # 2	
Line 81914	Note:	
26Jan24 / 1Feb24		

HEATING AND AIR CONDITIONING

Inv.6553	1 - To supply & install a capped gas line ( rough in only ) at the stove location in the kitchen to include a 110 V elec. outlet code requirement.	
Line 82008	Note:	
26Jan24 / 1Feb24		

KINGSMEN (THAMES) INC. / Havelock Corners (Kingsmen)

Lot/Unit: 142    Phase/Building: 5B    Model/Floor Plan: Louis (4203) Elev C 4 Bed - 4+1 Bath

Inv.6553	1 - As per schedule "PE": Vendor to install capped gas line ( Rough in only ) at rear of home for future BBQ location. Location to be finalized at vendors sole discretion.	
Line 81859	Note:	
26Jan24 / 1Feb24		
Inv.6553	1 - As per schedule "PE": Vendor to supply & install air conditioning unit, sized accordingly, from vendors standard samples.	
Line 81860	Note:	
26Jan24 / 1Feb24		

MISCELLANEOUS

Inv.6553	1 - DO NOT SUPPLY OR INSTALL ANY MIRRORS THROUGHOUT ALL BATHROOMS.	
Line 81922	Note:	
26Jan24 / 1Feb24		
Inv.6553	1 - DO NOT SUPPLY OR INSTALL ANY TOWEL BARS, TOILET PAPER HOLDERS OR SOAP DISHES THROUGHOUT ALL BATHROOMS.	
Line 81923	Note:	
26Jan24 / 1Feb24		

PLUMBING

Inv.6553	1 - To supply & install the Mirolin BROOKE free standing tub in the master ensuite in lieu of the standard free standing tub... see spec's	
Line 81924	Note:	
26Jan24 / 1Feb24		

RAILING

Inv.6553	1 - To supply & install the RAILING - UPGRADE 1 - METAL HANDRAIL 3 INCH OVAL IN OAK - PICKETS STEEL ½ INCH SQUARE, PLAIN, WITH SHOES IN FLAT BLACK - POSTS 3½ INCH SQUARE, WITH CAP OAK IN OAK in lieu of the standard pickets and rails.	
Line 82014	Note:	
26Jan24 / 1Feb24		

EXTRAS AS PER OFFER

5 FREE APPLIANCES – STAINLESS STEEL FRONT - FRIDGE; STOVE AND DISHWASHER. WHITE WASHER AND DRYER (SUPPLIED ONLY, NOT INSTALLED, FROM BUILDERS STANDARD LINE). AN APPLIANCES VOUCHER WILL BE GIVEN BY OUR DECOR CONSULTANT AT THE TIME OF BOOKING YOUR COLOUR A <i>Worksheet</i> Note:		
VENDOR TO INSTALL CAPPED GAS LINE (ROUGH-IN ONLY) AT REAR OF HOME FOR FUTURE BBQ LOCATION. LOCATION TO BE FINALIZED AT VENDORS SOLE DISCRETION. <i>Worksheet</i> Note:		
VENDOR TO SUPPLY & INSTALL AIR CONDITIONING UNIT, SIZED ACCORDINGLY, FROM VENDORS STANDARD SAMPLES. <i>Worksheet</i> Note:		

Purchasers: REHAN SHAHID, & SHASHIKALA RAGOONAN/Property: 142 of Plan - Draft Approval SB17-03-08  
Telephone Res. / Bus: / Project: KINGSMEN (THAMES) INC.  
Decor Advisor: Barbara Coccia Model and Elevation: Louis (4203) Elev C 4 Bed - 4+1 Bath  
Layout Changes: ☐ Yes ☒ No Sketch Attached: ☒ Yes ☐ No Exterior Colour Scheme:

1. Cabinetry

	Style and Colour	Counter Top	Hardware
Kitchen / Breakfast	#3 Simcoe Orchid	# 1 C/S # 9141 Ice Snow 3cm.	# 12881 Handle
Kitchen Island	#3 Simcoe Moonlight	# 1 C/S # 9141 Ice Snow 3cm.	# 12881 Handle
Laundry Room	/		
Powder Room	#3 Simcoe Orchid	# 6698-46 Paloma Polar	# 12881 Handle
Main Bathroom	/		
Master Ensuite Bathroom	#3 Muskoka Navy Blue	# 4924-38 White Carrara	# 12881 Handle
Second Ensuite Bathroom (If Applicable)	#3 Simcoe Orchid	# 6698-46 Paloma Polar	# 12881 Handle
Ens. #3's bathroom	#3 Muskoka Navy Blue	# 4924-38 White Carrara	# 12881 Handle
Ens. #4's bathroom	#3 Simcoe Orchid	# 6698-46 Paloma Polar	# 12881 Handle

Appliances

Custom Size Fridge

☐ Yes ☒ No

Valance Lighting

☐ Yes ☒ No

Microwave / Range Hood

☐ Yes ☒ No

Cooktop / Rangetop

☒ Yes ☐ No

Built in Wall Oven

☒ Yes ☐ No

Slide-in Range

☐ Yes ☒ No

Comment

/

2. Flooring

	Selection
Foyer	13 x13" Burlingstone White
Main Hall	3 1/2" Elements Oak Sturgeon
Back Hall	/
Breakfast	( Including pantry ) 13 x13" Burlingstone White
Laundry Room	13 x13" Burlingstone White
Kitchen	13 x13" Burlingstone White
Powder Room	13 x13" Burlingstone White
Main Bathroom	Ens. #2's bathroom: 13 x13" Burlingstone White
Master Ensuite	13x13" Keaton Ice
Bathroom (If Applicable)	Ens. #3's bathroom: 13x13" Keaton Ice
Mud Room	13 x13" Burlingstone White
Master & Ens. #2's shower	floor: 2x2" Inizio Bianco
Living Room	Sitting room: 3 1/2" Elements Oak Sturgeon
Dining Room	Ens. #4's bathroom: 13 x13" Burlingstone White
Family / Great Room	3 1/2" Elements Oak Sturgeon
Den / Library / Study	/
Basement Landing (If Applies)	
Lower Landing (If Applicable)	3 1/2" Elements Oak Sturgeon
Upper Landing	( if applicable ) 3 1/2" Elements Oak Sturgeon
Upper Hall	Modern Story 1, # 945 Felt Hat
Master Bedroom	Modern Story 1, # 945 Felt Hat
Bedroom #2	Modern Story 1, # 945 Felt Hat
Bedroom #3	Modern Story 1, # 945 Felt Hat
Bedroom #4	Modern Story 1, # 945 Felt Hat
Bedroom #5	/
Master & Ens. #2's shower	jamb: Anatolia Marmiline SNOW



Purchasers: REHAN SHAHID, & SHASHIKALA RAGOONAN/Property: 142 of Plan - Draft Approval SB17-03-08  
Telephone Res. / Bus: / Project: KINGSMEN (THAMES) INC.  
Decor Advisor: Barbara Coccia Model and Elevation: Louis (4203) Elev C 4 Bed - 4+1 Bath

2. Flooring - Continued -



Upgrade Underpad	Type	Area
	Standard	2nd. floor
Carpet on Stairs	Capped	Runner - *Upgrade
Comment	/	/

3. Plumbing Fixtures / Faucets

Kitchen	Standard	Second Ensuite	Standard	Powder Room	Standard
Master Ensuite	Standard			Other Room	/
Main Bathroom	/	Ens. #3 & #4's bathroom	Standard		
Comment	Still to install the standard under mount kitchen sink with the standard single hole kitchen faucet NO PLATE.				

4. Wall Tile

	Tile Selection	Listello	Insert	Insert Selection
Main Bathroom	/	<input type="checkbox"/>	<input type="checkbox"/>	
Master Ensuite				
Tub Deck	/	<input type="checkbox"/>	<input type="checkbox"/>	
Tub Apron	/	<input type="checkbox"/>	<input type="checkbox"/>	
Tub Surround	/	<input type="checkbox"/>	<input type="checkbox"/>	
Shower Stall	8x10" Weave White	<input type="checkbox"/>	<input type="checkbox"/>	
Second Ensuite	8x10" Weave White	<input type="checkbox"/>	<input type="checkbox"/>	
Ens. #3's bathroom	8x10" Weave White	<input type="checkbox"/>	<input type="checkbox"/>	
Ens. #4's bathroom	8x10" Weave White	<input type="checkbox"/>	<input type="checkbox"/>	
Kitchen Backsplash	/	<input type="checkbox"/>	<input type="checkbox"/>	
Complete Backsplash	/	<input type="checkbox"/>	<input type="checkbox"/>	
Comment				

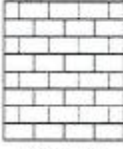
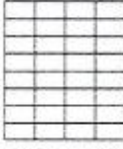

Horizontal stacked

brick pattern

vertical stacked

diagonal/diamond

5. Fireplace

	Living Room			Family Room			Other Room - Specify Great room		
	Purchased	As Per Plan	N/A	Purchased	As Per Plan	N/A	Purchased	As Per Plan	N/A
Fireplace Type	<input type="radio"/>	<input type="radio"/>	<input checked="" type="radio"/>	<input type="radio"/>	<input type="radio"/>	<input checked="" type="radio"/>	<input type="radio"/>	<input checked="" type="radio"/>	<input type="radio"/>
Mantle Type							Front Facing		
Over Mantle							NF-08		
Colour / Stain							/		
Surround							White		
Hearth							/		
Comment	/								

Initial:



**Purchasers:** REHAN SHAHID, & SHASHIKALA RAGOONAN/**Property:** 142 of Plan - Draft Approval SB17-03-08  
**Telephone Res. / Bus:** / **Project:** KINGSMEN (THAMES) INC.  
**Decor Advisor:** Barbara Coccia **Model and Elevation:** Louis (4203) Elev C 4 Bed - 4+1 Bath

### 6. Trim Carpentry

Door Hardware Standard Handle

Interior Trim Standard

Comment

/

#### Interior Doors

☐ 2 Panel Arch Top

☒ 2 Panel Square Top

☐ 6 Panel



Initial for Door Style

### 7. Railings and Pickets

Railing Package \*\* Upg. #1 Metal picket package

Railing Colour Elements Sturgeon

Picket Colour BLACK

Wood Stairs ☐ No ☒ Oak

Tread Colour Elements Sturgeon

Comment

/

### 8. Plaster Mouldings and Medallions

Foyer	/	
Main Hall	/	
Living Room	/	
Dining Room	/	
Family Room	/	

Kitchen/Breakfast	/	
Den/Library	/	
Lower Landing	/	

Comment

/

### 9. Wall Paint

Kingsmen White



Smooth Ceilings ☐ First Floor  
☐ First Floor incl. Second Floor Hall  
☐ First and Second Floor  
☒ Throughout  
☐ Not Applicable

Trim Paint Kingsmen White

### 10. Additional Comments

/

### 11. Disclaimers and Notes

- Colours of all materials are as close as possible to builder's selection, but not necessarily identical due to variances in manufacturing.
- Any extras listed above are null and void unless accompanied by a separate invoice/amendment. Said invoice must be paid in full.
- The Purchaser acknowledges that after Interior Colour Selection form is signed and dated, no further changes will be permitted other than re-selection due to unavailability.   Purchaser's Initials
- The Purchaser acknowledges reading and accepting the "Kingsmen Group Décor Centre Disclaimers" form. This document contains other miscellaneous disclaimers.

This Interior Colour Selection is final and approved by:

Purchaser:  Date: Feb 01/24

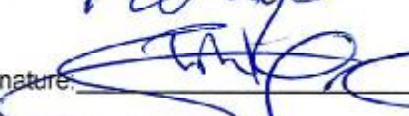
Signature:  Date: Feb 01/24

Vendor:   
KINGSMEN (THAMES) INC.



LOT 142  
THAMES PH. 5B  
SKETCH # 1

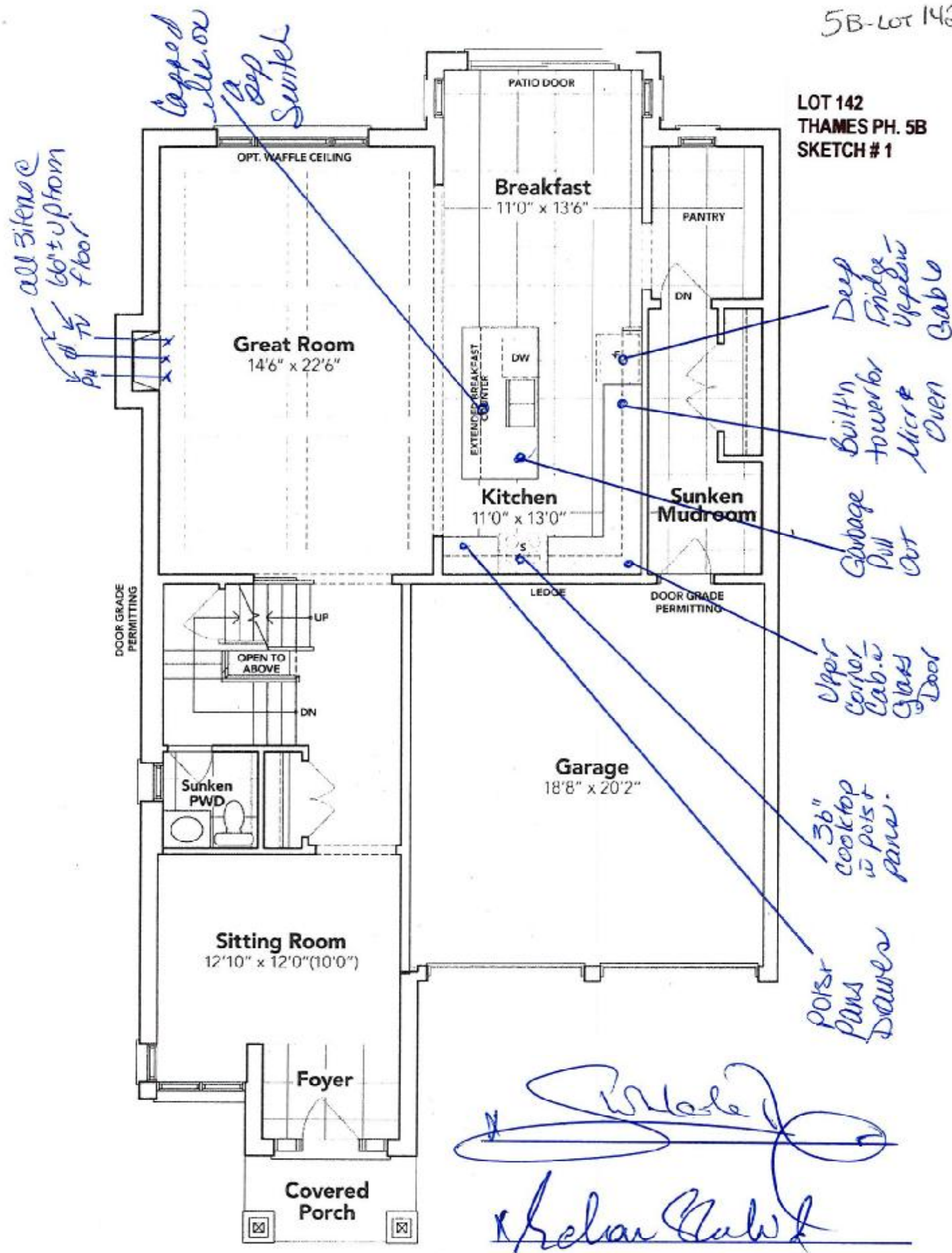

### GROUND FLOOR EL. C

The floor plans and elevations shown are pre-construction plans and may be revised or improved as necessitated by architectural controls and the construction process. The measurements adhere to the rules and regulations of the TARION Warranty Corporation's official method for the calculation of floor area. Materials, specifications and floor plans are subject to change without notice. All house renderings are artist's concept only. Actual usable floor space may vary from the stated floor area. All options shown are upgrades. E. & O. E.

5B-LOT 146

LOT 142  
THAMES PH. 5B  
SKETCH # 2

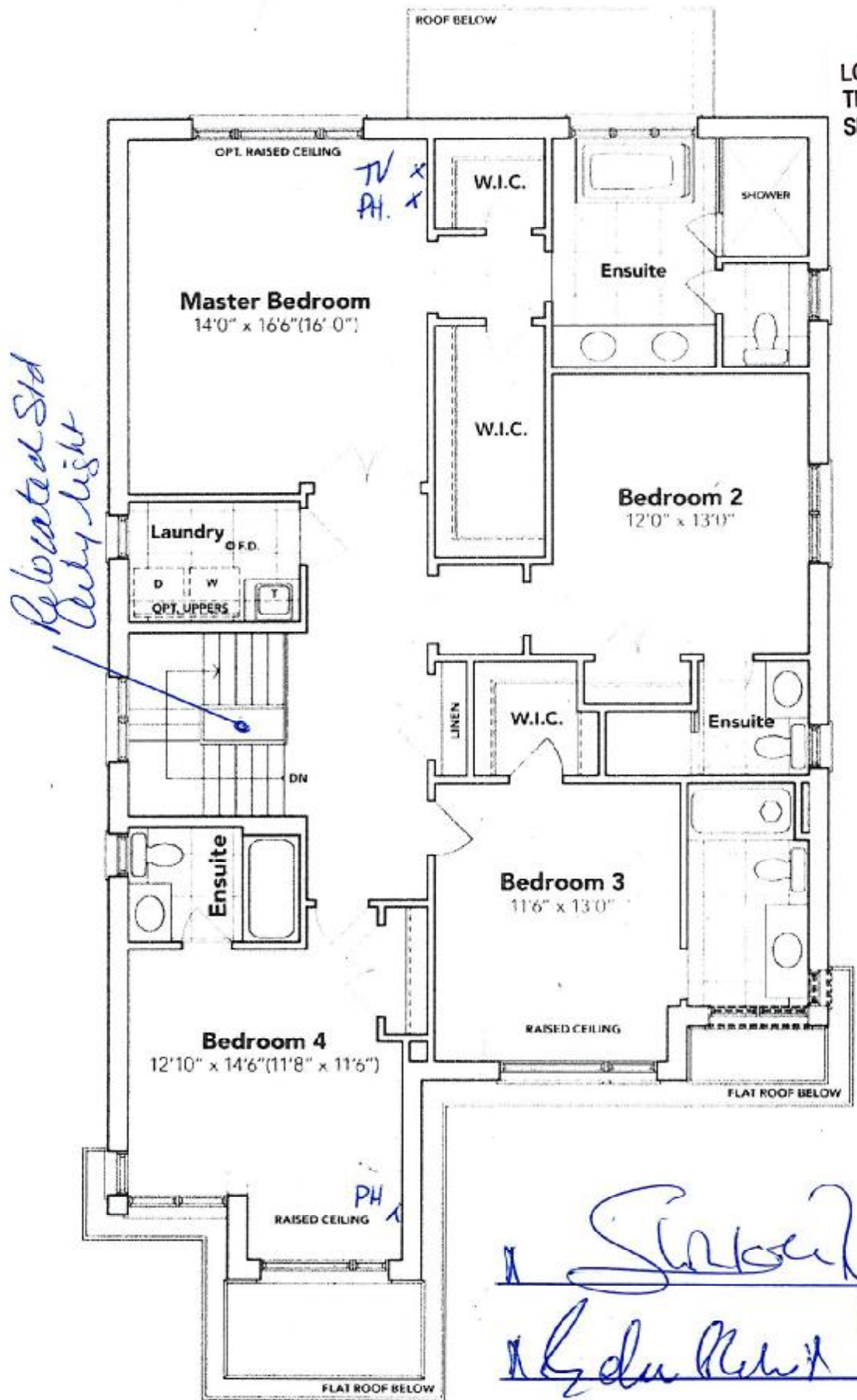

### SECOND FLOOR EL. C

The floor plans and elevations shown are pre-construction plans and may be revised or improved as necessitated by architectural controls and the construction process. The measurements adhere to the rules and regulations of the TARION Warranty Corporation's official method for the calculation of floor area. Materials, specifications and floor plans are subject to change without notice. All house renderings are artist's concept only. Actual usable floor space may vary from the stated floor area. All options shown are upgrades. E. & O. E.



**SCHEDULE "B-1"**  
**Floor Plan**

Lot 142  
Phase 5B  
Model: Louis (4203) Elev C 4 Bed - 4+1 Bath  
Standard

**LOT 142**  
**THAMES PH. 5B**  
**SKETCH #3**

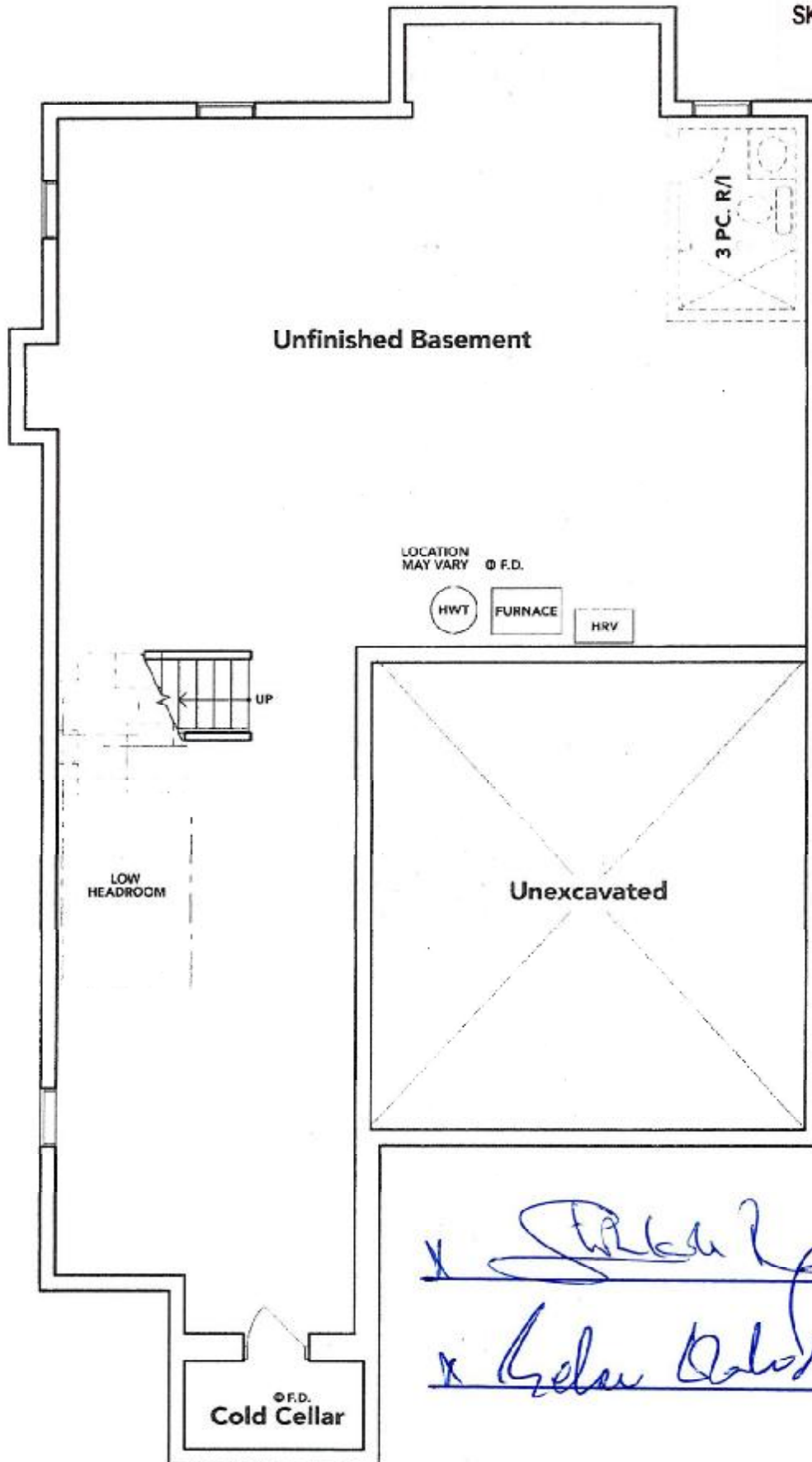

*[Handwritten signature]*  
*[Handwritten signature]*

**BASEMENT EL. C**

The floor plans and elevations shown are pre-construction plans and may be revised or improved as necessitated by architectural controls and the construction process. The measurements adhere to the rules and regulations of the TARION Warranty Corporation's official method for the calculation of floor area. Materials, specifications and floor plans are subject to change without notice. All house renderings are artist's concept only. Actual usable floor space may vary from the stated floor area. All options shown are upgrades. E. & O. E.



Brooke™ | 1

## Brooke™

Categories: Acrylic Freestanding

### DESCRIPTION

68" Freestanding Bath  
SKU #: CF2002

### FEATURES

- Installation friendly two piece design
- Accepts deck mounted faucet
- Includes a chrome integral pop up drain and rectangular overflow
- ~~Brushed nickel drain and overflow covers available~~
- Centre drain
- Includes levelling feet
- Available in White Only



### DIMENSIONS

68" x 36" x 23"

A handwritten signature in blue ink, appearing to read 'S. Smith', written over a horizontal line.

A handwritten signature in blue ink, appearing to read 'Helen Smith', written over a horizontal line.

## Frigidaire Gallery



### Gas Cooktop

### 36" Gas Cooktop

GCCG3648AS, GCCG3648AB

Available Colors : Stainless Steel, Black

Version : 05/22

#### Cooktop

Cooking Surface Type	Gas
Grate Material	Cast Iron
Grate Quantity	3
Grate Style	Continuous

#### Cooktop Performance

Right Front Element Burner	12,000 BTU
Right Rear Element Burner	5,000 BTU
Left Front Element Burner	9,500 BTU
Left Rear Element Burner	9,500 BTU
Center Front Element Burner	18,000 BTU

#### Display

Control Location	Front
------------------	-------

#### Exterior

Backlit Knobs	Yes
---------------	-----

#### Dimensions and Volume

Height	2 7/16"
Width	36"
Depth	21"
Cutout Height	7 1/2"
Minimum Cutout Width	33 7/8"
Minimum Cutout Depth	19"
Maximum Cutout Width	35 5/8"
Maximum Cutout Depth	20"

#### Electrical Specifications

Minimum Circuit Required	5 Amps
Voltage Rating	120 V

#### Installation

Gas Supply Connection Location	Top Right
Installed Over a Wall Oven	Yes

LP Conversion Kit Included	Yes
Power Cord Included	Yes
Power Supply Connection Location	Right Center

#### General Specifications

Prop 65 Label	Yes
Warranty - Labor	1 Year
Warranty - Parts	1 Year
Frigidaire Fit Promise	Yes

#### Certifications and Approvals

ADA Compliant	Yes
---------------	-----

#### Safety Certifications and Approvals

CSA Listed	Yes
UL Listed	Yes

*[Handwritten signatures]*



LOT 142 THAMES PH. 5B  
RE: 36" GAS COOKTOP SPEC'S

## Frigitaire Gallery

36" Gas Cooktop

GCCG3648AS, GCCG3648AB

Version : 05/22

✓ Shubal P

Richard Lloyd

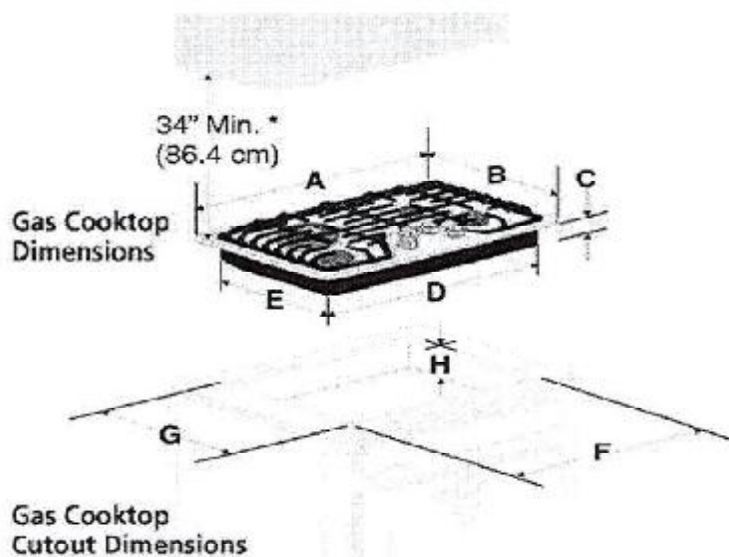

Figure 1

PRODUCT DIMENSIONS					
MODEL	A. WIDTH	B. DEPTH	C. HEIGHT	D. BOX WIDTH	E. BOX DEPTH
36" Gas Cooktop	36" (91.4 cm)	21" (53.3 cm)	2 7/16" (6.2 cm)	33 5/8" (85.4 cm)	18 7/8" (47.9 cm)

MODEL	CUTOUT DIMENSIONS		G. DEPTH		H. HEIGHT BELOW COOKTOP
	F. WIDTH MINIMUM	F. WIDTH MAXIMUM	MINIMUM	MAXIMUM	
36" Gas Cooktop	33 7/8" (86.0 cm)	35 5/8" (90.3 cm)	19" (48.3 cm)	20" (50.8 cm)	7.5" (19.0 cm)

LOT 142 THAMES PH. 5B  
RE: BUILT IN MICRO & OVEN SPEC'S  
NO FLUSH MOUNT INSTALLATION

*Swickard* *Helean Selod*

## Frigidaire Gallery



### Microwave Combination Wall Oven

30" Wall Oven and Microwave Combination

GCWM3067AF, GCWM3067AD

Available Colors : Stainless Steel, Black Stainless Steel

Version : 12/21

#### Cooking Controls

Air Fry	Yes
Air Sous Vide	Yes
Bake	Yes
Bake Time	Yes
Bread Proof	Yes
Broil	Yes
Cancel	Yes
Child Lock	Yes
Clear Off	Yes
Clock	Yes
Convection Bake	Yes
Convection Roast	Yes
Cook Time	Yes
Dehydrate	Yes
Delay Clean	Yes
Delay Start	Yes
Fast Preheat	Yes
Keep Warm	Yes
Kitchen Timer	Yes
Light	Yes
My Favorite	Yes
Off	Yes
Oven Light	Yes
Perfect Turkey	Yes
Preheat	Yes
Probe	Yes
Self Clean	Yes
Set Clock	Yes
Slow Cook	Yes
Start	Yes
Start Time	Yes
Steam Bake	Yes
Steam Clean	Yes
Steam Roast	Yes
Stop	Yes

Temperature Display	Yes
Timed Bake	Yes
Timer On / Off	Yes
User Preferences	Yes

#### Cooking Controls Function

Change between Continuous Bake Setting or 12-Hour Energy Saving Feature	Yes
Delayed Bake	Yes
Program Fahrenheit or Celsius	Yes
Silent Control Panel	Yes
Timed Cooking	Yes

#### Oven

Bake Element	2,600 Watts
Bake Element Pass	4
Bake Element Type	Hidden
Broil Element	4,000 Watts
Broil Element Pass	6
Broil System	Yes
Cleaning System	Yes
Convection	Yes
Convection Element	3,800 Watts
Convection Type	Total
Number of Convection Fans	1
Number of Rack Positions	6
Oven Interior Color	Midnight Black
Oven Light Quantity	2
Oven Light Type	Halogen
Oven Light Watts	40 Watts
Rack Position Type	Embossed
Rack Type 1	Handle
Rack Type 1 Quantity	2
Rack Type 2	Glide
Rack Type 2 Quantity	1

#### Microwave Cooking

NOTE: For handling microwave, only always use the microwave controls and not the oven controls.

Refer to product installation guide for detailed installation instructions and safety. [frigidaire.com](http://frigidaire.com) [frigidaire.ca](http://frigidaire.ca)

Specifications subject to change without notice. [frigidaire.com](http://frigidaire.com) [frigidaire.ca](http://frigidaire.ca)

USA © 2021 Frigidaire, a Whirlpool Corporation. NC 26753-0001-0001-0001 [frigidaire.com](http://frigidaire.com)



Shubh

Mela Sahel

Frigidaire Gallery

GCWM3067AF, GCWM3067AD

Version : 12/21

Microwave Interior Depth	.16 1/8"
Minimum Cutout Height	41 1/4"
Minimum Cutout Width	28 1/2"
Maximum Cutout Height	42"
Maximum Cutout Width	28 3/4"
Microwave Capacity	1.7 Cu. Ft.
Oven Capacity	5.3 Cu. Ft.

Electrical Specifications	
Connected Load @ 240V	7.6 kW
Voltage Rating	240 V

Installation	
Power Supply Connection Location	Top Left

General Specifications	
Prop 65 Label	Yes
Warranty - Labor	1 Year
Warranty - Parts	1 Year
Frigidaire Fit Promise	Yes

Certifications and Approvals	
Star-K Certification	Yes

Safety Certifications and Approvals	
CSA Listed	Yes
UL Listed	Yes
RcHS	Yes

Verify for accuracy, purchase only. Always check local and national electric and plumbing codes.  
Refer to product literature for full electrical and plumbing instructions on the web at [frigidaire.com](http://frigidaire.com) / [frigidaire.ca](http://frigidaire.ca)  
Specifications subject to change. Accessories and options not available with all units at [frigidaire.com](http://frigidaire.com) / [frigidaire.ca](http://frigidaire.ca)  
USDA - 40208-0000, 2010-01-01, Chapter No. 220, 1-2030-ENR-10AIRE, [frigidaire.com](http://frigidaire.com)



*[Signature]*

*[Signature]*

Frigidaire Gallery

30" Wall Oven and Microwave Combination

GCWM3067AF, GCWM3067AD

Version : 12/21

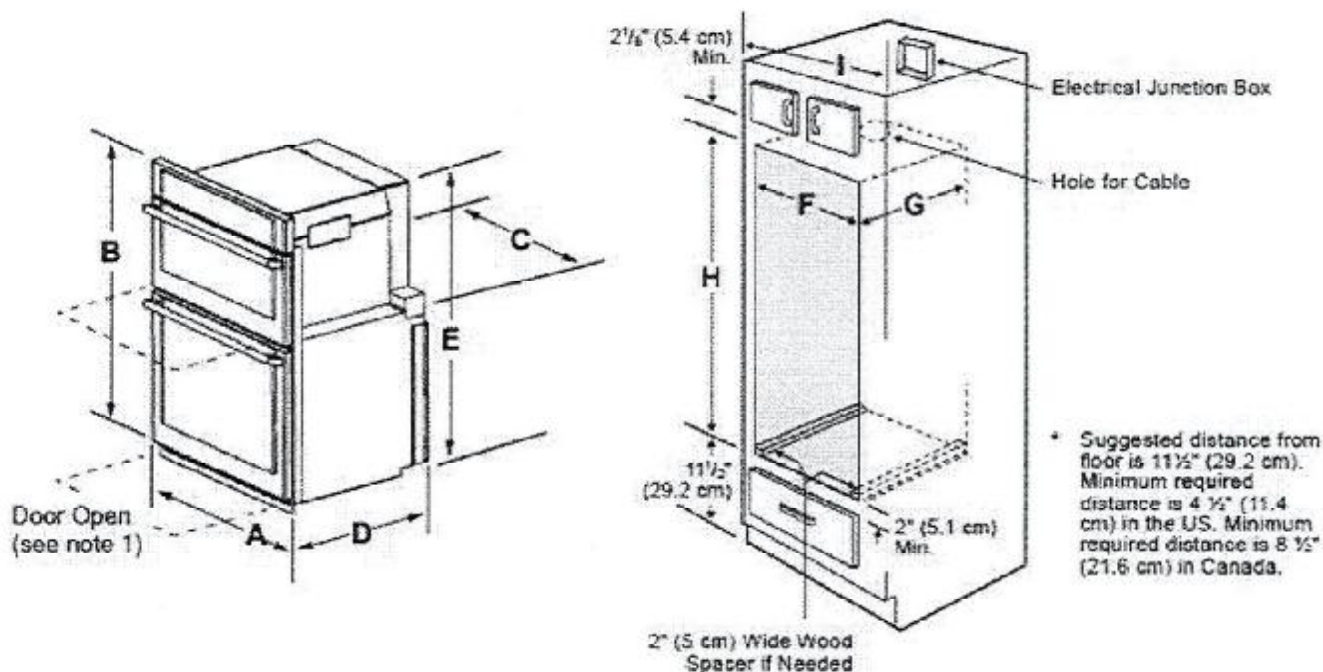

- NOTES:
1. Allow at least 22" (55.9cm) clearance in front of oven for door depth when it is open.
  2. Dimension G (cutout depth) is critical to the proper installation of the built-in oven. If the oven decorative trim does not butt against the cabinet verify dimension G to assure it is the required depth.
  3. For a cutout height greater than the maximum (H), add one 2" (5 cm) wide wood shim of appropriate height to each side of the opening under the appliance side rails. A trim kit may be purchased through a dealer, service, or on the brand website.

Figure 1: Product and Cutout Dimensions

PRODUCT DIMENSIONS					
A	B	C	D		E
29 <sup>7</sup> / <sub>8</sub> " (76.2 cm)	41 <sup>1</sup> / <sub>4</sub> " (105.6 cm)	28 <sup>7</sup> / <sub>8</sub> " (72.2 cm)	25 <sup>1</sup> / <sub>4</sub> " (63.9 cm)		40 <sup>1</sup> / <sub>4</sub> " (102.9 cm)
CUTOUT DIMENSIONS AND CABINET WIDTH					
F		G Min.	H		I
Min.	Max.		Min.	Max.	
28 <sup>1</sup> / <sub>2</sub> " (72.4 cm)	29" (73.7 cm)	23 <sup>1</sup> / <sub>2</sub> " (59.7 cm)	40 <sup>3</sup> / <sub>4</sub> " (103.1 cm)	41 <sup>1</sup> / <sub>2</sub> " (105.4 cm)	30 <sup>1</sup> / <sub>8</sub> " (76.5 cm) Min