

Lindsay 2017 Developments Inc. / Sugarwood

Lot/Unit: 105 Block 96 Phase/Building: 2 Model/Floor Plan: Four Mile Lake(2004)Elev B
3Bed 2.5Bath

CABINETRY APPLIANCE - FRIDGE

Inv.6546	1 - TO SUPPLY AND INSTALL 66CM DEEP FRIDGE ENCLOSURE - COUNTER DEPTH WITH NO WALLS - 2 66CM DEEP GABLES AND 1 66CM DEEP CABINET - THIS IS NOT A ZERO CLEARANCE ENCLOSURE. STANDARD HEIGHTS AND WIDTHS WILL BE USED. - CLASSIC SERIES.. SEE SKETCH #1	
Line 81804	Note:	
24Jan24 / 24Jan24		

CABINETRY VANITY

Inv.6546	1 - INCREASE VANITY TO KITCHEN HEIGHT- 90CM HIGH - MAINTAINS VANITY DEPTH - CLASSIC SERIES IN THE MASTER ENSUITE	
Line 81812	Note:	
24Jan24 / 24Jan24		

ELECTRICAL

Inv.6546	1 - TO SUPPLY AND INSTALL THE STANDARD TV ROUGH-IN, IN THE GREAT ROOM AND MASTER BEDROOM.. SEE SKETCH #1 AND #2	
Line 81797	Note:	
24Jan24 / 24Jan24		
Inv.6546	1 - TO SUPPLY AND INSTALL THE STANDARD PHONE ROUGH-IN, IN THE GREAT ROOM, BEDROOM #3 AND MASTER BEDROOM.. SEE SKETCH #1 AND #2	
Line 81798	Note:	
24Jan24 / 24Jan24		
Inv.6546	1 - TO SUPPLY AND INSTALL A CAPPED ELEC ON A SEP SWITCH OVER THE ISLAND.. SEE SKETCH #1	
Line 81808	Note:	
24Jan24 / 24Jan24		
Inv.6546	1 - TO SUPPLY AND INSTALL A CLOSET LIGHT IN THE LAUNDRY ROOM FIXTURED INCLUDED ON A SEP SWITCH.. SEE SKETCH #2	
Line 81809	Note:	
24Jan24 / 24Jan24		
Inv.6546	1 - SUPPLY AND INSTALL CAT-5 ROUGH IN WIRE PER DROP.. SEE SKETCH #2	
Line 81810	Note:	
24Jan24 / 24Jan24		

HARDWOOD

Inv.6546	2 - TO SUPPLY AND INSTALL 3 1/2" ELEMENTS OAK NATURAL TO THE LANDINGS OF THE STAIRCASE IN LIEU OF THE STANDARD	
Line 81803	Note:	
24Jan24 / 24Jan24		

HVAC

Inv.6546	1 - TO SUPPLY A GASLINE (ROUGH-IN ONLY) TO THE STOVE AREA INCLUDING A 110V CPDE REQUIREMENT	
Line 81806	Note:	
24Jan24 / 24Jan24		

PLUMBING



CONSTRUCTION SUMMARY

Lindsay 2017 Developments Inc. / Sugarwood

Lot/Unit: 105 Block 96 Phase/Building: 2 Model/Floor Plan: Four Mile Lake(2004)Elev B
3Bed 2.5Bath

Inv.6546	1 - WATERLINE ROUGH-IN TO THE FRIDGE LOCATION (NO HOOK UP)	
Line 81805	Note:	
24Jan24 / 24Jan24		

RAILING

Inv.6546	1 - RAILING - UPGRADE 1 – METAL – HANDRAIL – 3INCH OVAL OAK – PICKETS STEEL 1/2INCH SQUARE PLAIN WITH SHOES FLAT BLACK - POSTS 3-1/2INCH SQUARE WITH CAP OAK	
Line 81807	Note:	
24Jan24 / 24Jan24		

EXTRAS AS PER OFFER

KINGSIIEN
GROUP INC.

INTERIOR COLOUR SCHEME

Purchasers: SUROJNIE APPANAH & ARVEDA DEVI TOOLS
Telephone Res. / Bus: / Project: Lindsay 2017 Developments Inc.
Decor Advisor: Samantha Castelli Model and Elevation: Four Mile Lake(2004)Elev B 3Bed 2.5Bath
Layout Changes: ☐ Yes ☒ No Sketch Attached: ☒ Yes ☐ No Exterior Colour Scheme:

1. Cabinetry

	Style and Colour	Counter Top	Hardware
Kitchen / Breakfast	#3 SIMCOE RAIN CLOUD	Paloma Polar 6698-46	12881 HANDLE
Kitchen Island	#3 SIMCOE RAIN CLOUD	Paloma Polar 6698-46	12881 HANDLE
Laundry Room	/	/	/
Powder Room	#3 SIMCOE MOONLIGHT	Paloma Polar 6698-46	135 KNOB
Main Bathroom	#3 SIMCOE RAIN CLOUD	Paloma Polar 6698-46	135 KNOB
Master Ensuite Bathroom	#3 SIMCOE RAIN CLOUD	Paloma Polar 6698-46	135 KNOB
Second Ensuite Bathroom (If Applicable)			

Appliances Custom Size Fridge Valance Lighting Microwave / Range Hood
☐ Yes ☒ No ☐ Yes ☒ No ☐ Yes ☒ No
Cooktop / Rangetop Built in Wall Oven Slide-in Range
☐ Yes ☒ No ☐ Yes ☒ No ☐ Yes ☒ No

Comment

REQ / RECEIVED

24-01-2024

2. Flooring

	Selection
Foyer	13x13" Cinq White
Main Hall	OPENING NIGHT 21
Back Hall	/
Breakfast	13x13" Cinq White
Laundry Room	13x13" Cinq Black
Kitchen	13x13" Cinq White
Powder Room	13x13" Cinq White
Main Bathroom	13x13" Cinq White
Master Ensuite	13x13" Cinq White
Bathroom (If Applicable)	/
Mud Room	13x13" Cinq White
Master Ens Shower Floor	2x2" Inizio Bianco
Living Room	/
Dining Room	/
Family / Great Room	OPENING NIGHT 21
Den / Library / Study	/
Basement Landing (If Applies)	/
Lower Landing (If Applicable)	3 1/2" ELEMENTS OAK NATURAL
Upper Landing	3 1/2" ELEMENTS OAK NATURAL
Upper Hall	OPENING NIGHT 21
Master Bedroom	OPENING NIGHT 21
Bedroom #2	OPENING NIGHT 21
Bedroom #3	OPENING NIGHT 21
Bedroom #4	/
Bedroom #5	/
Master Ens Shower Jam	Anatolia Marmiline SNOW

Flooring Continued on Page 2

Initial:

ADT SA

Lindsay PH.2 lot 105

KINGSIIEN
GROUP INC.

INTERIOR COLOUR SCHEME

Purchasers: SUROJNIE APPANAH & ARVEDA DEVI TOOLS**Property:** 105 Block 96 of Plan -
Telephone Res. / Bus: / **Project:** Lindsay 2017 Developments Inc.
Decor Advisor: Samantha Castelli **Model and Elevation:** Four Mile Lake(2004)Elev B 3Bed 2.5Bath

2. Flooring - Continued -

Upgrade Underpad	Type	Area
	STANDARD	MAIN AND SECOND
Carpet on Stairs	Capped	Runner - *Upgrade
Comment		

3. Plumbing Fixtures / Faucets

Kitchen	STANDARD	Second Ensuite		Powder Room	STANDARD
Master Ensuite	STANDARD			Other Room	
Main Bathroom	STANDARD				

Comment
TO SUPPLY AND INSTALL ALL STANDARD PLUMBING FIXTURES.

RECU/RECEIVED

24-01-2024

4. Wall Tile

	Tile Selection	Listello	Insert	Insert Selection
Main Bathroom	8x10" Weave White	<input type="checkbox"/>	<input type="checkbox"/>	
Master Ensuite				
Tub Deck	13x13" Cinq White	<input type="checkbox"/>	<input type="checkbox"/>	
Tub Apron	13x13" Cinq White	<input type="checkbox"/>	<input type="checkbox"/>	
Tub Surround	13x13" Cinq White	<input type="checkbox"/>	<input type="checkbox"/>	
Shower Stall	8x10" Weave White	<input type="checkbox"/>	<input type="checkbox"/>	
Second Ensuite		<input type="checkbox"/>	<input type="checkbox"/>	
		<input type="checkbox"/>	<input type="checkbox"/>	
		<input type="checkbox"/>	<input type="checkbox"/>	
Kitchen Backsplash		<input type="checkbox"/>	<input type="checkbox"/>	
Complete Backsplash		<input type="checkbox"/>	<input type="checkbox"/>	

Comment



horizontal stacked

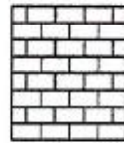

brick pattern



vertical stacked



diagonal/diamond

-5. Fireplace

	Living Room			Family Room			Other Room - Specify		
	Purchased	As Per Plan	N/A	Purchased	As Per Plan	N/A	Purchased	As Per Plan	N/A
Fireplace Type	<input type="radio"/>	<input type="radio"/>	<input type="radio"/>	<input type="radio"/>	<input type="radio"/>	<input type="radio"/>	<input type="radio"/>	<input type="radio"/>	<input type="radio"/>
Mantle Type									
Over Mantle									
Colour / Stain									
Surround									
Hearth									

Comment

Initial:

DS
AD SA

KINGSMEN
GROUP INC.**INTERIOR COLOUR SCHEME**

Purchasers: SUROJNIE APPANAH & ARVEDA DEVI TOOLS **Property:** 105 Block 96 of Plan -
Telephone Res. / Bus: / **Project:** Lindsay 2017 Developments Inc.
Decor Advisor: Samantha Castelli **Model and Elevation:** Four Mile Lake(2004) Elev B 3Bed 2.5Bath

6. Trim Carpentry**Door Hardware** STANDARD HANDLE**Interior Trim** STANDARD**Comment****Interior Doors**☐ 2 Panel Arch Top☒ 2 Panel Square Top☐ 6 Panel DS

Initial for Door Style

ADT
SA**7. Railings and Pickets****Railing Package** UPG #1 METAL PICKETS**Railing Colour** ELEMENTS NATURAL**Picket Colour** BLACK METAL**Wood Stairs** ☐ No ☒ Oak**Tread Colour** ELEMENTS NATURAL**Comment****8. Plaster Mouldings and Medallions****Foyer****Main Hall****Living Room****Dining Room****Family Room****Kitchen/Breakfast****Den/Library****Lower Landing****Comment****9. Wall Paint**

KINGSMEN WHITE

RECU/RECEIVED

24-01-2024

Smooth Ceilings☐ First Floor☐ First Floor incl. Second Floor Hall☐ First and Second Floor☒ Throughout☐ Not Applicable**Trim Paint** KINGSMEN WHITE**10. Additional Comments****11. Disclaimers and Notes**

- Colours of all materials are as close as possible to builder's selection, but not necessarily identical due to variances in manufacturing.
- Any extras listed above are null and void unless accompanied by a separate invoice/amendment. Said invoice must be paid in full.
- The Purchaser acknowledges that after Interior Colour Selection form is signed and dated, no further changes will be permitted other than re-selection due to unavailability. Purchaser's Initials
- The Purchaser acknowledges reading and accepting the "Kingsmen Group Décor Centre Disclaimers" form. This document contains other miscellaneous disclaimers.

This Interior Colour Selection is final and approved by: 1/24/2024

Purchaser Arveda Devi Tools**Signature:** 25C0184315DB478**Date:** 1/24/2024

Surojnie Appanah

Signature: 25C0184315DB478**Date:****Vendor:**

Lindsay 2017 Developments Inc.

SCHEDULE "B-1"
Floor Plan

Townhouse No. 105 Block 96
Phase 2
Model: Four Mile Lake(2004)Elev B 3Bed 2.5Bath
Standard

SKETCH #2

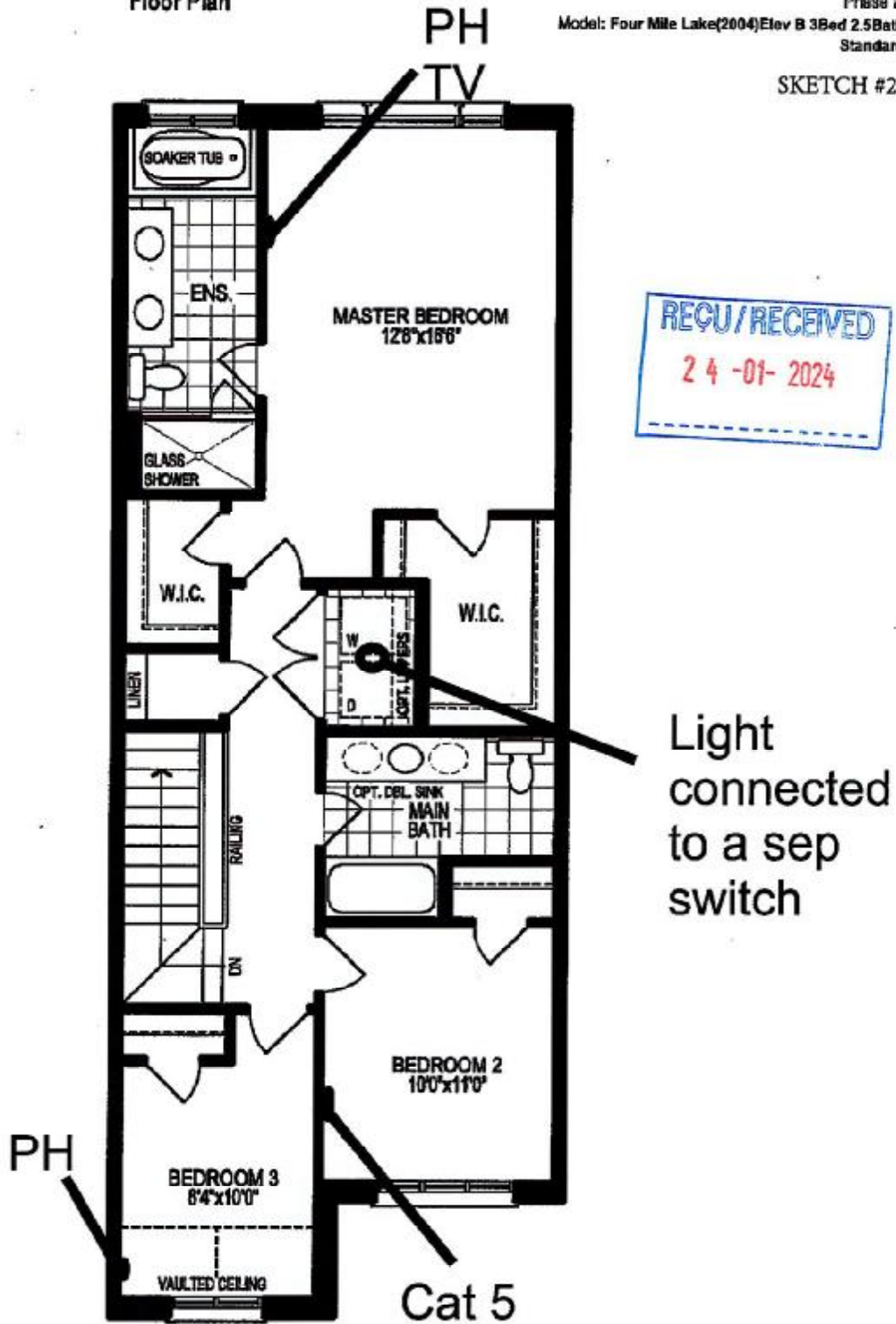

SECOND FLOOR PLAN, ELEV. 'A'

The floor plans and elevations shown are pre-construction plans and may be revised or improved as necessitated by architectural controls and the construction process. The measurements adhere to the rules and regulations of the TARIION Warranty Corporation's official method for the calculation of floor area. Materials, specifications and floor plans are subject to change without notice. All house renderings are artist's concept only. Actual usable floor space may vary from the stated floor area. All options shown are upgrades. E. & O. E.

Lindsey pt 2 lot 125

SCHEDULE "B-1"
Floor Plan

Townhouse No. 105 Block 96
Phase 2
Model: Four Mile Lake(2004) Elev B 3Bed 2.5Bath
Standard

SKETCH #3

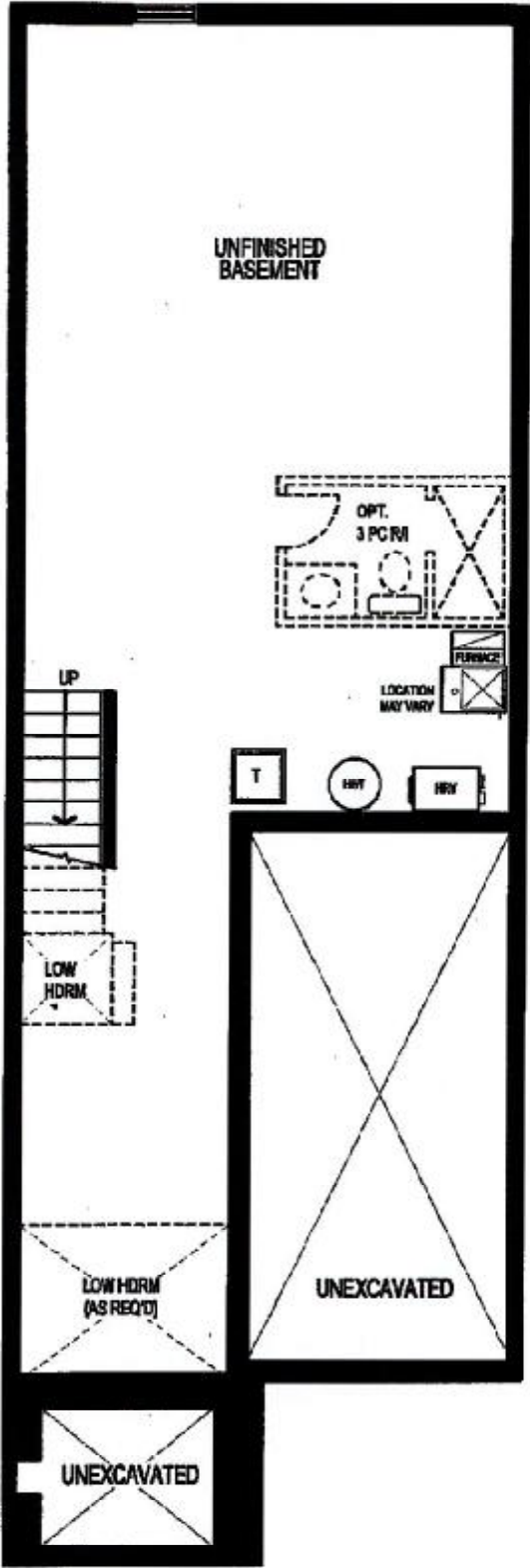

RECU/RECEIVED
24-01-2024

BASEMENT FLOOR PLAN, ELEV. 'A'

The floor plans and elevations shown are pre-construction plans and may be revised or improved as necessitated by architectural controls and the construction process. The measurements adhere to the rules and regulations of the TARION Warranty Corporation's official method for the calculation of floor area. Materials, specifications and floor plans are subject to change without notice. All house renderings are artist's concept only. Actual usable floor space may vary from the stated floor area. All options shown are upgrades. E. & O. E.

Initials: ^{DS} SA ^{DS} AT