

Lindsay 2017 Developments Inc. / Sugarwood

Lot/Unit: 87 Phase/Building: 2 Model/Floor Plan: Buckhorn Lake (3704) Elev A 4Bed
2.5Bath

CABINETRY APPLIANCE - FRIDGE

Inv.6478	1 - TO SUPPLY AND INSTALL 66CM DEEP FRIDGE ENCLOSURE - COUNTER DEPTH WITH - 1 WALL - 1 66CM DEEP GABLE AND 1 66CM DEEP CABINET - THIS IS NOT A ZERO CLEARANCE ENCLOSURE. STANDARD HEIGHTS AND WIDTHS WILL BE USED. - CLASSIC SERIES... SEE SKETCH #1	
Line 81140	Note:	
21Nov23 / 21Nov23		

CABINETRY HARDWARE

Inv.6478	1 - TO SUPPLY AND INSTALL CABINETRY HARDWARE - - Kitchen Hardware UPGRADE 2 IN THE KITCHEN.. SEE COLOUR CHART	
Line 81143	Note:	
21Nov23 / 21Nov23		

ELECTRICAL

Inv.6478	1 - TO SUPPLY AND INSTALL STANDARD TV ROUGH-IN, IN THE GREAT ROOM AND MASTER BEDROOM.. SEE SKETCH #1 AND #2	
Line 81137	Note:	
21Nov23 / 21Nov23		
Inv.6478	1 - TO SUPPLY AND INSTALL STANDARD PHONE ROUGH-IN, IN THE GREAT ROOM, BEDROOM #2 AND MASTER BEDROOM.. SEE SKETCH #1 AND #2	
Line 81138	Note:	
21Nov23 / 21Nov23		

HARDWOOD

Inv.6478	1 - TO SUPPLY AND INSTALL STANDARD KENTWOOD PROGRESSIVES OAK 3 1/2INCH - UPPER HALL IN LIEU OF THE STANDARD CARPET.. SEE COLOUR CHART	
Line 81142	Note:	
21Nov23 / 21Nov23		

PLUMBING

Inv.6478	1 - TO SUPPLY AND INSTALL KITCHEN SINK - BLANCO QUATRUS U SUPER SINGLE 401248 IN LIEU OF THE STANDARD.. SEE SPEC'S	
Line 81139	Note:	
21Nov23 / 21Nov23		

RAILING

Inv.6478	1 - RAILING - UPGRADE 1 – METAL – HANDRAIL – 3INCH OVAL OAK – PICKETS STEEL 1/2INCH SQUARE PLAIN WITH SHOES FLAT BLACK - POSTS 3-1/2INCH SQUARE WITH CAP OAK	
Line 81141	Note:	
21Nov23 / 21Nov23		

EXTRAS AS PER OFFER

Purchaser: HADIA KHAN

Property: 87 of Plan -

Telephone Res. / Bus: /

Project: Lindsay 2017 Developments Inc.

Decor Advisor: Samantha Castelli

Model and Elevation: Buckhorn Lake (3704) Elev A 4Bed 2.5Bath

Layout Changes: ☐ Yes ☒ No

Sketch Attached: ☒ Yes ☐ No

Exterior Colour Scheme:

1. Cabinetry

	Style and Colour	Counter Top	Hardware
Kitchen / Breakfast	#3 Charleston 3DL ORCHID	#1 C/S #9141 ICE SNOW	12817 MB
Kitchen Island	#3 Charleston 3DL ORCHID	#1 C/S #9141 ICE SNOW	12817 MB
Laundry Room	/	/	/
Powder Room	/	/	/
Main Bathroom	#3 Charleston 3DL ORCHID	White Carrara 4924-38	135 KNOB
Master Ensuite Bathroom	#3 Charleston 3DL ORCHID	White Carrara 4924-38	135 KNOB
Second Ensuite Bathroom (If Applicable)	/	/	/
	/	/	/
	/	/	/

Appliances

Custom Size Fridge

☐ Yes ☒ No

Valance Lighting

☐ Yes ☒ No

Microwave / Range Hood

☐ Yes ☒ No

Cooktop / Rangetop

☐ Yes ☒ No

Built in Wall Oven

☐ Yes ☒ No

Slide-in Range

☐ Yes ☒ No

Comment

REC'D / RECEIVED

20-12-2023

2. Flooring

	Selection
Foyer	13x13" Cinq White
Main Hall	3 1/2" ELEMENTS OAK NATURAL
Back Hall	/
Breakfast	13x13" Cinq White
Laundry Room	/
Kitchen	13x13" Cinq White
Powder Room	13x13" Cinq White
Main Bathroom	13x13" Cinq Grey
Master Ensuite	13x13" Cinq Grey
Bathroom (If Applicable)	/
Mud Room	13x13" Cinq White
Master Ens. Shower Floor	2x2" Inizio Bianco
Living Room	/
Dining Room	/
Family / Great Room	3 1/2" ELEMENTS OAK NATURAL
Den / Library / Study	/
Basement Landing (If Applies)	/
Lower Landing (If Applicable)	3 1/2" ELEMENTS OAK NATURAL
Upper Landing	3 1/2" ELEMENTS OAK NATURAL
Upper Hall	3 1/2" ELEMENTS OAK NATURAL
Master Bedroom	Opening Night:04
Bedroom #2	Opening Night:04
Bedroom #3	Opening Night:04
Bedroom #4	Opening Night:04
Bedroom #5	/
Master Ens. shower Jamb	Anatolia Marmiline SNOW

Flooring Continued on Page 2

Initial:

Page 1 of 3

Purchaser: HADIA KHAN

Property: 87 of Plan -

Telephone Res. / Bus: /

Project: Lindsay 2017 Developments Inc.

Decor Advisor: Samantha Castelli

Model and Elevation: Buckhorn Lake (3704) Elev A 4Bed 2.5Bath

2. Flooring - Continued -

Upgrade Underpad

Type

STANDARD

Area

BEDROOMS

Carpet on Stairs

Capped

Runner - *Upgrade

Comment

3. Plumbing Fixtures / Faucets

Kitchen

STANDARD

Second Ensuite

Powder Room

STANDARD

Master Ensuite

STANDARD

Other Room

Main Bathroom

STANDARD

Comment

NOTE: KITCHEN SINK HAS BEEN UPGRADED, STILL TO INSTALL THE STANDARD FAUCET. TO SUPPLY AND INSTALL ALL STANDARD PLUMBING FIXTURES IN ALL BATHROOMS

4. Wall Tile

	Tile Selection	Listello	Insert	Insert Selection
Main Bathroom	8x10" WEAVE WHITE	<input type="checkbox"/>	<input type="checkbox"/>	
Master Ensuite		<input type="checkbox"/>	<input type="checkbox"/>	
Tub Deck		<input type="checkbox"/>	<input type="checkbox"/>	
Tub Apron		<input type="checkbox"/>	<input type="checkbox"/>	
Tub Surround		<input type="checkbox"/>	<input type="checkbox"/>	
Shower Stall	8x10" WEAVE WHITE	<input type="checkbox"/>	<input type="checkbox"/>	
Second Ensuite		<input type="checkbox"/>	<input type="checkbox"/>	
		<input type="checkbox"/>	<input type="checkbox"/>	
Kitchen Backsplash		<input type="checkbox"/>	<input type="checkbox"/>	
Complete Backsplash		<input type="checkbox"/>	<input type="checkbox"/>	

Comment

RECU/RECEIVED
20-12-2023

horizontal stacked

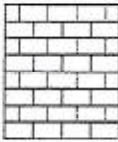
brick pattern

vertical stacked

diagonal/diamond

5. Fireplace

	Living Room			Family Room			Other Room - Specify GREAT ROOM		
	Purchased	As Per Plan	N/A	Purchased	As Per Plan	N/A	Purchased	As Per Plan	N/A
Fireplace Type	<input type="radio"/>	<input type="radio"/>	<input type="radio"/>	<input type="radio"/>	<input type="radio"/>	<input type="radio"/>	<input type="radio"/>	<input checked="" type="radio"/>	<input type="radio"/>
Mantle Type							FRONT FACING		
Over Mantle							NF-08		
Colour / Stain							WHITE		
Surround									
Hearth									
Comment									

Initial: _____

Page 2 of 3

Purchaser: HADIA KHAN

Property: 87 of Plan -

Telephone Res. / Bus: /

Project: Lindsay 2017 Developments Inc.

Decor Advisor: Samantha Castelli

Model and Elevation: Buckhorn Lake (3704) Elev A 4Bed 2.5Bath

6. Trim Carpentry

Door Hardware STANDARD HANDLE

Interior Trim STANDARD

Comment

Interior Doors

☐ 2 Panel Arch Top

☒ 2 Panel Square Top

☐ 6 Panel



Initial for Door Style _____

7. Railings and Pickets

Railing Package UPG #1 METAL PACKAGE

Railing Colour ELEMENTS NATURAL

Wood Stairs ☐ No ☒ Oak

Picket Colour BLACK METAL

Tread Colour ELEMENTS NATURAL

Comment

8. Plaster Mouldings and Medallions

Foyer

Main Hall

Living Room

Dining Room

Family Room

Kitchen/Breakfast

Den/Library

Lower Landing

Comment

9. Wall Paint

KINGSMEN WHITE

Smooth Ceilings ☐ First Floor

☐ First Floor incl. Second Floor Hall

☐ First and Second Floor

☒ Throughout

☐ Not Applicable

Trim Paint KINGSMEN WHITE

10. Additional Comments

RECEIVED

20-12-2023

11. Disclaimers and Notes

- Colours of all materials are as close as possible to builder's selection, but not necessarily identical due to variances in manufacturing.
- Any extras listed above are null and void unless accompanied by a separate invoice/amendment. Said invoice must be paid in full.
- The Purchaser acknowledges that after Interior Colour Selection form is signed and dated, no further changes will be permitted other than re-selection due to unavailability. _____ Purchaser's Initials
- The Purchaser acknowledges reading and accepting the "Kingsmen Group Décor Centre Disclaimers" form. This document contains other miscellaneous disclaimers.

This Interior Colour Selection is final and approved by:

Purchaser:

Signature: _____ Date: _____

Vendor: _____

Lindsay 2017 Developments Inc.

Decor/13

SCHEDULE "B-1"
Floor Plan

Model: Buckhorn Lake (3704) Elev A 4Bed 2.5Bath
Standard

Lindsay PH.2 Lot 87

Lot 87
Phase 2
Standard

SKETCH #1

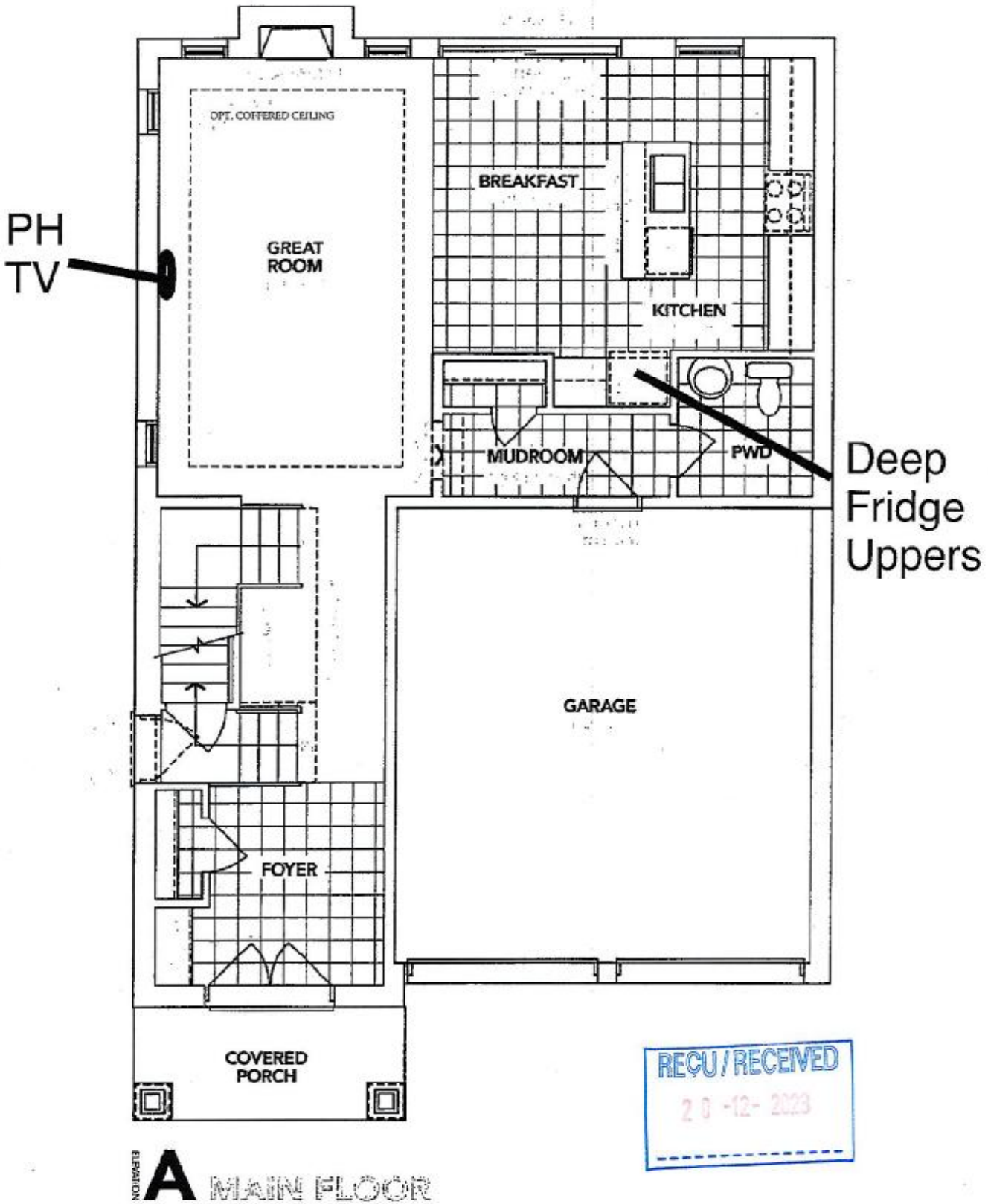

The floor plans and elevations shown are pre-construction plans and may be revised or improved as necessitated by architectural controls and the construction process. The measurements adhere to the rules and regulations of the TARJON Warranty Corporation's official method for the calculation of floor area. Materials, specifications and floor plans are subject to change without notice. All house renderings are artist's concept only. Actual usable floor space may vary from the stated floor area. All options shown are upgrades. E. & O. E.

SCHEDULE "B-1" - Page 1 of 3

SCHEDULE "B-1"
Floor Plan

Lot 87
Phase 2
Model: Buckhorn Lake (3704) Elev A 4Bed 2.5Bath
Standard

Lindsay PH.2 Lot 87

SKETCH #2

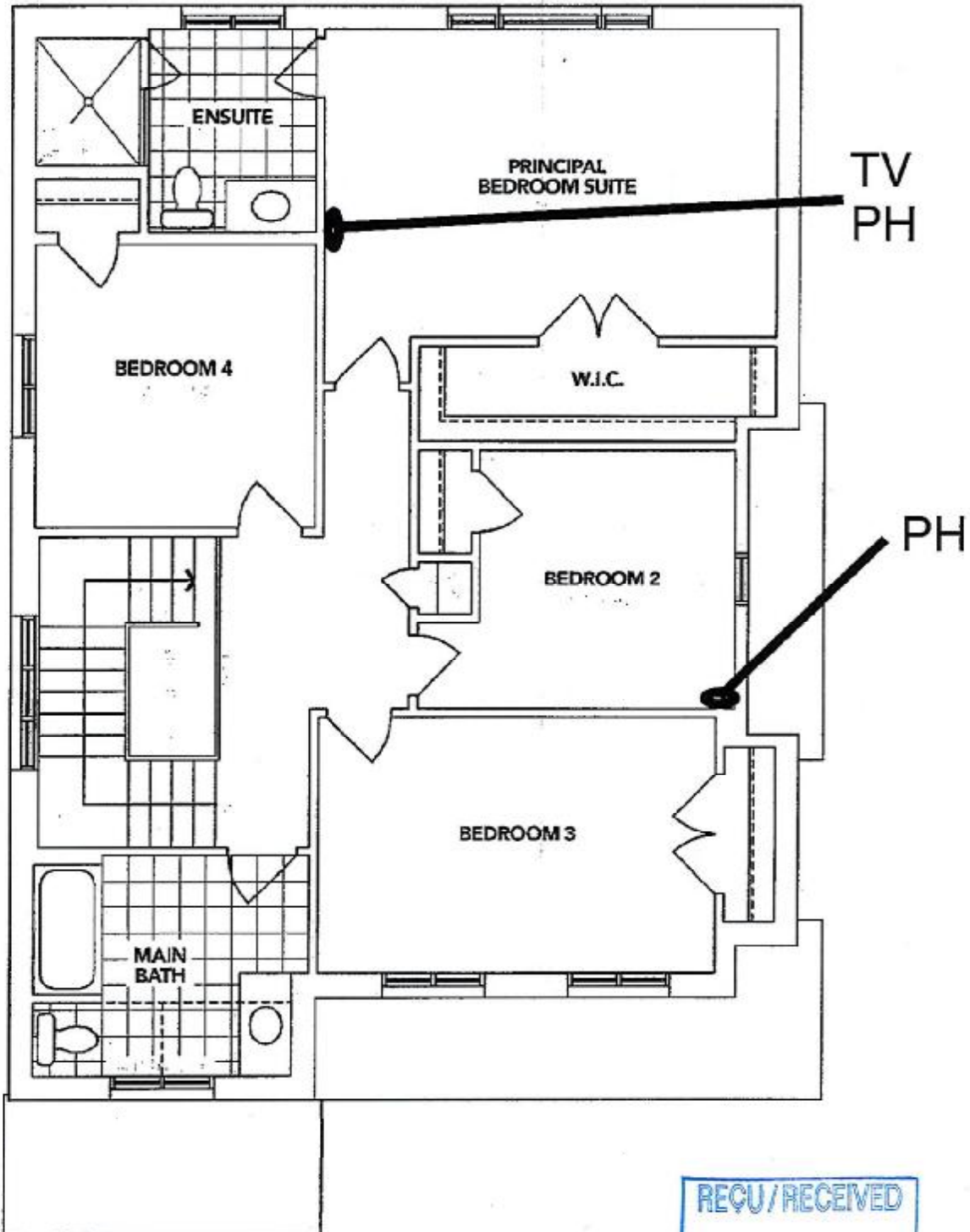

A SECOND FLOOR



The floor plans and elevations shown are pre-construction plans and may be revised or improved as necessitated by architectural controls and the construction process. The measurements adhere to the rules and regulations of the TARION Warranty Corporation's official method for the calculation of floor area. Materials, specifications and floor plans are subject to change without notice. All house renderings are artist's concept only. Actual usable floor space may vary from the stated floor area. All options shown are upgrades. E. & O. E.

Lindsay pr. 2 Lot 87

SCHEDULE "B-1"
Floor Plan

Lot 87
Phase 2
Model: Buckhorn Lake (3704) Elev A 4Bed 2.5Bath
Standard

SKETCH #3

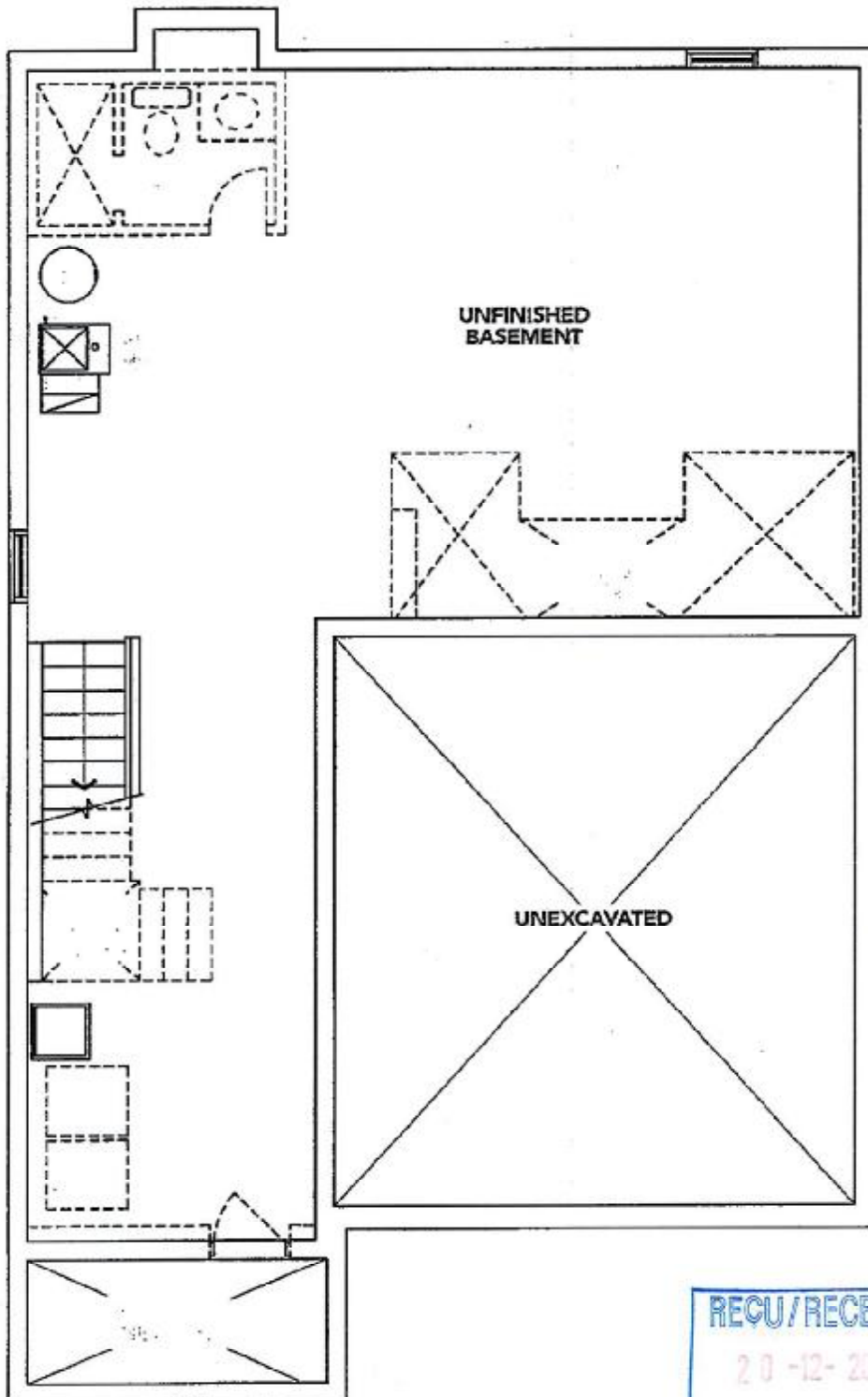

ELEVATION
A
BASEMENT

The floor plans and elevations shown are pre-construction plans and may be revised or improved as necessitated by architectural controls and the construction process. The measurements adhere to the rules and regulations of the TARIION Warranty Corporation's official method for the calculation of floor area. Materials, specifications and floor plans are subject to change without notice. All house renderings are artist's concept only. Actual usable floor space may vary from the stated floor area. All options shown are upgrades. E. & O. E.

BLANCO

Sink Specifications

Colour SKU
satin polish 401248

Design and planning tips

- Min cabinet size: 36 in (915 mm)

Specifications:

3 ½" stainless steel strainer(s), Installation Instructions, Cut-out template, Undermount clips, Limited Lifetime Warranty

Codes & Standards

ASME A112.19.3-2017/CSA B45.4-17

Optional Accessories

Sink Grid 235968
CapFlow Strainer Cover 517666
Ash Cutting Board 406345

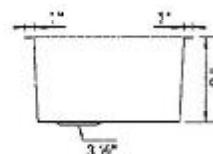
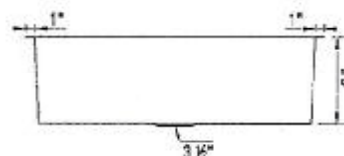
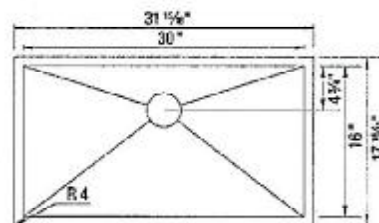

Warranty

Limited lifetime warranty on all sinks and faucets. One-year warranty on all accessories and soap dispensers.

Code/Standards Compliance

BLANCO sinks and faucets are third-party tested and certified to CSA, cUPC, ANSI/ASME, IAPMO and NSF standards and listed by applicable certification bodies. For more information on individual product listings, contact our office or listing organization.



Need support? Learn more by watching our sink & faucet How-to videos:
<https://www.blanco.com/ca-en/support/how-to-videos/how-to-videos-for-sinks/>



BLANCO Canada Inc
100 Corporation Drive
Brampton ON L6S 6B5

Tel & Fax
Tel: 905-494-2400 Toll free: 1-877-425-2626
Fax: 905-494-2425 Toll free: 1-877-825-2626

While BLANCO strives to provide accurate information, all images and dimensions in this document are intended for reference only and are subject to change at any time without notice. This document is not intended for use as an installation guide. For technical installation details, refer to installation instructions provided with the product. BLANCO assumes no responsibility for the use of superseded or voided specifications.