

Lindsay 2017 Developments Inc. / Sugarwood

Lot/Unit: 73 Phase/Building: 2 Model/Floor Plan: Buckhorn Lake (3704) Elev A 4Bed
2.5Bath

CABINETRY APPLIANCE - FRIDGE

Inv.6480	1 - TO SUPPLY AND INSTALL 66CM DEEP FRIDGE ENCLOSURE - COUNTER DEPTH WITH - 1 WALL - 1 66CM DEEP GABLE AND 1 66CM DEEP CABINET - THIS IS NOT A ZERO CLEARANCE ENCLOSURE. STANDARD HEIGHTS AND WIDTHS WILL BE USED. - CLASSIC SERIES.. SEE SKETCH #1	
Line 81192	Note:	
21Nov23 / 22Nov23		

CABINETRY VANITY

Inv.6480	1 - TO SUPPLY AND INSTALL VANITY LOWER DRAWER CLASSIC SERIES IN THE MASTER ENS.. SEE COLOUR CHART FOR DETAILS	
Line 81197	Note:	
21Nov23 / 22Nov23		
Inv.6480	1 - TO SUPPLY AND INSTALL VANITY LOWER DRAWER - CLASSIC SERIES IN THE MAIN BATHROOM.. SEE SKETCH #2	
Line 81198	Note:	
21Nov23 / 22Nov23		

ELECTRICAL

Inv.6480	1 - TO SUPPLY AND INSTALL A CAPPED ELEC. ON A SEP. SWITCH OVER THE BREAKFAST BAR.. SEE SKETCH #1	
Line 81196	Note:	
21Nov23 / 22Nov23		
Inv.6480	1 - TO SUPPLY AND INSTALL THE STANDARD TV ROUGH-IN, IN THE GREAT ROOM AND MASTER BEDROOM.. SEE SKETCH #1 AND #2	
Line 81146	Note:	
21Nov23 / 22Nov23		
Inv.6480	1 - TO SUPPLY AND INSTALL THE STANDARD PHONE ROUGH-IN, IN THE GREAT ROOM, BEDROOM #3 AND MASTER BEDROOM.. SEE SKETCH #1 AND #2	
Line 81147	Note:	
21Nov23 / 22Nov23		

HARDWOOD

Inv.6480	1 - TO SUPPLY AND INSTALL STANDARD KENTWOOD PROGRESSIVES OAK 3 1/2INCH - UPPER HALL IN LIEU OF CARPET	
Line 81195	Note:	
21Nov23 / 22Nov23		

PLUMBING

Inv.6480	1 - TO SUPPLY AND INSTALL KITCHEN SINK - BLANCO QUATRUS SUPER SINGLE-MODEL 401248 IN LIEU OF THE STANDARD.. SEE SPEC'S	
Line 81193	Note:	
21Nov23 / 22Nov23		

RAILING



CONSTRUCTION SUMMARY

Lindsay 2017 Developments Inc. / Sugarwood

Lot/Unit: 73 Phase/Building: 2 Model/Floor Plan: Buckhorn Lake (3704) Elev A 4Bed
2.5Bath

Inv. 6480	1 - RAILING - UPGRADE 1 – METAL – HANDRAIL – 3INCH OVAL OAK – PICKETS STEEL 1/2INCH SQUARE PLAIN WITH SHOES FLAT BLACK - POSTS 3-1/2INCH SQUARE WITH CAP OAK	
Line 81194	Note:	
21Nov23 / 22Nov23		

EXTRAS AS PER OFFER



INTERIOR COLOUR SCHEME

Lindsay ph. 2 lot 73

Purchasers: NEIL D GREEN & IVONA GREEN // MICHELLE IProperty: 73 of Plan -
Telephone Res. / Bus: / Project: Lindsay 2017 Developments Inc.
Decor Advisor: Samantha Castelli Model and Elevation: Buckhorn Lake (3704) Elev A 4Bed 2.5Batt
Layout Changes: ☐ Yes ☒ No Sketch Attached: ☒ Yes ☐ No Exterior Colour Scheme: ..

1. Cabinetry	Style and Colour	Counter Top	Hardware
Kitchen / Breakfast	#3 Simcoe Orchid	#1 C/S #9141 ICE SNOW	12881 HANDLE
Kitchen Island	#3 Simcoe Orchid	#1 C/S #9141 ICE SNOW	12881 HANDLE
Laundry Room	/	/	/
Powder Room	/	/	/
Main Bathroom	#3 Simcoe Orchid	Paloma Polar 6698-46	12881 HANDLE
Master Ensuite Bathroom	#3 Simcoe Orchid	Paloma Polar 6698-46	12881 HANDLE
Second Ensuite Bathroom (If Applicable)			

Appliances	Custom Size Fridge <input type="radio"/> Yes <input checked="" type="radio"/> No	Valance Lighting <input type="radio"/> Yes <input checked="" type="radio"/> No	Microwave / Range Hood <input type="radio"/> Yes <input checked="" type="radio"/> No
Comment	Cooktop / Rangetop <input type="radio"/> Yes <input checked="" type="radio"/> No	Built in Wall Oven <input type="radio"/> Yes <input checked="" type="radio"/> No	Slide-in Range <input type="radio"/> Yes <input checked="" type="radio"/> No

2. Flooring

	Selection
Foyer	13x13" Keaton Ice
Main Hall	3 1/2" ELEMENTS OAK NATURAL
Back Hall	/
Breakfast	13x13" Keaton Ice
Laundry Room	/
Kitchen	13x13" Keaton Ice
Powder Room	13x13" Keaton Ice
Main Bathroom	13x13" Keaton Ice
Master Ensuite	13x13" Keaton Ice
Bathroom (If Applicable)	/
Mud Room	13x13" Keaton Ice
Master Ens. shower Floor	2x2" Inizio Bianco
Living Room	/
Dining Room	/
Family / Great Room	3 1/2" ELEMENTS OAK NATURAL
Den / Library / Study	/
Basement Landing (If Applies)	
Lower Landing (If Applicable)	3 1/2" ELEMENTS OAK NATURAL
Upper Landing	3 1/2" ELEMENTS OAK NATURAL
Upper Hall	3 1/2" ELEMENTS OAK NATURAL
Master Bedroom	OPENING NIGHT:21
Bedroom #2	OPENING NIGHT:21
Bedroom #3	OPENING NIGHT:21
Bedroom #4	OPENING NIGHT:21
Bedroom #5	/
Master Ens. Shower Jamb	Anatolia Marmiline SNOW



Flooring Continued on Page 2

Initial:

KINGSIIEN
GROUP INC.**INTERIOR COLOUR SCHEME**

Lindsay PH.2 Lot T3

Purchasers: NEIL D GREEN & IVONA GREEN // MICHELLE IProperty: 73 of Plan -**Telephone Res. / Bus:** /**Project:** Lindsay 2017 Developments Inc.**Decor Advisor:** Samantha Castelli**Model and Elevation:** Buckhorn Lake (3704) Elev A 4Bed 2.5Bath**4. Flooring - Continued -**

Upgrade Underpad	Type STANDARD	Area ALL BEDROOMS
Carpet on Stairs	Capped	Runner - *Upgrade
Comment		

3. Plumbing Fixtures / Faucets

Kitchen	STANDARD	Second Ensuite	Powder Room	STANDARD
Master Ensuite	STANDARD		Other Room	
Main Bathroom	STANDARD			

Comment

KITCHEN SINK HAS BEEN UPGRADED. STILL TO INSTALL THE STANDARD FAUCET. TO SUPPLY AND INSTALL ALL STANDARD PLUMBING FIXTURES IN ALL BATHROOMS.

4. Wall Tile

	Tile Selection	Listello	Insert	Insert Selection
Main Bathroom	8x10" Weave White	<input type="checkbox"/>	<input type="checkbox"/>	
Master Ensuite				
Tub Deck		<input type="checkbox"/>	<input type="checkbox"/>	
Tub Apron		<input type="checkbox"/>	<input type="checkbox"/>	
Tub Surround		<input type="checkbox"/>	<input type="checkbox"/>	
Shower Stall	8x10" Weave White	<input type="checkbox"/>	<input type="checkbox"/>	
Second Ensuite		<input type="checkbox"/>	<input type="checkbox"/>	
		<input type="checkbox"/>	<input type="checkbox"/>	
		<input type="checkbox"/>	<input type="checkbox"/>	
Kitchen Backsplash		<input type="checkbox"/>	<input type="checkbox"/>	
Complete Backsplash		<input type="checkbox"/>	<input type="checkbox"/>	
Comment				

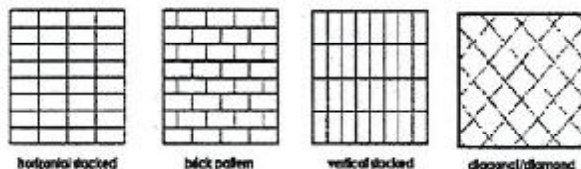
**5. Fireplace**

	Living Room			Family Room			Other Room - Specify GREAT ROOM		
	Purchased	As Per Plan	N/A	Purchased	As Per Plan	N/A	Purchased	As Per Plan	N/A
Fireplace Type	<input type="radio"/>	<input type="radio"/>	<input type="radio"/>	<input type="radio"/>	<input type="radio"/>	<input type="radio"/>	<input type="radio"/>	<input checked="" type="radio"/>	<input type="radio"/>
Mantle Type									
Over Mantle									
Colour / Stain									
Surround									
Hearth									
Comment									

FRONT FACING
NF-08
WHITE

Initial:

Page 2 of 3

Purchasers: NEIL D GREEN & IVONA GREEN // MICHELLE I **Property:** 73 of Plan -
Telephone Res. / Bus: / **Project:** Lindsay 2017 Developments Inc.
Decor Advisor: Samantha Castelli **Model and Elevation:** Buckhorn Lake (3704) Elev A 4Bed 2.5Bath

6. Trim Carpentry

Door Hardware STANDARD HANDLE
Interior Trim STANDARD
Comment

Interior Doors

- ☐ 2 Panel Arch Top
☒ 2 Panel Square Top
☐ 6 Panel

Initial for Door Style

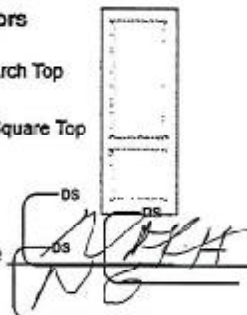

7. Railings and Pickets

Railing Package UPG #1 METAL PACKAGE
Railing Colour ELEMENTS NATURAL
Wood Stairs ☐ No ☒ Oak
Comment

Picket Colour BLACK METAL
Tread Colour ELEMENTS NATURAL

8. Plaster Mouldings and Medallions

Foyer
Main Hall
Living Room
Dining Room
Family Room
Comment

Kitchen/Breakfast
Den/Library
Lower Landing

9. Wall Paint

KINGSMEN WHITE

- Smooth Ceilings** ☐ First Floor
☐ First Floor incl. Second Floor Hall
☐ First and Second Floor
☒ Throughout
☐ Not Applicable

Trim Paint KINGSMEN WHITE

10. Additional Comments



11. Disclaimers and Notes

- Colours of all materials are as close as possible to builder's selection, but not necessarily identical due to variances in manufacturing.
- Any extras listed above are null and void unless accompanied by a separate invoice/amendment. Said invoice must be paid in full.
- The Purchaser acknowledges that after Interior Colour Selection form is signed and dated, no further changes will be permitted other than re-selection due to unavailability. **Purchaser's Initials**
- The Purchaser acknowledges reading and accepting the "Kingsmen Group Décor Centre Disclaimers" form. This document contains other miscellaneous disclaimers.

This Interior Colour Selection is final and approved by:

Purchaser:  **Date:** 11/24/2023
DocuSigned by: AF6F4BC838DB425...

Signature:  **Date:** 12/12/2023
DocuSigned by: F5C5F5C12E9B42D...

Vendor: 
Lindsay 2017 Developments Inc.

Lindsay PH. 2 Lot 73

SCHEDULE "B-1"
Floor Plan

Lot 73
Phase 2
Model: Buckhorn Lake (3704) Elev A 4Bed 2.5Bath
Standard

Capped. Elec on a
Sep switch

SKETCH #1

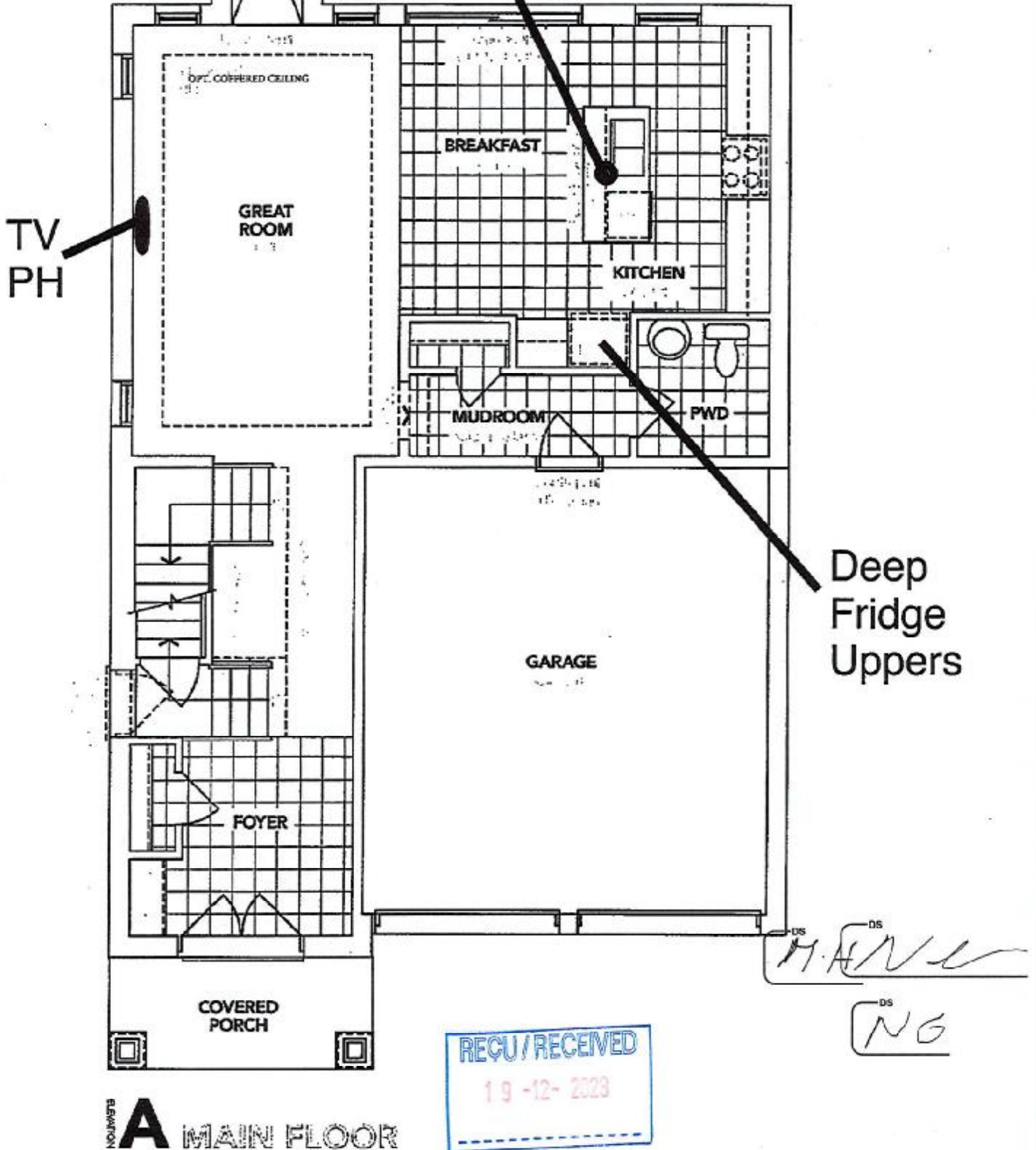

The floor plans and elevations shown are pre-construction plans and may be revised or improved as necessitated by architectural controls and the construction process. The measurements adhere to the rules and regulations of the TARIION Warranty Corporation's official method for the calculation of floor area. Materials, specifications and floor plans are subject to change without notice. All house renderings are artist's concept only. Actual usable floor space may vary from the stated floor area. All options shown are upgrades. E. & O. E.

SCHEDULE "B-1"
Floor Plan

Lot 73
Phase 2
Model: Buckhorn Lake (3704) Elev A 4Bed 2.5Bath
Standard

SKETCH #2

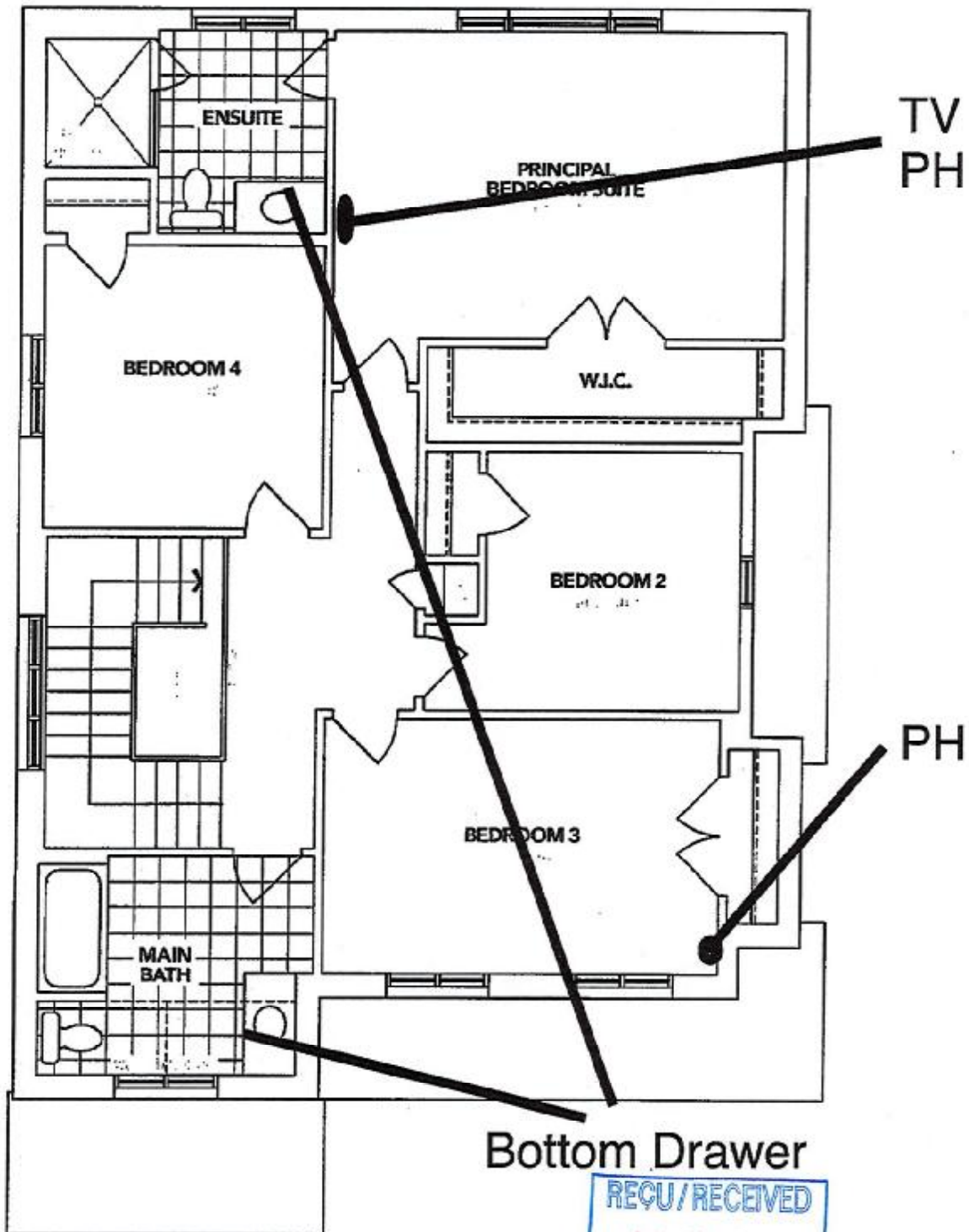

A SECOND FLOOR



The floor plans and elevations shown are pre-construction plans and may be revised or improved as necessitated by architectural controls and the construction process. The measurements adhere to the rules and regulations of the TARION Warranty Corporation's official method for the calculation of floor area. Materials, specifications and floor plans are subject to change without notice. All house renderings are artist's concept only. Actual usable floor space may vary from the stated floor area. All options shown are upgrades. E. & O. E.

DS
NG

DS
M.H.
NG

SCHEDULE "B-1" - Page 2 of 3

Initials: NG J. G. J. M.

Lindsay PH. 2 Lot 73

SCHEDULE "B-1"
Floor Plan

Lot 73
Phase 2
Model: Buckhorn Lake (3704) Elev A 4Bed 2.5Bath
Standard

SKETCH #3

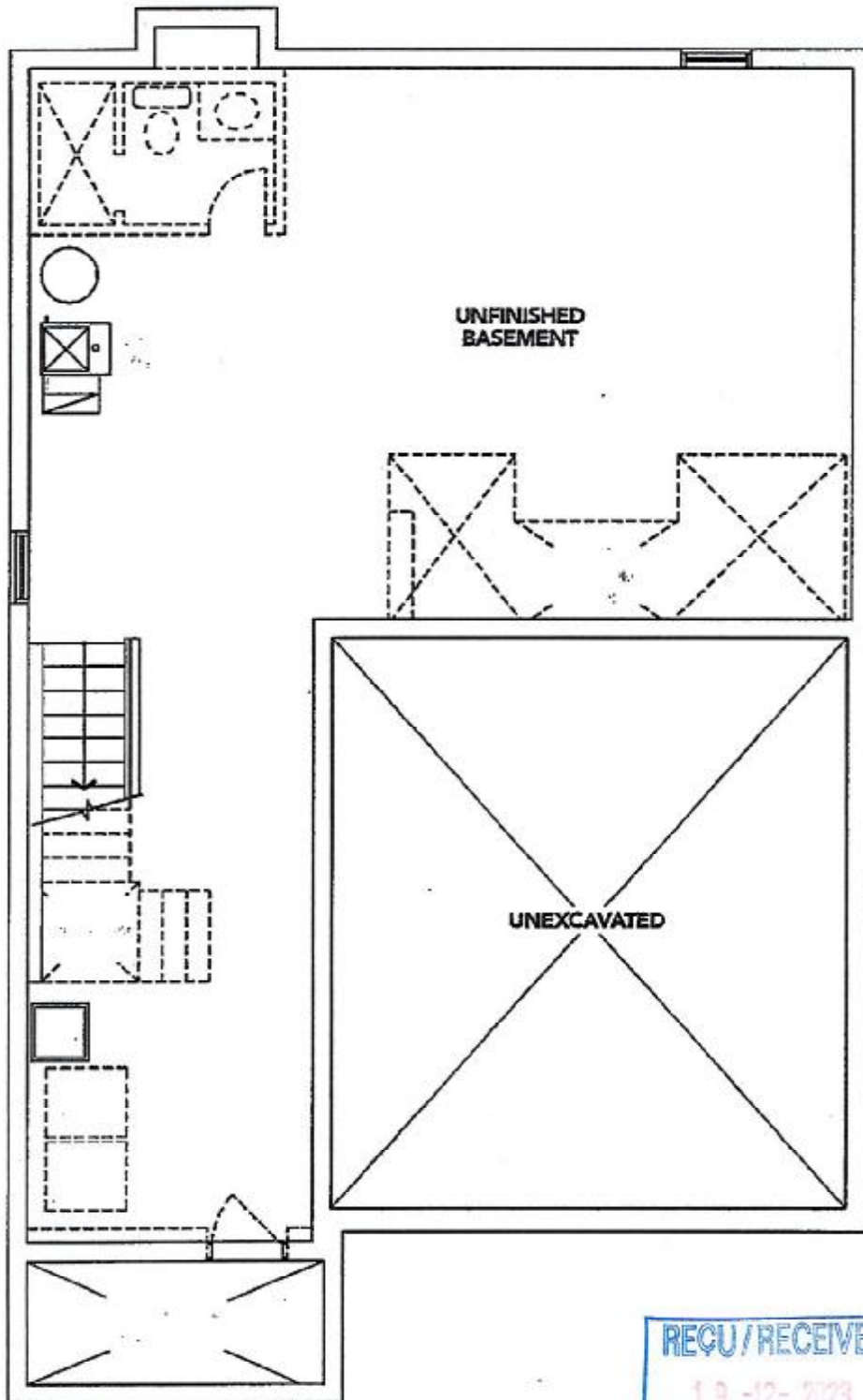

ELEVATION **A** BASEMENT

The floor plans and elevations shown are pre-construction plans and may be revised or improved as necessitated by architectural controls and the construction process. The measurements adhere to the rules and regulations of the TARION Warranty Corporation's official method for the calculation of floor area. Materials, specifications and floor plans are subject to change without notice. All house renderings are artist's concept only. Actual usable floor space may vary from the stated floor area. All options shown are upgrades. E. & O. E.

^{DS}

^{DS}

SCHEDULE "B-1" - Page 3 of 3

BLANCO

Sink Specifications

Colour SKU
satin polish 401248

Design and planning tips

- Min cabinet size: 36 in (915 mm)

Specifications:

3 ½" stainless steel strainer(s), Installation Instructions, Cut-out template, Undermount clips, Limited Lifetime Warranty

Codes & Standards

ASME A112.19.3-2017/CSA B45.4-17

Optional Accessories

Sink Grid 235968
CapFlow Strainer Cover 517666
Ash Cutting Board 406345

Lot 73 PH 2-SUGARWOOD Re: UPG KITCHEN SINK

QUATRUS U 1 Super Single

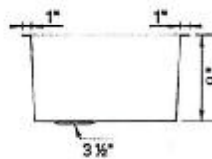
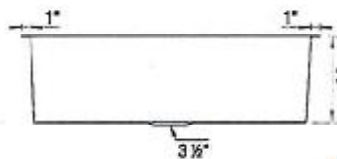
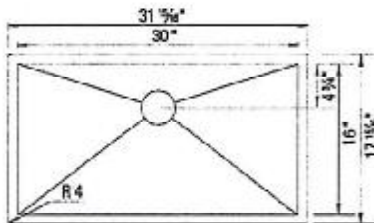

Warranty

Limited lifetime warranty on all sinks and faucets. One-year warranty on all accessories and soap dispensers.

Code/Standards Compliance

BLANCO sinks and faucets are third-party tested and certified to CSA, cUPC, ANSI/ASME, IAPMO and NSF standards and listed by applicable certification bodies. For more information on individual product listings, contact our office or listing organization.



Need support? Learn more by watching our sink & faucet How-to videos:
<https://www.blanco.com/ca-en/support/how-to-videos/how-to-videos-for-sinks/>



BLANCO Canada Inc
100 Corporation Drive
Brampton ON L6S 6B5

Tel & Fax
Tel: 905-494-2400 Toll free: 1-877-425-2626
Fax: 905-494-2425 Toll free: 1-877-825-2626

While BLANCO strives to provide accurate information, all images and dimensions in this document are intended for reference only and are subject to change at any time without notice. This document is not intended for use as an installation guide. For technical installation details, refer to installation instructions provided with the product. BLANCO assumes no responsibility for the use of superseded or voided specifications.

DS
NG DS
DS