



CONSTRUCTION SUMMARY

Lindsay 2017 Developments Inc. / Sugarwood

Lot/Unit: 75 Phase/Building: 2 Model/Floor Plan: Silver Lake (3702) Elev B 3Bed 2.5Bath

DOORS AND WINDOWS

ELECTRICAL

Inv.6484	1 - TO SUPPLY AND INSTALL THE STANDARD TV ROUGH-IN, IN THE GREATROOM AND MASTER BEDROOM.. SEE SKETCH #3 AND #4	
Line 81199	Note:	
22Nov23 / 23Nov23		
Inv.6484	1 - TO SUPPLY AND INSTALL THE STANDARD PHONE ROUGH-IN, IN THE GREATROOM, BEDROOM #3 AND MASTER BEDROOM.. SEE SKETCH #3 AND #4	
Line 81200	Note:	
22Nov23 / 23Nov23		

HARDWOOD

Inv.6484	1 - TO SUPPLY AND INSTALL UPG #1 HARDWOOD IN LIEU OF THE STANDARD TO THE MAIN FLOOR.. SEE COLOUR CHART FOR DETAILS	
Line 81230	Note:	
22Nov23 / 23Nov23		

MISCELLANEOUS

PAINT AND DRYWALL

Inv.6484	1 - TO SUPPLY A STAIN TO THE STAIRCASE IN LIEU OF THE NATURAL.. SEE COLOUR CHART FOR DETAILS	
Line 81229	Note:	
22Nov23 / 23Nov23		

PLUMBING

EXTRAS AS PER OFFER

Purchasers: DHAYAAN IYNKARAN & ARTHISHIA MOHANAT Property: 75 of Plan -
 Telephone Res. / Bus: / Project: Lindsay 2017 Developments Inc.
 Decor Advisor: Samantha Castelli Model and Elevation: Silver Lake (3702) Elev B 3Bed 2.5Bath
 Layout Changes: ☒ Yes ☐ No Sketch Attached: ☒ Yes ☐ No Exterior Colour Scheme:

1. Cabinetry

	Style and Colour	Counter Top	Hardware
Kitchen / Breakfast	#3 Camden Maple Oyster CL	#1 C/S #9141 ICE SNOW	9671 HANDLE
Kitchen Island	#3 Camden Maple Oyster CL	#1 C/S #9141 ICE SNOW	9671 HANDLE
Laundry Room	/	/	/
Powder Room	/	/	/
Main Bathroom	#3 Charleston 3DL Moonlight	Calcutta Marble 4925k-07	9671 HANDLE
Master Ensuite Bathroom	#3 Charleston 3DL Orchid	White Carrara 4924-38	9671 HANDLE
Second Ensuite Bathroom (If Applicable)	/	/	/

Appliances Custom Size Fridge Valance Lighting Microwave / Range Hood
☐ Yes ☒ No ☐ Yes ☒ No ☐ Yes ☒ No
 Cooktop / Rangeset Built in Wall Oven Slide-in Range
☐ Yes ☒ No ☐ Yes ☒ No ☐ Yes ☒ No
 Comment

2. Flooring

	Selection
Foyer	13x13" Malena Ivory
Main Hall	**3 1/2" ELEMENTS OAK WOLFHOUD
Back Hall	/
Breakfast	13x13" Malena Ivory
Laundry Room	/
Kitchen	13x13" Malena Ivory
Powder Room	13x13" Malena Ivory
Main Bathroom	13x13" Malena Ice
Master Ensuite	13x13" Kakfa Bone
Bathroom (If Applicable)	/
Mud Room	/
Master Ens. Shower Floor	2x2" Inizio Bianco
Living Room	/
Dining Room	/
Family / Great Room	**3 1/2" ELEMENTS OAK WOLFHOUD
Den / Library / Study	/
Basement Landing (If Applies)	/
Lower Landing (If Applicable)	**3 1/2" ELEMENTS OAK WOLFHOUD
Upper Landing	**3 1/2" ELEMENTS OAK WOLFHOUD
Upper Hall	OPENING NIGHT: 21
Master Bedroom	OPENING NIGHT: 21
Bedroom #2	OPENING NIGHT: 21
Bedroom #3	OPENING NIGHT: 21
Bedroom #4	/
Bedroom #5	/
Master Ens. Shower Jamb	Anatolia Marmiline SNOW



Flooring Continued on Page 2

Initial:

AB 27

Page 1 of 3

Purchasers: DHAYAAN IYNKARAN & ARTHISHIA MOHANAT Property: 75 of Plan -
 Telephone Res. / Bus: / Project: Lindsay 2017 Developments Inc.
 Decor Advisor: Samantha Castelli Model and Elevation: Silver Lake (3702) Elev B 3Bed 2.5Bath
 2. Flooring - Continued -

Upgrade Underpad	Type	Area
	STANDARD	2ND FLOOR
Carpet on Stairs	Capped	Runner - *Upgrade
Comment		

3. Plumbing Fixtures / Faucets

	STANDARD	Second Ensuite	Powder Room	STANDARD
Kitchen				
Master Ensuite			Other Room	
Main Bathroom				

Comment

SUPPLY AND INSTALL STANDARD TOPMOUNT KITCHEN SINK WITH THE STANDARD FAUCET. TO SUPPLY AND INSTALL ALL STANDARD PLUBING FIXTURES IN ALL BATHROOMS.

4. Wall Tile

	Tile Selection	Listello	Insert	Insert Selection
Main Bathroom	8x10" Weave White	<input type="checkbox"/>	<input type="checkbox"/>	
Master Ensuite		<input type="checkbox"/>	<input type="checkbox"/>	
Tub Deck		<input type="checkbox"/>	<input type="checkbox"/>	
Tub Apron		<input type="checkbox"/>	<input type="checkbox"/>	
Tub Surround		<input type="checkbox"/>	<input type="checkbox"/>	
Shower Stall	8x10" Malena Ivory	<input type="checkbox"/>	<input type="checkbox"/>	
Second Ensuite		<input type="checkbox"/>	<input type="checkbox"/>	
Kitchen Backsplash		<input type="checkbox"/>	<input type="checkbox"/>	
Complete Backsplash		<input type="checkbox"/>	<input type="checkbox"/>	

Comment

REQD/RECEIVED

04-12-2023



horizontal stacked

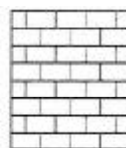

brick pattern



vertical stacked



diagonal/diamond

5. Fireplace

	Living Room			Family Room			Other Room - Specify		
	Purchased	As Per Plan	N/A	Purchased	As Per Plan	N/A	Purchased	As Per Plan	N/A
Fireplace Type	<input type="radio"/>	<input type="radio"/>	<input type="radio"/>	<input type="radio"/>	<input type="radio"/>	<input type="radio"/>	<input type="radio"/>	<input type="radio"/>	<input type="radio"/>

Mantle Type

Over Mantle

Colour / Stain

Surround

Hearth

Comment

Initial:

AS DI

Page 2 of 3

Purchasers: DHAYAAN IYNKARAN & ARTHISHIA MOHANAT Property: 75 of Plan -
 Telephone Res. / Bus: / Project: Lindsay 2017 Developments Inc.
 Decor Advisor: Samantha Castelli Model and Elevation: Silver Lake (3702) Elev B 3Bed 2.5Bath

6. Trim Carpentry

Door Hardware STANDARD HANDLE

Interior Trim STANDARD

Comment

Interior Doors

☐ 2 Panel Arch Top

☒ 2 Panel Square Top

☐ 6 Panel



Initial for Door Style AS DI

7. Railings and Pickets

Railing Package STANDARD TURNED PICKETS

Railing Colour *ELEMENTS WOLFHOUD

Picket Colour *ELEMENTS WOLFHOUD

Wood Stairs ☐ No ☒ Oak

Tread Colour *ELEMENTS WOLFHOUD

Comment

8. Plaster Mouldings and Medallions

Foyer

Main Hall

Living Room

Dining Room

Family Room

Comment

Kitchen/Breakfast

Den/Library

Lower Landing

9. Wall Paint

KINGSMEN WHITE

Smooth Ceilings

☐ First Floor

☐ First Floor incl. Second Floor Hall

☐ First and Second Floor

☒ Throughout

☐ Not Applicable

Trim Paint KINGSMEN WHITE

10. Additional Comments



11. Disclaimers and Notes

- Colours of all materials are as close as possible to builder's selection, but not necessarily identical due to variances in manufacturing.
- Any extras listed above are null and void unless accompanied by a separate invoice/amendment. Said invoice must be paid in full.
- The Purchaser acknowledges that after Interior Colour Selection form is signed and dated, no further changes will be permitted other than re-selection due to unavailability. AS DI Purchaser's Initials
- The Purchaser acknowledges reading and accepting the "Kingsmen Group Décor Centre Disclaimers" form. This document contains other miscellaneous disclaimers.

This Interior Colour Selection is final and approved by:

Purchaser:

Signature: S. Arthishia Date: 23-Nov-2023

Signature: [Signature] Date: 23-Nov-2023 Vendor: [Signature]

Lindsay 2017 Developments Inc.

Dec 5/23

SCHEDULE "B-1"
Floor Plan

Lindsay ph.2 Lot 75
Lot 75
Phase 2
Model: Silver Lake (3702) Elev B 3Bed 2.5Bath
Standard

SKETCH #3

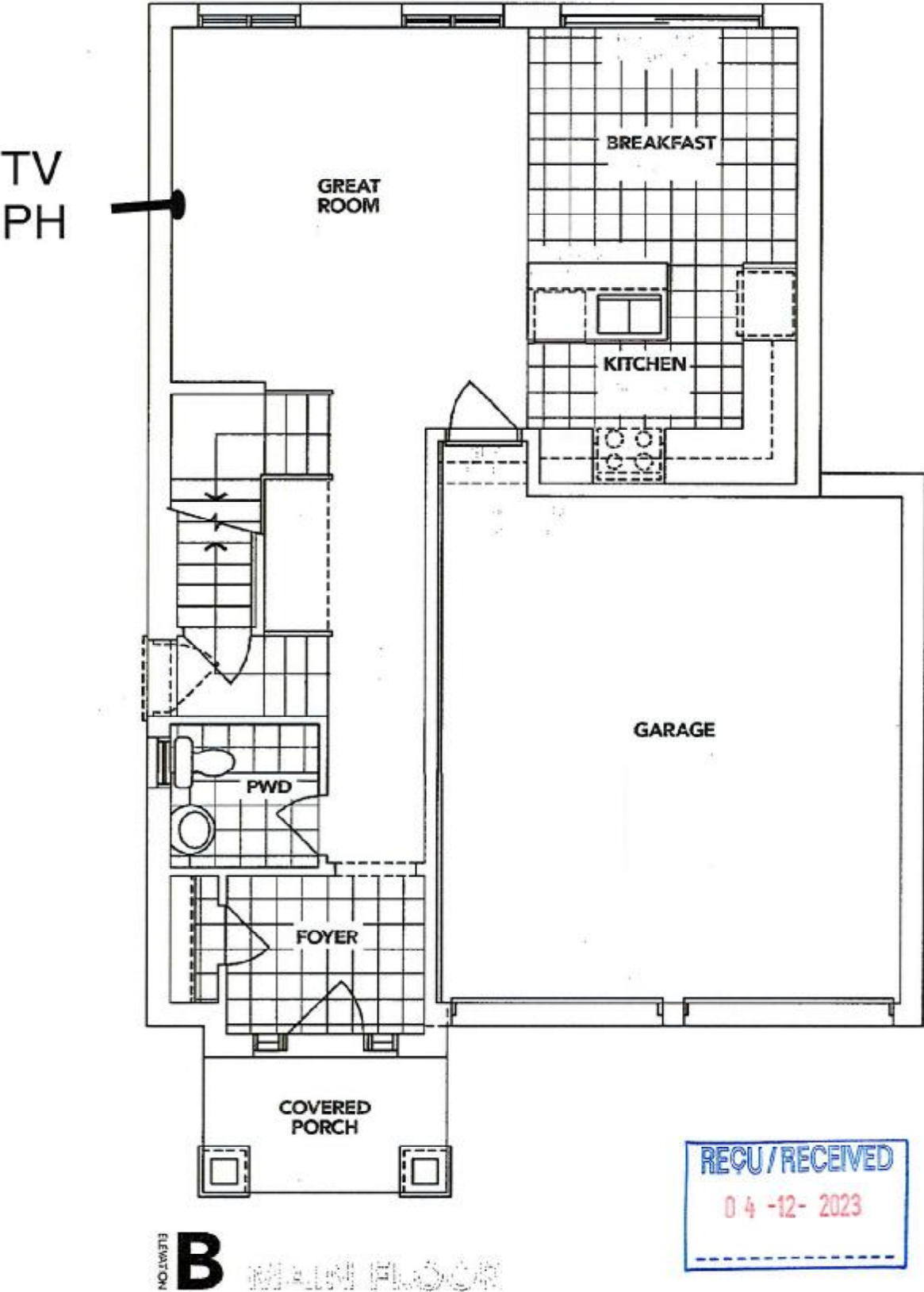

The floor plans and elevations shown are pre-construction plans and may be revised or improved as necessitated by architectural controls and the construction process. The measurements adhere to the rules and regulations of the TARION Warranty Corporation's official method for the calculation of floor area. Materials, specifications and floor plans are subject to change without notice. All house renderings are artist's concept only. Actual usable floor space may vary from the stated floor area. All options shown are upgrades. E. & O. E.

SCHEDULE "B-1"
Floor Plan

Lindsay PH.2 Lot 75
Lot 75
Phase 2
Model: Silver Lake (3702) Elev B 3Bed 2.5Bath
Standard

SKETCH #4

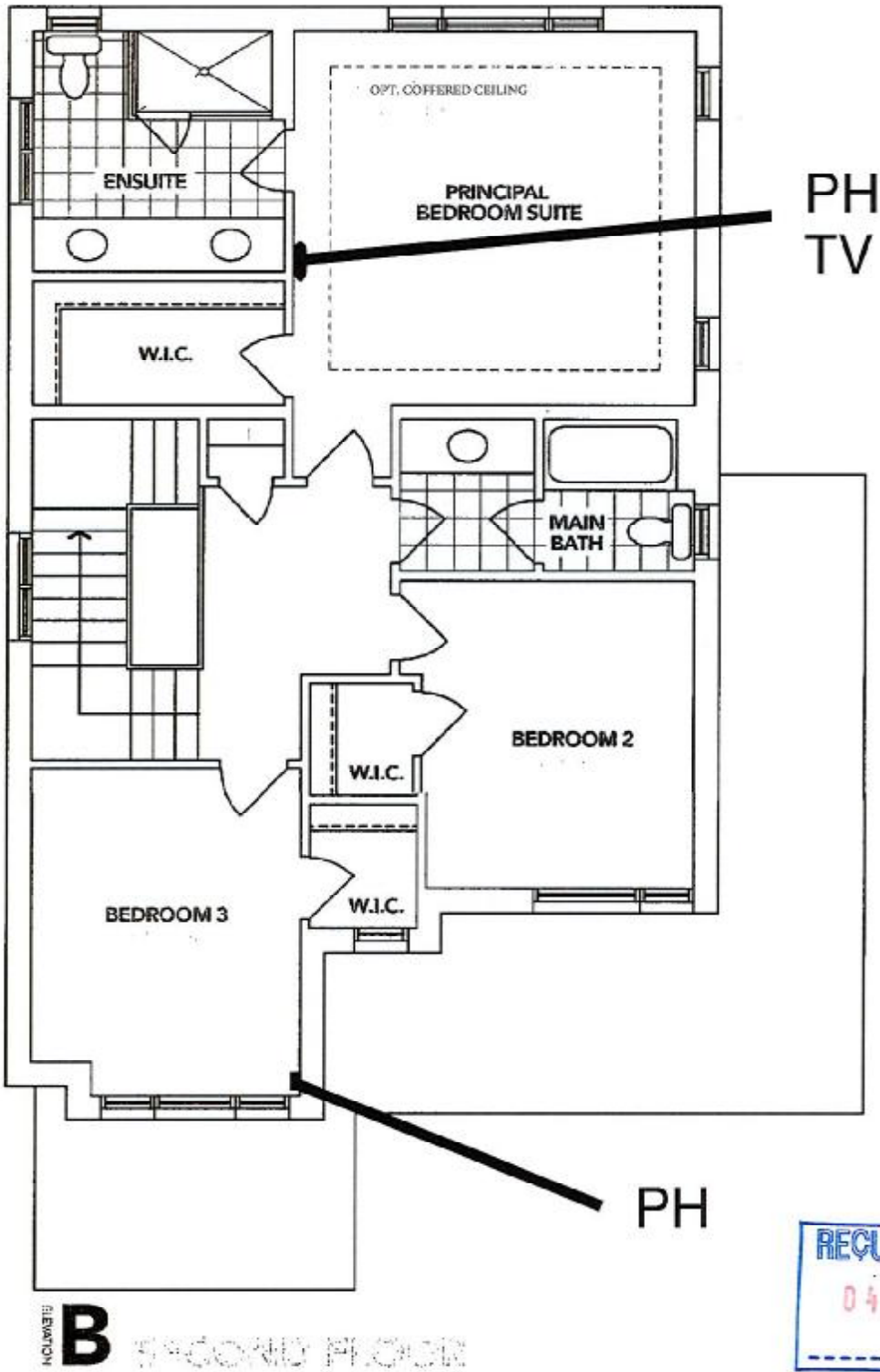

The floor plans and elevations shown are pre-construction plans and may be revised or improved as necessitated by architectural controls and the construction process. The measurements adhere to the rules and regulations of the TARION Warranty Corporation's official method for the calculation of floor area. Materials, specifications and floor plans are subject to change without notice. All house renderings are artist's concept only. Actual usable floor space may vary from the stated floor area. All options shown are upgrades. E. & O. E.

SCHEDULE "B-1"
Floor Plan

Lindsay p.m. 2 Lot 75

Lot 75
Phase 2
Standard

Model: Silver Lake (3702) Elev B 3Bed 2.5Bath

SKETCH #5

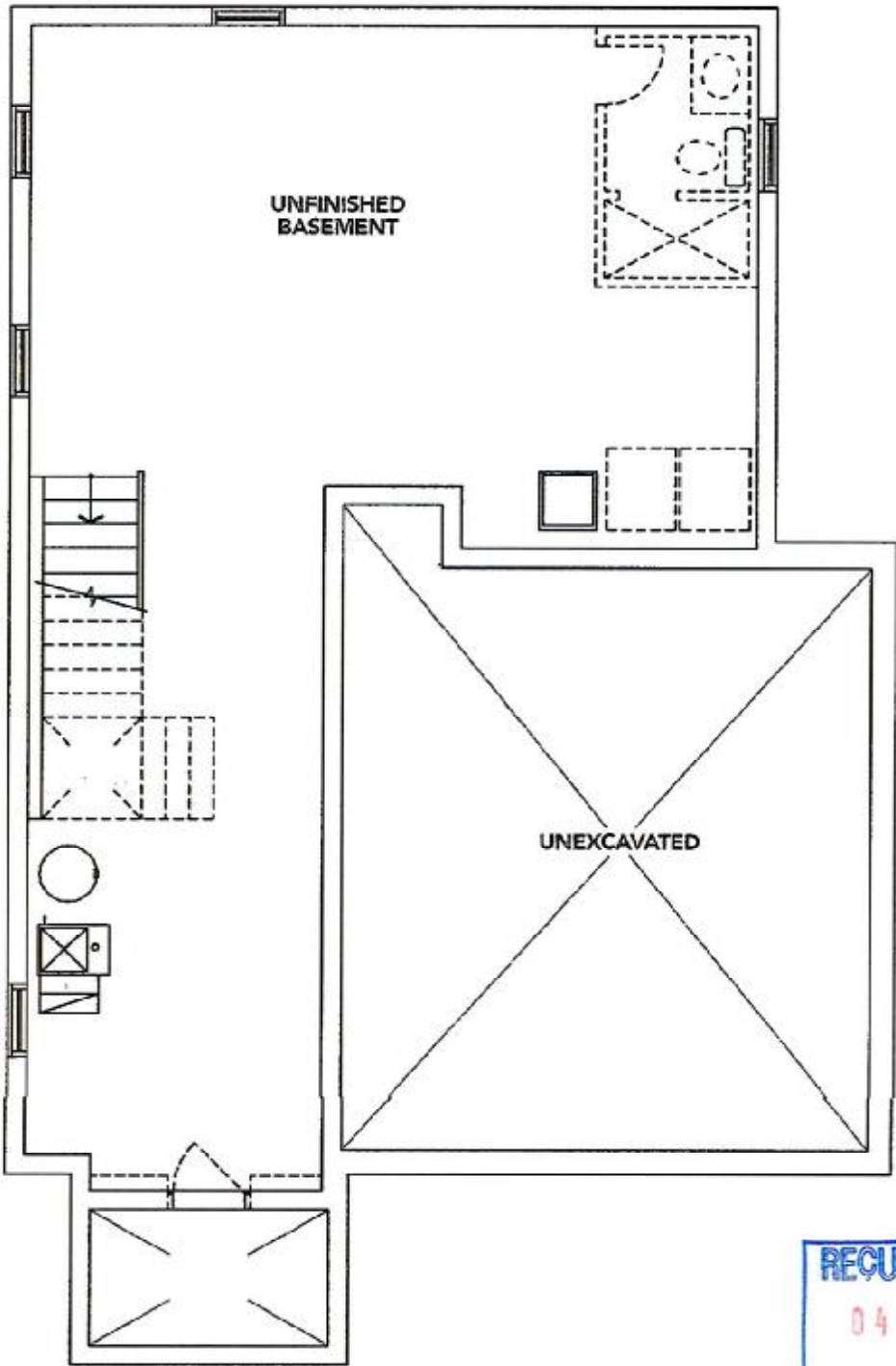

ELEVATION **B** BASEMENT

The floor plans and elevations shown are pre-construction plans and may be revised or improved as necessitated by architectural controls and the construction process. The measurements adhere to the rules and regulations of the TARION Warranty Corporation's official method for the calculation of floor area. Materials, specifications and floor plans are subject to change without notice. All house renderings are artist's concept only. Actual usable floor space may vary from the stated floor area. All options shown are upgrades. E. & O. E.