

Lindsay 2017 Developments Inc. / Sugarwood

Lot/Unit: 36 Phase/Building: 2 Model/Floor Plan: Cavendish Lake (4210) Elev B 4Bed
4.5Bath

CABINETRY APPLIANCE - FRIDGE

Inv.6487	1 - To supply & install the 66CM DEEP FRIDGE ENCLOSURE - COUNTER DEPTH WITH NO WALLS - 2 66CM DEEP GABLES AND 1 66CM DEEP CABINET - THIS IS NOT A ZERO CLEARANCE ENCLOSURE. STANDARD HEIGHTS AND WIDTHS WILL BE USED. in the kitchen... see sketch # 3	
Line 81219	Note:	
23Nov23 / 23Nov23		

CABINETRY MICROWAVE OVEN STOVE COOKTOP

Inv.6487	1 - To supply & install the WALL CABINET WITH SHELF FOR MICROWAVE - FINISHED INTERIOR - OPENING 24 INCHES W X 13 3 - 4 INCHES H X 17 INCHES D - in the kitchen... see sketch # 3	
Line 81220	Note: Elec. for this upgrade is sold sep.	
23Nov23 / 23Nov23		

DOORS AND WINDOWS

ELECTRICAL

Inv.6487	1 - To supply & install the standard T.V. rough in in the great room and master bedroom... see sketch # 3 & # 4	
Line 81213	Note: Install the standard T.V. rough in at approx. 66" + - up from the floor centered + - to the F/P mantle.	
23Nov23 / 23Nov23		
Inv.6487	1 - To supply & install the standard Phone (CAT5) rough in in the great room, master bedroom and bedroom #2 ... see sketch # 3 & # 4	
Line 81214	Note: Install the standard Phone (CAT 5) ough in at approx. 66" + - up from the floor centered + - to the F/P mantle.	
23Nov23 / 23Nov23		
Inv.6487	1 - To SUPPLY AND INSTALL AN ADDITIONAL BASIC RECEPTACLE (NOT DEDICATED) at approx. 66" + - up from the floor centered +- to the F/P mantle	
Line 81215	Note: in the great room... see sketch # 3	
23Nov23 / 23Nov23		
This is for a future wall mount T.V. NO CONDUIT PIPE HAS BEEN PURCHASED.		
Inv.6487	1 - To SUPPLY AND INSTALL AN ADDITIONAL BASIC RECEPTACLE (DEDICATED CIRCUIT AND INCLUDES ARC FAULT BREAKER) at the upgraded microwave shelf in the kitchen..	
Line 81221	Note: See sketch #3	
23Nov23 / 23Nov23		

HARDWOOD

Inv.6487	1 - To supply & install the 3 1/2" Elements Stained engineered hardwood floors to the main floor and stair landing(s) where applicable in lieu of the standard 3 1/2" Elements natural engineered hardwood floors... see colour chart for details.	
Line 81222	Note:	
23Nov23 / 23Nov23		
Inv.6487	1 - To supply & install the 3 1/2" Elements Stained engineered hardwood floors to the main floor and stair landing(s) where applicable in lieu of the standard carpet... see colour chart for details.	
Line 81223	Note:	
23Nov23 / 23Nov23		



CONSTRUCTION SUMMARY

Lindsay 2017 Developments Inc. / Sugarwood

Lot/Unit: 36 Phase/Building: 2 Model/Floor Plan: Cavendish Lake (4210) Elev B 4Bed
4.5Bath

HEATING AND AIR CONDITIONING

Inv.6487	1 - To supply & install a HUMMIDIFER to the furnace.	
Line 81216	Note:	
23Nov23 / 23Nov23		

MISCELLANEOUS

PAINT AND DRYWALL

Inv.6487	1 - To supply & install the PAINT EXTRAS - STAIN RAILINGS WITH IRON PICKETS (INCLUDING STAIRS)... see colour chart for details.	
Line 81226	Note:	
23Nov23 / 23Nov23		

PLUMBING

Inv.6487	1 - To supply & install the KITCHEN SINK - BLANCO QUATRUS U2 DBL UNDERMOUNT - MODEL 401247 in the kitchen in lieu of standard top mount kitchen sink... see spec's	
Line 81234	Note: Still to install the standard single hole kitchen faucet, NO PLATE.	
23Nov23 / 23Nov23		
Inv.6487	1 - To supply & install a WATERLINE ROUGH-IN TO THE FRIDGE LOCATION (NO HOOK UP) in the kitchen.	
Line 81217	Note:	
23Nov23 / 23Nov23		

RAILING - INTERIOR

Inv.6487	1 - To supply & install the RAILING - UPGRADE 1 - METAL HANDRAIL 3 INCH OVAL IN OAK - PICKETS STEEL ½ INCH SQUARE, PLAIN, WITH SHOES IN FLAT BLACK - POSTS 3½ INCH SQUARE, WITH CAP OAK IN OAK in lieu of the standard pickets and rails.	
Line 81224	Note:	
23Nov23 / 23Nov23		

EXTRAS AS PER OFFER

Purchaser:IRFAN NABI

Telephone Res. / Bus: /

Decor Advisor:Barbara Coccia

Layout Changes: ☐ Yes ☒ No

Property: 36 of Plan -

Project: Lindsay 2017 Developments Inc.

Model and Elevation: Cavendish Lake (4210) Elev B 4Bed 4.5Ba

Sketch Attached: ☐ Yes ☒ No

Exterior Colour Scheme:

1. Cabinetry	Style and Colour	Counter Top	Hardware
Kitchen / Breakfast	#3 Simcoe Rain Cloud	#1 C/S # 9141 Ice Snow	#12881 Handle
Kitchen Island	#3 Simcoe Rain Cloud	#1 C/S # 9141 Ice Snow	#12881 Handle
Laundry Room	/		
Powder Room	/		
Main Bathroom	/		
Master Ensuite Bathroom	#3 Simcoe Orchid	# 4925K-07 Calcutta Marble	#12881 Handle
Second Ensuite Bathroom (If Applicable)	# 3 Manchester Maple Shale Grey CL	# 4924-38 White Carrara	#12881 Handle
Ens. #3's bathroom:	# 3 Manchester Maple Shale Grey CL	# 4924-38 White Carrara	#12881 Handle
Ens. #4's bathroom:	# 3 Manchester Maple Shale Grey CL	# 4924-38 White Carrara	#12881 Handle

Appliances

Custom Size Fridge
☐ Yes ☒ No

Cooktop / Rangetop
☐ Yes ☒ No

Valance Lighting

☐ Yes ☒ No

Built in Wall Oven
☐ Yes ☒ No

Microwave / Range Hood

☐ Yes ☒ No

Slide-in Range
☐ Yes ☒ No

Comment

/



2. Flooring	Selection
Foyer	13x13" Burlingstone White
Main Hall	** 3 1/2" Elements oak Sturgeon
Back Hall	** 3 1/2" Elements oak Sturgeon
Breakfast	13x13" Burlingstone White
Laundry Room	13x13" Burlingstone White
Kitchen	13x13" Burlingstone White
Powder Room	13x13" Burlingstone White
Main Bathroom	Ens. #2' bathroom: 13x13" Keaton Ice
Master Ensuite Bathroom (If Applicable)	Principal's ens: 13x13" Piaggio Grey
Mud Room	Ens. #3' bathroom: 13x13" Keaton Ice
Principal & Ens. #2's ens.	13x13" Burlingstone White
Living Room	shower floor: 2x2" Inizio Blanco Mosaic
Dining Room	Ens. #4' bathroom: 13x13" Keaton Ice
Family / Great Room	** 3 1/2" Elements oak Sturgeon
Den / Library / Study	** 3 1/2" Elements oak Sturgeon
Basement Landing (If Applies)	/
Lower Landing (If Applicable)	** 3 1/2" Elements oak Sturgeon
Upper Landing	** 3 1/2" Elements oak Sturgeon
Upper Hall	** 3 1/2" Elements oak Sturgeon
Master Bedroom	Opening Night # 20
Bedroom #2	Opening Night # 20
Bedroom #3	Opening Night # 20
Bedroom #4	Opening Night # 20
Bedroom #5	Opening Night # 20
Principal & Ens. #2's ens.	/
	jamb: Anatolia Marmiline SNOW

SEE ATTACHED FOR SIGNATURES



Purchaser: IRFAN NABI

Property: 36 of Plan -

Telephone Res. / Bus: /

Project: Lindsay 2017 Developments Inc.

Decor Advisor: Barbara Coccia

Model and Elevation: Cavendish Lake (4210) Elev B 4Bed 4.5Ba

2. Flooring - Continued -

Upgrade Underpad	Type	Area
	Standard	Master bedroom, bedroom #2, #3 & #4
Carpet on Stairs	Capped	Runner - *Upgrade
Comment	/	/

3. Plumbing Fixtures / Faucets

Kitchen	Standard	Second Ensuite	Standard	Powder Room	Standard
Master Ensuite	Standard			Other Room	/
Main Bathroom	/	Ens. #3 & #4's bathroom	Standard		

Comment

Purchaser has upgraded to an under mount kitchen sink, still to install the standard single hole kitchen faucet NO PLATE.

RECU/RECEIVED

24-11-2023

4. Wall Tile

	Tile Selection	Listello	Insert	Insert Selection
Main Bathroom	/	<input type="checkbox"/>	<input type="checkbox"/>	
Master Ensuite				
Tub Deck	/	<input type="checkbox"/>	<input type="checkbox"/>	
Tub Apron	/	<input type="checkbox"/>	<input type="checkbox"/>	
Tub Surround	/	<input type="checkbox"/>	<input type="checkbox"/>	
Shower Stall	8x10" Weave White	<input type="checkbox"/>	<input type="checkbox"/>	
Second Ensuite	8x10" Weave Tender Grey	<input type="checkbox"/>	<input type="checkbox"/>	
Ens. #3's bathroom	8x10" Weave Tender Grey	<input type="checkbox"/>	<input type="checkbox"/>	
Ens. #4's bathroom	8x10" Weave Tender Grey	<input type="checkbox"/>	<input type="checkbox"/>	
Kitchen Backsplash	/	<input type="checkbox"/>	<input type="checkbox"/>	
Complete Backsplash	/	<input type="checkbox"/>	<input type="checkbox"/>	

Comment

/



horizontal stacked

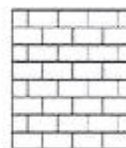

brick pattern



vertical stacked



diagonal/diamond

5. Fireplace

Living Room

Purchased ☐ As Per Plan ☐ N/A ☒

Family Room

Purchased ☐ As Per Plan ☐ N/A ☒

Other Room - Specify Great room

Purchased ☐ As Per Plan ☒ N/A ☐

Fireplace Type

Mantle Type

Over Mantle

Colour / Stain

Surround

Hearth

Comment

/

SEE ATTACHED FOR SIGNATURES



Initial: _____

Page 2 of 3

Purchaser: IRFAN NABI

Property: 36 of Plan -

Telephone Res. / Bus: /

Project: Lindsay 2017 Developments Inc.

Decor Advisor: Barbara Coccia

Model and Elevation: Cavendish Lake (4210) Elev B 4Bed 4.5Ba

6. Trim Carpentry

Door Hardware

Interior Trim

Comment

Interior Doors

☐ 2 Panel Arch Top

☒ 2 Panel Square Top

☐ 6 Panel

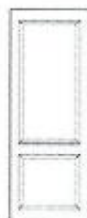

Initial for Door Style

7. Railings and Pickets

Railing Package

Railing Colour

Picket Colour

Wood Stairs ☐ No ☒ Oak

Tread Colour

Comment

SEE ATTACHED FOR SIGNATURES

8. Plaster Mouldings and Medallions

Foyer

/

Main Hall

/

Living Room

/

Dining Room

/

Family Room

/

Kitchen/Breakfast

/

Den/Library

/

Lower Landing

/

Comment

REQD/RECEIVED

24-11-2023

9. Wall Paint

Kingsmen White

Smooth Ceilings

☐ First Floor

☐ First Floor incl. Second Floor Hall

☐ First and Second Floor

☒ Throughout

☐ Not Applicable

Trim Paint

10. Additional Comments

11. Disclaimers and Notes

- Colours of all materials are as close as possible to builder's selection, but not necessarily identical due to variances in manufacturing.
- Any extras listed above are null and void unless accompanied by a separate invoice/amendment. Said invoice must be paid in full.
- The Purchaser acknowledges that after Interior Colour Selection form is signed and dated, no further changes will be permitted other than re-selection due to unavailability. SEE ATTACHED FOR SIGNATURES
- The Purchaser acknowledges reading and accepting the "Kingsmen Group Décor Centre Disclaimers" form. This document contains other miscellaneous disclaimers.

This Interior Colour Selection is final and approved by:

Purchaser:

Signature:

SEE ATTACHED FOR SIGNATURES

Vendor:

Lindsay 2017 Developments Inc.

Dec 5/23

SCHEDULE "B-1"
Floor Plan

Model: Cavendish Lake (4210) Elev B 48ed 4.5Bath
Standard

Lot 36
Phase 2

Optional Side Door

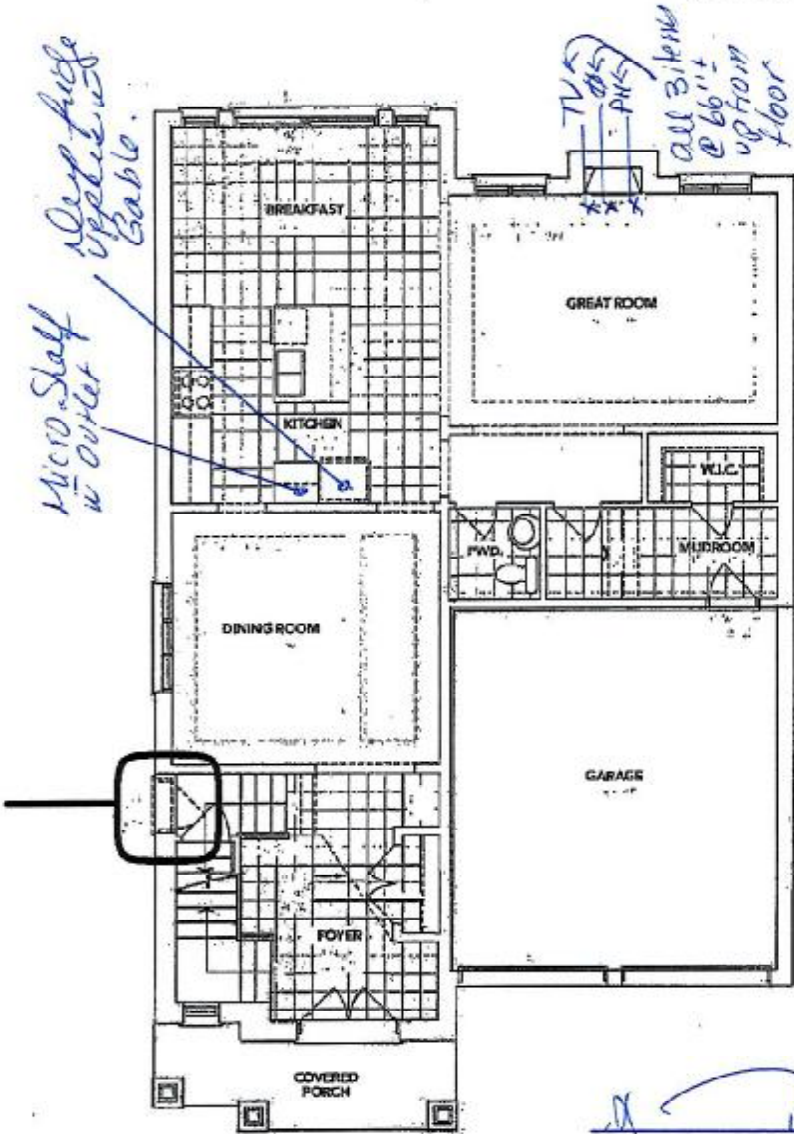

SKETCH #3

[Handwritten signature]

A MAIN FLOOR

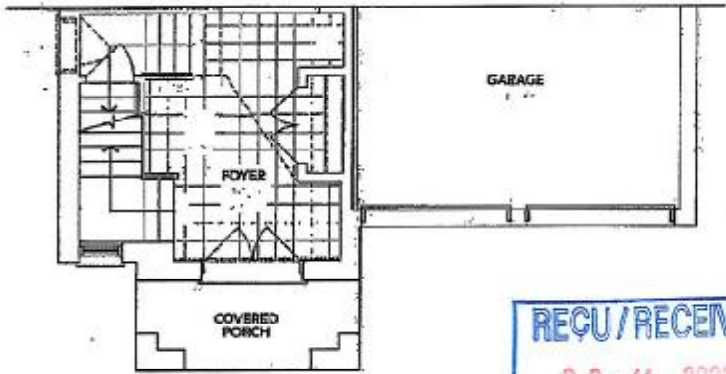

B PARTIAL MAIN FLOOR

RECU/RECEIVED
23-11-2023

The floor plans and elevations shown are pre-construction plans and may be revised or improved as necessitated by architectural controls and the construction process. The measurements adhere to the rules and regulations of the TARION Warranty Corporation's official method for the calculation of floor area. Materials, specifications and floor plans are subject to change without notice. All house renderings are artist's concept only. Actual usable floor space may vary from the stated floor area. All options shown are upgrades. E. & O. E.

[Handwritten initials: I.N.]

Initials: *[Handwritten initials: I.N.]*

LOT 36 LINDSAY PH 2
RE: UPG. UNDER MOUNT KITCHEN SINK

SEE ATTACHED FOR SIGNATURES

7

BLANCO

Sink Specifications

Colour	SKU
brushed finish	401247

QUATRUS U 2

Design and planning tips

- Min cabinet size: 36 in (915 mm)
- Bowl Depth: 9 in (230.0 mm)

Specifications:

Installation clips, Sink template, Installation instructions, 3
1/2" (90 mm) stainless steel strainers

Depending on cabinet construction, a different cabinet
size may be required. Consult the cabinet manufacturer.

