

Lindsay 2017 Developments Inc. / Sugarwood

Lot/Unit: 6 Phase/Building: 2 Model/Floor Plan: Buckhorn Lake (3704) Elev B 4Bed
2.5Bath

COUNTER TOP

Inv.6434	1 - TO SUPPLY AND INSTALL UPG #1 C/S TO THE MASTER ENSUITE IN LIEU OF THE STANDARD.. SEE COLOUR CHART	
Line 80821	Note:	
7Nov23 / 7Nov23		
Inv.6434	1 - TO SUPPLY AND INSTALL UPG #1 C/S TO THE MAIN BATHROOM IN LIEU OF THE STANDARD.. SEE COLOUR CHART	
Line 80822	Note:	
7Nov23 / 7Nov23		

ELECTRICAL

Inv.6434	1 - TO SUPPLY AND INSTALL THE STANDARD TV ROUGH-IN IN THE GREATROOM AND MASTER BEDROOM.. SEE SKETCH #1 AND #2	
Line 80808	Note:	
7Nov23 / 7Nov23		
Inv.6434	1 - TO SUPPLY AND INSTALL THE STANDARD PHONE ROUGH-IN IN THE GREATROOM, BEDROOM #3 AND MASTER BEDROOM.. SEE SKETCH #1 AND #2	
Line 80809	Note:	
7Nov23 / 7Nov23		
Inv.6434	1 - TO SUPPLY AND INSTALL CAPPED ELEC. ON A SEPARATE SWITCH OVER THE BREAKFAST BAR.. SEE SKETCH #1	
Line 80819	Note:	
7Nov23 / 7Nov23		

PLUMBING

Inv.6434	1 - TO SUPPLY AND INSTALL KITCHEN SINK - BLANCO QUATRUS U2 UNDERMOUNT - MODEL 401247 IN LIEU OF THE STANDARD.. SEE SPEC'S	
Line 80820	Note:	
7Nov23 / 7Nov23		
Inv.6434	2 - TO SUPPLY AND INSTALL VANITY SINK - CONTRAC CATENA UNDERMOUNT - MODEL 4210CIY IN THE MASTER AND MAIN BATHROOM IN LIEU OF THE STANDARD.. SEE SPEC'S	
Line 80823	Note:	
7Nov23 / 7Nov23		

STAIRS AND RAILING

Inv.6434	1 - TO SUPPLY AND INSTALL STRAIGHT OAK PICKETS	
Line 80825	Note:	
7Nov23 / 7Nov23		

TILE - BACKSPLASH

Inv.6434	1 - TO SUPPLY AND INSTALL UPG #1 TILE STACKED TO THE BACKPLASH OF THE TILE.. SEE COLOUR CHART FOR DETAILS	
Line 80824	Note:	
7Nov23 / 7Nov23		

Lindsay 2017 Developments Inc. / Sugarwood

**Lot/Unit: 6 Phase/Building: 2 Model/Floor Plan: Buckhorn Lake (3704) Elev B 4Bed
2.5Bath**

EXTRAS AS PER OFFER



INTERIOR COLOUR SCHEME

Lindsay PH. 2
Lot 6

Purchasers: VINH TUAN THANG & HUU VIEN NGUYEN // TIProperty: 6 of Plan -
Telephone Res. / Bus: / Project: Lindsay 2017 Developments Inc.
Decor Advisor: Samantha Castelli Model and Elevation: Buckhorn Lake (3704) Elev B 4Bed 2.5Bat

Layout Changes: ☐ Yes ☒ No Sketch Attached: ☒ Yes ☐ No Exterior Colour Scheme:

1. Cabinetry	Style and Colour	Counter Top	Hardware
Kitchen / Breakfast	#3 Muskoka Navy Blue	#1 C/S #9141 ICE SNOW	9671 HANDLE
Kitchen Island	#3 Muskoka Navy Blue	#1 C/S #9141 ICE SNOW	9671 HANDLE
Laundry Room	/	/	/
Powder Room	/	/	/
Main Bathroom	#3 Muskoka Navy Blue	#1 C/S #9141 ICE SNOW	135 KNOB
Master Ensuite Bathroom	#3 Muskoka Navy Blue	#1 C/S #9141 ICE SNOW	135 KNOB
Second Ensuite Bathroom (If Applicable)	/	/	/
	/	/	/
	/	/	/

Appliances Custom Size Fridge ☐ Yes ☒ No Valance Lighting ☐ Yes ☒ No Microwave / Range Hood ☐ Yes ☒ No
Cooktop / Rangetop ☐ Yes ☒ No Built in Wall Oven ☐ Yes ☒ No Slide-In Range ☐ Yes ☒ No
Comment ☐ Yes ☒ No ☐ Yes ☒ No ☐ Yes ☒ No

REQD / RECEIVED
08-11-2023

2. Flooring	Selection
Foyer	13x13" Burlingstone White
Main Hall	3 1/2" Elements Oak Natural
Back Hall	/
Breakfast	13x13" Burlingstone White
Laundry Room	/
Kitchen	13x13" Burlingstone White
Powder Room	13x13" Burlingstone White
Main Bathroom	13x13" Burlingstone White
Master Ensuite	13x13" Burlingstone White
Bathroom (If Applicable)	/
Mud Room	13x13" Burlingstone White
Master Ens. Shower Floor	2x2" Inizio Bianco
Living Room	/
Dining Room	/
Family / Great Room	3 1/2" Elements Oak Natural
Den / Library / Study	/
Basement Landing (If Applies)	/
Lower Landing (If Applicable)	3 1/2" Elements Oak Natural
Upper Landing	3 1/2" Elements Oak Natural
Upper Hall	Opening Night: 03
Master Bedroom	Opening Night: 03
Bedroom #2	Opening Night: 03
Bedroom #3	Opening Night: 03
Bedroom #4	Opening Night: 03
Bedroom #5	/
Master Ens Shower Jamb	ANATOLIA MARMILINE SNOW

Flooring Continued on Page 2

Initial: Page 1 of 3

Purchasers: VINH TUAN THANG & HUU VIEN NGUYEN // TIProperty: 6 of Plan -
Telephone Res. / Bus: / Project: Lindsay 2017 Developments Inc.
Decor Advisor: Samantha Castelli Model and Elevation: Buckhorn Lake (3704) Elev B 4Bed 2.5Bath

2. Flooring - Continued -

Upgrade Underpad	Type STANDARD	Area 2ND FLOOR
Carpet on Stairs	Capped	Runner - *Upgrade
Comment		

3. Plumbing Fixtures / Faucets



Kitchen	STANDARD	Second Ensuite		Powder Room	STANDARD
Master Ensuite	STANDARD			Other Room	
Main Bathroom	STANDARD				
Comment	KITCHEN SINK HAS BEEN UPGRADED TO UNDERMOUNT, STILL TO INSTALL STANDARD FAUCET. TO INSTALL STANDARD PLUMBING FIXTURES IN PWD. SINKS IN THE MAIN AND MASTER ENS. HAVE BEEN UPGRADED, STILL TO INSTALL THE STANDARD FAUCET				

RECU/RECEIVED

08-11-2023

4. Wall Tile

	Tile Selection	Listello	Insert	Insert Selection
Main Bathroom	8x10" Weave Tender Grey	<input type="checkbox"/>	<input type="checkbox"/>	
Master Ensuite		<input type="checkbox"/>	<input type="checkbox"/>	
Tub Deck		<input type="checkbox"/>	<input type="checkbox"/>	
Tub Apron		<input type="checkbox"/>	<input type="checkbox"/>	
Tub Surround		<input type="checkbox"/>	<input type="checkbox"/>	
Shower Stall	8x10" Weave Tender Grey	<input type="checkbox"/>	<input type="checkbox"/>	
Second Ensuite		<input type="checkbox"/>	<input type="checkbox"/>	
		<input type="checkbox"/>	<input type="checkbox"/>	
		<input type="checkbox"/>	<input type="checkbox"/>	
Kitchen Backsplash	4x16" Soho Vintage Grey Glossy Press STACKED	<input type="checkbox"/>	<input type="checkbox"/>	
Complete Backsplash		<input type="checkbox"/>	<input type="checkbox"/>	
Comment				

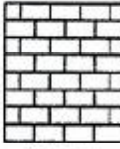
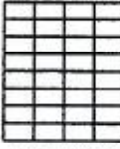

horizontal stacked brick pattern vertical stacked diagonal/diamond

5. Fireplace

	Living Room			Family Room			Other Room - Specify GREAT ROOM		
	Purchased	As Per Plan	N/A	Purchased	As Per Plan	N/A	Purchased	As Per Plan	N/A
Fireplace Type	<input type="radio"/>	<input type="radio"/>	<input type="radio"/>	<input type="radio"/>	<input type="radio"/>	<input type="radio"/>	<input type="radio"/>	<input checked="" type="radio"/>	<input type="radio"/>
Mantle Type							FRONT FACING		
Over Mantle							NF-08		
Colour / Stain							WHITE		
Surround									
Hearth									
Comment									

Initial:

TH I F

KINGSMEN
GROUP INC.

INTERIOR COLOUR SCHEME
Lindsay PH. 2 Lot 6

Purchasers: VINH TUAN THANG & HUU VIEN NGUYEN // **TIProperty:** 6 of Plan -
Telephone Res. / Bus: / **Project:** Lindsay 2017 Developments Inc.
Decor Advisor: Samantha Castelli **Model and Elevation:** Buckhorn Lake (3704) Elev B 4Bed 2.5Bath

6. Trim Carpentry
Door Hardware STANDARD HANDLE

Interior Trim STANDARD

Comment
Interior Doors
☐ 2 Panel Arch Top

☒ 2 Panel Square Top

☐ 6 Panel

 Initial for Door Style *TH IT*
7. Railings and Pickets
Railing Package **STRAIGHT OAK PICKETS

Railing Colour ELEMENTS OAK NATURAL

Picket Colour ELEMENTS OAK NATURAL

Wood Stairs ☐ No ☒ Oak

Tread Colour ELEMENTS OAK NATURAL

Comment
8. Plaster Mouldings and Medallions
Foyer
Main Hall
Living Room
Dining Room
Family Room
Kitchen/Breakfast
Den/Library
Lower Landing
Comment

RECEIVED

08-11-2023

9. Wall Paint

KINGSMEN WHITE

Smooth Ceilings
☐ First Floor

☐ First Floor incl. Second Floor Hall

☐ First and Second Floor

☒ Throughout

☐ Not Applicable

Trim Paint KINGSMEN WHITE

10. Additional Comments
11. Disclaimers and Notes

- Colours of all materials are as close as possible to builder's selection, but not necessarily identical due to variances in manufacturing.
- Any extras listed above are null and void unless accompanied by a separate invoice/amendment. Said invoice must be paid in full.
- The Purchaser acknowledges that after Interior Colour Selection form is signed and dated, no further changes will be permitted other than re-selection due to unavailability. *TH IT* Purchaser's Initials
- The Purchaser acknowledges reading and accepting the "Kingsmen Group Décor Centre Disclaimers" form. This document contains other miscellaneous disclaimers.

This Interior Colour Selection is final and approved by:

Purchaser:
Signature:
Date: Nov 7, 2023

DocuSigned by:

11/7/2023

OF9889702FB64CD...

Signature:
Date: Nov 7, 23

Vendor:

Lindsay 2017 Developments Inc.

Nov 8/23

SCHEDULE "B-1"
Floor Plan

Lindsay pt. 2 Lot 6
Phase 2
Model: Buckhorn Lake (3704) Elev B 48Bed 2.5Bath
Standard

SKETCH#1

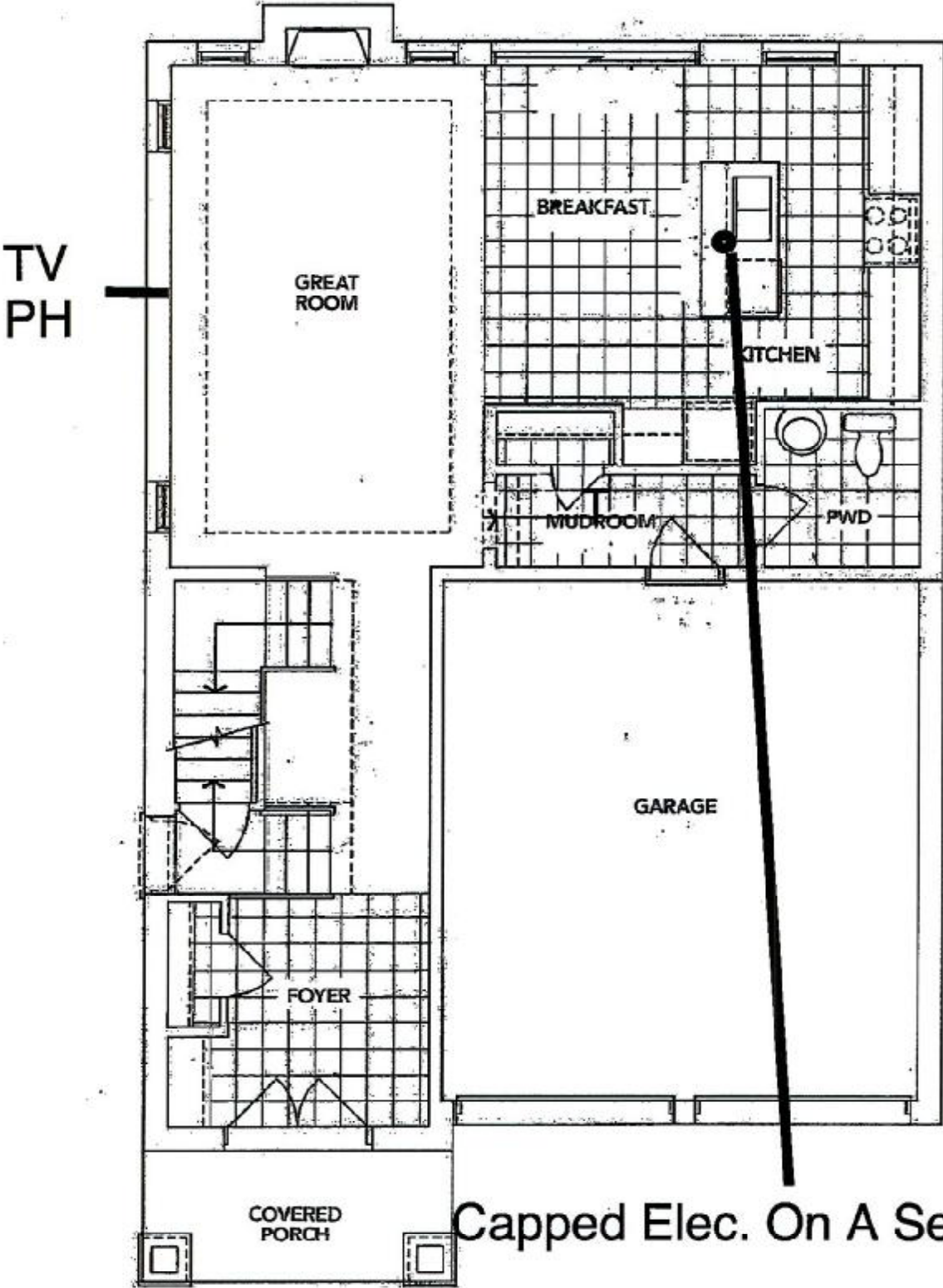

RECU/RECEIVED
08-11-2023

B MAIN FLOOR

The floor plans and elevations shown are pre-construction plans and may be revised or improved as necessitated by architectural controls and the construction process. The measurements adhere to the rules and regulations of the TARION Warranty Corporation's official method for the calculation of floor area. Materials, specifications and floor plans are subject to change without notice. All house renderings are artist's concept only. Actual usable floor space may vary from the stated floor area. All options shown are upgrades. E. & O. E.

TH T.T

SCHEDULE "B-1"
Floor Plan

Lindsay PH 2 Lot 6
Phase 2
Model: Buckhorn Lake (3704) Elev B 4Bed 2.5Bath
Standard

SKETCH #2

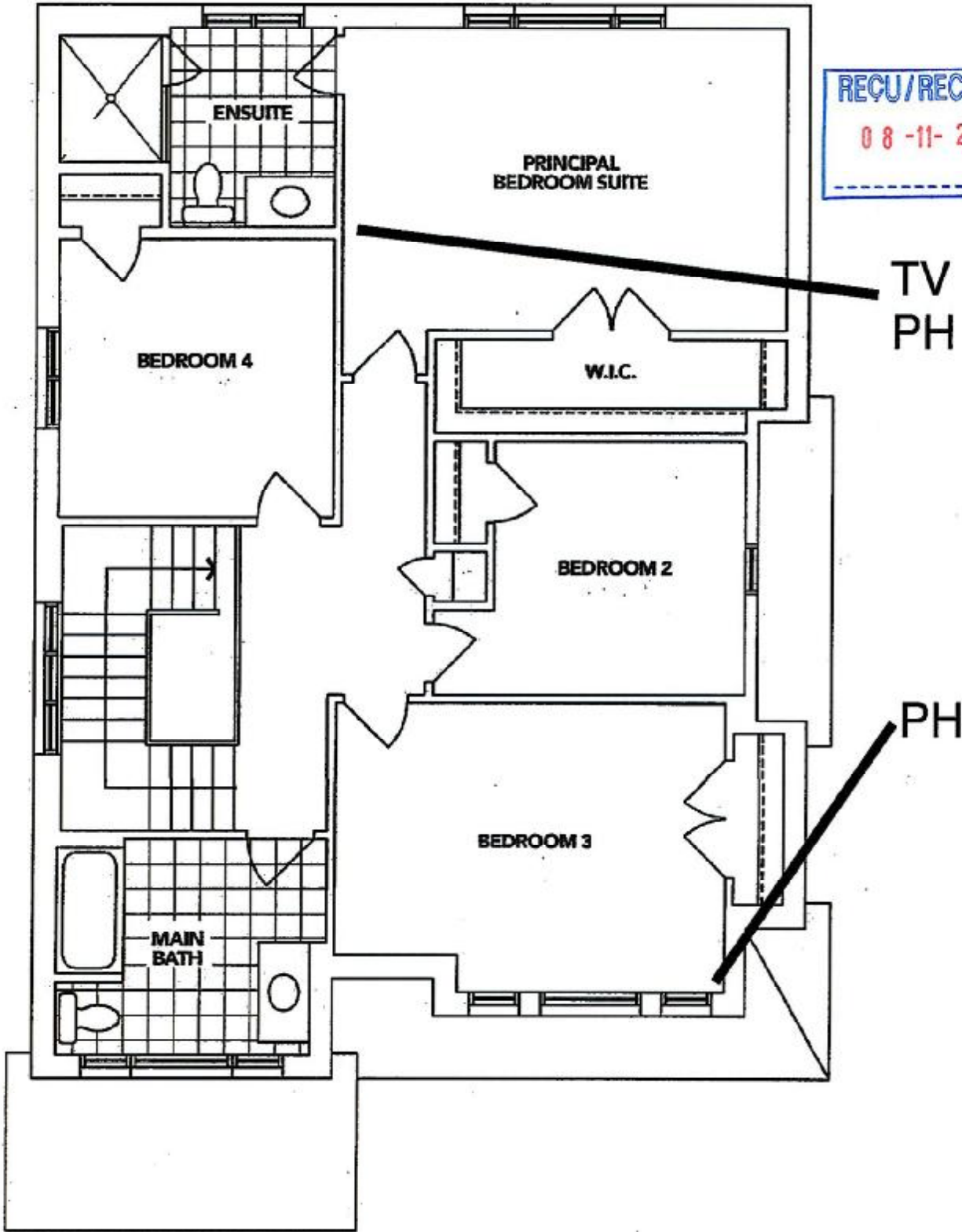

B SECOND FLOOR

The floor plans and elevations shown are pre-construction plans and may be revised or improved as necessitated by architectural controls and the construction process. The measurements adhere to the rules and regulations of the TARION Warranty Corporation's official method for the calculation of floor area. Materials, specifications and floor plans are subject to change without notice. All house renderings are artist's concept only. Actual usable floor space may vary from the stated floor area. All options shown are upgrades. E. & O. E.

TH T.T

Initials: [Signature] [Signature] [Signature]

SCHEDULE "B-1"
Floor Plan

Lindsay PH 2 Lot 6
Phase 2
Model: Buckhorn Lake (3704) Elev B 4Bed 2.5Bath
Standard

SKETCH #3

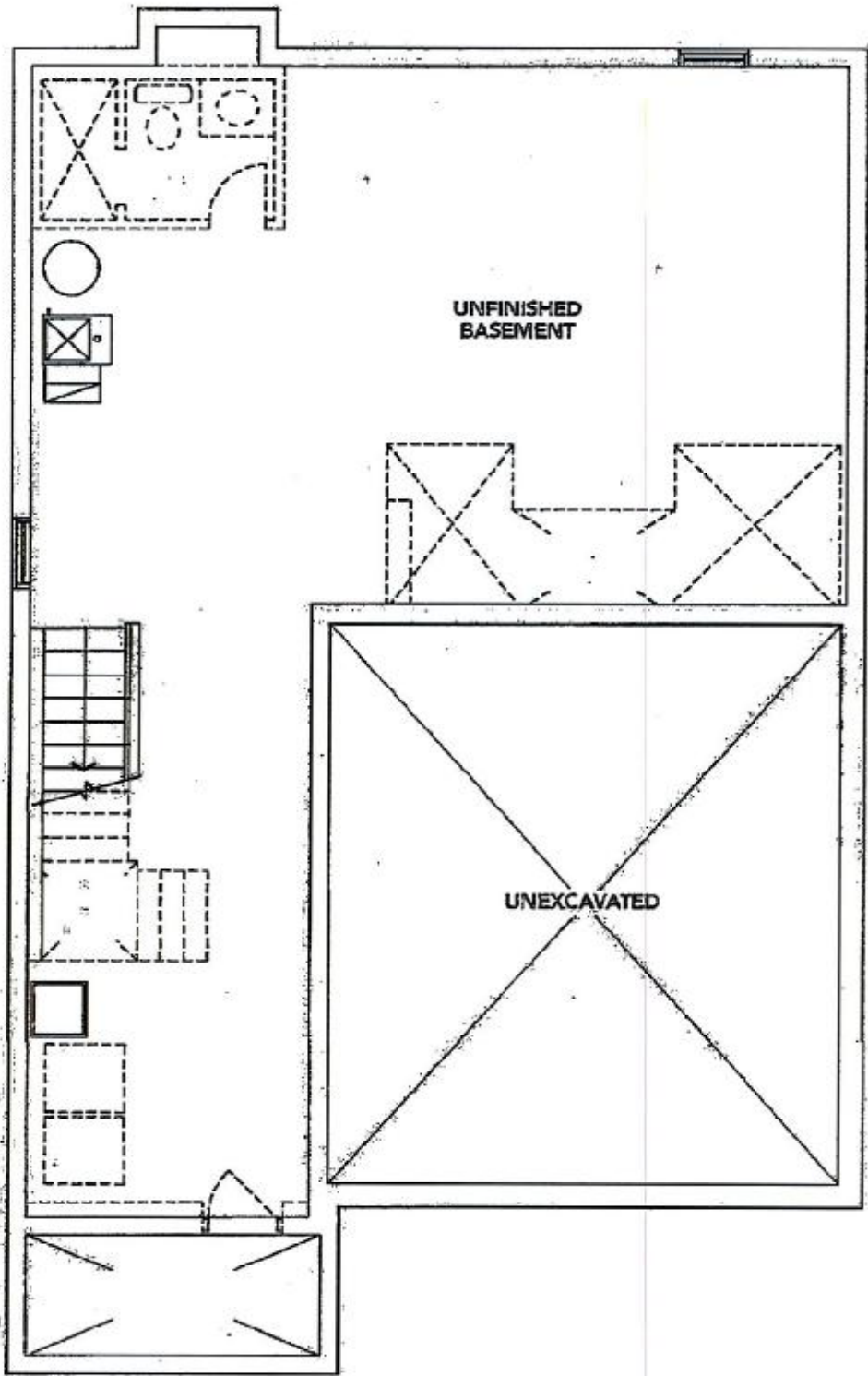

REC'D / RECEIVED
08-11-2023

ELEVATION **B** BASEMENT

The floor plans and elevations shown are pre-construction plans and may be revised or improved as necessitated by architectural controls and the construction process. The measurements adhere to the rules and regulations of the TARIION Warranty Corporation's official method for the calculation of floor area. Materials, specifications and floor plans are subject to change without notice. All house renderings are artist's concept only. Actual usable floor space may vary from the stated floor area. All options shown are upgrades. E. & O. E.

DS
VT

SCHEDULE "B-1" - Page 3 of 3

TH T.T

Initials: DS DS DS
VT VT VT

Lindsay PH.2 Lot 6



CATENA
LAVABO SOUS PLAN RECTANGULAIRE
4210CIY Lavebo sous plan

SPÉCIFICATIONS DU PRODUIT
- Porcelaine vitrifiée
- Trop-plein situé à l'avant
- Gabarit et quincaillerie de montage compris

DIMENSIONS
Extérieur :
510 mm L x 390 mm P x 190 mm H
20 po L x 15 3/4 po P x 7 1/2 po H
Intérieur :
458 mm L x 340 mm P x 140 mm H
18 po L x 13 3/4 po P x 5 1/2 po H

CERTIFICATIONS CONFORMITÉ
Satisfait aux normes suivantes ou les dépasse :
- cUPC de l'APMO
- ASME A112.19.2 / CSA B45.1
- Directive d'aménagement OBC article 3.8 pour accès facile B651 du CCN

EXPÉDITION
Volume 1,72
PB 27 lb

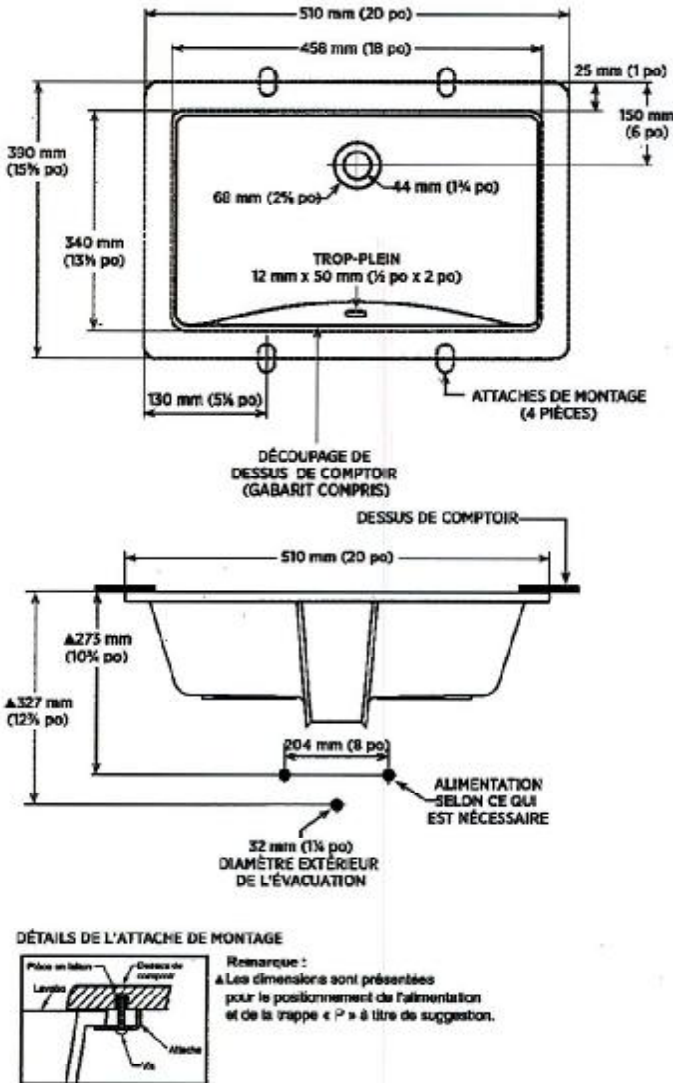

LOT 6 SUGARWOOD PH 2
RE: UPG: MASTER AND MAIN



A SPECIFIER
Couleur :
■ Blanc doux

REMARQUE : Les dimensions des appareils sanitaires sont nominales et peuvent varier à l'intérieur des limites de tolérance établies par la norme ASME A112.19.2. Ces mesures peuvent faire l'objet de modifications ou d'une annulation. Le fabricant n'assume aucune responsabilité en cas d'utilisation de documents périmés ou annulés.

Les produits ont été conçus afin de répondre à directive d'aménagement OBC article 3.8 pour accès facile B651 du CCN. Il incombe à l'installateur de se conformer aux normes et aux codes locaux et nationaux en matière d'accessibilité avant d'installer le produit.

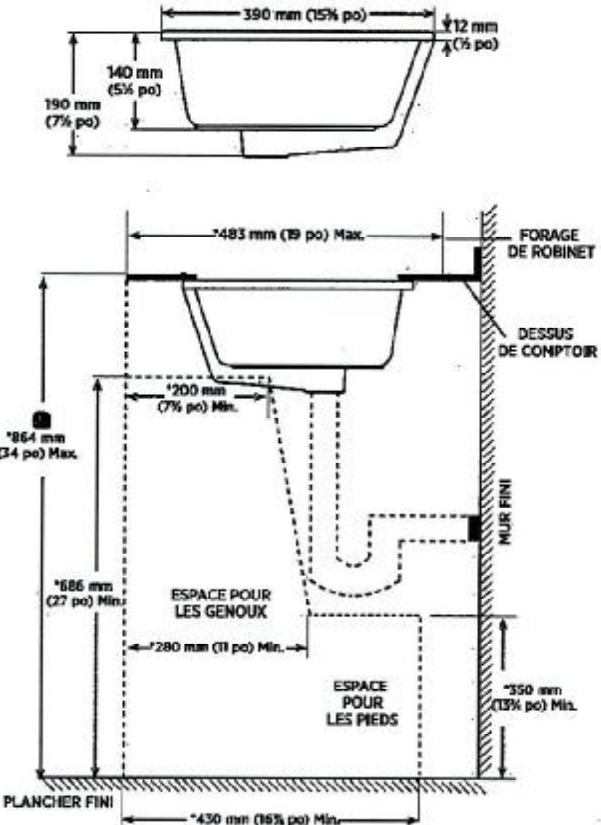

REMARQUE : * Les mesures sont conformes aux exigences d'accessibilité B651 du CCN et sans obstacles OBC.

REVISE MAI 2020

contrac 5970 CILDWORTH WAY, UNIT B, MISSISSAUGA, ONTARIO, CANADA L4R 4G5 | CONTRAC I.A.

DS
VT

TH T.T

Lindsay PH.2 Lot 6

Lot 6 PH 2 SUGARWOOD
UPG KITCHEN SINK

BLANCO

Sink Specifications

Colour	SKU
brushed finish	401247

Design and planning tips

- Min cabinet size: 36 in (915 mm)

Specifications:
3 ½" (90 mm) stainless steel strainer(s)
Installation instructions
Cut-out template
Mounting clips
Limited lifetime warranty

Depending on cabinet construction, a different cabinet size may be required.

Codes & Standards

ASME A112.19.3-2017/CSA B45.4-17

Optional Accessories

CapFlow Strainer Cover	517666
Ash Cutting Board	406345
Sink Grid	406349

QUATRUS U 2

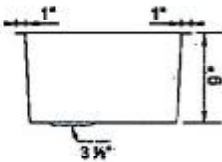
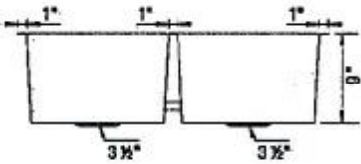
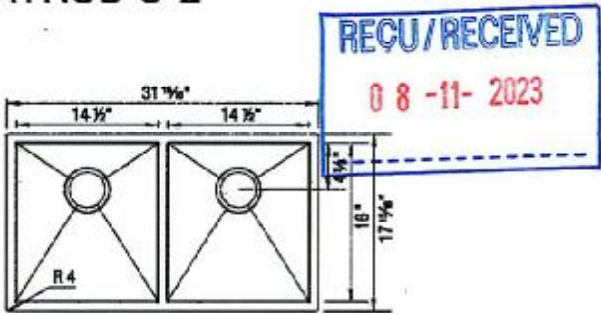

Warranty

Limited lifetime warranty on all sinks and faucets. One-year warranty on all accessories and soap dispensers.

Code/Standards Compliance

BLANCO sinks and faucets are third-party tested and certified to CSA, cUPC, ANSI/ASME, IAPMO and NSF standards and listed by applicable certification bodies. For more information on individual product listings, contact our office or listing organization.



Need support? Learn more by watching our sink & faucet How-to videos:
<https://www.blanco.com/ca-en/support/how-to-videos/how-to-videos-for-sinks/>



BLANCO Canada Inc
100 Corporation Drive
Brampton ON L6S 6B5

Tel & Fax
Tel: 905-494-2400 Toll free: 1-877-425-2626
Fax: 905-494-2425 Toll free: 1-877-825-2626

While BLANCO strives to provide accurate information, all images and dimensions in this document are intended for reference only and are subject to change at any time without notice. This document is not intended for use as an installation guide. For technical installation details, refer to installation instructions provided with the product. BLANCO assumes no responsibility for the use of superseded or voided specifications.

TH TF

