

KINGSMEN (THAMES) INC. / Havelock Corners (Kingsmen)

Lot/Unit: 117 Phase/Building: 5B Model/Floor Plan: Arthur (4205) Elev B 4 Bed - 4+1 Bath

ELECTRICAL

Inv.6415 Line 80676 1Nov23 / 7Nov23	1 - To supply & install the standard T.V. rough in in the great room and master bedroom... see sketch # 1 & # 2 Note:	
Inv.6415 Line 80677 1Nov23 / 7Nov23	1 - To supply & install the standard Phone (CAT5) rough in in the great room, master bedroom and computer niche area ... see sketch # 1 & # 2 Note:	

HEATING AND AIR CONDITIONING

Inv.6415 Line 80674 1Nov23 / 7Nov23	1 - As per schedule "PE": Vendor to install capped gas line (Rough in only) at rear of home for future BBQ location. Location to be finalized at vendors sole discretion. Note:	
Inv.6415 Line 80675 1Nov23 / 7Nov23	1 - As per schedule "PE": Vendor to supply & install air conditioning unit, sized accordingly, from vendors standard samples. Note:	

MISCELLANEOUS

Inv.6415 Line 80678 1Nov23 / 7Nov23	1 - To supply & install the standard COFFERED CEILING in the dining room as per plan.. see sketch # 1 Note:	
Inv.6415 Line 80679 1Nov23 / 7Nov23	1 - Enlarge wall slightly on great room side to accomodate the standard NF-08 F/P mantle. Note:	

EXTRAS AS PER OFFER

5 FREE APPLIANCES ? STAINLESS STEEL FRONT - FRIDGE: STOVE AND DISHWASHER. WHITE WASHER AND DRYER (SUPPLIED ONLY, NOT INSTALLED, FROM BUILDERS STANDARD LINE). AN APPLIANCES VOUCHER WILL BE GIVEN BY OUR DECOR CONSULTANT AT THE TIME OF BOOKING YOUR COLOUR A <i>Worksheet</i> Note:	
5 FREE APPLIANCES – STAINLESS STEEL FRONT - FRIDGE; STOVE AND DISHWASHER. WHITE WASHER AND DRYER (SUPPLIED ONLY, NOT INSTALLED, FROM BUILDERS STANDARD LINE). AN APPLIANCES VOUCHER WILL BE GIVEN BY OUR DECOR CONSULTANT AT THE TIME OF BOOKING YOUR COLOUR A <i>Worksheet</i> Note:	
VENDOR TO INSTALL CAPPED GAS LINE (ROUGH-IN ONLY) AT REAR OF HOME FOR FUTURE BBQ LOCATION. LOCATION TO BE FINALIZED AT VENDORS SOLE DISCRETION. <i>Worksheet</i> Note:	
VENDOR TO SUPPLY & INSTALL AIR CONDITIONING UNIT, SIZED ACCORDINGLY, FROM VENDORS STANDARD SAMPLES. <i>Worksheet</i> Note:	

Purchaser: 2720916 Ontario Inc

Property: 117 of Plan - Draft Approval SB17-03-08

Telephone Res. / Bus: /

Project: KINGSMEN (THAMES) INC.

Decor Advisor: Barbara Coccia

Model and Elevation: Arthur (4205) Elev B 4 Bed - 4+1 Bath

Layout Changes: ☐ Yes ☒ NoSketch Attached: ☒ Yes ☐ No

Exterior Colour Scheme:

1. Cabinetry

	Style and Colour	Counter Top	Hardware
Kitchen / Breakfast	#3 Charleston 3DL Rain Cloud	#1, C/S # 9141 Ice Snow 3cm.	# 12881 Handle
Kitchen Island	#3 Charleston 3DL Rain Cloud	#1, C/S # 9141 Ice Snow 3cm.	# 12881 Handle
Laundry Room	/		
Powder Room	#3 Charleston 3DL Rain Cloud	# 6698-46 Paloma Polar	# 12881 Handle
Main Bathroom	/		
Master Ensuite Bathroom	#3 Charleston 3DL Orchid	# P-344-LM Inukshuk Grey	# 12881 Handle
Second Ensuite Bathroom (If Applicable)	#3 Charleston 3DL Orchid	# P-344-LM Inukshuk Grey	# 12881 Handle
Ens. # 3's bathroom	#3 Charleston 3DL Orchid	# P-344-LM Inukshuk Grey	# 12881 Handle
Ens. # 4's bathroom	#3 Charleston 3DL Orchid	# P-344-LM Inukshuk Grey	# 12881 Handle

Appliances

Custom Size Fridge

☐ Yes ☒ No

Valance Lighting

☐ Yes ☒ No

Microwave / Range Hood

☐ Yes ☒ No

Cooktop / Rangetop

☐ Yes ☒ No

Built in Wall Oven

☐ Yes ☒ No

Slide-in Range

☐ Yes ☒ No

Comment

2. Flooring

	Selection
Foyer	13 x13" Burlingstone White
Main Hall	/
Back Hall	/
Breakfast	13 x13" Burlingstone White
Laundry Room	13x13" Keaton Ice
Kitchen	13 x13" Burlingstone White
Powder Room	13 x13" Burlingstone White
Main Bathroom	Ens. #2's bathroom: 13x13" Keaton Ice
Master Ensuite	13x13" Keaton Ice
Bathroom (If Applicable)	Ens. #3's bathroom: 13x13" Keaton Ice
Mud Room	13 x13" Burlingstone White
Master & Ens. 3'S Shower	floor: 2x2" Inizio Blanco Mosaic
Living Room	Ens. #4's bathroom: 13x13" Keaton Ice
Dining Room	3 1/2" Elements Oak Sturgeon
Family / Great Room	3 1/2" Elements Oak Sturgeon
Den / Library / Study	3 1/2" Elements Oak Sturgeon
Basement Landing (If Applies)	
Lower Landing (If Applicable)	3 1/2" Elements Oak Sturgeon
Upper Landing	(If applicable) 3 1/2" Elements Oak Sturgeon
Upper Hall	& Computer Niche area: Modern Story 1, # 808 Dawn
Master Bedroom	Modern Story 1, # 808 Dawn
Bedroom #2	Modern Story 1, # 808 Dawn
Bedroom #3	Modern Story 1, # 808 Dawn
Bedroom #4	Modern Story 1, # 808 Dawn
Bedroom #5	/
Master & Ens. 3'S Shower	Jamb: Anatolia Marmiline SNOW

SEE ATTACHED FOR SIGNATURES

Flooring Continued on Page 2

Initial: _____

Page 1 of 3

Purchaser: 2720916 Ontario Inc

Property: 117 of Plan - Draft Approval SB17-03-08

Telephone Res. / Bus: /

Project: KINGSMEN (THAMES) INC.

Decor Advisor: Barbara Coccia

Model and Elevation: Arthur (4205) Elev B 4 Bed - 4+1 Bath

4. Flooring - Continued -

Upgrade Underpad	Type	Area
	Standard	2nd. Floor
Carpet on Stairs	Capped	Runner - *Upgrade
Comment	/	/

3. Plumbing Fixtures / Faucets

Kitchen	Standard	Second Ensuite	Standard	Powder Room	Standard
Master Ensuite	Standard			Other Room	/
Main Bathroom	/	Ens. #3's & #4's bathroom	Standard		

Comment

Still to install the standard under mount kitchen sink with the standard single hole kitchen faucet NO PLATE.

4. Wall Tile

	Tile Selection	Listello	Insert	Insert Selection
Main Bathroom	/	<input type="checkbox"/>	<input type="checkbox"/>	
Master Ensuite				
Tub Deck	/	<input type="checkbox"/>	<input type="checkbox"/>	
Tub Apron	/	<input type="checkbox"/>	<input type="checkbox"/>	
Tub Surround	/	<input type="checkbox"/>	<input type="checkbox"/>	
Shower Stall	8X10" Burlingstone White	<input type="checkbox"/>	<input type="checkbox"/>	
Second Ensuite	8X10" Burlingstone White	<input type="checkbox"/>	<input type="checkbox"/>	
Ens. #3's bathroom	8X10" Burlingstone White	<input type="checkbox"/>	<input type="checkbox"/>	
Ens. #4's bathroom	8X10" Burlingstone White	<input type="checkbox"/>	<input type="checkbox"/>	
Kitchen Backsplash	/	<input type="checkbox"/>	<input type="checkbox"/>	
Complete Backsplash	/	<input type="checkbox"/>	<input type="checkbox"/>	

Comment

Install the standard 8x10" wall tiles on the 10" side stacked horizontally in ALL bathrooms where applicable.



horizontal stacked



brick pattern

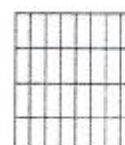

vertical stacked



diagonal/diamond

5. Fireplace

	Living Room			Family Room			Other Room - Specify Great/Study		
	Purchased	As Per Plan	N/A	Purchased	As Per Plan	N/A	Purchased	As Per Plan	N/A
Fireplace Type	<input type="radio"/>	<input type="radio"/>	<input checked="" type="radio"/>	<input type="radio"/>	<input type="radio"/>	<input checked="" type="radio"/>	<input type="radio"/>	<input checked="" type="radio"/>	<input type="radio"/>
Mantle Type							2 sided		
Over Mantle							NF-08 (both sides)		
Colour / Stain							White		
Surround							/		
Hearth							/		

Comment

/

SEE ATTACHED FOR SIGNATURES



Initial: _____

Purchaser: 2720916 Ontario Inc

Property: 117 of Plan - Draft Approval SB17-03-08

Telephone Res. / Bus: /

Project: KINGSMEN (THAMES) INC.

Decor Advisor: Barbara Coccia

Model and Elevation: Arthur (4205) Elev B 4 Bed - 4+1 Bath

6. Trim Carpentry

Door Hardware Standard Handle

Interior Trim Standard

Comment

/

Interior Doors

☐ 2 Panel Arch Top

☒ 2 Panel Square Top

☐ 6 Panel

Initial for Door Style



7. Railings and Pickets

Railing Package Standard Oak STRAIGHT picket package

Railing Colour Elements Sturgeon

Wood Stairs ☐ No ☒ Oak

Picket Colour Elements Sturgeon

Tread Colour Elements Sturgeon

Comment

/

SEE ATTACHED FOR SIGNATURES

8. Plaster Mouldings and Medallions

Foyer

/

Main Hall

/

Living Room

/

Dining Room

/

Family Room

/

Kitchen/Breakfast

/

Den/Library

/

Lower Landing

/

Comment

/

9. Wall Paint

Kingsmen White

Smooth Ceilings

☐ First Floor

☐ First Floor incl. Second Floor Hall

☐ First and Second Floor

☒ Throughout

☐ Not Applicable

Trim Paint Kingsmen White

10. Additional Comments

/

11. Disclaimers and Notes

- Colours of all materials are as close as possible to builder's selection, but not necessarily identical due to variances in manufacturing.
- Any extras listed above are null and void unless accompanied by a separate invoice/amendment. Said invoice must be paid in full.
- The Purchaser acknowledges that after Interior Colour Selection form is signed and dated, no further changes will be permitted other than re-selection due to unavailability. Purchaser's Initials
- The Purchaser acknowledges reading and accepting the "Kingsmen Group Décor Centre Disclaimers" form. This document contains other miscellaneous disclaimers.

This Interior Colour Selection is final and approved by:

Purchaser:

Signature:

SEE ATTACHED FOR SIGNATURES

Vendor:

KINGSMEN (THAMES) INC.

5B-LOT 117

LOT 117
THAMES PH. 5B
SKETCH #1

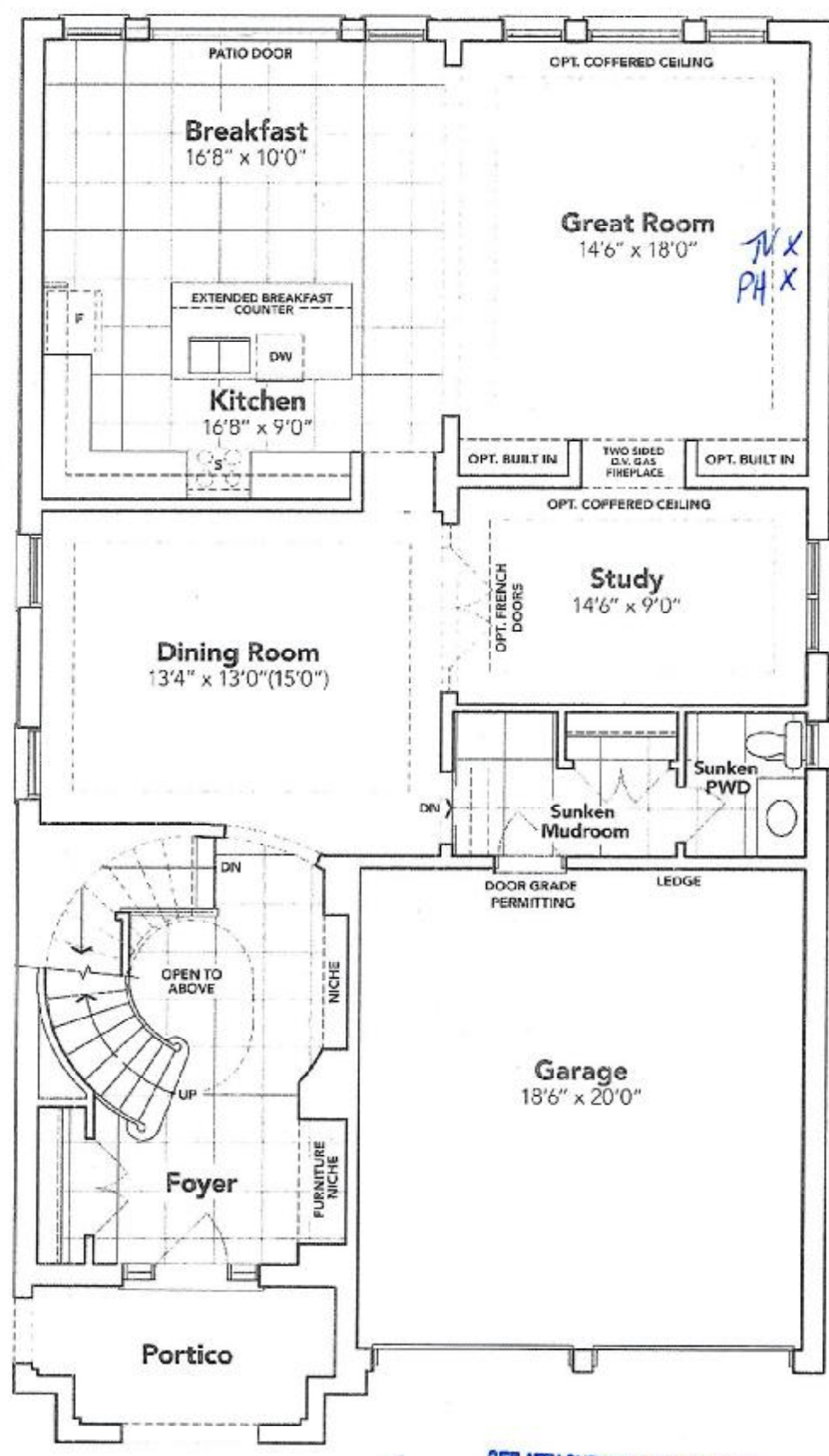

SEE ATTACHED FOR SIGNATURES

GROUND FLOOR EL. B

The floor plans and elevations shown are pre-construction plans and may be revised or improved as necessitated by architectural controls and the construction process. The measurements adhere to the rules and regulations of the TARIION Warranty Corporation's official method for the calculation of floor area. Materials, specifications and floor plans are subject to change without notice. All house renderings are artist's concept only. Actual usable floor space may vary from the stated floor area. All options shown are upgrades. E. & O. E.

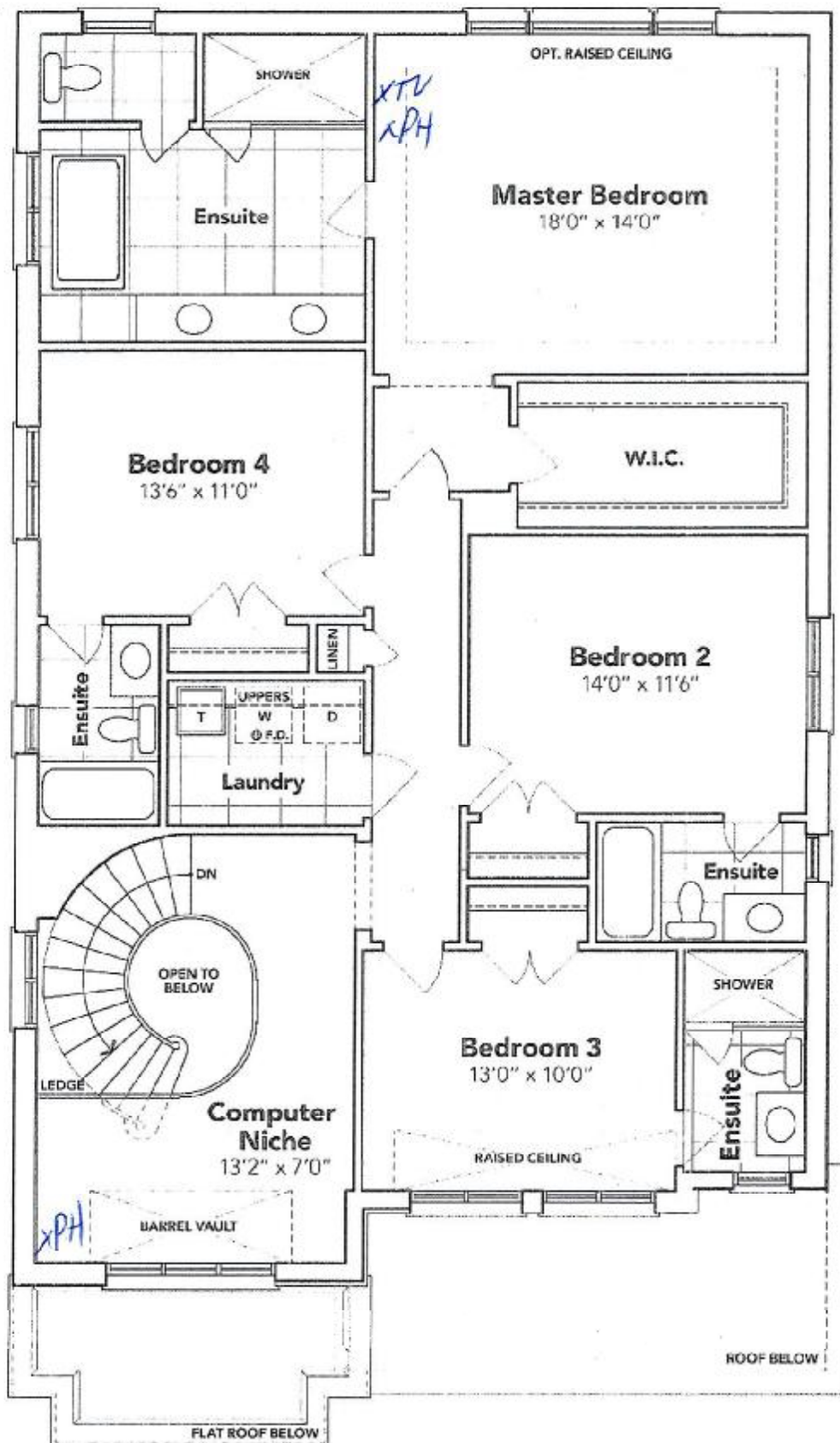

SEE ATTACHED FOR SIGNATURES

SECOND FLOOR EL. B

The floor plans and elevations shown are pre-construction plans and may be revised or improved as necessitated by architectural controls and the construction process. The measurements adhere to the rules and regulations of the TARION Warranty Corporation's official method for the calculation of floor area. Materials, specifications and floor plans are subject to change without notice. All house renderings are artist's concept only. Actual usable floor space may vary from the stated floor area. All options shown are upgrades. E. & O. E.

SCHED E "B-1"
Floor Plan

Lot 117
Phase 5B
Model: Arthur (4205) Elev B 4 Bed - 4+1 Bath
Standard

LOT 117
THAMES PH. 5B
SKETCH #3

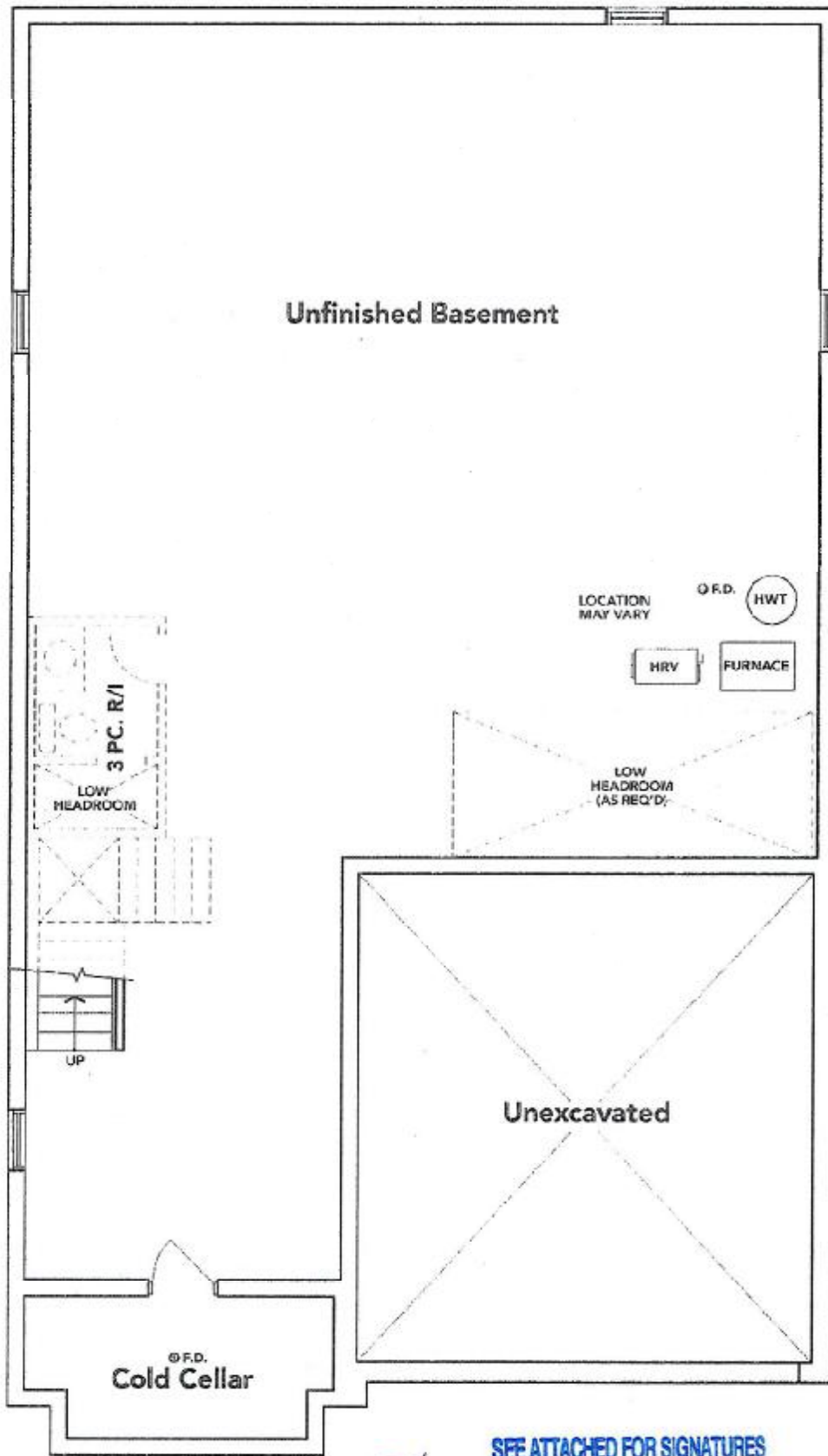

SEE ATTACHED FOR SIGNATURES

BASEMENT EL. B

The floor plans and elevations shown are pre-construction plans and may be revised or improved as necessitated by architectural controls and the construction process. The measurements adhere to the rules and regulations of the TARIION Warranty Corporation's official method for the calculation of floor area. Materials, specifications and floor plans are subject to change without notice. All house renderings are artist's concept only. Actual usable floor space may vary from the stated floor area. All options shown are upgrades. E. & O. E.