

KINGSMEN (THAMES) INC. / Havelock Corners (Kingsmen)

Lot/Unit: 122 Phase/Building: 5B Model/Floor Plan: Louis (4203) Elev C 4 Bed - 4+1 Bath

ELECTRICAL

Inv.6407	1 - To supply & install the standard T.V. rough in in the great room and master bedroom... see sketch # 1 & # 2	
Line 80625	Note: Install the standard T.V. rough in at approx. 66" + - up from the floor centered + - to the F/P mantle.	
25Oct23 / 25Oct23		
Inv.6407	1 - To supply & install the standard Phone (CAT5) rough in in the great room, master bedroom and bedroom #3 ... see sketch # 1 & # 2	
Line 80626	Note: Install the standard Phone (CAT 5) rough in at approx. 66" + - up from the floor centered + - to the F/P mantle.	
25Oct23 / 25Oct23		
Inv.6407	1 - To SUPPLY AND INSTALL AN ADDITIONAL BASIC RECEPTACLE (NOT DEDICATED) at approx. 66" + - up from the floor centered + - to the F/P mantle	
Line 80627	Note: in the great room... see sketch #1	
25Oct23 / 25Oct23		
This is for a future wall mount T.V. NO CONDUIT PIPE HAS BEEN PURCHASED.		

HEATING AND AIR CONDITIONING

Inv.6407	1 - As per schedule "PE": Vendor to install capped gas line (Rough in only) at rear of home for future BBQ location. Location to be finalized at vendors sole discretion.	
Line 80623	Note:	
25Oct23 / 25Oct23		
Inv.6407	1 - As per schedule "PE": Vendor to supply & install air conditioning unit, sized accordingly, from vendors standard samples.	
Line 80624	Note:	
25Oct23 / 25Oct23		

EXTRAS AS PER OFFER

5 FREE APPLIANCES ? STAINLESS STEEL FRONT - FRIDGE: STOVE AND DISHWASHER. WHITE WASHER AND DRYER (SUPPLIED ONLY, NOT INSTALLED, FROM BUILDERS STANDARD LINE). AN APPLIANCES VOUCHER WILL BE GIVEN BY OUR DECOR CONSULTANT AT THE TIME OF BOOKING YOUR COLOUR A <i>Worksheet</i> Note:	
VENDOR TO INSTALL CAPPED GAS LINE (ROUGH-IN ONLY) AT REAR OF HOME FOR FUTURE BBQ LOCATION. LOCATION TO BE FINALIZED AT VENDORS SOLE DISCRETION. <i>Worksheet</i> Note:	
VENDOR TO SUPPLY & INSTALL AIR CONDITIONING UNIT, SIZED ACCORDINGLY, FROM VENDORS STANDARD SAMPLES. <i>Worksheet</i> Note:	

Purchaser: JASDEEP MANDER,

Property: 122 of Plan - Draft Approval SB17-03-08

Telephone Res. / Bus: (416) 833-8505 /

Project: KINGSMEN (THAMES) INC.

Decor Advisor: Barbara Coccia

Model and Elevation: Louis (4203) Elev C 4 Bed - 4+1 Bath

Layout Changes: ☐ Yes ☒ No

Sketch Attached: ☒ Yes ☐ No

Exterior Colour Scheme:

1. Cabinetry

	Style and Colour	Counter Top	Hardware
Kitchen / Breakfast	#3 Muskoka Navy Blue	#1, C/S # 9141 Ice Snow 3cm.	#12881 Handle
Kitchen Island	#3 Muskoka Navy Blue	#1, C/S # 9141 Ice Snow 3cm.	#12881 Handle
Laundry Room	/		
Powder Room	#3 Muskoka Navy Blue	# 4925K-07 Calcutta Marble	#12881 Handle
Main Bathroom	/		
Master Ensuite Bathroom	#2 Huron Ontario White	# 4926K-07 Black Alicante	#12881 Handle
Second Ensuite Bathroom (If Applicable)	#3 Simcoe Orchid	# 4924-38 White Carrara	#12881 Handle
Ens. #3's Bathroom:	#3 Simcoe Orchid	# 4924-38 White Carrara	#12881 Handle
Ens. #4's Bathroom:	#3 Simcoe Orchid	# 4924-38 White Carrara	#12881 Handle

Appliances

Custom Size Fridge
☐ Yes ☒ No

Cooktop / Rangetop
☐ Yes ☒ No

Valance Lighting
☐ Yes ☒ No

Built in Wall Oven
☐ Yes ☒ No

Microwave / Range Hood
☐ Yes ☒ No

Slide-in Range
☐ Yes ☒ No

Comment

2. Flooring

	Selection
Foyer	13x13" Burlingstone White
Main Hall	3 1/2" Elements Oak Wolfhound
Back Hall	/
Breakfast	Including pantry: 13x13" Burlingstone White
Laundry Room	13x13" Malena Carbon
Kitchen	13x13" Burlingstone White
Powder Room	13x13" Burlingstone White
Main Bathroom	Ens. #2's bathroom: 13x13" Malena Carbon
Master Ensuite	13x13" Cinq Black
Bathroom (If Applicable)	Ens. #3's bathroom: 13x13" Malena Carbon
Mud Room	13x13" Burlingstone White
Master ens. & Ens. #2's	Shower floor: 2x2" Inizio Blanco Mosaic
Living Room	Sitting room: 3 1/2" Elements Oak Wolfhound
Dining Room	Ens. #4's bathroom: 13x13" Malena Carbon
Family / Great Room	3 1/2" Elements Oak Wolfhound
Den / Library / Study	/
Basement Landing (If Applies)	
Lower Landing (If Applicable)	3 1/2" Elements Oak Wolfhound
Upper Landing	(if applicable) 3 1/2" Elements Oak Wolfhound
Upper Hall	Modern Story 1, # 927 Morning Rain
Master Bedroom	Modern Story 1, # 927 Morning Rain
Bedroom #2	Modern Story 1, # 927 Morning Rain
Bedroom #3	Modern Story 1, # 927 Morning Rain
Bedroom #4	Modern Story 1, # 927 Morning Rain
Bedroom #5	/
Master ens. & Ens. #2's	shower jamb: Anatolia Marmiline SNOW

Purchaser: JASDEEP MANDER,

Property: 122 of Plan - Draft Approval SB17-03-08

Telephone Res. / Bus: (416) 833-8505 /

Project: KINGSMEN (THAMES) INC.

Decor Advisor: Barbara Coccia

Model and Elevation: Louis (4203) Elev C 4 Bed - 4+1 Bath

2. Flooring - Continued -

Upgrade Underpad	Type Standard	Area 2nd. floor
Carpet on Stairs	Capped	Runner - *Upgrade
Comment	/	/

3. Plumbing Fixtures / Faucets

Kitchen	Standard	Second Ensuite	Standard	Powder Room	Standard
Master Ensuite	Standard			Other Room	/
Main Bathroom	/	Ens. #3 & #4's bathroom	Standard		

Comment

Still to install the standard under mount kitchen sink with the standard single hole kitchen faucet NO PLATE.

4. Wall Tile

	Tile Selection	Listello	Insert	Insert Selection
Main Bathroom	/	<input type="checkbox"/>	<input type="checkbox"/>	
Master Ensuite				
Tub Deck	/	<input type="checkbox"/>	<input type="checkbox"/>	
Tub Apron	/	<input type="checkbox"/>	<input type="checkbox"/>	
Tub Surround	/	<input type="checkbox"/>	<input type="checkbox"/>	
Shower Stall	8X10" Weave White	<input type="checkbox"/>	<input type="checkbox"/>	
Second Ensuite	8x10" Uniwall White	<input type="checkbox"/>	<input type="checkbox"/>	
Ens. #3's bathroom	8x10" Uniwall White	<input type="checkbox"/>	<input type="checkbox"/>	
Ens. #4's bathroom	8x10" Uniwall White	<input type="checkbox"/>	<input type="checkbox"/>	
Kitchen Backsplash	/	<input type="checkbox"/>	<input type="checkbox"/>	
Complete Backsplash	/	<input type="checkbox"/>	<input type="checkbox"/>	

Comment

Install the standard 8x10" wall tiles on the 10" Side stacked horizontally in Ens. #2, #3 & #4's bathroom ONLY.



horizontal stacked



brick pattern



vertical stacked



diagonal/diamond

5. Fireplace

	Living Room			Family Room			Other Room - Specify Great Room		
	Purchased	As Per Plan	N/A	Purchased	As Per Plan	N/A	Purchased	As Per Plan	N/A
Fireplace Type	<input type="radio"/>	<input type="radio"/>	<input checked="" type="radio"/>	<input type="radio"/>	<input type="radio"/>	<input checked="" type="radio"/>	<input type="radio"/>	<input checked="" type="radio"/>	<input type="radio"/>
Mantle Type							Front Facing		
Over Mantle							NF-08		
Colour / Stain							/		
Surround							White		
Hearth							/		
Comment	/								

Initial:

Page 2 of 3

Purchaser: JASDEEP MANDER,
Telephone Res. / Bus: (416) 833-8505 /
Decor Advisor: Barbara Coccia

Property: 122 of Plan - Draft Approval SB17-03-08
Project: KINGSMEN (THAMES) INC.
Model and Elevation: Louis (4203) Elev C 4 Bed - 4+1 Bath

6. Trim Carpentry

Door Hardware Standard Handle

Interior Trim Standard

Comment

/

Interior Doors

☐ 2 Panel Arch Top

☒ 2 Panel Square Top

☐ 6 Panel



Initial for Door Style



7. Railings and Pickets

Railing Package Standard oak STRAIGHT picket package

Railing Colour Elements Wolfhound

Picket Colour Elements Wolfhound

Wood Stairs ☐ No ☒ Oak

Tread Colour Elements Wolfhound

Comment

/

8. Plaster Mouldings and Medallions

Foyer /

Main Hall /

Living Room /

Dining Room /

Family Room /

Kitchen/Breakfast /

Den/Library /

Lower Landing /

Comment

/

9. Wall Paint

Kingsmen White

Smooth Ceilings

☐ First Floor

☐ First Floor incl. Second Floor Hall

☐ First and Second Floor

☒ Throughout

☐ Not Applicable

Trim Paint Kingsmen White

10. Additional Comments

/

11. Disclaimers and Notes

- Colours of all materials are as close as possible to builder's selection, but not necessarily identical due to variances in manufacturing.
- Any extras listed above are null and void unless accompanied by a separate invoice/amendment. Said invoice must be paid in full.
- The Purchaser acknowledges that after Interior Colour Selection form is signed and dated, no further changes will be permitted other than re-selection due to unavailability. Purchaser's Initials
- The Purchaser acknowledges reading and accepting the "Kingsmen Group Décor Centre Disclaimers" form. This document contains other miscellaneous disclaimers.

This Interior Colour Selection is final and approved by:

Purchaser:

Signature: **Date:** Oct/25/23

Vendor:

KINGSMEN (THAMES) INC.

LOT 122
THAMES PH. 5B
SKETCH #1

all 3 items
@ 66" ± up
from floor.

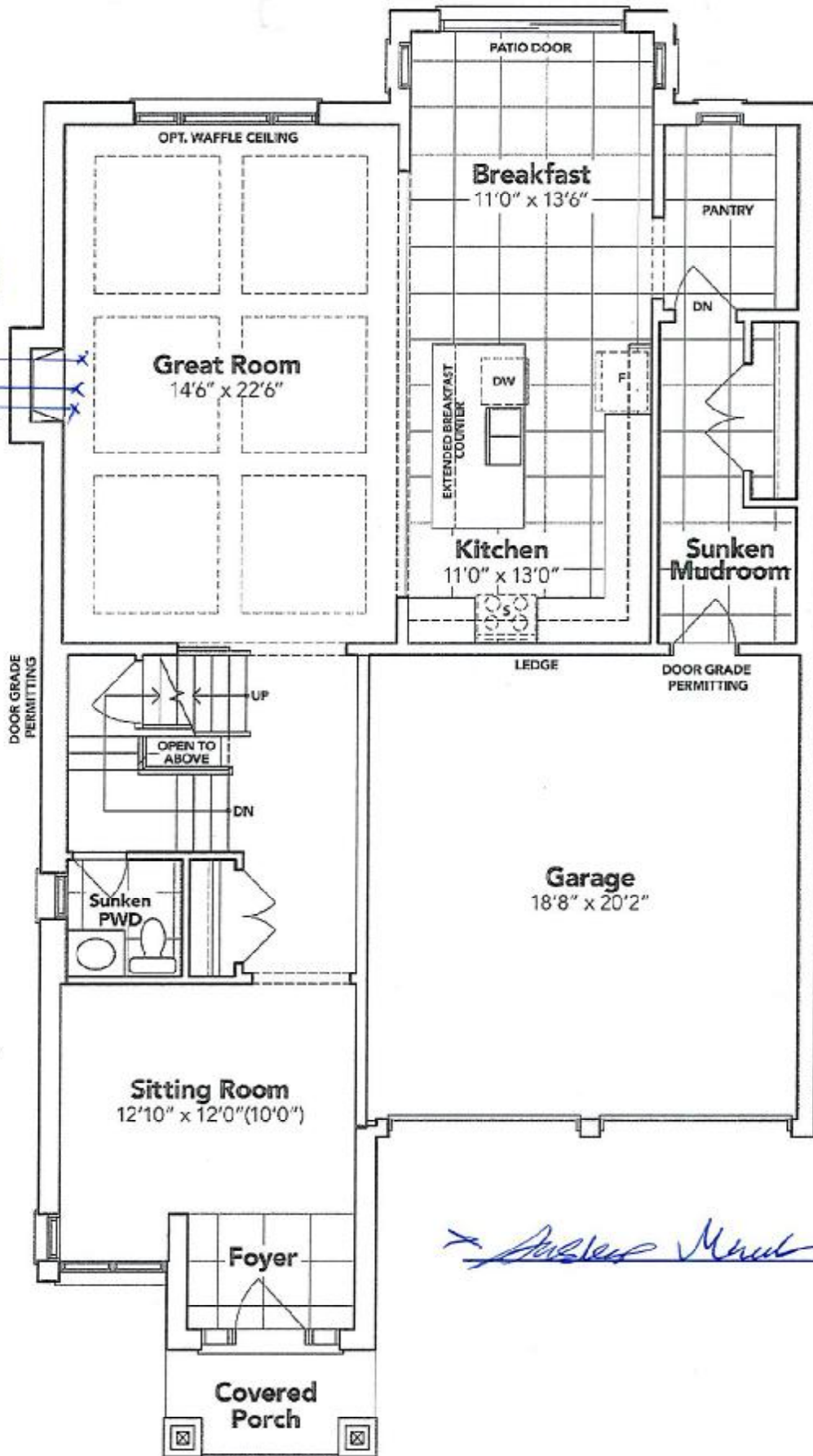

Sketch #1

GROUND FLOOR EL. C

The floor plans and elevations shown are pre-construction plans and may be revised or improved as necessitated by architectural controls and the construction process. The measurements adhere to the rules and regulations of the TARION Warranty Corporation's official method for the calculation of floor area. Materials, specifications and floor plans are subject to change without notice. All house renderings are artist's concept only. Actual usable floor space may vary from the stated floor area. All options shown are upgrades. E. & O. E.

5B-LOT 1002

LOT 122
THAMES PH. 5B
SKETCH #2

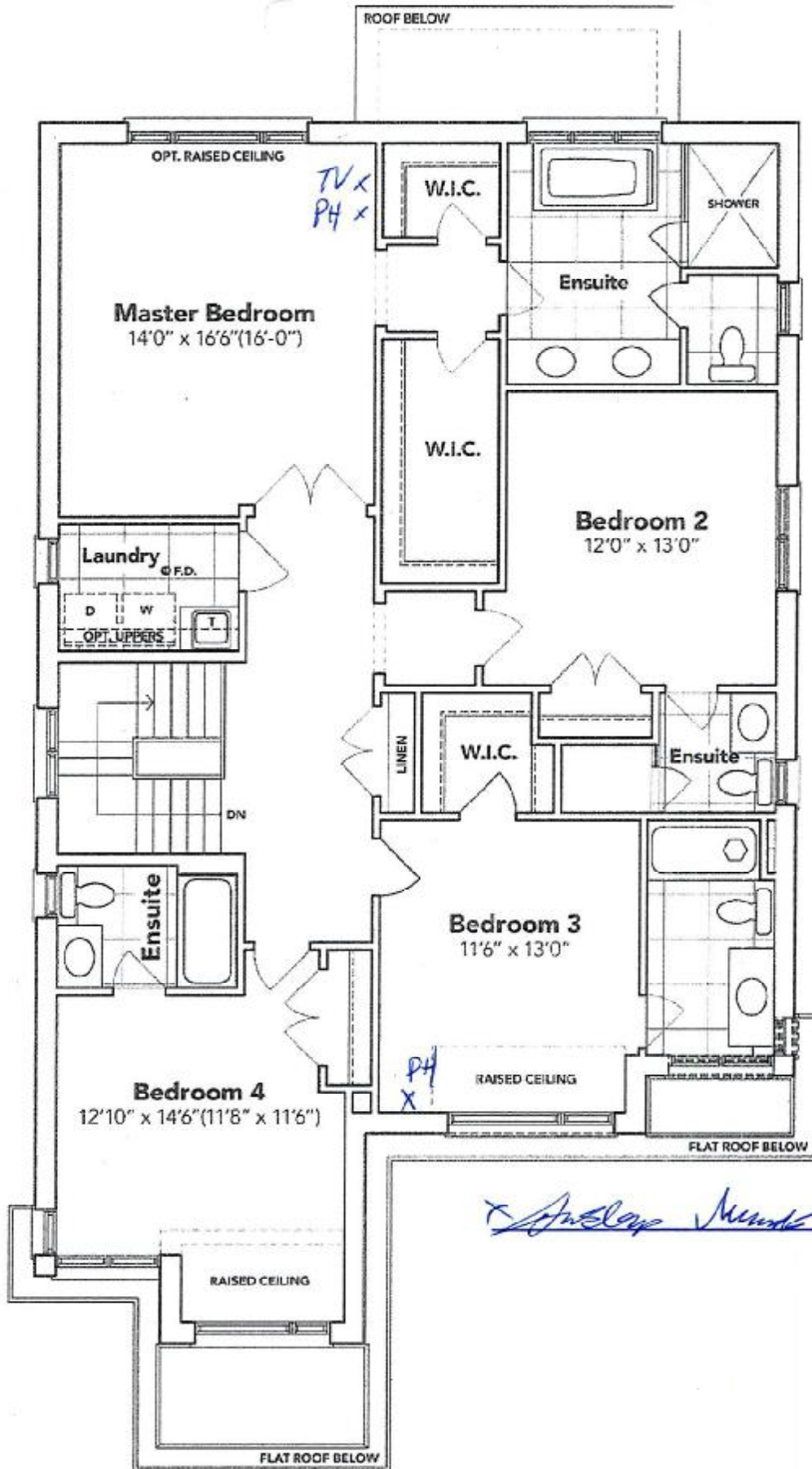

SECOND FLOOR EL. C

The floor plans and elevations shown are pre-construction plans and may be revised or improved as necessitated by architectural controls and the construction process. The measurements adhere to the rules and regulations of the TARION Warranty Corporation's official method for the calculation of floor area. Materials, specifications and floor plans are subject to change without notice. All house renderings are artist's concept only. Actual usable floor space may vary from the stated floor area. All options shown are upgrades. E. & O. E.

SCHEDULE "B-1"
Floor Plan

Model: Louis (4203) Elev C 4 Bed - 4+1 Bath
Standard

SB-122

Lot 122
Phase 5B

LOT 122
THAMES PH. 5B
SKETCH #3

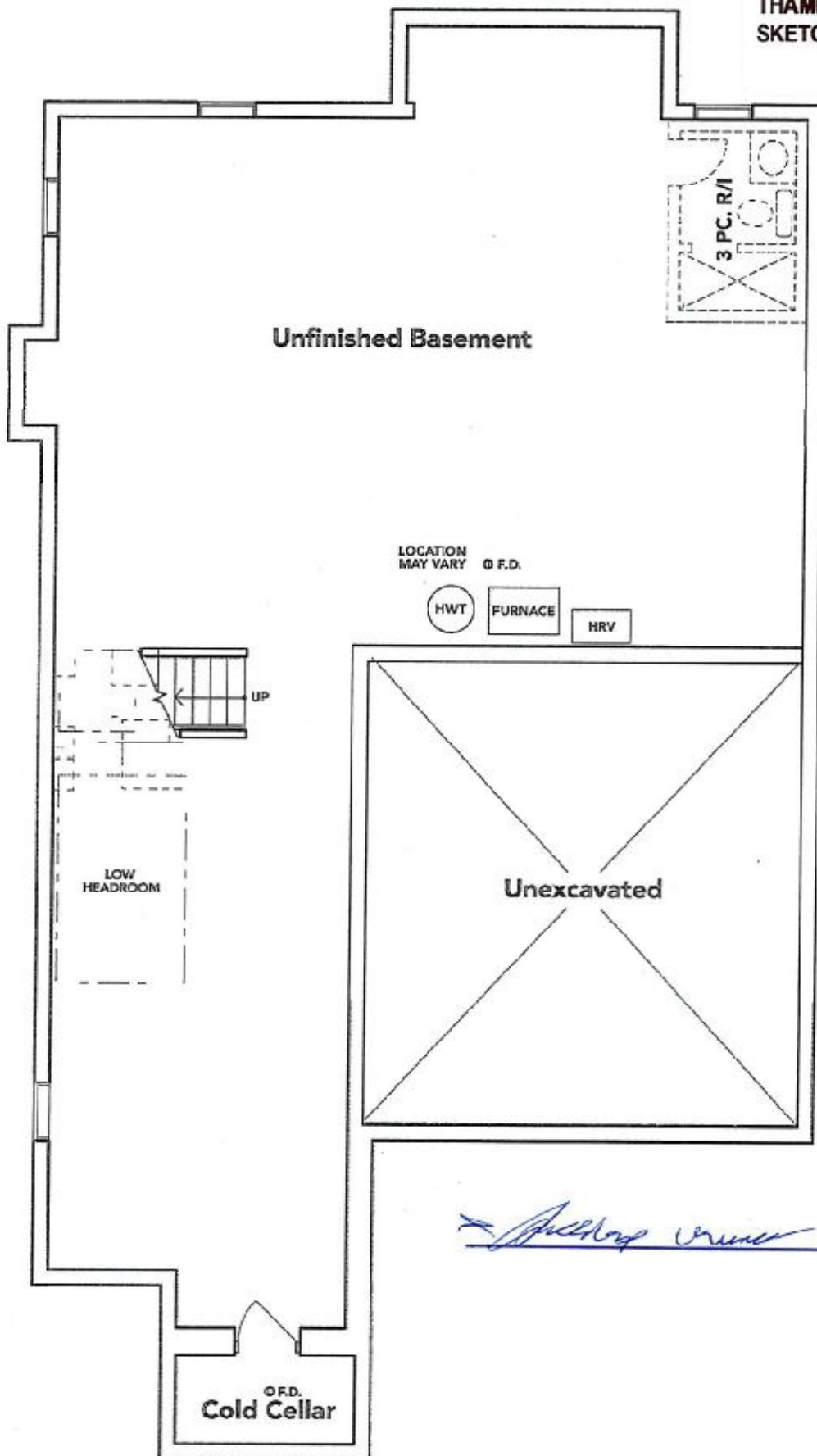

BASEMENT EL. C

The floor plans and elevations shown are pre-construction plans and may be revised or improved as necessitated by architectural controls and the construction process. The measurements adhere to the rules and regulations of the TARIION Warranty Corporation's official method for the calculation of floor area. Materials, specifications and floor plans are subject to change without notice. All house renderings are artist's concept only. Actual usable floor space may vary from the stated floor area. All options shown are upgrades. E. & O. E.