

KINGSMEN (THAMES) INC. / Havelock Corners (Kingsmen)

Lot/Unit: 64 Phase/Building: 5B Model/Floor Plan: Andrew (3603) Elev A 4 Bed - 2+1 Bath

ELECTRICAL

Inv.6390	1 - To supply & install the standard T.V. rough in in the great room and master bedroom... see sketch # 1 & # 2	
Line 80328	Note: Install the standard T.V. rough in at approx. 66" + - up from the floor centered + - to the F/P mantle.	
25Sep23 / 2Oct23		
Inv.6390	1 - To supply & install the standard Phone (CAT5) rough in in the great room, master bedroom and bedroom # 4 ... see sketch # 1 & # 2	
Line 80329	Note: Install the standard Phone (CAT 5) rough in at approx. 66" + - up from the floor centered + - to the F/P mantle.	
25Sep23 / 2Oct23		
Inv.6390	1 - To SUPPLY AND INSTALL AN ADDITIONAL BASIC RECEPTACLE (NOT DEDICATED) at approx. 66" + - up from the floor centered + - to the F/P mantle	
Line 80347	Note: in the great room... see sketch # 1	
25Sep23 / 2Oct23		
This is for a future wall mount T.V. NO CONDUIT PIPE HAS BEEN PURCHASED.		

HEATING AND AIR CONDITIONING

Inv.6390	1 - As per schedule "PE": Vendor to install capped gas line (Rough in only) at rear of home for future BBQ location. Location to be finalized at vendors sole discretion.	
Line 80326	Note:	
25Sep23 / 2Oct23		
Inv.6390	1 - As per schedule "PE": Vendor to supply & install air conditioning unit, sized accordingly, from vendors standard samples.	
Line 80327	Note:	
25Sep23 / 2Oct23		

MISCELLANEOUS

Inv.6390	1 - To supply & install the standard COFFERED CEILING in the dinette area as per plan..see sketch #1	
Line 80330	Note:	
25Sep23 / 2Oct23		

EXTRAS AS PER OFFER

5 FREE APPLIANCES ? STAINLESS STEEL FRONT - FRIDGE: STOVE AND DISHWASHER. WHITE WASHER AND DRYER (SUPPLIED ONLY, NOT INSTALLED, FROM BUILDERS STANDARD LINE). AN APPLIANCES VOUCHER WILL BE GIVEN BY OUR DECOR CONSULTANT AT THE TIME OF BOOKING YOUR COLOUR A <i>Worksheet</i> Note:		
VENDOR TO INSTALL CAPPED GAS LINE (ROUGH-IN ONLY) AT REAR OF HOME FOR FUTURE BBQ LOCATION. LOCATION TO BE FINALIZED AT VENDORS SOLE DISCRETION. <i>Worksheet</i> Note:		
VENDOR TO SUPPLY & INSTALL AIR CONDITIONING UNIT, SIZED ACCORDINGLY, FROM VENDORS STANDARD SAMPLES. <i>Worksheet</i> Note:		

Purchasers: GURCHARAN, SINGH GILL, & BALJIT GILL Property: 64 of Plan - Draft Approval SB17-03-08
Telephone Res. / Bus: / Project: KINGSMEN (THAMES) INC.
Decor Advisor: Barbara Coccia Model and Elevation: Andrew (3603) Elev A 4 Bed - 2+1 Bath
Layout Changes: ☐ Yes ☒ No Sketch Attached: ☒ Yes ☐ No Exterior Colour Scheme: _____

1. Cabinetry	Style and Colour	Counter Top	Hardware
Kitchen / Breakfast	#3 Charleston 3 DL Moonlight	#1, C/S # 9141 Ice Snow 3cm.	# 135 Knob
Kitchen Island	#3 Charleston 3 DL Moonlight	#1, C/S # 9141 Ice Snow 3cm.	# 135 Knob
Laundry Room	/		
Powder Room	#3 Charleston 3 DL Moonlight	# 4925K-07 Calcutta Marble	# 135 Knob
Main Bathroom	#3 Charleston 3 DL Moonlight	# 4925K-07 Calcutta Marble	# 135 Knob
Master Ensuite Bathroom	#3 Charleston 3 DL Moonlight	# 4925K-07 Calcutta Marble	# 135 Knob
Second Ensuite Bathroom (If Applicable)	/		
	/		
	/		

Appliances	Custom Size Fridge <input type="radio"/> Yes <input checked="" type="radio"/> No	Valance Lighting <input type="radio"/> Yes <input checked="" type="radio"/> No	Microwave / Range Hood <input type="radio"/> Yes <input checked="" type="radio"/> No
	Cooktop / Rangetop <input type="radio"/> Yes <input checked="" type="radio"/> No	Built in Wall Oven <input type="radio"/> Yes <input checked="" type="radio"/> No	Slide-in Range <input type="radio"/> Yes <input checked="" type="radio"/> No
Comment	<div></div>		

2. Flooring	Selection
Foyer	13x13" Malena Ice
Main Hall	13x13" Malena Ice
Back Hall	/
Breakfast	/
Laundry Room	13x13" Malena Ice
Kitchen	13x13" Malena Ice
Powder Room	13x13" Malena Ice
Main Bathroom	13x13" Malena Ice
Master Ensuite	13x13" Malena Ice
Bathroom (If Applicable)	/
Mud Room	13x13" Malena Ice
Master ens. shower floor:	2x2" Ontario Snow White Matte
Living Room	/
Dining Room	(Dinette) 3 1/2" Elements Oak Natural
Family / Great Room	3 1/2" Elements Oak Natural
Den / Library / Study	/
Basement Landing (If Applies)	
Lower Landing (If Applicable)	3 1/2" Elements Oak Natural
Upper Landing	(if applicable) 3 1/2" Elements Oak Natural
Upper Hall	Modern Story 1, # 945 Felt Hat
Master Bedroom	Modern Story 1, # 945 Felt Hat
Bedroom #2	Modern Story 1, # 945 Felt Hat
Bedroom #3	Modern Story 1, # 945 Felt Hat
Bedroom #4	Modern Story 1, # 945 Felt Hat
Bedroom #5	/
Master ens. shower jamb:	Anatolia Marmiline SNOW

SEE ATTACHED FOR SIGNATURES

B. K. 

Flooring Continued on Page 2

Initial:

Purchasers: GURCHARAN, SINGH GILL, & BALJIT GILL **Property:** 64 of Plan - Draft Approval SB17-03-08
Telephone Res. / Bus: / **Project:** KINGSMEN (THAMES) INC.
Decor Advisor: Barbara Coccia **Model and Elevation:** Andrew (3603) Elev A 4 Bed - 2+1 Bath
 2. Flooring - Continued -

Upgrade Underpad	Type	Area
	Standard	2nd. floor
Carpet on Stairs	Capped	Runner - *Upgrade
Comment	/	/

3. Plumbing Fixtures / Faucets

Kitchen	Standard	Second Ensuite	/	Powder Room	Standard
Master Ensuite	Standard			Other Room	/
Main Bathroom	Standard		/		

Comment
 Still to install the standard top mount kitchen sink.

4. Wall Tile

	Tile Selection	Listello	Insert	Insert Selection
Main Bathroom	8x10" Malena Ice	<input type="checkbox"/>	<input type="checkbox"/>	
Master Ensuite				
Tub Deck	13x13" Malena Ice	<input type="checkbox"/>	<input type="checkbox"/>	
Tub Apron	13x13" Malena Ice	<input type="checkbox"/>	<input type="checkbox"/>	
Tub Surround	13x13" Malena Ice	<input type="checkbox"/>	<input type="checkbox"/>	
Shower Stall	8x10" Malena Ice	<input type="checkbox"/>	<input type="checkbox"/>	
Second Ensuite	/	<input type="checkbox"/>	<input type="checkbox"/>	
	/	<input type="checkbox"/>	<input type="checkbox"/>	
	/	<input type="checkbox"/>	<input type="checkbox"/>	
Kitchen Backsplash	/	<input type="checkbox"/>	<input type="checkbox"/>	
Complete Backsplash	/	<input type="checkbox"/>	<input type="checkbox"/>	

Comment
 /

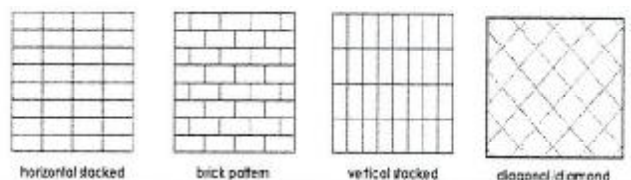

5. Fireplace

	Living Room			Family Room			Other Room - Specify Great Room		
	Purchased	As Per Plan	N/A	Purchased	As Per Plan	N/A	Purchased	As Per Plan	N/A
Fireplace Type	<input type="radio"/>	<input type="radio"/>	<input checked="" type="radio"/>	<input type="radio"/>	<input type="radio"/>	<input checked="" type="radio"/>	<input type="radio"/>	<input checked="" type="radio"/>	<input type="radio"/>
Mantle Type							Front Facing		
Over Mantle							NF-08		
Colour / Stain							/		
Surround							White		
Hearth							/		
Comment							/		

SEE ATTACHED FOR SIGNATURES

Initial:

Purchasers: GURCHARAN, SINGH GILL, & BALJIT GILL Property: 64 of Plan - Draft Approval SB17-03-08
 Telephone Res. / Bus: / Project: KINGSMEN (THAMES) INC.
 Decor Advisor: Barbara Coccia Model and Elevation: Andrew (3603) Elev A 4 Bed - 2+1 Bath

6. Trim Carpentry

Door Hardware Standard Handle

Interior Trim Standard

Comment

/

Interior Doors

☐ 2 Panel Arch Top

☒ 2 Panel Square Top

☐ 6 Panel

Initial for Door Style

BK

7. Railings and Pickets

Railing Package Standard Oak STRAIGHT picket package

Railing Colour Elements Natural

Picket Colour Elements Natural

Wood Stairs ☐ No ☒ Oak

Tread Colour Elements Natural

Comment

/

SEE ATTACHED FOR SIGNATURES

8. Plaster Mouldings and Medallions

Foyer

/

Kitchen/Breakfast

/

Main Hall

/

Den/Library

/

Living Room

/

Lower Landing

/

Dining Room

/

Family Room

/

Comment

/

9. Wall Paint

Kingsmen White

Smooth Ceilings

☐ First Floor

☐ First Floor incl. Second Floor Hall

☐ First and Second Floor

☒ Throughout

☐ Not Applicable

Trim Paint Kingsmen White

10. Additional Comments

/

11. Disclaimers and Notes

- Colours of all materials are as close as possible to builder's selection, but not necessarily identical due to variances in manufacturing.
- Any extras listed above are null and void unless accompanied by a separate invoice/amendment. Said invoice must be paid in full.
- The Purchaser acknowledges that after Interior Colour Selection form is signed and dated, no further changes will be permitted other than re-selection due to unavailability.  Purchaser's Initials
- The Purchaser acknowledges reading and accepting the "Kingsmen Group Décor Centre Disclaimers" form. This document contains other miscellaneous disclaimers.

This Interior Colour Selection is final and approved by:

Purchaser:

Signature: Baljit Gill Date: Oct 2 - 2023

SEE ATTACHED FOR SIGNATURES

Signature:

Date:

Vendor:

KINGSMEN (THAMES) INC.

5B-Lot 64

LOT 64
THAMES PH. 5B
SKETCH #1

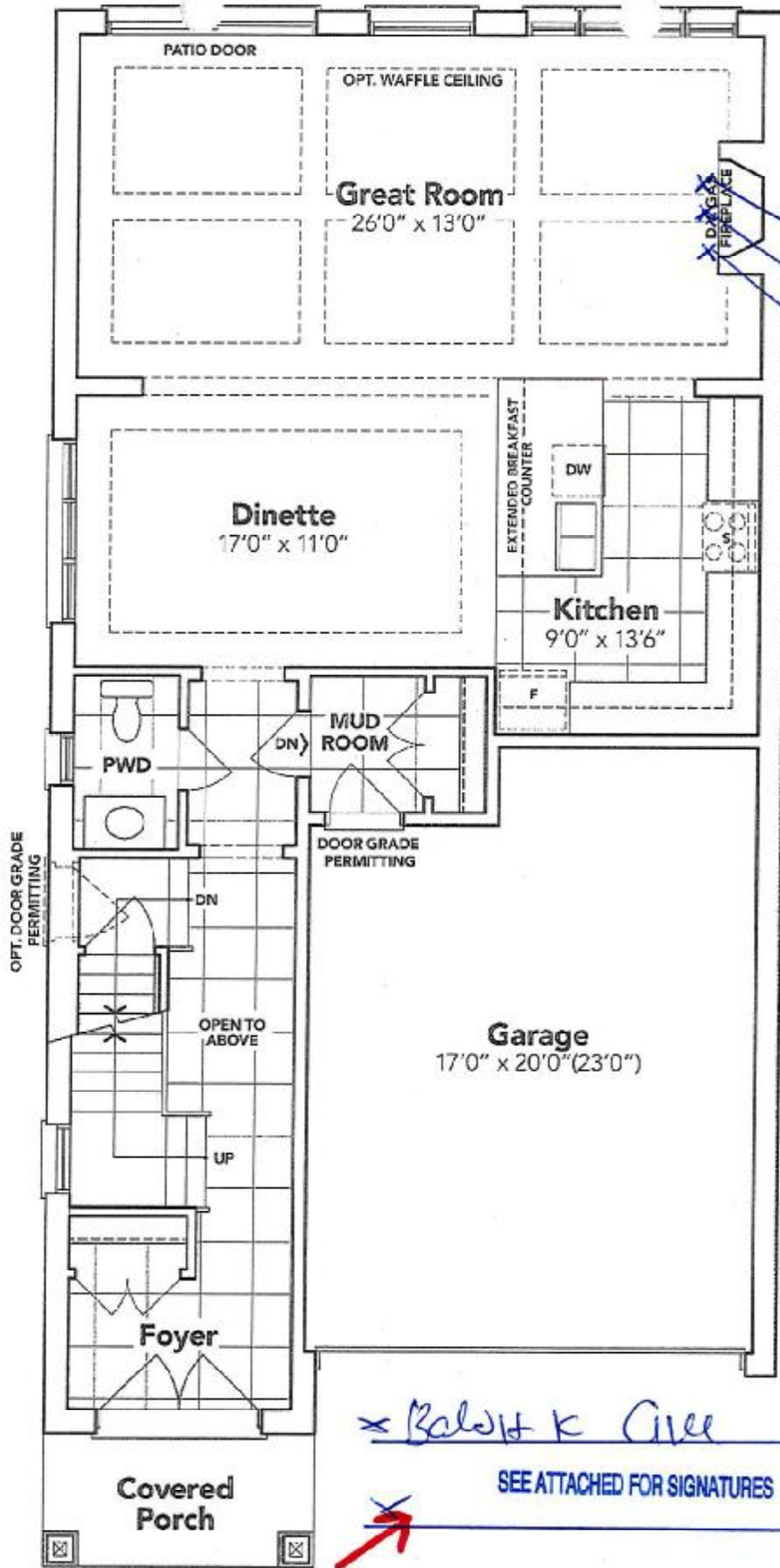

GROUND FLOOR EL. A

The floor plans and elevations shown are pre-construction plans and may be revised or improved as necessitated by architectural controls and the construction process. The measurements adhere to the rules and regulations of the TARION Warranty Corporation's official method for the calculation of floor area. Materials, specifications and floor plans are subject to change without notice. All house renderings are artist's concept only. Actual usable floor space may vary from the stated floor area. All options shown are upgrades. E. & O. E.

SB-Lot 64

LOT 64
THAMES PH. 5B
SKETCH #2

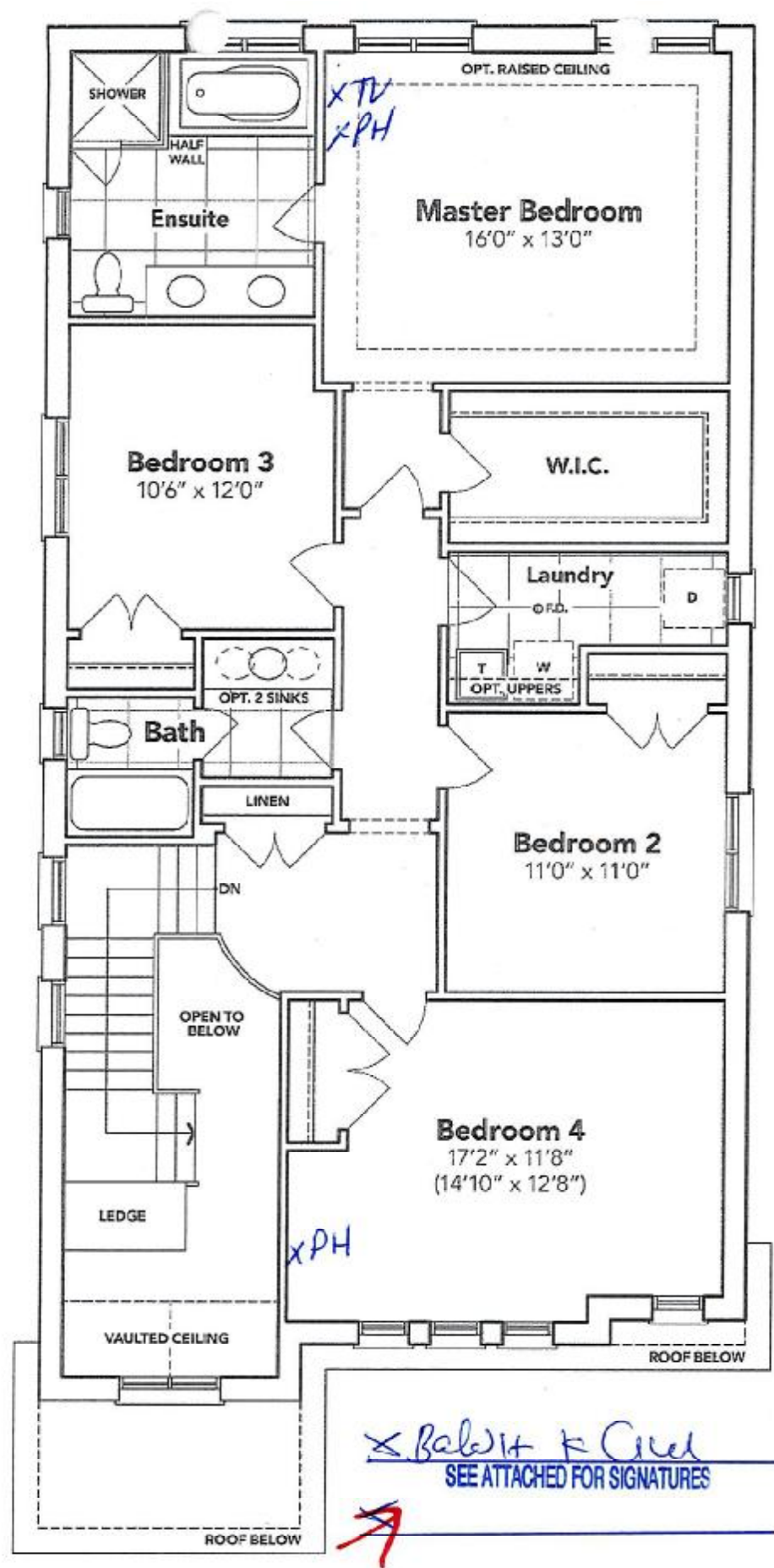

SECOND FLOOR EL. A

The floor plans and elevations shown are pre-construction plans and may be revised or improved as necessitated by architectural controls and the construction process. The measurements adhere to the rules and regulations of the TARION Warranty Corporation's official method for the calculation of floor area. Materials, specifications and floor plans are subject to change without notice. All house renderings are artist's concept only. Actual usable floor space may vary from the stated floor area. All options shown are upgrades. E. & O. E.

SCHEDULE "B-1"
Floor Plan

Model: Andrew (3603) Elev A 4 Bed - 2+1 Bath
Standard

5B-64
Lot 64

Phase 5B

Standard

LOT 64
THAMES PH. 5B
SKETCH # 3

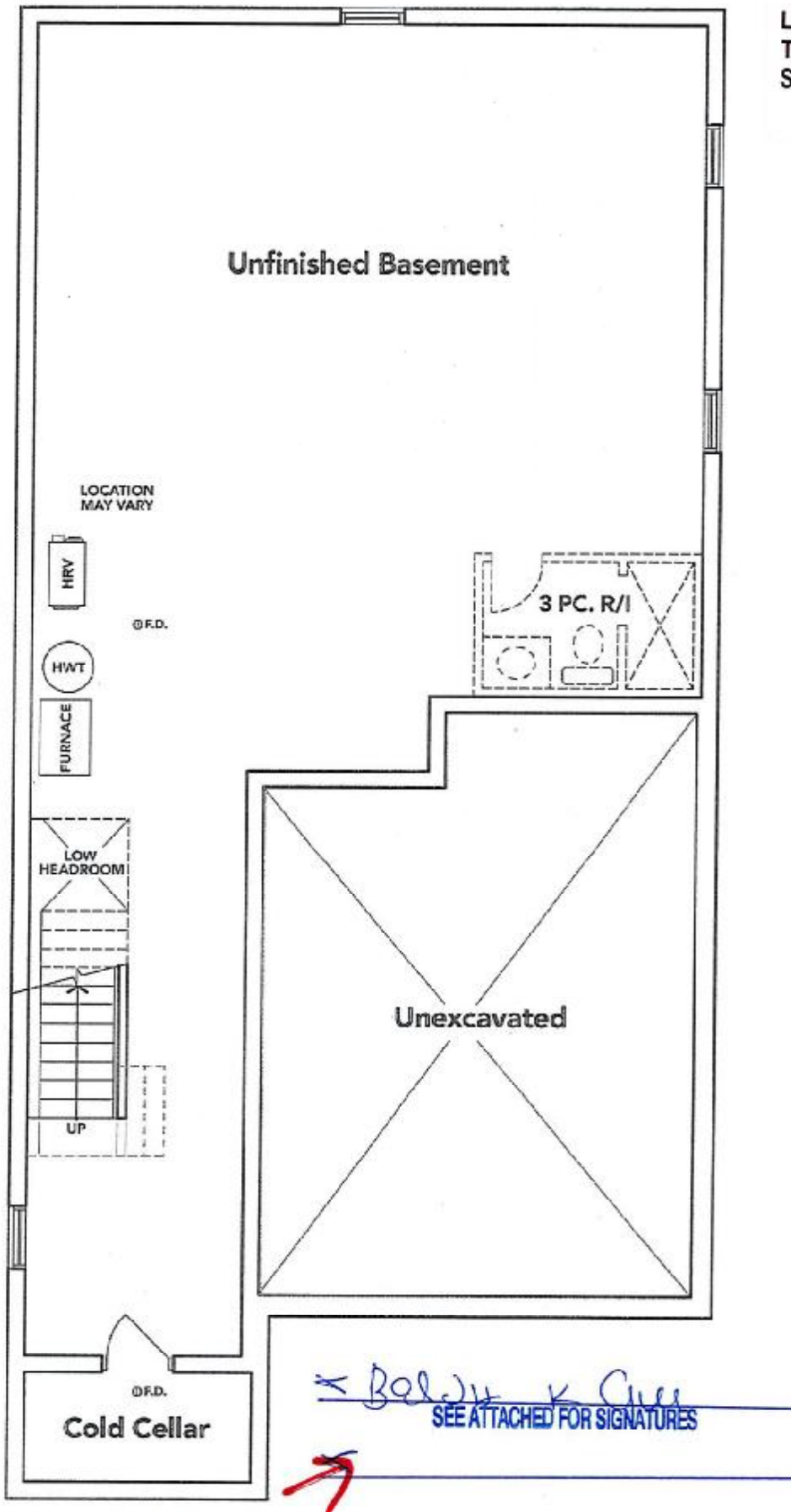

BASEMENT EL. A

The floor plans and elevations shown are pre-construction plans and may be revised or improved as necessitated by architectural controls and the construction process. The measurements adhere to the rules and regulations of the TARION Warranty Corporation's official method for the calculation of floor area. Materials, specifications and floor plans are subject to change without notice. All house renderings are artist's concept only. Actual usable floor space may vary from the stated floor area. All options shown are upgrades. E. & O. E.