

KINGSMEN (THAMES) INC. / Havelock Corners (Kingsmen)

Lot/Unit: 82 Phase/Building: 5B Model/Floor Plan: James (3601) Elev B 4 Bed - 2+1 Bath

ELECTRICAL

Inv.6382	1 - To supply & install the standard T.V. rough in in the great room and master bedroom... see sketch # 1 & # 2	
Line 80138	Note: Install the standard T.V. rough in at approx. 66" + - up from the floor centered + - to the F/P mantle in the great room.	
11Sep23 / 13Sep23		
Inv.6382	1 - To supply & install the standard Phone (CAT5) rough in in the great room, master bedroom and bedroom #2 ... see sketch # 1 & # 2	
Line 80139	Note: Install the standard Phone (CAT 5) rough in at approx. 66" + - up from the floor centered + - to the F/P mantle in the great room.	
11Sep23 / 13Sep23		
Inv.6382	1 - To SUPPLY AND INSTALL AN ADDITIONAL BASIC RECEPTACLE (NOT DEDICATED) at approx. 66" + - up from the floor centered + - to the F/P mantle	
Line 80204	Note: in the great room... see sketch # 1	
11Sep23 / 13Sep23		
This is for a future wall mount T.V. NO CONDUIT PIPE HAS BEEN PURCHASED.		

HARDWOOD

Inv.6382	1 - To supply & install the 3 1/2" Elements oak stained engineered hardwood floor to the main floor and stair landing(s) where applicable in lieu of the standard 3 1/2" Elements oak natural engineered hardwood floor...see colour chart for details.	
Line 80209	Note:	
11Sep23 / 13Sep23		

HEATING AND AIR CONDITIONING

Inv.6382	1 - As per schedule "PE": Vendor to install capped gas line (Rough in only) at rear of home for future BBQ location. Location to be finalized at vendors sole discretion.	
Line 80136	Note:	
11Sep23 / 13Sep23		
Inv.6382	1 - As per schedule "PE": Vendor to supply & install air conditioning unit, sized accordingly, from vendors standard samples.	
Line 80137	Note:	
11Sep23 / 13Sep23		

MISCELLANEOUS

PAINT AND DRYWALL

Inv.6382	1 - To supply & install the PAINT EXTRAS - STAIN RAILINGS WITH IRON PICKETS (INCLUDING STAIRS).. see colour chart for details.	
Line 80212	Note:	
11Sep23 / 13Sep23		

RAILING

Inv.6382	1 - To supply & install the RAILING - UPGRADE 1 - METAL HANDRAIL 3 INCH OVAL IN OAK - PICKETS STEEL ½ INCH SQUARE, PLAIN, WITH SHOES IN FLAT BLACK - POSTS 3½ INCH SQUARE, WITH CAP OAK IN OAK in lieu of the standard pickets and rails.	
Line 80211	Note:	
11Sep23 / 13Sep23		



CONSTRUCTION SUMMARY

KINGSMEN (THAMES) INC. / Havelock Corners (Kingsmen)

Lot/Unit: 82 Phase/Building: 5B Model/Floor Plan: James (3601) Elev B 4 Bed - 2+1 Bath

EXTRAS AS PER OFFER

5 FREE APPLIANCES ? STAINLESS STEEL FRONT - FRIDGE: STOVE AND DISHWASHER. WHITE WASHER AND DRYER (SUPPLIED ONLY, NOT INSTALLED, FROM BUILDERS STANDARD LINE). AN APPLIANCES VOUCHER WILL BE GIVEN BY OUR DECOR CONSULTANT AT THE TIME OF BOOKING YOUR COLOUR A <i>Worksheet</i> Note:	
5 FREE APPLIANCES – STAINLESS STEEL FRONT - FRIDGE; STOVE AND DISHWASHER. WHITE WASHER AND DRYER (SUPPLIED ONLY, NOT INSTALLED, FROM BUILDERS STANDARD LINE). AN APPLIANCES VOUCHER WILL BE GIVEN BY OUR DECOR CONSULTANT AT THE TIME OF BOOKING YOUR COLOUR A <i>Worksheet</i> Note:	
VENDOR TO INSTALL CAPPED GAS LINE (ROUGH-IN ONLY) AT REAR OF HOME FOR FUTURE BBQ LOCATION. LOCATION TO BE FINALIZED AT VENDORS SOLE DISCRETION. <i>Worksheet</i> Note:	
VENDOR TO SUPPLY & INSTALL AIR CONDITIONING UNIT, SIZED ACCORDINGLY, FROM VENDORS STANDARD SAMPLES. <i>Worksheet</i> Note:	

Purchaser: BALJINDER KAUR BADESHA
Telephone Res. / Bus: /
Decor Advisor: Barbara Coccia
Property: 82 of Plan - Draft Approval SB17-03-06
Project: KINGSMEN (THAMES) INC.
Model and Elevation: James (3601) Elev B 4 Bed - 2+1 Bath
Layout Changes: Yes No
Sketch Attached: Yes No
Exterior Colour Scheme:

1. Cabinetry

	Style and Colour	Counter Top	Hardware
Kitchen / Breakfast	#3 Charleston 3DL Moonlight	#1, C/S # 9141 Ice Snow 3cm.	# 12881 Handle
Kitchen Island	#3 Charleston 3DL Moonlight	#1, C/S # 9141 Ice Snow 3cm.	# 12881 Handle
Laundry Room	/		
Powder Room	#3 Charleston 3DL Moonlight	# 6698-46 Paloma Polar	# 12881 Handle
Main Bathroom	#3 Charleston 3DL Moonlight	# 1876K-52 Spring Carnival	# 12881 Handle
Master Ensuite Bathroom	#3 Charleston 3DL Moonlight	# 1876K-52 Spring Carnival	# 12881 Handle
Second Ensuite Bathroom (If Applicable)	/		
	/		
	/		

Appliances Custom Size Fridge Valance Lighting Microwave / Range Hood
Comment Cooktop / Rangetop Built in Wall Oven Slide-in Range

2. Flooring

	Selection
Foyer	13x13" Piaggio White
Main Hall	13x13" Piaggio White
Back Hall	/
Breakfast	13x13" Piaggio White
Laundry Room	13x13" Cinq White
Kitchen	13x13" Piaggio White
Powder Room	13x13" Piaggio White
Main Bathroom	13x13" Cinq White
Master Ensuite	13x13" Cinq White
Bathroom (If Applicable)	/
Mud Room	13x13" Piaggio White
Master ens. shower floor:	2x2" Ontario Snow White Matte
Living Room	/
Dining Room	/
Family / Great Room	**3 1/2" Elements Oak Strugeon
Den / Library / Study	/
Basement Landing (If Applies)	
Lower Landing (If Applicable)	**3 1/2" Elements Oak Strugeon
Upper Landing	(If applicable) **3 1/2" Elements Oak Strugeon
Upper Hall	Modern Story # 927 Morning Rain
Master Bedroom	Modern Story # 927 Morning Rain
Bedroom #2	Modern Story # 927 Morning Rain
Bedroom #3	Modern Story # 927 Morning Rain
Bedroom #4	Modern Story # 927 Morning Rain
Bedroom #5	/
Master ens. shower Jamb:	Anatolia Marmiline SNOW

Purchaser:

BALJINDER KAUR BADESHA

Telephone Res. / Bus:

/

Decor Advisor:

Barbara Coccia

2. Flooring - Continued -

Property:

82 of Plan - Draft Approval SB17-03-08

Project:

KINGSMEN (THAMES) INC.

Model and Elevation:



James (3601) Elev B 4 Bed - 2+1 Bath

Upgrade Underpad	Type	Area
	Standard	2nd. floor
Carpet on Stairs	Capped	Runner - *Upgrade
Comment	/	/
/		

3. Plumbing Fixtures / Faucets

Kitchen	Standard	Second Ensuite	/	Powder Room	Standard
Master Ensuite	Standard			Other Room	/
Main Bathroom	Standard	/			
Comment					
Still to install the standard top mount kitchen sink.					

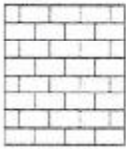
4. Wall Tile

	Tile Selection	Listello	Insert	Insert Selection
Main Bathroom	8x10" Cinq White	<input type="checkbox"/>	<input type="checkbox"/>	
Master Ensuite				
Tub Deck	13x13" Cinq White	<input type="checkbox"/>	<input type="checkbox"/>	
Tub Apron	13x13" Cinq White	<input type="checkbox"/>	<input type="checkbox"/>	
Tub Surround	13x13" Cinq White	<input type="checkbox"/>	<input type="checkbox"/>	
Shower Stall	8x10" Cinq White	<input type="checkbox"/>	<input type="checkbox"/>	
Second Ensuite	/	<input type="checkbox"/>	<input type="checkbox"/>	
	/	<input type="checkbox"/>	<input type="checkbox"/>	
	/	<input type="checkbox"/>	<input type="checkbox"/>	
Kitchen Backsplash	/	<input type="checkbox"/>	<input type="checkbox"/>	
Complete Backsplash	/	<input type="checkbox"/>	<input type="checkbox"/>	
Comment				
/				
				
		horizontal stacked	brick pattern	vertical stacked
				diagonal/diamond

5. Fireplace

	Living Room			Family Room			Other Room - Specify Great Room		
	Purchased	As Per Plan	N/A	Purchased	As Per Plan	N/A	Purchased	As Per Plan	N/A
Fireplace Type	<input type="radio"/>	<input type="radio"/>	<input checked="" type="radio"/>	<input type="radio"/>	<input type="radio"/>	<input checked="" type="radio"/>	<input type="radio"/>	<input checked="" type="radio"/>	<input type="radio"/>
Mantle Type							Front Facing		
Over Mantle							NF-08		
Colour / Stain							/		
Surround							White		
Hearth							/		
Comment							/		
/									

BK

Purchaser: BALJINDER KAUR BADESHA

Property: 82 of Plan - Draft Approval SB17-03-08

Telephone Res. / Bus: /

Project: KINGSMEN (THAMES) INC.

Decor Advisor: Barbara Coccia

Model and Elevation: James (3601) Elev B 4 Bed - 2+1 Bath

6. Trim Carpentry

Door Hardware Standard Handle

Interior Trim Standard

Comment

/

Interior Doors

☐ 2 Panel Arch Top

☒ 2 Panel Square Top

☐ 6 Panel

Initial for Door Style

BK

7. Railings and Pickets

Railing Package **Upg. 1 Metal picket package

Railing Colour **Elements Strugeon

Picket Colour BLACK

Wood Stairs ☐ No ☒ Oak

Tread Colour **Elements Strugeon

Comment

/

8. Plaster Mouldings and Medallions

Foyer /

Main Hall /

Living Room /

Dining Room /

Family Room /

Kitchen/Breakfast /

Den/Library /

Lower Landing /

Comment

/

9. Wall Paint

Kingsmen White

Smooth Ceilings

☐ First Floor

☐ First Floor incl. Second Floor Hall

☐ First and Second Floor

☒ Throughout

☐ Not Applicable

Trim Paint Kingsmen White

10. Additional Comments

/

11. Disclaimers and Notes

- Colours of all materials are as close as possible to builder's selection, but not necessarily identical due to variances in manufacturing.
- Any extras listed above are null and void unless accompanied by a separate invoice/amendment. Said invoice must be paid in full.
- The Purchaser acknowledges that after Interior Colour Selection form is signed and dated, no further changes will be permitted other than re-selection due to unavailability. BK Purchaser's Initials
- The Purchaser acknowledges reading and accepting the "Kingsmen Group Décor Centre Disclaimers" form. This document contains other miscellaneous disclaimers.

This Interior Colour Selection is final and approved by:

Purchaser:

Signature: Baljinder Kaur Badesha Date: 13-Sep-2023

Vendor:

KINGSMEN (THAMES) INC.

LOT 82
THAMES PH. 5B
SKETCH #1

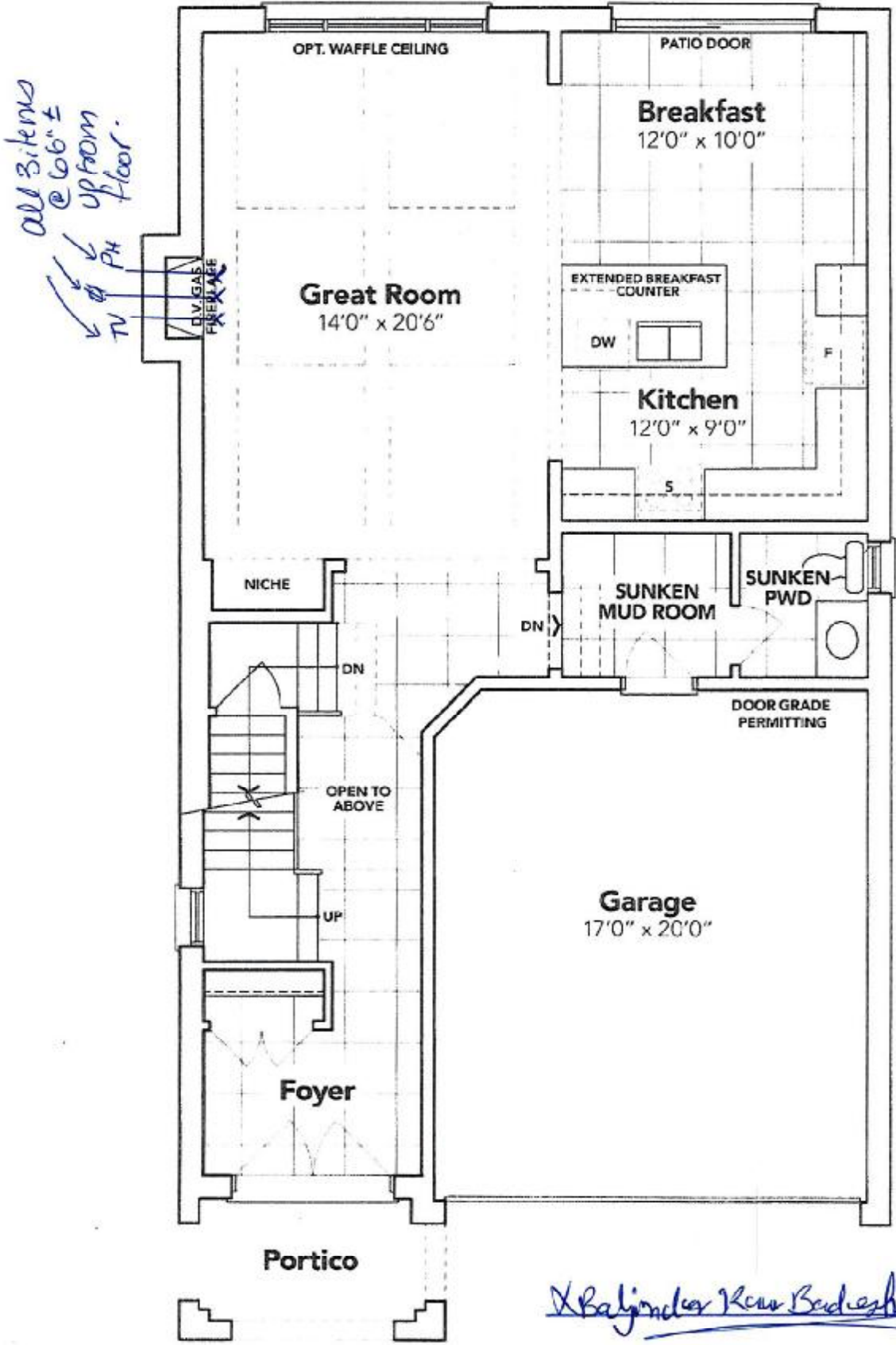

GROUND FLOOR EL. B

The floor plans and elevations shown are pre-construction plans and may be revised or improved as necessitated by architectural controls and the construction process. The measurements adhere to the rules and regulations of the TARION Warranty Corporation's official method for the calculation of floor area. Materials, specifications and floor plans are subject to change without notice. All house renderings are artist's concept only. Actual usable floor space may vary from the stated floor area. All options shown are upgrades. E. & O. E.

5B-82

LOT 82
THAMES PH. 5B
SKETCH #2

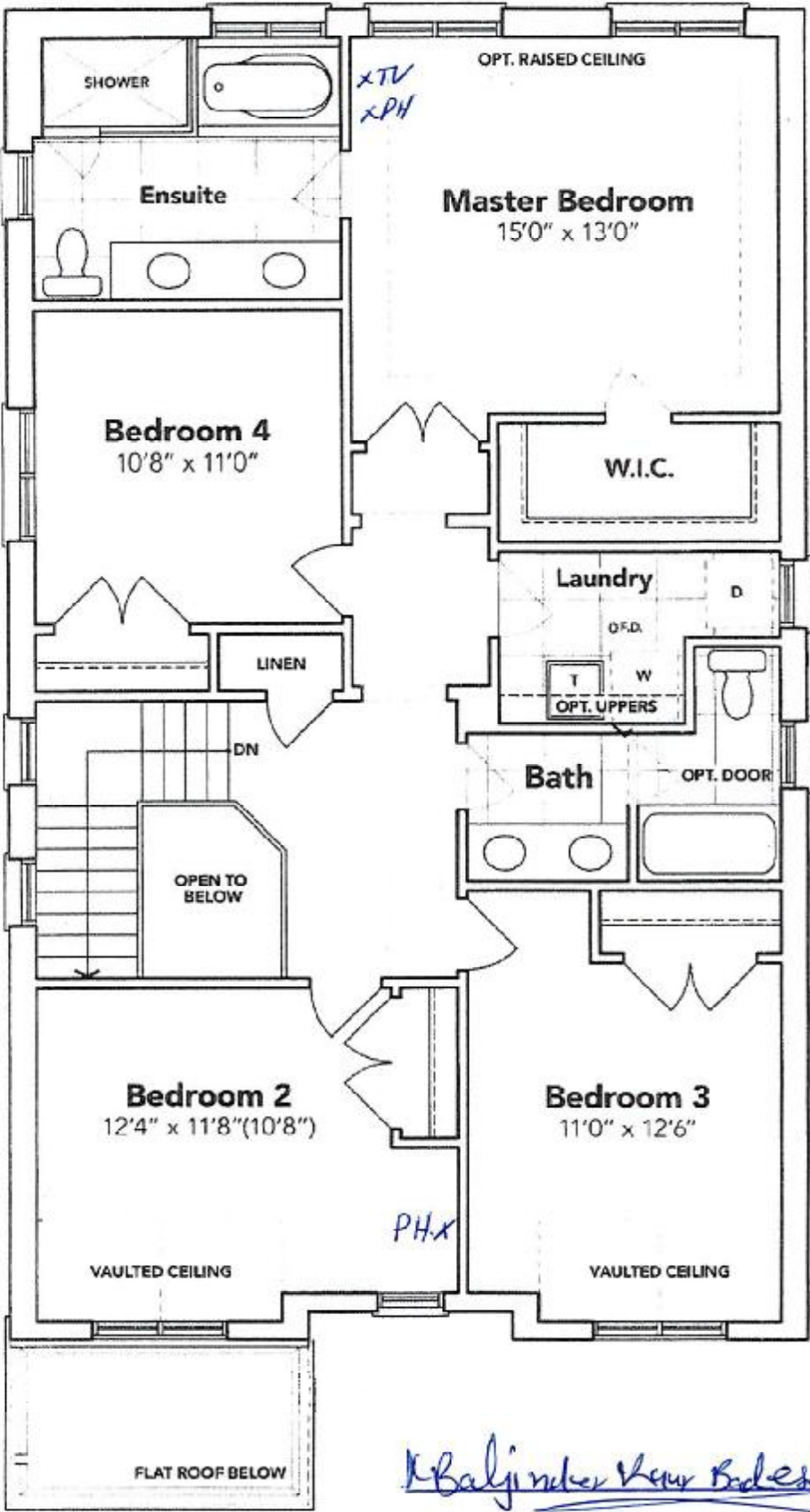

SECOND FLOOR EL. B

The floor plans and elevations shown are pre-construction plans and may be revised or improved as necessitated by architectural controls and the construction process. The measurements adhere to the rules and regulations of the TARION Warranty Corporation's official method for the calculation of floor area. Materials, specifications and floor plans are subject to change without notice. All house renderings are artist's concept only. Actual usable floor space may vary from the stated floor area. All options shown are upgrades. L. & O. E.

B.B.

Initials:

5B-82

SCHEDULE "B-1"
Floor Plan

Lot 82
Phase 5B
Model: James (3601) Elev B 4 Bed - 2+1 Bath
Standard

LOT 82
THAMES PH. 5B
SKETCH #3

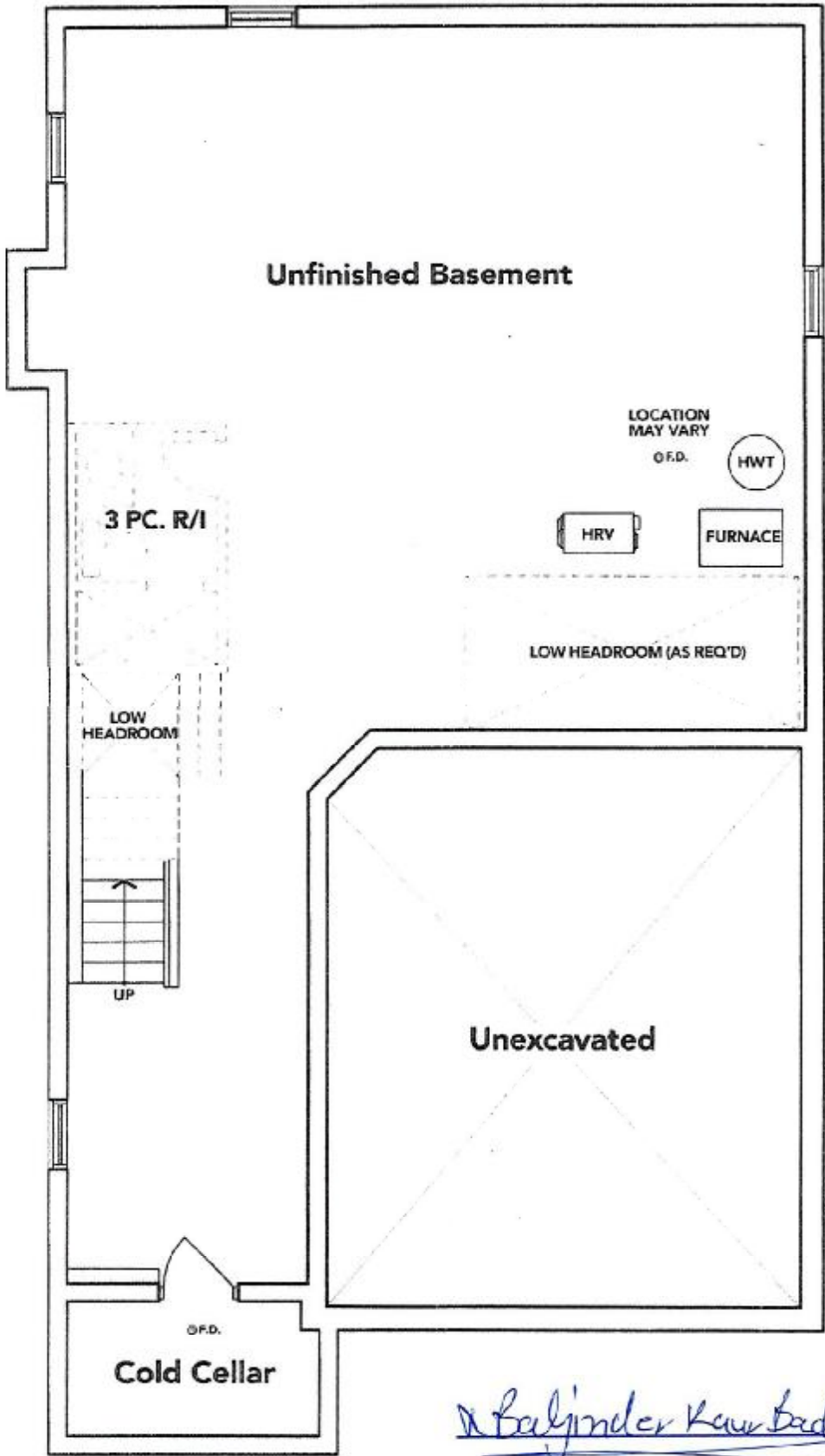

BASEMENT EL. B

The floor plans and elevations shown are pre-construction plans and may be revised or improved as necessitated by architectural controls and the construction process. The measurements adhere to the rules and regulations of the TARIION Warranty Corporation's official method for the calculation of floor area. Materials, specifications and floor plans are subject to change without notice. All house renderings are artist's concept only. Actual usable floor space may vary from the stated floor area. All options shown are upgrades. E. & O. E.